



42A01SW8928 10 BURT

010

DIAMOND DRILLING

Township: Burt

Report No: 10

WORK PERFORMED FOR: Billiton Exploration Canada Ltd.

RECORDED HOLDER: SAME AS ABOVE [ ]

: OTHER [X] Chevron Minerals Ltd.

<u>CLAIM NO.</u>	<u>HOLE NO.</u>	<u>FOOTAGE</u>	<u>DATE</u>	<u>NOTE</u>
L 779885	B84-1	375'	Oct/84	(1)
L 755198	B84-2	382'	Oct/84	(2)

NOTES: (1) #372-86 (filed in May/87)  
(2) #436-86 (filed in May/87)

Project: BURT  
 Location: Recon. Profile 1  
 Co-ordinates: Line 1  
9 + 00N

Collar Elev: 1030 ft.  
 Bottom Elev: 715 ft.  
 Collar Declination: -60°  
 Collar Bearing: 170°

Length: 375 ft.  
 Casing: 47 ft. BW  
 Core Size: BQ  
 Drilled by: Heath & Sherwood

Page: 1 of 5  
 Commenced: October 18, 1984  
 Completed: October 22, 1984  
 Logged by: H. Coates

DEPTH ( ft. )		INTERVAL	CORE RECOVERED (%)	DESCRIPTION	ASSAY DATA													
FROM	TO				SAMPLE	FROM	TO	INTERVAL										
0	47	47	-	Casing through overburden (boulders, gravel, till) - pulled														
47	55	8	100	<u>Huronian Arkose</u> : Medium-grained, massive, buff to pinkish quartzo feldspathic sediment. Minor quartz carbonate veining. 49.5 - one-half inch quartz carbonate vein oriented 75° to core axis. bedding at lower contact 75° to core axis.														
55	79	24	100	<u>Huronian Siltstone</u> : Massive green siltstone. Blocky ground due to jointing and surface weathering. No evidence of faulting. Gradational contact.														
79	89	10	100	<u>Huronian Siltstone minor arkose</u> : Massive green siltstone with one-half to 4 inch beds of reddish-pink arkose. Siltstone 90%. Arkose 10%.														

CANADIAN GEOLOGICAL SURVEY  
 ASSESSMENT FILES  
 RESEARCH OFFICE  
 OCT 3 1984  
 RECEIVED





PROJECT: BURT

HOLE NO. DD B84-1

PAGE: 4 OF 5

DEPTH ( ft. )		INTERVAL	CORE RECOVERED (%)	DESCRIPTION	ASSAY DATA									
FROM	TO				SAMPLE	FROM	TO	INTERVAL						
315.5	375	59.5	100	Timiskaming Conglomerate: As above. Deformed and schistose with streaks and wisps of sericitic alteration and occasional wisps of fuchsite.										
				338 - 2-inch quartz vein.										
				END OF HOLE.										
				Acid test: 150', 300'										

*R. W. Valley*

PROJECT: BURT

HOLE NO. DD B84-1

PAGE: 5 OF 5

Hole Survey Data				Core Angles						Specific Gravity				REMARKS
METHOD	DEPTH	DECLINATION	BEARING	DEPTH	BEDDING	SCHISTOSITY	JOINT, CLEAVAGE	FAULT	QUARTZ VEIN	DEPTH	% SULPHIDES	S.G.	TONNAGE FACTOR	
ACID	150 ft.	59°	---	49.5					75°					
ACID	300 ft.	55°	---	55	75°									
				114	65°									
				115	35°	35°								
				140	30°	30°								
				180	40°	40°								
				250	40°	40°								
				330	40°	40°								
				360	45°	45°								

FEDERAL GEOLOGICAL SURVEY  
 ASBESTOS FILE  
 WASHINGTON, D.C.  
 OCT 3 1968  
 R. E. G.

Project: BURT

Collar Elev. 1095 ft.

Length: 382 ft.

Page: 1 of 7

Location: Recon. Profile 2

Bottom Elev. 760 ft.

Casing: 13 ft. BW

Commenced: October 13, 1984

Co-ordinates: Line 2

Collar Declination: -60°

Core Size: BQ

Completed: October 16, 1984

10 + 90N

Collar Bearing: 170°

Drilled by: Heath & Sherwood

Logged by: H. Coates

DEPTH ( ft. )		INTERVAL	CORE RECOVERED (%)	DESCRIPTION	ASSAY DATA														
FROM	TO				SAMPLE	FROM	TO	INTERVAL											
0	13	13	0	Casing through overburden - pulled.															
13	45.5	32.5	100	Huronian Siltstone: Massive green siltstone with occasional 1 to 3 cm layers of green fine sandy greywacke. 13-26, 33-39 blocky ground. Bedding: 60° to core axis. Thin quartz carbonate veins ±5 mm at 20° to core axis.															
45.5	51	5.5	100	Huronian Greywacke: Massive green fine sandy greywacke with a few thin interlayers of green siltstone. Soft sediment slump features at gw/ss contacts.															
51	81.5	30.5	100	Huronian Siltstone: Massive green siltstone with occasional 0.5 to 3 cm thick layers of fine sandy greywacke. 52-63 fault breccia at low angle to core axis. Bedding: 75° to core axis.															

ONTARIO GEOLOGICAL SURVEY  
 ASSESSMENT FILES  
 RESEARCH OFFICE  
  
 OCT 29 1984  
  
 RECEIVED













PROJECT: BURT

HOLE NO.: DD B84-2

PAGE: 7

OF 7

Hole Survey Data				Core Angles						Specific Gravity				REMARKS
METHOD	DEPTH	DECLINATION	BEARING	DEPTH	BEDDING	SCHISTOSITY	JOINT, CLEAVAGE	FAULT	QUARTZ VEINS	DEPTH	% SULPHIDES	S.G.	TONNAGE FACTOR	
Acid	150 ft.	60°	---	40	60°				20°					
Acid	300 ft.	61°	---	52				20°						
				60	75°									
				82	45°									
				120	60°									
				180	70°									
				205				30°						
				225	75°									
				240	75°									
				262	55°									
				290	65°									

ONTARIO GEOLOGICAL SURVEY  
 ASSESSMENT FILES  
 RESEARCH OFFICE  
 OCT 29 1985  
 RECEIVED

THE PROPERTY

HOLMES  
BURT

BURT  
EBY

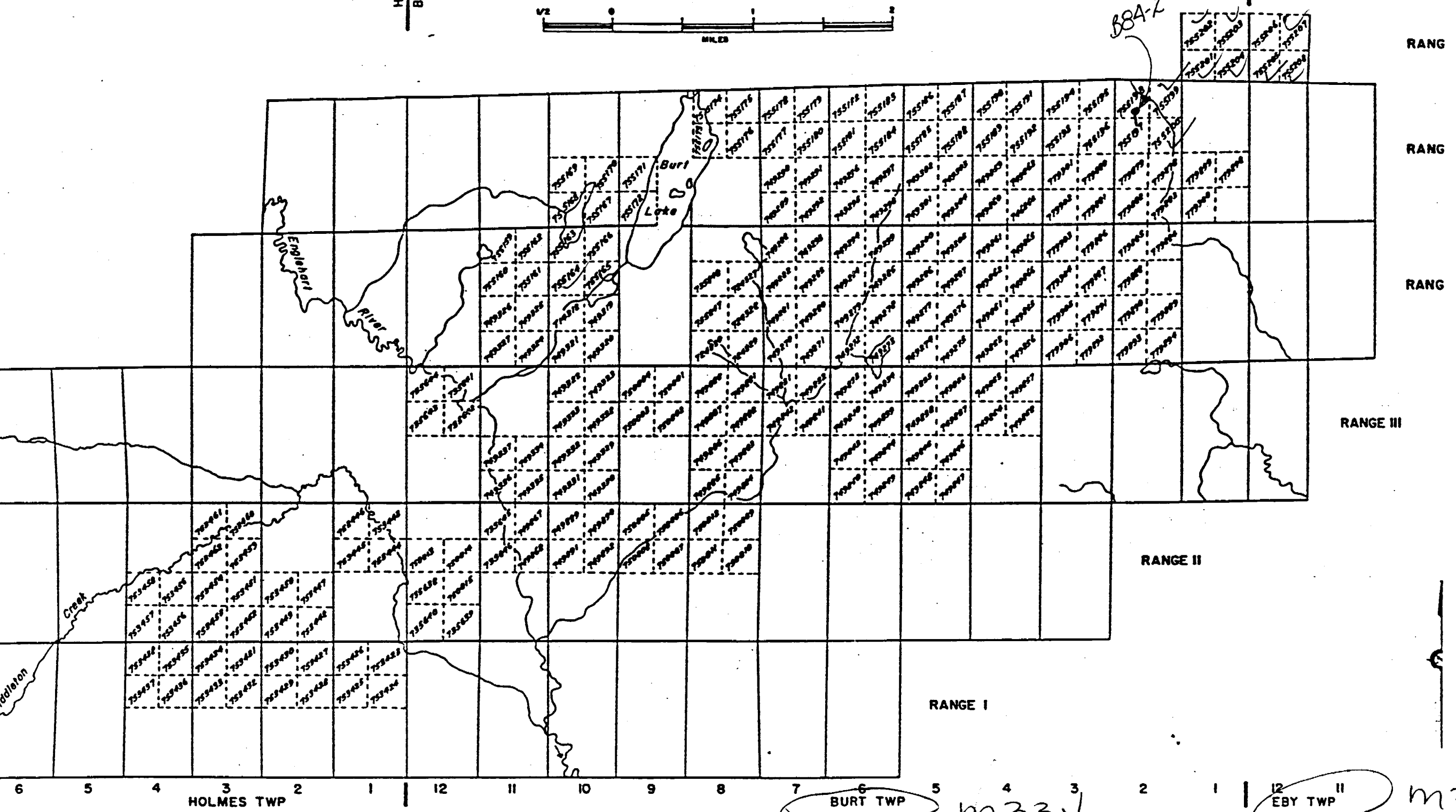
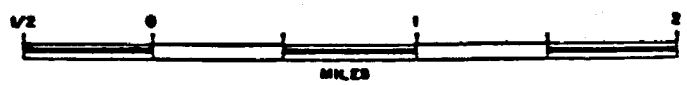

BURT TWP m334

EBY TWP m345

BILLITON CANADA LTD; April, 1

Figure 2



Name and Postal Address of Recorded Holder: **CHEVRON MINERALS LTD.** T-1690

**#1714-390 BAY STREET, TORONTO, ONTARIO M5H 2Y2**

Summary of Work Performance and Distribution of Credits

Total Work Days Cr. claimed <b>375.60</b>	Mining Claim			Work Days Cr.	Mining Claim			Work Days Cr.	Mining Claim			Work Days Cr.
	Prefix	Number			Prefix	Number			Prefix	Number		
for Performance of the following work. (Check one only) <input type="checkbox"/> Manual Work <input type="checkbox"/> Shaft Sinking Drifting or other Lateral Work. <input type="checkbox"/> Compressed Air, other Power driven or mechanical equip. <input type="checkbox"/> Power Stripping <input checked="" type="checkbox"/> Diamond or other Core drilling <input type="checkbox"/> Land Survey	L			L			L	749283		36.6		
								749284		36.6		
								749285		36.6		
								749288		36.6		
		735638		20				749289		36.6		
		735639		20				749290		36.6		
		735640		5.60				749291		36.6		
							749282		36.6			

All the work was performed on Mining Claim(s): **L779885** MINING GEOLOGICAL SURVEY

Required Information eg: type of equipment, Names, Addresses, etc. (See Table Below)

**HEATH & SHERWOOD DRILLING**  
 34 DUNCAN AVENUE NORTH  
 BOX 898  
 KIRKLAND LAKE, ONTARIO  
 P2N 3L3

**DIAMOND DRILL HOLE B84-1**  
 TOTAL FOOTAGE **375 feet**

**DRILLED BETWEEN OCTOBER 18, 1984 and OCTOBER 22, 1984**

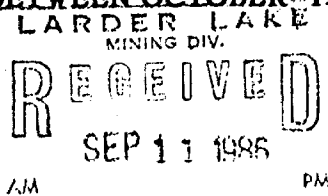
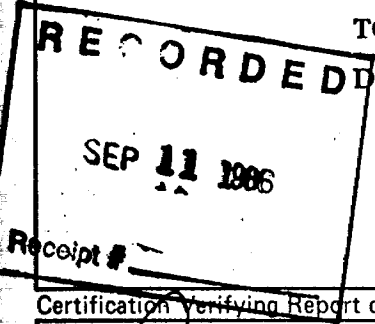
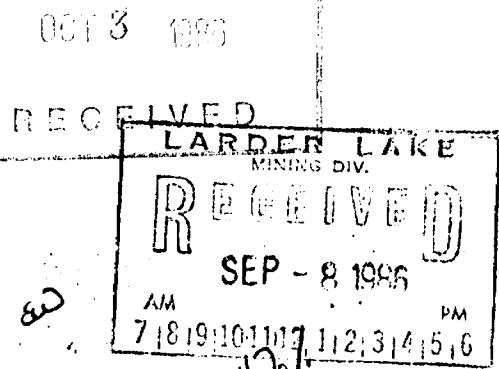

Date of Report: **September 5/86**  
 Recorded Holder or Agent (Signature): *[Signature]*

Certification Verifying Report of Work

I hereby certify that I have a personal and intimate knowledge of the facts set forth in the Report of Work annexed hereto, having performed the work or witnessed same during and/or after its completion and the annexed report is true.

Name and Postal Address of Person Certifying: **H WATKINS, Billiton Metals Canada Inc, #1006, 141 Adelaide Street West Toronto,**

Date Certified: **Sept 5<sup>th</sup> 1986**  
 Certified by (Signature): *[Signature]*

Table of Information/Attachments Required by the Mining Recorder

Type of Work	Specific information per type	Other information (Common to 2 or more types)	Attachments
Manual Work	Nil	Names and addresses of men who performed manual work/operated equipment, together with dates and hours of employment.	Work Sketch: these are required to show the location and extent of work in relation to the nearest claim post.
Shaft Sinking, Drifting or other Lateral Work			
Compressed air, other power driven or mechanical equip.	Type of equipment	Names and addresses of owner or operator together with dates when drilling/stripping done.	
Power Stripping	Type of equipment and amount expended. Note: Proof of actual cost must be submitted within 30 days of recording.		
Diamond or other core drilling	Signed core log showing: footage, diameter of core, number and angles of holes.		Work Sketch (as above) in duplicate
Land Survey	Name and address of Ontario land surveyer.	Nil	Nil

Name and Postal Address of Recorded Holder: **HEVRON MINERALS LTD.**  
 Prospector's Licence No.: **T-1690**  
**#1714 - 390 BAY STREET, TORONTO, ONTARIO M5H 2Y2**

Summary of Work Performance and Distribution of Credits

Total Work Days Cr. claimed 382	Mining Claim			Mining Claim			Mining Claim		
	Prefix	Number	Work Days Cr.	Prefix	Number	Work Days Cr.	Prefix	Number	Work Days Cr.
for Performance of the following work. (Check one only) <input type="checkbox"/> Manual Work <input type="checkbox"/> Shaft Sinking Drifting or other Lateral Work. <input type="checkbox"/> Compressed Air, other Power driven or mechanical equip. <input type="checkbox"/> Power Stripping <input checked="" type="checkbox"/> Diamond or other Core drilling <input type="checkbox"/> Land Survey	L	755199	36.6	L	755208	36.6			
		755200	36.6		755165	20			
		755201	36.6		755164	11.6			
		755202	57.6						
		755203	36.6						
		755204	36.6						
		755205	36.6						
		755207	36.6						

ONTARIO GEOLOGICAL SURVEY  
 ASSESSMENT & RESEARCH OFFICE  
 OCT 29 1986

All the work was performed on Mining Claim(s): **L755198**  
**RECEIVED**

Required Information eg: type of equipment, Names, Addresses, etc. (See Table Below)

**HEATH & SHERWOOD DRILLING**  
 34 DUNCAN AVENUE  
 BOX 898  
 KIRKLAND LAKE, ONTARIO  
 P2N 3L3

LADDER LAKE  
 RECEIVED  
 OCT 16 1986  
 AM PM  
 7 8 9 10 11 12 1 2 3 4 5 6

**RECORDED**  
 OCT 16 1986  
 Receipt # \_\_\_\_\_

DIAMOND DRILL HOLE B84-2  
 TOTAL FOOTAGE 382'  
 DRILLED BETWEEN OCTOBER 13 and OCTOBER 16, 1984

Date of Report: **October 15/86**  
 Recorded Holder or Agent (Signature): *[Signature]*

Certification Verifying Report of Work

I hereby certify that I have a personal and intimate knowledge of the facts set forth in the Report of Work annexed hereto, having performed the work or witnessed same during and/or after its completion and the annexed report is true.

Name and Postal Address of Person Certifying: **W. E. Glenn 390 Bay St Suite 1714 Toronto Ont M5H 2Y2**  
 Date Certified: \_\_\_\_\_  
 Certified by (Signature): *[Signature]*

Table of Information/Attachments Required by the Mining Recorder

Type of Work	Specific information per type	Other information (Common to 2 or more types)	Attachments
Manual Work	Nil	Names and addresses of men who performed manual work/operated equipment, together with dates and hours of employment.	Work Sketch: these are required to show the location and extent of work in relation to the nearest claim post.
Shaft Sinking, Drifting or other Lateral Work			
Compressed air, other power driven or mechanical equip.	Type of equipment	Names and addresses of owner or operator together with dates when drilling/stripping done.	Work Sketch (as above) in duplicate
Power Stripping	Type of equipment and amount expended. Note: Proof of actual cost must be submitted within 30 days of recording.		
Diamond or other core drilling	Signed core log showing; footage, diameter of core, number and angles of holes.	Nil	Nil
Land Survey	Name and address of Ontario land surveyer.		



# BOMPAS TWP.

(1) W.71/76 104517 21/2/74  
(2) W.71/76 100581 15/12/76  
(3) NR.W.33/79 139857 14/5/79  
(4) NR.W.32/30 129365 9/7/80  
(5) W.24/32 188522 29/11/82

S.R.O.  
S.R.O.  
S.R.O.  
S.R.O.  
S.R. 198.

## START 10 MILE DISTANCE

Portage

Bunt Lake

AREA WITHDRAWN FROM STAKING SECTION 42 MINING ACT

FILE 164956

TOWER SITE S.R.O. RESERVED

CABIN SITE

VI  
V  
IV  
EBY TWP.

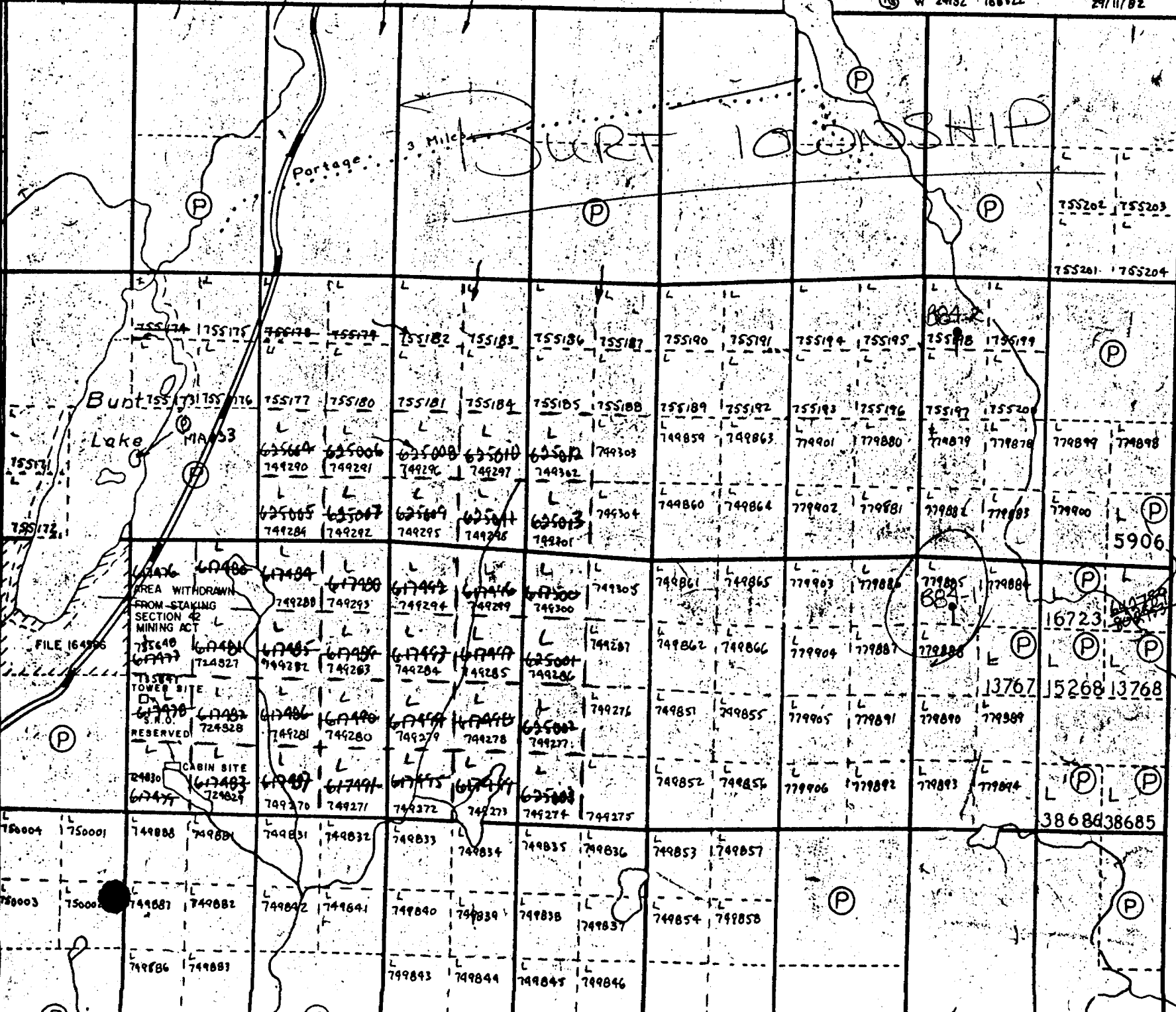

M.334

BURT TWP

M.334

# BURT TOWNSHIP

# 30

## LARDER LAKE MINING DIVISION DISTRICT OF TIMISKAMING

### M.334

Areas withdrawn from staking under Section 43 of the Mining Act (R.S.O. 1970).

#### LEGEND

PATENTED LAND  
CROWN LAND SALE  
LEASES  
LICENSE OF OCCUPATION  
LOCATED LAND  
MINING RIGHTS ONLY  
SURFACE RIGHTS ONLY  
CANCELLED

CS.  
L.O.  
Loc.  
M.R.O.  
S.R.O.  
C.

Mining & surface rights withdrawn from staking, prospecting, sale or lease, Sec 36, The Mining Act, R.S.O. 1980  
Order No. NRW 24/82 Nov 29, 1982 1:40 pm

400' surface rights reservation along the shores of all lakes and rivers.

SCALE 40 CHAINS TO ONE INCH

BOMPAS TWP.

Order No.	File	Date	Disposition
W.7/74	104317	21/2/74	S.R.O.
W.7/76	100581	15/12/76	S.R.O.
NRW 33/79	159857	14/5/79	S.R.O.
NRW 92/80	124365	9/7/80	S.R.O.
W 24/82	188522	29/11/82	SR & MR

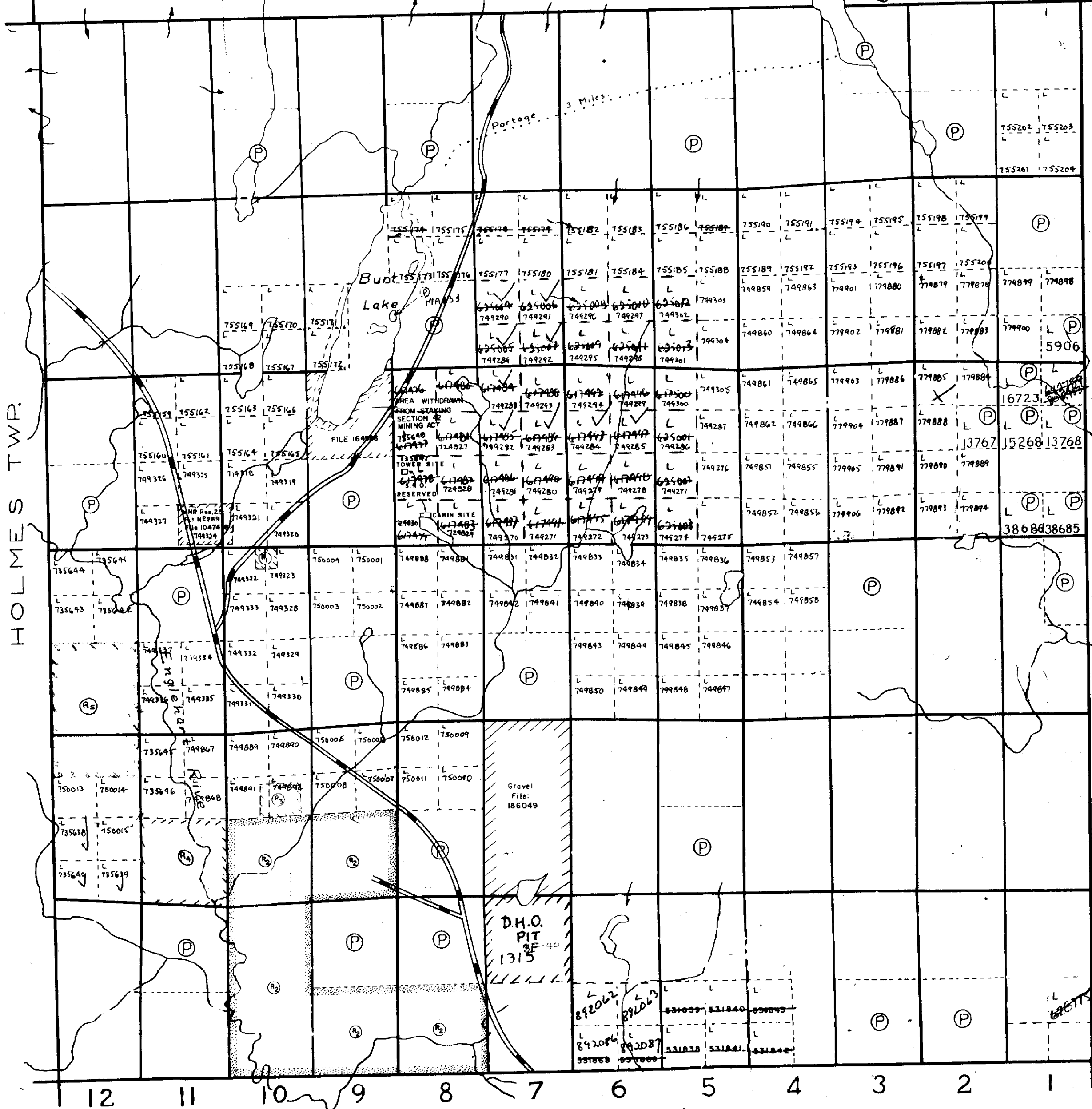

HOLMES TWP.

VI

V

IV

III

II

I

EBY TWP.

GROSS TWP.

ONTARIO

MINISTRY OF NATURAL RESOURCES

SURVEYS AND MAPPING BRANCH

M.334

BURT TWP

M.334

