



42A02NW0026 2.9079 FALLON

010

Basal Till Sampling  
Report  
for Assessment Work Credits  
on the  
Fallon South Grid  
Fallon Township  
Porcupine Mining Division  
District of Timiskaming, Ontario

NTS 42 A/2 and 3  
Latitude: 48°14'N  
Longitude: 80°59'W  
April 15, 1986

By: P. Miller

*Equal on this file*

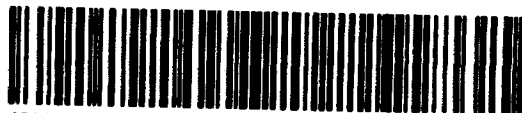

42A02NW0028 2.9079 FALLON

010C

TABLE OF CONTENTS

<u>TABLE</u>	<u>PAGE</u>
INTRODUCTION AND SUMMARY OF RESULTS	1
LOCATION AND ACCESS	5
PHYSIOGRAPHY AND VEGETATION	5
PROPERTY DESCRIPTION	6
SURVEY PROCEDURE	6
PROPERTY GEOLOGY	7
LITHOLOGY	7
QUATERNARY GEOLOGY	9
STRUCTURAL GEOLOGY	10
ECONOMIC GEOLOGY	10
RESULTS OF TILL IDENTIFICATIONS	11
RESULTS OF -5 MESH CLAST IDENTIFICATIONS	11
HEAVY MINERAL (+3.2 gm/cm <sup>3</sup> ), -5 to +250 MESH IDENTIFICATION	12
BIBLIOGRAPHY	14
CERTIFICATION	15
APPENDICES: I Overburden Drill Logs	
II Mineral Identifications of the Heavy Mineral Separates of the -5 to +250 Size Fraction	
III Technical Data Statement	

FIGURES

<u>FIGURE</u>		<u>PAGE</u>
1	LOCATION MAP (1:1,600,000)	3
2	LOCATION MAP (1:250,000)	4

MAPS

- 1 BASAL TILL SAMPLING, +5 MESH CLAST LITHOLOGY IDENTIFICATION (Back Pocket of Report)

## INTRODUCTION AND SUMMARY OF RESULTS

This report describes the results of a basal till sampling program performed over selected VLF electromagnetic anomalies on the Fallon South grid. The anomalies were previously outlined during a geophysical survey undertaken in 1984. Important information was gained about the bedrock geology, mineralization, alteration, deformation and type of overburden cover in the vicinity of the conductors. The Fallon South property is situated in Fallon township, 38 kilometers southwest of the city of Timmins. Mr. David J. Meunier, of South Porcupine, Ontario, is the owner of the surveyed claims.

R. Cormier and Associates Ltd. were contracted to carry out the basal till sampling program and subsequent sample preparation. Sampling was completed between June 12, 1985 to July 25, 1985 by two persons employing a percussion pionjar portable drill unit. Four lines of holes were drilled over the entire widths of ~~three~~ conductors and over portions of two other conductors. The holes were drilled at both 12.5 and 25.0 meter intervals across the conductors on metric grid lines trending at 025°. In total, 55 holes, with an aggregate length of 561.3 meters, were drilled. The average cost per hole, including sample preparation, was \$141.80 giving a total expenditure of \$7,800.

Microscopic, mineralogical and lithological identifications were respectively performed on the heavy mineral separates of the -5 to +250 mesh and the entire +5 mesh size fractions of the overburden samples. The -5 to +250 mesh identifications were done by C. F. Gleeson and Associates Ltd. and the +5 mesh identifications were done by the author of this report.

Basal till was recovered at 81% of the sample locations. The depth of overburden varied from 0.0 to 30.0 meters and had an average depth of 10.2 meters. Basal till generally had a thickness of less than one meter.

The mineralogical and lithological identifications failed to identify the direct causes of any of the conductors. Lithological identification of the +5 mesh size fraction found that the conductors are mainly associated with intercalated intermediate pyroclastics and mafic volcanic flows that are intruded by minor porphyritic monzonite dikes. Minor amounts of diabase, Huronian sediments, intermediate flows, felsic volcanic flows and tuffs and Archean sediments were also observed in the +5 mesh size fraction. Volcanic clasts have undergone weak to moderate chlorite, silica carbonate, epidote and pyrite alteration. Pyroclastic clasts typically host trace to 1% pyrite. Alteration of the volcanics is widespread and is believed to be related to a period of isoclinal folding, attendant shearing and the intrusion of monzonite dikes and plugs. Late stage quartz ± hematite veins cross-cut this earlier alteration assemblage.

The heavy mineral, -5 to +250 size fraction, of samples 5091 and 5100 contains 25% pyrite and 25% galena respectively. Thirty four percent of the clasts in the +5 mesh size fraction of sample 5100 consists of vein quartz-carbonate. One of the vein quartz-carbonate clasts was observed to host galena.

It is concluded that the VLF conductors, covered by the survey, are probably structural features related to shearing in a predominantly east south east direction.

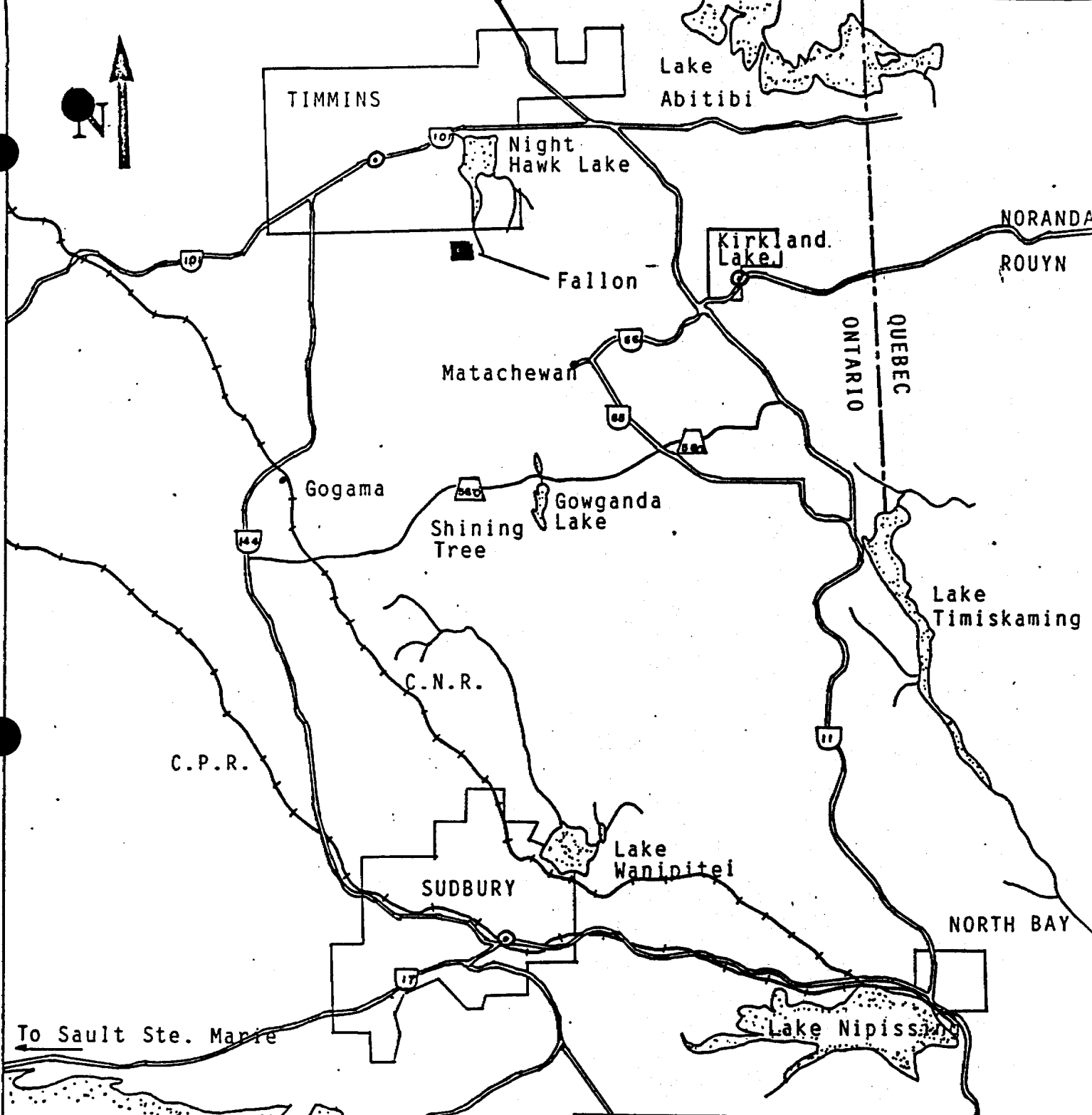

MEUNIER OPTION	
FALLON PROPERTY	
LOCATION MAP	
Date	Sept. 1985
Scale	1:1,600,000
P.M.	Fig. 1

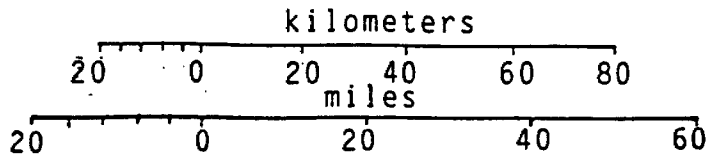



Location Map-Fallon Property

Scale 1:250,000

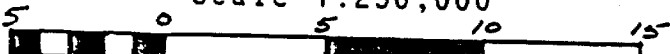

KILOMETERS

Figure 2.

### LOCATION AND ACCESS

The claims discussed in this report are located in Fallon township, approximately 38 kilometers southwest of the city of Timmins. Centered at latitude 48°14' north and 80°59' west, the property is situated in NTS quadrants 42A/2 and 3. Figures 1 and 2 illustrate the property's location at scales of 1:1,600,000 and 1:250,000 respectively.

Gravel road access is available to the property commencing at Connaught Hill, south of South Porcupine. The Langmuir Mine Road is followed for a distance of 15.2 kilometers until the junction with Night Hawk Timber Co. Ltd.'s private access road is met. The access road is followed south for a distance of approximately 21 kilometers. At this point a four wheel drive track can be followed in an easterly direction for four kilometers to within a kilometer of the western portion of the surveyed grid.

### PHYSIOGRAPHY AND VEGETATION

The majority of the property is low lying or gently undulating having a maximum relief of 2.5 meters. Areas of outcrop exposed north of the baseline on line 0E, between 2+00S - 3+50S on lines 2E and 3E, between 3+00S - 10+50S on lines 2E to 6E, between 1+50S - 4+00S on lines 6E to 8E and between 0+50N - 8+00N on lines 9E to 11E form prominent topographical features having local reliefs of 10 - 20 meters.

These areas of higher relief are often bounded by steep sided, north-south trending, scarps that may be fault zones.

Those areas overlying and surrounding the outcrop areas are covered by spruce, pine and poplar forest cover. Intervening, low lying, regions are covered by a combination of muskeg, alder, cedar, spruce and balsam.



PHYSIOGRAPHY AND VEGETATION (continued)

Water is available from a north-east flowing creek that intersects the grid's baseline at 2+50E and from an east-south-east trending creek on the south of the grid.

PROPERTY DESCRIPTION

The property is situated in Fallon township, Porcupine Mining Division, District of Timiskaming, Ontario. All claims covered in this report are unpatented claims owned by Mr. David J. Meunier. Claims on which basal till sampling was undertaken include: P 661936, P 654193, P 663467 - P 663470, and P 741732. The claims on which assessment work is being applied for are listed below:

<u>CLAIM NUMBER</u>	<u>NUMBER OF CLAIMS</u>
P 783572 - P 783574	3
P 792435 - P 792436	2
P 792531 - P 792539	<u>9</u>
	TOTAL 14

SURVEY PROCEDURE

Basal till sampling was conducted between June 12 - July 25, 1985, by a two man crew utilizing a pionjar drill. The pionjar drill is a portable percussion drill that obtains a single overburden sample from each hole, over a 20 centimeter long interval, immediately above the bedrock-overburden interface. Between six and nine holes were drilled at 25 meter intervals, along 025° trending metric grid lines, across the conductors. Four lines of holes were drilled across five separate conductors. In total, 55 holes having an aggregate length of 561.3 meters were completed. Weights of recovered samples ranged from 105.1 to 254.2 grams, having an average of 190.21 grams.

### SURVEY PROCEDURE (continued)

Drill logs, summarizing the types of overburden encountered, were completed simultaneously with the drilling by the drill crew personnel. Sample preparation was done by R. Cormier and Associates Ltd. Initially the samples were screened into +5, -5, to +250 and -250 mesh size fractions. The -5 to +250 mesh fraction was then subjected to heavy liquid separations using tetrabromofom (2.96 gm/cm<sup>3</sup>) and methylene iodide (3.2 gm/cm<sup>3</sup>). Grains having specific gravities of between 2.96 to 3.2 gm/cm<sup>3</sup> and greater than 3.2 gm/cm<sup>3</sup> were then subjected to magnetic separations. Microscopic examination of the magnetic and non-magnetic portions of the -5 to +250 mesh size fraction, with a specific gravity of greater than 3.2 gm/cm<sup>3</sup>, was completed by C. F. Gleeson and Associates Limited. The +5 mesh size fraction underwent binocular microscopic examination by the author of this report.

### PROPERTY GEOLOGY

The following description of the property's geology is based upon the results of a geological mapping survey completed in the summer of 1985, and in which the author of this report participated. Ten percent outcrop is exposed on the grid.

### LITHOLOGY

All rocks, with the exception of a thick east-northeast trending Proterozoic diabase dike on the far west of the grid, are Archean in age. Proterozoic, Huronian, Cobalt Group sediments occur as a large outlier immediately west of the grid. Metavolcanic intermediate pyroclastics intercalated with lesser amounts of mafic flows underlie the majority of the region. Felsic tuffs occur as a 25 meter thick unit north of the baseline on

LITHOLOGY (continued)

line 0E. Examination of the basal till suggests that a thin Archean aged siliceous siltstone/tuffite unit is intercalated with intermediate tuffs immediately south of the baseline on lines 4E to 6E. This sedimentary unit was not observed during bedrock mapping.

Intruding the metavolcanics along south-east to north-east trends are a number of monzonite dikes, plugs and small stocks. Thin mafic dikes and Archean diabase dikes have intruded the metavolcanic and monzonite units along north-south trends.

Intermediate pyroclastic varieties include tuffs, lapilli tuffs, and agglomerates. These units are commonly interbedded on a scale of meters. Tuffs are fine to medium grained, grey to green, finely banded units that host trace amounts of pyrite. Lapilli tuffs contain up to 30% subangular felsic fragments in a fine grained, grey to green matrix. The agglomerates host up to 40% feldspar prophyry, massive intermediate flow and felsic clasts in a fine to medium grained grey to green matrix.

Mafic flows occur mainly as dark green to black, non-magnetic, massive, fine grained or porphyritic units. Rarely they occur as pillow and amygdaloidal flows. The flow sequences attain thicknesses of up to 250 meters.

Both the intermediate pyroclastic and mafic flow units have been subjected to widespread epidote, silica, chlorite ± carbonate alteration. This alteration assemblage is concentrated in bands, pods and stringers that are subparallel to the affected rock's schistosity. The intensity of alteration intensifies adjacent to the monzonite dikes and stocks.

### LITHOLOGY (continued)

The felsic tuff unit is grey to grey-green, extremely hard, finely bedded and very fine grained.

Monzonites are typically prophyritic units that host up to 40%, 3-10 mm diameter feldspar phenocrysts in a fine to medium grained matrix that hosts 10-20% hornblende ± biotite. Varieties of the monzonite that host between 5 and 20 percent quartz are generally finer grained, grey in colour and contain a smaller percentage of feldspar phenocrysts. Monzonite dikes vary from one to ten meters in width, while stocks attain diameters in excess of 600 meters.

Mafic dikes are fine grained, chloritically altered units that rarely exceed two meters in width. The diabases are dark green, medium grained units having thicknesses between 5 and 10 meters.

### QUATERNARY GEOLOGY

Nintey-five percent of the grid area is overlain by unconsolidated Quaternary deposits. Glaciolacustrine clay and silt are the dominant deposit type, covering approximately 70% of the area (Lee 1979). Subordinate peat and organic terrain overlies the glaciolacustrine sediments. Outcrop areas on the southwest grid region are covered by C horizon soil or a thin veneer of till. Basal till and/or gravel was found to have a thickness of 0.2 - 4.4 meters. Overburden in the sampled holes had an average depth of 10.2 meters. Glacial material is believed to have been transported from north to south (Pyke, 1970).

### STRUCTURAL GEOLOGY

The bedding, flow and schistosity strike directions of the metavolcanics varies from  $0^{\circ}$  -  $150^{\circ}$ , with steep north and south dips. A top direction to the north was found for pillowed flows at line 9E - 16+00N.

Metavolcanic units have been variably subjected to east-south-east shearing which is developed subparallel to their bedding and flow directions. It is suspected that the shearing was influenced by a period of isoclinal folding along east-south-east trending axes. The chlorite-epidote-silica  $\pm$  carbonate alteration assemblage which is developed in the metavolcanics is probably related to this period of deformation. A later period of deformation involves faulting along north-south trends in a dominantly left lateral sense. Drag folding associated with the north-south faulting has aligned previous foliations parallel to the faulting. The north-south trending faults were once extensional features that have been infilled by the mafic dikes.

A late set of fractures, containing hematite and/or milky white quartz veins, post dates all the other structural features. These fractures trend at  $040^{\circ}$  -  $110^{\circ}$  with subvertical dips.

### ECONOMIC GEOLOGY

No instances of economic mineralization are known to occur in bedrock on the grid. The east-south-east shear related chlorite-epidote-silica  $\pm$  carbonate alteration zones host up to several percent pyrite, but are not associated with economic mineralization.

### RESULTS OF TILL IDENTIFICATION

Drill logs, detailing the types of overburden encountered, were completed by drill contractor personnel while drilling was underway. These logs are presented in Appendix I at the back of this report.

### RESULTS OF +5 MESH CLAST IDENTIFICATION

Clast lithology identifications failed to explain the causes of the conductors, but did aid in confirming and supplementing previous bedrock mapping. Map 1, at the back of this report, summarizes the sample depth, sample type, number of clasts and the major and minor lithology types encountered at each sample location. Major lithologies identified included: intermediate pyroclastics, mafic flows, monzonites, Archean sediments, intermediate flows and vein quartz-carbonate. No attempt was made to distinguish between different varieties of the intermediate pyroclastics, due to the small sample size. The pyroclastics are all termed as intermediate tuffs. Lithologies only occurring in minor amounts included: Huronian sediments, felsic flows, felsic tuffs, diabase and ultramafic flows. Metavolcanic intermediate pyroclastics and mafic flows have been variably affected by chlorite-silica-epidote ± carbonate alteration. Tuff clasts hosted trace to several percent pyrite.

Samples 5000 - 5085, taken on line 4E between 11+50S - 12+25S, are primarily composed of mafic to intermediate flows with minor tuffs and monzonite.

Samples 5086 - 5124 were taken on lines 4E and 6E over three conductors. Samples on line 4E extend from 1+25N to 3+75S and on line 6E from 0+00 to 2+00S. Intermediate pyroclastics constitute the dominant primary lithology for the two lines. Mafic to intermediate flows, Archean sediments and vein quartz-carbonate also occur as major

RESULTS OF +5 MESH CLAST IDENTIFICATION (continued)

lithology types. The sediment is a pink to grey siltstone that has been fractured and silicified. Apparently having a width of less than 25 meters, the sedimentary unit was observed in samples from both lines. Minor lithology types include vein quartz, monzonite, diabase, Huronian sediments and felsic tuffs. Alteration and deformation of the pyroclastics and flows is weak to moderate. The pyrite content of the tuffs varies from trace to several percent. Vein quartz and vein quartz-carbonate are particularly abundant in samples 5094, 5100, and 5117. Vein quartz-carbonate clasts in samples 5100 and 5101 contain a grey metallic mineral which is believed to be galena.

Samples 5125 - 5134 are located between 5+50S and 7+00S on line 8E. These samples appear to be underlain by intercalated mafic flows and intermediate pyroclastics which are intruded by monzonite dikes. Vein quartz, Archean sediments, and diabase occurs as minor lithologies. In sample 5130, one clast is composed of vein quartz, monzonite and intermediate pyroclastic.

HEAVY MINERAL (+3.2 gm/cm<sup>3</sup>), -5 to +250 MESH, IDENTIFICATION

Results of the heavy mineral identifications are presented in Appendix II. No causes for the conductors were observed. Minerals consistently occurring in amounts equal to or exceeding 5%, and listed in order of abundance are: pyroxene, garnet, magnetite, epidote, amphibole and ilmenite. Minor amounts of apatite, chlorite, hematite, pyrite, zircon, sphene, kyanite, leucoxene, pyrrhotite, galena, barite and goethite were also noted. The relative abundance of the major mineral types is a function of their distance and abundance up-ice from the sample location

HEAVY MINERAL (+3.2 gm/cm<sup>3</sup>), -5 to +250 MESH, IDENTIFICATION (continued)

and their chemical and physical stability in the secondary environment.

The abundances of the minerals in the samples could not be reliably related to the underlying or up-ice lithologies. Higher epidote levels can be weakly correlated with increased alteration levels.

Much of the magnetite in the samples is described as dull and platey, possibly indicating the rocks, from which it is derived, have been subjected to shearing. Sample 5100 was observed to host 25% galena and sample 5091 hosted 25% pyrite.



BIBLIOGRAPHY

Bowen, R. P., A Geological Survey for Assessment Work Credit on the Meunier Claims; Fallon Township, Ontario, Porcupine Mining District; Assessment Report, 1984.

Ontario Department of Mines, Map 2205 Timmins-Kirkland Lake, Geological Compilation Series, 1:253,440.

Lee, H. A., Northern Ontario Engineering Geology Terrain Study, Data Base Map, Kirkland Lake, Ontario Geological Survey, Map 5030, Scale 1:100,000.

Pyke, D. R., Geology of Fallon and Fasken Townships, District of Timiskaming, Ontario Division of Mines Geology Report 104, 1973, page 32.

Pyke, D. R., Geology of Timmins Area, District of Cochrane, Ontario Geological Survey Report 219, 1982, page 141.

CERTIFICATION

I, Paul D. Miller, certify:

1. That I reside at 448 Eglinton Avenue West,  
Toronto, Ontario.
2. That I graduated from the University of  
Toronto in 1980 with a Bachelor of Applied  
Science in Geological Engineering.
3. That I have been continuously employed as an  
exploration geologist since 1980.

Paul D. Miller

Paul D. Miller  
Geologist

APRIL 30/86

APPENDIX I

Overburden Drill Logs

**rca**R. Cormier & Associés  
Associates Ltd.2050, Thibault,  
Bécancour, Qué.  
Canada, G0X 1B0  
Tél. - (819) 294-9939**OVERBURDEN DRILLING LOG  
JOURNAL DE FORAGE MORT TERRAIN**

SAMPLE No./No D'ÉCHANTILLON: <b>LÉ5080</b>	DRILL No./No DU TROU: <b>80</b>	DATE: <b>12/16/85</b>
SAMPLE DEPTH:/ PROF. D'ÉCHANT: <b>13'8</b>	SAMPLERS:/ SONDEURS: <b>RL-FL</b>	CONTRACT:/ CONTRAT: <b>LAC MINÉRAL</b>
LINE:/ LIGNE: <b>4-E</b>	STATION: <b>11750-S</b>	LOCATION:/LOCALITÉ: <b>F-S</b>

**DRILLING TIME - FEUILLE DE TEMPS**POINT STARTED:  
DÉBUT DE POINTE:SAMPLER STARTED:  
DÉBUT D'ÉCHANTILLON:POINT STOPPED:  
ARRÊT DE POINTE:SAMPLER STOPPED:  
ARRÊT D'ÉCHANTILLON:POINT EXTRACTED:  
EXTRACTION DE POINTE:SAMPLE EXTRACTED:  
EXTRACTION D'ÉCHANTILLON:

FOOTAGE PROFONDEUR		OVERBURDEN DESCRIPTION DESCRIPTION DU MORT TERRAIN	SAMPLE DESCRIPTION ÉCHANTILLON
FROM DE	TO À		
0	0.1	ORGANIC	ORGANIC ORGANIQUE %
0.1	6	CLAY	CLAY ARGILE %
6	10	FINE SAND	SILT SILTE %
10	13.7	COURSE SAND	FINE SAND SABLE FIN %
13.7	13.8	BASAL TILL	MEDIUM SAND SABLE MED. %
	13.8	BED ROCK	COARSE SAND SABLE GROS %
			GRAVEL GRAVIER %
			PEBBLES CAILLOUX %

REMARKS:  
REMARQUES:





R. Cormier & Associés Ltée  
Associates Ltd.

2050, Thibault,  
Bécancour, Qué.  
Canada, G0X 1B0  
Tél. - (819) 294-9939

OVERBURDEN DRILLING LOG  
JOURNAL DE FORAGE MORT TERRAIN

SAMPLE No./No D'ÉCHANTILLON: LE50 83	DRILL No./No DU TROU: 83	DATE: 13-6-85
SAMPLE DEPTH./ PROF. D'ÉCHANT: 17 M	SAMPLERS./ SONDEURS: RL-FL	CONTRACT./ CONTRAT: LAC MINERAL
LINE./ LIGNE: 4 E	STATION: 11787-5-S	LOCATION./ LOCALITÉ: F-S

DRILLING TIME - FEUILLE DE TEMPS

POINT STARTED: DÉBUT DE POINTE:      SAMPLER STARTED: DÉBUT D'ÉCHANTILLON:  
POINT STOPPED: ARRÊT DE POINTE:      SAMPLER STOPPED: ARRÊT D'ÉCHANTILLON:  
POINT EXTRACTED: EXTRACTION DE POINTE:      SAMPLE EXTRACTED: EXTRACTION D'ÉCHANTILLON:

FOOTAGE PROFONDEUR		OVERBURDEN DESCRIPTION DESCRIPTION DU MORT TERRAIN	SAMPLE DESCRIPTION ÉCHANTILLON
FROM DE	TO A		
0	0.2	ORGANIC	ORGANIC ORGANIQUE %
0.2	1.2	CLAY	CLAY ARGILE %
1.2	1.5	FINE SAND	SILT SILTE %
1.5	16.7	COURSE SAND	FINE SAND SABLE FIN %
16.7	17 M	BASAL TILL	MEDIUM SAND SABLE MED. %
	17 M	BED ROCK	COARSE SAND SABLE GROS %
			GRAVEL GRAVIER %
			PEBBLES CAILLOUX %
		2 T-R	

REMARKS:  
REMARQUES:



R. Cormier & Associés Ltée  
Associates Ltd.

2050 Thibault,  
Bécancour, Qué.  
Canada, G0X 1B0  
Tél. - (819) 294-9939

OVERBURDEN DRILLING LOG  
JOURNAL DE FORAGE MORT TERRAIN

SAMPLE No./No D'ÉCHANTILLON: LE50 84	DRILL No./No DU TROU: 84	DATE: 13-6-85
SAMPLE DEPTH./ PROF. D'ÉCHANT: 14.5	SAMPLERS./ SONDEURS: RL-FL	CONTRACT./ CONTRAT: LAC MINERAL
LINE./ LIGNE: 4 E	STATION: 12700-0-S	LOCATION./ LOCALITÉ: F-S

DRILLING TIME - FEUILLE DE TEMPS

POINT STARTED: DÉBUT DE POINTE:      SAMPLER STARTED: DÉBUT D'ÉCHANTILLON:  
POINT STOPPED: ARRÊT DE POINTE:      SAMPLER STOPPED: ARRÊT D'ÉCHANTILLON:  
POINT EXTRACTED: EXTRACTION DE POINTE:      SAMPLE EXTRACTED: EXTRACTION D'ÉCHANTILLON:

FOOTAGE PROFONDEUR		OVERBURDEN DESCRIPTION DESCRIPTION DU MORT TERRAIN	SAMPLE DESCRIPTION ÉCHANTILLON
FROM DE	TO A		
0	0.2	ORGANIC	ORGANIC ORGANIQUE %
0.2	9	CLAY	CLAY ARGILE %
9	12	FINE SAND	SILT SILTE %
12	14.2	COURSE SAND	FINE SAND SABLE FIN %
14.2	14.5	BASAL TILL	MEDIUM SAND SABLE MED. %
	14.5	BED ROCK	COARSE SAND SABLE GROS %
			GRAVEL GRAVIER %
			PEBBLES CAILLOUX %

REMARKS:  
REMARQUES:



R. Cormier & Associés Ltée  
Associates Ltd.

2050, Thibault,  
Bécancour, Qué.  
Canada, G0X 1B0  
Tél. - (819) 294-9939

OVERBURDEN DRILLING LOG  
JOURNAL DE FORAGE MORT TERRAIN

SAMPLE No./No D'ÉCHANTILLON: <b>LE5085</b>	DRILL No./No DU TROU: <b>85</b>	DATE: <b>13-6-85</b>
SAMPLE DEPTH:/ PROF.D'ÉCHANT: <b>14.5 M</b>	SAMPLERS:/ SONDEURS: <b>RL FL</b>	CONTRACT:/ CONTRAT: <b>LAC MINERAL</b>
LINE:/ LIGNE: <b>4-E</b>	STATION: <b>12725 S</b>	LOCATION:/LOCALITÉ: <b>F-S</b>

DRILLING TIME - FEUILLE DE TEMPS

POINT STARTED:  
DÉBUT DE POINTE:

SAMPLER STARTED:  
DÉBUT D'ÉCHANTILLON:

POINT STOPPED:  
ARRÊT DE POINTE:

SAMPLER STOPPED:  
ARRÊT D'ÉCHANTILLON:

POINT EXTRACTED:  
EXTRACTION DE POINTE:

SAMPLE EXTRACTED:  
EXTRACTION D'ÉCHANTILLON:

FOOTAGE PROFONDEUR		OVERBURDEN DESCRIPTION DESCRIPTION DU MORT TERRAIN	SAMPLE DESCRIPTION ÉCHANTILLON
FROM DE	TO A		
0	2	ORGANIC	ORGANIC ORGANIQUE %
2	10	CLAY	CLAY ARGILE %
10	14.2	COARSE SAND	SILT SILTE %
	14.2	RED ROCK	FINE SAND SABLE FIN %
			MEDIUM SAND SABLE MED. %
			COARSE SAND SABLE GROS %
			GRAVEL GRAVIER %
			PEBBLES CAILLOUX %

REMARKS:  
REMARQUES:



R. Cormier & Associés Ltée  
Associates Ltd.

2050 Thibault,  
Bécancour, Qué.  
Canada, G0X 1B0  
Tél. - (819) 294-9939

OVERBURDEN DRILLING LOG  
JOURNAL DE FORAGE MORT TERRAIN

SAMPLE No./No D'ÉCHANTILLON: <b>LE5086</b>	DRILL No./No DU TROU: <b>86</b>	DATE: <b>14-6-85</b>
SAMPLE DEPTH:/ PROF.D'ÉCHANT: <b>OUT CROC</b>	SAMPLERS:/ SONDEURS: <b>RL-FL</b>	CONTRACT:/ CONTRAT: <b>LAC MINERAL</b>
LINE:/ LIGNE: <b>4E</b>	STATION: <b>3775 S</b>	LOCATION:/LOCALITÉ: <b>F-S</b>

DRILLING TIME - FEUILLE DE TEMPS

POINT STARTED:  
DÉBUT DE POINTE:

SAMPLER STARTED:  
DÉBUT D'ÉCHANTILLON:

POINT STOPPED:  
ARRÊT DE POINTE:

SAMPLER STOPPED:  
ARRÊT D'ÉCHANTILLON:

POINT EXTRACTED:  
EXTRACTION DE POINTE:

SAMPLE EXTRACTED:  
EXTRACTION D'ÉCHANTILLON:

FOOTAGE PROFONDEUR		OVERBURDEN DESCRIPTION DESCRIPTION DU MORT TERRAIN	SAMPLE DESCRIPTION ÉCHANTILLON
FROM DE	TO A		
	0	OUT CROC	ORGANIC ORGANIQUE %
			CLAY ARGILE %
			SILT SILTE %
			FINE SAND SABLE FIN %
			MEDIUM SAND SABLE MED. %
			COARSE SAND SABLE GROS %
			GRAVEL GRAVIER %
			PEBBLES CAILLOUX %

REMARKS:  
REMARQUES:



R. Cormier & Associés Ltée  
Associates Ltd.

2050, Thibault,  
Bécancour, Qué.  
Canada, G0X 1B0  
Tél. - (819) 294-9939

OVERBURDEN DRILLING LOG  
JOURNAL DE FORAGE MORT TERRAIN

SAMPLE No./No D'ÉCHANTILLON: <b>LE5087</b>	DRILL No./No DU TROU: <b>87</b>	DATE: <b>14-6-85</b>
SAMPLE DEPTH:/ PROF. D'ÉCHANT: <b>1M</b>	SAMPLERS:/ SONDEURS: <b>RL-FL</b>	CONTRACT:/ CONTRAT: <b>LAC MINERAL</b>
LINE:/ LIGNE: <b>4E</b>	STATION: <b>3750 S</b>	LOCATION:/ LOCALITÉ: <b>F-S</b>

DRILLING TIME - FEUILLE DE TEMPS

POINT STARTED:  
DÉBUT DE POINTE:

SAMPLER STARTED:  
DÉBUT D'ÉCHANTILLON:

POINT STOPPED:  
ARRÊT DE POINTE:

SAMPLER STOPPED:  
ARRÊT D'ÉCHANTILLON:

POINT EXTRACTED:  
EXTRACTION DE POINTE:

SAMPLE EXTRACTED:  
EXTRACTION D'ÉCHANTILLON:

FOOTAGE PROFONDEUR		OVERBURDEN DESCRIPTION DESCRIPTION DU MORT TERRAIN	SAMPLER DESCRIPTION ÉCHANTILLON
FROM DE	TO À		
0	2	ORGANIC	ORGANIC ORGANIQUE %
2	8	GRAVEL	CLAY ARGILE %
8	1M	BASAL TILL	SILT SILTE %
	1M	BED ROCK	FINE SAND SABLE FIN %
			MEDIUM SAND SABLE MED. %
			COARSE SAND SABLE GROS %
			GRAVEL GRAVIER %
			PEBBLES CAILLOUX %

REMARKS:  
REMARQUES:



R. Cormier & Associés Ltée  
Associates Ltd.

2050 Thibault,  
Bécancour, Qué.  
Canada, G0X 1B0  
Tél. - (819) 294-9939

OVERBURDEN DRILLING LOG  
JOURNAL DE FORAGE MORT TERRAIN

SAMPLE No./No D'ÉCHANTILLON: <b>LE5088</b>	DRILL No./No DU TROU: <b>88</b>	DATE: <b>14-6-85</b>
SAMPLE DEPTH:/ PROF. D'ÉCHANT: <b>OUT CROC</b>	SAMPLERS:/ SONDEURS: <b>RL-FL</b>	CONTRACT:/ CONTRAT: <b>LAC MINERAL</b>
LINE:/ LIGNE: <b>4E</b>	STATION: <b>3737.5-S</b>	LOCATION:/ LOCALITÉ: <b>F-S</b>

DRILLING TIME - FEUILLE DE TEMPS

POINT STARTED:  
DÉBUT DE POINTE:

SAMPLER STARTED:  
DÉBUT D'ÉCHANTILLON:

POINT STOPPED:  
ARRÊT DE POINTE:

SAMPLER STOPPED:  
ARRÊT D'ÉCHANTILLON:

POINT EXTRACTED:  
EXTRACTION DE POINTE:

SAMPLE EXTRACTED:  
EXTRACTION D'ÉCHANTILLON:

FOOTAGE PROFONDEUR		OVERBURDEN DESCRIPTION DESCRIPTION DU MORT TERRAIN	SAMPLER DESCRIPTION ÉCHANTILLON
FROM DE	TO À		
	0	OUT CROC	ORGANIC ORGANIQUE %
			CLAY ARGILE %
			SILT SILTE %
			FINE SAND SABLE FIN %
			MEDIUM SAND SABLE MED. %
			COARSE SAND SABLE GROS %
			GRAVEL GRAVIER %
			PEBBLES CAILLOUX %

REMARKS:  
REMARQUES:





R. Cormier & Associés Ltée  
Associates Ltd.

2050, Thibault,  
Bécancour, Qué.  
Canada, G0X 1B0  
Tél. - (819) 294-9939

OVERBURDEN DRILLING LOG  
JOURNAL DE FORAGE MORT TERRAIN

SAMPLE No./No D'ÉCHANTILLON: LE5089	DRILL No./No DU TROU: 89	DATE: 14-6-85
SAMPLE DEPTH./PROF.D'ÉCHANT: 02	SAMPLERS./SONDEURS: RL-FL	CONTRACT./CONTRAT: LAC MINERAL
LINE./LIGNE: 4E	STATION: 3725-S	LOCATION./LOCALITÉ: F-S

DRILLING-TIME - FEUILLE DE TEMPS

POINT STARTED:  
DÉBUT DE POINTE:

SAMPLER STARTED:  
DÉBUT D'ÉCHANTILLON:

POINT STOPPED:  
ARRÊT DE POINTE:

SAMPLER STOPPED:  
ARRÊT D'ÉCHANTILLON:

POINT EXTRACTED:  
EXTRACTION DE POINTE:

SAMPLE EXTRACTED:  
EXTRACTION D'ÉCHANTILLON:

FOOTAGE PROFONDEUR		OVERBURDEN DESCRIPTION DESCRIPTION DU MORT TERRAIN	SAMPLER DESCRIPTION ÉCHANTILLON
FROM DE	TO A		
0	12	ORGANIC	ORGANIC ORGANIQUE %
	12	BED ROCK	CLAY ARGILE %
			SILT SILTE %
			FINE SAND SABLE FIN %
			MEDIUM SAND SABLE MED. %
			COARSE SAND SABLE GROS %
			GRAVEL GRAVIER %
			PEBBLES CAILLOUX %

REMARKS:  
REMARQUES:



R. Cormier & Associés Ltée  
Associates Ltd.

2050 Thibault,  
Bécancour, Qué.  
Canada, G0X 1B0  
Tél. - (819) 294-9939

OVERBURDEN DRILLING LOG  
JOURNAL DE FORAGE MORT TERRAIN

SAMPLE No./No D'ÉCHANTILLON: LE5090	DRILL No./No DU TROU: 90	DATE: 14-6-85
SAMPLE DEPTH./PROF.D'ÉCHANT: 02	SAMPLERS./SONDEURS: RL-FL	CONTRACT./CONTRAT: LAC MINERAL
LINE./LIGNE: 4E	STATION: 3700-S	LOCATION./LOCALITÉ: F-S

DRILLING-TIME - FEUILLE DE TEMPS

POINT STARTED:  
DÉBUT DE POINTE:

SAMPLER STARTED:  
DÉBUT D'ÉCHANTILLON:

POINT STOPPED:  
ARRÊT DE POINTE:

SAMPLER STOPPED:  
ARRÊT D'ÉCHANTILLON:

POINT EXTRACTED:  
EXTRACTION DE POINTE:

SAMPLE EXTRACTED:  
EXTRACTION D'ÉCHANTILLON:

FOOTAGE PROFONDEUR		OVERBURDEN DESCRIPTION DESCRIPTION DU MORT TERRAIN	SAMPLER DESCRIPTION ÉCHANTILLON
FROM DE	TO A		
0	12	ORGANIC	ORGANIC ORGANIQUE %
	12	BED ROCK	CLAY ARGILE %
			SILT SILTE %
			FINE SAND SABLE FIN %
			MEDIUM SAND SABLE MED. %
			COARSE SAND SABLE GROS %
			GRAVEL GRAVIER %
			PEBBLES CAILLOUX %

REMARKS:  
REMARQUES:



R. Cormier & Associés Ltée  
Associates Ltd.

2050, Thibault,  
Bécancour, Qué.  
Canada, G0X 1B0  
Tél. - (819) 294-9939

OVERBURDEN DRILLING LOG  
JOURNAL DE FORAGE MORT TERRAIN

SAMPLE No./No D'ÉCHANTILLON: LE5091	DRILL No./No DU TROU: 91	DATE: 14-6-85
SAMPLE DEPTH./PROF.D'ÉCHANT: 3M	SAMPLERS./SONDEURS: RLFL	CONTRACT./CONTRAT: LAC MINERAL
LINE./LIGNE: 4E	STATION: 2775-S	LOCATION./LOCALITÉ: F-S

DRILLING TIME - FEUILLE DE TEMPS

POINT STARTED:  
DÉBUT DE POINTE:

SAMPLER STARTED:  
DÉBUT D'ÉCHANTILLON:

POINT STOPPED:  
ARRÊT DE POINTE:

SAMPLER STOPPED:  
ARRÊT D'ÉCHANTILLON:

POINT EXTRACTED:  
EXTRACTION DE POINTE:

SAMPLE EXTRACTED:  
EXTRACTION D'ÉCHANTILLON:

FOOTAGE PROFONDEUR		OVERBURDEN DESCRIPTION DESCRIPTION DU MORT TERRAIN	SAMPLE DESCRIPTION ÉCHANTILLON
FROM DE	TO À		
0	12	ORGANIC	ORGANIC ORGANIQUE %
12	18	GRAVEL	CLAY ARGILE %
18	1	BASAL TILL	SILT SILTE %
	1	BED ROCK	FINE SAND SABLE FIN %
			MEDIUM SAND SABLE MED. %
			COARSE SAND SABLE GROS %
			GRAVEL GRAVIER %
			PEBBLES CAILLOUX %

REMARKS:  
REMARQUES:



R. Cormier & Associés Ltée  
Associates Ltd.

2050 Thibault,  
Bécancour, Qué.  
Canada, G0X 1B0  
Tél. - (819) 294-9939

OVERBURDEN DRILLING LOG  
JOURNAL DE FORAGE MORT TERRAIN

SAMPLE No./No D'ÉCHANTILLON: LE5092	DRILL No./No DU TROU: 92	DATE: 15-6-85
SAMPLE DEPTH./PROF.D'ÉCHANT: 7M	SAMPLERS./SONDEURS: RLFL	CONTRACT./CONTRAT: LAC MINERAL
LINE./LIGNE: 4E	STATION: 27625 S	LOCATION./LOCALITÉ: F-S

DRILLING TIME - FEUILLE DE TEMPS

POINT STARTED:  
DÉBUT DE POINTE:

SAMPLER STARTED:  
DÉBUT D'ÉCHANTILLON:

POINT STOPPED:  
ARRÊT DE POINTE:

SAMPLER STOPPED:  
ARRÊT D'ÉCHANTILLON:

POINT EXTRACTED:  
EXTRACTION DE POINTE:

SAMPLE EXTRACTED:  
EXTRACTION D'ÉCHANTILLON:

FOOTAGE PROFONDEUR		OVERBURDEN DESCRIPTION DESCRIPTION DU MORT TERRAIN	SAMPLE DESCRIPTION ÉCHANTILLON
FROM DE	TO À		
0	12	ORGANIC	ORGANIC ORGANIQUE %
12	4	ROCK DEUR	CLAY ARGILE %
4	6'7	CORSE SAND	SILT SILTE %
6'7	7M	BASAL TILL	FINE SAND SABLE FIN %
	7M	BED ROCK	MEDIUM SAND SABLE MED. %
			COARSE SAND SABLE GROS %
			GRAVEL GRAVIER %
			PEBBLES CAILLOUX %

REMARKS:  
REMARQUES:



R. Cormier & Associés Ltée  
Associates Ltd.

2050, Thibault,  
Bécancour, Qué.  
Canada, G0X 1B0  
Tél. - (819) 294-9939

OVERBURDEN DRILLING LOG  
JOURNAL DE FORAGE MORT TERRAIN

SAMPLE No./No D'ÉCHANTILLON: <b>LE5093</b>	DRILL No./No DU TROU: <b>93</b>	DATE: <b>15-6-85</b>
SAMPLE DEPTH./PROF.D'ÉCHANT: <b>10.4</b>	SAMPLERS./SONDEURS: <b>RL-FL</b>	CONTRACT./CONTRAT: <b>LAC MINÉRAL</b>
LINE./LIGNE: <b>4 E</b>	STATION: <b>2750 S</b>	LOCATION./LOCALITÉ: <b>F-S</b>

DRILLING TIME - FEUILLE DE TEMPS

POINT STARTED:  
DÉBUT DE POINTE:  
  
POINT STOPPED:  
ARRÊT DE POINTE:  
  
POINT EXTRACTED:  
EXTRACTION DE POINTE:

SAMPLER STARTED:  
DÉBUT D'ÉCHANTILLON:  
  
SAMPLER STOPPED:  
ARRÊT D'ÉCHANTILLON:  
  
SAMPLE EXTRACTED:  
EXTRACTION D'ÉCHANTILLON:

FOOTAGE PROFONDEUR		OVERBURDEN DESCRIPTION DESCRIPTION DU MORT TERRAIN	SAMPLE DESCRIPTION ÉCHANTILLON
FROM DE	TO À		
0	2	ORGANIC	ORGANIC ORGANIQUE %
2	7	KINE SAND	CLAY ARGILE %
7	10	RED CLAY	SILT SILTE %
10	10.4	BASAL TILL	FINE SAND SABLE FIN %
	10.4	RED ROCK	MEDIUM SAND SABLE MED. %
			COARSE SAND SABLE GROS %
			GRAVEL GRAVIER %
			PEBBLES CAILLOUX %

REMARKS:  
REMARQUES:



R. Cormier & Associés Ltée  
Associates Ltd.

2050, Thibault,  
Bécancour, Qué.  
Canada, G0X 1B0  
Tél. - (819) 294-9939

OVERBURDEN DRILLING LOG  
JOURNAL DE FORAGE MORT TERRAIN

SAMPLE No./No D'ÉCHANTILLON: <b>LE5094</b>	DRILL No./No DU TROU: <b>94</b>	DATE: <b>15-6-85</b>
SAMPLE DEPTH./PROF.D'ÉCHANT: <b>11.4</b>	SAMPLERS./SONDEURS: <b>RL-FL</b>	CONTRACT./CONTRAT: <b>LAC MINÉRAL</b>
LINE./LIGNE: <b>4 E</b>	STATION: <b>2737.5-S</b>	LOCATION./LOCALITÉ: <b>F-S</b>

DRILLING TIME - FEUILLE DE TEMPS

POINT STARTED:  
DÉBUT DE POINTE:  
  
POINT STOPPED:  
ARRÊT DE POINTE:  
  
POINT EXTRACTED:  
EXTRACTION DE POINTE:

SAMPLER STARTED:  
DÉBUT D'ÉCHANTILLON:  
  
SAMPLER STOPPED:  
ARRÊT D'ÉCHANTILLON:  
  
SAMPLE EXTRACTED:  
EXTRACTION D'ÉCHANTILLON:

FOOTAGE PROFONDEUR		OVERBURDEN DESCRIPTION DESCRIPTION DU MORT TERRAIN	SAMPLE DESCRIPTION ÉCHANTILLON
FROM DE	TO À		
0	2	ORGANIC	ORGANIC ORGANIQUE %
2	5	FINE SAND	CLAY ARGILE %
5	7	GRAVEL	SILT SILTE %
7	10.8	BASAL TILL	FINE SAND SABLE FIN %
	10.8	RED ROCK	MEDIUM SAND SABLE MED. %
			COARSE SAND SABLE GROS %
			GRAVEL GRAVIER %
			PEBBLES CAILLOUX %

REMARKS:  
REMARQUES:



R. Cormier & Associés Ltée  
Associates Ltd.

2050, Thibault,  
Bécancour, Qué.  
Canada, G0X 1B0  
Tél. - (819) 294-9939

OVERBURDEN DRILLING LOG  
JOURNAL DE FORAGE MORT TERRAIN

SAMPLE No./No D'ÉCHANTILLON: LE 5095	DRILL No./No DU TROU: 95	DATE: 16-6-85
SAMPLE DEPTH./PROF.D'ÉCHANT: 11.2	SAMPLERS./SONDEURS: RL-FL	CONTRACT./CONTRAT: LAC MINÉRAL
LINE./LIGNE: 4E	STATION: 2725-S	LOCATION./LOCALITÉ: E-S

DRILLING TIME - FEUILLE DE TEMPS

POINT STARTED:  
DÉBUT DE POINTE:

SAMPLER STARTED:  
DÉBUT D'ÉCHANTILLON:

POINT STOPPED:  
ARRÊT DE POINTE:

SAMPLER STOPPED:  
ARRÊT D'ÉCHANTILLON:

POINT EXTRACTED:  
EXTRACTION DE POINTE:

SAMPLE EXTRACTED:  
EXTRACTION D'ÉCHANTILLON:

FOOTAGE PROFONDEUR		OVERBURDEN DESCRIPTION DESCRIPTION DU MORT TERRAIN	SAMPLE DESCRIPTION ÉCHANTILLON
FROM DE	TO À		
0	1	ORGANIC	ORGANIC ORGANIQUE %
1	4	BOL DEUR	CLAY ARGILE %
4	6	CORSE SAND	SILT SILTE %
6	11	GRAVEL	FINE SAND SABLE FIN %
11	11.2	BASAL TILL	MEDIUM SAND SABLE MED. %
	11.2	BED ROCK	COARSE SAND SABLE GROS %
			GRAVEL GRAVIER %
			PEBBLES CAILLOUX %

REMARKS:  
REMARQUES:



R. Cormier & Associés Ltée  
Associates Ltd.

2050, Thibault,  
Bécancour, Qué.  
Canada, G0X 1B0  
Tél. - (819) 294-9939

OVERBURDEN DRILLING LOG  
JOURNAL DE FORAGE MORT TERRAIN

SAMPLE No./No D'ÉCHANTILLON: LE 5096	DRILL No./No DU TROU: 96	DATE: 16-06-85
SAMPLE DEPTH./PROF.D'ÉCHANT: 15 M	SAMPLERS./SONDEURS: RL-FL	CONTRACT./CONTRAT: LAC MINÉRAL
LINE./LIGNE: 4E	STATION: 2712.5-S	LOCATION./LOCALITÉ: K S

DRILLING TIME - FEUILLE DE TEMPS

POINT STARTED:  
DÉBUT DE POINTE:

SAMPLER STARTED:  
DÉBUT D'ÉCHANTILLON:

POINT STOPPED:  
ARRÊT DE POINTE:

SAMPLER STOPPED:  
ARRÊT D'ÉCHANTILLON:

POINT EXTRACTED:  
EXTRACTION DE POINTE:

SAMPLE EXTRACTED:  
EXTRACTION D'ÉCHANTILLON:

FOOTAGE PROFONDEUR		OVERBURDEN DESCRIPTION DESCRIPTION DU MORT TERRAIN	SAMPLE DESCRIPTION ÉCHANTILLON
FROM DE	TO À		
0	2	ORGANIC	ORGANIC ORGANIQUE %
2	5	GRAVEL	CLAY ARGILE %
5	8	BOL DEUR	SILT SILTE %
8	14.8	CORSE SAND	FINE SAND SABLE FIN %
14.8	15	BASAL TILL	MEDIUM SAND SABLE MED. %
	15	BED ROCK	COARSE SAND SABLE GROS %
			GRAVEL GRAVIER %
			PEBBLES CAILLOUX %

REMARKS:  
REMARQUES:



R. Cormier & Associés Ltée  
Associates Ltd.

2050, Thibault,  
Bécancour, Qué.  
Canada, G0X 1B0  
Tél. - (819) 294-9939

OVERBURDEN DRILLING LOG  
JOURNAL DE FORAGE MORT TERRAIN

SAMPLE No./No D'ÉCHANTILLON: 456097	DRILL No./No DU TROU: 97	DATE: 26/6/85
SAMPLE DEPTH./PROF.D'ÉCHANT: 14M	SAMPLERS./SONDEURS: RL-FL	CONTRACT./CONTRAT: LAC MINERAL
LINE./LIGNE: 4E	STATION: 2700-B	LOCATION./LOCALITÉ: F-S

DRILLING TIME - FEUILLE DE TEMPS

POINT STARTED: DÉBUT DE POINTE:	SAMPLER STARTED: DÉBUT D'ÉCHANTILLON:
POINT STOPPED: ARRÊT DE POINTE:	SAMPLER STOPPED: ARRÊT D'ÉCHANTILLON:
POINT EXTRACTED: EXTRACTION DE POINTE:	SAMPLE EXTRACTED: EXTRACTION D'ÉCHANTILLON:

FOOTAGE PROFONDEUR		OVERBURDEN DESCRIPTION DESCRIPTION DU MORT TERRAIN	SAMPLE DESCRIPTION ÉCHANTILLON
FROM DE	TO À		
0	2	ORGANIC	ORGANIC ORGANIQUE %
2	8	CORSE SAND	CLAY ARGILE %
8	12	BOL DEUR	SILT SILTE %
12	13.8	CORSE SAND	FINE SAND SABLE FIN %
13.8	14M	BASAL TILL	MEDIUM SAND SABLE MED. %
	14M	BED ROCK	COARSE SAND SABLE GROS %
			GRAVEL GRAVIER %
			PEBBLES CAILLOUX %

REMARKS:  
REMARQUES:



R. Cormier & Associés Ltée  
Associates Ltd.

2050, Thibault,  
Bécancour, Qué.  
Canada, G0X 1B0  
Tél. - (819) 294-9939

OVERBURDEN DRILLING LOG  
JOURNAL DE FORAGE MORT TERRAIN

SAMPLE No./No D'ÉCHANTILLON: 456098	DRILL No./No DU TROU: 98	DATE: 27-6-85
SAMPLE DEPTH./PROF.D'ÉCHANT: 11M	SAMPLERS./SONDEURS: RL-FL	CONTRACT./CONTRAT: LAC MINERAL
LINE./LIGNE: 4E	STATION: 1775 S	LOCATION./LOCALITÉ: E-S

DRILLING TIME - FEUILLE DE TEMPS

POINT STARTED: DÉBUT DE POINTE:	SAMPLER STARTED: DÉBUT D'ÉCHANTILLON:
POINT STOPPED: ARRÊT DE POINTE:	SAMPLER STOPPED: ARRÊT D'ÉCHANTILLON:
POINT EXTRACTED: EXTRACTION DE POINTE:	SAMPLE EXTRACTED: EXTRACTION D'ÉCHANTILLON:

FOOTAGE PROFONDEUR		OVERBURDEN DESCRIPTION DESCRIPTION DU MORT TERRAIN	SAMPLE DESCRIPTION ÉCHANTILLON
FROM DE	TO À		
0	2	ORGANIC	ORGANIC ORGANIQUE %
2	7	CORSE SAND	CLAY ARGILE %
7	10.8	GRAVEL	SILT SILTE %
10.8	11	BASAL TILL	FINE SAND SABLE FIN %
	11	BED ROCK	MEDIUM SAND SABLE MED. %
			COARSE SAND SABLE GROS %
			GRAVEL GRAVIER %
			PEBBLES CAILLOUX %

REMARKS:  
REMARQUES:

**rca**R. Cormier & Associés Ltée  
Associates Ltd.2050, Thibault,  
Bécancour, Qué.  
Canada, G0X 1B0  
Tél. - (819) 294-9939**OVERBURDEN DRILLING LOG**  
**JOURNAL DE FORAGE MORT TERRAIN**

SAMPLE No./No D'ÉCHANTILLON: <b>LE5099</b>	DRILL No./No DU TROU: <b>99</b>	DATE: <b>27/6/85</b>
SAMPLE DEPTH./PROF.D'ÉCHANT: <b>8.4</b>	SAMPLERS./SONDEURS: <b>RL-FL</b>	CONTRACT./CONTRAT: <b>LAC MINERU</b>
LINE./LIGNE: <b>4E</b>	STATION: <b>1750 S</b>	LOCATION./LOCALITÉ: <b>ES</b>

**DRILLING TIME - FEUILLE DE TEMPS**POINT STARTED:  
DÉBUT DE POINTE:POINT STOPPED:  
ARRÊT DE POINTE:POINT EXTRACTED:  
EXTRACTION DE POINTE:SAMPLER STARTED:  
DÉBUT D'ÉCHANTILLON:SAMPLER STOPPED:  
ARRÊT D'ÉCHANTILLON:SAMPLE EXTRACTED:  
EXTRACTION D'ÉCHANTILLON:

FOOTAGE PROFONDEUR		OVERBURDEN DESCRIPTION DESCRIPTION DU MORT TERRAIN	SAMPLE DESCRIPTION ÉCHANTILLON
FROM DE	TO À		
0	1.2	ORGANIC	ORGANIC ORGANIQUE %
1.2	6	COARSE SAND	CLAY ARGILE %
6	7	BOL DEUR	SILT SILTE %
7	7.9	GRAVEL	FINE SAND SABLE FIN %
7.9	8.4	BASAL TILL	MEDIUM SAND SABLE MED. %
	8.4	RED ROCK	COARSE SAND SABLE GROS %
			GRAVEL GRAVIER %
			PEBBLES CAILLOUX %

REMARKS:  
REMARQUES:**rca**R. Cormier & Associés Ltée  
Associates Ltd.2050 Thibault,  
Bécancour, Qué.  
Canada, G0X 1B0  
Tél. - (819) 294-9939**OVERBURDEN DRILLING LOG**  
**JOURNAL DE FORAGE MORT TERRAIN**

SAMPLE No./No D'ÉCHANTILLON: <b>LE50100</b>	DRILL No./No DU TROU: <b>100</b>	DATE: <b>27/6-85</b>
SAMPLE DEPTH./PROF.D'ÉCHANT: <b>5M</b>	SAMPLERS./SONDEURS: <b>RL FL</b>	CONTRACT./CONTRAT: <b>LAC MINERU</b>
LINE./LIGNE: <b>4E</b>	STATION: <b>1725-S</b>	LOCATION./LOCALITÉ: <b>FS</b>

**DRILLING TIME - FEUILLE DE TEMPS**POINT STARTED:  
DÉBUT DE POINTE:POINT STOPPED:  
ARRÊT DE POINTE:POINT EXTRACTED:  
EXTRACTION DE POINTE:SAMPLER STARTED:  
DÉBUT D'ÉCHANTILLON:SAMPLER STOPPED:  
ARRÊT D'ÉCHANTILLON:SAMPLE EXTRACTED:  
EXTRACTION D'ÉCHANTILLON:

FOOTAGE PROFONDEUR		OVERBURDEN DESCRIPTION DESCRIPTION DU MORT TERRAIN	SAMPLE DESCRIPTION ÉCHANTILLON
FROM DE	TO À		
0	1.2	ORGANIC	ORGANIC ORGANIQUE %
1.2	4	BOL DEUR	CLAY ARGILE %
4	4.8	BASAL TILL	SILT SILTE %
	5	RED ROCK	FINE SAND SABLE FIN %
			MEDIUM SAND SABLE MED. %
			COARSE SAND SABLE GROS %
			GRAVEL GRAVIER %
			PEBBLES CAILLOUX %

REMARKS:  
REMARQUES:**2 TRAIL**



R. Cormier & Associés Ltée  
Associates Ltd.

2050, Thibault,  
Bécancour, Qué.  
Canada, G0X 1B0  
Tél. - (819) 294-9939

OVERBURDEN DRILLING LOG  
JOURNAL DE FORAGE MORT TERRAIN

SAMPLE No./No D'ÉCHANTILLON: <i>LE50101</i>	DRILL No./No DU TROU: <i>101</i>	DATE: <i>29-6-85</i>
SAMPLE DEPTH:/PROF.D'ÉCHANT: <i>3M</i>	SAMPLERS:/SONDEURS: <i>X2-FL</i>	CONTRACT:/CONTRAT: <i>LAC MINERALS</i>
LINE:/LIGNE: <i>L-4E</i>	STATION: <i>1700 S</i>	LOCATION:/LOCALITÉ: <i>F.S</i>

DRILLING TIME - FEUILLE DE TEMPS

POINT STARTED:  
DÉBUT DE POINTE:

SAMPLER STARTED:  
DÉBUT D'ÉCHANTILLON:

POINT STOPPED:  
ARRÊT DE POINTE:

SAMPLER STOPPED:  
ARRÊT D'ÉCHANTILLON:

POINT EXTRACTED:  
EXTRACTION DE POINTE:

SAMPLE EXTRACTED:  
EXTRACTION D'ÉCHANTILLON:

FOOTAGE PROFONDEUR		OVERBURDEN DESCRIPTION DESCRIPTION DU MORT TERRAIN	SAMPLE DESCRIPTION ÉCHANTILLON
FROM DE	TO A		
0	0.2	ORGANIC	ORGANIC ORGANIQUE %
0.2	2.8	BOLDEUR	CLAY ARGILE %
2.8	3	BASAL TILL	SILT SILTE %
	3	BED ROCK	FINE SAND SABLE FIN %
			MEDIUM SAND SABLE MED. %
			COARSE SAND SABLE GROS %
			GRAVEL GRAVIER %
			PEBBLES CAILLOUX %

REMARKS:  
REMARQUES:



R. Cormier & Associés Ltée  
Associates Ltd.

2050, Thibault,  
Bécancour, Qué.  
Canada, G0X 1B0  
Tél. - (819) 294-9939

OVERBURDEN DRILLING LOG  
JOURNAL DE FORAGE MORT TERRAIN

SAMPLE No./No D'ÉCHANTILLON: <i>LE50102</i>	DRILL No./No DU TROU: <i>102</i>	DATE: <i>27/6/85</i>
SAMPLE DEPTH:/PROF.D'ÉCHANT: <i>1.2</i>	SAMPLERS:/SONDEURS: <i>RL-FL</i>	CONTRACT:/CONTRAT: <i>LAC MINERALS</i>
LINE:/LIGNE: <i>4E</i>	STATION: <i>75700-G</i>	LOCATION:/LOCALITÉ: <i>F-S</i>

DRILLING TIME - FEUILLE DE TEMPS

POINT STARTED:  
DÉBUT DE POINTE:

SAMPLER STARTED:  
DÉBUT D'ÉCHANTILLON:

POINT STOPPED:  
ARRÊT DE POINTE:

SAMPLER STOPPED:  
ARRÊT D'ÉCHANTILLON:

POINT EXTRACTED:  
EXTRACTION DE POINTE:

SAMPLE EXTRACTED:  
EXTRACTION D'ÉCHANTILLON:

FOOTAGE PROFONDEUR		OVERBURDEN DESCRIPTION DESCRIPTION DU MORT TERRAIN	SAMPLE DESCRIPTION ÉCHANTILLON
FROM DE	TO A		
0	0.1	ORGANIC	ORGANIC ORGANIQUE %
0.1	1	BOLDEUR	CLAY ARGILE %
1	1.2	BASAL TILL	SILT SILTE %
	1.2	BED ROCK	FINE SAND SABLE FIN %
			MEDIUM SAND SABLE MED. %
			COARSE SAND SABLE GROS %
			GRAVEL GRAVIER %
			PEBBLES CAILLOUX %

REMARKS:  
REMARQUES:

*3 TILL*



R. Cormier & Associés Ltée  
Associates Ltd.

2050, Thibault,  
Béancour, Qué.  
Canada, G0X 1B0  
Tél. - (819) 294-9939

OVERBURDEN DRILLING LOG  
JOURNAL DE FORAGE MORT TERRAIN

SAMPLE No./No D'ÉCHANTILLON: 4550103	DRILL No./No DU TROU: 103	DATE: 28-6-85
SAMPLE DEPTH./PROF. D'ÉCHANT: 3'5	SAMPLERS./SONDEURS: RL FL	CONTRACT./CONTRAT: LAC MINERAL
LINE./LIGNE: 4 E	STATION: 50700 S	LOCATION./LOCALITÉ: F-S

DRILLING TIME - FEUILLE DE TEMPS

POINT STARTED: DÉBUT DE POINTE:      SAMPLER STARTED: DÉBUT D'ÉCHANTILLON:  
POINT STOPPED: ARRÊT DE POINTE:      SAMPLER STOPPED: ARRÊT D'ÉCHANTILLON:  
POINT EXTRACTED: EXTRACTION DE POINTE:      SAMPLE EXTRACTED: EXTRACTION D'ÉCHANTILLON:

FOOTAGE PROFONDEUR		OVERBURDEN DESCRIPTION DESCRIPTION DU MORT TERRAIN	SAMPLE DESCRIPTION ÉCHANTILLON
FROM DE	TO A		
0	0.2	ORGANIC	ORGANIC ORGANIQUE %
0.2	3	BOL DEUR	CLAY ARGILE %
3	3.3	GRAVEL	SILT SILTE %
3.3	3.5	BASAL TILL	FINE SAND SABLE FIN %
	3.5	BED ROCK	MEDIUM SAND SABLE MED. %
			COARSE SAND SABLE GROS %
			GRAVEL GRAVIER %
			PEBBLES CAILLOUX %

REMARKS:  
REMARQUES:



R. Cormier & Associés Ltée  
Associates Ltd.

2050, Thibault,  
Béancour, Qué.  
Canada, G0X 1B0  
Tél. - (819) 294-9939

OVERBURDEN DRILLING LOG  
JOURNAL DE FORAGE MORT TERRAIN

SAMPLE No./No D'ÉCHANTILLON: 4550104	DRILL No./No DU TROU: 104	DATE: 28-6-85
SAMPLE DEPTH./PROF. D'ÉCHANT: 10 M	SAMPLERS./SONDEURS: RL-FL	CONTRACT./CONTRAT: LAC MINERAL
LINE./LIGNE: 4 E	STATION: 25700	LOCATION./LOCALITÉ: F-S

DRILLING TIME - FEUILLE DE TEMPS

POINT STARTED: DÉBUT DE POINTE:      SAMPLER STARTED: DÉBUT D'ÉCHANTILLON:  
POINT STOPPED: ARRÊT DE POINTE:      SAMPLER STOPPED: ARRÊT D'ÉCHANTILLON:  
POINT EXTRACTED: EXTRACTION DE POINTE:      SAMPLE EXTRACTED: EXTRACTION D'ÉCHANTILLON:

FOOTAGE PROFONDEUR		OVERBURDEN DESCRIPTION DESCRIPTION DU MORT TERRAIN	SAMPLE DESCRIPTION ÉCHANTILLON
FROM DE	TO A		
0	0.2	ORGANIC	ORGANIC ORGANIQUE %
0.2	6	FINE SAND	CLAY ARGILE %
6	8	CORSE SAND	SILT SILTE %
8	9.8	BOL DEUR	FINE SAND SABLE FIN %
9.8	10	BASAL TILL	MEDIUM SAND SABLE MED. %
	10	BED ROCK	COARSE SAND SABLE GROS %
			GRAVEL GRAVIER %
			PEBBLES CAILLOUX %

REMARKS:  
REMARQUES:





R. Cormier & Associés Ltée  
Associates Ltd.

2050, Thibault,  
Bécancour, Qué.  
Canada, G0X 1B0  
Tél. - (819) 294-9939

OVERBURDEN DRILLING LOG  
JOURNAL DE FORAGE MORT TERRAIN

SAMPLE No./No D'ÉCHANTILLON: 6E50105	DRILL No./No DU TROU: 105	DATE: 28-6-85
SAMPLE DEPTH./PROF.D'ÉCHANT: 10M	SAMPLERS./SONDEURS: PCLFL	CONTRACT./CONTRAT: LAC MINERAL
LINE./LIGNE: 4E	STATION: 00700 BL	LOCATION./LOCALITÉ: F-S

DRILLING TIME - FEUILLE DE TEMPS

POINT STARTED:  
DÉBUT DE POINTE:

SAMPLER STARTED:  
DÉBUT D'ÉCHANTILLON:

POINT STOPPED:  
ARRÊT DE POINTE:

SAMPLER STOPPED:  
ARRÊT D'ÉCHANTILLON:

POINT EXTRACTED:  
EXTRACTION DE POINTE:

SAMPLE EXTRACTED:  
EXTRACTION D'ÉCHANTILLON:

FOOTAGE PROFONDEUR		OVERBURDEN DESCRIPTION DESCRIPTION DU MORT TERRAIN	SAMPLE DESCRIPTION ÉCHANTILLON
FROM DE	TO À		
0	2	ORGANIC	ORGANIC ORGANIQUE %
2	6	CORSE SAND	CLAY ARGILE %
6	9	RED DEUR	SILT SILTE %
9	9.8	CORSE SAND	FINE SAND SABLE FIN %
9.8	10	BASALTILL	MEDIUM SAND SABLE MED. %
	10	RED ROCK	COARSE SAND SABLE GROS %
			GRAVEL GRAVIER %
			PEBBLES CAILLOUX %

REMARKS:  
REMARQUES:



R. Cormier & Associés Ltée  
Associates Ltd.

2050 Thibault,  
Bécancour, Qué.  
Canada, G0X 1B0  
Tél. - (819) 294-9939

OVERBURDEN DRILLING LOG  
JOURNAL DE FORAGE MORT TERRAIN

SAMPLE No./No D'ÉCHANTILLON: 6E50106	DRILL No./No DU TROU: 106	DATE: 28-6-85
SAMPLE DEPTH./PROF.D'ÉCHANT: 10.5	SAMPLERS./SONDEURS: PCLFL	CONTRACT./CONTRAT: LAC MINERAL
LINE./LIGNE: 4E	STATION: 12705 - N	LOCATION./LOCALITÉ: F-S

DRILLING TIME - FEUILLE DE TEMPS

POINT STARTED:  
DÉBUT DE POINTE:

SAMPLER STARTED:  
DÉBUT D'ÉCHANTILLON:

POINT STOPPED:  
ARRÊT DE POINTE:

SAMPLER STOPPED:  
ARRÊT D'ÉCHANTILLON:

POINT EXTRACTED:  
EXTRACTION DE POINTE:

SAMPLE EXTRACTED:  
EXTRACTION D'ÉCHANTILLON:

FOOTAGE PROFONDEUR		OVERBURDEN DESCRIPTION DESCRIPTION DU MORT TERRAIN	SAMPLE DESCRIPTION ÉCHANTILLON
FROM DE	TO À		
0	2	ORGANIC	ORGANIC ORGANIQUE %
2	7	CLAY	CLAY ARGILE %
7	9	RED DEUR	SILT SILTE %
9	10.3	FINE SAND	FINE SAND SABLE FIN %
10.3	10.5	BASALTILL	MEDIUM SAND SABLE MED. %
	10.5	RED ROCK	COARSE SAND SABLE GROS %
			GRAVEL GRAVIER %
			PEBBLES CAILLOUX %
		2 TAIL	

REMARKS:  
REMARQUES:



R. Cormier & Associés Ltée  
Associates Ltd.

2050, Thibault,  
Bécancour, Qué.  
Canada, G0X 1B0  
Tél. - (819) 294-9939

OVERBURDEN DRILLING LOG  
JOURNAL DE FORAGE MORT TERRAIN

SAMPLE No./No D'ÉCHANTILLON: LE50107	DRILL No./No DU TROU: 107	DATE: 29-6-85
SAMPLE DEPTH./PROF.D'ÉCHANT: 16M	SAMPLERS./SONDEURS: RLFL	CONTRACT./CONTRAT: LAC MINERAL
LINE./LIGNE: 4E	STATION: 25700N	LOCATION./LOCALITÉ: KS

DRILLING TIME - FEUILLE DE TEMPS

POINT STARTED:  
DÉBUT DE POINTE:

SAMPLER STARTED:  
DÉBUT D'ÉCHANTILLON:

POINT STOPPED:  
ARRÊT DE POINTE:

SAMPLER STOPPED:  
ARRÊT D'ÉCHANTILLON:

POINT EXTRACTED:  
EXTRACTION DE POINTE:

SAMPLE EXTRACTED:  
EXTRACTION D'ÉCHANTILLON:

FOOTAGE PROFONDEUR		OVERBURDEN DESCRIPTION DESCRIPTION DU MORT TERRAIN	SAMPLE DESCRIPTION ÉCHANTILLON
FROM DE	TO A		
0	2	ORGANIC	ORGANIC ORGANIQUE %
2	6	CLAY	CLAY ARGILE %
6	8	GRAVEL	SILT SILTE %
8	9	BOL DEUR	FINE SAND SABLE FIN %
9	9'8	GRAVEL	MEDIUM SAND SABLE MED. %
9'8	10	BASAL TILL	COARSE SAND SABLE GROS %
	10	BED ROCK	GRAVEL GRAVIER %
			PEBBLES CAILLOUX %

REMARKS:  
REMARQUES:



R. Cormier & Associés Ltée  
Associates Ltd.

2050, Thibault,  
Bécancour, Qué.  
Canada, G0X 1B0  
Tél. - (819) 294-9939

OVERBURDEN DRILLING LOG  
JOURNAL DE FORAGE MORT TERRAIN

SAMPLE No./No D'ÉCHANTILLON: LE50108	DRILL No./No DU TROU: 108	DATE: 29-6-85
SAMPLE DEPTH./PROF.D'ÉCHANT: 11M	SAMPLERS./SONDEURS: RLFL	CONTRACT./CONTRAT: LAC MINERAL
LINE./LIGNE: 4E	STATION: 3750N	LOCATION./LOCALITÉ: FS

DRILLING TIME - FEUILLE DE TEMPS

POINT STARTED:  
DÉBUT DE POINTE:

SAMPLER STARTED:  
DÉBUT D'ÉCHANTILLON:

POINT STOPPED:  
ARRÊT DE POINTE:

SAMPLER STOPPED:  
ARRÊT D'ÉCHANTILLON:

POINT EXTRACTED:  
EXTRACTION DE POINTE:

SAMPLE EXTRACTED:  
EXTRACTION D'ÉCHANTILLON:

FOOTAGE PROFONDEUR		OVERBURDEN DESCRIPTION DESCRIPTION DU MORT TERRAIN	SAMPLE DESCRIPTION ÉCHANTILLON
FROM DE	TO A		
0	2	ORGANIC	ORGANIC ORGANIQUE %
2	6	CLAY	CLAY ARGILE %
6	9	CORSE SAND	SILT SILTE %
9	10'8	BOL DEUR	FINE SAND SABLE FIN %
10'8	11	BASAL TILL	MEDIUM SAND SABLE MED. %
	11	BED ROCK	COARSE SAND SABLE GROS %
			GRAVEL GRAVIER %
			PEBBLES CAILLOUX %

REMARKS:  
REMARQUES:



R. Cormier & Associés Ltée  
Associates Ltd.

2050, Thibault,  
Bécancour, Qué.  
Canada, G0X 1B0  
Tél. - (819) 294-9939

OVERBURDEN DRILLING LOG  
JOURNAL DE FORAGE MORT TERRAIN

SAMPLE No./No D'ÉCHANTILLON: <b>LE50109</b>	DRILL No./No DU TROU: <b>109</b>	DATE: <b>29-6-85</b>
SAMPLE DEPTH./PROF. D'ÉCHANT: <b>11.2</b>	SAMPLERS./SONDEURS: <b>RL FL</b>	CONTRACT./CONTRAT: <b>LAC MINERAL</b>
LINE./LIGNE: <b>4E</b>	STATION: <b>50700N</b>	LOCATION./LOCALITÉ: <b>F-S</b>

DRILLING TIME - FEUILLE DE TEMPS

POINT STARTED:  
DÉBUT DE POINTE:

SAMPLER STARTED:  
DÉBUT D'ÉCHANTILLON:

POINT STOPPED:  
ARRÊT DE POINTE:

SAMPLER STOPPED:  
ARRÊT D'ÉCHANTILLON:

POINT EXTRACTED:  
EXTRACTION DE POINTE:

SAMPLE EXTRACTED:  
EXTRACTION D'ÉCHANTILLON:

FOOTAGE PROFONDEUR		OVERBURDEN DESCRIPTION DESCRIPTION DU MORT TERRAIN	SAMPLE DESCRIPTION ÉCHANTILLON
FROM DE	TO À		
0	0.1	ORGANIC	ORGANIC ORGANIQUE %
0.1	0.8	CLAY	CLAY ARGILE %
0.8	1.1	BOL DEUR	SILT SILTE %
1.1	11.2	BASAL TILL	FINE SAND SABLE FIN %
	11.2	BED ROCK	MEDIUM SAND SABLE MED. %
			COARSE SAND SABLE GROS %
			GRAVEL GRAVIER %
			PEBBLES CAILLOUX %

REMARKS:  
REMARQUES:



R. Cormier & Associés Ltée  
Associates Ltd.

2050, Thibault,  
Bécancour, Qué.  
Canada, G0X 1B0  
Tél. - (819) 294-9939

OVERBURDEN DRILLING LOG  
JOURNAL DE FORAGE MORT TERRAIN

SAMPLE No./No D'ÉCHANTILLON: <b>LE50110</b>	DRILL No./No DU TROU: <b>110</b>	DATE: <b>29-6-85</b>
SAMPLE DEPTH./PROF. D'ÉCHANT: <b>13.5</b>	SAMPLERS./SONDEURS: <b>RL-FL</b>	CONTRACT./CONTRAT: <b>LAC MINERAL</b>
LINE./LIGNE: <b>4E</b>	STATION: <b>62.5N</b>	LOCATION./LOCALITÉ: <b>F-S</b>

DRILLING TIME - FEUILLE DE TEMPS

POINT STARTED:  
DÉBUT DE POINTE:

SAMPLER STARTED:  
DÉBUT D'ÉCHANTILLON:

POINT STOPPED:  
ARRÊT DE POINTE:

SAMPLER STOPPED:  
ARRÊT D'ÉCHANTILLON:

POINT EXTRACTED:  
EXTRACTION DE POINTE:

SAMPLE EXTRACTED:  
EXTRACTION D'ÉCHANTILLON:

FOOTAGE PROFONDEUR		OVERBURDEN DESCRIPTION DESCRIPTION DU MORT TERRAIN	SAMPLE DESCRIPTION ÉCHANTILLON
FROM DE	TO À		
0	0.2	ORGANIC	ORGANIC ORGANIQUE %
0.2	0.7	CLAY	CLAY ARGILE %
0.7	1.0	CORSE SAND	SILT SILTE %
1.0	1.2	BOL DEUR	FINE SAND SABLE FIN %
1.2	13.4	GRAVEL	MEDIUM SAND SABLE MED. %
13.4	13.5	BASAL TILL	COARSE SAND SABLE GROS %
	13.5	BED ROCK	GRAVEL GRAVIER %
			PEBBLES CAILLOUX %

REMARKS:  
REMARQUES:



R. Cormier & Associés Ltée  
Associates Ltd.

2050, Thibault,  
Bécancour, Qué.  
Canada, G0X 1B0  
Tél. - (819) 294-9939

OVERBURDEN DRILLING LOG  
JOURNAL DE FORAGE MORT TERRAIN

SAMPLE No./No D'ÉCHANTILLON: <b>LES0111</b>	DRILL No./No DU TROU: <b>111</b>	DATE: <b>30/6-85</b>
SAMPLE DEPTH./PROF.D'ÉCHANT: <b>14M</b>	SAMPLERS./SONDEURS: <b>RL FL</b>	CONTRACT./CONTRAT: <b>KACMINERAL</b>
LINE./LIGNE: <b>4E</b>	STATION: <b>75400N</b>	LOCATION./LOCALITÉ: <b>F-S</b>

DRILLING TIME - FEUILLE DE TEMPS

POINT STARTED:  
DÉBUT DE POINTE:

SAMPLER STARTED:  
DÉBUT D'ÉCHANTILLON:

POINT STOPPED:  
ARRÊT DE POINTE:

SAMPLER STOPPED:  
ARRÊT D'ÉCHANTILLON:

POINT EXTRACTED:  
EXTRACTION DE POINTE:

SAMPLE EXTRACTED:  
EXTRACTION D'ÉCHANTILLON:

FOOTAGE PROFONDEUR		OVERBURDEN DESCRIPTION DESCRIPTION DU MORT TERRAIN	SAMPLE DESCRIPTION ÉCHANTILLON
FROM DE	TO A		
0	2	ORGANIC	ORGANIC ORGANIQUE %
2	8	CLAY	CLAY ARGILE %
8	12	COURSE SAND	SILT SILTE %
12	13.8	GRAVEL	FINE SAND SABLE FIN %
13.8	14M	BASAL TILL	MEDIUM SAND SABLE MED. %
	14	BED ROCK	COARSE SAND SABLE GROS %
			GRAVEL GRAVIER %
			PEBBLES CAILLOUX %

REMARKS:  
REMARQUES:



R. Cormier & Associés Ltée  
Associates Ltd.

2050 Thibault,  
Bécancour, Qué.  
Canada, G0X 1B0  
Tél. - (819) 294-9939

OVERBURDEN DRILLING LOG  
JOURNAL DE FORAGE MORT TERRAIN

SAMPLE No./No D'ÉCHANTILLON: <b>LES0112</b>	DRILL No./No DU TROU: <b>112</b>	DATE: <b>30-6-85</b>
SAMPLE DEPTH./PROF.D'ÉCHANT: <b>19'2</b>	SAMPLERS./SONDEURS: <b>RL-FS</b>	CONTRACT./CONTRAT: <b>KACMINERAL</b>
LINE./LIGNE: <b>4E</b>	STATION: <b>100400N</b>	LOCATION./LOCALITÉ: <b>FS</b>

DRILLING TIME - FEUILLE DE TEMPS

POINT STARTED:  
DÉBUT DE POINTE:

SAMPLER STARTED:  
DÉBUT D'ÉCHANTILLON:

POINT STOPPED:  
ARRÊT DE POINTE:

SAMPLER STOPPED:  
ARRÊT D'ÉCHANTILLON:

POINT EXTRACTED:  
EXTRACTION DE POINTE:

SAMPLE EXTRACTED:  
EXTRACTION D'ÉCHANTILLON:

FOOTAGE PROFONDEUR		OVERBURDEN DESCRIPTION DESCRIPTION DU MORT TERRAIN	SAMPLE DESCRIPTION ÉCHANTILLON
FROM DE	TO A		
0	2	ORGANIC	ORGANIC ORGANIQUE %
2	10	CLAY	CLAY ARGILE %
10	16	COURSE SAND	SILT SILTE %
16	18	BOL DEUR	FINE SAND SABLE FIN %
18	19	GRAVEL	MEDIUM SAND SABLE MED. %
19	19.2	BASAL TILL	COARSE SAND SABLE GROS %
	19.2	BED ROCK	GRAVEL GRAVIER %
			PEBBLES CAILLOUX %

REMARKS:  
REMARQUES:

OVERBURDEN DRILLING LOG  
JOURNAL DE FORAGE MORT TERRAIN

SAMPLE No./No D'ÉCHANTILLON: <b>LE50113</b>	DRILL No./No DU TROU: <b>113</b>	DATE: <b>12/7/85</b>
SAMPLE DEPTH./PROF.D'ÉCHANT: <b>20'2</b>	SAMPLERS./SONDEURS: <b>RLFL</b>	CONTRACT./CONTRAT: <b>LACHMINERAL</b>
LINE./LIGNE: <b>4E</b>	STATION: <b>1725-N</b>	LOCATION./LOCALITÉ: <b>FS</b>

DRILLING TIME - FEUILLE DE TEMPS

POINT STARTED: DÉBUT DE POINTE:      SAMPLER STARTED: DÉBUT D'ÉCHANTILLON:  
POINT STOPPED: ARRÊT DE POINTE:      SAMPLER STOPPED: ARRÊT D'ÉCHANTILLON:  
POINT EXTRACTED: EXTRACTION DE POINTE:      SAMPLE EXTRACTED: EXTRACTION D'ÉCHANTILLON:

FOOTAGE PROFONDEUR		OVERBURDEN DESCRIPTION DESCRIPTION DU MORT TERRAIN	SAMPLE DESCRIPTION ÉCHANTILLON
FROM DE	TO A		
0	12	ORGANIC	ORGANIC ORGANIQUE %
12	10	CLAY	CLAY ARGILE %
10	16	FINE SAND	SILT SILTE %
16	20	COURSE SAND	FINE SAND SABLE FIN %
20	20'2	BASALTILL	MEDIUM SAND SABLE MED. %
	20'2	RED ROCK	COARSE SAND SABLE GROS %
			GRAVEL GRAVIER %
			PEBBLES CAILLOUX %

REMARKS:  
REMARQUES:

OVERBURDEN DRILLING LOG  
JOURNAL DE FORAGE MORT TERRAIN

SAMPLE No./No D'ÉCHANTILLON: <b>LE50114</b>	DRILL No./No DU TROU: <b>114</b>	DATE: <b>12/7/85</b>
SAMPLE DEPTH./PROF.D'ÉCHANT: <b>9'M</b>	SAMPLERS./SONDEURS: <b>RLFL</b>	CONTRACT./CONTRAT: <b>LACHMINERAL</b>
LINE./LIGNE: <b>6E</b>	STATION: <b>60700</b>	LOCATION./LOCALITÉ: <b>FS</b>

DRILLING TIME - FEUILLE DE TEMPS

POINT STARTED: DÉBUT DE POINTE:      SAMPLER STARTED: DÉBUT D'ÉCHANTILLON:  
POINT STOPPED: ARRÊT DE POINTE:      SAMPLER STOPPED: ARRÊT D'ÉCHANTILLON:  
POINT EXTRACTED: EXTRACTION DE POINTE:      SAMPLE EXTRACTED: EXTRACTION D'ÉCHANTILLON:

FOOTAGE PROFONDEUR		OVERBURDEN DESCRIPTION DESCRIPTION DU MORT TERRAIN	SAMPLE DESCRIPTION ÉCHANTILLON
FROM DE	TO A		
0	1	ORGANIC	ORGANIC ORGANIQUE %
1	7	FINE SAND	CLAY ARGILE %
7	8'8	COURSE SAND	SILT SILTE %
8'8	9	BASALTILL	FINE SAND SABLE FIN %
	9	RED ROCK	MEDIUM SAND SABLE MED. %
			COARSE SAND SABLE GROS %
			GRAVEL GRAVIER %
			PEBBLES CAILLOUX %

REMARKS:  
REMARQUES:



R. Cormier & Associés Ltée  
Associates Ltd.

2050, Thibault,  
Bécancour, Qué.  
Canada, G0X 1B0  
Tél. - (819) 294-9939

OVERBURDEN DRILLING LOG  
JOURNAL DE FORAGE MORT TERRAIN

SAMPLE No./No D'ÉCHANTILLON: LE50115	DRILL No./No DU TROU: 115	DATE: 2-7-85
SAMPLE DEPTH./PROF.D'ÉCHANT: 8.2	SAMPLERS./SONDEURS: RL FL	CONTRACT./CONTRAT: LAC MINERAL
LINE./LIGNE: 6E	STATION: 25700 S	LOCATION./LOCALITÉ: E-S

DRILLING TIME - FEUILLE DE TEMPS

POINT STARTED:  
DÉBUT DE POINTE:

SAMPLER STARTED:  
DÉBUT D'ÉCHANTILLON:

POINT STOPPED:  
ARRÊT DE POINTE:

SAMPLER STOPPED:  
ARRÊT D'ÉCHANTILLON:

POINT EXTRACTED:  
EXTRACTION DE POINTE:

SAMPLE EXTRACTED:  
EXTRACTION D'ÉCHANTILLON:

FOOTAGE PROFONDEUR		OVERBURDEN DESCRIPTION DESCRIPTION DU MORT TERRAIN	SAMPLE DESCRIPTION ÉCHANTILLON
FROM DE	TO À		
0	1	ORGANIC	ORGANIC ORGANIQUE %
1	4	FINE SAND	CLAY ARGILE %
4	8	CORSE SAND	SILT SILTE %
8	8.2	BASAL TILL	FINE SAND SABLE FIN %
	8.2	BED ROCK	MEDIUM SAND SABLE MED. %
			COARSE SAND SABLE GROS %
			GRAVEL GRAVIER %
			PEBBLES CAILLOUX %
		2 TRAIL	

REMARKS:  
REMARQUES:



R. Cormier & Associés Ltée  
Associates Ltd.

2050 Thibault,  
Bécancour, Qué.  
Canada, G0X 1B0  
Tél. - (819) 294-9939

OVERBURDEN DRILLING LOG  
JOURNAL DE FORAGE MORT TERRAIN

SAMPLE No./No D'ÉCHANTILLON: LE50116	DRILL No./No DU TROU: 116	DATE: 2/7-85
SAMPLE DEPTH./PROF.D'ÉCHANT: 4.5	SAMPLERS./SONDEURS: RL-FL	CONTRACT./CONTRAT: LAC MINERAL
LINE./LIGNE: 6E	STATION: 50700-S	LOCATION./LOCALITÉ: E S

DRILLING TIME - FEUILLE DE TEMPS

POINT STARTED:  
DÉBUT DE POINTE:

SAMPLER STARTED:  
DÉBUT D'ÉCHANTILLON:

POINT STOPPED:  
ARRÊT DE POINTE:

SAMPLER STOPPED:  
ARRÊT D'ÉCHANTILLON:

POINT EXTRACTED:  
EXTRACTION DE POINTE:

SAMPLE EXTRACTED:  
EXTRACTION D'ÉCHANTILLON:

FOOTAGE PROFONDEUR		OVERBURDEN DESCRIPTION DESCRIPTION DU MORT TERRAIN	SAMPLE DESCRIPTION ÉCHANTILLON
FROM DE	TO À		
0	1	ORGANIC	ORGANIC ORGANIQUE %
1	4.3	CORSE SAND	CLAY ARGILE %
4.3	4.5	BASAL TILL	SILT SILTE %
	4.5	BED ROCK	FINE SAND SABLE FIN %
			MEDIUM SAND SABLE MED. %
			COARSE SAND SABLE GROS %
			GRAVEL GRAVIER %
			PEBBLES CAILLOUX %

REMARKS:  
REMARQUES:



R. Cormier & Associés Ltée  
Associates Ltd.

2050, Thibault,  
Bécancour, Qué.  
Canada, G0X 1B0  
Tél. - (819) 294-9939

OVERBURDEN DRILLING LOG  
JOURNAL DE FORAGE MORT TERRAIN

SAMPLE No./No D'ÉCHANTILLON: <i>LE50117</i>	DRILL No./No DU TROU: <i>117</i>	DATE: <i>2-7-85</i>
SAMPLE DEPTH./ PROF. D'ÉCHANT: <i>7'5</i>	SAMPLERS./ SONDEURS: <i>RL FL</i>	CONTRACT./ CONTRAT: <i>LACMINERAL</i>
LINE./ LIGNE: <i>6 E</i>	STATION: <i>75700-S</i>	LOCATION./ LOCALITÉ: <i>ES</i>

DRILLING TIME - FEUILLE DE TEMPS

POINT STARTED:  
DÉBUT DE POINTE:

POINT STOPPED:  
ARRÊT DE POINTE:

POINT EXTRACTED:  
EXTRACTION DE POINTE:

SAMPLER STARTED:  
DÉBUT D'ÉCHANTILLON:

SAMPLER STOPPED:  
ARRÊT D'ÉCHANTILLON:

SAMPLE EXTRACTED:  
EXTRACTION D'ÉCHANTILLON:

FOOTAGE PROFONDEUR		OVERBURDEN DESCRIPTION DESCRIPTION DU MORT TERRAIN	SAMPLE DESCRIPTION ÉCHANTILLON
FROM DE	TO À		
0	1	ORGANIC	ORGANIC ORGANIQUE %
1	7	FINE SAND	CLAY ARGILE %
7	7'3	BOLDEUR	SILT SILTE %
7'3	7'5	BASAL TILL	FINE SAND SABLE FIN %
	7'5	BED ROCK	MEDIUM SAND SABLE MED. %
			COARSE SAND SABLE GROS %
			GRAVEL GRAVIER %
			PEBBLES CAILLOUX %

REMARKS:  
REMARQUES:



R. Cormier & Associés Ltée  
Associates Ltd.

2050 Thibault,  
Bécancour, Qué.  
Canada, G0X 1B0  
Tél. - (819) 294-9939

OVERBURDEN DRILLING LOG  
JOURNAL DE FORAGE MORT TERRAIN

SAMPLE No./No D'ÉCHANTILLON: <i>LE50118</i>	DRILL No./No DU TROU: <i>118</i>	DATE: <i>2-7-85</i>
SAMPLE DEPTH./ PROF. D'ÉCHANT: <i>8M</i>	SAMPLERS./ SONDEURS: <i>RL FL</i>	CONTRACT./ CONTRAT: <i>LACMINERAL</i>
LINE./ LIGNE: <i>6 E</i>	STATION: <i>1700-S</i>	LOCATION./ LOCALITÉ: <i>E-S</i>

DRILLING TIME - FEUILLE DE TEMPS

POINT STARTED:  
DÉBUT DE POINTE:

POINT STOPPED:  
ARRÊT DE POINTE:

POINT EXTRACTED:  
EXTRACTION DE POINTE:

SAMPLER STARTED:  
DÉBUT D'ÉCHANTILLON:

SAMPLER STOPPED:  
ARRÊT D'ÉCHANTILLON:

SAMPLE EXTRACTED:  
EXTRACTION D'ÉCHANTILLON:

FOOTAGE PROFONDEUR		OVERBURDEN DESCRIPTION DESCRIPTION DU MORT TERRAIN	SAMPLE DESCRIPTION ÉCHANTILLON
FROM DE	TO À		
0	1	ORGANIC	ORGANIC ORGANIQUE %
1	6	FINE SAND	CLAY ARGILE %
6	7'8	CORSE SAND	SILT SILTE %
7'8	8M	BASAL TILL	FINE SAND SABLE FIN %
	8M	BED ROCK	MEDIUM SAND SABLE MED. %
			COARSE SAND SABLE GROS %
			GRAVEL GRAVIER %
			PEBBLES CAILLOUX %

REMARKS:  
REMARQUES:



R. Cormier & Associés Ltée  
Associates Ltd.

2050, Thibault,  
Bécancour, Qué.  
Canada, G0X 1B0  
Tél. - (819) 294-9939

OVERBURDEN DRILLING LOG  
JOURNAL DE FORAGE MORT TERRAIN

SAMPLE No./No D'ÉCHANTILLON: LE50119	DRILL No./No DU TROU: 119	DATE: 2-7-85
SAMPLE DEPTH./ PROF. D'ÉCHANT: 5M	SAMPLERS./ SONDEURS: RL-FL	CONTRACT./ CONTRAT: LACHMINERAL
LINE./ LIGNE: 65	STATION: 1725-S	LOCATION./ LOCALITÉ: FS

DRILLING TIME - FEUILLE DE TEMPS

POINT STARTED:  
DÉBUT DE POINTE:

SAMPLER STARTED:  
DÉBUT D'ÉCHANTILLON:

POINT STOPPED:  
ARRÊT DE POINTE:

SAMPLER STOPPED:  
ARRÊT D'ÉCHANTILLON:

POINT EXTRACTED:  
EXTRACTION DE POINTE:

SAMPLE EXTRACTED:  
EXTRACTION D'ÉCHANTILLON:

FOOTAGE PROFONDEUR		OVERBURDEN DESCRIPTION DESCRIPTION DU MORT TERRAIN	SAMPLE DESCRIPTION ÉCHANTILLON
FROM DE	TO A		
0	1	ORGANIC	ORGANIC ORGANIQUE %
1	4	COARSE SAND	CLAY ARGILE %
4	4'8	BOL DEUR	SILT SILTE %
4'8	5M	BASAL TILL	FINE SAND SABLE FIN %
	5M	BED ROCK	MEDIUM SAND SABLE MED. %
			COARSE SAND SABLE GROS %
			GRAVEL GRAVIER %
			PEBBLES CAILLOUX %

REMARKS:  
REMARQUES:



R. Cormier & Associés Ltée  
Associates Ltd.

2050 Thibault,  
Bécancour, Qué.  
Canada, G0X 1B0  
Tel. - (819) 294-9939

OVERBURDEN DRILLING LOG  
JOURNAL DE FORAGE MORT TERRAIN

SAMPLE No./No D'ÉCHANTILLON: LE50120	DRILL No./No DU TROU: 120	DATE: 3-07-85
SAMPLE DEPTH./ PROF. D'ÉCHANT: 2'2	SAMPLERS./ SONDEURS: RL FL	CONTRACT./ CONTRAT: LACHMINERAL
LINE./ LIGNE: 65	STATION: 1737.5-S	LOCATION./ LOCALITÉ: E-S

DRILLING TIME - FEUILLE DE TEMPS

POINT STARTED:  
DÉBUT DE POINTE:

SAMPLER STARTED:  
DÉBUT D'ÉCHANTILLON:

POINT STOPPED:  
ARRÊT DE POINTE:

SAMPLER STOPPED:  
ARRÊT D'ÉCHANTILLON:

POINT EXTRACTED:  
EXTRACTION DE POINTE:

SAMPLE EXTRACTED:  
EXTRACTION D'ÉCHANTILLON:

FOOTAGE PROFONDEUR		OVERBURDEN DESCRIPTION DESCRIPTION DU MORT TERRAIN	SAMPLE DESCRIPTION ÉCHANTILLON
FROM DE	TO A		
0	1	ORGANIC	ORGANIC ORGANIQUE %
1	2	GRAVEL	CLAY ARGILE %
2	2'2	BASAL TILL	SILT SILTE %
	2'2	BED ROCK	FINE SAND SABLE FIN %
			MEDIUM SAND SABLE MED. %
			COARSE SAND SABLE GROS %
			GRAVEL GRAVIER %
			PEBBLES CAILLOUX %

REMARKS:  
REMARQUES:





R. Cormier & Associés Ltée  
Associates Ltd.

2050, Thibault,  
Bécancour, Qué.  
Canada, G0X 1B0  
Tél. - (819) 294-9939

OVERBURDEN DRILLING LOG  
JOURNAL DE FORAGE MORT TERRAIN

SAMPLE No./No D'ÉCHANTILLON: <b>L550121</b>	DRILL No./No DU TROU: <b>121</b>	DATE: <b>3-07-85</b>
SAMPLE DEPTH./PROF.D'ÉCHANT: <b>1M</b>	SAMPLERS./SONDEURS: <b>RL-FL</b>	CONTRACT./CONTRAT: <b>LAC MINERAL</b>
LINE./LIGNE: <b>6 E</b>	STATION: <b>1+50-S</b>	LOCATION./LOCALITÉ: <b>E-S</b>

DRILLING TIME - FEUILLE DE TEMPS

POINT STARTED:  
DÉBUT DE POINTE:

SAMPLER STARTED:  
DÉBUT D'ÉCHANTILLON:

POINT STOPPED:  
ARRÊT DE POINTE:

SAMPLER STOPPED:  
ARRÊT D'ÉCHANTILLON:

POINT EXTRACTED:  
EXTRACTION DE POINTE:

SAMPLE EXTRACTED:  
EXTRACTION D'ÉCHANTILLON:

FOOTAGE PROFONDEUR		OVERBURDEN DESCRIPTION DESCRIPTION DU MORT TERRAIN	SAMPLE DESCRIPTION ÉCHANTILLON
FROM DE	TO À		
0	0.1	ORGANIC	ORGANIC ORGANIQUE %
-	0.8	BOL DEUR	CLAY ARGILE %
0.8	1M	BASAL TILL	SILT SILTE %
	1M	RED ROCK	FINE SAND SABLE FIN %
			MEDIUM SAND SABLE MED. %
			COARSE SAND SABLE GROS %
			GRAVEL GRAVIER %
			PEBBLES CAILLOUX %

REMARKS:  
REMARQUES:



R. Cormier & Associés Ltée  
Associates Ltd.

2050 Thibault,  
Bécancour, Qué.  
Canada, G0X 1B0  
Tél. - (819) 294-9939

OVERBURDEN DRILLING LOG  
JOURNAL DE FORAGE MORT TERRAIN

SAMPLE No./No D'ÉCHANTILLON: <b>L550122</b>	DRILL No./No DU TROU: <b>122</b>	DATE: <b>3-07-85</b>
SAMPLE DEPTH./PROF.D'ÉCHANT: <b>0</b>	SAMPLERS./SONDEURS: <b>RL-FL</b>	CONTRACT./CONTRAT: <b>LAC MINERAL</b>
LINE./LIGNE: <b>6 E</b>	STATION: <b>1+62.5-S</b>	LOCATION./LOCALITÉ: <b>E-S</b>

DRILLING TIME - FEUILLE DE TEMPS

POINT STARTED:  
DÉBUT DE POINTE:

SAMPLER STARTED:  
DÉBUT D'ÉCHANTILLON:

POINT STOPPED:  
ARRÊT DE POINTE:

SAMPLER STOPPED:  
ARRÊT D'ÉCHANTILLON:

POINT EXTRACTED:  
EXTRACTION DE POINTE:

SAMPLE EXTRACTED:  
EXTRACTION D'ÉCHANTILLON:

FOOTAGE PROFONDEUR		OVERBURDEN DESCRIPTION DESCRIPTION DU MORT TERRAIN	SAMPLE DESCRIPTION ÉCHANTILLON
FROM DE	TO À		
		OUT CROC	ORGANIC ORGANIQUE %
			CLAY ARGILE %
			SILT SILTE %
			FINE SAND SABLE FIN %
			MEDIUM SAND SABLE MED. %
			COARSE SAND SABLE GROS %
			GRAVEL GRAVIER %
			PEBBLES CAILLOUX %

REMARKS:  
REMARQUES:



R. Cormier & Associés Ltée  
Associates Ltd.

2050, Thibault,  
Bécancour, Qué.  
Canada, G0X 1B0  
Tél. - (819) 294-9939

OVERBURDEN DRILLING LOG  
JOURNAL DE FORAGE MORT TERRAIN

SAMPLE No./ No D'ÉCHANTILLON: <b>LE50123</b>	DRILL No./ No DU TROU: <b>123</b>	DATE: <b>3-07-85</b>
SAMPLE DEPTH./ PROF. D'ÉCHANT: <b>0</b>	SAMPLERS./ SONDEURS: <b>RL-FL</b>	CONTRACT./ CONTRAT: <b>LACHIVERAUX</b>
LINE./ LIGNE: <b>6E</b>	STATION: <b>1775-S</b>	LOCATION./ LOCALITÉ: <b>F-S</b>

DRILLING TIME - FEUILLE DE TEMPS

POINT STARTED:  
DÉBUT DE POINTE:

SAMPLER STARTED:  
DÉBUT D'ÉCHANTILLON:

POINT STOPPED:  
ARRÊT DE POINTE:

SAMPLER STOPPED:  
ARRÊT D'ÉCHANTILLON:

POINT EXTRACTED:  
EXTRACTION DE POINTE:

SAMPLE EXTRACTED:  
EXTRACTION D'ÉCHANTILLON:

FOOTAGE PROFONDEUR		OVERBURDEN DESCRIPTION DESCRIPTION DU MORT TERRAIN	SAMPLE DESCRIPTION ÉCHANTILLON
FROM DE	TO À		
	<b>0</b>	<b>OUT CROC</b>	ORGANIC ORGANIQUE %
			CLAY ARGILE %
			SILT SILTE %
			FINE SAND SABLE FIN %
			MEDIUM SAND SABLE MED. %
			COARSE SAND SABLE GROS %
			GRAVEL GRAVIER %
			PEBBLES CAILLOUX %

REMARKS:  
REMARQUES:



R. Cormier & Associés Ltée  
Associates Ltd.

2050 Thibault,  
Bécancour, Qué.  
Canada, G0X 1B0  
Tel. - (819) 294-9939

OVERBURDEN DRILLING LOG  
JOURNAL DE FORAGE MORT TERRAIN

SAMPLE No./ No D'ÉCHANTILLON: <b>LE50124</b>	DRILL No./ No DU TROU: <b>124</b>	DATE: <b>3-07-85</b>
SAMPLE DEPTH./ PROF. D'ÉCHANT: <b>0</b>	SAMPLERS./ SONDEURS: <b>RL FL</b>	CONTRACT./ CONTRAT: <b>LACHIVERAUX</b>
LINE./ LIGNE: <b>6E</b>	STATION: <b>2700-S</b>	LOCATION./ LOCALITÉ: <b>F-S</b>

DRILLING TIME - FEUILLE DE TEMPS

POINT STARTED:  
DÉBUT DE POINTE:

SAMPLER STARTED:  
DÉBUT D'ÉCHANTILLON:

POINT STOPPED:  
ARRÊT DE POINTE:

SAMPLER STOPPED:  
ARRÊT D'ÉCHANTILLON:

POINT EXTRACTED:  
EXTRACTION DE POINTE:

SAMPLE EXTRACTED:  
EXTRACTION D'ÉCHANTILLON:

FOOTAGE PROFONDEUR		OVERBURDEN DESCRIPTION DESCRIPTION DU MORT TERRAIN	SAMPLE DESCRIPTION ÉCHANTILLON
FROM DE	TO À		
	<b>0</b>	<b>OUT CROC</b>	ORGANIC ORGANIQUE %
			CLAY ARGILE %
			SILT SILTE %
			FINE SAND SABLE FIN %
			MEDIUM SAND SABLE MED. %
			COARSE SAND SABLE GROS %
			GRAVEL GRAVIER %
			PEBBLES CAILLOUX %

REMARKS:  
REMARQUES:



R. Cormier & Associés Liée  
Associates Ltd.

2050, Thibault,  
Bécancour, Qué.  
Canada, G0X 1B0  
Tél. - (819) 294-9939

OVERBURDEN DRILLING LOG  
JOURNAL DE FORAGE MORT TERRAIN

SAMPLE No./No D'ÉCHANTILLON: 450125	DRILL No./No DU TROU: 125	DATE: 16-07-85
SAMPLE DEPTH./PROF.D'ÉCHANT: 4.4	SAMPLERS./SONDEURS: RL EL	CONTRACT./CONTRAT: LAC MINERAL
LINE./LIGNE: 8 E	STATION: 5750-S	LOCATION./LOCALITÉ: E-S

DRILLING TIME - FEUILLE DE TEMPS

POINT STARTED:  
DÉBUT DE POINTE:

SAMPLER STARTED:  
DÉBUT D'ÉCHANTILLON:

POINT STOPPED:  
ARRÊT DE POINTE:

SAMPLER STOPPED:  
ARRÊT D'ÉCHANTILLON:

POINT EXTRACTED:  
EXTRACTION DE POINTE:

SAMPLE EXTRACTED:  
EXTRACTION D'ÉCHANTILLON:

FOOTAGE PROFONDEUR		OVERBURDEN DESCRIPTION DESCRIPTION DU MORT TERRAIN	SAMPLE DESCRIPTION ÉCHANTILLON
FROM DE	TO A		
0	0.2	ORGANIC	ORGANIC ORGANIQUE %
0.2	0.4	COARSE SAND	CLAY ARGILE %
0.4	0.42	BOL DEUR	SILT SILTE %
0.42	0.44	BASAL TILL	FINE SAND SABLE FIN %
0.44	0.44	BED ROCK	MEDIUM SAND SABLE MED. %
			COARSE SAND SABLE GROS %
			GRAVEL GRAVIER %
			PEBBLES CAILLOUX %

REMARKS:  
REMARQUES:



R. Cormier & Associés Liée  
Associates Ltd.

2050, Thibault,  
Bécancour, Qué.  
Canada, G0X 1B0  
Tél. - (819) 294-9939

OVERBURDEN DRILLING LOG  
JOURNAL DE FORAGE MORT TERRAIN

SAMPLE No./No D'ÉCHANTILLON: 450126	DRILL No./No DU TROU: 126	DATE: 16-07-85
SAMPLE DEPTH./PROF.D'ÉCHANT: 7 M	SAMPLERS./SONDEURS: RL-R.G	CONTRACT./CONTRAT: LAC MINERAL
LINE./LIGNE: 8 E	STATION: 5775-S	LOCATION./LOCALITÉ: F-S

DRILLING TIME - FEUILLE DE TEMPS

POINT STARTED:  
DÉBUT DE POINTE:

SAMPLER STARTED:  
DÉBUT D'ÉCHANTILLON:

POINT STOPPED:  
ARRÊT DE POINTE:

SAMPLER STOPPED:  
ARRÊT D'ÉCHANTILLON:

POINT EXTRACTED:  
EXTRACTION DE POINTE:

SAMPLE EXTRACTED:  
EXTRACTION D'ÉCHANTILLON:

FOOTAGE PROFONDEUR		OVERBURDEN DESCRIPTION DESCRIPTION DU MORT TERRAIN	SAMPLE DESCRIPTION ÉCHANTILLON
FROM DE	TO A		
0	0.2	ORGANIC	ORGANIC ORGANIQUE %
0.2	0.4	FINE SAND	CLAY ARGILE %
0.4	0.6	COARSE SAND	SILT SILTE %
0.6	0.68	BOL DEUR	FINE SAND SABLE FIN %
0.68	0.7	BASAL TILL	MEDIUM SAND SABLE MED. %
	0.7	BED ROCK	COARSE SAND SABLE GROS %
			GRAVEL GRAVIER %
			PEBBLES CAILLOUX %
		2 T RAIL	

REMARKS:  
REMARQUES:



R. Cormier & Associés Ltée  
Associates Ltd.

2050, Thibault,  
Bécancour, Qué.  
Canada: G0X 1B0  
Tél. - (819) 294-9939

OVERBURDEN DRILLING LOG  
JOURNAL DE FORAGE MORT TERRAIN

SAMPLE No./No D'ÉCHANTILLON: <b>LE50127</b>	DRILL No./No DU TROU: <b>127</b>	DATE: <b>16-07-85</b>
SAMPLE DEPTH./PROF.D'ÉCHANT: <b>9 M</b>	SAMPLERS./SONDEURS: <b>RL-RG</b>	CONTRACT./CONTRAT: <b>LAL MINERAL</b>
LINE./LIGNE: <b>8 E</b>	STATION: <b>6700 S</b>	LOCATION./LOCALITÉ: <b>F-S</b>

DRILLING TIME - FEUILLE DE TEMPS

POINT STARTED:  
DÉBUT DE POINTE:

POINT STOPPED:  
ARRÊT DE POINTE:

POINT EXTRACTED:  
EXTRACTION DE POINTE:

SAMPLER STARTED:  
DÉBUT D'ÉCHANTILLON:

SAMPLER STOPPED:  
ARRÊT D'ÉCHANTILLON:

SAMPLE EXTRACTED:  
EXTRACTION D'ÉCHANTILLON:

FOOTAGE PROFONDEUR		OVERBURDEN DESCRIPTION DESCRIPTION DU MORT TERRAIN	SAMPLE DESCRIPTION ÉCHANTILLON
FROM DE	TO A		
0	2	ORGANIC	ORGANIC ORGANIQUE %
2	4	FINE SAND	CLAY ARGILE %
4	6	COARSE SAND	SILT SILTE %
6	8.8	GRAVEL	FINE SAND SABLE FIN %
8.8	9	BASAL TILL	MEDIUM SAND SABLE MED. %
	9	BED ROCK	COARSE SAND SABLE GROS %
			GRAVEL GRAVIER %
			PEBBLES CAILLOUX %

REMARKS:  
REMARQUES:



R. Cormier & Associés Ltée  
Associates Ltd.

2050, Thibault,  
Bécancour, Qué.  
Canada: G0X 1B0  
Tél. - (819) 294-9939

OVERBURDEN DRILLING LOG  
JOURNAL DE FORAGE MORT TERRAIN

SAMPLE No./No D'ÉCHANTILLON: <b>LE50128</b>	DRILL No./No DU TROU: <b>128</b>	DATE: <b>17-07-85</b>
SAMPLE DEPTH./PROF.D'ÉCHANT: <b>16 M</b>	SAMPLERS./SONDEURS: <b>RL-RG</b>	CONTRACT./CONTRAT: <b>LAL MINERAL</b>
LINE./LIGNE: <b>8 E</b>	STATION: <b>6725-S</b>	LOCATION./LOCALITÉ: <b>E-S</b>

DRILLING TIME - FEUILLE DE TEMPS

POINT STARTED:  
DÉBUT DE POINTE:

POINT STOPPED:  
ARRÊT DE POINTE:

POINT EXTRACTED:  
EXTRACTION DE POINTE:

SAMPLER STARTED:  
DÉBUT D'ÉCHANTILLON:

SAMPLER STOPPED:  
ARRÊT D'ÉCHANTILLON:

SAMPLE EXTRACTED:  
EXTRACTION D'ÉCHANTILLON:

FOOTAGE PROFONDEUR		OVERBURDEN DESCRIPTION DESCRIPTION DU MORT TERRAIN	SAMPLE DESCRIPTION ÉCHANTILLON
FROM DE	TO A		
0	2	ORGANIC	ORGANIC ORGANIQUE %
2	6	COARSE SAND	CLAY ARGILE %
6	12	GRAVEL	SILT SILTE %
12	12.4	BOL D'EUR	FINE SAND SABLE FIN %
12.4	15.8	COARSE SAND	MEDIUM SAND SABLE MED. %
15.8	16	BASAL TILL	COARSE SAND SABLE GROS %
	16	BED ROCK	GRAVEL GRAVIER %
			PEBBLES CAILLOUX %

REMARKS:  
REMARQUES:



R. Cormier & Associés Ltée  
Associates Ltd.

2050, Thibault,  
Bécanour, Qué.  
Canada, G0X 1B0  
Tél. - (819) 294-9939

OVERBURDEN DRILLING LOG  
JOURNAL DE FORAGE MORT TERRAIN

SAMPLE No./No D'ÉCHANTILLON: LE50 129	DRILL No./No DU TROU: 129	DATE: 17-07-85
SAMPLE DEPTH./PROF.D'ÉCHANT: 22.2	SAMPLERS./SONDEURS: RL RG	CONTRACT./CONTRAT: LAC MINERAL
LINE./LIGNE: 8E	STATION: 67375-S	LOCATION./LOCALITÉ: F-S

DRILLING TIME - FEUILLE DE TEMPS

POINT STARTED:  
DÉBUT DE POINTE:

SAMPLER STARTED:  
DÉBUT D'ÉCHANTILLON:

POINT STOPPED:  
ARRÊT DE POINTE:

SAMPLER STOPPED:  
ARRÊT D'ÉCHANTILLON:

POINT EXTRACTED:  
EXTRACTION DE POINTE:

SAMPLE EXTRACTED:  
EXTRACTION D'ÉCHANTILLON:

FOOTAGE PROFONDEUR		OVERBURDEN DESCRIPTION DESCRIPTION DU MORT TERRAIN	SAMPLE DESCRIPTION ÉCHANTILLON
FROM DE	TO A		
0	2	ORGANIC	ORGANIC ORGANIQUE %
2	14	CLAY	CLAY ARGILE %
14	20	FINE SAND	SILT SILTE %
20	22	BOL DEUR	FINE SAND SABLE FIN %
22	22.2	BASAL TILL	MEDUM SAND SABLE MED. %
	22.2	BED ROCK	COARSE SAND SABLE GROS %
			GRAVEL GRAVIER %
			PEBBLES CAILLOUX %

REMARKS:  
REMARQUES:



R. Cormier & Associés Ltée  
Associates Ltd.

2050 Thibault,  
Bécanour, Qué.  
Canada, G0X 1B0  
Tél. - (819) 294-9939

OVERBURDEN DRILLING LOG  
JOURNAL DE FORAGE MORT TERRAIN

SAMPLE No./No D'ÉCHANTILLON: LE50 130	DRILL No./No DU TROU: 130	DATE: 18-07-85
SAMPLE DEPTH./PROF.D'ÉCHANT: 27.4	SAMPLERS./SONDEURS: RL RG	CONTRACT./CONTRAT: LAC MINERAL
LINE./LIGNE: 8E	STATION: 6750-S	LOCATION./LOCALITÉ: F-S

DRILLING TIME - FEUILLE DE TEMPS

POINT STARTED:  
DÉBUT DE POINTE:

SAMPLER STARTED:  
DÉBUT D'ÉCHANTILLON:

POINT STOPPED:  
ARRÊT DE POINTE:

SAMPLER STOPPED:  
ARRÊT D'ÉCHANTILLON:

POINT EXTRACTED:  
EXTRACTION DE POINTE:

SAMPLE EXTRACTED:  
EXTRACTION D'ÉCHANTILLON:

FOOTAGE PROFONDEUR		OVERBURDEN DESCRIPTION DESCRIPTION DU MORT TERRAIN	SAMPLE DESCRIPTION ÉCHANTILLON
FROM DE	TO A		
0	2	ORGANIC	ORGANIC ORGANIQUE %
2	12	CLAY	CLAY ARGILE %
12	18	FINE SAND	SILT SILTE %
18	22	COURSE SAND	FINE SAND SABLE FIN %
22	24	BOL DEUR	MEDUM SAND SABLE MED. %
24	26.8	COURSE SAND	COARSE SAND SABLE GROS %
26.8	27	BASAL TILL	GRAVEL GRAVIER %
	27	BED ROCK	PEBBLES CAILLOUX %

REMARKS:  
REMARQUES:

**roa**R. Cormier & Associés Ltée  
Associates Ltd.2050, Thibault,  
Bécancour, Qué.  
Canada, G0X 1B0  
Tél. - (819) 294-9939OVERBURDEN DRILLING LOG  
JOURNAL DE FORAGE MORT TERRAIN

SAMPLE No./No D'ÉCHANTILLON: LE50131	DRILL No./No DU TROU: 131	DATE: 24-07-85
SAMPLE DEPTH./PROF.D'ÉCHANT: 28	SAMPLERS./SONDEURS: RL-RG	CONTRACT./CONTRAT: LAC MINÉRAL
LINE./LIGNE: L8E	STATION: G767-5-S	LOCATION./LOCALITÉ: F-S

## DRILLING TIME - FEUILLE DE TEMPS

POINT STARTED:  
DÉBUT DE POINTE:SAMPLER STARTED:  
DÉBUT D'ÉCHANTILLON:POINT STOPPED:  
ARRÊT DE POINTE:SAMPLER STOPPED:  
ARRÊT D'ÉCHANTILLON:POINT EXTRACTED:  
EXTRACTION DE POINTE:SAMPLE EXTRACTED:  
EXTRACTION D'ÉCHANTILLON:

FOOTAGE PROFONDEUR		OVERBURDEN DESCRIPTION DESCRIPTION DU MORT TERRAIN	SAMPLE DESCRIPTION ÉCHANTILLON
FROM DE	TO À		
0	12	ORGANIC	ORGANIC ORGANIQUE %
2	12	CLAY	CLAY ARGILE %
12	18	FINE SAND	SILT SILTE %
18	20	CORSE SAND	FINE SAND SABLE FIN %
20	26	GRAVEL	MEDIUM SAND SABLE MED. %
26	27'8	BOL DEUR	COARSE SAND SABLE GROS %
27'8	28	BASAL TILL	GRAVEL GRAVIER %
	28	BED ROCK	PEBBLES CAILLOUX %

REMARKS:  
REMARQUES:**rca**R. Cormier & Associés Ltée  
Associates Ltd.2050 Thibault,  
Bécancour, Qué.  
Canada, G0X 1B0  
Tél. - (819) 294-9939OVERBURDEN DRILLING LOG  
JOURNAL DE FORAGE MORT TERRAIN

SAMPLE No./No D'ÉCHANTILLON: LE50132	DRILL No./No DU TROU: 132	DATE: 24-07-85
SAMPLE DEPTH./PROF.D'ÉCHANT: 30 M	SAMPLERS./SONDEURS: RL-RG	CONTRACT./CONTRAT: LAC MINÉRAL
LINE./LIGNE: L8E	STATION: G775-S	LOCATION./LOCALITÉ: F-S

## DRILLING TIME - FEUILLE DE TEMPS

POINT STARTED:  
DÉBUT DE POINTE:SAMPLER STARTED:  
DÉBUT D'ÉCHANTILLON:POINT STOPPED:  
ARRÊT DE POINTE:SAMPLER STOPPED:  
ARRÊT D'ÉCHANTILLON:POINT EXTRACTED:  
EXTRACTION DE POINTE:SAMPLE EXTRACTED:  
EXTRACTION D'ÉCHANTILLON:

FOOTAGE PROFONDEUR		OVERBURDEN DESCRIPTION DESCRIPTION DU MORT TERRAIN	SAMPLE DESCRIPTION ÉCHANTILLON
FROM DE	TO À		
0	2	ORGANIC	ORGANIC ORGANIQUE %
2	10	CLAY	CLAY ARGILE %
10	16	FINE SAND	SILT SILTE %
16	20	CORSE SAND	FINE SAND SABLE FIN %
20	26	GRAVEL	MEDIUM SAND SABLE MED. %
26	27	BOL DEUR	COARSE SAND SABLE GROS %
27	28	CORSE SAND	GRAVEL GRAVIER %
28	28'8	BOL DEUR	PEBBLES CAILLOUX %
28'8	30	BASAL TILL	
	30	BED ROCK	

REMARKS:  
REMARQUES:



R. Cormier & Associés Ltée  
Associates Ltd.

2050, Thibault,  
Bécancour, Qué.  
Canada, G0X 1B0  
Tél. - (819) 294-9939

OVERBURDEN DRILLING LOG  
JOURNAL DE FORAGE MORT TERRAIN

SAMPLE No./No D'ÉCHANTILLON: L550133	DRILL No./No DU TROU: 133	DATE: 25-07-85
SAMPLE DEPTH./PROF D'ÉCHANT: 27	SAMPLERS./SONDEURS: RL RG	CONTRACT./CONTRAT: LACHMINERAL
LINE./LIGNE: L'8E	STATION: 7+002-S	LOCATION./LOCALITÉ: F-S

DRILLING TIME - FEUILLE DE TEMPS

POINT STARTED:  
DÉBUT DE POINTE:

SAMPLER STARTED:  
DÉBUT D'ÉCHANTILLON:

POINT STOPPED:  
ARRÊT DE POINTE:

SAMPLER STOPPED:  
ARRÊT D'ÉCHANTILLON:

POINT EXTRACTED:  
EXTRACTION DE POINTE:

SAMPLE EXTRACTED:  
EXTRACTION D'ÉCHANTILLON:

FOOTAGE PROFONDEUR		OVERBURDEN DESCRIPTION DESCRIPTION DU MORT TERRAIN	SAMPLE DESCRIPTION ÉCHANTILLON
FROM DE	TO À		
0	12	ORGANIC	ORGANIC ORGANIQUE %
.2	14	CLAY	CLAY ARGILE %
14	20	FINE SAND	SILT SILTE %
20	25	COARSE SAND	FINE SAND SABLE FIN %
25	26	BOL DEUR	MEDIUM SAND SABLE MED. %
26	26'8	BOL DEUR	COARSE SAND SABLE GROS %
26'8	27M	BASAL TILL	GRAVEL GRAVIER %
	27M	RED ROCK	PEBBLES CAILLOUX %

REMARKS:  
REMARQUES:



R. Cormier & Associés Ltée  
Associates Ltd.

2050, Thibault,  
Bécancour, Qué.  
Canada, G0X 1B0  
Tél. - (819) 294-9939

OVERBURDEN DRILLING LOG  
JOURNAL DE FORAGE MORT TERRAIN

SAMPLE No./No D'ÉCHANTILLON: L550134	DRILL No./No DU TROU: 134	DATE: 25-07-85
SAMPLE DEPTH./PROF D'ÉCHANT: 27M	SAMPLERS./SONDEURS: RL-RG	CONTRACT./CONTRAT: LACHMINERAL
LINE./LIGNE: L'8E	STATION: 7+002-S	LOCATION./LOCALITÉ: F-S

DRILLING TIME - FEUILLE DE TEMPS

POINT STARTED:  
DÉBUT DE POINTE:

SAMPLER STARTED:  
DÉBUT D'ÉCHANTILLON:

POINT STOPPED:  
ARRÊT DE POINTE:

SAMPLER STOPPED:  
ARRÊT D'ÉCHANTILLON:

POINT EXTRACTED:  
EXTRACTION DE POINTE:

SAMPLE EXTRACTED:  
EXTRACTION D'ÉCHANTILLON:

FOOTAGE PROFONDEUR		OVERBURDEN DESCRIPTION DESCRIPTION DU MORT TERRAIN	SAMPLE DESCRIPTION ÉCHANTILLON
FROM DE	TO À		
0	12	ORGANIC	ORGANIC ORGANIQUE %
.2	12	CLAY	CLAY ARGILE %
12	18	FINE SAND	SILT SILTE %
18	24	COARSE SAND	FINE SAND SABLE FIN %
24	25	BOL DEUR	MEDIUM SAND SABLE MED. %
25	26'8	COARSE SAND	COARSE SAND SABLE GROS %
26'8	27	BASAL TILL	GRAVEL GRAVIER %
	27	RED ROCK	PEBBLES CAILLOUX %

REMARKS:  
REMARQUES:

APPENDIX II

Mineral Identifications of the Heavy Mineral  
Separates of the -5 to +250 Size Fraction



LAC MINERALS: Heavy Mineral Identifications Sept 13/85

MINERAL	SAMPLE NUMBERS FALLON SOUTH			
	5080	5081	5082	5083
AMPHIBOLE	5	5	13	10
ANATASE				
ANDALUSITE				
APATITE	tr			
ARSENOPYRITE				
BARITE				
BIOTITE				
CARBONATE				
CHALCOPYRITE				
CHLORITE				
CHROMITE	tr			
CASSITERITE				
DOLOMITE				
EPIDOTE	20	10	20	14
FLUORITE				
GARNET Pink	25	25	20	20
GARNET Red-br	tr	tr		tr-1
GARNET P		tr?		
GARNET Yellow	tr			
GARNET O				
GOE-LIM				
GOLD	tr (S)		tr (P)	tr (P)(S)
HEMATITE	5	5	4	tr
ILMENITE				tr
KYANITE	tr		tr	tr
LEUCOXENE				16
MAGNETITE	15	20	16	
MONAZITE				
MUSCOVITE				
OLIVINE	tr	tr	tr	tr
PYRITE	30	35	25	35
PYROXENE				
PYRRHOTITE				
QUARTZ				
RUTILE				
SCHEELITE				
SERICITE				
SERPENTINITE				
SILLIMANITE				
SPHENE	tr	tr		
SPINEL				
TOURMALINE				
TOPAZ	tr	tr	tr	tr
ZIRCON				

REMARKS:

5081 - garnets are mostly light - dark pink however 1 grain (1mm<sup>2</sup>) looks purple with black metallic inclusions

5081 - most pyrite coarse grained - subhedral.

5083 - brown, green and black pyroxene - m/c.g.

MINERAL	SAMPLE NUMBERS				
	5LE 5084	5085	5086	5087	5088
AMPHIBOLE	10	10		10	
ANATASE					
ANDALUSITE					
APATITE	h	h			
ARSENOPYRITE					
BARITE					
BIOTITE					
CARBONATE					
CHALCOPYRITE					
CHLORITE	h	h		h	
CHROMITE					
CASSITERITE					
DOLOMITE					
EPIDOTE	10	10		20	
FLUORITE					
GARNET Pink	20	20		25	
GARNET Red		h			
GARNET P					
GARNET Yellow		h-1			
GARNET O				h	
GOE-LIM					
GOLD					
HEMATITE	h (R)	17 (S)		h (R+S)	
ILMENITE	5	5		5	
KYANITE					
LEUCOXENE	h	h			
MAGNETITE	25	13		5	
MONAZITE					
MUSCOVITE					
OLIVINE					
PYRITE	h	h		h	
PYROXENE	30	25		35	
PYRRHOTITE					
QUARTZ					
RUTILE					
SCHEELITE					
SERICITE					
SERPENTINITE					
SILLIMANITE					
SPHENE	h	h			
SPINEL					
TOURMALINE					
TOPAZ					
ZIRCON	h	h		h	

OUT C R P A

OUT C R O P

REMARKS: 5084 - several fragments of magnetite aggregated with feldspar  
 5085 - coarse fragments of specular hematite

MINERAL	SAMPLE NUMBERS				
	5LE 5089	5090	5091 2-3	5092 2-3	5093 2-3
AMPHIBOLE					
ANATASE					
ANDALUSITE					
APATITE			tr	tr	tr
ARSENOPYRITE				tr	
BARITE					
BIOTITE					
CARBONATE	o	o			
CHALCOPYRITE	c	c			
CHLORITE					tr
CHROMITE	A	T			
CASSITERITE					
DOLOMITE	c	c			
EPIDOTE			20	10	5
FLUORITE	P	P			
GARNET Pink			15	5	5
GARNET Red	o	o			tr
GARNET Purple			tr	tr	tr
GARNET Yellow	P	P			
GARNET O				tr	tr
GOE-LIM					
GOLD					
HEMATITE			tr (R) 2-3	tr (S) 2-3	tr (S) 2-3
ILMENITE				tr	
KYANITE				tr	
LEUCOXENE					
MAGNETITE			20	70	70
MONAZITE					
MUSCOVITE					
OLIVINE					
PYRITE			25	tr-1	tr
PYROXENE			15 tr.	10	15
PYRRHOTITE					
QUARTZ					
RUTILE					
SCHEELITE					
SERICITE					
SERPENTINITE					
SILLIMANITE					
SPHENE					
SPINEL					
TOURMALINE					
TOPAZ					
ZIRCON			tr	tr	tr

REMARKS: 5091- magnetite is platy, pyrite is aggregated w intermed.  
 vcc. - 1 dark purple garnet 0.3mm dia  
 5092: Magnetite is platy, 1 purple garnet 1mm dia and leucoblastic grain 0.5mm dia  
 5093: most magnetite is platy

MINERAL.	SAMPLE NUMBERS				
	5094	5095	5096	5097	5098
AMPHIBOLE	10	10	15	15	15
ANATASE					
ANDALUSITE					
APATITE	tr	tr	tr	tr	tr
ARSENOPYRITE					
BARITE	tr	tr	tr-1	tr	tr
BIOTITE					
CARBONATE					
CHALCOPYRITE					
CHLORITE					
CHROMITE			tr		tr
CASSITERITE					
DOLOMITE					
EPIDOTE	10	10	10	15	15
FLUORITE					
GARNET Pink	20	20	20	20	20
GARNET Red					tr
GARNET P					
GARNET Y					
GARNET O					tr
GOE-LIM			tr		tr
GOLD					
HEMATITE			tr (sp)	tr (sp)	tr (R)
ILMENITE	5	5	5	5	5
KYANITE					
LEUCOXENE		tr		tr	tr
MAGNETITE	25	25	20	15	15
MONAZITE					
MUSCOVITE					
OLIVINE					
PYRITE	tr	tr	tr	tr	tr
PYROXENE	30	30	30	30	30
PYRRHOTITE					tr
QUARTZ					
RUTILE					
SCHEELITE					
SERICITE					
SERPENTINITE					
SILLIMANITE					
SPHENE		tr			
SPINEL					
TOURMALINE					
TOPAZ					
ZIRCON	tr	tr	tr	tr	tr

REMARKS: 5095: magnetite is platy; 5096 - 5097: mag. is tramp iron.

MINERAL	SAMPLE NUMBERS				
	5LE 5099	5100*	5101	5102	5103
AMPHIBOLE	15	5	5	10	10
ANATASE					
ANDALUSITE					
APATITE	tr	tr	tr	tr	tr
ARSENOPYRITE					
BARITE	tr	tr	tr		tr
BIOTITE					
CARBONATE		tr			tr
CHALCOPYRITE					
CHLORITE					
CHROMITE				tr	
CASSITERITE					
DOLOMITE					
EPIDOTE	10	10	10	10	15
FLUORITE					
GARNET Pink	20	15	20	20	25
GARNET Red	tr	tr	tr	tr	tr
GARNET P					
GARNET Y					
<del>GARNET</del> GALENA		25			tr
GOE-LIM	tr				tr
GOLD					
HEMATITE			5 (s)		
ILMENITE	10	5	15	5	5
KYANITE					
LEUCOXENE	tr				
MAGNETITE	15	10	25	20	15
MONAZITE					
MUSCOVITE					
OLIVINE					
PYRITE	tr	tr	tr	tr	tr
PYROXENE	30	30	30	35	30
PYRRHOTITE					
QUARTZ					
RUTILE					
SCHEELITE					
SERICITE					
SERPENTINITE					
SILLIMANITE					
SPHENE	tr	tr	tr		
SPINEL					
TOURMALINE					
TOPAZ					
ZIRCON	tr	tr	tr	tr	tr

REMARKS: 5100: 25% galena - mostly e.g. euhedral grains some agg w white carb (calcite) - probably from vein-type mineralization  
 5103: 2 carb. grains in galena (?)

MINERAL	SAMPLE NUMBERS				
	SLE 5104	5105	5106	5107	5108
AMPHIBOLE	10	10	10	5	10
ANATASE					
ANDALUSITE					
APATITE	tr	tr	tr	tr	tr
ARSENOPYRITE					tr
BARITE					tr
BIOTITE					
CARBONATE					
CHALCOPYRITE					
CHLORITE					
CHROMITE	tr	tr(?)	tr		
CASSITERITE					
DOLOMITE					
EPIDOTE	10	10	10	10	10
FLUORITE					
GARNET Pink	25	25	30	20	20
GARNET Red	tr				tr
GARNET P					
GARNET Yellow	tr	tr-1			
GARNET O					
GOE-LIM			tr	tr	
GOLD					
HEMATITE	tr-1 (s)		tr (r)		
ILMENITE	5	5	10	5	5
KYANITE					
LEUCOXENE	tr			tr	
MAGNETITE	15	20	15	25	25
MONAZITE					
MUSCOVITE					
OLIVINE					
OPYRITE	tr	tr	tr	tr	tr
PYROXENE	35	30	25	35	30
PYRRHOTITE					
QUARTZ					
RUTILE					
SCHEELITE					
SERICITE					
SERPENTINITE					
SILLIMANITE					
SPHENE				tr	
SPINEL					
TOURMALINE					
TOPAZ					
ZIRCON	tr	tr	tr	tr	tr

REMARKS: 5104 - 5% mag is tramp metal; 5105 - 2-3% mag. is tramp metal.  
 5106 - 1/2% mag. is tramp metal.; 5107 - 25% mag. is tramp metal.

MINERAL	SAMPLE NUMBERS				
	5LE 5109	5110	5111	5112	5113
AMPHIBOLE	10	5	25	1-2	6
ANATASE					
ANDALUSITE					
APATITE	tr	tr	tr	tr	tr
ARSENOPYRITE				tr	tr
BARITE					
BIOTITE					
CARBONATE					
CHALCOPYRITE					
CHLORITE	tr			tr	tr
CHROMITE	tr			tr	
CASSITERITE					
DOLOMITE					
EPIDOTE	10	10	10	2-3	6
FLUORITE					
GARNET Pink	20	15	20	7	18
GARNET Red		tr	tr	tr	3
GARNET P					
GARNET Y					
GARNET O					
GOE-LIM	tr	tr			
GOLD					
HEMATITE		5 (s)			
ILMENITE	5	5	5	1	3
KYANITE					
LEUCOXENE					
MAGNETITE	15	20	20	78	40
MONAZITE					
MUSCOVITE					
OLIVINE					
PYRITE	tr	tr	tr	tr	tr
PYROXENE	40	40	20	10	24
PYRRHOTITE					
QUARTZ					
RUTILE					
SCHEELITE					
SERICITE					
SERPENTINITE					
SILLIMANITE					
SPIHENE		tr			
SPINEL					
TOURMALINE					
TOPAZ					
ZIRCON	tr	tr	tr	tr	tr

REMARKS: 5109: mag. fraction ~60% but 75% of this is tramp metal; most removed from sample.  
 5111: 10% of mag. fraction is tramp metal - removed from sample  
 5112: } mag. is platy, dull black medium grained frag  
 5113: }

MINERAL	SAMPLE NUMBERS				
	5114	5115	5116	5117	5118
AMPHIBOLE	5	5	15	10	6
ANATASE					
ANDALUSITE	h		h	h	h
APATITE	h		h	h	h
ARSENOPYRITE	h				
BARITE	h				
BIOTITE			h		
CARBONATE			h		
CHALCOPYRITE					
CHLORITE				h	
CHROMITE				h	
CASSITERITE					
DOLOMITE					
EPIDOTE	5	5	10	10	4
FLUORITE					
GARNET Fink	15	20	20	15	8
GARNET Red	h-1	h+	h+	h+	h
GARNET P					
GARNET Y					
GARNET O					
GOE-LIM		h	h		
GOLD					
HEMATITE					
ILMENITE	3	3	5	5	2
KYANITE	h	h		h	
LEUCOXENE	h	h		h	
MAGNETITE	47	40	20	40	60
MONAZITE					
MUSCOVITE					
OLIVINE					
PYRITE	h	h	h+	h	h
PYROXENE	25	27	30	20	30
PYRRHOTITE					
QUARTZ					
RUTILE					
SCHEELITE					
SERICITE					
SERPENTINITE					
SILLIMANITE					
SPHENE					
SPINEL					
TOURMALINE					
TOPAZ					
ZIRCON	h	h	h	h	h

REMARKS: 5114 - mag. is platy  
5115 - v. small sample, mag. is platy  
5117 - mag. is platy  
5118 - " " " "



MINERAL.	SAMPLE NUMBERS		
	51E 5119	5120	5121
AMPHIBOLE	20	2-3	
ANATASE			
ANDALUSITE			
APATITE	t	t	
ARSENOPYRITE			
BARITE	t-		
BIOTITE			
CARBONATE			
CHALCOPYRITE			
CHLORITE			
CHROMITE			
CASSITERITE			
DOLOMITE			
EPIDOTE	10	5	t
FLUORITE			
GARNET Pink	20	2r3	t-1
GARNET Red	t	t	
GARNET P			
GARNET Y			
GARNET O			
GOE-LIM			
GOLD			
HEMATITE			
ILMENITE	5	t-1	t-1
KYANITE			
LEUCOXENE			
MAGNETITE	15	40	35
MONAZITE			
MUSCOVITE			
OLIVINE			
PYRITE		t	t
PYROXENE	30	50	65
PYRRHOTITE			
QUARTZ			
RUTILE			
SCHEELITE			
SERICITE			
SERPENTINITE			
SILLIMANITE			
SPIHENE			
SPINEL			
TOURMALINE			
TOPAZ			
ZIRCON	t		

REMARKS: 5119 - V. small sample, mag is platy  
5120 - most magnetite aggr. w pyroxene  
5121 - mag (30% of it) is platy, some aggr. w pyroxene.

MINERAL.	SAMPLE NUMBERS				
	5125	5126	5127	5128	5129
AMPHIBOLE	10	10	15	15	20
ANATASE					
ANDALUSITE	h	h	h	h	h
APATITE					
ARSENOPYRITE					
BARITE					
BIOTITE					
CARBONATE					
CHALCOPYRITE					
CHLORITE					
CHROMITE					
CASSITERITE					
DOLOMITE				10	10
EPIDOTE	5	10	10	10	10
FLUORITE					10
GARNET Pink	10	10	10	10	10
GARNET Red	h	h	h	h	h
GARNET P					
GARNET Y					
GARNET O		h	h		h
GOE-LIM					
GOLD		h-1 (S)	h+		
HEMATITE		5	5	5	5
ILMENITE	5	5	5	5	5
KYANITE					
LEUCOXENE					
MAGNETITE	25	15	15	20	15
MONAZITE					
MUSCOVITE					
OLIVINE					
PYRITE	h	h	h	h	h
PYROXENE	4.5	50	45	40	40
PYRRHOTITE					
QUARTZ					
RUTILE					
SCHEELITE					
SERICITE					
SERPENTINITE					
SILLIMANITE					
SPHENE					
SPINEL					
TOURMALINE					
TOPAZ					
ZIRCON	h	h	h	h	h
REMARKS:	5128 - magnetite frequently, aggreg. w pyroxene.				

MINERAL	SAMPLE NUMBERS FALLON SOUTH				
	5130	5131	5132	5133	5134
AMPHIBOLE	20	15	15	15	10
ANATASE					
ANDALUSITE					
APATITE	tr	tr	tr	tr	
ARSENOPYRITE			tr		
BARITE					
BIOTITE					
CARBONATE					
CHALCOPYRITE					
CHLORITE			tr	tr	tr
CHROMITE					
CASSITERITE					
DOLOMITE					
EPIDOTE	10	10	10	10	10
FLUORITE					
GARNET Pink	15	15	15	15	15
GARNET Red	tr	tr	tr	tr	
GARNET P					
GARNET Y					
GARNET O					tr
GOE-LIM	tr	tr			tr
GOLD					
HEMATITE					
ILMENITE	5	7	5	5	2
KYANITE					
LEUCOXENE					
MAGNETITE	20	18	20	20	15
MONAZITE					
MUSCOVITE					
OLIVINE					
PYRITE	tr	tr	tr	tr	tr
PYROXENE	30	35	35	35	48
PYRRHOTITE					
QUARTZ					
RUTILE					
SCHEELITE					
SERICITE					
SERPENTINITE					
SILLIMANITE					
SPHENE					
SPINEL					
TOURMALINE					
TOPAZ					
ZIRCON	tr	tr	tr	tr	tr

REMARKS:

APPENDIX III

Technical Data Statement



**SELF POTENTIAL**

Instrument \_\_\_\_\_ Range \_\_\_\_\_

Survey Method \_\_\_\_\_

Corrections made \_\_\_\_\_

**RADIOMETRIC**

Instrument \_\_\_\_\_

Values measured \_\_\_\_\_

Energy windows (levels) \_\_\_\_\_

Height of instrument \_\_\_\_\_ Background Count \_\_\_\_\_

Size of detector \_\_\_\_\_

Overburden \_\_\_\_\_  
(type, depth - include outcrop map)

**OTHERS (SEISMIC, DRILL WELL LOGGING ETC.)**

Type of survey \_\_\_\_\_ Basal Till Sampling Survey

Instrument \_\_\_\_\_ Pionjar Drill

Accuracy \_\_\_\_\_

Parameters measured \_\_\_\_\_ Clast lithology type, heavy grain mineral type, depth of overburden,  
and type of overburden.

Additional information (for understanding results) \_\_\_\_\_ The pionjar drill is a percussion drill which  
obtains a single overburden sample from along the bedrock overburden  
interface.

**AIRBORNE SURVEYS**

Type of survey(s) \_\_\_\_\_

Instrument(s) \_\_\_\_\_  
(specify for each type of survey)

Accuracy \_\_\_\_\_  
(specify for each type of survey)

Aircraft used \_\_\_\_\_

Sensor altitude \_\_\_\_\_

Navigation and flight path recovery method \_\_\_\_\_

Aircraft altitude \_\_\_\_\_ Line Spacing \_\_\_\_\_

Miles flown over total area \_\_\_\_\_ Over claims only \_\_\_\_\_

GEOCHEMICAL SURVEY - PROCEDURE RECORD

Numbers of claims from which samples taken Seven (7) P 661734, P 654193, P 663467, P 663468, P 663469, P 663470, and P 741732.

Total Number of Samples 55

Type of Sample Basal Till  
(Nature of Material)

Average Sample Weight 190.21

Method of Collection Pionjar Percussion  
Drill

Soil Horizon Sampled Till Horizon adjacent to bed- Others \_\_\_\_\_  
Horizon Development Moderate rock

Sample Depth Avr. 10.2 meters

Terrain Predominantly glaciolacustrine  
silt and clay.

Drainage Development Poor

Estimated Range of Overburden Thickness \_\_\_\_\_  
0.0 to 30.0 meters

**SAMPLE PREPARATION**

(Includes drying, screening, crushing, ashing)

Mesh size of fraction used for analysis \_\_\_\_\_  
+5 mesh and -5 to +250 mesh (greater than  
3.2 gm/cm<sup>3</sup>)

General \_\_\_\_\_  
\_\_\_\_\_  
\_\_\_\_\_  
\_\_\_\_\_  
\_\_\_\_\_  
\_\_\_\_\_  
\_\_\_\_\_  
\_\_\_\_\_  
\_\_\_\_\_

**ANALYTICAL METHODS**

Values expressed in: per cent   
p. p. m.   
p. p. b.

Cu, Pb, Zn, Ni, Co, Ag, Mo, As, -(circle)

Field Analysis (\_\_\_\_\_ tests)

Extraction Method \_\_\_\_\_

Analytical Method \_\_\_\_\_

Reagents Used \_\_\_\_\_

Field Laboratory Analysis

No. (\_\_\_\_\_ tests)

Extraction Method \_\_\_\_\_

Analytical Method \_\_\_\_\_

Reagents Used \_\_\_\_\_

Commercial Laboratory (\_\_\_\_\_ tests)

Name of Laboratory \_\_\_\_\_

Extraction Method \_\_\_\_\_

Analytical Method \_\_\_\_\_

Reagents Used \_\_\_\_\_

General \_\_\_\_\_  
\_\_\_\_\_  
\_\_\_\_\_  
\_\_\_\_\_  
\_\_\_\_\_  
\_\_\_\_\_  
\_\_\_\_\_  
\_\_\_\_\_  
\_\_\_\_\_



Ministry of Natural Resources

Report of Work  
(Geophysical, Geological, Geochemical and Expenditures)

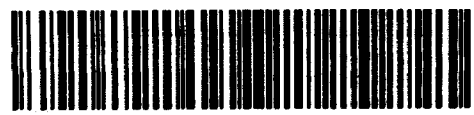

42A02NW0026 2.9079 FALLON

900

# 096/86

# C  
2.91  
Mining Act

- Do not use shaded areas below.

Type of Survey(s) <b>Basal Tilling Sampling</b>	Township or Area <b>Fallon Twp.</b>
Claim Holder(s) <b>David J. Meunier</b>	Prospector's Licence No. <b>M-17157</b>
Address <b>403 Dome St., S. Porcupine, Ontario.</b>	
Survey Company <b>R. Cormier and Assoc.</b>	Date of Survey (from & to) <b>12 06 25 15 07 85</b> Day Mo. Yr. Day Mo. Yr.
Name and Address of Author (of Geo-Technical report) <b>Paul Miller, 448 Eglinton Ave W, Toronto.</b>	

Credits Requested per Each Claim in Columns at right

Special Provisions	Geophysical	Days per Claim
For first survey: Enter 40 days. (This includes line cutting)	- Electromagnetic	
	- Magnetometer	
For each additional survey: using the same grid: Enter 20 days (for each)	- Radiometric	
	- Other	
	Geological	
	Geochemical	
Man Days Complete reverse side and enter total(s) here	Geophysical	Days per Claim
	- Electromagnetic	
	- Magnetometer	
	- Other	
	Geological	
	Geochemical	
Airborne Credits		Days per Claim
Note: Special provisions credits do not apply to Airborne Surveys.	Electromagnetic	
	Magnetometer	
	Radiometric	

Mining Claims Traversed (List in numerical sequence)

Mining Claim Prefix	Mining Claim Number	Expend. Days Cr.
P	783572	40
	573	40
	574	40
	792435	40
	436	40
	792531	40
	532	40
	533	40
	534	20
	535	40
	536	40
	537	40
	538	40
	792539	20
	520	

**RECEIVED**  
APR - 1 1986  
**MINING LANDS SECTION**

**RECORDED**  
MAR 20 1986

**RECEIVED**  
MAR 20 1986  
PORCUPINE MINING DIVISION

Expenditures (excludes power stripping) **Sec 17-19**

Type of Work Performed  
**(Basal Till Sampling) Survey**

Performed on Claim(s)  
**P-663467; 663470; 663910; 663907; 663468; 641734.**

Calculation of Expenditure Days Credits

Total Expenditures	Total Days Credits
<b>\$ 7,800</b>	<b>520</b>

Instructions  
Total Days Credits may be apportioned at the claim holder's choice. Enter number of days credits per claim selected in columns at right.

Total number of mining claims covered by this report of work. **14**

For Office Use Only

Total Days Cr. Recorded <b>520</b>	Date Recorded <b>Mar 20 / 86</b>	Mining Recorder <i>[Signature]</i>
	Date Approved as Recorded	Branch Director <i>[Signature]</i>

Date  
**March 14/86**

Recorded Holder or Agent (Signature)  
*[Signature]*

Certification Verifying Report of Work

I hereby certify that I have a personal and intimate knowledge of the facts set forth in the Report of Work annexed hereto, having performed the work or witnessed same during and/or after its completion and the annexed report is true.

Name and Postal Address of Person Certifying  
**Brian Madill, P.O. Box 833, Kirkland Lake, ONT**

**P2N 3K4**

Date Certified  
**March 14/86**

Certified by (Signature)  
*[Signature]*





91 Duncan Ave. South  
Kirkland Lake, Ontario  
P2N 1Y2  
(705) 567-5656

LAC

Lac Minerals Ltd.  
Exploration Division

April 29, 1986

Mr. Ray Pichette  
Land Management Branch  
Ministry of Natural Resources  
Room 6643, Whitney Block  
Queen's Park  
TORONTO, Ontario  
M7A 1W3

Dear Sir:

Enclosed please find duplicate reports covering a basal till survey performed in Fallon Township, Porcupine Mining Division. A Report of Work was filed previously with the Mining Recorder in Timmins, for assessment credits on Dave Meunier's claims in this Township.

I trust all is in order.

Sincerely,

Chris Pegg  
Office Manager

CP:ptm

cc: file

Enclosure

**RECEIVED**  
APR 30 1986  
**MINING LANDS SECTION**

August 15<sup>th</sup> 19 85

Received from  
Reçu de

Lac Minerals Exploration

— Seven thousand eight hundred — <sup>100</sup> Dollars

Overburden drilling "Fallon South"  
(between June 9<sup>th</sup> and July 15<sup>th</sup>)

\$ 7,800.<sup>00</sup>

Roch Cormier

FOR R. CORMIER + ASSOCIATES

RECEIVED

APR 30 1986

MINING LANDS SECTION

Mining Lands Section

File No 29079

Control Sheet

TYPE OF SURVEY     GEOPHYSICAL  
                           GEOLOGICAL  
                           GEOCHEMICAL  
                           EXPENDITURE

MINING LANDS COMMENTS:

---

---

---

---

---

---

---

---

---

---

J. Hurst

Signature of Assessor

May 2/60

Date

*log*

May 9, 1986

Your File: 96/86  
Our File: 2.9079

Mining Recorder  
Ministry of Northern Development and Mines  
60 Wilson Avenue  
Timmins, Ontario  
P4N 2S7

Dear Sir:

RE: Assaying submitted under Section 77(19) of  
the Mining Act R.S.O. 1980, on Mining Claims  
P 641734, et al, in Fallon Township

---

The enclosed statement of assessment work credits for  
assaying expenditures has been approved as of the above  
date.

Please inform the recorded holder of these mining claims  
and so indicate on your records.

Yours sincerely,

J.C. Smith, Supervisor  
Mining Lands Section

Whitney Block, 6th Floor  
Queen's Park  
Toronto, Ontario  
M7A 1W3

Telephone: (416) 965-4888

SH/mc

cc: David J. Meunier  
403 Dome Street  
South Porcupine, Ontario  
P0N 1H0

Brian Madill  
P.O. Box 833  
Kirkland Lake, Ontario  
P2N 3K4

Paul Miller  
448 Eglinton Avenue West  
Toronto, Ontario M5N 1A6

Resident Geologist  
Timmins, Ontario

Encl.



Recorded Holder  
**DAVID J. MEUNIER**

Township or Area  
**FALLON TOWNSHIP**

Type of survey and number of Assessment days credit per claim	Mining Claims Assessed
<b>Geophysical</b> Electromagnetic _____ days Magnetometer _____ days Radiometric _____ days Induced polarization _____ days Other _____ days Section 77 (19) See "Mining Claims Assessed" column Geological _____ days Geochemical _____ days Man days <input type="checkbox"/> Airborne <input type="checkbox"/> Special provision <input type="checkbox"/> Ground <input type="checkbox"/> <input type="checkbox"/> Credits have been reduced because of partial coverage of claims. <input type="checkbox"/> Credits have been reduced because of corrections to work dates and figures of applicant.	<p><b>\$7,800.00 SPENT ON BASAL TILL SURVEY AND ASSAYING SAMPLES TAKEN FROM MINING CLAIMS:</b></p> <p>P 641734            663467 to 470 inclusive            654193            6741732</p> <p><b>520 DAYS CREDIT ALLOWED WHICH MAY BE GROUPED IN ACCORDANCE WITH SECTION 76(6) OF THE MINING ACT R.S.O. 1980.</b></p>

**Special credits under section 77 (16) for the following mining claims**

**No credits have been allowed for the following mining claims**

not sufficiently covered by the survey                       insufficient technical data filed

The Mining Recorder may reduce the above credits if necessary in order that the total number of approved assessment days recorded on each claim does not exceed the maximum allowed as follows: Geophysical - 80; Geological - 40; Geochemical - 40; Section 77(19) - 60.

663470 ✓

69 w

641734 ✓

741732 ✓

663468 ✓

467 ✓

654193 ✓

# FALLON

## PORCUPINE MINING DIVISION DISTRICT OF TIMISKAMING

Scale - 40 Chans - 1 Inch

up to date as of:  
20/01 Dec 19/85

North Arrow

### LANGMUIR

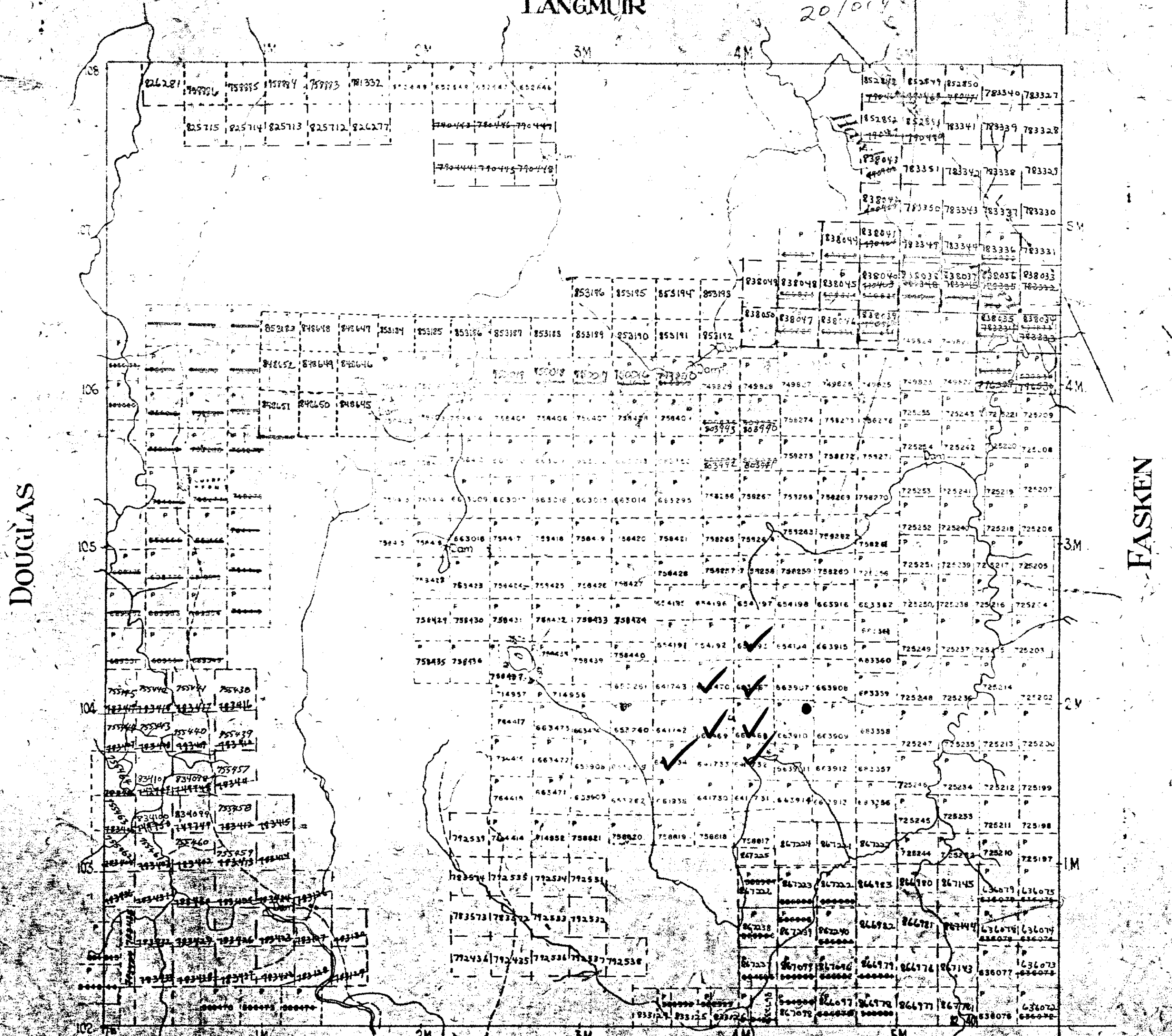

DOUGLAS

FASKEN

### LEGEND

CANCELLED  
PATENTED LAND  
CROWN LAND  
LEASERS  
LUGGERS

Loc  
Lo  
No  
Sta

### CLEAVER

400' Surface rights reservation around all lakes & rivers.

January 20, 1985



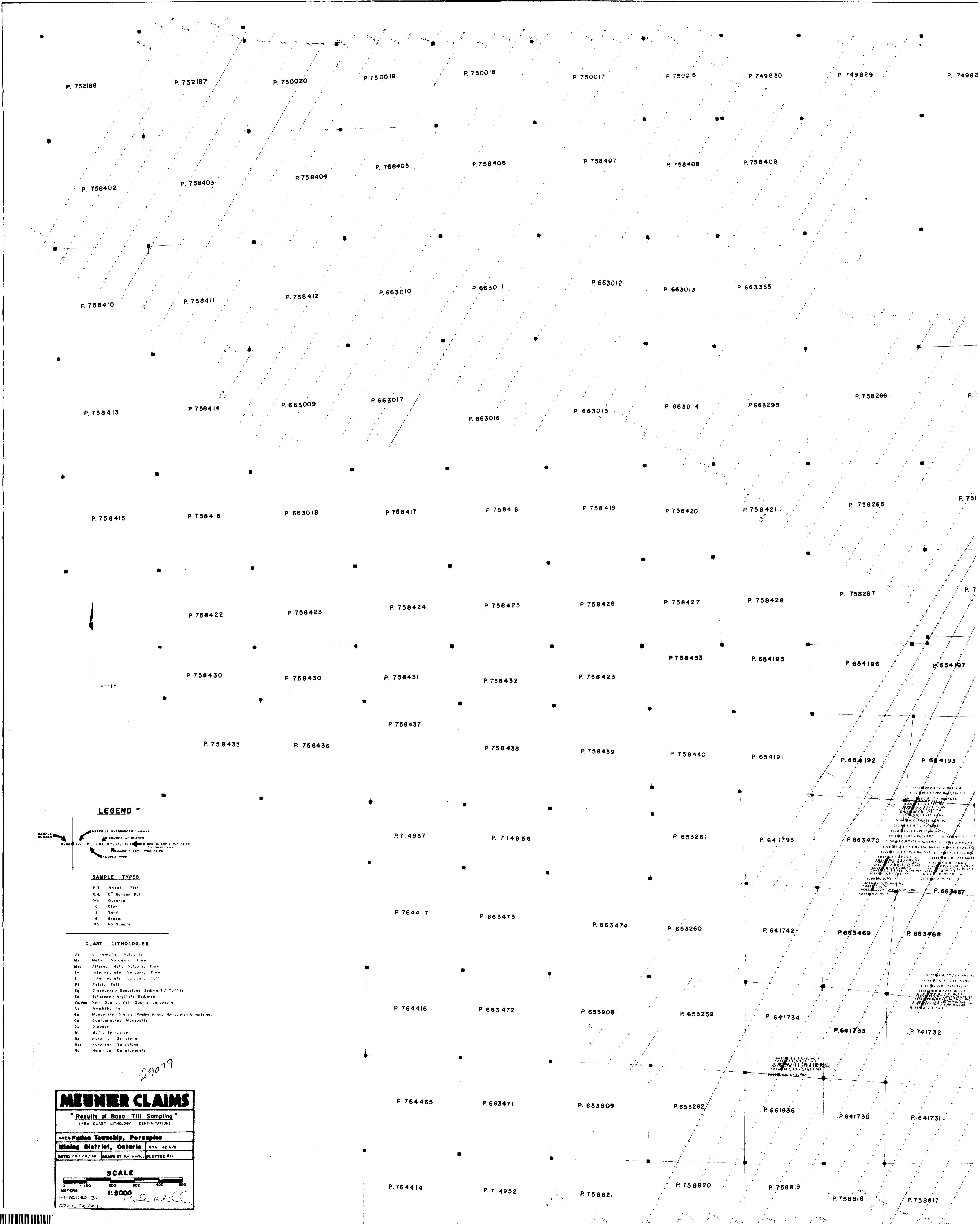

**LEGEND**

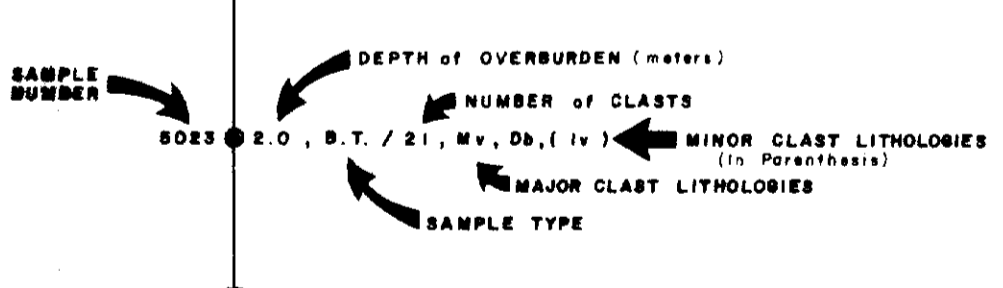

**SAMPLE TYPES**

- B.T. Basal Till
- C.H. "C" Horizon Soil
- O/C Outcrop
- C Clay
- S Sand
- G Gravel
- N.S. No Sample

**CLAST LITHOLOGIES**

- Uv Ultramafic Volcanic
- Mv Mafic Volcanic Flow
- Mve Altered Mafic Volcanic Flow
- Iv Intermediate Volcanic Flow
- It Intermediate Volcanic Tuff
- Ft Felsic Tuff
- Sg Graywacke / Sandstone Sediment / Tuffite
- Ss Siltstone / Argillite Sediment
- Vq Vein Quartz; Vein Quartz-carbonate
- Ab Amphibolite
- Ga Monzonite - Granite (Porphyritic and Non-porphyritic varieties)
- Cg Conglomerate Monzonite
- Db Diabase
- Mi Mafic Intrusive
- Hs Horonian Siltstone
- Hss Horonian Sandstone
- Mc Horonian Conglomerate

**MEUNIER CLAIMS**  
 "Results of Basal Till Sampling"  
 (\*5% CLAST LITHOLOGY IDENTIFICATION)

AREA: **Fallon Township, Paragwip**  
 Mining District, Ontario HTS. 42 A / Z

DATE: 09 / 08 / 88 DRAWN BY: R.H. MADILL PLOTTED BY: [Signature]

**SCALE**  
 0 100 200 300 400 500 METERS  
 1:5000  
 CHECKED BY: [Signature]  
 APRIL 30, 1986



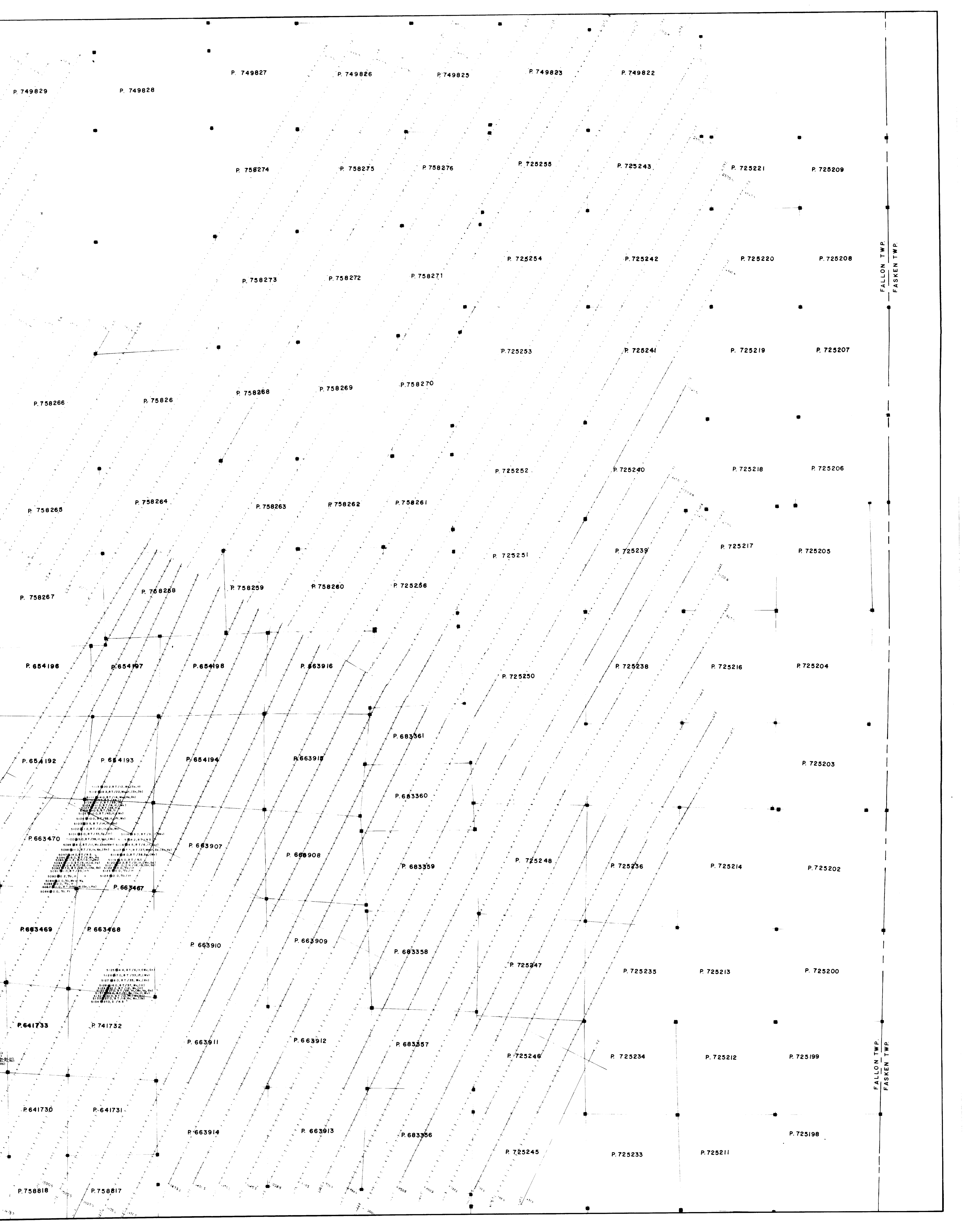

P. 749829 P. 749828 P. 749827 P. 749826 P. 749825 P. 749823 P. 749822  
P. 758274 P. 758275 P. 758276 P. 725255 P. 725243 P. 725221 P. 725209  
P. 758273 P. 758272 P. 758271 P. 725254 P. 725242 P. 725220 P. 725208  
P. 758266 P. 75826 P. 758268 P. 758269 P. 758270 P. 725253 P. 725241 P. 725219 P. 725207  
P. 758265 P. 758264 P. 758263 P. 758262 P. 758261 P. 725252 P. 725240 P. 725218 P. 725206  
P. 758267 P. 758258 P. 758259 P. 758260 P. 725256 P. 725251 P. 725239 P. 725217 P. 725205  
P. 654196 P. 654197 P. 654198 P. 663916 P. 725250 P. 725238 P. 725216 P. 725204  
P. 654192 P. 654193 P. 654194 P. 663918 P. 683361 P. 725251 P. 725236 P. 725214 P. 725202  
P. 663470 P. 663907 P. 663908 P. 663359 P. 725248 P. 725236 P. 725214 P. 725202  
P. 663469 P. 663468 P. 663910 P. 663909 P. 663358 P. 725247 P. 725235 P. 725213 P. 725200  
P. 641733 P. 741732 P. 663911 P. 663912 P. 663357 P. 725246 P. 725234 P. 725212 P. 725199  
P. 641730 P. 641731 P. 663914 P. 663913 P. 663356 P. 725245 P. 725233 P. 725211 P. 725198  
P. 758818 P. 758817 P. 663914 P. 663913 P. 663356 P. 725245 P. 725233 P. 725211 P. 725198

FALLON TWP.  
FASKEN TWP.