



DIAMOND DRILLING

010

TOWNSHIP: McNeil

REPORT No.: 16

WORK PERFORMED BY: Paul R. Ronovsky

<u>CLAIM No.</u>	<u>HOLE No.</u>	<u>FOOTAGE</u>	<u>DATE</u>	<u>NOTE</u>
L 512585	21	403	July/83	(1)
L 512582	24	125	Aug/83	(1)
L 512356	25	335	Aug/83	(1)

NOTES: (1) #286-83



Ontario

THE MINING ACT - MINISTRY OF NATURAL RESOURCES  
DIAMOND DRILLING LOG

Start a new page for every new hole, but fill in top portion of form only on first page for each hole.

FILL IN ON EVERY PAGE

HOLE NO. 21 PAGE NO. 1

DRILLING COMPANY L. WEEKLEY		COLLAR ELEVATION	BEARING OF HOLE FROM TRUE NORTH 160	TOTAL FOOTAGE 403	DIP OF HOLE AT collar 60	LOCATION OF HOLE IN RELATION TO A FIXED POINT ON THE CLAIM 536 ft East 430 ft North of #3 post	MAP REFERENCE NO.	CLAIM NO. 512585
DATE HOLE STARTED July 16, 1983	DATE COMPLETED July 26, 1983	DATE LOGGED Aug. 30, 1983	LOGGED BY G. Grabowski†		ft		LOCATION (T <sub>p.</sub> , Lot, Con. OR Lot. and Long.) McNeil	PROPERTY NAME
EXPLORATION CO., OWNER OR OPTIONEE L. WEEKLEY		DATE SUBMITTED	SUBMITTED BY (Signature)		ft			
					ft			

FOOTAGE		ROCK TYPE	DESCRIPTION Colour, grain size, texture, minerals, alteration, etc.	PLANAR FEATURE ANGLE *	CORE SPECIMEN FOOTAGE †	YOUR SAMPLE NUMBER	SAMPLE FOOTAGE		SAMPLE LENGTH	ASSAYS †	
FROM	TO						FROM	TO			
0	3	Overburden									
3		Basalt	Dark grey green, fine to medium grain -porphyritic in sections -pillowed? 47-48 - altered silicified rock by qv 54-54.5 - altered silicified rock by qv 55-58 altered silicified rock by qv 147-151 altered silicified rock with qv -1-2% euhedral fine to medium grain 155-159 altered, silicified								
159	174	Syenite	Red, medium grain buff colour when altered by qv								
171	403	Basalt	As above - 317-318.5 syenite as above 347-352 altered by qv								
403			END OF HOLE								

\* For features such as foliation, bedding, schistosity, measured from the long axis of the core.

† Additional credit available. See Assessment Work Regulations.



Ontario

# THE MINING ACT - MINISTRY OF NATURAL RESOURCES DIAMOND DRILLING LOG

Start a new page for every new hole, but fill in top portion of form only on first page for each hole.

FILL IN ON EVERY PAGE

HOLE NO. 24 PAGE NO. 1

DRILLING COMPANY L. WEEKLEY		COLLAR ELEVATION	BEARING OF HOLE FROM TRUE NORTH 230	TOTAL FOOTAGE 125	DIP OF HOLE AT collar 45°	LOCATION OF HOLE IN RELATION TO A FIXED POINT ON THE CLAIM  650 ft East 400 ft South of #4 post	MAP REFERENCE NO.	CLAIM NO. 512582
DATE HOLE STARTED Aug. 1, 1983	DATE COMPLETED Aug. 5, 1983	DATE LOGGED Aug. 30, 1983	LOGGED BY G. Grabowski		ft		LOCATION (Tp., Lot, Con. OR Lat. and Long.)  McNeil	PROPERTY NAME
EXPLORATION CO., OWNER OR OPTIONEE L. WEEKLEY		DATE SUBMITTED	SUBMITTED BY (Signature)		ft			
					ft			

FOOTAGE		ROCK TYPE	DESCRIPTION Colour, grain size, texture, minerals, alteration, etc.	PLANAR FEATURE ANGLE *	CORE SPECIMEN FOOTAGE †	YOUR SAMPLE NUMBER	SAMPLE FOOTAGE		SAMPLE LENGTH	ASSAYS †	
FROM	TO						FROM	TO			
0	7	Overburden									
7	106	Andesite	Medium grey green to black, fine grain -porphyritic from 21-22, 30-37, 41-44, 49-76  -non porphyritic sections contain carbonate  -99-103 stretched amygdules?								
106	113	Syenite	Red medium grain, contains red feldspar and chlorite, equigranular								
113	125	Andesite	As above								
125			END OF HOLE								

\* For features such as foliation, bedding, schistosity, measured from the long axis of the core.  
† Additional credit available. See Assessment Work Regulations.



THE MINING ACT - MINISTRY OF NATURAL RESOURCES  
DIAMOND DRILLING LOG

Start a new page for every new hole, but fill in top portion of form only on first page for each hole.

FILL IN ON EVERY PAGE

HOLE NO. 25 PAGE NO. 1

DRILLING COMPANY L. WEEKLEY		COLLAR ELEVATION	BEARING OF HOLE FROM TRUE NORTH 220	TOTAL FOOTAGE 335 ft.	DIP OF HOLE AT collar 45	LOCATION OF HOLE IN RELATION TO A FIXED POINT ON THE CLAIM 1 420 ft West 150 ft North of #2 post	MAP REFERENCE NO.	CLAIM NO. 512356
DATE HOLE STARTED Aug. 8, 1983	DATE COMPLETED Aug. 18, 1983	DATE LOGGED Aug. 30, 1983	LOGGED BY G. Grabowski		ft		LOCATION (Tp., Lot, Con. OR Lot. and Long.) McNeil	PROPERTY NAME
EXPLORATION CO., OWNER OR OPTIONEE L. WEEKLEY		DATE SUBMITTED	SUBMITTED BY (Signature)		ft			
					ft			
					ft			

FOOTAGE		ROCK TYPE	DESCRIPTION Colour, grain size, texture, minerals, alteration, etc.	PLANAR FEATURE ANGLE	CORE SPECIMEN FOOTAGE +	YOUR SAMPLE NUMBER	SAMPLE FOOTAGE		SAMPLE LENGTH	ASSAYS +	
FROM	TO						FROM	TO			
0	5	Overburden									
5	10	Basalt	Dark grey green, fine grain, cut by numerous narrow qtz-carb veins -carbonate throughout -pillowed?								
10	13	Syenite dike	Reddish green, medium grain, sharp contact or 1% py fine-grained euhedral								
13	179	Basalt	As above - sheared with more numerous qtz-carb veins 22-68 84-110								
179	201	Syenite porphyry	- red feldspar porphyry, medium grain . sharp contact								
201	208	Basalt	As above								
208	224	Syenite Porphyry	As above								
224	335	Basalt	As above - pillowed  234-251 silicified by qtz. veining buff coloured alteration								
335			END OF HOLE								

\* For features such as foliation, bedding, schistosity, measured from the long axis of the core.

+ Additional credit available. See Assessment Work Regulations.

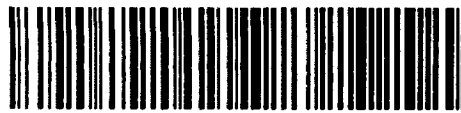

42A02NW0075 16 MCNEIL

WPA 302-2 AG McNeil Top

900

Name and Postal Address of Recorded Holder

PAUL R. KOVACHSKY K 20025  
 P.O. BOX 638, WOOSTER, Ohio, U.S.A. 44691

Summary of Work Performance and Distribution of Credits

Total Work Days Cr. claimed 863	Mining Claim			Mining Claim			Mining Claim		
	Prefix	Number	Work Days Cr.	Prefix	Number	Work Days Cr.	Prefix	Number	Work Days Cr.
for Performance of the following work. (Check one only) <input type="checkbox"/> Manual Work <input type="checkbox"/> Shaft Sinking Drifting or other Lateral Work. <input type="checkbox"/> Compressed Air, other Power driven or mechanical equip. <input type="checkbox"/> Power Stripping <input checked="" type="checkbox"/> Diamond or other Core drilling <input type="checkbox"/> Land Survey		531578	5 1/2		512355	40		618724	40
		578936	6 1/2		512357	40		618725	40
		578935	40		512358	40		618726	
		512368	6.0		512356	40		618627	
		571377	23		512362	40		618628	
		512354	40		512361	40		618629	
		512353	40		512360	40		666117	
		512362	40		512359	40		666114	

All the work was performed on Mining Claim(s): 512<sup>21</sup>585 - 512<sup>24</sup>582 + 512<sup>23</sup>356

Required information eg: type of equipment, Names, Addresses, etc. (See Table Below)

Map showing mining claim locations (DH 21, DH 24, DH 25) and distances. Includes a 'RECEIVED' stamp from the Ontario Geological Survey dated OCT 7 1983 and a 'RECORDED' stamp dated SEP 28 1983. A 'LARDER LAKE MINING DIV.' stamp is dated AUG 30 1983.

Certification Verifying Report of Work

I hereby certify that I have a personal and intimate knowledge of the facts set forth in the Report of Work annexed hereto, having performed the work or witnessed same during and/or after its completion and the annexed report is true.

Name and Postal Address of Person Certifying  
 LOUIS M WEEKLEY, 1798 PINE COVE  
 WOOSTER, Ohio, U.S.A. 44691

Date Certified: Aug. 30, 83  
 Certified by (Signature): Louis M Weekley

Table of Information/Attachments Required by the Mining Recorder

Type of Work	Specific information per type	Other information (Common to 2 or more types)	Attachments
Manual Work	Nil	Names and addresses of men who performed manual work/operated equipment, together with dates and hours of employment.	Work Sketch: these are required to show the location and extent of work in relation to the nearest claim post.
Shaft Sinking, Drifting or other Lateral Work			
Compressed air, other power driven or mechanical equip.	Type of equipment	Names and addresses of owner or operator together with dates when drilling/stripping done.	Work Sketch (as above) in duplicate
Power Stripping	Type of equipment and amount expended. Note: Proof of actual cost must be submitted within 30 days of recording.		
Diamond or other core drilling	Signed core log showing: footage, diameter of core, number and angles of holes.	Nil	Nil
Land Survey	Name and address of Ontario land surveyor.		

FASKEN TWP

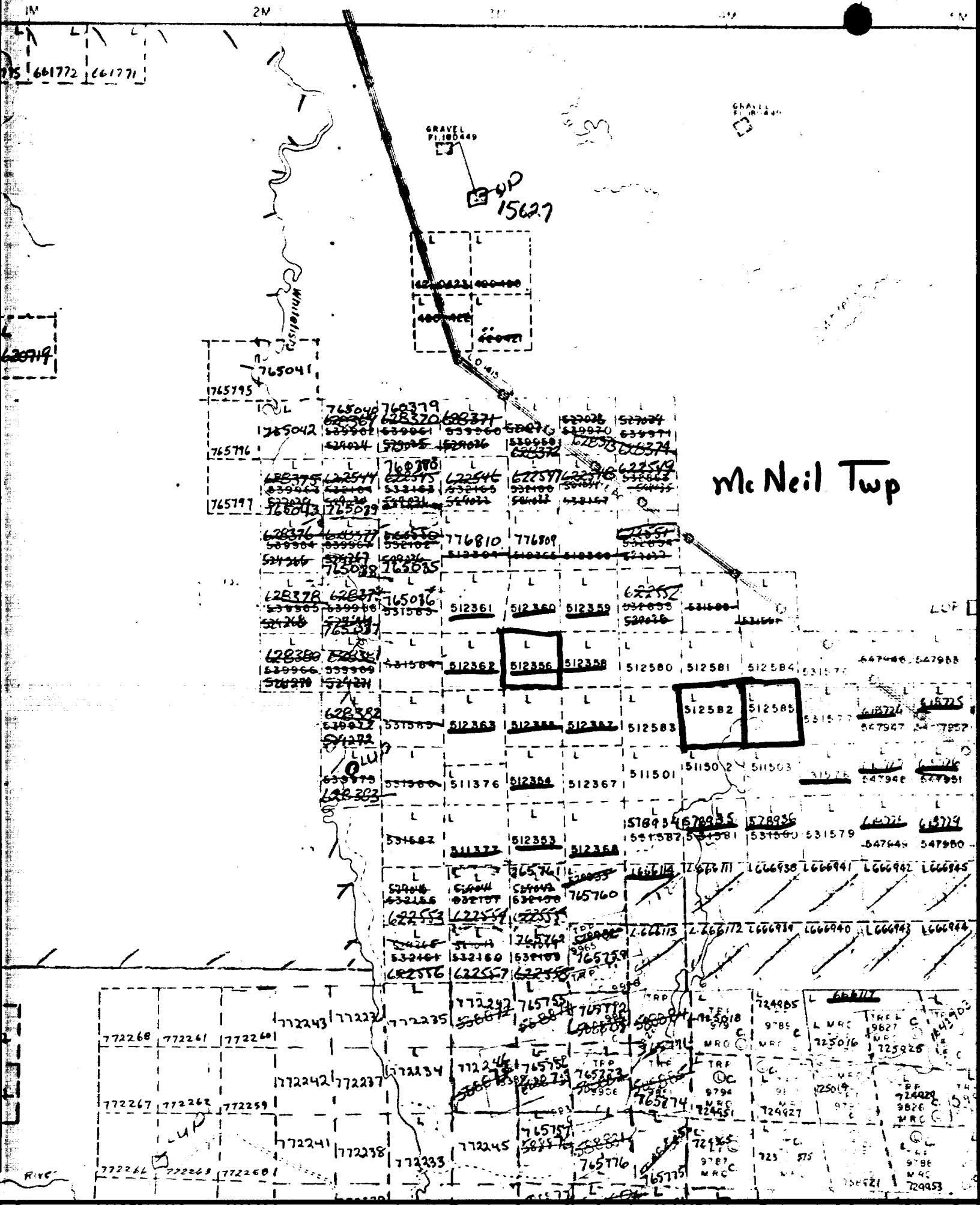

GRAVEL PIT 100449

GRAVEL PIT 100449

UP 1562.7

Mc Neil Twp

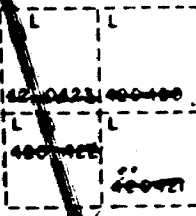

661772 661771

661719

772268 772261 772261  
772267 772262 772259  
772261 772263 772260

772243 772233 772235  
772242 772237 772234  
772241 772238 772233  
772245 765774 765775

724985 978E L MRC TREF C  
724987 9827 MRC C  
725016 725028  
725019 725019  
724927 724927  
725 975  
729 975

661717 L MRC TREF C  
9827 9827  
725028 725028  
725019 725019  
724927 724927  
975 975  
975 975  
724951 724951  
724953 724953