

DIAMOND DRILLING



42A02NW0081 14 MCNEIL

010

TOWNSHIP: McNeil

REPORT No.: 14

WORK PERFORMED BY: Louis M. Weekly

<u>CLAIM No.</u>	<u>HOLE No.</u>	<u>FOOTAGE</u>	<u>DATE</u>	<u>NOTE</u>
L 512585	16	391.0	July/82	(1)
	17	154.0	Aug/82	(1)
	18	388.0	Aug/82	(1)

333H

933'

NOTES: (1) #308-82

FASKEN TWP M.280

2M

3M

4M

5M

GRAVEL
FL 180449

GRAVEL
FL 180449

UP
15627

LUP

308/82

McNeil
Twp
M 360

LUP

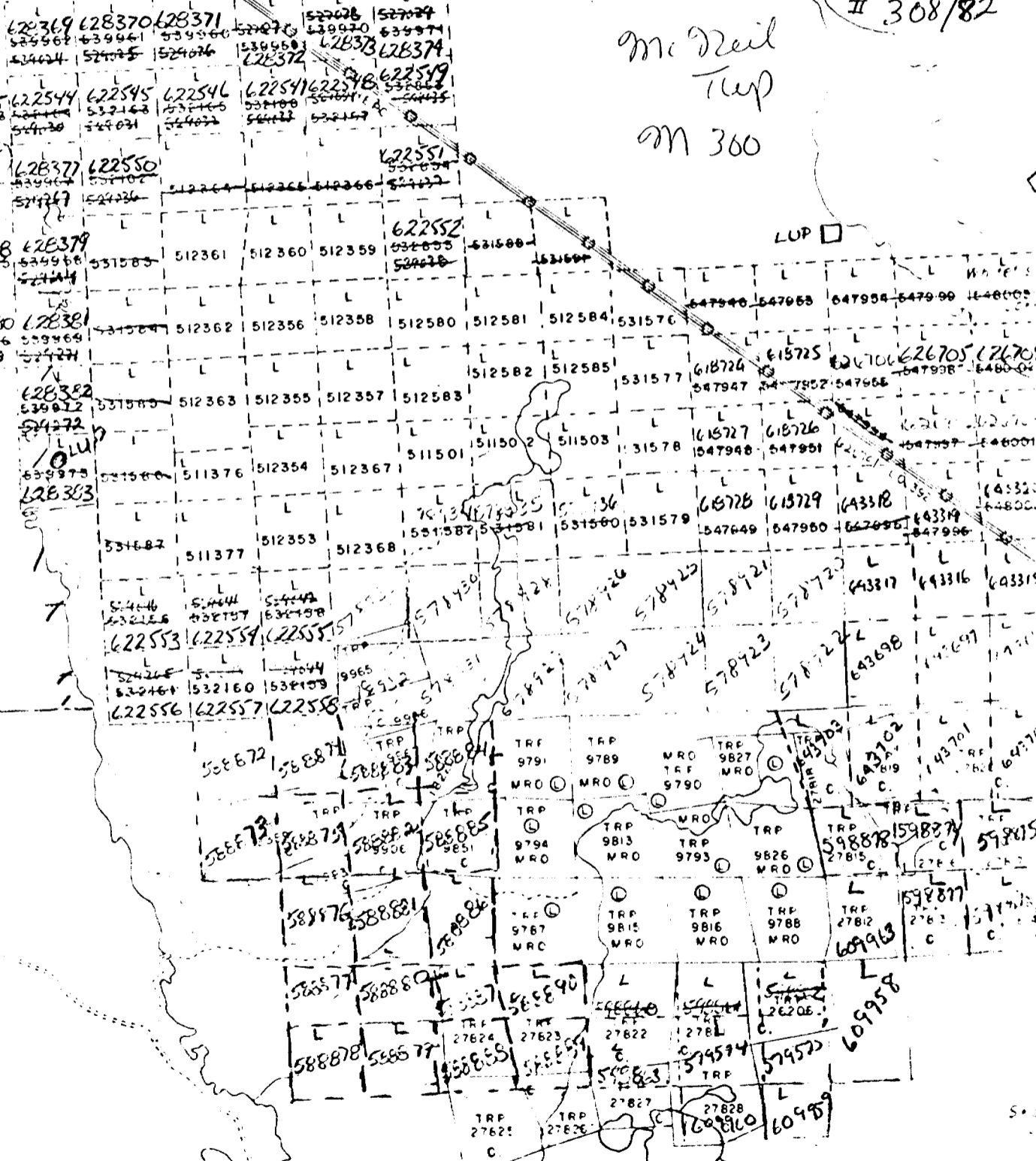

LUP

Howk
ke

Howk's Lot

2M

3M

4M

5M



THE MINING ACT - DEPARTMENT OF MINES
DIAMOND DRILLING LOG

Start a new page for every new hole, but fill in top portion of form only on first page for each hole.

FILL IN ON EVERY PAGE

HOLE NO. 16 PAGE 1

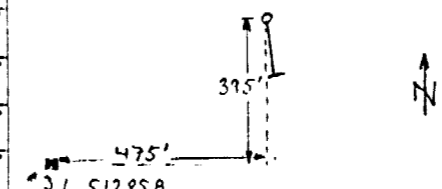
DRILLING COMPANY Louis M. Weekley		COLLAR ELEVATION	BEARING OF HOLE FROM TRUE NORTH 170	TOTAL FOOTAGE 391	DIP OF HOLE AT collar 60	LOCATION OF HOLE IN RELATION TO A FIXED POINT ON THE CLAIM 	MAP REFERENCE NO.	CLAIM NO. L512585
DATE HOLE STARTED July 28, 1982	DATE COMPLETED August 10, 1982	DATE LOGGED Sept 16/82	LOGGED BY Gary Grabowski & David Guindon		ft		LOCATION (Tp., Lot, Con. OR Lat. and Long.) McNeil Tp.	
REGISTRATION CO. OWNER OR OPTIONEE Louis M. Weekley		DATE SUBMITTED	SUBMITTED BY (Signature)		ft		PROPERTY NAME	
					ft			

FOOTAGE FROM TO		ROCK TYPE	DESCRIPTION Colour, grain size, texture, minerals, alteration, etc.	PLANAR FEATURE ANGLE	CORE SPECIMEN FOOTAGE +	YOUR SAMPLE NUMBER	SAMPLE FOOTAGE FROM TO		SAMPLE LENGTH	ASSAYS *
0	3	casing								
2	149	tuff	mafic - dark grey green f.g. numerous qcv 12.5 1" vuggy qv 125-128.8 syenite dike brown							
149	149.5	breccia	breccia zone							
149.5	391	Fe Tholeiite	f-mg dark grey green - cut by numerous narrow veins some coarse grain sections 142.5 1" qv @ 50° c.a. 146.7 2" qv trace py @ 60° c.a. 170.7 1" qv trace py @ 80° c.a. 174.5 1" qv trace py along c.a. 181.4 1" qv trace py @ 50° c.a. 205.5 1" qv 2% py @ 90° c.a. 222.5 1" qtz-py vein 50% py - 20% cp 227 1/2" qv 251.5 1/2" qtz-py vein @ 80° c.a. 271-279 maroon coloured fg alteration 301-309 maroon coloured fg alteration 347.2 10" qv 2% py @ 80° c.a. altered 1 ft on either side of vein 370 5" vein breccia - altered rock 378.4-379 network of veins w/ 1% py @ 70° c.a.							
			391 End of Hole							



THE MINING ACT - DEPARTMENT OF MINES
DIAMOND DRILLING LOG

Start a new page for every new hole, but fill in top portion of form only on first page for each hole.

FILL IN ON EVERY PAGE

HOLE NO. 17 PAGE 1

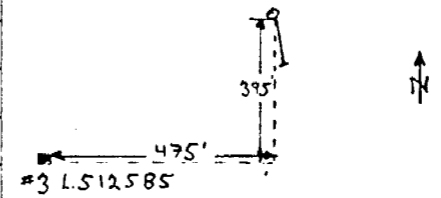
DRILLING COMPANY Louis M. Weekley		COLLAR ELEVATION	BEARING OF HOLE FROM TRUE NORTH 170	TOTAL FOOTAGE 154	DIP OF HOLE AT collar 45	LOCATION OF HOLE IN RELATION TO A FIXED POINT ON THE CLAIM 	MAP REFERENCE NO.	CLAIM NO. 1512585	
DATE HOLE STARTED August 13, 1982	DATE COMPLETED August 18, 1982	DATE LOGGED Sept 16/82	LOGGED BY Gary Grabowski & David Guindon		ft		LOCATION (Tp., Lot, Con. OR Lot. and Long.) McNeil Tp.		
EXPLORATION CO., OWNER OR OPTIONEE Louis M. Weekley		DATE SUBMITTED	SUBMITTED BY (Signature)		ft				
					ft			PROPERTY NAME	

FOOTAGE FROM	TO	ROCK TYPE	DESCRIPTION Colour, grain size, texture, minerals, alteration, etc.	PLANAR FEATURE ANGLE *	CORE SPECIMEN FOOTAGE +	YOUR SAMPLE NUMBER	SAMPLE FOOTAGE		SAMPLE LENGTH	ASSAYS *
							FROM	TO		
1	2.3	casing								
2.3	86	tuff	f.g. dark grey green 27.3 1" qcv 33.4 1/2" qcv							
86	100	Fe Tholeiite	massive dark grey green							
100	103	syenite	brown - lower contact 1" qv 5% py							
103	119	tuff	103-105.7 altered fg dark grey green cut by numerous narrow qcv							
119	154	Fe Tholeiite	f-mg dark grey green 154 End of Hole							

