

Walsh - Kiernicki
Claims

Aug 31 / 96

511098 - 511099
Baden Twp.



42A02SE0035 W9680-00440 BADEN

010

Location & Access

- south central part Baden Twp.
- Longitude $80^{\circ}43'W$ / Lat. $48^{\circ}03'N$
- eight miles NW town of Matachewan
- one mile NW of Matachewan Falls.
- a well marked trail leaves the north shore of Mistinikon Lake for one half-mile to the northwest.

Geology

- parallel shear zones 30 to 50' wide up to 500' long that cut greenstones & syenite
- the shears strike $N80^{\circ}E$ and dip $80^{\circ}S$
- the rock types consist essentially of mafic volcanics (Andesite, Basalt, Andesite Porphyry, Agglomerate, Carbonitized & amygdaloidal rocks)
- small syenite and syenite porphyry dikes also intrude the trenches.

Manual Work.

- consisted of 2 men & three days
- chainsaw clearing overgrown trenches
- hand cleaning debris of old trenches

And Kiernicki

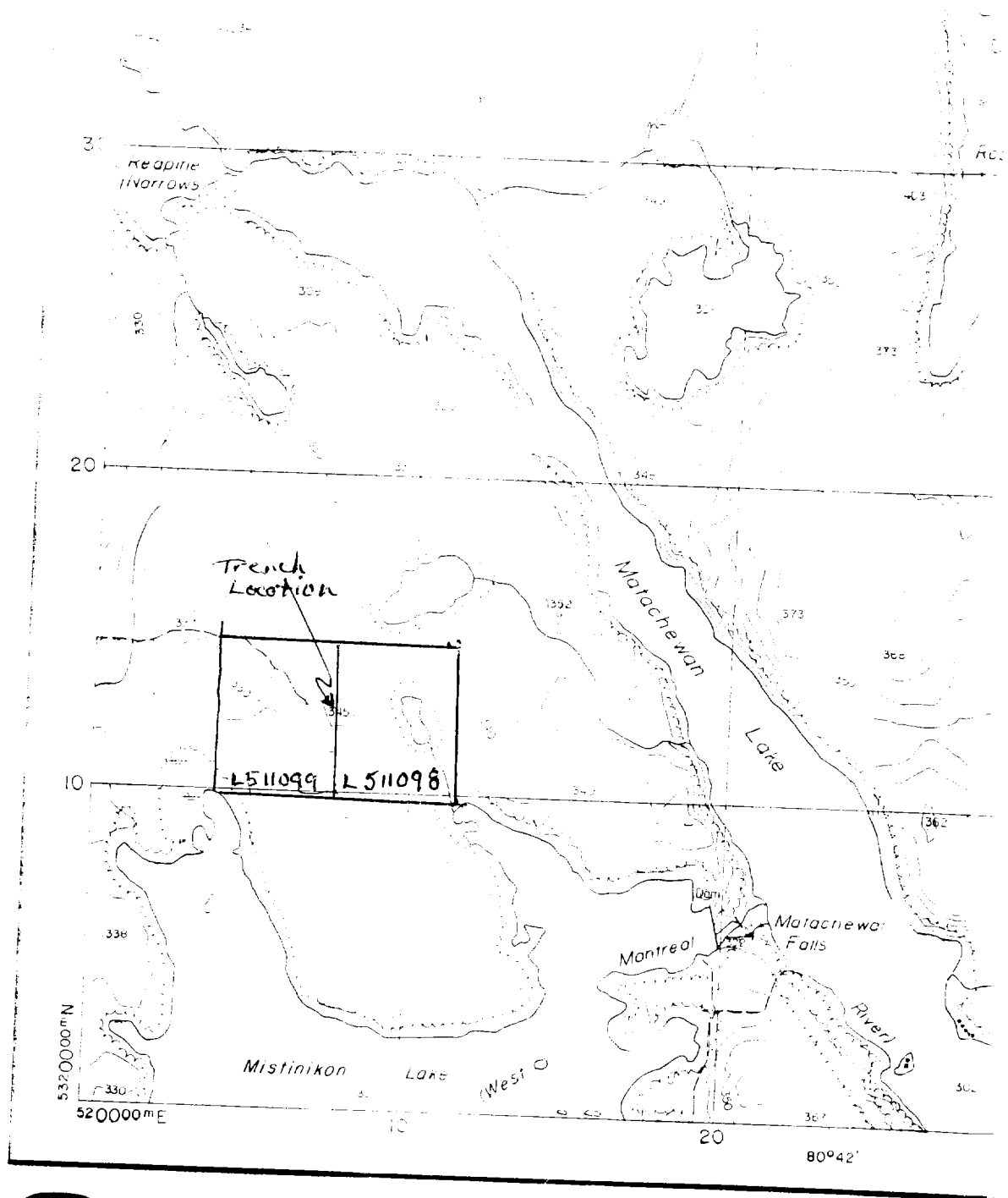

Ontario

Ministry of
Natural
Resources

Sheet

20 17 5200 53200

Map base by Surveys and Mapping Branch.
Air photography 1984. Published 1987.

1 1320' 1 1/2 mile 1 3/4 mile 1

1 inch = 1/4 mile

BADEN TWP.

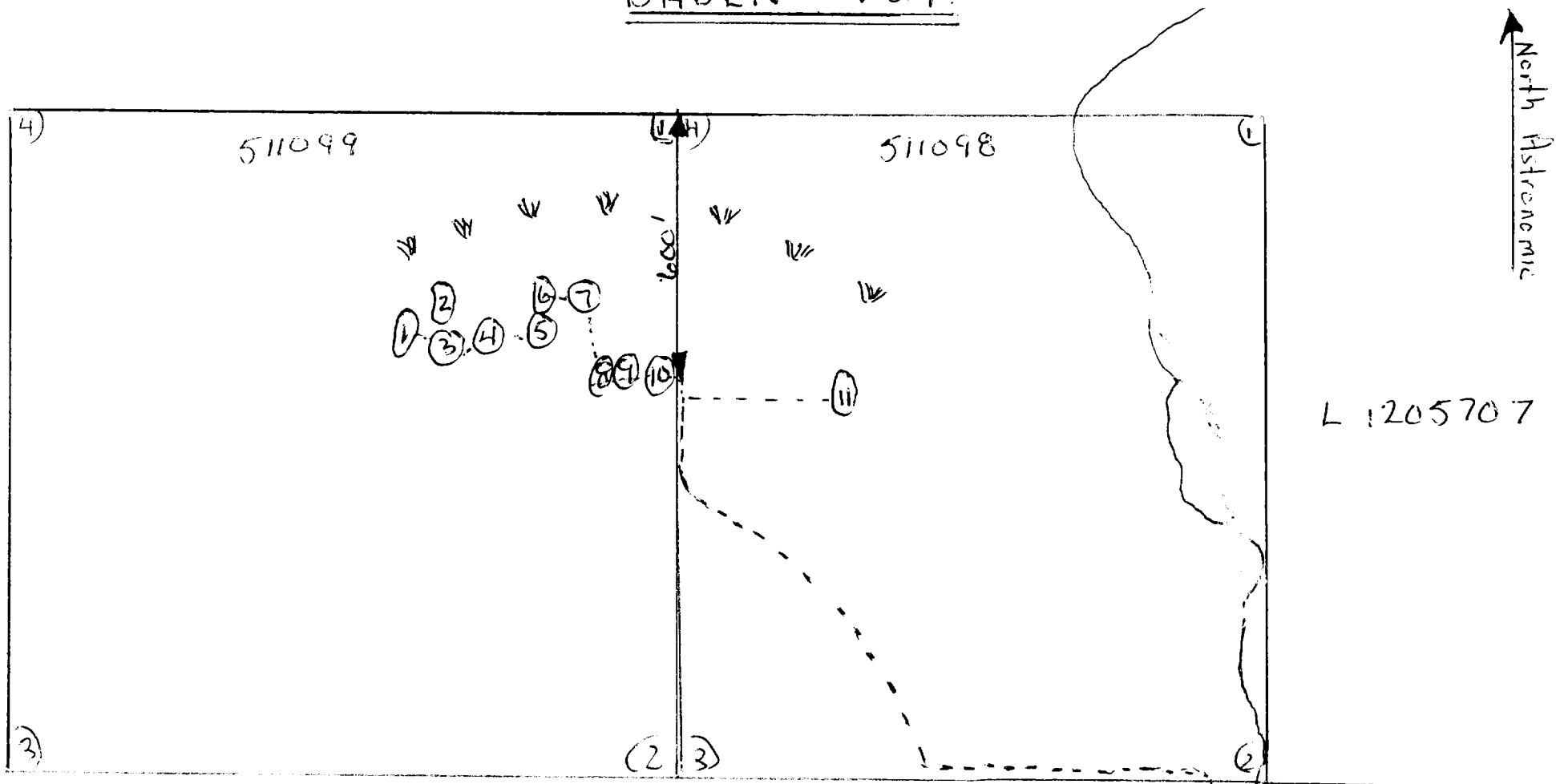

Trail

Trench 3

Swamp

300' | 600' | 900'

1 inch = 300 ft.

Trench Location and Size			
①	28'	x 10'	x 2'
②	15'	x 10'	x 3'
③	15'	x 6'	x 2'
④	8'	x 6'	x 2'
⑤	11'	x 4'	x 2'
⑥	21'	x 6'	x 3'
⑦	31'	x 6'	x 2'
⑧	19'	x 21'	x 2'
⑨	13'	x 7'	x 3'
⑩	17'	x 16'	x 2'
⑪	21'	x 15'	x 2'

Mistimikon Lake



Report of Work Conducted After Recording Claim

Mining Act

Transaction Number
W9680.00440

Personal information collected on this form is obtained under the authority of the
this collection should be directed to the Provincial Manager, Mining Lands, 1
Sudbury, Ontario, P3E 6A5, telephone (705) 670-7264.



42A02SE0035 W9680-00440 BADEN

900

- Instructions:**
- Please type or print and submit in duplicate.
 - Refer to the Mining Act and Regulations for requirements of mining assessment work or assessment work.
 - A separate copy of this form must be completed for each Work Group.
 - Technical reports and maps must accompany this form in duplicate.
 - A sketch, showing the claims the work is assigned to, must accompany this form.

Recorded Holder(s) <i>Ethel Welsh / Fred Kiernicki</i>	Client No. <i>207580 (E.W.)</i>
Address <i>796 East East APT 24 / Box 1143 Kirkland Lake Ont.</i>	Telephone No. <i>567-4858</i>
Mining Division <i>PANTHE</i>	M or G Plan No. <i>M 205</i>
Township/Area <i>Baden</i>	
Dates Work Performed From: <i>Aug 26/96</i> To: <i>Aug 29/96</i>	

Work Performed (Check One Work Group Only)

Work Group	Type
<input type="checkbox"/> Geotechnical Survey	
<input checked="" type="checkbox"/> Physical Work, including Drilling	<i>Manual Work - chain saw clearing of old trenches and cleaning out old trenches by hand tools.</i>
<input type="checkbox"/> Rehabilitation	
<input type="checkbox"/> Other Authorized Work	
<input type="checkbox"/> Assays	
<input type="checkbox"/> Assignment from Reserve	

Total Assessment Work Claimed on the Attached Statement of Costs \$ 900.00

Note: The Minister may reject for assessment work credit all or part of the assessment work submitted if the recorded holder cannot verify expenditures claimed in the statement of costs within 30 days of a request for verification.

Persons and Survey Company Who Performed the Work (Give Name and Address of Author of Report)

Name	Address
<i>Fred Kiernicki (author)</i>	<i>Box 1143 Kirkland Lake, Ont.</i>
<i>Wayne Schrom</i>	<i>Box 229 Matachewan Ont.</i>
<i>Kevin Miller</i>	<i>Box 116 Matachewan Ont.</i>

(attach a schedule if necessary)

Certification of Beneficial Interest * See Note No. 1 on reverse side

I certify that at the time the work was performed, the claims covered in this work report were recorded in the current holder's name or held under a beneficial interest by the current recorded holder.	Date <i>Aug 31/96</i>	Recorded Holder or Agent (Signature) <i>Fred Kiernicki</i>
--	--------------------------	---

Certification of Work Report

I certify that I have a personal knowledge of the facts set forth in this Work report, having performed the work or witnessed same during and/or after its completion and annexed report is true.		
Name and Address of Person Certifying <i>Fred Kiernicki Box 1143 Kirkland Lake Ont. P2N 3M7</i>		
Telephone No. <i>567-4858</i>	Date <i>Aug 31/96</i>	Certified By (Signature) <i>Fred Kiernicki</i>

For Office Use Only

Total Value Cr. Recorded <i>900</i>	Date Recorded <i>96 Sept 3</i>	Mining Recorder <i>[Signature]</i>	Received Stamp MINING DIVISION <i>96 SEP 3 AM 8 40</i> RECEIVED
	Deemed Approval Date	Date Approved <i>96 Nov 28</i>	
	Date Notice for Amendments Sent		

STANDARD WC
TRANSACTION # W95
FORM 7

Claim Number (see Note 2)	of Claim Units	Assessment Work Done on this Claim	Value Applied to this Claim	Value Assigned from this Claim	Reserve Work to be Claimed at a Future Date
511098	1	\$100.-	\$458.00		
511099	1	\$800.-	\$458.00	\$50.00	
Total Number of Claims		Total Value Work Done		Total Assigned From	
2		\$900.00		\$50.00	
		Total Value Went Applied		Total Reserve	
		\$900.00			

Credits you are claiming in this report may be cut back. In order to minimize the adverse effects of such deletions, please indicate from which claims you wish to prioritize the deletion of credits. Please mark (✓) one of the following:

1. Credits are to be cut back starting with the claim listed last, working backwards.
2. Credits are to be cut back equally over all claims contained in this report of work.
3. Credits are to be cut back as prioritized on the attached appendix.

In the event that you have not specified your choice of priority, option one will be implemented.

Note 1: Examples of beneficial interest are unrecorded transfers, option agreements, memorandum of agreements, etc., with respect to the mining claims.

Note 2: If work has been performed on patented or leased land, please complete the following:

I certify that the recorded holder had a beneficial interest in the patented or leased land at the time the work was performed.	Signature	Date
---	-----------	------

Information collected on this form is obtained under the authority of subsection 6(1) of the Assessment Work Regulation 6/96. Under the Mining Act, the information is a public record. This information will be used to review the assessment work and correspond with the land holder. Questions about this collection should be directed to the Chief Mining Recorder, Ministry of Northern Development and Mines, 6th Floor, 933 Ramsey Lake Road, Sudbury, Ontario, P3E 6B5.

Work Type	Units of Work <small>Depending on the type of work, list the number of hours/days worked, metres of drilling, kilometres of grid line, number of samples, etc.</small>	Cost Per Unit	Total Cost
Manual Trench clearing and cleaning	Aug 26, 28, 29 th	4k 800.00	800.-
	3 days x 2 men per day	100.00	100.-
Associated Costs (e.g. supplies, mobilization and demobilization).			
Transportation Costs			
Food and Lodging Costs			
Total Value of Assessment Work			\$ 900.00

Calculations of Filing Discounts:

1. Work filed within two years of performance is claimed at 100% of the above Total Value of Assessment Work.
2. If work is filed after two years and up to five years after performance, it can only be claimed at 50% of the Total Value of Assessment Work. If this situation applies to your claims, use the calculation below:

TOTAL VALUE OF ASSESSMENT WORK $\times 0.50 =$ Total \$ value of worked claimed.

Note:

- Work older than 5 years is not eligible for credit.
- A recorded holder may be required to verify expenditures claimed in this statement of costs within 45 days of a request for verification and/or correction/clarification. If verification and/or correction/clarification is not made, the Minister may reject all or part of the assessment work submitted.

Certification verifying costs:

I, Fred Kiernicki (please print full name), do hereby certify, that the amounts shown are as accurate as may reasonably be determined and the costs were incurred while conducting assessment work on the lands indicated on the accompanying Declaration of Work form as Recorded Holder 50% (recorded holder, agent, or state company position with signing authority) I am authorized to make this certification.

Signature: Fred Kiernicki Date: Aug 31/96

205.M

BADEN 1WB

205.M

TRIM LINE

DATE OF ISSUE

NOV 27 1996

DOCUMENT No.

W 9680-00440

pman
ptrnch

Robertson Twp. M.310

Sheba Twp. M.385

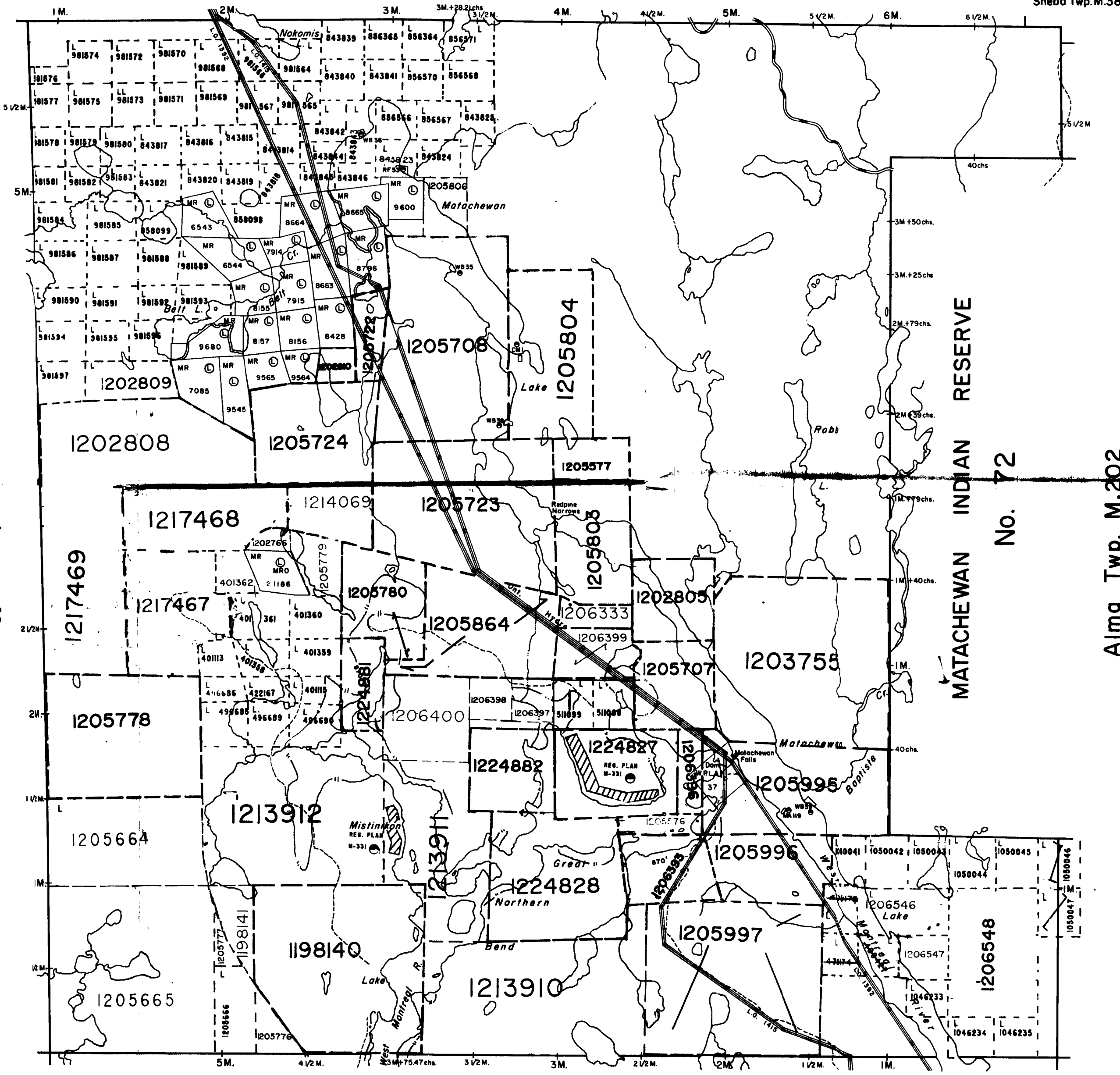

BADEN

DISTRICT OF
TIMISKAMING

LARDER LAKE
MINING DIVISION

SCALE: 1-INCH = 40 CHAINS

LEGEND

PATENTED LAND	● or ⊕
CROWN LAND SALE LEASES	⊕
LOCATED LAND	⊕
LICENSE OF OCCUPATION	L.O.
MINING RIGHTS ONLY	M.R.O.
SURFACE RIGHTS ONLY	S.R.O.
ROADS	—
IMPROVED ROADS	—
KING'S HIGHWAYS	—
RAILWAYS	—
POWER LINES	—
MARSH OR MUSKOG	—
MINES	⊕
CANCELLED	⊕
PATENTED S.R.O.	⊕

NOTES

- 400' surface rights reservation along the shores of all lakes and rivers.
- Flooding rights to contour elevation 870 to Ont. Hydro L.O. 7601 File: 12290 v.2
- (R) Surface and Mining Rights Withdrawn from Staking section 36/80 order No. W 65/83
- (R) MINING & SURFACE RIGHTS REOPENED TO PROSPECTING, SALE OR LEASE. ORDER #0-L-10/95, PREVIOUSLY WITHDRAWN UNDER ORDER #W 65/83.

THE INFORMATION THAT APPEARS ON THIS MAP HAS BEEN COMPILED FROM VARIOUS SOURCES, AND ACCURACY IS NOT GUARANTEED. THOSE WISHING TO STAKE MINING CLAIMS SHOULD CONSULT WITH THE MINING RECORDER, MINISTRY OF NORTHERN DEVELOPMENT AND MINES, FOR ADDITIONAL INFORMATION ON THE STATUS OF THE LANDS SHOWN HEREON.

PLAN NO. **M.205**
ONTARIO
MINISTRY OF NATURAL RESOURCES
SURVEYS AND MAPPING BRANCH

Powell Twp. M.241

CIRCULATED JAN. 30, 1995



42A02SE0035 W9680-00440 BADEN