

42A02SE0040 W9680 00564 CAIRO

010

**ASSESSMENT REPORT
G. KOSY - CROWLEY GROUNDWATER LIMITED JOINT VENTURE
BROWNING LAKE AREA
CAIRO TOWNSHIP
LARDER LAKE MINING DIVISION**

Prepared for: G. Kosy - Crowley Groundwater Limited Joint Venture

October 11, 1996



IAN D. WILSON ASSOCIATES LIMITED
CONSULTING HYDROGEOLOGISTS

STRATFORD, ONT.

519-271-7940

C O N T E N T S

1. Report of Work Conducted After Recording Claim
2. Statement of Costs for Assessment Credit
3. Summary of Accounts
4. Account of A. Dale Well & Pump Service Ltd.
5. Account of Ian D. Wilson Associates Ltd.
including i) Report
6. Account of Crowley Groundwater Ltd.
including i) Summary of Costs of
Mineral Analysis
ii) Summary of Expenses
Paid on Visa

RE: BROWNING LAKE - CLAIM #1202488 - 4 Units
& CLAIM #1202489 - 1 Unit

DRAWING SHOWING
LOCATION
OF
BROWNING LAKE

SCALE 1:50,000

FIGURE 1

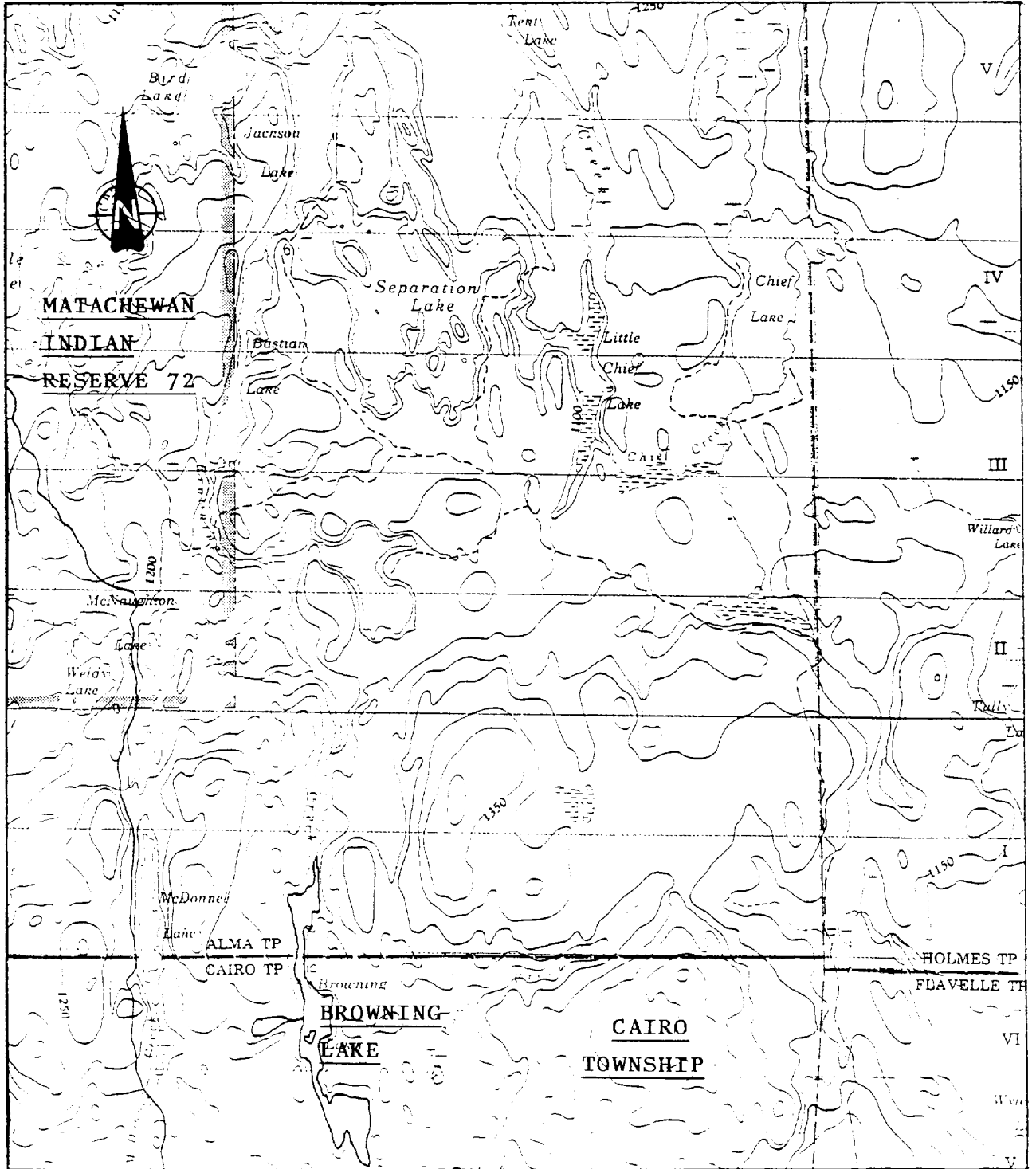

ASSESSMENT REPORT
G. KOSY - CROWLEY GROUNDWATER LIMITED JOINT VENTURE
BROWNING LAKE AREA
CAIRO TOWNSHIP
LARDER LAKE MINING DIVISION

1.0 INTRODUCTION

Mining Claim Group 1202488 consists of 4 contiguous units and Claim 1202489 belonging to G. Kosy were investigated during June and September, 1996 as part of a joint venture between G. Kosy and Crowley Groundwater Limited. The claims are located towards the north end of Cairo Township around Browning Lake in the Larder Lake Mining Division as seen on Figure 1.

Ian D. Wilson Associates Limited, consulting geologists, and Mr. H. Lovell, the retired Resident Geologist for the Larder Lake Mining Division, were retained by the joint venture group to investigate the property. Mr. D. Crowley of Crowley Groundwater Limited co-ordinated and organized the project. Figure 2 shows the location of the claims and Figure 3 shows those claims in relation to others in the area.

2.0 LOCATION

The property is located approximately 5.5 kilometres north of the intersection of Highways 65 and 66 (just east of the Matachewan Townsite), and about 1.3 kilometres east of the road from the intersection of Highways 65 and 66 heading north to the Matachewan Indian Reserve No. 72. A road to the northeast to Browning Lake branches off the road to the Reserve approximately 4.2 km north of the intersection of Highways 65 and 66. This road leads directly to the claim group.

3.0 PREVIOUS WORK ON CLAIMS

Apart from prospecting, the only known work carried out on the claim group prior to 1996 was a rock trench in a quartz vein and a test pit at a barite prospect which appear to have been constructed a considerable time ago. Figure 4 shows the approximate location of the trench and test pit. Apparently gold values were obtained from quartz samples taken from the trench, however, assay results are not available.

DRAWING SHOWING
LOCATION
OF
CLAIM GROUP

SCALE 1:20,000

FIGURE 2

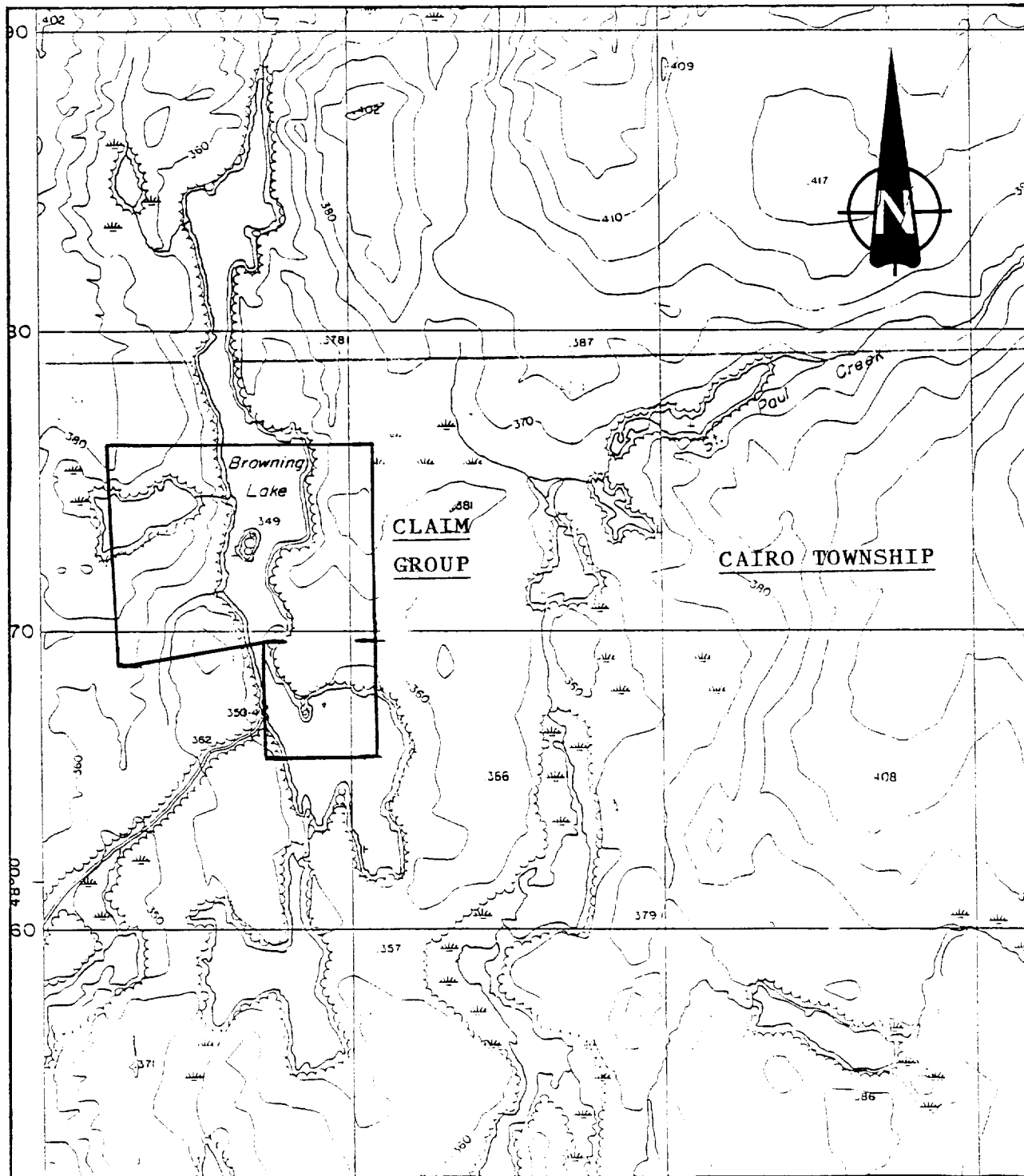

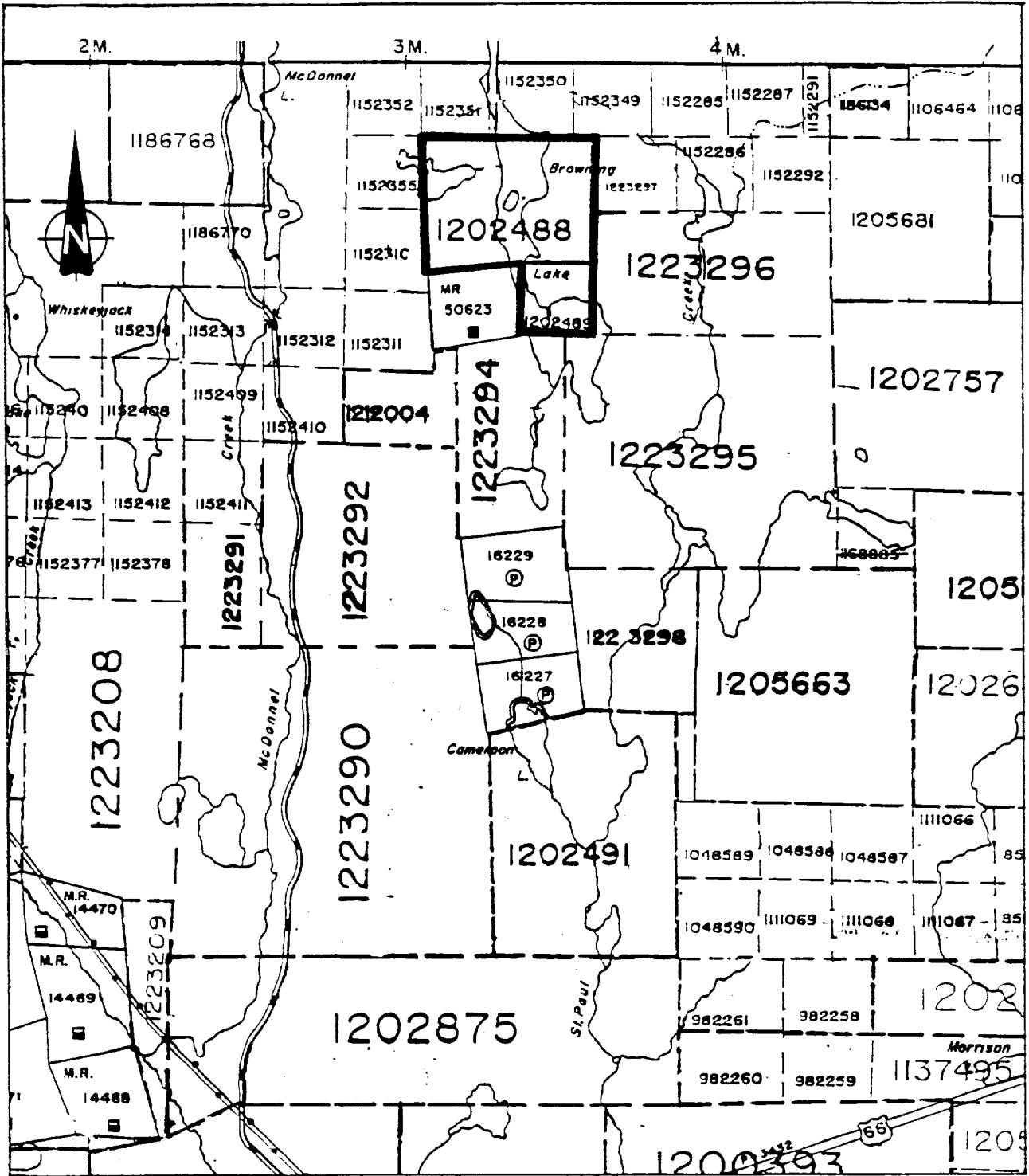

DRAWING SHOWING
 CLAIM GROUP 1202488 AND CLAIM 1202489
 IN RELATION TO
 OTHER AREA CLAIMS

SCALE 1:31,600±

FIGURE 3

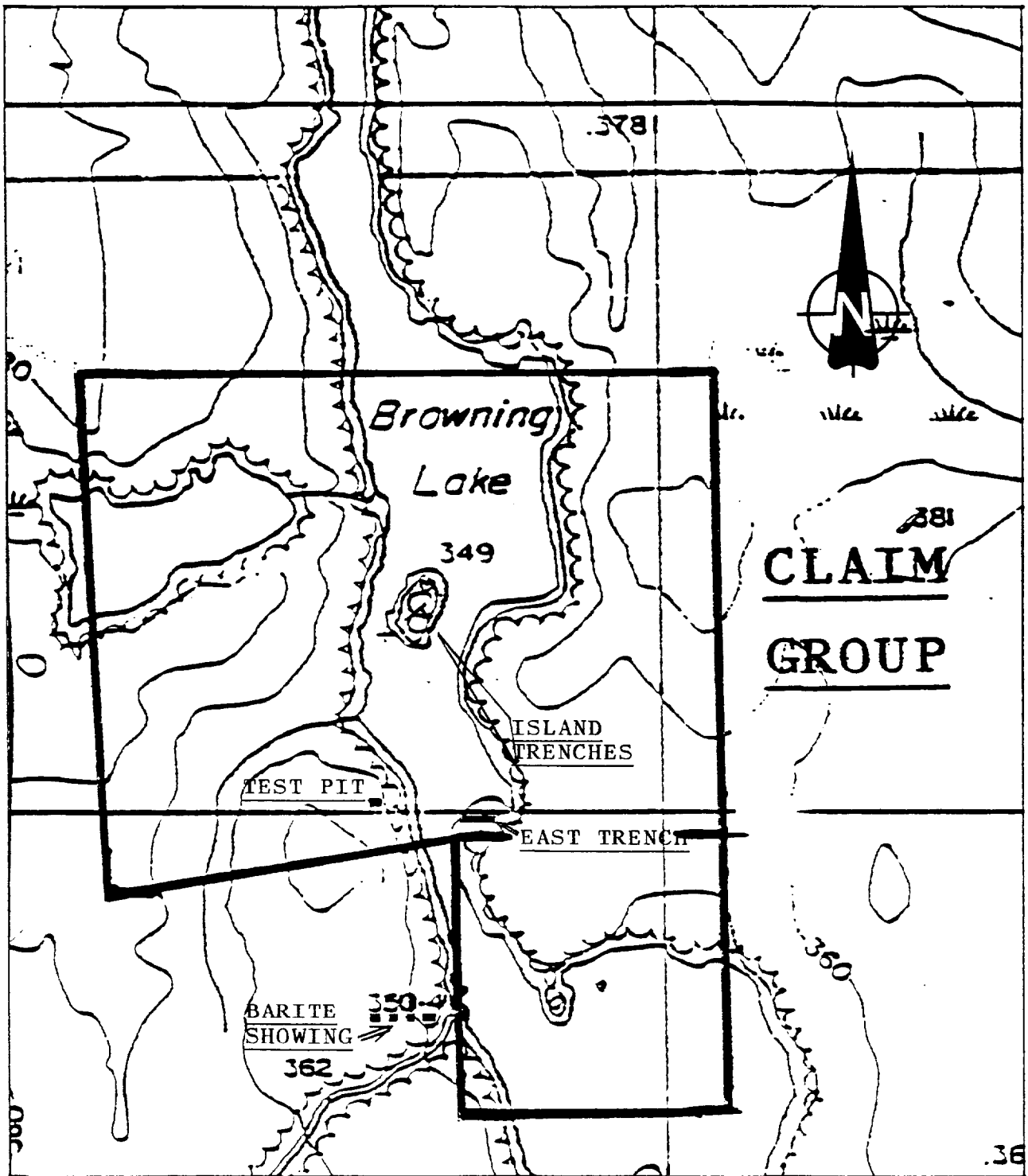

DRAWING SHOWING
 APPROXIMATE LOCATIONS
 OF
 TRENCHES AND TEST PIT

SCALE 1:8400±

FIGURE 4

4.0 TOPOGRAPHY AND VEGETATION COVER

Browning Lake is an elongated feature which occupies the Browning Lake north-south fault; a branch of the Whiskeyjack Creek fault system. Tree cover is heavy, consisting largely of evergreens, poplars and to a lesser degree birch with alders occupying the lower areas.

The topography is fairly rugged, particularly the central portion of the claim group to the west of Browning Lake (elevation 349 metres above sea level) where the land rises approximately 30 metres to a high point at about 380 metres above sea level. A small beaver pond is located in this area which drains to the east into Browning Lake. The east shore of the lake, within the central sector of the claim group, is not as steep but still rises approximately 20 metres. The topography within Claim 1202489, to the south of the main group (see Figure 3), is not as rugged.

The shores of the lake within the central part of the claim group are steep to sheer, particularly on the west side, due to rock outcrop. A small island is located within this sector.

5.0 GEOLOGIC SURVEY

5.1 General Geology:

The entire claim group falls within the Archean silicic intrusive rocks made up of coarse grained syenite and syenite porphyry. Two later Matachewan diabase dikes cross the claim group from north to south on either side of the lake forming the higher lands.

The east-west Galer Lake - Fort Matachewan Fault crosses the claim group and appears to have been displaced horizontally approximately 0.2 km by the north-south Browning Lake fault which forms the lake.

5.2 Economic Geology:

An east-west trench exposing a quartz vein in syenite, approximately 0.6 to 0.9 metres wide and 48 metres long, was investigated during June 1996. This trench had obviously been excavated and sampled many years ago, however, no assay results are available. Chalcopyrite was visible at many locations along the trench length and gold mineralization had been reported in the past within the quartz vein. Figure 4 shows the approximate location of the trench. The trench was partially cleared out but was not resampled.

An east-west barite vein deposit occurs south of the main claim group and west of Claim 1202489. The barite has been exposed over a considerable length where material has been removed. Lead, zinc and fluorite mineralization was also reported at this location.

Mr. H. Lovell traversed north from this deposit to an old boulder filled pit shown on Geological Map 2110, Powell and Cairo Townships. as a second barite showing (see Figure 4) in white vein

quartz cutting pink syenite. North of this pit is a small beaver lake draining to Browning Lake. Barren-appearing syenite and syenite porphyry outcrop along the shores of the lake. Immediately east of the beaver lake is a north-south trending Matachewan diabase ridge which may be displaced to the west forming a second north-south diabase dike. Economic mineralization was not encountered on this traverse.

Sampling of rock outcrop on the small island in Browning Lake was undertaken in September, 1996. The bedrock was exposed from the centre of the island in three directions at magnetic bearings of 130°, 212° and 312°. What little overburden present was stripped and channel samples were taken from the rock between 7.0 and 7.6m (23 to 24.9 ft.) from the centre point in the 312° direction, at 5.2 to 5.5m (17 to 18 ft.) and at 3.7 to 4.1m (12.3 to 13.6 ft.) in the same direction. Additional rock samples were taken from 22.6 to 28.0m (74.0 to 75.6 ft.) with a repeat at 22.9 to 23.2m (75 to 76 ft.) at the 130° bearing and at 17.4m (57 ft.) at the 212° bearing. The rock samples were taken using a diamond saw in ± 8 ins. wide by ± 2 ins. deep cuts. The location of the trenches are shown on the map contained in the report pocket while the assay results appear in the appendix. The centre of the island is 336m (1102 ft.) south of the No. 1 claim post and 410m (1345 ft.) west of the eastern claim boundary. The trench lengths are 7.6m (312°), 23.2m (130°) and 17.4m (212°).

Assay results for the above samples showed no gold or silver values while an I.C.A.P. Plasma Scan of the same samples showed some low values of barium and titanium. Copies of the analyses undertaken by Swastika Laboratories appear in the Appendix.

6.0 DISCUSSION

Although no economic mineralization has been found on Claim Group 1202488 and Claim 1202489 to-date, the properties are located within syenite and syenite porphyry where two major north-south and east-west fault systems intersect. Definite copper mineralization is present in the trench along the quartz vein on the east shore of Browning Lake where gold has also been reported while barite has apparently been exposed in a pit near the west shoreline of the lake. This barite showing is approximately 290 metres north of the larger barite works just south of the main claim group.

The quartz vein in the old trench on the east side of Browning Lake outcrops on the shoreline of the lake near the intersection of the north-south and east-west faults which shows an interpreted horizontal movement of approximately 220 metres. Although not observed in the field during 1996, it is conceivable that the quartz vein system may also be displaced a similar distance to the north by the north-south fault system and may be located on or near the western shoreline about 220 metres to the north.

7.0 CONCLUSIONS

1. The claim group is located in an area of syenite and syenite porphyry with gold potential. Other mineralization has also been seen. More

intensive prospecting could disclose prospects of greater interest.

2. Access to the property is good making prospecting relatively easy.

8.0 RECOMMENDATIONS

1. The continuation of the mineralized quartz vein on the east shore of Browning Lake should be explored further to the east and to the west on the west shore of the lake.
2. The old pit north of the barite deposit south of the claim group which contained boulders of white vein quartz cutting pink syenite should be examined in more detail.
3. Further prospecting of the claims should be undertaken.

IAN D. WILSON ASSOCIATES LIMITED

Ian D. Wilson, P.Eng.



October 11, 1996

REFERENCES

Lovell, H.L.

1967: Geology of the Matachewan Area, Ontario Department of Mines, GR 51, 52p.
Accompanied by Maps 2109 and 2110, scale 1 inch to 1/2 mile.

Sinclair, W.D., Copper-molybdenum occurrences of the Matachewan Area, Ontario; in Current Research, Part A, Geol. Surv. Can., Paper 79-1A, p. 253-258, 1997.

APPENDIX



Swastika Laboratories

A Division of TSL/Assayers Inc.

Assaying - Consulting - Representation

Established 1928

Assay Certificate

6W-3685-RA1

Company: CROWLEY GROUNDWATER LTD

Date: OCT-01-96

Project:

Attn: D. Crowley

We hereby certify the following Assay of 7 Rock samples submitted SEP-16-96 by .

Sample Number	Au oz/ton	Au Check oz/ton	Multi-Element Results to follow
TRENCH#3 23.0-24.9	Nil	-	Results to follow
TRENCH#3 17.0-18.0	Nil	Nil	
TRENCH#3 12.3-13.6	Nil	-	
TRENCH#3 12.0- *	Nil	Nil	
TRENCH#3 74.0-75.6	Nil	-	
TRENCH#3 57.0- *	Nil	Nil	
TRENCH#3 75.0-76.0	Nil	-	

One assay ton portion used.

Certified by

P.O. Box 10, Swastika, Ontario P0K 1T0
Telephone (705) 642-3244 FAX (705) 642-3300

CROWLEY GROUNDWATER LTD.

ATTN: D. CROWLEY

TSL/ASSAYERS Laboratories

1270 FEWSTER DRIVE, UNIT 3 MISSISSAUGA, ONTARIO L4W-1A4

PHONE #: (905)602-8236

FAX #: (905)206-0513

REPORT No. : MB107

Page No. : 1 of 1

File No. : OC01HA

Date : OCT-01-1996

I.C.A.P. PLASMA SCAN

Aqua-Regia Digestion

6W-3685-RA1

SAMPLE #	Ag	Al	As	B	Ba	Be	Bi	Ca	CD	Co	Cr	Cu	Fe	Mg	Mn	Mo	Nb	Ni	P	Pb	Sb	Sc	Sn	Sr	Ti	V	W	Y	Zn	Zr
	ppm	%	ppm	ppm	ppm	ppm	ppm	%	ppm	ppm	ppm	ppm	%	%	ppm	ppm	%	ppm	ppm	ppm	ppm	ppm	ppm	ppm	ppm	ppm	ppm	ppm	ppm	ppm
TRENCH#3 23.0-24.9	< 1	0.51	< 5	< 10	1300	< 1	< 5	0.39	< 1	9	170	120	1.4	0.69	240	< 2	0.05	21	540	25	< 5	2	< 10	71	490	31	< 10	5	54	16
TRENCH#3 17.0-18.0	< 1	0.86	< 5	< 10	340	2	< 5	1.0	< 1	12	130	40	2.6	1.3	430	< 2	0.06	34	1000	32	< 5	4	< 10	81	1200	55	< 10	11	80	5
TRENCH#3 12.3-13.6	< 1	0.85	< 5	< 10	200	2	< 5	1.3	< 1	10	120	16	2.3	1.3	470	< 2	0.05	32	870	10	< 5	3	< 10	56	1100	53	< 10	11	80	5
TRENCH#3 12.0*	< 1	0.54	< 5	< 10	570	2	< 5	1.2	< 1	8	110	50	2.3	0.68	340	< 2	0.05	25	720	9	< 5	3	< 10	79	1600	47	< 10	11	51	8
TRENCH#3 74.0-75.6	< 1	0.65	< 5	< 10	160	3	< 5	1.3	< 1	8	95	9	1.9	0.84	400	< 2	0.05	24	840	6	< 5	3	< 10	56	1000	42	< 10	12	62	6
TRENCH#3 57.0*	< 1	0.57	< 5	< 10	1200	1	< 5	1.5	< 1	10	110	180	2.3	0.79	340	< 2	0.05	25	860	57	< 5	3	< 10	100	1800	44	< 10	12	55	6
TRENCH#3 75.0-76.0	< 1	0.57	< 5	< 10	1400	2	< 5	1.3	< 1	9	130	43	1.7	0.69	320	< 2	0.05	23	710	10	< 5	3	< 10	87	890	42	< 10	10	57	10

A .5 gm sample is digested with 2 ml of 3:1 HCL/HNO3
 at 95° C for 90 min and diluted to 10 ml with DI H2O
 This method is partial for many oxide materials

SIGNED :

Ray Saad

10-08-96 03:13PM [9] #2

Big Pine Key

FL USA 33043

Box 431876

Fax 1-306 872-3077

Tel 1-306 872-0229

Fax To 1-705-567-8621

Larder Lake Mining Division

Mining Records Office

Attn Ms. Francis Hoskins

Re mining claims # ~~L120287~~ # L120289. (Blowing Lake)

Francis. Page # 2 of 3 of this box are the amended Report of Work conducted on these claims. The following information was requested:

Item #3 Eqt. Used. 13' boat, 10hp motor 5000 watt generator
 *350 Stihl power saw hammer drill picks & shovels 1-20' chain saw
 GPS. Existing trench on the East side of Blowing Lake was
 cleared of brush & hand dug out & samples were taken. The
 small island north of this location was hand traversed
 North-South & East West about 1/3 of this island is bare
 rock with moss patches. Fallen timber was removed from trench
 areas. Samples were cut by diamond saw as per report.
 of Ian D. Wilson. The 13' boat & motor was used by 3 men
 from the end of the road @ S.W. corner of Blowing Lake,
 to the East shore & to the island.

- Ian D Wilson & Associates will supply new maps as required.
 please let me know by Fax if this portion of your request
 has been fully answered.

Paul Truhy
 J.W. Crowley
 Crowley Groundwater Limited.

J.V. = JOINT VENTURE

Oct/96

1.61

requires interest
the advance or
posted to your
is received

amount is received
the interest
by the amount of

OLD

VISA Card
PAGE

RETAIN THIS
AMOUNT

SEP 16 96 2740.73 0.00 6.38 2747.11

Table with columns: Description of Transaction, Amount, Location. Includes entries like BON AIR MOTOR INN, DELEAN'S GAS BAR, SHELL 281 DUNLOP STREET W, etc.

INTEREST/SERVICE CHARGE NEW CHARGES PRESENT BALANCE
STATEMENT DATE OVERDUE PAYMENT THIS MONTH'S PAYMENT MINIMUM PAYMENT
ACCOUNT NUMBER CREDIT LINE CREDIT STILL AVAILABLE DUE DATE

Handwritten note: 1,607.04
TOTAL JOINT VENTURE EXPENSES OCT 196 CW VISA

Interest is charged in advance of the amount of the payment. Interest is charged on the amount of the payment.

Sept 196
207.2

VISA Card
PAGE 2 OF 3

RETAIN THIS PORTION AMOUNT 3

PREVIOUS BALANCE CONSISTED OF:
 AUG 18 96 3897.66 0.00 60.20 BALANCE FORWARD 3957.86

REFERENCE NO.	DESCRIPTION OF TRANSACTION	AMOUNT
0909 01929010	BON AIR MOTOR INN KIRKLAND LA CA	6.18 -JL
0909 38528075	AUSTRIAN VILLAGE INN INC ST GEORGE ON	10.82
0909 01802010	PETROCAN HWY 11 NORTH NORTH BAY CA	14.65 -JL
0909 06180442	YOUR PLACE EATERY KIRKLAND LAKEON	19.99 -JL
0909 01801010	PETROCAN HWY 400 KING CITY CA	24.00 -JL
0909 01936010	BON AIR MOTOR INN KIRKLAND LA CA	33.08 -JL
0909 01929010	BON AIR MOTOR INN KIRKLAND LA CA	34.73 -JL
0909 01825010	ESSO WOODBINE & RAVENSHOE KESWICK CA	41.00 -JL
0909 01801010	PETROCAN HWY 11 NORTH NORTH BAY CA	89.20 -JL
0909 02007010	ROYAL OAK INN -BEST WESTE BARRIE CA	125.44 -JL
0910 01471010	BON AIR MOTOR INN KIRKLAND LA CA	6.18 -JL
0910 05343010	DELEAN'S GAS BAR SWASTIKA CA	26.00 -JL
0910 05343010	DELEAN'S GAS BAR SWASTIKA CA	35.50 -JL
0910 01471010	BON AIR MOTOR INN KIRKLAND LA CA	48.26 -JL
0910 05343010	DELEAN'S GAS BAR SWASTIKA CA	56.00 -JL
0910 05343010	BURLINGTON POST BURLINGTON CA	224.70
0911 03011010	BON AIR MOTOR INN KIRKLAND LA CA	9.81 -JL
0911 00908010	DELEAN'S GAS BAR SWASTIKA CA	26.50 -JL
0911 03012010	BON AIR MOTOR INN KIRKLAND LA CA	29.13 -JL
0911 02180192	CDN TIRE STORE # 00052 KIRKLAND LAKEON	32.36 -JL
0912 01119010	BON AIR MOTOR INN KIRKLAND LA CA	5.72 -JL
0912 01119010	BON AIR MOTOR INN KIRKLAND LA CA	8.30 -JL
0912 03880462	NORTHERN AUTO&IND SUPPLY KIRKLAND LAKEON	22.17 -JL
0912 01119010	BON AIR MOTOR INN KIRKLAND LA CA	75.82 -JL
0912 02571010	JC TRAILERS AND EQUIPMENT KESWICK CA	113.85 -JL -Repairs
0913 01664010	BON AIR MOTOR INN KIRKLAND LA CA	7.31 -JL
0913 11983075	IRENE'S HOMESTYLE COOKING BARRIE ON	8.24 -JL
0913 01664010	BON AIR MOTOR INN KIRKLAND LA CA	8.55 -JL
0913 01626010	PETER FORCELLINI LTD KIRKLAND LAKECA	29.89 -JL
0913 05034010	DELEAN'S GAS BAR SWASTIKA CA	57.20 -JL
0916 03447010	MOTEL CALIFORNIA ANCASTER CA	7.56
0916 02528010	BON AIR MOTOR INN KIRKLAND LA CA	8.03 -JL
0916 02530010	BON AIR MOTOR INN KIRKLAND LA CA	8.48 -JL
0916 02522010	BON AIR MOTOR INN KIRKLAND LA CA	30.78 -JL
0916 02528010	BON AIR MOTOR INN KIRKLAND LA CA	45.48 -JL
0916 02530010	BON AIR MOTOR INN KIRKLAND LA CA	90.71 -JL
0916 00025218	INTEREST	6.38

CHANGES ARE BEING MADE TO YOUR TD GOLD

STATEMENT CREDITS INTEREST/SERVICE CHARGE NEW CHARGES PRESENT BALANCE

STATEMENT DATE 9-18-96 OVERDUE PAYMENT THIS MONTH'S PAYMENT MINIMUM PAYMENT

ACCOUNT NUMBER CREDIT LINE CREDIT STILL AVAILABLE DUE DATE

ANNUAL INTEREST RATE REPORT ANY DISCREPANCIES TO

Charges of interest
of the advance or
posted to your
statement.
Payment in respect
of the interest
made, the interest
of the amount of

J.V. = JOINT VENTURE

Sept 1996

1 of 2

VISA Card PAGE

RETAIN THIS PORTION AMOUNT

PREVIOUS BALANCE CONSISTED OF:
 MERCHANDISE 3897.66
 CASH ADVANCES 0.00
 INTEREST/SERVICE CHARGE 60.20
 BALANCE FORWARD 3957.86

ACCOUNT NO	DESCRIPTION OF TRANSACTION	CITY	STATE	AMOUNT
0819 02579011	GAS RITE #17	HAMILTON	CA	23.41
0819 07081011	PRINCESS AUTO LTD	KITCHENER	CA	171.25 - jr
0820 02381011	MOTEL CALIFORNIA	ANCASTER	CA	8.49 - jr
0821 01200192	CDN TIRE STORE # 00027	DUNDAS	ON	31.47 - jr
0821 02636011	PIONEER PETROLEUM #174	HAMILTON	CA	33.00
0821 05274011	TSC STORES LTD #189	BRANFORD	CA	91.28 - jr
0822 01030462	LEE'S DUNDAS PHARMACY	DUNDAS	ON	6.11
0822 00650342	DAFFODILS	PARIS	ON	11.66
0822 03727011	CANGO #1843	ARTHUR	CA	20.00
0823 05990342	HUNTER PRO HARDWARE	WIARTON	ON	8.94
0823 01966011	KELLY JOES REST & ROAD HS	DURIHAM	CA	34.51 - jr cap. 2
0823 05618011	TSC STORES LTD #189	BRANFORD	CA	44.82 - jr
0823 08854055	G C MCDONALD SUPPLY LTD	BRANFORD	ON	120.70 - jr
0826 09785011	GOLDEN GRIDDLE PANCAKE H	TORONTO	CA	6.19
0826 07822011	BREEZY CORNERS REST.	FREELTON	CA	11.10
0826 05360442	KHALSA AUTO SERVICE	MOUNT FOREST	ON	38.00
0826 07822011	PIONEER PETROLEUM #174	HAMILTON	CA	42.69
0827 01699011	MAPLE LEAF PANCAKE HOUSE	BRANFORD	CA	6.35
PAYMENTS - THANK YOU				
0828 01331011	TAMMY'S NO.2	DUNDAS	CA	12.11
0829 01338011	RADIO SHACK #05-5257	DUNDAS	CA	3.90
0829 01825011	MOTEL CALIFORNIA	ANCASTER	CA	9.68
0830 03045011	MCKERLIE-MILLEN STORE 216	DUNDAS	CA	9.24 - jr
0830 04021011	PRINCESS AUTO	LONDON	CA	10.29 - jr
0830 04021011	PIONEER PETROLEUM #84	PARIS	CA	34.00
0830 04021011	PIONEER PETROLEUM #19	DUNDAS	CA	44.00
0903 26640192	CDN TIRE STORE # 00012	BRANFORD	ON	30.44 - jr
0903 13173011	TSC STORES LTD #189	BRANFORD	CA	72.50 - jr
0904 01818011	RADIO SHACK #05-5257	DUNDAS	CA	8.04
0904 01621011	ESSO	WIARTON	CA	20.00 - jr
0904 57820442	DAVIS FUEL CO LTD	BRANFORD	ON	23.00
0904 06829011	PIONEER PETROLEUM #142	HAMILTON	CA	36.00
0904 15340472	TSC STORES LTD #189	BRANFORD	ON	105.62 - jr
0905 01140462	LEE'S DUNDAS PHARMACY	DUNDAS	ON	9.75
0905 01850010	MOTEL CALIFORNIA	ANCASTER	CA	10.18
0905 01282010	TAMMY'S NO.2	DUNDAS	CA	11.80
0905 01140462	LEE'S DUNDAS PHARMACY	DUNDAS	ON	129.41 - jr
0906 02335010	NEWMARKET HOME HARDWARE	NEWMARKET	CA	8.60
0906 46620342	TU LANE RESTAURANT	CAMBRIDGE	ON	20.58

PAYMENTS/CREDITS INTEREST/SERVICE CHARGE NEW CHARGES PRESENT BALANCE
 STATEMENT DATE OVERDUE PAYMENT THIS MONTH'S PAYMENT MINIMUM PAYMENT
 ACCOUNT NUMBER CREDIT LINE CREDIT STILL AVAILABLE DUE DATE

ANNUAL INTEREST RATE REPORT ANY DISCREPANCIES TO

Joint Venture
 sub total 1,897.75
 165.52
 TOTAL w/ Sept 1996 15732.23
 11/5/96

10 Jun
1996
Interest
ad
100%

GOLD
Elite

JOV = JOINT VENTURE

VISA Card
PAGE

RETAIN
THIS
PORTION
OF
AMOUNT

Aug/96
171

PREVIOUS BALANCE CONSISTED OF:
STATEMENT NO. 2829.03 CASH ADVANCES 0.00 INTEREST/SERVICE CHARGE 24.52 BALANCE FORW. 2853.55

STATEMENT NO.	REFERENCE NO.	DESCRIPTION OF TRANSACTION			
0717	01355011	TAMMY'S NO.2	DUNDAS	CA	13.21
0718	03614011	WEST END CAR WASH	HAMILTON	CA	13.00
0719	97880342	TU LANE RESTAURANT	CAMBRIDGE	ON	5.72 -jr
0719	01960011	MAPLE LEAF PANCAKE HOUSE	HAMILTON	CA	7.51
0719	03323011	PIONEER PETROLEUM #84	PARIS	CA	34.00
0719	12000035	JOHNNY BO'S	SIMCOE	ON	42.35
0719	03323011	ST GEORGE TIRE	ST GEORGE	CA	372.60 -jr - Capital
0723	01524011	MAPLE LEAF PANCAKE HOUSE	BRANTFORD	CA	8.69
0723	05919011	PIONEER PETROLEUM #142	FLAMBOROUGH	CA	33.00
0724	01328011	SEAN'S FIFTH WHEEL	DORCHESTER	CA	6.83
0724	01320011	GAS RITE #17	HAMILTON	CA	26.00
0724	09780342	SHOPPERS DRUG MART #742	MANAGER	ON	47.88
0726	05597011	TSC STORES LTD #189	BRANTFORD	CA	36.80 -jr
0726	04128011	BURLINGTON POST	BURLINGTON	CA	326.35
0729	19839936	PAYMENT - THANK YOU			1374.13 -
0729	02553011	SUNOCO 1050 MAIN ST	HAMILTON	CA	35.00
0730	01780011	REGIONAL FORD NEW HOLLAND	FREELTON	CA	6.64
0730	01558011	LUBRICARE CENTRES	HAMILTON	CA	50.48
0730	18751055	LEE MCBRIDES	HAMILTON	ON	52.77
0731	02823011	CANGO #136	MORRISTON	CA	16.50
0731	49730342	BEAVER FUELS #5046	HAMILTON	ON	36.00 -jr Capital
0731	05211011	TSC STORES LTD	STRATFORD	CA	631.35
0801	09070342	TU LANE RESTAURANT	CAMBRIDGE	ON	7.43
0806	01236011	GAS RITE #17	HAMILTON	CA	16.50
0806	98270442	KHALSA AUTO SERVICE	MOUNT FOREST	ON	39.00
0807	04520011	UNIVERSITY HOME HARDWARE	DUNDAS	CA	8.61
0807	02651011	MANDARIN RESTAURANT	BURLINGTON	CA	33.14
0808	03847011	WEST END CAR WASH	HAMILTON	CA	13.00
0808	03847011	PIONEER PETROLEUM #142	FLAMBOROUGH	CA	23.20
0809	03347011	GEORGES VILLA RESTAURA	ORANGEVILLE	CA	10.30
0809	06802011	NEW HOLLAND NORTH AMERICA	NEW HOLLAND	US	40.87 -jr
29.25 US DLRS					
0812	02510011	HOLIDAY INN - KINGSTON	KINGSTON	CA	24.28
0812	07043011	PIONEER PETROLEUM #632	KINGSTON	CA	33.00
0812	02526011	HOLIDAY INN - OSHAWA	OSHAWA	CA	49.38
0813	05088011	PIONEER PETROLEUM #142	FLAMBOROUGH	CA	16.23
0814	04828011	PIONEER PETROLEUM #174	HAMILTON	CA	7.00
0814	03395011	TSC STORES LTD #189	BRANTFORD	CA	84.11 -jr
0814	01050462	LEE'S DUNDAS PHARMACY	DUNDAS	ON	106.11

PAYMENTS/CREDITS INTEREST/SERVICE CHARGE NEW CHARGES PRESENT BALANCE
 STATEMENT DATE OVERDUE PAYMENT THIS MONTH'S PAYMENT MINIMUM PAYMENT
 ACCOUNT NUMBER CREDIT LINE CREDIT STILL AVAILABLE DUE DATE

ANNUAL INTEREST RATE REPORT ANY DISCREPANCIES TO

JOINT VENTURE
 SUB TOTAL 1171.45
 LESS CAPITAL EXPENSES - 1,003.95
 TOTAL ON AUG-96 167.50
 VISA

GOLD
Elite

VISA Card PAGE

RETAIN THIS PORTION 2 OF 2 AMOUNT

July 1998
L.J.R.

PREVIOUS BALANCE CONSISTED OF:	1479.42	CASH ADVANCES	0.00	INTEREST/SERVICE CHARGE	0.00	BALANCE FORWARD	▶	1479.42
--------------------------------	---------	---------------	------	-------------------------	------	-----------------	---	---------

REFERENCE NO.	DESCRIPTION OF TRANSACTION			
0703 06591011	CANGO #1843	ARTHUR	CA	36.00
0704 00930462	LEE'S DUNDAS PHARMACY	DUNDAS	ON	26.77
0704 03900011	PRINCESS AUTO LTD	MISSISSAUGA	CA	218.49
0705 21600055	THE SPOT RESTAURANT	MOUNT FOREST	ON	18.72
0705 04497011	PIONEER PETROLEUM #142	FLAMBOROUGH	CA	24.67
0705 01876011	OLIVE GARDEN 00043117	HAMILTON	CA	34.06
0705 01915011	MCKERLIE MILLEN STORE 224	BRANTFORD	CA	102.35
0705 04497011	CARRIER TRUCK	BRANTFORD	CA	104.14
0709 01468011	PETROCAN 79 KING ST	PARIS	CA	30.00
0712 14831916	PAYMENT THANK YOU	PARIS	CA	1479.42
0715 98850442	KHALSA AUTO SERVICE	MOUNT FOREST	ON	40.00
0716 01221011	ESSO	SCOTLAND	CA	14.00
0716 00025925	INTEREST			24.52

ACCUMULATED DIVIDEND IS \$118.19 .

Jr Capital
 Capital
 424.98
 Capital

INTEREST TO FUTURE MONTHS

J.V. = Joint Venture

July 196
1967

OLD

VISA Card

RETAIN THIS PORTION

PREVIOUS BALANCE CONSISTED OF:
 STATEMENT NO. 1479.42 CASH ADVANCES 0.00 INTEREST/SERVICE CHARGE 0.00 BALANCE FORWARD 1479.42

DATE	REFERENCE NO.	DESCRIPTION OF TRANSACTION			AMOUNT
0617	11141011	FIFTH WHEEL TRUCK STOP	MILTON	CA	19.23 -JV
0617	02174011	ESSO HWY 25 / CHISOLM	MILTON	CA	29.55 -JV
0617	08562011	DELEAN'S GAS BAR	SWASTIKA	CA	36.00 -JV
0617	02272011	BON AIR MOTOR INN	KIRKLAND LA	CA	51.56 -JV
0618	05965035	PINEWOOD PARK MOTOR INN	NORTH BAY	ON	6.63 -JV
0618	05283011	DELEAN'S GAS BAR	SWASTIKA	CA	17.00 -JV
0618	05283011	GOLDEN GRIDDLE FAMILY RES	NEW LISKEARD	CA	19.11 -JV
0618	01599011	BON AIR MOTOR INN	KIRKLAND LA	CA	22.90 -JV
0618	05283011	DELEAN'S GAS BAR	SWASTIKA	CA	42.00 -JV
0618	01599011	BON AIR MOTOR INN	KIRKLAND LA	CA	66.78 -JV
0618	05980035	PINEWOOD PARK MOTOR INN	NORTH BAY	ON	109.76 -JV
0619	00886011	BON AIR MOTOR INN	KIRKLAND LA	CA	13.62 -JV
0619	04505011	DELEAN'S GAS BAR	SWASTIKA	CA	22.00 -JV
0619	00886011	BON AIR MOTOR INN	KIRKLAND LA	CA	57.21 -JV
0619	04505011	PAUL'S NEW & USED STORE	KIRKLAND LK	CA	57.39 -JV
0620	00896011	BON AIR MOTOR INN	KIRKLAND LA	CA	17.00 -JV
0620	00896011	BON AIR MOTOR INN	KIRKLAND LA	CA	19.98 -JV
0620	02714011	DELEAN'S GAS BAR	SWASTIKA	CA	30.00 -JV
0620	00896011	BON AIR MOTOR INN	KIRKLAND LA	CA	57.19 -JV
0621	03361011	BON AIR MOTOR INN	KIRKLAND LA	CA	11.20 -JV
0621	34880342	MACEWEN - NORTH BAY	NORTH BAY	ON	28.00 -JV
0621	03361011	BON AIR MOTOR INN	KIRKLAND LA	CA	49.45 -JV
0624	02753011	BON AIR MOTOR INN	KIRKLAND LA	CA	16.64 -JV
0624	10497011	FIFTH WHEEL TRUCK STOP	MILTON	CA	17.53 -JV
0624	02752011	BON AIR MOTOR INN	KIRKLAND LA	CA	17.74 -JV
0624	07433011	DELEAN'S GAS BAR	SWASTIKA	CA	28.00 -JV
0624	02753011	BON AIR MOTOR INN	KIRKLAND LA	CA	54.86 -JV
0624	03780011	CAPITOL GRILL	KIRKLAND LAKE	CA	58.48 -JV
0624	02752011	BON AIR MOTOR INN	KIRKLAND LA	CA	835.15 -JV
0625	00980462	LEE'S DUNDAS PHARMACY	DUNDAS	ON	117.19
0627	08846015	PINEWOOD PARK MOTOR INN	NORTH BAY	ON	14.87 -JV
0627	00934011	LUBRICARE CENTRES	HAMILTON	CA	22.95
0627	01063011	OLIVE GARDEN 00043117	HAMILTON	CA	34.21
0627	02609011	PIONEER PETROLEUM #19	DUNDAS	CA	37.00
0627	08855015	PINEWOOD PARK MOTOR INN	NORTH BAY	ON	54.88 -JV
0628	70280342	BEAVER FUELS #5046	HAMILTON	ON	29.00
0702	15380672	SHELL R R 1	WIARTON	ON	20.90
0702	03101011	ESSO 062196	MILTON	CA	27.50
0703	01939011	TAMMY'S NO.2	DUNDAS	CA	9.37

PAID PAYMENTS & CREDITS INTEREST/SERVICE CHARGE NEW CHARGES PRESENT BALANCE
 STATEMENT DATE OVERDUE PAYMENT THIS MONTH'S PAYMENT MINIMUM PAYMENT
 ACCOUNT NUMBER CREDIT LINE CREDIT STILL AVAILABLE DUE DATE

ANNUAL INTEREST RATE REPORT ANY DISCREPANCIES TO

JOINT VENTURE
 SUB TOTAL \$ 2306.69
 LESS CAPITAL EXPENSE - 424.98
 TOTAL \$ 1881.71
 July 196
 C.A.

J.V. = Joint Venture.

James [Signature] 1.11

GOLD

VISA Card

RETAIN THIS PORTION AMOUNT

PREVIOUS BALANCE CONSISTED OF	2104.77	0.00	2.29	BALANCE FORWARD	2107.06
MERCHANDISE		CASH ADVANCES	INTEREST/SERVICE CHARGE		

REFERENCE NO.	DESCRIPTION OF TRANSACTION			
0516 03281011	CHAN'S RESTAURANT	DUNDAS	CA	29.95
0517 04432011	LUBRICARE CENTRES	HAMILTON	CA	28.70
0517 02765011	PIONEER PETROLEUM #174	HAMILTON	CA	29.00
0501 26330442	KHALSA AUTO SERVICE	MOUNT FOREST	ON	40.00
0502 03347011	TSC STORES LTD #189	BRANTFORD	CA	11.72
0504 01287055	THE SPOT RESTAURANT	MOUNT FOREST	ON	15.68
0504 01589011	TAMMY'S NO.2	DUNDAS	CA	17.03
0507 12302916	PAYMENT - THANK YOU			2107.06-
0507 05477011	CANGO #136			30.00
0530 14260442	PROVONT-N DEV & MINES	KIRKLAND	ON	31.03 JV-
0531 63380342	SHOPPERS DRUG MART #742	MANAGER	ON	12.75
0603 22250192	CDN TIRE STORE # 00027	DUNDAS	ON	40.24
0604 01520011	TAMMY'S NO.2	DUNDAS	CA	9.03
0604 47770342	BEAVER FUELS #5104	CAMBRIDGE	ON	30.00
0605 02891011	PRINCESS AUTO LTD	KITCHENER	CA	61.25
0606 00920011	TAMMY'S NO.2	DUNDAS	CA	13.45
0607 32535075	UNITED REFRIGERATION	MISSISSAUGA	ON	159.57
0610 07242011	PIONEER #119	HAMILTON	CA	19.50
0610 07241011	GRISANTI'S	ETOBICOKE	CA	23.36
0610 64040442	KHALSA AUTO SERVICE	MOUNT FOREST	ON	37.00
0610 02672011	GAS RITE #37	SIMCOE	CA	39.09 JV
0611 06410011	PLM QUIDOOR ENTERPRISE	HEPWORTH	CA	22.95 JV
0611 02019011	MANDARIN RESTAURANT	BURLINGTON	CA	34.93
0611 06410011	THE SPECTATOR	HAMILTON	CA	91.00
0612 00934011	TAMMY'S NO.2	DUNDAS	CA	14.88
0612 01532011	PHOTOMAP AIR SURVEYS	REXDALE	CA	209.88 JV
0613 00970462	LEE'S DUNDAS PHARMACY	DUNDAS	ON	69.53
0613 05400192	CDN TIRE STORE # 00177	HAMILTON	ON	79.32 JV
0614 10020672	SHELL HIGHWAY #11 NORTH	GRAVENHURST	ON	19.38 JV
0614 01675011	PIONEER PETROLEUM #38	HANNON	CA	34.50
0614 01675011	BURLINGTON POST	BURLINGTON	CA	224.70

DUE TO RECENT AIRLINE INDUSTRY CHANGES THE TD GOLD TRAVEL CLUB WILL NO LONGER BE OFFERING 5% DISCOUNTS ON SCHEDULED AIRFARES. YOU CAN STILL EARN 5% DISCOUNTS ON CHARTERED AIRFARES, CRUISES AND PACKAGED HOLIDAYS. MORE DETAILS WILL BE MAILED TO YOU IN AUGUST. IF YOU

STATEMENT DATE	INTEREST/SERVICE CHARGE	NEW CHARGES	PRESENT BALANCE
STATEMENT DATE	OVERDUE PAYMENT	THIS MONTH'S PAYMENT	MINIMUM PAYMENT
ACCOUNT NUMBER	CREDIT LINE	CREDIT STILL AVAILABLE	DUE DATE

401.65

*TOTAL
Joint Venture
EXPENSES
C/O James
VISA*

KOSY + CROWLEY
JOINT VENTURE

Summary of Expenses
Paid on VISA - JDC

JUNE 196 = \$ 401.65

JULY 196 = \$ 1,881.71

AUG 196 = \$ 167.50

SEPT 196 = \$ 1,732.23

OCT 196 = \$ 1,607.04

TOTAL TO DATE ON VISA: \$ 5,790.13

PLUS CAPITAL EXPENSES:
ON VISA (NOT INCLUDED ABOVE)

JULY 196 - \$ 424.98

AUG 196 - \$ 1,003.95

SEPT 196 = 165.52

TOTAL CAPITAL EXPENSES \$ 1,594.45

TOTAL EXPENSES ON VISA
{ BOTH CAPITAL + OTHER } \$ 7,384.58

KOSY & CROWLEY
JOINT VENTURE
Summary of Costs
for Mineral Analysis

SWASTIKA LAB:

1. JUNE 18/96 - CERT # 6W-2128-RA1 = 18.21
2. JUNE 21/96 - CERT # 6W-2168-RA1 = 61.53
3. JUNE 25/96 - CERT # 6W-2188-RA1 }
- CERT # 6W-2194-RA1 } = 80.26
4. JULY 16/96 - CERT # 6W-2487-RA1 = 120.38
5. SEPT 27/96 - CERT # 6W-3683-RA1 }
- CERT # 6W-3684-RA1 } = 856.54
6. OCT. 2/96 - CERT # 6W-3685-RA1 = 149.06
7. OCT 7/96 - CERT # 6W-3684-RA1 = 8.99

TOTAL TO DATE: \$ 1,294.97

MINING RECORDER OFFICE.
KIRKLAND WARE:

MAY 29/96 = 31.23
FEB 26/96 = 54.08
DEC 12/95 = 30.36

TOTAL \$ 115.66 \$ 115.66

Growley Groundwater Ltd
 & Gary Kosy - Joint Venture

October 29th, 1996

ROOM, BOARD, FUEL
& MISCELLANES EXPENSES:

As Per Attached Summary of
 Visa Statement and Expenses
 Itemized Thereon:

TOTAL EXPENSES:	\$7,384.58	
LESS CAPITAL EXPENSES:	<u>\$1,594.45</u>	
TOTAL EXPENSES CHARGED	\$5,790.13	----- \$5,790.13
		<u>\$16,547.76</u>
SUBTOTAL OF OUR ACCOUNT		\$16,547.76
PLUS 7% GST (#R101213049)		<u>\$ 1,158.34</u>
OUR TOTAL ACCOUNT HEREIN:		----- <u>\$17,706.10</u>

CERTIFIED CORRECT & SUBMITTED FOR PAYMENT HEREIN:

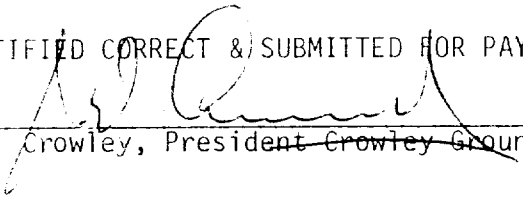
 J.D. Crowley, President Crowley Groundwater Ltd.

E.&.O.E.

BREAKDOWN OF COSTS

<u>Area:</u>	<u>Subtotal</u>	<u>+</u>	<u>GST</u>	<u>=</u>	<u>Total</u>
Webb Lake	\$12,451.91	+	\$871.63	=	\$13,323.54
Browning Lake	\$ 4,095.85	+	\$286.71	=	\$ 4,382.56
TOTALS	#15,437.76	+	\$1,158.34	=	\$17,706.10

Crowley Groundwater Ltd.
& Gary Kosy - Joint Venture

- 2 -

October 29th, 1996

1996 Sept 09 - Co-ordinating @ Webb Lake	11.0 hrs	
Sept 10 - Co-ordinating @ Webb Lake	11.0 hrs	
Sept 11 - Sampling @ Webb	11.0 hrs	
Sept 12 - Sampling @ Webb	11.0 hrs	
Sept 13 - Sampling @ Webb	<u>11.0 hrs</u>	
TOTAL TIME:	99.0 hrs	
99 hrs @ \$30/hr (1/2 rate)	-----	\$2,970.00
Sept 14 - Co-ordinating @ Browning Lake	10.0 hrs	
Sept 15 - Co-ordinating @ Browning Lake	10.0 hrs	
Sept 16 - Travel Time	20.0 hrs	
Sept 17 - Travel Time	<u>20.0 hrs</u>	
TOTAL TIME:	40.0 hrs	
40 hrs @ \$30/hr (1/2rate)	-----	\$1,200.00

MILEAGE:

3/4 Ton Van - 2740 km @ \$.30/km	-----	\$ 822.00
----------------------------------	-------	-----------

DAY LABOUR (LOCAL): Including trucking & saw rental

Sept 09 - Chq #4558 - Kirk Miness	-	\$220.00	
Sept 09 - Chq #4559 - R. Charbonneau	-	305.00	
Sept 13 - Chq #4560 - R. Charbonneau	-	465.00	
Sept 13 - Chq #4561 - Kirk Miness	-	300.00	
Sept 15 - Chq #4562 - R. Charbonneau	-	295.00	
Sept 15 - Chq #4563 - Kirk Miness	-	<u>250.00</u>	\$1,835.00

MINERAL ANALYSIS:

Swastika Laboratories as per attached summary	-----	\$1,294.97
--	-------	------------

RECORDER FEES:

Mining Recorder, Kirkland Lake		
Dec 12/95 -	\$30.36	
Feb 26/96 -	\$54.00	
May 29/96 -	<u>\$31.03</u>	-----
		\$ 115.66

CROWLEY GROUNDWATER LIMITED
GROUNDWATER SPECIALISTS
2 BERTRAM DRIVE
DUNDAS - ONTARIO - L9H 4S9

October 29th, 1996

Crowley Groundwater Ltd
& Gary Kosy
Joint Venture

IN ACCOUNT WITH:

Crowley Groundwater Limited
2 Bertram Drive, Dundas, Ont.

TO: Services rendered by J.D. Crowley RE: Webb Lake, Claim #1202490 - 4 Units
 as outlined below: Browning Lake, Claim #1202488 - 4 Units
 & Claim #1202489 - 1 Unit

1996 June 14 - Loading Time	09.0 hrs	
June 15 - Travel Time	10.0 hrs	
June 16 - Prospecting @ Webb Lake	11.0 hrs	
June 17 - Prospecting @ Webb Lake	10.0 hrs	
June 18 - Prospecting @ Webb Lake	10.0 hrs	
June 19 - Research 1/2 @ Webb, 1/2 Browning	10.0 hrs	
June 20 - Co-ordinating	11.0 hrs	
June 21 - Travel Time	<u>13.0 hrs</u>	
	TOTAL TIME: 84.0 hrs	
	84 hrs @ \$30/hr (1/2 rate) -----	\$2,520.00
1966 Sept 05 - Travel Time	11.0 hrs	
Sept 06 - Co-ordinating @ Webb Lake	11.0 hrs	
Sept 07 - Co-ordinating @ Webb Lake	11.0 hrs	
Sept 08 - Co-ordinating @ Webb Lake	11.0 hrs	

Summary of Accounts

- WEBB LAKE -
CLAIM # 1202490
4 UNITS

(BROWNING LAKE
1202488 + 120249
4 UNIT 1 UNIT

1. Dale	= \$	12,553.70	\$	5,657.54
2. Wilson	= \$	13,744.20	\$	7,941.82
3. Crowley	= \$	13,323.54	\$	4,382.56
		<hr/>	<hr/>	
Totals	= \$	39,621.44	\$	17,981.92

Grand Totals \$ 39,621.44 - WEBB
of all 17,981.92 - BROWNING.
3

Accounts \$ 57,603.36

<u>Labour</u>					
1996	Sept.	9	travel & unloading	8.5 hours	
	Sept.	10	fieldwork	11 hours	
	Sept.	12	fieldwork	<u>11 hours</u>	
				30.5 hours @ \$30/hr.	\$ 915.00
 <u>Rentals</u>					
1996	Sept.	9 to 13 period	Two ATVs 2 days @ \$80/day each		320.00
 <u>Incidentals</u>					
1996	June & Sept.	- 50% of \$779.39			<u>\$ 389.70</u>
Total Webb Lake					<u>\$13744.20</u>

IAN D. WILSON ASSOCIATES LIMITED

Highway 19 North
R.R. 1
Stratford, Ontario
N5A 6S2

GST Reg. 102442068

October 28, 1996

G. Kosy - Crowley Groundwater Limited - Joint Venture
Attn. Mr. D. Crowley
2 Bertram Drive
Dundas, Ontario
L9H 4S9

To Professional Services

Webb Lake

1202490 Claim Group

Ian D. Wilson, P.Eng.

1996	June 16	fieldwork	11 hours		
	Sept. 10	fieldwork	11 hours		
	12	fieldwork	11 hours		
	27	report preparation	7 hours		
	30	report preparation	7 hours		
Oct.	1	report preparation	7.5 hours		
	4	report preparation	5 hours		
	21	report preparation	<u>4 hours</u>		
	Total		63.5 hours @ \$80/hr.		\$5080.00

Travel

1996	June 13	5.25 hours		
	14	4 hours		
	16	4 hours		
	17	<u>3.5 hours</u>		
	Total	16.75 hours @ \$40/hr.	\$ 670.00	
	Kilometres 1365 km @ \$0.30/km		<u>409.50</u>	\$1079.50

H. Lowell

1996	June 16	fieldwork	5.25 hours		
	18	fieldwork	11 hours		
	20	fieldwork	11 hours		
July	12	fieldwork	9 hours		
Sept.	10	fieldwork	11 hours		
	11	fieldwork	11 hours		
	12	fieldwork	<u>11 hours</u>		
	Total		74.5 hours @ \$80/hr.		\$5960.00

continued

G. Kosy - Crowlev Groundwater Limited - Joint Venture

Incidentals

Accommodation	July 13, 1996	North Bay	\$ 54.88	
	July 14	Kirkland Lake	58.74	
	July 15	Kirkland Lake	58.74	
Meals	June 13 - 15		19.61	
Accommodation	Sept. 10	Kirkland Lake	64.34	
	Sept. 11	Kirkland Lake	64.34	
	Sept. 12	Kirkland Lake	64.34	
	Sept. 13	Kirkland Lake	64.34	
Meals	Sept. 9 - 13		229.20	
Maps and reports			68.05	
lagging tape, etc.			<u>32.81</u>	<u>779.39</u>

Note: - The above is for your information only. The total has been divided between the Webb Lake and Browning Lake claims.

IAN D. WILSON ASSOCIATES LIMITED

Highway 19 North

R.R. 1

Stratford, Ontario

N5A 6S2

GST Reg. 102442068

October 28, 1996

G. Kosy - Crowley Groundwater Limited - Joint Venture

Attn. Mr. D. Crowley

2 Bertram Drive

Dundas, Ontario

L9H 4S9

To Professional ServicesBrowning Lake1202488 Claim Group & Claim 1202489Ian D. Wilson, P.Eng.

1996	June	15	fieldwork	10 hours		
	Sept.	11	fieldwork	11 hours		
	Oct.	9	report preparation	3 hours		
		10	report preparation	7 hours		
		11	report preparation	<u>3 hours</u>		
	Total			34 hours @ \$80/hour		\$2720.00

Travel

1996	Sept.	9		8.5 hours		
		13		<u>9 hours</u>		
	Total			17.5 hours @ \$40/hour	\$ 700	
	Kilometres	1374 km @ \$0.30/km			<u>412.20</u>	\$1112.12

H. Lowell

1996	June	15	fieldwork	11 hours		
	July	9	fieldwork	10 hours		
	Sept.	7	fieldwork	<u>12 hours</u>		
	Total			33 hours @ \$80/hour		\$2640.00

Labour

1996	Sept.	11	fieldwork	11 hour		
		13	travel, load & unload	<u>9 hours</u>		
	Total			20 hours @ \$30/hour		\$ 600.00

Rentals

1996	Sept. 9 - 13 period	Two ATVs 3 days @ \$80/day each				\$ 480.00
------	---------------------	---------------------------------	--	--	--	-----------

Incidentals

1996	June & Sept.	- 50% of \$779.39				<u>\$ 389.70</u>
------	--------------	-------------------	--	--	--	------------------

Total		Browning Lake				<u>\$7941.82</u>
-------	--	---------------	--	--	--	------------------

LABOUR: (continued)

1996 - Sept 16	Travel with	18 hrs.	
	and	Truck Float &	
- Sept 17	Backhoe		
	18 hrs @ \$65/hr	-----	\$1,170.00 ✓

MILEAGE: (Truck)

2461 km @ \$1/km	-----	\$2,461.00
------------------	-------	------------

RENTALS:

Honda ATV - 13 days @ \$80/day	-----	\$1,040.00
1-ton Trailer - 13 days @ \$25/day	-----	\$ 325.00
Stihl Diamond Saw - 13 days @ \$40/day	-----	\$ 520.00
1- 12" Diamond Blade (Purchased)	-----	\$ 458.85

ROOM, BOARD & FUEL:

Supplied by Crowley Groundwater Ltd.	-----	-----
--------------------------------------	-------	-------

SUBTOTAL #2	-----	\$13,134.85
-------------	-------	-------------

RECAP:

SUBTOTAL # 1	-----	\$3,885.00	
SUBTOTAL # 2	-----	<u>13,134.85</u>	\$17,019.85
PLUS GST @ 7% (#R119435022)			<u>\$ 1,191.39</u>
TOTAL ACCOUNT HEREIN:			<u><u>\$18,211.24</u></u>

TERMS: Net 30 days
 A. Dale Well & Pump Service Ltd.

BREAKDOWN OF COSTS

<u>Area:</u>	<u>Subtotal</u>	<u>+</u>	<u>GST</u>	<u>=</u>	<u>Total</u>
Webb Lake	\$11,732.43	+	\$821.27	=	\$12,553.70
Browning Lake	<u>\$ 5,287.42</u>	+	<u>\$370.12</u>	=	<u>\$ 6,657.54</u>
TOTALS	\$17,019.85	+	\$1,191.39	=	<u>\$18,211.24</u>

LABOUR:

1996 - Sept 05 - Travel and Load Backhoe , Float, etc.	11.0 hrs	
- Sept 06 - Unload & Strip at Webb Lake	11.0 hrs	
- Sept 07 - Stripping and Road Building at Webb Lake	12.0 hrs	
- Sept 08 - Stripping and Road Building at Webb Lake	11.0 hrs	
- Sept 09 - Stripping and Road Building at Webb Lake	11.0 hrs	
- Sept 10 - Stripping and Road Building at Webb Lake	11.0 hrs	
- Sept 11 - Stripping and Road Building at Webb Lake	11.0 hrs	
- Sept 12 - Stripping and Road Building at Webb Lake	11.0 hrs	
- Sept 13 - Stripping and Road Building at Webb Lake	<u>11.0 hrs</u>	
TOTAL HOURS:	100.0 hrs	
100 hrs @ \$65/hr	-----	\$6,500.00
- Sept 14 - Hand Trenching & Sampling at Browning Lake	10.0 hrs	
- Sept 15 - Hand Trenching & Sampling at Browning Lake	<u>12.0 hrs</u>	
TOTAL HOURS:	22.0 hrs	
22 hrs @ \$30/hr	-----	\$ 660.00

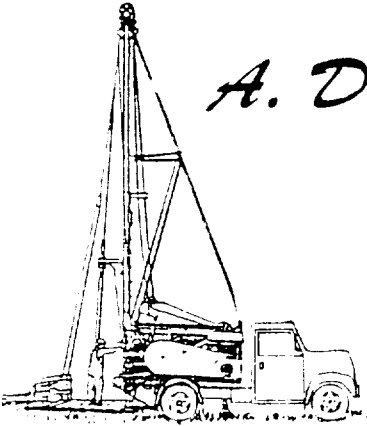

A. Dale Well & Pump Service Limited

WATER WELL DRILLING & PUMP CONTRACTOR

832 Westminster Drive, London, Ontario N6N 1M1
Telephone: (519) 644-1020 Facsimile: (519) 644-2241

September 24th, 1996

TO: Crowley Groundwater Limited
2 Bertram Drive
Dundas, Ontario L9H 4S9

Webb Lake - Claim #1202490, 4 Units
Browning Lake - Claim #1202488, 4 Units
& Claim #1202489, 1 Unit

RE: Gary Kosy
Joint Venture

This invoice covers our work on this project on June 14th to June 22nd, 1996 and on September 5th to September 17th, 1996 and includes the following:

LABOUR:

1996 - June 14 - Load and Travel	10.0 hrs	
- June 15 - Travel and Unload	10.0 hrs	
- June 16 - Beep Map at Webb Lake	11.0 hrs	
- June 17 - Beep Map at Webb Lake	10.5 hrs	
- June 18 - Beep Map at Webb Lake	11.0 hrs	
- June 19 - Beep Map at Browning Lake	10.5 hrs	
- June 20 - Beep Map at Browning Lake	11.0 hrs	
- June 21 - Beep Map & Prospect at Webb Lake	11.0 hrs	
- June 22 - Travel Time & Load and Unload	<u>13.0 hrs</u>	
TOTAL HOURS:	98.0 hrs	
98 hrs @ \$30/hr -----		\$2,940.00

RENTALS:

Honda ATV - 9 days @ \$80/day	-----	720.00
1-ton Trailer - days @ \$25/day	-----	225.00

ROOM, BOARD & FUEL:

Supplied by Crowley Groundwater Ltd.-----

SUBTOTAL #1 ----- \$3,885.00



Report of Work Conducted After Recording Claim

Mining Act

BROWNING LAKE

Transaction Number

amended copy
W9680.00564

Personal information collected on this form is obtained under the authority of the Mining Act. This information will be used for correspondence. Questions about the collection of this information should be directed to the Mining Act, Ministry of Northern Development and Mines, Fourth Floor, 159 Cedar Street, Sudbury, Ontario

Instructions



42A02SE0040 W9680.00564 CAIRO

900

filling assessment work or consult the Mining

- Technical reports and maps must accompany this form in duplicate.
- A sketch, showing the claims the work is assigned to, must accompany this form.

Recorded Holder(s) 153728 & 302647 Client No.

GARY DOUGLAS KOSY & CROWLEY GROUNDWATER LIMITED

Address: 2 Hilltop Dr. CHAPUI-HUGHES, ON POK 1A0 Telephone No. 705-567-3909

Mining Division: DUNDAS, ON L9H 4P6 Telephone No. 905-627-7486

Location: LARDER LAKE Township/Area: CARLO TWP M or D Plan No.

Date Work Performed From: JUNE 14, 1996 to: SEPT. 17, 1996

Work Performed (Check One Work Group Only)

EXPLORATION

Work Group	Description
Geotechnical Survey	REPORT - ATTACHED
Physical Work, Including Drilling	ROAD BUILDING, TRENCHING, SAMPLING
Rehabilitation	WATER TABLE BOUNDARIES <i>W.D.</i>
Other Authorized Work	NIL
Assays	AS PER REPORT OF IAN D. WILSON
Assignment from Reserve	

Total Assessment Work Claimed on the Attached Statement of Costs \$ 17,982.00 *866 W.D.*

Note: The Minister may reject for assessment work credit all or part of the assessment work submitted if the recorded holder cannot verify expenditures claimed in the statement of costs within 30 days of a request for verification.

Persons and Survey Company Who Performed the Work (Give Name and Address of Author of Report)

Name	Address
Ian D. Wilson Associates Ltd	Hwy 19 North, R.R. #1 Stratford, Ont. N5A 6S2- AUTHOR
A. Dale Well & Pump Service Ltd.	832 Westminster Dr. London, Ont. N6H 1M1
Crowley Groundwater Limited	2 Bertram Dr. Dundas, Ont. L9H 4P6

Attach a schedule if necessary)

Certification of Beneficial Interest * See Note No. 1 on reverse side

I certify that at the time the work was performed, the claims covered in this work report were recorded in the current holder's name or held under a beneficial interest by the current recorded holder.

Date: Oct 30/96 Signature: *[Signature]*

Certification of Work Report

I certify that I have a personal knowledge of the facts set forth in this Work report, having performed the work or witnessed same during and after its completion and annexed report in true.

Name and Address of Person Certifying: J. David Crowley, President Crowley Groundwater Limited
2 Bertram Dr. Dundas, Ont. L9H 4P6

Telephone No: 905-627-7486 Date: October 30, 1996 Certified By (Signature): *[Signature]*

For Office Use Only

Total Value Cr. Recorded	Date Recorded	Mining Recorder	Received Stamp
<u>\$17,000</u>	<u>Nov. 4/96</u>	<i>[Signature]</i>	RECEIVED LARDER LAKE MINING DIVISION
Reserve <u>\$9,982</u>	Deemed Approval Date	Date Approved	NOV 4 1996
	<u>Feb 2/97</u>	<u>97 March 4</u>	
	Date Notice for Amendments Sent		
	<u>97 Jan 31 - Reserves due</u>		

JAN -31 '97 (FRI) 13:09

KLK MINING RECORDER

TEL:5675621

P.010

ORANGE WOODWATER LIMITED

PHONE No. : 1 905 6272929

Nov. 07 1996 1:18PM P03

Account No.	Debit	Credit	Balance	Description	Signature	Date
		120298				
		122089				
		14,385.00				
		3,077.00				
		3481.00				
	17,982.00					
	17,866.00					
		12,000.00				
		19,000.00				
		19,520.00				
		17,982.00				
		955.00				
		1081.00				
		1197.00				
		1495.00				
		5180.00				
		1997.00				

any amounts in this report may be cut back. In order to include the adverse effects of such deletions, please indicate from which claims you wish to prioritize the deletion of credits. Please mark [x] one of the following:

- 1) Credits are to be cut back starting with the claim listed last, working backwards.
- 2) Credits are to be cut back equally over all claims contained in this report of work.
- 3) Credits are to be cut back as prioritized on the attached appendix.

NOTE: that you have not specified your choice of priority, option one will be implemented.

Examples of beneficial interests are unrecorded transfers, option agreements, memorandum of agreements, etc., with respect to the mining claims.

If work has been performed on patented or leased land, please complete the following:

Signature of the recorded holder had a beneficial interest in the patented or leased land at the time the work was performed. _____

Signature _____ Date _____

17



IAN D. WILSON ASSOCIATES LIMITED

CONSULTING HYDROGEOLOGISTS, GEOLOGISTS & ENGINEERS

March 12, 1997

Ms. Frances Haskins
Mining Recorder's Office
Ministry of Northern Development & Mines
Larder Lake Division
4 Government Road East
Kirkland Lake, Ontario
P2N 1A2

Dear Ms. Haskins:

Re: Assessment Drawings
Claims 1202490, 1202488 and 1202489,
Cairo Township.

Further to your faxes of March 10 and 11, 1997 regarding the assessment drawings which accompanied reports on Claims 1202490, 1202488 and 1202489, enclosed are replacement drawings which, we hope, are now acceptable. Please include these with our reports and discard the old drawings.

With regards to the Browning Lake claims (1202488 and 1202489), the only rock type seen was barren syenite with a quartz vein showing mineralization (pyrite and chalcopyrite) located at the site of the east trench. No visible mineralization was seen at the sites of the island trenches and the drawing is, therefore, simple. In the case of the Webb Lake claim (1202490), sulphide (largely pyrite) mineralization was common throughout but no economic values were seen in trenches during the 1996 field season.

The sample locations are shown at the bottoms of the drawings so that they can be easily read rather than clutter up the drawings. I hope this is acceptable.

Please let me know, if you have any questions.

Yours sincerely
IAN D. WILSON ASSOCIATES LIMITED

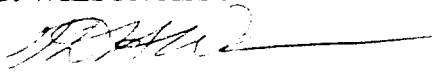
Ian D. Wilson, P.Eng.
IW/hb
encls.

MAR 16 1997

2:30 ←

Big Pine Key Fl.
 FAX 1-305-872-3079
 Telephax-505.872.0229
 Feb 26/97

Fax To 1-705-564-5621

LARDER LAKE MINING DIVISION

MINING RECORDS OFFICE

AH, Ms FRANCIS HASKINS

(Browning Lake)

Re MINING CLAIMS L170288 L170289 CarioTwp

PHYSICAL WORK CHECK LIST

Item #3 Type of Equipment used.

13' Aluminum Boat

10 hp. motor

20" Chain Saw

spicks & shovels

Stihl #350 power saw with 12" Diamond blade

Beop MAP from Resident Geologist Kirkland Lake

Hammer Drill

5000 Watt Generator 110/220 Volts

We TRUST this is the information you require

Speaking to Ian Wilson, he expects to send the revised map for these claims before the week-end.

Yours Truly

J.V. Crowley

Crowley Groundwater Limited

REFERENCES

AREAS WITHDRAWN FROM DISPOSITION

- A.R.O. - MINING RIGHTS ONLY
- .R.O. - SURFACE RIGHTS ONLY
- I.+ S. - MINING AND SURFACE RIGHTS

Description Order No. Date Disposition File

(1) SEG. 3 REG. NRW 65/83 NOV. 18, 1983 M.S.

(R1) MINING & SURFACE RIGHTS REOPENED TO PROSPECTING, SALE OR LEASE, ORDER O-L-1/95, PREVIOUSLY WITHDRAWN UNDER ORDER W 65/83.

(R2) Mining and Surface Rights Withdrawn Order No. W-L-17/95 Dated March 30, 1995. Previously withdrawn under Order NWR 65/83.

THE INFORMATION THAT APPEARS ON THIS MAP HAS BEEN COMPILED FROM VARIOUS SOURCES, AND ACCURACY IS NOT GUARANTEED. THOSE WISHING TO STAKE MINING CLAIMS SHOULD CONSULT WITH THE MINING RECORDER, MINISTRY OF NORTHERN DEVELOPMENT AND MINES, FOR ADDITIONAL INFORMATION ON THE STATUS OF THE LANDS SHOWN HEREON

NOTES

... LAND USE PERMIT

NOTICE OF FORESTRY ACTIVITY

THIS TOWNSHIP / AREA FALLS WITHIN THE PLONSKI DREST MANAGEMENT UNIT AND MAY BE SUBJECT TO FORESTRY OPERATIONS. THE MNR JNT FORESTER FOR THIS AREA CAN BE CONTACTED AT: P.O. BOX 129 SWASTIKA, ONT. POK ITO 705-642-3222

Alma Twp.

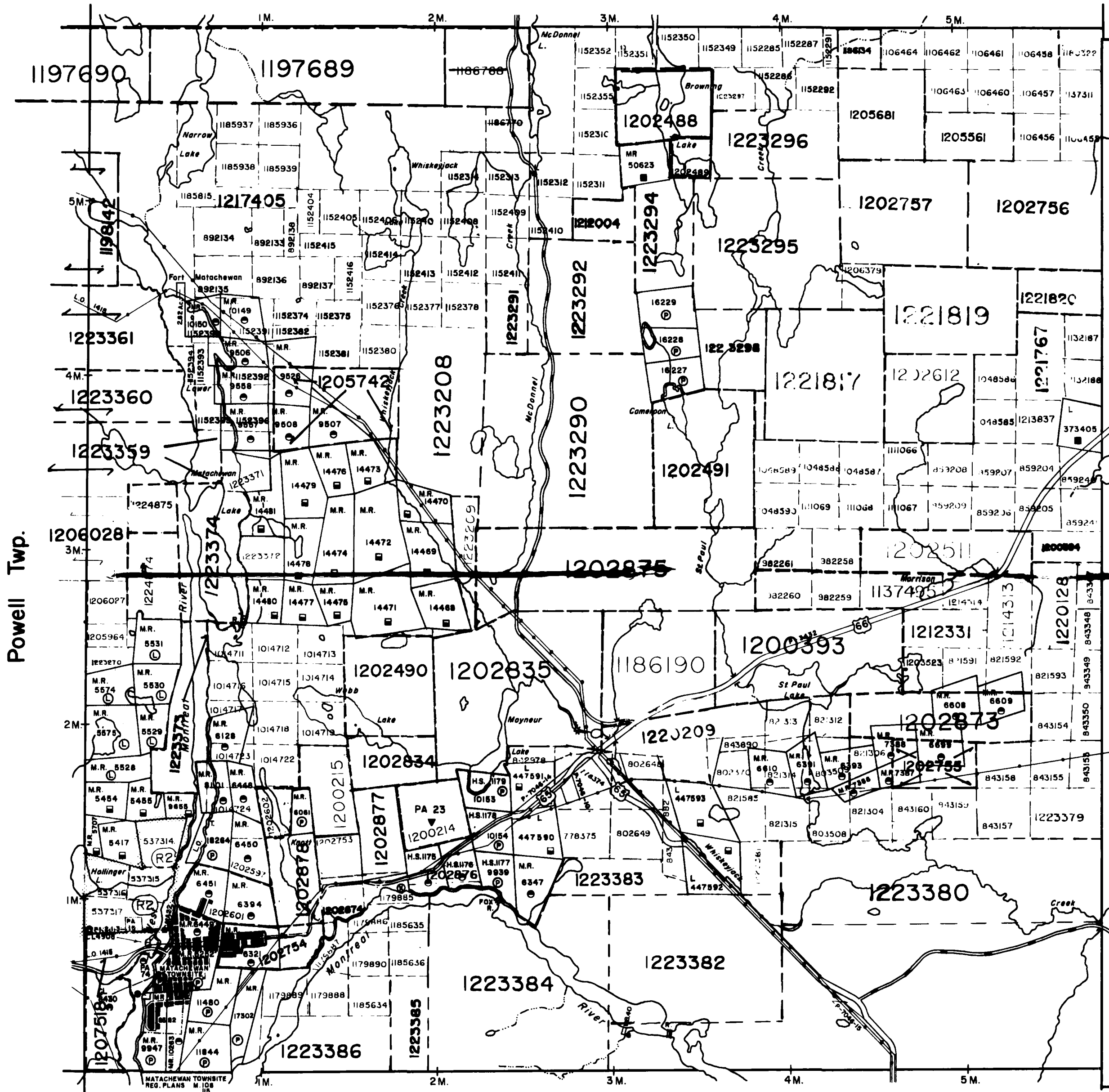

Kimberley Twp.

LEGEND

- HIGHWAY AND ROUTE No.
- OTHER ROADS
- TRAILS
- SURVEYED LINES
- TOWNSHIPS, BASE LINES ETC.
- LOTS, MINING CLAIMS, PARCELS, ETC.
- UNSURVEYED LINES
- LOT LINES
- PARCEL BOUNDARY
- MINING CLAIMS ETC.
- RAILWAY AND RIGHT OF WAY
- UTILITY LINES
- NON-PERENNIAL STREAM
- FLOODING OR FLOODING RIGHTS
- SUBDIVISION OR COMPOSITE PLAN
- RESERVATIONS
- ORIGINAL SHORELINE
- MARSH OR MUSKEG
- MINES
- TRAVERSE MONUMENT

DISPOSITION OF CROWN LANDS

TYPE OF DOCUMENT	SYMBOL
PATENT, SURFACE & MINING RIGHTS	⊙ or ●
" SURFACE RIGHTS ONLY	○ or ○
" MINING RIGHTS ONLY	⊙ or ⊙
LEASE, SURFACE & MINING RIGHTS	⊙ or ⊙
" SURFACE RIGHTS ONLY	⊙ or ⊙
" MINING RIGHTS ONLY	⊙ or ⊙
LICENCE OF OCCUPATION	L.O. or ▼
ORDER-IN COUNCIL RESERVATION	⊙ or ⊙
CANCELLED	⊙ or ⊙
SAND & GRAVEL	⊙ or ⊙

NOTE: MINING RIGHTS IN PARCELS PATENTED PRIOR TO MAY 6, 1913, VESTED IN ORIGINAL PATENTEE BY THE PUBLIC

SCALE: 1 INCH = 40 CHAINS

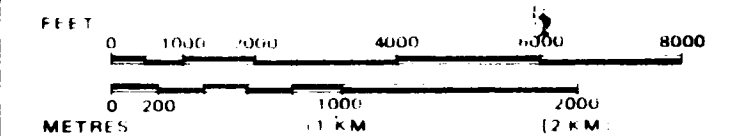

DATE OF ISSUE
 FEB 13 1997

TOWNSHIP *ptrch.*
CAIRO
 M.N.R. ADMINISTRATIVE DISTRICT
 KIRKLAND LAKE
 MINING DIVISION
 LARDER LAKE
 LAND TITLES / REGISTRY DIVISION
 TIMISKAMING

Ministry of Natural Resources
 Ministry of Northern Development and Mines
 Ontario

Date JULY 1986 Number **G-3209**

ARCHIVED JAN 2/97

CIRCULATED JANUARY 17, 1995 M.



TRENCH SAMPLING DETAILS
 HORIZONTAL SCALE 1"=4' (1:48)
 ISLAND TRENCH (312 BEARING)

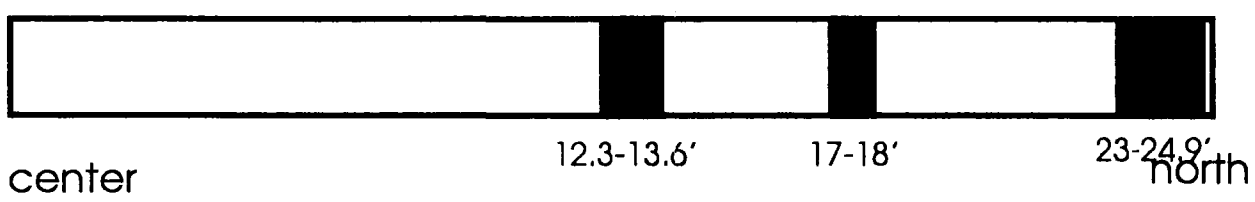

312° Bearing
 Stripping: Length: 24.75 feet
 Width: 2 to 3 feet
 Depth: 0 to 1 foot
 Rock Samples: ± 8 ins. wide by ± 2 ins. deep (as shown)

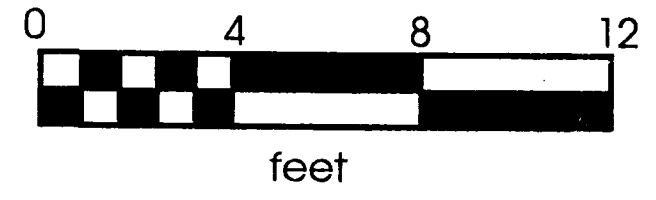

130° Bearing
 Stripping: Length: 76 feet
 Width: 2 to 3 feet
 Depth: 0 to 1 foot
 Rock Samples: ± 8 ins. wide by ± 2 ins. deep (as shown)

ISLAND TRENCH (130 BEARING)

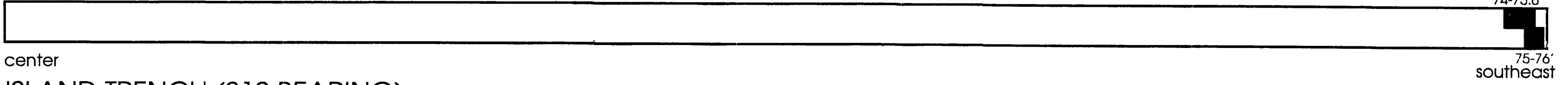

ISLAND TRENCH (212 BEARING)

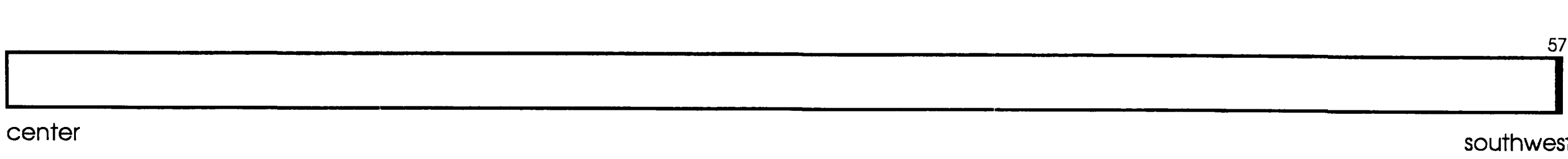

212° Bearing
 Stripping: Length: 57 feet
 Width: 2 to 3 feet
 Depth: 0 to 1 foot
 Rock Samples: ± 8 ins. wide by ± 2 ins. deep (as shown)

EAST TRENCH - NO SAMPLES COLLECTED

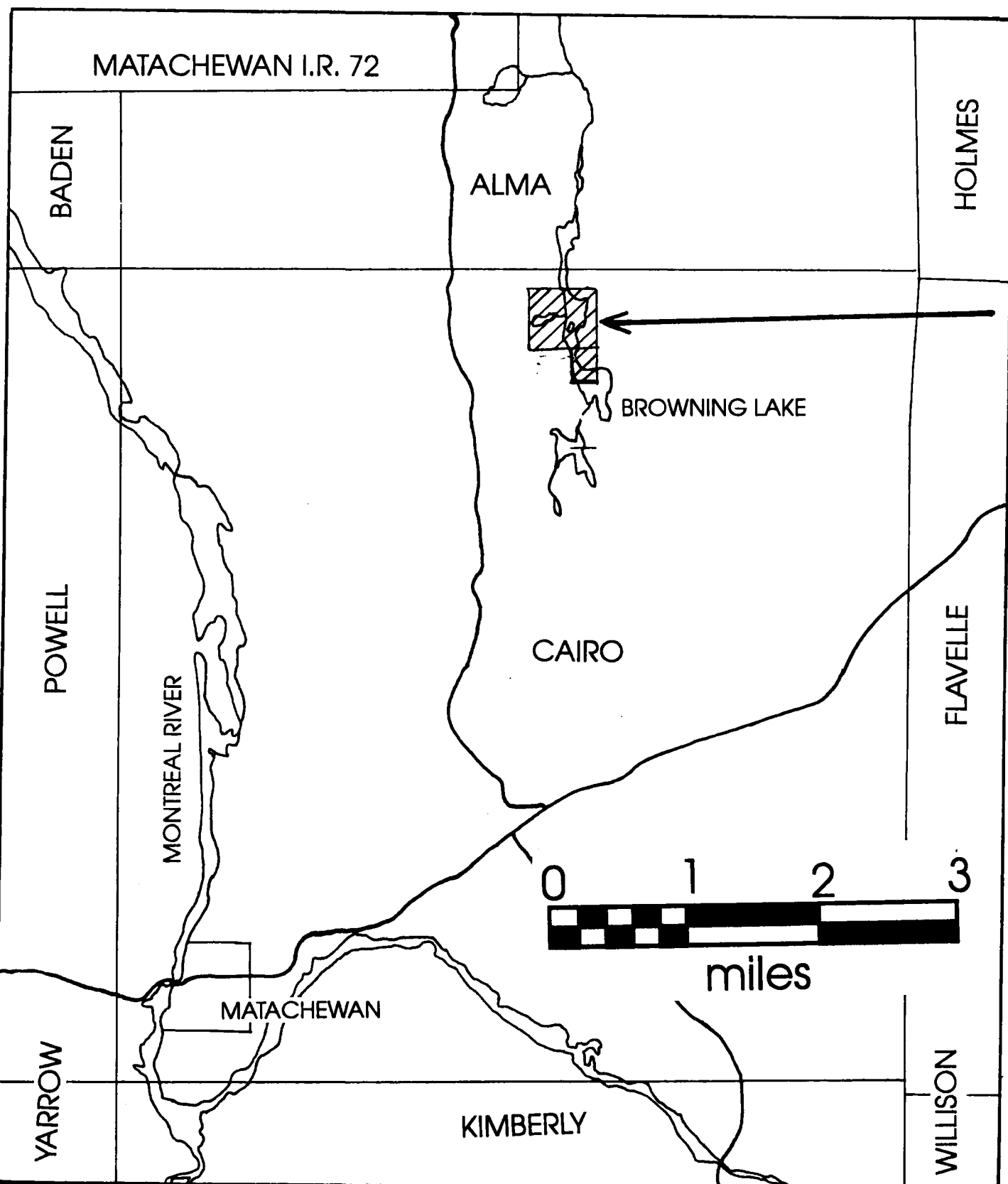

IAN D. WILSON ASSOCIATES LIMITED
 LOCATIONS OF
 TRENCHES AND TEST PITS
 G. KOSY CLAIMS
 LARDER LAKE MINING DIVISION
 ONTARIO
 FEB./97
 SCALE 1"=200' (1:2400) | FIGURE 4

