

Attached List

Persons Who Performed Work.

Sat. Aug. 23/97

Wayne Schrom, Box 229, Matachewan, Ont.
Kevin Miller, Box 116, Matachewan, Ont.
Jim Plant, Matachewan, Ont.
Martin Milten, Matachewan Ont.

2.17645

Sun. Aug 24/97

Fred Kiernicki, Box 1143, Kirkland Lake, Ont.
Wayne Schrom, Box **229**, Matachewan, Ont.
Kevin Miller, Box 116, Matachewan, Ont.

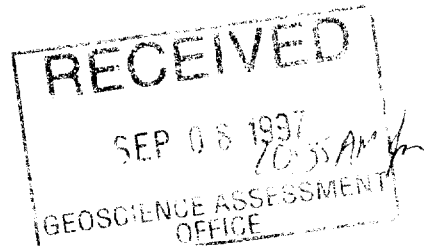

42A02SE0053 2.17645 BADEN

Welsh-Kiernicki

Aug 29/97

Claims

511098 - 511099

Baden Twp.

Location & Access

- south central part of Baden Twp
- Long. $80^{\circ}43'W$ Lat $48^{\circ}03'N$
- eight miles NW town of Matachewan
- one mile NW of Hydro Dam, Matachewan Falls
- a well marked trail leaves the north shore of Mistinikon Lake for one half mile to the northwest.

Geology

- parallel shear zones 30' to 50' wide up to 500' long that cut greenstones and syenite.
- the shear zone strikes $N80^{\circ}E$ and dip $80^{\circ}S$
- the rock types consist of mafic volcanics andesite, basalt, andesite porphyry, agglomerate and carbonitized rocks.

Manual Work

- consisted of hand cleaning trenches and chainsaw clearing of brush & trees.

Paul Kump

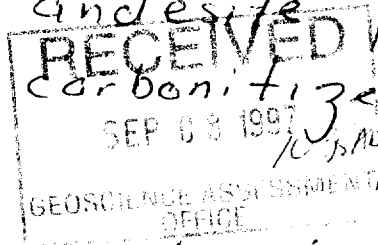

BADEN TWP.

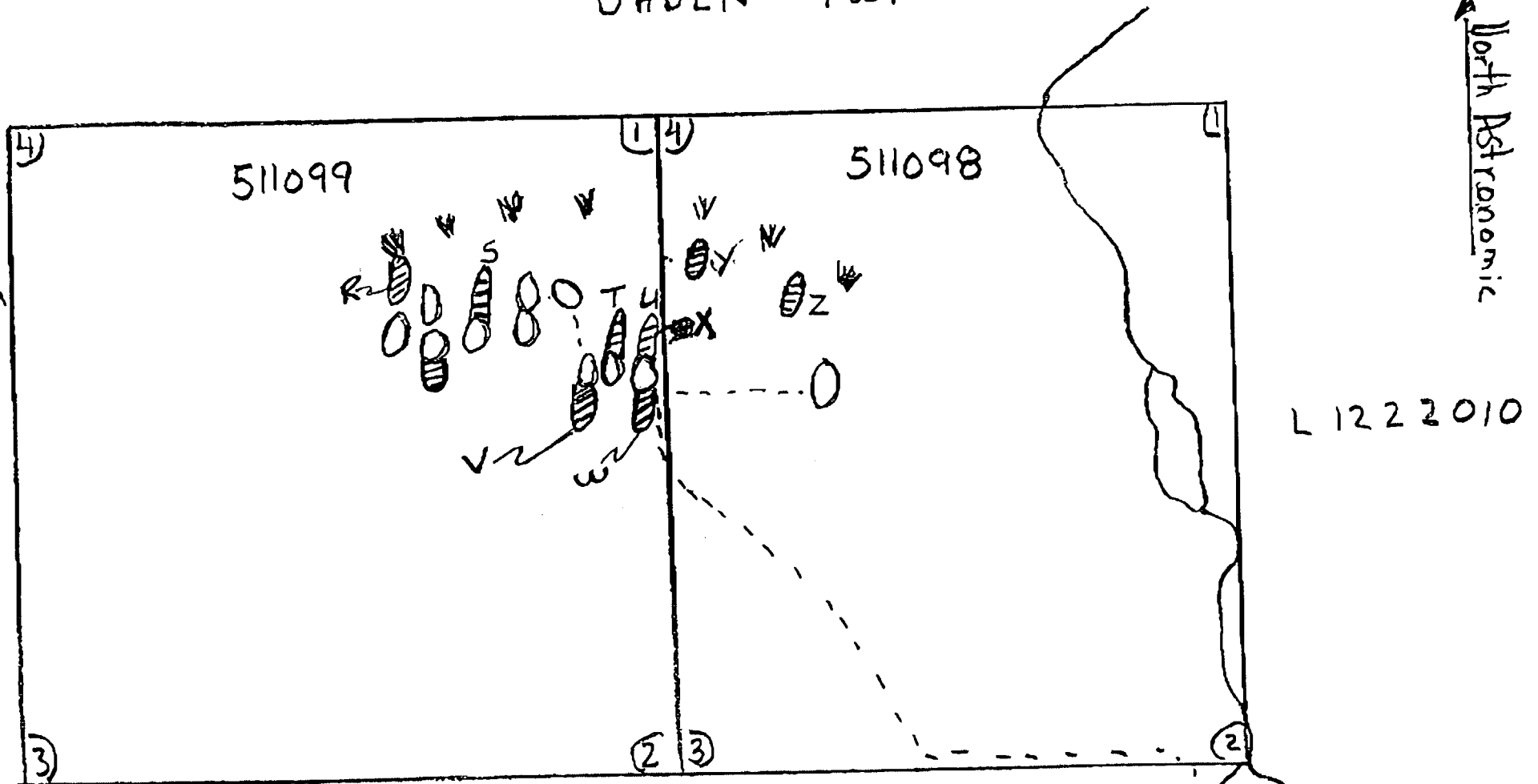

Trail -----

Trench ○ 1996

Swamp ♪ ♪

Trench 1997 x-w-z ▨ ▨ ▨

300' | 600' | 900'

1 inch = 300ft

Trench Location and Size

R	30' x 4' x 2'
S	10' x 4' x 3'
T	14' x 3' x 2'
U	12' x 3' x 2'
V	6' x 6' x 2'
W	4' x 2' x 2'
X	6' x 2' x 2'
Y	2' x 2' x 2'
Z	2' x 2' x 2'

Hydro Dam
Mistinikon Lake

1997

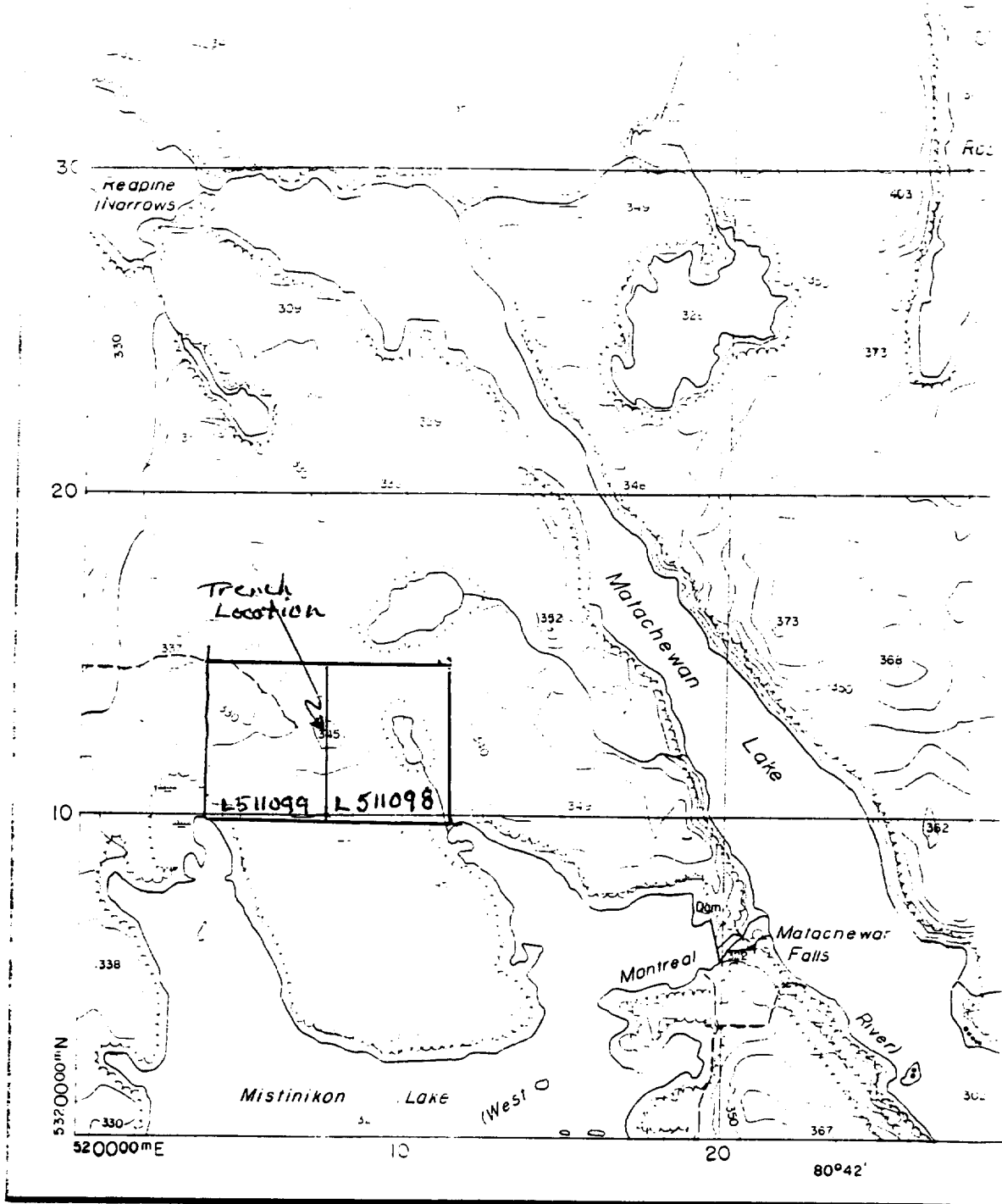

Ontario

Ministry of
Natural
Resources

Sheet

20 17 5200 53200

Map base by Surveys and Mapping Branch.
Air photography 1984. Published 1987.

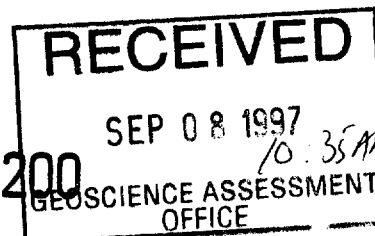

1 1320' , 1/2 mile , 3/4 mile

1 inch = 1/4 mile



Declaration of Assessment Work Performed on Mining Land

Mining Act, Subsection 65(2) and 66(3), R.S.O. 1990

Transaction Number (office use)
9780-00902
Assessment Files Research Imaging

Personal Information col Mining Act, the informati Questions about this c: 933 Ramsey Lake Road,



(3) of the Mining Act. Under section 8 of the k and correspond with the mining land holder. rthern Development and Mines, 6th Floor,

900 **2.17645**

Instructions: - For work performed on Crown Lands before recording a claim, use form 0240. - Please type or print in ink.

1. Recorded holder(s) (Attach a list if necessary)

Name <i>Ethel Welsh (50%)</i>	Client Number <i>207580</i>
Address <i>19 Govt. Rd East Apt #4 P2N1A6 Kirkland Lake.</i>	Telephone Number <i>705-567-4858</i>
	Fax Number <i>same as above</i>
Name <i>Fred Kiernicki</i>	Client Number <i>152022</i>
Address <i>Box 1143 Kirkland Lake. Ont. P2N-3M7</i>	Telephone Number
	Fax Number

2. Type of work performed: Check (✓) and report on only ONE of the following groups for this declaration.

- Geotechnical: prospecting, surveys, assays and work under section 18 (regs) **Physical: drilling, stripping, trenching and associated assays** Rehabilitation

Work Type <i>Manual Work - cleaning old trenches - clearing trenches with power saws.</i>	Office Use
	Commodity
	Total \$ Value of Work Claimed <i>1050</i>
Dates Work Performed From <i>23</i> Day <i>Aug</i> Month <i>97</i> Year To <i>24</i> Day <i>Aug</i> Month <i>97</i> Year	NTS Reference
Global Positioning System Data (if available)	Mining Division <i>Larder Lake</i>
Township/Area <i>Baden Twp</i>	Resident Geologist District <i>Kirkland</i>
M or G-Plan Number <i>M 205</i>	

- Please remember to: - obtain a work permit from the Ministry of Natural Resources as required; - provide proper notice to surface rights holders before starting work; - complete and attach a Statement of Costs, form 0212; - provide a map showing contiguous mining lands that are linked for assigning work; - include two copies of your technical report.

3. Person or companies who prepared the technical report (Attach a list if necessary)

Name <i>Fred Kiernicki</i>	Telephone Number <i>705-567-4858</i>
Address <i>Box 1143 Kirkland Lake.</i>	Fax Number <i>same as above.</i>
Name <i>Ont. P2N-3M7</i>	Telephone Number
Address	Fax Number
Name	Telephone Number
Address	Fax Number

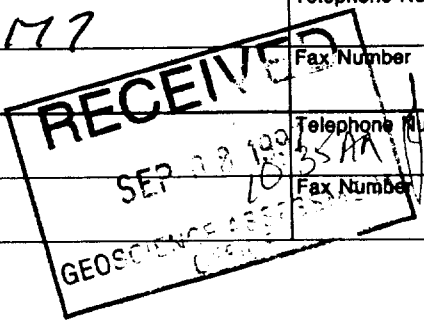

4. Certification by Recorded Holder or Agent

I, Fred Kiernicki (Print Name), do hereby certify that I have personal knowledge of the facts set forth in this Declaration of Assessment Work having caused the work to be performed or witnessed the same during or after its completion and, to the best of my knowledge, the annexed report is true.

Signature of Recorded Holder or Agent <i>Fred Kiernicki</i>	Date <i>Aug 29/97</i>
Agent's Address <i>Box 1143 Kirkland Lake</i>	Telephone Number <i>705-567-4858</i>
	Fax Number <i>same</i>

5. Work to be recorded and distributed. Work can only be assigned to claims that are contiguous (adjoining) to the mining land where work was performed, at the time work was performed. A map showing the contiguous link must accompany this form.

Mining Claim Number. Or if work was done on other eligible mining land, show in this column the location number indicated on the claim map.	Number of Claim Units. For other mining land, list hectares.	Value of work performed on this claim or other mining land.	Value of work applied to this claim.	Value of work assigned to other mining claims.	Bank. Value of work to be distributed at a future date.
eg TB 7827	16 ha	\$26,825	N/A	\$24,000	\$2,825
eg 1234567	12	0	\$24,000	0	0
eg 1234568	2	\$8,892	\$4,000	0	\$4,892
1 511098	16 Ha	\$425.00	525.00		
2 511099	16 ha	\$625.00	525.00		
3					
4					
5					
6					
7					
8					
9					
10					
11					
12					
13					
14					
15					
Column Totals		1050.-	1050.-		

2.17645

I, Fred Kiernicki (Print Full Name), do hereby certify that the above work credits are eligible under subsection 7 (1) of the Assessment Work Regulation 6/96 for assignment to contiguous claims or for application to the claim where the work was done.

Signature of Recorded Holder or Agent Authorized in Writing: Fred Kiernicki Date: Aug 29/97

6. Instructions for cutting back credits that are not approved.

Some of the credits claimed in this declaration may be cut back. Please check (✓) in the boxes below to show how you wish to prioritize the deletion of credits:

- 1. Credits are to be cut back from the Bank first, followed by option 2 or 3 or 4 as indicated.
- 2. Credits are to be cut back starting with the claims listed last, working backwards; or
- 3. Credits are to be cut back equally over all claims listed in this declaration; or
- 4. Credits are to be cut back as prioritized on the attached appendix or as follows (describe)

RECEIVED
 SEP 08 1997
 10:35 AM
 GEOSCIENCE ASSESSMENT
 OFFICE

Note: If you have not indicated how your credits are to be deleted, credits will be cut back from the Bank first, followed by option number 2 if necessary.

For Office Use Only
 Received Stamp
 97 AUG 29 PM 11 12
 MINING DIVISION

Deemed Approved Date <u>Nov 27/97</u>	Date Notification Sent
Date Approved	Total Value of Credit Approved
Approved for Recording by Mining Recorder (Signature) <u>Fred Kiernicki</u>	

Personal information collected on this form is obtained under the authority of subsection 6(1) of the Assessment Work Regulation 6/96. Under section 8 of the Mining Act, the information is a public record. This information will be used to review the assessment work and correspond with the mining land holder. Questions about this collection should be directed to the Chief Mining Recorder, Ministry of Northern Development and Mines, 6th Floor, 933 Ramsey Lake Road, Sudbury, Ontario, P3E 6B5.

Work Type	Units of Work <small>Depending on the type of work, list the number of hours/days worked, metres of drilling, kilometres of grid line, number of samples, etc.</small>	Cost Per Unit of work	Total Cost
Manual Trenching	Aug 23/97		
Chain saw Clearing	2 men manual work	2 x 100. day	200. -
	2 men chainsaw work.	2 x 150. day	300. -
	Aug 24/97		
	3 men manual work	3 x 100 day	300. -

Associated Costs (e.g. supplies, mobilization and demobilization).

Boat, motor, trailer ² 75 day x 2 days 150. ~~100~~ 45,150.00

Transportation Costs

1/2 ton truck * 50.00 day x 2 day 100. - 100. -

Food and Lodging Costs

Total Value of Assessment Work

1050.00

Calculations of Filing Discounts:

1. Work filed within two years of performance is claimable 100% of the above Total Value of Assessment Work.
2. If work is filed after two years and up to five years after performance, it can only be claimed at 50% of the Total Value of Assessment Work. If this situation applies to your claims, use the calculation below:

TOTAL VALUE OF ASSESSMENT WORK x 0.50 = Total \$ value of worked claimed.

Note:

- Work older than 5 years is not eligible for credit.
- A recorded holder may be required to verify expenditures claimed in this statement of costs within 45 days of a request for verification and/or correction/clarification. If verification and/or correction/clarification is not made, the Minister may reject all or part of the assessment work submitted.

Certification verifying costs:

I, Fred Kiernicki (please print full name), do hereby certify, that the amounts shown are as accurate as may reasonably be determined and the costs were incurred while conducting assessment work on the lands indicated on the accompanying Declaration of Work form as Fred Kiernicki (recorded holder, agent, or state company position with signing authority) I am authorized to make this certification.

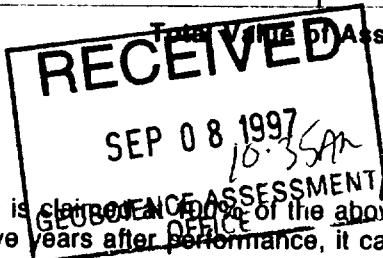

Signature: Fred Kiernicki Date: Aug 29/97

Ministry of
Northern Development
and Mines
November 28, 1997

Ministère du
Développement du Nord
et des Mines

ETHEL WELSH
19 Government Road East
Apt.#4
KIRKLAND LAKE, Ontario
P2N-1A6

Geoscience Assessment Office
933 Ramsey Lake Road
6th Floor
Sudbury, Ontario
P3E 6B5

Telephone: (888) 415-9846
Fax: (705) 670-5863

Dear Sir or Madam:

Submission Number: 2.17645

Status

Subject: Transaction Number(s): W9780.00902 Approval After Notice

We have reviewed your Assessment Work submission with the above noted Transaction Number(s). The attached summary page(s) indicate the results of the review. **WE RECOMMEND YOU READ THIS SUMMARY FOR THE DETAILS PERTAINING TO YOUR ASSESSMENT WORK.**

If the status for a transaction is a 45 Day Notice, the summary will outline the reasons for the notice, and any steps you can take to remedy deficiencies. The 90-day deemed approval provision, subsection 6(7) of the Assessment Work Regulation, will no longer be in effect for assessment work which has received a 45 Day Notice.

Please note any revisions must be submitted in DUPLICATE to the Geoscience Assessment Office, by the response date on the summary.

If you have any questions regarding this correspondence, please contact Bruce Gates by e-mail at gates_b@torv05.ndm.gov.on.ca or by telephone at (705) 670-5856.

Yours sincerely,



ORIGINAL SIGNED BY
Blair Kite
Supervisor, Geoscience Assessment Office
Mining Lands Section

Work Report Assessment Results

Submission Number: 2.17645

Date Correspondence Sent: November 28, 1997

Assessor: Bruce Gates

General Comment:

Note: All submissions under section 10 of the Regulation (physical work) require a description of the rocks and mineralization exposed in a report format as well as showing this information on a "detailed map of the workings". If only one trench or stripped area is being reported on then the information in the report will obviously refer to the new information obtained from the single trench or area. If several trenches or areas are worked on, the information in the report should refer to each trench or area separately. As the quantity of the work and assessment credit increases there should be a corresponding increase in the information supplied.

Assessment work credit is intended to reflect the quantity of work submitted to the database of the province. It is not the intent of the Regulation to accept only the location of physical work, separate from the results. Linecutting costs are not allowed unless accompanied by a geotechnical survey on the lines, nor is the costs of drilling allowed without a core log, plans and sections. In the future physical work should not be reported until the results are available.

Transaction Number	First Claim Number	Township(s) / Area(s)	Status	Approval Date
W9780.00902	511098	BADEN	Approval After Notice	November 28, 1997

Section:

10 Physical PMAN

The revisions outlined in the Notice dated November 25, 1997, have in part been corrected. Accordingly, assessment work credit has been approved as outlined on the Declaration of Assessment Work Form accompanying this submission.

Correspondence to:

Resident Geologist
Kirkland Lake, ON

Assessment Files Library
Sudbury, ON

Recorded Holder(s) and/or Agent(s):

ETHEL WELSH
KIRKLAND LAKE, Ontario

FRED STAN KIERNICKI
KIRKLAND LAKE, Ontario

Robertson Twp. M.310

Sheba Twp. M.385

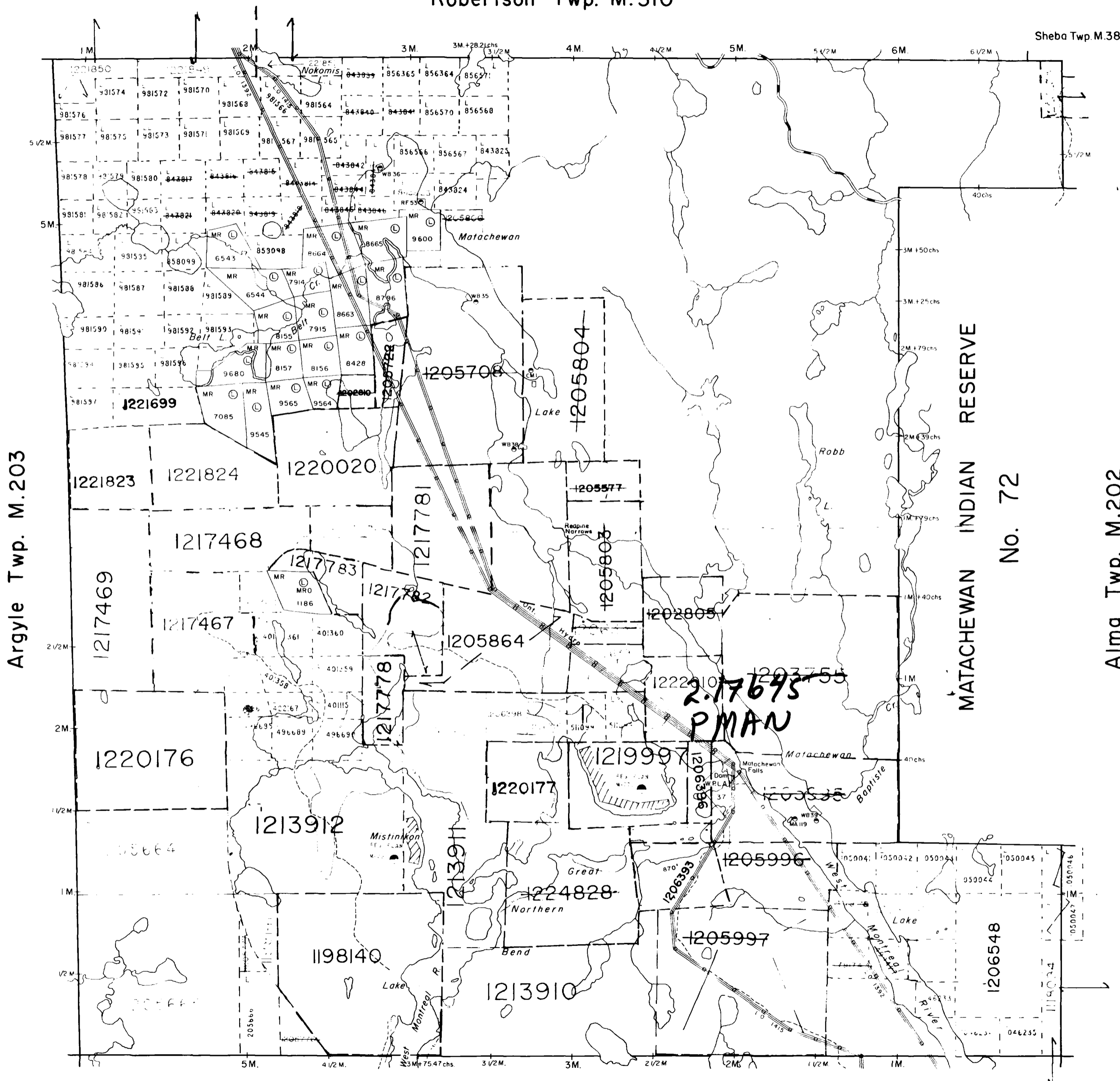

THE TOWNSHIP OF
OF
BADEN
DISTRICT OF
TIMISKAMING
LARDER LAKE
MINING DIVISION

SCALE: 1-INCH 40 CHAINS

LEGEND

PATENTED LAND	● or ⊕
CROWN LAND SALE	C.S.
LEASES	L.O.
LOCATED LAND	M.R.O.
LICENSE OF OCCUPATION	S.R.O.
MINING RIGHTS ONLY	
SURFACE RIGHTS ONLY	
ROADS	
IMPROVED ROADS	
KING'S HIGHWAYS	
RAILWAYS	
POWER LINES	
MARSH OR MUSKEG	
MINES	
CANCELLED	
PATENTED S.R.O.	

NOTES

400' surface rights reservation along the shores of all lakes and rivers.

Flooding rights to contour elevation 870 to Mt. Hydro. Sec. 100. 1229. v.2

(2) Surface and Mining Rights Withdrawn from Staking, section 36/80 order No W 65/83

PLANTING RIGHTS WITHDRAWN FROM STAKING, SECTION 36/80 ORDER NO W 65/83

PLAN NO. **M.205**

ONTARIO
MINISTRY OF NATURAL RESOURCES
SURVEYS AND MAPPING BRANCH

Argyle Twp. M.203

Alma Twp. M.202

MATACHEWAN INDIAN RESERVE
No. 72

Powell Twp. M.241