

DIAMOND DRILLING



42A02SE0121 11 ALMA

010

TOWNSHIP: Alma

REPORT NO.: 11

WORK PERFORMED BY: Northclaim Resources Inc.

<u>CLAIM No.</u>	<u>HOLE No.</u>	<u>FOOTAGE</u>	<u>DATE</u>	<u>NOTE</u>
L 495956	81-1	148.0	Oct/81	(1)
L 495956	81-2	159.0	Oct/81	(1)

NOTES: (1) #590-81

1wp.

3M

2M

1M

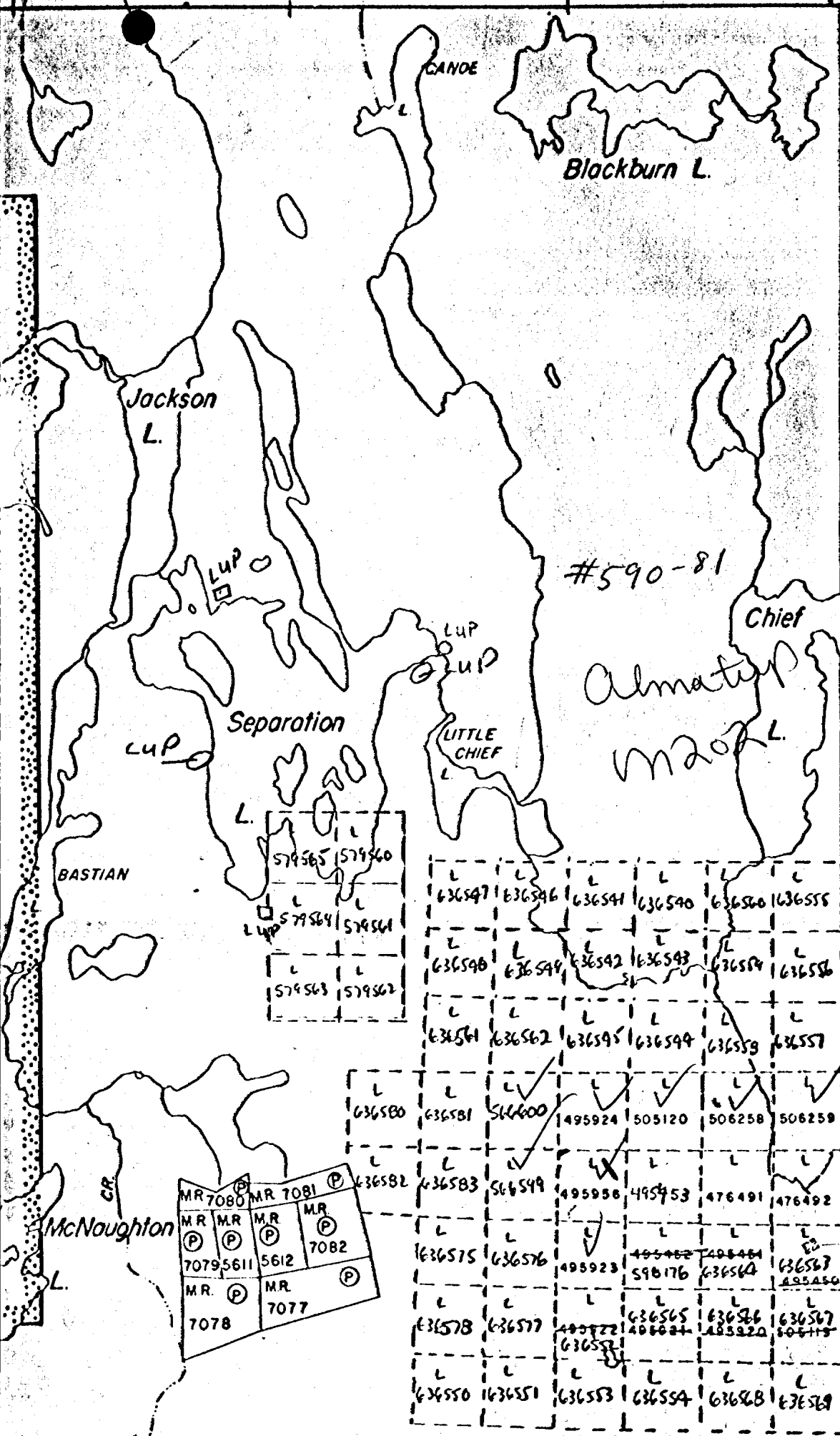

Con. 6

Con. 5

Con. 4

Con. 3

Con. 2

Holmes Twp.

SO

PAT
CR
LE
LO
LIC
MIN
SU
RO
IMP
KIN
RA
PO
MA
MIN
CA

Mot
400
rive

Gravel
Filling
181588

DIAMOND DRILL LOG

COMPANY NORTACCLAIM RESOURCES INC.

Page # 1 of 3

PROPERTY "DRAVERDAM"

N. T. S. # _____

PURPOSE OF HOLE Testing surface gold showing

Start October 21, 1981 Hole 81-1 Az. 0 Dip -40

Finish October 27, 1981 Lat. _____ Dep. _____ El. _____

Test Core Size: "AQ" 1" Length 143 Feet

Footage		Description	Sample No.	Assays.	
From	To			Gold (oz./Ton)	
0	14.0	Casing			
14.0	148.0	Syenite, brick red, often pyritic and with ubiquitous fine magnetite. Local quartz veins and brecciation, rare chalcopyrite. Details follow.			
14.0	14.3	5% disseminated pyrite, weak foliation 50° to core axis (C.A.) not sampled.			
14.3	18.5	Less than 1/2% fine pyrite			
18.5	21.4	5-8% fine pyrite, N.D. at 20.0 fault slip 10 to C.A.	4625	Tr	
21.4	32.5	Less than 1/2% fine pyrite			
32.5	35.0	8-12% fine pyrite. Brecciation and some bluish quartz stringers at various angles.	4626	.02	
35.9	37.8	Less than 1/2% fine pyrite. foliation 45 to core axis.			
37.8	38.5	Welsite dyke, pink, aphanitic, rare trace pyrite, 60° to C.A.			
38.5	42.0	Less than 1/2% fine pyrite			
42.0	42.5	3% fine pyrite			
42.5	64.5	Less than 1/2% fine pyrite			
64.5	66.5	3% fine pyrite and several bluish quartz stringers to 2" at high angles to C.A., also with sparse fine pyrite.	4627	.02	
66.5	73.8	Less than 1/2% fine pyrite, traces chalcopyrite locally.			
73.8	75.2	3% fine pyrite	4628	.02	
75.2	76.2	Less than 1/2% fine pyrite.			
76.2	76.5	1% fine pyrite, trace chalcopyrite.			
76.5	80.0	Less than 1/2% fine pyrite.			
80.0	81.5	3% fine pyrite	4629	.26	
81.5	82.2	Less than 1/2% fine pyrite			
82.2	94.0	40% quartz carbonate stringers, irregular, local disseminated pyrite to 2% over 2"	4630	.01	

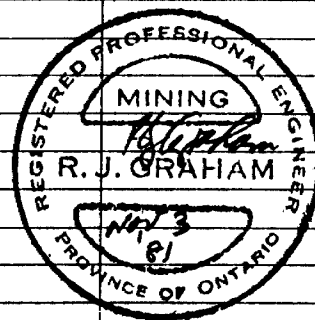

DRILLED BY: A. McKnight

LOGGED BY: R. J. Graham

McKnight Drilling Co. Ltd., Box 906, Haileybury, Ontario

DIAMOND DRILL LOG

COMPANY PORTLAND RESOURCES INC

Page # 2 of 3

PROPERTY _____

N. T. S. # _____

PURPOSE OF HOLE _____

Start _____

Hole 81-1

Az. _____

Dip _____

Finish _____

Lat. _____

Dep. _____

El. _____

Tests _____

Length _____

Footage		Description	Sample No.	Assays.	
From	To			Gold (oz./ton)	
38.5	42.0	less than 1/2% fine pyrite			
42.0	42.5	3% fine pyrite			
42.5	64.5	less than 1/2% fine pyrite			
64.5	66.5	3% fine pyrite and several bluish quartz stringers 2" at high angles to C.A., also with sparse fine pyrite.	4627	.02	
66.5	73.3	less than 1/2% fine pyrite, traces chalcopyrite locally.			
73.3	75.2	3% fine pyrite	4628	.02	
75.2	76.2	Less than 1/2% fine pyrite.			
76.2	76.5	1% fine pyrite, trace chalcopyrite			
76.5	80.0	less than 1/2% fine pyrite.			
80.0	81.5	3% fine pyrite	4629	.26	
81.5	82.2	Less than 1/2% fine pyrite			
82.2	84.0	40% quartz carbonate stringers, irregular, local disseminated pyrite to 2% over 2".	4630	.01	
84.0	92.0	less than 1/2% fine pyrite			
92.0	92.3	5% fine pyrite			
92.3	93.2	less than 1/2% fine pyrite.			
93.2	103.5	intense brecciation 5-25% pyrite as follows.			
93.2	97.2	5% pyrite.	4631	.02	
97.2	102.2	5% pyrite.	4632	.02	
102.2	103.5	25% pyrite.	4633	.01	
103.5	114.6	3% pyrite, weak brecciation	4634	.01	
114.6	115.5	60% bluish quartz, 2% pyrite	4635	.02	
115.5	118.5	less than 1/2% pyrite	4636	Tr	
118.5	120.2	5% fine pyrite	4637	Tr	
120.2	133.3	Vol. breccia zone, 70% quartz, bluish, less than 1% pyrite on average but up to 3% locally. Details follow.			
120.2	125.0	3% fine pyrite	4638	.01	
125.0	130.0	less than 1/2% pyrite. At 123.0 core shattered, probable fault.			

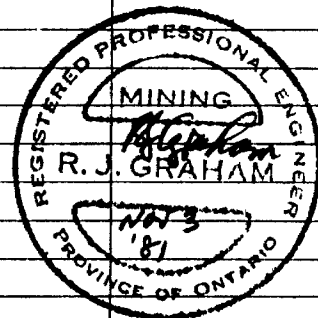

DRILLED BY: _____

LOGGED BY: _____

R. J. Graham

DIAMOND DRILL LOG

COMPANY NORTHCLAIM RESOURCES INC. Page # 1 of 2

PROPERTY "BEAVERDAM" N. T. S. # _____

PURPOSE OF HOLE TESTING SURFACE GOLD SHOWING

Start October 29, 1981 Hole 81-2 Az. 180 Dip -45

Finish October 31, 1981 Lat. _____ Dep. _____ El. _____

Tests Core Size: "AQ" 1" Length 159 feet

Footage		Description	Sample No.	Assays.	
From	To			Gold (oz/ton)	
0	7.0	Casing			
7.0	159.0	Syenite, pink to grey, locally pyritic, with fine magnetite throughout. Occasional quartz carbonate veins and stringers. Weak foliation 30-50 to core axis (C.A.) Details follow.			
19.0	19.3	One 3" quartz stringer, 90 to core axis. Trace pyrite			
31.5	32.5	5% disseminated pyrite.			
at	47.5	Trace disseminated galena and chalcopyrite.			
54.5	60.0	20" quartz carbonate stringers to 2". Trace pyrite, galena, chalcopyrite.	4641	Tr	
60.0	65.0	50% Quartz vein. Local pyrite galena, chalcopyrite.	4642	Tr	
65.0	72.0	80% Quartz carbonate vein, gray to bluish.	4643	Tr	
70.0	75.0	50% quartz carbonate vein	4644	Tr	
75.0	77.3	Sparse weak quartz carbonate threads. Less than 1/2% pyrite			
80.0	83.3	Sparse, weak quartz threads. Less than 1/2% fine pyrite.			
93.3	95.3	Dyke, dark green, hard, aphanitic, 80°, 40° contacts to core axis. Unmineralized.			
95.3	112.5	Less than 1/2% pyrite. Rare quartz carbonate threads.			
112.5	113.7	50% quartz carbonate vein, 40° to core axis. Less than 1% pyrite. Trace galena and chalcopyrite.	4645	.02	
113.7	141.0	Trace pyrite (except 139.2 - 140.2=2.0)			

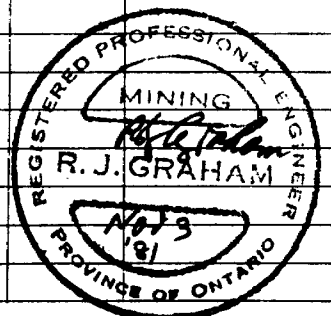

DRILLED BY: L. McKnight LOGGED BY: R. J. Graham

McKnight Drilling Co. Ltd., Box 906, Haileybury, Ont.

WORK SKETCH SHOWING LOCATION OF
DIAMOND DRILL HOLES #81-1 and 81-2
DRILLED BY NORTHCLAIM RESOURCES INC.

ALMA TOWNSHIP, ONTARIO

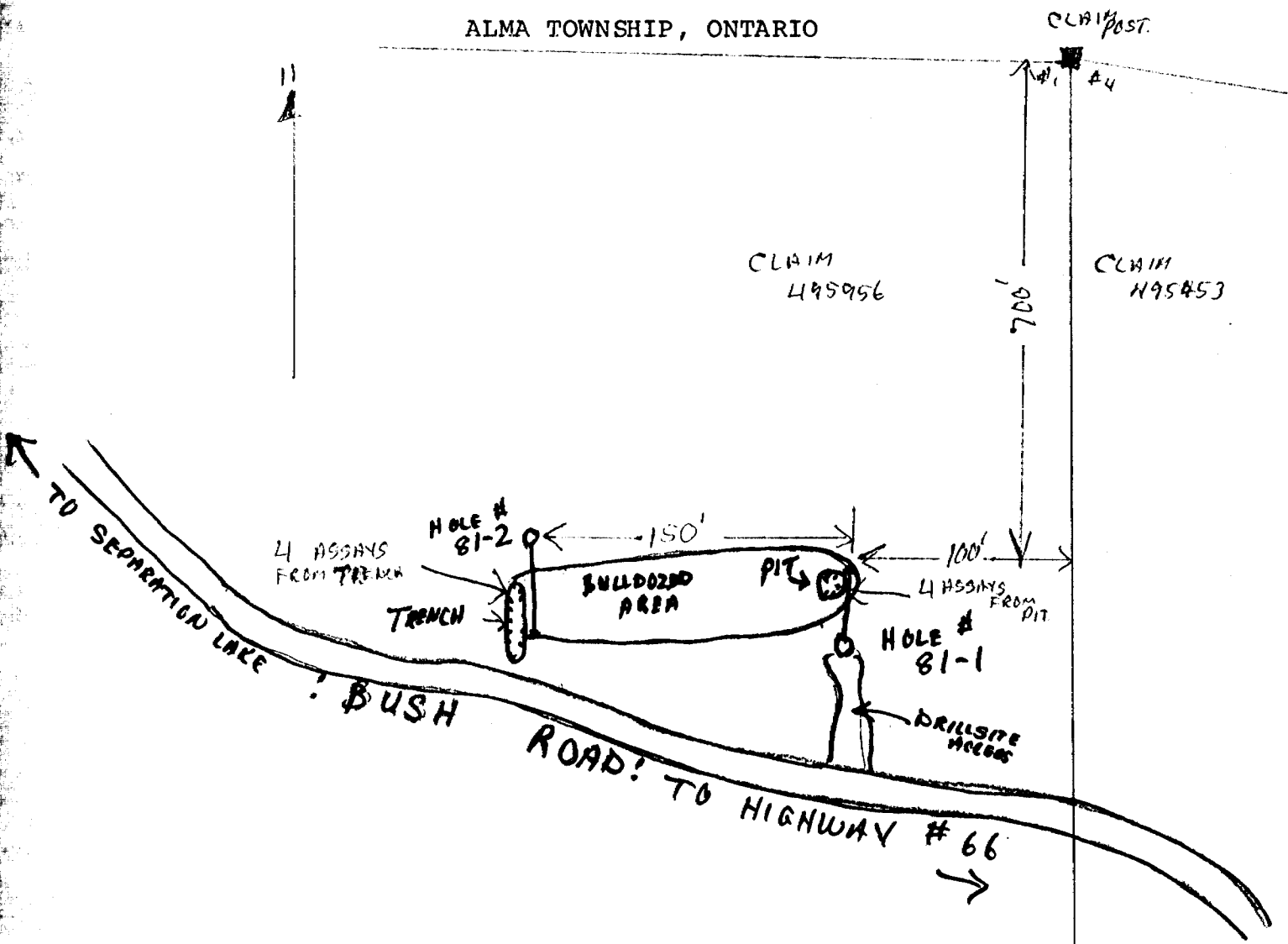

Eric J. Plesman

CLAIM POST

SOUTH

81-1

40°

SURFACE FOLD SHOWING

81-2

45°

NORTH

8-12% PY
Brecciated
Felsite Dyke 60°

20-80% Vein

5% PY

3% PY

3% PY
0.26/1.5
(oz/ton/FE)

80°
Dyke

Brecciated A: 5% PY
A: 25% PY

3-25% PY A: 3% PY
60% Quartz

5% PY
3% PY
Fault

50% Vein

0.09/8.0
(oz/ton/FE)

148.0

3% PY

5' Fault

5' PY

159.0



NORTHCLAIM RESOURCES INC.
BEAVERDAM PROPERTY
MATACHEWAN ONTARIO

Scale

0 Feet. 20' North 81.