



42A02SE0130 13 BADEN

010

Diamond Drilling

Township of BADEN

Report NO: 13

Work performed by: Mid-North Engineering Services

Claim NO	Hole NO	Footage	Date	Note
L 267333	LR-1	503'	Feb/76	(1)
L 267332	LR-2	303'	Mar/76	(1)
	LR-3	300'	Mar/76	(1)
	LR-5	250'	Mar/76	(1)
L 353679	LR-4A	301'	Mar/76	(1)

5/1657'

Notes:

(1) #182-76

Argyle Twp. M.203

#182-76
BADEN TWP.

MID-NORTH ENGINEERING SERVICES LTD.

9599

MR 9877

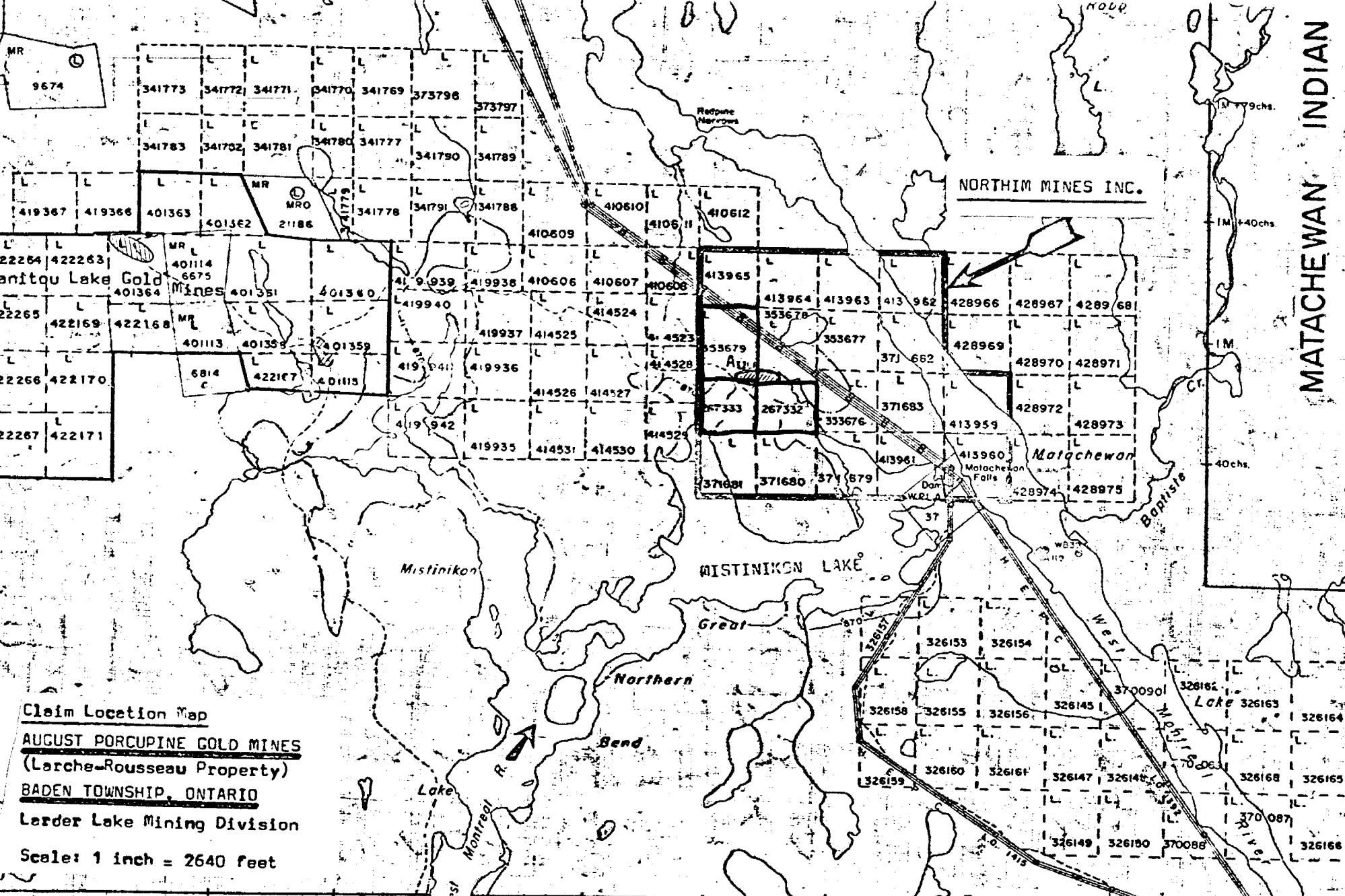

Claim Location Map
AUGUST PORCUPINE GOLD MINES
 (Larche-Rousseau Property)
BADEN TOWNSHIP, ONTARIO
 Larder Lake Mining Division
 Scale: 1 inch = 2640 feet

5M. 4 1/2 M. 3 1/2 M. 3M. 2 1/2 M. 2M. 1 1/2 M. 1M.

To Hwy. 566

To Hwy. 566

Powell Twp. M.241

MATACHEWAN INDIAN

No. 72

Alma Twp. M.202

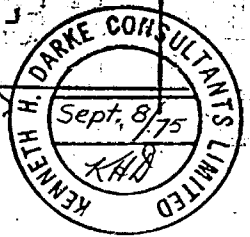

Northim Mines Inc.
Drill Hole Location Sketch
LARCHE-ROUSSEAU PROPERTY
BADEN TOWNSHIP, ONTARIO
Larder Lake Mining Division

Scale: 1 inch = 100 feet

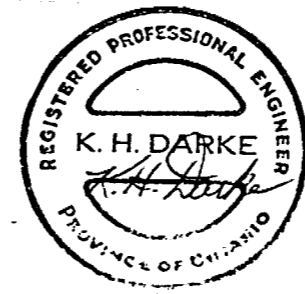
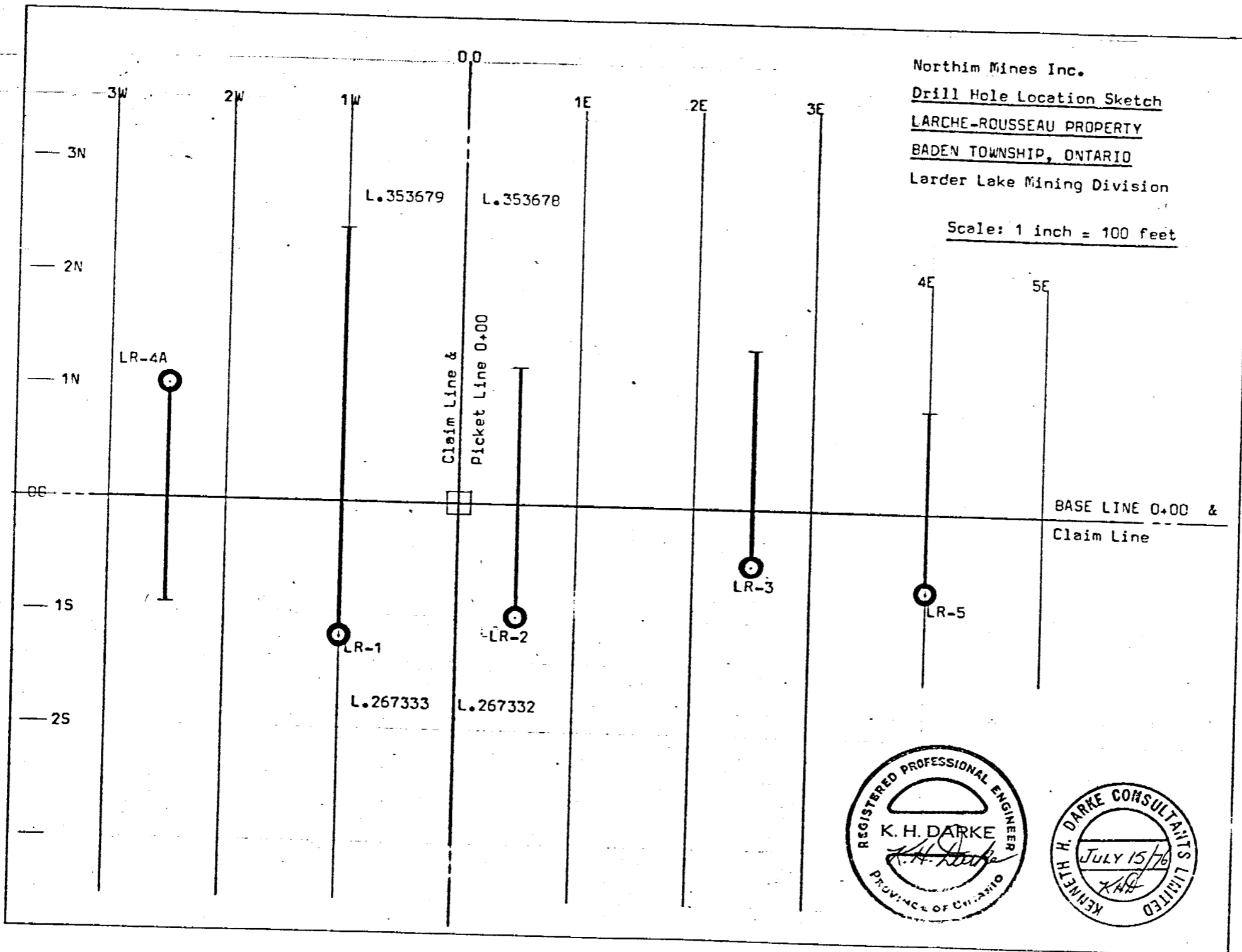

CLAIM LOCATION MAP

353679	353678	353677	371682
267333	267332	353676	371683
371681	371680	371679	

Location of Detailed Assay Plan Map

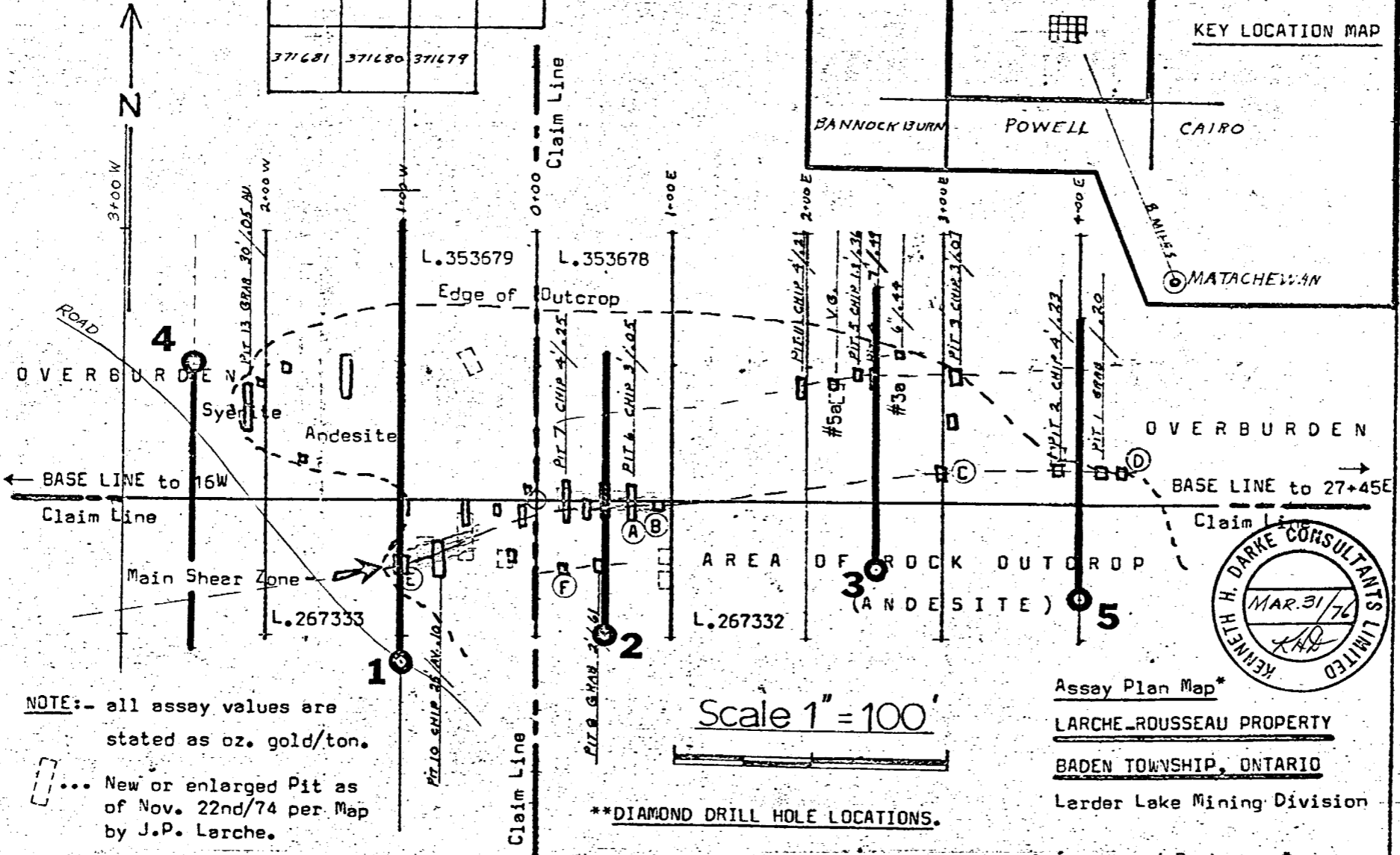
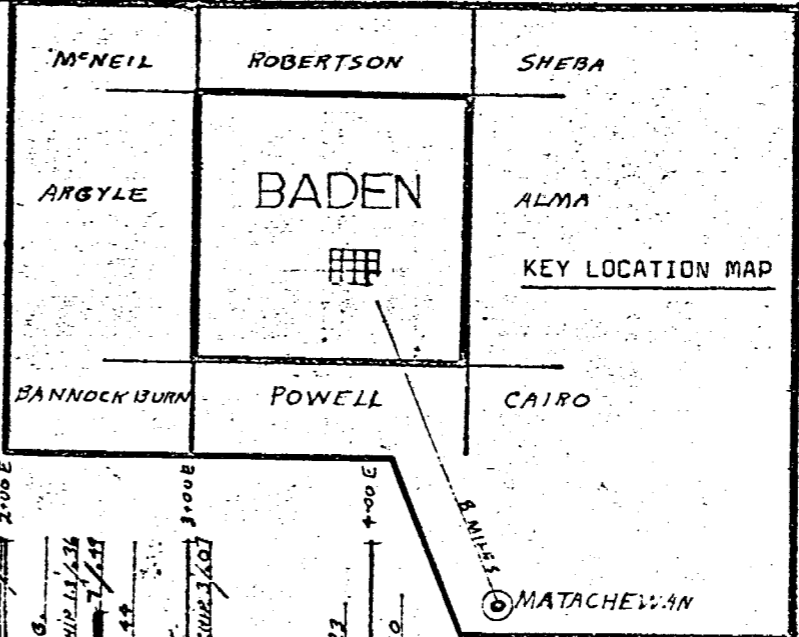

NOTE:- all assay values are stated as oz. gold/ton.

... New or enlarged Pit as of Nov. 22nd/74 per Map by J.P. Larche.

ⓑ ... Pit sampled by Sylvanite, 1940

Scale 1" = 100'

**DIAMOND DRILL HOLE LOCATIONS.

*Modified in part by K.H. Darke, P.Eng., Dec. 5, 1974

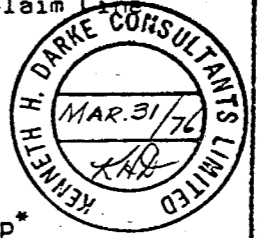

Assay Plan Map*
 LARCHE-ROUSSEAU PROPERTY
 BADEN TOWNSHIP, ONTARIO
 Larder Lake Mining Division

J.P. Larche*
 July 27, 1973

LARCHE-ROUSSEAU PROPERTY
BADEN TOWNSHIP, ONTARIO

NORTHIM MINES INC.
D. D. HOLE No. LR-1

Loc. Claim # 267333 Dip collar : 45° Bearing collar : Due North Length: 503 ft.
1+00 W 500' : 17° : Collar el. :
1+20 S : : Bottom el. :

Drilled by: Hosking Core size: AQ Begun: Feb. 25th/76 Ended: Mar. 4th/76 Logged by: K.H. Darke, P. Eng.

Samples	Footage drilled				Geology
	From	To	Len.	Rec.	
	0	25	25	% 0	OVERBURDEN
	25				Altered ANDESITE: schistose; dark & light green mottled texture due to carbonate & chloritic alteration; scattered zones of lt. green, hard (siliceous) alteration which probably represents peripheral phase of adjacent PORPHYRY(Syenite) INTRUSIVE; cross-cutting Quartz-Carbonate stringer veins with disseminated Pyrite cubes & a few blebs Chalcopyrite & Specular Hematite in places. 34':- rough schistosity (banding) @ 58° to core axis. 40':- " " " @ 53° " " " . 49-54':- disseminated Pyrite & a few Qtz. stringers. 66':- diss. Py; banding (sch.) @ 58° to c.e. 69-69.7':- Qtz-Carb. strgs. with minor Fuchsite.
	70	70	45	100	Highly Altered ANDESITE: schistose; abundant Carbonate alteration gives mottled & banded appearance; scattered Qtz-Carbonate stringer veinlets with Py cubes. 76':- well developed schistosity @ 66° to c.e. 76.1-.4':- Qtz-Carbonate zone. 75.6-76':- slight reddish (Hematitic) colouration; may be highly altered PORPHYRY (Syenite) strg. 84':- Banding (Carbonate alteration) @ 69° to c.e. 106':- Qtz. Strg. (1/2") with Py cubes. 108':- rough schistosity @ 65° to c.e. 108.5':- gash strg. of Qtz. with blebs Cpy 109':- Qtz. strg. (1/2") with Py cubes. 118':- Qtz. strg. (3/8").
	120	120	50	100	Brecciated; Highly Altered ANDESITE: abundant Carbonate alteration; a few Qtz. stringers; disseminated (coarse & fine) Pyrite cubes; a few vuggy zones ... probably represents a flow top.
	145	145	25	"	Altered ANDESITE: mottled texture due to Carbonate alteration; a few specks Py & Cpy in hairline fractures with Qtz-Carbonate.
	206	206	61	"	Altered ANDESITE:- bands of Carbonate alteration; (1/16" a few disseminated Pyrite cubes. 209':- banding @ 81° to c.e.
	216	216	10	"	ANDESITE: a few carbonate alteration zones.
	224	224	8	"	
	...	continued in	Page 2.		

D. D. Hole No. LR-1



Loc. Dip collar : Bearing collar : Length: 503 ft.
..... : : Collar el. :
..... : : Bottom el. :

Drilled by: Core size: Begun: Ended: Logged by: K.H. Darke, P. Eng.

Samples	Footage drilled				Geology
	From	To	Len.	Rec. %	
	224	250.2	26.2	100	Altered ANDESITE; mottled texture (carbonate alt.).
	250.2	250.9	Flow Contact Zone; rusty-weathering fractures.
	250.9				ANDESITE; amygdaloidal flow top; thin, Qtz-Carbonate stringers.
		265	14.1	"	
	265				Highly Altered ANDESITE; mottled texture due to abundant Carbonate alteration; a few Qtz-Carb. stringers.
		295	30	93	287-90':- core ground; 30% recovery. (Fault Zone ?)
	295				ANDESITE; fine-grained; scattered Qtz-Carb. strgs.
		315	20	100	298':- Qtz-Carb. strg. (1"); diss. Py cubes.
	315				Highly Altered ANDESITE; mottled texture due to abundant carbonate alteration; a few Qtz-Carb. strgs.
		328	13	"	
	328				ANDESITE; fine-grained; generally unaltered.
		359	31	"	354-55':- Qtz-Carbonate strgs. with blebs Py, Cpy.
	359				Altered ANDESITE; mottled texture; a few Qtz-Carbon. stringers; disseminated Pyrite in places.
					428.2-29.2':- Qtz-Carbon. strgs. with diss. Py.
					442.5-43.5':- " " ; 5% Py as blebs & along hairline fractures.
					446.2-47.4':- 10% Py as fine cubes.
					451.8-52.8':- diss. Py & hline Calcite strgs.
					494.2-96':- 10% Py as fracture fillings & local concentrations.
		503	44	"	
	E N D O F H O L E				



LARCHE-ROUSSEAU PROPERTY
BADEN TOWNSHIP, ONTARIO

NORTHIM MINES INC.
D. D. HOLE No. LR-2

Loc. Claim # 267332 Dip collar : 45° Bearing collar : Due North Length: 303 ft.
0.50 E 300' 25° Collar el. :
1.00 S Bottom el. :

Drilled by: Hosking Core size: AQ Begun: Mar. 9th/76 Ended: Mar. 11th/76 Logged by: K.H. Darke, P. Eng.

Samples	Footage drilled				Geology
	From	To	Len.	Rec. %	
	0	8.0	8.0	0	OVERBURDEN
	8.0				Highly Altered ANDESITE: mottled texture due to abundant Carbonate alteration (dark green matrix with creamy-white blebs & zones); a few thin Quartz-Carbonate stringers; disseminated Pyrite cubes.
	38		30	100	Altered ANDESITE Flow Top: 30% Quartz (white, barren); disseminated Pyrite as cubes & blebs (5% in places).
	41.6		3.6	"	Altered ANDESITE: local zones of Carbonate alteration; scattered Quartz & Qtz-Carbonate stringers.
	71		29.4	"	51':- rudimentary schistosity @ 65° to core axis. 51':- Qtz. strg. (2") @ 87° to c.a. 54.9':- Qtz. strg. (7") @ 9° to c.a. 71':- Qtz-Carbonate strg. (1/2") @ 58° to c.a.
	71				Highly Altered ANDESITE: mottled texture due to abundant Carbonate (creamy-white) blebs; scattered Qtz-Carbonate stringer veinlets & fracture fillings.
	112		41	"	71-75':- a few, thin Qtz-Carbonate stringers. 94':- Qtz-Carb. strg. (1/2") with 10% Chalcopyrite-Pyrite blebs @ 60° to c.a. 96.7':- Calcite strg. (1/2") @ 66° to c.a.
	112				ANDESITE Flow Top: 5% Pyrite as thin fracture fillings @ 57° to core axis.
	113		1.0	"	ANDESITE: massive, dark green with disseminated Pyrite cubes & a few, thin Quartz-Carbonate stringers.
	190		77	"	118':- Rudimentary schistosity (lineation) & thin Qtz-Carb. strgs. @ 61° to c.a. 126':- Qtz-Carb. strg. (2") with 5% Py @ 63° to c.a.
	190				Altered ANDESITE: numerous, small crenulated blebs Carbonate.
	208		18	"	ANDESITE: dark green; generally massive.
	255		47	"	ANDESITE Flow Top (?): blocky, broken ground; vuggy Quartz stringer (2").
	257		2.0	50	ANDESITE: generally massive, dark green; some Carbonate alteration.
	303		46	100	numerous 1/8-1" Calcite strgs.

END OF HOLE



D. D. Hole No. LR-2

LARCHE-ROUSSEAU PROPERTY
BADEN TOWNSHIP, ONTARIO

NORTHIM MINES INC.
D. D. HOLE No. LR-3

Loc. Claim # 267332 Dip collar : 50° Bearing collar : Due North Length: 300 ft.
2+50 E 300' : 26° Collar el. :
0+50 S Bottom el. :

Drilled by: Hosking Core size: AQ Begun: Mar. 18th/76 Ended: Mar. 20th/76 Logged by: K.H. Darke, P. Eng.

Samples	Footage drilled				Geology
	From	To	Len.	Rec. %	
	0	12	12	0	OVERBURDEN
	12				Highly Altered ANDESITE: mottled texture due to abundant Carbonate alteration which forms matrix in places; scattered Quartz-Carbonate stringers; disseminated Pyrite in places.
					12-14': - rusty weathering, vuggy, blocky ground (90% recovery); a few Carbonate stringers.
					25.4': - 4" of 20% Qtz-Carb. with minor Py; rusty fractures.
					29.4': - 3" of 50% Qtz-Carb. + 20% Py, minor Chalcopyrite.
					44.2': - 3" of rusty-weathering Py stringers.
					46-47': - core ground (10% recovery); fault Zone ?
		68	56	98	49.2': - a few, thin Qtz-Carb. strgs. (4") with Py.
					55': - Qtz. strg. (1/2") with Hematitic alteration.
	68				Altered ANDESITE Flow Top: local zones of Carbonate alteration & Quartz-Carbonate stringers.
					68-70': - 40% Qtz-Carb. with 3% Py as cubes & fracture fillings.
					73.9': - Qtz-Carb. strg. (1/2") @ 57° to core axis.
					74': - Schistosity & hairline Py strgs. @ 68° to c.a.
		76	8	100	75.8': - Qtz-Carb. strg. (2") with Py @ 72° to c.a.
	76				Altered ANDESITE: mottled texture due to Carbonate alteration; coarse grained in places.
		96	20	"	78': - Qtz-Carb. strg. (1/2") @ 35° to core axis.
	96				Altered ANDESITE: local zones of Carbonate alteration; scattered Quartz-Carbonate stringers.
					104': - Qtz-Carb. strg. (1/2") with Py @ 38° to c.a.
					125.6': - Qtz-Carb. strg. (2") with 10% Cpy, Py (oxidized) @ 55° to c.a.
					133': - Qtz. Carb. strgs. @ 42° & 49° to c.a.
		214	118	"	139': - Qtz-Carb. strg. (1") & Py strgs. @ 53° to c.a.
					175-181': - 10% Qtz-Carb. stringers.
	214				Silicified ANDESITE: bleached along fractures.
					218': - Qtz. strg. (2") @ 41° to c.a.
					226-28': - 15% Qtz-Carb. stringers.
					226.8': - Qtz. strg. (2") @ 41° to c.a.
					238.6': - Basic Dike (5"), black, hard, aphanitic.
					246.2': - " " (2")
					264': - " " (10")
		268	54	"	265-73': - numerous Basic Dikes (1" - 6")
	268	275	7	"	ANDESITE: coarse grained.
	275				Altered ANDESITE: local zones of Carbonate alteration.
		300	25	"	
	E N D O F H O L E				

D. D. Hole No. LR-3



LARCHE-ROUSSEAU PROPERTY
BADEN TOWNSHIP, ONTARIO

NORTHIM MINES INC.
D. D. HOLE No. LR-4A

Loc. Claim # 353679 Dip collar : 50° Bearing collar : Due South Length: 301 ft.
2+50 W 300' : 11° Collar el. :
1+00 N Bottom el. :

Drilled by: Hosking Core size: AQ Begun: Mar. 23/76 Ended: Mar. 24/76 Logged by: K.H. Darke, P. Eng.

Samples	Footage drilled				Geology
	From	To	Len.	Rec.	
	0	17	17	% 0	OVERBURDEN
	17				Highly Altered PORPHYRY (Syenite): local zones of Highly Altered ANDESITE; schistose; abundant Carbonate & some Sericite alteration; some Fuchsite; numerous, thin Quartz-Carbonate stringer veinlets. 17':- Carbonate stringers @ 0-20° to core axis. 19-21':- 20% Qtz. as contorted strgs. (1/2" to 1"); abundant Fuchsite; disseminated Py as small cubes. 24-26':- a few scattered Qtz. strgs. + diss. Py. 27.6':- Qtz. strg. (2") @ 55° to c.a. 28':- Schistosity @ 32° to c.a. 29-31':- 50% Qtz-Carb. strgs.; diss. Py.
		46	29	100 Contact Zone @ 18° to core axis.
	46				PORPHYRY (probably peripheral phase of adjacent SYENITE INTRUSIVE): highly siliceous, aphanitic matrix with Quartz eyes; light to dark grey with local reddish (Hematitic) & brown (Carbonate) colouration; minor disseminated Pyrite throughout. 53-65.4':- highly altered with abundant carbonate. 65.4-69':- red (Hematitic) colouration; Qtz. eyes; diss. Py. 69-107':- Carbonated; brown to yellow bleaching along fractures. 89.8-92.2':- a few thin Qtz-Carb. strgs. (1/2"); 2% Py. 95-96':- " " " (1/2-1/2"); Py cubes. 108':- rough schistosity @ 50° to c.a.
	46				Highly Altered PORPHYRY & ANDESITE: schistose & chloritic; a few, thin Quartz-Carbonate stringers throughout.
		151	43	"	130.6':- Qtz-Carb. strg. (1/2") @ 50° to c.a.
	151				Altered ANDESITE: schistose; abundant Carbonate alteration in places; scattered Qtz-Carb. stringers. 168':- Schistosity @ 50° to c.a. 180':- Qtz-Carb. strg. (1/2") @ 40° to c.a. 187':- Sch. @ 46° to c.a. 193':- Qtz-Carb. strg. (1/2") @ 48° to c.a. 210':- Sch. @ 49° to c.a. 240.8':- Qtz-Carb. strg. (1/2") @ 34° to c.a. (opposes sch.) 266-72':- broken rock in places; rusty fractures; Fault Zone. 269-71':- 15% Qtz-Carb. as contorted stringer veins. 272':- Qtz-Carb. strg. (1") @ 50° to c.a.; parallel to sch. 284':- " " (1/2"); contorted.
		301	50	"	
	END OF HOLE				

D. D. Hole No. LR-4A



LARCHE-ROUSSEAU PROPERTY
BADEN TOWNSHIP, ONTARIO

NORTHIM MINES INC.
D. D. HOLE No. LR-5

Loc. Claim # 267332 Dip collar : 50° Bearing collar : Due North Length: 250 ft.
4.00 E 250' : 38° Collar el. :
0+70 S Bottom el. :

Drilled by: Hosking Core size: AQ Begun: Mar. 27/76 Ended: Mar. 31/76 Logged by: K.H. Darke, P. Eng.

Samples	Footage drilled				Geology
	From	To	Len.	Rec. %	
	0	4	4	0	OVERBURDEN
	4				Highly Altered ANDESITE: mottled texture due to creamy-white Carbonate blebs & alteration zones; a few Quartz-Carbonate stringer veinlets; disseminated Pyrite.
					12' :- Schistosity @ 52° to core axis. 42.6-45.6' :- a few Qtz-Carb. strgs.; 2% diss. Py 61' :- Sch. @ 61° to c.a. 62-63' :- a few Qtz-Carb. strgs.; diss. Py. 66-76' :- Brecciated; Shear Zone 66.1-69.3' :- a few Qtz-Carb. strgs. (1/4"-1"). 76.7-77.9' :- two Qtz-Carb. strgs. (1/2" & 3"). 79' :- more massive non-schistose rock.
	104	110	6	50 Contact Zone; core ground
	110				PORPHYRY (probably peripheral phase of adjacent SYENITE INTRUSIVE); aphanitic matrix; massive (non-schistose); dark grey; a few Quartz-Carbonate stringers; disseminated Pyrite.
	204		94	100	151-151.6' :- two Qtz-Carb. strgs. (1/4") @ 59° to c.a. 203' :- minor sch. @ 68° to c.a.
	204			 Contact irregular; carbonated.
	204				DIABASE DIKE; dark greenish-black; fine grained; massive (non-schistose); finely diss. Pyrite; magnetic.
	250		46	100	226' :- hairline fractures @ 43° to c.a. with minor chlorite & carbonate alteration.
	E N D O F H O L E				



D. D. Hole No. LR-5