

63.928

REPORT ON

ELECTRICAL RESISTIVITY SURVEY

OF

BADEN POWELL

MATACHEWAN AREA,

FOR



42A025E0145 63.928 BADEN

010

GEO-SCIENTIFIC PROSPECTORS LIMITED

BY

GEOPHYSICAL ENGINEERING & SURVEYS LIMITED

PROPERTY

The property consists of 25 claims MR23453 to MR23472, MR23484 to MR23487 and MR26999 located in Baden and Powell townships, District of Timiskaming, Province of Ontario.

The claims are most easily accessible by boat from the village of Matachewan along Matachewan Lake, a distance of about 6 miles.

GEOPHYSICAL SURVEY

An electrical resistivity survey was carried out along north-south picket lines spaced 400 feet apart. Sixty cycle alternating current was introduced into the earth through electrodes spaced four miles apart in a north-south direction. Voltage drops were read between stations 100 feet apart using a vacuum-tube voltmeter. The apparent average earth resistivity in the vicinity of each station was calculated and plotted logarithmically on Drawings # 1156 and 1157.

A self-potential survey was made of a local area of low resistivity near the western boundary of the property.

GENERAL GEOLOGY

The claims are underlain by Keewatin-type volcanic rocks which include andesites, rhyolites, agglomerate and tuff. Small

porphyry dikes have been found in the N.E. section of the property. North-south trending diabase dikes cut the above-mentioned rocks.

A major N.W. trending fault is believed to traverse the claims along the Montreal River.

DISCUSSION OF GEOPHYSICAL RESULTS

One local area of low resistivity near the western end of the baseline was believed to be sufficiently interesting to justify further work. A self potential check was made in this anomaly area with negative results.

CONCLUSIONS AND RECOMMENDATIONS

The geophysical work did not indicate any anomalies that could be interpreted as the expression of sizeable sulphide concentrations. No further work is, therefore, recommended.

Respectfully submitted,

December 16, 1957
North Bay, Ontario.



J. C. Frantz
GEOPHYSICAL ENGINEERING & SURVEYS LTD.

RESISTIVITY SURVEY
OF
POWELL - BADEN PROPERTY
 MATACHEWAN AREA, ONT.
 FOR
GEO-SCIENTIFIC PROSPECTORS LIMITED
 BY
GEO-PHYSICAL ENGINEERING & SURVEYS LTD.

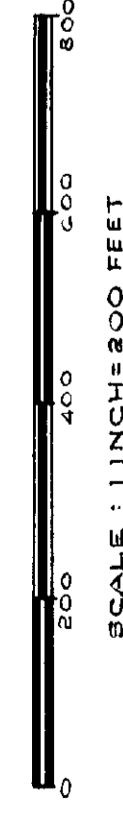

NOTE: VALUES ARE APPARENT AVERAGE
 EARTH RESISTIVITIES AS 100 IN. 100 OHM-CM.

(NORTH SHEET)

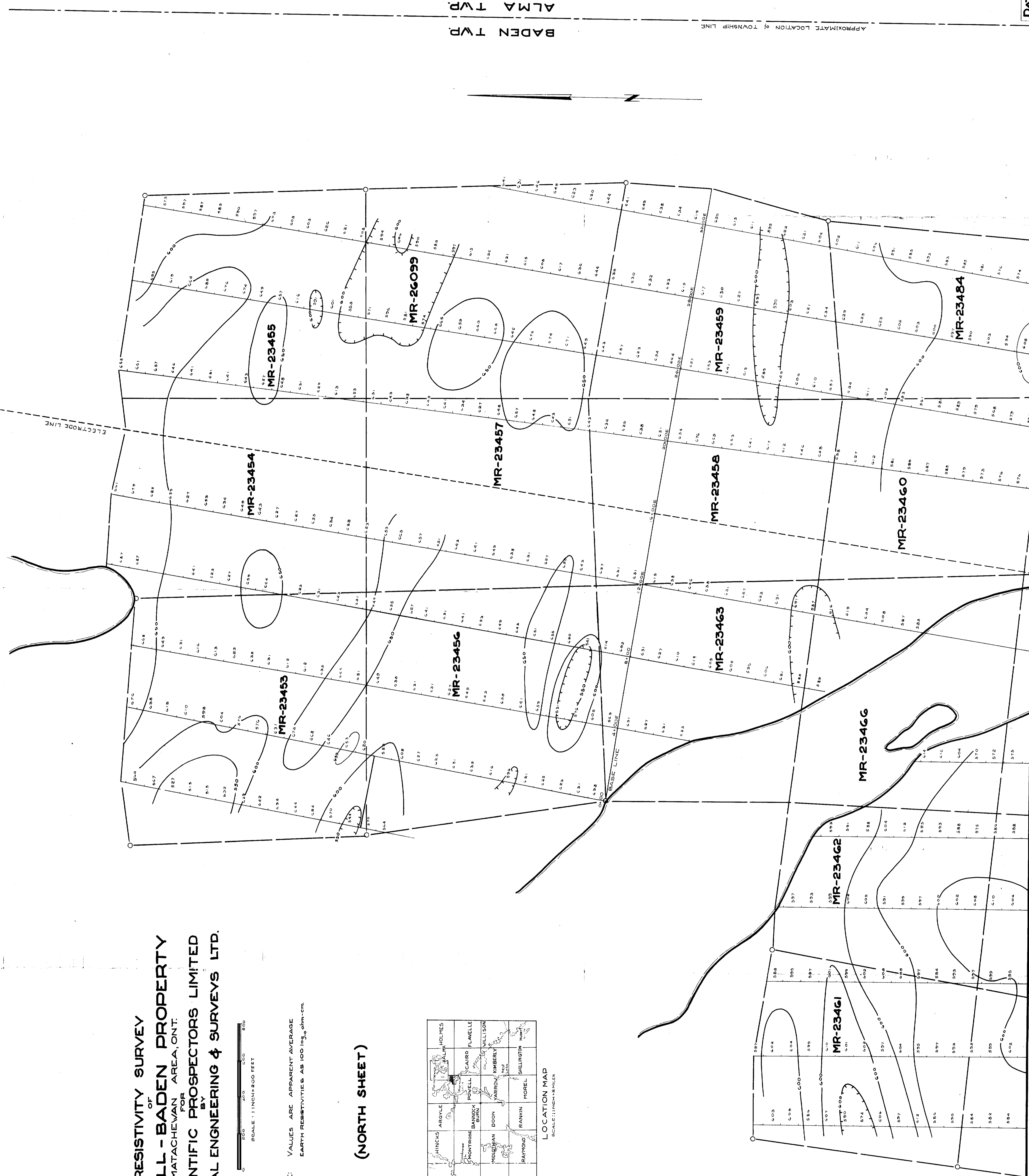
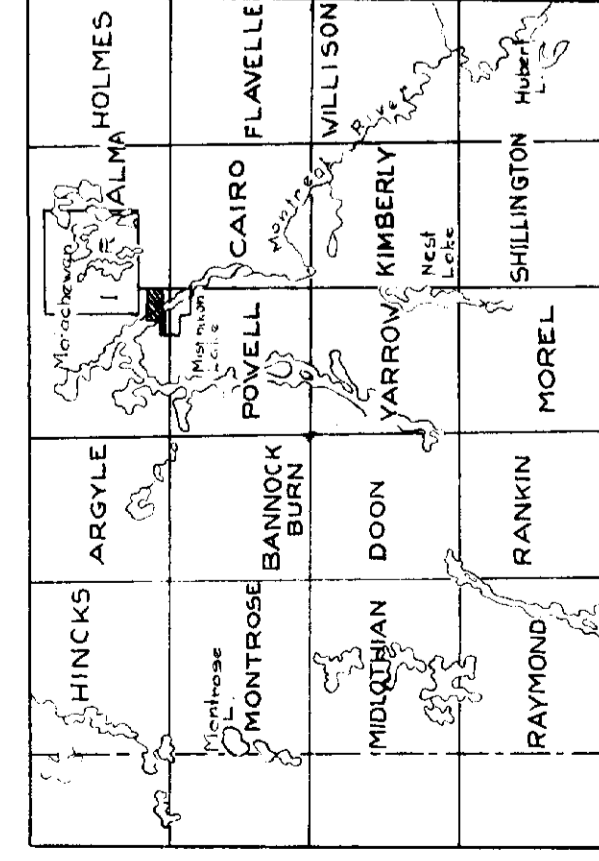

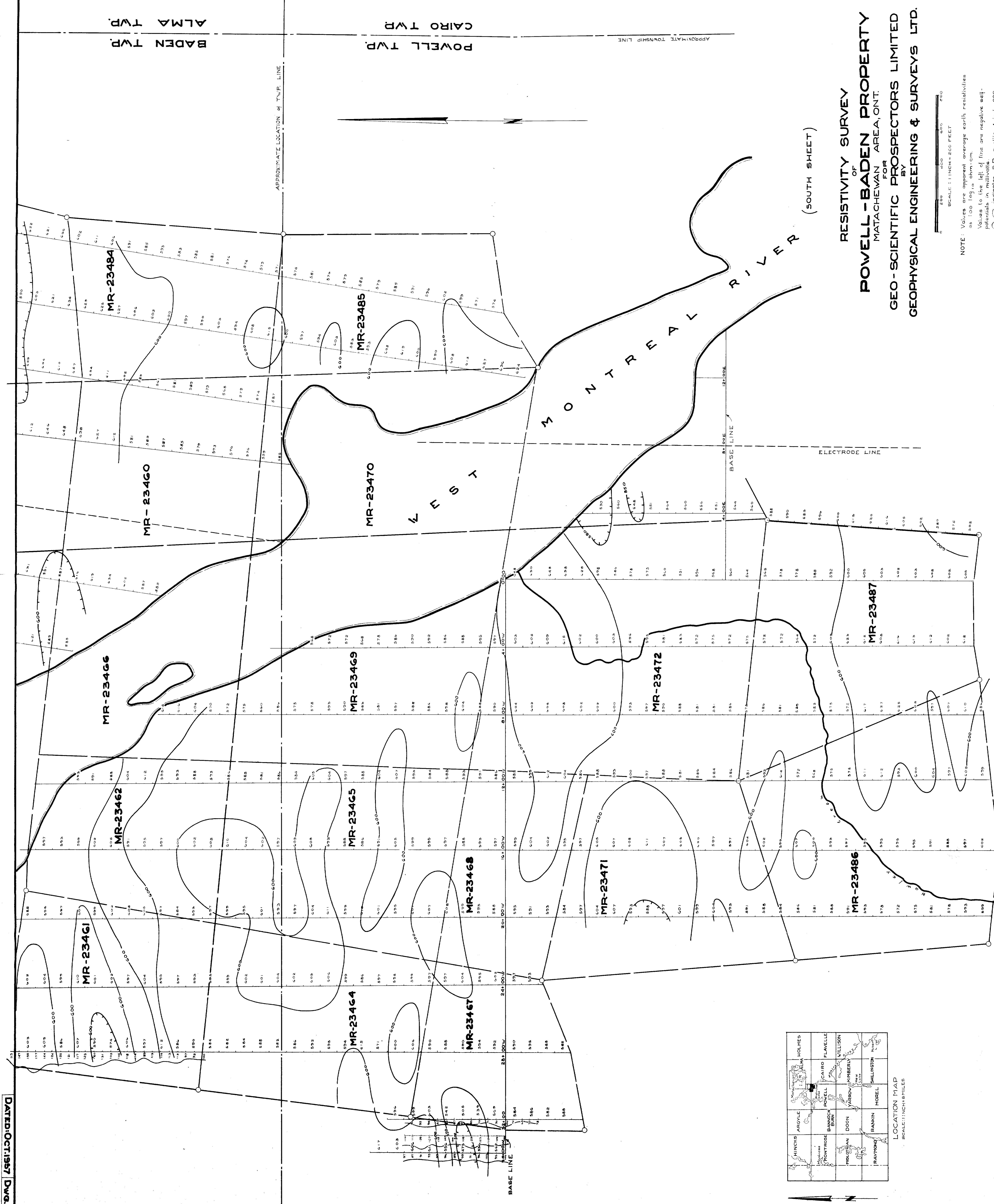

RESISTIVITY SURVEY
 OF
POWELL - BADEN PROPERTY
 MATACHEWAN AREA, ONT.
 FOR
 BY
GEO - SCIENTIFIC PROSPECTORS LIMITED
GEOLOGICAL ENGINEERING & SURVEYS LTD.

(SOUTH SHEET)

NOTE: Values are apparent average earth resistivities as 100 leg. ohm-cm. Values to the left of line are negative self-potentials in millivolts. indicates S.P. profile 1 inch = 200 mv.

DATE	REVISION
DEC. 1957	Addition of S.P. data