

OCT-NOV 1999

Submission # 2.20078

REPORT ON THESAURUS PROPERTY
BADEN TWP - TRENCHING & SAMPLING

ATTN LUCILLE JEROME

OCT 17 - PAT ROSKO & JIM FORBES
LOCATE TRENCH AREA & SAMPLE

RECEIVED LARDER LAKE MINING DIVISION

OCT 18 - PAT ROSKO & JIM FORBES
DRILL TRENCH.

JUN 19 2000 3:28

OCT 24 - PAT ROSKO & JIM FORBES
DRILL TRENCH

OCT 25 PAT ROSKO
DRILL TRENCH.

RECEIVED FORBES
11:16am
JUN 22 2000
GEOSCIENCE ASSESSMENT OFFICE

OCT 31 - PAT ROSKO & JIM FORBES
DRILL TRENCH.

NOV 1 - PAT ROSKO & JIM FORBES
DRILL TRENCH

OFFICIAL RECORDING
E - SUBSURY
EVIDENCE
NOV 10 2000
2:13 PM
2/3/4/5/6

NOV 6 - PAT ROSKO & JIM FORBES
DRILL TRENCH.

NOV 7 - PAT ROSKO & JIM FORBES
LAST TRENCH & SAMPLE.

This trenching was done on a quartz vein 18" wide in granite. The mineralization exposed in the vein was sparse pyrite, with one part of the vein having copper sulphides. All samples were taken from the trench site.



010
BADEN
42A02SE2022 2.20078

The trench is located on claim 1222447. The trench is 400 meters south of the #1-1222447 and 600 meters west.

Pat Laska

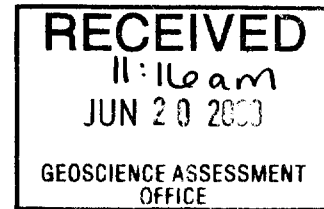

□ THE SAURUS SHAFT

STRIPPED AREA

25° EAST OF NORTH

TRUE NORTH

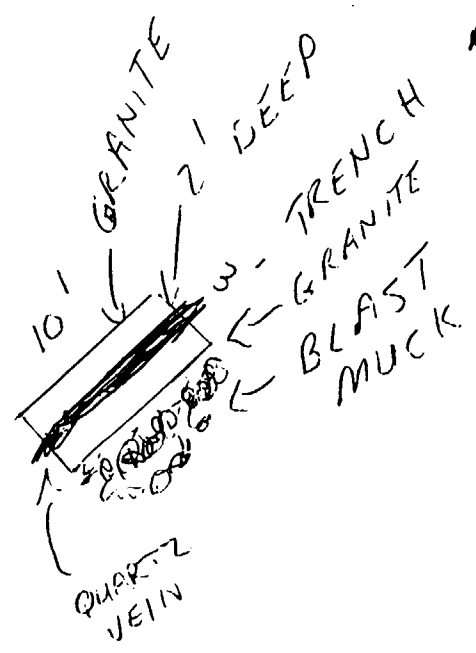

SCALE
1" = 10'

350' SOUTH TO ROAD TO MATACHEWAN INDIAN RESERVE

Robertson Twp. M.310

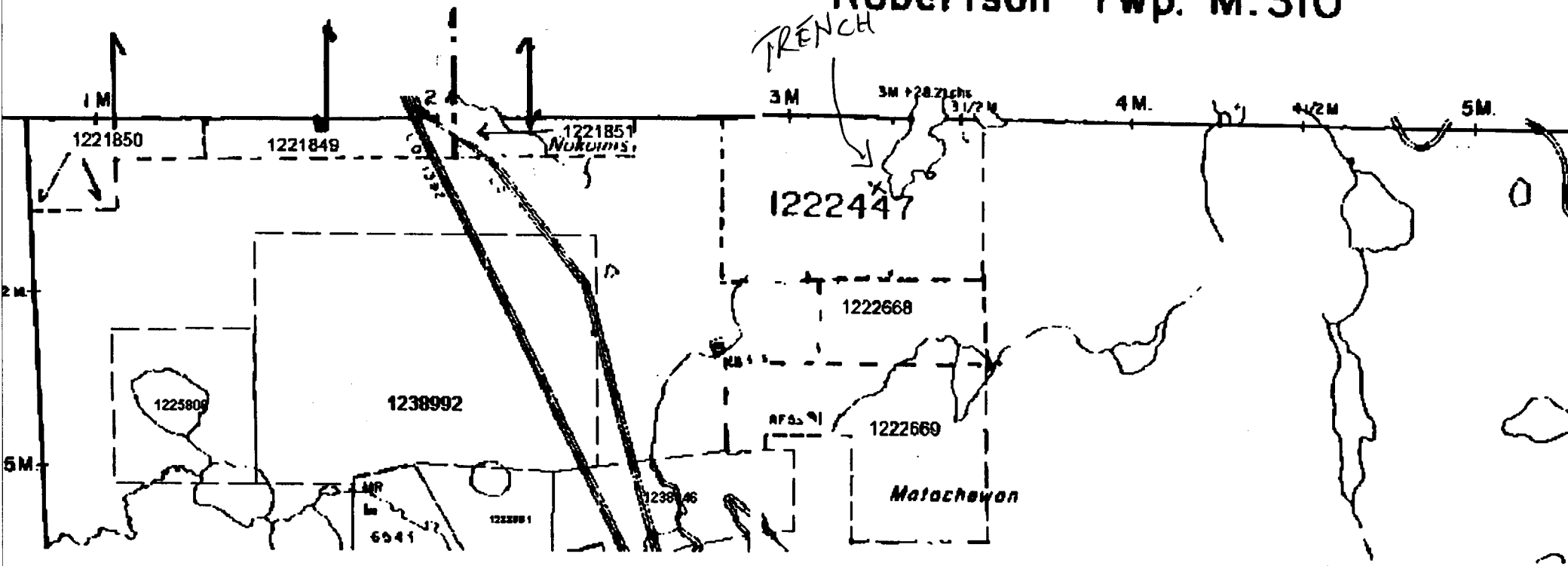

KIRKLAND LAKE RESIDENT GEOLOGIST'S DISTRICT

2.20078

42A02SE2022 2.20078 BADEN

020

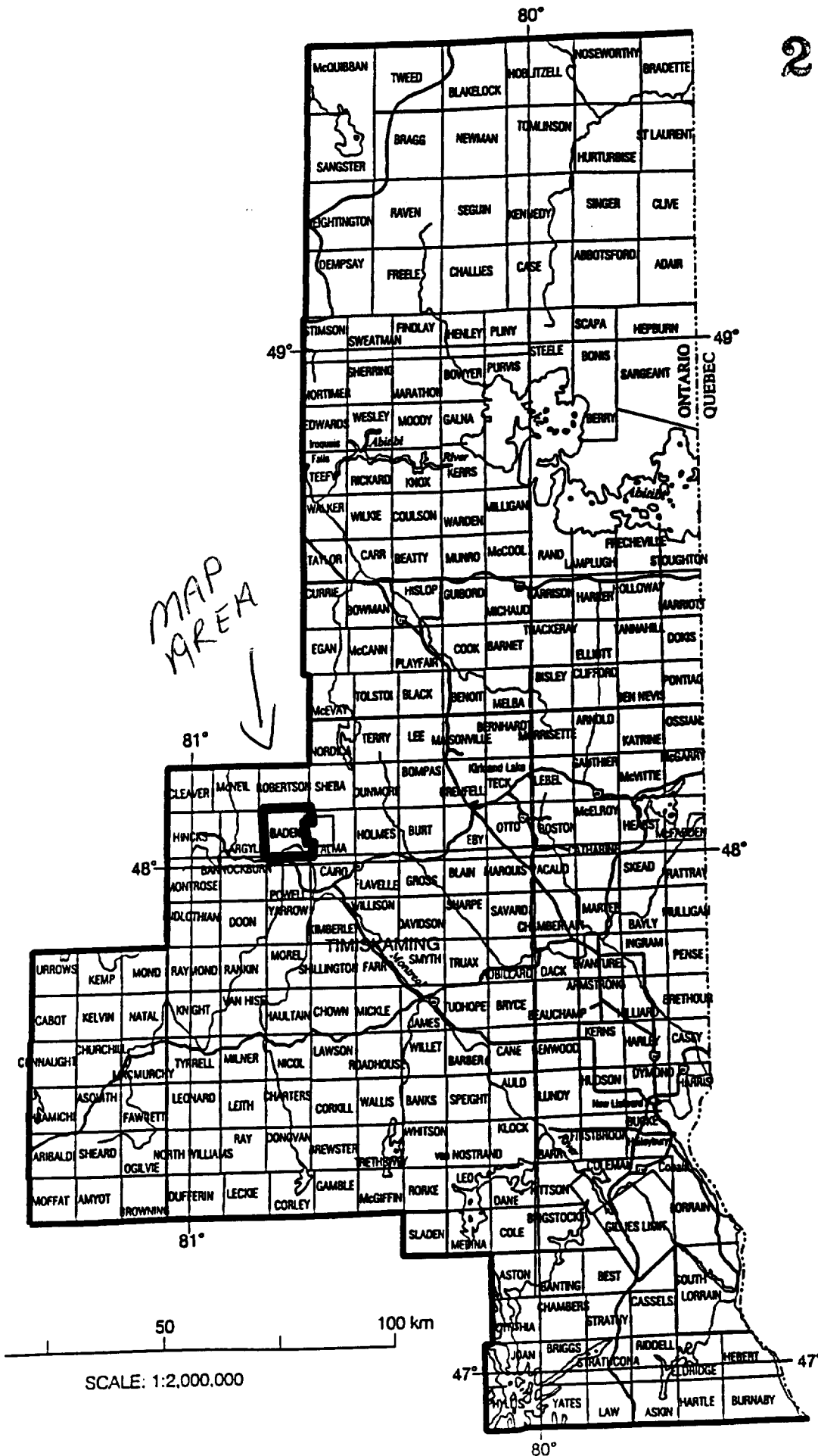

RECEIVED
 FEB 16 2000
 GEOSCIENCE ASSESSMENT
 OFFICE

Robertson Twp. M.310

ROAD TO MATACHEWAN
INDIAN RESERVE

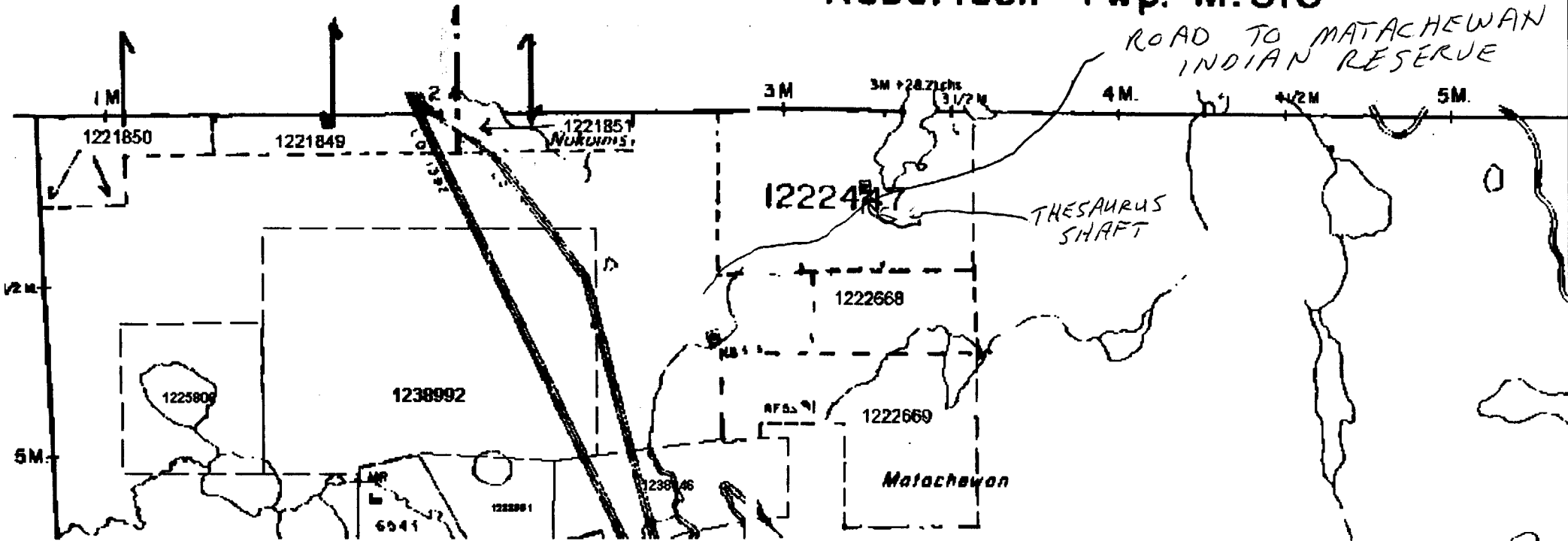

60
61
62
63
64
65
66
67
68
69
70



2.20078

☐ THE SAURUS
SHAFT

STRIPPED
AREA

TRUE
NORTH ↑

25° EAST OF NORTH

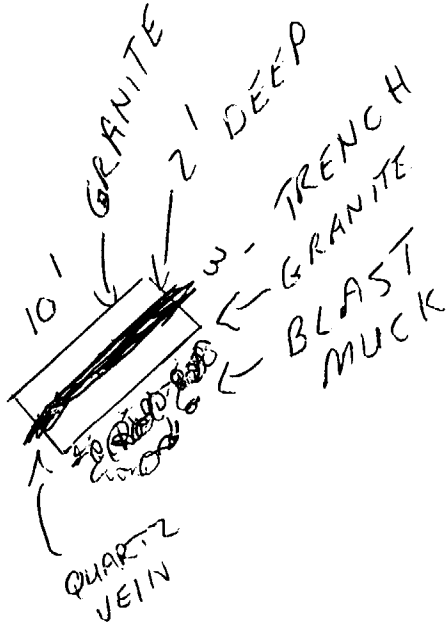

SCALE
1" = 10'

Swastika Laboratories
 Div. of TSL/Assayers Inc.
 P.O. Box 10
 1 Cameron Avenue
 Swastika, Ontario
 P0K 1T0

Tel: (705) 642-3244

INVOICE

NO: 00047309

DATE: 11/05/99

PAGE: 1

SOLD TO:

P. ROSKO
 158 BURNSIDE DRIVE
 KIRKLAND LAKE ONTARIO
 P2N 1M7

SHIP TO: R152

Same

GST Number: R132862640

Proj #/P.O. # N/A

ITEM NO.	QUANTITY	UNIT	DESCRIPTION	G	P	UNIT PRICE	AMOUNT
	1		Au			8.00	8.00
	1		Sample Prep			3.50	3.50
			Cert #9W-3315-RA1				
			GST @ 7%				0.81
COMMENTS							
Net 30 Days						TOTAL	12.31

SWASTIKA LABORATORIES
 NOV 15 1999
 PER [Signature]

Swastika Laboratories
 Div. of TSL/Assayers Inc.
 P.O. Box 10
 1 Cameron Avenue
 Swastika, Ontario
 P0K 1T0

Tel: (705) 642-3244

INVOICE

NO: 00047468

DATE: 11/19/99

PAGE: 1

SOLD TO:

SHIP TO: R152

P. ROSKO
 158 BURNSIDE DRIVE
 KIRKLAND LAKE ONTARIO
 P2N 1M7

Same

GST Number: R132862640

Proj #/P.O. # N/A

ITEM NO.	QUANTITY	UNIT	DESCRIPTION	G	P	UNIT PRICE	AMOUNT
	2		Au			8.00	16.00
	2		Sample Prep			3.50	7.00
			Cert #9W-3577-RA1				1.61
			GST @ 7%				
COMMENTS: Net 30 Days						TOTAL	24.61

SWASTIKA LABORATORIES
 Dec 13 / 99
[Signature]

P. ROSKO

Attention: P. Rosko / J. Forbes

Project:

Sample: Rock

TSL Assayers Swastika

1 Cameron Ave., Swastika, Ontario, P0K 1T0

Tel: (705) 642-3244 Fax: (705) 642-3300

Report No : 9W3100 RJ

Date : Oct-27-99

MULTI-ELEMENT ICP ANALYSIS

Aqua Regia Digestion

Sample Number	Ag ppm	Al %	As ppm	Ba ppm	Be ppm	Bi ppm	Ca %	Cd ppm	Co ppm	Cr ppm	Cu ppm	Fe %	K %	Mg %	Mn ppm	Mo ppm	Na %	Ni ppm	P ppm	Pb ppm	Sb ppm	Sc ppm	Sn ppm	Sr ppm	Ti %	V ppm	W ppm	Y ppm	Zn ppm	Zr ppm
16501	34.2	1.64	280	10	<0.5	10	0.11	<1	96	210	>10000	14.78	0.09	1.17	570	<2	0.01	236	530	46	5	2	<10	3	0.03	47	<10	1	329	14
16503	3.6	2.82	30	50	<0.5	<5	0.44	<1	31	131	1529	7.58	0.23	2.03	985	<2	0.01	56	820	12	5	3	<10	6	0.13	103	<10	7	186	13

A .5 gm sample is digested with 10 ml 3:1 HCl/HNO3 at 95c for 2 hours and diluted to 25ml with D.I.H2O.

Signed:





Established 1928

Swastika Laboratories

A Division of Assayers Corporation Ltd.

Assaying - Consulting - Representation **2.20078**

Geochemical Analysis Certificate

9W-3100-RG1

Company: **P. ROSKO**

Date: OCT-21-99

Project:

Attn: P. Rosko / J. Forbes

We hereby certify the following Geochemical Analysis of 3 Rock samples submitted OCT-13-99 by .

Sample Number	Au PPB	Au Check PPB	Ag PPM	Cu PPM	Pt PPB	Pd PPB	Multi-Element
26501	-	-	-	-	<5	<5	Results
26502	146	182	12.0	9920	-	-	to
26503	-	-	-	-	<5	<5	follow

One assay ton portion used.

Certified by 

2.20 8

Swastika Laboratories
Div. of TSL/Assayers Inc.
P.O. Box 10
1 Cameron Avenue
Swastika, Ontario
P0K 1T0

Tel: (705) 642-3244

INVOICE

NO.: 00047235

DATE: 10/28/99

PAGE: 1

SOLD TO:

SHIP TO: R152

P. ROSKO
158 BURNSIDE DRIVE
KIRKLAND LAKE ONTARIO
P2N 1M7

Same

GST Number: R132862640

Proj #/P.O. # N/A

ITEM NO.	QUANTITY	UNIT	DESCRIPTION	G	P	UNIT PRICE	AMOUNT
	1		Au			8.00	8.00
	1		Ag			3.00	3.00
	1		Cu			1.50	1.50
	2		Pt Pd			12.00	24.00
	2		Multi Element			8.40	16.80
	3		Sample Prep			3.50	10.50
			Cert #9W-3100-RG1				
			GST @ 7%				4.48
COMMENTS:						TOTAL	68.28
Net 30 Days							

One assay ton portion used.

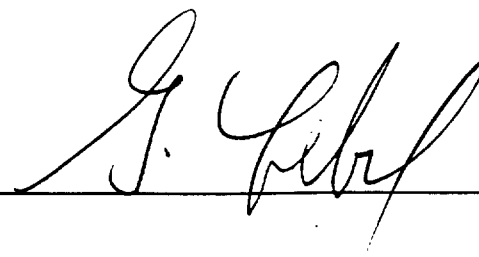
Certified by 

2, 20070

Swastika Laboratories

A Division of Assayers Corporation Ltd.

Assaying - Consulting - Representation

Established 1928

Assay Certificate

9W-3315-RA1

Date: NOV-04-99

Company: **P. ROSKO**

Project:

Attn: P. Rosko

We hereby certify the following Assay of 1 Rock samples
submitted NOV-01-99 by .

Sample Number	Au oz/ton	Au Check oz/ton
#1	0.004	0.004

One assay ton portion used.

Certified by

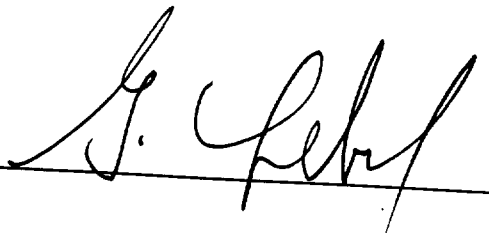

1 Cameron Ave., P.O. Box 10, Swastika, Ontario P0K 1T0
Telephone (705)642-3244 Fax (705)642-3300



42A02SE2022 2.20078 BADEN

900

subsection 65(2) and 66(3) of the Mining Act. Under section 8 of the Mining Act, assessment work and correspond with the mining land holder. Questions about this orthern Development and Mines, 3rd Floor, 933 Ramsey Lake Road, Sudbury.

Instructions: - For work performed on Crown Lands before recording a claim, use form 0240.
- Please type or print in ink.

2.20078

1. Recorded holder(s) (Attach a list if necessary)

Name	PAT ROSKO	Client Number	189 297
Address	158 BURNSIDE DRIVE KIRKLAND LAKE ONTARIO	Telephone Number	567-4125
		Fax Number	SAME No
Name		Client Number	
Address		Telephone Number	
		Fax Number	

2. Type of work performed: Check (✓) and report on only ONE of the following groups for this declaration.

Geotechnical: prospecting, surveys, assays and work under section 18 (regs) Physical: drilling stripping, trenching and associated assays ✓ Rehabilitation

Work Type	TRENCHING & SAMPLING	Office Use	
Dates Work Performed	From Day 17 Month 10 Year 1999 To Day 11/11 Month 1 Year 1999	Commodity	
Global Positioning System Data (if available)	Township/Area BADEN TWP. M or G-Plan Number M-0205	Total \$ Value of Work Claimed	3357
		NTS Reference	
		Mining Division	Kirkland Lake
		Resident Geologist District	Kirkland Lake

Please remember to: - obtain a work permit from the Ministry of Natural Resources as required;
- provide proper notice to surface rights holders before starting work;
- complete and attach a Statement of Costs, form 0212;
- provide a map showing contiguous mining lands that are linked for assigning work;
- include two copies of your technical report.

3. Person or companies who prepared the technical report (Attach a list if necessary)

Name	PAT ROSKO	Telephone Number	567-4125
Address	158 BURNSIDE DRIVE K.L.	Fax Number	SAME
Name	P2N1M7	Telephone Number	
Address		Fax Number	
Name	JIM FORBES	Telephone Number	568-6409
Address	60 MCKELVIE AVE K.L.	Fax Number	

4. Certification by Recorded Holder or Agent

I, PAT ROSKO (Print Name), do hereby certify that I have personal knowledge of the facts set forth in this Declaration of Assessment Work having caused the work to be performed or witnessed the same during or after its completion and, to the best of my knowledge, the annexed report is true.

Signature of Recorded Holder or Agent: Pat Rosko Date: FEB 14/2000

Agent's Address: 158 BURNSIDE DRIVE Telephone Number: 567-4125 Fax Number: 567-4125

0241 (03/97) KIRKLAND LAKE ONTARIO

RECEIVED
FEB 16 2000
GEOSCIENCE ASSESSMENT OFFICE

REC'D
LARDER
MINING DIVISION
FEB 14 2000
4:10 PM
MLR

Work to be recorded and distributed. Work can only be assigned to claims that are contiguous (adjoining) to the mining land where work was performed, at the time work was performed. A map showing the contiguous link must accompany this form.

W0080.00080

Claim Number. Or if work was done on other eligible mining land, show in this column the location number indicated on the claim map.	Number of Claim Units. For other mining land, list hectares.	Value of work performed on this claim or other mining land.	Value of work applied to this claim.	Value of work assigned to other mining claims.	Bank. Value of work to be distributed at a future date
TB 7827	16 ha	\$26,825	N/A	\$24,000	\$2,825
1234567	12	0	\$24,000	0	0
1234568	2	\$ 8,892	\$ 4,000	0	\$4,892
1222447	6	3357	3357		0
Column Totals		3357	3357		

Pat Rosko
(Print Full Name)

do hereby certify that the above work credits are eligible under subsection 7 (1) of the Assessment Work Regulation 6/96 for assignment to contiguous claims or for application to the claim where the work was done.

Signature of Recorded Holder or Agent Authorized in Writing
Pat Rosko

Date FEB 14 / 2000

6. Instruction for cutting back credits that are not approved.

Some of the credits claimed in this declaration may be cut back. Please check (✓) in the boxes below to show how you wish to prioritize the deletion of credits:

- 1. Credits are to be cut back from the Bank first, followed by option 2 or 3 or 4 as indicated.
- 2. Credits are to be cut back starting with the claims listed last, working backwards; or
- 3. Credits are to be cut back equally over all claims listed in this declaration; or
- 4. Credits are to be cut back as prioritized on the attached appendix or as follows (describe):

Note: If you have not indicated how your credits are to be deleted, credits will be cut back from the Bank first, followed by option number 2 if necessary.

For Office Use Only

Received Stamp

RECORDS
CLERK
MINING DIVISION

FEB 14 2000
4:10 PM
MLR

Deemed Approved Date	Date Notification Sent
Date Approved	Total Value of Credit Approved
Approved for Recording by Mining Recorder (Signature)	

RECEIVED
FEB 15 2000
GEOSCIENCE ASSESSMENT
OFFICE

Personal information collected on this form is obtained under the authority of subsection 6 (1) of the Assessment Work Regulation 6/96. Under section 8 of the Mining Act, this information is a public record. This information will be used to review the assessment work and correspond with the mining land holder. Questions about this collection should be directed to a Provincial Mining Recorder, Ministry of Northern Development and Mines, 3rd Floor, 933 Ramsey Lake Road, Sudbury, Ontario, P3E 6B5.

Work Type	Units of work Depending on the type of work, list the number of hours/day worked, metres of drilling, kilometres of grid line, number of samples, etc.	Cost Per Unit of work	Total Cost
PROSPECTING	1 DAY X 2 WORKERS	\$ 150 ⁰⁰	\$ 300 ⁰⁰
TRENCHING	7 DAYS X 2 WORKERS	\$ 150 ⁰⁰	\$ 2100 ⁰⁰
SAMPLES	7		\$ 105 ²⁰
Associated Costs (e.g. supplies, mobilization and demobilization).			
PLUGGER RENTAL	6 DAYS	\$ 50 ⁰⁰	\$ 300 ⁰⁰
Transportation Costs			
	146 KM @ 35¢ X 8 DAYS	\$ 49 ⁰⁰	\$ 392 ⁰⁰
Food and Lodging Costs			
	SUNDRIES \$ 20 ⁰⁰ X 8 DAYS	\$ 20 ⁰⁰	\$ 160 ⁰⁰
Total Value of Assessment Work			3357²⁰

Calculations of Filing Discounts:

1. Work filed within two years of performance is claimed at 100% of the above Total Value of Assessment Work.
2. If work is filed after two years and up to five years after performance, it can only be claimed at 50% of the Total Value of Assessment Work. If this situation applies to your claims, use the calculation below:

TOTAL VALUE OF ASSESSMENT WORK x 0.50 = Total \$ value of worked claimed.

Note:

- Work older than 5 years is not eligible for credit.
- A recorded holder may be required to verify expenditures claimed in this statement of costs within 45 days of a request for verification and/or correction/clarification. If verification and/or correction/clarification is not made, the Minister may reject all or part of the assessment work submitted.

Certification verifying costs
Pat Rosko
 (please print full name)

I, Pat Rosko P.R., do hereby certify, that the amounts shown are as accurate as may reasonably be determined and the costs were incurred while conducting assessment work on the lands indicated on the accompanying Declaration of Work form as Pat Rosko I am authorized to make this certification
 (recorded holder, agent, or state company position with signing authority)

Signature Pat Rosko Date FEB 14/2000

RECEIVED
 LARDER LAKE
 MINING DIVISION

FEB 14 2000
 4:10 PM
 MRE

RECEIVED
 FEB 15 2000
 GEOSCIENCE ASSESSMENT
 OFFICE

Geoscience Assessment Office
933 Ramsey Lake Road
6th Floor
Sudbury, Ontario
P3E 6B5

Telephone: (888) 415-9845
Fax: (877) 670-1555

June 27, 2000

PATRICK ARTHUR ROSKO
158 BURNSIDE DRIVE
KIRKLAND LAKE, Ontario
P2N-1M7

Visit our website at:
www.gov.on.ca/MNDM/MINES/LANDS/mismnpge.htm

Dear Sir or Madam:

Submission Number: 2.20078

Status

Subject: Transaction Number(s): W0080.00080 Approval After Notice

We have reviewed your Assessment Work submission with the above noted Transaction Number(s). The attached summary page(s) indicate the results of the review. **WE RECOMMEND YOU READ THIS SUMMARY FOR THE DETAILS PERTAINING TO YOUR ASSESSMENT WORK.**

If the status for a transaction is a 45 Day Notice, the summary will outline the reasons for the notice, and any steps you can take to remedy deficiencies. The 90-day deemed approval provision, subsection 6(7) of the Assessment Work Regulation, will no longer be in effect for assessment work which has received a 45 Day Notice. Allowable changes to your credit distribution can be made by contacting the Geoscience Assessment Office within this 45 Day period, otherwise assessment credit will be cut back and distributed as outlined in Section #6 of the Declaration of Assessment work form.

Please note any revisions must be submitted in **DUPLICATE** to the Geoscience Assessment Office, by the response date on the summary.

If you have any questions regarding this correspondence, please contact JIM MCAULEY by e-mail at james.mcauley@ndm.gov.on.ca or by telephone at (705) 670-5880.

Yours sincerely,

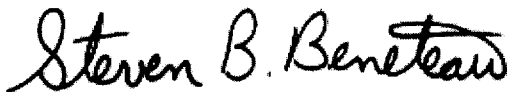

ORIGINAL SIGNED BY
Steve B. Beneteau
Acting Supervisor, Geoscience Assessment Office
Mining Lands Section

Work Report Assessment Results

Submission Number: 2.20078

Date Correspondence Sent: June 27, 2000

Assessor: JIM MCAULEY

Transaction Number	First Claim Number	Township(s) / Area(s)	Status	Approval Date
W0080.00080	1222447	BADEN	Approval After Notice	June 23, 2000

Section:

10 Physical PTRNCH

The revisions outlined in the Notice dated May 9, 2000 have been corrected. The 1 day of prospecting to locate the trench has been included within the trenching program and, as such, falls within the requirements of Section 10 of the Assessment Regulations.

In future, please provide a detailed plan of sampling locating where the samples were taken and the sample numbers as part of Section 10 of the Assessment Regulations. This will allow comparison of the results of the samples from the assay certificates with their location on the sample plan. Also, differentiate between the area(s) stripped and those area(s) which have been trenched and blasted.

Accordingly, assessment work credit has been approved as outlined on the Declaration of Assessment Work Form accompanying this submission.

Correspondence to:

Resident Geologist
Kirkland Lake, ON

Recorded Holder(s) and/or Agent(s):

PATRICK ARTHUR ROSKO
KIRKLAND LAKE, Ontario

Assessment Files Library
Sudbury, ON

Robertson Twp. M.310

Sheba Twp. M.315

THE TOWNSHIP OF
OF
BADEN

DISTRICT OF
TIMISKAMING

LARDER LAKE
MINING DIVISION

SCALE: 1-INCH 40 CHAINS

2.20078
PTRNCH

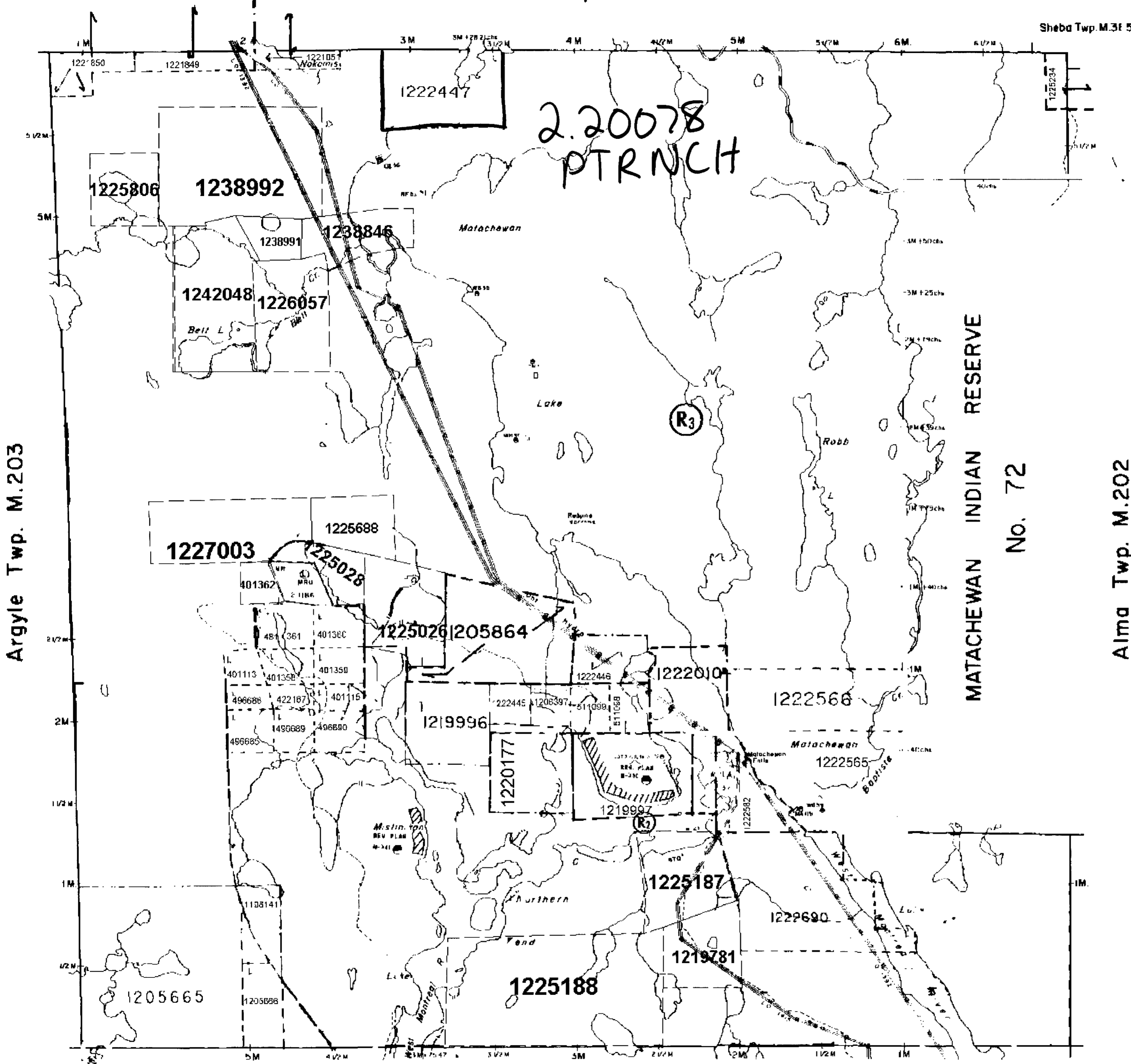

Argyle Twp. M.203

MATACHEWAN INDIAN RESERVE
No. 72

Alma Twp. M.202

LEGEND

PATENTED LAND	● or ⊕
CROWN LAND SALE	C.S.
LEASES	⊕
LOCATED LAND	Loc.
LICENSE OF OCCUPATION	L.O.
MINING RIGHTS ONLY	M.R.O.
SURFACE RIGHTS ONLY	S.R.O.
ROADS	—
IMPROVED ROADS	—
KING'S HIGHWAYS	—
RAILWAYS	—
POWER LINES	—
MARSH OR MUSKEG	—
MINES	⊕
CANCELLED	C.
PATENTED S.R.O.	⊕

NOTES

- 400' surface rights reservation along the shores of all lakes and rivers.
- Flooding rights to contour elevation B70 to Ont. Hydro L.O. 7601 File: 12290 v.2 SEC 35 W-LL-C1602/99 ONT MAY 17/99 M&S
- (R) MINING & SURFACE RIGHTS REOPENED TO PROSPECTING, SALE OR LEASE. ORDER NO. L.O./95, PREVIOUSLY WITHDRAWN UNDER ORDER #W 65/83.
- (S) SEC 35 W-LL-D1715/99 ONT MAY 13/99 M&S (200 METRES FROM WATER'S EDGE)
- THE INFORMATION THAT APPEARS ON THIS MAP HAS BEEN COMPILED FROM VARIOUS SOURCES, AND ACCURACY IS NOT GUARANTEED. THOSE WISHING TO STAKE MINING CLAIMS SHOULD CONSULT WITH THE MINING RECORDER, MINISTRY OF NORTHERN DEVELOPMENT AND MINES, FOR ADDITIONAL INFORMATION ON THE STATUS OF THE LANDS SHOWN HEREON.

PLAN NO. **M.205**

ONTARIO
MINISTRY OF NATURAL RESOURCES
SURVEYS AND MAPPING BRANCH

CIRCULATED JAN. 30, 1995

ARCHIVED APRIL 3, 1997

