

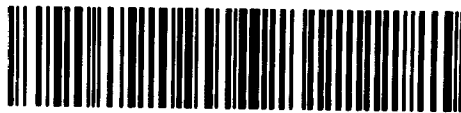

**MCADAM**  
**RESOURCES INC**  
Projet McWatters Project



42A02SW0067 2.10073 ARGYLE

010

REPORT ON THE TOM FOX PROPERTY  
ARGYLE TWP., NORTH-EASTERN ONTARIO  
FOR  
MCADAM RESOURCES INC.  
BY  
WALTER HANYCH  
DECEMBER, 1986

**RECEIVED**

MAY 21 1987

MINING LANDS SECTION

797-1620

TABLE OF CONTEN



42A025W0067 2.10073 ARGYLE

010C

SUMMARY	1
LOCATION AND ACCESS	2
CLAIMS AND STATUS	2
PREVIOUS WORK	3
RESULTS OF PREVIOUS WORK	3
PROPERTY GEOLOGY	5
ECONOMIC GEOLOGY	6
1986 PROGRAM	8
RESULTS OF 1986 PROGRAM	8
RECOMMENDATIONS	11
PROPOSED DIAMOND DRILL PROGRAM	<i>Schedule 1</i>
BUDGET FOR PROPOSED DIAMOND DRILL PROGRAM	<i>Schedule 2</i>

**SUMMARY**

The Tom Fox property is a stratabound auriferous sulphidic exhalite bordered by andesitic flows and pyroclastics. The exhalite unit has been traced along strike for 950 feet, it is four to five feet wide, contains massive to disseminated sulphides and is ubiquitously anomalous (250 ppb) in gold. Grab samples of up to 0.28 ounce per ton gold have been reported from trenches excavated on the property.

The property warrants additional work in the form of diamond drilling to test the known favourable unit along its strike length and at depth. The program would entail 2,800 feet of drilling and is estimated to cost 104 000 \$.

## LOCATION AND ACCESS

The Tom Fox property is located in the north-west corner of Argyle Township in the district of Timiskaming, Ontario, Larder Lake Mining Division.

Access to the property from Kirkland Lake, Ontario is west from the junction of highway 66 and 11 for 27 miles to the town of Matachewan. Westerly along highway 566 from Matachewan for 13 miles to the turn-off to camp Tru-Nor. Northerly for 43 miles along a bush road to a point along the east bank of the Whitefish River. A short canoe ride to cross the river followed by a walk along a well marked trail for a distance of approximately 3,000 feet leads to the eastern boundary of the claim block.

## CLAIMS AND STATUS

The property consists of 14 unpatented contiguous claims covering 560 acres. They are recorded under the following claim numbers: L-799866, L-799867, L-799868, L-799869, L-822234, L-737273, L-737274, L-822233, L-822235, L-918082, L-918081, L-822232, L-822543, L-822542.

Claims L-918081 and L-918082 were staked Sept. 8, 1986 and therefore are in good standing for one year.

An extension of time for filing work was applied for and granted to claims L-799868 and L-799869. The extension has been granted to April 30, 1987.

Expiry dates for the remainder of the claims are as follows:

<u>CLAIM</u>	<u>EXPIRY DATE</u>
L-737273 & L-737274	Dec. 28, 1985
L-799866 & L-799867	Sept. 26, 1987
L-822232 & L-822235	Nov. 27, 1987
L-822542 & L-822543	Mar. 25, 1988

#### PREVIOUS WORK

The Argyle Township area was mapped on a regional scale in the 1930's and sometime after the discovery of gold at the Ashely property in 1932 much of Argyle Township was staked.

After this initial burst of activity no further work was reported from this area. However, sometime prior to 1975 a local prospector - trapper manually excavated seventeen trenches along a sulphidic felsic unit that today is referred to as the Tom Fox property.

In 1975 Texas Gulf Canada Limited carried out a program in search of base metals and mapped, soil sampled, electromagnetically surveyed and diamond drilled the property. A total of 810 feet of diamond drilling was performed in two holes along the felsic unit.

The current vendors in 1983 resampled by blasting and stripping some of the old showings and trenches. Their work established that the felsic unit is anomalous in gold.

In 1985 McAdam Resources carried out a VLF survey over a cut grid amounting to 14.64 line miles of survey.

#### RESULTS OF PREVIOUS WORK

The manual trenching carried out by Tom Fox exposed a

stratabound sulphidic felsic unit 140 feet long that averaged 4 to 5 feet in width.

Texas gulf's work did not reveal any new significantly mineralized zones of interest. Their electromagnetic survey did not detect any conductors. However, the diamond drill program did intersect the felsic unit. Hole A-51-1, drilled north easterly at  $-48^{\circ}$  intersected a sulphide zone from 106.8 to 114.0 for a drill thickness of 7.2 feet. The intersection is reported to average 10% pyrite and minor sphalerite. This intersection assayed 2.96% zinc, 0.10 oz/t Au, and 0.10 oz/t Ag. Hole A-51-2 was collared 1,200 feet south of A-51-1 along the strike extension of the favourable unit. This hole was drilled north easterly at  $-47^{\circ}$  to a depth of 552.0 feet. The drill log description of this hole does not mention a sulphide intersection within the felsic unit. However, samples were submitted for assay between 435.0 to 440.0; 5 foot drill intersection - trace Au, nil Ag, 0.02% Zn and between 480.0 - 484.0; 4 foot drill intersection - trace Au, nil Ag, .01% Zn.

Limited blast sampling of the old trenches and the exposing of mineralized outcrops along strike of the felsic unit by the current vendors has resulted in defining two main zones of interest. The "Main showing" which has been exposed by trenches over a length of 140 feet and averages 4 to 5 feet in width is the trenched area that was worked by Tom Fox. Samples from this area are reported to have returned values ranging from 0.002 oz/t Au to 0.28 oz/t Au. The "South Showing" is situated 620 feet south along strike of the Main Showing. Samples from this area are reported to have returned values

ranging from .005 oz/t Au to 0.16 oz/t Au in grab samples.

In 1985 McAdam Resources Inc. conducted a VLF survey over a cut grid that amounted to 14.64 line miles of surveying. Two surveys were conducted using the Cutter VLF transmitter and the Annapolis VLF transmitter. Numerous conductive zones were outlined by the survey; for a full report of these results refer to Report on VLF-Electromagnetic Surveys performed on the Tom Fox property by John H. McAdam dated Nov. 1985.

### PROPERTY GEOLOGY

The Tom Fox property is situated in the Abitibi greenstone belt and is underlain by northwest trending; steeply dipping, intermediate to felsic metavolcanics. North-south trending diabase dykes intrude the volcanics. All the rocks have been metamorphosed to the greenschist facies and are Precambrian in age.

Andesitic massive and porphyritic flows and pyroclastics constitute the dominant rock type on the property. Massive flows are pale green, weakly foliated and commonly silicified. The porphyritic flows are similar to the massive flows except that they exhibit a preponderance of subhedral to euhedral feldspar phenocrysts. These phenocrysts vary in size from 1/16 of an inch to 1/4 of an inch in length. Pyroclastics are also pale green and weakly foliated. Fragment size varies from tuff to breccia (agglomerate) and the matrix may or may not contain feldspar phenocrysts. Where feldspar phenocrysts

occur in a significant amount, the rock can best be termed an andesitic crystal tuff.

Felsic volcanics occur as dacite feldspar porphyry flows / crystal tuff that flank the andesitic volcanic pile and as stratabound, sulphidic - sericitic - cherty schist. The dacite feldspar porphyry flows / crystal tuffs are pale grey, weakly foliated contain both feldspar and quartz-eye phenocrysts. The sulphidic - sericitic - cherty schist occurs as a distinct horizon in the mineralized zone of interest. The schist is pale yellow to cream, moderately to strongly foliated and averages 3-5% disseminated sulphides. Sections of the schist grade from a rock that is basically a sericite schist to massive chert. Sulphides occur as disseminations, laminations and nodules in this felsic unit. The unit is interpreted to be a stratabound exhalite and the host to the mineralization on the property.

#### ECONOMIC GEOLOGY

Previous work has identified two zones of interest on the Tom Fox property. Both zones occur along strike of each other separated by 700 feet and occur in a north-northwest trending sulphidic exhalite unit that averages 4 to 5 feet in width.

The "Main Showing" is exposed in 5 trenches in the immediate vicinity of line 3 north, 2+30 west. Here the sulphidic exhalite unit has been traced over a 150 foot strike



length and varies in width from 4 to 10 feet. It strikes  $315^{\circ}$  and dips steeply to the west. The hanging wall contact of this unit and the andesitic volcanics is strongly sheared and weakly carbonated. The exhalite's footwall is in contact with a felsic feldspar porphyry dyke. The dyke obliquely cuts the middle of the exhalite unit along its strike. This dyke is typically pale grey-brown, hematized, contains feldspar phenocrysts and varies in width from 5 feet at its northern exposure, to 20 feet at approximately 22 feet north of line 3 north station 2 west.

The favourable mineralized unit is the exhalite horizon. It displays small scale, open folding of sulphide laminations and disseminated and nodular sulphide concentrations. Overall the unit averages 5% sulphides but sections of 30% sulphides across 1 foot were observed. These sections contain massive sulphides in the form of nodules. The most abundant sulphide in the unit is pyrite followed by pyrrhotite, sphalerite and chalcopyrite. Anomalous gold values have been reported from this horizon. Channel chip samples across 5 foot widths ranged from .002 oz/t Au (68 ppb) to .06 oz/t Au (2,040 ppb.) Grab samples ranged from .01 oz/t (340 ppb.) to .28 oz/t Au (9,520 ppb.)

Gold values of up to 0.23 oz/t were reported from a narrow (2 to 4 inch wide) quartz carbonate vein in andesitic volcanics (See figure 2).

The "South Showing" is located approximately 650 feet south of the main showing and is exposed by two stripped out-

crops separated along strike by 171 feet. The showing is tied into the existing grid at approximately line 3 south, 3 + 42 west. The mineralogical composition of the exhalite unit here does not change with respect to the Main Showing except that fuschite occurs at finely disseminated grains. In the most southerly outcrop fuschite constitutes 5 to 10% of the rock. Fuschite appears to be more concentrated where intense shearing has taken place. The full width of the exhalite unit is not known due to overburden conditions but it is estimated to be up to 30 feet wide.

Anomalous gold values from channel chip samples taken across the stripped outcrop range in value from .002 oz/t (68 ppb) to 0.02 oz/t (650 ppb). Grab samples from this showing have been reported to assay .08 oz/t (2,720 ppb) to 0.28 oz/t (9,520 ppb).

#### 1986 PROGRAM

The 1986 program entailed geological mapping & outcrop sampling on cut lines at a scale of 1 inch to 200 feet; approximately 14.4 line miles of grid was mapped. In addition 17 rock chip samples were submitted for assay. The Main Showing and the South Showing were mapped at a scale of 1 inch to 10 feet - and total of 35 samples were taken from the zones and fire assayed for gold.

#### RESULTS OF 1986 PROGRAM

Geological mapping of the entire grid area confirmed that most of the area is underlain by a thick sequence of andesitic

pyroclastics, massive and porphyritic flows. Due to the paucity of outcrop facies relationships within the volcanic pile could not be determined.

Sampling of mineralized (pyritic) outcrop did not locate any previously unknown anomalous gold concentrations outside the known showings area.

A trenched showing on line 0, 34+00 E at the eastern boundary of claim L-799869 was mapped and sampled. The showing is a narrow (3 foot wide) rhyolitic to dacitic flow within carbonated and sheared andesitic flows. The felsic unit averaged approximately 3% disseminated pyrite. Four samples from this showing returned nil gold values.

The Main Showing and the South Showing were mapped at a scale of one inch to ten feet as well as systematically sampled. The sulphidic exhalite unit in the Main Showing has been traced over 150 foot strike length and averages 6 feet in width. The South Showing is located 650 feet south of the Main Showing and has been traced over a strike length of 171 feet and appears to be considerably wider (up to 30 feet). Given that the sulphidic exhalite unit represents a stratabound volcanogenic horizon it can be inferred to strike over a 900 foot length.

Chip samples from the Main Showing assayed from 10 ppb to 13230 ppb Au. The high value of 13230 ppb Au (0.389 oz/t) was a chip sample of quartz-carbonate vein material that contained 3% disseminated coarse pyrite. Gold values within the sulphidic exhalite unit ranged from 10 ppb to 1230 ppb and averaged 278 ppb. Approximately 110 feet northwest of line 3 north, 2 + 60 west a mineralized, auriferous, brecciated andesite occurs in

an excavated pit and is exposed in outcrop over an area 8 feet by 6 feet. The outcrop is intensely quartz veined and brecciated and averages 10% pyrite. Pyrite concentrations of up to 40% were observed in blasted material within the pit. Grab samples of blast material assayed from 430 to 820 ppb Au. A chip sample from the outcrop containing 10% disseminated pyrite assayed 110 ppb Au. Approximately 21 feet east of the above location the felsic dyke was sampled, the material contained trace pyrite and fuschite and assayed 190 ppb Au.

A 3 foot wide sulphidic - cherty felsic unit is exposed in a trench 85 feet southeast of line 3 north 2+27 west. Its relationship to the favourable unit within the immediate area of the Main Showing is not known, however a chip sample across 1 foot containing 5% disseminated pyrite assayed 70 ppb Au.

The South Showing is exposed in two outcrops just south of line 3, 3+42 west. The exposed pyritic sericite quartz schist in the northerly outcrop was sampled by eight three foot long chip samples. The schist averaged 5-10% disseminated pyrite and trace fuschite. Seven samples returned nil values in gold while one sample of more cherty material returned a value of 30 ppb Au. One hundred and seventy one feet southeast of the above outcrop a stripped area has exposed highly sheared sericite quartz schist containing 10-30% disseminated pyrite and 5-10% fuschite. Grab samples from this outcrop assayed from 80 ppb to 620 ppb Au. Four samples averaged 222 ppb Au.

The VLF-EM survey conducted in 1985 outlined an anomaly with an axis that trends north-northwest parallel to the base line between lines 6 north and 9 south, through stations 3 west.

Pyrite distribution as revealed through geological mapping in 1986 confirmed that the VLF axis coincided spatially with the felsic exhalite.

#### RECOMMENDATIONS

The Tom Fox property represents an auriferous stratabound exhalite environment. The unit can be traced on surface for a 900 foot strike length and averages 4 to 5 feet in width. Although the unit is only moderately anomalous in gold (average 250 ppb) potential exists along strike and down dip for economic concentrations of gold. The property warrants further work as recommended.

A diamond drill program is proposed to test the favourable unit along 1,150 feet of strike length between L6N and L9S. Five holes at  $-45^{\circ}$  are designed to test the horizon at a vertical depth of 150 feet and one hole at  $-45^{\circ}$  is located to intersect the unit approximately at a 50 foot depth. In addition one hole at  $-45^{\circ}$  is located on line 24 north, 4+80 west to test a broad north-northwest trending VLF-EM anomaly that lies on strike of the VLF anomaly at the main target area. Total drilling would amount to 2,800 feet. Drill hole details are outlined on the next page.

## Schedule 1

## PROPOSED DIAMOND DRILL PROGRAM

DRILL HOLE LOCATION	ANGLE	TARGET INTERSECTION VERTICAL DEPTH	TOTAL DEPTH
A87-1 L 4+10N - 3+00W	-45°	50'	250'
A87-2 L 4+10N - 4+15W	-45°	150'	400'
A87-3 L 3+00N - 4+15W	-45°	150'	400'
A87-4 L 0+20N - 4+15W	-45°	150'	500'
A87-5 L 4+60S - 4+15W	-45°	150'	500'
A87-6 L 5+40S - 4+15W	-45°	150'	500'
A87-7 L23+80N - 5+40W	-45°	100'	250'
TOTAL DRILLING			2,800 ft.

## Schedule 2

## BUDGET FOR PROPOSED DIAMOND DRILL PROGRAM

SALRIES (FIELD)			
Program geologist	28 days	2 500 \$	
Helper	28 days	2 000	
Manager	7 days	<u>875</u>	5 375 \$
EQUIPMENT & SUPPLIES			
Truck 4X4	50 \$/day X 28 days	1 400 \$	
Snowmachine	30 \$/day X 28 days X 2	1 680	
Fuel		800	
Core logging & splitting shack		400	
Miscellaneous		<u>500</u>	4 780
REPORT			3 000
PROJECT TRAVEL			1 500
TELEPHONE			300
FOOD (STAFF)			
	63 man days X 25 \$/day		1 575
LODGING			
	Staff & drill crew (Camp Tru-Nor)		1 200
DIAMOND DRILLING			
	2,800 ft X 26 \$/ft		72 800 \$
ACCESS ROAD CONSTRUCTION & DRILL SITE PREPARATION			
	D7 @ 50 \$/hr X 40 hrs		2 000
SAMPLE ANALYSIS			
	ICP Au & 26 elements--		
	300 samples X 16 \$/sample	4 800 \$	
	Fire assay Au -		
	100 samples X 8,50\$/sample	<u>850</u>	5 650
SUB-TOTAL			98 180 \$
CONTINGENCY			<u>5 820</u>
GRAND TOTAL			<u>104 000 \$</u>

CERTIFICATE

I Walter Hanych, hereby certify:

1. That I am a geologist and reside at 70 Beech Street, Collingwood, Ontario
2. That I am a graduate of Laurentian University and hold an H.BSC. in geology
3. That I have been practicing my profession in Canada for 9 years
4. That the accompanying report is based on direct involvement on the Argyle Twp. Project, McAdam Resources Inc. as a consulting geologist.

Rouyn-Noranda, Quebec

March 18, 1987



W. Hanych

200  
2-7577





Ontario

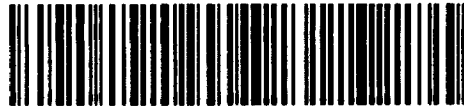

42A02SW0067 2.10073 ARGYLE

900

Ministry of  
Northern Development  
and Mines

July 7, 1987

Your File: 157/87  
Our File: 2.10073

Mining Recorder  
Ministry of Northern Development and Mines  
4 Government Road East  
Kirkland Lake, Ontario  
P2N 1A2

Dear Sir:

RE: Notice of Intent dated June 18, 1987  
Geological Survey on Mining Claims  
L 799866, et al, in Argyle Township

The assessment work credits, as listed with the above-mentioned  
Notice of Intent, have been approved as of the above date.

Please inform the recorded holder of these mining claims and  
so indicate on your records.

Yours sincerely,

Gary L. Weatherson, Manager  
Mining Lands Section  
Mineral Development and Lands Branch  
Mines and Minerals Division

Whitney Block, Room 6610  
Queen's Park  
Toronto, Ontario  
M7A 1W3

Telephone: (416) 965-4888

JS/mc  
cc: McAdam Resources Inc  
P. Fox Sr  
Suite 1415  
25 Adelaide Street East  
Toronto, Ontario  
M5C 1Y2

Resident Geologist  
Kirkland Lake, Ontario

Encl.

Walter Hanych  
Post Restante  
McWatters, Quebec  
J0Z 2V0

Mr. G.H. Ferguson  
Mining & Lands Commissioner  
Toronto, Ontario

Recorded Holder  
 McADAM RESOURCES INC

Township or Area  
 ARGYLE TOWNSHIP

Type of survey and number of Assessment days credit per claim	Mining Claims Assessed
<b>Geophysical</b> Electromagnetic _____ days Magnetometer _____ days Radiometric _____ days Induced polarization _____ days Other _____ days	
Section 77 (19) See "Mining Claims Assessed" column	
Geological <u>20</u> days	L 799866 822232 to 35 inclusive 737273 - 74 918081 - 82 822542 - 43
Geochemical _____ days Man days <input type="checkbox"/> Airborne <input type="checkbox"/> Special provision <input checked="" type="checkbox"/> Ground <input checked="" type="checkbox"/>	
<input type="checkbox"/> Credits have been reduced because of partial coverage of claims. <input type="checkbox"/> Credits have been reduced because of corrections to work dates and figures of applicant.	

Special credits under section 77 (16) for the following mining claims

<u>10 DAYS GEOLOGICAL</u>	<u>5 DAYS GEOLOGICAL</u>
L 799867 799868	L 799869

No credits have been allowed for the following mining claims

not sufficiently covered by the survey
  insufficient technical data filed

The Mining Recorder may reduce the above credits if necessary in order that the total number of approved assessment days recorded on each claim does not exceed the maximum allowed as follows: Geophysical - 80; Geological - 40; Geochemical - 40; Section 77(19) - 60.



W503

Hinks Twp.

W503

McNeil Twp.

Robertson Twp.

Bannockburn Twp.

Baden Twp.

THE TOWNSHIP OF

ARGYLE

DISTRICT OF TIMISKAMING

LARDER LAKE MINING DIVISION

SCALE: 1-INCH=40 CHAINS

LEGEND

- PATENTED LAND
- CROWN LAND SALE
- LEASES
- LOCATED LAND
- LICENSE OF OCCUPATION
- MINING RIGHTS ONLY
- SURFACE RIGHTS ONLY
- ROADS
- IMPROVED ROADS
- KING'S HIGHWAYS
- RAILWAYS
- POWER LINES
- MARSH OR MUSKES
- MINES
- CANCELLED

NOTES

400' Surface rights reservation of rivers.

*Withdrawals and Reopenings*

(R) Sec 36/80 w. 8/86 20/10/86 Mrs. ...

(S) Sec 36/80 w. 14/02/86 Mrs. ...

Order No. O-35-80 NR Reopens ...

(R) Sec 36/80 w. 10/1/86 NR 20/11/86 Mining and Surface Rts. Withdrawn

DATE OF ISSUE  
APR 23 1987  
LARDER LAKE  
MINING DIVISION

PLAN NO.- M-203 #

ONTARIO  
MINISTRY OF NATURAL RESOURCES  
SURVEYS AND MAPPING BRANCH

W503

ARGYLE

W503

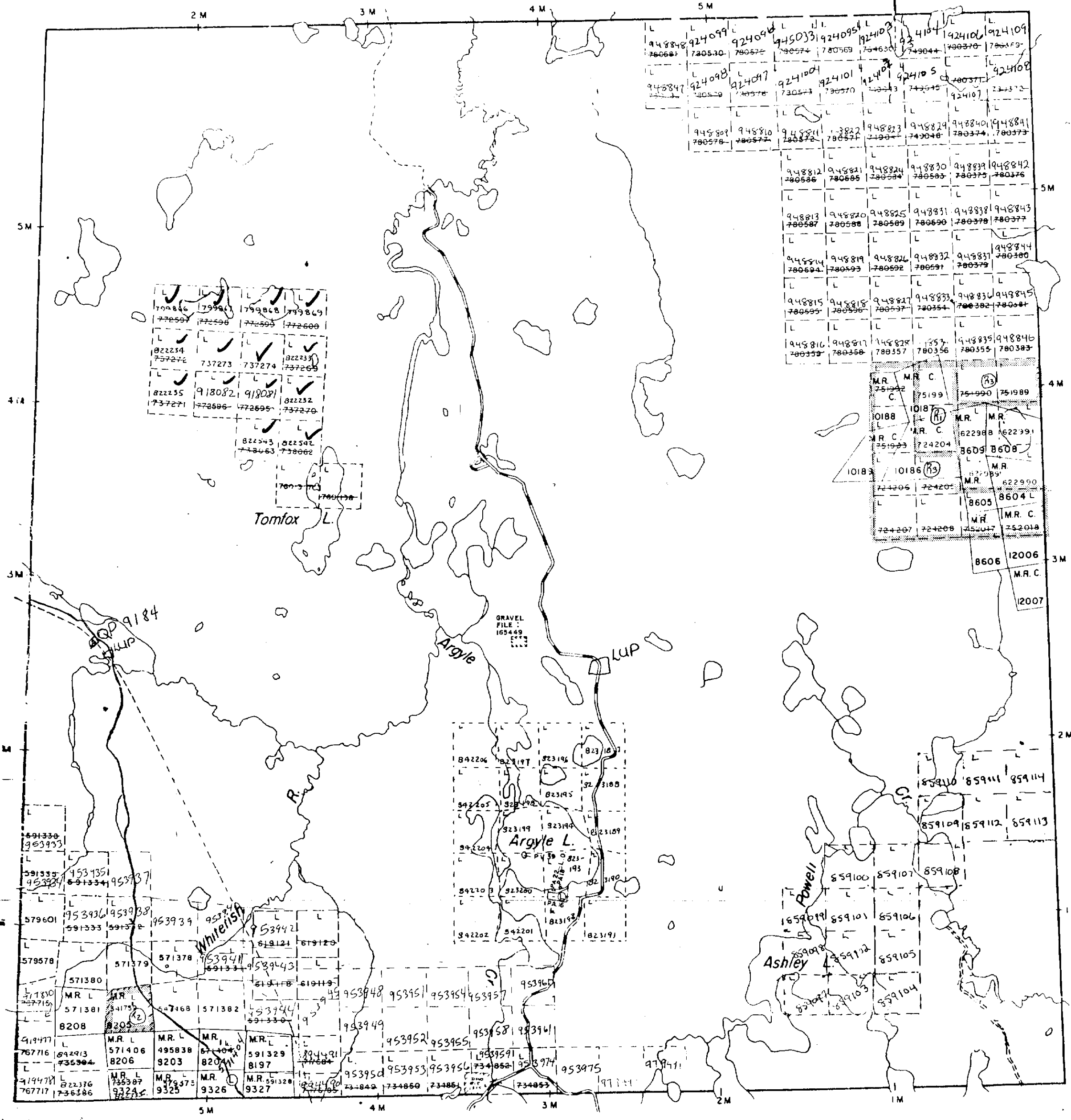

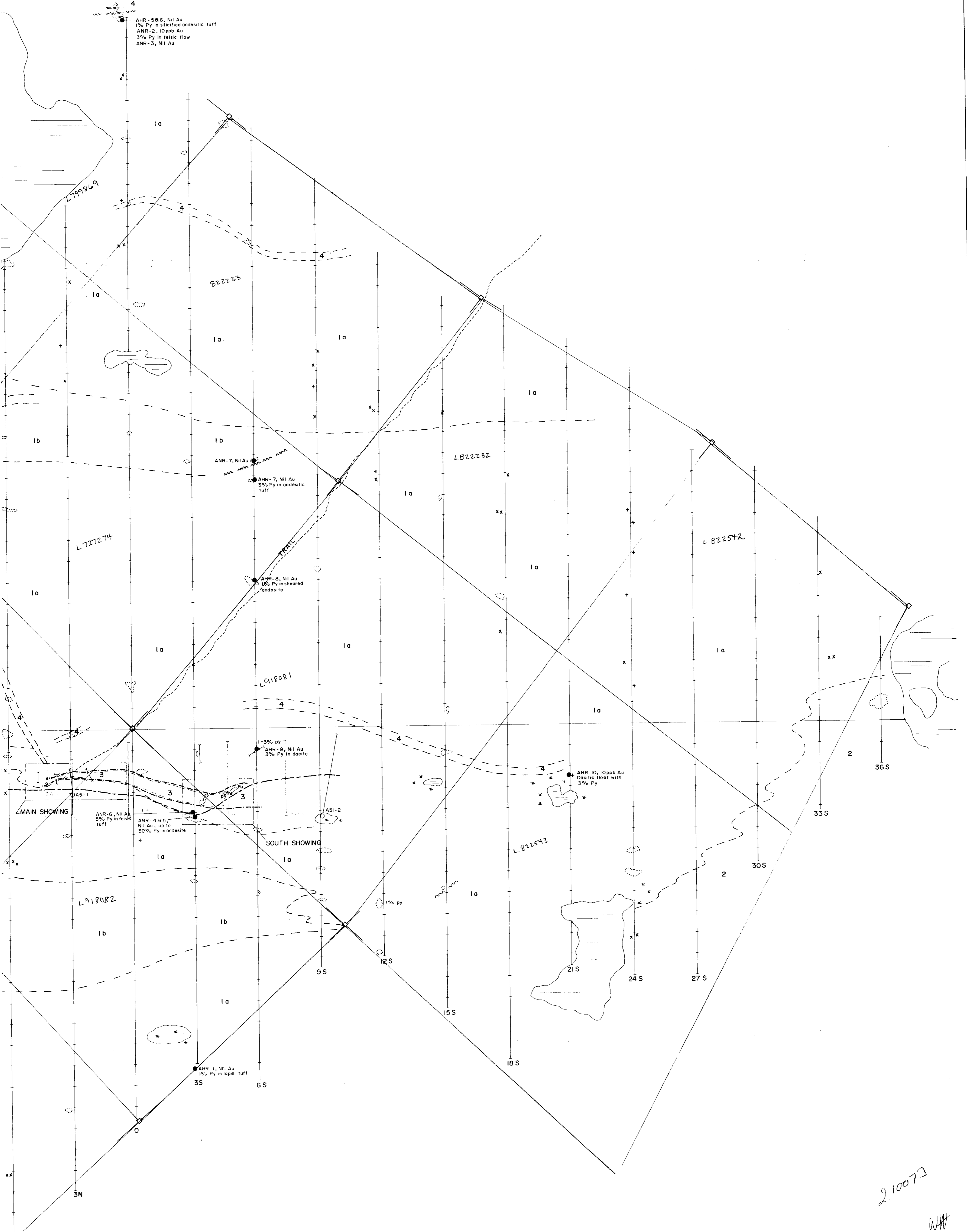

- LEGEND**
- 4 DIABASE DYKE
  - 3 SULPHIDIC QUARTZ SERICITE CHERT SCHIST
  - 2 FELSIC PORPHYRITIC FLOW
  - 1a INTERMEDIATE CRYSTAL TUFF - BRECCIA
  - 1b INTERMEDIATE FLOW

- SYMBOLS**
- VLF CONDUCTOR AXIS
  - SULPHIDE ZONE
  - FAULT
  - TRENCH
  - PIT
  - ROCK CHIP SAMPLE SITE
  - DIAMOND DRILL HOLE
  - OUTCROP
  - CLAIM POST
  - SUBCROP
  - FLOAT

2.10073  
W.H.

**McADAM RESOURCES INC.**  
TOM FOX PROPERTY - ARGYLE TWP.

---

TITLE: COMPILATION MAP  
DATE: DECEMBER, 1986  
SCALE: 1 INCH = 200 FEET

---

0 100 200 400 600

---

DRAWN BY: W.H. FIGURE: 1

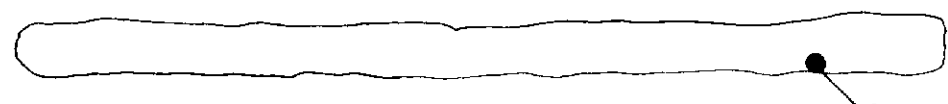

ANR-8, 5% PY IN FELDSPAR PORPHYRY DYKE  
NIL AU

ANR-18, 430 PPB QTZ VEINED  
BRECCIA, 40% SULPH  
ANR-19, 680-820 PPB AU  
SAME AS ANR-18

QUARTZ VEINED ANDESITE  
BRECCIA, 10-40% PY

ANR-19, 110 PPB 10% PY  
SHEARED ANDESITE

ANR-9, 30 PPB CONTACT MATERIAL - SERICITIC SCHIST  
1% PY

ANR-10, 190 PPB TRACE PY & FUSCHITE

ANR-15, 190 PPB AU, 5% SULPHIDES

ANR-16, 60 PPB AU UP TO  
10% PY

ANR-11, 620 PPB AU, QTZ-SER-CHL SCHIST  
50% SULPH

ANR-12, 100 PPB AU, CRENULATED SHEARED  
CONTACT, SERICITE SCHIST, 25% PY

ANR-13, 12,750 PPB AU, QTZ CARB VEIN  
WITH 3% EUHEDRAL PY

CHERTY SERICITIC LAMINATED  
EXHALITE, 5% PY (DISS) &  
20% LAMINATED SULPH  
ANR-20, 210 PPB AU

ANR-21, 150 PPB AU

ANR-22, 200 PPB AU

SULPHIDE ZONE: LAMINATED BANDED NODULAR SULPHIDES  
(PY, PO, SPHAL) UP TO 30% IN CHERTY  
SERICITIC EXHALITE

ANR-23, 260 PPB AU MASSIVE SULPH  
ANR-24, 10 PPB AU QUARTZ VEIN

ANR-27, 1,100-1,230 PPB AU, 30% SULPH

ANR-26, 60 PPB AU 40-50% SULPH

ANR-25, 70 PPB AU 5% PY IN  
CHERTY FELSIC ROCK

2.10073  
W.H.



McADAM RESOURCES INC.

TOM FOX PROPERTY - ARGYLE TWP.

TITLE: MAIN SHOWING - GEOLOGY

DATE: DECEMBER, 1986

SCALE: 1 INCH = 10 FEET

0 5 10 20

DRAWN BY: W.H.

FIGURE: 2

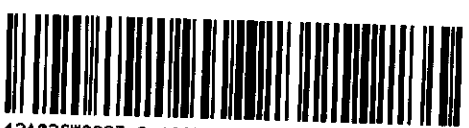

3+42 W

LINE 3S



ANR-28, NIL AU

3 FOOT CHIP SAMPLES OF PYRITIC QUARTZ SERICITE SCHIST

- ANR-29, 3% PY NIL AU
- ANR-30, 10% PY NIL AU
- ANR-31, 5% PY NIL AU
- ANR-32, 5-10% PY NIL AU
- ANR-33, 5% PY NIL AU
- ANR-34, 10% PY NIL AU
- ANR-35, 5% PY NIL AU
- ANR-36, 5% PY 30 PPB AU

GASH VEINS

ANR-37, 10% PY IN CHERT, NIL AU

CHERT

ANDESITIC TUFF  
 PYRITIC QUARTZ SERICITE SCHIST

ANR-39, OXIDIZED MASSIVE SULPHIDES  
480 - 620 PPB AU

ANR-42, 30% PY, 10% FUSCHITE  
100 PPB AU

ANR-40, SHEARED MATERIAL, 10% PY, 5% FUSCHITE  
80 PPB AU

ANR-38, 20% PY  
110 PPB AU

ANR-41, 5% PY, 90 PPB AU

2.10073

W.H.

LEGEND

GRAB SAMPLE SITE ●

SHEAR wavy line symbol

OUTCROP dashed line symbol



McADAM RESOURCES INC.

TOM FOX PROPERTY - ARGYLE TWP

TITLE: SOUTH SHOWING - GEOLOGY

DATE: DECEMBER, 1986

SCALE: 1 INCH = 10 FEET

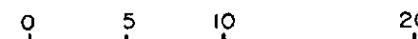

DRAWN BY: M.H.

FIGURE: 3



42A025W0067 2.10073 ARGYLE

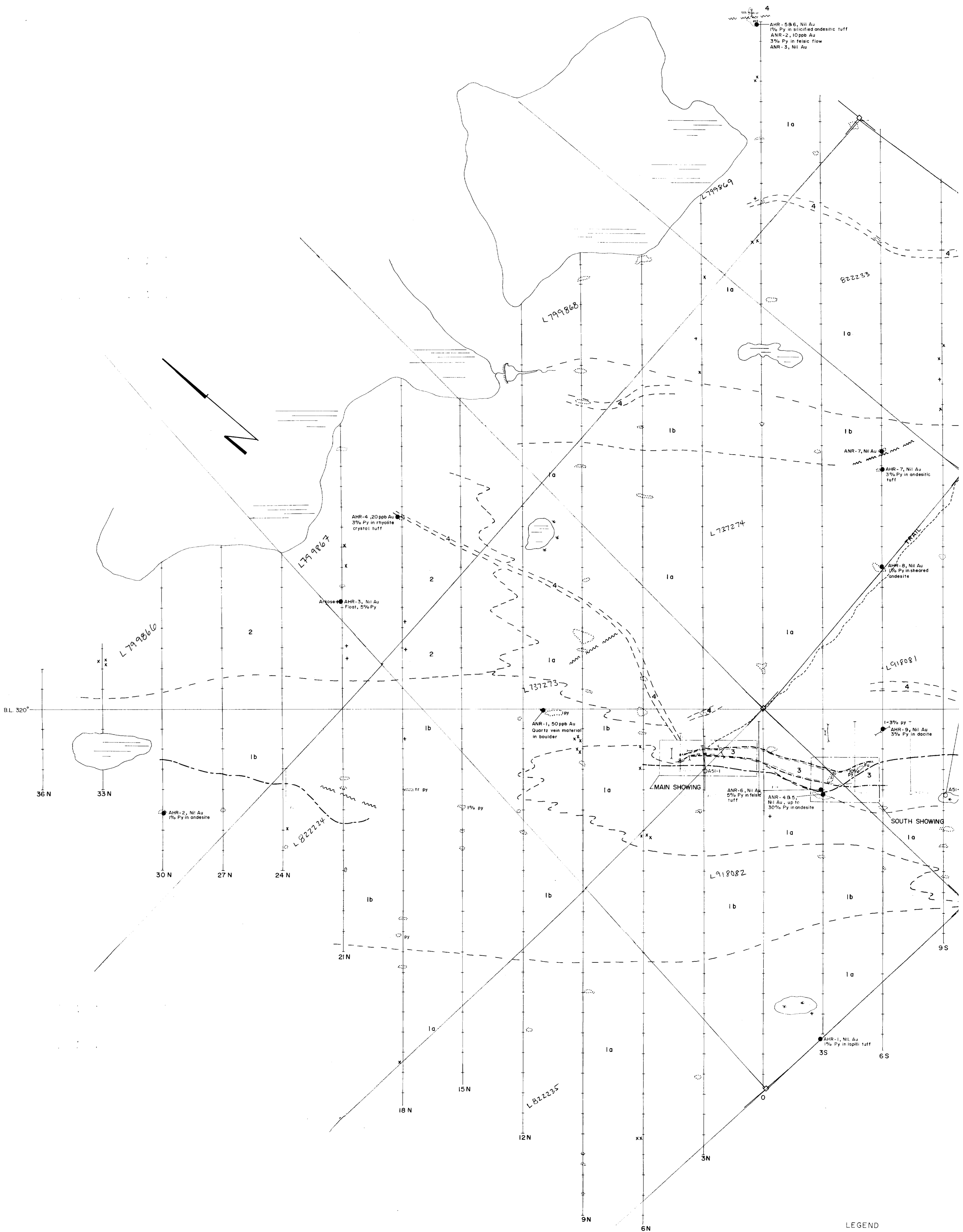

- LEGEND
- 4 DIABASE DYKE
  - 3 SULPHIDIC QUARTZ SERICIT
  - 2 FELSIC PORPHYRITIC FLO
  - 1a INTERMEDIATE CRYSTA
  - 1b INTERMEDIATE FLOW

