



42A025W0118 21 HINCKS

010

DIAMOND DRILLING

TOWNSHIP: HINCKS TWP.

REPORT NO: 21

WORK PERFORMED FOR: Wilzel Resources Ltd.

RECORDED HOLDER: Same as Above [xx]
: Other []

<u>Claim No.</u>	<u>Hole No.</u>	<u>Footage</u>	<u>Date</u>	<u>Note</u>
L 737296	M87-4	400'	Feb/88	(1)
	M87-5	150'	Feb/88	(1)

Notes: (1) #W8808.224, filed in Dec/88

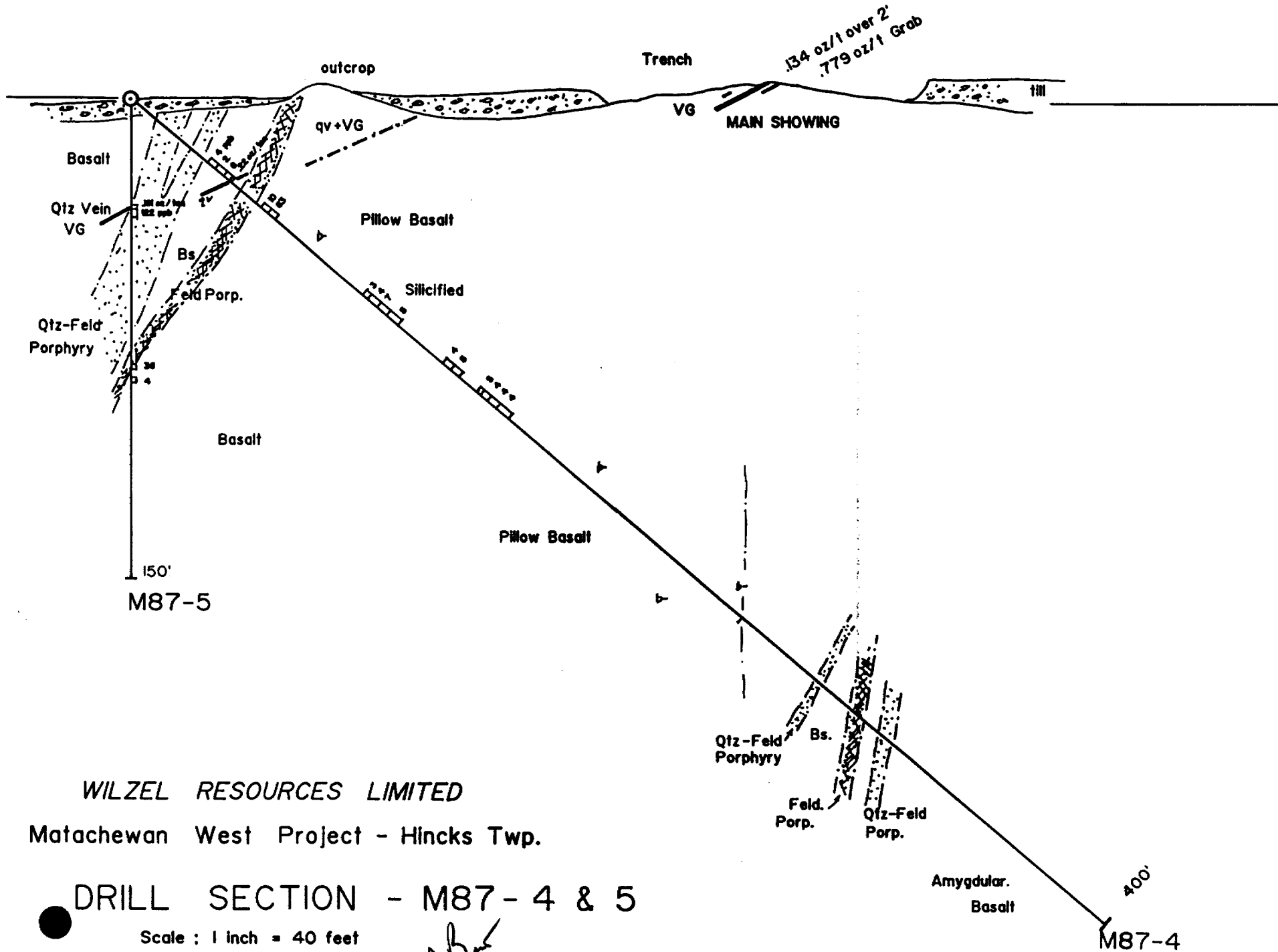

WILZEL RESOURCES LIMITED

Matachewan West Project - Hincks Twp.

DRILL SECTION - M87-4 & 5

Scale : 1 inch = 40 feet

FEBRUARY 1988

Handwritten signature: D.A.B.

1987 BOREHOLE LOG SUMMARY WZ M87-4

HOLE # M87-4 CO-OR: 63E, 2+00S DIP: -40° @ 305° Az LENGTH - 400 ft.

FOOTAGE ft	GEOLOGY	CA SAMPLE #	ASSAY ppb Au	Other
0 - 7	Casing, overburden & rubble. Start of core.			DIP TESTS
7 - 15.7	Qtz-Feldspar Perphyry - vfg brick/red matrix with m to cg pink and white plagioclase xls and smokey quartz 'eyes'. Very minor pyrite.			200' - 40' 400' - 40'
15.7 - 23.5	Basalt - fg, dark green, blocky with a few narrow qtz vnits @ 50°			
23.5 - 28.4	Qtz-Feldspar Perphyry - brick red with subhedral plagio xls. Sharp lower ct @ 60°	60		
28.4 - 31	Pillow Basalt - fg, dark green, amygdular, with a few pillows. Minor pyrite. Few qc vnits.			
31 - 34	Pillow Basalt as above with a few qtz vnits @	55	33535	4 ppb Au
34 - 38	Pillow Basalt as above		33536	2
38 - 40	Pillow Basalt as above		33537	8
40 - 41	Silicified Pillow Basalt- centered around a 1/2" qtz vein with strongly hematized cts and containing pyrite and chalcopyrite.	55	33538	.220 oz/ton Au
41 - 45.1	Pillow Basalt as before. Sharp lower ct @	75		
45.1 - 50.6	Feldspar Perphyry - vfg, brown matrix with chlorite spots & only a few plag xls.	65		
50.6 - 53	Pillow Basalt - vfg, dark grey/green, amygdular & locally brecciated lava cut by a few tiny qtz vnits with hematized cts.			
53 - 56	Pillow Basalt as above with a few vnits		33539	10 ppb Au
56 - 59	Pillow Basalt as above		33540	63
59 - 86	Pillow Basalt as above - massive			
86 - 95	Pillow Basalt - vfg, dark grey/green, breccia and hyaloclastite-rich lava cut by a few narrow qtz-calcite veinlets with 'orange' altered contacts and minor pyrite.			
95 - 97	Pillow Basalt as above with a few qc vnits.		33541	3
97 - 101	Pillow Basalt as above		33542	4
101 - 105	Pillow Basalt as above		33543	7
105 - 110	Pillow Basalt as above		33544	5
110 - 128	Pillow Basalt as above			
128 - 131	Pillow Basalt as above		33545	4
131 - 134	Pillow Basalt as above		33546	5
134 - 141.5	Pillow Basalt as above			
141.5 - 143	Pillow Basalt as above with 1/2" qtz vn +py @	60	33547	5

ONTARIO GEOLOGICAL SURVEY
ASSESSMENT FILES
OFFICE

JUN 1 1988

RECEIVED

143 - 146	Pillow Basalt as above	33548	4
146 - 150	Pillow Basalt as above with 1/2" qtz vn + py @ 60	33549	4
150 - 155	Pillow Basalt as above but close packed pillows and more massive with only a few qc vnits with 'orange' contacts and minor pyrite. Vns @ 70".	33550	4
155 - 190	Pillow Basalt as above - massive.		
190 - 217	Basalt - fg, dark green, massive, amygdular and quite fractured with only a few 'orange' qtz-calcite veinlets @ 30"		
217 - 251.5	Pillow Basalt - fg, amygdular, close-packed with 50% breccia-matrix. No qv, non-magnetic, sharp lower contact @ 60"	60	
251.5 - 281.2	Amygdular Basalt - fg, dark green, massive Sharp lower ct @ 80". Few barren qtz vnits.	80	
281.2 - 283.4	Qtz-Feldspar Porphyry - fg, grey & brick matrix with euhedral plagioclase xls and round quartz grains. Sharp lower ct @ 80".	80	
283.4 - 294.9	Amygdular Basalt as above. Ct is broken.		
294.9 - 301	Feldspar Porphyry - vfg, brown matrix with a few pink and white subhedral plagiocrystals and abundant chlorite spots.	60	
301 - 306	Amygdular Basalt as before. Sharp lower ct @ 80"		
306 - 312.1	Qtz-Feldspar Porphyry - fg, grey/brick red matrix with euhedral plagioclase & round qtz. Contacts are very sharp and not chilled.	80	
312.1 - 373.4	Amygdular Basalt - fg, dark green, very massive and featureless.		
373.4 - 375.4	Qtz-Feldspar Porphyry as before. Broken contacts, barren.		
375.4 - 400	Amygdular Basalt - fg, dark grey/green, massive, featureless flow with a few epidote altered sections associated with tiny qc vnits.		



400 - FOOT OF HOLE. M87-4 collar located 890' south and 330' west from Post # 1 of L.737296, Hincks Twp., Larder Lake Mining Division, Ontario. Casing left, 21 core boxes used. M87-4 started February 4th and was completed February 15th, 1988. (Joy Drill)

1987 BOREHOLE LOG SUMMARY WZ M87-5**HOLE # M87-5 CO-OR: 63E, 2+00S DIP: -90° LENGTH - 150 ft.**

FOOTAGE ft	GEOLOGY	CA	SAMPLE #	ASSAY ppb Au	Other
0 - 7	Casing, overburden, rubble, start of core				DIP TEST
7 - 33	Basalt - fg, dark green, rather massive lava with only a few tiny qc vnlt.				150' - 90°
33 - 34	Quartz Vein + Gold - 6" white qtz vein with 5% pyrite, minor allunite, and 3 grains of native gold (.2 - 1mm size). Basalt contact are strongly hematized and silicified.	60	33551	.181 oz/ton	VG
34 - 37	Quartz Feldspar Porphyry - fg, brick red matrix with cg, euhedral white plagioclase crystals and qtz eyes. A few white qtz veinlets @ 75°. Sharp lower contact @ 70°.	70	33552	122 ppb Au	
37 - 72.5	Qtz-Feldspar Porphyry as above but less qv	70			
72.5 - 76.6	Basalt - vfg, dark green, massive and featureless flow. Sharp lower contact @	30			
76.6 - 82.1	Feldspar Porphyry - vfg, brown matrix with occasional white plag xl and many green chlorite spots. Cts at 30° to core axis.	30			
82.1 - 83.4	Basalt - vfg, dark green, with a few very narrow white qtz vnlt @ 60°, minor pyrite	60	33553	36 ppb	
83.4 - 86.5	Basalt as above but no veinlets				
86.5 - 88	Feldspar Porphyry - vfg, brown matrix with a few white plag xls and green chlorite grains + a 1/4" qtz vein with pyrite @ 35° to core axis.	40	33554	4 ppb	
88 - 89.6	Feldspar Porphyry as above but no quartz veinlets. Sharp lower contact at 40°.	40			
89.6 - 150	Basalt - fine grading to medium grained, rather massive and featureless flow with minor leucoxene crystals throughout and a few epidote alteration zones associated with very tiny and barren qtz vnlt.				

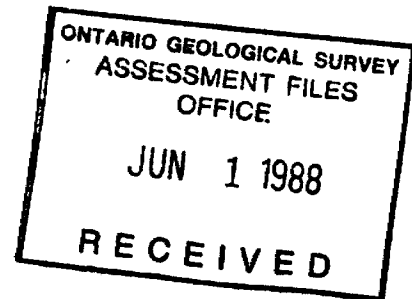

150 - FOOT OF HOLE. M87-5 collar located 890' south and 330' west from Post # 1 of L.737296, Hincks Twp., Larder Lake Mining Division, Ontario. Casing pulled, 9 core boxes used. M87 - 5 started February 15 and was completed February 17th, 1988. (Joy Drill)

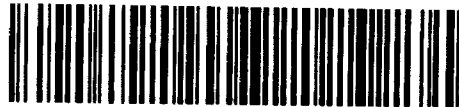

Name and Postal Address of Recorded Holder

WZEL RESOURCES LIMITED

T 46 99

300 ELM STREET WEST, SUDBURY, ONTARIO, P3C1V9

Summary of Work Performance and Distribution of Credits

Total Work Days Cr. claimed	Mining Claim			Work Days Cr.	Mining Claim			Work Days Cr.	Mining Claim			Work Days Cr.
	Prefix	Number	Work Days Cr.		Prefix	Number	Work Days Cr.		Prefix	Number	Work Days Cr.	
550	L.	919452	8	L	919398	20	L	919389	20			
		919453	20		919399	20		919383	20			
		919454	20		919400	20		919382	20			
		919455	20		919401	20		919390	20			
		919456	20		919402	20		919391	20			
		919457	20		919386	20		919392	20			
		919459	20		919385	20		919393	20			
		919397	20		919396	20		919394	20			
								919395	20			
								919405	20			
								919406	20			
								919387	22			

All the work was performed on Mining Claim(s): L 737296 (Hincks Twp.)

Required Information eg: type of equipment, Names, Addresses, etc. (See Table Below)

Drilled by: Trans-Arctic Explorations Limited
815-850 West Hastings, Vancouver, BC

Equipment: Joy 22 Wireline diamond drill

Core Size: BQ

Hole Numbers: M 87-4 RECORDED total = 550 ft.
M 87-5 = 150 ft.

Location: 890' South & 330' West from Post #1 of L. 737296
Hincks Township

DATES: Feb 4 → 17/88

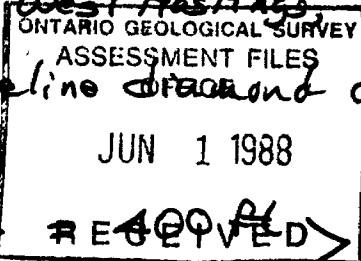

Hincks Tp

Date of Report: April 22/88
Recorded Holder or Agent (Signature): [Signature]

Certification Verifying Report of Work

I hereby certify that I have a personal and intimate knowledge of the facts set forth in the Report of Work annexed hereto, having performed the work or witnessed same during and/or after its completion and the annexed report is true.

Name and Postal Address of Person Certifying

ROBERT A. BENNETT, P.Eng. RR 4, SITE 37, Box 1

SUDBURY, ONT. P3E4M9

Date Certified: April 22/88

Certified by (Signature): [Signature]

Table of Information/Attachments Required by the Mining Recorder

Type of Work	Other Information (Common to 2 or more types)	Attachments
Manual Work	Names and addresses of men who performed manual work/operated equipment, together with dates and hours of employment.	Work Sketch: these are required to show the location and extent of work in relation to the nearest claim post.
Shaft Sinking, Drifting or other Lateral Work		
Compressed air, other power driven or mechanical equip.	Names and addresses of owner or operator together with dates when drilling/stripping done.	Work Sketch (as above) in duplicate
Power Stripping		
Diamond or other core drilling	NII	NII
Land Survey		

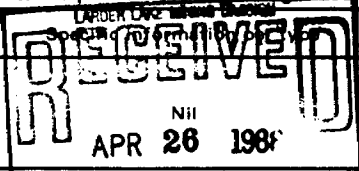

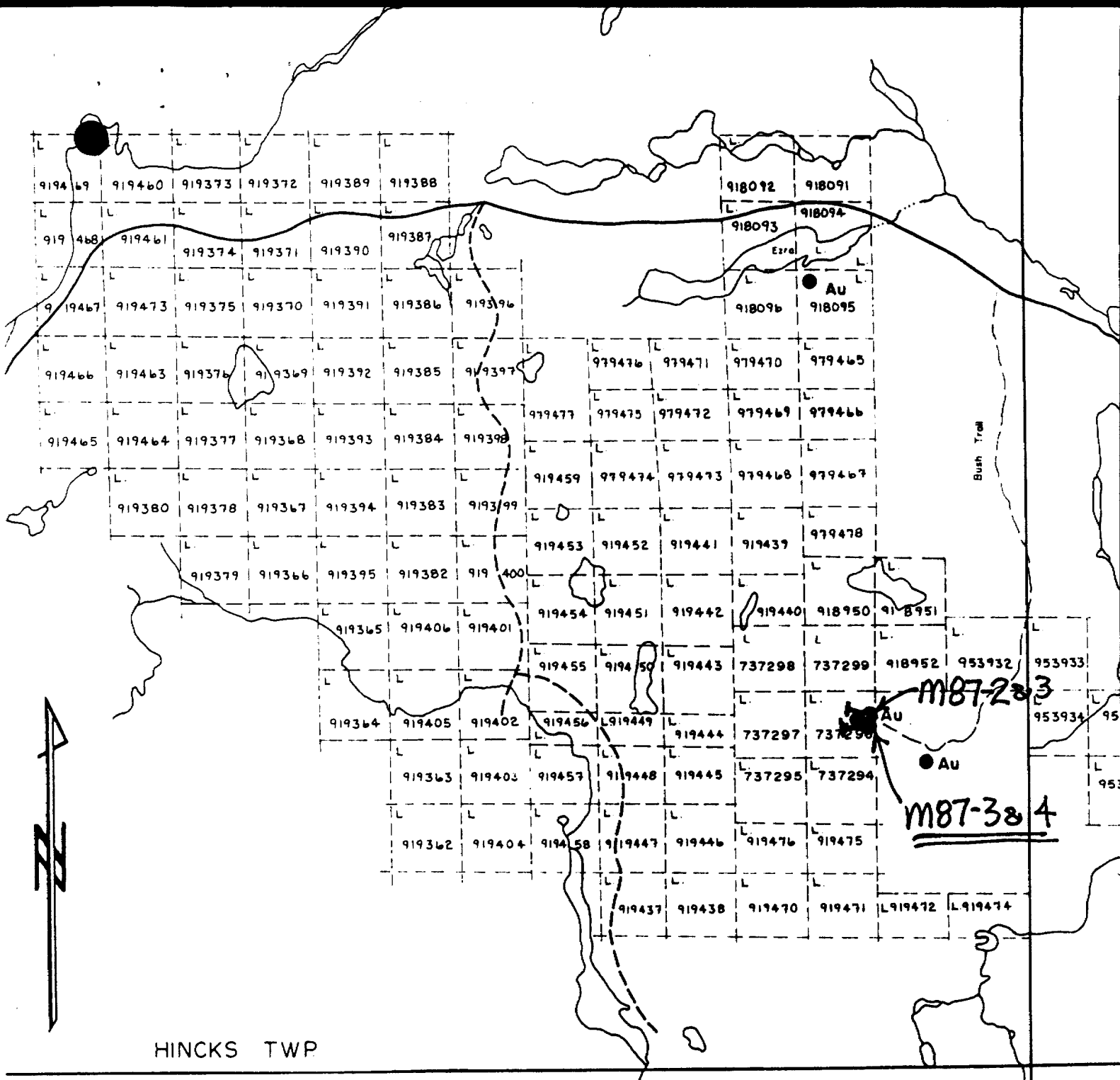

HINCKS TWP

MONTROSE TWP

WILZEL RESOURCES LTD.
 WEST MATACHEWAN PROJECT
Claim & Location Map

RMB

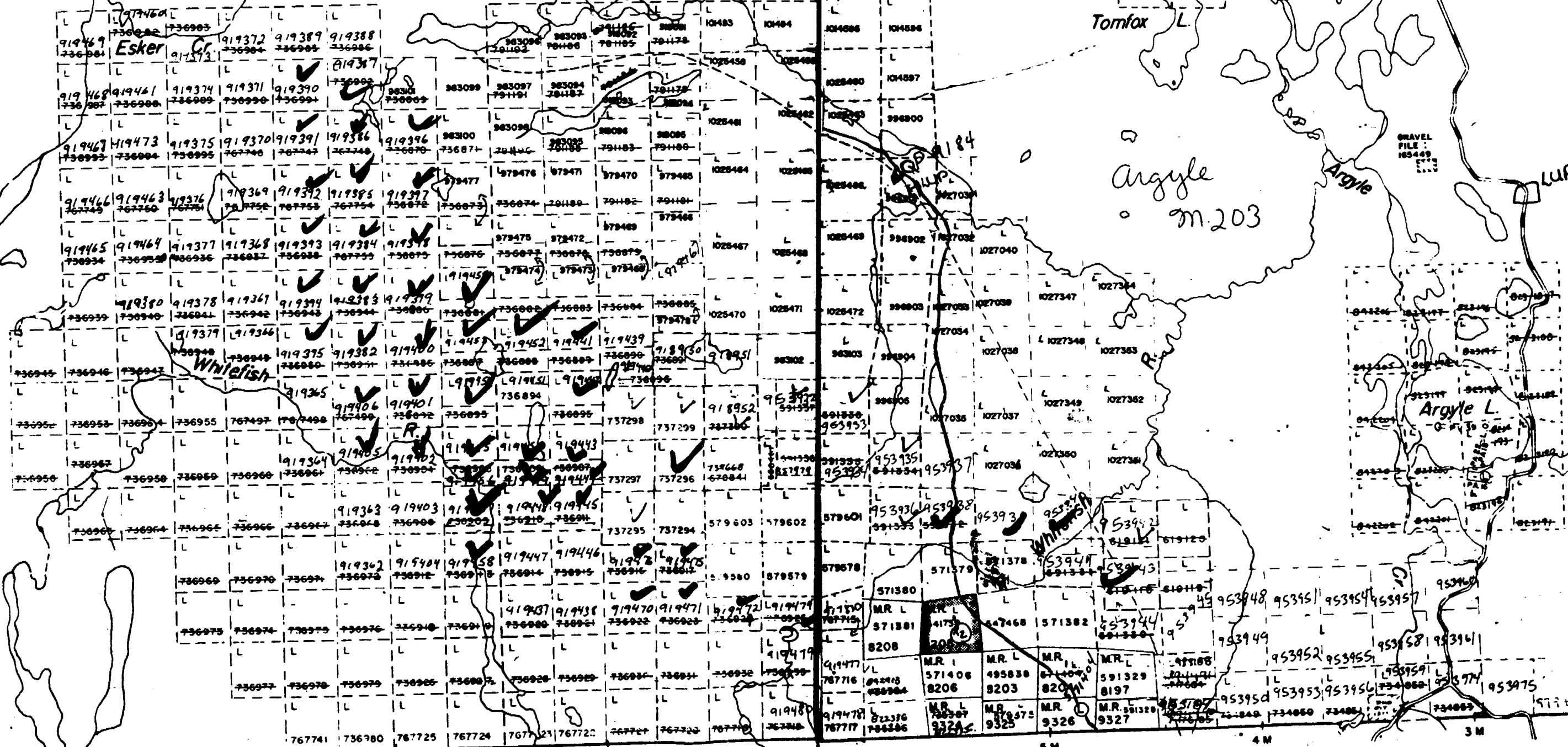

4M 3M 2M 1M 5M 4M 3M

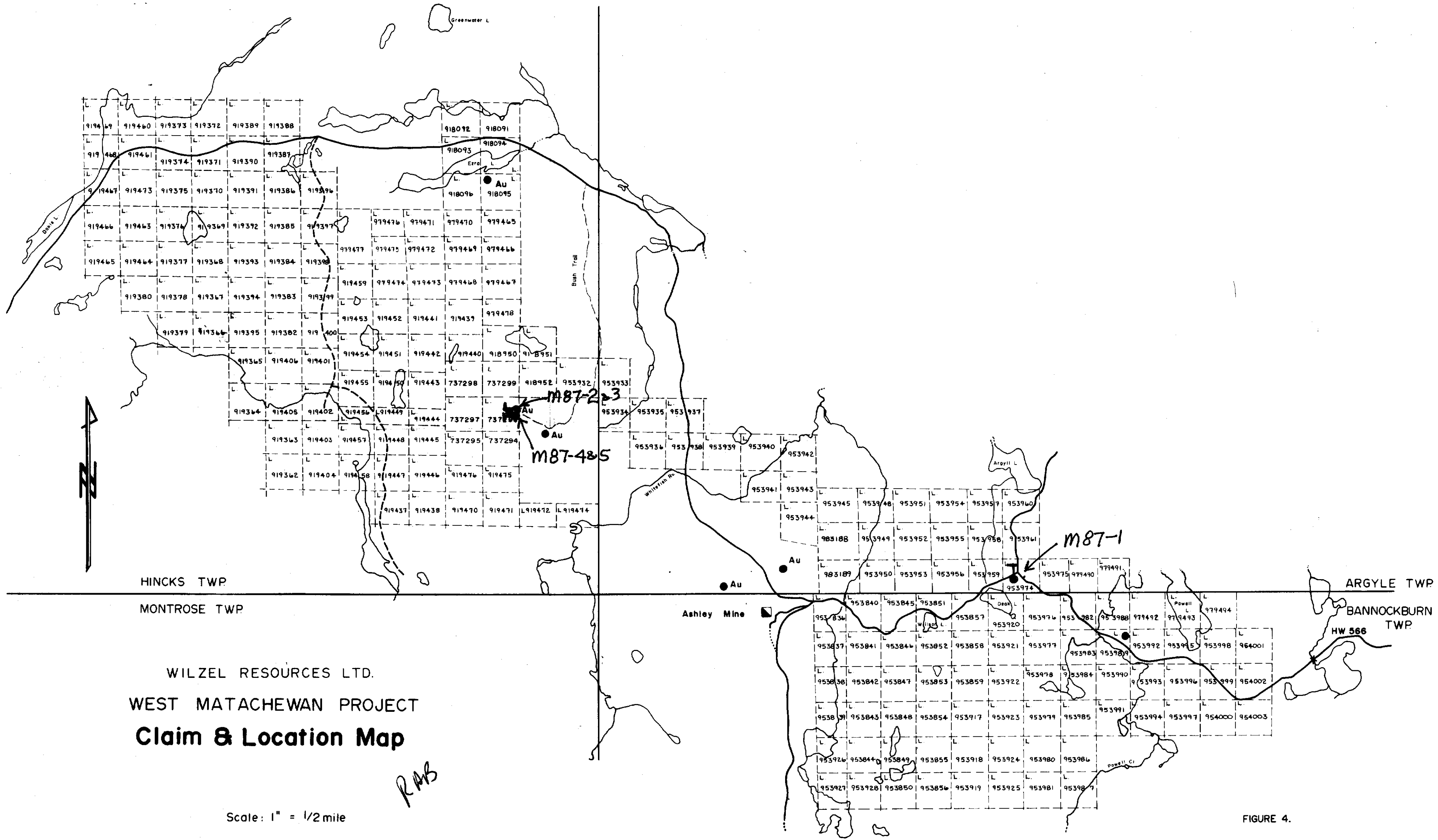

HINCKS TWP
MONTROSE TWP

ARGYLE TWP
BANNOCKBURN TWP

WILZEL RESOURCES LTD.
WEST MATACHEWAN PROJECT
Claim & Location Map

RAB

Scale: 1" = 1/2 mile

FIGURE 4.

NOV 1987

