



42A625W6346 13 BANNOCKBURN

010

### Diamond Drilling

Township OF BANNOCKBURN

Report NO: 13

Work performed by: THE HANNA MINING COMPANY

Claim NO	Hole NO	Footage	Date	Note
382474	Road No.1	179'	Sept 28/74	(1)
	Road No.2	124'	Oct 2/74	(1)
		363'		

### Notes:

(1) # 20-75

ARGYLE TWP. - M.203

#20-75 Bannockburn Twp.

SE TWP. - M.237

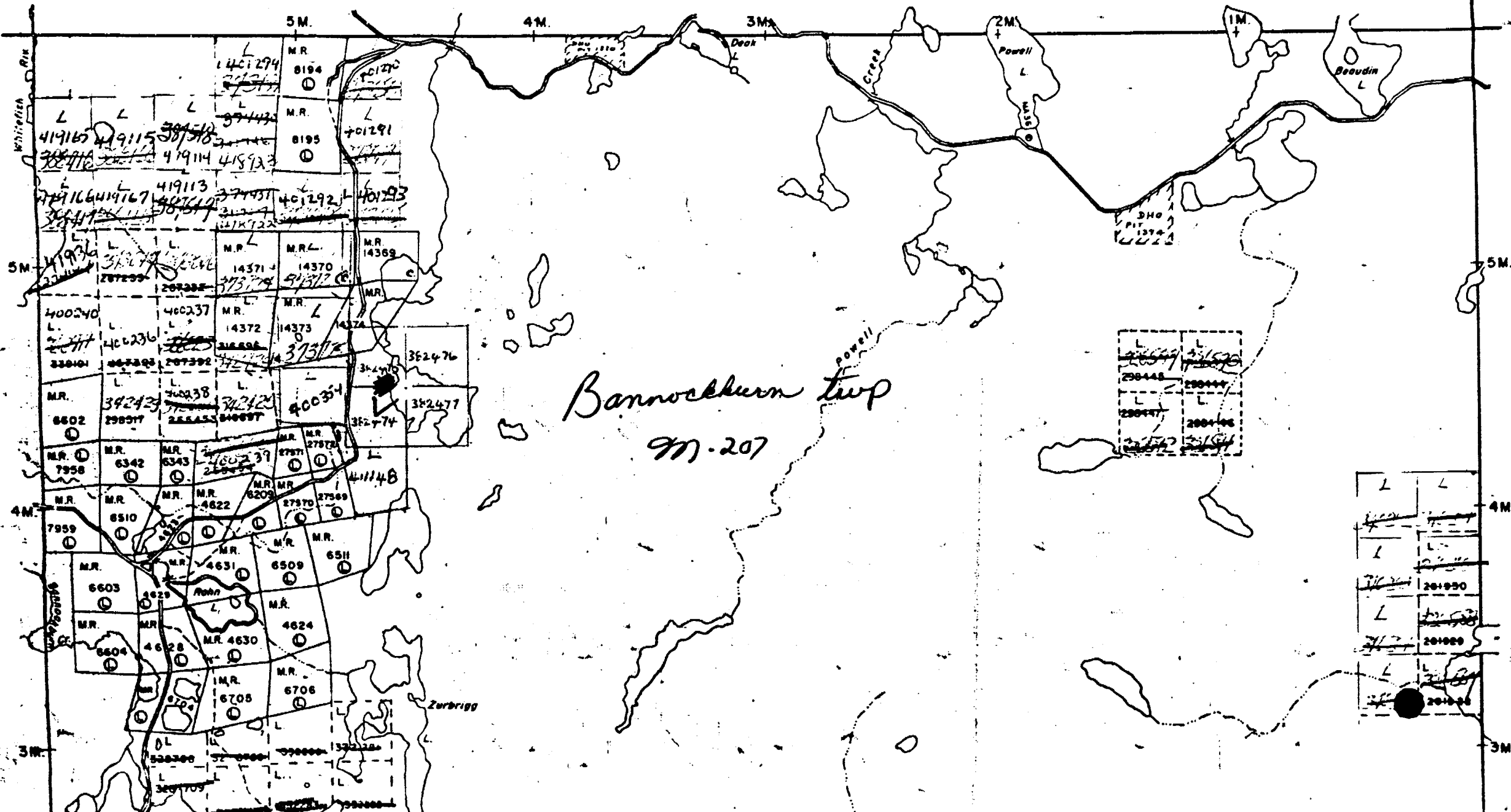

L	L
L	L
L	201950
L	201951
L	201952
L	201953

Property: Matachewan Project (Road Group) THE HANNA MINING COMPANY Sheet 1 of 2  
 Logged by: B. L. Hodgins Location: Claim #382474 Bearing: 180° Depth: 179'  
 Date: October 2, 1974 XX S - 9+10 Inclination: -43° Started: Sept. 28, 1974  
 Drilled by: Heath and Sherwood E - 1+65 Elevation: - Completed: Oct. 2, 1974

Footage		Description	ANGLE OF BEDDING OR FOLIATION TO CORE		Samples				Assays
From	To		FOOTAGE	ANGLE	No.	From	To	Core Length	
0	37	Casing - Overburden - sand, gravel and boulders.							
37.0	136.2	<p>Felsic Volcanic Breccia - Feldspars, quartz, amphibole, fine to medium textured feldspathic rock, light to dark gray. Fragments vary in size, composition, angularity and amount throughout section. Some short sections consist almost entirely of fragments. Fragments are probably derived from flow and tuff sources.</p> <p>119 - 136.2 - Consists almost entirely of angular to sub-rounded fragments with apparent reaction rims (?) - fragments range to 3" across, are unsorted and pyritiferous.</p> <p>The whole section is carbonatized with abundant fractures, filled with carbonate. Pyrite is a common accessory mineral and occurs in amounts to 5% across 6" sections as disseminations, stringers and blebs. In some sections the fragments seem to be pyritized.</p>							
136.2	165.8	<p>Carbonaceous Zone with Pyrite - Finely laminated, schistose? - poor core recovery - 40%, (section made water). 3" quartz-feldspar band in section 136.2 to 142.0. Graphitic slips</p>	136.2	42°					



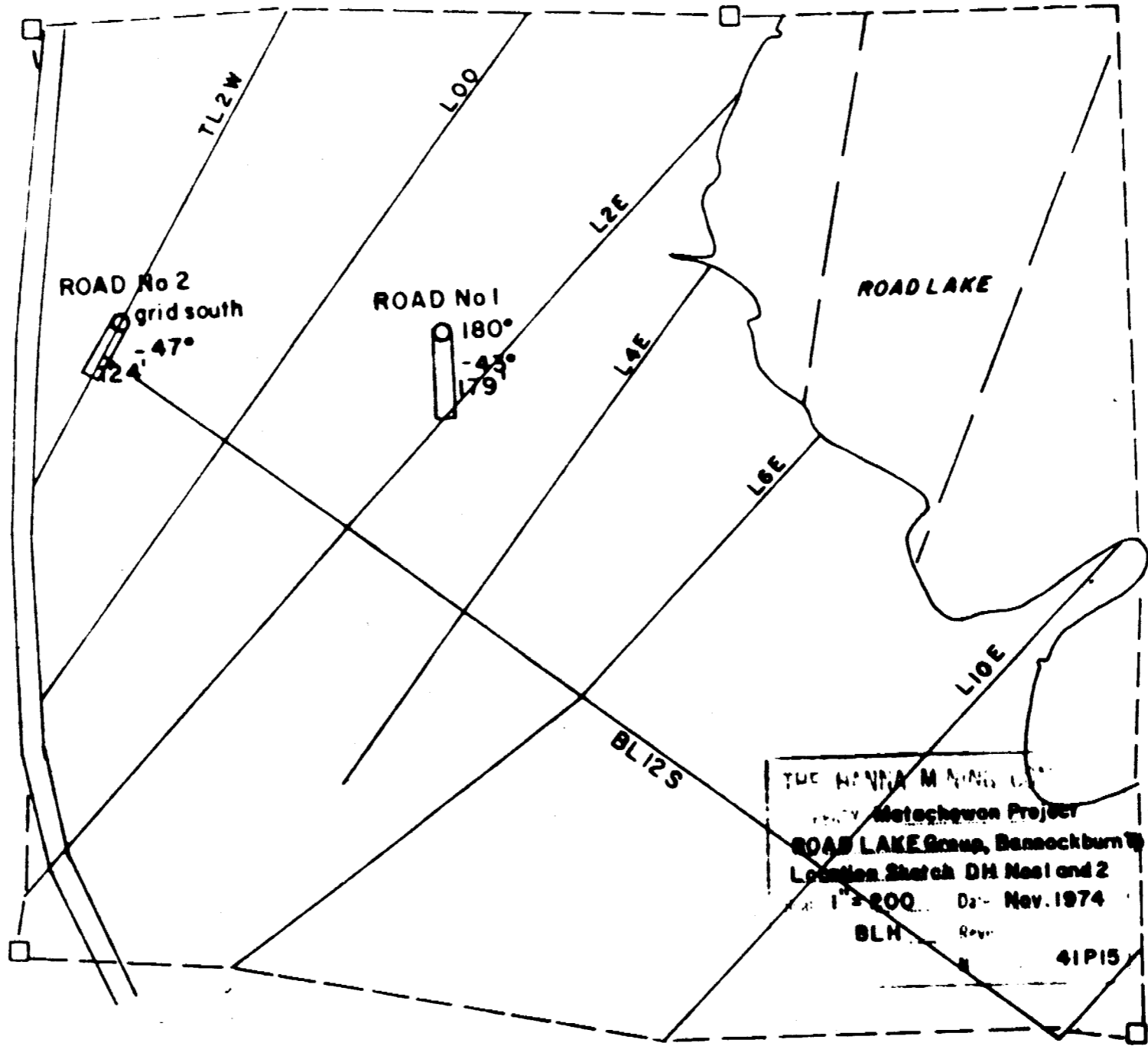

ROAD No 2  
grid south  
124° - 47'

ROAD No 1  
180° - 179'

ROAD LAKE

THE HANNA MINING CO.  
Metochewon Project  
ROAD LAKE Group, Banockburn  
Location Sketch DH No 1 and 2  
Scale 1" = 200' Date Nov. 1974  
BLH Rev  
41P15

Property: **Matachewan Project** THE HANNA MINING COMPANY Sheet **1** of \_\_\_\_\_  
 Logged by: **B. L. Hodgins** Claim #382474 Bearing: **Grid South** Depth **124** Drill Hole No.: **Road No.2**  
 Date: **Oct.3, 1974** Location: **XX-S -11+50** Inclination: **-47°** Started: **Oct.2, 1974**  
 Drilled by: **Heath and Sherwood** **XX-W -line 2+00** Elevation: **-** Completed: **Oct.3, 1974**

Footage		Description	ANGLE OF BEDDING OR FOLIATION TO CORE		Samples				Assays
From	To		FOOTAGE	ANGLE	No.	From	To	Core Length	
0	23	Casing - Overburden sand, gravel and boulders.							
23	124	Rhyolite Breccia -- Feldspar, quartz, minor amphiboles. Whole section seems to be pyroclastic with several different types of fragments. Rock is relatively hard and feldspathic. The fragments have a fine to medium texture with many of them being porcellanic. Fragments are usually less than 1.0" in size with some up to 3" across. Much of the section has yellowish-gray cast (sericitic). Fragments make up almost all of the section with very minor matrix. Locally small angular patches of black, hard matrix material occur (carbonaceous silica rich rock?). A section 95.5 to 109 has a matrix of soft carbonaceous black material that is graphitic and pyritic. -No bedding is apparent, poor core recovery. Pyrite is common throughout and it varies from less than 1% to about 3% as disseminations, stringers and blebs. The blebs are common in the carbonaceous section. The rock is carbonatized throughout. It is more abundant below the carbonaceous zone.							
124		END OF HOLE							

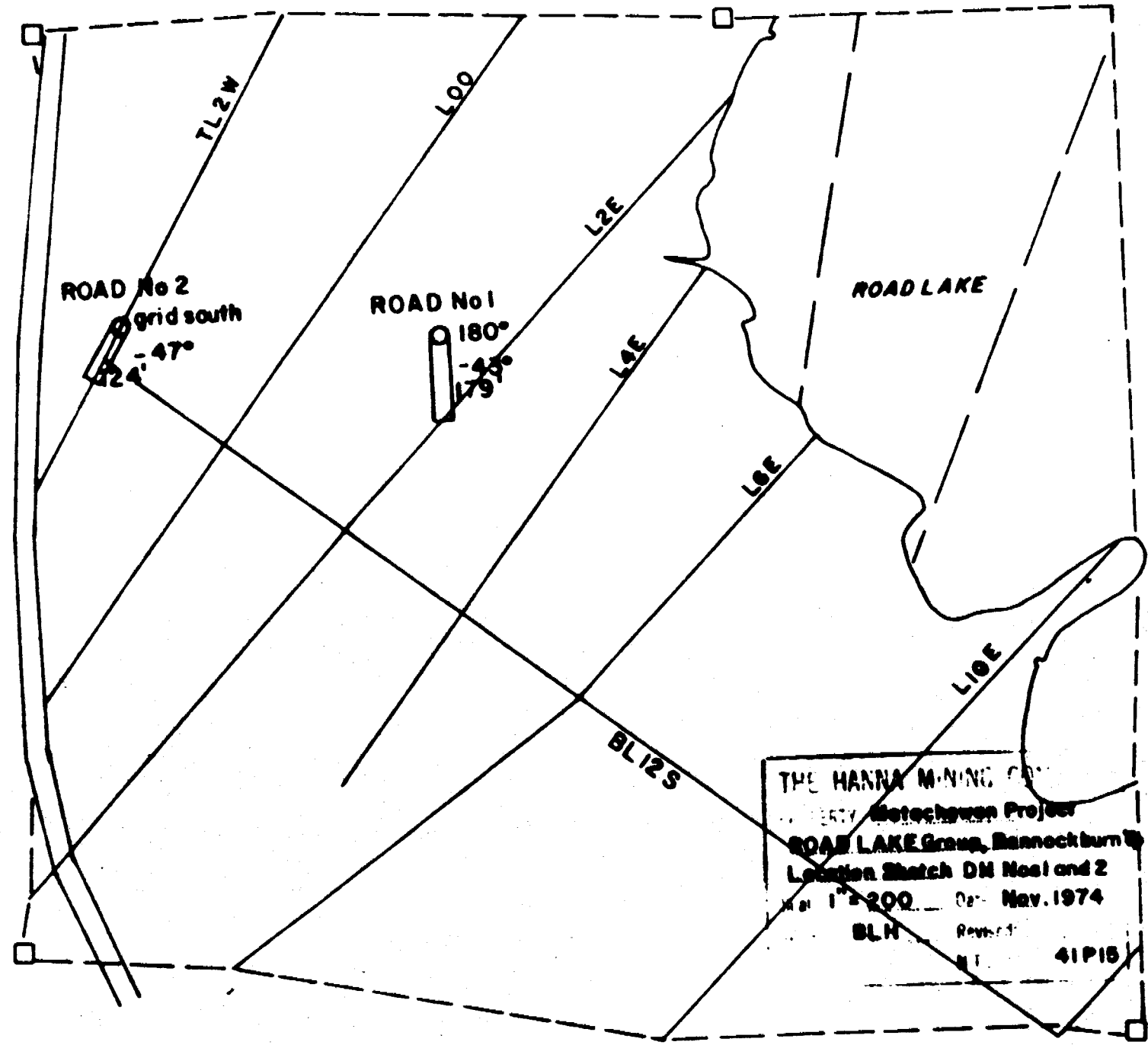

ROAD No 2  
grid south  
47°

ROAD No 1  
180°

ROAD LAKE

THE HANNA MINING CO.  
Metochgwan Project  
ROAD LAKE Group, Bannockburn  
Location Sketch DM Nos 1 and 2  
Scale 1" = 200' Date Nov. 1974  
BLH Rev. 1  
41 P 15