

STRIPPING & SAMPLING PLAN

MAIN SHOWING AREA

102 GROUP

POWELL TOWNSHIP, ONTARIO

SCALE 1.2 : 1,000



010

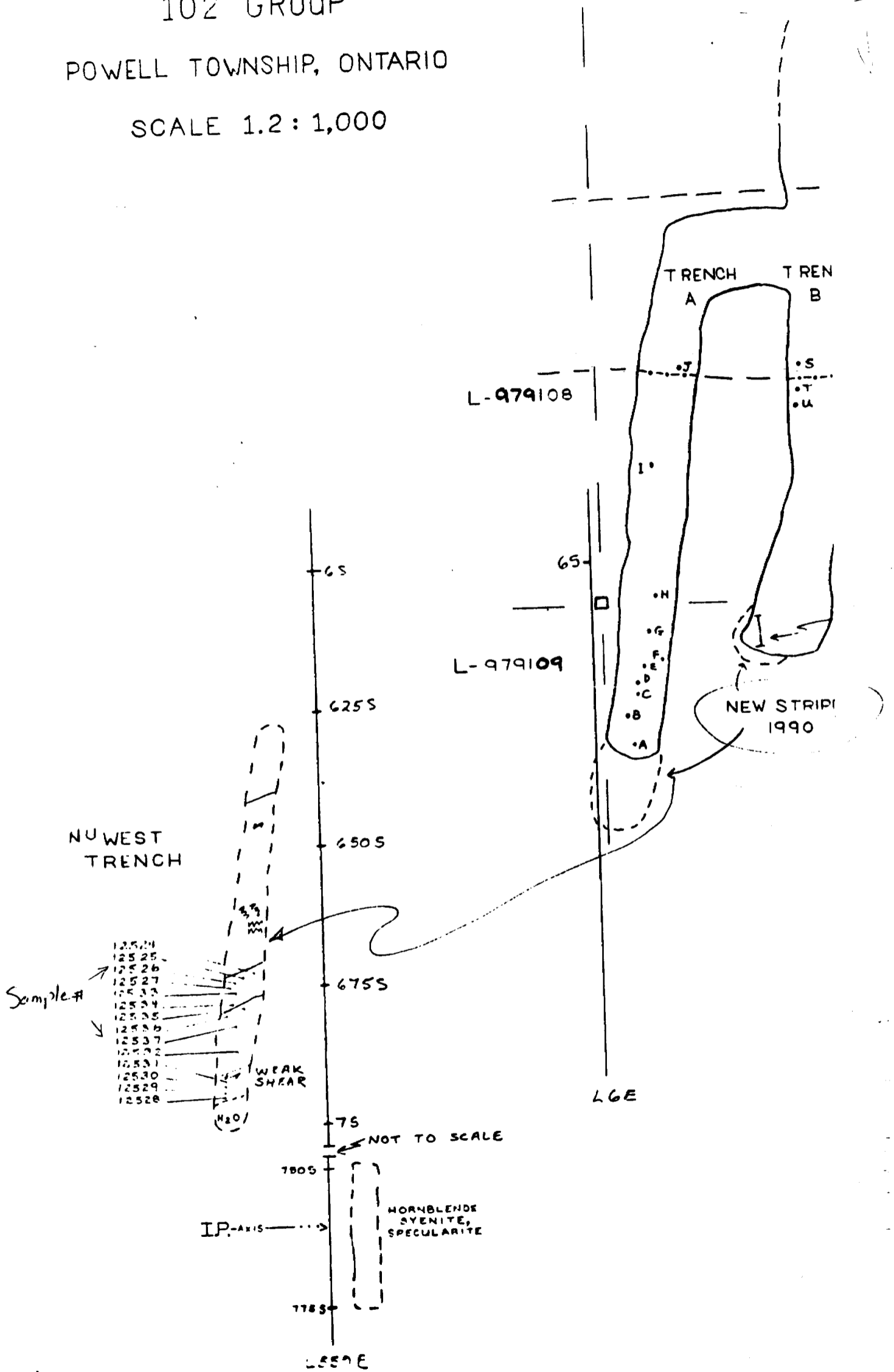

MAP B
 STRIPPING & SAMPLING
 PLAN
 SULFIDE ZONE
 102 GROUP
 POWELL TOWNSHIP
 ONTARIO
 SCALE 1:300
 L-981897 (NW corner)

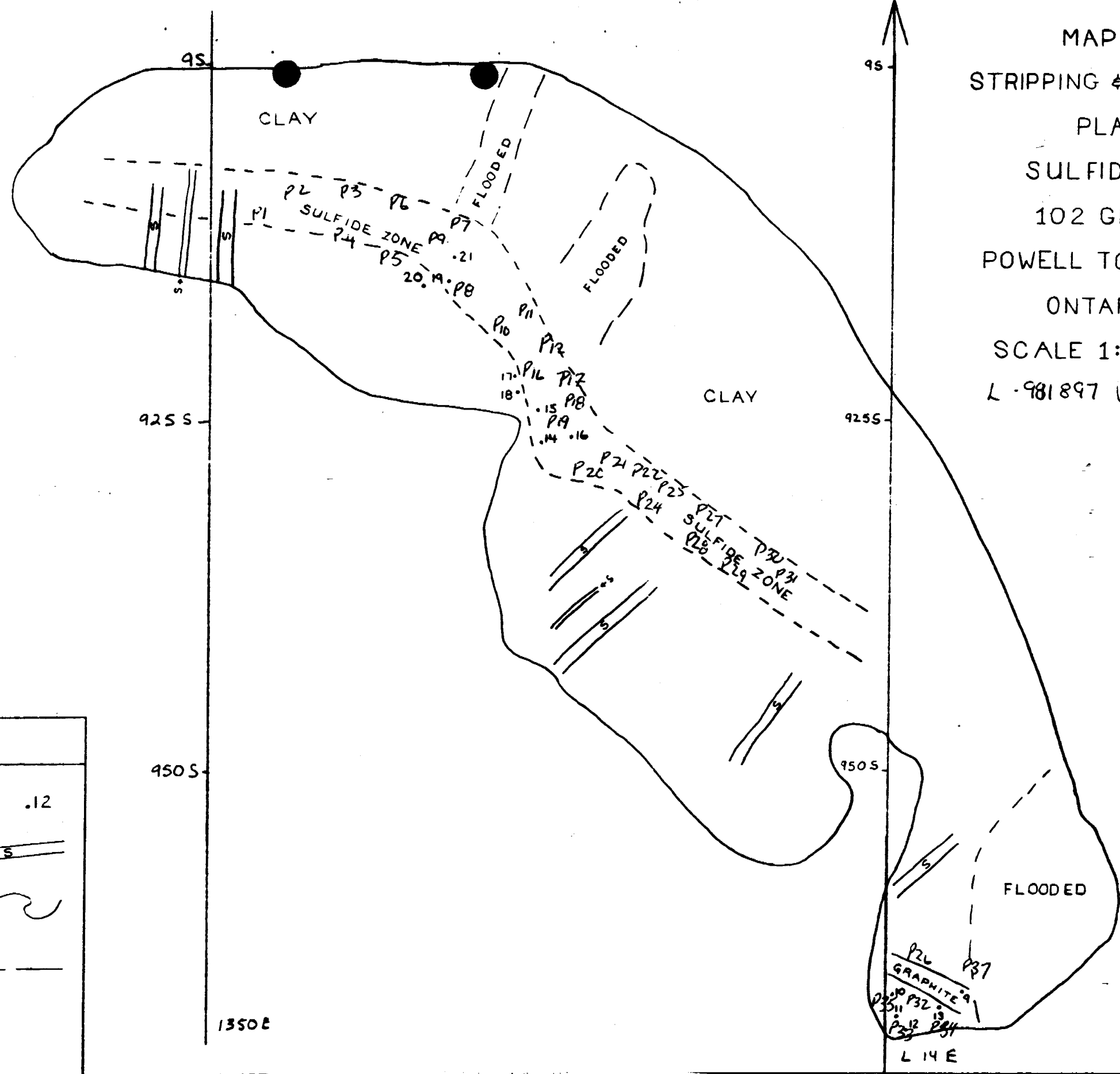

LEGEND	
SAMPLE #	.12
SYENITE	
STRIPPING	
CLAIM LINE	

ALEX MACINTYRE & ASSOCIATES LIMITED

MINING CONTRACTORS

FAX 705-567-4925

P.O. BOX 517

PHONE 705-567-3266

KIRKLAND LAKE, ONTARIO

P2N 3J5

I N V O I C E

Kiernicki Exploration
P. O. Box 1143
KIRKLAND LAKE, Ontario

Invoice No. : 978
Date : Sept 17/90
Your P. O. No: Verbal

To Work on your Claims - Matachewan Area

<u>Date</u>	<u>Backhoe</u>
Sept 11	3
12	10
13	10
14	10
15	<u>2</u>
	35

RH 12 Backhoe 35 Hours @ \$ 85.86

3,005.10

TOTAL INVOICE

\$ 3,005.10
~~~~~

# PAID

- ALEX MacINTYRE & ASSOC. LTD. -

P.O. BOX 517

KIRKLAND LAKE, ONT. P2N 3J5

*Bill Bennett*

AL

63:5458

DOCUMENT No. 9108.00112



42A625W8503 63.5458 POWELL

900

Mining Act Report of Work

Name and Address of Recorded Holder: FRED KIERNICKI, Box 1143 Kirkland Lake Ont. P2N-3M7. Prospector's Licence No. K19582. Telephone No. 567-4858

Summary of Distribution of Credits and Work Performance

Table with columns: Mining Division (Larder Lake), Mining Claim (Prefix, Number), Work Days Cr. Includes entries for claims 971906, 971907, 971908, 971909, 971910, 971911, 979107, 979108, 979109.

Dates when work was performed: From Sept 10/90 To Sept 14/90. Total No. of Days Performed: 300.5. Total No. of Days Claimed: 300.5.

Table for Mining Claim(s) with columns: Mining Claim, No. of Days. Includes entries for 981897 (200 days) and 979107 (100.5 days).

Required Information eg. type of equipment, Names, Addresses, etc. (See Table on reverse side). Includes text: ALEX McJINTYRE & ASS. JOHN-DEERE BACKHOE 792 MODEL. 35 hrs @ 85.86 = 3,005.10. Includes 'RECEIVED' stamp dated MAY 07 1991.

Certification of Beneficial Interest: I hereby certify that, at the time the work was performed, the claims covered in this report of work were recorded in the current recorded holder's name or held under a beneficial interest by the current recorded holder. Date: March 12/91. Recorded Holder or Agent (Signature): Fred Kiernicki.

Certification Verifying Report of Work: I hereby certify that I have a personal and intimate knowledge of the facts set forth in the Report of Work annexed hereto, having performed the work or witnessed same during and/or after its completion and the annexed report is true. Name and Address of Person Certifying: Fred Kiernicki, Box 1143 Kirkland Lake Ont. P2N-3M7. Telephone No. 567-485. Date: March 12/91. Certified By (Signature): Fred Kiernicki.

For Office Use Only

Work Assignments: 981897 183. 3817. 979107 93.5 3906.5. (Fred Kiernicki). Received Stamp: LARDER LAKE MINING DIVISION, 01 MAR 12 PM 1 38, RECEIVED.

AL

W9108.00112

# N C E S

## DISPOSITION

ONLY  
S ONLY  
FACE RIGHTS

Disposition File  
13 S+M

Bader

INFORMATION THAT  
APPEARS ON THIS MAP  
HAS BEEN COMPILED  
FROM VARIOUS SOURCES.  
NO ASSURANCE OF  
ACCURACY IS NOT  
GUARANTEED. THOSE  
INTERESTING TO STAKE MIN-  
ING CLAIMS SHOULD CON-  
SULT WITH THE MINING  
OFFICE, MINISTRY OF  
NORTHERN DEVELOP-  
MENT AND MINES, FOR AD-  
DITIONAL INFORMATION  
ON THE STATUS OF THE  
CLAIMS SHOWN HEREON.

Bannockburn Twp.

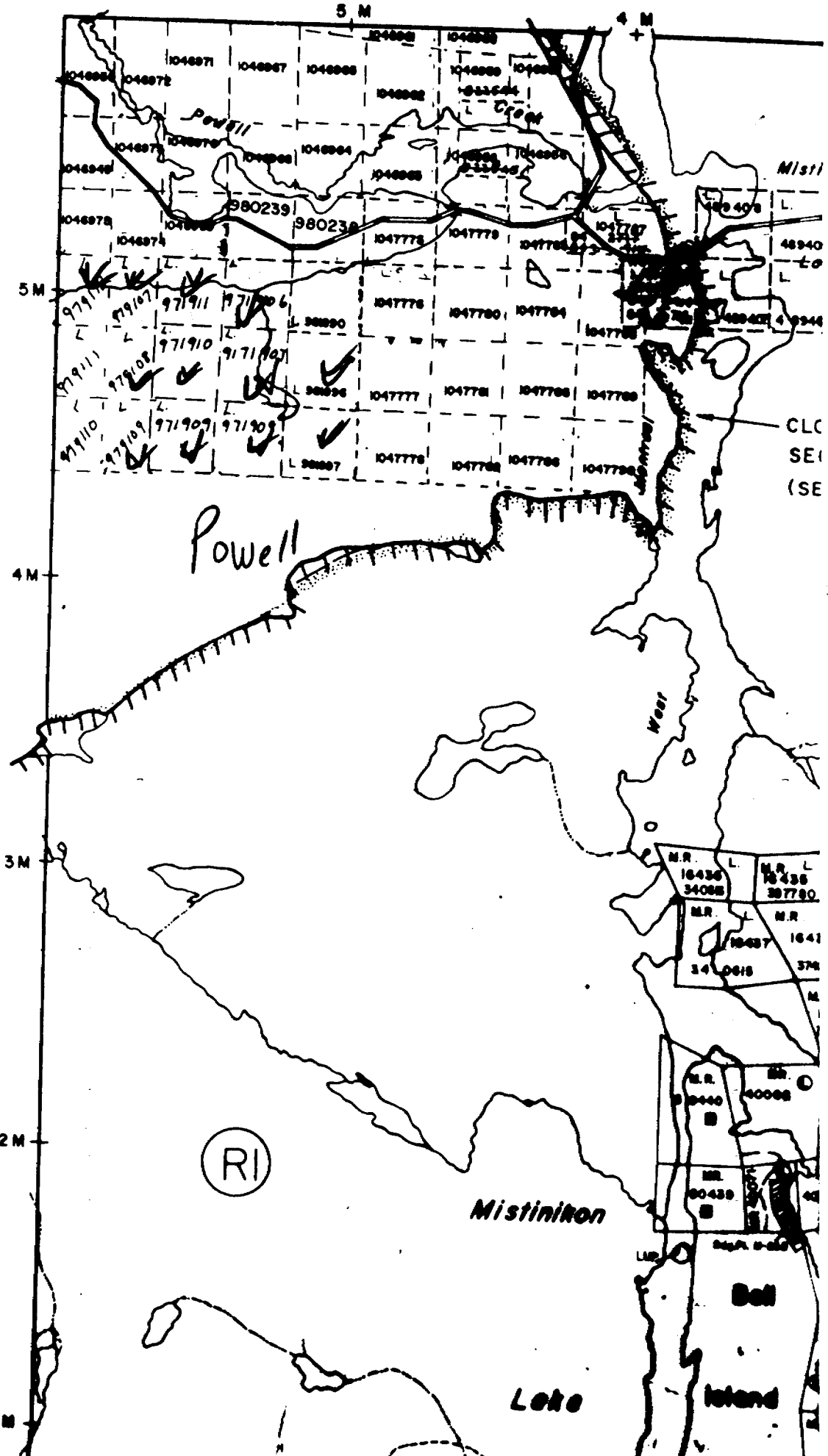

LE 1888

IN THIS  
YDRO

FT

Al

W 9108.0011

# ARGYLE TWP. - M.203

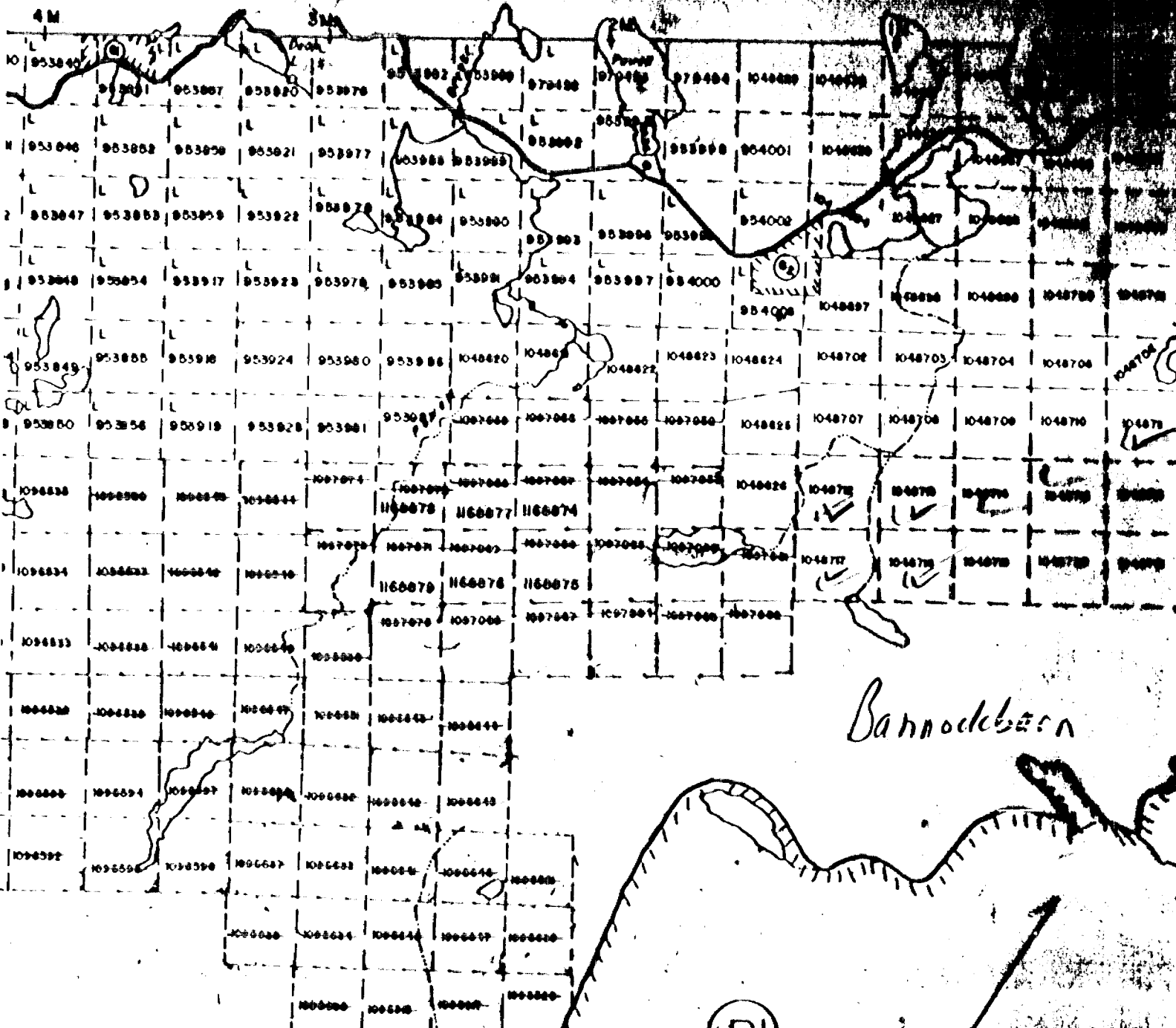

Bannockburn

(RI)

CLOSED TO STAKE SUBJECT TO SEC. 38 (1)  
OF MIND AS OF 17/1/17

AL

N C E S

FROM DISPOSITION

ONLY  
ONLY  
RIGHTS

Disposition File

1/83 5+11

INFORMATION THAT  
APPEARS ON THIS MAP  
HAS BEEN COMPILED  
FROM VARIOUS SOURCES.  
ACCURACY IS NOT  
GUARANTEED. THOSE  
WISHING TO STAKE MIN-  
ING CLAIMS SHOULD CON-  
SULT WITH THE MINING  
REGULATORY BOARD,  
NORTHERN DEVELOP-  
MENT AND MINES, FOR AD-  
DITIONAL INFORMATION  
ON THE STATUS OF THE  
CLAIMS SHOWN HEREON.

FILE 18885

IN THIS  
HYDRO

ACT

Bannockburn Twp.

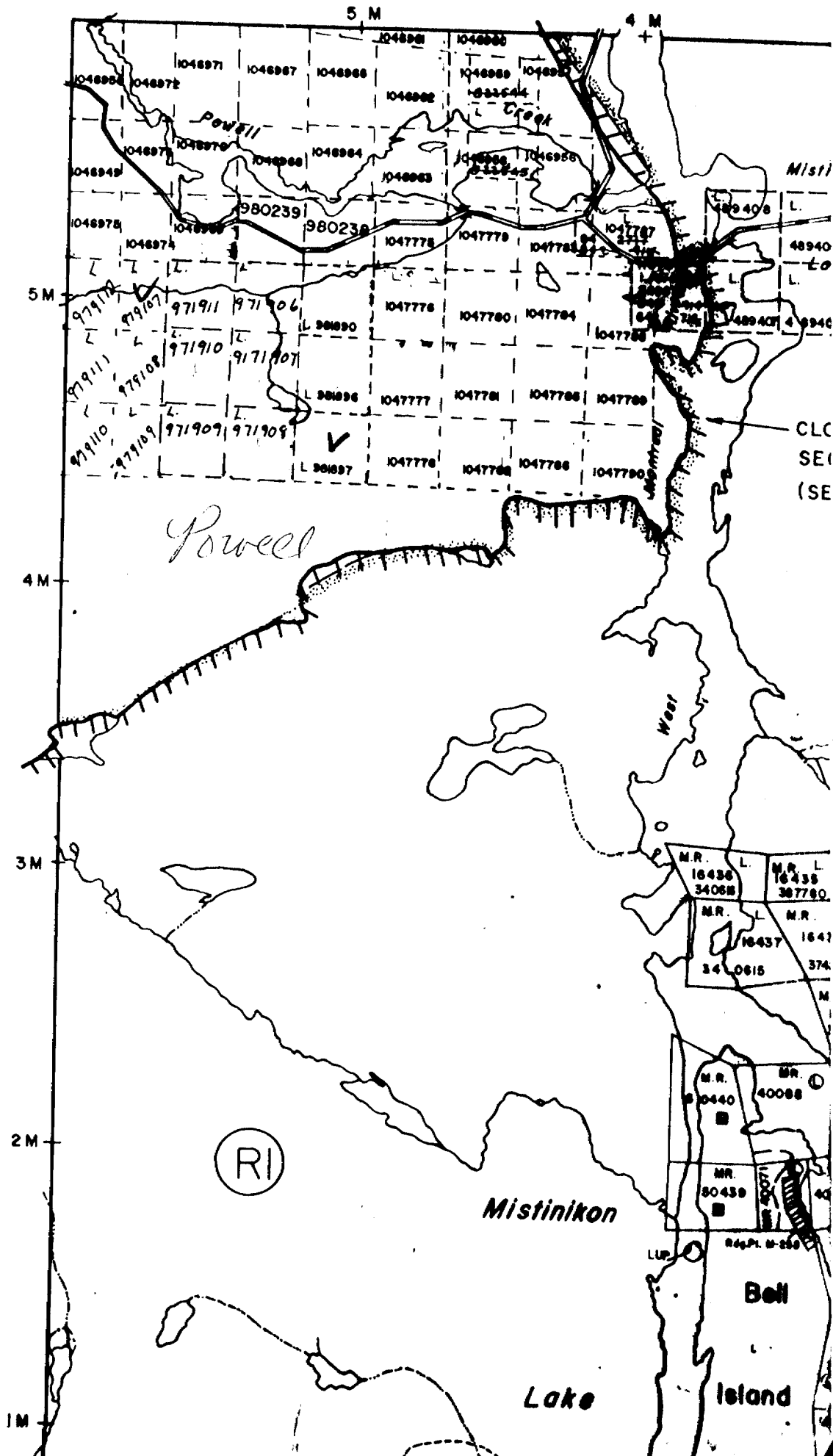

Bader

Mist

CLC  
SE  
(SE

|            |          |            |           |
|------------|----------|------------|-----------|
| M.R. 16436 | L. 34068 | M.R. 16438 | L. 367760 |
| M.R. 16437 | L. 34065 | M.R. 16439 | L. 374    |

|            |          |
|------------|----------|
| M.R. 50440 | L. 40088 |
| M.R. 50439 | L. 40071 |

Bell Island

Lake

Mistinikon

(RI)