

Report on the Elect



42A03NE0043 63.1868 CLEAVER

010

for B. W. Lang

Cleaver Township Property

---

Background

This property consists of 56 claims in a group located in the south-west quadrant of Cleaver Township, Montreal River Mining Division, Ontario. The ground was staked to cover an area of geologically favourable rhyolite-andesite contact.

A base line was cut and reconnaissance grid laid out with a 400' line interval. This grid consisted of 31 line miles.

Instrument Used:

A Crone dual frequency E.M. Unit was used throughout the survey using the "High" (1800 cps) frequency. The in-line method was used with a 300' coil separation. On this property two crews were employed consisting of three men each. The readings were recorded at the mid-point between the two coils.

Results:

No anomalies were detected on the property the readings over the entire area covered being exceptionally flat. No response was obtained from a quartz-pyrite trenched showing located at 14 + 00 W, Line 0 + 00.

Certain areas of the claim group were flooded due to heavy rain fall during and previous to the survey period, (October, 1965). Thus E.M. coverage on this portion of the claim group will not be possible until after freeze-up.

Claims covered are noted in the attached list.

Other than E.M. coverage of the 17 flooded claims, no further work is recommended.

Respectfully submitted,

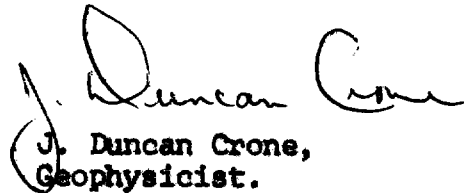
  
J. Duncan Crone,  
Geophysicist.

Toronto, Ontario,  
November 20th, 1965.

Use  one type of survey only



900

Assessment Work Breakdown

1. Type of Survey Electromagnetic

2. Township or Area Cleaver  
M.R.

3. Mining claim numbers 41180, 41181, 41182, 41183, 41184, 41185, 41186, 41187, 41188,  
41189, 41190, 41191, 41192, 41193, 41194, 41195, 41196, 41197, 41198, 41199,  
41200, 41201, 41206, 41209, 41210, 41211, 41212, 41213, 41214, 41215, 41234,  
41235, 41236, 41237, 41238, 41239, 41240, 41241, 41244.

4. Number of miles of line cut 5

\* 5. Type of instrument used Crone Dual Frequency E.M.

\* 6. Scale constant or sensitivity + 1° Resultant Dip Angle

\* 7. Number of stations established 1509

8. Summary of days worked ( details on reverse side )

Total technical (include consultants, draughting etc.) 112 x 7 = 784

Total line-cutting 12

Total man-days ( technical plus line-cutting ) 796

Assessment days credit per claim 20½

*note: Mining claims MR 41180-81-82, 41200, 41198-99 are sparsely covered. Additional area covered to same extent as these six claims equals at least three claims. To count additional areas would reduce credits to below 20 days which would place all claims in jeopardy for 1st year. Allow only 20 days per claim and pass as is.*

*H. M. Smith*

9. Dated November 26th, 1965. Signed J. D. Duncan

\* Complete only if applicable

Complete list of names, addresses and dates on reverse side

Use for one type of survey only

Assessment Work Breakdown

I. Technical

<u>Type of Work</u>	<u>Name &amp; Address</u>	<u>Dates Worked</u>	<u>Hours</u>	<u>Days</u>
EM	W. Gloster, Timmins, Ont.	Oct. 12 - 31	144	18
EM	E. Brier, Timmins, Ont.	Oct. 12 - 31	144	18
EM	C. Loock, Timmins, Ont.	Oct. 12 - 31	144	18
EM	J. Taylor, Red Bank, N. B.	Oct. 12 - 31	136	17
EM	T. Taylor, Red Bank, N. B.	Oct. 12 - 31	136	17
EM	H. Bears, Timmins, Ont.	Oct. 12 - 31	136	17
Totals			840	105

Consultants

<u>Name &amp; Address</u>	<u>Dates Worked (specify in field or office)</u>	<u>Hours</u>	<u>Days</u>
A. J. O'Donnell (Field)	Oct. 25 - 29	40	5
J. Duncan Crone (Office)	Nov. 20	8	1
Totals		48	6

Draughtsman, Typing, others (specify)

<u>Name &amp; Address</u>	<u>Type of Work</u>	<u>Dates Worked</u>	<u>Hours</u>	<u>Days</u>
R. Breitner	Typing	Nov. 26	8	1
Totals			8	1

2. Line-Cutting

<u>Name</u>	<u>Address</u>	<u>Dates Worked</u>	<u>Hours</u>	<u>Days</u>
G. Potter	Swastika, Ontario	Oct. 3 - 8	48	6
J. Duncan	Swastika, Ontario	Oct. 3 - 8	48	6
Totals			96	12

ACME GAS & OIL CO. LTD.  
 ELECTRO-MAGNETIC SURVEY  
 CLEAVER TOWNSHIP  
 MONTREAL RIVER MINING DIVISION  
 TIMMINS AREA ONTARIO  
 CRONE J.E.M. COILS 300' APART  
 READINGS: HIGH FREQUENCY  
 SCALE 1 INCH = 400 FEET

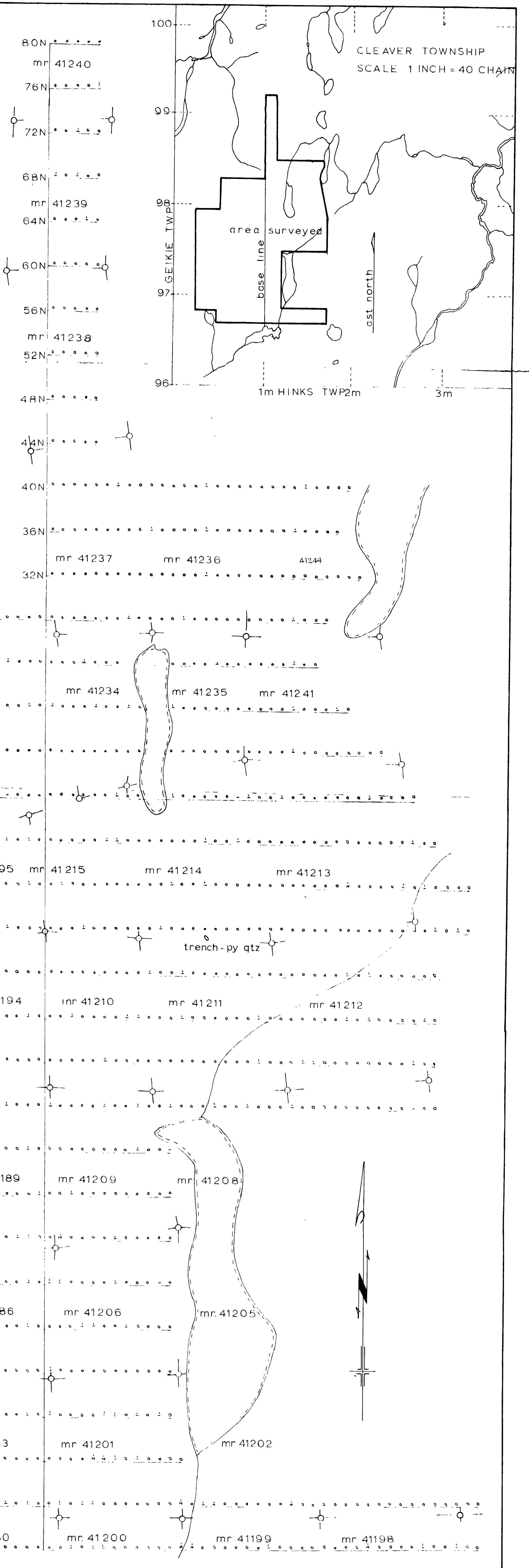

A. G. O'Donnell Oct. 1964

