



42A03NE0098 19 BARTLETT

010

Diamond Drilling

Township of BARTLETT

Report NO 19

Work performed by: Texmont Mines Limited

Claim NO	Hole NO	Footage	Date	Note
P 77846	10-A	837.0'	Oct/65	

Notes:

P-846

13-2-310

Claim No. 77846

Drilled by Bradley Bros. Drilling
 STARTED Oct. 14, 1965
 COMPLETED Nov. 1, 1965

HOLE NO. A-10
 PROPERTY Texmont Mines Limited
Bartlett, Geikie

DIP -45°
 $810' - 42^{\circ}$

BEARING Due West LENGTH 837
 LAT. 2600' N. of 5 mile post
 DEP. 300' E. of Base Line

ELEV. _____
 Logged by H. A. Pearson, P. Eng.

FOOTAGE		DESCRIPTION	CORE				
FROM	TO		SPL NO.	FROM	TO	WIDTH	GRADE
0	20.0	<u>Overburden</u> Casing	2934	55	60	5	0.01
			2935	60	65	5	0.01
20.0	498.0	<u>Granodiorite</u> Medium-grained, grey, red feldspar and hematite staining in parts, also containing fine sulphides in joints @ 50-70 and 285-290.	2936	285	290	5	0.01
498.0	508.5	<u>Aplite</u> Fine grained, grey, contact chilled contact zone.	2937	565	570	5	0.16
			2938	570	575	5	0.10
508.5	650.0	<u>Peridotite - Talcose</u> Fine and medium grained, flow texture down to 521; short sections serpentinite. Scattered sulphides and blebs @ 565-580.	2939	575	580	5	0.23
			2948	590	595	5	0.26
650.0	657.0	<u>Lamprophyre</u> Dyke; fine grained, brownish grey, has phlogophite and very little sulphides.	2949	655	660	5	0.14
			2950	660	665	5	0.44
			A1664	665	670	5	0.33
657.0	703.0	<u>Peridotite - Talcose</u> Same as 508-650; scattered sulphides; lean.	2940	670	675	5	0.56
			A1665	675	680	5	0.35
703.0	753.0	<u>Siliceous Sediments</u> Fine grained, grey, fine porphyritic texture in parts, dacite flow in other parts, cherty, brecciated @ 751-753; pyrite, pyrrhotite and monor chalcopyrite.	2941	680	685	5	0.26
			2942	685	690	5	0.38
			2951	690	695	5	0.38
			2952	695	700	5	0.26
753.0	761.0	<u>Aplite</u> Dyke; fine grained, light grey, fine sulphides.	2943	700	705	5	0.24
			2944	705	710	5	0.01
761.0	808.0	<u>Siliceous Sediments</u> Fine to medium grained, grey, volcanics, carbonatized sections.	2945	710	715	5	0.01
			2953	720	725	5	0.04
808.0	826.0	<u>Aplite</u> Dyke: fine grained, grey; lean.	2954	735	740	5	0.01
			2946	740	745	5	0.01
826.0	837.0	<u>Siliceous Sediments</u> Fine grained, grey and dark grey, graphitic in parts, light pyrite mineralization.	2947	745	750	5	0.01
			2955	750	755	5	0.06
			2956	755	760	5	0.01
			2957	760	765	5	0.08
837.0		END OF HOLE	2958	765	770	5	0.02
			2959	780	785	5	0.11
			2960	785	790	5	0.15
			2961	790	795	5	0.11
			2962	795	800	5	0.01

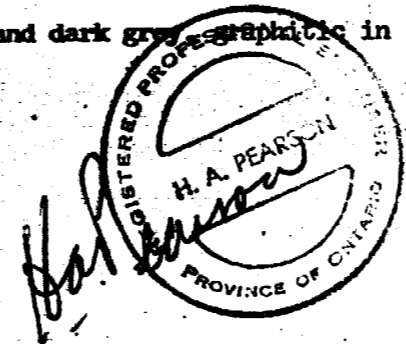

GRADE (% NI)	WIDTH	TO	FROM	Spl. No.
0.01	5	805	800	2963
0.01	5	810	805	2964

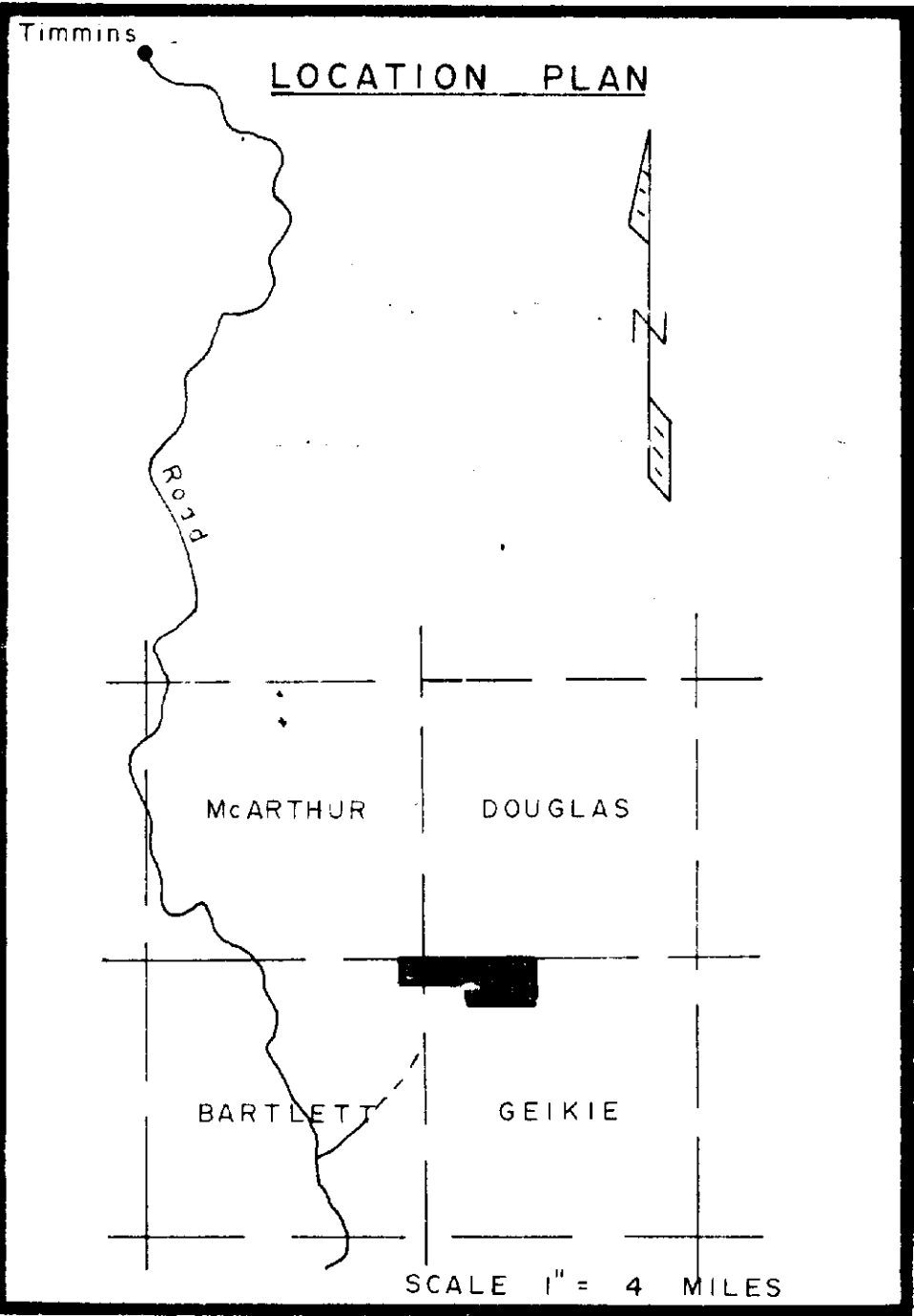
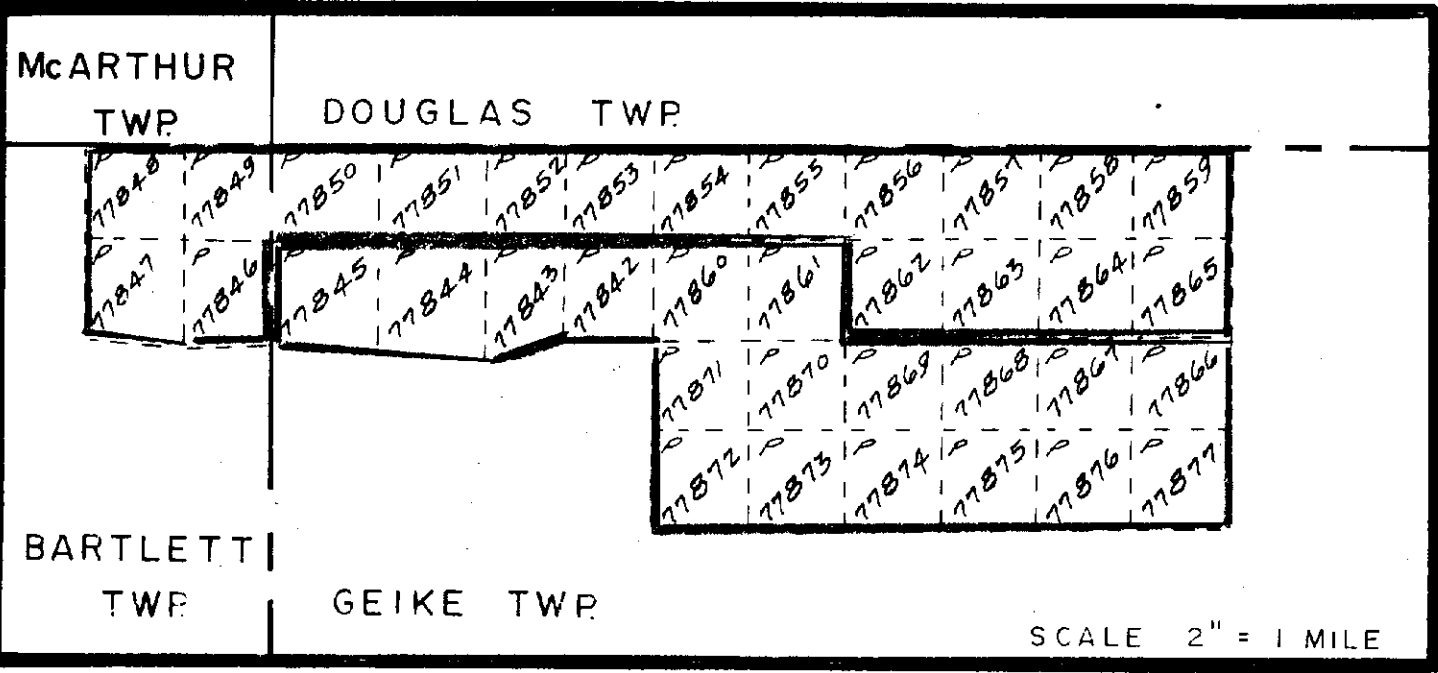
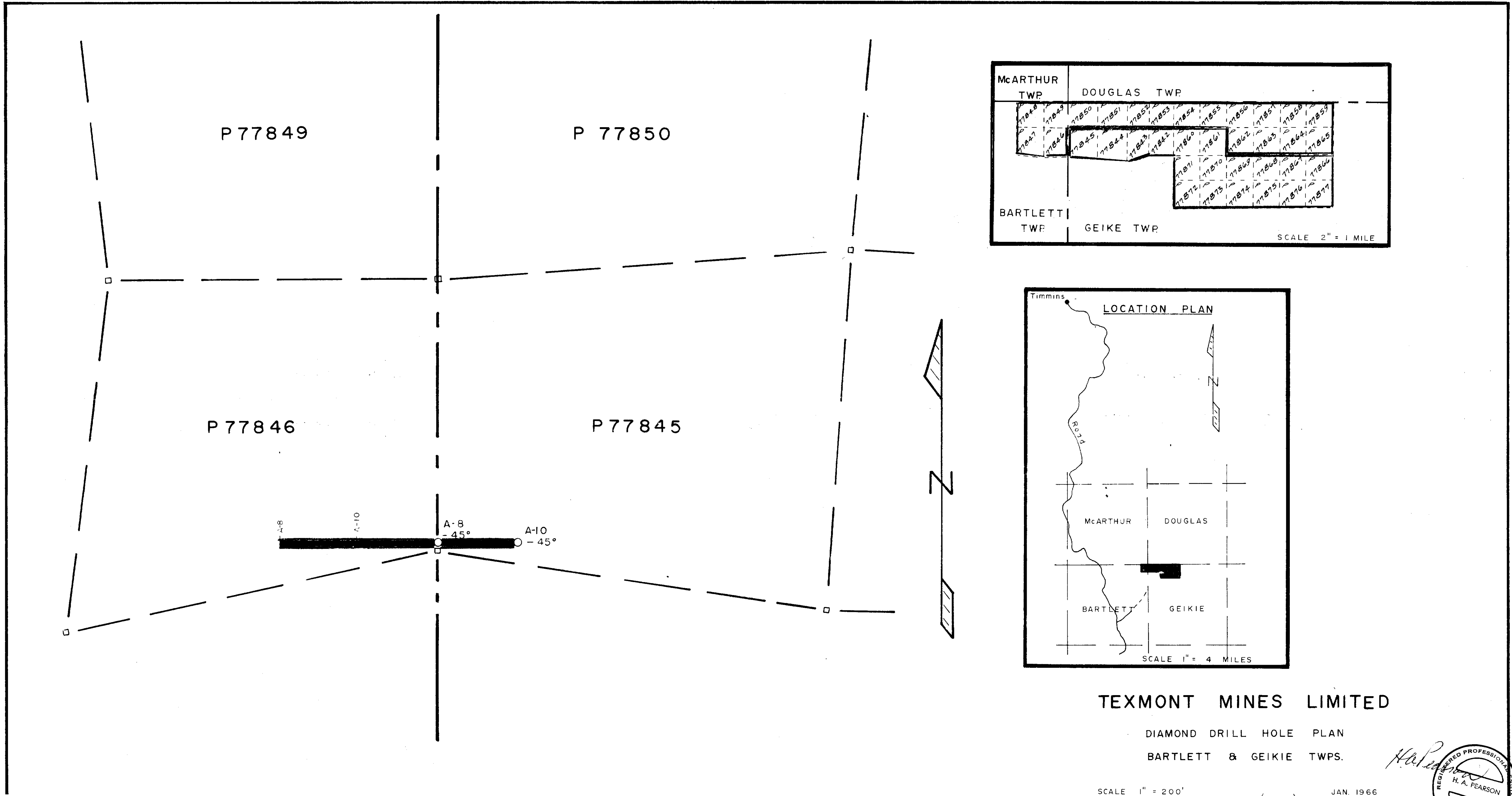

TEXMONT MINES LIMITED

DIAMOND DRILL HOLE PLAN
BARTLETT & GEIKE TWPS.

SCALE 1" = 200'

JAN. 1966
(12x2 1/2) 4 3/4 SA/IT

