



42A03NE1103 10 BARTLETT

010

Diamond Drilling

Township of BARTLETT

Report N<sup>o</sup> 10

Work performed by: Dominion Gulf Company

Claim N <sup>o</sup>	Hole N <sup>o</sup>	Footage	Date	Note
P 36102	52-6	400.0'	Oct/52	
	52-8	266.0'	Oct/52	

Notes:

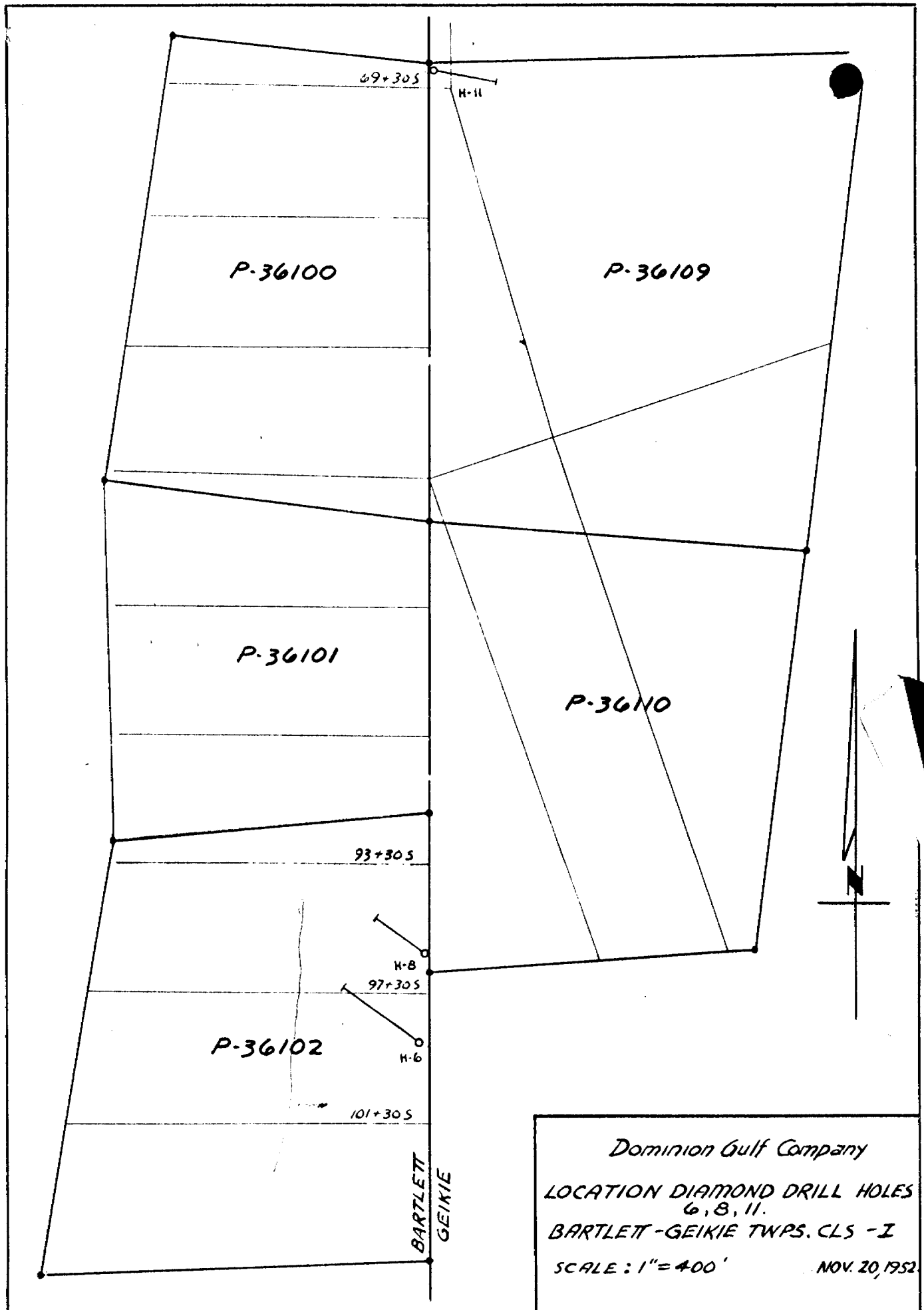

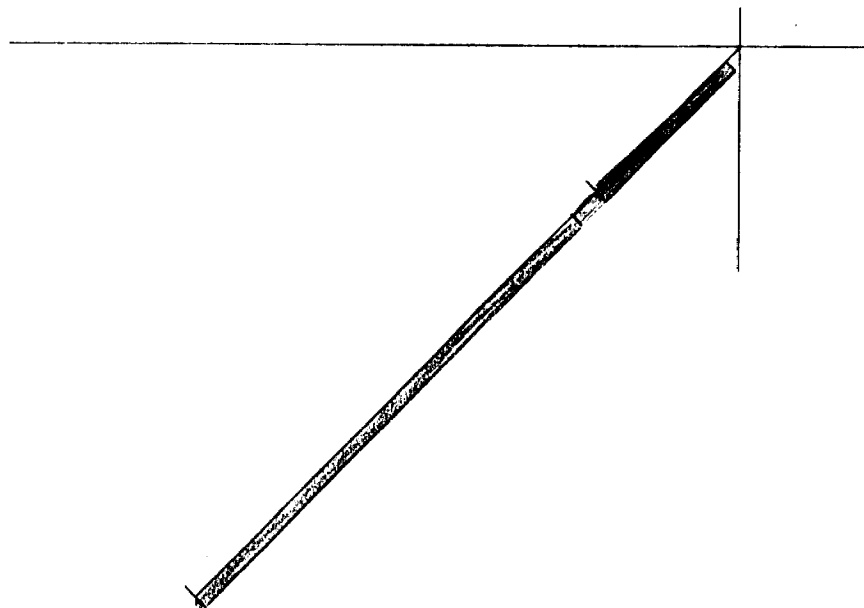

DIABASE





PERIDOTITE

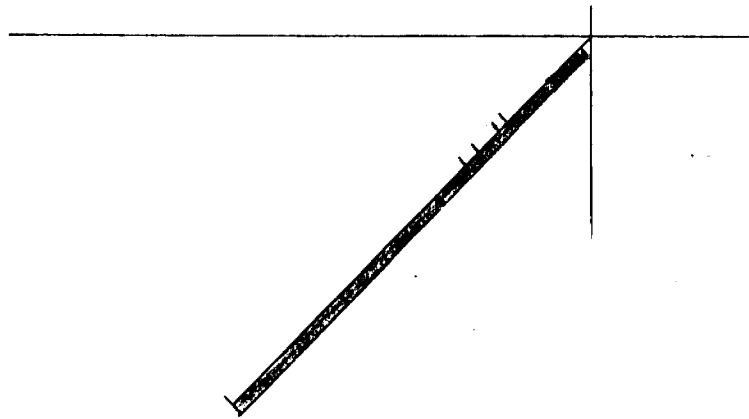

DOMINION GULF COMPANY  
VERTICAL SECTION D.D.H. № 6  
BARTLETT-GEIKIE TWPS. CLS. I  
SCALE: 1" = 100'      NOV. 10, 1952.



-  BASIC DIKE
-  PERIDOTITE
- 

DOMINION GULF COMPANY  
VERTICAL SECTION D.D.H. N<sup>o</sup> 8  
BARTLETT-GEIKIE TWPS. CLS - I  
1" = 100'  
NOV. 10, 1952.

## DIAMOND DRILL RECORD

LOCATION: LAT. 43° N55°W of 9890 south on township line

STARTED October 14, 1952

DEP. ....

COMPLETED October 22, 1952.

ELEVATION OF COLLAR .....

DATUM .....

ULTIMATE DEPTH 400

DIRECTION AT START: BEARING N55°W  
DIP 45° at 200' - 45° at 400' - 42°

PROPOSED DEPTH 396

DEPTH FEET	FORMATION	SAMPLE NO	WIDTH OF SAMPLE	GOLD \$	SLUDGE GOLD \$
0-10	<u>Casing</u>	5808	14-19		
10-106.3	<u>Peridotite</u>	09	24.2-29.2		
	sulphides disseminated and in widely scattered "goose eggs" up to 1/2" long	10	29.2-34.2		
	15-15.7 lost core 17.3 - 18.0 mainly carbonate	11	34.2 - 38.9		
	42-42.5 mainly carbonate 48.6-49.1 mainly carbonate and serpentine 96-101 fairly abundant patches of sulphides	12	38.9-44		
		13	44-49		
		14	49-54		
		15	54-59		
106.3-123.1	<u>Matachewan diabase</u>	16	59-67		
	contacts with peridotite sharp	17	79.5-84.5		
123.1-400	<u>Peridotite</u>	18	96.5-101.5		
	123.1-128 dark bottle green colour, fine grained; numerous 1/4 to 1/2" wide carbonate veinlets nearly at right angles to the core; only minor sulphides. 128-134 bluish grey; carbonate threads and minor scattered sulphides. 134-271 fair scattered sulphides; carbonate threads, scattered minus 1/16" asbestos. 163-167 much scattered sulphides 172-174 much scattered sulphides 188- 244 much scattered sulphides 271- 400 light grey	19	101.5-106.4		
		20	124.4-130		
		21	130-135		
		22	135-140		
		23	140-145		
		24	145-150		
		25	150-155		
		26	155-160		
		27	160-165		
		28	165-170		

PROPERTY .....

HOLE NUMBER ..... 52-6 .....

# DIAMOND DRILL RECORD

SHEET NUMBER .....

SECTION FROM ..... TO .....

LOCATION: LAT. ....  
 DEP. ....

STARTED .....

ELEVATION OF COLLAR .....

COMPLETED .....

DATUM .....

ULTIMATE DEPTH .....

DIRECTION AT START: BEARING .....  
 DIP .....

PROPOSED DEPTH .....

DEPTH FEET	FORMATION	SAMPLE NO	WIDTH OF SAMPLE	GOLD \$	SLUDGE GOLD \$
	coarser grained, very minor sulphides	5829	170-175		
		30	175-180		
	<u>400 - end of Hole</u>	31	180-185		
		32	185-190		
		33	190-195		
		34	195-200		
		35	200-205		
		36	205-210		
		37	210-215		
		38	215-220		
		39	220-225		
		40	225-230		
		41	230-235		
		42	235-240		
		43	240-245		
		44	245-250		
		45	250-255		
		46	255-260		
		47	260-265		
		48	265-270		
		49	270-275		
		5850	275-280		

NORTHERN MINER PRESS LIMITED TORONTO STOCK FORM NO. 801 REV. 9-44

DRILLED BY **Heath and Sherwood**

SIGNED **W.C. McAulay**

PROPERTY 68 Bartlett-Geikie Twp. Gr. I

P 36102

HOLE NUMBER 52-8

SHEET NUMBER 1

SECTION FROM 0 TO 124

# DIAMOND DRILL RECORD

LOCATION: LAT. 9600'S  
 DEP. 15'W  
 ELEVATION OF COLLAR  
 DATUM  
 DIRECTION AT START: BEARING N 55° W  
 DIP 45° at 200' - 45°

STARTED October 27, 1952.  
 COMPLETED October 29, 1952.  
 ULTIMATE DEPTH ~~200~~ 266  
 PROPOSED DEPTH 204

DEPTH FEET	FORMATION	SAMPLE NO	WIDTH OF SAMPLE	GOLD \$	SLUDGE GOLD \$
0-8	Casing	5768	61-68		
8-115	Peridotite	69	81.4-86.4		
	8-13 light grey	70	86.4-92		
	13-45 dark green, serpentized dunitic 18.5-19.5	71	173.5-178.5		
	1% disseminated sulphides veinlets of serpentine	72	178.5-183.5		
	and carbonate at various angles to the core;	73	183.5-188.5		
	2" carbonate vein 45° to the core at 23.3'.	74	188.5-193.5		
	45-52 dark balded crystals, grey	75	193.5-198.5		
	52-98 dark green, dunitic; scattered minus 1/16"	76	198.5-203.5		
	cross fibre asbestos veinlets				
	75.4-76 mud seam- lost core				
	98-115 light grey, talcy, numerous carbonate veinlets				
115-117.5	Basic dike, fine-grained dark; may be lamprophyre				
117.5-209	Peridotite				
	117.5-124 mottled, variable light grey to green				
	118.8-119 lost core				
	124-165 variable bottle green to very dark green,				
	dunitic; numerous carbonate veinlets and				
	minus 1/16" cross fibre asbestos veins at				
	various angles to the core; @ 139' 1/2"				
	composite asbestos vein @ 139.4" 1/8" cross				

NORTHERN MINER PRESS LIMITED, TORONTO, ONT. CAN. TEL. REG. P. 44

DRILLED BY Heath and Sherwood

*Shill ore is stored on the property*

SIGNED

G. McAulay





## DIAMOND DRILL RECORD

LOCATION: LAT. ....  
 DEP. ....  
 ELEVATION OF COLLAR .....  
 DATUM .....  
 DIRECTION AT START: BEARING .....  
 DIP .....

STARTED Deepened November 2, 1952.  
 COMPLETED November 3, 1952.  
 ULTIMATE DEPTH 266  
 PROPOSED DEPTH .....

DEPTH FEET	FORMATION	SAMPLE NO	WIDTH OF SAMPLE	GOLD \$	SLUDGE GOLD \$
117.5-266	<u>Peridotite</u>				
	209-243.9 dark green; disseminated sulphides	5778	209-214		
	243.9-254.5 lighter colour, coarser grain; minor scattered sulphides @ 248.3 1 1/2" banded carbonate-serpentine	79	214-219		
		80	219-224		
		81	224-229		
	254.5-259 mainly dark green,	82	229-237		
	259-266 variable green; a few carbonate veinlets; scattered sulphides,	83	237-243.9		
		5784	254.5-260.3		
	266 - End of Hole.				