



Tri-J Mineral

12A03NW0022 63.1873 FRIPP

Electromagnetic Survey of a Twenty Claim Block  
Claim Nos. P-62515 - P-62524 Inclusive  
Claim Nos. P-62506 - P-62507  
Claim Nos. P-62239 - P-62246 Inclusive  
Fripp Township - McArthur Township -  
Porcupine Mining Division, Ontario  
District of Cochrane

010

1. INTRODUCTION

During August, 1965, a grid was cut on the property. In September and October a ground electromagnetic survey was conducted over Claim No. P-62515 - P-62524 Inclusive, P-62506 - P-62507, and P-62239 - P-62246 Inclusive in Fripp Township, Ontario in order to detect any electrically conductive zones.

There are extensive outcroppings on parts of the property but generally the area is covered with overburden. Sulphides with some copper mineralization are evident in showings on the claims and drill holes have been put down on adjoining claims.

The group lies on the nose of a magnetic feature as indicated on the government airborne magnetic map of this area.

The claims lie approximately ten miles North + West of Texmont Mines Limited who are currently carrying out an extensive drilling program.

This report is concerned with the results of the geophysical survey as applied to the following claims.

- Claim Nos. P-62515 - P-62524 Inclusive
- Claim Nos. P-62506 - P-62507
- Claim Nos. P-62239 - P-62246 Inclusive

2. LOCATION AND ACCESSIBILITY

These claims lie approximately twenty miles south of Timmins and are accessible by a bush road most of the year. The road goes through the claims and along the East boundary.

3. THE ELECTROMAGNETIC METHOD

The method used was a Ronka Mark 11 Horizontal Loop Unit, 300 feet spacing, and a frequency of 876 cycles per second.

4. INTERPRETATION

This electromagnetic method is capable of detecting buried conductors caused by a number of geological conditions:

- (a) graphitic slates
- (b) massive bands of sulphides
- (c) banded magnetites
- (d) interlocking grains of oxides and sulphides.

5. CONCLUSIONS

No conductive zones were encountered.

6. RECOMMENDATIONS

That an electromagnetic survey using the vertical method be carried out to check the property for any deep lying conductors.

Attached hereto is Appendix A listing the names and addresses and time of the men employed.

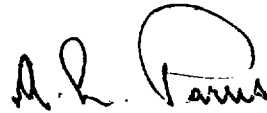

A. L. Parres, P. Eng.

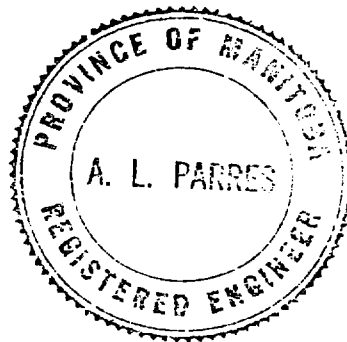

APPENDIX A

<u>Name</u>	<u>Address</u>	<u>No. of days</u> <u>Work</u>	
A. Maskevich	Timmins, Ontario	20	Hooping
J. Parres	South Porcupine, Ont.	10	Hooping
J. Moodie	South Porcupine, Ontario	1	Hooping
H. Shearer	South Porcupine, Ontario	1	Hooping
G. Perreault	Timmins, Ontario	10	Hooping
T. Ionsen	South Porcupine, Ontario	10	Hooping
A. L. Parres	South Porcupine, Ontario	3	Report
J. J. Johnson	South Porcupine, Ontario	3	Report
T. Savard	South Porcupine, Ontario	1	Typing
J. Twaine	Timmins, Ontario	9	Line Cutting
S. Twaine	Timmins, Ontario	8	Line Cutting
A. Luke	Timmins, Ontario	9	Line Cutting
J. Kioki	Timmins, Ontario	12	Line Cutting
G. Etherington	Moosonee, Ontario	3	Line Cutting
X. Bird	Moosonee, Ontario	16	Line Cutting
C. Beaulieu	South Porcupine, Ontario	12	Line Cutting
B. Burns	South Porcupine, Ontario	4	Line Cutting
C. Spadafort	South Porcupine, Ontario	<u>4</u>	Line Cutting

136

NAME AND ADDRESS OF OWNER

The name and address of the registered owner of these claims is G. Perreault, 287 Algonquin Blvd. West, TIMMINS, Ontario.

NAME AND ADDRESS OF SURVEY COMPANY

The name and address of the party submitting the report is Tri-J Mineral Surveys Limited, 58 Crawford Street, SOUTH PORCUPINE, Ontario.

  
A. L. Parres,  
President.

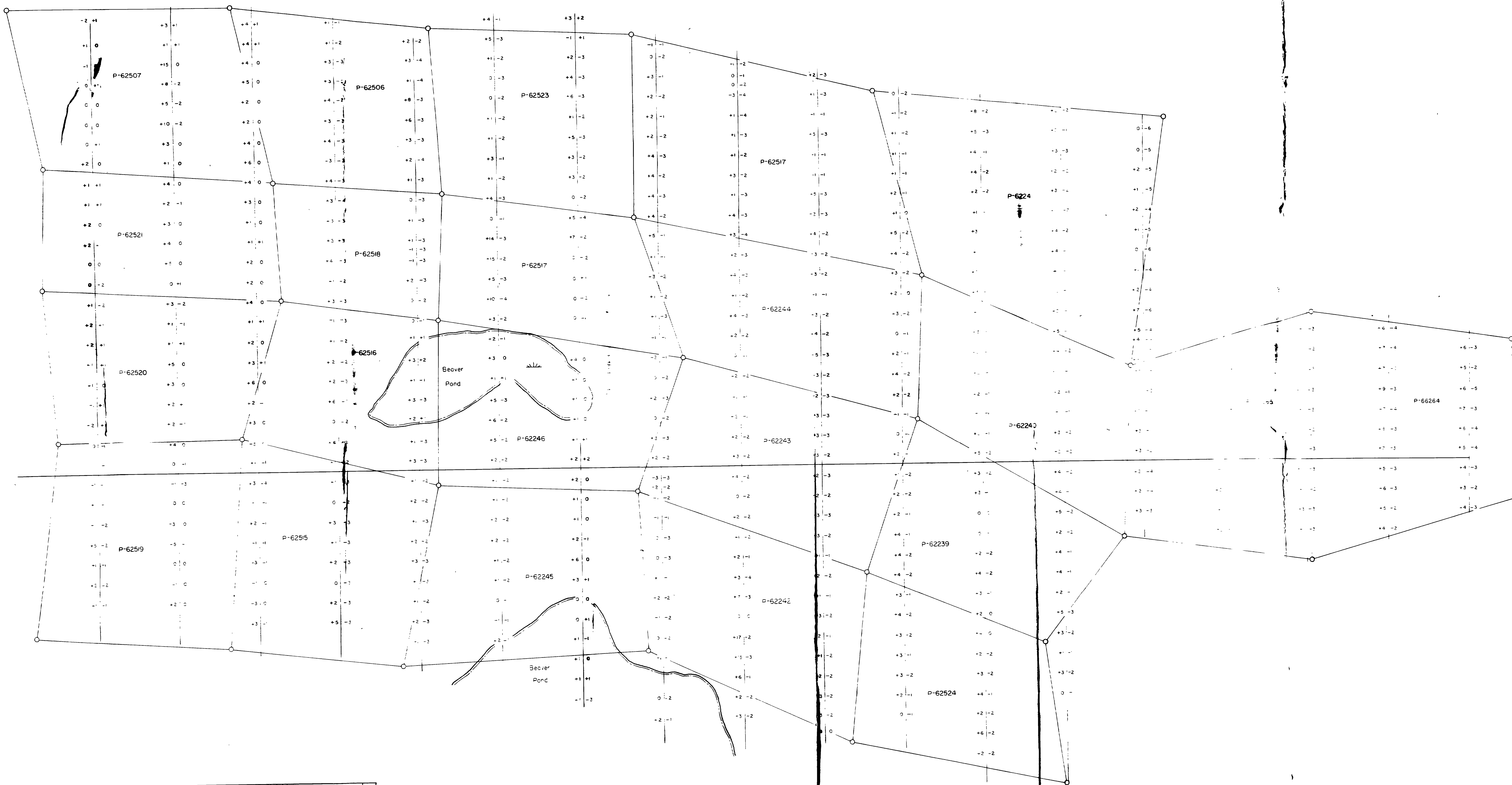

24+00W  
22+00W  
20+00W  
18+00W  
16+00W  
14+00W  
12+00W  
10+00W  
8+00W  
6+00W  
4+00W  
2+00W  
0+00W  
2+00E  
4+00E  
6+00E  
8+00E  
10+00E  
12+00E  
14+00E  
16+00E  
18+00E

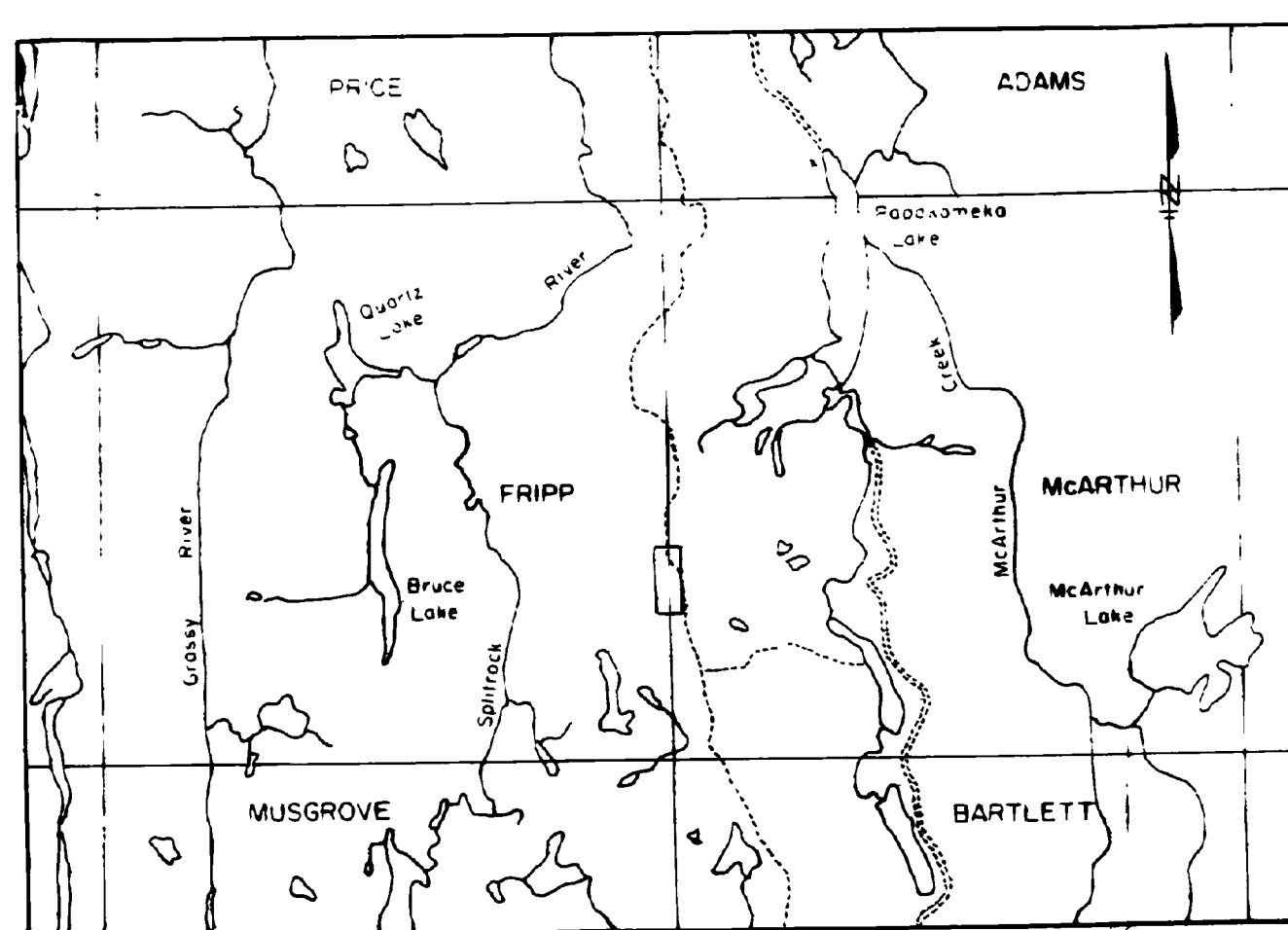

KEY PLAN

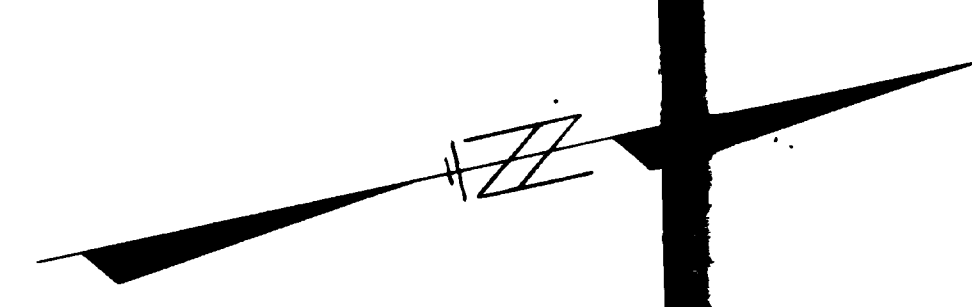

HORIZONTAL ELECTROMAGNETIC SURVEY  
FRIPP TOWNSHIP  
PORCUPINE MINING DIVISION  
SURVEYED BY TRI-J MINERAL SURVEYS LIMITED  
INSTRUMENT USED - RONKA 876 C.P.S.  
300' COIL SPACING  
IN PHASE LEFT      OUT OF PHASE RIGHT  
Scale 1" = 200'      Date February 11th 1966  
Drawing No

