



Township of McARTHUR

Report No: 15

Work performed by: Paymaster Consolidated Mines Ltd.

Claim No	Hole No	Footage	Date	Note
P 44516	1	101'	Feb/60	
P 44517	2	529'	Feb/60	
	3	199'	Feb/60	(1)
	3	676'	Mar/60	(2)
P 44512	4	495'	Mar/60	
	5	396'	Mar/60	
P 44511	6	449'	Apr/60	

Notes: (1) Direction N53°E
(2) Direction S53°E

PEYMASTEEL CONSOLIDATED MINES, LIMITED

DISMOUNT DRIFT MINE

Near Arthur Twp.

Scale 1" = 400'

May 1960.

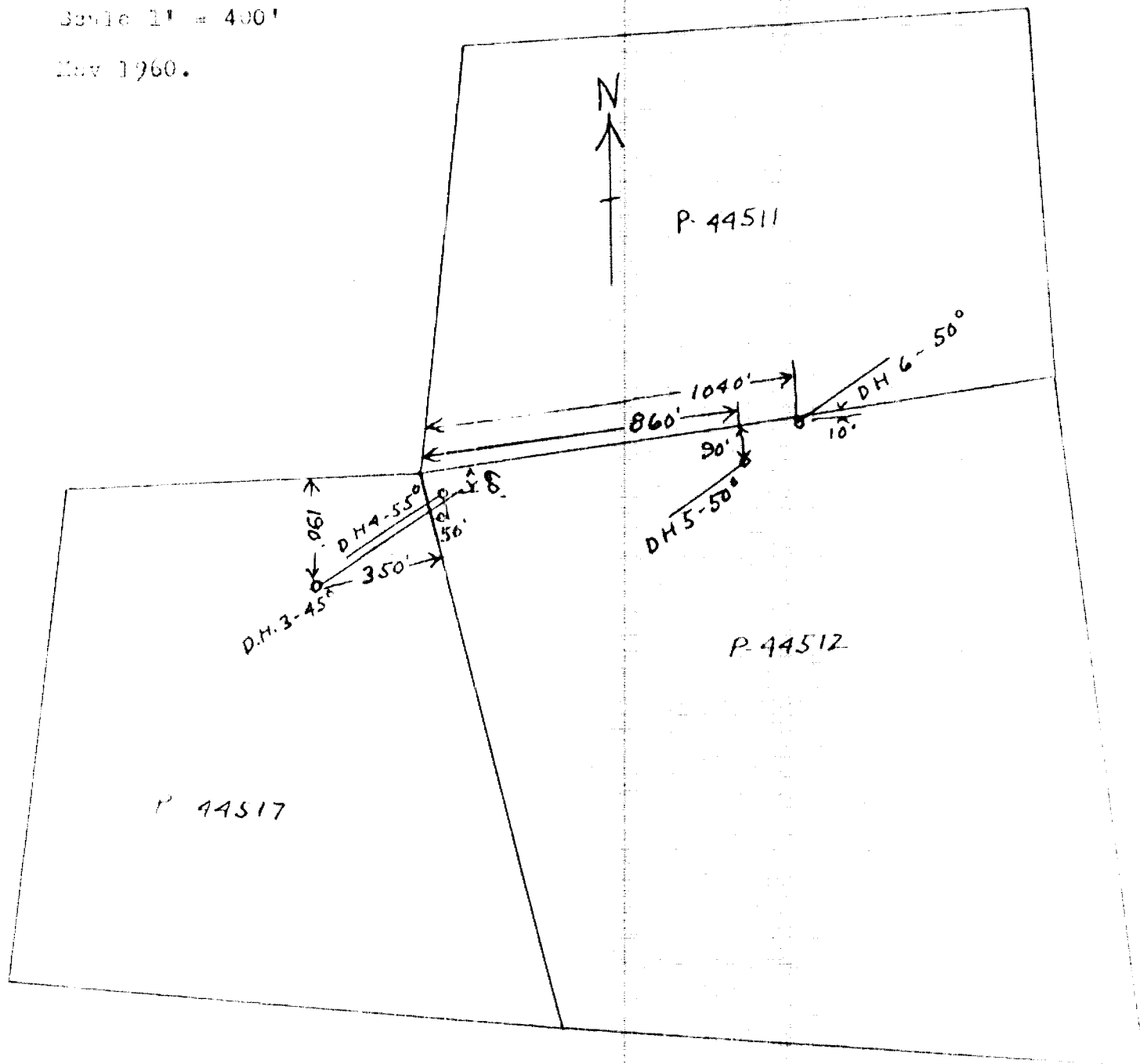

PAYMASTER CONSOLIDATED MINES, LTD.

(No Personal Liability)

DIAMOND DRILL RECORD

HOLE NO. 2 SHAFT NO. Surface DATE February 18, 1960
 Claim P-44517 McArthur Twp.
 LOCATION Coordinates 1600'S. 75' W. DIRECTION S. 53° W. DIP -40°

Sample No.	Geology.	Description	Footage	Width	Value Oz. Ton
0-15	Casing				
15-22	Agglomerate, altered, much epidote, Black cherty bands up to 1" wide probably from gabbro- specks of chalcopyrite				
22-23	Very fine grained gabbro.				
23-47	Medium grained fresh dark gabbro, 1/4" feldspar at 32'				
47-200	Coarse grained medium grey colored gabbro, somewhat variable in texture.				
200-223	Medium grained medium grey gabbro.				
223-230	Fine grained medium grey gabbro, chilled contact.				
230-240	Banded iron formation out at 45°, bands 1/16" to 1/4" of magnetite, some epidote, cherty between magnetite bands, very fine sulphides est 25% Fe.				
240-265	Iron formation banding out at 60°, some jasper 251-254. est. 35% Fe. 250' 3" light green streak, grunnerite?.				
265-293	Lean to very lean iron formation banding out at 70° with 30% introduced quartz in bands 4" wide.				
293-298	Light diorite intrusive, some lineation.				
298-305	Altered agglomerate, fragments 1" maximum diameter.				
305-322	Medium to fine grained diorite, 307-309 partially digested banded seeds.				
322-324.5	Banded fine grained sediments.				
324.5-326	Quartz				
326-333	Agglomerate, fragments up to 1", highly altered by diorite silic'n at 331				
333-357	Sediments banded at 70-75°, local magnetite, maximum width 1 1/2".				
357-362	Massive softer sediments, (greywacke)				
362-365.5	Sediments banded at 75°				
365.5-368	Finely banded iron formation out at 75° 15-20% Fe.				
368-382	Sediments banded at 70°, 5" quartz at 380', 1" rose quartz at 380.5.				
382-387	Amygdaloidal lava.				
387-399	Massive uniform lava, 3" I.F. at 395; G.C. 391-392; 397-398.				
399-401	Silicified iron formation (black)				
401-405	Uniform lava				
405-407	Black silicic iron formation G.C. 407-409				
409-430	Partially altered agglomerate, 3/4" fragments				
430-434	Silicic iron formation 40% quartz out at 75°, 15% Fe. estimated.				
434-467	Agglomerate 3" maximum fragments,				
467-529	Agglomerate less altered, 5" fragments, 494 & 510 porphyry fragments 3".				
529	End of hole.				
Hole drilled by <u>Albert Brochu, North Bay.</u>					
Core logged by <u>Robert Ginn, Timmins and G. S. Longley.</u>					

RECEIVED
 FEB 23 1960
 PAYMASTER CONSOLIDATED MINES LTD.
 TIMMINS ONTARIO

C. S. Longley

44517

PAYMASTER CONSOLIDATED MINES, LTD.

(No Personal Liability)

DIAMOND DRILL RECORD

HOLE NO. 3 SHAFT NO. Surface DATE February 19, 1960
 Claim P-44517 McArthur Township
 LOCATION Co-ordinates 1600 S. 185' W. DIRECTION N. 53° E. DIP -45°

Sample No.	Geology.	Description	Footage	Width	Value Oz. Ton
0-12	Casing				
12-27	Uniform sediments altered with epidote, jasper at 19'				
27-31	Sediments highly altered by gabbro.				
31-32	Very fine grained gabbro, chilled contact				
32-34	Fine grained gabbro.				
34-43	Fine medium grained gabbro.				
43-57	Medium grained gabbro.				
57-112	Coarse medium grained, medium grey gabbro.				
112-125	Medium grained gabbro.				
125-132	Fine grained gabbro.				
132-133	Very fine grained gabbro, chilled contact.				
133-147	Massive sediments altered by gabbro. black cherty inclusions at 134' 3" epidote at 135'				
147-166	Iron formation banded at 40°, chert stringers estimated 5% Fe.				
166-170	Lost core Very blocky 147 to 170' probably near top of ledge.				
170-201	199 Fine grained crystalline uniform rock probably should be classified with amphibolite reported in McArthur Twp in O.D.M. report 1926 Pt.6. Contains iron formation remnants up to 1' wide in core. Hole being continued. 282' deep at 11.30am today.				
	Core logged by C. S. Longley, <i>C. S. Longley</i>				

RECORDED
 INDEXED
 FILED
 FEB 23 1960
 DEPT. OF MINES
 TORONTO

PAYMASTER CONSOLIDATED MINES, LTD.

(No Personal Liability)

DIAMOND DRILL RECORD

HOLE NO. **3** Surface DATE **March 19, 1960**
 Claim **P-44517 McArthur 1p.** SHAFT NO. _____
 Co-ordinates **1600 S. 185' W.** DIRECTION **S. 53° E.** DIP **-45°**

LOCATION _____

DIRECTION _____

DIP _____

Elevation **+30'** above swamp level
 Description _____

Sample No.	Description	Footage	Width	Value Oz. Ton
37169	Quartz 229'-231'	226' - 231'	60	tr
37170	12" Quartz	275' - 277'	24	tr
37172	Qts out long, a little cube pyrite	614' - 617'	36	tr
	End of hole 676'			
	Geology			
0-7	Casing			
7-27	Uniform lava altered by epidote			
27-31	Lava highly altered by gabbro diabase			
31-34	Very fine to f.g. gabbro, chilled contact, Is attracted by magnet.			
34-43	Fine medium grained gabbro diabase			
43-57	Medium grained gabbro diabase.			
57-112	Coarse medium grained gabbro diabase 1/8" crystals, medium grey color.			
112-125	Medium grained gabbro diabase, From 11 to 133 attracted by magnet.			
125-133	Fine grained to very f.g. gabbro diabase, chilled contact.			
133-147	Massive lava altered by diabase, black chert inc at 134' banding 30-40°			
147-161	Iron formation banded at 35°, chert str., est 15% Fe. G.O. 154-155'			
161-166	Streaked lava resembling spherulites squeezed out. G.O. 166-170'.			
170'-200	Fine grained amphibolite with iron formation remnants up to 1' wide.			
201-206	Fine grained green amphibolite or diorite-gabbro.			
206-216	Medium grained diorite-gabbro, some quartz str			
216-272.5	C.m.g. diorite-gabbro, local 1/8" amphibole crystals, 231-240 foliated with leucoxene, 257-260 & 267-272 foliated at 50°			
272.5-277	Fine to f.m.g. bluish grey diorite, 272.5 contact at 50°			
277-317	Coarse m.g. amphibolite foliated 312-317.			
317-465	Medium grained fresh diorite-gabbro, light grey-green color 412 D- 3.0			
465-488	Altered medium grained diorite-gabbro foliated at 60°			
488-508	Medium grained fresh gabbro			
508-	Contact probably faulted at 15° with 1/4" epidote stringer.			
508-524	Fine to f.m.g. diorite. G.O. 525-527 & 528-529'			
524-593	Medium grained light green diorite-gabbro.			
593-595	Fine grained diorite			
595-600	Medium grained gabbro.			
600-624	Fine to f.m.g. felsitic porphyry syenite-diorite composition. out at low angle and chilled at 600', 1/8" phenocrysts.			
624-637	Medium grained amphibolite coarsest at 624'.			
637-645	Fine medium grained diorite			
645-676'	Coarse medium grained fresh gabbro.			
676'	End of hole.			

Hole drilled by Wilfred Brochu D.D. Co. North Bay.
 Core Logged by Robert Ginn and Charles Longley

MAR 21 1960

✓ KE STORED
 AT Paymaster Mines
 So Rock
 C. S. Longley
 REC'D
 MINING DIVISION

194
 477

PAYMASTER CONSOLIDATED MINES, LTD.

(No Personal Liability)

DIAMOND DRILL RECORD

HOLE NO. **4** SHAFT NO. **Surface** DATE **March 23, 1960**
McArthur Township Claim 44512

LOCATION **CO-ordinates 1600 S. 250' East** DIRECTION **S. 53° W.** DIP **-55°**

Sample No.	Description	Footage	Width	Value Oz. Ton
37172	2" quartz stringer with fine cube pyrite	65' - 65.5'	6	tr
3	24" Quartz, locally purplish	132.5' - 135'	30	tr
	Geology. End of hole 495'			
0-55	Casing mostly in sand.			
55-56	Reddish granitic rock probably boulder.			
56-248	Medium grained fresh gabbro, 1/8" crystals. 5" acid dyke at 114' out 60°			
	116-117 epidote alteration, 150-152- 2" quartz with rock fine medium grain			
	196-197.5 Quartz, 224-225 Quartz			
248	Contact at 40°			
248-253.5	Fine to fine medium grained uniform diorite, contact at 20°			
253.5-275	Medium grained diorite-gabbro, somewhat foliated with blebs.			
275-	259 4" quartz with pyrite 277-289 Qtz str up to 3", some pink color			
275-297	Fine to medium grained diorite-gabbro foliated parallel to core.			
297-411	Medium grained diorite-gabbro, slightly altered.			
411-422	Medium grained diorite-gabbro, partially altered, sheared at 50-55°.			
422-425	Amygdaloidal greenstone.			
425-440	8-8" bands of iron formation out at 50° in greenstone or f.g. diorite			
440-	434-437 G.O.			
440-448	Greenstone top with squeezed spherulites			
448-460	Squeezed amygdaloidal lava or flow top, Iron formation 450-1 +454-7 -40°			
460-466	Iron formation banded at 40°; 25% Fe.			
466-468	2-4" quartz stringers at least 15% chalcopyrite			
468-470	Lava.			
470-474	Iron formation estimated 30% iron.			
474-475	Fine grained diorite			
475-495	Medium grained diorite-gabbro.			
	495 End of hole			
Hole drilled by Wilfred Brochu D.D.Co. North Bay.				
Core logged by Robert Ginn and Charles Longley				
<i>C. S. Longley</i>				
CORE STOPPED AT PAYMASTER M.D.S. S. 250'				

RECORDED
INDEXED
MARCH 23 1960

PAYMASTER CONSOLIDATED MINES, LTD.

(No Personal Liability)

DIAMOND DRILL RECORD

HOLE NO. 5 SHAFT NO. Surface DATE March 23, 1960
 Claim 44512 McArthur Township

LOCATION Co-ordinates 2000' S. 950' East DIRECTION S. 53° W. DIP -50°

Sample No.	Geology	Description	Footage	Width	Value Oz. Ton
0-18	Casing				
18-30.5	Rhyolite agglomerate				
30.5-32	Ground Core.				
32-34	Altered (sericitic) acid tuff.				
34-56.5	Acid agglomerate out at 50° Flowy 41-44'				
56.5-67.5	Massive fine grained greenstone with inclusions.	66-67 G.C.			
67.5-73	Flowy top of greenstone, squeezed out spherulites.				
73-75	Acid tuff with pyrite				
75-100	Series of thin flows facing east. Uniform bases and flowy tops.				
100-101	Very fine grained acid dyke.				
101-107	Flow top agglomerate				
107-110	Amygdaloidal greenstone.				
110-122.5	Medium grained greenstone.				
122.5-130	Fine grained felsite, light color, sugary texture				
130-131	Altered agglomerate				
131-135	Fine grained uniform acid lava				
135-147	Sheared agglomerate out at 50-75°				
147-154	Coarse medium grained diorite-gabbro				
154-163	Sheared acid tuff out at 60 & 35°. 4" diorite at 155'				
163-170	Light felsite				
170-181	Altered tuff sheared at 45 to 50°				
181-184	Medium grained dioritic intrusive				
184-186	Brecciated contact zone with quartz				
186-189	Fine to f.m.g. diorite-gabbro				
189-225	Medium grained diorite-gabbro with 1/4" reddish stringers				
225-284	Coarse medium grained diorite-gabbro, rusty	281-284			
284-323	Medium Medium grained diorite-gabbro				
323-324	Reddish alteration with quartz stringers, a little cube pyrite 1/4" diam with chalcopyrite pseudomorphs				
324-342	Fine to fine medium grained diorite-gabbro, abundant small quartz str.				
342-396	Coarse medium grained diorite-gabbro.				
396	End of hole.				
Core logged by Robert Ginn, resident geologist and O. S. Longley.					
Hole drilled by Wilfred Brochu D.D. Co. North Bay.					

SOME STRENGTH UP
 Paymaster M.C. & Co.

March 23, 1960
 Robert Ginn
 Resident Geologist

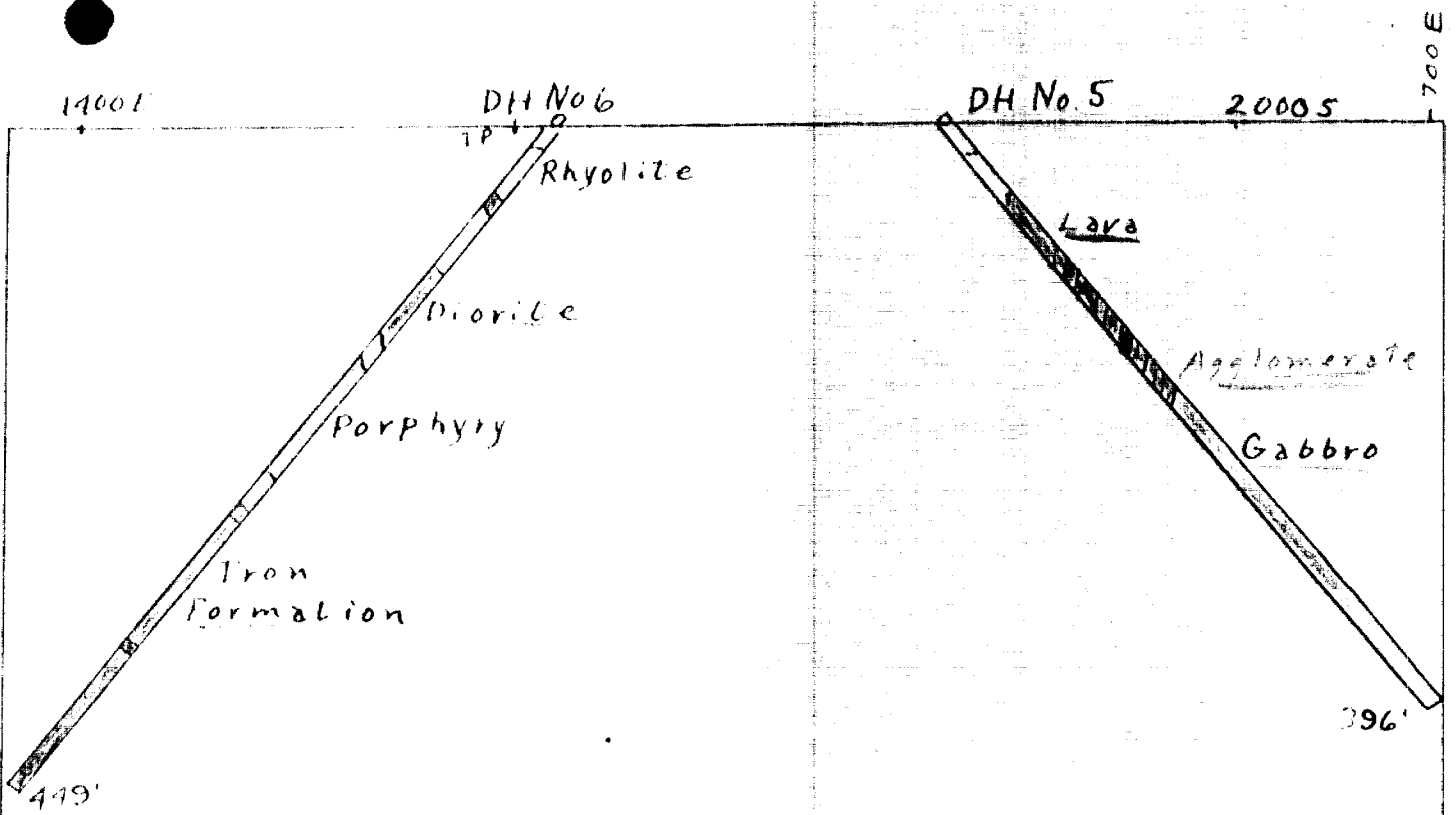

PAYMASTER CONSOLIDATED MINES, LIMITED

McArthur Township Group 2,

Claims P-44512, 44511.

Section D.H. No. 5 & 6. Scale 1" = 100'

May 1960.

PAYMASTER CONSOLIDATED MINES, LTD.

(No Personal Liability)

DIAMOND DRILL RECORD

HOLE NO. 6 SHAFT NO. Surface DATE April 15, 1960
 McArthur Township Claim P-44511
 LOCATION Co-ordinates 2000S, 1150 E. DIRECTION N. 53° E. DIP 50°

Sample No.	Geology, Description	Footage	Width	Value Oz. Ton
0-16	Casing			
16-55	Rhyolite and rhyolite breccia, 23-24' crystalline, cut at 40-50°			
55-64	Fine grained diorite			
64-88	Rhyolite and rhyolite breccia out at 40° to shearing.			
89-91	G.C. 32-33, 52-53, 88-89, Shearing 75-83 at 35°, 83-88 30% quartz. Rhyolite and rhyolite breccia.			
91-94	Massive, probably diorite, shearing at 35-40°			
94-96	Rhyolite and rhyolite breccia.			
96-109	Fine m.g. diorite (amphibolite) with rhyolite inclusions, contact zone.			
109-150	Medium grained diorite-amphibolite, leucoxene flecks, shearing 40-55° Fine grained at 150'			
150-152	Quartz and feldspar porphyry			
152-164	Speckled rhyolite (altered)			
164-167	Fine to fine m.g. diorite			
167-170	Rhyolite			
170-239	Acid dyke, xxxx locally feldspar porphyry, G.C. 223-224.			
239-264	Highly altered rhyolite sheared at 50°			
264-274.5	Acid dyke.			
274.5-289	Siliceous banded iron formation 70% quartz, 6" pyrite at 275, 1" pyrrhotite at 278, local pyrite			
289-307	Siliceous iron formation 40% quartz, 10% pyrite-pr, a little chalco in later fine stringers, 6" pr at 302, 12" pr at 305'.			
307-316	Dark I-F with probably magnetite, est 25% Fe. 6" pr a l. chalco at 313			
316-336	Grey I-F 15% pr, dis & 2" str at 329' chalco in 1/8" cross fractures. This section is suggestive of siliceous intrusive alteration.			
336-345	Siliceous I-F cut at 40-50° Folding at 344' 10% pr, a l. chalco.			
345-352	4" agg at 345, Chloritic I-F, 4" dis pyrite at 346, 10% pr, a l. chalco			
352-357	Siliceous I-F, 6" Pr at 353, 8% in remainder, a l. chalco.			
357-367	Fine grained diorite dyke.			
367-386	Siliceous I-F 60% quartz pyrite at 368, 15% pr, fine chalco streaks, 385, 4" pyrrhotite.			
386-404	Greenish I-F 30% quartz, 5% magnetite, 5% pyrrhotite.			
404-419	Greenish I-F 5% magnetite, pyrrhotite at 419'			
419-424	Chloritic altered lava			
424-428	Siliceous I-F. 70% quartz, 5% pyrrhotite			
428-449	Iron Formation, banding 0-60°, 60% quartz, 20% magnetite			
449	End of hole.			

Cone logged by C. S. Langley.

RECEIVED
 MINING DIVISION

Core started at
 1700 hours 4/15/60
 S. K.

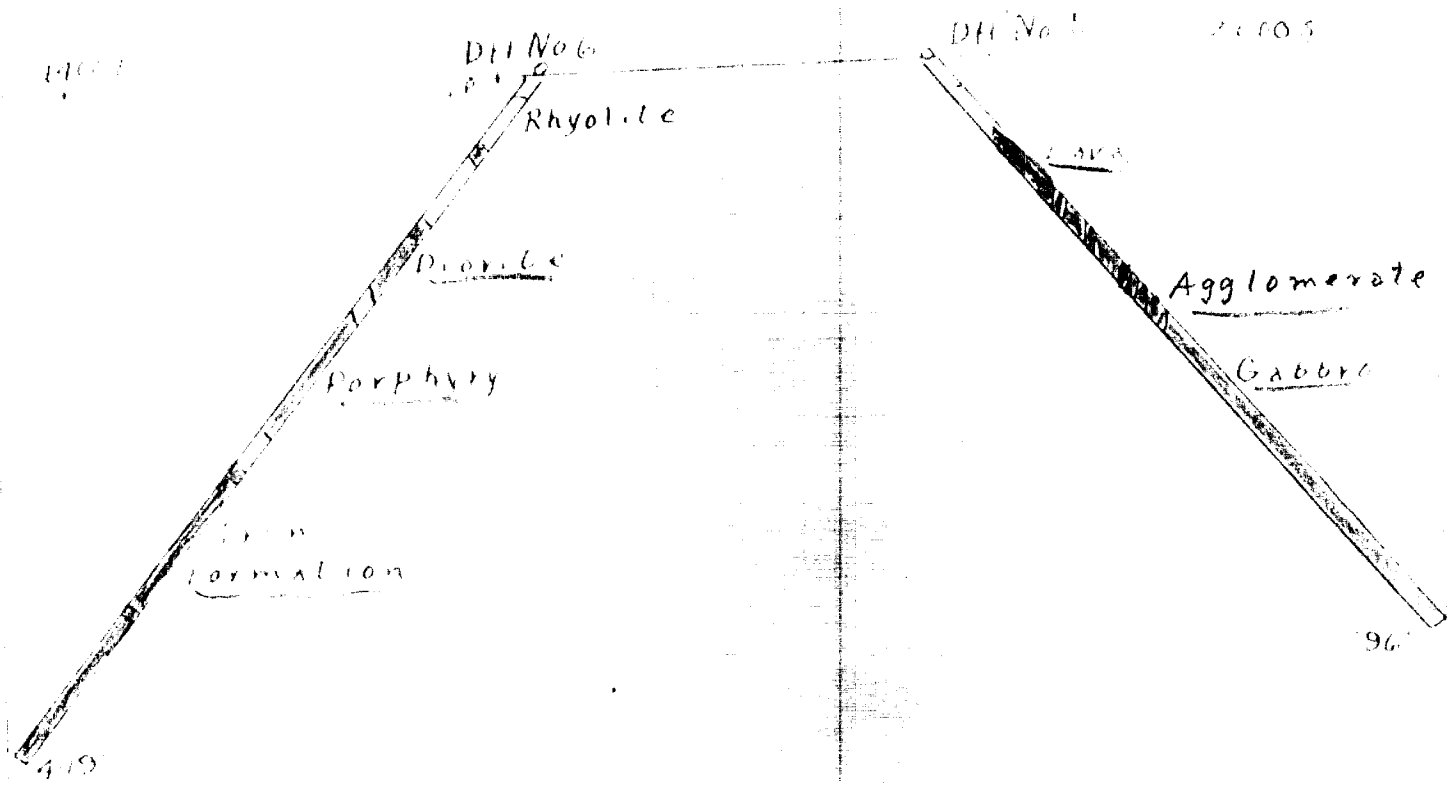

RIVERSIDE CONSOLIDATED MINES, LIMITED
 McArthur Township Group 2,
 Claims P-44512, 44511.
 Section A.R. No. 5 & 6. Scale 1" = 100'
 May 1900.

Group 3 * Group 2 McArthur Township.

45420	45419	43751	P 43752	P 43753
P 45423	P 45418	P 43421	P 43754	P 43755
P 45422	P 45417	P 43428	P 43429	P 43432

P 43430	P 43431	P 43434
------------	------------	------------

P
43435

Mineral Drilling

Group 3	Group 2
1- 93 ✓	5- 411 ✓
2- 513 ✓	8- 618 ✓
3- 150 ✓	Total 1029
30- 30 ✓	
4- 454 ✓	
6- 190 ✓	
7- 707 ✓	
Total 2142 ✓	

P 43436	P 43437	P 43441	P 43443
			P 43444

Assignment Distribution

Group 3	
Claim 1- 45417 - 160 ✓	
45418 - 160 ✓	
45419 - 160 ✓	
45420 - 160 ✓	
45422 - 160 ✓	
45423 - 160 ✓	
Total 960	
Remaining 1182	

Group 2

Claim 1- 43427 - 65.4 ✓
43428 - 65.4 ✓
43429 - 65.4 ✓
43430 - 64.4 ✓
43431 - 64.4 ✓
43432 - 64.4 ✓
43434 - 64.4 ✓
43435 - 64.4 ✓
43436 - 64.4 ✓
43437 - 64.4 ✓
43751 - 65.4 ✓
43752 - 84. ✓
43753 - 84. ✓
43754 - 65.4 ✓
43755 - 83.2 ✓
Total 1029.

MINING & BORDER
RECEIVED
 JUL 14 1959

PORCUPINE
 MINING DIVISION

CONSOLIDATED CANORAMA EXPLORATIONS LIMITED
 McArthur Township, Ontario
GEOLOGICAL PLAN

July, 1965

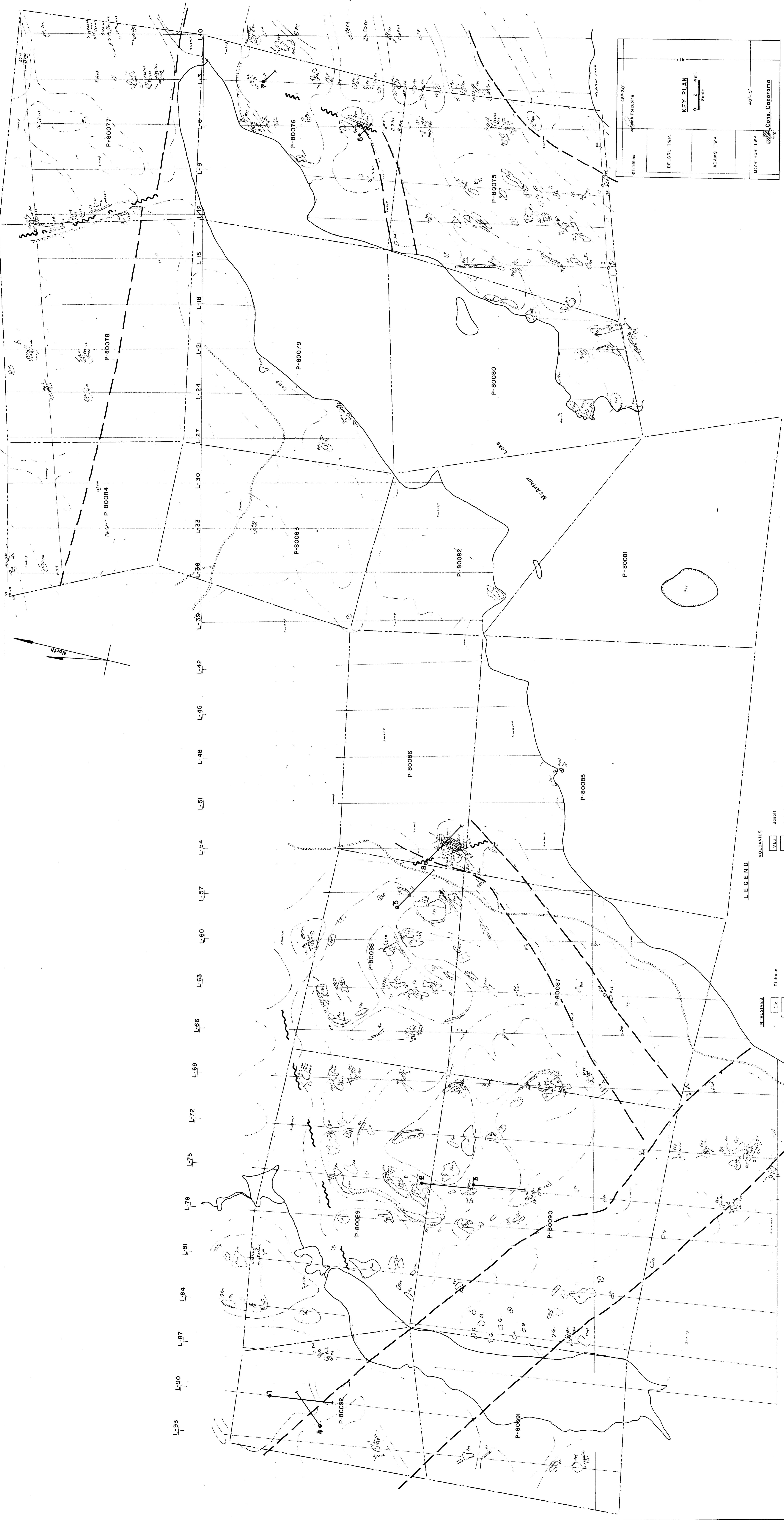
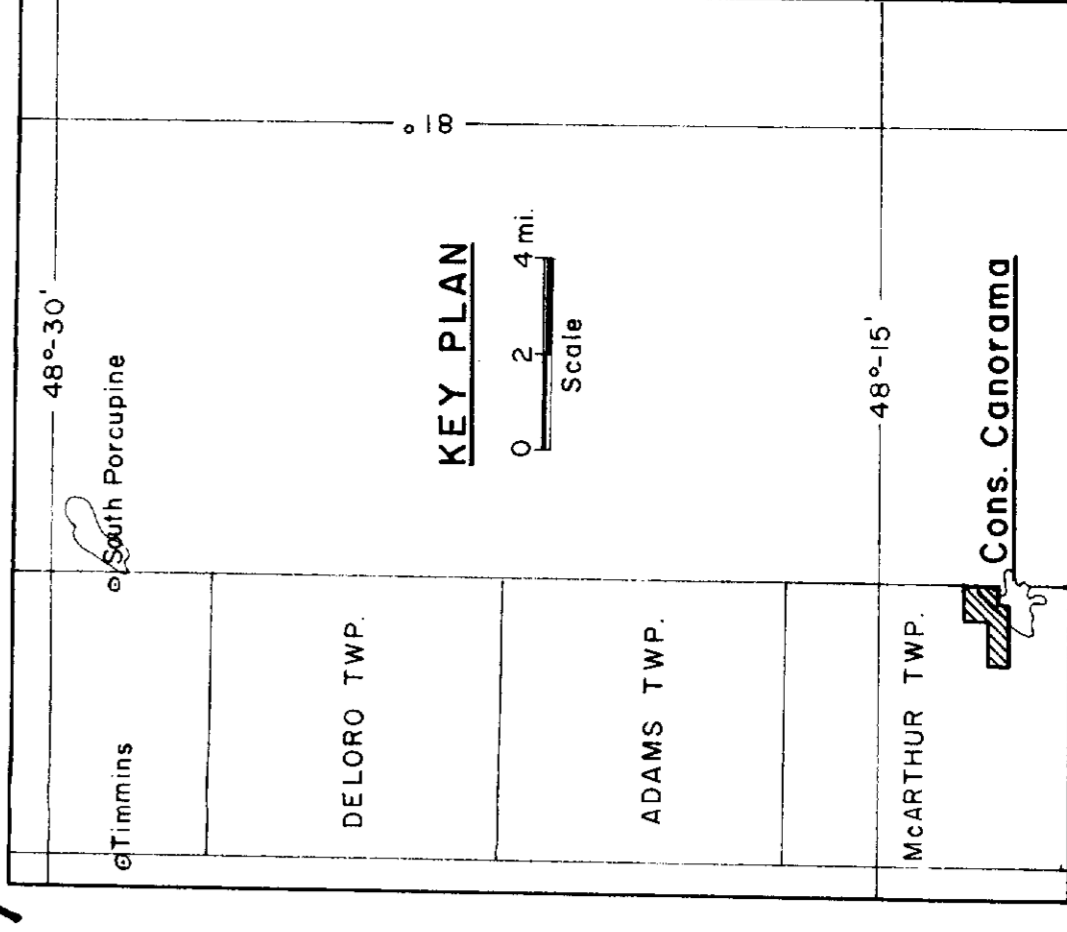
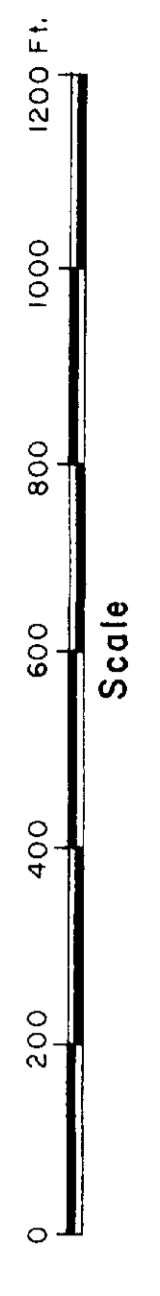

LEGEND

- INTRUSIVES**
- Diabase
 - Porphyry
 - Syenite
 - Granite
 - Gabbro, (g-aenorthositic, p-paraphyric)
 - Quartz, meta-quartz
 - Peridotite, undifferentiated
 - Amphibolitized Peridotite
 - Pyroxenitic Peridotite
 - Olivine-rich Peridotite, Dunite, Serpentine
 - Gabbroic Peridotite
- VOLCANICS**
- Basalt
 - Andesite
 - Tuff
 - Amphibolite
 - Dacite
- Other Symbols:**
- chl - Chlorite
 - To - Talc
 - Qtz - Quartz
 - Fel - Feldspar
 - Serp - Serpentine
 - Ol - Olivine

SYMBOLS

- Strike and dip of Formation, Schistosity, Jointing
- Shearing
- Outcrop
- Outcrop area
- Scarp
- Topographic trend
- Tractor road
- Fault
- Geological boundary
- Diamond drill hole

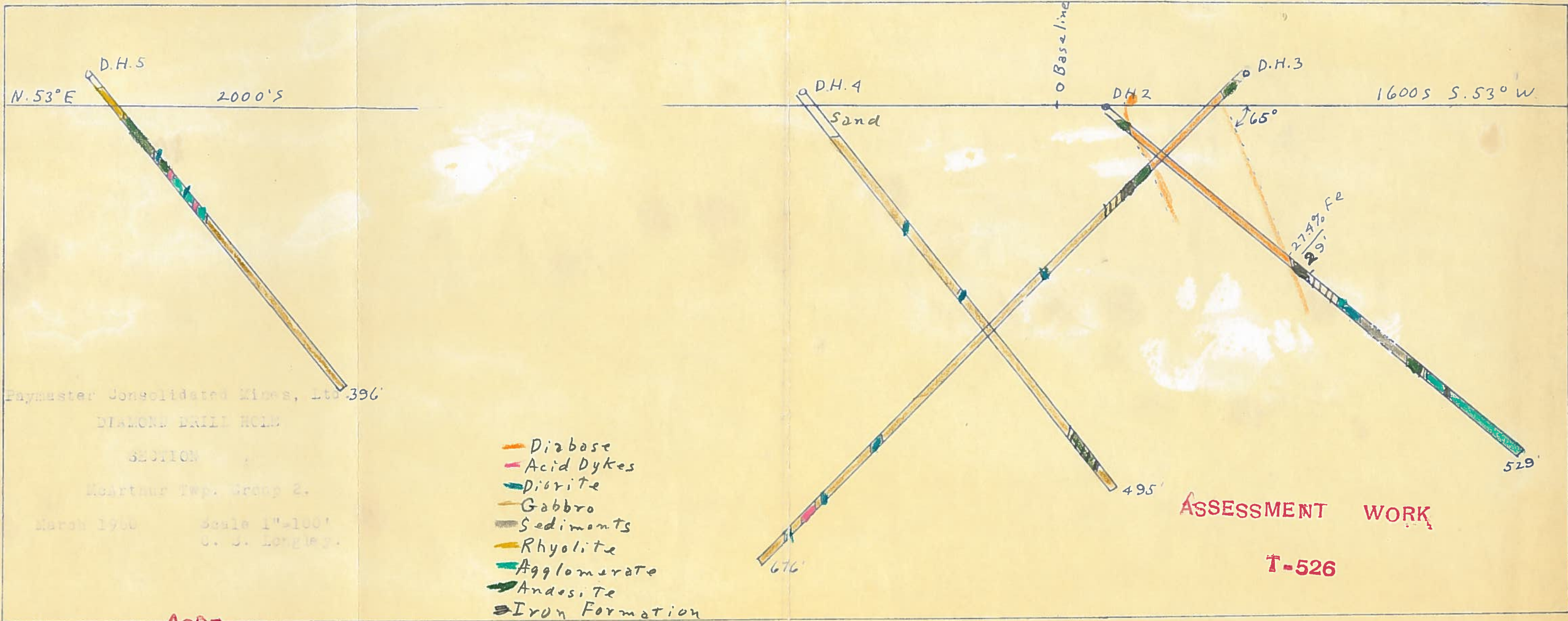

ASSESSMENT WORK

ASSESSMENT WORK

T-526