



Ontario

Mining Act

Personal information collected on this form is obtained under the authority of the Mining Act. This information will be used for correspondence. Questions about this collection should be directed to the Provincial Manager, Mining Lands, Ministry of Northern Development and Mines, Fourth Floor, 159 Cedar Street, Sudbury, Ontario, P3E 6A5, telephone (705) 670-7264.

- Instructions:**
- Please type or print and submit in duplicate.
  - Refer to the Mining Act and Regulations for requirements of filing assessment work or consult the Mining Recorder.
  - A separate copy of this form must be completed for each Work Group.
  - Technical reports and maps must accompany this form in duplicate.
  - A sketch, showing the claims the work is assigned to, must accompany this form.

Recorded Holder(s) <i>Great White Mineral Ltd.</i>		Client No. <i>217743</i>
Address <i>74 Roblin RR #2 Timmins Ont.</i>		Telephone No. <i>705-268-7793</i>
Mining Division <i>Porcupine</i>	Township/Area <i>Frapp &amp; Price</i>	M or G Plan No.
Dates Work Performed	From: <i>MAY 30 1991</i>	To: <i>DEC 23 1991</i>

**Work Performed (Check One Work Group Only)**

Work Group	Type
Geotechnical Survey	
Physical Work, Including Drilling	<i>POWER STRIPPING / PROSPECTING</i>
Rehabilitation	
Other Authorized Work	
Assays	
Assignment from Reserve	

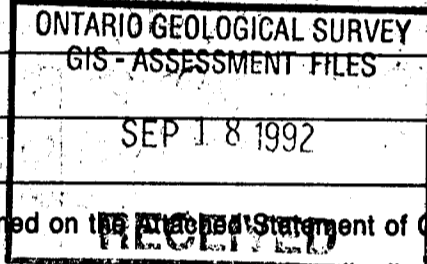

Total Assessment Work Claimed on the Attached Statement of Costs \$ *22,086.00*

**Note:** The Minister may reject for assessment work credit all or part of the assessment work submitted if the recorded holder cannot verify expenditures claimed in the statement of costs within 30 days of a request for verification.

**Persons and Survey Company Who Performed the Work (Give Name and Address of Author of Report)**

Name	Address
<i>LARCHER INC.</i>	<i>74 Roblin RR #2 Timmins Ont.</i>

(attach a schedule if necessary)

**Certification of Beneficial Interest \* See Note No. 1 on reverse side**

I certify that at the time the work was performed, the claims covered in this work report were recorded in the current holder's name or held under a beneficial interest by the current recorded holder.	Date	Recorded Holder or Agent (Signature)
--	------	--------------------------------------

**Certification of Work Report**

I certify that I have a personal knowledge of the facts set forth in this Work report, having performed the work or witnessed same during and/or after its completion and annexed report is true.		
Name and Address of Person Certifying <i>Paul P. Larcher 74 Roblin RR #2 Timmins</i>	Date	Certified By (Signature) <i>Paul P. Larcher</i>
Telephone No. <i>705-268-7793</i>		

**For Office Use Only**

Total Value Cr. Recorded <i>\$22,086.00</i>	Date Recorded <i>MARCH 25 1992</i>	Mining Recorder <i>[Signature]</i>	
	Deemed Approval Date <i>JUNE 23 1992</i>	Date Approved	
	Date Notice for Amendments Sent		





Ministry of  
Northern Development  
and Mines

Ministère du  
Développement du Nord  
des mines

**Statement of Costs  
for Assessment Credit**

**État des coûts aux fins  
du crédit d'évaluation**

**Mining Act/Loi sur les mines**

Transaction No./N° de transaction

**W9260.00052**

Personal information collected on this form is obtained under the authority of the Mining Act. This information will be used to maintain a record and ongoing status of the mining claim(s). Questions about this collection should be directed to the Provincial Manager, Minings Lands, Ministry of Northern Development and Mines, 4th Floor, 159 Cedar Street, Sudbury, Ontario P3E 6A5, telephone (705) 670-7264.

Les renseignements personnels contenus dans la présente formule sont recueillis en vertu de la Loi sur les mines et serviront à tenir à jour un registre des concessions minières. Adresser toute question sur la collecte de ces renseignements au chef provincial des terrains miniers, ministère du Développement du Nord et des Mines, 159, rue Cedar, 4<sup>e</sup> étage, Sudbury (Ontario) P3E 6A5, téléphone (705) 670-7264.

**1. Direct Costs/Coûts directs**

Type	Description	Amount Montant	Totals Total global
Wages Salaires	Labour Main-d'oeuvre	\$ 9750.00	
	Field Supervision Supervision sur le terrain	\$ 9750.00	
Contractor's and Consultant's Fees Droits de l'entrepreneur et de l'expert- conseil	Type		
Supplies Used Fournitures utilisées	Type		
Equipment Rental Location de matériel	Type		
	Segment B Attached Cost	\$ 9280.00	
<b>Total Direct Costs</b> <b>Total des coûts directs</b>			\$ 19030

**2. Indirect Costs/Coûts indirects**

\*\* Note: When claiming Rehabilitation work Indirect costs are not allowable as assessment work.  
Pour le remboursement des travaux de réhabilitation, les coûts indirects ne sont pas admissibles en tant que travaux d'évaluation.

Type	Description	Amount Montant	Totals Total global
Transportation Transport	Employer's vehicle		
	Truck Fuel		
	Utility trucks	\$ 200.00	
Food and Lodging Nourriture et hébergement		\$ 206.00	
Mobilization and Demobilization Mobilisation et démobilisation	Truck Fuel Subduction transport	\$ 16.50	
<b>Sub Total of Indirect Costs</b> <b>Total partiel des coûts indirects</b>			\$ 3856.00
Amount Allowable (not greater than 20% of Direct Costs) Montant admissible (n'excedant pas 20 % des coûts directs)			
Total Value of Assessment Credit (Total of Direct and Allowable indirect costs)			\$ 22086.00

Note: The recorded holder will be required to verify expenditures claimed in this statement of costs within 30 days of a request for verification. If verification is not made, the Minister may reject for assessment work all or part of the assessment work submitted.

Note : Le titulaire enregistré sera tenu de vérifier les dépenses demandées dans le présent état des coûts dans les 30 jours suivant une demande à cet effet. Si la vérification n'est pas effectuée, le ministre peut rejeter tout ou une partie des travaux d'évaluation présentés.

**Filing Discounts**

1. Work filed within two years of completion is claimed at 100% of the above Total Value of Assessment Credit.
2. Work filed three, four or five years after completion is claimed at 50% of the above Total Value of Assessment Credit. See calculations below:

Total Value of Assessment Credit	Total Assessment Claimed
	x 0.50 =

**Remises pour dépôt**

1. Les travaux déposés dans les deux ans suivant leur achèvement sont remboursés à 100 % de la valeur totale susmentionnée du crédit d'évaluation.
2. Les travaux déposés trois, quatre ou cinq ans après leur achèvement sont remboursés à 50 % de la valeur totale du crédit d'évaluation susmentionné. Voir les calculs ci-dessous.

Valeur totale du crédit d'évaluation	Evaluation totale demandée
	x 0,50 =

**Certification Verifying Statement of Costs**

I hereby certify:  
that the amounts shown are as accurate as possible and these costs were incurred while conducting assessment work on the lands shown on the accompanying Report of Work form.

that as [Signature] I am authorized  
(Recorded Holder, Agent, Position in Company)  
to make this certification.

**Attestation de l'état des coûts**

J'atteste par la présente :  
que les montants indiqués sont le plus exact possible et que ces dépenses ont été engagées pour effectuer les travaux d'évaluation sur les terrains indiqués dans la formule de rapport de travail ci-joint.

Et qu'à titre de [Signature] je suis autorisé  
(titulaire enregistré, représentant, poste occupé dans la compagnie)

à faire cette attestation.

Signature	Date



Ministry of  
Northern Development  
and Mines

Ministère du  
Développement du Nord  
et des Mines

Application for Client Number  
(Company)  
Mining Act

Demande de numéro de client  
(Compagnie)  
Loi sur les mines

Personal information collected on this form is obtained under the authority of the Mining Act. This information will be used to maintain a record and ongoing status of clients. Questions about this collection should be directed to the Provincial Manager, Mining Lands, Ministry of Northern Development and Mines, 4th Floor, 159 Cedar St., Sudbury, Ontario, P3E 6A5, telephone (705) 670-7264.

Les renseignements personnels contenus dans la présente formule sont recueillis en vertu de la Loi sur les mines et serviront à tenir à jour un registre sur les clients. Adresser toute question sur la collecte de ces renseignements au chef provincial des terrains miniers, ministère du Développement du Nord et des Mines, 159, rue Cedar, 4<sup>e</sup> étage, Sudbury (Ontario) P3E 6A5, téléphone (705) 670-7264.

Please Print or Type/Écrire en lettres moulées ou dactylographier

Company Name / Nom de la compagnie <b>GREAT WHITE MINERALS LTD.</b> <i>GREAT WHITE MINERALS LTD.</i>		Telephone No. / N° de téléphone <b>(705) 268-7793</b>	Fax No. / N° de télécopieur <b>705-268-6225</b>
Address of Head Office: Street / Adresse du siège social : Rue <b>74 Roblin RR #2</b>			
City, Town or Village / Ville ou village <b>Timmins</b>	Prov./State / Prov./État <b>Ont</b>	Country / Pays <b>Canada</b>	Postal/Zip Code / Code postal <b>P4N 7C3</b>
Name of President / Nom du président <b>David P. Larche</b>		Address of President: Street / Adresse du président : Rue <b>74 Roblin RR #2</b>	
City, Town or Village / Ville ou village <b>SAME AS ABOVE</b>	Prov./State / Prov./État	Country / Pays	Postal/Zip Code / Code postal
Place of Incorporation / Lieu de constitution <b>City of Timmins District of Cochrane</b>			

This application must be signed by an authorized officer of the corporation.

Cette demande doit être signée par un agent autorisé de la personne morale.

I hereby apply for a client number and in support thereof make the following statements:

Je demande par la présente un numéro de client et pour appuyer ma demande je déclare ce qui suit :

1. The company  is  is not the holder of a client number.

1. La compagnie  est  n'est pas titulaire d'un numéro de client.

2. I have submitted a copy of the articles of incorporation.

2. J'ai déposé une copie des articles de constitution.

Signature of Official / Signature de l'agent <i>David P. Larche</i>	Office Held / Fonctions <b>President</b>	Date <b>MARCH 4/92</b>
--	---	---------------------------

It is an offence under the Mining Act to make a false statement on this document.

Toute fausse déclaration dans le présent document constitue une infraction en vertu de la Loi sur les mines.

Office Use Only/Réservé au bureau

Client No. / N° de client <b>217743</b>	Date of Issue / Date de délivrance <b>March 9/92</b>	<div style="border: 2px solid black; padding: 5px; text-align: center;"> <p>RECEIVED</p> <p>MAR - 9 1992</p> <p>AM <input type="checkbox"/> PM <input type="checkbox"/></p> <p>7 8 9 10 11 12 1 2 3 4 5 6</p> </div>
<p>Articles of incorporation Cop # 976086</p>		

Nota : Dans cette formule, lorsqu'il désigne des personnes, le masculin est utilisé au sens générique.



**LARCHEX Inc.**  
**MINING EXPLORATION**  
 PHONE 268-7793 FAX 268-6225

Office: 74 Roblin Ave.  
 Mailing: P.O. Box 1394  
 Timmins, Ontario P4N 7N2

025

Great White Minerals Ltd  
 74 Roblin RR # 2

DATE OF INVOICE: .....

CUSTOMER NO: .....

	RE: stripping + trenching on Frapp + Price property.		
JUNE 5-8	Timber jack Backhoe + Pick shovel incl Operator float equipment	3 Days	2250.00
AUG 5-6	Timber jack Backhoe + Operator	4 Days	3000.
	Wajax +	6 Days	4800.
	3 Operators		1500.
SEP 15	Excavator 1 Yard Back of	Month	4800.
OCT 10	D4D Dozer	Month	2000.
	WAJAX	Month	1000.
	3 Operators.		4000.
			\$ 19030.00
	Map + Demolish	\$ 16.50	
	Utility track 3 units	1200.	
	Greensys Camp Supplies	206.	3056
	<i>Price per 1.</i>		
	<b>COST PRICE</b>		\$ 22086.00



FIGURE 1: LOCATION MAP

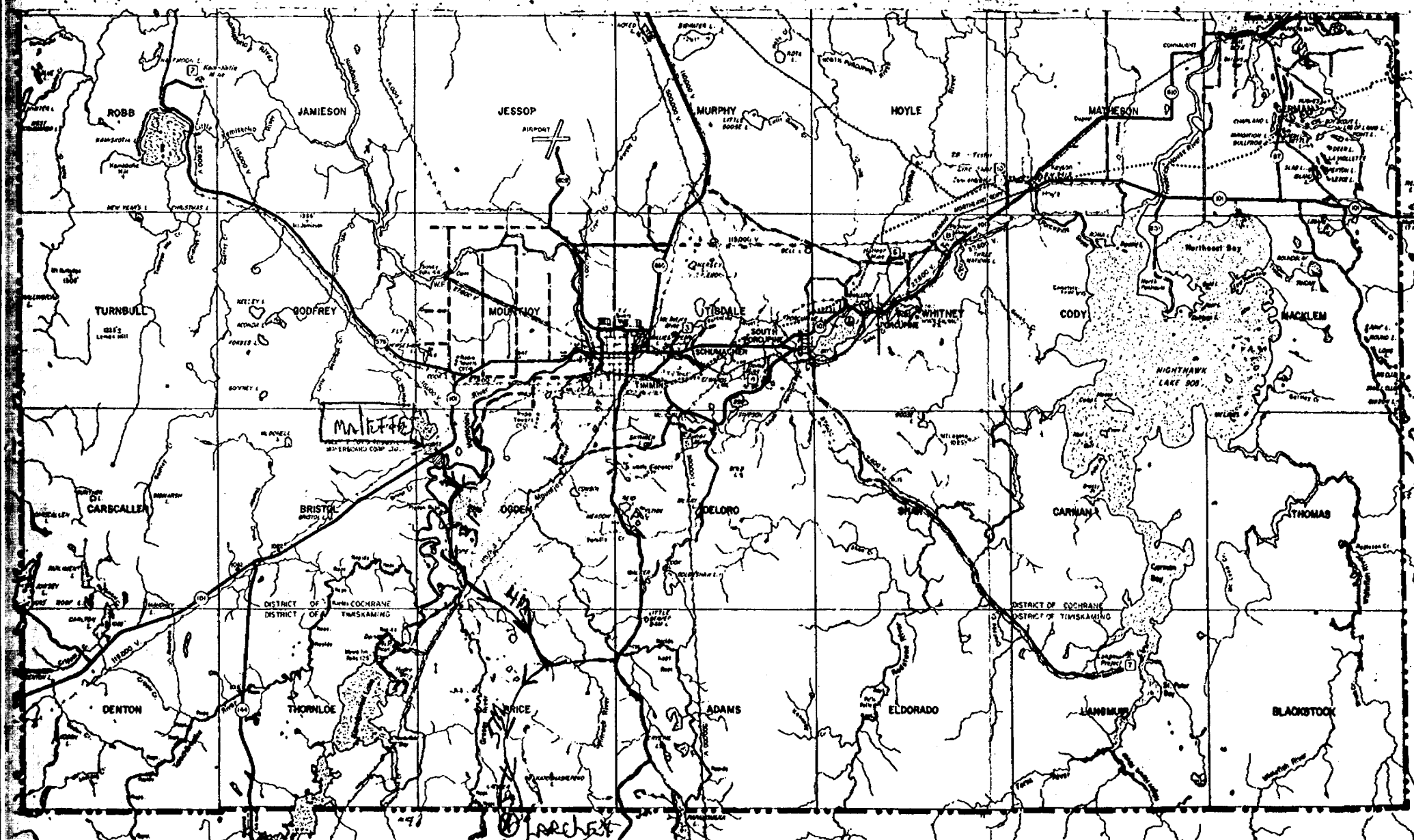

# CITY OF TIMMINS ONTARIO

## REFERENCE

- 1. CITY BOUNDARY
- 2. MAIN ROADS
- 3. BRANCH ROADS
- 4. RAILROADS
- 5. POWER LINES
- 6. HYDRO-ELECTRIC GENERATING STATION

- 7. RAPIDS, FALLS AND DAM
- 8. SEAPLANE BASE
- 9. MINE
- 10. ELEVATION IN FEET
- 11. HORIZONTAL CONTROL POINT
- 12. BENCH MARK
- 13. NORTHWESTERN BALS CO. LTD. - VAN LINE



Drawn by: DAVIDSON TIDDAH Approved by: GEORGE A. QUINN, P. Eng  
 JANUARY 1, 1970

## MINERAL PRODUCTION

- |   |                                  |
|---|----------------------------------|
| 1. TOLUFT - ECSTAL MINING LIMITED       | - ZINC, COPPER, SILVER, YR., UR. |
| 2. KAM-KOTIA MINES LIMITED              | - ZINC, COPPER                   |
| 3. MCINTYRE PORCUPINE MINES LTD.        | - GOLD, COPPER                   |
| 4. DOME MINES LIMITED                   | - GOLD                           |
| 5. AUNOR MINE                           | - GOLD                           |
| 6. HALLNOR MINE                         | - GOLD                           |
| 7. LANGMUIR PROJECT MINE                | - SILVER                         |
| 8. PARACLET PORCUPINE MINES LTD.        | - GOLD                           |
| 9. ECSTAL MINING LTD - ORE CONCENTRATOR |                                  |
| 10. ECSTAL MINING LTD - ZINC PLANT      |                                  |

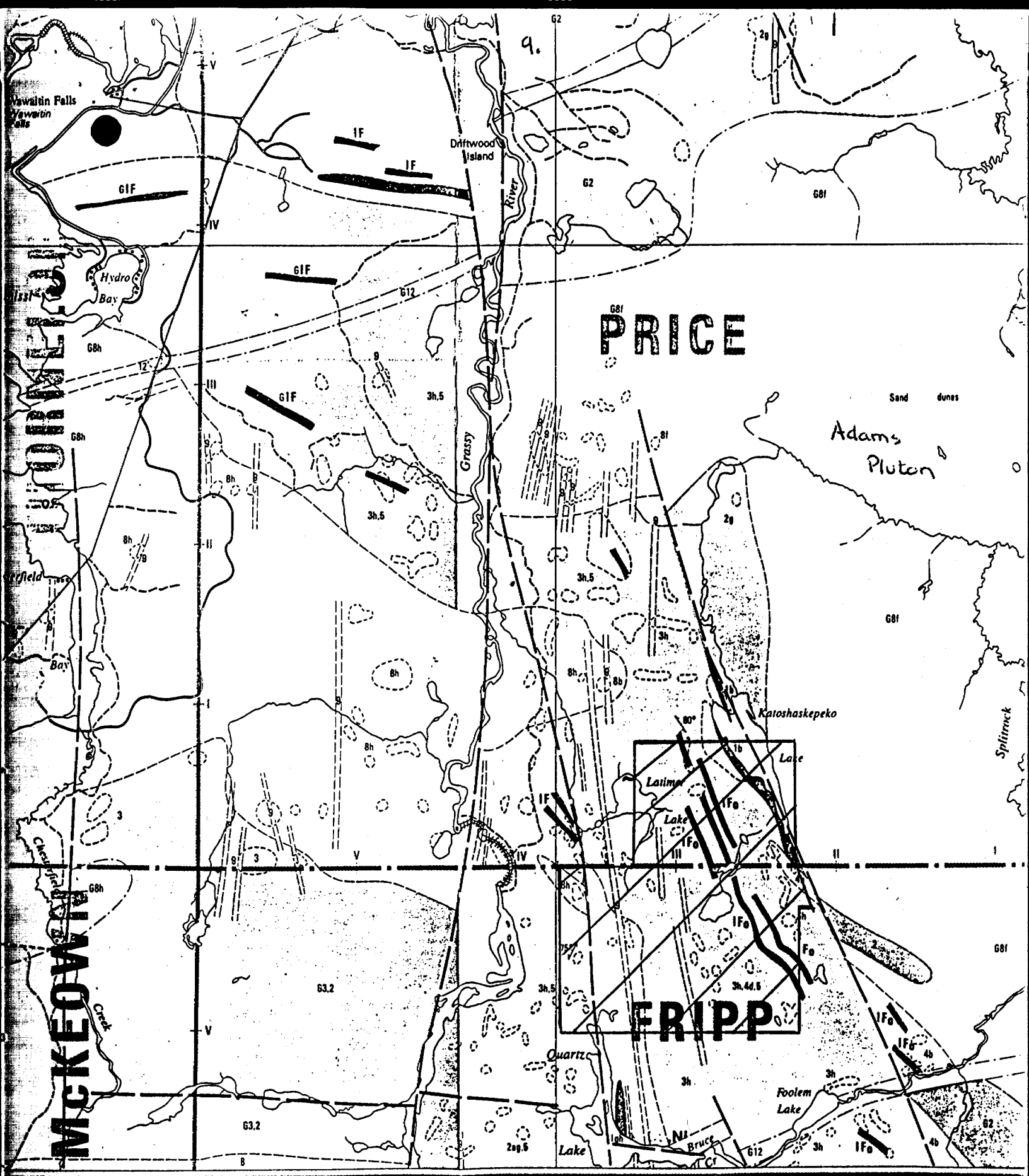
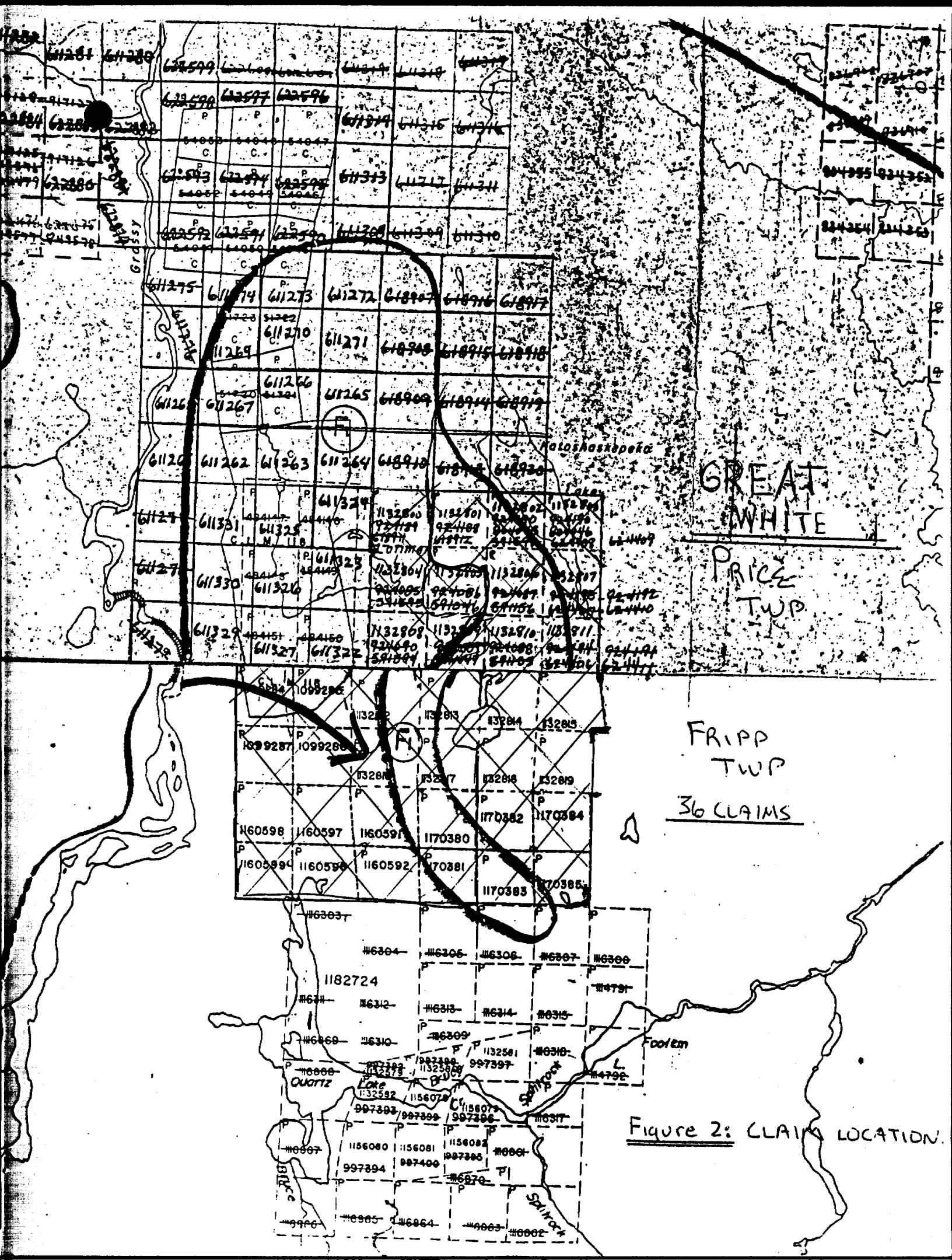

Figure 4: Local Geology - Great White Silica Property





GREAT  
WHITE

PRICE  
TWP

FRIPP  
TWP

36 CLAIMS

Figure 2: CLAIM LOCATION.

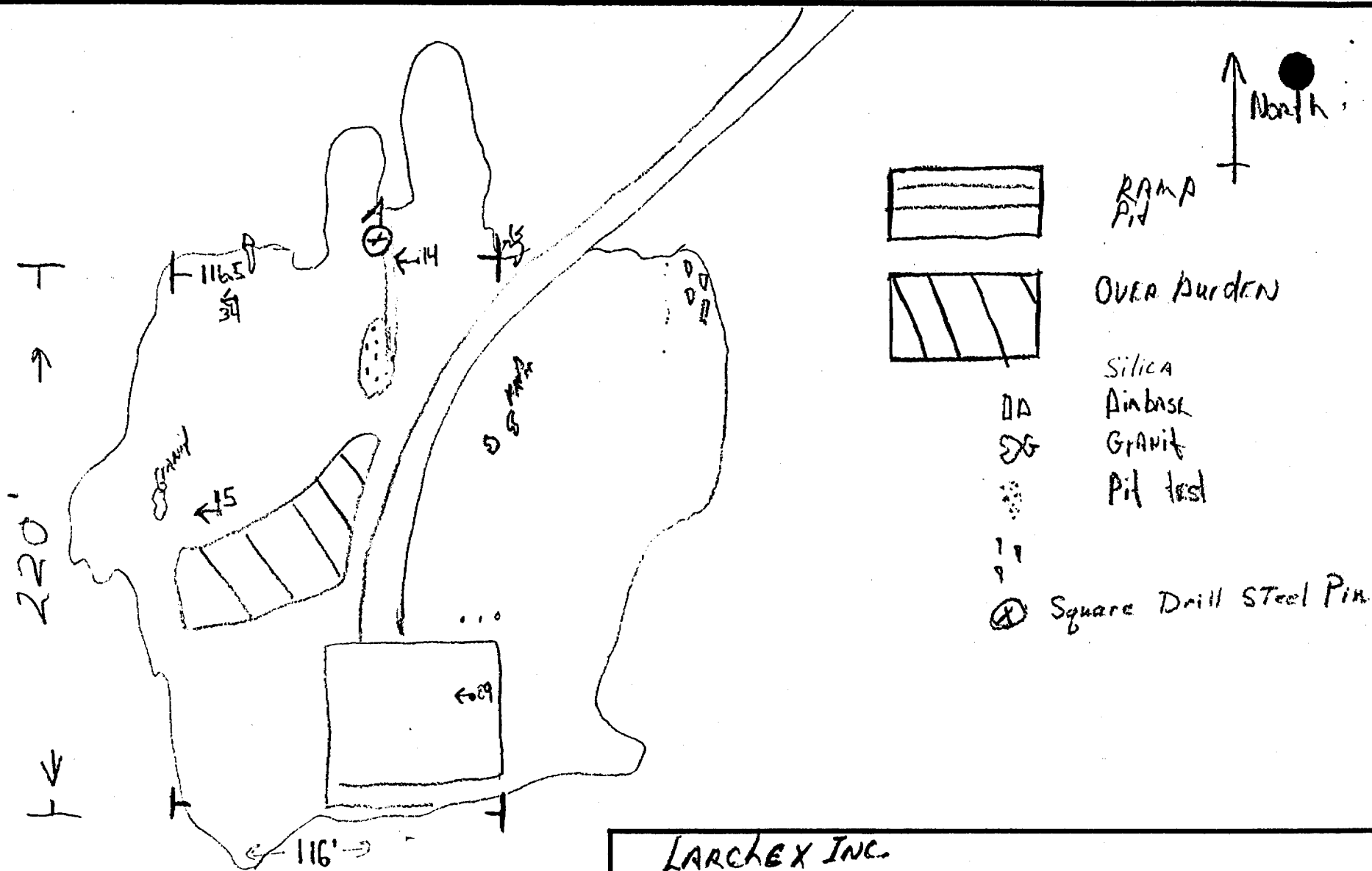

Note: ⊗ Pin located 500 Feet S and 400 Feet East of #4 of P-1132816

<b>LARCHEX INC.</b>		
Stripping Mapping Drilling		
SCALE: 50.2 FEET = 1 INCH 1.5 INCH = 1 M	APPROVED BY:	DRAWN BY: David
DATE: DEC 5/91		REVISED
		DRAWING NUMBER
		2



OFFICE 74 ROBLIN AVE., BOX 1394, TIMMINS, ONTARIO P4N 7N2  
PHONE (705) 268-7793 FAX (705) 268-6225

Technical Report

Property Name GREAT WHITE SILICA PROSPECT  
-----

Location Main access to the property South of Timmins  
pine str. south 13km (first right past Mountjoy  
River ). At this point the property would be  
reached by travelling west a distance of 4.9 km.  
Then south on a property access road a distance  
of 9km to the main silica showing.

Mining Division:

The property is located within the Porcupine  
Mining Division. The property straddles Price  
Fripp. Townships. Stripping Trenching located  
on claim P-1132816 sketch attached.

Main Target of Project

A - To further expose and delineate the large  
quartz mass that has been partially explored  
early last spring. The program will aid in a  
preliminary tonnage and grade of silica also outline  
of the deposit. These figures will assist in  
defining the type of market that is best suited  
for the deposit.

*Thank You,*  
*DPK*  
*March 25/92*  
David P. Larche President  
Larchex Inc.

*Note: For breakdown in type of Equipment + Days worked please  
see attached invoice.*

---

Power Stripping — Trenching and Blasting — Sampling Bulk, Channel Hole — Exploration Access Road  
Road Slashing Construction — Hydraulic Trenching (Wajax) — Staking & Surveys

---

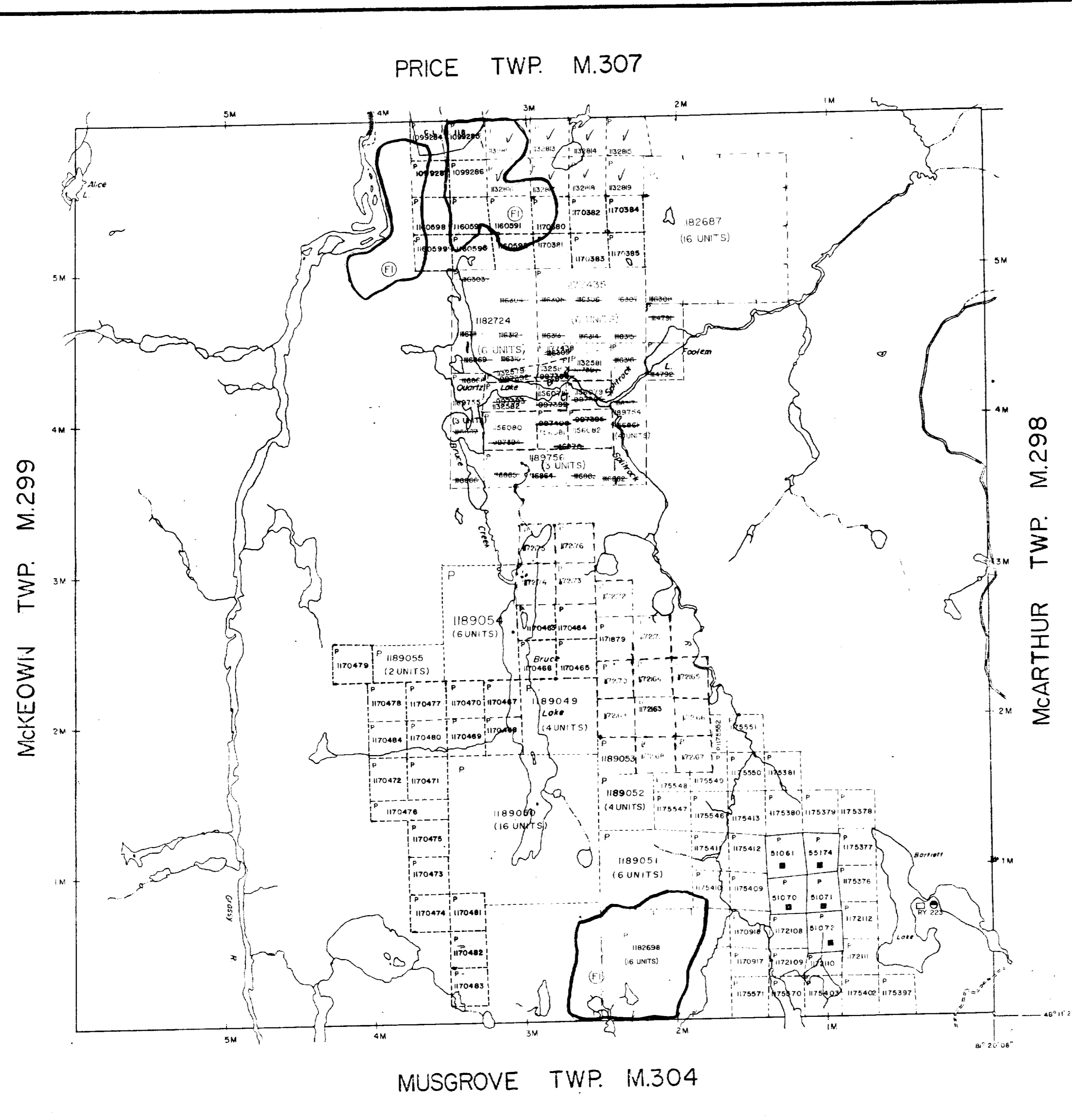

THE TOWNSHIP  
OF  
**FRIPP**

DISTRICT OF  
TIMISKAMING  
  
PORCUPINE  
MINING DIVISION

SCALE: 1-INCH = 40 CHAINS

- DISPOSITION OF CROWN LANDS**
- PATENT, SURFACE AND MINING RIGHTS ----- (C)
  - SURFACE RIGHTS ONLY ----- (O)
  - MINING RIGHTS ONLY ----- (S)
  - LEASE, SURFACE AND MINING RIGHTS ----- (L)
  - SURFACE RIGHTS ONLY ----- (O)
  - MINING RIGHTS ONLY ----- (S)
  - LICENCE OF OCCUPATION ----- (L)
- ROADS
- IMPROVED ROADS ----- (R)
  - KING'S HIGHWAYS ----- (K)
  - RAILWAYS ----- (R)
  - POWER LINES ----- (P)
  - MARSH OR MUSKEG ----- (M)
  - MINES ----- (M)
  - CANCELLED ----- (C)

**NOTES**

400' surface rights reservation along the shores of all lakes and rivers.

Areas withdrawn from staking under Section 43 of the Mining Act (R.S.O. 1970.)

Order No	File	Date	Disposition

Φ REMOTE TOURIST CAMPS

F- THIS TWP. SUBJECT TO FOREST ACTIVITY IN 1992/93. FURTHER INFORMATION ON FILE

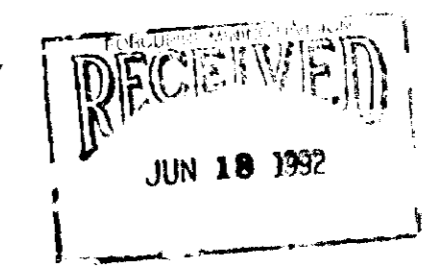

IN SERVICE NOV. 22/89 CHECKED BY S. ROWAN

PLAN NO. **M.281**

ONTARIO  
MINISTRY OF NATURAL RESOURCES  
SURVEYS AND MAPPING BRANCH

THE INFORMATION THAT APPEARS ON THIS MAP HAS BEEN COMPILED FROM VARIOUS SOURCES AND ACCURACY IS NOT GUARANTEED. THOSE WISHING TO STAKE MINING CLAIMS SHOULD CONSULT WITH THE MINING RECORDER, MINISTRY OF NORTHERN DEVELOPMENT AND MINES FOR ADDITIONAL INFORMATION ON THE STATUS OF THE



M.305

PRICE 1MB

M.305

PRICE 1MB

Ogden Twp. (M.305)

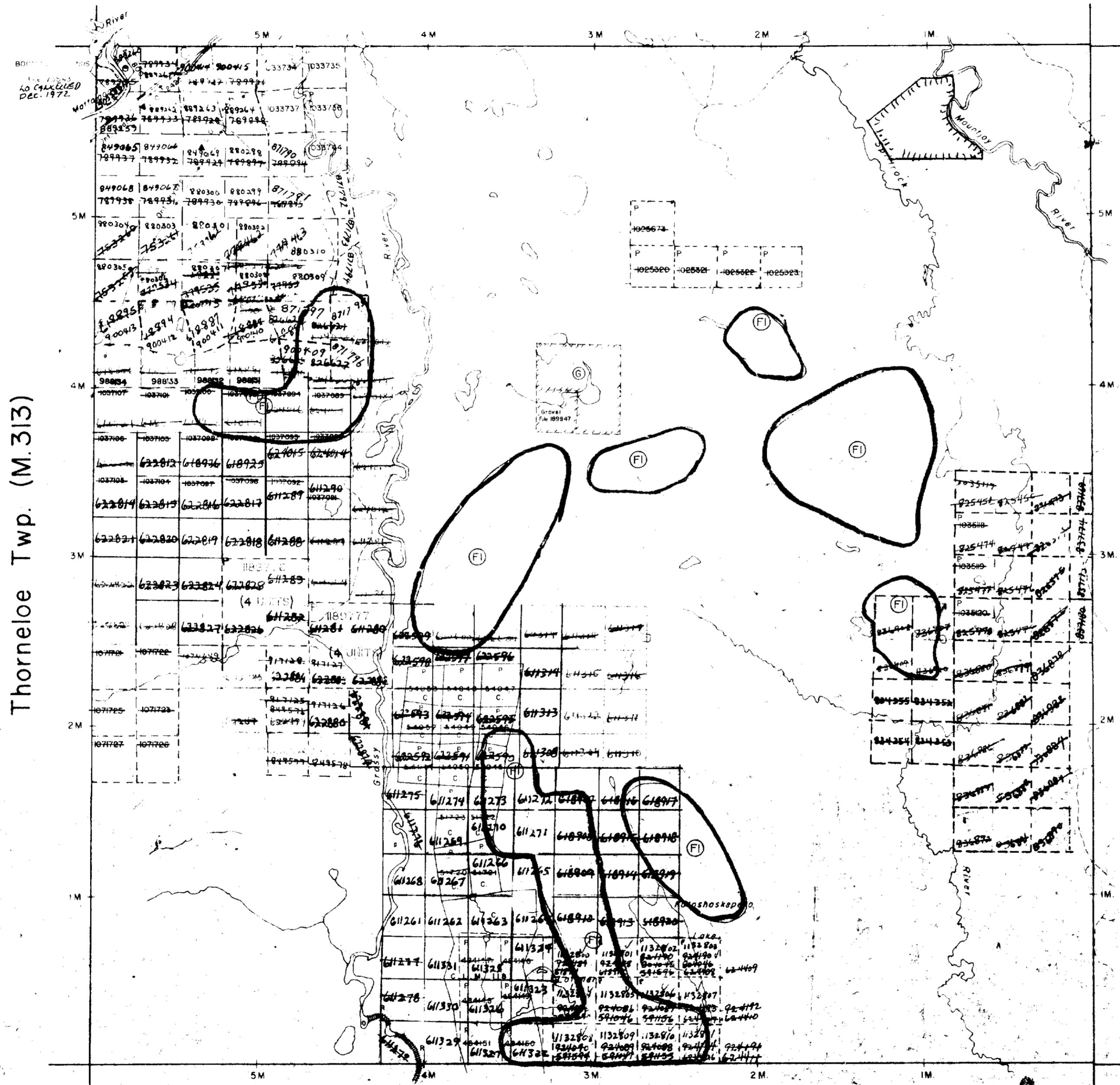

Thorneloe Twp. (M.313)

Adams Twp. (M.261)

Frapp Twp. (M.281)

THE TOWNSHIP OF

PRICE

DISTRICT OF COCHRANE

PORCUPINE MINING DIVISION

SCALE: 1-INCH = 40 CHAINS

DISPOSITION OF CROWN LANDS

- PATENT, SURFACE AND MINING RIGHTS
- " SURFACE RIGHTS ONLY
- " MINING RIGHTS ONLY
- LEASE, SURFACE AND MINING RIGHTS
- " SURFACE RIGHTS ONLY
- " MINING RIGHTS ONLY
- LICENCE OF OCCUPATION
- ROADS
- IMPROVED ROADS
- KING'S HIGHWAYS
- RAILWAYS
- POWER LINES
- MARSH OR MUSKEG
- MINES
- CANCELLED

NOTES

400' surface rights reservation along the shores of all lakes and rivers.

Areas withdrawn from staking under Section 43 of the Mining Act (R.S.O. 1970).  
 Order No. File Date Disposition

*PLANNED RE FORESTATION*  
*May 2/83*  
 FI - THIS TWP. SUBJECT TO FOREST ACTIVITY IN 1992/93  
 FURTHER INFORMATION AVAILABLE ON FILE.

SAND AND GRAVEL

Q QUARRY PERMIT

*Rec. Oct. 3/79*

This township lies within the Municipality of the CITY OF TIMMINS.

PLAN NO. M-307

ONTARIO  
MINISTRY OF NATURAL RESOURCES  
SURVEYS AND MAPPING BRANCH

THE INFORMATION THAT APPEARS ON THIS MAP HAS BEEN COMPILED FROM VARIOUS SOURCES, AND ACCURACY IS NOT GUARANTEED. THOSE WISHING TO STAKE MINING CLAIMS SHOULD CONSULT WITH THE MINING RECORDER, MINISTRY OF NORTHERN DEVELOPMENT AND MINES, FOR ADDITIONAL INFORMATION ON THE STATUS OF THE LANDS SHOWN HEREON.



M.305