

42A03SE0013 17 BARTLETT

010

# Diamond Drilling

Township of BARTLETT

Report NO 17

Work performed by: Conigo Mines

Claim NO	Hole NO	Footage	Date	Note
P 59088	1	500.0'	May/65	
	2	449.0'	June/65	
	3	367.0'	May/65	
	7	631.0'	June/65	
	8	548.0'	June/65	
P 59089	4	502.0'	June/65	
	11	1199.0'	July/65	
	12	328.0'	July/65	
P 75191	5-B	352.0'	June/65	
P 75190	6	302.0'	June/65	
	9	795.0'	July/65	
	10	1000.0'	July/65	
		<u>6973'</u>		

Notes:

CONIGO MINES LIMITED  
DIAMOND DRILL SUMMARY  
GROUP "C"  
BARTLETT TOWNSHIP, ONTARIO

Hole No.	Location		Claim No.	Bearing Magnetic	Collar Dip	Casing Feet	Depth Feet	Accum. Footage	DATE STARTED	DATE FINISHED	LOGGED BY
	Latitude	Departure									
1	3N	26 † 00E	P 59088	West	45°	33.0	500.0	500.0	16/5/65	19/5/65	S.S. Szetu
2	3N	23 † 00E	P 59088	West	45°	55.0	449.0	949.0	7/6/65	9/6/65	F.M. Smith
3	3N	20 † 00E	P 59088	West	45°	32.0	500.0 <sup>367</sup>	1449.0	20/5/65	24/5/65	S.S. Szetu
4	15N	29 † 50E	P 59089	West	45°	22.0	502.0	1951.0	9/6/65	14/6/65	F.M. Smith
5	9S	12 † 00E	P 75191	West	45°	Lost in overburden			26/5/65	31/5/65	F.M. Smith
5B	9S	12 † 00E	P 75191	West	50°	125.0	352.0	2303.0	1/6/65	7/6/65	F. M. Smith
6	3S	24 † 00E	P 75190	West	45°	24.0	302.0	2605.0	17/6/65	22/6/65	F.M. Smith
7	3N	25 † 40E	P 59088	East	55°	46.0	631.0	3236.0	22/6/65	6/7/65	F.M. Smith
8	3N	25 † 50E	P 59088	East	45°	46.0	548.0	3784.0	23/6/65	26/6/65	F.M. Smith
9	6S	20 † 00E	P 75190	East	45°	27.0	795.0	4579.0	6/7/65	13/7/65	F.M. Smith
10	3S	24 † 00E	P 75190	East	45°	40.0	1000.0	5579.0	7/7/65	21/7/65	F.M. Smith
11	3N	23 † 00E	P 75189	S60E	45°	25.0	1199.0	6778.0	21/7/65	11/8/65	F.M. Smith
12	24S	16 † 50E	P 75189	East	45°	60.0	328.0	7106.0	15/7/65	20/7/65	F.M. Smith

Note

- a) Logged by Dr. S.S. Szetu and Fred M. Smith, P.Eng.
- b) Locations plotted from Geophysical Map by Cana Exploration Consultants Ltd.
- c) Two machines used in this program.





# DIAMOND DRILL RECORD

NAME OF PROPERTY Conigo Mines Ltd. (Block "C")  
 HOLE NO. 1 LENGTH 500'  
 LOCATION Bartlett Township, Ontario.  
 LATITUDE \_\_\_\_\_ DEPARTURE L. 3N., 26 + 00 East  
 ELEVATION \_\_\_\_\_ AZIMUTH West DIP -45°  
 STARTED \_\_\_\_\_ FINISHED May 17, 1965.

FOOTAGE	DIP	AZIMUTH	FOOTAGE	DIP	AZIMUTH

HOLE NO. 1 SHEET NO. 3

REMARKS \_\_\_\_\_

LOGGED BY S. S. Szetu.

FOOTAGE		DESCRIPTION	SAMPLE				ASSAYS			
FROM	TO		NO.	SULPHIDES	FOOTAGE		%	%	OZ/TON	OZ/TON
					FROM	TO				
425	450	Same, blocky at 425-426'; 433-434. 5'; 443-444. 5'; quartz veinlet at 443'.  Sp. 10 at 500'. Black or grey impure soapstone, with numerous calcareous veinlets from 450-455', specks of sulphide at last 20 ft.  - End of Hole -  <i>S.S. Szetu</i>								
450	500									
500										

LANFRIDGE LIMITED, 105 RICHMOND STREET WEST, TORONTO, ONT. EM. 6-1168

# DIAMOND DRILL RECORD

**PROPERTY** CONIGO MINES LIMITED **HOLE No.** 2 Block C.  
**SHEET NUMBER** 1 **SECTION FROM** \_\_\_\_\_ **TO** \_\_\_\_\_ **STARTED** June 7th 1965  
**LATITUDE** line 3 N. 2300 E **DATUM** \_\_\_\_\_ **COMPLETED** June 9th 1965  
**DEPARTURE** \_\_\_\_\_ **BEARING** 270 Magnetic **ULTIMATE DEPTH** 449  
**ELEVATION** \_\_\_\_\_ **DIP** 37 degrees bottom of casing **PROPOSED DEPTH**  
36 " at 220 feet 38 degrees at 440 feet

DEPTH FEET	FORMATION	SAMPLE NO.	FROM	TO	WIDTH	ASSAY VALUES			
0-55	Casing								
55-75	dark dense structure, shear planes graphite faced metallic mineral								
75-130	light grey granitic type of intrusive								
130-133	dark colored dense structure								
133-154	light grey type of structure								
154-268	dark grey medium grained structure occasional seams & stringers of qtz and carbonate, coarser grained								
268-331	dark grey fine grained structure occasional seams & stringers qtz & carb.								
331-335	light grey intrusive granitic type								
335-407	dark grey fine grained structure								
407-447	light grey fine grained structure intrusive contact								
447-449	light grey very fine grained structure.								
	END OF HOLE GOOD CONTACT COVERED								

NORTHERN MINER FORM 908 REV/54

DRILLED BY Bradley Bros. D.D. Co. SIGNED \_\_\_\_\_

2-59088

# DIAMOND DRILL RECORD

NAME OF PROPERTY Conigo Mines Ltd. (Block "C")  
 HOLE NO. 3 LENGTH 599' 367'  
 LOCATION Bartlett Township, Ontario  
 LATITUDE \_\_\_\_\_ DEPARTURE L. 3N, 2,000' East  
 ELEVATION \_\_\_\_\_ AZIMUTH West DIP -45°  
 STARTED \_\_\_\_\_ FINISHED May 24, 1965

FOOTAGE	DIP	AZIMUTH	FOOTAGE	DIP	AZIMUTH

HOLE NO. 3 SHEET NO. 1

REMARKS \_\_\_\_\_

LOGGED BY S. S. Szetu

FOOTAGE		DESCRIPTION	SAMPLE				ASSAYS				
FROM	TO		NO.	SULPHIDES	FOOTAGE			%	%	OZ/TON	OZ/TON
					FROM	TO	TOTAL				
0	32	Casing.									
32	50	Brecciated and partly-silicified volcanic with siliceous and quartz fillings, heavily-disseminated and streaks of pyrrhotite, sizes of fragments from minute to about 2". Sp. C-3-1, a few quartz eyes; 2" quartz vein at 32.8'; weak shearing more or less parallel to core from 37-38'; sharp angle at 38.5'.									
50	75	Same as above, with quartzite from 54.5-56'(C-3-2); strong silicification to 64.5'; quartzite at 61-63'; 64.5-65' - weak shearing 25° to core; calcareous slip from 73-73.6', less pyrrhotite, although, local heavy streaks.									
75	100	Same, but with numerous small porphyroblastic quartz which appeared to be after feldspar phenocrysts in the volcanic fragments, suggesting an originally brecciated porphyritic volcanic, (C-3-3) same type of pyrrhotite mineralization, but with heavy, fine pyrite at 79.5-79.8', mixed with some pyrrhotite.									
100	125	Same, with small porphyroblastic quartz (or feldspar); 1" pyrite seam at 122'; fragments, in general, large - up to about 5".									
125	150.6	Same as 100-125', less mineralized; aplitic from 146-148.5'; heavy pyrite from 145.4 to 145.7'.									

LANGRIDGE LIMITED, 105 RICHMOND STREET WEST, TORONTO, ONT. EM. 6-186







# DIAMOND DRILL RECORD

PROPERTY CONIGO MINES LIMITED

HOLE No. 4 Block

SHEET NUMBER 1

SECTION FROM \_\_\_\_\_ TO \_\_\_\_\_

STARTED June 10th 1965

LATITUDE Line 15 N. 30 E.

DATUM \_\_\_\_\_

COMPLETED June 14th 1965

DEPARTURE \_\_\_\_\_

BEARING 270 degrees Mag.

ULTIMATE DEPTH 502

ELEVATION \_\_\_\_\_

22ft. 43 degrees 200ft. 39 degrees

500ft. 38 degrees 500ft. 38 degrees

RECORDED DEPTH \_\_\_\_\_

DEPTH FEET	FORMATION	SAMPLE NO.	FROM	TO	WIDTH	ASSAY VALUES			
0-22	casing								
22-42.5	light grey siliceous material qtz stringers								
44.5-165	Alternating sections of dark & light grey fine grained material with stringers of qtz. and seams & disseminated pyrite & pyrrhotite. Banded 123-130								
165-297	Dark grey basic structure some chlorite alteration. fine grained. seams and sections of qtz. and disseminated pyrite & some pyrrhotite.								
297-442	Fine to medium grained acidic material some spotted sections. Disseminated pyrite & some pyrrhotite through out. Seams and sections of qtz.								
442-465	Dark grey highly altered material basic. qtz pyrite & pyrrhotite								
463-502	alternating sections of basic and acidic material. qtz. pyrite. & some Pyrrhotite. Good core recovery								
All core split and sent for assay. Assay slip #0103 was blank not printed in book. assay numbers from 0103 to 0122 should be advanced one number.									

NORTHERN MINER FORM 004 REV. 54

Bradley Bros. D.D. CO

SIGNED \_\_\_\_\_

# DIAMOND DRILL RECORD

*321107*

PROPERTY COMICO LINES LIMITED HOLE No. 5891-ek C1  
 SHEET NUMBER 1 SECTION FROM \_\_\_\_\_ TO \_\_\_\_\_ STARTED \_\_\_\_\_  
 LATITUDE loc. line 9S 1202 E. DATUM \_\_\_\_\_ COMPLETED June 5th 1965  
 DEPARTURE \_\_\_\_\_ BEARING 270 degrees magnetic ULTIMATE DEPTH 352  
 ELEVATION \_\_\_\_\_ DIP surface 50 degree 350 53 degree PROPOSED DEPTH \_\_\_\_\_

DEPTH FEET	FORMATION	SAMPLE NO.	FROM	TO	WIDTH	ASSAY VALUES			
0-125	casing								
125-137	greenstone								
137-142	sheared soft soap stone								
142-162	soapstone								
162-170	4 inches massive at 162. siliceous structure 1 inch banding at 170 disseminat ed pyrite.								
170-177	massive light colored pyrite.								
177-187	banded structure. alternating bands of pyrite rock & pyrrhotite.								
187-256	banded structure banding less distinct from 223								
256-263	feldspar porphoty, fractured scattered pyritic mineral.								
263-265	massive pyrite and pyrrhotite.								
265-307	greenstone with numerous seams of coarse pyrite								
307-322	feldspar porphory								
322-342	greenstone, sections of pyrite & pyrrhotite								

NORTHERN MINER FORM 505 REV. 64

DRILLED BY Bradley Bros. Limited SIGNED \_\_\_\_\_

# DIAMOND DRILL RECORD

PROPERTY CO. BRADLEY MINES LIMITED HOLE No. 58 Block C.

SHEET NUMBER 2 SECTION FROM \_\_\_\_\_ TO \_\_\_\_\_ STARTED \_\_\_\_\_

LATITUDE \_\_\_\_\_ DATUM \_\_\_\_\_ COMPLETED \_\_\_\_\_

DEPARTURE \_\_\_\_\_ BEARING \_\_\_\_\_ ULTIMATE DEPTH \_\_\_\_\_

ELEVATION \_\_\_\_\_ DIP \_\_\_\_\_ PROPOSED DEPTH \_\_\_\_\_

DEPTH FEET	FORMATION	SAMPLE NO.	FROM	TO	WIDTH	ASSAY VALUES			
342- 352	feldspar porphyry.								
	END OF HOLE GOOD CORE RECOVERY								
	<del>sample slips with details of sampling attached.</del>								

NORTHERN MINER FORM 505 REV./54

DRILLED BY Bradley Bros. Limited SIGNED M. Smith

# DIAMOND DRILL RECORD

PROPERTY CONGO LINES LIMITED HOLE No. 6 Block C.  
 SHEET NUMBER 1 SECTION FROM \_\_\_\_\_ TO \_\_\_\_\_ STARTED June 17th 1965  
 LATITUDE Line 3 S. 24 E. DATUM \_\_\_\_\_ COMPLETED June 22nd 1965  
 DEPARTURE \_\_\_\_\_ BEARING 270 magnetic ULTIMATE DEPTH 302 feet  
 at 25 ft. 43 degrees at 150ft. 42 degrees  
 ELEVATION \_\_\_\_\_ DIP at 300 feet 38degrees. PROPOSED DEPTH 300.

DEPTH FEET	FORMATION	SAMPLE NO.	FROM	TO	WIDTH	ASSAY VALUES			
0-24	casing								
24-104	grey granitic type of rock coarse grained. Fine at contact.								Intrusive
104-124	Dark grey altered greenstone								
124-130	Massive light colored pyrite								
130-136	Massive pyrrhotite with seams & crystals of pyrite.								
136-170	Seams & sections of pyrrhotite some pyrite								
170-229	Acidic intrusion some porphoritic sections. Seams & occasional section pyrr.								pyrit
229-253.5	Altered basic greenstone								
253.5-280.5	Siliceous intrusion some porphoritic sections								
280.5-302	Basic talcose material sparse metallic minerals.								
GOOD CORE RECOVERY									

NORTHERN MINER FORM 500 REV./64

DRILLED BY Bradley Bros D.D.Co

SIGNED F.M. Smith

# DIAMOND DRILL RECORD

PROPERTY CONIGO MINES LIMITED HOLE No. 7 BLOCK 1  
 SHEET NUMBER 1 SECTION FROM \_\_\_\_\_ TO \_\_\_\_\_ STARTED June 22nd 1965  
 LATITUDE Line 3 N. 2540 E. DATUM \_\_\_\_\_ COMPLETED July 6th 1965  
 DEPARTURE \_\_\_\_\_ BEARING 90 degrees magnetic ULTIMATE DEPTH 631  
 dip at surface 55 degrees at 45ft, 52 degrees  
 ELEVATION \_\_\_\_\_ DIP at 200-48 degrees at 400-53 degrees DEPTH \_\_\_\_\_  
 at 500-47 degrees at 630-47 degrees.

DEPTH FEET	FORMATION	SAMPLE NO.	FROM	TO	WIDTH	ASSAY VALUES			
0-46	casing								
46-84	soapstone								
84-94	dark grey fine grained basic material								
94-168	<del>talcoose more massive and harder from 136-168</del>								
168-257	Dark grey fine grained material some alteration								
216-257	soap stone								
257-501	Dark grey fine grained altered material fragments from 498-501								
501-537	Grey medium to coarse grained; tourmaline needles & plates								
537-631	Alternating sections of dark & light grey material much altered.								
	This whole hole I judge to be peridotite with meta morphosed sections								
	Metallic minerals sparse.								

NORTHERN MINER FORM 500 REV/54

Drilled by Bradley bros D.D. Co

SIGNED H. M. Gault

# DIAMOND DRILL RECORD

PROPERTY CONIGO MINES LIMITED HOLE No. 8 Block C.  
 SHEET NUMBER 1 SECTION FROM \_\_\_\_\_ TO \_\_\_\_\_ STARTED June 23rd 1965  
 LATITUDE Line 3 N, 2550 E. DAPUM \_\_\_\_\_ COMPLETED June 26th, 1965  
 DEPARTURE \_\_\_\_\_ BEARING 90 degrees magnetic ULTIMATE DEPTH 548 ft.  
 ELEVATION \_\_\_\_\_ dip at 46ft. 39 degrees at 200 38 degrees  
 dip at 400 38 degrees at 545 37 degrees DEPTH \_\_\_\_\_

DEPTH FEET	FORMATION	SAMPLE NO.	FROM	TO	WIDTH	ASSAY VALUES			
0-46	casing								
46-433	Dark gray fine grained igneous rock with occasional sections of lighter gray, no contacts just gradation, very little metallic minerals some very narrow seams of asbestos.								
433-444	soap stone								
444-457	dark gray altered structure some talc.								
457-490	Dark gray igneous rock some light gray sections								
490-510	gray coarse grained tourmaline laths.								
510-548	dark gray fine grained basic igneous rock.								

NORTHERN MINES FORM NO. REV. 54  
 Drawn by Bradley Bros D. D. Co SIGNED F. M. Smith

# DIAMOND DRILL RECORD

PROPERTY CONIGO MINES LIMITED HOLE No. 9 BLOCK C.  
 SHEET NUMBER 1 SECTION FROM \_\_\_\_\_ TO \_\_\_\_\_ STARTED July 6th 1965  
 LATITUDE L. 6 S 20 E. DATUM \_\_\_\_\_ COMPLETED July 13th 1965  
 DEPARTURE \_\_\_\_\_ BEARING 90 degrees magnetic ULTIMATE DEPTH 795  
 ELEVATION \_\_\_\_\_ Dip 45 degrees at 27ft 43 degrees at 100-43 degrees  
 \_\_\_\_\_ Dip at 300-43 degrees at 500-43 degrees at 790-43 degrees

DEPTH FEET	FORMATION	SAMPLE NO.	FROM	TO	WIDTH	ASSAY VALUES			
0-28	casing								
27-139	gray fine grained biotite altered structure								
139-147	dark gray dense basic intrusive trap dike?								
147-795	Alternating sections of grey and dark grey basic structure, greatly altered with very few specks of metallic mineralization.								

DRILLED BY Bradley Bros D. D. Co SIGNED F. M. F. Smith  
NORTHERN MINER FORM 600 REV. 7/54



# DIAMOND DRILL RECORD

PROPERTY W. 190 E. IS LIPED HOLE No. 10 Block C.

SHEET NUMBER 1 SECTION FROM                      TO                      STARTED July 7th 1965

LATITUDE 33° 32' 4 E. DATUM                      COMPLETED July 21st 1965

DEPARTURE                      BEARING 90 degrees magnetic ULTIMATE DEPTH 1000  
45 degrees at 40. 43 degrees at 200-43-degrees

ELEVATION                      DIP at 400-43degrees at 600 43 degrees PROPOSED DEPTH 1000  
at 300-43degrees at 1000-43degrees

DEPTH FEET	FORMATION	SAMPLE NO.	FROM	TO	WIDTH	ASSAY VALUES		
0-40	casing							
40-162	gray fine grained altered structure some metallics							
162-196	dark grey very fine grained structure massive some metallics							
196-1000	alternating sections of grey and dark grey structure much broken ground and some sections with a great deal of biotite alteration, very little metallic minerals throughout this section.							

NORTHERN BLANK FORM 500 REV. 54  
 Bradley Bros D.D.Co.

SIGNED F. M. Smith

# DIAMOND DRILL RECORD

SONIGO MINES LIMITED

HOLE No. 11 Block C.

SHEET NUMBER 1

SECTION FROM \_\_\_\_\_ TO \_\_\_\_\_

STARTED July 21st 1965

LATITUDE L.3N.2300 E

DATUM \_\_\_\_\_

COMPLETED Aug 11 1965

DEPARTURE \_\_\_\_\_

BEARING S.60 E.

ULTIMATE DEPTH 1199

ELEVATION \_\_\_\_\_

dip at 25ft. 43 degrees at 300-43degrees at 600-43degrees  
 dip at 900-43 degrees at 1190-42 degrees DEPTH 1200

DEPTH FEET	FORMATION	SAMPLE NO.	FROM	TO	WIDTH	ASSAY VALUES			
0-25									
0-25	casing								
25-444	Alternating sections of fine to medium grained grey & dark grey structure dark grey usually finer grained and dense and slightly magnetic. Increased talc content from 162-320 with occasional qtz. injections								
444-608	Intrusive contact, medium to coarse grained basic intrusion. Has the appearance and constituents of a dark grey granite, possibly diabase.								
608-725	alternating grey & dark grey sections, basic very little metallic mineral.								
725-794	basic intrusive medium to coarse grained Diabase ?								
794-1199	alternating section of grey and dark grey basic material, some badly broken ground, very little metallic minerals.								

BRADLEY BROS D.D. Co

SIGNED J.M. Howell

# DIAMOND DRILL RECORD

PROPERTY CONIGO MINES LIMITED

HOLE No. 12 Block C.

SHEET NUMBER 1

SECTION FROM \_\_\_\_\_ TO \_\_\_\_\_

STARTED July 15th. 1965

LATITUDE L 24 S. 1650 E.

DATUM \_\_\_\_\_

COMPLETED July 20th 1965

DEPARTURE \_\_\_\_\_

BEARING 90 degrees Magnetic

ULTIMATE DEPTH 328.

ELEVATION \_\_\_\_\_

45 degrees at 60ft. 43 degrees  
DIP at 320 ft 43 degrees

PROPOSED DEPTH 325.

DEPTH FEET	FORMATION	SAMPLE NO.	FROM	TO	WIDTH	ASSAY VALUES		
0-60	casing							
60-65	grey fine grained structure							
65-149	Intrusive contact, grey medium to coarse grained structure, chiefly basic material with crystals of quartz & feldspar occasional lath-like features probably diabase.							
149-328	Fine grained alternating sections of grey and dark grey material some sections biotite altered.							

NORTHERN MINER FORM 500 REV. 74  
Bradley Bros. D.D. CO.

SIGNED F. M. Smith

LINE 24 SOUTH

16+50 E

WEST  
BEARING

No.12

**NOTE**  
Collar = 45°  
60' = 45°  
320' = 43°  
Plotted at 43° from ledge

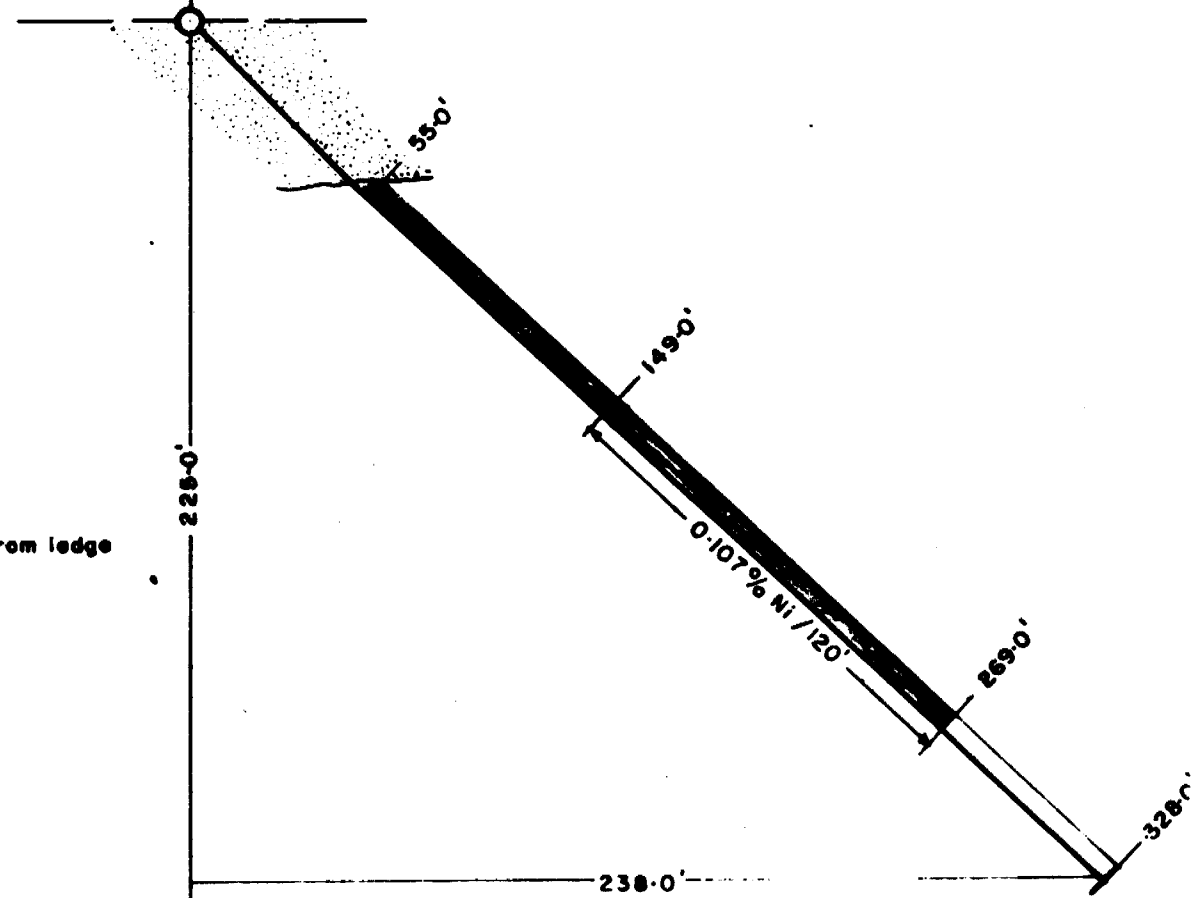

2380.0'

No. 10

698.0

0.21% Ni / 30.0'

149.0'

162.0'

179.0'

193.0'

0.11% Ni / 11.0'

Plot

600.0

Highest value  
Averaged 0.18% Ni / 18.0'

769.0'

787.0'

0.126% Ni / 391.0'

714.0'

1000.0'

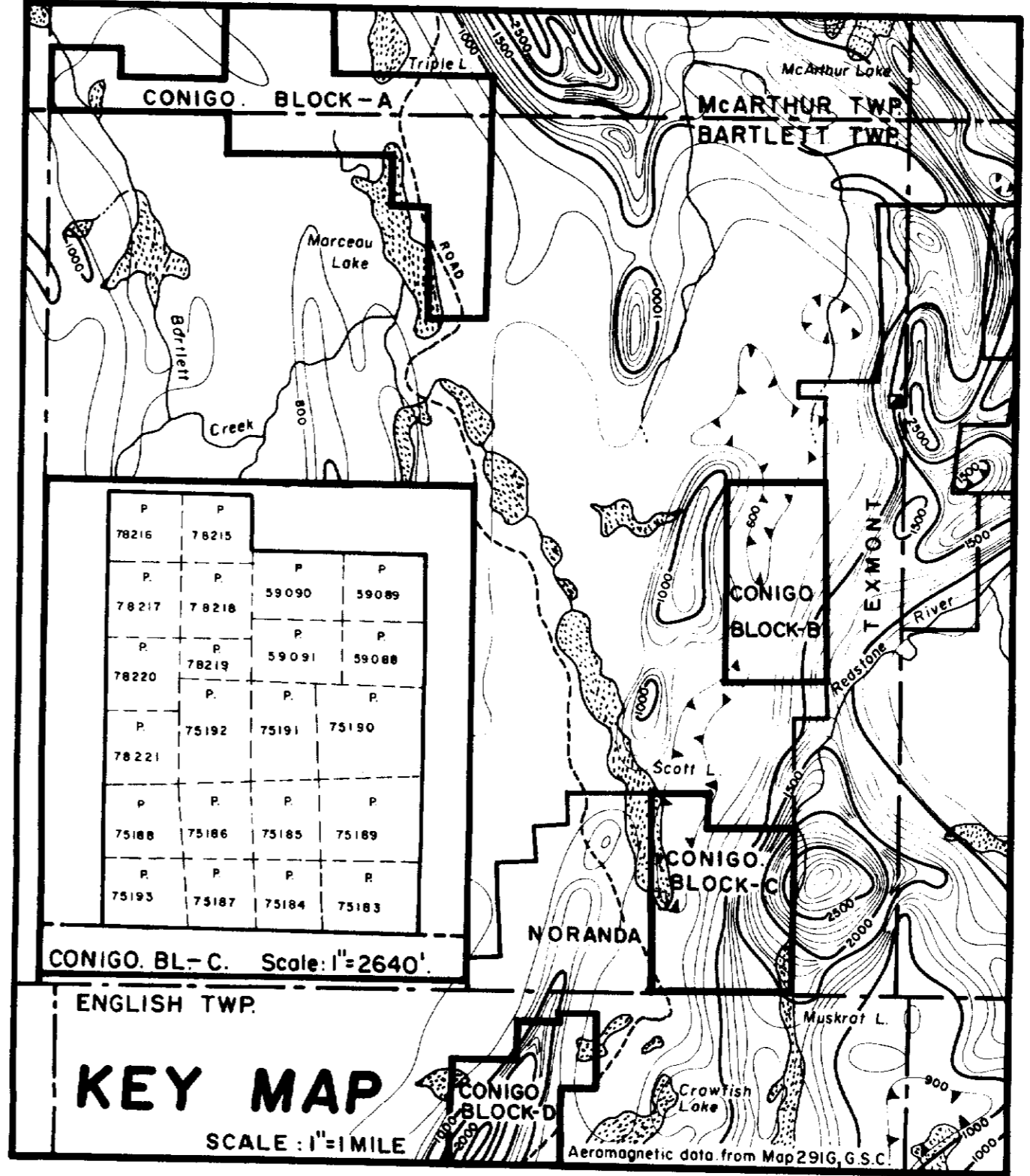

- Claim post and claim boundary.
- Higher ground.
- Swamp.
- Cliff.
- Outcrop.
- Magnetic control station.
- Picket line cut and chained.
- Magnetic readings obtained and plotted at the north side of picket line.
- Magnetic contour.
- Below 0 gamma.
- 0 - 500 gammas.
- 500 - 1000 "
- 1000 - 1500 "
- 1500 - 2000 "
- 2000 - 4000 "
- 4000 - 6000 "
- 6000 - 10,000 "

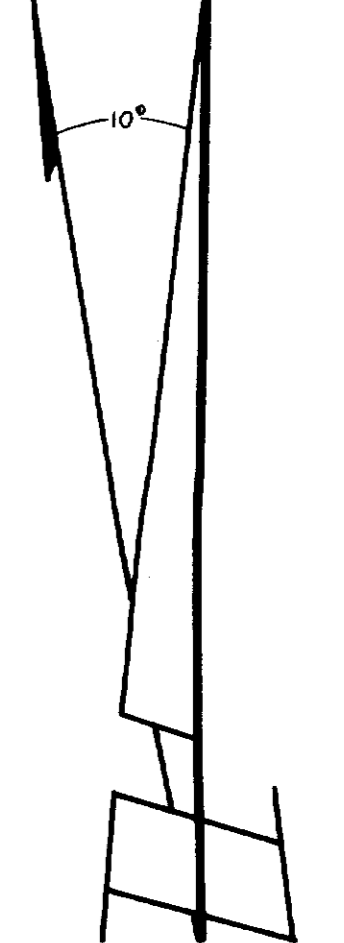

LINE 3 NORTH

20+00E

23+00E

25+40E

26+00E

WEST

BEARING

No. 3

No. 2

No. 7

No. 1

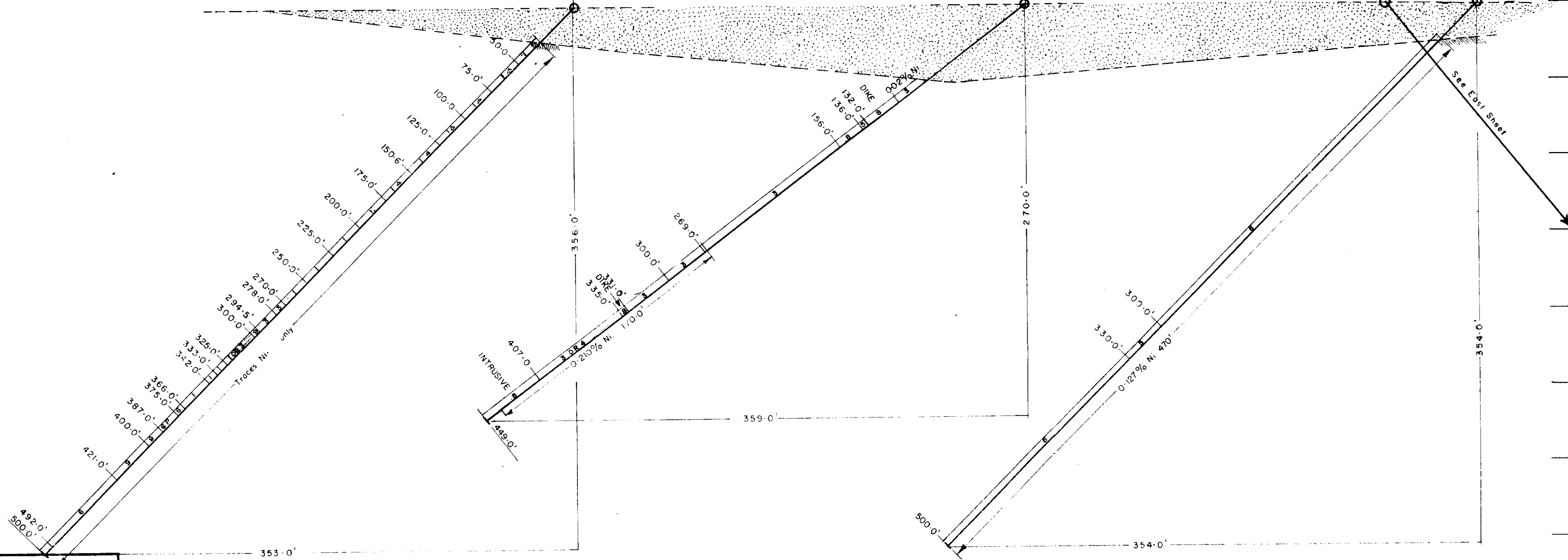

LEGEND

1	1	Rhyolite
1	Δ	Rhyolite, Brecciated Volcanic
3	3	Andesites (Greenstones)
9	4	Basalts
5	5	Basic Intrusive
6	6	Soapstone or Talc
8	P	Peridotite
8	8	Granitic Intrusive
9	9	Diabase or Diabasic Gabbro



CONIGO MINES LIMITED  
BARTLETT TOWNSHIP, ONTARIO  
GROUP "C"

D.D.H. 1, 2 AND 3.  
After F.M. Smith

SECTION 3 NORTH

DRAWN BY F.V.W.  
(2x2) 4.5/11





LINE 15 NORTH

30+00E

N 4

312' 0"

392' 0"

502' 0"

483' 0"

442' 0"

297' 0"

165' 0"

22' 5"

WEST BEARING

NOTE

- Collar = 45°
- 22' = 43°
- 200' = 39°
- 400' = 38°
- 500' = 38°

Plotted at 38°30' from ledge

LEGEND

2	2	Dacite
3	3	Andesites (Greenstones)
4	4	Basalts
5	5	Basic Intrusive



CONIGO MINES LIMITED  
 BARTLETT TOWNSHIP, ONTARIO  
 GROUP "C"

D.D.H: 4  
 After F.M. Smith

SECTION 15 NORTH

DRAWN BY R.M.W. APPROVED BY SCALE 1"=50'



LINE 3 NORTH

25+40E

29+50E

WEST BEARING

No. 7

No. 8

NOTE

Collar : 55°  
 45' : 52°  
 200' : 48°  
 400' : 53°  
 500' : 47°  
 630' : 47°  
 Plotted at 48°30' from collar

NOTE

Collar : 45°  
 Ledge : 39°  
 200' : 38°  
 400' : 38°  
 545' : 37°  
 Plotted at 38° from ledge

LEGEND

	2	Dagite
	3	Andesites (Greenstones)
	4	Basalts
	5	Basic Intrusive
	6	Sagestone or Talc

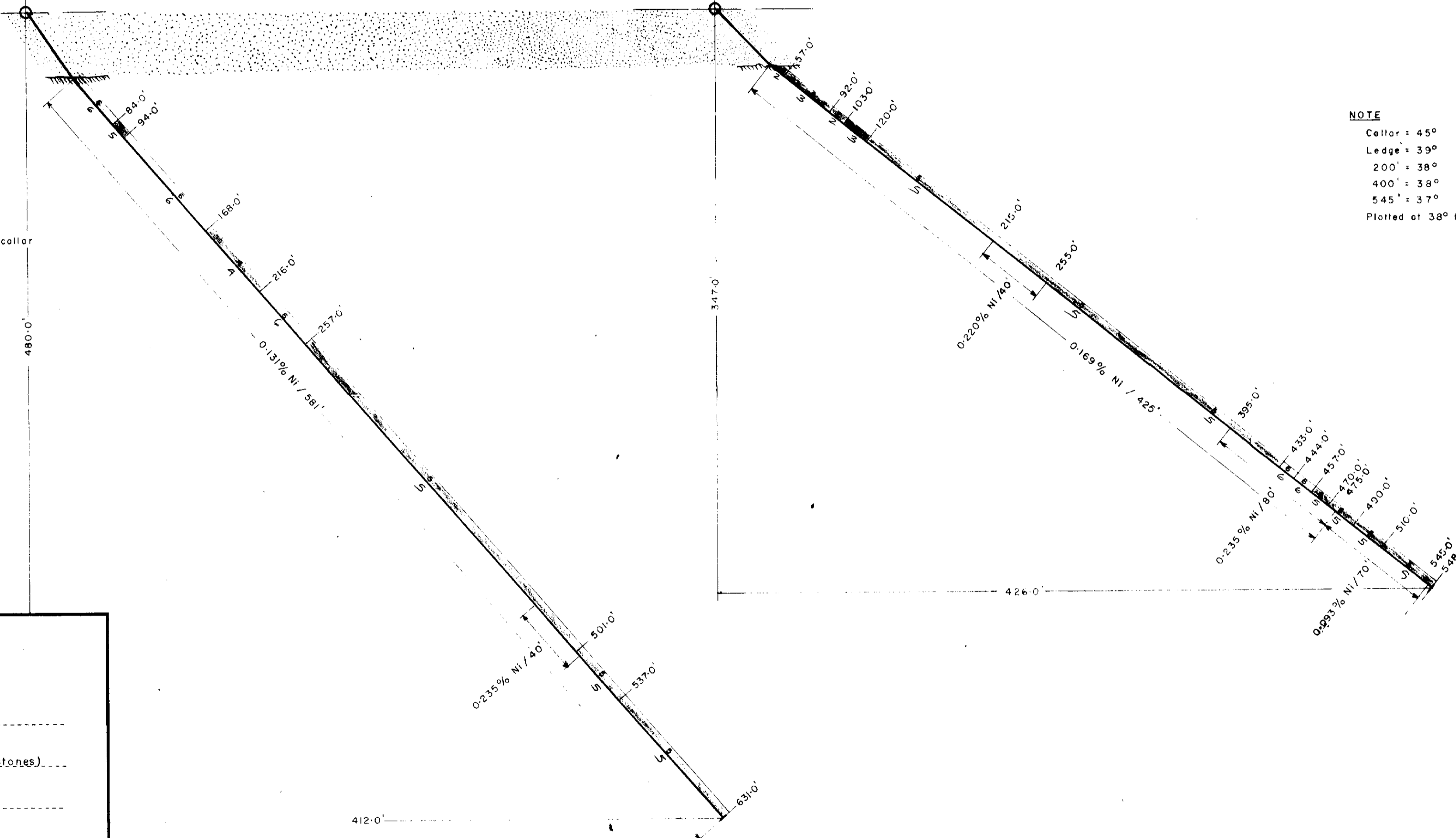

CONIGO MINES LIMITED  
 BARTLETT TOWNSHIP, ONTARIO  
 GROUP "C"

D.D.H: 7 AND 8  
 After F.M. Smith

SECTION 3 NORTH

DRAWN BY R. M. W. APPROVED BY \_\_\_\_\_ SCALE 1"=50'



42AR35E013 17 BARTLETT

LINE 3 NORTH

23+00E

BEARING S60°E

No. 11

NOTE

- Collar - 45°
- Ledge - 43°
- 300' - 43°
- 600' - 43°
- 900' - 43°
- 1190' - 42°
- Plotted at 43° From Ledge

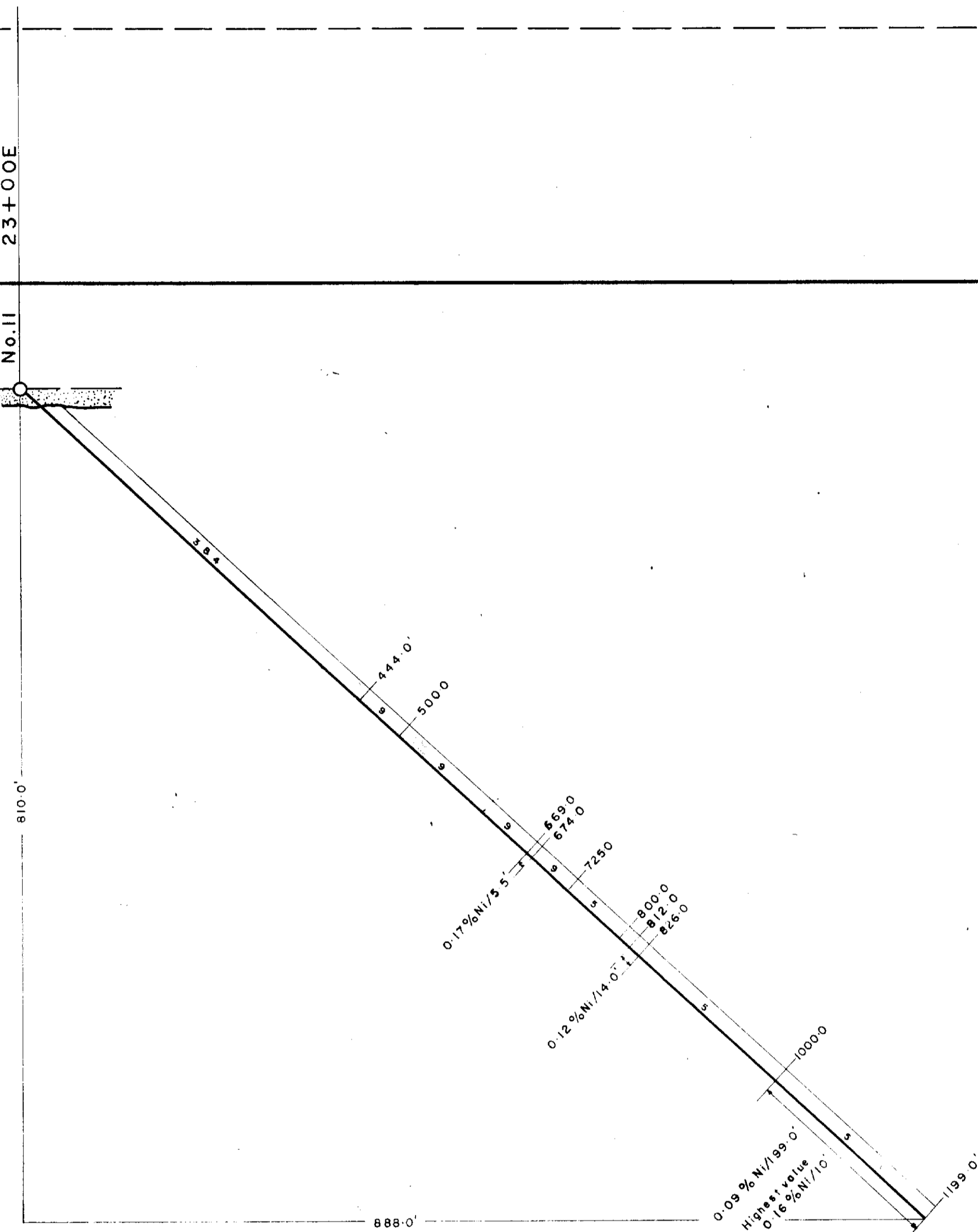

LEGEND

3	3	Andesites (Gneiss) etc.
4	4	Basalts
5	5	Basic Intrusive
9		Diabase or Diabasic Gabbro

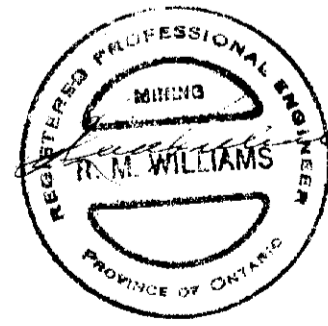

CONIGO MINES LIMITED  
 BARTLETT TOWNSHIP, ONTARIO  
 GROUP "C"

D.D.H.: 11  
 After F.M. Smith

SECTION 3 NORTH

DRAWN BY R.M.W. APPROVED BY SCALE 1" = 100'



LEGEND

- Claim post and claim boundary.
- Higher ground.
- Swamp.
- Cliff.
- Outcrop.
- Magnetic control station.
- Picket line cut and chained.
- Magnetic readings obtained and plotted at the north side of picket line.
- Magnetic contour.
- Below 0 gamma.
- 0 - 500 gammas.
- 500 - 1000 "
- 1000 - 1500 "
- 1500 - 2000 "
- 2000 - 4000 "
- 4000 - 6000 "
- 6000 - 10,000 "

- Electromagnetic readings obtained at the receiver station by using a RONKA MARK-IV unit and a RONKA MARK-III unit with 300 ft. cables.
- In-phase readings plotted to the South.
- Out-of-phase readings plotted to the North of picket line.
- Scale of profile: 1/10" = 1% of phase change.
- Direction of traverse.
- Electromagnetic conductor.
- Proposed diamond drill hole.
- Ni in ppm.

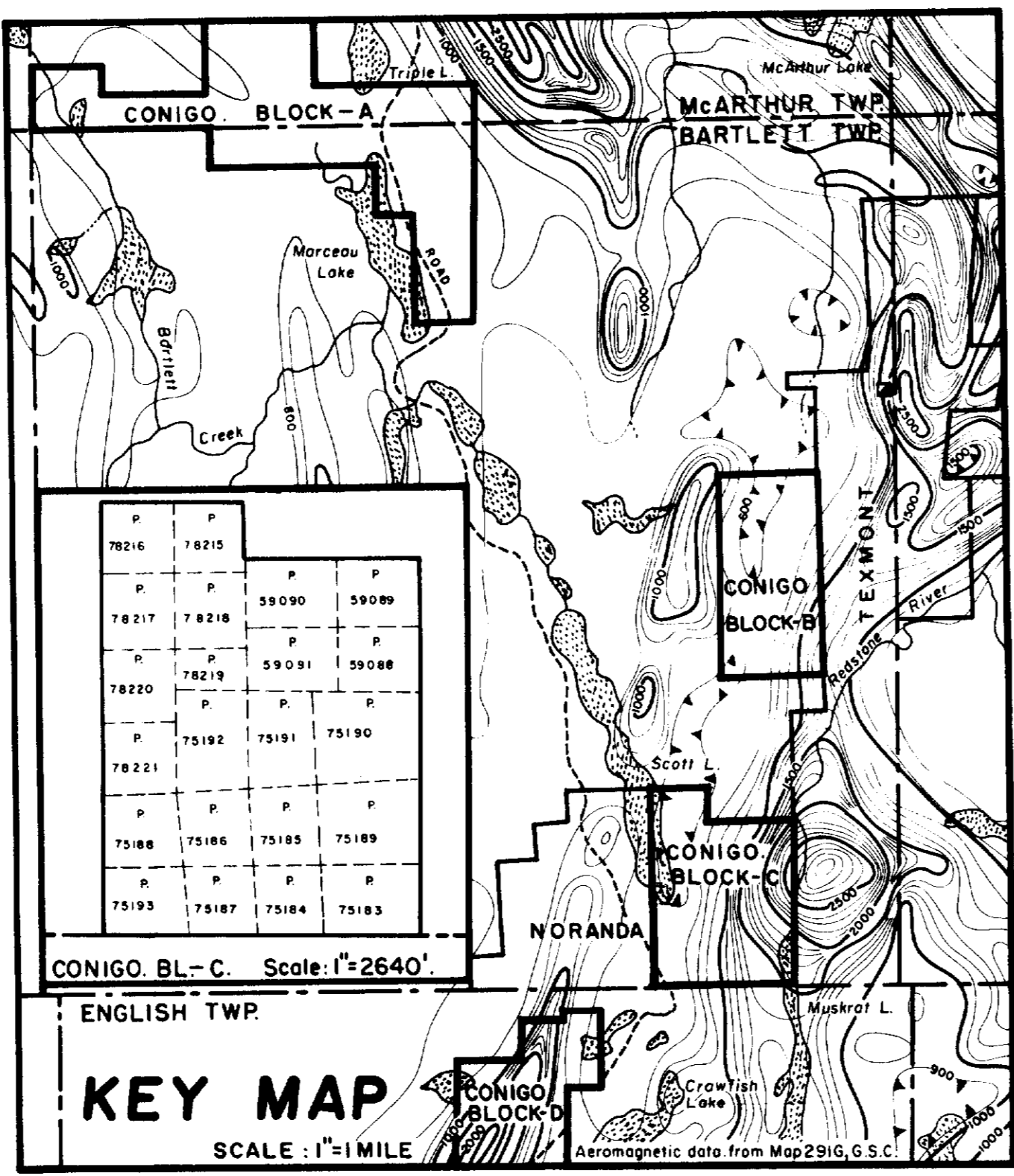

GEOPHYSICAL SURVEY DATA ON 22-CLAIM PROPERTY  
**CONIGO MINES LIMITED.**

BLOCK - C.  
BARTLETT TOWNSHIP,  
PORCUPINE MINING DIVISION  
ONTARIO

SCALE: 1" = 200' MAY 1965

CANA EXPLORATION CONSULTANTS LIMITED

UPDATED, AUGUST 1965  
To show location of DD holes  
by Murray Williams,  
Professional Engineer

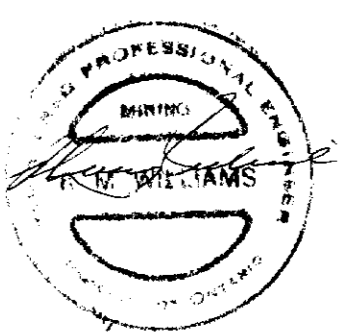

L-36 S

BARTLETT TWP  
ENGLISH TWP

MUSKRAT LAKE

REDSTONE RIVER