



42A03SE0014 11 BARTLETT

010

Diamond Drilling

Township of BARTLETT

Report NO 11

Work performed by: Queenston Gold Mines Limited

Claim NO	Hole NO	Footage	Date	Note
P 42727	1	376.0'	Sept/57	
	5	614.0'	Nov/57	
		<u>990'</u>		

Notes:

*Bottle
Inventories*

				42673
			42672	42674
			42670	42677
			42679	42700
	42702	42703	42704	
	42705	42706	42707	
	42708	42709	42710	
	42711	42712	42713	2M
42714	42715	42716	42717	
42718	42719	42720	42721	
42722	42723	42724	42725	
41771	42726	X 42727	42728	42729
41770	42730	42731	42732	42733
41769	42734	42735	42736	42737
41768	42738	42739	42740	42741

1M

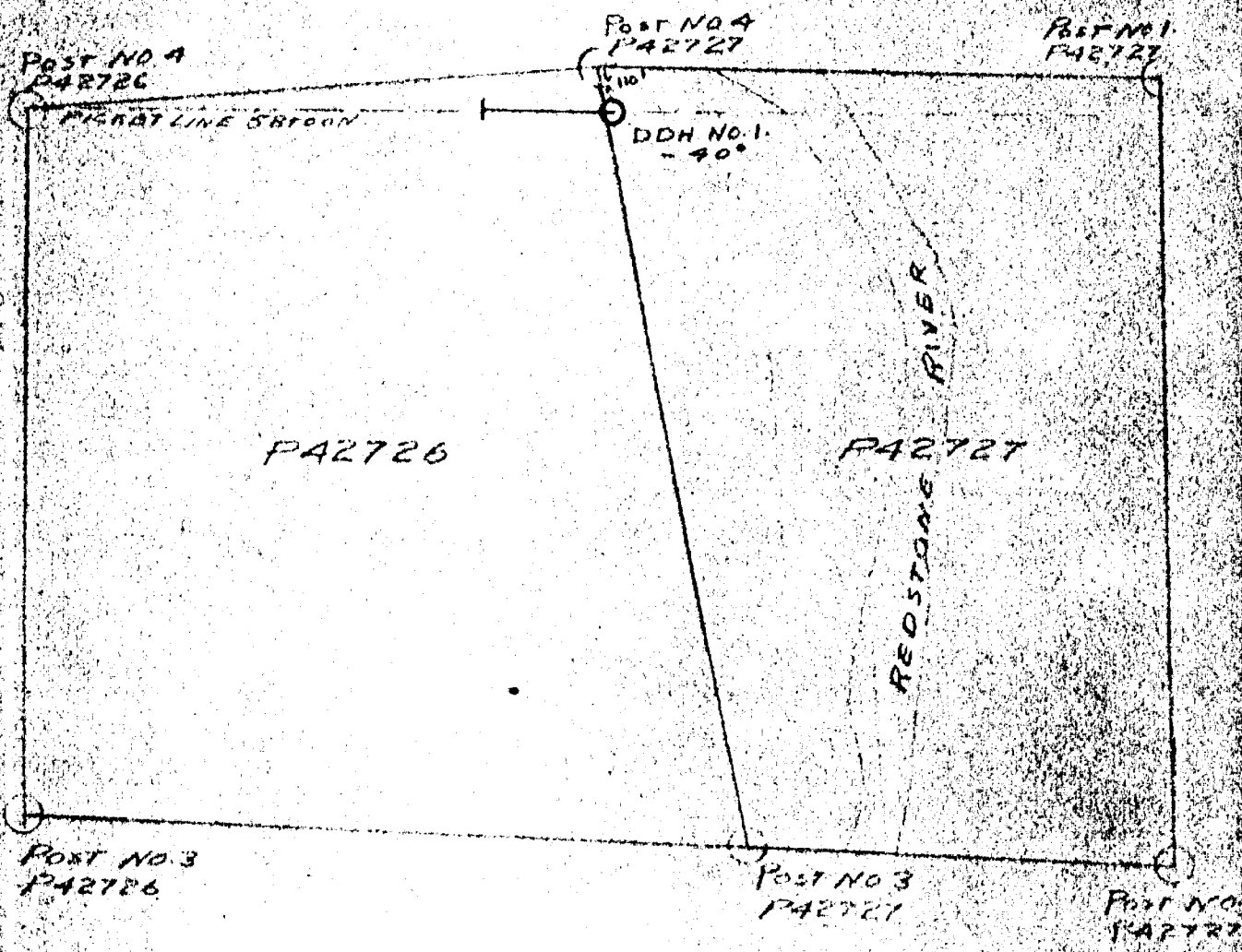

QUEENSTON GOLD MINES LTD
 BARTLETT TWP
 LOCATION OF DRILL HOLE NO
 1 - 400' MAR 3 1950



QUINCY GOLD MINING CO.
PARTIAL PLAN
LOCATION OF DRILL TESTS
1940

Can not be located on maps.

file
P.42727

JULIENSTON GOLD MINES LTD
911 Federal Building
85 Richmond Street West
Toronto, Ontario

DIAMOND DRILL HOLE LOG

Porcupine Mining Division
Township of Bartlett

Hole No :	5	Location :	54.00N, 19.00E
Direction:	Due East	Dip :	-50°
Depth :	614.0'	logged By :	H. W. Marsh
Date :	Nov. 25, 1957	Checked By:	D. W. Tully
Core Size:	EXT (7/8")	Drilled By:	Heath & Sherwood Drilling Limited, Kirkland Lake, Ontario.

-0-0-0-0-0-0-

FOOTAGE

DESCRIPTION

0-61.0'	Casing
243.0	Basalt - dark grey to black, fine grained with disseminated magnetite and magnetite - rich seams.
367.5	Basalt - dark grey to black, disseminated magnetite. Magnetite content decreases towards base of section.
369.7	Basalt - blocky, with pyrrhotite and chalcopryrite along fracture planes.
374.7	Quartz - gabbro, has sparse disseminated pyrrhotite and chalcopryrite.
378.7	Basalt.
381.4	Gabbro - dark grey, coarse-grained with prominent quartz and feldspar crystals.
434.5	Chlorite schist - slightly carbonatized and serpentinized. 418.5-430.0 Fault zone - highly schistose and blocky.
525.0	Basalt - dark black with abundant fine disseminated magnetite. Blocky with serpentinized fractures. Some fracture planes have thin coating of sulfides.
614.0	Basalt - as above but more massive and carries no sulfides.

614.0' End of Hole