



42A03SE0213 2.7098 ENGLISH

010

ASSESSMENT REPORT  
CHEURON CANADA RESOURCES LTD.  
ENGLISH PROJECT  
GROUND MAGNETOMETER SURVEY  
1984

ASSESSMENT REPORT  
CHEVRON CANADA RESOURCES LIMITED  
ENGLISH PROJECT  
- GROUND MAGNETOMETER SURVEY -

1. The Property:

The claims actually covered by the survey and on which the work was performed are:

P725661 to 725664  
P725666 to 725669  
P725683  
P725760 to 725761  
P725770 to 725775  
P725779 to 725780  
P725793 to 725796  
P725799 to 725803  
P725805 to 725809  
P725815, 759184 to  
759189 inclusive.

2. Location and access:

The property is located 50 km. south of Timmins, in southeastern English and Northeastern Semple Townships. Access is via gravel road from Pine St. S. in Timmins or from Matachewan.

3. Ownership:

The 43 staked mineral claims are registered to Chevron Minerals Ltd. The survey which was performed by Exsics Exploration Ltd. of Timmins was commissioned and supervised by Chevron Canada Resources Limited.

4. Dates of Survey:

The mag survey was carried out between June 7 and June 28, 1984.

5. Geology:

Ontario Geological Survey Report 171 by Dr. D. R. Pyke shows the surveyed area to be underlain primarily by mafic to felsic metavolcanics, ultramafic metavolcanics, iron-formation and diabase dykes.

6. Previous Work by Chevron:

No previous work has been done on these claims by Chevron.

7. Instrumentation and Method:

The magnetometer which was used in this survey is a Scintrex MP-2 Proton Precession Magnetometer. It has a total field accuracy of  $\pm 1$  gamma.

Mag readings were taken on all cut lines at 25 m. intervals. When anomalous readings were noted the interval between stations was reduced to 12.5 m. Diurnal corrections were made by looping back to one of four base stations.

*L. A. Tihor*

L. A. Tihor, (HBS c)

Geologist

Field Office Manager.

GEOPHYSICAL TECHNICAL DATE

GROUND SURVEY

Number of Stations: 386                  Number of Readings: 429  
Stations Interval: No greater than 25m.  
Line Spacing: 100m.  
Profile scale or Contour Intervals: 50, 100, 250, 500, 1000  
gammas

MAGNETIC

Instrument: Scintrex MP-2  
Accuracy - Scale constant:  $\pm$  1 gamma  
Diurnal correction method: looping back to base stations.  
Base stations location: Base Line stations 12+00 N, 2+00 S,  
40+50 N, 30+00 N

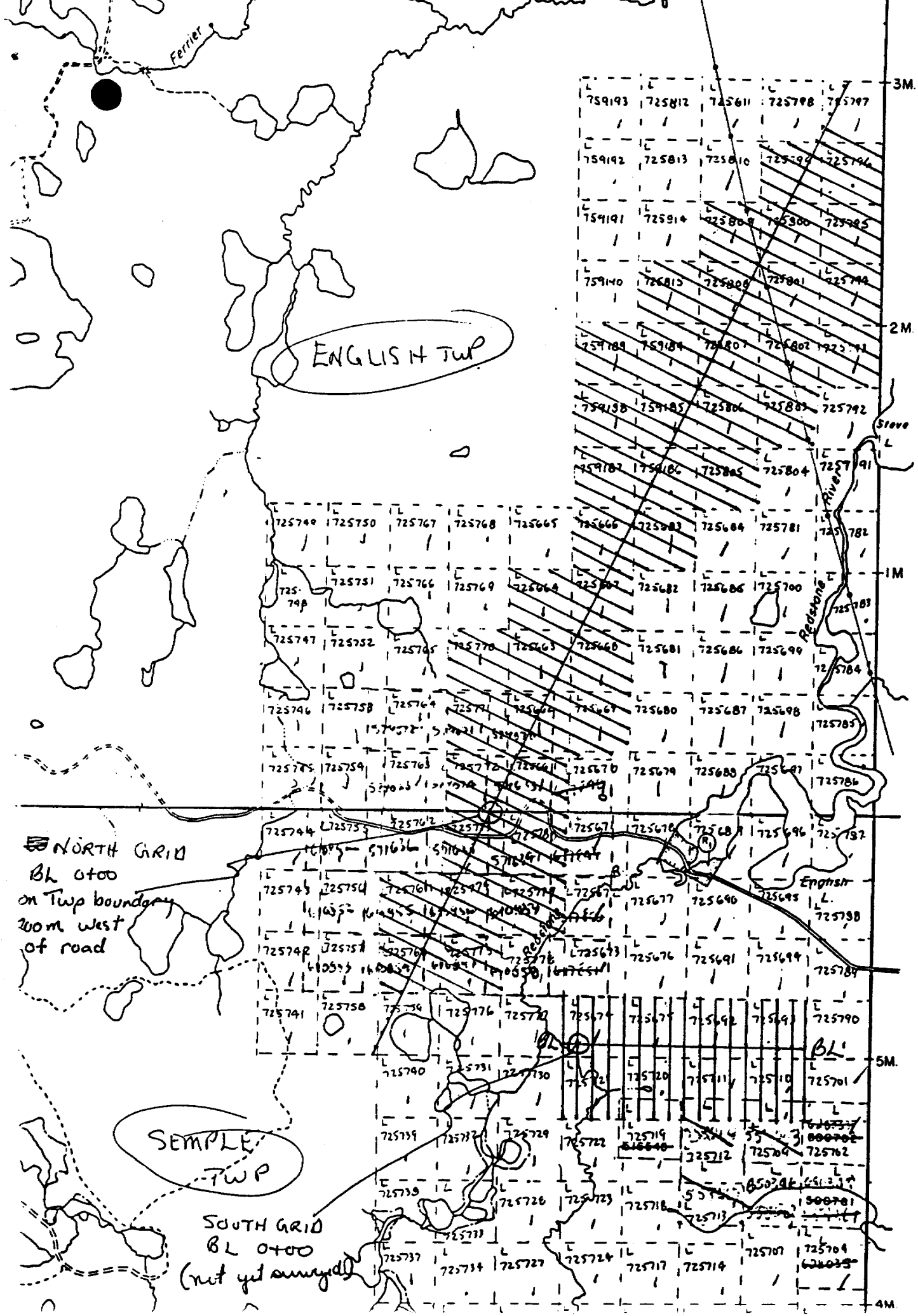

SOUTH GRID  
BL 0100  
(not yet surveyed)

NORTH GRID  
BL 0100  
on Twp boundary  
200m west  
of road

ENGLISH TWP

SEMPLE TWP

BL

English L.

Stove

Ferrier

3M

2M

1M

5M

4M

CERTIFICATE OF QUALIFICATIONS

I, Leslie A. Tihor of Timmins, Ontario, hereby certify that:

- 1) I hold a Bachelor of Science (Honours) degree in Geology from Lakehead University, Thunder Bay, Ontario.
- 2) Following graduation in 1973 I spent four years in study towards a PHD in Geology at McMaster University, Hamilton, Ontario.
- 3) Beginning in 1967 as a Prospector, and excluding the time spent in academic studies, I have practised my profession in mineral exploration continuously, in the Provinces of Ontario, Quebec, British Columbia and the Yukon and N. W. Territories.

Timmins, Ontario  
August, 1984

  
Leslie A. Tihor



#252

Mini

Type of Survey(s) <b>Ground Magnetometer</b>	Township or Area <b>Semple Township &amp; English Township</b>
Claim Holder(s) <b>Chevron Minerals Ltd</b>	Prospector's Licence No. <b>T-1690</b>
Address <b>167B Wilson Ave, Timmins, Ontario. P4N 2T2</b>	
Survey Company <b>Exsics Exploration Ltd</b>	Date of Survey (from & to) <b>6</b> 07 07 84   28 07 84 Day   Mo.   Yr.   Day   Mo.   Yr.
Name and Address of Author (of Geo-Technical report) <b>John Grant, 4 Conc. Lot 10, Montjoy Township, Ontario.</b>	
Total Miles of line Cut <b>53</b>	

Credits Requested per Each Claim in Columns at right

Mining Claims Traversed (List in numerical sequence)

Special Provisions	Geophysical	Days per Claim
For first survey: Enter 40 days. (This includes line cutting)	Electromagnetic	40
	Magnetometer	
For each additional survey: using the same grid: Enter 20 days (for each)	Radiometric	
	Other	
	Geological	
	Geochemical	

Man Days	Geophysical	Days per Claim
Complete reverse side and enter total(s) here	Electromagnetic	
	Magnetometer	
	Radiometric	
	Other	
	Geological	
	Geochemical	

Airborne Credits	Geophysical	Days per Claim
Note: Special provisions credits do not apply to Airborne Surveys.	Electromagnetic	1
	Magnetometer	
	Other	

Mining Claims			Mining Claims		
Prefix	Number	Expend. Days Cr.	Prefix	Number	Expend. Days Cr.
L	725661	40	L	725801	40
	725662	40		725802	40
	725663	40		725803	40
	725664	40		725805	40
	725666	40		725806	40
	725667	40		725807	40
	725668	40		725808	40
	725669	40		725809	40
	725683	40		725815	40
	725760	40		759184	40
	725761	40		759185	40
	725770	40		759186	40
	725771	40		759187	40
	725772	40		759188	40
	725773	40		759189	40
	725774	40		725799	40
	725775	40		725800	40
	725779	40			
	725780	40			
	725793	40			
	725794	40			
	725795	40			
	725796	40			

Expenditures (excludes power stripping)

Type of Work Performed **JUL 24 1984**

Performed on Claim(s) **MINING LANDS SECTION**

Calculation of Expenditure Days Credits

Total Expenditures **\$** ÷ **15** =  Total Days Credits

Instructions  
Total Days Credits may be apportioned at the claim holder's choice. Enter number of days credits per claim selected in columns at right.

Total number of mining claims covered by this report of work. **40**

Date **June 29, 1984** Recorder Holder or Agent (Signature) *[Signature]*

For Office Use Only

Total Days Cr. Recorded **1600** Date Recorded **JUL 10 1984** Mining Recorder *[Signature]*

Date Approved as Recorded **Sept 25/84** Branch Director *[Signature]*

Certification Verifying Report of Work

I hereby certify that I have a personal and intimate knowledge of the facts set forth in the Report of Work annexed hereto, having performed the work or witnessed same during and/or after its completion and the annexed report is true.

Name and Postal Address of Person Certifying  
**L.A. Tihor, 81 Graham Lane  
Timmins, Ontario P4N 7Z5**

Date Certified **June 29/1984** Certified by (Signature) *[Signature]*

Mining Lands Section

File No 2.7098

Control Sheet

TYPE OF SURVEY

- GEOPHYSICAL
- GEOLOGICAL
- GEOCHEMICAL
- EXPENDITURE

MINING LANDS COMMENTS:

---

---

---

---

---

---

---

---

---

---

*lyd*

*L.D.*

*Dennis King*

Signature of Assessor

*Sept 24/84*

Date



September 11, 1984

Our File: 2.7098

Chevron Minerals Ltd  
167B Wilson Avenue  
Timmins, Ontario  
P4N 2T2

Dear Sirs:

RE: Geophysical (Magnetometer) Survey  
submitted on Mining Claims L 725661  
et al in the Townships of Semple and  
English

---

Enclosed are the plans (in duplicate) for the above-mentioned survey. Please show all claim lines and numbers on the plans and return them to this office quoting file 2.7098.

For further information, please contact Susan Hurst at (416)965-4888.

Yours sincerely,

S.E. Yundt  
Director  
Land Management Branch

Whitney Block, Room 6643  
Queen's Park  
Toronto, Ontario  
M7A 1W3  
Phone: (416)965-4888

S. Hurst:mc

cc: Mining Recorder  
Kirkland Lake, Ontario

Encl.

1984 08 31

Your File: 252  
Our File: 2.7098

Mr. George J. Koleszar  
Mining Recorder  
Ministry of Natural Resources  
4 Government Road East  
P.O. Box 984  
Kirkland Lake, Ontario  
P2N 1A2

Dear Sir:

We have received reports and maps for a Geophysical  
(Magnetometer) Survey submitted under Special Provisions  
(credit for Performance and Coverage) on Mining Claims  
L 725661 et al in the Townships of Semple and English.

This material will be examined and assessed and  
a statement of assessment work credits will be  
issued.

Yours sincerely,

S.E. Yundt  
Director  
Land Management Branch

Whitney Block, Room 6643  
Queen's Park  
Toronto, Ontario  
M7A 1W3  
Phone: (416)965-6918

A. Barr:sc

cc: Chevron Minerals Limited  
1678 Wilson Avenue  
Timmins, Ontario  
P4N 2T2  
Attn: Leslie A. Tihor.



**Chevron Canada Resources Limited**

Minerals Staff

167B Wilson Ave., Timmins, Ontario P4N 2T2 Phone (705) 264-2291

August 23, 1984.

Land Management Branch,  
Ministry of Natural Resources,  
Room 6643, Whitney Block,  
Queen's Park,  
Toronto, Ontario.  
M7A 1W3

ATTENTION: Mr. Fred Matthews

Dear Mr. Matthews:

I enclose duplicate copies of geophysical reports for two properties. One covers P.E.M. and Mag surveys on claims P 750389 et al in Foleyet Township. The other is a Mag survey of claims L 725661 et al in English and Semple Townships.

Please advise me if you need additional information.

Yours truly,

A handwritten signature in cursive script that reads "L. A. Tihor".

Leslie A. Tihor

LAT/cs

Enclosure

*Qual. His  
file*

725561	✓	725801	✓
62	✓	2	✓
63	✓	3	✓
64	✓	725805	<del>34</del>
725666	✓	6	✓
67	✓	7	✓
68	✓	8	✓
69	✓	9	✓
725683	✓	725815	✓
725760	✓	759184	✓
61	✓	85	✓
725710	✓	86	<del>44</del>
71	✓	87	✓
72	✓	88	✓
73	✓	89	✓
74	✓	725799	✓
75	✓	800	✓
725779	✓		
80	✓		
725793	✓		
94	✓		
95	✓		
96	✓		

785 M

ENGLISH TWP

785 M

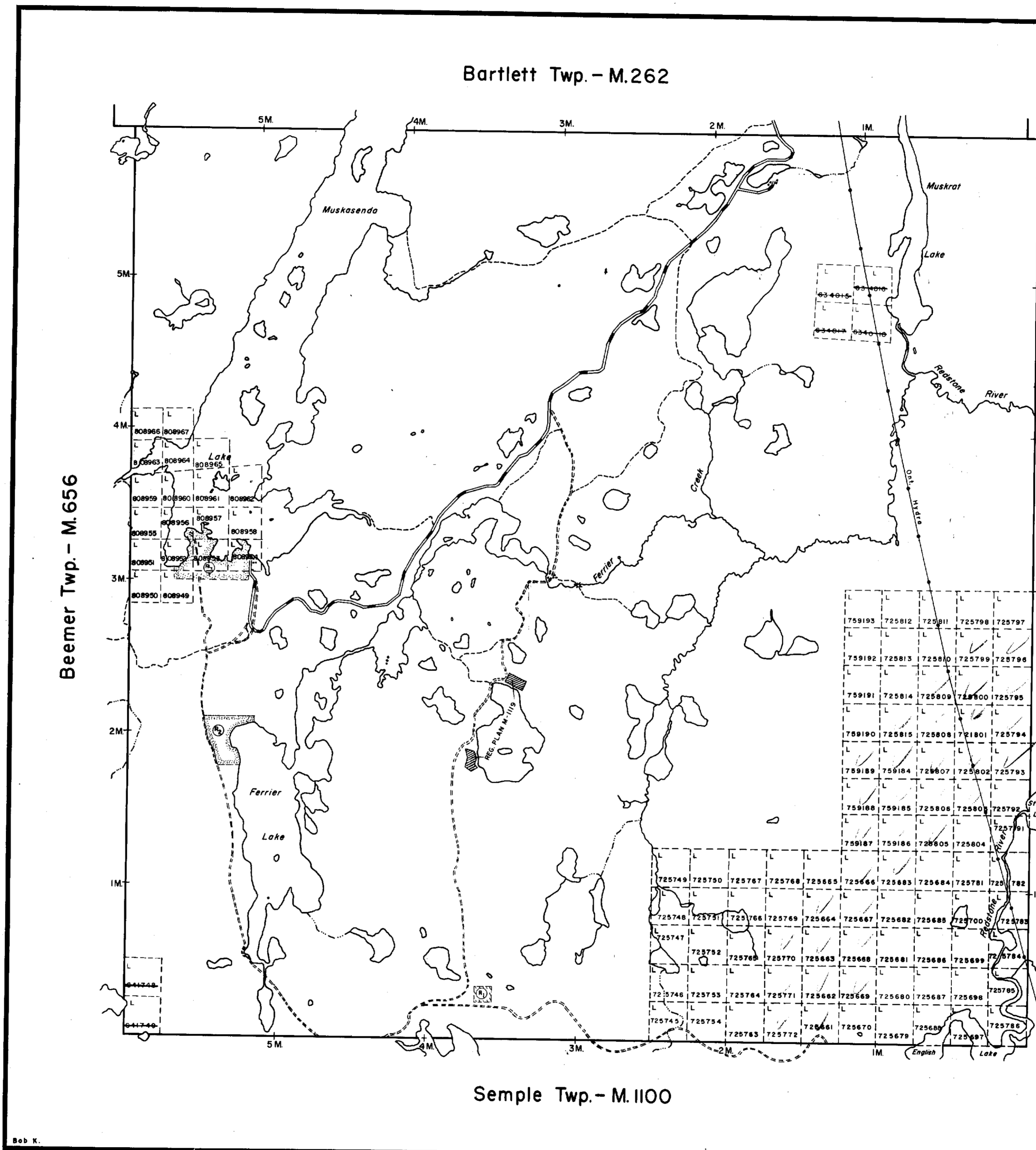

THE TOWNSHIP OF ENGLISH

DISTRICT OF SUDBURY

LARDER LAKE MINING DIVISION

SCALE: 1-INCH=40 CHAINS

LEGEND

- PATENTED LAND (P)
- CROWN LAND SALE (C.S.)
- LEASES (L)
- LOCATED LAND (Loc.)
- LICENSE OF OCCUPATION (L.O.)
- MINING RIGHTS ONLY (M.R.O.)
- SURFACE RIGHTS ONLY (S.R.O.)
- ROADS
- IMPROVED ROADS
- KING'S HIGHWAYS
- RAILWAYS
- POWER LINES
- MARSH OR MUSKEG
- MINES
- CANCELLED
- PATENTED S.R.O.

NOTES

400' surface rights reservation along the shores of all lakes and rivers.

As withdrawn from staking under Section of the Mining Act (R.S.O. 1970).

No.	File	Date	Disposition
W. 16/77	83582	28/2/77	S.R.O.
W. 19/78	108543	10/4/78	S.R.O.
W. 30/78	192219	2/6/78	S.R.O.

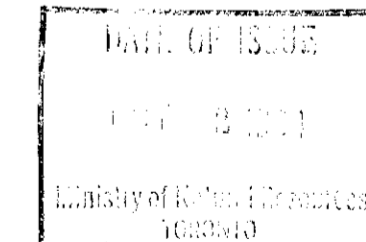

PLAN NO.- M.787

ONTARIO MINISTRY OF NATURAL RESOURCES SURVEYS AND MAPPING BRANCH



42A835E8213 2.7000 ENGLISH

ENGLISH TWP. M-787

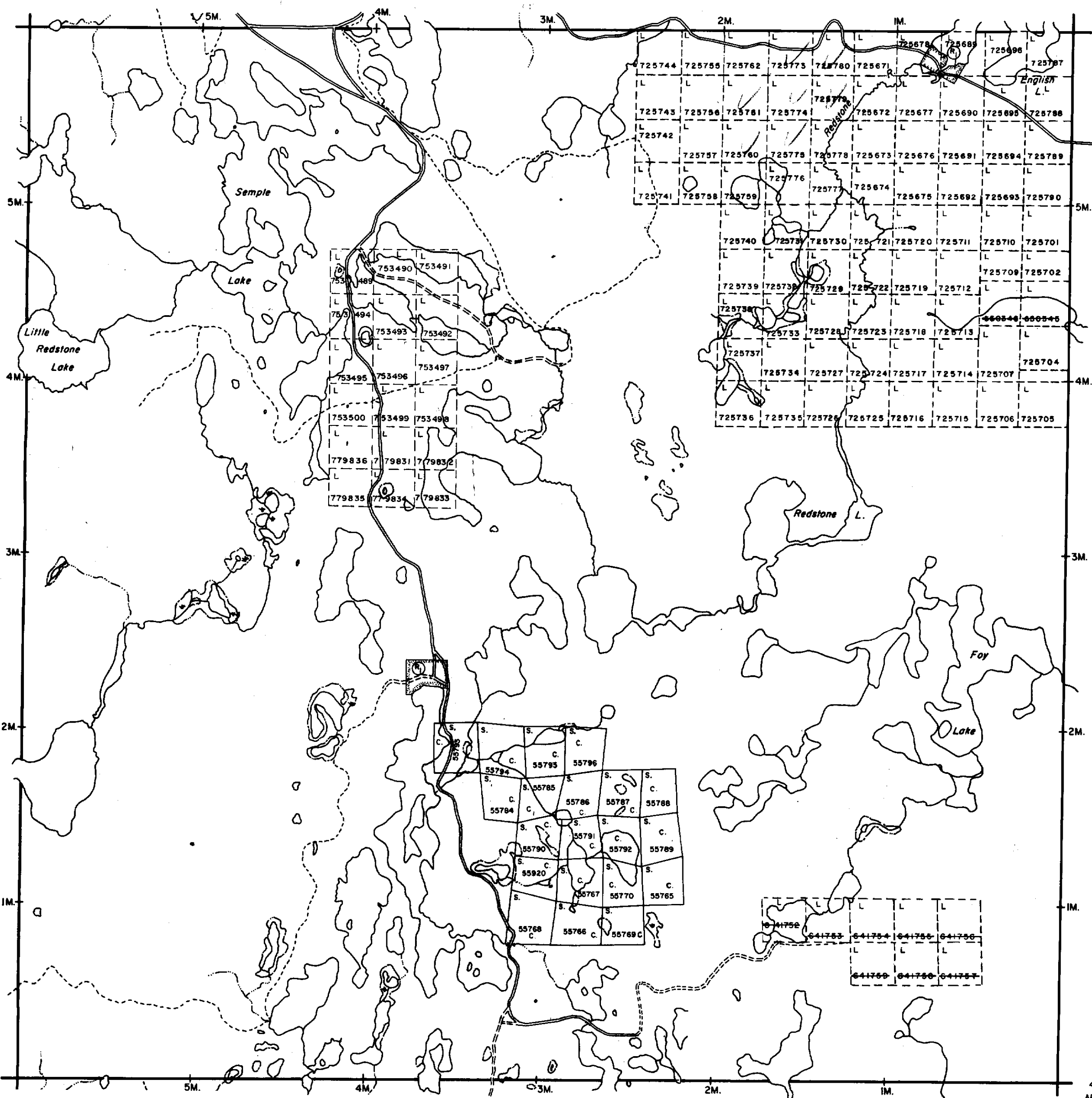

NOTES

400' surface rights reservation along the shores of all lakes and rivers.

Areas withdrawn from staking under Section 44 of the Mining Act, (R.S.O. 1970)

File	Date	Disposition
W.19/78	188543	10/4/78 S.R.O.

DATE OF ISSUE  
 OCT 2 1981  
 Ministry of Natural Resources  
 TORONTO

LEGEND

- PATENTED LAND P or \*
- PATENTED FOR SURFACE RIGHTS ONLY \*
- LEASE L
- LICENSE OF OCCUPATION L.O.
- CROWN LAND SALES C.S.
- LOCATED LAND Loc.
- CANCELLED C.
- MINING RIGHTS ONLY M.R.O.
- SURFACE RIGHTS ONLY S.R.O.
- HIGHWAY & ROUTE NO.
- ROADS
- TRAILS
- RAILWAYS
- POWER LINES
- MARSH OR MUSKEG
- MINES

\*used only with summer resort locations or when space is limited

TOWNSHIP OF

**SEMPLÉ**

DISTRICT OF  
 SUDBURY

LARDER LAKE  
 MINING DIVISION

SCALE : 1 INCH = 40 CHAINS (1/2 MILE)

DR. R.W. NOBLE  
 DATE APR. 22, 71  
 PLAN NO. **M-1100**

ONTARIO  
 MINISTRY OF NATURAL RESOURCES  
 SURVEYS AND MAPPING BRANCH



47° 55' 45"  
 APPROX.  
 81° 12' 15"



SHEET 1

L2400N  
L2300N  
L2200N  
L2100N  
L2000N  
L1900N  
L1800N  
L1700N  
L1600N  
L1500N  
L1400N  
L1300N  
L1200N  
L1100N  
L1000N  
L900N  
L800N  
L700N  
L600N  
L500N  
L400N  
L300N  
L200N  
L100N  
L0+00  
L100S  
L200S  
L300S  
L400S  
L500S  
L600S  
L700S  
L800S  
L900S  
L1000S  
L1100S  
L1200S  
L1300S

900E  
800E  
700E  
600E  
500E  
400E  
300E  
200E  
100E  
B.L. 0 (02359)  
100  
200  
300  
400  
500  
600  
700  
800  
900W



220







L2400N  
L2300N  
L2200N  
L2100N  
L2000N  
L1900N  
L1800N  
L1700N  
L1600N  
L1500N  
L1400N  
L1300N  
L1200N  
L1100N  
L1000N  
L900N  
L800N  
L700N  
L600N  
L500N  
L400N  
L300N  
L200N  
L100N  
L0+00  
L100S  
L200S  
L300S  
L400S  
L500S  
L600S  
L700S  
L800S  
L900S  
L1000S  
L1100S  
L1200S  
L1300S

**LEGEND**

Total Magnetic Field, in gammas 59100

Magnetic Depression:

Base Station Location:

Contour Intervals: 50, 100, 250, 500, 1000

Instrument: Srintrex MP-4

Operator: Exsics Exploration Ltd.

**KEY**

Claim Post *2.7098*

---

© 1984 Exsics Exploration Ltd.

Unit: English Township

Survey: Magnetometer - 2.7098

Date: June/84	Plotting: P. Noel, Y. Collin
Scale: 1cm=25m	Interpretation: J. Grant

**EXSICS EXPLORATION LTD**  
(705) 267-4151  
*Supervised by Robert Chen*

SHEET 1

700W  
600W  
500W  
400W  
300W  
200W  
100W

BL 0 (025°)  
100E  
200E  
300E  
400E  
500E  
600E  
700E  
800E  
900E  
100E