



42A03SE0263 12 HUTT

010

Diamond Drilling

Township of HUTT

Report No: 12

Work performed by: R.H. CLAYTON (DOWA MINING)

Claim No	Hole No	Footage	Date	Note
L. 328050	1	479'	Apr/72	
L. 328046	2	398'	May/72	
		<u>877</u>		

Notes:

184/72 Autopositive enclosed



ZAVITZ TWP
HUTT TWP

HUTT 5-1

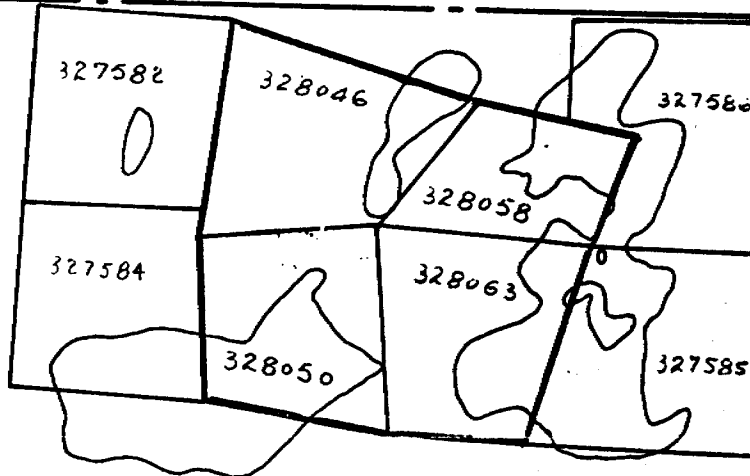

ESKER LAKES

HUTT 5-2

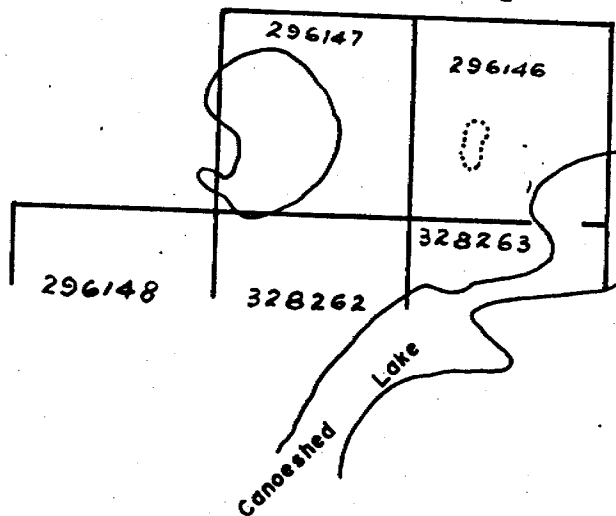

WATTS, GRIFFIS & McQUAT LIMITED
DOWA MINING CO. LIMITED
MATACHEWAN PROJECT
ESKER LAKES

Scale 1"=1320'

DIAMOND DRILL HOLE SUMMARY

COMPANY: Dowa Mining
 PROPERTY: Esker Lake

Hole: Hutt 5-1, No. 1
 Claim: 328050- 328046
 Coords: _____
 Bearing: North
 Depth: 479'
 Started: April 7, 1972
 Drilled By: Inspiration Drilling
 Core Recovery: 100%

Location: 1, 600 NW; 300 SW
 Elev: _____
 Angle: -50°
 Core Size: AQ
 Completed: April 9, 1972.
 Logged By: D. F. Des Rosiers

Survey: _____
 Depth: 0
 Azimuth: _____
 Dip: -50°

D.F. Des Rosiers April 9/72

FROM	TO	DESCRIPTION	INTERSECTION			ANALYSIS			
			FROM	TO	LENGTH				
0	23	Overburden							
23	57	Dacitic Tuff - Light gray-green with many minor quartz bands cutting core at various angles. Few calcite veins cut core. Minor amounts of disseminated pyrrhotite and chalcopryrite (less than 1% of core) through entire section. Core has many small calcite veinlets.							
57	98	Dacite - Light green with many quartz and calcite veins and siliceous sections. Core cut with many small calcite veinlets. Minor amounts of disseminated pyrrhotite and chalcopryrite (less than 1%) through entire section.							
		77-78' 3-5% pyrrhotite and chalcopryrite (about 1/2%).							
		96.5-97.5' Broken section.							
		97.5-98 Rhyolite.							
98	123.5	Rhyolitic Tuff - Light-gray light gray-green with light rhyolite sections. Many quartz veins and few calcite veins. Less than 1% pyrrhotite and chalcopryrite as disseminations and few pyrite cubes.							
123.5	175.5	Rhyolite breccia - Light gray-green very siliceous with silica forming matrix material. Core very hard, Minor disseminated pyrrhotite and chalcopryrite throughout (less than 1%).							
		.../2							

#184/72 Hutt 5-1

Richard H. Clayton

DIAMOND DRILL HOLE SUMMARY

COMPANY: Dowa Mining

PROPERTY: _____

Hole No. Hutt 5-1 1

Claim No. _____

Location: _____

Depth: _____

Survey: _____

Coords: _____

Elev: _____

Azimuth: _____ Dip: _____

Bearing: _____

Angle: _____

Depth: _____

Core Size: _____

Started: _____

Completed: _____

Drilled By: _____

Core Recovery: _____

Logged By: _____

FROM	TO	DESCRIPTION	INTERSECTION			ANALYSIS			
			FROM	TO	LENGTH	Tag No.	Cu%	Zn%	Ni%
		143-145 Dacite with flakes of biotite.							
175.5	194.5	Dacitic breccia - Light green with siliceous and calcite as matrix material. Cut by small calcite and quartz veins. Less than 1% disseminated pyrrhotite and chalcopyrite.							
194.5	217.5	Dacitic breccia - Light green with black material and calcite as matrix. Core softer than above. In parts of core more mineralization (up to 10%) mostly pyrrhotite with pyrite and chalcopyrite.							
		195.5-199 5% mineralization mostly pyrrhotite and less than 1% chalcopyrite in places. Black matrix material very hard but not magnetic.	195.5	199.0	3.5'	5810	0.024	0.19	0.02 4.25
		206.5-208.5 5% mineralization mostly pyrrhotite with pyrite and chalcopyrite. <u>Hard black mineral 10% of core not magnetic.</u>	206.5	208.5	2.0'	5811	0.041	0.15	0.022 6.64
		211.5-213 5% pyrrhotite with pyrite and chalcopyrite. Black mineral 15% of core.							
		215-217 5% pyrrhotite with pyrite and chalcopyrite. Black material 10% of core.							
217.5	288.5	Dacite and dacitic breccia. Rock grades back and forth. Light green light gray-green. Cut with many quartz stringers and some calcite. Only minor traces of disseminated pyrrhotite, pyrite and chalcopyrite.							
		.../3							

DIAMOND DRILL HOLE SUMMARY

COMPANY: Dowa Mining
 PROPERTY: _____

Hole Hutt 5-1 1
 Claim No. _____
 Coords: _____
 Bearing: _____
 Depth: _____
 Started: _____
 Drilled By: _____
 Core Recovery: _____

Location: _____
 Elev: _____
 Angle: _____
 Core Size: _____
 Completed: _____
 Logged By: _____

Survey: _____
 Depth: _____
 Azimuth: _____ Dip: _____

FROM	TO	DESCRIPTION	INTERSECTION			ANALYSIS			
			FROM	TO	LENGTH				
288.5	405	Dacitic Breccia. Light green, light gray-green with gray-black matrix material. Cut with many small quartz and calcite veins. Minor disseminated pyrite, pyrrhotite and chalcopyrite.							
		320.5-323 Dacite light green.							
405	479	Dacitic Tuff Breccia. Light gray-green with black material running through core in veinlets and small veins. Contacts of rock appear to be about 10 - 30 degrees to core axis (almost down core in places). Minor amounts of disseminated pyrrhotite, pyrite and chalcopyrite. Calcite and quartz veins throughout core.							
		427.8 3" band of quartz with 5% pyrrhotite and some chalcopyrite.							
		428.2 2" band of quartz with 5% pyrrhotite and some chalcopyrite.							
		433.3 1" band of black mineral with 10% pyrrhotite and up to 1% chalcopyrite.							
		441.5-442.5 1/2" band of black material runs down core with 10% pyrrhotite and up to 1% chalcopyrite.							
479		END OF HOLE.							
		<i>D. J. [Signature]</i>							

DIAMOND DRILL HOLE SUMMARY

COMPANY: Dowa Mining Company Limited
 PROPERTY: Esker Lake

Hole: Hutt 5-1 No. 2
 Claim No.: 328046
 Coords: 2000 NW ; 100 NE
 Bearing: South
 Depth: 398'
 Started: May 7, 1972
 Drilled By: Inspiration
 Core Recovery: 100% except as noted.

Location: 48°00'28"N ; 81°10'38" W. 42A/3
 Elev: _____ Hutt Township
 Angle: -45°
 Core Size: AQ
 Completed: May 8, 1972.
 Logged By: D. F. DesRosiers

Depth: 0

Survey: _____
 Azimuth: 180° Dip: -45°

D F DesRosiers May 10/72

FROM	TO	DESCRIPTION	INTERSECTION			ANALYSIS			
			FROM	TO	LENGTH				
0	7	Overburden							
7	27.5	Dacite - dacitic tuff, green-gray with many patches and veinlets of quartz and few veinlets of calcite core often has mottled appearance showing flow structure. Less than 1/2% disseminated pyrrhotite with few flecks of chalcopyrite.							
27.5	29	Rhyolite, light gray very siliceous showing flow structures. Few quartz veinlets small amount of iron staining on fractures.							
29	80.2	Rhyolite with volcanic ash - light gray rhyolite as bands and lenticular patches with a matrix of dark gray relatively soft volcanic ash. Few quartz veinlets and calcite stringers. Less than 1/2% pyrite as plates along bedding planes. Minor amounts of pyrrhotite with few flecks of chalcopyrite associated with quartz-calcite stringers. Banding 70 - 80 degrees to core axis.							
		32.8 - 33.5 60% Recovery.							
80.2	169.5	Agglomerate, gray, green rounded and semi-rounded pebbles of rhyolite and dacite with partial quartz and partial gray matrix material. Few quartz and calcite veinlets. Mineralization 1 - 2% pyrrhotite as pebbles and disseminated with minor pyrite and chalcopyrite.							
		.../2							

DIAMOND DRILL HOLE SUMMARY

COMPANY: Dowa Mining
 PROPERTY: _____

Hole No: Hutt 5-1 No. 2
 Claim: _____
 Coords: _____
 Bearing: _____
 Depth: _____
 Started: _____
 Drilled By: _____
 Core Recovery: _____

Location: _____
 Elev: _____
 Angle: _____
 Core Size: _____
 Completed: _____
 Logged By: _____

Survey: _____
 Azimuth: _____ Dip: _____

FROM	TO	DESCRIPTION	INTERSECTION			ANALYSIS			
			FROM	TO	LENGTH				
		102.5 - 102.9 Calcite-quartz vein.							
		121 - 122 5% pyrrhotite minor chalcopyrite.							
169.5	247.2	Rhyolite breccia, gray to gray-green rhyolite blocks with black to dark gray matrix material. Some places graphitic. Calcite and quartz veinlets and patches throughout. Mineralization pyrite and pyrrhotite with minor chalcopyrite.							
		169.5 - 174 2% pyrite 2% pyrrhotite trace chalcopyrite.							
		174 - 181 1% pyrite 2 - 4% pyrrhotite and minor chalcopyrite.							
		181 - 182 2% pyrite. 2% pyrrhotite.							
		182 - 186 2% pyrite 3 - 7% pyrrhotite minor chalcopyrite.							
		186 - 187 15% pyrite 1% pyrrhotite.							
		187 - 189 5 - 7% pyrite.							
		189 - 191 Graphitic slate with 5 - 10% pyrite.							
		191 - 192 7 - 10% pyrite.							
		192 - 193 Graphitic slate with 10% pyrite.							
		193 - 195 2% pyrite 2% pyrrhotite minor chalcopyrite.							
		.../3							

DIAMOND DRILL HOLE SUMMARY

COMPANY: Dowa Mining
 PROPERTY: _____

Hole: Hutt 5-1 No. 2
 Claim No: _____ Location: _____
 Coords: _____ Elev: _____
 Bearing: _____ Angle: _____
 Depth: _____ Core Size: _____
 Started: _____ Completed: _____
 Drilled By: _____
 Core Recovery: _____ Logged By: _____

Survey: _____
 Depth: _____ Azimuth: _____ Dip: _____

			INTERSECTION			ANALYSIS			
FROM	TO	DESCRIPTION	FROM	TO	LENGTH				
		195 - 196 2% pyrite 5% pyrrhotite.							
		196 - 198.5 2% pyrite 2% pyrrhotite.							
		198.5 - 201.5 5% pyrite 5% pyrrhotite.							
		201.5 - 203 2% pyrite 2% pyrrhotite.							
		203 - 204.5 3% pyrite 3% pyrrhotite.							
		204.5 - 210 2% pyrite 2% pyrrhotite.							
		243 - 247.2 2% pyrite 4% pyrrhotite.							
247.2	275	Mineralized rhyolite breccia. Light gray-gray-green with massive patches of pyrite. Calcite and quartz stringers and siliceous patches throughout.							
		247.2 - 249.5 30% pyrite 3 - 5% pyrrhotite.							
		249.5 - 252 80% pyrite 2 - 3% pyrrhotite.							
		252 - 253.2 10% pyrite; minor pyrrhotite.							
		253.2 - 255 65% pyrite 2 - 3% pyrrhotite.							
		255 - 257.6 10% pyrite 3 - 5% pyrrhotite.							
		.../4							

DIAMOND DRILL HOLE SUMMARY

COMPANY: Dowa Mining
 PROPERTY: _____

Hole No. Hutt 5-1 No. 2
 Claim No.: _____
 Coords: _____
 Bearing: _____
 Depth: _____
 Started: _____
 Drilled By: _____
 Core Recovery: _____

Location: _____
 Elev: _____
 Angle: _____
 Core Size: _____
 Completed: _____
 Logged By: _____

Survey: _____
 Depth: _____
 Azimuth: _____
 Dip: _____

FROM	TO	DESCRIPTION	INTERSECTION			ANALYSIS			
			FROM	TO	LENGTH				
		257.6 - 271 10 - 15% pyrite 2 - 3% pyrrhotite.							
		271 - 271.7 80% pyrite 2 - 3% pyrrhotite.							
		271.7 - 275 20 - 25% pyrite 2- 3% pyrrhotite.							
275	277.1	Rhyolite, gray-green massive with traces of disseminated pyrite. Few quartz veinlets.							
277.1	312	Rhyolite, light gray with patches of siliceous material and veins and veinlets of quartz with some calcite. Patches and disseminated pyrite and pyrrhotite.							
		277.1 - 312 3 - 5% pyrite 5 - 10% pyrrhotite minor chalcopyrite.							
312	333	Rhyolite - rhyolitic agglomerate. Gray-green with gray-black matrix material. Core siliceous for first 6' and then few silica patches and quartz and calcite veinlets. Mineralization pyrrhotite with pyrite and minor chalcopyrite associated with siliceous-calcitic areas. Pyrrhotite 1 - 2% pyrite 1% minor chalcopyrite.							
333	346.3	Rhyolitic tuff, light-medium gray with veinlets of quartz and some calcite. Patches of pyrrhotite and pyrite associated with small areas of black material. Minor chalcopyrite. 2% pyrrhotite 1% pyrite, minor chalcopyrite.							
		.../5							

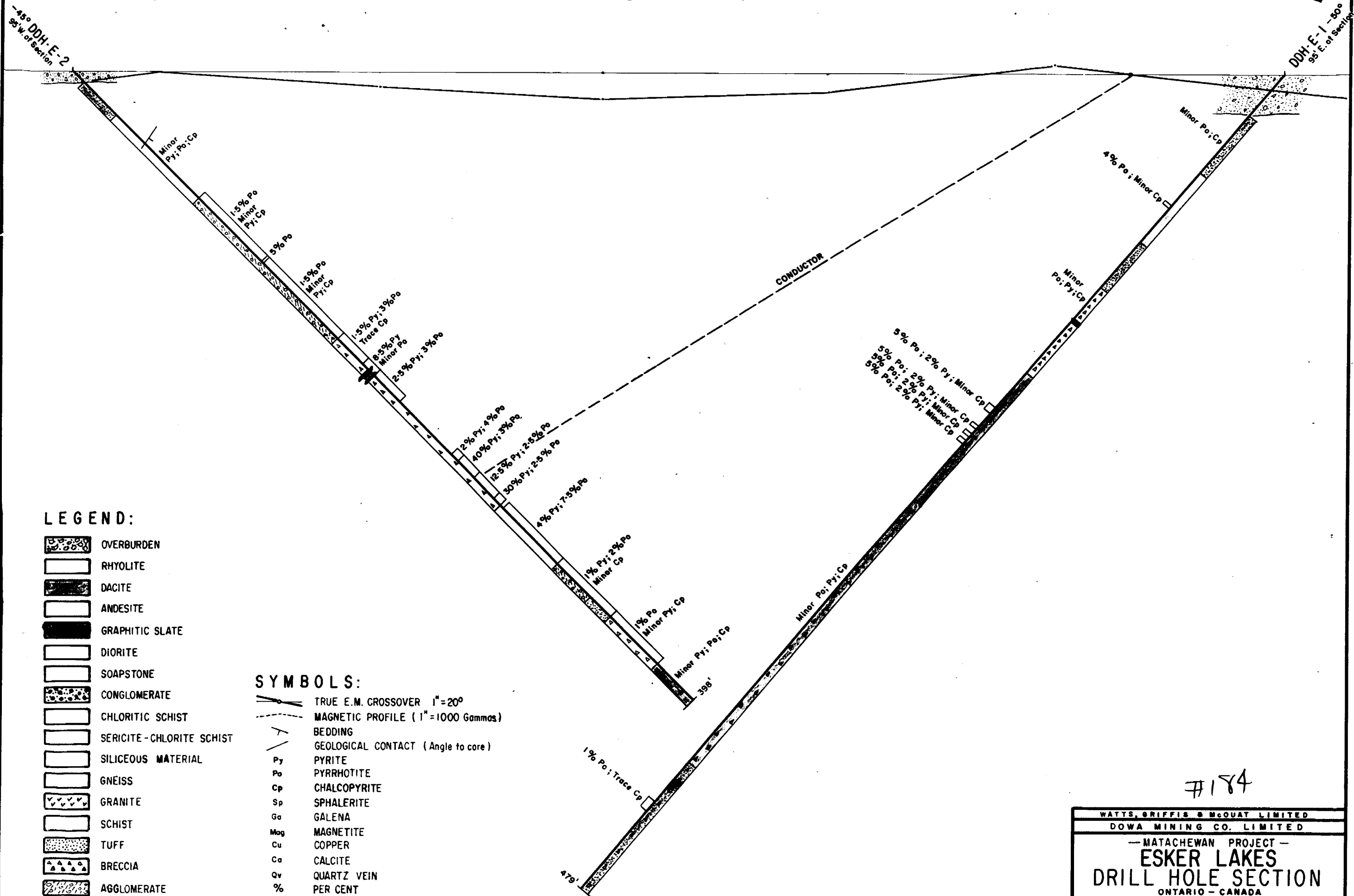

LEGEND:

- OVERBURDEN
- RHYOLITE
- DACITE
- ANDESITE
- GRAPHITIC SLATE
- DIORITE
- SOAPSTONE
- CONGLOMERATE
- CHLORITIC SCHIST
- SERICITE-CHLORITE SCHIST
- SILICEOUS MATERIAL
- GNEISS
- GRANITE
- SCHIST
- TUFF
- BRECCIA
- AGGLOMERATE

SYMBOLS:

- TRUE E.M. CROSSOVER 1" = 20°
- MAGNETIC PROFILE (1" = 1000 Gammas)
- BEDDING
- GEOLOGICAL CONTACT (Angle to core)
- Py PYRITE
- Po PYRRHOTITE
- Cp CHALCOPYRITE
- Sp SPHALERITE
- Ga GALENA
- Mog MAGNETITE
- Cu COPPER
- Ca CALCITE
- Qv QUARTZ VEIN
- % PER CENT

#184

WATTS, GRIFFIS & McQUAT LIMITED		
DOWA MINING CO. LIMITED		
-MATACHEWAN PROJECT-		
ESKER LAKES		
DRILL HOLE SECTION		
ONTARIO - CANADA		
SCALE: 1" = 40'	DATE: MAY 1972	DWG. NO.
DRAWN BY:	APPROVED:	14

10+00 NE -
 8+00 NE -
 6+00 NE -
 4+00 NE -
 2+00 NE -
 0+00 Baseline -
 -2+00 SW
 -4+00 SW
 -6+00 SW
 -8+00 SW
 -10+00 SW
 -12+00 SW
 -14+00 SW
 -16+00 SW
 -18+00 SW

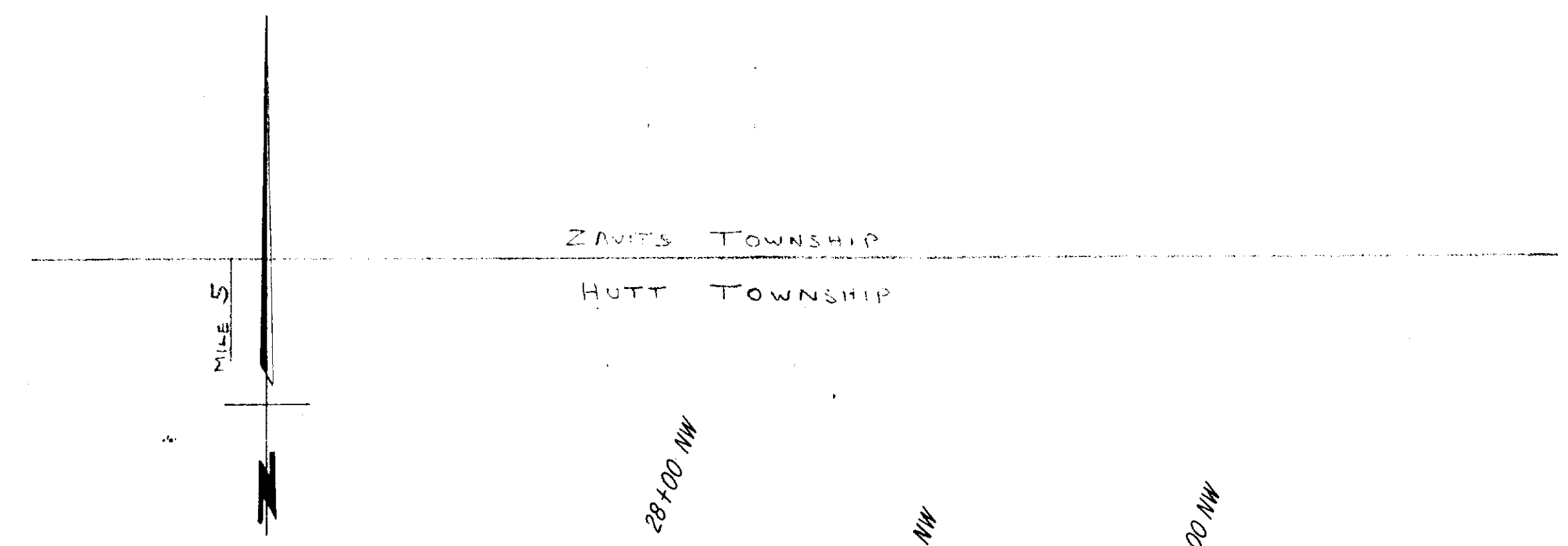

327586

327582

328046

328058

327585

327584

328050

328063

#184 Cas L.

WATTS, GRIFFIS & McQUAT LIMITED
 DOWA MINING CO. LIMITED
 MATACHEWAN PROJECT
 ESKER LAKES
 Scale 1" = 200'
 Toronto, Canada October, 1971

