



42A03SE5051 W7406-00036 ZAVITZ

010

74 06 # 36  
A separate form is required for each type of work to be recorded.

THE MINING ACT REPORT OF WORK

To the Recorder of KIRKLAND LAKE Mining Division

I, ROBERT ROUSSEAU Miner's Licence M-18562

225 Ross West Post Office Address TIMMINS ONT.

do hereby report the performance of 300 days of MECHANICAL EQUIP. MANUAL LABOUR type of work

not before reported to be applied on the following contiguous claims

Claim No.	Days	Claim No.	Days	Claim No.	Days
354075	20	354320	20	354075	152 mech
354315	20	354321	20		12 manual
354316	20	354322	20		
354317	20			354316	12 manual
354318	20				
354319	20				

All the work was performed on Mining Claim (s) 354075 - 354316  
(In the case of geological and/or geophysical survey (s) where more than 18 claims are involved attach a schedule)

READ CAREFULLY: THE FOLLOWING INFORMATION IS REQUIRED BY THE MINING RECORDER.

- For Manual Work, Stripping or Opening up of Mines, Sinking Shafts or Other Actual Mining Operations - Names and addresses of the men who performed the work and the dates and hours of their employment.
- For Diamond and other Core Drilling - Footage, No. and angle of holes and diameter of core. Name and address of owner or operator of drill. Dates when drilling was done. Signed core log and sketch in duplicate.
- For Compressed Air or Other Power Driven or Mechanical Equipment - Type of drill or equipment. Names and addresses of men engaged in operating equipment and the dates and hours of their employment.
- For Power Stripping - Type of equipment. Name and address of owner or operator. Amount expended. Dates on which work was done. Proof of actual cost must be submitted within 30 days of recording.
- With each of the above types of work sketches are required to show the location and extent of the work in relation to the nearest claim post. In the case of diamond or other core drilling the sketch must be submitted in duplicate.
- For Geophysical, Geological, Geochemical Surveys and Expenditure Credits - the name of author of report. Covering dates of survey (linecutting & office). Type of instrument used. Total amount of expenditure. Technical reports, maps, expenditure breakdown, receipts must be filed in duplicate with the Minister within 60 days of recording.
- For Land Survey - the name and address of Ontario Land surveyor.

The Required Information is as Follows:

(Attach a list if this space is insufficient)

ROBERT ROUSSEAU  
225 ROSS WEST  
TIMMINS ONT.  
TYPE OF EQUIP  
GAS PLUGGER  
AND MANUAL LABOUR, PICK & SHOVEL.  
Date MARCH 27/74

REG ROCHON  
GOL LAMMINEN  
TIMMINS ONT  
TYPE OF EQUIP  
GAS PLUGGER  
AND MANUAL LABOUR  
PICK & SHOVEL  
Robert Rousseau  
Signature of Recorded Holder or Agent

The Mining Act Certificate Verifying Report of Work

I, ROBERT ROUSSEAU  
225 ROSS WEST (Post Office Address) TIMMINS ONT.

hereby certify:

- That I have a personal and intimate knowledge of the facts set forth in the report of work annexed hereto, having performed the work or witnessed same during and/or after its completion.
- That the annexed report is true.

Dated MARCH 27 19 74

Robert Rousseau  
Signature

(file L 354075)

THE PENALTY FOR MAKING A FALSE STATEMENT IN THIS REPORT AND/OR CERTIFICATE IS \$500. OR SIX MONTHS IMPRISONMENT OR BOTH



ONTARIO

A separate form is required for each type of work to be recorded.

THE MINING ACT REPORT OF WORK

To the Recorder of KIRKLAND LAKE Mining Division

I, ROBERT ROUSSEAU M-18562  
name of Recorded Holder Miner's Licence

225 ROSS WEST TIMMINS ONT.  
Post Office Address

do hereby report the performance of ~~work~~ days of MECHANICAL EQUIP  
type of work MANUAL LABOUR.

not before reported to be applied on the following contiguous claims

Claim No.	Days	Claim No.	Days	Claim No.	Days
354070	20	.....	.....	.....	.....
354071	38	354073 - 4.5 man	.....	354071 - 7.2 mech	.....
354072	20 <sup>x</sup>	.....	.....	.....	- 6 man
354073	40	.....	.....	.....	.....
.....	.....	.....	.....	.....	.....
.....	.....	.....	.....	.....	.....

All the work was performed on Mining Claim (s) 354071 354073  
(In the case of geological and/or geophysical survey (s) where more than 18 claims are involved attach a schedule)

READ CAREFULLY: THE FOLLOWING INFORMATION IS REQUIRED BY THE MINING RECORDER.

- For Manual Work, Stripping or Opening up of Mines, Sinking Shafts or Other Actual Mining Operations - Names and addresses of the men who performed the work and the dates and hours of their employment.
- For Diamond and other Core Drilling - Footage, No. and angle of holes and diameter of core. Name and address of owner or operator of drill. Dates when drilling was done. Signed core log and sketch in duplicate.
- For Compressed Air or Other Power Driven or Mechanical Equipment  
Type of drill or equipment. Names and addresses of men engaged in operating equipment and the dates and hours of their employment.
- For Power Stripping - Type of equipment. Name and address of owner or operator. Amount expended. Dates on which work was done. Proof of actual cost must be submitted within 30 days of recording.
- With each of the above types of work sketches are required to show the location and extent of the work in relation to the nearest claim post. In the case of diamond or other core drilling the sketch must be submitted in duplicate.
- For Geophysical, Geological, Geochemical Surveys and Expenditure Credits - the name of author of report. Covering dates of survey (linecutting & office). Type of instrument used. Total amount of expenditure. Technical reports, maps, expenditure breakdown, receipts must be filed in duplicate with the Minister within 60 days of recording.
- For Land Survey - the name and address of Ontario Land surveyor.

The Required Information is as Follows: (Attach a list if this space is insufficient)

ROBERT ROUSSEAU  
225 ROSS WEST  
TIMMINS ONT.  
TYPE OF EQUIP.  
GAS PLUGGER  
AND MANUAL LABOUR  
PICK & SHOVEL.  
Date MARCH 27 1974

REG ROCHON  
601 LAMMINEN  
TIMMINS ONT.  
TYPE OF EQUIP  
GAS PLUGGER  
AND MANUAL LABOUR  
PICK & SHOVEL

ROBERT ROUSSEAU  
Signature of Recorded Holder or Agent

The Mining Act Certificate Verifying Report of Work

I, ROBERT ROUSSEAU  
225 ROSS WEST TIMMINS ONT.  
(Post Office Address)

- hereby certify:
- That I have a personal and intimate knowledge of the facts set forth in the report of work annexed hereto, having performed the work or witnessed same during and/or after its completion.
  - That the annexed report is true.

Dated MARCH 29 19 74 ROBERT ROUSSEAU  
Signature

THE PENALTY FOR MAKING A FALSE STATEMENT IN THIS REPORT AND/OR CERTIFICATE IS \$500. OR SIX MONTHS IMPRISONMENT OR BOTH



42A03SE5051 W7406-00036 ZAVITZ

900 LR?

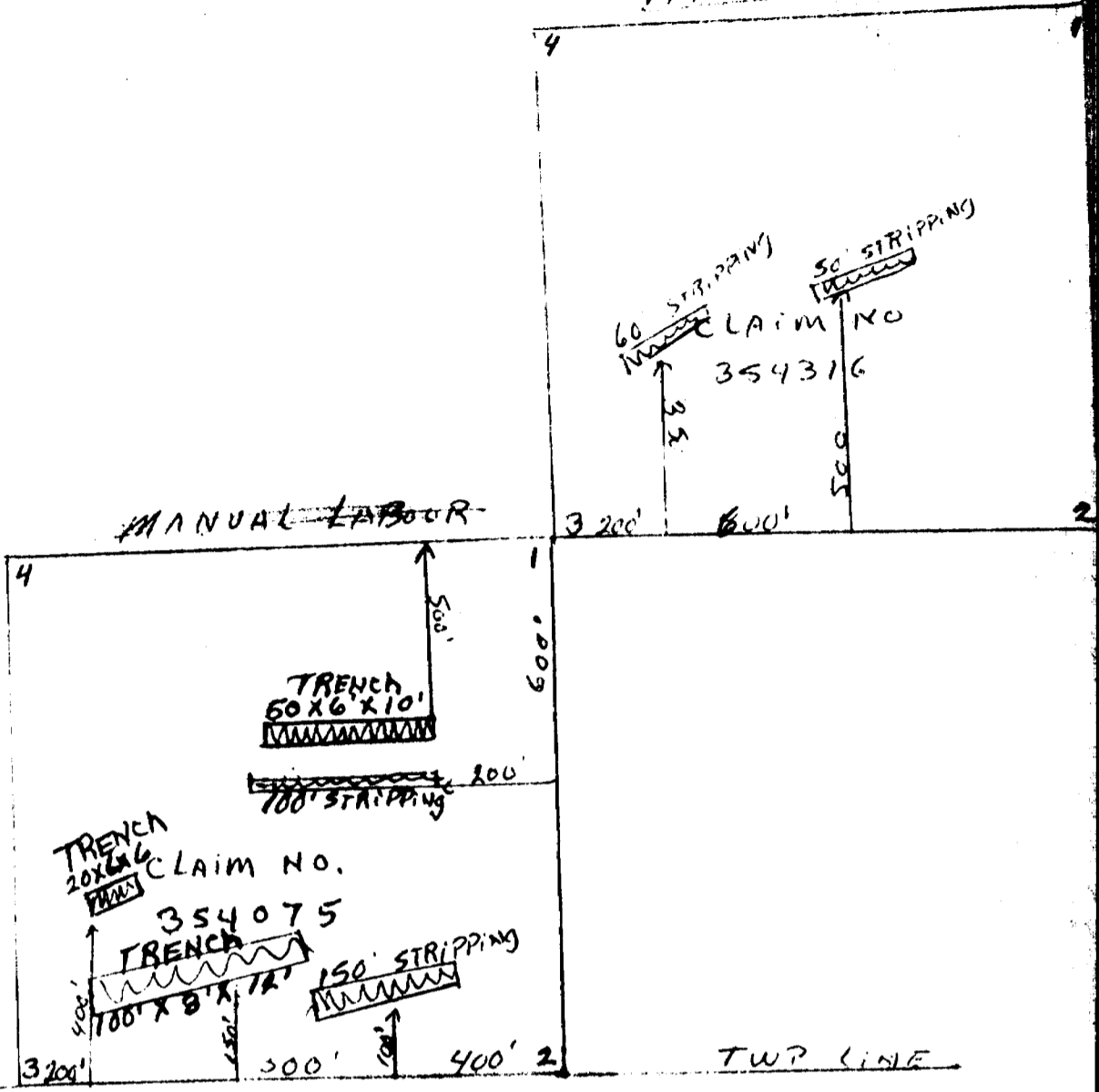

ZAVITZ  
HUTT



MANUAL LABOUR (PICKY SHOVEL)  
MECH EQUIP (GAZ PLUGGER)

DATES	HOURS	CL. NUMBER	TYPE OF WORK
JUNE 14/73	12	354073	MANUAL LABOUR
" 15/73	12	354071	MECH EQUIP.
" 16/73	3	354071	MANUAL LABOUR
" 16/73	9	354071	MECH EQUIP.
" 17/73	6	354071	MAN LAB.
" 17/73	6	354071	MECH EQUIP.
" 18/73	12	354071	MECH EQUIP.
" 19/73	3	354073	MAN. LAB.
" 19/73	9	354071	MECH. EQUIP.
" 20/73	6	354071	MAN. LAB.
" 20/73	6	354071	MECH. EQUIP.
" 21/73	3	354071	MAN. LAB
" 21/73	9	354071	MECH EQUIP.
" 22/73	12	354073	MAN. LAB.
" 23/73	12	354071	MECH EQUIP.
" 24/73	6	354073	MAN. LAB.
" 24/73	6	354071	MECH. EQUIP.
" 25/73	12	354071	MECH. EQUIP.
" 26/73	12	354073	MAN. LAB
" 27/73	6	354071	MECH. EQUIP.
" 28/73	12	354073	MAN. LAB
AUG. 10/73	9	354071	MECH. EQUIP
AUG. 11/73	12	354073	MAN. LABOUR

hrs x 2

~~73 - 69 hrs man~~  
~~71 - 18 man~~  
~~71 - 108 mech~~

~~75 - 66 man~~  
~~75 - 228 mech~~  
~~16 - 66 man~~

MANUAL LABOUR ( PICK & SHOVEL )  
 MECH. EQUIP. ( RAZ PLUGGER )

DATES	HOURS		CL NUMBERS	TYPE OF WORK
July 1/73	12		354075	MAN. LAB
" 2/73	6		354316	MAN. LAB
" 2/73	6	→	354075	MECH EQUIP.
" 3/73	12	→	354075	MECH EQUIP.
" 4/73	12		354316	MAN. LAB.
" 5/73	12	→	354075	<del>MAN. LAB.</del> MECH EQUIP
" 6/73	12	→	354075	MECH EQUIP.
" 7/73	6	-	354075	MAN LAB.
" 7/73	6	→	354075	MECH. EQUIP.
" 8/73	12	→	354075	MECH. EQUIP.
" 9/73	12		354316	MAN LAB.
" 10/73	12	→	354075	MECH EQUIP
" 11/73	6	-	354075	MAN. LAB
" 11/73	6	→	354075	MECH. EQUIP.
" 12/73	3	-	354075	MAN. LAB
" 12/73	9	→	354075	MECH. EQUIP
" 16/73	6	-	354075	MAN. LAB.
" 16/73	6	→	354075	MECH EQUIP
" 17/73	12	→	354075	MECH. EQUIP. ↓
" 18/73	12		354316	MAN. LAB
" 24/73	12	→	354075	MECH EQUIP.
" 25/73	3	-	354075	MAN. LAB.
" 25/73	9	→	354075	MECH. EQUIP.
" 26/73	6	-	354075	MAN. LAB
" 26/73	6	→	354075	MECH EQUIP
" 27/73	6	-	354075	MAN. LAB
" 27/73	6	→	354075	MECH EQUIP.
" 28/73	12	→	354075	MECH EQUIP.
" 29/73	3	-	354075	MAN. LAB
" 29/73	9	→	354075	MECH. EQUIP.
" 29/73	9	→	354075	MECH. EQUIP.
Aug. 1/73	12	→	354075	MECH. EQUIP.
Aug. 2/73	6	-	354075	MAN. LAB
" 2/73	6	→	354075	MECH. EQUIP
" 3/73	12		354316	MAN. LAB.
" 4/73	12	→	354075	MECH. EQUIP.
" 5/73	6	-	354075	MAN. LAB
" 5/73	6	→	354075	MECH EQUIP

CONTINUES ON

OTHER SIDE →

		HOURS	CL. NUM.	TYPE OF WORK
AUG	6/73	- 12	354075	MECH. EQUIP
"	7/73	- 12	354316	MAN. LAB.
"	8/73	- 12	354075	MECH. EQUIP
"	9/73	- 3	354075	MAN. LAB
"	9/73	- 9	354075	MECH. EQUIP

354075 - 2 men  
18 week

work assignment - 134 ✓

354316 22 men

~~work assignment~~ = 2

354073 20 men

work assignment - 26

354071 6 men  
32 week

work assignment 40

354315 - 20 week from 354075

354317 - 20 " " "

354318 - 20 " " "

354319 - 20 " " "

354320 - 20 " " "

354321 - 20 " " "

354322 - 14 " " ; 6 men from 354073

354070 - 20 men from 354073

354072 - 20 week from 354071

354073 - 20 week from 354071