



42A05NE0079 63.6338 BRISTOL

010

WORK REPORT ON THE
BRISTOL LAKE PROPERTY
TRENCHING AND SAMPLING PROGRAM
FOR
R.J. POIRIER

Respectfully Submitted

A handwritten signature in black ink, appearing to read "S.D. Anderson".

S.D. Anderson

January 4, 1994



42A05NE0079 63.6338 BRISTOL

010C

TABLE OF CONTENTS

Introduction..... 1

Location and Access..... 1

Personnel..... 2

Property History..... 2

Work Program..... 3

Conclusions and Recommendations..... 4

LIST OF FIGURES

Location Map..... Fig. 1

Road Location Map..... Fig. 2

Claim Sketch..... Fig. 3

Sample Locations..... Fig. 4

APPENDICES

Sample Description and Assay Results..... Appendix A

Certificate of Qualification..... Appendix B

INTRODUCTION

During the month of October, 1993 a trenching and sampling program was carried out on the Bristol Lake Property. The purpose of this work was to sample a number of old trenches in an attempt to verify anomalous Au and Ag assays results reportedly taken in the area. This property is located in Bristol Township, Porcupine Mining Division, District of Cochrane (Fig.1). The claim block is comprised of one unpatented mining claim unit, numbered P-1089764, which is owned by R.J.Poirier of Timmins, Ontario (Fig.3)

LOCATION AND ACCESS

The Bristol Lake Property is located within the city of Timmins, Ont., Porcupine Mining Division, District of Cochrane. It is situated approximately 15 km. southwest from the city of Timmins. The western portion of the claim is located within Bristol Lake.

Access to the claim during the work period was gained by going west on Hwy. 101 for 15km. At this point a gravel road heads north from the highway and provides access to a hydro line which runs diagonally through the block (Fig.2). An old road which follows this hydro line to the west leads to Bristol Lake and provides excellent access to the work area. All roads to this point may be travelled by two wheel drive truck.

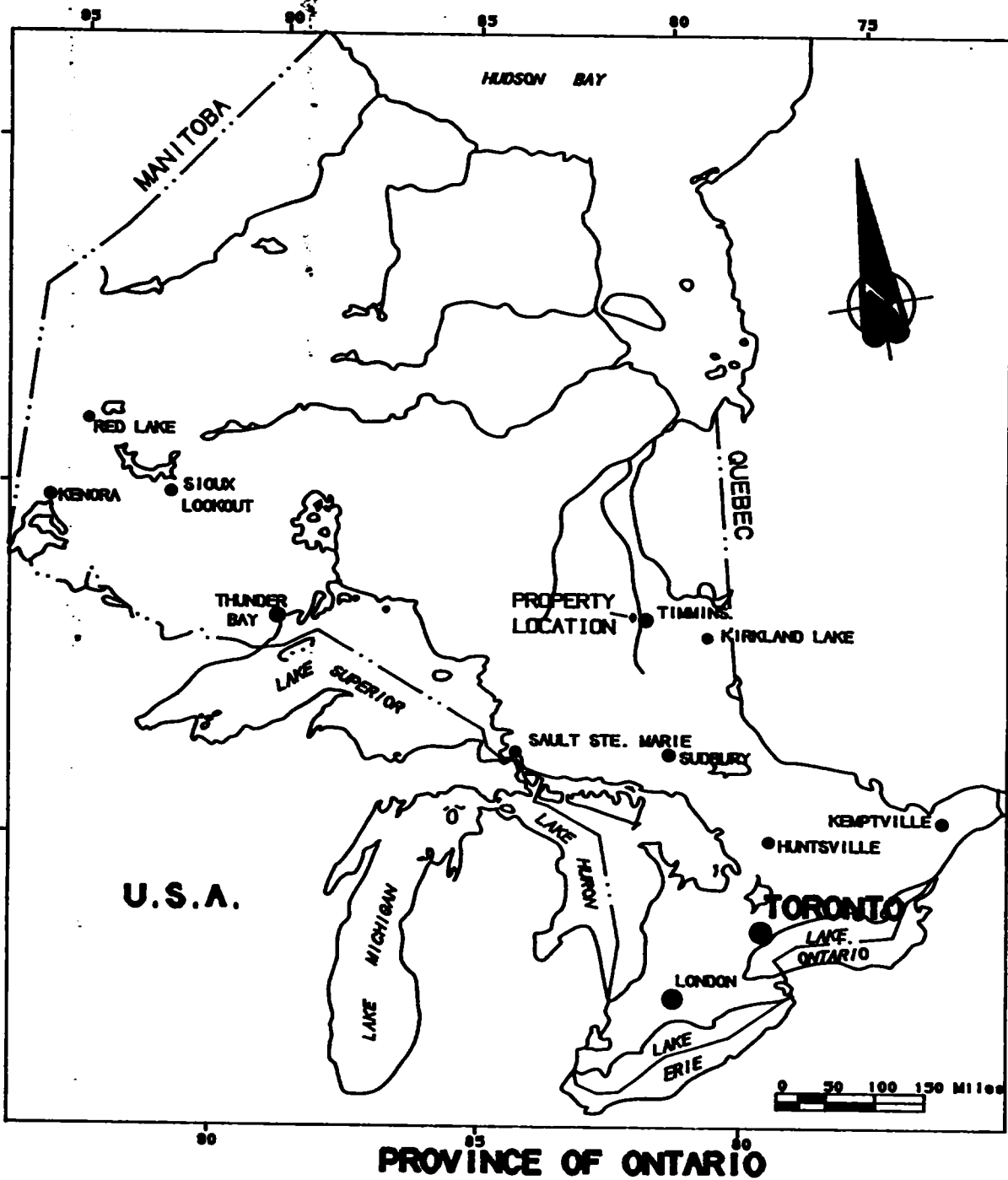

<i>BRISTOL LAKE PROP.</i>	
Client: R. J. POIRIER	
Title: LOCATION MAP	
Date: JAN 94	Scale: 1" = 100 mi N.T.S.
Drawn: R.P.B.	File: Fig. 1

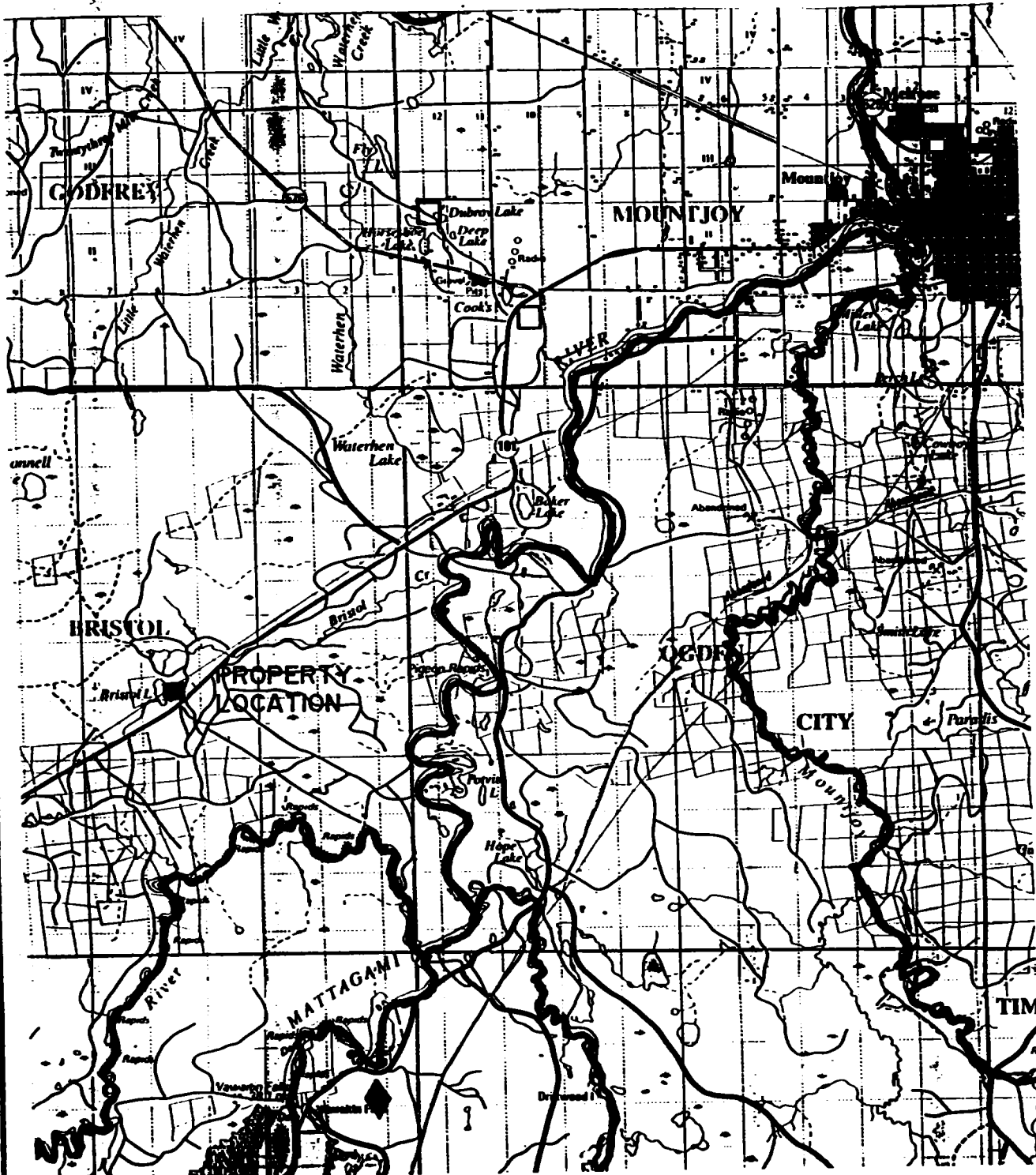

Client: R:J POIRIER
 Property: BRISTOL LAKE
 Title:
 ROAD LOCATION MAP
 Fig 2

Scale	1:100000
Projection	N.T.S.
Author	
Editor	
Reviewer	
Checker	

 **RAYAN**
EXPLORATION LTD

1:100000

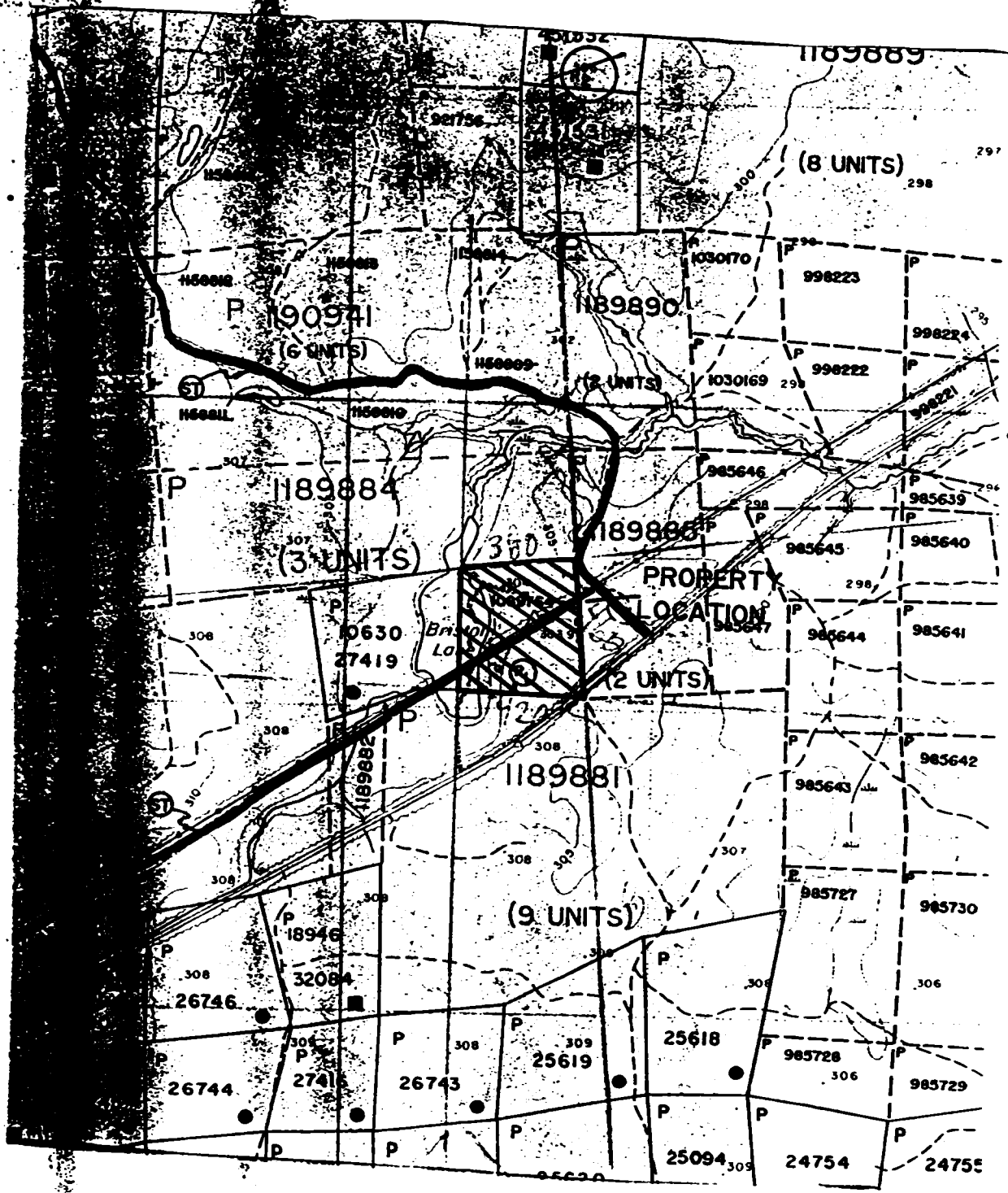

BRISTOL TOWNSHIP

1:20000

Client: R:J POIRIER	
Property: BRISTOL LAKE	
Title: CLAIM SKETCH	
Fig 3	
Drawn by:	Checked:
Scale:	Form/Map:
Project:	N.T.S.:
Date:	Drawn by:



PERSONNEL

The people directly involved with this work program are listed below.

Steve Anderson.....Timmins, Ont.

R.J.Poirier.....Timmins, Ont.

All work was supervised by R.J.Poirier.

PROPERTY HISTORY

Some of first work reported on the property was filed by the Wright-Venture group in 1939. This work included a trenching and blasting program which was followed up by diamond drilling. The diamond drill results from two holes in the area of the current project, reported gold assays of .06 oz/ton and .04 oz/ton.

The most significant results reported from this claim were taken in the early 1960's by Mr. Alton. He reported assays as high as 8.35 oz/ton Au and 28.0 oz/ton Ag. Again, these samples were apparently taken from trenches in the current area of interest.

In 1988 Chevron also completed a stripping and sampling program in this area, in an attempt to repeat Mr. Alton's results. Although some encouraging results were obtained, they were no where near the assays reported by Mr. Alton. Despite not being able to repeat these assays to date, a number of old trenches in the area remain untested.

WORK PROGRAM

The work program on the Bristol Lake property was carried out during the month of October, 1993. It included a trenching and blasting program which was completed on Oct.29, followed up by grab sampling on Oct31.

The first area to be worked was trench number three. The trench was to be located at the east end of an old trench which was grown in and could not be sampled properly in it's present condition. This area was drilled using a compressor and rock drill. It was then blasted out to the east of the existing trench for a distance of roughly 5 meters in length, 2 meters wide and 1 meter deep. This exposed the quartz vein which the old trench had originally tested and allowed fresh samples to be taken. Four samples were take from this area on Oct.31.

A second trench, labelled number 4, was also blasted in an outcrop which appeared to contained disseminated sulphides that had not been tested by previous work. A trench about 2 meters long 1 meter wide and 1 meter deep, was rock drilled and blasted, and one sample was taken (Fig 3).

The rock drilling and blasting part of the work program was carried out on Oct.29, by S. Anderson. This work was completed in 1 day (8 hours) at a rate of \$ 250/day. Mr. R.J. Poirier was also present on this day to supervise and assist in the work at a rate of \$150/day (8 hours). Other expenditures included 1 days rental for the rock drill and compressor at \$75/day and \$92 for powder.

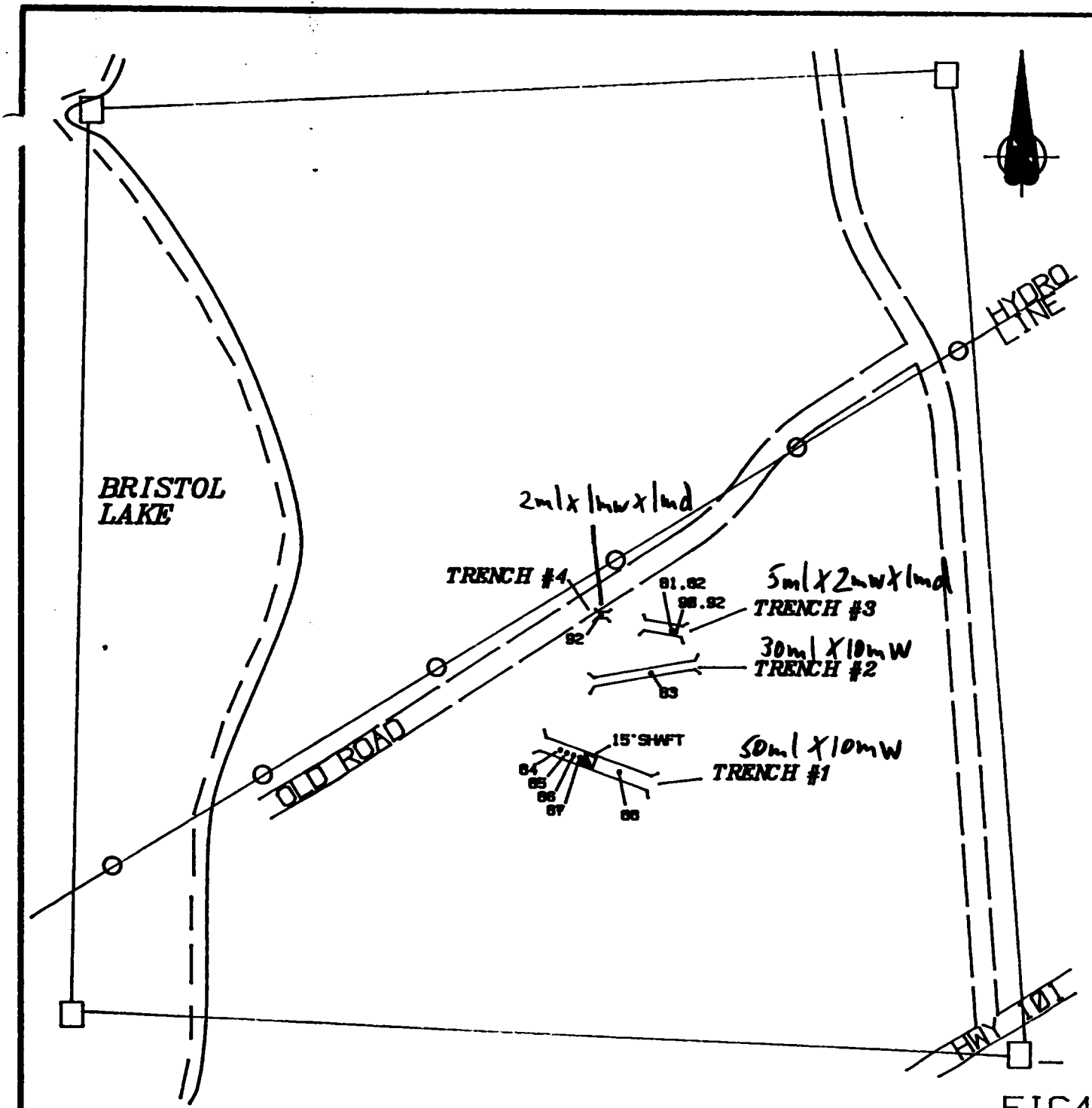

FIG4

CLAIM#
P1089764

R. J. POIRIER
BRISTOL LAKE PROP.

SAMPLE LOCATIONS

SCALE: 1:2500

TWP: BRISTOL

DRAWN: SDA

NOV. 1993



Two other stripped areas labelled trench 1 (50 meters long, 10 meters wide) and 2 (30 meters long, 10 meters wide) were also sampled with 1 sample taken from trench 2 and 5 from trench 1 (Fig 3). These stripped areas were exposed in 1988 by Chevron and were still in relatively good shape . As a result adequate grab samples were taken from areas of exposed outcropping with no blasting required.

Eleven samples in all were taken from the 4 trenches on Oct.31 by Mr. Poirier at a rate of \$150/day (8 hours). All eleven samples taken were assayed for Au,Ag and As. For a more accurate location of these trenches as well as sample locations refer to figure number 3. Sample descriptions and assay results can be found under appendix A of this report.

This technical report was also completed by Mr. Anderson at a rate of \$250/ day (8 hours).

CONCLUSIONS AND RECOMMENDATIONS

Although the trenching and blasting portion of this project was successful in exposing the areas of interest, the assay results obtained from the samples taken were not as encouraging as hoped. However, the area should not be dismissed without further testing. The high Au and Ag assays reported by Mr. Alton in the early 1960's may well have come from this area, as a number of old trenches still remain untested.

At this point, one consideration could be, to further test some of the old trenches in the area, with a program similar the one outlined in this report.

A second option that should be considered, would be a detailed geophysical program. This would involve a linecutting program to establish a detailed grid over the project area. Detailed coverage of this grid with a magnetometer and EM (VLF) survey would likely help define any geological structures. Should any favourable geological areas be outlined, some test lines of Induced Polarization should be considered. This may help outline areas of disseminated sulphides which may not have been detected previously.

If the re-sampling of old trenches fail to provide the assays expected, a geophysical program such as the one mentioned above, should help narrow down the area where Mr. Alton may have obtained his reported Au and Ag samples.

APPENDIX A

POIRIER BRISTOL LAKE PROPERTY
BRISTOL TWP., ONTARIO

Sample#	Location	Description	Au ppb	Ag ppm	As ppm
DX04581	Vein #3 trench chip 1.0' th. vein @ 100/90	90% qtz, 5% tourm, 5% sericitic porphyry; oxidized with tr py.	35	0.5	4
DX04582	Vein #3 trench chip 1.5' th. n. side of vn.	altered, sheared porph. with 0.5% v.f.g. dissem. py.; 5% black specks	<35	0.5	7
DX04583	Vein #2 trench chip 1.5' th. veins @ 080/90	80% sheared, altered porphyry with 2% dissem. py.; 20% qtz str's with 2% py. along selvidges	310	1.4	7
DX04584	Vein #1 strip 30'W. of shaft chip 1.0' th. vein @ 110/90	75% qtz with 5% tourm, 0.5% py.; 25% sheared, altered porphyry with 0.5% py.	2610 (0.076 opt)	6.7	5
DX04585	Vein #1 strip 20'W. of shaft chip 1.0' th. vein @ 110/90	25% qtz with 2% tourm, 0.2% py.; 75% sheared, altered porphyry with 0.5% py, 2% black specks	615	0.8	12
DX04586	Vein #1 strip 10'W. of shaft chip 3.0' th. veins @ 110/90	25% qtz with 1% tourm, 0.1% py.; 75% sericitic sheared porphyry with 5% tourm, 0.5% py.	35	0.7	5
DX04587	Vein #1 strip at W. edge of shaft; chip 1.5' thick vein @ 110/90	85% qtz with 0.2% py; 15% sericitized porphyry with 2% py (shaft 7'X7'X15' deep)	890	1.2	9
DX04588	Vein #1 strip 75'E. of shaft shear chip 1.0 ' th. @ 110/90	sheared, altered porph- ry with 2% py, 5% black streaks, 5% sericite, and rusty- vein pinched?	35	0.3	9
DX04590	Vein #3 trench grab sample - (vein portion)	qtz vein with 15% tourm. bands with 0.5% py.	70	1.5	13
DX04591	part of #4590 (porph. port.)	altered porphyry with 0.5% py in aggregates	<35	0.2	5
DX04592	powerline O/C 50'N. of Vn.#3	altered porphyry with 0.2% py	<35	0.3	11

ROYAL OAK ANALYTICAL LABORATORY

CERTIFICATE OF ANALYSIS

EXPLORATION 5590/5600-1100

DATE: Nov 10/93

	SAMPLE NUMBER	Au oz/ton	Au ppb	Ag ppm	As ppm			
1	DX 04581	.001	35	0.5	4.			
2	82	<.001	<35	0.5	7.			
3	83	.009	310	1.4	7.			
4	84	.076	2610	6.7	5.			
5	85	.018	615	0.8	12.			
6	86	.001	35	0.7	5.			
7	87	.026	890	1.2	9.			
8	88	.001	35	0.3	9.			
9	4590	.002	70	1.5	13.			
10	91	<.001	<35	0.2	5.			
11	DX 04592	<.001	<35	0.3	11.			
12								
13								
14								
15								
16								
17								
18								
19								
20								
21								
22								
23								
24								

Lab16

Chief Chemist: 

POIRIER BRISTOL LAKE PROPERTY.
BRISTOL TWP., ONTARIO.

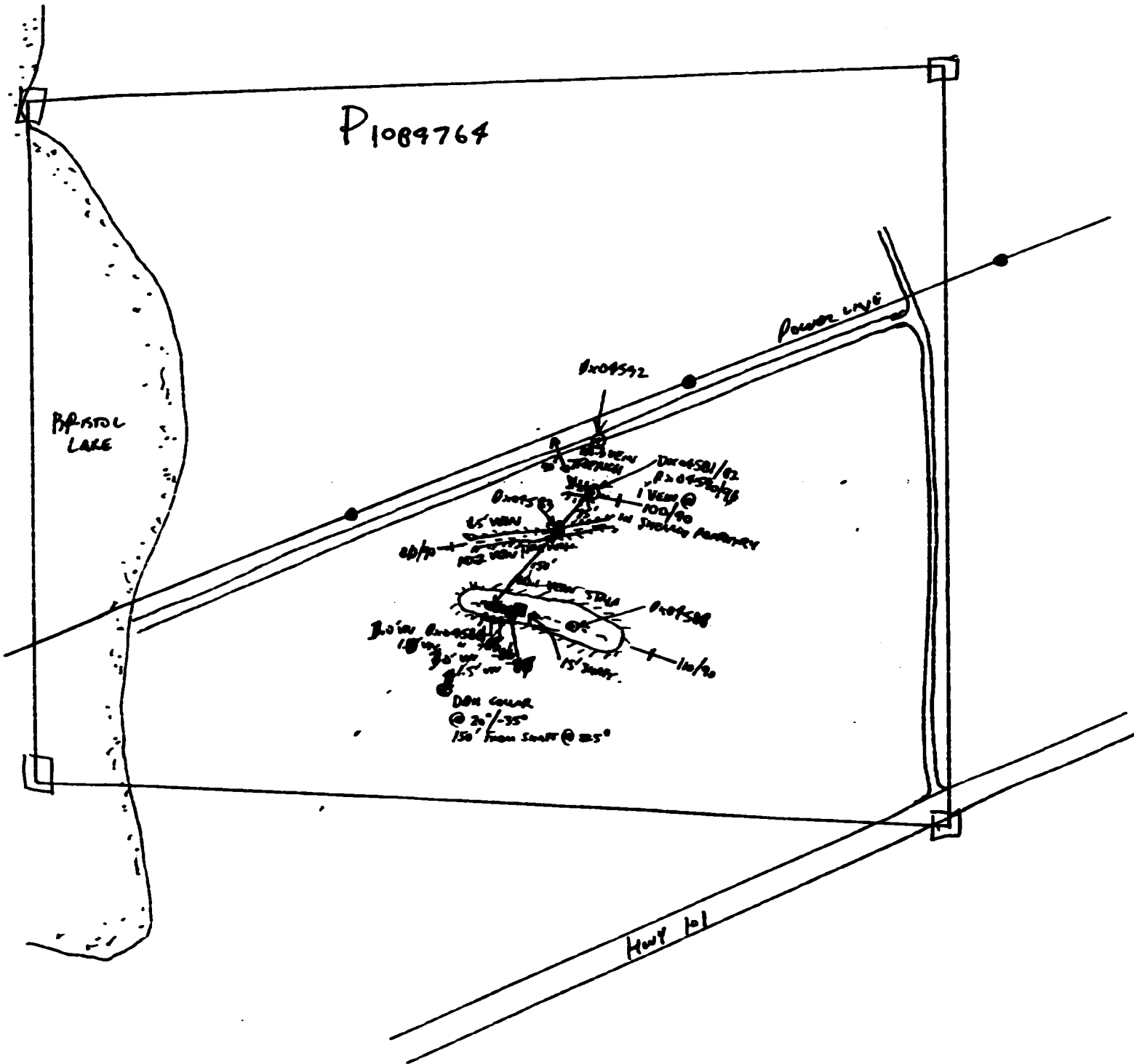

0 100 200

SCALE IN FT. 1-INCH = 200 FT

APPENDIX B

CERTIFICATION

I, Steve Dean Anderson of Timmins, Ontario hereby certify that:

1. I hold a three year Geological Technologist Diploma from Sir Sandford Fleming College, Lindsay, Ontario, obtained in May 1982.

2. I have been practising my profession since 1980 in Ontario, Quebec, Saskatchewan, New Brunswick, Northwest Territories and Manitoba.

3. I have been employed directly with Urangessellschaft Canada Ltd., Asamera Inc., R.S. Middleton Exploration Services Ltd., Crone Geophysics and Exploration Ltd., Strathcona Minerals and currently with Rayan Exploration Ltd.

4. I have based conclusions and recommendations contained in this report on knowledge of the area, my previous experience and on the results of the field work conducted on the property during 1993.

5. I hold no interest, directly or indirectly in this property, nor do I expect to receive any interest or considerations from Mr. R.J. Poirier.

Dated this 4th day of January, 1994
at Timmins, Ontario.



S.D. Anderson



Report of Work Conducted After Recording Claim

Mining Act

Transaction Number
W9460.00001

A-F.

Personal information collected on this form is obtained under the authority of the Mining Act. This collection should be directed to the Provincial Manager, Mining Lands, M
Sudbury, Ontario, P3E 6A5, telephone (705) 670-7264.



42A05NE0079 63.6338 BRISTOL

900

- Instructions:**
- Please type or print and submit in duplicate.
 - Refer to the Mining Act and Regulations for requirements of filing assessment work or consult the Mining Recorder.
 - A separate copy of this form must be completed for each Work Group.
 - Technical reports and maps must accompany this form in duplicate.
 - A sketch, showing the claims the work is assigned to, must accompany this form.

Recorded Holder(s) R.J. Poirier	Client No. 183246
Address 561 Birch St. North, Timmins, Ont. P4N 6E9	Telephone No. 705-267-2576
Mining Division Porcupine Det (As per Report)	Township/Area Bristol Twp.
M or G Plan No. G-3998	
Dates Work Performed From: Nov 28/93	To: Jan 4/94

Work Performed (Check One Work Group Only)

Work Group	Type
Geotechnical Survey	
Physical Work, Including Drilling	Blasting, Tranching and Sampling
Rehabilitation	
Other Authorized Work	
Assays	Au, Ag, As
Assignment from Reserve	

RECORDED

JAN - 5 1994

Receipt _____

ONTARIO GEOLOGICAL SURVEY

GIS - ASSESSMENT FILES

MAR 23 1994

RECEIVED

Total Assessment Work Claimed on the Attached Statement of Costs \$ **1187**

Note: The Minister may reject for assessment work credit all or part of the assessment work submitted if the recorded holder cannot verify expenditures claimed in the statement of costs within 30 days of a request for verification.

Persons and Survey Company Who Performed the Work (Give Name and Address of Author of Report)

Name	Address
Steve Dean Anderson	780 McClinton D. Timmins, Ont P4N-4P8
R.J. Poirier	561 Birch St North, Timmins, Ont.

(attach a schedule if necessary)

Certification of Beneficial Interest * See Note No. 1 on reverse side

I certify that at the time the work was performed, the claims covered in this work report were recorded in the current holder's name or held under a beneficial interest by the current recorded holder.	Date	Recorded Holder or Agent (Signature)
--	------	--------------------------------------

Certification of Work Report

I certify that I have a personal knowledge of the facts set forth in this Work report, having performed the work or witnessed same during and/or after its completion and annexed report is true.		
Name and Address of Person Certifying Same as Above		
Telephone No. 267-2576	Date Jan 5/94	Certified By (Signature) Roland Poirier

For Office Use Only

Total Value Cr. Recorded \$ 1187.00	Date Recorded JAN. 5th / 94	Mining Recorder [Signature]	<div style="border: 2px solid black; padding: 5px;"> <p style="text-align: center; font-size: 2em;">RECEIVED</p> <p style="text-align: center;">JAN 5 1994</p> <p style="text-align: center;">@ 4:20 pm [Signature]</p> <p style="text-align: center;">PORCUPINE MINING DIVISION</p> </div>
	Deemed Approval Date	Date Approved FEB 22/94	
	Date Notice for Amendments Sent JAN. 17th / 94		

Statement of Costs for Assessment Credit

Transaction No./N° de transaction
W9460.00001

État des coûts aux fins du crédit d'évaluation

Mining Act/Loi sur les mines

Personal information collected on this form is obtained under the authority of the Mining Act. This information will be used to maintain a record and ongoing status of the mining claim(s). Questions about this collection should be directed to the Provincial Manager, Minings Lands, Ministry of Northern Development and Mines, 4th Floor, 159 Cedar Street, Sudbury, Ontario P3E 6A5, telephone (705) 670-7264.

Les renseignements personnels contenus dans la présente formule sont recueillis en vertu de la Loi sur les mines et serviront à tenir à jour un registre des concessions minières. Adresser toute question sur la collecte de ces renseignements au chef provincial des terrains miniers, ministère du Développement du Nord et des Mines, 159, rue Cedar, 4^e étage, Sudbury (Ontario) P3E 6A5, téléphone (705) 670-7264.

1. Direct Costs/Coûts directs

See Report

Type	Description	Amount Montant	Totals Total global
Wages Salaires	Labour Main-d'oeuvre	1 day @ \$250.00	
	Field Supervision Supervision sur le terrain	2 days @ \$150.00	550
Contractor's and Consultant's Fees Droits de l'entrepreneur et de l'expert-conseil	Type Report	\$250.00	
	Asses,	\$220.00	470
Supplies Used Fournitures utilisées	Type Powder	92.00	
			92
Equipment Rental Location de matériel	Type Compressor & Rock Drill	75.00	
			75
Total Direct Costs Total des coûts directs			1187

2. Indirect Costs/Coûts indirects

** Note: When claiming Rehabilitation work Indirect costs are not allowable as assessment work. Pour le remboursement des travaux de réhabilitation, les coûts indirects ne sont pas admissibles en tant que travaux d'évaluation.

Type	Description	Amount Montant	Totals Total global
Transportation Transport	Type		
Food and Lodging Nourriture et hébergement	JAN		
Mobilization and Demobilization Mobilisation et démoblisation			
Sub Total of Indirect Costs Total partiel des coûts indirects			
Amount Allowable (not greater than 20% of Direct Costs) Montant admissible (n'excédant pas 20 % des coûts directs)			
Total Value of Assessment Credit (Total of Direct and Allowable Indirect costs) Valeur totale du crédit d'évaluation (Total des coûts directs et indirects admissibles)			

Note: The recorded holder will be required to verify expenditures claimed in this statement of costs within 30 days of a request for verification. If verification is not made, the Minister may reject for assessment work all or part of the assessment work submitted.

Note : Le titulaire enregistré sera tenu de vérifier les dépenses demandées dans le présent état des coûts dans les 30 jours suivant une demande à cet effet. Si la vérification n'est pas effectuée, le ministre peut rejeter tout ou une partie des travaux d'évaluation présentés.

Filing Discounts

1. Work filed within two years of completion is claimed at 100% of the above Total Value of Assessment Credit.
2. Work filed three, four or five years after completion is claimed at 50% of the above Total Value of Assessment Credit. See calculations below:

Total Value of Assessment Credit	Total Assessment Claimed
	× 0.50 =

Remises pour dépôt

1. Les travaux déposés dans les deux ans suivant leur achèvement sont remboursés à 100 % de la valeur totale susmentionnée du crédit d'évaluation.
2. Les travaux déposés trois, quatre ou cinq ans après leur achèvement sont remboursés à 50 % de la valeur totale du crédit d'évaluation susmentionné. Voir les calculs ci-dessous.

Valeur totale du crédit d'évaluation	Évaluation totale demandée
	× 0,50 =

Certification Verifying Statement of Costs

I hereby certify: that the amounts shown are as accurate as possible and these costs were incurred while conducting assessment work on the lands shown on the accompanying Report of Work form.

that as Roland Poirier I am authorized (Recorded Holder, Agent, Position in Company)

to make this certification

Attestation de l'état des coûts

J'atteste par la présente : que les montants indiqués sont le plus exact possible et que ces dépenses ont été engagées pour effectuer les travaux d'évaluation sur les terrains indiqués dans la formule de rapport de travail ci-joint.

Et qu'à titre de _____ je suis autorisé (titulaire enregistré, représentant, poste occupé dans la compagnie)

à faire cette attestation.

Signature Roland Poirier Date Jan 5/94

