



42A05NE0106 2.9142 TURNBULL

010

RECEIVED

1986

MINERAL SECTION

INTERIM EXPLORATION REPORT

TURNBULL TOWNSHIP GOLD PROPERTY, DE SANTIS PROSPECT CLAIMS

DELBIDGE MINES LIMITED

May 5, 1986
Willowdale, Ontario

William A. Hogg, Ph.D., P. Eng.
Consulting Geologist



INTRODUCTION	1
PHASE 1 EXPLORATION EXPENDITURES FOR WORK COMPLETED IN 1985-86	1
DESCRIPTION OF WORK COMPLETED	3
SHAFT DEWATERING	3
GEOLOGICAL MAPPING	3
STRIPPING AND TRENCHING	4
LINE CUTTING	4
GROUND ELECTROMAGNETIC SURVEY	4
RESULTS OF VLF SURVEY	4
GROUND MAGNETIC SURVEY	5
RESULTS OF MAGNETIC SURVEY	5
SAMPLING	5
ANALYTICAL RESULTS	6
GOLD BEARING QUARTZ VEINS	6
CONCLUSIONS AND RECOMMENDATIONS	7
CERTIFICATE OF QUALIFICATIONS	10

LIST OF MAPS

1. GEOLOGY AND ASSAY RESULTS
SHAFT SECTION DE SANTIS PROPERTY
MAP NO. 101 in folder
2. GEOLOGY AND ASSAY RESULTS TRENCHED AREA
MAIN VEIN - DE SANTIS PROPERTY
MAP NO. 102 in folder
3. GEOLOGY AND ASSAY PLAN
'25' LEVEL DE SANTIS PROPERTY
MAP NO. 102 in folder
4. VLF - EM SURVEY FRASER FILTERED
SOUTH SHEET - DE SANTIS PROPERTY
MAP NO. 104 in folder
5. VLF - EM SURVEY PROFILE
SOUTH SHEET - DE SANTIS PROPERTY
MAP NO. 105 in folder
6. MAGNETOMETRIC SURVEY
SOUTH SHEET - DE SANTIS PROPERTY
MAP NO. 106 in folder
7. SAMPLE LOCATION
MAP NO. 107 in folder

INTERIM EXPLORATION REPORT

TURNBULL TOWNSHIP GOLD PROPERTY, DE SANTIS PROSPECT CLAIMS

(TO SUPPLEMENT PRELIMINARY EXPLORATION REPORT DATED MAY 15, 1985)

INTRODUCTION

This report describes Phase 1 of the exploration work completed on the Delbridge Mines Limited De Santis prospect claims situated in Turnbull Township, Porcupine Mining Division, Ontario. The progress of the surface and underground exploration is described and the expenditures are shown. Phase 1 was carried out during December, 1985 and January, 1986, and was completed on the south half of the property.

PHASE 1 EXPLORATION EXPENDITURES FOR WORK COMPLETED IN 1985-86

1. SHAFT DEWATERING AND TIMBERING
Refurbishing, scaling and washing down of shaft
125' level back, walls and faces. Includes cost of
removing snow from the road to property. \$20,000.00

2. GEOLOGICAL MAPPING
Mapping the shaft, the 125' level east, west and north
of the shaft and the trench area north of the shaft.
Maps 101, 102 and 103 show this work. 4,000.00

3. SURFACE STRIPPING AND TRENCHING
Rock trenching of the main quartz vein located north
of the shaft area. Map 103 displays this work. 4,000.00

4. LINE CUTTING
Lines spaced at 400 foot intervals over the south
part of the property and at 200' intervals in the
shaft area. Chained stations were established at
100' and 50' intervals. Total line cutting 23.1 miles.
See maps 104, 105 and 106. 5,500.00

5. GROUND VLF SURVEY
A very low frequency electromagnetic survey completed
over 20.08 line miles on the south part of the
property. Individual readings were taken at 1,529
stations. A profile map 105 and a Fraser filtered
map 104 show the results. 6,000.00

6.	<u>MAGNETIC SURVEY</u> A ground magnetic survey included 1,804 individual readings at stations along the cut lines, base line and tie lines. The instrument used for the survey was a Geometrics G816 Precession Magnetometer. The results were contoured at intervals of 100 gammas. The property south sheet map shows the results.	\$4,000.00
7.	<u>SAMPLING</u> This included the collection of chip and grab samples from the shaft area, the 125' level, and the surface trench. Labelling and transportation are also included. The analytical results are plotted on map 101, 102 and 103 and copies of certificate of analysis attached.	4,000.00
8.	<u>ANALYTICAL</u> Assays were completed by Swastika Laboratories Limited, Assayers (Ontario) Limited and Timmins Analytical Services.	5,000.00
9.	<u>PROSPECTING</u> A general prospecting over the south part of the property and the area of trenching north of the shaft.	3,000.00
10.	<u>TRANSPORTATION</u> Cost of personnel to and from the property.	1,000.00
11.	<u>SUPERVISION AND CONSULTING</u>	6,000.00
12.	<u>ADMINISTRATION EXPENDITURE</u>	7,000.00
13.	<u>LEGAL EXPENDITURE</u>	500.00
	TOTAL	<u>\$70,000.00</u>

9.	A ground based magnetic survey with individual readings at all line stations, base line and tie lines. 14 line miles @ \$170./line mile	\$ 2,300.00
10.	Supervision and consulting for the complete exploration program.	10,500.00
11.	Contingency	9,000.00
	Total Phase II	\$90,000.00

W.A. HOGG
William A. Hogg
William A. Hogg, P. Eng.

A review of the previous work and the preliminary exploration completed in 1985-86 indicates that the property has sufficient merit to recommend continuing to Phase II of this exploration program.

The recommendation for Phase II exploration is as follows:

1. Trenching, stripping and sampling of the various gold showings briefly described. This work to include extensions of trenching north and south of the shaft zone. \$25,000.00

2. Prospecting of all the claims of the De Santis Delbridge property to seek out new showings and to check the geophysical results of the 1985-86 program. 9,000.00

3. Geological mapping of all rock outcrops on the property and tied in to the line grid system. Special attention should be paid to the association of gold-bearing veins to the host rock. 8,000.00

4. Sampling and analytical cost for gold assays from trenches and other showings, prospecting and geological mapping. It also includes analytical costs for testing samples from shaft muck bulk sampling.
600 samples and assays @ 15. 9,000.00

5. Rock geochemical program, sample collecting and analyses.
100 samples @ \$40. 4,000.00

6. Transportation of geologist, prospectors and geophysical crews to property. 6,000.00

7. Line cutting of control grid extending across the north part of the property. Line cutting to be at 400' stations chained at 100' and less where required.
14 miles @ \$230. 3,200.00

8. A VLF electromagnetic survey across the grid system with readings taken at 100' intervals and 50' intervals when warranted.
14 line miles @ \$285./line mile 4,000.00

(4) A quartz vein north of claim P8938 has been recorded by the same authors and will require examination.

(5) A sheared and fractured quartz vein about one mile west of the De Santis shaft is recorded by Hogg (1949) and assays of 0.19 oz./ton have been reported. The vein is described as occurring on the boundary of claim P8798 and midway between the De Santis shaft and the quartz vein north of claim P8938.

(6) A sheared vein of white and bluish quartz is believed to be close to the boundary of Delbridge claim P80543. Samples are reported to contain up to 0.19 oz./ton over 4 feet. (Woolverton, pg. 18, 19) This zone will require additional testing.

CONCLUSIONS AND RECOMMENDATIONS

Nearly ninety percent of the Delbridge De Santis claims are covered by overburden. This represents a large area of relatively unknown geological and structural information. It is expected that geophysical surveys will be useful to make interpretations of the underlying structure and geology.

The interpretation of the geophysical data on the south half of the property shows the presence of at least two diabase dykes and a number of conductive structures. Each will require testing by geological mapping, prospecting, stripping, trenching and sampling.

The north half of the property will require a similar geophysical survey and ground follow-up.

It is suggested that perhaps a limited rock geochemical testing program be undertaken and a selective bulk sampling of the surface dump of underground muck be made. This would be a controlled, systematic sampling to determine if trucking to a mill for testing would be feasible.

on the dump south of the shaft. The best assay here was 0.311 oz./ton. Another high assay of 1.77 oz./ton is reported from a surface dump 10-15 feet west of the shaft.

ANALYTICAL RESULTS

The analytical work was performed by Assayers (Ontario) Limited, Toronto, Swastika Laboratories, Swastika, and the Pamour Timmins Analytical Services, Schumaker. The tabulated results of each laboratory are attached to this report.

GOLD BEARING QUARTZ VEINS

Quartz veins with chalcopyrite, sphalerite, galena and pyrite containing values of gold and silver are believed to be associated with felsic intrusive rocks on the Delbridge claims. The host rocks for the quartz veins are gabbro and granodiorite.

The quartz veins on the Delbridge De Santis claims have been described by Finley (1925) and Hogg (1949).

At least six quartz veins and shears, believed to be significant, have been reported:

(1) The main quartz vein on which the shaft was sunk has been described (Woolverton, 1985, pg. 11) and will require additional testing in 1986.

(2) A quartz vein in an old trench $1\frac{1}{2}$ miles north of the De Santis has been reported. A search for this site and an examination is recommended.

(3) Gold values in quartz shear zones on old patented claims P8938 and P8939 have been reported by Hogg (1949) and summarized by Woolverton (1985, pg. 15, 16) will require further testing.

east of a strong series of magnetic closures. It appears to represent a significant conductive structure or other conductor that will warrant closer examination.

The other conductors appear to be less important but should be checked carefully on the surface.

GROUND MAGNETIC SURVEY

The instrument used for this survey was a Geometrics G-816 Proton Precession Magnetometer. Readings were taken at all the 100 foot stations and at a considerable number of intermediate 50 foot stations as well. The isomagnetic contours are plotted at 100 gamma intervals and some 1,800 (base, sub-base and lines) stations were read.

MAGNETIC RESULTS

There are two elongate magnetic closures that extend across the grid from south to north. They are due to diabase dykes and can be verified on surface and underground in the west drift on the 125 foot level. Other smaller magnetic closures appear to be overburden covered.

SAMPLING

Both chip and channel samples were collected in the shaft area, from the north, south and west drifts on the 125 foot level and from a surface trench adjacent to and north of the shaft.

A total of 101 samples were collected and analysed for gold. The best results are on the 125 foot level in the south drift 215 to 275 feet south of the shaft. The assay values in ounces per ton were: 0.28, 0.53, 0.14 and 0.18 along the drift in the quartz vein.

Other samples with higher gold values were from samples collected

STRIPPING AND TRENCHING

Several areas of overburden were trenched by bulldozer on the south part of the property but the main stripping and trenching was on the main quartz vein north of the shaft. This trenching along with the geology and sampling is shown on Map No. 103 - Geology and Assay Results Trenched Area Main Vein, De Santis Property.

LINE CUTTING

Line cutting over the south part of the property was completed during December, 1985. A total of 24.8 line miles were cut and were spaced at 400 foot intervals in an east-west direction. Stations were chained at 100 foot intervals. Seven lines in the area of the shaft and main quartz vein were spaced at 200 feet apart and chained at 50 foot intervals.

GROUND VLF SURVEY

A very low frequency electromagnetometer survey was completed over 20.08 line miles on the south part of the property. Individual readings were taken at 1,519 stations. The instrument used was a Geonics EM-16 VLF-EM.

VLF RESULTS

Both profile and Fraser filtered maps show the results of the readings. Six longer conductors were located along with six shorter conductors.

A single strong conductor with strong conductivity and good amplitude extends from line 2N to line 28 north. It lies 400 to 600 feet

DESCRIPTION OF EXPLORATION WORK COMPLETED
DURING THE PERIOD DECEMBER, 1985 AND JANUARY, 1986

SHAFT DEWATERING

The shaft dewatering program began early in December and in order to reach the property snow removal was required. The dewatering crew moved in to tear down the old headframe over the shaft, prior to starting the pumps to dewater the underground workings. A water volume greater than had been calculated, had to be pumped due to an old drill hole in the east cross-cut making water under pressure.

The dewatering program of the shaft because of safety factors, required new timbering and refurbishing in order to gain access. Scaling of the back and walls of the cross-cut and washing down to clean the rock surface was required prior to geological mapping. This work was completed prior to January 9, 1986.

GEOLOGICAL MAPPING

The method of geological mapping of the shaft and 125 foot level was by chain and compass. All of the north wall, most of the west wall and part of the east and south walls were accessible for mapping. Map No. 101 - Geology and Assay Results Shaft Section show this work and Map No. 102 - Geology and Assay Plan 125' Level shows the geology of the three cross-cuts of the level. The geological mapping was started in the shaft area by December 24, 1985, and continued to completion as the water level was progressively lowered in the levels. It was completed by January 10, 1986.

CERTIFICATE TO ACCOMPANY INTERIM EXPLORATION REPORT ON TURNBULL TOWNSHIP GOLD PROPERTY, DE SANTIS PROSPECT CLAIMS FOR DELBRIDGE MINES LIMITED, DATED MAY 5, 1986.

I, WILLIAM A. HOGG, OF WILLOWDALE, ONTARIO, CERTIFY THAT:

I am a Professional Engineer and Consulting Geologist and reside at 22 Maxome Avenue, Willowdale, in the Province of Ontario.

I am a graduate of Acadia University, Dalhousie University and McGill University, and hold the degrees of B.Sc. (1950), M.Sc. (1954) and Ph.D. (1959), respectively.

I am a Member of the Association of Professional Engineers of the Province of Ontario.

I have been practising my profession in Canada, and occasionally in the United States, Cyprus, Ireland, Italy, United Arab Emirates and Saudi Arabia, since 1950.

The statements made in this report are based on a study of information available from Delbridge Mines Limited and from government reports, maps, files and assessment work records.

I have no interest, direct or indirect, in the Turnbull Township De Santis claims or in Delbridge Mines Limited, nor do I expect to receive any.

Willowdale, Ontario
May 5, 1986

A circular seal for a Registered Professional Engineer. The outer ring contains the text "REGISTERED PROFESSIONAL ENGINEER" at the top and "PROVINCE OF ONTARIO" at the bottom. In the center, the name "W.A. HOGG" is printed. A handwritten signature, "William A. Hogg", is written across the seal. Below the seal, the text "William A. Hogg, P. Eng." is printed.

William A. Hogg, P. Eng.



SWASTIKA LABORATORIES LIMITED

P.O. BOX 10, SWASTIKA, ONTARIO POK 1T0
TELEPHONE: (705) 842-3244
ANALYTICAL CHEMISTS • ASSAYERS • CONSULTANTS

Certificate of Analysis

Certificate No. 62162

Date: Jan. 17, 1986

Received Jan. 15, 1986 87 Samples of ore

Submitted by Delbridge Mines Ltd., c/o Skytron Exploration & Development Ltd., Timmins,
per: Mr. Onotsky Ontario

SAMPLE NO.	GOLD PPB	SAMPLE NO.	GOLD PPB	SAMPLE NO.	GOLD PPB
1	Nil	21	Nil	42	9600
2	Nil	22	Nil		8230
3	Nil	23	10	43	17140
4	10	24	30	second pulp	15090
	Nil	25	Nil		19750
5	10	26	Nil	44	19540
6	Nil	27	Nil	45	210
7	Nil	28	Nil	46	4940
9	30	29	60		6030
10	30		190	second pulp	5970
11	10	30	Nil	47	3980
12	70	31	40	48	4390
13	40	34	300	49	820
14	Nil	35	140	50	320
15	40	36	Nil		270
	30	37	Nil	51	2450
16	Nil	38	Nil	52	2610
17	Nil	39	10	53	430
18	Nil	40	60	54	140
20	Nil	41	110	55	590
					540
					Nil

con't...

Per G. Label
G. Label, Manager





SWASTIKA LABORATORIES LIMITED

P.O. BOX 10, SWASTIKA, ONTARIO P0K 1T0

TELEPHONE: (705) 642-3244

ANALYTICAL CHEMISTS • ASSAYERS • CONSULTANTS

Certificate of Analysis

Certificate No. 62162

Date: Jan. 17, 1986

Received Jan. 15, 1986 87 Samples of ore

Submitted by Delbridge Mines Ltd., c/o Skytron Exploration & Development Ltd., Timmins,
per: Mr. Onotsky Ontario

SAMPLE NO.	GOLD PPB	SAMPLE NO.	GOLD PPB
56	Nil	77	30
57	Nil		20
58	10	78	Nil
59	Nil	79	10
60	Nil	80	Nil
61	Nil	81	Nil
62	30	82	Nil
63	30	83	Nil
64	30	84	Nil
	30	85	Nil
65	Nil	86	10
66	Nil	87	10
67	Nil	88	Nil
68	Nil	89	270
69	Nil		300
70	Nil	90	Nil
71	Nil	91	Nil
72	Nil	92	Nil
73	Nil		
74	Nil		
75	Nil		

Per G. Lebel
G. Lebel, Manager



SWASTIKA LABORATORIES LIMITED

P.O. BOX 10, SWASTIKA, ONTARIO P0K 1T0

TELEPHONE: (705) 642-3244

ANALYTICAL CHEMISTS • ASSAYERS • CONSULTANTS

Certificate of Analysis

Certificate No. 62163

Date: Jan. 20, 1986

Received Jan. 15, 1986 32 Samples of ore

Submitted by Delbridge Mines Ltd., c/o Skytron Exploration & Development Ltd., Timmins
Ontario

SAMPLE NO.	GOLD PPB	SAMPLE NO.	GOLD PPB
93	10	109	20
94	20	110	70
95	30	111	10
96	20	112	10
97	50	113	20
98	1540	115	Nil
	1810	116	Nil
second pulp	1510	117	130
	1650	118	Nil
99	70	119	60
100	Nil	120	Nil
101	30	121	1540
102	Nil		1230
103	10	second pulp	690
104	10		750
105	30	122	380
106	Nil	123	Nil
107	10	124	30
	Nil	125	160
108	30		170

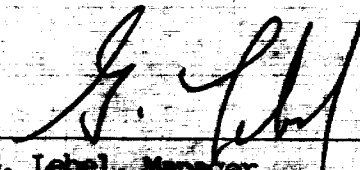
Per 
G. Label, Manager

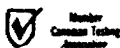



ASSAYERS (ONTARIO) LIMITED

33 CHAUNCEY AVENUE TORONTO, ONTARIO M8Z 2Z2 · TELEPHONE (416) 238-3527

Certificate of Analysis

Certificate No. GA-33/ #46-5

Date: January 9, 1986

Received Dec. 30/85 30 Samples of Rock

Submitted by E.A. Gallo Exploration Services Inc. Att'n: Mr. E. Gallo

Sample No.	Au ppb	Sample No.	Au ppb
1	57	21	783
2	67	22	32
3	1620	23	26
4	97	24	38
5	46	25	22
6	42	26	16
7	161	27	40
8	52	28	14
9	93	29	34
10	2750	30	40
11	557		
12	61		
13	91		
14	103		
15	63		
16	376		
17	79		
18	101		
19	.19 oz/ton		
20	.56 " "		

ASSAYERS (ONTARIO) LIMITED

Per _____

J. van Engelen
J. van Engelen Mgr.

timmins

Analytical Services

P.O. Box 342
McIntyre Road
Schumacher, Ontario
Canada P0N 1G0
Phone 705-264-5111

CERTIFICATE OF ANALYSIS

Samples of: Rock

Date: January 8, 1986

No.: A-3-86

Samples from: R. Onotsky

Received:

Lab number	Shipper number	o.p.t. Au					
	D601	Tr.*	}	Surface Dump - East side of dump			
	D602	Tr.					
	D603	Tr.					
	D604	.311		Qtz + Sulphides - dump material 20' S. of SWERT			
	D605	Tr.*		East road of SWERT & below			
	D606	.006		mostly Qtz - dump material 10' W. of SWERT			
	D607	1.777*		Qtz with Sulphides - dump mat 10-15 ft W of SWERT			
	D608	.016		Dump - 10' W of SWERT			
	D609	.018		Chip - 15' N of SWERT			
	D612	.017*		Grab at SWERT below			
	D613	.028		Vain - 65' down SWERT - No wall			
	D614	Tr.		Same as D613 - W. wall			
	D615	.009		from bank 50' N. of SWERT			
	D616	Tr.		Quartz from dump			

*checked

Timmins Analytical Services

Per: *Richard Wagner* 01/08/86

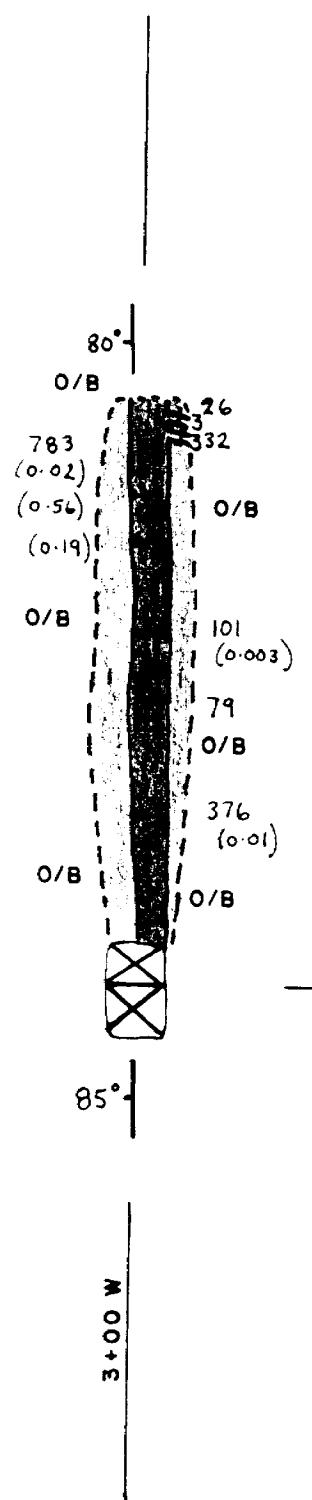

LINE 1 S

SYMBOLS

- Cp CHALCOPYRITE
- O/B OVERBURDEN
- 80° STRIKE AND DIP OF VEIN
- ← CHIP-CHANNEL SAMPLE
- 783 (0.02) GOLD ASSAY RESULT IN PARTS PER BILLION (CONVERTED TO OZ./TON)

LEGEND

- 3 CARBONATE VEIN
- QUARTZ VEIN
- ▨ GABBRO

DELBRIDGE MINES LIMITED TORONTO, ONT.	
GEOLOGY AND ASSAY RESULTS TRENCHED AREA - MAIN VEIN DE SANTIS PROPERTY TURNBULL TWP., ONT.	
DATE: DEC. 24, 1985	SCALE: 1" = 20'
DRAWN BY: EAG	MAP NO. 103

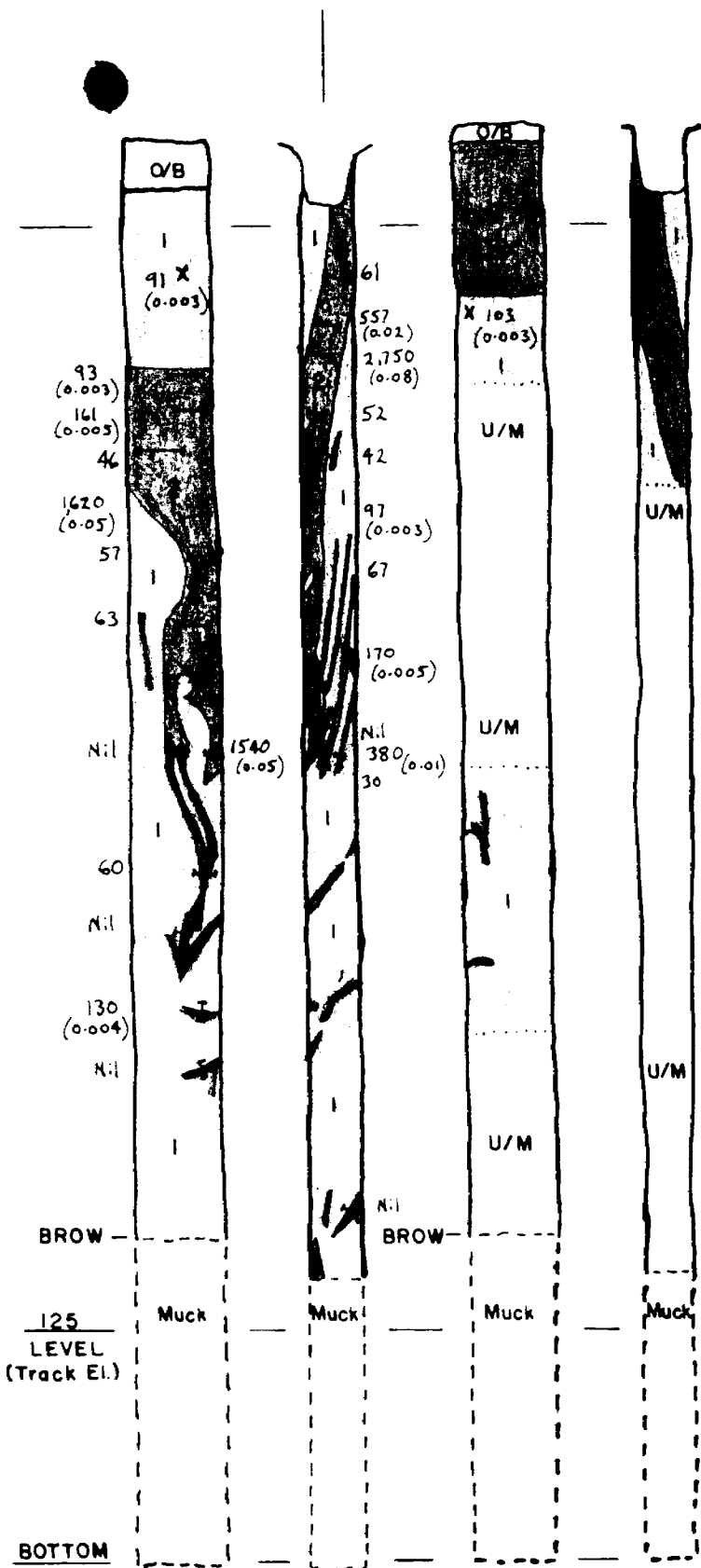

COLLAR
 TOP OF FIRST
 TIMBER SET

SYMBOLS

- O/B OVERBURDEN
- U/M UNMAPPED (TIMBERED OR DIRTY)
- CHIP-CHANNEL SAMPLE
- X CHIP SAMPLE
- 380 GOLD ASSAY RESULT IN PARTS PER BILLION (CONVERTED TO OZ./TON)

LEGEND

- QUARTZ VEIN
- GABBRO

WEST WALL NORTH WALL EAST WALL SOUTH WALL

3+00 W

DELBRIDGE MINES LIMITED TORONTO, ONT.	
GEOLOGY AND ASSAY RESULTS SHAFT SECTION De SANTIS PROPERTY TURNBULL TWP., ONT.	
DATE: DEC. 24, 1985	SCALE: 1" = 20'
DRAWN BY: EAG	MAP NO. 101



42A05NE0106 2.9142 TURNBULL

900

Mining Lands Section

File No 29142

Control Sheet

SURVEY GEOPHYSICAL
 GEOLOGICAL
 GEOCHEMICAL
 EXPENDITURE

MINING LANDS COMMENTS:

Signature of Assessor

Date

Lot



Ministry of Natural Resources
Ontario

Report of Work
(Geophysical, Geological, Geochemical and Expenditures)

#124/86

Instructions: - Please type or print.
- If number of mining claims traversed exceeds space on this form, attach a list.
Note: - Only days credits calculated in the "Expenditures" section may be entered in the "Expend. Days Cr." columns.
- Do not use shaded areas below.

The Mining Act

Type of Survey(s) Geological (Surface & Underground)		Township or Area Turnbull Twp	
Claim Holder(s) 655 GROUP HOLDINGS LIMITED		Prospector's Licence No. T - 1200	
Address 680 Dieppe Street P.O. Box 216 - Timmins, Ontario P4N-7C9			
Survey Company Skytron Exploration & Dev Ltd		Date of Survey (from & to) 14 12 85 30 1 86 Day Mo. Yr. Day Mo. Yr.	Total Miles of line Cut
Name and Address of Author (of Geo-Technical report) E.A. Gallo - 148 Allanhurst Dr, Islington, Ontario M9A-4K7			

Credits Requested per Each Claim in Columns at right

Special Provisions	Geophysical	Days per Claim
For first survey: Enter 40 days. (This includes line cutting)	- Electromagnetic	
	- Magnetometer	
For each additional survey: using the same grid: Enter 20 days (for each)	- Radiometric	
	- Other	
	Geological	
	Geochemical	

Man Days	Geophysical	Days per Claim
Complete reverse side and enter total(s) here	- Electromagnetic	
	- Magnetometer	
	- Radiometric	
	Other	
	Geological	
	Geochemical	

Airborne Credits	Geophysical	Days per Claim
Note: Special provisions credits do not apply to Airborne Surveys.	Electromagnetic	
	Magnetometer	
	Radiometric	

Mining Claims Traversed (List in numerical sequence)

Mining Claim			Mining Claim		
Prefix	Number	Expend. Days Cr.	Prefix	Number	Expend. Days Cr.
P	708902	20			
	708903	20			
	708904	20			
	708905	20			
	708906	20			
	708907	20			
	708908	20			
	708909	20			
	708914	60			
	708915	60			
	708916	60			
	708917	60			
	708918	60			
	708919	60			
	708920	60			
	708921	60			
	805437	7.2			
	796753	23.6			
		24.6			
	649641	1.0			

RECEIVED
APR 28 1986
PORCUPINE MINING DISTRICT

RECORDED
APR 28 1986
MINING LANDS SECTION

Expenditures (excludes power stripping) Sect. 77-19

Type of Work Performed Beneficiation Studies - Underground &
Performed on Claim(s) Surface mapping & sampling
P628225 & P649637
Calculation of Expenditure Days Credits
Total Expenditures \$ 10,076.31 ÷ 15 = Total Days Credits 671.8

Instructions
Total Days Credits may be apportioned at the claim holder's choice. Enter number of days credits per claim selected in columns at right.

For Office Use Only		
Total Days Cr. Recorded 671.8	Date Recorded April 28/86	Mining Registrar <i>[Signature]</i>
Date Approved as Recorded 6.7.23	District Director <i>[Signature]</i>	

Date April 25/86	Recorded Holder or Agent (Signature) R. Onotsky-655 Group Holdings Ltd
---------------------	---

Certification Verifying Report of Work

I hereby certify that I have a personal and intimate knowledge of the facts set forth in the Report of Work annexed hereto, having performed the work or witnessed same during and/or after its completion and the annexed report is true.

Name and Postal Address of Person Certifying
Robert M. Onotsky
680 Dieppe St., Timmins, Ontario P4N-5H2

Date Certified
April 25/86

Certified by (Signature)
[Signature]

#117/86
2.91432

Instructions: - Please type or print.
- If number of mining claims traversed exceeds space on this form, attach a list.
Note: - Only days credits calculated in the "Expenditures" section may be entered in the "Expend. Days Cr." columns.
- Do not use shaded areas below.

May 29

The Mining Act

Type of Survey(s) Geological Survey (Surface & Underground)		Township or Area Turnbull Twp	
Claim Holder(s) 655 GROUP HOLDINGS LIMITED		Prospector's Licence No. T - 1200	
Address 680 Dieppe St, c/o P.O. Box 216, Timmins, Ontario P4N-7C9			
Survey Company Superior Contracting		Date of Survey (from & to) 14 12 85 15 1 86 Day Mo. Yr. Day Mo. Yr.	Total Miles of line Cut
Name and Address of Author (of Geo-Technical report) E.A. Gallo - 148 Allanhurst Dr, Islington, Ontario M9A-4K7			

Credits Requested per Each Claim in Columns at right Mining Claims Traversed (List in numerical sequence)

Special Provisions	Geophysical	Days per Claim
For first survey: Enter 40 days. (This includes line cutting)	- Electromagnetic	
	- Magnetometer	
	- Radiometric	
	- Other	
For each additional survey using the same grid: Enter 20 days (for each)	Geological	
	Geochemical	
Man Days Complete reverse side and enter total(s) here	Geophysical	Days per Claim
	- Electromagnetic	
	- Magnetometer	
	- Radiometric	
	- Other	
	Geological	
	Geochemical	
Airborne Credits Note: Special provisions credits do not apply to Airborne Surveys.	Electromagnetic	Days per Claim
	Magnetometer	
	Radiometric	

Prefix	Mining Claim Number	Expend. Days Cr.
P	649632	60
	649633	60
	649634	60
	649635	60
	649636	60
	649637	60
	649638	60
	649639	60
	649640	60
	649641	60
	649642	40
	796746	60
	796747	60
	796748	60
	796749	60
	796750	60
	796751	60
	796752	20
	796753	20
	796754	20

Prefix	Mining Claim Number	Expend. Days Cr.
P	628225	35
	806295	60
	806296	60
	806297	60
	806298	60
	806299	60

RECEIVED
APR 29 1986
MAGNETOMETER
RADIOMETRIC
OTHER
GEOLOGICAL
GEOCHEMICAL

RECORDED
APR - 9 1986

Expenditures (excludes power stripping)
Type of Work Performed (Beneficiation Studies) - Underground & Surface mapping & sampling
Performed on Claim(s) P628225, P649637

Calculation of Expenditure Days Credits
Total Expenditures \$ 20,929.71 ÷ 15 = Total Days Credits 1395

Instructions
Total Days Credits may be apportioned at the claim holder's choice. Enter number of days credits per claim selected in columns at right.

Date April 8/86
Responsible Holder or Agent (Signature) R. Onotsky - 655 Group Holdings Ltd

For Office Use Only
Total Days Cr. Recorded 1395
Date Recorded April 9/86
Date Approved as Recorded 16.7.23
Mining Registrar
Inspector

Total number of mining claims covered by this report of work. 26

Certification Verifying Report of Work
I hereby certify that I have a personal and intimate knowledge of the facts set forth in the Report of Work annexed hereto, having performed the work or witnessed same during and/or after its completion and the annexed report is true.
Name and Postal Address of Person Certifying Robert M. Onotsky
680 Dieppe St, Timmins, Ontario P4N-5H2
Date Certified April 8/86
Certified by (Signature)



Ministry of
Natural
Resources
Ontario

Report of Work
(Geophysical, Geological,
Geochemical and Expenditures)

#118/86
29142

The Mining Act

Instructions: - Please type or print.
- If number of mining claims traversed exceeds space on this form, attach a list.
Note: - Only days credits calculated in the "Expenditures" section may be entered in the "Expend. Days Cr." columns.
- Do not use shaded areas below.

May 29

Type of Survey(s) Geological		Township or Area Turnbull Twp	
Claim Holder(s) 655 GROUP HOLDINGS LIMITED		Prospector's Licence No. T - 1200	
Address 680 Dieppe Street, c/o P.O. Box 216, Timmins, Ontario P4N-7C9			
Survey Company Skytron Exploration & Dev Ltd		Date of Survey (from & to) 14 12 85 30 1 86 Day Mo. Yr. Day Mo. Yr.	
Name and Address of Author (of Geo-Technical report) E.A. Gallo - 148 Allanhurst Drive, Islington, Ontario M9A-4K7			

Credits Requested per Each Claim in Columns at right		Days per Claim
Special Provisions For first survey: Enter 40 days. (This includes line cutting) For each additional survey: using the same grid: Enter 20 days (for each)	Geophysical	
	- Electromagnetic	
	- Magnetometer	
	- Radiometric	
	- Other	
Man Days Complete reverse side and enter total in this column	Geophysical	
	- Electromagnetic	
	- Magnetometer	
Airborne Credits Note: Special provisions credits do not apply to Airborne Surveys.	Geophysical	
	- Electromagnetic	
	- Magnetometer	

Mining Claims Traversed (List in numerical sequence)			Mining Claims Traversed (List in numerical sequence)		
Prefix	Mining Claim Number	Expend. Days Cr.	Prefix	Mining Claim Number	Expend. Days Cr.
P	628225	12			
	805431	20			
	805432	20			
	805433	20			
	805434	20			
	805435	20			
	805436	20			
	805437	12.8			

RECEIVED
APR 09 1986

RECORDED
APR - 9 1986

RECEIVED
APR 28 1986
MINING LANDS SECTION

Expenditures (excludes power stripping) Type of Work Performed Analytical Costs	
Performed on Claim(s) P628225, 649637	
Calculation of Expenditure Days Credits Total Expenditures \$ 2,172.50 ÷ 15 = 144.8 Total Days Credits	
Instructions Total Days Credits may be apportioned at the claim holder's choice. Enter number of days credits per claim selected in columns at right.	

For Office Use Only		Total number of mining claims covered by this report of work. 8	
Total Days Cr. Recorded 144.8	Date Recorded April 9/86	Mining Recorder <i>[Signature]</i>	
Date Approved as Recorded 10-7-86		Branch Chief <i>[Signature]</i>	

Date April 8/86	Recorded Holder or Agent (Signature) R. Onotsky - 655 Group Holdings Ltd
Certification Verifying Report of Work I hereby certify that I have a personal and intimate knowledge of the facts set forth in the Report of Work annexed hereto, having performed the work or witnessed same during and/or after its completion and the annexed report is true.	
Name and Postal Address of Person Certifying Robert M. Onotsky	
Date Certified April 8/86	

655 GROUP HOLDINGS LIMITED

P.O. BOX 216

TIMMINS, ONTARIO P4N 7C9

PHONE (705) 267-7141

MINING LANDS SECTION

July 12, 1986

J.C. Smith
Supervisor
Mining Lands Section
MINISTRY OF NORTHERN DEVELOPEMENT
6th Floor - Whitney Block
Queen's Park
Toronto, Ontario
M7A - 1W3

RE: File - 2,9142

Dear Mr or Mrs Smith:

Regarding "Data for Assaying and Underground Mapping submitted for Mining Claims P628225 et al, in the Township of Turnbull", please be advised of the following:

The whole of the claim group in question in Turnbull Twp has been assigned under an option arrangement of March 1, 1985 to Delbridge Mines Ltd of Toronto.

In Nov-Dec/85, Delbridge Mines Ltd was successful in arranging "flow through" funding for common shares of the Company, which was expended for field exploration on our "Turnbull Twp" property as per Offering Memorandum.

Delbridge Mines Ltd contracted field exploration program out to Skytron Exploration & Development Ltd for the 49 mining claim group in Turnbull Twp in Dec/85, which was fully executed by the end of January, 1986.

Field work consisted of line cutting and ground geophysical work (some \$12,500 worth - not claimed for assessment, since we had already claimed maximum for geophysics previously), with the balance expended for prospecting, sampling (surface & underground), analytical costs, stripping & trenching, shaft dewatering & refurbishing, surveying, mapping, supervision and consultation at a total cost of \$68,457.84.

As principal shareholder of both 655 Group Holdings Limited and Skytron Exploration & Development Ltd (the contractor), I the undersigned to hereby certify that the \$33,178.52 expenditure claimed for credits on assessments of claim group was executed for said purposes claimed and filed for and was paid to Skytron Exploration & Development Ltd by Delbridge Mines Limited.

Please refer to attached verification by Skytron Exploration & Development Ltd to same effect. Thank you.

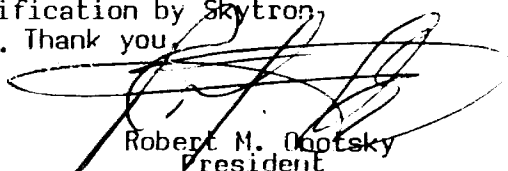
Robert M. Gotsky
resident

655 GROUP HOLDINGS LTD & SKYTRON EXPLORATION & DEV LTD

SKYTRON EXPLORATION & DEVELOPMENT LTD.

P.O. BOX 216
TIMMINS, ONTARIO P4N 7C9
PHONE (705) 267-7141

July 12, 1986

655 GROUP HOLDINGS LIMITED
P.O. Box 216
Timmins, Ontario
P4N-7C9

Dear Sirs:

As per request, please be advised that as of March 1, 1986, Skytron Exploration & Development Ltd has received a total of \$60,000.00 from Delbridge Mines Limited against outstanding account of \$68,457.84 for exploration work performed during the months of December, 1985 and January 1986 on your mining claims in Turnbull Twp, in and around mining claim P628225, on which the old Descantis mine shaft is located, which was dewatered, surveyed, mapped and sampled as per order along with other work requirements in the relative areas thereto, as requested.

We herewith certify that the above is true and valid.

Dated at Timmins, Ontario this 12th day of July, 1986

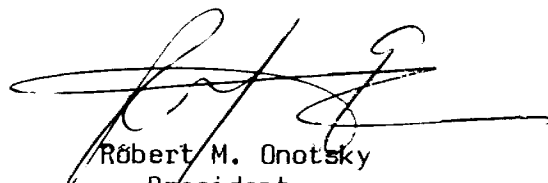

Robert M. Onotsky
President

SKYTRON EXPLORATION & DEVELOPEMENT LTD

1. Mineral Assessment

655 Group Holdings

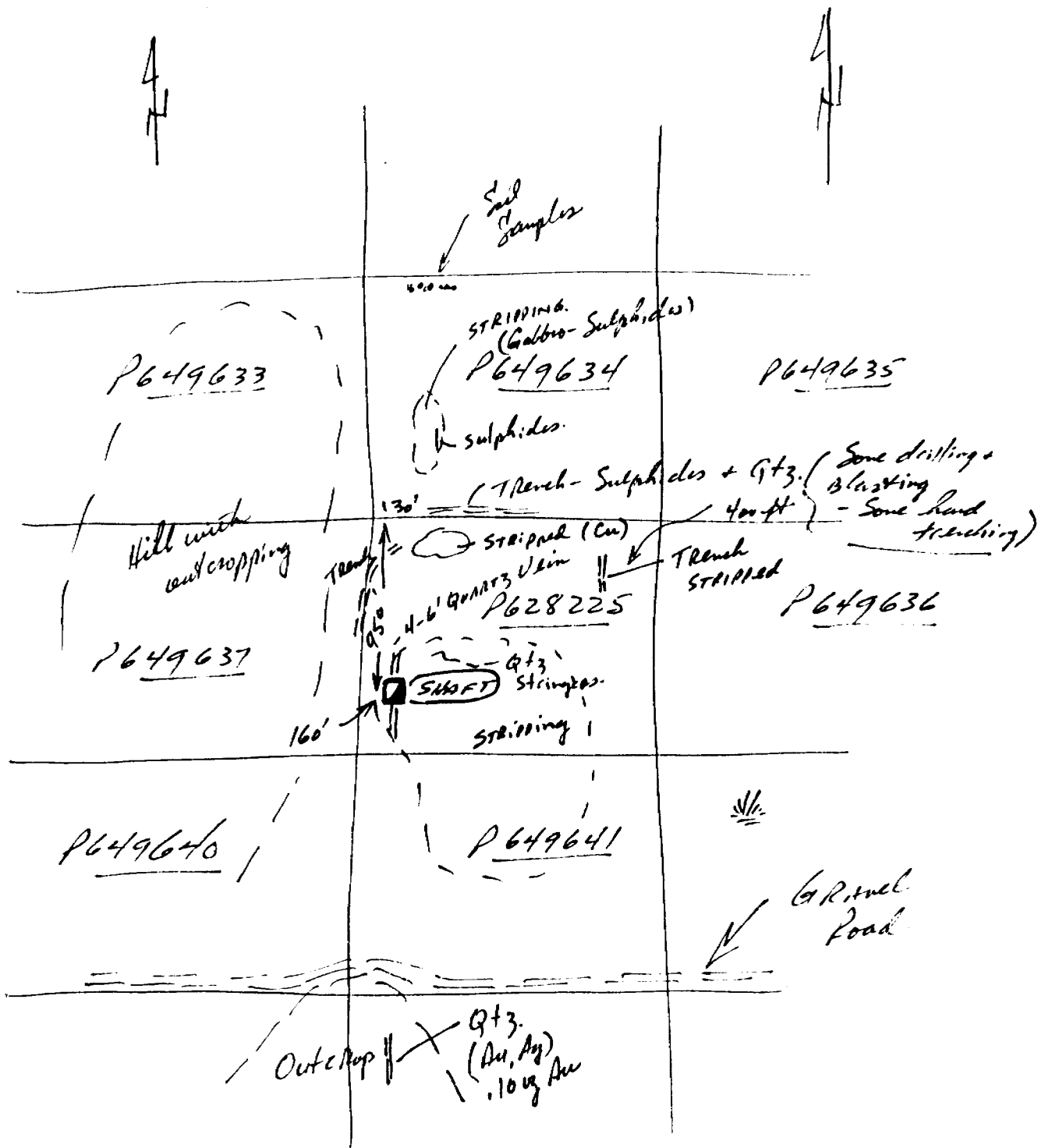

SHIP LIES WITHIN THE MUNICIPALITY
CITY OF TIMMINS

Massey TP.

FORCUPINE MINING DIVISION
RECEIVED
JUN 17 1985

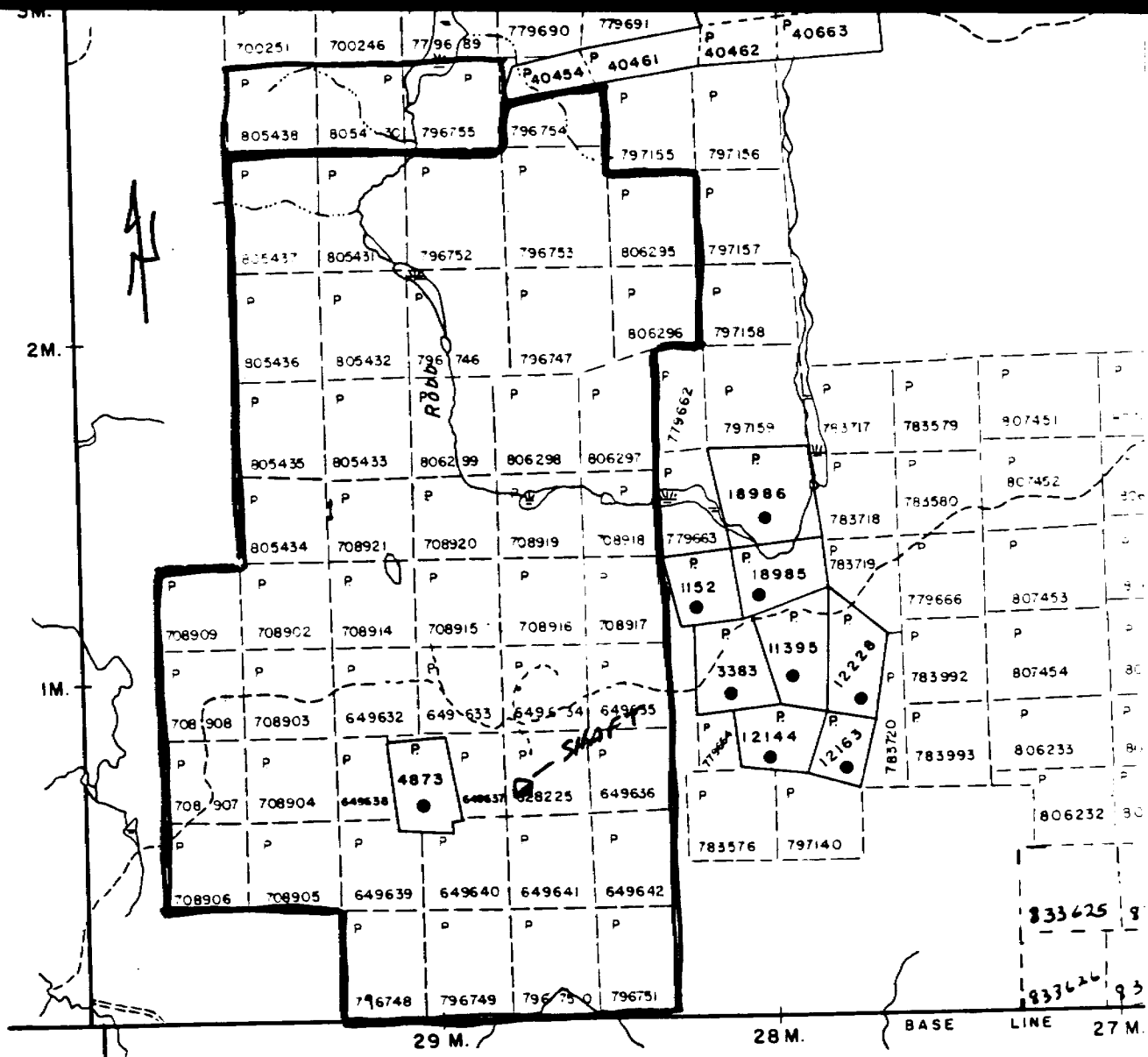

K. Koldamov

Carscallen TP

July 2, 1986

File: 2.9142

655 Group Holdings Ltd
680 Dieppe Street
c/o P.O. Box 216
Timmins, Ontario
P4N 7C9

Dear Sirs:

RE: Data for Assaying and Underground Mapping
submitted on Mining Claims P 628225, et al,
in the Township of Turnbull

In order to complete the above-described submission, the following information is required:

1. a key map (in duplicate) showing the shaft location in relation to claim lines and claim numbers.
2. verification of payment for the \$33,178.52 expenditure credits claimed. Attached is a list of acceptable forms of proof of payment.

When submitting this material, please quote file 2.9142.

For further information, please contact Mr. Dennis Kinvig at (416) 965-4888.

Yours sincerely,

J.C. Smith, Supervisor
Mining Lands Section

Whitney Block, 6th Floor
Queen's Park
Toronto, Ontario
M7A 1W3

Telephone: (416) 965-4888

DK/mc

cc: E.A. Gallo
148 Allanhurst Drive
Islington, Ontario
M9A 4K7

Mining Recorder
Timmins, Ontario
#117, 118, 124/86

Encl.



Mining Lands Comments

Clearance 3

They have performed underground mapping & asked for credit under section 77(19). Should this be assessed for geological credits instead? Any other comments appreciated.
Dennis King

To: Geophysics

Comments

Approved Wish to see again with corrections

Date

Signature

To: Geology - Expenditures

Comments
Dennis: Fits more under section 77(19).
We need a claim map showing where the shaft location & the rest of the property claims to which this work applies

Approved Wish to see again with corrections

Date

Signature

June 18/86

Keestra

To: Geochemistry

RE: 67

Comments
MINING LANDS SECTION

Approved Wish to see again with corrections

Date

Signature

To: Mining Lands Section, Room 6610, Whitney Block.

(Tel: 5-4888)

R. of. W.
#124/86

Superior Contracting

Electrical & Mechanical Installations

PHONE (705) 268-6666
P.O. Box 2170
TIMMINS, ONTARIO
P4N 7X8

December 31, 1985

File #TM497

Invoice #121385

Skytron Exp. & Dev. Ltd.
Box 216
Timmins, Ontario
P4N 7C9

*GEN. CONTRACTOR!
For Turnkey Turp
Exploration project.*

Re: Delbridge Mines Account
Purchase Order #85-1214

Billing for material, labour and equipment rental to the
period ended December 28, 1985.

Labour

Foreman	4 hrs. @ 32.50	\$ 130.00	
Miner	72 hrs. @ 26.00	1872.00	
Helpers	104 hrs. @ 21.00	<u>2184.00</u>	\$ 4186.00

Equipment Rental

As per attached "A" 3934.05

Material

As per attached "B" 1956.26

Total This Invoice \$10076.31

Thank You

Superior Contracting

Superior Contracting

Electrical & Mechanical Installations

PHONE (705) 268-6666

P.O. Box 2170

TIMMINS, ONTARIO

P4N 7X8

December 31, 1985

File #TM497

Invoice #121285

Attachment "A" - Equipment Rental

1 325 cfm compressor
1 header
1 air pump
100 ft. water hose
1 tugger

2 drills
2 2 ft shanks
2 4 ft shanks
2 6 ft shanks
1 lubricator
1 8 ft shank

1 barrel pump

100 ft hose

1 delco

misc. tools & heaters

Total equipment rental

\$3934.05

Superior Contracting

Electrical & Mechanical Installations

PHONE (705) 268-6666

P.O. Box 2170

TIMMINS, ONTARIO

P4N 7X8

December 31, 1985

File #TM497

Invoice #121385

Attachment "B" - Material

100 ft 2" plastic hose

diesel fuel

air fittings

12 2 x 10 x 16

11 ladders

3 bundles wedges

1 roll wire

4 rolls snow fence

6 2 x 6 x 16

10 pces. 25mm rebar

4 rainsuits

2 #341 rubber gloves

2 #1915 rubber gloves

1 J105 plastic can

1 #992 kleen flo diesel fuel container

2 5/16 cable clips

3 3/8 cable clips

2 1L 10W30

1 #731 eveready

4 HS32E hose clamps

12 150 amp bulbs

8 rainwear

6 hard hat liners

50 1 x 3 x 8 plugs

8 2 x 10 x 16

4 2 x 6 x 16

Total materials

\$1956.26

R. of W.
#117/86

Superior Contracting

Electrical & Mechanical Installations

PHONE (705) 268-6666
P.O. Box 2170
TIMMINS, ONTARIO
P4N 7X8

January 17, 1986

File #TM497

Invoice #186-11

Skytron Exp. & Dev. Ltd.
P.O. Box 216
Timmins, Ontario
P4N 7C9

*GENERAL CONTRACTOR
FOR FIELD EXPLORATION
FOR Tumbull Twp
Property*

Re: Delbridge Mines Account
Purchase Order #85-1214

Billing for labour, (to Jan. 14) equipment, (to Jan. 10) and
material to completion of our services.

Labour

Miner	140 reg. hrs.	@ 26.00	\$3640.00	
	70½ prem hrs	@ 39.00	2749.50	
Helper	164½ reg hrs	@ 21.00	3454.50	
	40½ prem hrs	@ 31.50	<u>1275.75</u>	\$11119.75

Equipment as per schedule "A" attached 5255.27

Materials as per schedule "B" attached 921.19

Total This Invoice \$17296.21

Thank You

Superior Contracting

Superior Contracting

Electrical & Mechanical Installations

PHONE (705) 268-6666

P.O. Box 2170

TIMMINS, ONTARIO

P4N 7X8

January 17, 1986

File #TM497

Invoice #186-11 Schedule "A"

1 325 cfm compressor
1 header
1 air pump
100 ft hose
1 tigger

2 drills
150 ft 1" hose
2 2' shanks
2 4' shanks
2 6' shanks
1 lubricator
1 8' shank

1 barrel pump

100 ft air hose

1 delco

Misc. tools & heaters

1 air pump
100 ft air hose
1 45 gal drum
1 air pump(loan)

100 ft 3" hose

450 ft air hose

\$5255.27

Superior Contracting

Electrical & Mechanical Installations

PHONE (705) 268-6666

P.O. Box 2170

TIMMINS, ONTARIO

P4N 7X8

January 17, 1986

File #TM497

Invoice #186-11 Schedule "B"

Diesel fuel

Oil

"T" Straps

24 ear plugs
2 tins spray paint
18 light bulbs
4 spencer sockets
6 cable clamps

\$921.19

Superior Contracting

Electrical & Mechanical Installations

PHONE (705) 268-6666
P.O. Box 2170
TIMMINS, ONTARIO
P4N 7X8

December 18, 1985

File #TM497C

Invoice #121185

Skytron Exp. & Dev. Ltd.
Box 216
Timmins, Ontario
P4N 7C9

Gen. Contractor

Re; Delbridge Mines Account
Purchase Order #85-1214

Billing for material, labour and equipment rental as per the following and in accordance with our quotation of December 10, 1985.

Labour

Foreman	10 hrs. @ 32.50	\$325.00	
Miner	31 hrs. @ 26.00	806.00	
Helper	31 hrs. @ 21.00	<u>651.00</u>	\$1782.00

Material

1	case 3½ nails		
1	roll poly		
20	2 x 4 x 8		
20	1 x 2 x 8		
1	sheet 5/8/ waferboard		
1	chain oil		
1	starting fluid		
1	gas line antifreeze		
45	gal. diesel fuel		
40	litres rock drill oil		
2	100 lb. propane	<u>\$508.48</u>	508.48

.....2

Superior Contracting

Electrical & Mechanical Installations

PHONE (705) 268-6666

P.O. Box 2170

TIMMINS, ONTARIO

P4N 7X8

December 18, 1985

2

File #TM497C

Invoice #121185

Equipment

1	325 cfm compressor		
1	header		
1	air pump		
100	ft. hose		
1	tugger		
2	drills		
150	ft. 1" hose		
2	2' shanks		
2	4' shanks		
2	6' shanks		
1	lubricator		
1	8' shank		
1	truck		
Misc.	tools & heaters as attached	<u>\$1343.12</u>	1343.02

Total This Invoice

\$3633.50

Thank You

Superior Contracting

143
EZ

R.f.w. 12557
#118/86

SWASTIKA LABORATORIES LIMITED

10, SWASTIKA, ONTARIO P0K 1T0 TELEPHONE: (705) 642-3244

DeLbridge Mines Limited
c/o Skytron Exploration & Development Ltd.
Box 216
Timmins, Ontario
P4N 7C9

S
H
I
P
T
O

1.5% late charge over 30 days
annual rate 18%

DATE	SHIPPED VIA	FED LICENCE NO	PROV LICENCE NO	YOUR ORDER NO	OUR ORDER NO	TERMS	SALESMAN
Jan. 24/86							
QUANTITY	DESCRIPTION					UNIT PRICE	AMOUNT
87	Au Assays PPB					\$ 8.50	\$ 739.50
87	Sample handling					2.75	239.25
	Cert. No. 62162 Jan. 17/86 Mr. Onotsky						
32	Au Assays PPB					8.50	272.00
32	Sample handling					2.75	88.00
	Cert. No. 62163 Jan. 20/86						
Total							\$ 1338.75

MOORE BUSINESS FORMS 3 7060E

ANALYTICAL CHEMISTS • ASSAYERS • CONSULTANTS



FACTURE / INVOICE

ESTABLISHED 1928

12	13	15	1	TORONTO	UN	416	245	3511	8	.75
12	13	CS	6	TORONTO	UN	416	245	3511	8	3.90

.75
3.90

T DUREE ET FRAIS DONNES
X NON TAXABLE

COUNT DUE WHEN RENDERED / COMPTE DU SUR RECEPTION

*DeLbridge
Inv # 84258*

4645

ERS (ONTARIO) LIMITED

LAUNCEY AVENUE, TORONTO, ONTARIO M8Z 2Z2 . TELEPHONE (416) 239-3527

Exploration Services Inc.,
 Attention: Mr. E.A. Gallo,
 Allanhurst Drive,
 BRIMLEY, Ontario
 M9A 4K7

SHIP TO

9/86		SHIPPED VIA	FED LICENCE NO	PROV LICENCE NO	YOUR ORDER NO	OUR ORDER NO	TERMS Net 30	SALES REP.
QUANTITY	DESCRIPTION					UNIT PRICE	AMOUNT	
30	Assays Au					\$ 8.50	\$ 255.00	
30	Sample Prep					2.75	82.50	
Cert. No. GA-33 Jan. 9/86								
25	Assays Au					8.50	212.50	
25	Sample Prep					2.75	68.75	
Cert. No. GA-34 Jan. 9/86								
TOTAL							\$ 618.75	

SPEEDPLY - 3 - MOONCLEANPRINT PATENTED 1983 1984 7060E

pd. Jan 20/86

INVOICE

FACTURE / INVOICE

ESTABLISHED 1928

21 13 15	1 TORONTO	UN	410	245	3511	9	3.90	3.27	<input type="checkbox"/> TARIFF MONTREAL
21 13 09	6 TORONTO	UN	416	245	3511	8	3.90	3.90	<input type="checkbox"/> TARIFF MONTREAL
CALLS							APPELS		<input checked="" type="checkbox"/> NON TAXABLE

AMOUNT DUE WHEN RENDERED / COMPTE DU SUR RECEPTION

*DE 2 Bridge
 Inv # 84258*

timmins

Analytical Services
P.O. Box 842
McIntyre Road
Schumacher, Ontario
Canada P0N 1G0
Phone 705-264-5111

SOLD TO Skytron Exploration

DATE: December 12, 1985

P.O. Box 216

INVOICE NO: A - 289 - 85

Timmins, Ont. P4N 7C9

PURCHASE NO: _____

Attn: Mr. Robert Onotsky

PLEASE RETURN ONE COPY OF INVOICE WITH PAYMENT.

1	Suspended Solids @ \$6.00	\$ 6.00
1	Dissolved Solids @ \$6.00	6.00
1	Conductivity @ \$4.00	4.00
1	PH @ \$3.50	3.50
1	Alkalinity @ \$5.00	5.00
1	Sulphate @ \$8.00	8.00
1	Ammonia @ \$12.00	12.00
1	Cu @ \$6.50	6.50
4	Base Metals @ \$4.25	17.00
	<i>paid # 911 Jan 17/86</i>	\$68.00
	6999-9178	

PAP 10112

TOTAL AMOUNT OWING: \$14.15

(TERMS: Net: 15 Days - 2% Interest on Overdue Accounts)

*Skytron
- Delbridge*

timmins

Analytical Services
P.O. Box 842
McIntyre Road
Schumacher, Ontario
Canada P0N 1G0
Phone 705-264-5111

SOLD TO Delbridge Mines Limited, DATE January 8, 1986
P.O. Box 216, INVOICE NO. 2-3-86
Timmins, Ontario, P4N 7C9 PURCHASE NO.
ATTENTION: ROBERT ONOTSKY

PLEASE RETURN ONE COPY OF INVOICE WITH PAYMENT.

- 14 Au @ \$8.50 Ea.
- 14 Handling @ \$2.00 Ea.

\$119.00

\$ 28.00

TOTAL: \$147.00

6999-9178
P.A.P. 10112

INDUSTRY'S ONE-STOP SERVICE...
INCLUANT TUNNELS, PONTS ET BRANCHES D'ARBRES.

17 PERSONAL ACCIDENT INSURANCE (PAI) - ASSURANCE ACCIDENT PERSONNELLE (AAP)
CUSTOMER ACCEPTS OR DECLINES PAI AT RATE SHOWN IN SEPARATE BROCHURE. ACCEPTANCE IS PROOF OF COVERAGE UNDER POLICY ISSUED TO TILDEN AS OUTLINED ON SEPARATE BROCHURE.
LE CLIENT ACCEPTE OU REFUSE AAP AUX FRAIS APPARAISSANT DANS LA BROCHURE SEPARÉE. LE CONSENTEMENT EST LA PREUVE DE COUVERTURE SOUS LA POLICE ÉMISE À TILDEN COMME INDIQUÉ SUR LA BROCHURE SEPARÉE.

ACCEPTS PAI / ACCEPTE AAP INITIAL ONE - INITIALEZ UNE CASE DECLINES PAI / REFUSE AAP

18 CUSTOMER AUTHORIZES TILDEN TO PROCESS A CREDIT CARD VOUCHER, IF ANY, IN HIS/HER NAME FOR CHARGES HEREUNDER. I HAVE READ THE TERMS AND CONDITIONS ON BOTH SIDES OF THIS RENTAL AGREEMENT AND I AGREE THERETO.
LE CLIENT AUTORISE TILDEN À ÉMETTRE UN TALON DE CARTE DE CREDIT, S'IL Y A LIEU, EN SON NOM POUR LES FRAIS CI-DESSOUS. J'AI PRIS CONNAISSANCE DES CLAUSES ET CONDITIONS AUX DEUX CÔTÉS DE CE CONTRAT DE LOCATION ET JE LES ACCEPTE.

19 DRIVER'S NAME / NOM DU CHAUFFEUR
20 HOME ADDRESS / ADRESSE DOMICILE
21 CITY / VILLE
22 LOCAL ADDRESS / ADRESSE LOCALE
23 TELEPHONE / TÉLÉPHONE

*680 Dreppe St
TIMMINS, Ont
P4N 5K2*

TRAFFIC VIOLATIONS.
LE CLIENT EST TENU RESPONSABLE DE TOUTES INFRACTIONS DE STATIONNEMENT OU DE CIRCULATION.

49 DEPOSITS / DÉPÔTS

54 CASH REFUND / REMBOURSEMENT COMPTANT

I ACKNOWLEDGE RECEIPT OF ABOVE AMOUNT. J'ACCUSE RECEPTION DU MONTANT CI-HAUT MENTIONNÉ.

45 PAI / AAP	NIC
46 GASOLINE / ESSENCE	22.00
47 OTHER / AUTRES	17/80
48 TOTAL CHARGES / TOTAL DES FRAIS	1,153.8
50 LESS DEPOSITS / MOINS DÉPÔTS	
51 BALANCE DUE / SOLDE DUE	1153.8
52 CASH COMPTANT	
53 CHARGE À FACTURER	1153.8

RENTAL AGREEMENT IS CLOSED SUBJECT TO AUDIT. AVANT D'ÊTRE FINALISÉ CE CONTRAT DE LOCATION SERA SOUMIS À UNE VÉRIFICATION.

AVANT D'ÊTRE FINALISÉ CE CONTRAT DE LOCATION SERA SOUMIS À UNE VÉRIFICATION.

PERSONAL RENTAL CAR

TO-84546

REFERENCES

AREAS WITHDRAWN FROM DISPOSITION

- M.R.O. - MINING RIGHTS ONLY
- S.R.O. - SURFACE RIGHTS ONLY
- M.+S. - MINING AND SURFACE RIGHTS

Description Order No. Date Disposition File

NOTES

THIS TOWNSHIP LIES WITHIN THE MUNICIPALITY OF THE CITY OF TIMMINS.

RECEIVED
JUN 23 1986



Robb TP.

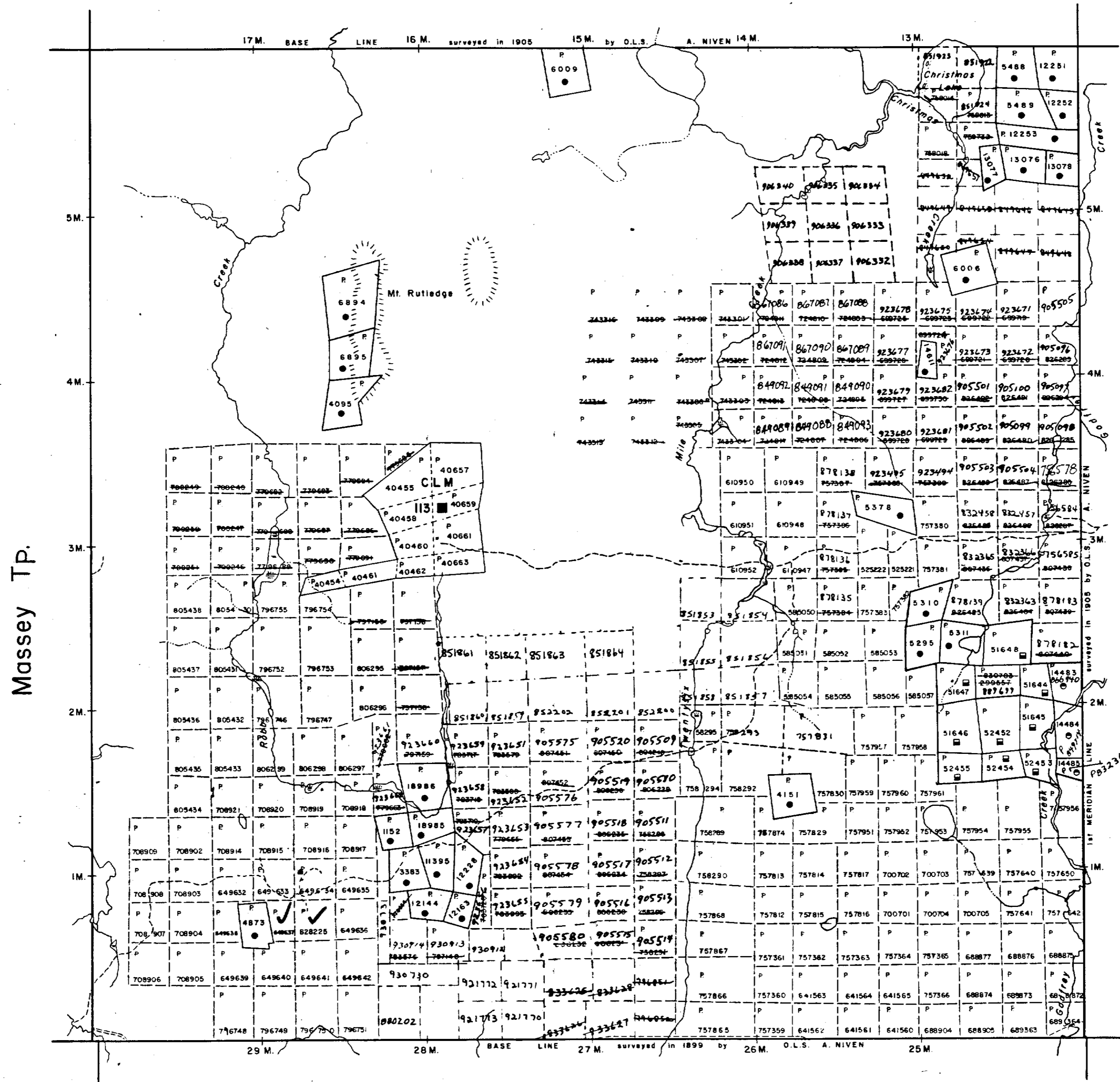

LEGEND

- HIGHWAY AND ROUTE No.
- OTHER ROADS
- TRAILS
- SURVEYED LINES:
 - TOWNSHIPS, BASE LINES, ETC.
 - LOTS, MINING CLAIMS, PARCELS, ETC.
- UNSURVEYED LINES:
 - LOT LINES
 - PARCEL BOUNDARY
 - MINING CLAIMS ETC.
- RAILWAY AND RIGHT OF WAY
- UTILITY LINES
- NON-PERENNIAL STREAM
- FLOODING OR FLOODING RIGHTS
- SUBDIVISION OR COMPOSITE PLAN
- RESERVATIONS
- ORIGINAL SHORELINE
- MARSH OR MUSKEG
- MINES
- TRAVERSE MONUMENT

DISPOSITION OF CROWN LANDS

TYPE OF DOCUMENT	SYMBOL
PATENT, SURFACE & MINING RIGHTS	●
" SURFACE RIGHTS ONLY	○
" MINING RIGHTS ONLY	◐
LEASE, SURFACE & MINING RIGHTS	■
" SURFACE RIGHTS ONLY	□
" MINING RIGHTS ONLY	◑
LICENCE OF OCCUPATION	▼
ORDER-IN-COUNCIL	OC
RESERVATION	⊙
CANCELLED	⊘
SAND & GRAVEL	⊙

NOTE: MINING RIGHTS IN PARCELS PATENTED PRIOR TO MAY 6, 1913, VESTED IN ORIGINAL PATENTEE BY THE PUBLIC LANDS ACT, R.S.O. 1970, CHAP. 380, SEC. 63, SUBSEC. 1.

SCALE: 1 INCH = 40 CHAINS

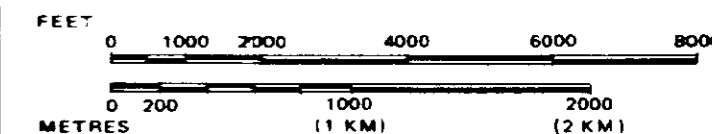

TOWNSHIP
TURNBULL
M.N.R. ADMINISTRATIVE DISTRICT
TIMMINS
MINING DIVISION
PORCUPINE
LAND TITLES / REGISTRY DIVISION
COCHRANE

Ministry of Natural Resources
Land Management Branch
Ontario

Date: MARCH 1985
Number: **G-3250**

6+00 W

5+00 W

4+00 W

3+00 W

2+00 W

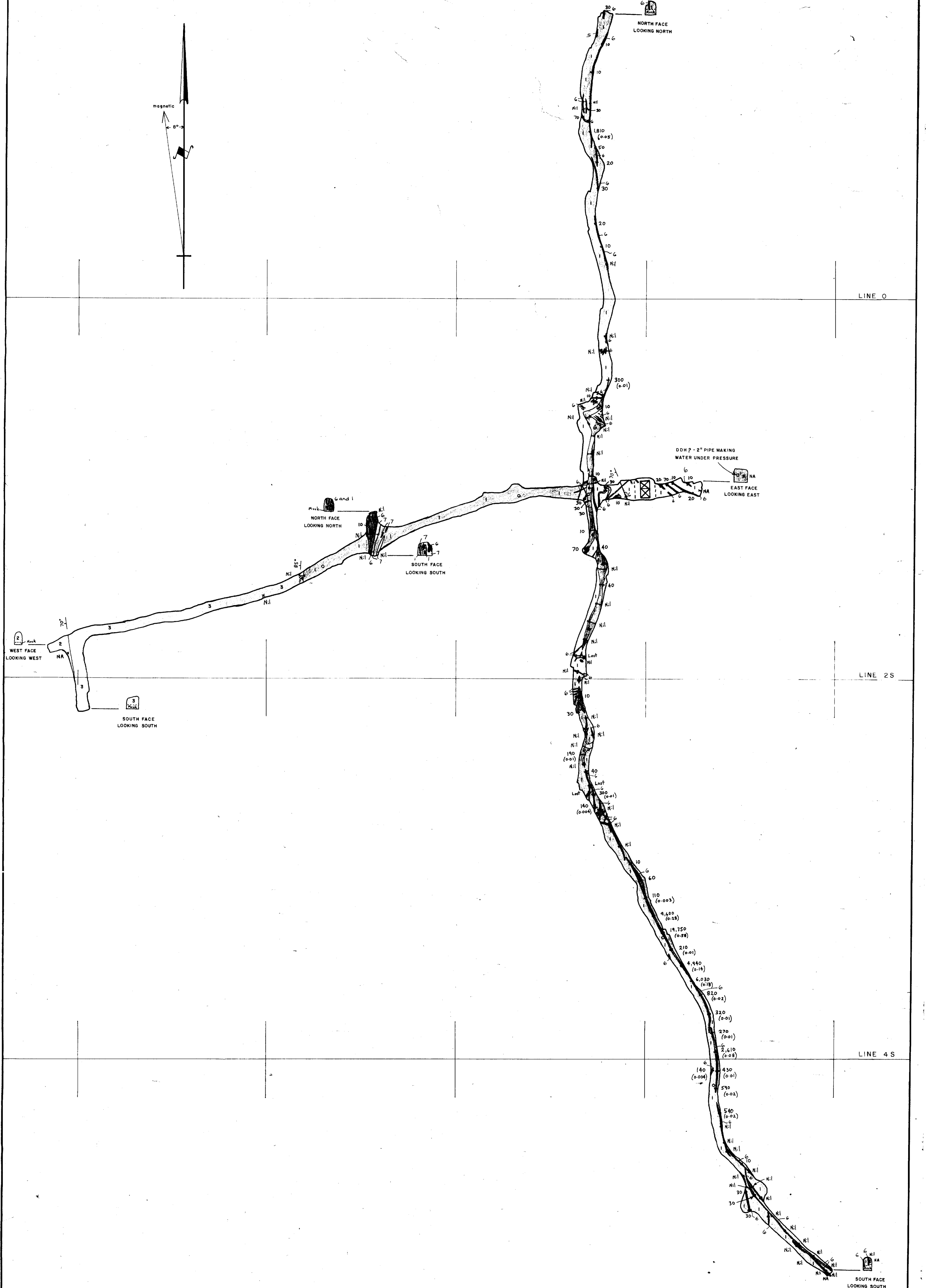
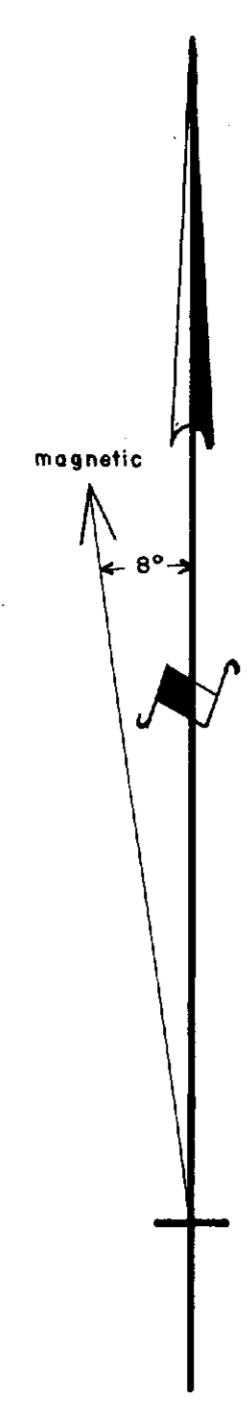

LEGEND

- 7 CARBONATE VEIN
- QUARTZ VEIN
- 5 FELSITE VEIN
- 4 SYENITE
- 3 DIABASE DYKE
- 2 GRANODIORITE
- GABBRO

SYMBOLS

- 60° STRIKE AND DIP
- o SURVEY STATION
- CHIP-CHANNEL SAMPLE
- 320 GOLD ASSAY RESULT IN PARTS PER BILLION (CONVERTED TO OZ./TON)
- x CHIP SAMPLE
- NA NOT ASSAYED
- FAULT

NOTE : SURVEY BY CHAIN AND COMPASS

DELBRIDGE MINES LTD. TORONTO, ONT.	
GEOLOGY AND ASSAY PLAN 125 LEVEL DE SANTIS PROPERTY TURNBULL TWP., ONT.	
DATE : Dec. 27, 1985	SCALE : 1" = 20'
DRAWN BY : EAG	MAP NO. 102

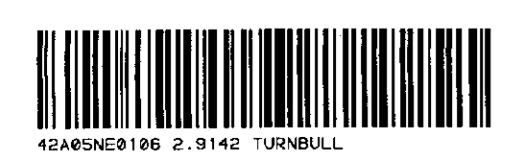

6+00 W

5+00 W

4+00 W

3+00 W

2+00 W

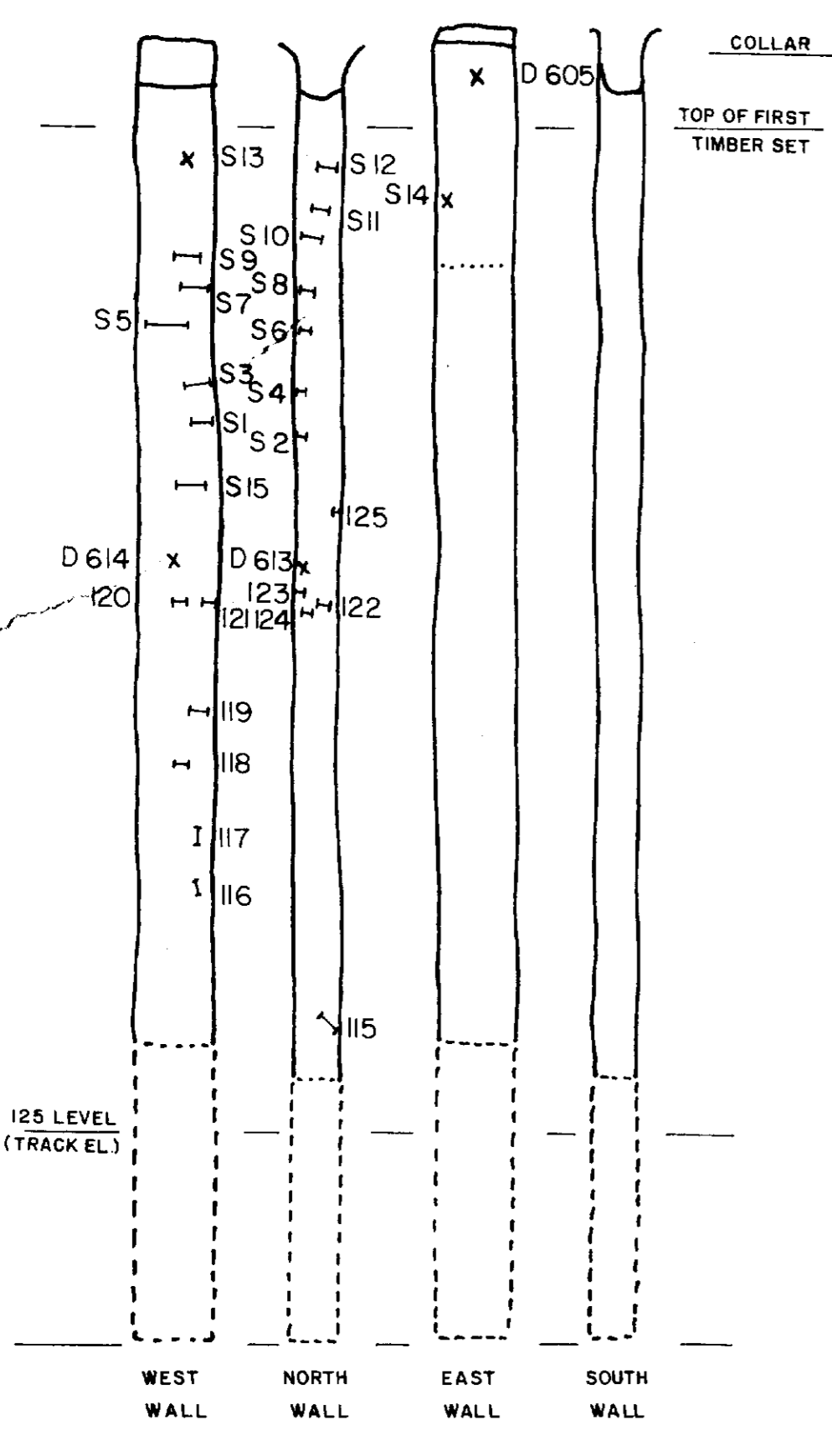
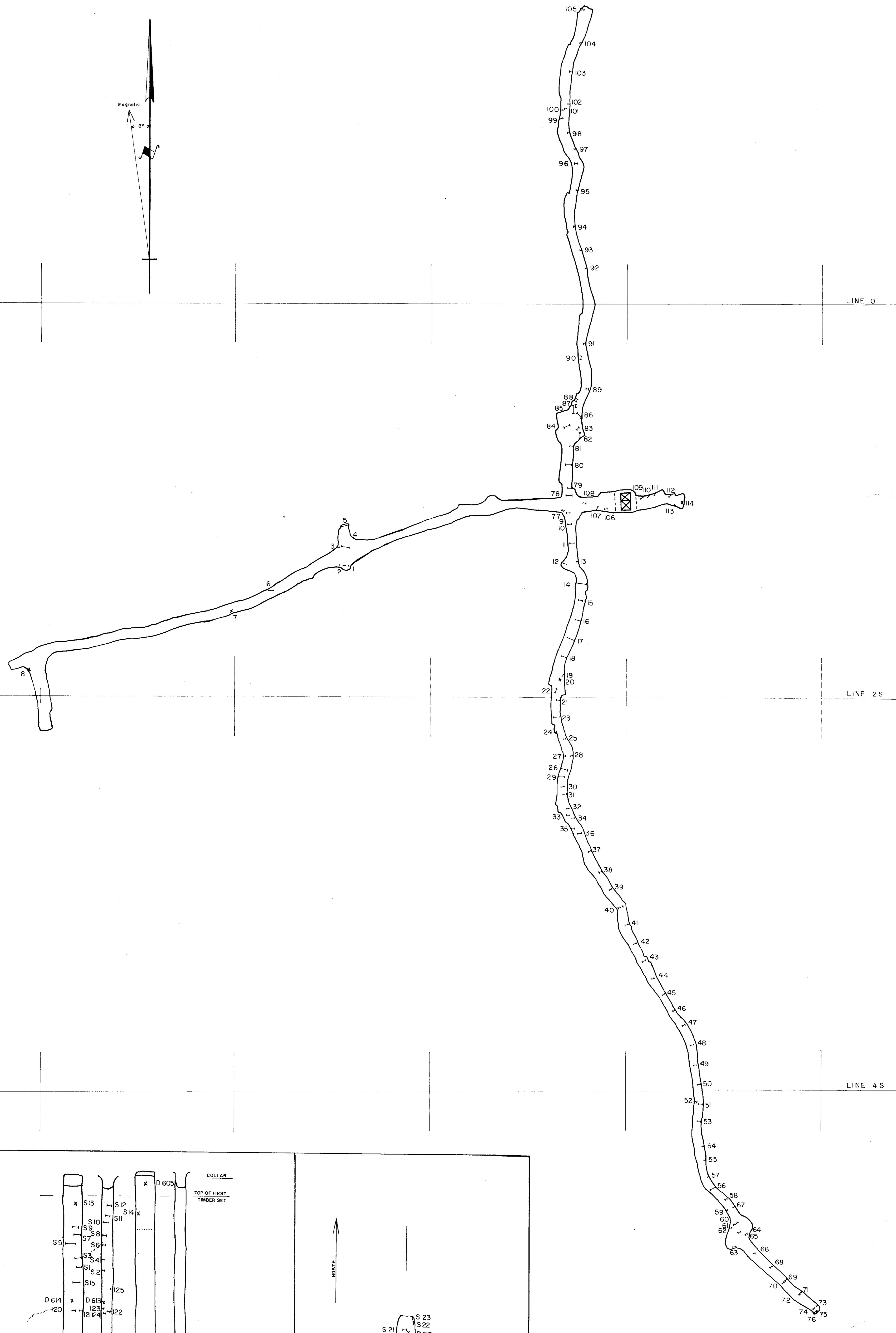
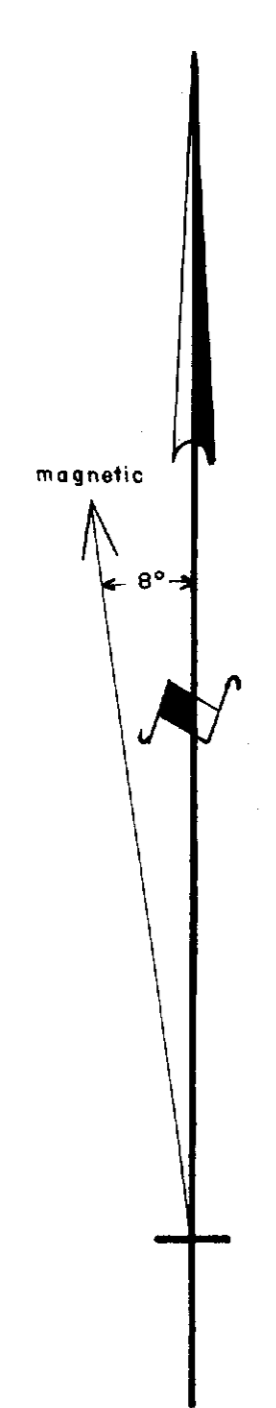

SHAFT SECTION
SCALE: 1" = 20'

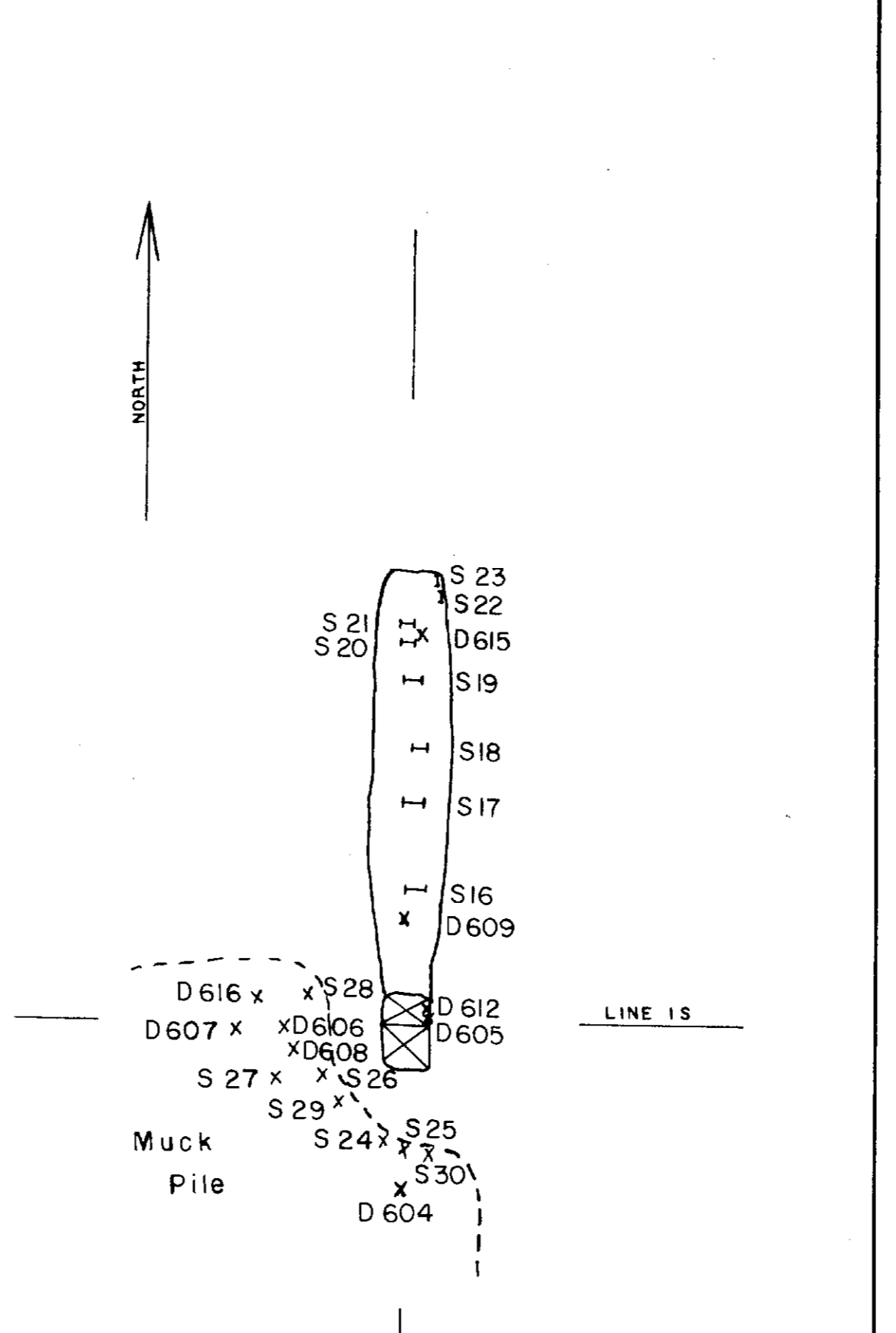

TRENCHED AREA
MAIN VEIN
SCALE: 1" = 20'

DELBRIDGE MINES LTD. TORONTO, ONT.	
SAMPLE LOCATIONS 125 LEVEL De SANTIS PROPERTY TURNBULL TWP., ONT.	
DATE: Dec. 27, 1985	SCALE: 1" = 20'
DRAWN BY: EAG	MAP NO. 107



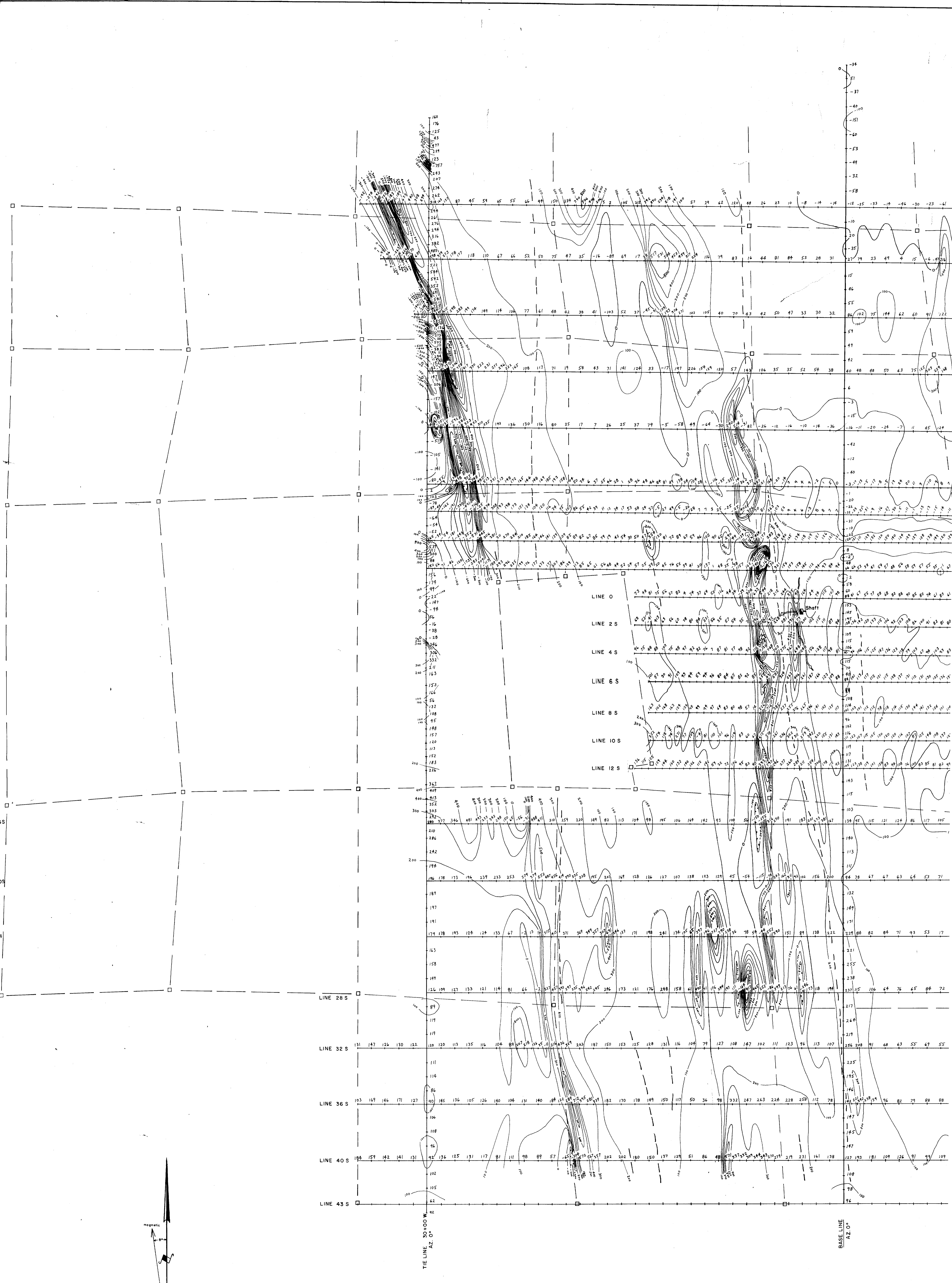

165
205
24

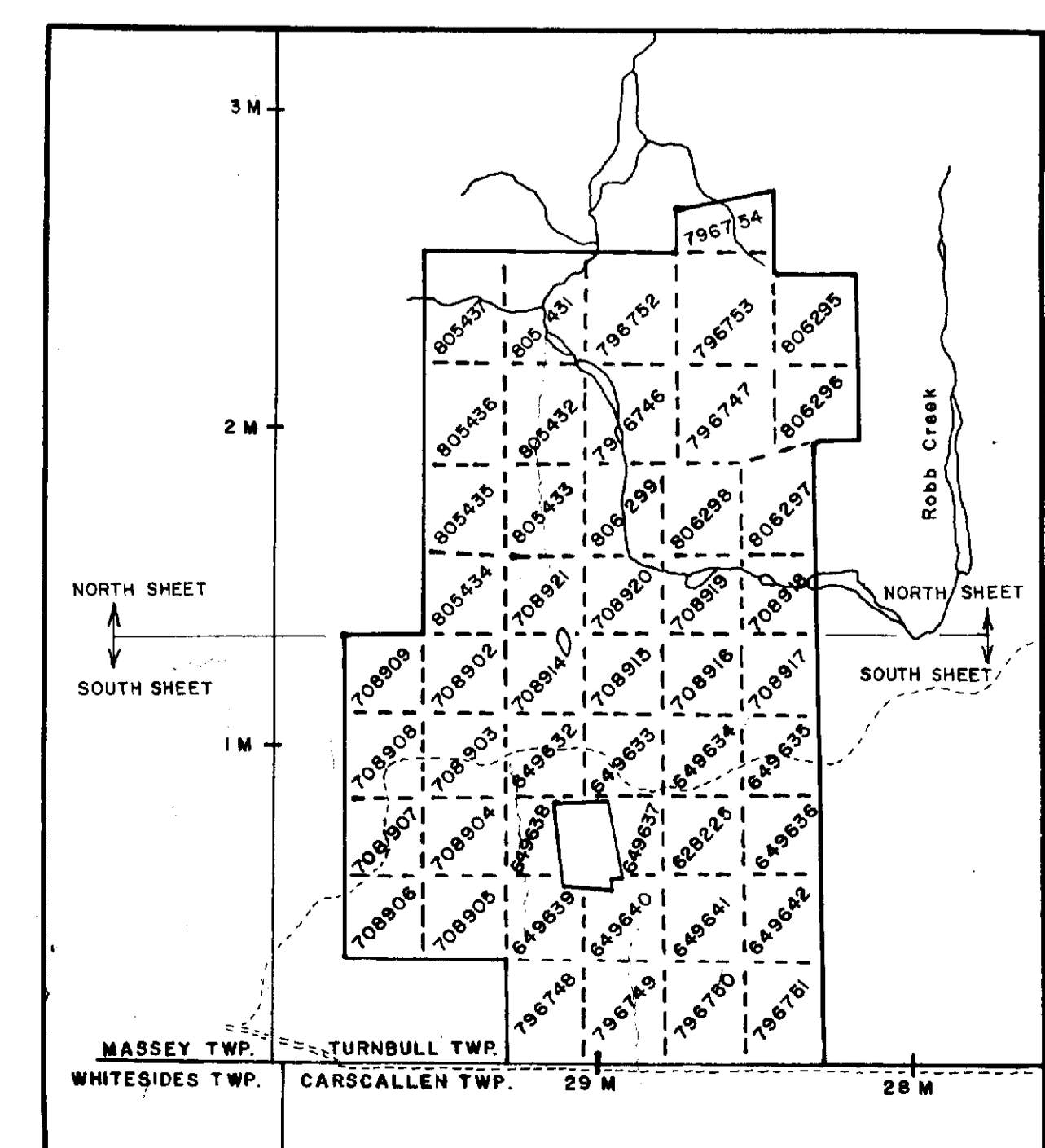

LOCATION SKETCH FROM CLAIM MAP G-3250
Scale: 1" = 1/2 Mile

LEGEND

- ISOMAGNETIC CONTOURS
- MAGNETIC DEPRESSION
- CONTOUR INTERVAL: 100 GAMMAS
- INSTRUMENT: GEOMETRICS G-816 PROTON PRECESSION MAGNETOMETER
- NOTE: ADD 59,000 GAMMAS TO EACH READING
- READINGS ARE DIRECTLY IN GAMMAS
- ELECTROMAGNETIC CONDUCTOR AXIS

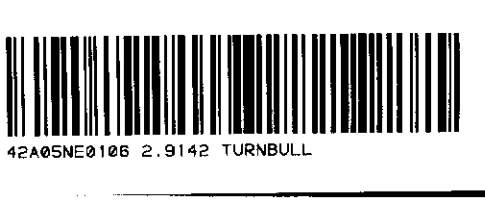

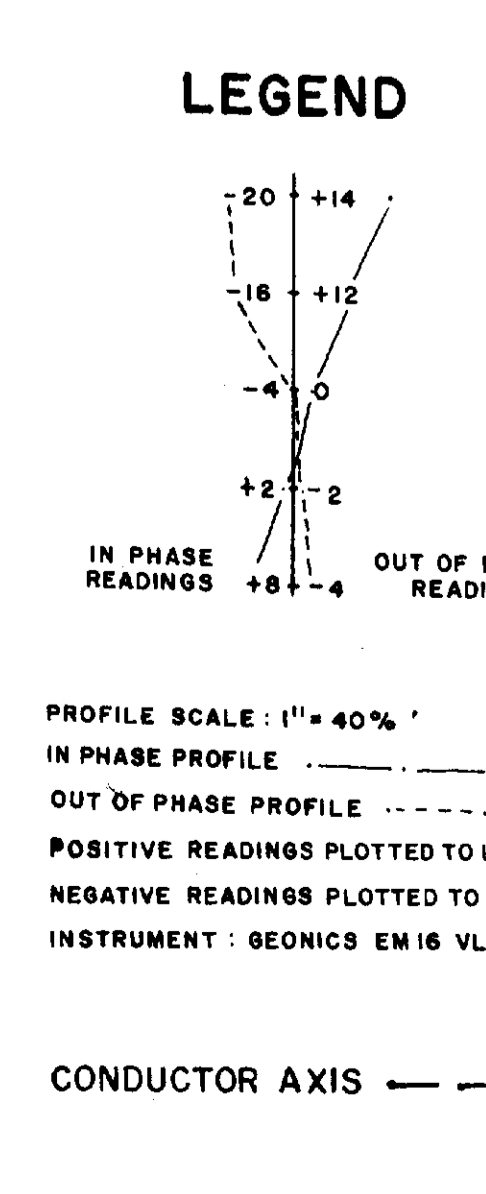
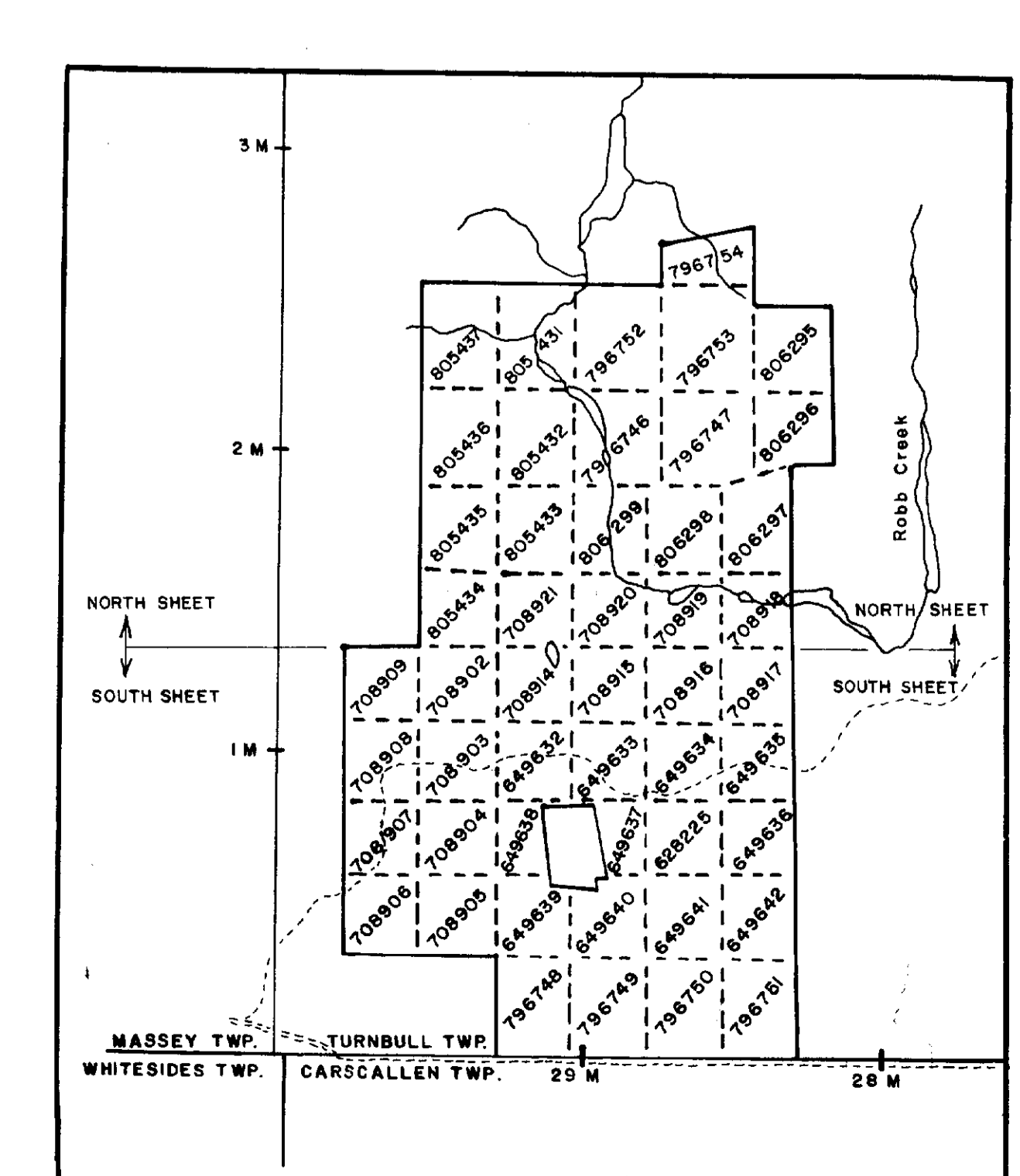
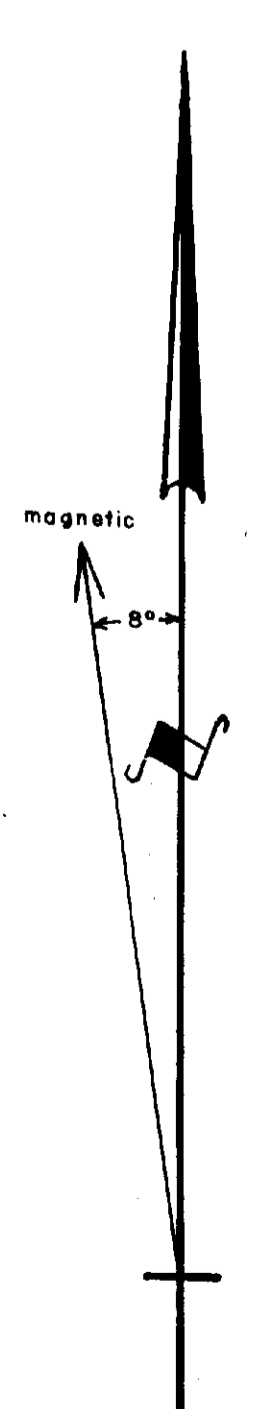
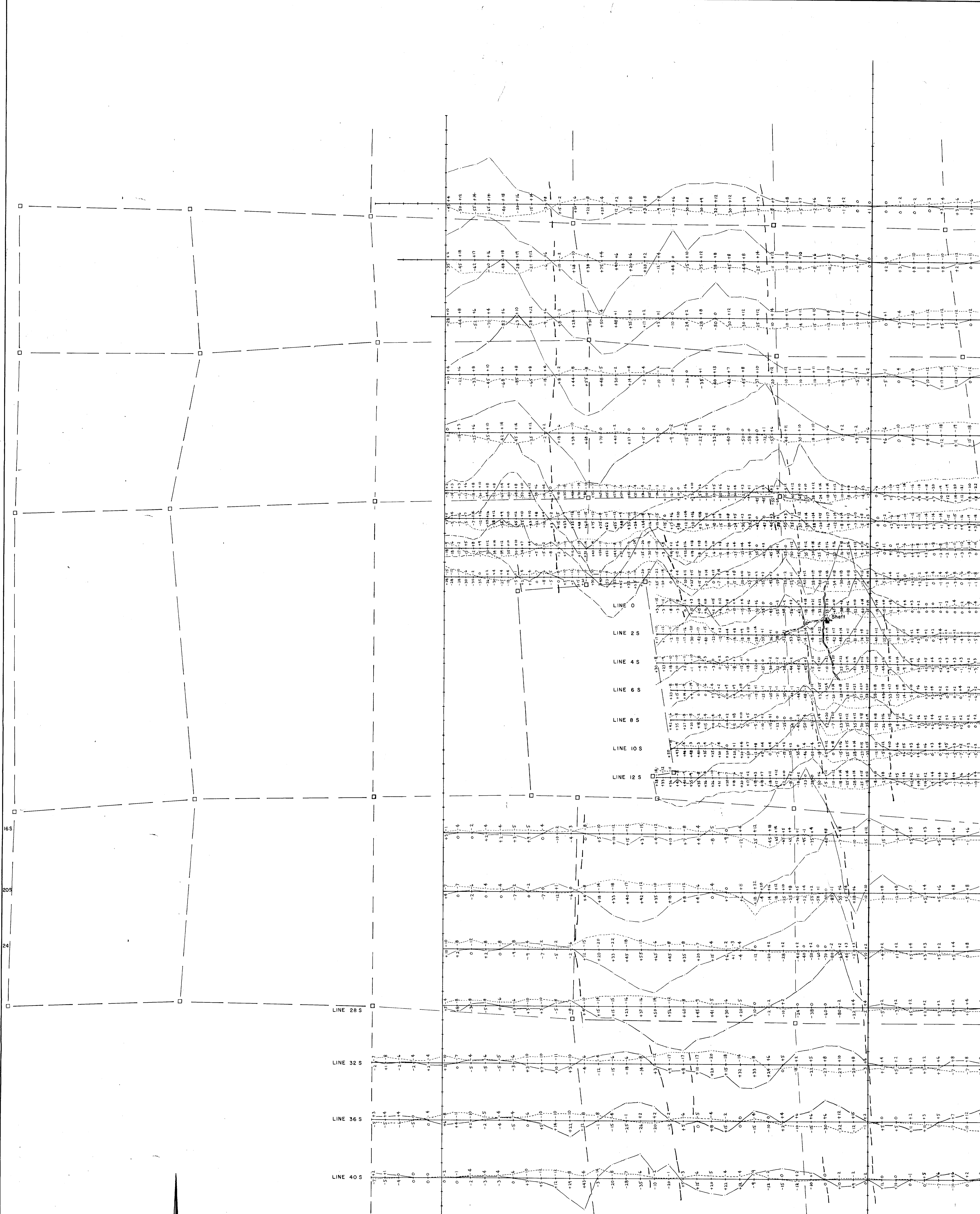

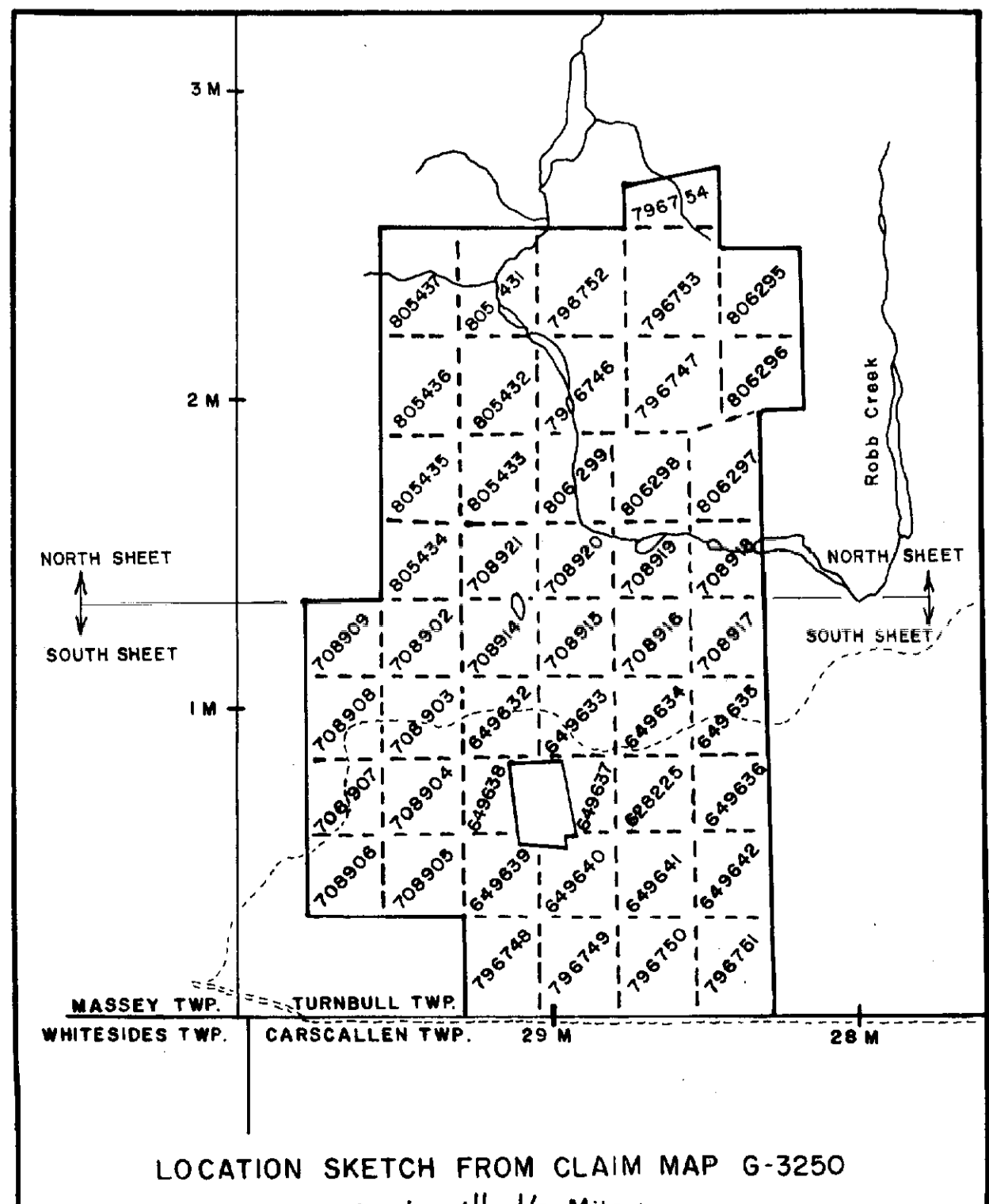
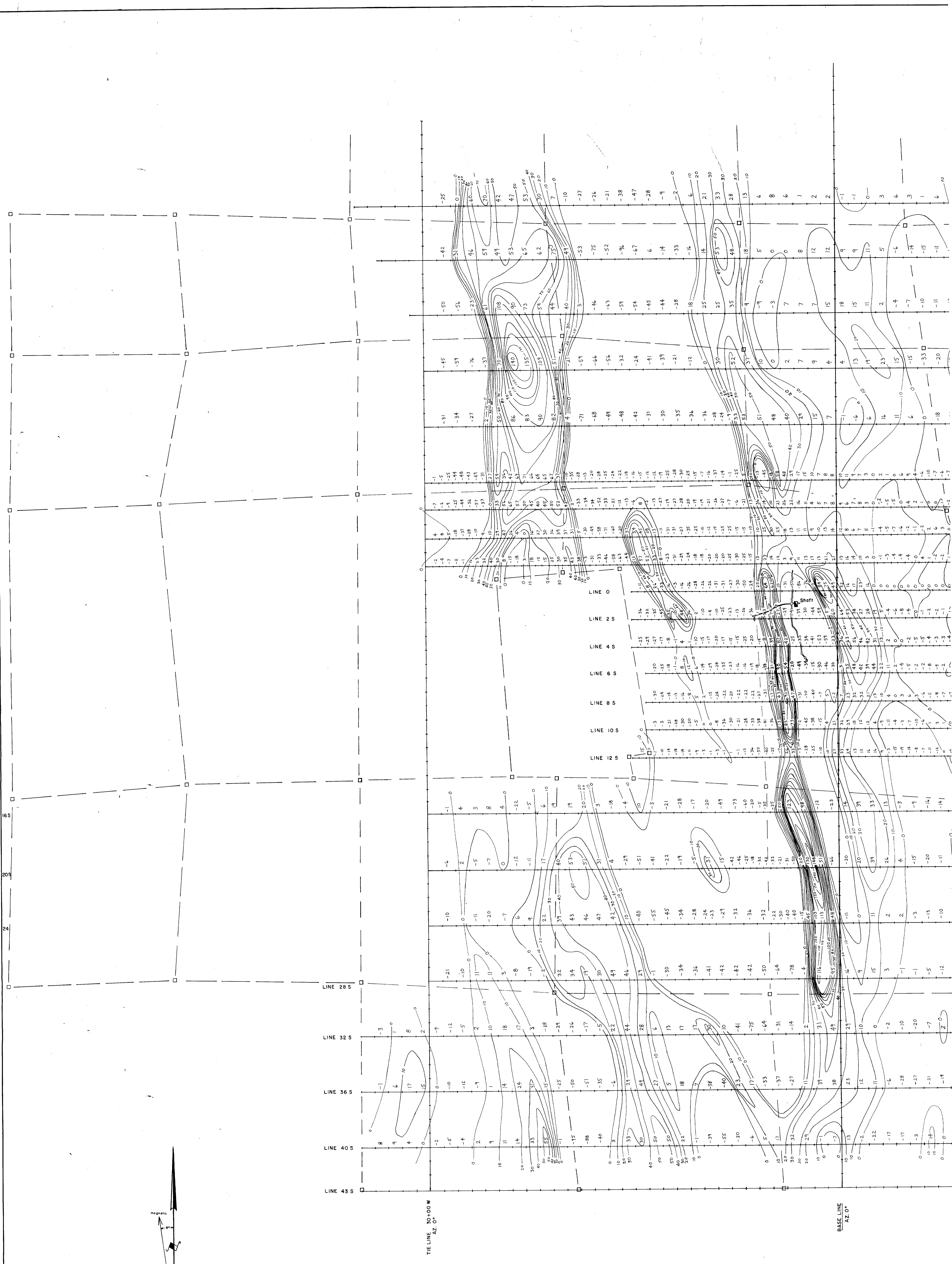

LEGEND

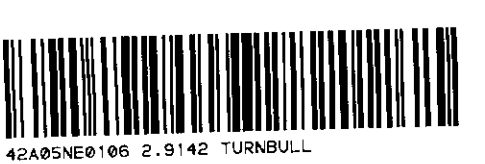
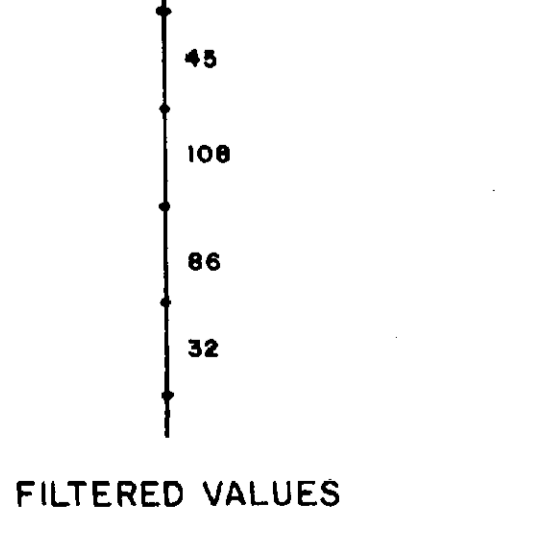

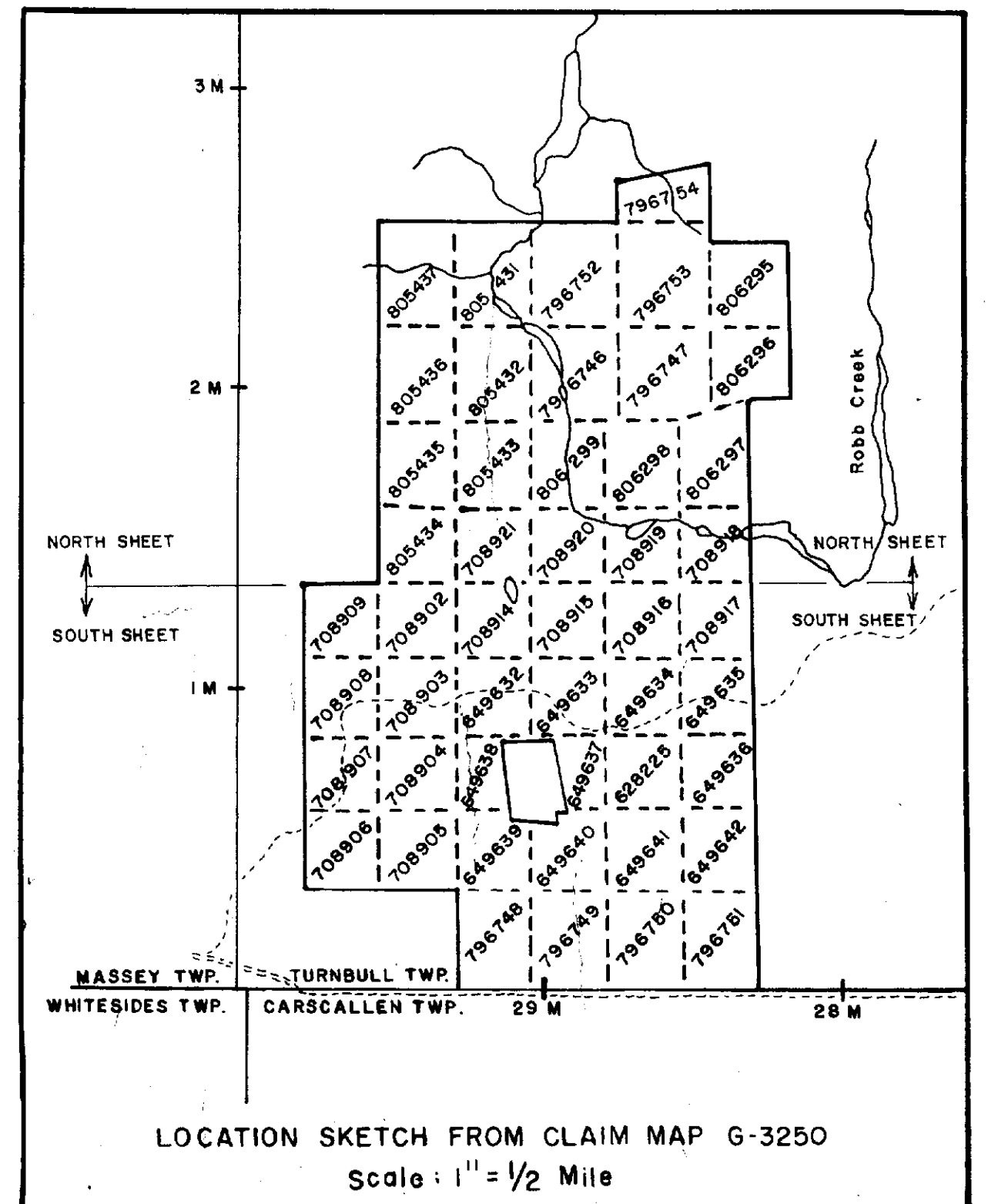
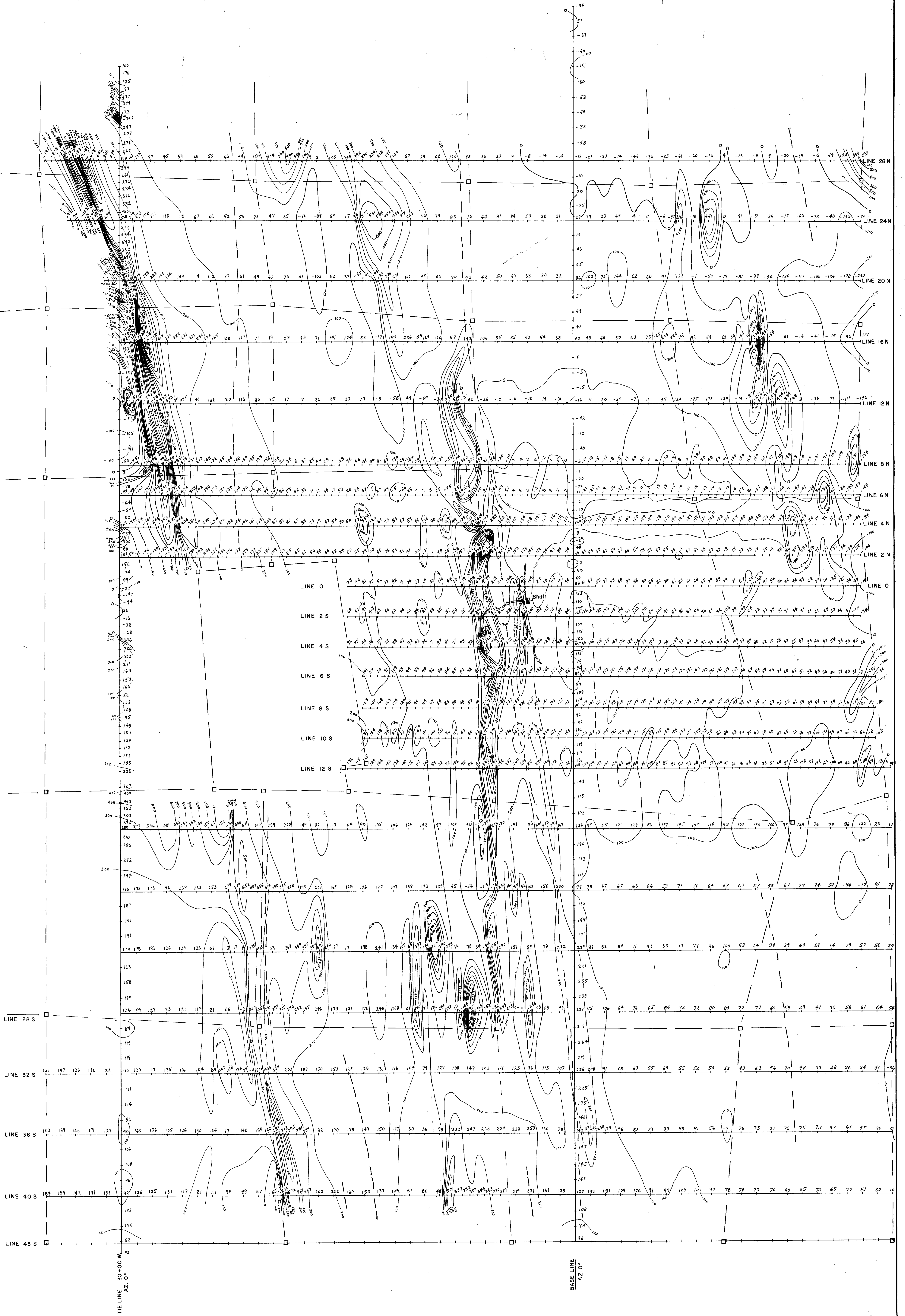

LEGEND

- ISOMAGNETIC CONTOURS
- MAGNETIC DEPRESSION
- CONTOUR INTERVAL: 100 GAMMAS
- INSTRUMENT: GEOMETRICS G-816 PROTON PRECESSION MAGNETOMETER
- NOTE: ADD 59,000 GAMMAS TO EACH READING
- READINGS ARE DIRECTLY IN GAMMAS
- ELECTROMAGNETIC CONDUCTOR AXIS

2.9142

DELBRIDGE MINES LTD. TORONTO, ONT.	
MAGNETOMETER SURVEY SOUTH SHEET De SANTIS PROPERTY TURNBULL TWP., ONT.	
DATE: Dec. 28, 1985	SCALE: 1" = 200'
DRAWN BY: EAG	MAP NO. 106

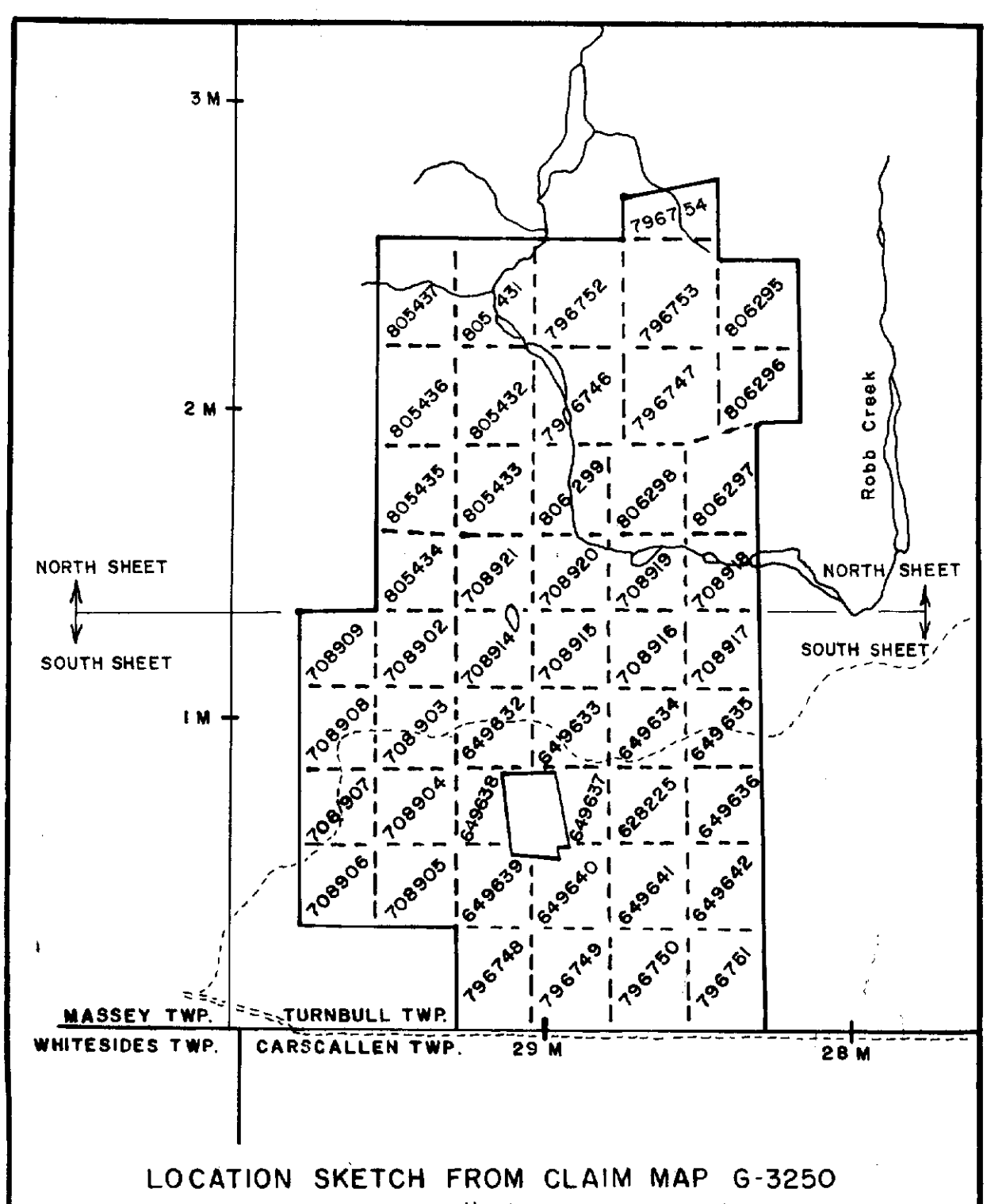
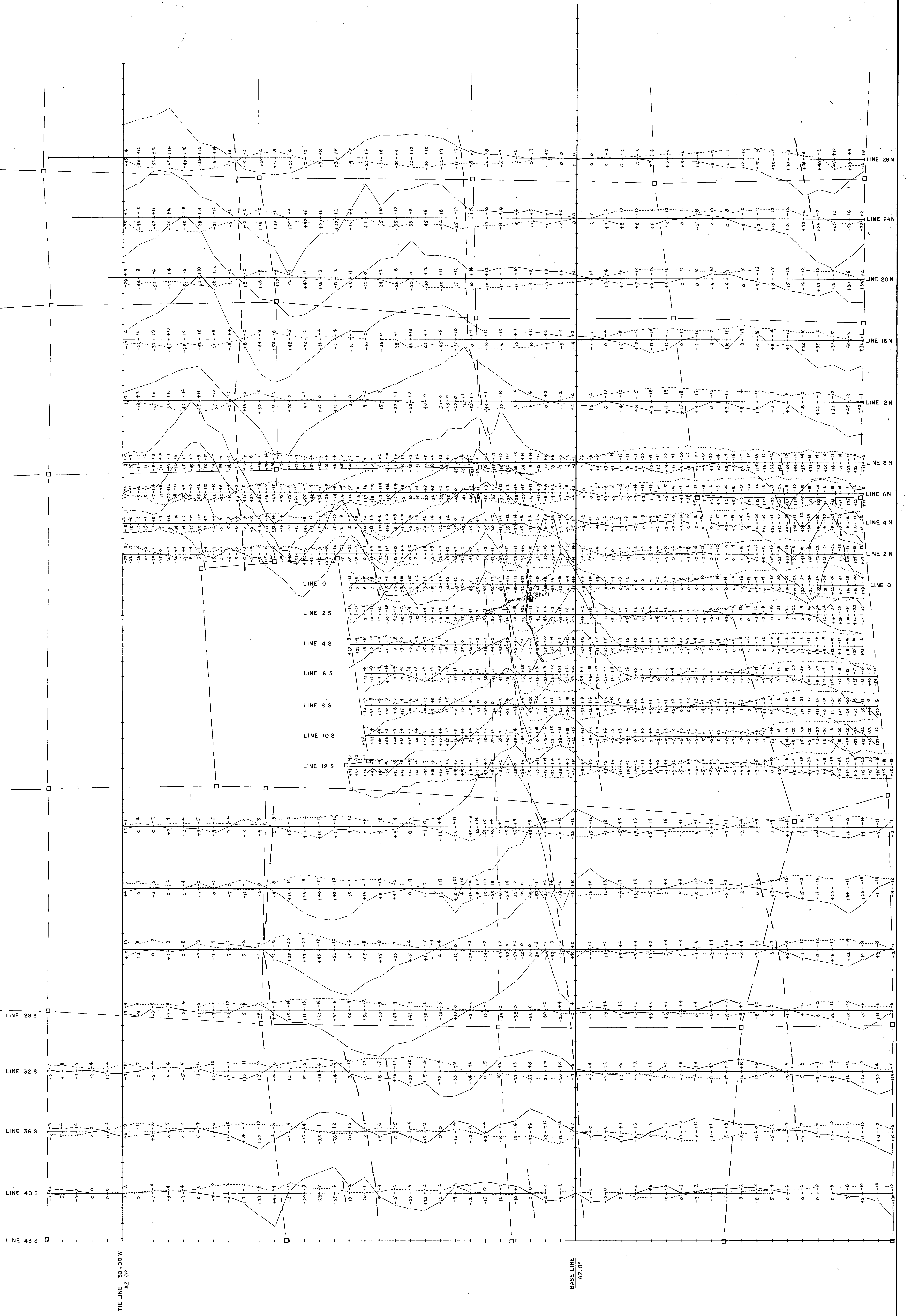

LEGEND

IN PHASE READINGS ± 14
OUT OF PHASE READINGS ± 2

PROFILE SCALE: 1" = 40'
IN PHASE PROFILE
OUT OF PHASE PROFILE
POSITIVE READINGS PLOTTED TO LEFT
NEGATIVE READINGS PLOTTED TO RIGHT
INSTRUMENT: BEOMICS EM 18 VLF EM

CONDUCTOR AXIS

2.9142

DELBRIDGE MINES LTD. TORONTO, ONT.	
VLF EM SURVEY SOUTH SHEET De SANTIS PROPERTY TURNBULL TWP., ONT.	
DATE : Dec. 28, 1985	SCALE : 1" = 200'
DRAWN BY : EAG	MAP NO. 108

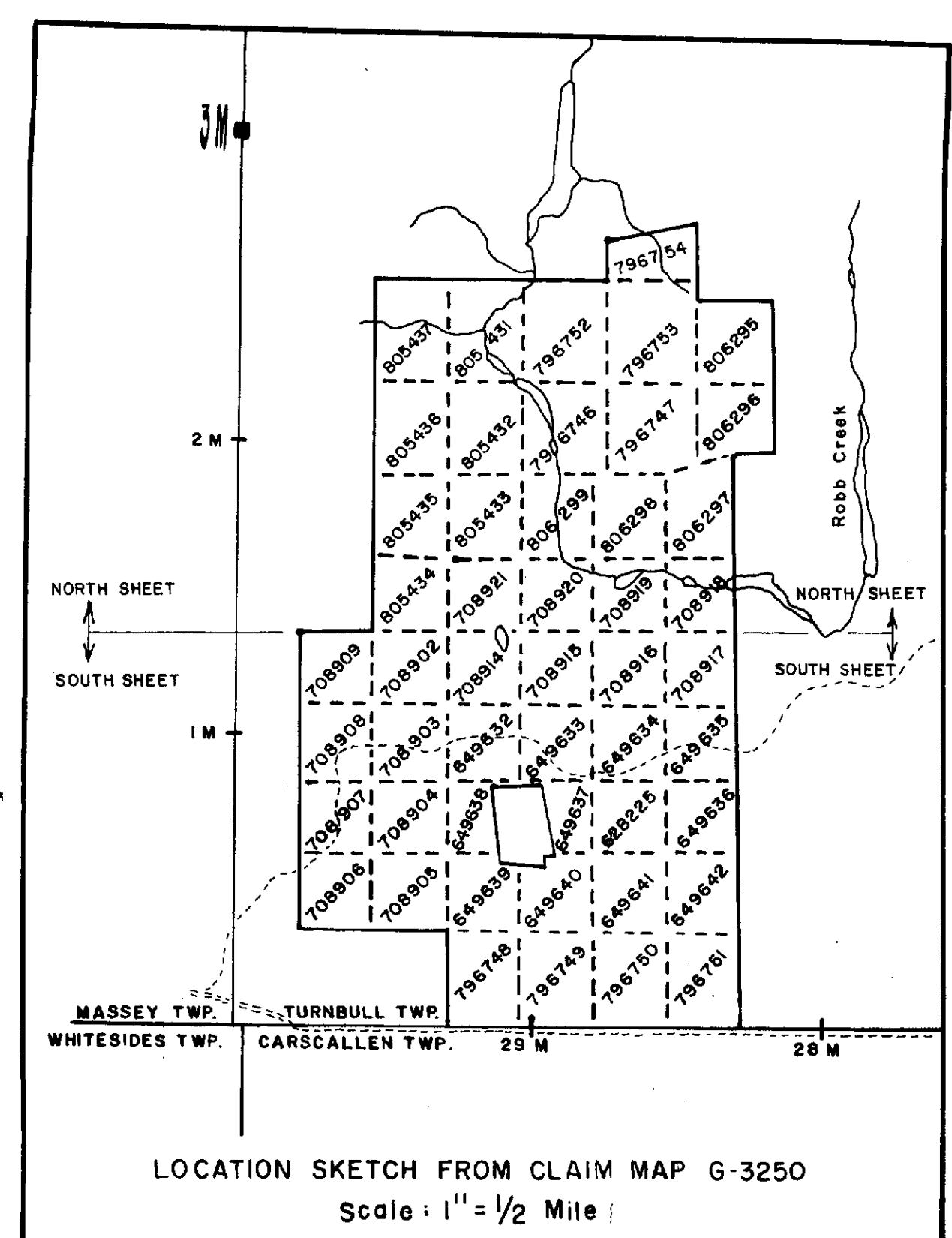
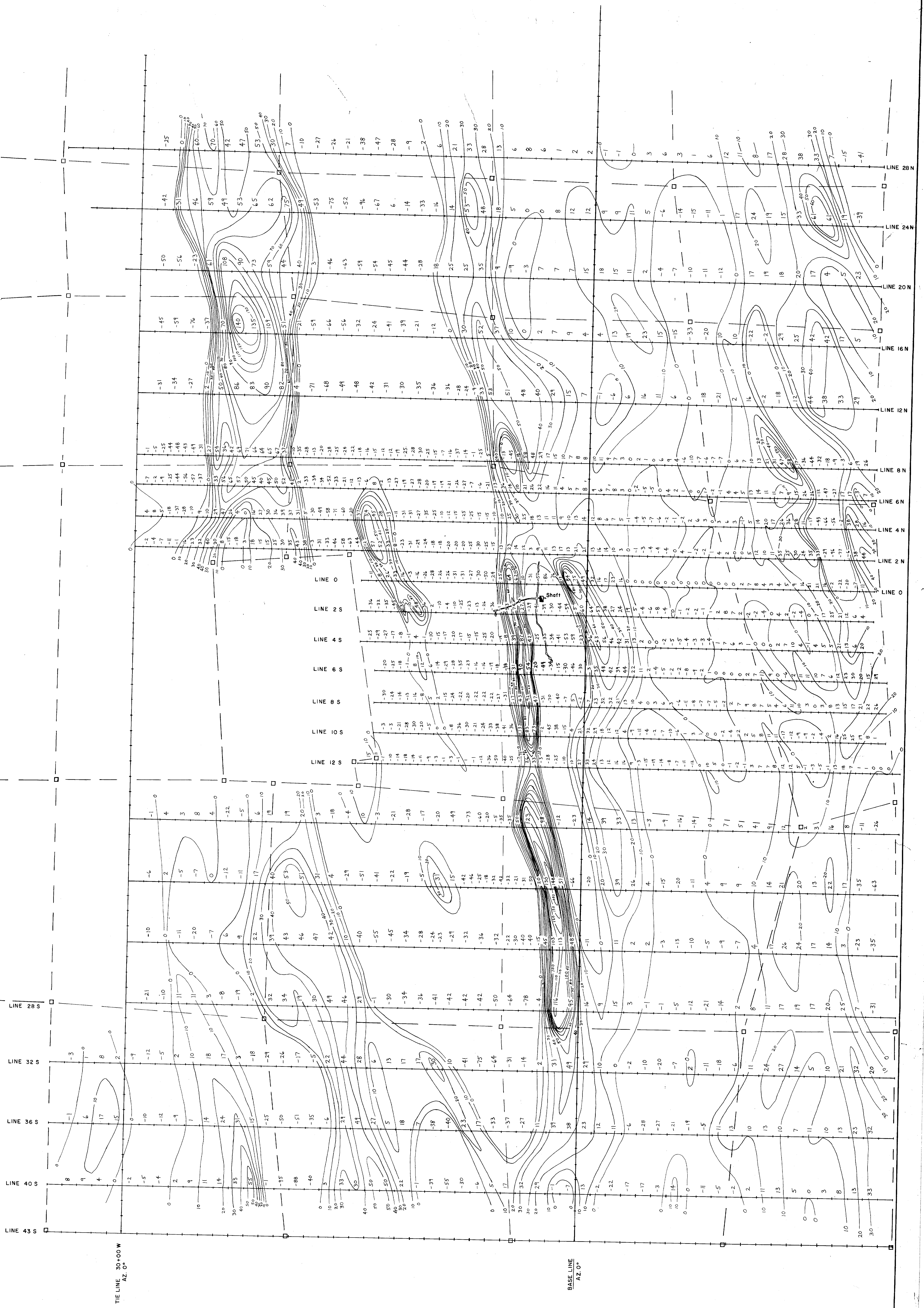

LEGEND

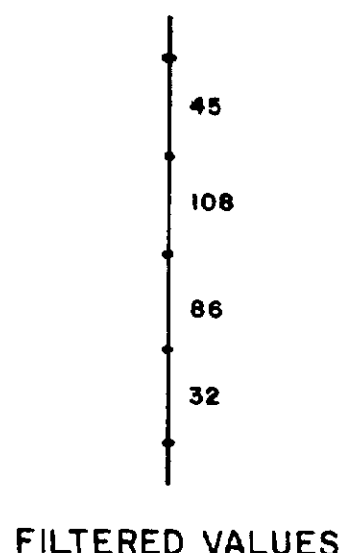

ISOMETRIC CONTOURS
CONTOUR INTERVAL: 10 UNITS
INSTRUMENT: GEONICS EM 16 VLF EM

2.9142

DELBRIDGE MINES LTD. TORONTO, ONT.	
FRASER-FILTERED VLF EM RESULTS SOUTH SHEET De SANTIS PROPERTY TURNBULL TWP., ONT.	
DATE: Dec. 28, 1985	SCALE: 1" = 200'
DRAWN BY: EAG	MAP NO 104