

CLAIM MAP - GOLDFEAST PROPERTY

Porcupine Mining Division, Ontario

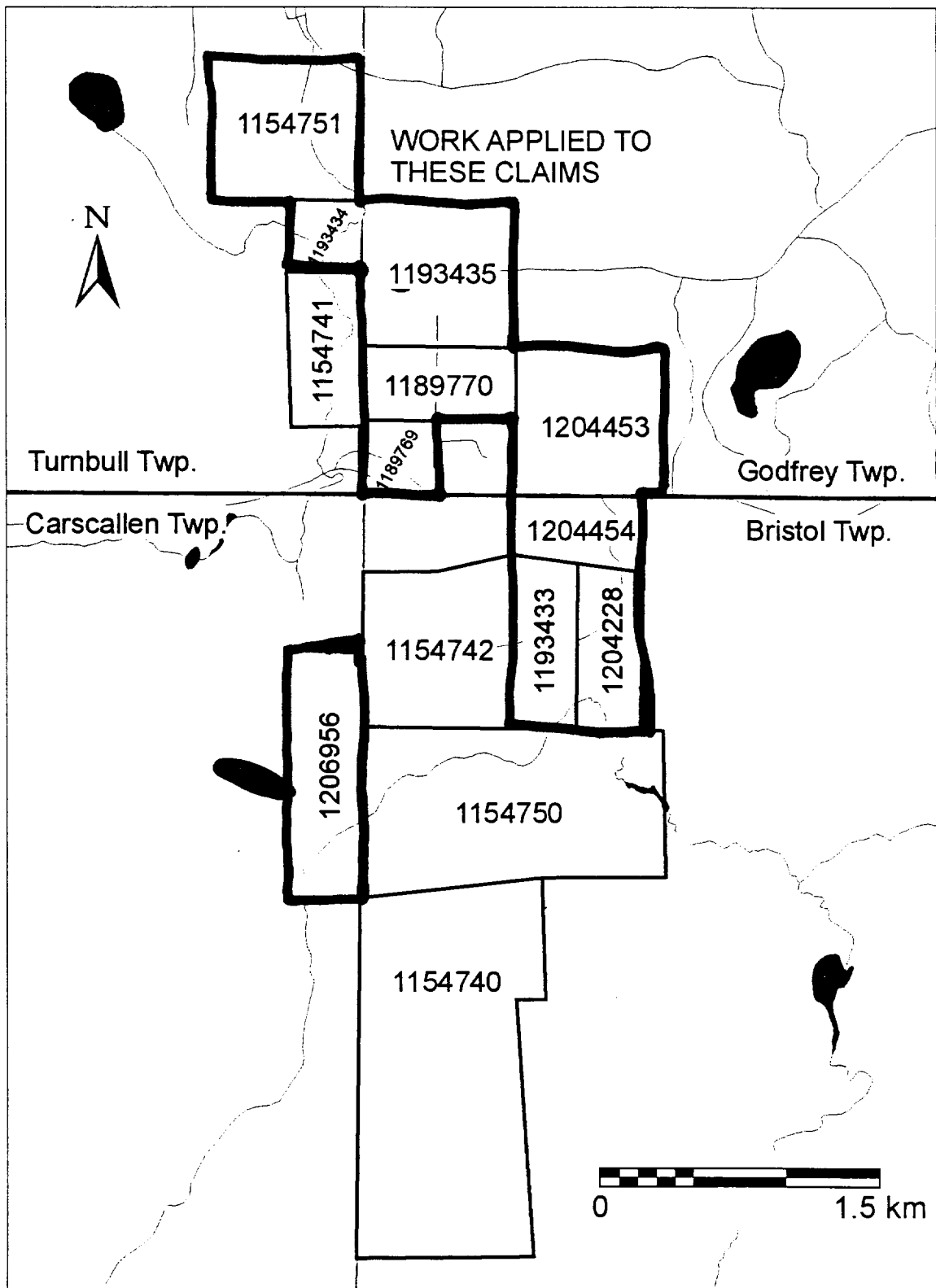

CLAIM MAP - GOLDFEAST PROPERTY

Porcupine Mining Division, Ontario

FINDORE GOLD RESOURCES LTD.

DRILL HOLE: GF-98-1	PROJECT: Goldfeast	COLLAR AZIMUTH: 0°
N.T.S.: 42 A/5	NORTHING: 0+00 N	COLLAR DIP: 50°
TOWNSHIP: Godfrey, ON	EASTING: 1+00 E	CORE SIZE: NQ
CLAIM: P 1189769	ELEVATION:	TOTAL DEPTH: 117.35 m
STARTED: Feb. 18, 1998	STOPPED: Feb. 20, 1998	CASING DEPTH: 1.5 m
CONTRACTOR: Forage Downing	LOGGED: J.M. SIRIUNAS, 1998/02/25	SECTION: 100 E

J.M. Siriunas

COMMENTS: GPS survey location: UTM Zone 17, 456021E, 5366420N (± 5 m). Core stored in Timmins. Casing left in hole.

GEOLOGICAL SUMMARY						DOWN HOLE DATA		
FROM	TO	DESCRIPTION	FROM	TO	DESCRIPTION	DEPTH	DIP	AZIMUTH
0.00	1.50	CASING				0	50°	0°
1.50	32.31	INTERMEDIATE-FELSIC TUFF/ LAPILLI TUFF				117.35	44½°	N/A
32.31	38.14	INTERMEDIATE INTRUSIVE						
38.14	70.45	INTERMEDIATE-FELSIC TUFF/ LAPILLI TUFF						
70.45	71.86	MAFIC-INTERMEDIATE INTRUSIVE						
71.86	73.07	INTERMEDIATE-FELSIC TUFF/ LAPILLI TUFF						
73.07	73.43	INTERMEDIATE-FELSIC INTRUSIVE						
73.43	117.35	INTERMEDIATE-FELSIC TUFF/ LAPILLI TUFF						
117.35		END OF HOLE						
						ASSAY NUMBERS		
						601 - 623		

DDH: GF-98-1	PROJECT: Goldfeast	FINDORE GOLD RESOURCES LTD.
--------------	--------------------	-----------------------------

METERS		DESCRIPTION	ASSAY #	FROM	TO	WIDTH	g Au/t	Check
FROM	TO							
0	1.50	CASING - Overburden						
1.50	32.31	INTERMEDIATE-FELSIC TUFF/LAPILLI TUFF - fairly oxidized and broken to about 6.0 m depth; generally massive and structureless with no pronounced foliation or schistosity, though rock may be locally blocky; variably altered and cut by quartz ± carbonate (ankerite) veining; pinkish cast may be result of pervasive ankeritic alteration; possible fault gouge at 6.00 m depth oriented 50° TCA; local <i>in situ</i> (hydrophraetic?) brecciation, homolithic, clast-supported with chloritic matrix and chloritic fractures; 7.92 m - 12.72 m medium grey-green coloured section with numerous quartz-carbonate veinlets; 12.72 m - 31.70 m light green section, weak porphyritic appearance (lapillis?); iron oxide-rich weathered zone or fault gouge at 20.10 m, 3 cm wide oriented 90° TCA; weak iron oxide staining from 21.10 m - 21.25 m and 22.45 m - 23.20 m; tourmaline-bearing section from 28.76 m - 30.30 m especially with quartz vein at 30.09 m, minor disseminated pyrite is also present with this 35 mm wide vein.	601	6.25	6.75	0.50	0.051	0.065
			602	6.75	7.25	0.50	0.084	
			603	13.00	13.50	0.50	0.01	
			604	14.00	14.50	0.50	0.002	
			605	14.50	15.00	0.50	0.005	
			606	15.00	15.50	0.50	0.014	
			607	15.50	16.00	0.50	0.077	
			623	18.40	18.90	0.50	<0.002	
			608	28.75	29.25	0.50	0.01	
			609	29.25	29.75	0.50	0.118	
			610	29.75	30.25	0.50	1.037	1.313
			611	30.25	30.75	0.50	0.009	
		612	30.75	31.25	0.50	<0.002		
32.31	38.14	INTERMEDIATE INTRUSIVE - feldspar porphyry; medium grey-green colour; 25% white feldspar phenocrysts only mm in size; upper contact is indistinct; 5 cm wide fault gouge at 37.90 m oriented 70° TCA.						

DDH: GF-98-1

PROJECT: Goldfeast

FINDORE GOLD RESOURCES LTD.

METERS		DESCRIPTION	ASSAY #	FROM	TO	WIDTH	g Au/t	Check
FROM	TO							
38.14	70.45	INTERMEDIATE-FELSIC TUFF/LAPILLI TUFF - section from 38.14 m - 54.48 m is similar to previous section 7.92 m - 12.72 m being medium grey-green in colour with numerous quartz-carbonate veinlets; sericitic bleaching and minor (locally up to 5%) pyrite associated with the aforementioned veinlets; section from 54.48 m - 70.45 m is similar to typical 1.50 m - 32.31 m material; brecciated zones at 66.50 m - 67.64 m and 69.30 m - 69.75 m.	613	40.05	40.55	0.50	0.015	1.047 0.962
			614	40.55	41.05	0.50	<0.002	
			615	41.05	41.55	0.50	<0.002	
			616	41.55	42.05	0.50	<0.002	
			617	42.05	42.55	0.50	0.012	
			618	42.55	43.05	0.50	1.329	
			618/2	42.55	43.05	0.50	0.806	
			619	43.05	43.55	0.50	<0.002	
			620	51.00	51.50	0.50	<0.002	
			621	51.50	52.00	0.50	0.007	
70.45	71.86	MAFIC-INTERMEDIATE INTRUSIVE - feldspar porphyry; 25% white feldspar phenocrysts mm in size; grey-green colour; weakly magnetic; contacts at 45° TCA.						
71.86	73.07	INTERMEDIATE-FELSIC TUFF/LAPILLI TUFF - similar to section 54.48 m - 70.45 m						
73.07	73.43	INTERMEDIATE-FELSIC INTRUSIVE - light grey colour; aphanitic; upper contact at 50° TCA; lower contact (badly broken core) 90° TCA?						
73.43	117.35	INTERMEDIATE-FELSIC TUFF/LAPILLI TUFF - similar to section 54.48 m - 70.45 m; brecciated zone at 82.92 m - 83.75 m; abundant chlorite disseminated from 105.52 m - 110.15 m.	622	97.75	98.25	0.50	<0.002	
117.35		END OF HOLE						

Box List

DDH: GF-98-1

BOX	FROM	TO	TOTAL	COMMENTS
1	0.00	5.18	5.18	
2	5.18	9.05	3.87	
3	9.05	12.81	3.76	
4	12.81	17.00	4.19	
5	17.00	21.15	4.15	
6	21.15	25.10	3.95	
7	25.10	29.26	4.16	
8	29.26	32.90	3.64	
9	32.90	36.65	3.75	
10	36.65	40.40	3.75	
11	40.40	44.33	3.93	
12	44.33	48.26	3.93	
13	48.26	52.25	3.99	
14	52.25	56.43	4.18	
15	56.43	60.55	4.12	
16	60.55	64.90	4.35	
17	64.90	68.95	4.05	
18	68.95	72.95	4.00	
19	72.95	77.20	4.25	
20	77.20	81.23	4.03	
21	81.23	85.19	3.96	
22	85.19	89.15	3.96	
23	89.15	93.34	4.19	
24	93.34	97.49	4.15	
25	97.49	101.40	3.91	
26	101.40	105.58	4.18	
27	105.58	109.83	4.25	
28	109.83	113.81	3.98	
29	113.81	117.35	3.54	EOH

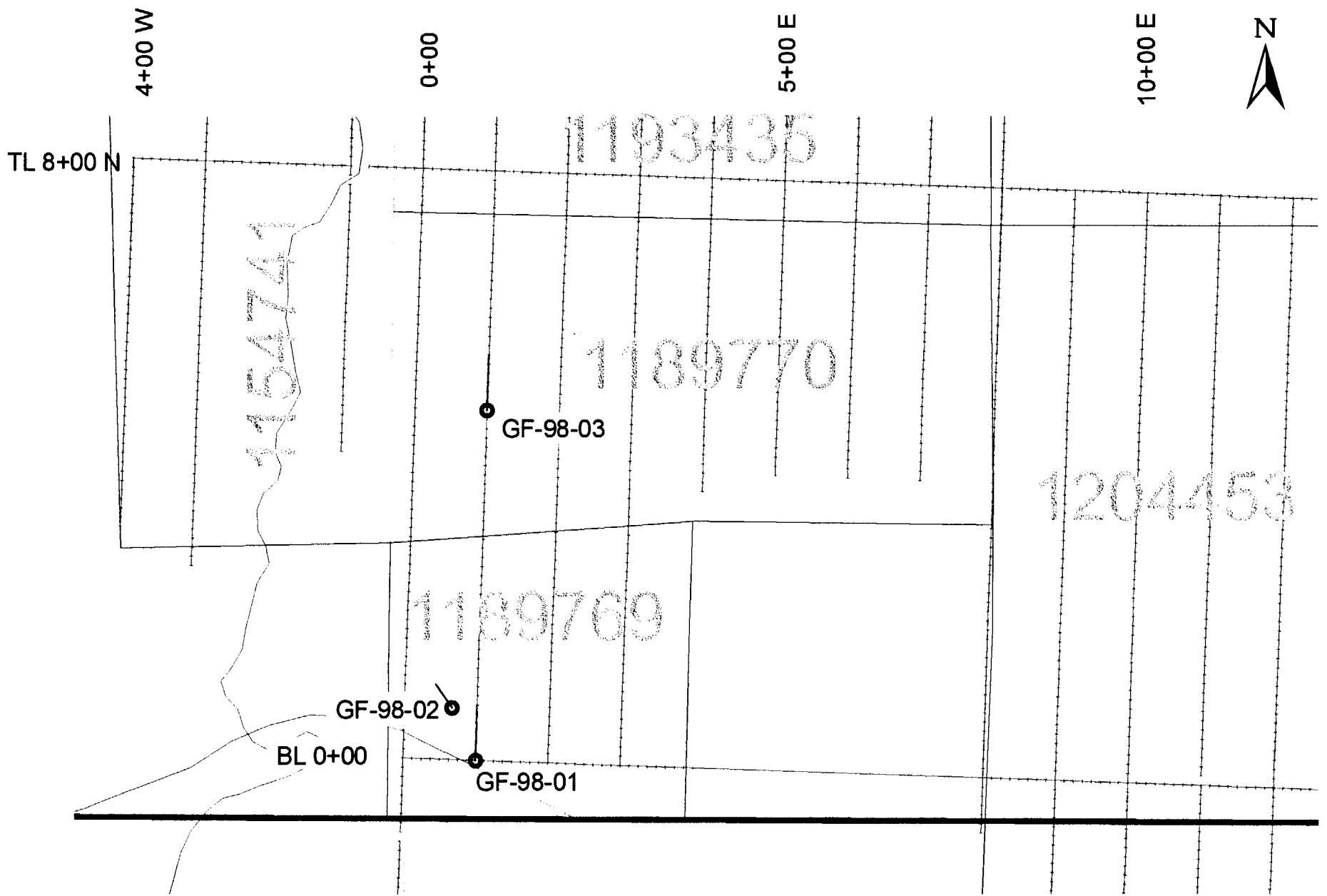

DDH COLLAR LOCATIONS GOLDFEAST PROPERTY

Q

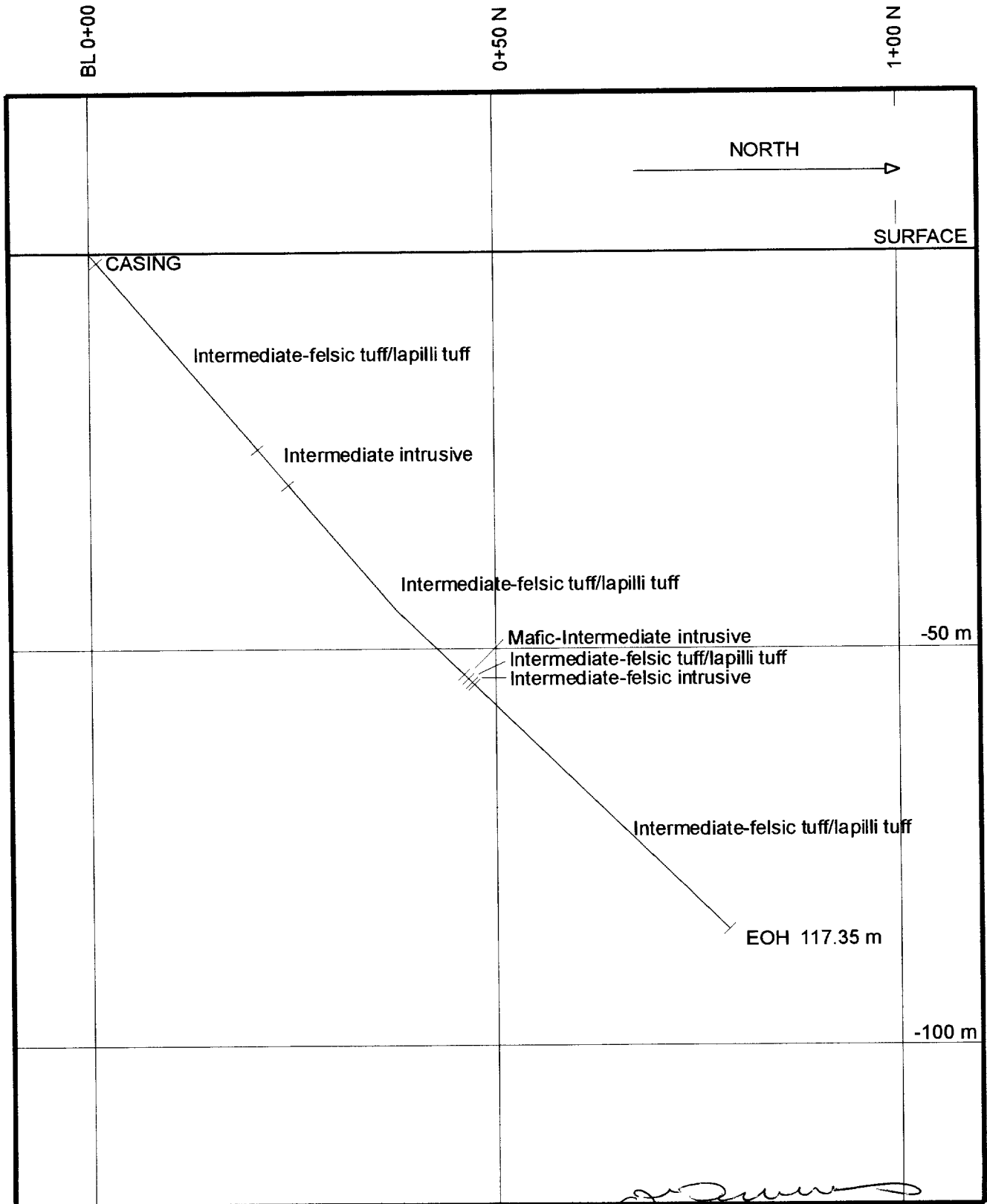

**DDH GF-98-01
SECTION 1+00 E
GOLDFEAST PROPERTY**



FINDORE GOLD RESOURCES LTD.

DRILL HOLE: GF-98-2	PROJECT: Goldfeast	COLLAR AZIMUTH: 325°
N.T.S.: 42 A/5	NORTHING: 0+75 N	COLLAR DIP: 50°
TOWNSHIP: Godfrey, ON	EASTING: 0+65 E	CORE SIZE: NQ
CLAIM: P 1189769	ELEVATION:	TOTAL DEPTH: 62.79 m
STARTED: Feb. 20, 1998	STOPPED: Feb. 21, 1998	CASING DEPTH: 1.00 m
CONTRACTOR: Forage Downing	LOGGED: J.M. SIRIUNAS, 1998/02/25	SECTION: 50 E

J.M. Siriunas

COMMENTS: GPS survey location: UTM Zone 17, 455989E, 5366491N (± 5 m). Core stored in Timmins.

GEOLOGICAL SUMMARY						DOWN HOLE DATA		
FROM	TO	DESCRIPTION	FROM	TO	DESCRIPTION	DEPTH	DIP	AZIMUTH
0.00	1.00	CASING				0	50°	325°
1.00	62.79	INTERMEDIATE-FELSIC TUFF/ LAPILLI TUFF				62.79	48°	N/A
62.79		END OF HOLE						
						ASSAY NUMBERS		
						625 - 641		

DDH: GF-98-2	PROJECT: Goldfeast	FINDORE GOLD RESOURCES LTD.
--------------	--------------------	-----------------------------

METERS		DESCRIPTION	ASSAY #	FROM	TO	WIDTH	g Au/t	Check
FROM	TO							
0	1.00	CASING - Overburden						
1.00	62.79	INTERMEDIATE-FELSIC TUFF/LAPILLI TUFF - generally massive and structureless with no pronounced foliation or schistosity, though rock may be locally blocky; variably altered and cut by quartz ± carbonate (ankerite) veining; pinkish cast may be result of pervasive ankeritic alteration; local <i>in situ</i> (hydrophraetic?) brecciation, homolithic, clast-supported with chloritic matrix and chloritic fractures and a weak fabric developed at 75° TCA; breccias well-developed at 17.55 m - 19.10 m and 56.69 m - 57.88 m (locally vuggy) and weakly-developed near the collar and around 42.50 m; trace pyrite with veinlets at 4.29 m, 4.58 m, 38.20 m, 47.05 m, 48.55 m (with trace galena) and 60.50 m; pyritization best developed (about 2%) between veinlets at 55.57 m and 55.67 m.	637	4.00	4.50	0.50	0.067	0.069
			638	4.50	5.00	0.50	0.002	
			625	38.00	38.50	0.50	<0.002	0.002
			626	38.50	39.00	0.50	<0.002	
			627	39.00	39.50	0.50	<0.002	
			628	44.50	45.00	0.50	<0.002	
			629	45.00	45.50	0.50	<0.002	
			630	45.50	46.00	0.50	<0.002	
			631	46.00	46.50	0.50	<0.002	
			632	46.50	47.00	0.50	<0.002	
			633	47.00	47.50	0.50	<0.002	
			634	47.50	48.00	0.50	<0.002	
			639	48.00	48.50	0.50	0.003	
			640	48.50	49.00	0.50	0.01	
		635	55.00	55.50	0.50	0.07		
		636	55.50	56.00	0.50	0.057		
		641	60.25	60.75	0.50	0.002		
62.79		END OF HOLE						

Box List

DDH: GF-98-2

BOX	FROM	TO	TOTAL	COMMENTS
1	0.00	5.22	5.22	CASING "CORE" INCLUDED
2	5.22	9.30	4.08	
3	9.30	13.35	4.05	
4	13.35	17.20	3.85	
5	17.20	20.78	3.58	
6	20.78	24.94	4.16	
7	24.94	29.08	4.14	
8	29.08	32.86	3.78	
9	32.86	36.74	3.88	
10	36.74	40.80	4.06	
11	40.80	44.50	3.70	
12	44.50	48.64	4.14	
13	48.64	52.80	4.16	
14	52.80	56.69	3.89	
15	56.69	60.12	3.43	
16	60.12	62.79	2.67	EOH

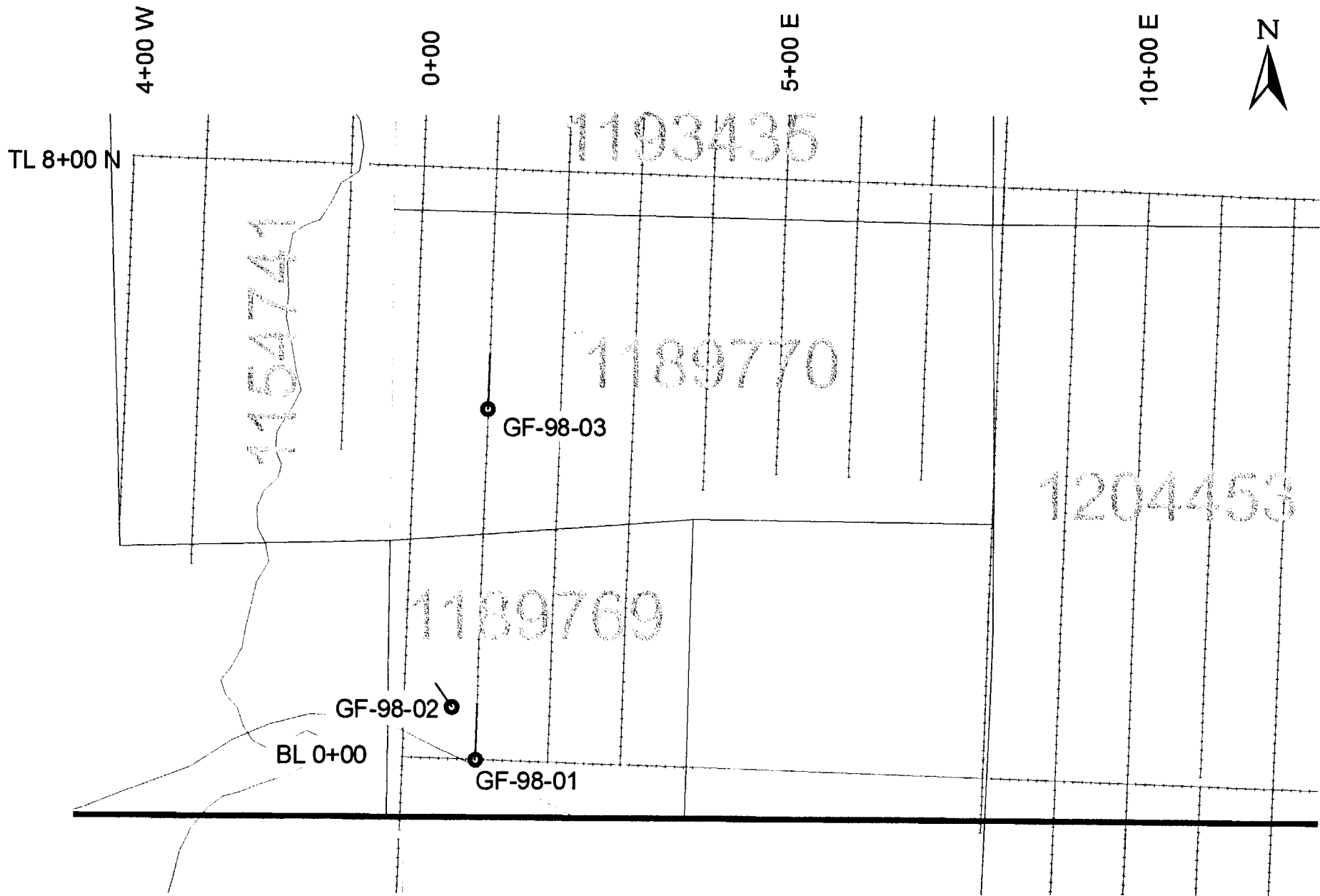

**DDH COLLAR LOCATIONS
GOLDFEAST PROPERTY**

g



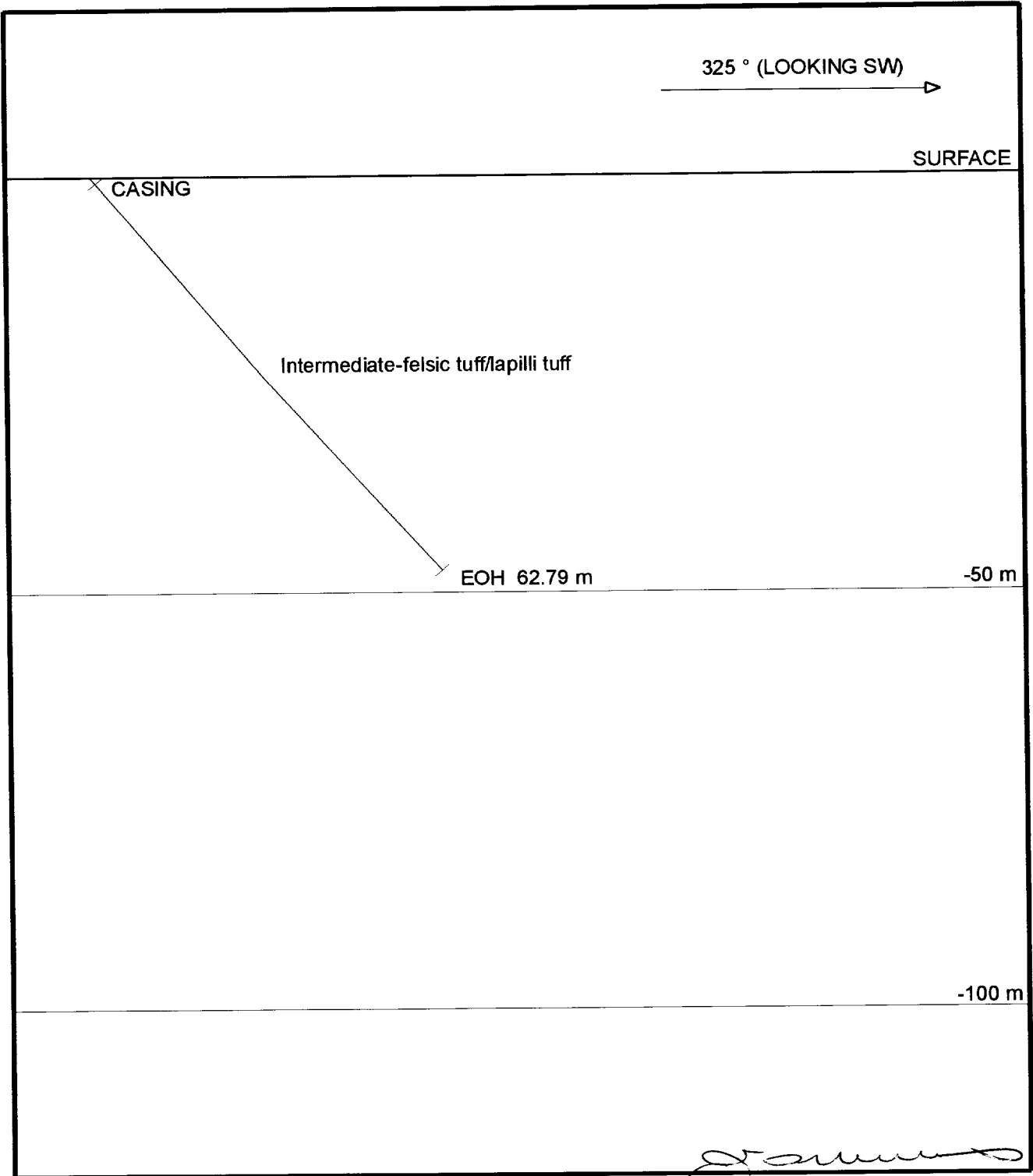

**DDH GF-98-02
SECTION
GOLDFEAST PROPERTY**



FINDORE GOLD RESOURCES LTD.

DRILL HOLE: GF-98-3	PROJECT: Goldfeast	COLLAR AZIMUTH: 0°
N.T.S.: 42 A/5	NORTHING: 4+75 N	COLLAR DIP: 50°
TOWNSHIP: Godfrey, ON	EASTING: 1+00 E	CORE SIZE: NQ
CLAIM: P 1189770	ELEVATION:	TOTAL DEPTH: 150.88 m
STARTED: Feb. 21, 1998	STOPPED: Feb. 24, 1998	CASING DEPTH: 22.86 m
CONTRACTOR: Forage Downing	LOGGED: J.M. SIRIUNAS, 1998/02/27	SECTION: 100 E

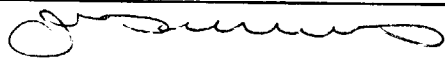

COMMENTS: GPS survey location: UTM Zone 17, 456039E, 5366887N (± 5 m). Core stored in Timmins.

GEOLOGICAL SUMMARY						DOWN HOLE DATA		
FROM	TO	DESCRIPTION	FROM	TO	DESCRIPTION	DEPTH	DIP	AZIMUTH
0.00	22.86	CASING	107.70	150.88	INTERMEDIATE-FELSIC TUFF/ LAPILLI TUFF	0	50°	0°
22.86	35.62	FELSIC LAPILLI TUFF/TUFF BRECCIA	150.88		END OF HOLE	150.88	44°	N/A
35.62	36.15	MAFIC VOLCANIC						
36.15	37.17	FELSIC LAPILLI TUFF/TUFF BRECCIA						
37.17	38.97	MAFIC VOLCANIC						
38.97	52.90	FELSIC LAPILLI TUFF/TUFF BRECCIA						
52.90	53.80	MAFIC INTRUSIVE						
53.80	60.58	MAFIC VOLCANIC						
60.58	61.15	MAFIC INTRUSIVE						
61.15	69.75	MAFIC VOLCANIC						
69.75	105.23	INTERMEDIATE-FELSIC TUFF/ LAPILLI TUFF						
105.23	107.70	MAFIC INTRUSIVE						
						ASSAY NUMBERS		
						642 - 644		

DDH: GF-98-3	PROJECT: Goldfeast	FINDORE GOLD REOURCES LTD.
--------------	--------------------	----------------------------

METERS		DESCRIPTION	ASSAY #	FROM	TO	WIDTH	g Au/t	Check
FROM	TO							
0	22.86	CASING - Overburden, clay and till with boulders near bedrock.						
22.86	35.62	FELSIC LAPILLI TUFF/TUFF BRECCIA - light medium grey to grey-white in colour; fairly massive; weak fabric at 80° TCA; breccia is homolithic, clast-supported with reaction-rims on some clasts; fragments/clasts up to 3 cm in size are generally subangular; few chloritic patches; extremely oxidized/weathered from 22.86 m - 27.18 m; locally sandy alteration or seams between 33.10 m and 34.28 m.	642	34.60	35.60	1.00	<0.002	
			642	34.60	35.60	1.00	Cu (ppm)	5
			642	34.60	35.60	1.00	Zn (ppm)	79
35.62	36.15	MAFIC VOLCANIC - dark grey-green colour; fine grained; massive; upper contact appears to conformable rather than intrusive.						
36.15	37.17	FELSIC LAPILLI TUFF/TUFF BRECCIA - similar to section 22.86 m - 35.62 m but very oxidized or weathered.						
37.17	38.97	MAFIC VOLCANIC - similar to section 35.62 m - 36.15 m; upper contact at 40° TCA has entrained small fragments of previous unit; broken core with iron oxides from 38.10 m - 38.30 m.						
38.97	52.90	FELSIC LAPILLI TUFF/TUFF BRECCIA - starting similar to section 22.86 m - 35.62 m but grading to tuff/lapilli tuff around 43.00 m with						

DDH: GF-98-3	PROJECT: Goldfeast	FINDORE GOLD REOURCES LTD.
--------------	--------------------	----------------------------

METERS		DESCRIPTION	ASSAY #	FROM	TO	WIDTH	g Au/t	Check
FROM	TO							
38.97	52.90	con't - quartz eyes/phenocrysts becoming more distinctive; broken ground and clay present at 41.72 m - 41.80 m; quartz-chlorite veining at 48.65 m, 15 mm wide oriented 30° TCA.						
52.90	53.80	MAFIC INTRUSIVE - fine grained; massive; non-magnetic.						
53.80	60.58	MAFIC VOLCANIC - massive; possibly tuffaceous; ubiquitous carbonitization (ankerite-dolomite) generally as porphyritic blebs possibly after feldspar; carbonate phenocrysts are generally weathered orange-brown colour; 5% to 20% of these grains are typically present; small band or xenolith of felsic lapilli tuff present from 53.30 m - 55.57 m with section 54.85 m - 55.57 m badly broken and moderately oxidized; calcite veining present at 57.30 m - 60.00 m in possible intrusive section; subangular to sub-rounded lapilli-size fragments present within sections 56.80 m - 57.30 m and 60.00 m - 60.58 m.						
60.58	61.15	MAFIC INTRUSIVE - massive; lacking calcite veining/alteration but quartz-carbonate veins are present at contacts; upper contact 60° TCA and lower contact 50° TCA; trace pyrite is present.						
61.15	69.75	MAFIC VOLCANIC - similar to section 53.80 m - 60.58 m; possible fault gouge at 65.53 m.						

DDH: GF-98-3	PROJECT: Goldfeast	FINDORE GOLD REOURCES LTD.
--------------	--------------------	----------------------------

METERS		DESCRIPTION	ASSAY #	FROM	TO	WIDTH	g Au/t	Check
FROM	TO							
69.75	105.23	INTERMEDIATE-FELSIC TUFF/LAPILLI TUFF - gradational contact with previous unit, 69.75 m marks the appearance of quartz phenocrysts; few large lapilli-size fragments of mafic composition are present near the upper contact; massive; from around 74.50 m a ladder or network-like matrix of sericite (?) is developed around lapilli fragments and quartz phenocrysts; green colour of the unit become light green around 85.85 m; presence of white feldspar phenocrysts starts at 103.27 m; at 101.43 m a 8 mm quartz vein with trace pyrite, oriented 60° TCA.	644	101.30	101.80	0.50	<0.002	
105.23	107.70	MAFIC INTRUSIVE - massive; dark grey-green colour; feldspar phenocrysts present in upper 25 cm of intersection; lower contact has well-developed chill margin; xenolith of felsic lapilli tuff (quartz phenocrystic) present at 106.95 m.						
107.70	150.88	INTERMEDIATE-FELSIC TUFF/LAPILLI TUFF - massive; contains quartz and feldspar phenocrysts (QFP); alternating light and medium green-coloured sections as per the following list: 107.70 m - 112.85 m, light green with dark green chloritic alteration along fractures; 112.85 m - 116.85 m, medium green colour; 116.85 m - 118.70 m, as 107.70 m - 112.85 m; 118.70 m - 125.78 m, as 112.85 m - 116.85 m; 125.78 m - 132.10 m, as 107.70 m - 112.85 m; 132.10 m - 150.88 m, as 112.85 m -	643	110.00	110.50	0.50	<0.002	0.002

DDH: GF-98-3	PROJECT: Goldfeast	FINDORE GOLD REOURCES LTD.
---------------------	---------------------------	-----------------------------------

METERS		DESCRIPTION	ASSAY #	FROM	TO	WIDTH	g Au/t	Check
FROM	TO							
107.7	150.88	con't - 116.85 m but with minor lighter green sections; 10 cm wide quartz vein with trace tourmaline present at 110.20 m; minor mafic intrusives present at 121.05 m - 122.00 m, 122.65 m - 122.85 m and 137.40 m - 137.85 m.						
150.88		END OF HOLE						

Box List

DDH: GF-98-3

BOX	FROM	TO	TOTAL	COMMENTS
1	9.45	24.00	14.55	CASING "CORE" AND OVERBURDEN INCLUDED
2	24.00	28.49	4.49	
3	28.49	32.45	3.96	
4	32.45	36.65	4.20	
5	36.65	40.10	3.45	
6	40.10	44.10	4.00	
7	44.10	48.08	3.98	
8	48.08	52.24	4.16	
9	52.24	55.92	3.68	
10	55.92	60.09	4.17	
11	60.09	64.35	4.26	
12	64.35	68.90	4.55	
13	68.90	73.18	4.28	
14	73.18	77.47	4.29	
15	77.47	81.70	4.23	
16	81.70	86.05	4.35	
17	86.05	89.92	3.87	
18	89.92	93.75	3.83	
19	93.75	98.07	4.32	
20	98.07	102.34	4.27	
21	102.34	106.55	4.21	
22	106.55	110.65	4.10	
23	110.65	114.97	4.32	
24	114.97	119.19	4.22	
25	119.19	123.35	4.16	
26	123.35	127.49	4.14	
27	127.49	131.78	4.29	
28	131.78	135.92	4.14	
29	135.92	139.81	3.89	
30	139.81	143.96	4.15	
31	143.96	148.22	4.26	
32	148.22	150.88	2.66	

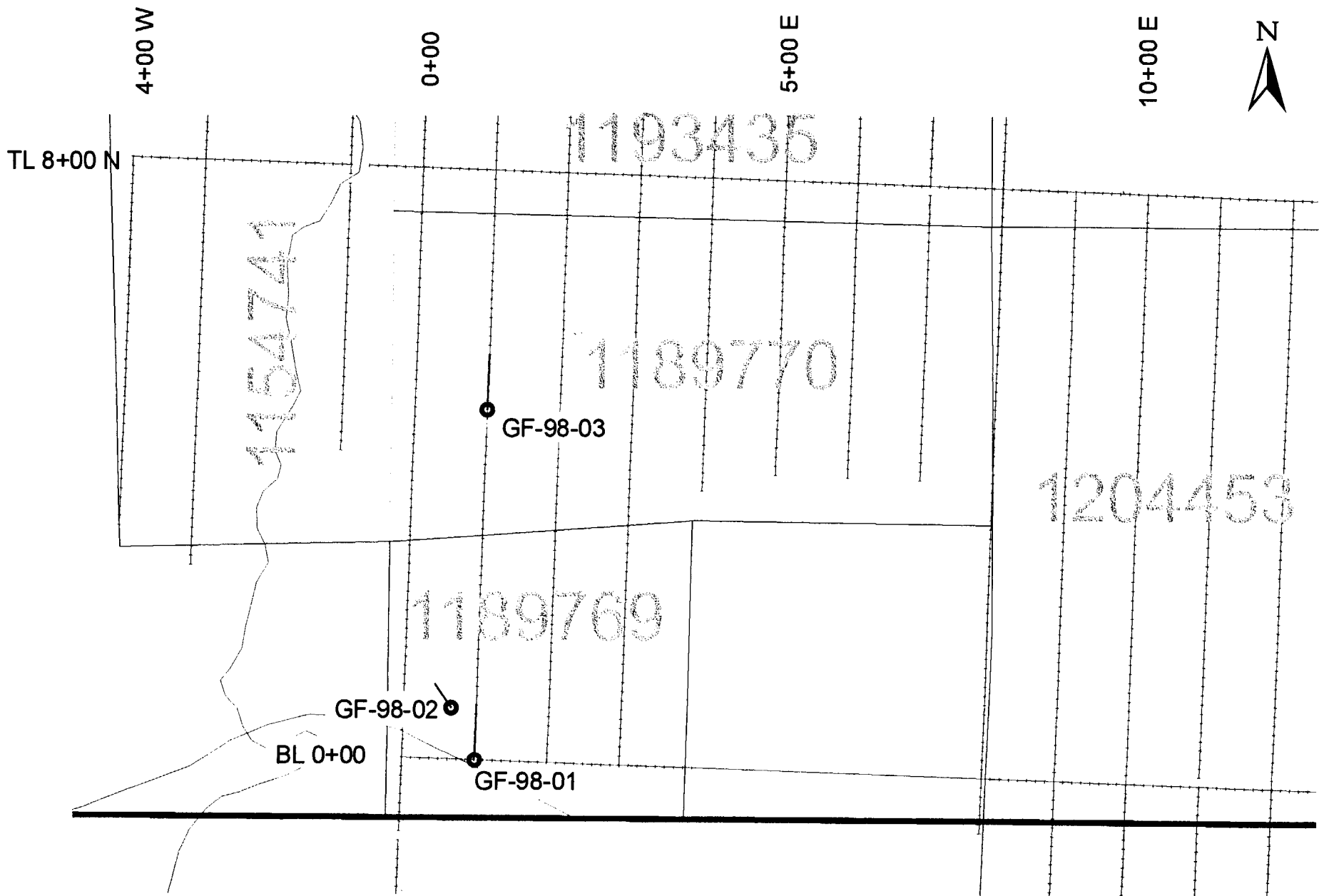

**DDH COLLAR LOCATIONS
GOLDFEAST PROPERTY**

9

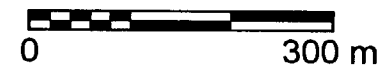

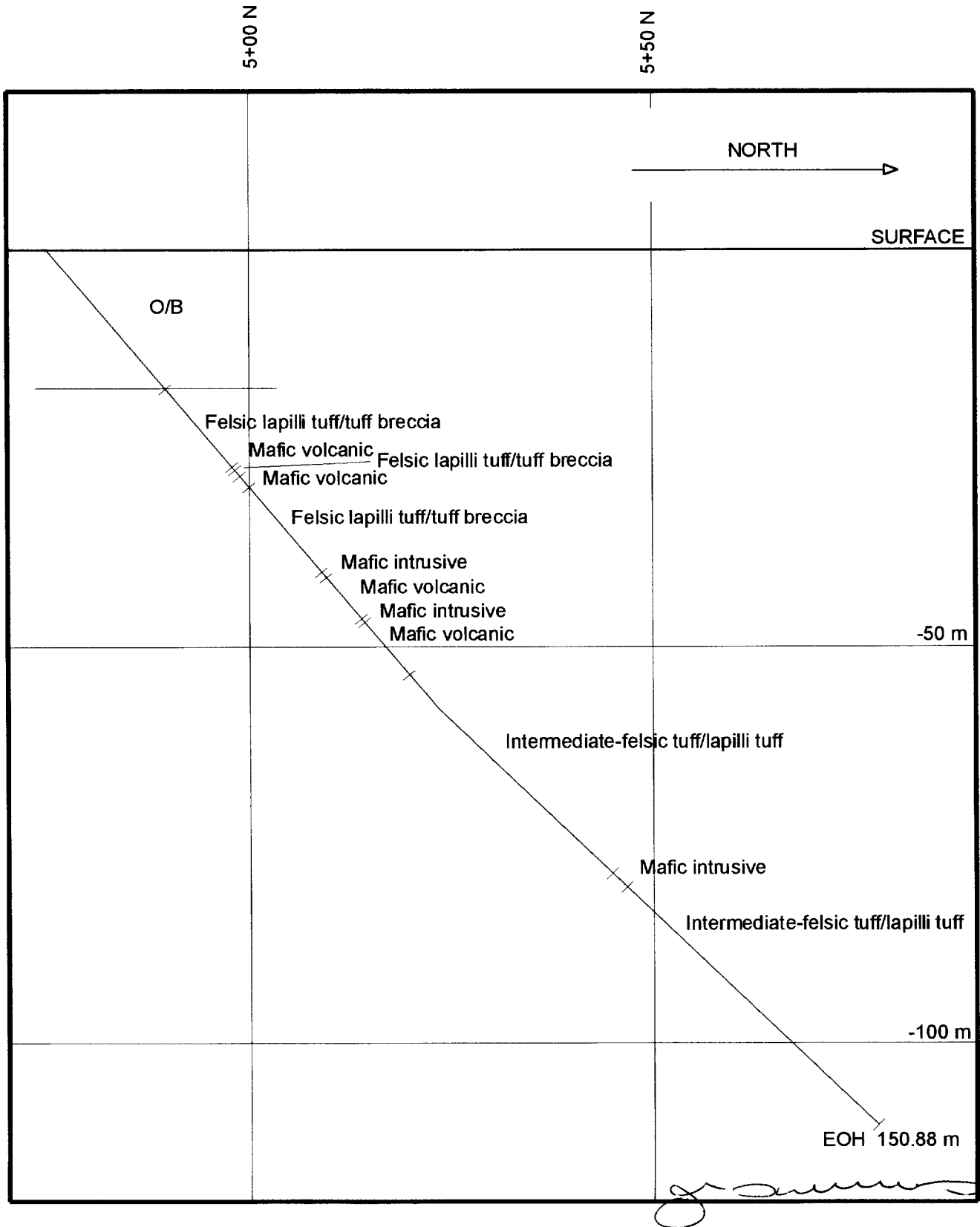

DDH GF-98-03
SECTION 1+00 E
GOLDFEAST PROPERTY

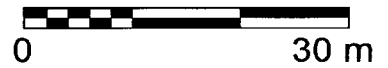



Swastika Laboratories

A Division of Assayers Corporation Ltd.

Assaying - Consulting - Representation

Page 1 of 2

Established 1928

Geochemical Analysis Certificate

8W-0496-RG1

Company: **FINDORE GOLD RESOURCES LTD**

Project: Gold Feast

Attn: J.Siriunas

Date: MAR-05-98

We hereby certify the following Geochemical Analysis of 44 Core samples submitted MAR-02-98 by .

Sample Number	Au PPB	Au Check PPB	Au 2nd PPB	Au Check PPB	Cu PPM	Zn PPM
601	51	65	-	-	-	-
602	84	-	-	-	-	-
603	10	-	-	-	-	-
604	2	-	-	-	-	-
605	5	-	-	-	-	-
606	14	-	-	-	-	-
607	77	-	-	-	-	-
608	10	-	-	-	-	-
609	118	-	-	-	-	-
610	1037	1313	-	-	-	-
611	9	-	-	-	-	-
612	Nil	-	-	-	-	-
613	15	-	-	-	-	-
614	Nil	-	-	-	-	-
615	Nil	-	-	-	-	-
616	Nil	-	-	-	-	-
617	12	-	-	-	-	-
618	1329	1047	806	962	-	-
619	Nil	-	-	-	-	-
620	Nil	-	-	-	-	-
621	7	-	-	-	-	-
622	Nil	-	-	-	-	-
623	Nil	-	-	-	-	-
624	Nil	-	-	-	-	-
625	Nil	-	-	-	-	-
626	Nil	-	-	-	-	-
627	Nil	2	-	-	-	-
628	Nil	-	-	-	-	-
629	Nil	-	-	-	-	-
630	Nil	-	-	-	-	-

One assay ton portion used.

Certified by Denis Chastre



Swastika Laboratories

A Division of Assayers Corporation Ltd.

Assaying - Consulting - Representation

Page 2 of 2

Established 1928

Geochemical Analysis Certificate

8W-0496-RG1

Company: **FINDORE GOLD RESOURCES LTD**

Date: MAR-05-98

Project: Gold Feast

Attn: J.Siriunas

We hereby certify the following Geochemical Analysis of 44 Core samples submitted MAR-02-98 by .

Sample Number	Au PPB	Au Check PPB	Au 2nd PPB	Au Check PPB	Cu PPM	Zn PPM
631	Nil	-	-	-	-	-
632	Nil	-	-	-	-	-
633	Nil	-	-	-	-	-
634	Nil	-	-	-	-	-
635	70	-	-	-	-	-
636	57	-	-	-	-	-
637	67	69	-	-	-	-
638	2	-	-	-	-	-
639	3	-	-	-	-	-
640	10	-	-	-	-	-
641	2	-	-	-	-	-
642	Nil	-	-	-	-	-
643	Nil	2	-	-	5	79
644	Nil	-	-	-	-	-

One assay ton portion used.

Certified by Dennis Chantre

FINDORE GOLD RESOURCES LTD.

Attention: J. Siriunas

Project: Gold Feast

Sample: Core

Swastika Laboratories

1 Cameron Ave., Swastika, Ontario

PHONE (705) 642-3244 FAX (705) 642-3300

Report No : 8W0497

Date : Mar-09-98

ICP Whole Rock Assay

Lithium Metaborate Fusion

Sample Number	SiO ₂ %	Al ₂ O ₃ %	Fe ₂ O ₃ %	CaO %	MgO %	Na ₂ O %	TiO ₂ %	K ₂ O %	MnO %	P ₂ O ₅ %	LOI %	Ba ppm	Sr ppm	Zr ppm	Sc ppm	Y ppm	Be ppm	Co ppm	Cr ₂ O ₃ %	Cu ppm	Ni ppm	V ppm	Zn ppm	Rb %	Nb ppm	Total %
701	59.29	13.96	7.82	1.71	6.06	1.55	0.94	1.99	0.08	0.20	6.18	350	30	230	15	35	5	20	0.02	10	31	115	105	0.01	<10	99.89
702	66.74	12.83	4.49	2.94	1.15	4.98	0.57	1.20	0.06	0.11	4.77	350	110	230	10	40	5	10	0.02	335	13	55	40	0.01	10	99.97
703	69.37	11.96	3.16	2.55	1.15	4.77	0.43	1.34	0.05	0.07	5.02	240	70	210	5	40	5	5	0.02	35	16	45	30	<0.01	10	99.97
704	70.25	12.80	3.03	1.77	1.19	5.24	0.44	1.34	0.04	0.07	3.65	220	70	240	5	35	5	5	0.02	25	24	45	35	0.01	<10	99.92
705	42.19	10.74	17.11	6.72	4.51	1.57	2.65	1.60	0.23	0.42	12.09	310	80	220	40	45	15	70	0.01	75	42	395	195	0.01	10	100.00
706	69.44	13.20	3.61	1.66	1.01	5.57	0.42	1.62	0.03	0.07	3.13	520	90	240	5	40	5	5	0.02	<5	11	45	20	0.01	10	99.88
707	71.18	11.99	2.98	2.57	1.28	1.17	0.38	3.62	0.02	0.06	4.33	680	20	210	5	40	5	5	0.01	20	13	40	20	0.01	<10	99.72
708	70.21	12.36	3.39	1.80	0.89	4.76	0.40	1.70	0.03	0.06	3.92	480	80	190	5	40	5	5	0.02	20	15	40	15	<0.01	<10	99.62
709	77.31	12.21	1.51	0.17	0.81	6.36	0.22	0.39	0.02	0.03	0.89	50	30	290	5	65	<5	<5	0.02	15	8	5	35	<0.01	<10	99.99
710	44.14	12.11	15.89	7.98	5.36	1.66	2.19	0.83	0.24	0.38	8.74	290	120	210	40	45	10	60	0.02	60	53	295	195	<0.01	<10	99.66
711	74.47	10.61	4.15	0.14	1.58	3.48	0.26	1.83	0.07	0.02	2.79	410	30	460	<5	110	5	<5	0.02	40	4	10	175	<0.01	<10	99.55
712	74.57	10.41	3.96	0.23	1.33	2.83	0.29	2.38	0.06	0.03	3.32	590	10	460	5	105	5	<5	0.03	30	50	10	125	0.01	<10	99.57
713	75.80	11.27	3.13	0.24	1.55	4.69	0.29	1.09	0.03	0.04	1.69	240	40	240	5	50	5	<5	0.02	55	23	20	45	<0.01	<10	99.93
714	73.81	10.96	3.44	0.18	1.67	3.55	0.29	2.09	0.03	0.04	3.65	500	40	210	5	45	5	<5	0.02	5	13	25	70	0.01	<10	99.84
715	72.99	11.74	4.01	0.34	2.40	3.82	0.37	1.83	0.03	0.05	2.12	410	30	240	5	55	5	5	0.02	25	11	30	95	<0.01	<10	99.82
716	45.01	14.86	11.89	3.61	10.06	1.64	0.96	1.56	0.15	0.10	9.67	250	30	70	35	20	5	40	0.01	5	67	240	155	<0.01	<10	99.62

A .2 gm sample is fused with 1 gm Lithium metaborate for 10 minutes and dissolved into 100 ml 10% HNO3

Signed: 



Ontario

Ministry of Northern Development and Mines

Declaration of Assessment Work Performed on Mining Land

Transaction Number (office use)

W9860 00384

Assessment Files Research Imaging

subsections 65(2) and 66(3), R.S.O. 1990



42A05NE2008 2.18341 GODFREY

900

of subsections 65(2) and 66(3) of the Mining Act. Under section 8 of the Mining Act, this assessment work and correspond with the mining land holder. Questions about this collection development and Mines, 3rd Floor, 933 Ramsey Lake Road, Sudbury, Ontario, P3E 6B5.

Instructions: - For work performed on Crown Lands before recording a claim, use form 0240. - Please type or print in ink.

1. Recorded holder(s) (Attach a list if necessary)

Form with fields for Name, Address, Client Number, Telephone Number, and Fax Number for FINDORE GOLD RESOURCES LTD. and AAVDEX CORPORATION.

2. Type of work performed: Check (✓) and report on only ONE of the following groups for this declaration.

Geotechnical: prospecting, surveys, assays and work under section 18 (regs) [] Physical: drilling stripping, trenching and associated assays [X] Rehabilitation []

Work Type: DIAMOND DRILLING ASSAYS + WHOLE ROCK ANALYSES. Office Use: Commodity, Total \$ Value of Work Claimed \$29733, NTS Reference, Mining Division, Resident Geologist District.

Please remember to: - obtain a work permit from the Ministry of Natural Resources as required; - provide proper notice to surface rights holders before starting work; - complete and attach a Statement of Costs, form 0212; - provide a map showing contiguous mining lands that are linked for assigning work; - include two copies of your technical report.

3. Person or companies who prepared the technical report (Attach a list if necessary)

Form with fields for Name, Address, Telephone Number, and Fax Number for JOHN M. SIRIUNAS.

4. Certification by Recorded Holder or Agent

I, JOHN M. SIRIUNAS, do hereby certify that I have personal knowledge of the facts set forth in this Declaration of Assessment Work having caused the work to be performed or witnessed the same during or after its completion and, to the best of my knowledge, the annexed report is true.

Signature of Recorded Holder or Agent, Date 7 APRIL 1998, Agent's Address, Telephone Number, Fax Number.

0241 (03/97)

Deemed July 07/98

RECEIVED 9:30 AM APR 06 1998 GEOSCIENCE ASSESSMENT OFFICE



Ontario

Ministry of Northern Development and Mines

Statement of Costs for Assessment Credit

Transaction Number (office use)

W9860.00384

Personal information collected on this form is obtained under the authority of subsection 6 (1) of the Assessment Work Regulation 6/96. Under section 8 of the Mining Act, this information is a public record. This information will be used to review the assessment work and correspond with the mining land holder. Questions about this collection should be directed to a Provincial Mining Recorder, Ministry of Northern Development and Mines, 3rd Floor, 933 Ramsey Lake Road, Sudbury, Ontario, P3E 6B5.

Table with 4 columns: Work Type, Units of work, Cost Per Unit of work, Total Cost. Rows include DIAMOND DRILLING, SUPERVISION/LOGGING/REPORTING, ASSAYS + ANALYTICAL, Associated Costs, CORE SHACK RENTAL, GBS RENTAL, FIELD SUPPLIES, Transportation Costs, Food and Lodging Costs.

RECEIVED 9:30 AM APR 08 1998 GEOSCIENCE ASSESSMENT OFFICE

Total Value of Assessment Work 29,732.70

Calculations of Filing Discounts:

- 1. Work filed within two years of performance is claimed at 100% of the above Total Value of Assessment Work.
2. If work is filed after two years and up to five years after performance, it can only be claimed at 50% of the Total Value of Assessment Work.

TOTAL VALUE OF ASSESSMENT WORK x 0.50 = Total \$ value of worked claimed.

Note:

- Work older than 5 years is not eligible for credit.
- A recorded holder may be required to verify expenditures claimed in this statement of costs within 45 days of a request for verification and/or correction/clarification.

Certification verifying costs:

I, JOHN M. SIRIVNAS, do hereby certify, that the amounts shown are as accurate as may reasonably be determined and the costs were incurred while conducting assessment work on the lands indicated on the accompanying Declaration of Work form as AGENT I am authorized to make this certification.

(recorded holder, agent, or state company position with signing authority)

Signature [Handwritten Signature] Date 7 APRIL 1998

6. Work to be recorded and distributed. Work can only be assigned to claims that are contiguous (adjoining) to the mining land where work was performed, at the time work was performed. A map showing the contiguous link must accompany this form.

W9860-00384

Mining Claim Number. Or if work was done on other eligible mining land, show in this column the location number indicated on the claim map.	Number of Claim Units. For other mining land, list hectares.	Value of work performed on this claim or other mining land.	Value of work applied to this claim.	Value of work assigned to other mining claims.	Bank. Value of work to be distributed at a future date
eg TB 7827	16 ha	\$26,825	N/A	\$24,000	\$2,825
eg 1234567	12	0	\$24,000	0	0
eg 1234568	2	\$ 8,892	\$ 4,000	0	\$4,892
1 1189769	1	16056	800'	5523	9733
2 1189770	2	13677	1600'	12077	0
3 1154751	4	0	3200'	0	0
4 1193433	2	0	1600'	0	0
5 1193434	1	0	800'	0	0
6 1193435	4	0	3200'	0	0
7 1204228	2	0	1600'	0	0
8 1204453	4	0	3200'	0	0
9 1204454	2	0	1600'	0	0
10 1206956	3	0	2400'	0	0
11					
12					
13					
14					
15					
Column Totals	25	29733	20000	17600	9733

RECEIVED
 9:30 AM
 APR 08 1998
 GEOSCIENCE ASSESSMENT
 OFFICE

I, JOHN M. SIRIONAS (Print Full Name), do hereby certify that the above work credits are eligible under subsection 7 (1) of the Assessment Work Regulation 6/96 for assignment to contiguous claims or for application to the claim where the work was done.

Signature of Recorded Holder or Agent Authorized in Writing: [Signature] Date: 7 APRIL 1998

6. Instructions for cutting back credits that are not approved.

Some of the credits claimed in this declaration may be cut back. Please check (✓) in the boxes below to show how you wish to prioritize the deletion of credits:

- 1. Credits are to be cut back from the Bank first, followed by option 2 or 3 or 4 as indicated.
- 2. Credits are to be cut back starting with the claims listed last, working backwards; or
- 3. Credits are to be cut back equally over all claims listed in this declaration; or
- 4. Credits are to be cut back as prioritized on the attached appendix or as follows (describe):

Note: If you have not indicated how your credits are to be deleted, credits will be cut back from the Bank first, followed by option number 2 if necessary.

For Office Use Only

Received Stamp	Deemed Approved Date	Date Notification Sent
	Date Approved	Total Value of Credit Approved
	Approved for Recording by Mining Recorder (Signature)	

Geoscience Assessment Office
933 Ramsey Lake Road
6th Floor
Sudbury, Ontario
P3E 6B5

Telephone: (888) 415-9846
Fax: (705) 670-5881

June 23, 1998

J. M. Siriunas
FINDORE GOLD RESOURCES LTD.
56 TEMPERANCE ST., 6TH FLOOR
TORONTO, ONTARIO
M5H-3V5

Visit our website at:
www.gov.on.ca/MNDM/MINES/LANDS/mlsmnpge.htm

Dear Sir or Madam:

Submission Number: 2.18341

Status

Subject: Transaction Number(s): W9860.00384 Deemed Approval

We have reviewed your Assessment Work submission with the above noted Transaction Number(s). The attached summary page(s) indicate the results of the review. **WE RECOMMEND YOU READ THIS SUMMARY FOR THE DETAILS PERTAINING TO YOUR ASSESSMENT WORK.**

If the status for a transaction is a 45 Day Notice, the summary will outline the reasons for the notice, and any steps you can take to remedy deficiencies. The 90-day deemed approval provision, subsection 6(7) of the Assessment Work Regulation, will no longer be in effect for assessment work which has received a 45 Day Notice. Allowable changes to your credit distribution can be made by contacting the Geoscience Assessment Office within this 45 Day period, otherwise assessment credit will be cut back and distributed as outlined in Section #6 of the Declaration of Assessment work form.

Please note any revisions must be submitted in DUPLICATE to the Geoscience Assessment Office, by the response date on the summary.

If you have any questions regarding this correspondence, please contact Steve Beneteau by e-mail at benetest@epo.gov.on.ca or by telephone at (705) 670-5855.

Yours sincerely,



ORIGINAL SIGNED BY
Blair Kite
Supervisor, Geoscience Assessment Office
Mining Lands Section

Work Report Assessment Results

Submission Number: 2.18341

Date Correspondence Sent: June 23, 1998

Assessor: Steve Beneteau

Transaction Number	First Claim Number	Township(s) / Area(s)	Status	Approval Date
W9860.00384	1189769	GODFREY	Deemed Approval	June 22, 1998

Section:

16 Drilling PDRILL

Correspondence to:

Resident Geologist
South Porcupine, ON

Assessment Files Library
Sudbury, ON

Recorded Holder(s) and/or Agent(s):

J. M. Siriunas
FINDORE GOLD RESOURCES LTD.
TORONTO, ONTARIO

AAVDEX CORPORATION
MISSISSAUGA, ON

MAP SYMBOLOGY

Aerial Cableway	Pipeline (leave ground)
Boundary (unimproved)	Railroad (Single Track)
Boundary (improved)	Railroad (Double Track)
Channel, Trench, Ditch, Reservoir	Abandoning
Approximate	Turbine
Lat, Concession	Road
Approximate	Highway, County
Part Boundary	Township
Bridge	Access (road of doubtful maintenance or significant driveway)
Road, Railroad	Trail, Bark Road (Storage site)
Building	Rapids
Chimney	Double line river with multiple rapids
Cliff, Pit, Pile	Reservoir
Contours	River, Stream, Canal
Interpretation	Approximate
Approximate	Spot Elevation (from altimeter) 300.0
Depression	Horizontal 0.017400
Control Points	Vertical 0.30002
Horizontal	Rock
Vertical	Significant
Culvert	Fall
Falls	Spot Elevation (from altimeter) 300.0
Double line river	Fence, Hedge, Wall
Feature Outline (contour, fence, etc.)	Transmission Line
Flooded Land	Pole
Lock	Utility Poles
Marsh or Swamp	Wharf, Dock, Pier
Mast	Wooded Area
Mine Head Frame	
Outcrop	

AREAS WITHDRAWN FROM DISPOSITION

M.R.O. - MINING RIGHTS ONLY
 S.R.O. - SURFACE RIGHTS ONLY
 M+S. - MINING AND SURFACE RIGHTS

Description	Order No.	Date	Disposition	File
① - S.R.O. UNDER APPLICATION FOR AGRICULTURAL PURPOSES				
② - CERTIFIED AGRICULTURAL LAND - 26/8/82 SUBJECT TO SEC. 4(1) OF THE MINING ACT				
③ - BONA FIDE APPLICATION				
④ - Pending S.R. disposition under P.L.A.				
⑤ - PENDING APPLICATION UNDER THE PUBLIC LANDS ACT NOTICE REC'D 8/20/82				
⑥ - PENDING APPLICATION UNDER THE PUBLIC LANDS ACT NOTICE REC'D 8/20/82				

MINING AND SURFACE RIGHTS REOPENED TO PROSPECTING, STAKING OUT, SALE AND LEASE UNDER SECTION 36 OF THE MINING ACT R60 890 EFFECTIVE 9/14/89 AT 1:00 AM E.A.T. ORDER NO. O.P. 1/89 DATED JAN. 19/89. (P.L.A. 17)

PENDING APPLICATION UNDER THE PUBLIC LANDS ACT NOTICE REC'D 8/20/82

MINING AND SURFACE RIGHTS REOPENED TO PROSPECTING, STAKING OUT, SALE OR LEASE UNDER SECTION 36 OF THE MINING ACT R60 890 EFFECTIVE FEB. 1/89, AT 7:00 AM E.A.T. ORDER NO. O.P. 1/89 DATED JAN. 19/89. (P.L.A. 17)

THE INFORMATION THAT APPEARS ON THIS MAP HAS BEEN COMPILED FROM VARIOUS SOURCES AND ACCURACY IS NOT GUARANTEED. THOSE WISHING TO STAKE MINING CLAIMS SHOULD CONSULT WITH THE MINING RECORDER, MINISTRY OF NORTHERN DEVELOPMENT AND MINES, FOR ADDITIONAL INFORMATION ON THE STATUS OF THE LANDS SHOWN HEREON.

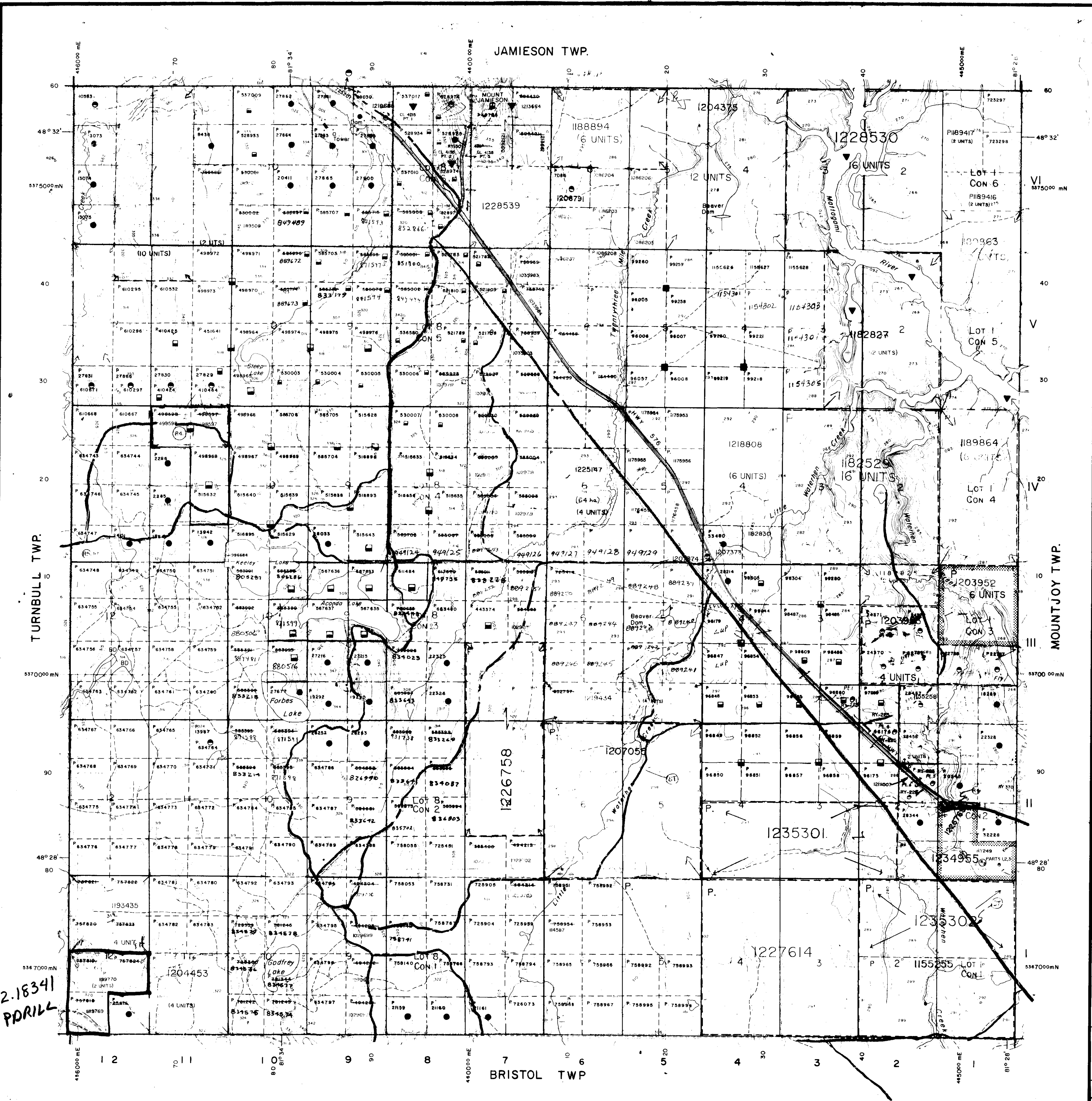

LEGEND

Highway and Route No.	
Other Roads	
Trails	
Surveyed Lines	
Township Base Lines, Etc.	
Lots, Mining Claims, Parcels, Etc.	
Unsurveyed Lines	
Lot Lines	
Parcel Boundary	
Mining Claims, Etc.	
Railway and Right of Way	
Utility Lines	
Non-Perennial Stream	
Flooding or Flooding Rights	
Subdivision or Composite Plan	
Reservations	
Original Shoreline	
Marsh or Muskeg	
Mines	
Traverse Monument	

DISPOSITION OF CROWN LANDS

Type of Document	Symbol
Patent, Surface & Mining Rights	●
Surface Rights Only	○
Mining Rights Only	◐
Lease, Surface & Mining Rights	◑
Surface Rights Only	◒
Mining Rights Only	◓
Licence of Occupation	○
Order in Council	○
Reservation	○
Cancelled	○
Sand & Gravel	○

NOTE: MINING RIGHTS IN PARCELS PATENTED PRIOR TO MAY 6, 1913, VESTED IN ORIGINAL PATENTEE BY THE PUBLIC LANDS ACT R.S.O. 1970, CHAP. 380, SEC. 83, SUBSEC. 1

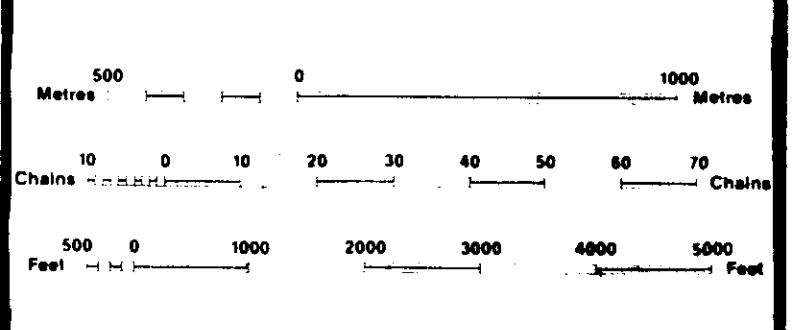

NOTES

FLOODING RIGHTS ON EITHER SIDE OF THE MATTAGAMI RIVER TO H.E.P.C.

LICENCE OF OCCUPATION, LOCATED WITH LOTS 7, 8 & 9 CONVEYANCE 6, BEING PARTS 1, 2, AND 3 ON A PLAN OF LOCATION CL 4155, ISSUED JUNE 11, 1985 FOR SURFACE RIGHTS ONLY TO KAMSPOTIA RECREATION LIMITED.

LICENCE DOCUMENT AND PLAN OF SURVEY AVAILABLE IN LAND ROLL FILE.

⑤ - PROPOSED SNOWMOBILE TRAIL
 NOTICE REC'D 93-MAY-20

DATE OF ISSUE
 JUN 13 1991
 PROVINCIAL RECORDING OFFICE - SUDBURY

TOWNSHIP
GODFREY
 M. N. S. ADMINISTRATIVE DISTRICT
TIMMINS
 MINING DIVISION
PORCUPINE
 LAND TITLES / REGISTRY DIVISION
COCHRANE

Ministry of Natural Resources
 Land Management Branch
 Ontario

ORIGINAL COMPILATION JULY 1984
 REVISED

Number
G-3991