

DIAMOND DRILL CORE LOG-SUMMARY SHEET

Project: Falconbridge Option-Carscallen Twp
Date: October 24-26, 1997
Logged by: Robert Calhoun
Drilling Co: Colbert Drilling

DDH: PFL97-1

Claim Number: 1201246

COLLAR LOCATION: L3400/1855N

SURVEYS: Acid Test

TIMMINS COORDINATES

GRID COORDINATES

	<u>Depth</u>	<u>Azimuth</u>	<u>Dip</u>
Setup:	0.0m	200°	-45°
	99.0m	200°	-44°

Northing:	1855N
Easting:	3400E
Elevation:	0.0 meters
TD:	99.0 meters

DRILLING DATES

Started: October 24, 1997
Finished: October 26, 1997

2.19300



42A05NE2017 2.19300 CARSCALLLEN

010

DIAMOND DRILL SUMMARY LOG

Project: Falconbridge Option - Carscallen Twp
 Date: October 24, 1997
 Logged By: R. Calhoun

DDH: PFL97-1

GEOLOGIC SUMMARY

FROM		TO	DESCRIPTION	INTERVAL			SIGNIFICANT ASSAY AVERAGES				
(m)	(m)			From (m)	To (m)	Width (m)	Cu ppm	Zn ppm	Pb ppm	Ag g/t	Au ppb
0.0	7.5		Overburden								
7.5	15.6		Mafic Dyke								
15.6	99.0		Felsic Pyroclastic								
	99.0		End of hole								

COMMENTS Target Max-Min conductor

Diamond Drill Log

Property: Falconbridge Option

Hole Number: PFL97-1

Claim Number: 1201246

Location: L3400E/1855N

Final Depth: 99.0 meters

Logged By: Robert Calhoun

Azimuth: Grid South

Dates Drilled: Oct 24-26, 1997

Drilled By: Colbert Drilling

Dip: -45°

Dates Logged: Re-logged Jan 30, 1999

Signature: 

Assays											
From	To	Description	Sample #	From	To	Length (meter)	Cu ppm	Zn ppm	Pb ppm	Ag g/ton	Au ppb
		Hole originally drilled as PDP97-1, changed to PFL97-1 for consistency in numbering. Logged by Peter Vamos, re-logged January 30, 1999 by Robert Calhoun									
0	7.5	Overburden									
7.5	15.6	Mafic Dyke -medium grained, dark grey to grey green, lathes of feldspar, white. Unit is highly fractured, non-magnetic and siliceous. Nil to trace pyrrhotite. There is a fine grained, silicified contact area from 15.0 to 15.6. Contact 66° to core axis.									
15.6	99.0	Felsic Pyroclastic -fine to medium grained, colour is highly variable from pale grey to dark green, grey-green. The unit is a somewhat chaotic pyroclastic with fragments or lapilli to 4cm. The fragments are heterolithic with abundant dark grey cherty fragments from sub rounded to angular. The unit is porphyritic with abundant white feldspars to 0.4cm in size. The unit is consistently siliceous and has potassic alteration associated with fractures. This alteration can be pervasive over 0.5 to 2m as at 50.0 to 52.0 and 54.5-53.0. The unit, over many meters, appears chloritized with a dark green matrix and is siliceous as well. This chloritized nature is also associated with some small quartz veins where unit becomes fine grained for 0.5cm either side of the veining. Sulfide mineralization is absent through the									

Diamond Drill Log

Hole # PFL97-1

							Assays				
From	To	Description	Sample #	From	To	Length (meter)	Cu ppm	Zn ppm	Pb ppm	Ag g/ton	Au ppb
		<p>section.</p> <p>62.2-66.3 -very fine grained, mafic dyke? <i>Silicified, weakly altered in fractures, massive. The upper contact diffuse while the lower is at 25° to core axis, minor chilled margin.</i></p> <p>The crystal abundance in the lower section, 69.0-99.0, has increased to 60-65% of the unit while <i>fragments continue. Local sections are finer textured but are still crystal abundant with small dark grey to blackish fragments.</i></p> <p>This unit is a feldspar crystal lapilli tuff</p>									
	99.0	End Of Hole									
		<p>WRA at 37m- 667015 93.2- 667014</p>									

Az. 200°

1115754

0

0

Overburden

FL97-1
L 3400 E, 1855mN
Az. 200° Dip -45°

Mafic Dyke

Felsic Pyroclastic

99.00 m.
FL97-1

-100

-100

-200

1900N

1900N

PROSPECTORS ALLIANCE CORPORATION

Exploration Timmins, ONTARIO

FALCONBRIDGE OPTION 6170
CARSCALLEN TOWNSHIP

SECTION L 3400 E
DDH FL97-01

TRACED:	DATE:	NTS: 42-A/05	PROJECT: 6170
DRAWN: del DRAFTING	DATE: 03/02/99	MAP No:	FILE: FL9701STN
SUPERVISED: R Colhoun	DATE: 03/02/99	SCALE 1: 1000 (metres)	
REVISED:	DATE:	0 20 40 60 80 100	



Ministry of Northern Development and Mines

Declaration of Assessment Work Performed on Mining Land

Sections 65(2) and 66(3), R.S.O. 1990

Transaction Number (office use)
W9960.00103
Assessment Files Research Imaging



42A05NE2017 2.19300 CARSCALLEN 900

Sections 65(2) and 66(3) of the Mining Act. Under section 8 of the Mining Act, this work and correspond with the mining land holder. Questions about this collection at and Mines, 3rd Floor, 933 Ramsey Lake Road, Sudbury, Ontario, P3E 6B5.

- For work performed on Crown Lands before recording a claim, use form 0240.
- Please type or print in ink.

1. Recorded holder(s) (Attach a list if necessary)

Name FALCONBRIDGE LIMITED	Client Number 130679
Address 95 WELLINGTON ST. W. SUITE 1200 TORONTO, ONTARIO M5J 2J4	Telephone Number 416-956-5786
	Fax Number 416-956-5749
Name	Client Number
Address	Telephone Number
	Fax Number

2. Type of work performed: Check (✓) and report on only ONE of the following groups for this declaration.

Geotechnical: prospecting, surveys, assays and work under section 18 (regs) Physical: drilling stripping, trenching and associated assays Rehabilitation

Work Type: Diamond Drill

Office Use		
Commodity		
Total \$ Value of Work Claimed: \$ 4750		
NTS Reference		
Dates Work Performed: From 24 10 97 To 26 10 97		
Global Positioning System Data (if available)	Township/Area: <u>CARSCALLEN</u>	Mining Division: <u>Porcupine</u>
	M or G-Plan Number	Resident Geologist District: <u>Timmins</u>

- Please remember to:
- obtain a work permit from the Ministry of Natural Resources as required;
 - provide proper notice to surface rights holders before starting work;
 - complete and attach a Statement of Costs, form 0212;
 - provide a map showing contiguous mining lands that are linked for assigning work;
 - include two copies of your technical report.

3. Person or companies who prepared the technical report (Attach a list if necessary)

Name PETER VAMOS	Telephone Number 905-689-6276
Address 19 BERRY HILL	Fax Number 905-689-2175
Name WATCHDOWN, ONTARIO L0R 2H4	Telephone Number
Address	Fax Number
Name	Telephone Number
Address	Fax Number

4. Certification by Recorded Holder or Agent

I, Lizal Bahome Agent, do hereby certify that I have personal knowledge of the facts set forth in this Declaration of Assessment Work having caused the work to be performed or witnessed the same during or after its completion and, to the best of my knowledge, the annexed report is true.

Signature of Recorded Holder or Agent:

Agent's Address: _____ Telephone Number: _____ Date: _____

241 (03/97)
 Dated June 8/99
 2.19300

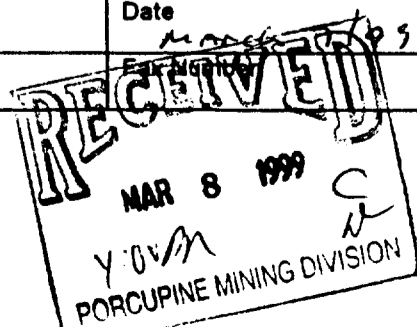
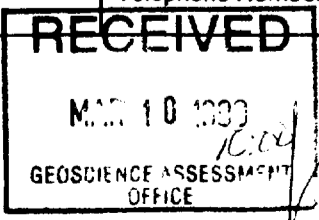

5. Work to be recorded and distributed. Work can only be assigned to claims that are contiguous (adjoining) to the mining land where work was performed, at the time work was performed. A map showing the contiguous link must accompany this form.

W9960.00/03

Mining Claim Number. Or if work was done on other eligible mining land, show in this column the location number indicated on the claim map.	Number of Claim Units. For other mining land, list hectares.	Value of work performed on this claim or other mining land.	Value of work applied to this claim.	Value of work assigned to other mining claims.	Bank. Value of work to be distributed at a future date
eg TB 7827	16 ha	\$26,825	N/A	\$24,000	\$2,825
eg 1234567	12	0	\$24,000	0	0
eg 1234568	2	\$ 8,892	\$ 4,000	0	\$4,892
1 1201246	8	4752.			4752
2					
3					
4					
5					
6					
7					
8					
9					
10					
11					
12					
13					
14					
15					
Column Totals		4752			4752.

I, Lionel Barbame Agent - Agent, do hereby certify that the above work credits are eligible under subsection 7 (1) of the Assessment Work Regulation 6/96 for assignment to contiguous claims or for application to the claim where the work was done.

Signature of Recorded Holder or Agent Authorized in Writing: [Signature] Date: March 9/99

6. Instructions for cutting back credits that are not approved.

Some of the credits claimed in this declaration may be cut back. Please check (✓) in the boxes below to show how you wish to prioritize the deletion of credits:

- 1. Credits are to be cut back from the Bank first, followed by option 2 or 3 or 4 as indicated.
- 2. Credits are to be cut back starting with the claims listed last, working backwards; or
- 3. Credits are to be cut back equally over all claims listed in this declaration; or
- 4. Credits are to be cut back as prioritized on the attached appendix or as follows (describe):

Note: If you have not indicated how your credits are to be deleted, credits will be cut back from the Bank first, followed by option number 2 if necessary.

For Office Use Only

Received Stamp	Deemed Approved Date	Date Notification Sent
	Date Approved	Total Value of Credit Approved
Approved for Recording by Mining Recorder (Signature)		

0241 (03/97)

2.1950

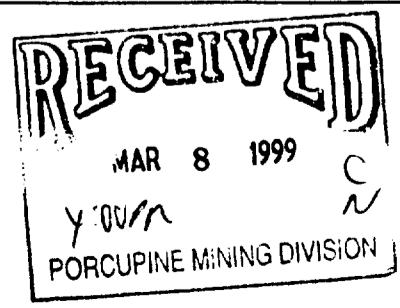
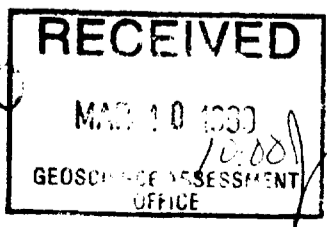



Statement of Costs for Assessment Credit

Transaction Number (office use) W9960.00163

Personal information collected on this form is obtained under the authority of subsection 6(1) of the Assessment Work Regulation 6/96. Under section 8 of the Mining Act, the information is a public record. This information will be used to review the assessment work and correspond with the mining land holder. Questions about this collection should be directed to the Chief Mining Recorder, Ministry of Northern Development and Mines, 6th Floor, 933 Ramsey Lake Road, Sudbury, Ontario, P3E 6B5.

Table with 4 columns: Work Type, Units of Work, Cost Per Unit of work, Total Cost. Includes entries for Diamond Drill, Geologist, and Transportation Costs.

Calculations of Filing Discounts:

- 1. Work filed within two years of performance is claimed at 100% of the above Total Value of Assessment Work.
2. If work is filed after two years and up to five years after performance, it can only be claimed at 50% of the Total Value of Assessment Work.

TOTAL VALUE OF ASSESSMENT WORK x 0.50 = Total \$ value of worked claimed.

Note:

- Work older than 5 years is not eligible for credit.
- A recorded holder may be required to verify expenditures claimed in this statement of costs within 45 days of a request for verification and/or correction/clarification.

Certification verifying costs:

I, Lionel Bonhomme, do hereby certify, that the amounts shown are as accurate as may reasonably be determined and the costs were incurred while conducting assessment work on the lands indicated on the accompanying Declaration of Work Form as Agent

I am authorized to make this certification. (recorded holder, agent, or state company position with signing authority)

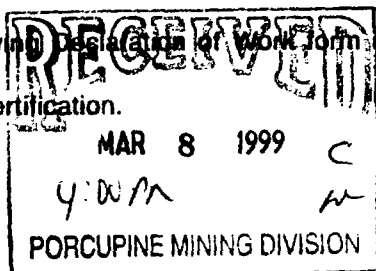

Signature and Date (March 7/99)

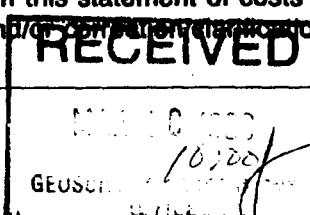

2.19300

Geoscience Assessment Office
933 Ramsey Lake Road
6th Floor
Sudbury, Ontario
P3E 6B5

Telephone: (888) 415-9846
Fax: (877) 670-1555

April 7, 1999

FALCONBRIDGE LIMITED
SUITE 1200, 95 WELLINGTON STREET WEST
TORONTO, ONTARIO
M5J-2V4

Visit our website at:
www.gov.on.ca/MNDM/MINES/LANDS/mlsmnpge.htm

Dear Sir or Madam:

Submission Number: 2.19300

Status

Subject: Transaction Number(s): W9960.00103 Deemed Approval

We have reviewed your Assessment Work submission with the above noted Transaction Number(s). The attached summary page(s) indicate the results of the review. **WE RECOMMEND YOU READ THIS SUMMARY FOR THE DETAILS PERTAINING TO YOUR ASSESSMENT WORK.**

If the status for a transaction is a 45 Day Notice, the summary will outline the reasons for the notice, and any steps you can take to remedy deficiencies. The 90-day deemed approval provision, subsection 6(7) of the Assessment Work Regulation, will no longer be in effect for assessment work which has received a 45 Day Notice. Allowable changes to your credit distribution can be made by contacting the Geoscience Assessment Office within this 45 Day period, otherwise assessment credit will be cut back and distributed as outlined in Section #6 of the Declaration of Assessment work form.

Please note any revisions must be submitted in **DUPLICATE** to the Geoscience Assessment Office, by the response date on the summary.

If you have any questions regarding this correspondence, please contact Bruce Gates by e-mail at bruce.gates@ndm.gov.on.ca or by telephone at (705) 670-5856.

Yours sincerely,



ORIGINAL SIGNED BY
Blair Kite
Supervisor, Geoscience Assessment Office
Mining Lands Section

Work Report Assessment Results

Submission Number: 2.19300

Date Correspondence Sent: April 07, 1999

Assessor: Bruce Gates

Transaction Number	First Claim Number	Township(s) / Area(s)	Status	Approval Date
W9960.00103	1201246	CARSCALLEN	Deemed Approval	April 01, 1999

Section:
16 Drilling PDRILL

Correspondence to:

Resident Geologist
South Porcupine, ON

Assessment Files Library
Sudbury, ON

Recorded Holder(s) and/or Agent(s):

Lionel Bonhomme
TIMMINS, ONTARIO, CANADA

FALCONBRIDGE LIMITED
TORONTO, ONTARIO

INDEX TO LAND DISPOSITION

PLAN
G-3040
TOWNSHIP
CARSCALLEN

M.N.R. ADMINISTRATIVE DISTRICT
TIMMINS
MINING DIVISION
PORCUPINE
LAND TITLES/REGISTRY DIVISION
COCHRANE

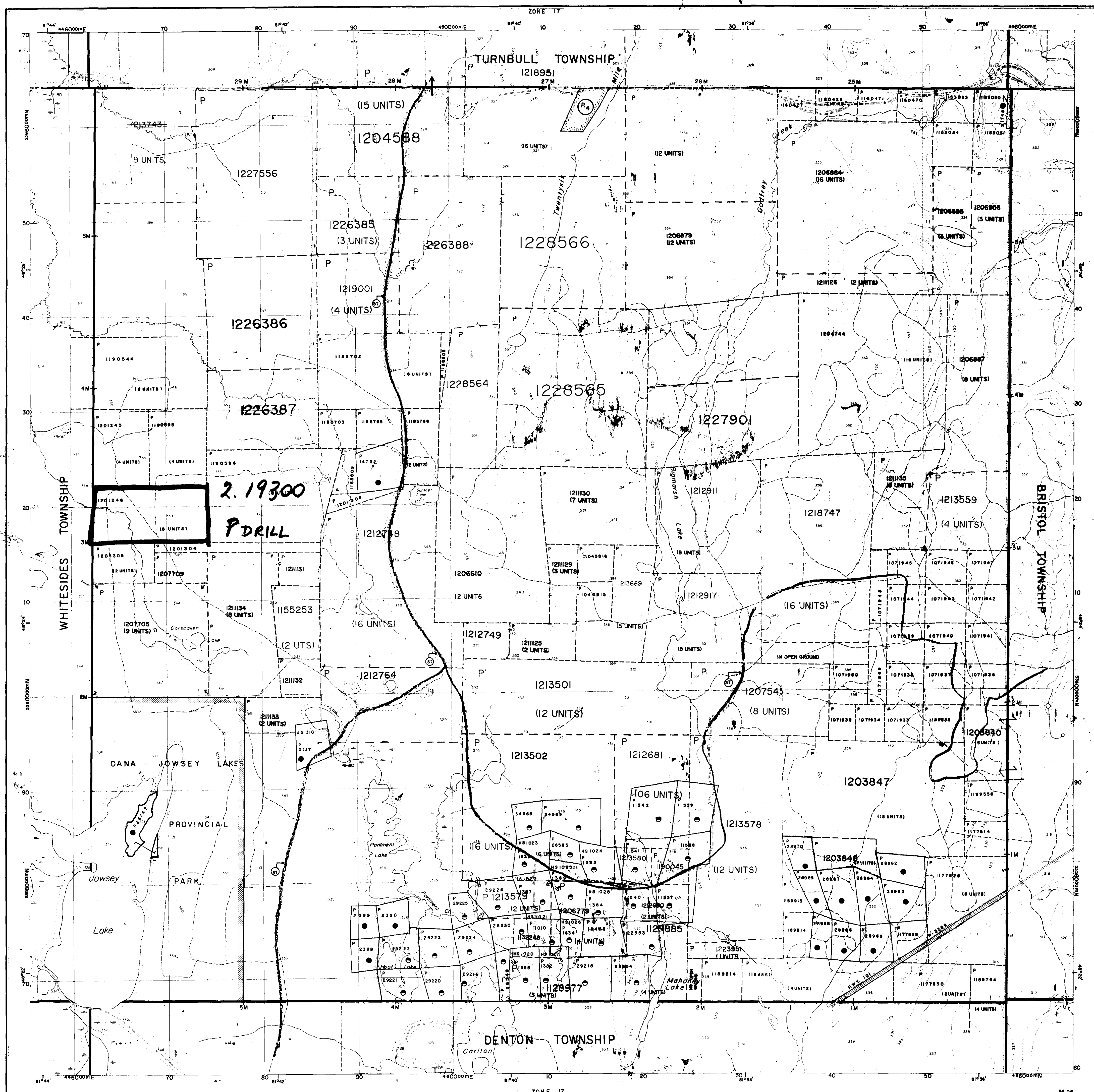
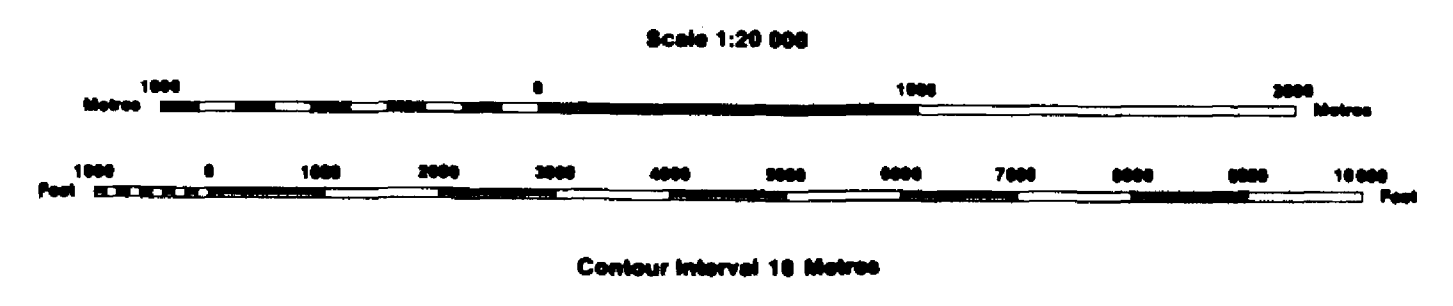

AREAS WITHDRAWN FROM DISPOSITION
MRO - Mining Rights Only
SRO - Surface Rights Only
M + S - Mining and Surface Rights

SYMBOLS

- Boundary: Township, Meridian, Baseline
- Road allowance, surveyed
- Lot/Concession, surveyed
- Parcel, surveyed
- Right-of-way, road
- Reservation
- Control point (horizontal)
- Flooded land
- Mine head frame
- Pipeline (above ground)
- Railway: single track, double track, abandoned
- Road: highway, county, township
- Transmission line
- Wooded area

AGGREGATE PERMIT - NOTICE RECEIVED JUNE 16, 1993

THIS TWP IS SUBJECT TO FOREST ACTIVITY IN 1994-95
APPLICATION PENDING UNDER THE PUBLIC LANDS ACT
THIS TWP SUBJECT TO FOREST ACTIVITY IN 1995-96

DISPOSITION OF CROWN LANDS

- Patent: Surface & Mining Rights, Surface Rights Only, Mining Rights Only
- Lease: Surface & Mining Rights, Surface Rights Only, Mining Rights Only
- Licence of Occupation
- Order-in-Council
- Cancelled
- Reservation
- Sand & Gravel

DATE OF ISSUE
SEP 01 1988
PROVINCIAL RECORDING OFFICE - SAGUIRY

ACTIVATED AUG. 17/94, BY: D.C.
CHECKED BY:

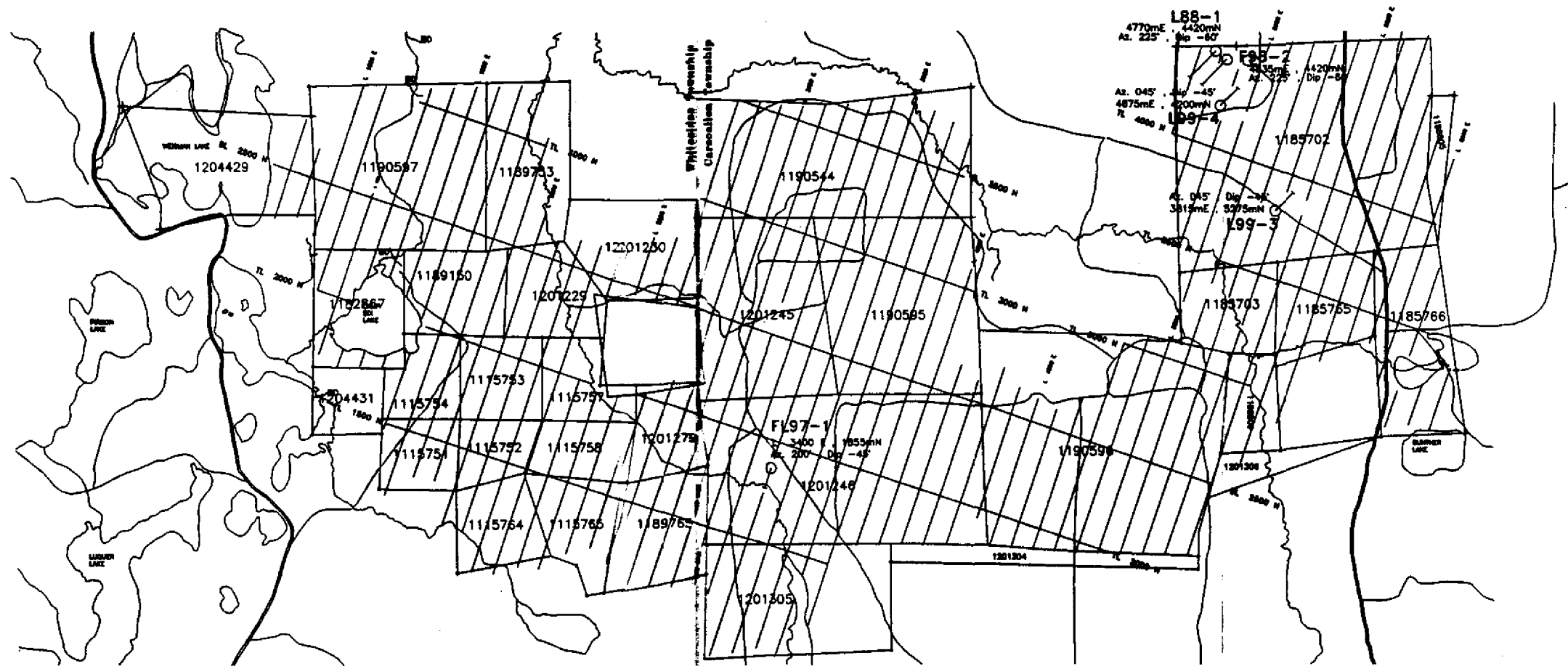

2.19300

DUPLICATE



PROSPECTORS ALLIANCE CORPORATION			
Timmins ONTARIO			
FALCONBRIDGE OPTION 6170			
CARSCALLEN TOWNSHIP			
GRID AND			
DIAMOND DRILL LOACATION			
PLANNED BY	DATE	SHEET NO. OF	TOTAL SHEETS
DESIGNED BY	DATE	SCALE	
APPROVED BY	DATE		

