

Hole R-1-98 AZ 366° Dip 50° - locate Turnbull Twp CI-1207720
 Length 50 meters.

From (m)	To (m)	DESCRIPTION	Sample #	From (m)	To (m)	Length (m)	Sample Description	Au (ppb)	Au (oz/t)	Zn (ppm)
0	21.95	CASING	88704	22.95	23M	1.05M	.53m of Brownish Qtz.			
21.95	22.47	Brownish Qtz Feld Per cut 1 = few small Qtz-cal str	88705	23M	24M	1	feld per + 20cm of redish Kermitic str + 27cm of Gl. 47cm of Gabbro + 50cm of Granitic str. silicified 15m Qtz str			
22.47	26.7M	Fine gr'd to Medium gr'd dark green Gabbro cut by numerous Kermitic str and Feld Porphyry dikes from 2" to 7" = 27.20m Most Granitic str at 10° to S.A. and at 45° to S.A.	88706	25	26M	1	60cm of Granite dikes 40cm of Gl. v.l. Py			
26.7	27.16	Brownish speckled Feld Per etc Upper contact at 45° to C.A. however contact irregular at 40 to 50° to C.A.	88707	26	27	1M	40cm of Qtz Feld Per 60cm Fine gr'd Pyritic Gabbro dotted with black spks not magnetic.			
27.16	33.24	Med gr'd Feldspar rich Gabbro Varying from dk green massive phase to Feldspar rich phases, locally chloritized.	88708	27	28	1M	16cm of Feld. Per, 84cm of med gr'd Gabbro + diss Py + diss black in not magnetic. v.l. Py.			
33.24	40.62	Gray bleached Basalt flow with circular phenocrysts and amg.ules with chlorite centers 34-35 5 white Qtz str in this section 3cm to 5cm in width veins vary from 45°-45° to C.A.	88709	28	29	1M	Highly chloritized section with Qtz-cal str with Py and blebs of chalc in str and on chloritic shear planes.			
40.62	42.43	Pink to white Granodiorite carrying 10% Qtz str v.l. Py	88710	33.24	34	.76	Bleached volcanic flow local diss Py + chalc			
			88711	34	35	1	5 white Qtz str + Pyritic kermitized volcanics.			
			88712	35	36	1	carb volcanics local diss Py			
			88713	36	37	1	A few Qtz str			
			88714	37	38	1				
			88715	38	39	1	chlorite patches + 10% sm Qtz str local diss Py			
			88716	39	40	1	10% sm Qtz str in chloritic Vol.			
			88717	40	41	1	50% chloritic Vol + Granodiorite.			
			88718	41	42	1	90% Granodiorite with 5% Qtz str.			
			88719	42	43	1	Mostly Gb + Granodiorite + Qtz str			
			88720	43	44	1	50% dikes + 50% Pyritic Gb			

RECEIVED
 6061 01 MAY
 1999

2.19482



From (m)	To (m)	DESCRIPTION	Sample #	From (m)	To (m)	Length (m)	Sample Description	Au (ppb)	Au (oz/t)	Zn (ppm)
42.40	45.26	Coarse to fine gr'd Gabbro cut by a few sm qtz-calcite strcs and 4 small Grndiorite strcs with 5-10 sm qtz-calc.	88721	44	45	1m	30% Granodiorite dykes 70% dk green Gabbro 5% qtz-calc strcs V.L. Py			
			88722	45	46	1M	DK gr Gabbro V.L. Py a few sm qtz-calc strcs			
45.26	46.03	Granodiorite dyke with 20% qtz strcs both contacts at 15° to C.A.	88723	46	47	1m	DK gr. fine gr'd Gabbro a little diss. fine Py.			
46.03	50	DK green Gabbro cut by 5 to 10% qtz-calc strcs + sm qtz strcs mostly at 60° to C.A. locally epidote rich.	88724	47	48	1M	Fine diss Py in Gabbro a few calcitic qtz strcs.			
			88725	48	49	1M	Very few qtz strcs minor fine Py in Gb.			
			88726	49	50	1M	A few qtz strcs V.L. diss fine Py			
		50M End of Hole								

[Signature]
 Geocal Exploration Services
 for Cliff Mackenzie deceased.

From (m)	To (m)	DESCRIPTION	Sample #	From (m)	To (m)	Length (m)	Sample Description	Au (ppb)	Au (oz/t)	Zn (ppm)
0	1.52	CASING	88727	1.52	2M	.48M				
1.52	18.95	Mafic volcanic flow brecciated and Pyritic. From 2.55m to 3m locally broken core. Green color.	88728	2m	3m	1m	chl. str. 60% broken Cerc. V.k. Py			
		3m - 5m layer in Carbonate Pyritic Schistosity developed at 51° to 70° to SH. 5m - 6m schistosity at 35° to C.A.	88729	3m	4m	1m	A few small str. chloritic sulfonitized Gray green V.k. Py			
		6m - 7m schistosity at 15-75° to C.A.	88730	4m	5m	1m	chloritic Bx V.k. Py.			
		From 9m - 14m Bleached zone to white Carbonate zone. Local 15-15% Pyrite only local Qtz str. Schistosity at 35° to 40° to C.A.	88731	5m	6m	1m	layer in pinkish Carb str V.k. mineral			
		14m - 15m massive carbonate and mafic vol. a few sm calcitic str V.k. Py.	88732	6m	7m	1m	Finely brecciated mafic vol. V.k. min			
		AT 18m schistosity at 45° to 50° to C.A. From 18.36 to 18.4 cut by granodiorite str.	88733	7m	8m	1m	layer in reddish Qtz + carb a few spks of Py			
18.95	21.1m	Coarse Gabbro large rounded feldspars up to 2cm in length calcitic breccia borders.	88734	8m	9m	1m	A few Qtz str + diss Py			
			88735	9m	10m	1m	26cm with brown Carb + Py + 1-5cm Qtz str. 74cm of vol.			
			88736	10m	11m	1m	Bx zone 20% fine Py No Qtz str.			
			88737	11	12	1m	40cm of 5-15% diss Py + brown Carb in fractures.			
			88738	12	13	1m	White fragments of gabbro brown Carb + 2% diss Py			
			88739	13	14	1m	1-2% sm Qtz str 2% diss Py			
			88740	14	15	1m	Leucocrane der gray green Pyritic mafic vol. a few sm str			
			88741	15	16	1	layer in Qtz-calcite str V.k. Py			
			88742	16	17	1	20% Qtz-calcite str local diss Py			
				17	18	1	15-20% sm Qtz-calcite str V.k. Py			

RECEIVED
 JUL 01 AM
 GEOSCIENTIFIC ASSESSMENT OFFICE

42A05NE2020 2.19482
 TURNBULL
 020

From (m)	To (m)	DESCRIPTION	Sample #	From (m)	To (m)	Length (m)	Sample Description	Au (ppb)	Au (oz/t)	Zn (ppm)
35.86	37.55	White Granite dy Ke	88745	24.16	25	.9	20% Qtz-Cal strcs 100/0 red Gr strcs.			
37.55	38.56	Fine gr'd Gabbro -	88746	31	32	1	DK gr Gabbro 5-100% Magnetite 2% Py Viki chalc			
35.86	39.14	Granodiorite with inc signs of black volcanic? inclusions Pyritic -	88747	34	35	1	10% Magnetite and 15% calcite strcs + diss Py Viki chalc			
38.14	47	Shear zone schistosity @ small angle to C.A. Carb + striated str. eyes Porphyry in black Gabbro fine gr'd	88748	37	39	1	67cm of Gr			
			88749	39	40	1	45cm of Qtz veining + a few Qtz-cal veins + 30cm of Pyritic G			
47	49.6	Med gr'd feldspar rich Gabbro locally Py curds	88750	40	41	1				
			15413	41	42	1				
49.6	50	Orange col Granite dy Ke w/epi contact at 45° to C.A. 50M End of Hole	15414	42	43	1				
			15415	43	44	1				
			15416	44	45	1				
			15417	45	46	1				
			15418	46	47	1				
		Global Exploration Services.	15419	47	48	.9m	Black nonmagnetic min Med gr'd Gb.			
		for Cliff Mackenzie deceased.	15420	47.1	48	.9m	Med gr'd Gb + magnetite			
			15421	48	49	1m	Med gr'd Gb Py + Magnetite			
			1522	49	50	1m	Gb + 37cm of Granite			

Hole R-3 AZ 250° Dip 50°
Length 56m

Location - Turnbull Camp
C1-

From (m)	To (m)	DESCRIPTION	Sample #	From (m)	To (m)	Length (m)	Sample Description	Au (ppb)	Au (oz/t)	Zn (ppm)
0	2.43m	Casing	88651	3	4	1m	Grey Por Qtz eye V.L. Py local chl + blue qtz eyes.			
2.43	9.64m	Pale grey Qtz eye Porphyry. Locally chloritic minor diss. locally cut by small qtz str with brown Carb zones usually at a small angle to C.A	88652	4	5	1m	A few sm Qtz str, pink ch + brown Carb alt.			
			88653	5	6	1m	Diss Py 10% to 30%			
			88654	6	7	1m	2 sm qtz str + brown Carb in brown Carb along shear planes, diss Py a few qtz str			
9.64m	11.5m	Blotchy fragmental App to Carb. Large 2 to 3 cm of Ankerite fragments minor chl. V.L. Py Pink carb to Carbonate from 11m to 11.5m	88655	7	8	1m	30% brown carb at 10° to 30° to C.A. 10% diss Py in bleached Por.			
		Lower contact irreg into Gabbro	88656	8	9	1m	Bleached Qtz Por with brown Carb bands at 45° to 70° to C.A			
11.5	17.4	DK green medium gr Gabbro cut by redish Granite strings and dikes of Granite, spotted Gabbro with white feldspars	88657	9	10	1m	Bleached Qtz eye Por minor Py bands of br Carb			
			88658	10	11	1m	Carbonate breccias white of Pink in color. V.L. Py			
17.4	18.3	Medgrid white Granite dyke upper contact at 15° to C.A lower contact at 20° to C.A, chloritic	88659	11	12	1m	50% Pink Carb frag + 50% DK gr Gabbro			
18.3	19m	DK green spotted Gabbro								
19m	22m	Granite with inclusions of Gabbro	88660	12	13	1m	Gabbro + Granite str and qtz str. 50% Granite str.			
			88661	13	14	1m	Medgrid Pyritic Gabbro with str of Granite			
			88662	14	15	1m	Gabbro, V.L. Py 50% Granite str + qtz-cal str			
			88663	15	16	1m	Mostly Pyritic Gb. a few Gr. str.			
			88664	16	17	1m	Pyritic Gb. + sm qtz-cal str			
			88665	17	18	1m	1.04 m of Gb 96 cm of			
			88666				Gr. dike 1 qtz str with Py + brown Ank at 30° to C.A			

RECEIVED
MAY 11 1982

MEMBER 42A05NE2020 2.19482 TURNBULL 030



28761.2

From (m)	To (m)	DESCRIPTION	Sample #	From (m)	To (m)	Length (m)	Sample Description	Au (ppb)	Au (oz/t)	Zn (ppm)
22m	26.08	DK green Massive Gb 5 to 10% magnetite in blebs and along str of qtz-corb NO calcite. V.L. diss Py	88666	18	19	1	50% Gr and 50% Gb V.L. Py No qtz str			
		From 25.4 to 26.8 coarse gold Gabbro with 70% white feldspar. sharp contact at 30° to C.A.	88667	19	20	1	Mostly Granite with Gb inclusions			
			88668	20	21	1	Mostly Granite with Gb inclusions. V.L. Py			
			88669	21	22	1	Mostly Granite dyke with sm Gb inclusions			
26.08	30m	Granodiorite porphyritic packed white and pink feldspars less than 1mm in length. Occ. sm qtz str with diss cubic Py.	88670	22	23	1	Gb with 5 to 10% magnetite V.L. Py +			
		From 30m/ becoming bleached and finer grained with Incl. in mm wide qtz-calc str at sm angle to C.A.	88671	23	24	1	Incl. in diss Py in Gb. + 5% diss magnetite			
		a little diss Py locally in sm qtz str and along chlorite shear planes	88672	24	25	1	Gb + 5% magnetite + diss Py			
		Gradational change to less feldspar incr in qtz eyes and sericite	88673	25	26	1	Gb + Mag and Granite str. + 16cm of white anorthosite Gabbro.			
			88674	26	27	1	Med gr Granodiorite			
30m	36m	Yellowish qtz eye periphery cut by Qtz tourmaline veins with patches of Pyrite. brown ink and black str of Tour. malis	88675	27	28	1	Med gr Granodiorite V.L. diss Py			
		35.4 to 36.2 badly brecciated Core	88676	28	29	1	Med gr Granodiorite 5% sm qtz calc str pyritic			
36	36.61	Grey altered zone with rimmed feldspars + dk centric sharp contact at 36.62 at 90° to C.A.	88677	29	30	1	3% sm qtz-calc str local diss Py in fine grained Granodiorite			
			88678	30	31	1	3% sm qtz-calc str in Granodiorite.			
36.61	36.80	Red Granite dyke both contacts at 90° to C.A.	88679	31	32	1	Bleached sericitic Granodiorite 4 qtz str 1, 17cm wide as part of a larger vein + 14 qtz veins. Patches of Py + tourmaline str			
			88680	32	33	1	44cm wide qtz tour vein + 3 qtz str chlorite patch. thin calc sericitic.			

From (m)	To (m)	DESCRIPTION	Sample #	From (m)	To (m)	Length (m)	Sample Description	Au (ppb)	Au (oz/t)	Zn (ppm)
36.80	38.9	2.10 meters of Fin grid Gabbro becoming Coarse spalte = Anorthositic Gb at 38m to 34.9 meters	88681	33	34	1	Qtz eye Per Sericitic a few sm qtz-cal str			
			88682	34	35	1	yellowish Qtz eye Per			
38.9	39.41	.51 meters of redish porphyritic Granodiorite - upper part at 15° to C.A. lower contact at 50° to C.A.	88683	35	36	1	yellowish Qtz eye Per			
			88683	36	37	1	27cm of Redish Gr dike + Gray alt. zone			
39.41	56m	Grey green highly feldspathic med grid obicular plagioclase & feldspar with chlorite centers. Inaggregates of chlorite large blue aggregates of qtz eyes dev. (Qtz Gabbro) locally cut by small str = Granite. Amygdaloidal app. may be volcanican origin?	88684	37	38	1	Med grid feldspar rich Gb			
			88685	38	39	1	Gb + feldspar of Granodiorite no qtz str or min			
			88686	39	40	1	.51 meters of redish fine grid Granodiorite 4.9 m of Coarse Gb.			
		58.14 to 51.3m, 1.16m of redish Granodiorite dyke	88687	40	41	1	Mostly Gb. a few qtz-cal str + (by 10cm wide red dyke.			
		56m - End of hole	88688	41	42	1	1/2 cm band of qtz-cal str a few qtz-cal str mostly Gabbro			
			88689	42	43	1	Gray gr. med grid Gabbro			
			88690	43	44	1	" " "			
			88691	44	45	1	" " "			
			88692	44	45	1	" " "			
			88693	45	46	1	" " "			
			88694	46	47	1	A few sm qtz-cal str			
			88695	47	48	1	Gb with a few sm qtz-cal str			
			88696	48	49	1	A few sm qtz-cal str in Gb.			
			88697	49	50	1	Gray Gb. Gabbro no min			
			88698	50	51	1	Redish Granodiorite			
			88699	51	52	1	30cm of Granodiorite + 70cm Gb			
			88700	52	53	1	Gabbro V.L. min			
			81701	53	54	1	G			
			86702	54	55	1				

[Handwritten signature]
 Geo Cal Exploration Services
 for Cliff Mackenzie is deceased.



Swastika Laboratories

A Division of TSL/Assayers Inc.

Established 1928

Assaying - Consulting - Representation

Page 1 of 2

Geochemical Analysis Certificate

8W-4856-RG1

Company: **B. ROUSSEAU**
Project: Turnbull
Attn: B. Rousseau

Date: DEC-17-98

We hereby certify the following Geochemical Analysis of 53 Core samples submitted DEC-14-98 by .

Sample Number	Au PPB	Au Check PPB	Ba PPM	Zn PPM	Pt PPB	Pd PPB
88651	Nil	-	-	-	-	-
88652	7	-	-	-	-	-
88653	12	-	-	-	-	-
88654	Nil	-	-	-	-	-
88655	26	-	-	-	-	-
88656	17	-	-	-	-	-
88657	51	51	-	-	-	-
88658	9	-	Nil	96	-	-
88659	Nil	-	-	-	-	-
88660	3	-	-	-	-	-
88661	5	-	-	-	-	-
88662	2	-	-	-	-	-
88663	2	-	-	-	-	-
88664	5	-	-	-	-	-
88665	3	-	-	-	-	-
88666	3	-	-	-	-	-
88667	2	-	-	-	-	-
88668	Nil	3	-	-	-	-
88669	2	-	-	-	-	-
88670	5	-	-	-	5	5
88671	9	-	-	-	-	-
88672	3	-	-	-	5	5
88673	Nil	-	-	-	-	-
88674	Nil	-	-	-	-	-
88675	5	-	-	-	-	-
88676	2	2	-	-	-	-
88677	2	-	-	-	-	-
88678	7	-	-	-	-	-
88679	105	94	-	-	-	-
88680	24	-	-	-	-	-

One assay ton portion used.

RECEIVED
MAY 10 1999
GEOSCIENCE ASSESSMENT OFFICE

Certified by

42A05NE2020 2.19482 TURNBULL



1 Cameron Ave., P.O. Box 10, Swastika, Ontario P0K 1T0
Telephone (705)642-3244 Fax (705)642-3300

040



Established 1928

Swastika Laboratories

A Division of TSL/Assayers Inc.

Assaying - Consulting - Representation

Page 2 of 2

8W-4856-RG1

Date: DEC-17-98

Geochemical Analysis Certificate

Company: **B. ROUSSEAU**
Project: Turnbull
Attn: B. Rousseau

We hereby certify the following Geochemical Analysis of 53 Core samples submitted DEC-14-98 by .

Sample Number	Au PPB	Au Check PPB	Ba PPM	Zn PPM	Pt PPB	Pd PPB
88681	7	9	-	-	-	-
88682	9	-	-	-	-	-
88683	5	-	-	-	-	-
88684	5	-	-	-	-	-
88685	7	-	-	-	-	-
88686	2	-	-	-	-	-
88687	3	-	-	-	-	-
88688	7	-	-	-	-	-
88689	2	-	-	-	-	-
88690	5	-	-	-	-	-
88691	7	2	-	-	-	-
88692	3	-	-	-	-	-
88693	3	-	-	-	-	-
88694	5	-	-	-	-	-
88695	3	-	-	-	-	-
88696	5	-	-	-	-	-
88697	2	5	-	-	-	-
88698	3	-	-	-	-	-
88699	Ni 1	-	-	-	-	-
88700	19	-	-	-	-	-
88701	2	-	-	-	-	-
88702	5	-	-	-	-	-
88703	2	-	-	-	-	-

RECEIVED
MAY 10 1999
GEOSCIENCE ASSESSMENT
OFFICE

One assay ton portion used.

Certified by 

1 Cameron Ave., P.O. Box 10, Swastika, Ontario P0K 1T0
Telephone (705)642-3244 Fax (705)642-3300



Swastika Laboratories

A Division of TSL/Assayers Inc.

Established 1928

Assaying - Consulting - Representation

Page 1 of 2

Geochemical Analysis Certificate

8W-4875-RG1

Company: **R. ROUSSEAU**
Project: Turnbull
Attn: R. Rousseau

Date: DEC-23-98

We hereby certify the following Geochemical Analysis of 47 Core samples submitted DEC-15-98 by .

Sample Number	Au PPB	Au Check PPB	Pt PPB	Pd PPB
88704	10	-	-	-
88705	Nil	-	-	-
88706	2	-	-	-
88707	3	-	⊂	⊂
88708	2	-	⊂	⊂
88709	125	134	⊂	⊂
88710	Nil	-	⊂	⊂
88711	Nil	-	⊂	⊂
88712	Nil	-	⊂	⊂
88713	Nil	-	⊂	⊂
88714	Nil	-	⊂	⊂
88715	7	2	⊂	⊂
88716	10	-	⊂	⊂
88717	Nil	-	⊂	⊂
88718	2	-	⊂	⊂
88719	12	-	⊂	⊂
88720	72	89	⊂	⊂
88721	38	-	⊂	⊂
88722	7	-	⊂	⊂
88723	Nil	-	⊂	⊂
88724	Nil	-	⊂	⊂
88725	Nil	-	⊂	⊂
88726	5	Nil	⊂	⊂
88727	Nil	-	⊂	⊂
88728	Nil	-	⊂	⊂
88729	Nil	-	⊂	⊂
88730	Nil	-	⊂	⊂
88731	Nil	-	⊂	⊂
88732	Nil	-	⊂	⊂
88733	12	-	⊂	⊂

One assay ton portion used.

Certified by _____

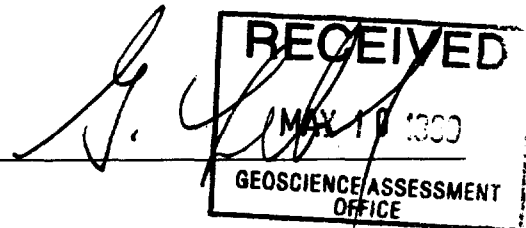

2.19482



Established 1928

Swastika Laboratories

A Division of TSL/Assayers Inc.

Assaying - Consulting - Representation

Page 2 of 2

Geochemical Analysis Certificate

8W-4875-RG1

Company: **R. ROUSSEAU**
Project: Turnbull
Attn: R. Rousseau

Date: DEC-23-98

We hereby certify the following Geochemical Analysis of 47 Core samples submitted DEC-15-98 by .

Sample Number	Au PPB	Au Check PPB	Pt PPB	Pd PPB
88734	2	-	5	5
88735	22	31	5	5
88736	3	-	5	5
88737	154	-	5	5
88738	180	158	5	5
88739	123	-	5	5
88740	Nil	-	5	5
88741	Nil	-	5	5
88742	5	-	5	5
88743	5	-	5	5
88744	Nil	-	5	5
88745	2	-	5	5
88746	2	-	5	5
88747	Nil	-	5	5
88748	60	96	-	-
88749	10	-	-	-
88750	120	91	-	-

One assay ton portion used.

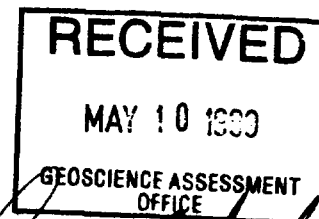

Certified by _____



Swastika Laboratories

A Division of TSL/Assayers Inc.

Assaying - Consulting - Representation

Established 1928

Geochemical Analysis Certificate

8W-4885-RG1

Company: **R. Rousseau**
Project: **Turnbull**
Attn: **R. Rousseau**

Date: DEC-21-98

We hereby certify the following Geochemical Analysis of 10 Core samples submitted DEC-16-98 by .

Sample Number	Au PPB	Au Check PPB	Ag PPM	MoS2 PPM	Zn PPM
15413	221	240	-	-	-
15414	14	-	-	-	-
15415	Nil	-	-	-	-
15416	3	-	-	-	-
15417	31	27	-	-	-
15418	3	-	-	-	-
15419	2	-	0.2	1	136
15420	3	-	-	-	-
15421	5	-	-	-	-
15422	2	2	-	-	-

One assay ton portion used for gold.

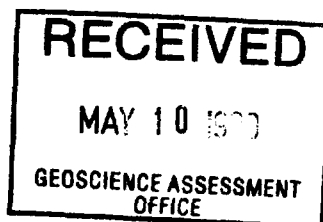

2.19482

Certified by



42A05NE2020 2.19482 TURNBULL 900

Subsections 65(2) and 66(3) of the Mining Act. Under section 8 of the Mining Act, assessment work and correspond with the mining land holder. Questions about this Act, Assessment Files Research Imag, 3rd Floor, 933 Ramsey Lake Road, Sudbury, Ontario, P3E 1

Instructions: - For work performed on Crown Lands before recording a claim, use form 0240.
- Please type or print in ink.

1. Recorded holder(s) (Attach a list if necessary)

Name <i>MAUREEN ROUSSEAU</i>	Client Number <i>299033</i>
Address <i>Box 2122</i>	Telephone Number <i>705-267-3779</i>
<i>Timmins ONTARIO - P4N 7X8</i>	Fax Number
Name	Client Number
Address	Telephone Number
	Fax Number

TURNBULL

2. Type of work performed: Check (✓) and report on only ONE of the following groups for this declaration.

Geotechnical: prospecting, surveys, assays and work under section 18 (regs) Physical: drilling stripping, trenching and associated assays Rehabilitative

Work Type <i>DIAMOND DRILL PROGRAM</i>	Office Use
	Commodity
	Total \$ Value of Work Claimed <i>\$11,436</i>
Dates Work Performed From <i>8 12 98</i> To <i>23 12 98</i>	NTS Reference
Global Positioning System Data (if available)	Mining Division <i>Porcupine</i>
Township/Area <i>TURNBULL</i>	Resident Geologist District <i>Timmins</i>
M or G-Plan Number	

Please remember to: - obtain a work permit from the Ministry of Natural Resources as required;
- provide proper notice to surface rights holders before starting work;
- complete and attach a Statement of Costs, form 0212;
- provide a map showing contiguous mining lands that are linked for assigning work;
- include two copies of your technical report.

3. Person or companies who prepared the technical report (Attach a list if necessary)

Name <i>Geocal Exploration Inc.</i>	Telephone Number <i>705-267-3511</i>
Address <i>168 Alouette Blvd East - Timmins Ontario</i>	Fax Number <i>705-267-3121</i>
Name <i>Lionel Barlowe</i>	Telephone Number <i>705-267-3511</i>
Address <i>168 Alouette Blvd East Timmins Ontario</i>	Fax Number <i>705-267-3121</i>
Name	Telephone Number
Address	Fax Number

4. Certification by Recorded Holder or Agent

I, *Maureen Rousseau* (Print Name), do hereby certify that I have personal knowledge of the facts set forth in this Declaration of Assessment Work having caused the work to be performed or witnessed the same during or after its completion and, to the best of my knowledge, the annexed report is true.

Signature of Recorded Holder or Agent <i>Maureen Rousseau</i>	Date <i>May 4, 1999</i>
Agent's Address	Telephone Number <i>705-267-3779</i>
	Fax Number

2.19482

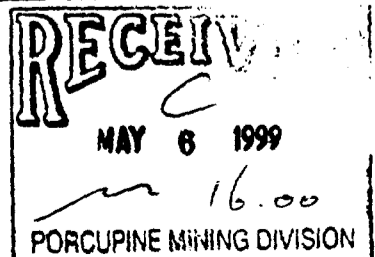
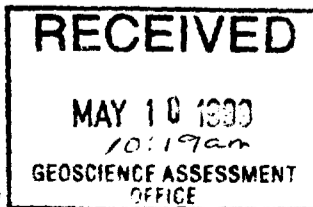

the mining land where work was performed, at the time work was performed. A map showing the contiguous claims must accompany this form.

W9960.0022

Mining Claim Number. Or if work was done on other eligible mining land, show in this column the location number indicated on the claim map	Number of Claim Units. For other mining land, list hectares.	Value of work performed on this claim or other mining land.	Value of work applied to this claim.	Value of work assigned to other mining claims.	Bank. Value of to be distributed at a future date.
eg TB 7827	16 ha	\$26,825	N/A	\$24,000	\$2,825
eg 1234567	12	0	\$24,000	0	0
eg 1234568	2	\$8,892	\$4,000	0	\$4,892
1 1207720	2	11436.	800	1600	9036
2 1207068	(1)		400		
3 1213176	1		400		
4 1213175	2		800		
5					
6					
7					
8					
9					
10					
11					
12					
13					
14					
15					
Column Totals		11436	2400	1600	9036

I, Robert Rousseau Agent, do hereby certify that the above work credits are eligible under subsection 7 (1) of the Assessment Work Regulation 6/96 for assignment to contiguous claims or for application to the claim where the work was done.

Signature of Recorded Holder or Agent Authorized in Writing: Robert Rousseau Date: May 4/99

8. Instructions for cutting back credits that are not approved.

Some of the credits claimed in this declaration may be cut back. Please check (✓) in the boxes below to show how you wish to prioritize the deletion of credits:

- 1. Credits are to be cut back from the Bank first, followed by option 2 or 3 or 4 as indicated.
- 2. Credits are to be cut back starting with the claims listed last, working backwards; or
- 3. Credits are to be cut back equally over all claims listed in this declaration; or
- 4. Credits are to be cut back as prioritized on the attached appendix or as follows (describe):

RECEIVED
MAY 10 1999
GEOSCIENCE BUSINESS OFFICE

Note: If you have not indicated how your credits are to be deleted, credits will be cut back from the Bank first, followed by option number 2 if necessary.

For Office Use Only
Received Stamp: **RECEIVED**
MAY 8 1999
16.00
ECONOMIC MINING DIVISION

Deemed Approved Date	Date Notification Sent
Date Approved: <u>2.19402</u>	Total Value of Credit Approved

Approved for Recording by Mining Recorder (Signature) 2

Geoscience Assessment Office
933 Ramsey Lake Road
6th Floor
Sudbury, Ontario
P3E 6B5

Telephone: (888) 415-9846
Fax: (877) 670-1555

June 1, 1999

A. MAUREEN ROUSSEAU
P.O. BOX 2122
TIMMINS, ONTARIO
P4N-7X8

Visit our website at:
www.gov.on.ca/MNDM/MINES/LANDS/mlsmnpge.htm

Dear Sir or Madam:

Submission Number: 2.19482

Status

Subject: Transaction Number(s): W9960.00226 Deemed Approval

We have reviewed your Assessment Work submission with the above noted Transaction Number(s). The attached summary page(s) indicate the results of the review. **WE RECOMMEND YOU READ THIS SUMMARY FOR THE DETAILS PERTAINING TO YOUR ASSESSMENT WORK.**

If the status for a transaction is a 45 Day Notice, the summary will outline the reasons for the notice, and any steps you can take to remedy deficiencies. The 90-day deemed approval provision, subsection 6(7) of the Assessment Work Regulation, will no longer be in effect for assessment work which has received a 45 Day Notice. Allowable changes to your credit distribution can be made by contacting the Geoscience Assessment Office within this 45 Day period, otherwise assessment credit will be cut back and distributed as outlined in Section #6 of the Declaration of Assessment work form.

Please note any revisions must be submitted in DUPLICATE to the Geoscience Assessment Office, by the response date on the summary.

If you have any questions regarding this correspondence, please contact Lucille Jerome by e-mail at lucille.jerome@ndm.gov.on.ca or by telephone at (705) 670-5858.

Yours sincerely,



ORIGINAL SIGNED BY
Blair Kite
Supervisor, Geoscience Assessment Office
Mining Lands Section

Work Report Assessment Results

Submission Number: 2.19482

Date Correspondence Sent: June 01, 1999

Assessor: Lucille Jerome

Transaction Number	First Claim Number	Township(s) / Area(s)	Status	Approval Date
W9960.00226	1207720	TURNBULL	Deemed Approval	June 01, 1999

Section:

16 Drilling PDRILL

Correspondence to:

Resident Geologist
South Porcupine, ON

Assessment Files Library
Sudbury, ON

Recorded Holder(s) and/or Agent(s):

A. MAUREEN ROUSSEAU
TIMMINS, ONTARIO

ROBERT ROGER ROUSSEAU
TIMMINS, ONTARIO

GEORGES FOURNIER
TIMMINS, Ontario

REFERENCES

AREAS WITHDRAWN FROM DISPOSITION

- M.R.O. - MINING RIGHTS ONLY
- S.R.O. - SURFACE RIGHTS ONLY
- M.+S. - MINING AND SURFACE RIGHTS

Description	Order No.	Date	Disposition	File

(R) - AGGREGATE PERMIT - NOTICE RECEIVED JUNE 16, 1993

(RS) - THE MINING AND SURFACE RIGHTS ARE WITHDRAWN FROM PROSPECTING, STAKING OUT, SALE OR LEASE UNDER SECTION 35 OF THE MINING ACT R.S.O. 1990 DATED JAN. 11, 1986 AT 1016 A.M. ORDER NO. W-P-1/86 NER.

NOTES

THIS TOWNSHIP LIES WITHIN THE MUNICIPALITY OF THE CITY OF TIMMINS.

(ST) - PROPOSED SNOWMOBILE TRAIL NOTICE REC'D 93-MAY-20

(E) - THIS TWP SUBJECT TO FOREST ACTIVITY IN 1995-9 FURTHER INFORMATION AVAILABLE ON FILE.

□ - open
June 1/97.
(see Ont. Gazette)

THE INFORMATION THAT APPEARS ON THIS MAP HAS BEEN COMPILED FROM VARIOUS SOURCES, AND ACCURACY IS NOT GUARANTEED. THOSE WISHING TO STAKE MINING CLAIMS SHOULD CONSULT WITH THE MINING RECORDER, MINISTRY OF NORTHERN DEVELOPMENT AND MINES, FOR ADDITIONAL INFORMATION ON THE STATUS OF THE LANDS SHOWN HEREON.



Robb TP.

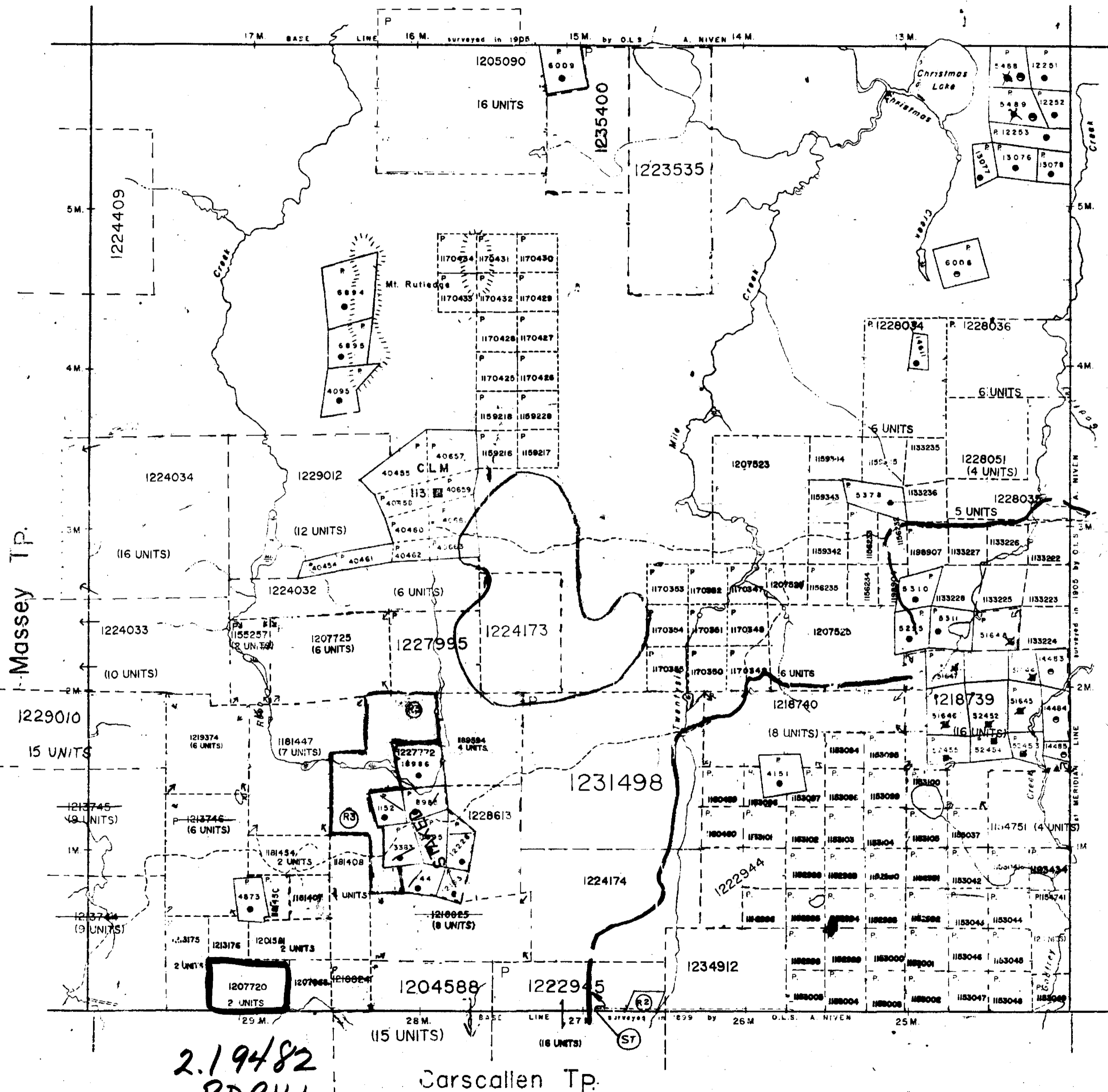

2.19482
PDRILL

LEGEND

- HIGHWAY AND ROUTE No.
- OTHER ROADS
- TRAILS
- SURVEYED LINES:
 - TOWNSHIPS, BASE LINES, ETC.
 - LOTS, MINING CLAIMS, PARCELS, ETC.
- UNSURVEYED LINES:
 - LOT LINES
 - PARCEL BOUNDARY
 - MINING CLAIMS ETC.
- RAILWAY AND RIGHT OF WAY
- UTILITY LINES
- NON-PERENNIAL STREAM
- FLOODING OR FLOODING RIGHTS
- SUBDIVISION OR COMPOSITE PLAN
- RESERVATIONS
- ORIGINAL SHORELINE
- MARSH/MUSKOG
- MINES
- TRAVERSE MONUMENT

DISPOSITION OF CROWN LANDS

TYPE OF DOCUMENT	SYMBOL
PATENT, SURFACE & MINING RIGHTS	
" SURFACE RIGHTS ONLY	
" MINING RIGHTS ONLY	
LEASE, SURFACE & MINING RIGHTS	
" SURFACE RIGHTS ONLY	
" MINING RIGHTS ONLY	
LICENCE OF OCCUPATION	
ORDER-IN-COUNCIL	
RESERVATION	
CANCELLED	
SAND & GRAVEL	

NOTE: MINING RIGHTS IN PARCELS PATENTED PRIOR TO MAY 6 1913 VESTED IN ORIGINAL PATENTEE BY THE PUBLIC LANDS ACT, R.S.O. 1970, CHAP. 300, SEC. 83, SUBSEC. 1.

SCALE: 1 INCH = 40 CHAINS

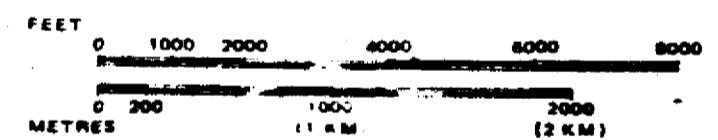

DATE OF ISSUE

APR 27 1990

PROVINCIAL RECORDING OFFICE - SUDBURY

TOWNSHIP
TURNBULL
M.N.R. ADMINISTRATIVE DISTRICT
TIMMINS
MINING DIVISION
PORCUPINE
LAND TITLES / REGISTRY DIVISION
COCHRANE



Date MARCH, 1985
Number
ACTIVATED JANUARY 30, 1990
G-3250

TURNBULL Twp.

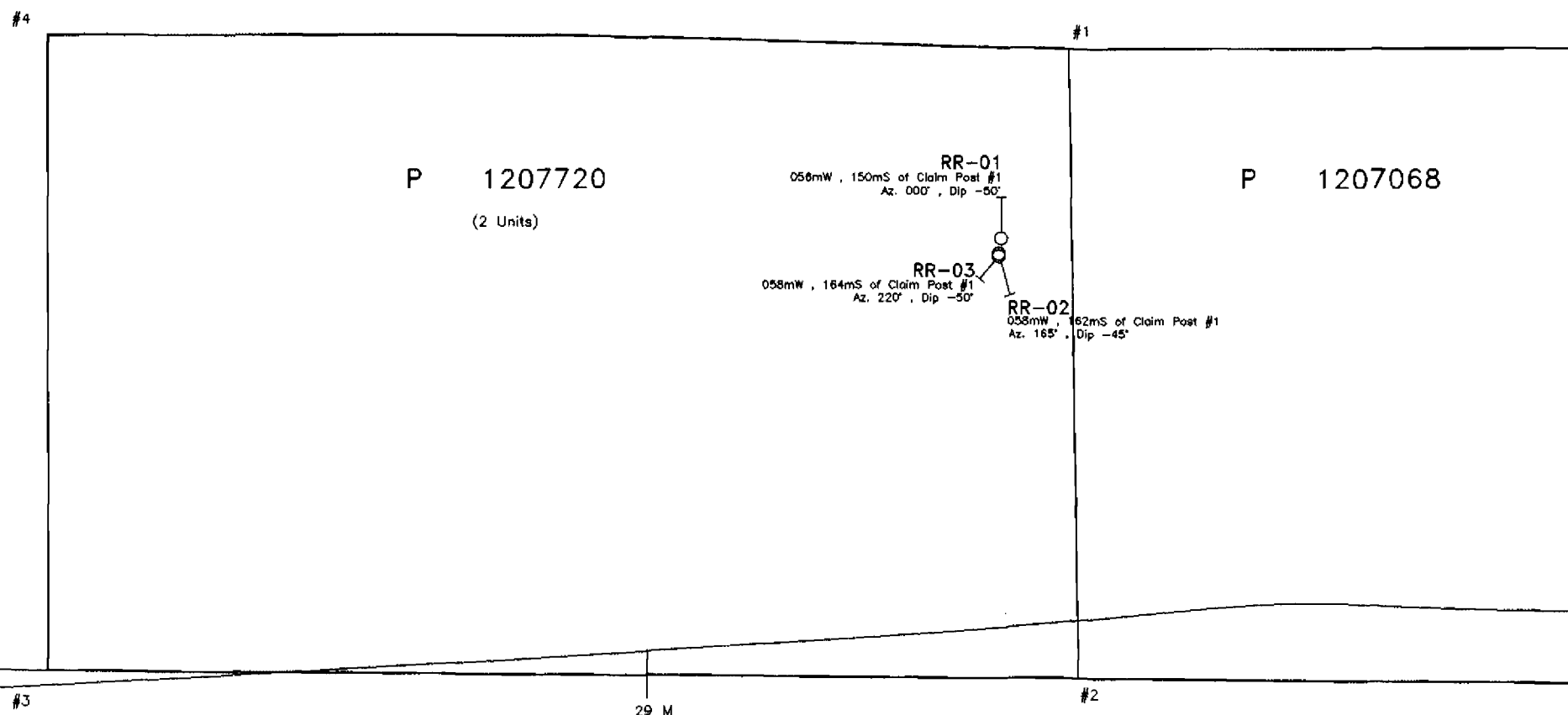

RECEIVED
 MAY 10 1999
 GEOSCIENCE ASSESSMENT
 OFFICE

CARSCALLEN Twp.

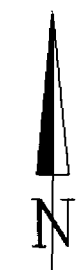

Rousseau - Fournier
 Exploration Timmins, ONTARIO

Rousseau-Fournier Claims
 TURNBULL TOWNSHIP

DIAMOND DRILL PLAN
 DDH RR-01 to 03

TRACED:	DATE:	NTS: 42-A/05 & 12	PROJECT: TURNBULL
DRAWN: dal DRAFTING	DATE: 04/05/99	MAP No:	FILE: ROUFOLFPN
SUPERVISED: R Colman	DATE: 03/05/99	SCALE 1: 5000 (metres)	
REVISED:	DATE:	0 25 50 75 100	



42A05NE2020 2.19482 TURNBULL

Az. 000°

P 1207720

RR-01
056mW , 150mS of Claim Post #1
Az. 000° , Dip -50°

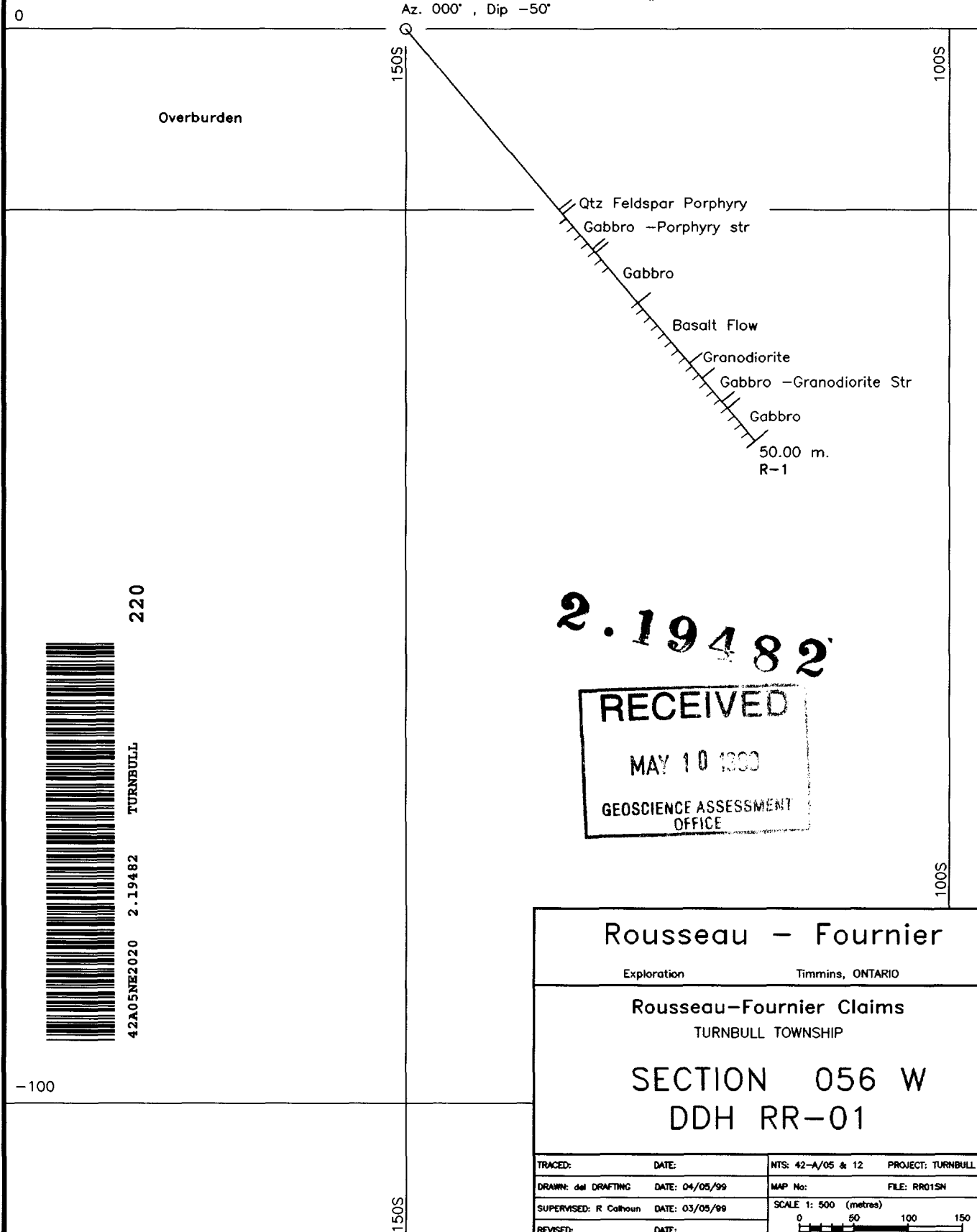

Overburden

Qtz Feldspar Porphyry
 Gabbro - Porphyry str
 Gabbro
 Basalt Flow
 Granodiorite
 Gabbro - Granodiorite Str
 Gabbro
 50.00 m.
 R-1



220
 42A05NE2020 2.19482 TURNBULL

2.19482

RECEIVED
 MAY 10 1999
 GEOSCIENCE ASSESSMENT
 OFFICE

Rousseau - Fournier
 Exploration Timmins, ONTARIO
 Rousseau-Fournier Claims
 TURNBULL TOWNSHIP
 SECTION 056 W
 DDH RR-01

-100

TRACED:	DATE:	NTS: 42-A/05 & 12	PROJECT: TURNBULL
DRAWN: del DRAFTING	DATE: 04/05/99	MAP No:	FILE: RR01SN
SUPERVISED: R Cathoun	DATE: 03/05/99	SCALE 1: 500 (metres)	
REVISED:	DATE:		

Az. 165°

P 1207720

RR-02
058mW , 162mS of Claim Post #1
Az. 165° , Dip -45°

0

0

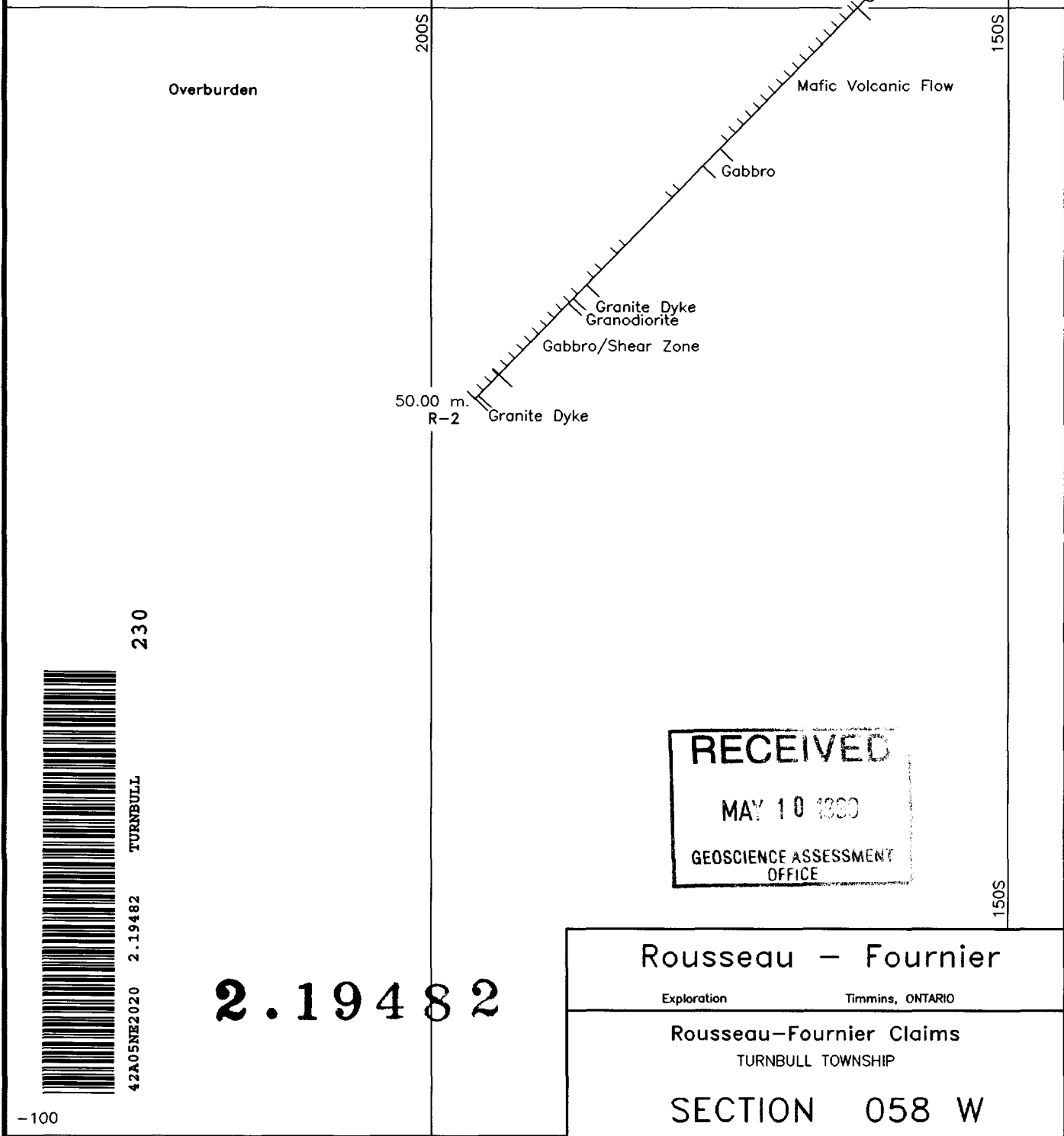

230

2.19482

-100

RECEIVED
MAY 10 1990
GEOSCIENCE ASSESSMENT
OFFICE

Rousseau - Fournier
Exploration Timmins, ONTARIO
Rousseau-Fournier Claims
TURNBULL TOWNSHIP
SECTION 058 W
DDH RR-02

TRACED:	DATE:	NTS: 42-A/05 & 12	PROJECT: TURNBULL
DRAWN: del DRAFTING	DATE: 04/05/99	MAP No:	FILE: RR02SN
SUPERVISED: R Cathoun	DATE: 03/05/99	SCALE 1: 500 (metres)	
REVISED:	DATE:		

200S

150S

150S

200S

P 1207720

Az. 220°

RR-03
058mW , 164mS of Claim Post #1
Az. 220° , Dip -50°

0

0

Overburden

200S

150S

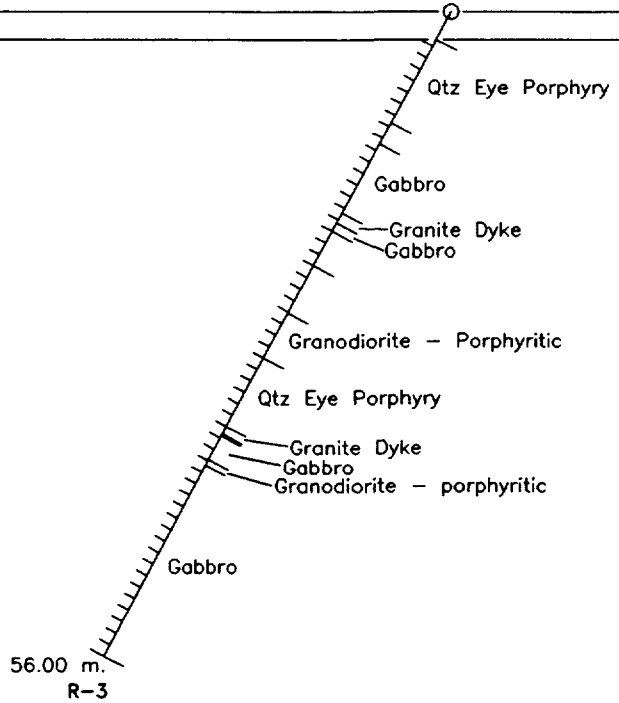

2.19482

RECEIVED
MAY 10 1999
GEOSCIENCE ASSESSMENT
OFFICE



240

TURNBULL

2.19482

42A05NE2020

150S

-100

200S

Rousseau - Fournier

Exploration

Timmins, ONTARIO

Rousseau-Fournier Claims

TURNBULL TOWNSHIP

SECTION 058 W

DDH RR-03

TRACED:	DATE:	NTS: 42-A/05 @ 12	PROJECT: TURNBULL
DRAWN: del DRAFTING	DATE: 04/05/99	MAP No:	FILE: RR03SN
SUPERVISED: R Calhoun	DATE: 03/05/99	SCALE 1: 500 (metres)	
REVISED:	DATE:		