



42A05NE8449 19 BRISTOL

010

Diamond Drilling

Township BRISTOL

Report N<sup>o</sup>: 19

Work performed by: ~~DUCANEX~~ RESOURCES

Claim N <sup>o</sup>	Hole N <sup>o</sup>	Footage	Date	Note
410812	74-1	492.8'	Nov.25/74	(1)
410812	74-2	560'	Dec.2/74	(1)

Notes: (1) #34-75

RALPH E. ALLERSTON - PROSPECTOR

LIC: M-13613

(ASSESSMENT RIGHT ALLERSTON - GROUP)

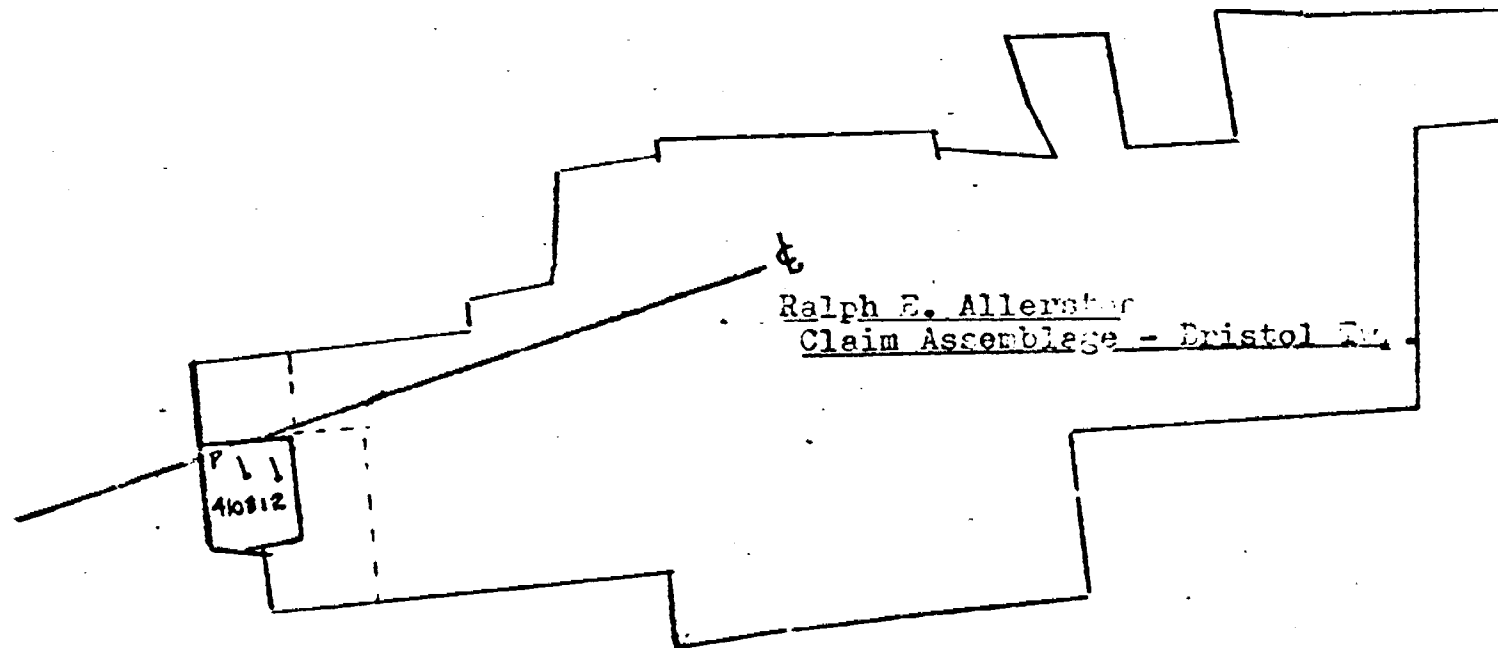

SCALE: 1" = 1/2 Mile

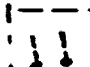
Location of Drill Test  
for Assessment Credits: 

For Logs and  
Detail Sketch

# 34-75 BRISTOL TWP

COMPANY Ducanex Resources  
 Township Bristol Twp., Ontario

PROPERTY Allerston Gold Property  
 Claim No. 410812 (N/E/S/T)

SHEET No. 1 of 7  
 Started Nov. 25/74  
 Finished Nov. 30/74  
 Depth 492.8'

Reference Location Line 40+00W  
7+00S

HOLE No. 74-1  
 Bearing N20°W  
 Dip: -45° @ Collar; -36° @ 200'  
-27° @ 400'

Elevation \_\_\_\_\_  
 Sample Nos. 401 to 428 incl. & 430 are drill sludge samples

FROM	TO	DESCRIPTION	SAMPLES				ASSAYS	
			NO	FROM	TO	WIDTH	Oz. Au	Oz. Ag
0	26	OVERBURDEN - sand & gravel.						
26	28.5	BASIC FRAGMENTAL 5% 1-2 mm angular white feldspar frags in a moderately chloritic f.g., grey-green matrix. Moderately carbonaceous. Sharp lower contact. Foliation @ 30° to c.a.						
28.5	55.5	SERICITE SCHIST (FELSIC TUFF?) - light grey, f.g. to v.f.g., thinly laminated, intensely sheared, friable. Strongly sericitic as laminae & films on foliation planes @ 40° to c.a. - 1% diss. Py as c.g. blebs on foliation planes (often elongate parallel to foliation orient; corroded blebs, rare, cubic xtl's). 33.2-41.1 Rusty (limonitic) + strong Fe carb. alter., friable. Probable fractures to surface @ 33.4' and 36.6'. 3-4% weathered out Py(?). 50.7-51.1 Rusty as above. 52.0-55.5 Rusty as above, soft, crumbly, highly altered. No recognizable sulphides. 55.5-55.7 Irregular Qtz.-carb. vein						
55.5	92.0	CHLORITE SCHIST (ANDESITE FRAGMENTAL?) - matrix, dark grey-green, f.g. to v.f. g., moderately chloritic (+ occasional seam to 40% chlorite). Strongly sheared. Foliation @ 35° to c.a.	401	402	403	404		

Drilled by Bradley Bros.

Core Size BQ

Logged by J. R. Allan  
*J. R. Allan*

COMPANY Ducanex Resources

PROPERTY Allerston Gold Property

Township Bristol Twp., Ontario

Claim No. 410812

SHEET No. 2 of 7

Reference \_\_\_\_\_

HOLE No. 74-1

Started \_\_\_\_\_

Location \_\_\_\_\_

Bearing \_\_\_\_\_

Finished \_\_\_\_\_

Elevation \_\_\_\_\_

Dip: \_\_\_\_\_ e Collar; \_\_\_\_\_ e

Depth \_\_\_\_\_

FROM	TO	DESCRIPTION	SAMPLES				ASSAYS						
			NO	FROM	TO	WIDTH	Oz. Au	Oz. Ag					
		Occasional small-scale crenulations (open style) & pronounced lineations on slip planes.											
		- moderately carbonaceous											
		- highly variable texture. Fragments of very light grey, v.f.g. sericite schist (av.5%) 1-10 mm, stretched 4:1 conformable with orient. of foliation + occasional bands 1 cm. to 10 cm. (fragments?) of sericite schist.											
		- sparse 1" qtz. veins @ 65° to c.a.											
		- occasional rusty laminae or seam											
		- 1% diss. c.g. Py											
92.0	102.5	SERICITE SCHIST (same as 28.5-55.5)	405										
		- sparse dk. green chloritic laminae, widely separated.											
		- strongly sheared.											
		- rare fragments, weakly discernible to 2 cm.											
		- occasional near conformable qtz. veins to 10 mm.											
		- sharp conformable upper & lower contacts											
		- foliation @ 30 to 35° to c.a.											
		- 1% diss. Py											
102.5	124.0	BANDED SCHIST (meta-sediments?)	406										
		- alternate laminae, 1 mm to 2 cm. (sharp distinct contacts) of chlorite schist (70%) and sericite schist (30%).	407										

Drilled by Bradley Bros.

Core Size BQ

Logged by J. R. Allan

COMPANY Ducanex Resources

PROPERTY <sup>(WEST)</sup> Allerston Gold Property

Township Bristol Twp., Ontario

Claim No. 410812

SHEET No. 3 of 7  
 Started \_\_\_\_\_  
 Finished \_\_\_\_\_  
 Depth \_\_\_\_\_

Reference \_\_\_\_\_  
 Location \_\_\_\_\_  
 Elevation \_\_\_\_\_

HOLE No. 74-1  
 Bearing \_\_\_\_\_  
 Dip: \_\_\_\_\_ @ Collar; \_\_\_\_\_ @ \_\_\_\_\_

FROM	TO	DESCRIPTION	SAMPLES			ASSAYS		
			NO	FROM	TO	WIDTH	Oz. Au	Oz. Ag
		- May be strongly sheared agglomerate with felsic fragments in a basic, chloritic matrix(?).						
		- moderately carb. altered						
		- 1% diss. Py						
		- numerous small-scale crenulations						
		- foliation 30-35° to c.a.						
124.0	133.5	SERICITE SCHIST (same as 28.5-55.5)						
		- contains sparse, widely separated chloritic laminae.						
		- sharp upper contact; gradational lower contact over 2'.						
		- intensely sheared. Numerous crenulations.						
		130.4-131.5 Rusty (limonite). Moderately carbonaceous.	408					
133.5	142.8	BANDED SCHIST (same as 102.5-124.0)	409					
		- banding (or fragments?) less distinct than previous; also more chloritic.						
		- 1% diss. Py.						
142.8	146.7	SERICITE SCHIST (same as 28.5-55.5)						
		- occasional near-conformable qtz. vein to 1/2".						
		- 2% diss. Py.						
146.7	180.8	CHLORITE SCHIST (tuffaceous andesite?)	410					
		- f.g., dark green; relatively dense, massive	411					
			412					
		- decrease in chlorite content and increase in sericite down unit.						

Drilled by Bradley Bros.

Core Size BQ

Logged by J. R. Allan

COMPANY Ducanex Resources

PROPERTY Allerston Gold Property

Township Bristol Twp., Ontario

Claim No. 410812

SHEET No. 4 of 7  
 Started \_\_\_\_\_  
 Finished \_\_\_\_\_  
 Depth \_\_\_\_\_

Reference \_\_\_\_\_  
 Location \_\_\_\_\_  
 Elevation \_\_\_\_\_

HOLE No. 74-1

Bearing \_\_\_\_\_  
 Dip: \_\_\_\_\_ @ Collar; \_\_\_\_\_ @ \_\_\_\_\_

FROM	TO	DESCRIPTION	SAMPLES			ASSAYS		
			NO	FROM	TO	WIDTH	Oz. Au	Oz. Ag
		- foliation planes occasionally marked by thin laminae of white carb.						
		- 1% diss. Py throughout.						
		176.7-177.8 DIKE (diorite?) m.g. to f.g., dark grey altered feldspar. Moderately sericitic, weakly chloritic. Strongly sheared.						
		177.8-180.8 SERICITE SCHIST as above 3 to 4% Py (as seams to 5 mm of 20% sulphide).						
180.8	200.5	BANDED SCHIST (meta-sediment? or sheared agglomerate?)	413					
		- 60% sharp, distinct sericite schist laminae 1 mm to 15 mm; 40% dk. grey to grey-green, moderately chloritic laminae. Occasional ser. schist band to 6". Moderately carbonaceous. Strongly sheared, friable.	414					
		- Rare near-conformable qtz. veins to 5 mm.						
		- 1% Py, locally to 2 or 3% (predominantly diss., occasional thin seam).						
		- Foliation @ 40° to c.a.						
		187.8-189.4 DIORITE (same as 176.7-177.8) well foliated. Conformable contacts.						
200.5	238.8	CHLORITE SCHIST (ANDESITE?)	415					
		- f.g., dk. green, strongly chloritic, relatively massive, homogeneous.	416					

Drilled by Bradley Bros.

Core Size BQ

Logged by J. R. Allan

COMPANY Ducanex Resources

PROPERTY Allerston Gold Property

Township Bristol Twp., Ontario

Claim No. 410812

SHEET No. 5 of 7  
 Started \_\_\_\_\_  
 Finished \_\_\_\_\_  
 Depth \_\_\_\_\_

Reference \_\_\_\_\_  
 Location \_\_\_\_\_  
 Elevation \_\_\_\_\_

HOLE No. 74-1  
 Bearing \_\_\_\_\_  
 Dip: \_\_\_\_\_ @ Collar; \_\_\_\_\_ @ \_\_\_\_\_

FROM	TO	DESCRIPTION	SAMPLES			ASSAYS			
			NO	FROM	TO	WIDTH			
		Moderately carb. altered. Occasional massive chlorite laminae.							
		- Weakly to moderately sheared.							
		201.5-202.5 3-4% Py in strongly sericitic section.							
		202.5-203.0 irregular qtz.-carb. vein							
		203.0-204.0 3-4% Py in strongly sericitic section.							
		- After 220', foliation @ 40° to c.a.							
		- Sharp lower contact.							
238.8	295.6	CHLORITE-SERICITE SCHIST (sheared basic tuff?)							
		238.8-268.8 f.g., dk. grey-green, relatively massive. Moderately chloritic, decreasing down unit, increasingly sericitic. Sparse, widely separated, lt. grey laminae. Occasional near-conformable qtz. veins to 1/2". Moderately sheared. Foliation @ 45° to c.a. 1% Py.							
		268.8-273.8 FRAGMENTAL 20% 1 mm - 3 mm white, aphanitic feldspar fragments (angular to sub-angular - flattened) in a v.f.g., dk. green chloritic, tuffaceous, carbonaceous matrix. Sharp upper & lower contacts. Foliation @ 45° to core axis. 1% diss. Py.							

Drilled by Bradley Bros.

Core Size BQ

Logged by J. R. Allan

COMPANY Ducanex Resources

PROPERTY <sup>(WEST)</sup> Allerston Gold Property

Township Bristol Twp., Ontario

Claim No. 410812

SHEET No. 6 of 7  
 Started \_\_\_\_\_  
 Finished \_\_\_\_\_  
 Depth \_\_\_\_\_

Reference \_\_\_\_\_  
 Location \_\_\_\_\_  
 Elevation \_\_\_\_\_

HOLE No. 74-1  
 Bearing \_\_\_\_\_  
 Dip: \_\_\_\_\_ @ Collar; \_\_\_\_\_ @ \_\_\_\_\_

FROM	TO	DESCRIPTION	SAMPLES			ASSAYS	
			NO	FROM	TO	WIDTH	Oz. Au
		273.8-295.6 Chlorite-sercicite schist (as 238.8-268.8) 1% diss. Py.					
		286.4-288.8 4% Py diss. on foliation planes.					
		286.4 irreg. qtz. vein 1/4"					
		287.6 " " " 1/2"					
		287.8 " " " "					
		288.0 " " " 1-1/2"					
295.6	405.2	SERCITE SCHIST (sheared int. to felsic tuff).	417				
		- v.f.g., lt. grey, moderately sheared, moderately sericitic, thinly laminated.	418				
		Occasional laminae or very thin band of chlorite.	419				
		- relatively homogeneous throughout.	420				
		Occasional small scale crenulation.	421				
		- strongly carb. (Ca) altered, 1% diss. Py.	422				
		- approx. 5% 1 mm to 5 mm, weakly dis- cernable, stretched fragments, slightly more siliceous than matrix.	423				
		- Foliation 320' to 400' @ 50° to c.a.; after 400' fol. @ 60° to c.a.	424				
		355.5-390.0 4% Py occurring in carb. rich seams 1-5 mm thick & con- formable with schistosity.	425				
		401-405.2 very finely fragmental, moderately chloritic, highly altered.	426				
			427				
			430				

Drilled by Bradley Bros.

Core Size BQ

Logged by J. R. Allan



COMPANY Ducanex Resources

PROPERTY Allerston Gold Property

Township Bristol Twp., Ontario

Claim No. 410812

SHEET No. 7 of 7  
 Started \_\_\_\_\_  
 Finished \_\_\_\_\_  
 Depth \_\_\_\_\_

Reference \_\_\_\_\_  
 Location \_\_\_\_\_  
 Elevation \_\_\_\_\_

HOLE No. 74-1

Bearing \_\_\_\_\_  
 Dip: \_\_\_\_\_ @ Collar; \_\_\_\_\_ @ \_\_\_\_\_

FROM	TO	DESCRIPTION	NO	SAMPLES			ASSAYS			
				FROM	TO	WIDTH	Oz. Au	Oz. Ag		
405.2	423.8	APLITE DIKE(?) - m.g., lt. grey, v. weakly foliated on upper and lower contacts. Moderately sericitic. No mafic minerals. - <1% diss. Py.	428							
423.8	434.5	SERICITE SCHIST (same as 28.5-55.5) - blocky core 431-433.3 intensely sheared & crumpled Possible fault. <1/2% diss. Py.								
434.5	473.4	ANDESITE (?) FRAGMENTAL - moderately sheared, dk. green, chloritic matrix, f.g. - 20% fragments, weakly discernable, stretched, moderately sericitic, 1 mm - 4 mm. - Occasional band to 3" of lt. grey sericite schist. - Trace diss. Py. 440-480 foliation @ 65° to c.a.								
473.4	492.8	ANDESITE (TUFF?) - f.g. dk. green, moderately to strongly chloritic, strongly carb. altered. - relatively homogeneous to end; rare fragments. - trace diss. Py.								
	492.8	END OF HOLE								

Core stored in Bradley Bros. warehouse in Timmins.

Drilled by Bradley Bros.

Core Size BQ

Logged by J. R. Allan

COMPANY Ducanex Resources

PROPERTY Allerston Gold Property

Township Bristol Twp., Ontario

Claim No. 410812

SHEET No. 1 of 9  
 Started Dec. 2/74  
 Finished Dec. 6/74  
 Depth 560'

Reference Line 45+00W  
 Location 4+50'S  
 Elevation \_\_\_\_\_

HOLE No. 74-2  
 Bearing N20°W  
 Dip: -45° @ 200'; -45° @ 12'  
-41° @ 200'; -35° @ 400'

FROM	TO	DESCRIPTION	SAMPLES			ASSAYS		
			NO	FROM	TO	WIDTH		
0	11	OVERBURDEN						
11.0	21.6	ANDESITE FRAGMENTAL - >75% weakly discernable, intensely sheared lapilli sized fragments; lt. grey, v.f.g., weakly to moderately sericitic in a v.f.g. darker grey-green chloritic matrix. - Moderately carbonate altered. - Blocky friable core throughout. - Strongly foliated @ 45° to c.a. - Tr. diss. f.g. Py.						
	11.4	1-1/2" conformable qtz.-carb. seam with 2 to 3% diss. Py.						
	14.4-15.9	Rusty, crumbly; no sulphides evident.						
	18.0-18.8	Rusty, crumbly; no sulphides evident.						
	19.2-19.3	Rusty, crumbly; no sulphides evident.						
		- Sharp lower contact.						
21.6	46.6	TUFFACEOUS ANDESITE (?) - light grey, v.f.g., thinly laminated, intensely sheared, moderately carbonate altered. - Foliation @ 45° to c.a. - Slight banding in places with sericite rich laminae. - 1% diss. fine grained pyrite (up to 2% locally).						

Drilled by Bradley Bros.

Core Size BQ

Logged by J. R. Allan

*J. R. Allan*

COMPANY Ducanex Resources

PROPERTY <sup>(WEST)</sup> Allerston Gold Property

Township Bristol Twp., Ontario

Claim No. 410812

SHEET No. 2 of 9  
 Started \_\_\_\_\_  
 Finished \_\_\_\_\_  
 Depth \_\_\_\_\_

Reference \_\_\_\_\_  
 Location \_\_\_\_\_  
 Elevation \_\_\_\_\_

HOLE No. 74-2  
 Bearing \_\_\_\_\_  
 Dip: \_\_\_\_\_ @ Collar; \_\_\_\_\_ @ \_\_\_\_\_

FROM	TO	DESCRIPTION	SAMPLES			ASSAYS							
			NO	FROM	TO	WIDTH							
		- Occasional near-conformable qtz.-carb. seams 1/8" to 1" thick.											
		- Sharp lower contact.											
		25.7-25.8 Rusty, crumbly; no sulphides evident.											
		26.8-28.0 "											
		43.4-43.7 "											
46.6	182.0	ANDESITE TUFF - weakly sheared											
		- dark green to dark grey-green, fine grained, thinly laminated chlorite schist.											
		- moderately carbonate altered.											
		- Foliation @ 45° to c.a.											
		- Traces diss. Py throughout, usually associated with carb. or qtz.-carb. rich seams.											
		56.4-56.5 conf. qtz.-carb. vein											
		77.0-77.8 small scale open fold, slightly brecciated, weakly silicified.											
		1% diss. Py.											
		77.8-78.1 Conf. qtz. vein with minor chloritic & tourmaline inclusions.											
		78.1-78.5 4% pyrite diss. on foliation planes.											
		78.5-78.9 Conf. qtz. vein with minor chloritic & tourmaline inclusions.											
		3-4% Py in inclusions.											

Drilled by Bradley Bros.

Core Size BQ

Logged by J. R. Allan

COMPANY Ducanex Resources

PROPERTY <sup>(WEST)</sup> Allerston Gold Property

Township Bristol Twp., Ontario

Claim No. 410812

SHEET No. 3 of 9

Reference \_\_\_\_\_

HOLE No. 74-2

Started \_\_\_\_\_

Location \_\_\_\_\_

Bearing \_\_\_\_\_

Finished \_\_\_\_\_

Elevation \_\_\_\_\_

Dip: \_\_\_\_\_ @ Collar; \_\_\_\_\_ @ \_\_\_\_\_

Depth \_\_\_\_\_

FROM	TO	DESCRIPTION	SAMPLES			ASSAYS							
			NO	FROM	TO	WIDTH							
	80-110	Very dark green; much more chloritic than above.											
	86.3-95	5% diss. medium grained blebs of carbonate (possibly infilled amygdules).											
	93.4-104	films of hematite on widely spaced fracture planes.											
	94.8	film of chalcopyrite on fracture.											
	100-118	blocky core											
	108.2-108.4	Rusty-no sulphides evident.											
	113.2-115	"											
	116-116.4	"											
	117.1-118	"											
	118-118.1	1" conf. quartz vein.											
	110-182	light grey-green; less chloritic than above.											
	124-124.3	rusty v.f.g. laminae (argillaceous?)											
	124.5-124.6	"											
	125.6-126.7	"											
	129.3-129.4	"											
	137.8	1" qtz.-carb. vein @ 75° to c.a.											
	139.1	3/4" qtz.-carb. vein											

Drilled by Bradley Bros.

Core Size BQ

Logged by J. R. Allan

COMPANY Ducanex Resources  
 Township Bristol Twp., Ontario

(West)  
 PROPERTY Allerston Gold Property  
 Claim No. 410812

SHEET No. 4 of 9  
 Started \_\_\_\_\_  
 Finished \_\_\_\_\_  
 Depth \_\_\_\_\_

Reference \_\_\_\_\_  
 Location \_\_\_\_\_  
 Elevation \_\_\_\_\_

HOLE No. 74-2  
 Bearing \_\_\_\_\_  
 Dip: \_\_\_\_\_ @ Collar; \_\_\_\_\_ @ \_\_\_\_\_

FROM	TO	DESCRIPTION	SAMPLES			ASSAYS				
			NO	FROM	TO	WIDTH				
		@ 75° to c.a.								
		120-140 Foliation averages 40° to c.a.								
		140-180 Foliation averages 45° to c.a.								
		147-148 3-4% diss. c.g. Py								
		145-160 rare hematite stained fractures.								
		168.5-168.6 conf. qtz.-carb. vein.								
		168.8-169 "								
		172.9-173 "								
		173-175 blocky, shattered zone								
		Sharp lower contact.								
182.0	217.3	DACITIC TUFF (?)								
		- relatively massive, homogeneous unit								
		- light grey-green, v.f.g. to aphanitic								
		very weakly carb. altered. Moderately sericitic, very weakly chloritic.								
		- weakly discernable foliation @ 40 to 45° to c.a.								
		- 1/2% diss. Py (2 to 3% locally in widely spaced, conformable 1/8" to 1" thick, qtz.-carb. seams).								
		- sharp lower contact.								
217.3	410.3	DACITE (?) (Flow or intrusive?)								
		- fine to medium grained, equigranular, 'felted' texture; feldspathic, moderately carbonate altered. Massive; very								

Drilled by Bradley Bros.

Core Size BQ

Logged by J. R. Allan

COMPANY Ducanex Resources

PROPERTY <sup>(WKS.T)</sup> Allerston Gold Property

Township Bristol Twp., Ontario

Claim No. 410812

SHEET No. 5 of 9  
 Started \_\_\_\_\_  
 Finished \_\_\_\_\_  
 Depth \_\_\_\_\_

Reference \_\_\_\_\_  
 Location \_\_\_\_\_  
 Elevation \_\_\_\_\_

HOLE No. 74-2  
 Bearing \_\_\_\_\_  
 Dip: \_\_\_\_\_ @ Collar; \_\_\_\_\_ @ \_\_\_\_\_

FROM	TO	DESCRIPTION	SAMPLES			ASSAYS				
			NO	FROM	TO	WIDTH				
		homogeneous.								
		- Very weakly chloritic throughout.								
		Occasional laminae of >50% chlorite + sericite on fractures.								
		- Sparse irregular blebs & veins of qtz.-carb throughout. Accessory epidote where minor shearing of qtz.-carb veins.								
		- Carbonate often occurs as finely diss. m.g. blebs. Tr diss. Py throughout.								
	217.3-218.5	fine grained - possible chilled margin of flow.								
	226.1-229.2	Inclusion? v.f.g., dark green, moderately sheared, chloritic andesite. 1% diss. Py. Sharp upper contact. Slightly gradational lower contact.								
	247.7-248.4	60% irregular qtz. vein, 10% carbonate, 30% inclusions of host rock but strongly chloritic. Contacts approx. conformable.								

Drilled by Bradley Bros.

Core Size BQ

Logged by J. R. Allan

COMPANY Ducanex Resources

PROPERTY <sup>(WEST)</sup> Allerston Gold Property

Township Bristol Twp., Ontario

Claim No. 410812

SHEET No. 6 of 9  
 Started \_\_\_\_\_  
 Finished \_\_\_\_\_  
 Depth \_\_\_\_\_

Reference \_\_\_\_\_  
 Location \_\_\_\_\_  
 Elevation \_\_\_\_\_

HOLE No. 74-2  
 Bearing \_\_\_\_\_  
 Dip: \_\_\_\_\_ @ Collar; \_\_\_\_\_ @ \_\_\_\_\_

FROM	TO	DESCRIPTION	SAMPLES			ASSAYS							
			NO	FROM	TO	WIDTH							
		325-339 Variable, weak foliation from 20° to 35° to c.a.											
		388-389.2 Irregular vein 90% qtz., 5% carb., 5% inclusions of dacite. Upper & lower contacts strongly chloritic over 2".											
		402-402.8 irreg. qtz.-carb. vein + epidote											
		403.8-404.2 "											
		404.5-405 "											
		Sharp lower contact @ 50° to c.a.											
410.3	416.5	COARSE ANDESITE TUFF (hyaloclastic tuff?) - light grey, medium to coarse grained, densely packed spherulitic (?) texture. Moderately carb. altered, weakly chloritic. Sparse sub-angular buff colored, siliceous, aphanitic fragments 1/8" to 1/2". - Weakly foliated @ 50° to 55° to c.a. - Sharp, conformable lower contact.											
416.5	424.0	- ANDESITE, LAPILLI BRECCIA > 70% weakly discernable lapilli sized frags. of v.f.g. to aphanitic, light grey-green, weakly chloritic, weakly carb. altered feldspathic material.											

Drilled by Bradley Bros.

Core Size BQ

Logged by J. R. Allan

COMPANY Ducanex Resources

PROPERTY <sup>(WEST)</sup> Allerston Gold Property

Township Bristol Twp., Ontario

Claim No. 410812

SHEET No. 7 of 9  
 Started \_\_\_\_\_  
 Finished \_\_\_\_\_  
 Depth \_\_\_\_\_

Reference \_\_\_\_\_  
 Location \_\_\_\_\_  
 Elevation \_\_\_\_\_

HOLE No. 74-2  
 Bearing \_\_\_\_\_  
 Dip: \_\_\_\_\_ @ Collar; \_\_\_\_\_ @ \_\_\_\_\_

FROM	TO	DESCRIPTION	SAMPLES			ASSAYS								
			NO	FROM	TO	WIDTH								
		- Matrix slightly more chloritic, carbonaceous, coarser grained.												
		- Rare buff colored siliceous fragment as in previous unit.												
424.0	431.4	ANDESITE TUFF												
		- same composition as fragments in above unit, slight tuffaceous texture.												
		- Rare buff colored siliceous fragments as above.												
		- Sheared, carbonate rich, chloritic lower contact from 430.5 to 431.4.												
431.4	447.2	COARSE ANDESITE TUFF												
		- same as 410.3 - 416.5												
		- gradational lower contact over 1".												
447.2	462.3	ANDESITE (same as 424-431.4)												
		- light grey, v.f.g. to aphanitic. Massive, homogeneous.												
		- Very weakly foliated @ 60° to c.a.												
		- Sharp lower contact.												
462.3	464.8	COARSE ANDESITE TUFF												
		- same as 410.3-416.5												
464.8	474.6	ANDESITE (same as 424-431.4)												
		466.5-467 numerous fractures coated with hematite and/or qtz.-carb. seams.												
474.6	478.6	ANDESITE, LAPILLI BRECCIA												
		- same as 416.5-424.												

Drilled by Bradley Bros.

Core Size BQ

Logged by J. R. Allan



COMPANY Ducanex Resources

PROPERTY <sup>(WEST)</sup> Allerston Gold Property

Township Bristol Twp., Ontario

Claim No. 410812

SHEET No. 8 of 9  
 Started \_\_\_\_\_  
 Finished \_\_\_\_\_  
 Depth \_\_\_\_\_

Reference \_\_\_\_\_  
 Location \_\_\_\_\_  
 Elevation \_\_\_\_\_

HOLE No. 74-2  
 Bearing \_\_\_\_\_  
 Dip: \_\_\_\_\_ e Collar; \_\_\_\_\_ e

FROM	TO	DESCRIPTION	SAMPLES			ASSAYS		
			NO	FROM	TO	WIDTH	OZ. Au	OZ. Ag
478.6	511.4	ANDESITE TUFF (CHLORITE SCHIST) - dark green, fine grained, moderately chloritic. - Moderately well foliated @ 60 to 65° to c.a. - Occasional massive laminae of chlorite. - Numerous thin, conformable seams of carbonate. 478.6-507 relatively homogeneous 507-511.4 Some light color banding (var. in chlorite content). Becomes increasingly siliceous & decreasingly carbonaceous.						
511.4	560	RHYODACITE						
511.4	524.3	COARSE RHYODACITE TUFF - light grey-green, densely packed, siliceous tuff. - weakly chloritic with sericitic laminations. 516.6-519.1 3 to 4% diss. Py on foliation planes.	429	516.6-519.1				
524.3	527.8	RHYODACITE TUFF - dark grey, v.f.g. to aphanitic, siliceous, dense. - occasional discontinuous seams of carbonate.						

Drilled by Bradley Bros.

Core Size BQ

Logged by J. R. Allan

COMPANY Ducanex Resources  
 Township Bristol Twp., Ontario

PROPERTY Allerston Gold Property  
 Claim No. 410812

SHEET No. 9 of 9  
 Started \_\_\_\_\_  
 Finished \_\_\_\_\_  
 Depth \_\_\_\_\_

Reference \_\_\_\_\_  
 Location \_\_\_\_\_  
 Elevation \_\_\_\_\_

HOLE No. 74-2  
 Bearing \_\_\_\_\_  
 Dip: \_\_\_\_\_ @ Collar; \_\_\_\_\_ @ \_\_\_\_\_

FROM	TO	DESCRIPTION	SAMPLES			ASSAYS				
			NO	FROM	TO	WIDTH				
		- sharp lower contact.								
527.8	529.2	COARSE RHYODACITE TUFF								
		- same as 511.4-524.3								
		- sharp lower contact								
529.2	560	RHYODACITE TUFF	431							
		- same as 524.3-527.8								
		532.4-532.8 Numerous limonitic fractures.								
		538.0-538.2 "								
		538.4-538.5 "								
		540.7-541.2 Conformable qtz. veins with 1 to 2% Py as diss. blebs.								
		543.2-548.9 LAMPROPHYRE DIKE (?)	431							
		60 to 70% coarse, anhedral grains of pyroxenite(?), 25-30% biotite, 5-10% Ca carbonate, tr. diss. f.g. Py. Upper contact brecciated, limonite stained and altered from 542.4-543.2. Lower contact irregular, chloritic.								
560		END OF HOLE.								
		Core stored in Bradley Bros. warehouse in Timmins								

\* see attached spectrographic analysis

Drilled by Bradley Bros.

Core Size BO

Logged by J. R. Allan

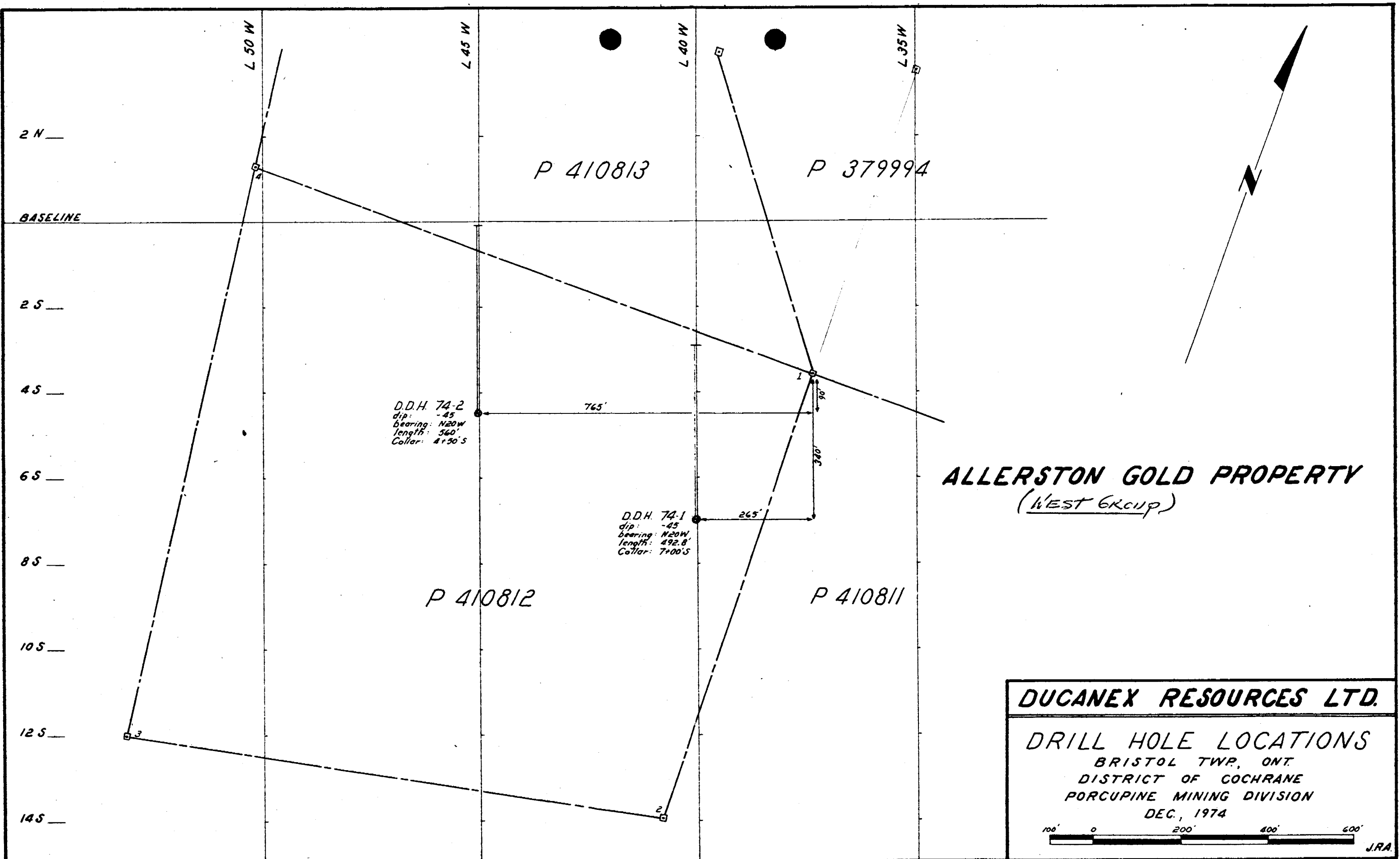

**ALLERSTON GOLD PROPERTY**  
*(WEST GROUP)*

**DUCANEX RESOURCES LTD.**

**DRILL HOLE LOCATIONS**  
 BRISTOL TWP., ONT.  
 DISTRICT OF COCHRANE  
 PORCUPINE MINING DIVISION  
 DEC., 1974

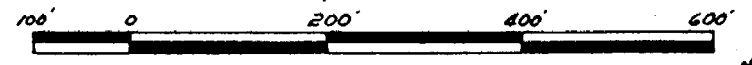

J.R.A.