

①
Report on Mapping and Prospecting on the 25 claim
block in Whitesides & Massey Township which is held
by C. D. MacKenzie, Denis Laforest, and Douglas Lalonde
in District of Cochrane and
in the Porcupine Mining Division



010

There was 19 claims out of the 25 claims in
Whitesides & Massey Township which were well covered
by prospecting to see what was causing the
mag highs. One claim # 1127394 there is a large
gabbro outcrop it has very little mineral in it
but just south of the claim on the patented claims
about 100 meters from the boundary of the property
is a good showing with 3-4% copper, .7-.8% nickel
and some cobalt. There is a cross fault in the 8'-20' pit
which cut across the ore which is run North & South
The fault cuts across the one claim # 1127394 and
then goes up the river when the water is low
in July you can see it on the west side of the
river in a couple of places. The rest of the claim
is covered by over burden the mag high is next to
the west side of the fault but it is covered by
the over burden. The claim was prospected by C. D. MacKenzie
and Douglas Lalonde.

In the 6 claims prospecting was done from Sept. 14 & 15/91
There is a large gabbro out crop on line 17 east
about 100 meters from base line but it has very little
quite in the gabbro which is on claim 1127391. The
rest of the claim is covered by overburden.
On claim 1127392 there is a large out crop of
gabbro near the north side of the claim and it crosses
line 17 east the gabbro has nothing in it.

On claim 1127393 there is a tip of gabbro and a diabase
dike on the north & centre part of the claim there
is no mineral in the outcrop. The rest of the claim
is covered with sandy and clay and trees. The
diabase is probably what is causing the mag high
across the claim.

On claim 1127386 ⁽²⁾ there are two small gabbro outcrop on the base line one on line 16 east and the other outcrop on or near line 18 east and the baseline. The rest of the claim is covered by over burden and trees, so we done no was causing the mag high at the present time.

On claim 1127385 there is no outcrop to be found it is all covered by over burden so we done no what is causing the mag high at the present time.

On claim 1127384 there is a large out crop crossing the centre of the hole claim. The outcrop is a big gabbro outcrop with a 30' diabase run along the east side of it which is probably causing the mag high going north. There is two small out crops on the other side of the diabase which they are gabbro. The rest of the property is covered by trees sand. The outcrop crosses lines 16, 17, 18. Work was completed by C.D. MacKenzie and Douglas Lalonde.

In Sept 25, 26/91

Prospecting was done on 6 claims 1127381-1127383 1127404-1127406 by C.D. MacKenzie & Douglas Lalonde.

On claim 1127381 and on line 20 east there is a gabbro out crop with no mineralization. The out crop between line 20 east and 21 east it has lots of pyrite, pyroxenite and some pyrrhotite but the assays ran very low in copper, nickel, cobalt there is solid bands of sulphide. The outcrop is at 400M east. There is a high mag zone there it is possible to have some values in copper and nickel on either side of the barren zone. The rest of the claim 1127381 and 1127382 has over burden all around the out crop with the sulphide in it. There is a large cedar swamp on the north and east side of the outcrop.

On Claim 112 7383 there is a large outcrop of gabbro and a diabase dike on the east side of the gabbro. There is cedar swamp on 3 side of the outcrop. The outcrop crosses line 19-20 east at about the 750 M mark. There is a high mag with the diabase.

One claim 1127406 has a small outcrop of a big poplar tree which was uproot by the wind it is meta sedimentary Gneiss it is located at 2175 M north on the base line. There is also a large meta. Sedimentary Gneiss out crop on line 22 east it has some pyrite all threw the out crop. The rest of the claim is covered by sand and boulders and Poplar, Pine, spruce trees. There is a mag high near the base line and 3 airborne anomalies which was picked up when it was flowing but its covered by overburden.

On claim 1127405 there is no out crop on the hole claim it a big cedar and spruce tree swamp. The claim is covered by over burden.

Claims 1127404 has a large outcrop on line 21 east 22, 23 east it is a gabbro outcrop and a diabase flowing along east side of the gabbro. There is a quartz vein in the centre of the hill about 1 foot wide it has no mineral of any kind in it. There is a large out ~~crop~~ of gabbro on line 21, 22, 23 east there is no mineral in the out crop. The rest of the claim is black spruce and cedar swamp. The high mag is do to the diabase.

The prospecting done on Sept 29, 30/91 by C. E. Mackenzie and Douglas Lalonde on 6 claims west of base line.

Claim 1127390 there is a large out crop on line 14 west it is Meta sedimentary gneiss there is some pyrite in the outcrop. The rest of the claim is covered by sand and boulders and a creek runs threw the centre of the claim. Claim 1127389 is covered by over burden and a creek runs threw south east corner of the claim. The Mag sig. is heard by overburden.

④

Claim 1127387 has one outcrop on line 20 west which is all gabbro with no mineral at the outcrop. The rest of the claim has mostly sand & boulders and cedar swamp. There is a mag high going through the claim but it is beared by overburden.

O.n claim 1127388 there are two large outcrops on line 18, 19, 20, 21 west the outcrop is all granitic and no mineral in the granitic the rest of the claim is sand and boulders. The mag high is covered by overburden along the granitic contact.

O.n claim 1127380 there is no outcrop it is all covered by sand, boulders and swamp poplar spruce and balsam trees The mag high is covered by overburden.

O.n claim 1127379 it has no outcrop on it it is covered by mostly Black spruce swamp. The mag high is covered by overburden.

Results and Conclusions

The airborne which was flown in 1988 pick-up 3 strong anomalies on the boundary of Whitesides and Massey Top. From the prospecting done the 3 airborne anomalies are beared by overburden. The mag pick the anomalies up so they need to be drilled. There has to be V.L.F. done and the Max-Mira has to be done yet on the property too.

The rest of the line cutting & the mag will be send in by Denis Laforest. Only part of the line cutting was applied on these OPAP grant the rest will be applied by Denis Laforest on his OPAP grant and the mag too. I hope you will find every thing in order.

I am sending you ⑤ a mag map and the line cutting which was done on the 25 claims property. And here is a report also. Denis Laforest will be sending you a report and mag map^{too} and the rest of the line cutting which was done on the property in the near future.

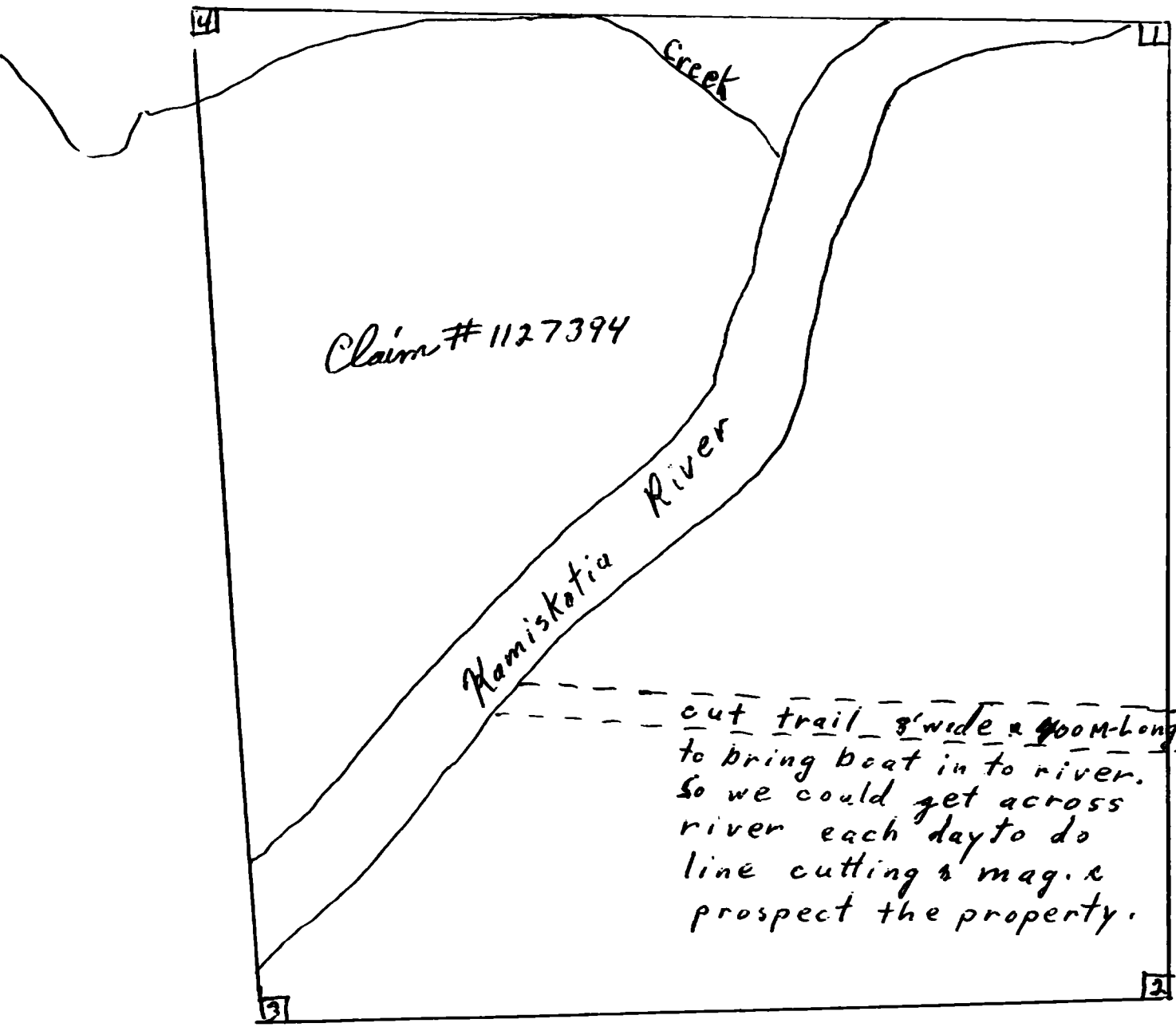
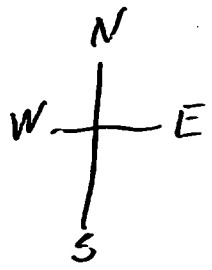

Claim # 1127394

Namiskotia River

cut trail 3' wide x 400m long
to bring boat in to river.
So we could get across
river each day to do
line cutting & mag. &
prospect the property.

Turn
around

Whitesides Twp.
May 22/91

C.D. Mac Kenzie
Douglas Lalande
Lerry Cutta

Cutting of Base line
May 23, 24, 25, 26/91

N
W E
S

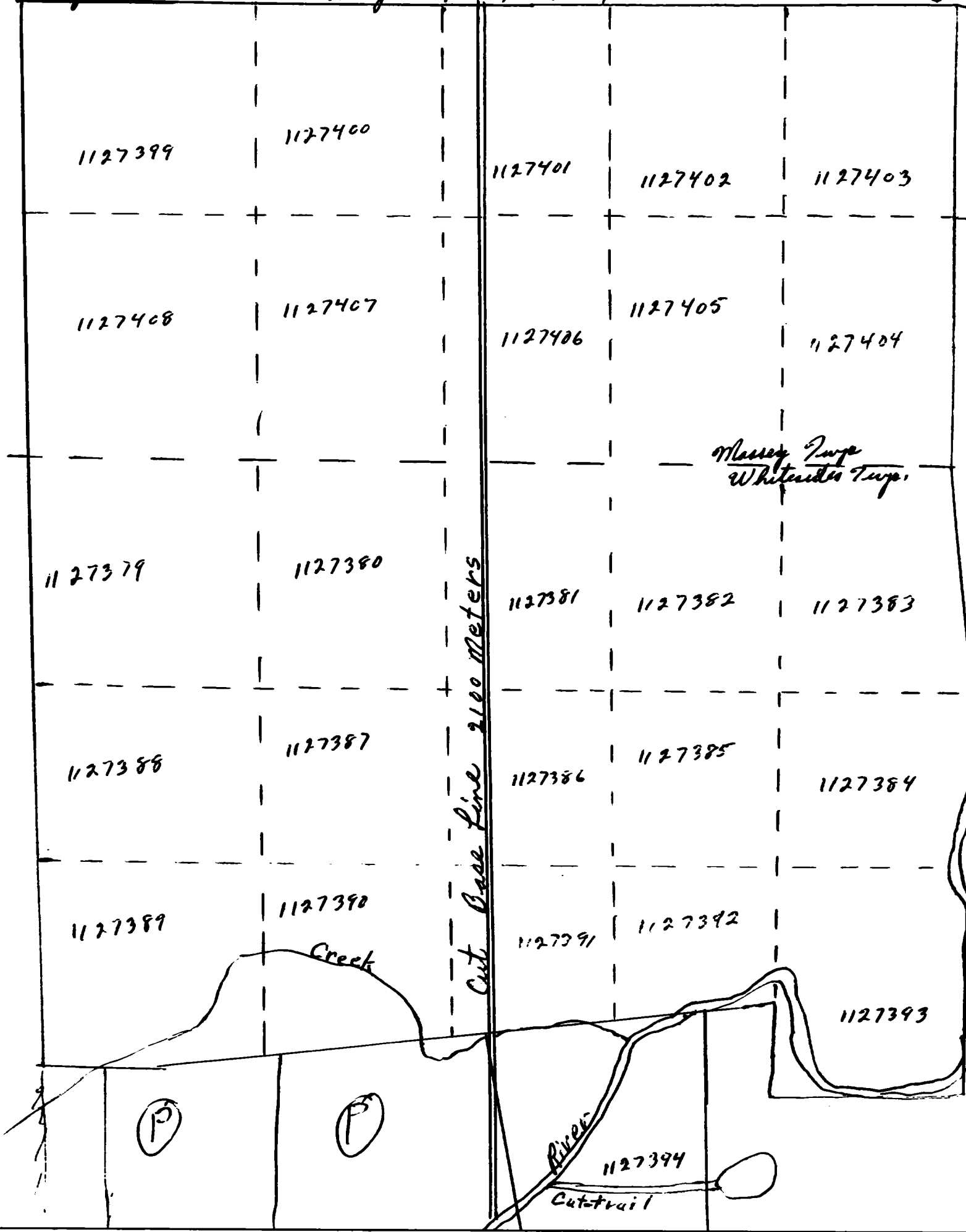

1127399

1127400

1127401

1127402

1127403

1127408

1127407

1127406

1127405

1127404

Massey Twp
Whitesides Twp.

1127379

1127380

1127381

1127382

1127383

1127388

1127387

1127386

1127385

1127384

1127389

1127390

1127391

1127392

1127393

(P)

(P)

River

1127394

Cut-trail

Creek

Cut Base line 2100 meters

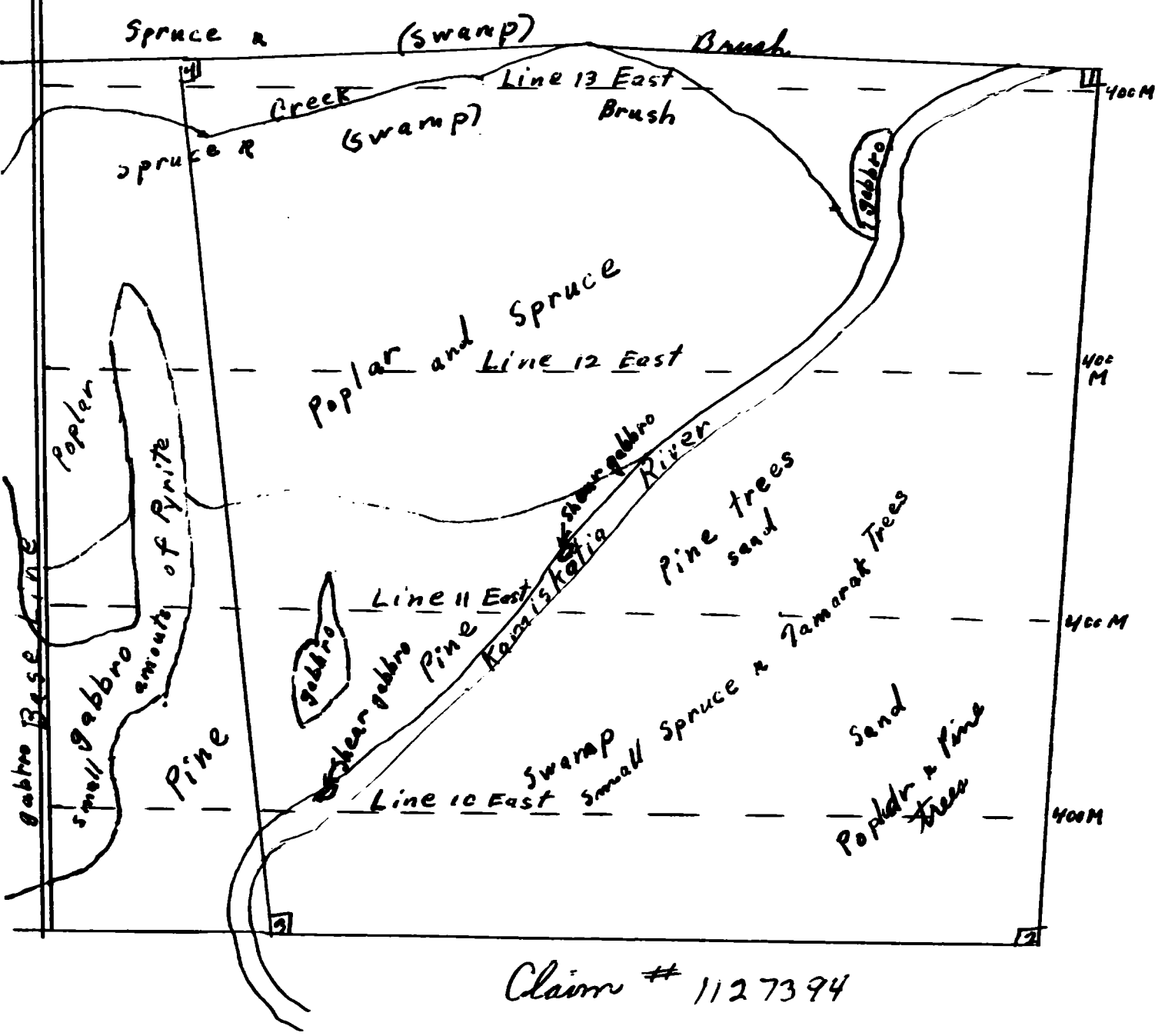
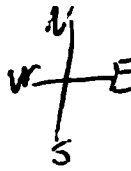

Claim # 1127394

Used Lines which where cut for mag. U.S.
to prospect from.

Scale $2\frac{1}{4}'' = 100 M$

Sept 13 / 91
C. D. Mac Kenzie
Douglas Falcone

Sept 29/91
Sept 30/91

Prospecting
C. S. MacKenzie
Douglas Falconer

Use cut lines to
prospect from the lines
which was cut for the W
Mag & V. L. F.

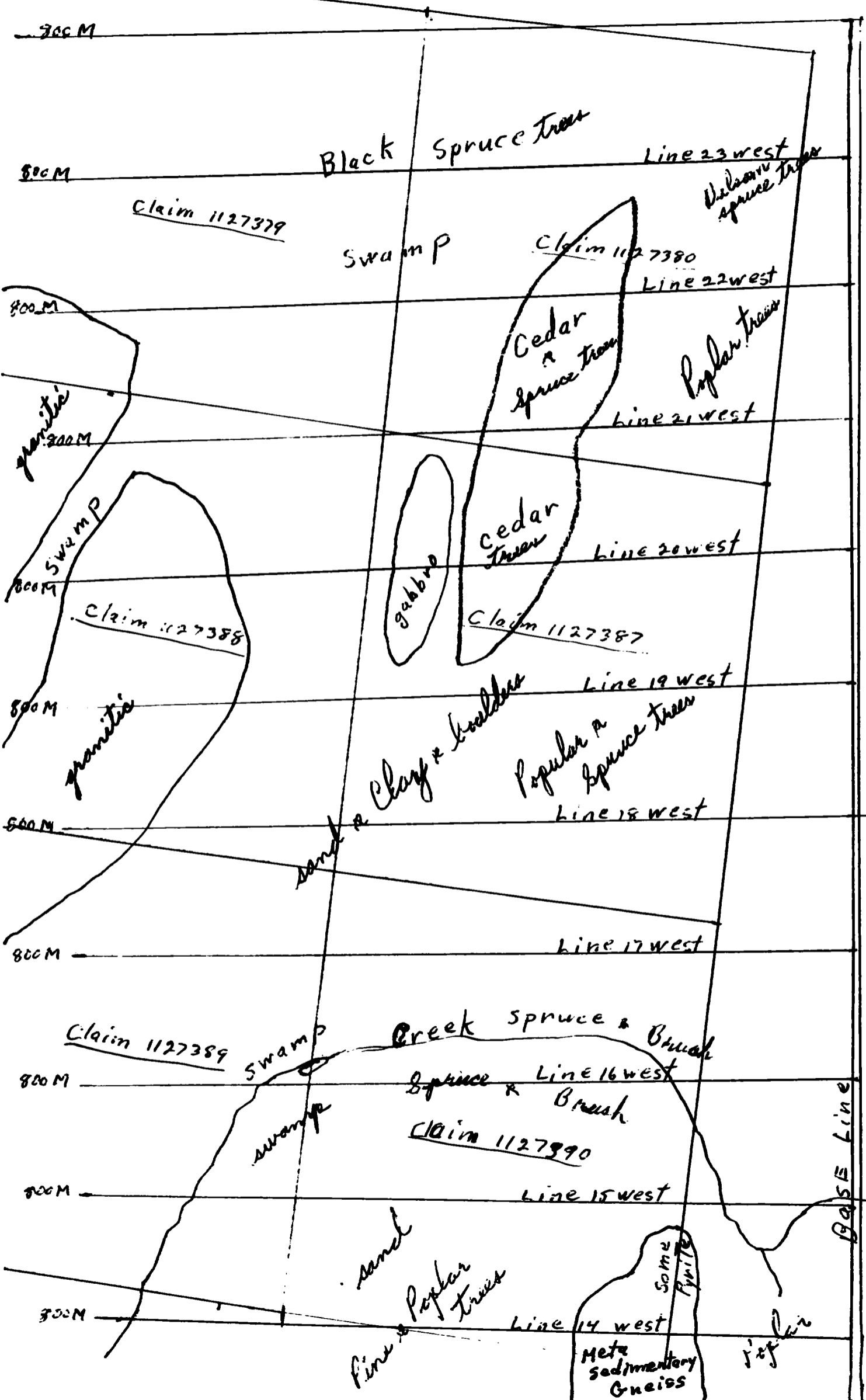

900 M

800 M

800 M

800 M

800 M

500 M

800 M

800 M

900 M

900 M

Claim 1127379

Claim 1127380

Claim 1127388

Claim 1127387

Claim 1127389

Claim 1127390

Black Spruce Trees

Swamp

Line 23 west

Willow spruce trees

Line 22 west

Cedar & spruce trees

Poplar trees

Line 21 west

Cedar trees

Line 20 west

Gabbro

Line 19 west

Clay & boulders

Poplar & spruce trees

Line 18 west

Line 17 west

Creek spruce & brush

spruce & brush

Line 16 west

Swamp

swamp

Line 15 west

sand

Poplar trees

Line 14 west

some granite

Meta sedimentary Gneiss

jet

BASE LINE

Used cut lines to prospect N. from which surface cut to do May a d.d. to

Sept 25/91
Sept 26/91
Prospecting C. D. Mrs. Marye Douglas Falander

Scale 1" = 300 M

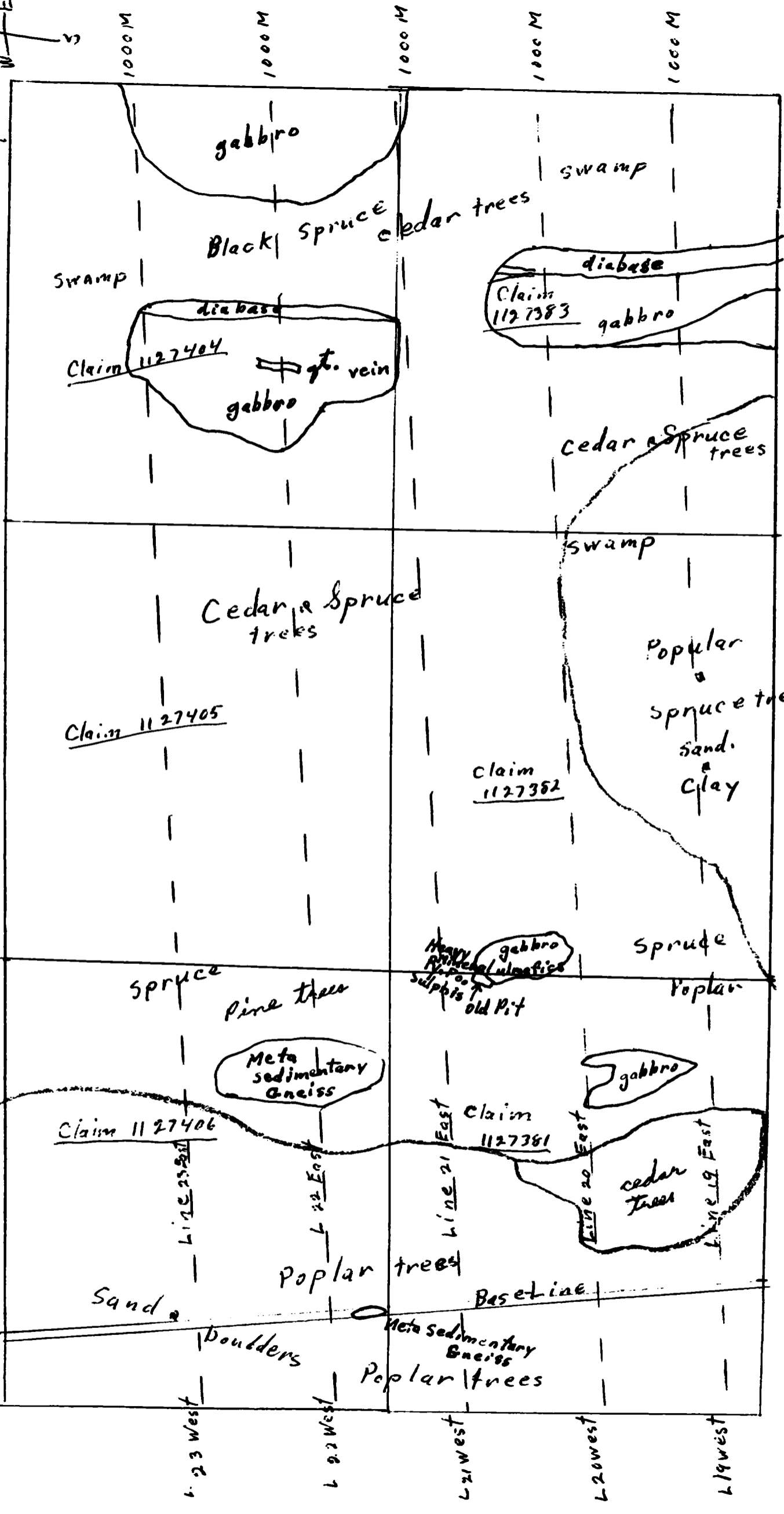

Scale 1" = 300 M

also cut lines to prospect from which was cut for May 1887 N

E. D. Mac Kenzie Douglas Lake

Prospecting Sept 14/91 Sept 15/91

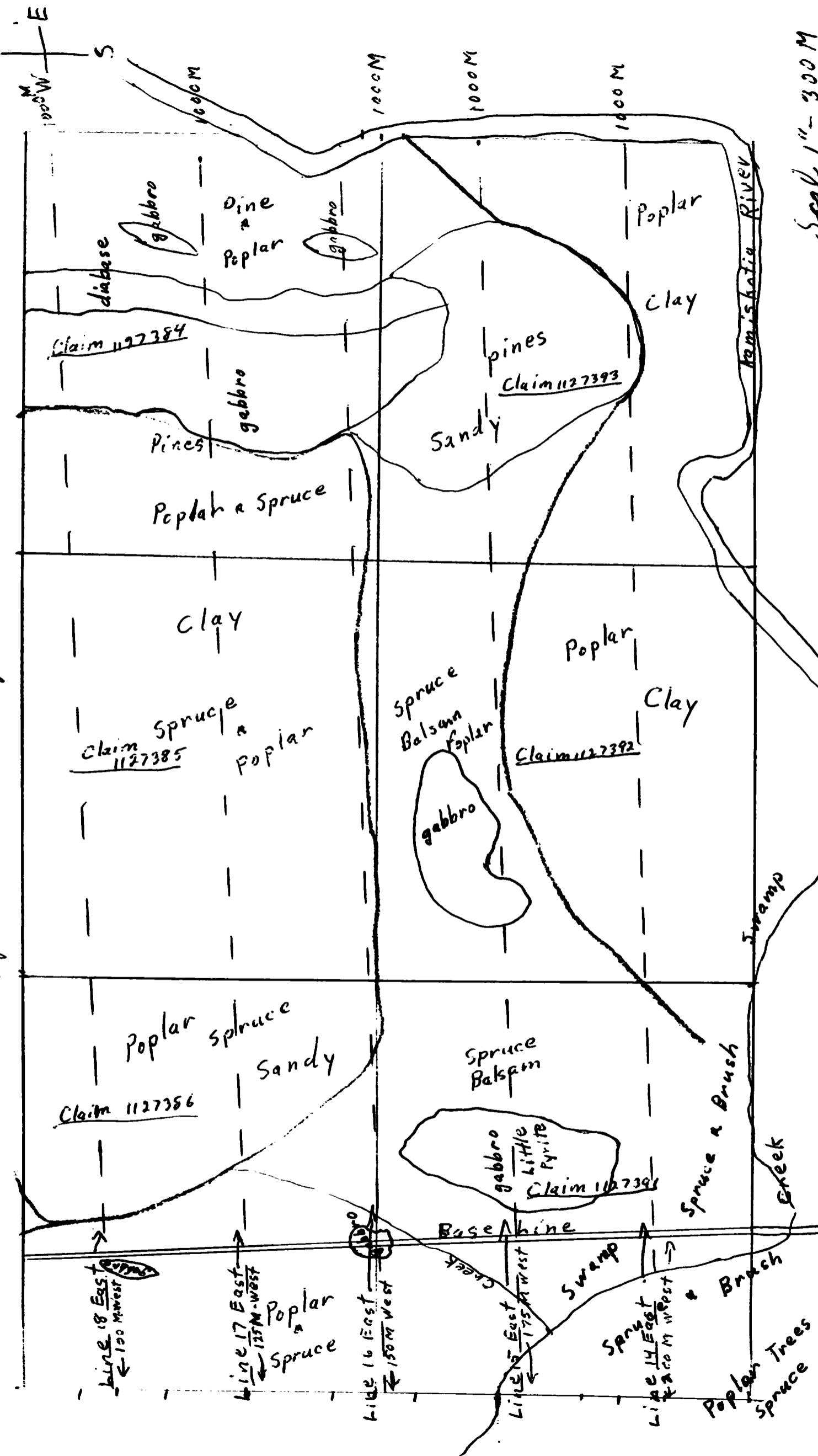

Scale 1" = 300 M



42A05NW0009 OP91-202 MASSEY

020

GROUND MAGNETOMETER SURVEY

FOR

**CLIFF MACKENZIE - DOUGLAS LALONDE
AND
DENNIS LAFOREST PROPERTY**

WHITESIDES & MASSEY TOWNSHIPS

DISTRICT OF COCHRANE

PORCUPINE MINING DIVISION

**Timmins, Ontario
October 2, 1991**

**C.D. MacKenzie
Consulting Geologist**

OP-91-204.



42A05NW0009 OP91-202 MASSEY

020C

TABLE OF CONTENTS

	PAGE
INTRODUCTION	1
PROPERTY LOCATION AND ACCESS	1
PROPERTY DESCRIPTION	1
LINECUTTING	2
GROUND MAGNETOMETER SURVEY	2
PROPERTY GEOLOGY	2
RESULTS OF THE MAGNETOMETER SURVEY	3
RECOMMENDATIONS AND CONCLUSIONS	5

MAPS

(Back Pocket)

MAP A

Magnetic Survey

1:2,500

INTRODUCTION

The following report describes the results of a ground magnetometer survey for Cliff MacKenzie, 446 Poplar Avenue, Timmins, Ontario, Douglas Lalonde, 53 Way Avenue, Timmins, Ontario and Dennis LaForest, 730 McClinton Drive, Timmins, Ontario.

The field work was carried out under a OPAP Government Grant and was completed October 2, 1991 and the report was completed on October 3, 1991.

PROPERTY LOCATION AND ACCESS

The property is located in Whitesides and Massey Townships, Porcupine Mining Division, Ontario.

The property is accessible by four-wheel drive vehicles. The claim group can be reached by driving west along Highway 101 for a distance of 30 kilometres, then turning north along the Whitesides gravel road for a distance of 15 kilometres to the end of a bush road at a point 400 metres east of the Kamiskotia River and the west boundary of the present claim group. The baseline lies a short distance west of the river and a boat or canoe is necessary to cross the river at this location where a 400 metre trail has been cut west to the river.

PROPERTY DESCRIPTION

The property consists of 25 contiguous claims in the northeast corner of Whitesides Township extending north into Massey Townships. The claims are numbered as follows:

1127380 -	1127390 -	1127404 -
1127381 -	1127391 -	1127405 -
1127382 -	1127392 -	1127406 -
1127383 -	1127393 -	1127407 -
1127384 -	1127399 -	1127408 -
1127385 -	1127400 -	1127590 -
1127386 -	1127401 -	1127591 -
1127387 -	1127402 -	
1127388 <i>out</i>	1127403 -	
1127394		

LINECUTTING

A north-south baseline starting on the Don Warren patented claims in Whitesides Township was continued to the north boundary of the claim group under discussion.

Lines were cut east-west from the baseline at 100 metre intervals and stations were established at 25 metre intervals. A total of 30.1 kilometres were cut over 23 claims by M.C. Explorations Ltd. of Timmins, Ontario. 21 claims were completely covered and 2 were partially covered by grid lines.

GROUND MAGNETOMETER SURVEY

The ground magnetometer survey was completed utilizing a proton magnetometer Geometrics Model G-816 capable of reading total field values to a accuracy of ± 1 gamma. Base stations were established at 100 metre intervals along the baseline. Diurnal variation was corrected by tying into the base stations every 60 minutes.

A total of 1,274 readings were read. The operators were Glen Coyne, 527 Mountjoy South, Timmins, Ontario and Dennis LaForest, 730 McClinton Drive, Timmins, Ontario.

PROPERTY GEOLOGY

The property is underlain by Precambrian formations, the oldest being the sedimentary gneisses striking north-south throughout the claim group. These rocks are intruded by a complex gabbro intrusive ranging from white anorthosite to a pyroxenite gabbro.

This intrusive is cut by granite towards the western boundary of the property and the western side of the property is underlain mainly by red granite and paragneiss. For this reason lines were not cut over this portion of the claim group.

Representing the late Precambrian, north-south striking diabases intrude all of the formations including the granite.

Nickel, cobalt and copper mineralization are present south of the claim group and a trench near Line 10N at a point immediately west of the baseline shows nearly massive pyrrhotite over a 1 metre width in a black pyroxenite. Values in nickel-copper and cobalt were obtained from this trench with nickel assaying .7%.

Three airborne EM anomalies, circa 1988, are located on and near the township line at the south boundary of Massey Township.

The only record of drilling on the property was a short x-ray diamond drill hole by Inco in the vicinity of the Massey Township line, circa 1970. This hole intersected sulfides in a grey garnetiferous para-gneiss.

At present, a zone of nickeliferous pyrrhotite in gabbro and pyroxenite is being traced by magnetometer work from XL10N north to the vicinity of 3 airborne EM anomalies near the Massey Township line. The "showing" is located just west of the baseline on the Don Warren claims in Whitesides Township.

RESULTS OF THE MAGNETOMETER SURVEY

The results of the magnetometer survey are shown on a map located in the back pocket of this report on a scale of 1:2,500.

The magnetic anomalies are designated on the map by the letters A, A-1, B, C, D, E, F, G, H and I.

ANOMALY A appears to be a narrow north-south diabase striking north across the claim group. At XL27N it appears to cross a east-west feature designated as Anomaly A-1. Anomaly A-1 appears to be possibly a mineralized shear zone containing magnetic pyrrhotite.

ANOMALY B is approximately 500 metres in length striking north-south direction and may be due to a mineralized zone in gabbro.

ANOMALIES C and D have a total combined length of 1,000 metres striking northeasterly and are believed due to disseminated to massive pyrrhotite lenses in the gabbro and lie in the vicinity of 3 airborne conductors, circa 1988.

ANOMALIES E and F are believed to be caused by north-south striking diabase dykes.

ANOMALY G is a series of lenses of pyrrhotite in pyroxene gabbro.

ANOMALIES H and I appear to be north-south striking mineralized zones within the gabbro. Anomaly I lies east of a known nickeliferous zone lying in a shear striking 60° and dipping steeply south. However, Anomaly I continues north for at least 900 metres and is probably part of the G anomaly and since no magnetite was observed in the gabbro outcrops all magnetic highs in this area appear to be due to magnetic pyrrhotite mineralization.

RECOMMENDATIONS AND CONCLUSIONS

This magnetometer map should be redone by computer, color coded to separate the magnetic diabases and the mineralized zones.

Prospecting, mapping and sampling over the entire property should be completed.

A Max-Min survey should be carried out on all lines presently cut and additional north-south lines cut over Anomaly A-1 and read with a Max-Min unit.

Anomalies C and D which lie in the vicinity of the airborne EM anomalies obtained in 1988 should be drilled if the Max-Min shows strong anomalies beneath the overburden in this area. No outcrop has been found to date in the vicinity of the C and D anomalies.

Respectfully submitted

C.D. MacKenzie

REFERENCES

AREAS WITHDRAWN FROM DISPOSITION

- M R O MINING RIGHTS ONLY
- S R O SURFACE RIGHTS ONLY
- M I S MINING AND SURFACE RIGHTS

Description	Order No.	Date	Disposition	File
(R1) HANA AND LOWLEY LAKES PARK RE	100	1975	M R O	172506
(R2) 111 457 70	100	1975	M R O	172506
(R3) 111 457 70	100	1975	M R O	172506

THE INFORMATION THAT APPEARS ON THIS MAP HAS BEEN COMPILED FROM VARIOUS SOURCES AND ACCURACY IS NOT GUARANTEED. THOSE WISHING TO START MINING CLAIMS SHOULD CONSULT WITH THE MINING RECORDS DIVISION OF NORTHERN DEVELOPMENT AND MINES FOR ADDITIONAL INFORMATION ON THE STATUS OF THE LANDS SHOWN THEREON.

Massey Twp

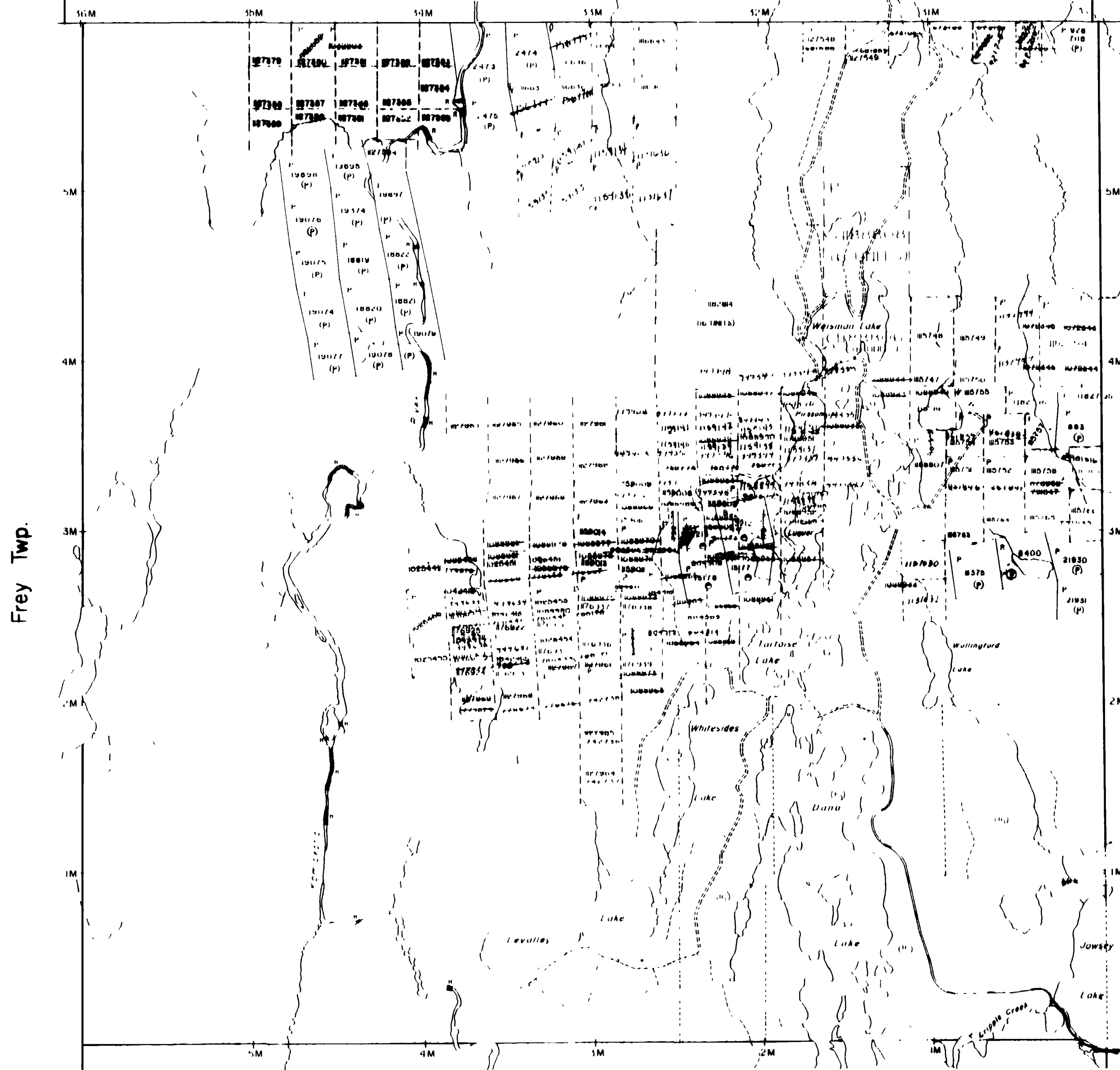

Keefe Twp

LEGEND

- HIGHWAY AND TRAIL
- OTHER ROAD
- TRAIL
- SURVEYED LINE
- TOWNSHIP, BASE LINES, ETC.
- LOT, MINING CLAIMS, PARCELS, ETC.
- UNSURVEYED LINES
- LOT LINE
- PARCEL BOUNDARY
- MINING CLAIMS, ETC.
- RAILWAY AND RIGHT OF WAY
- UTILITY LINE
- NON PERENNIAL STREAM
- FLOODING OR FLOODING RIGHTS
- SUBDIVISION OR COMPOSITE PLAN
- RESERVATIONS
- ORIGINAL SHORE LINE
- MARSH OR MOSKELG
- MINI'S
- TRAVERSE MONUMENT

DISPOSITION OF CROWN LANDS

TYPE OF DOCUMENT	SYMBOL
PATENT SURFACE & MINING RIGHTS	(P) ●
SURFACE RIGHTS ONLY	○
MINING RIGHTS ONLY	○
LEASE SURFACE & MINING RIGHTS	○
SURFACE RIGHTS ONLY	○
MINING RIGHTS ONLY	○
LICENCE OF OCCUPATION	OC
ORDER IN COUNCIL	○
RESERVATION	○
CANCELLED	○
SAND & GRAVEL	○

NOTE: MINING RIGHTS IN PARCELS PATENTED PRIOR TO MAY 8 1913 VESTED IN ORIGINAL PATENTEE BY THE PUBLIC LANDS ACT R.S.O. 1970 CHAP. 380 SEC. 63 SUBSEC. 1

SCALE 1 INCH = 40 CHAINS



TOWNSHIP

WHITESIDES

M N R ADMINISTRATIVE DISTRICT

TIMMINS

MINING DIVISION

PORCUPINE

LAND TITLES / REGISTRY DIVISION

COCHRANE



Date FEBRUARY 1985

Number

G-3230



CÔTÉ TWP - M 271

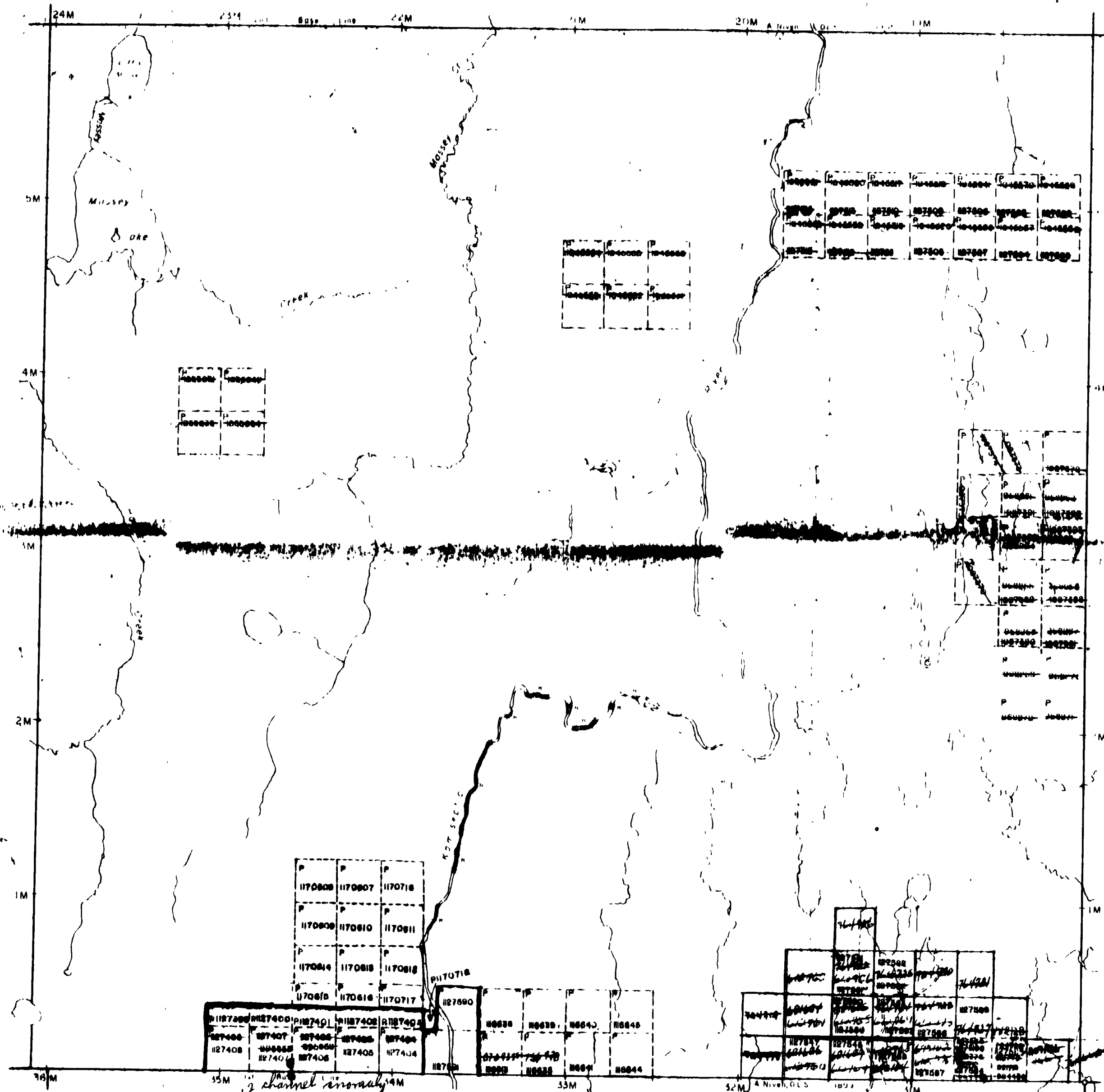

THE TOWNSHIP OF

MASSEY

DISTRICT OF COCHRANE

PORCUPINE MINING DIVISION

SCALE: 1-INCH 40 CHAINS

LEGEND

- PATENTED LAND Ⓟ
- CROWN LAND SAIT C S
- LEASES Ⓛ
- LOCATED LAND Loc
- LICENSE OF OCCUPATION L O
- MINING RIGHTS ONLY M.R.O
- SURFACE RIGHTS ONLY S.R.U
- ROADS —
- IMPROVED ROADS —
- KING'S HIGHWAYS —
- RAILWAYS —
- POWER LINES —
- MINES OR MINE LOTS —
- CANCELLED —

NOTES

400' surface rights reservation around all lakes and rivers

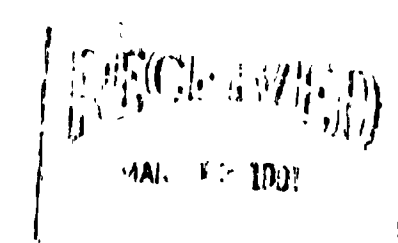

PLAN NO. *Rec'd 10/4/07* M.296

DEPARTMENT OF MINES











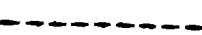

ONTARIO

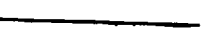
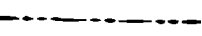
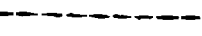
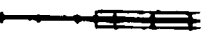
THE INFORMATION THAT APPEARS ON THIS MAP HAS BEEN COMPILED FROM VARIOUS SOURCES, AND ACCURACY IS NOT GUARANTEED. THOSE WISHING TO STAKE MINING CLAIMS SHOULD CONSULT WITH THE RECORDS, MINES, OR NORTHWESTERN DEVELOPMENT AND MINING, FOR ADDITIONAL INFORMATION ON THE STATUS OF THE LANDS SHOWN HEREON.

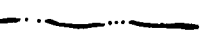

Massey Twp.

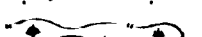
LEGEND

- HIGHWAY AND ROUTE No. 
- OTHER ROADS 
- TRAILS 
- SURVEYED LINES
 - TOWNSHIPS, BASE LINES, ETC 
 - LOTS, MINING CLAIMS, PARCELS, ETC 
- UNSURVEYED LINES
 - LOT LINES 
 - PARCEL BOUNDARY 
 - MINING CLAIMS ETC 
- RAILWAY AND RIGHT OF WAY 
- UTILITY LINES 
- NON-PERENNIAL STREAM 
- FLOODING OR FLOODING RIGHTS 
- SUBDIVISION OR COMPOSITE PLAN RESERVATIONS 
- ORIGINAL SHORELINE 
- MARSH OR MUSKEG 
- MINES 
- TRAVERSE MONUMENT 

DISPOSITION OF CROWN LANDS

TYPE OF DOCUMENT	SYMBOL
PATENT, SURFACE & MINING RIGHTS	⊙ or ●
" SURFACE RIGHTS ONLY	○
" MINING RIGHTS ONLY	◐
LEASE, SURFACE & MINING RIGHTS	◑
" SURFACE RIGHTS ONLY	◒
" MINING RIGHTS ONLY	◓
LICENCE OF OCCUPATION	◔
ORDER-IN-COUNCIL	◕
RESERVATION	◖
CANCELLED	◗
SAND & GRAVEL	◘

NOTE: MINING RIGHTS IN PARCELS PATENTED PRIOR TO MAY 6, 1913, VESTED IN ORIGINAL PATENTEES BY THE PUBLIC LANDS ACT, R.S.O. 1970 CHAP. 360, SEC. 63, SUBSEC. 1

SCALE: 1 INCH = 40 CHAINS

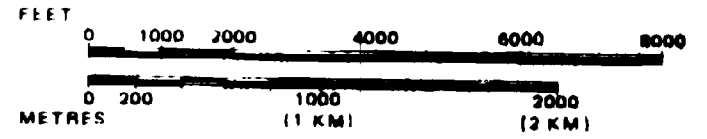

TOWNSHIP
WHITESIDES
 M.N.R. ADMINISTRATIVE DISTRICT
TIMMINS
 MINING DIVISION
PORCUPINE
 LAND TITLES / REGISTRY DIVISION
COCHRANE



Date FEBRUARY 1985
 Number **G-3230**

Frey Twp.

Carscallen Twp.

Keefe Twp.

*(Assays)
Nickel
Copper
Cobalt*

*Airborne
Anomaly*

11-12 channel

*9-10
Airborne
channel
anomaly*

*get up to 2 1/2%
nickel
3-5% copper
some cobalt
on the
patented claims
own by Don Warren*



0191-204

COLE TWP - M 271

ENID TWP - M.788

TURBULL TWP - M 316

WHITESIDES TWP - M 318

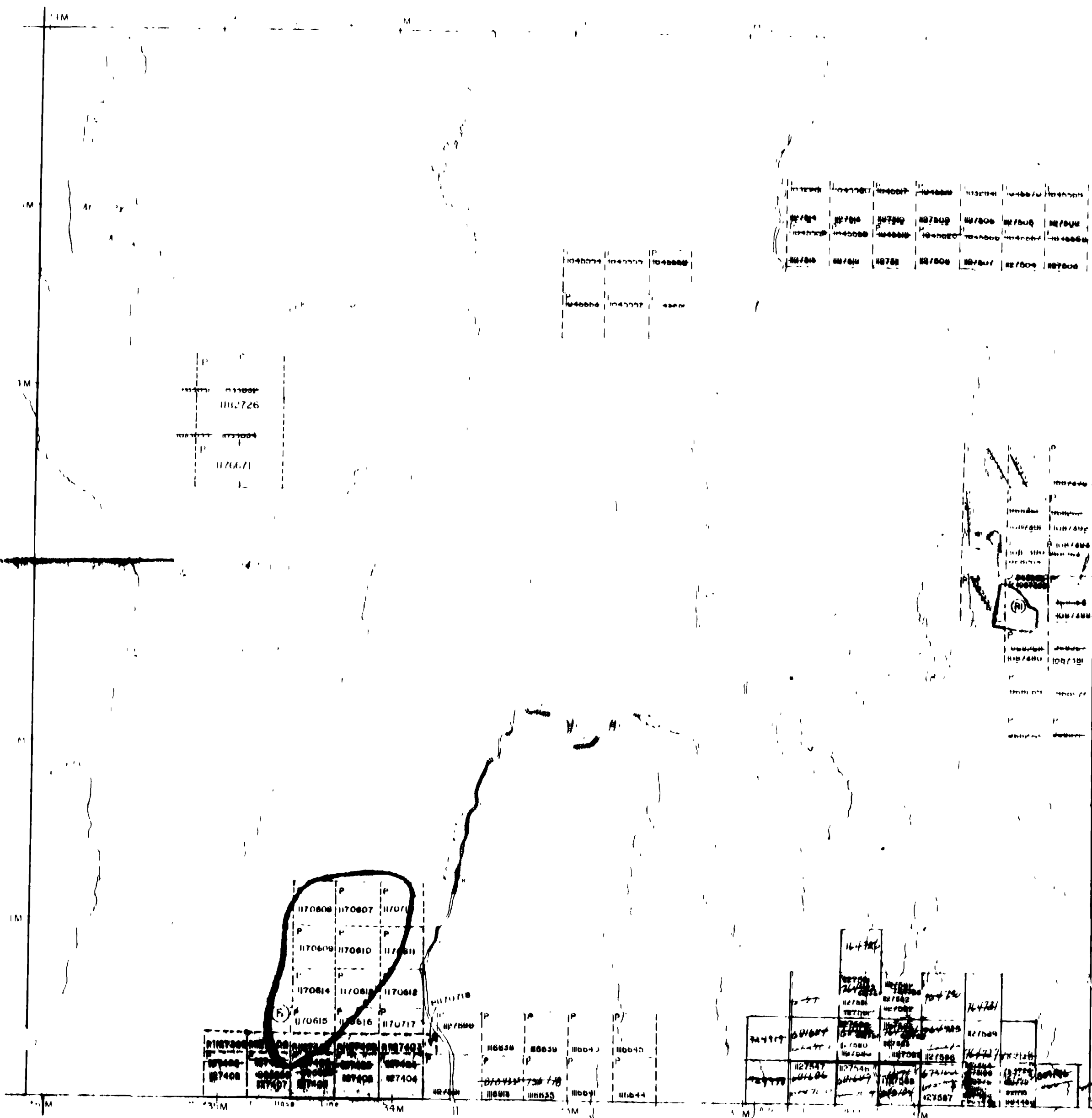

THE INFORMATION THAT APPEARS ON THIS MAP HAS BEEN COMPILED FROM VARIOUS SOURCES AND ACCURACY IS NOT GUARANTEED. THOSE WISHING TO STAKE MINING CLAIMS SHOULD CONSULT WITH THE MINING RECORDS, MINISTRY OF NORTHERN DEVELOPMENT AND MINES FOR ADDITIONAL INFORMATION ON THE STATUS OF THE LANDS SHOWN HEREON.

THE TOWNSHIP OF

MASSEY

DISTRICT OF COCHRANE

PORCUPINE MINING DIVISION

SCALE 1 INCH = 40 CHAINS

LEGEND

- PAVEMENT ROAD (P)
- UNPAVED ROAD (U)
- RAIL (R)
- LOCATED LAND (L)
- GENERAL OCCUPATION (G)
- MINING RIGHTS ONLY (M)
- ROAD RIGHTS ONLY (RO)
- ROAD (RD)
- IMPROVED ROAD (IR)
- KING'S HIGHWAY (KH)
- RAILWAYS (RW)
- POWER LINE (PL)
- MARK OF DE MURRAY (MD)
- UNANCELLED (UN)

NOTES

- (1) To surface right reservation around all lake and rivers.
- (2) THIS TWP SUBJECT TO FOREST ACTIVITY IN 1991/92. FURTHER INFORMATION AVAILABLE ON FILE.
- (3) PENDING APPLICATION UNDER THE AGGREGATE RESOURCE ACT. NOTICE RECEIVED 91 NOV 22.

PLAN NO. *Acc'd 10/1/99* M.296

DEPARTMENT OF MINES

ONTARIO



L310
L300
L290
L280
L270
L260
L250
L240
L230
L220
L210
L200
L190
L180
L170
L160
L150
L140
L130
L120
L110
L100

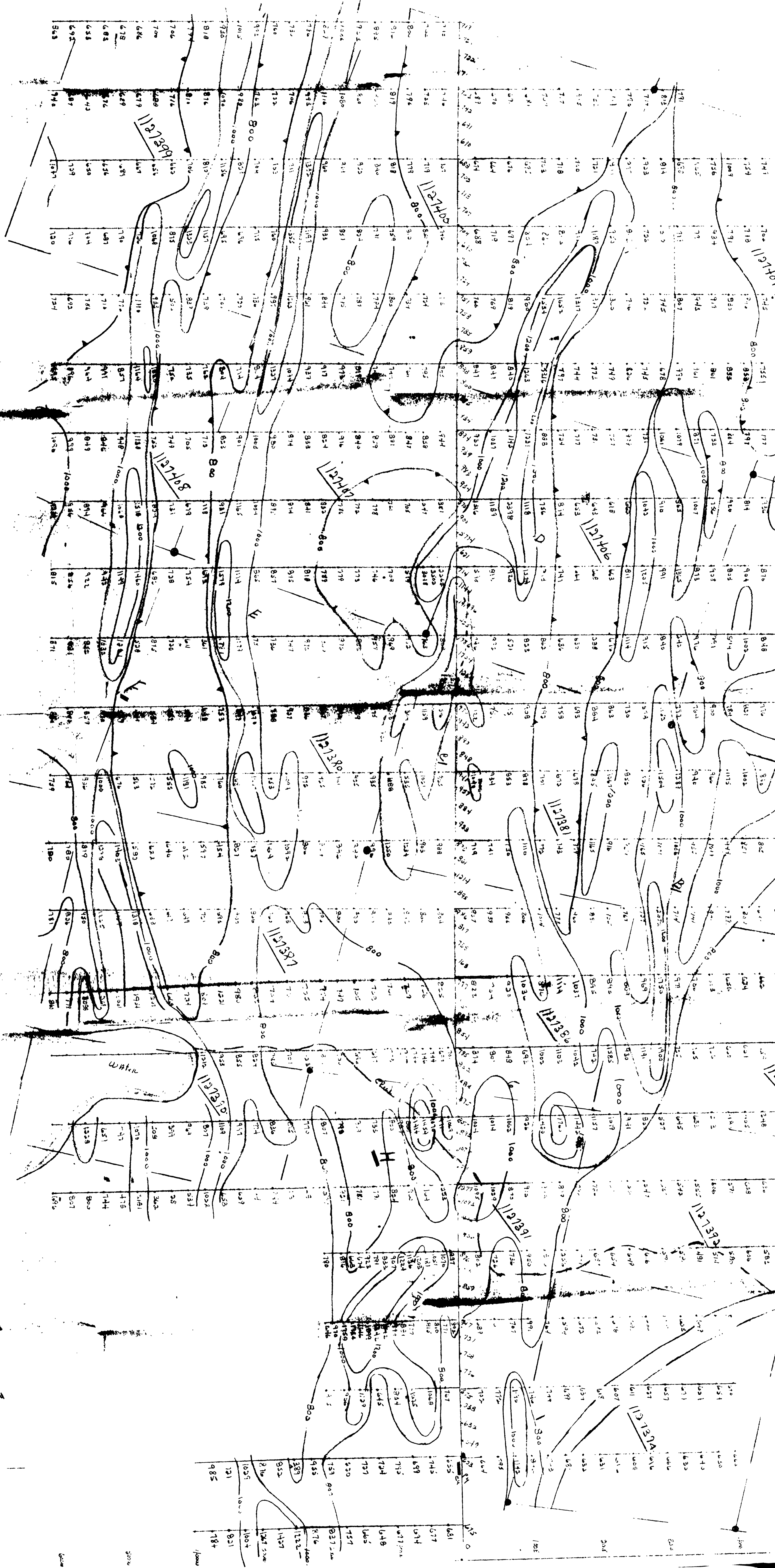

- Location -

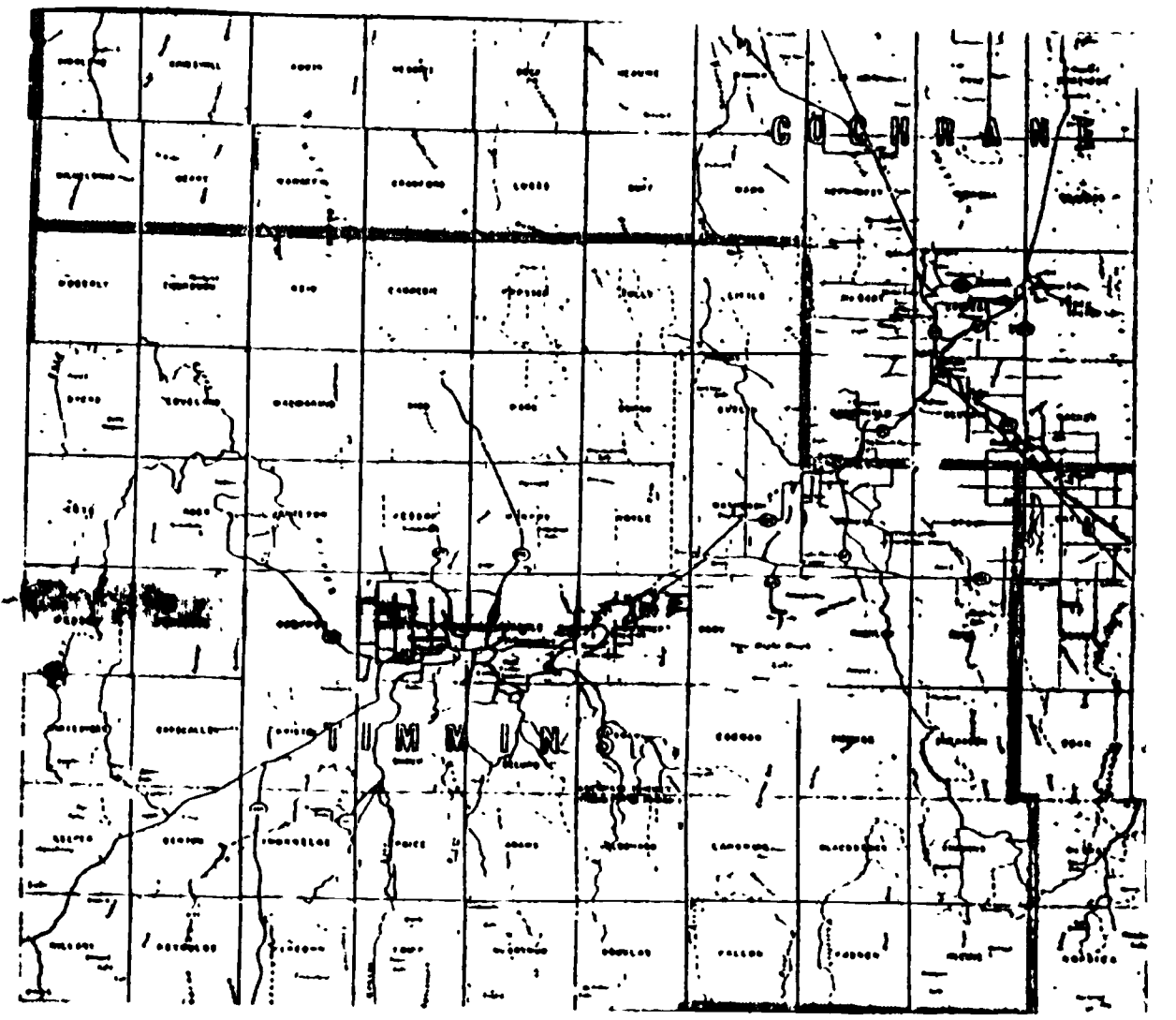

Scale 1 inch To 10 Mile.

- Legend -

MAG SURVY

Instrument - Geometric 6-216
 Precision 1 GAUMH
 Total field accuracy 7 1 GAUMH
 Range 3000 to 10000 ft
 Plotting &
 Precision location Δ 50.633
 Claim Pt location \bullet

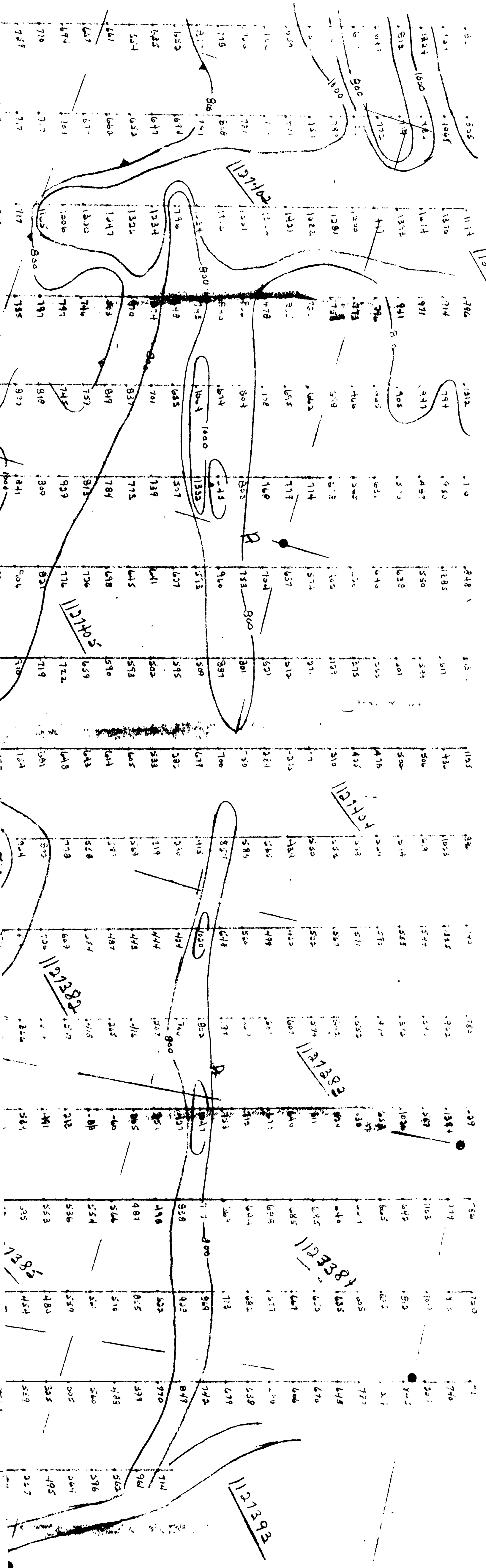

MAG Survey
White Side Trp

McKenzie & Associates Property

White Side - White Side Trp

Property of McKenzie & Associates