

42A05NW0106 63.6049 WHITESIDES

010

Report on Power Stripping
on Claim P 1159142

The stripping was performed because there was a lot of mineralization all thru the gabbro rock which was outcropping on the claim. We were getting low assays in Cu, Ni, Co. so we decided to do some stripping. We figure by stripping the outcrop we would get something alot better.
Work was done from Oct 7/91 to Oct 12/91

Sales Form

NO.

39175

DATE

Oct 7 - 12/92

CUSTOMER ORDER NO.

~~802638~~ *Pruce Cutts*
Mountain Top Timbers Ltd.

Work done for Doug Salonda

SOLD BY		CASH	C.O.D.	CHARGE	ON ACCT.	MOSE. RETD.	PAID OUT
		<input checked="" type="checkbox"/>					
QUANTITY	DESCRIPTION	PRICE	AMOUNT				
1	<i>Shipping with 238 skidder trays and over burden to get to outcrop in Whiteside Crp. Work 6 days 50 hrs at 50.00/hr. machine & man</i>						
2							
3							
4							
5							
6							
7						\$ 2500.00	
8							
9							
10							
11							
12							
13							
14							
15							

BLUELINE D 4801 (50 Pkg.) D 5801 (250 Pkg.) All claims and returned goods MUST be accompanied by this bill.

RECEIVED BY _____



Claim Holder D. Lalonde

Lic m 20625

Whitesides Sup.

Client #R156077

Drilling & Blasting = Operator D. Lalonde
Gas Plugger

Helper Larry Cutler
Porcupine Ont.

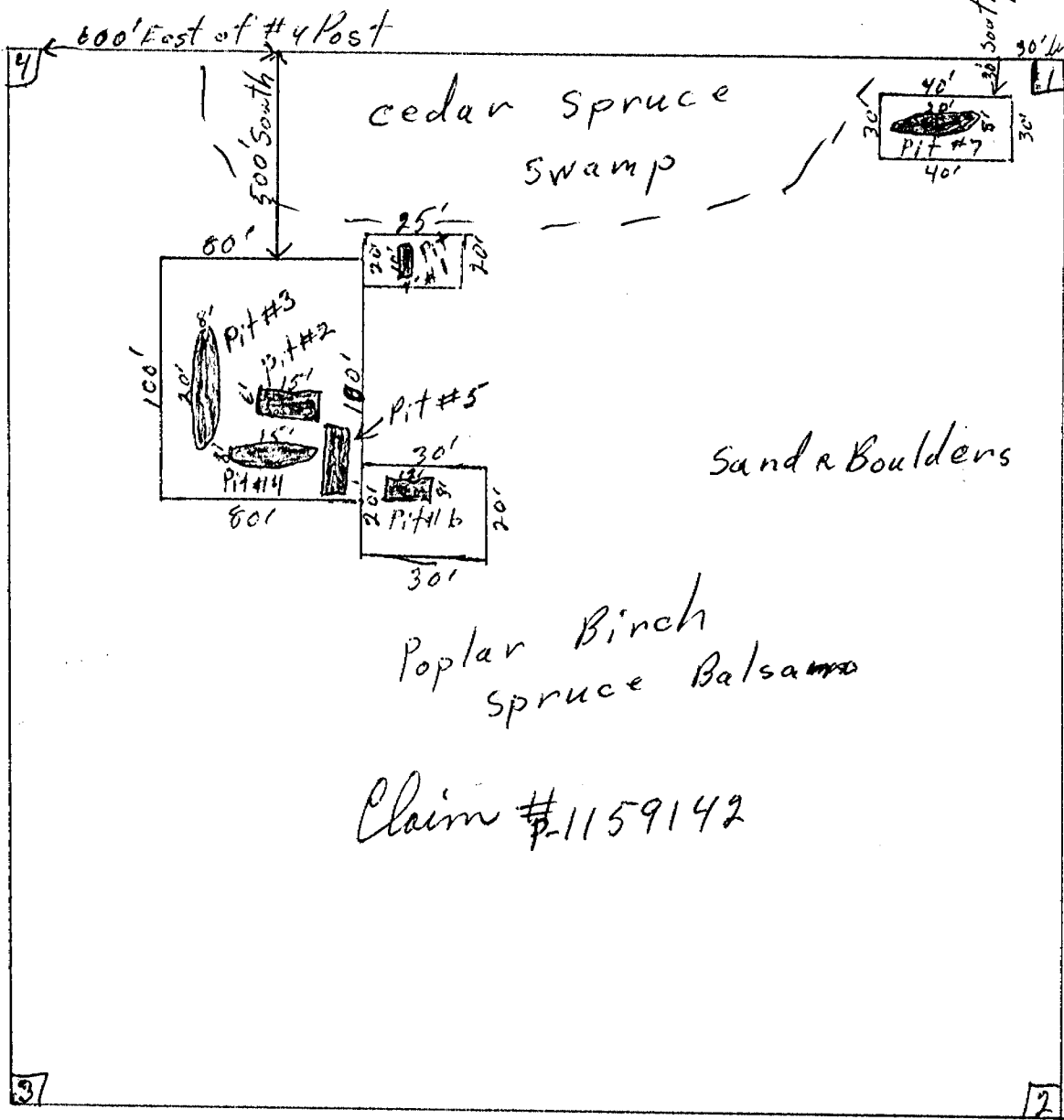

Claim #1159142



Drilled & Blasted Areas

Scale 1" = 260'

Report on Claim P-1159142

In pit #1 there is a breccia zone thru the gabbro with good copper values with low values of nickel and cobalt and a little zinc there is mineralized pyrite and peridotite.

Pit #2

Has a lot of mineralization pyrite and peridotite has nickel & copper and some cobalt in the gabbro

Pit #3 Has pyrite and peridotite in the pit there was nickel, copper and cobalt assay. There is mineral all thru the gabbro.

Pit #4 Has lots of mineral in the iron formation which runs east & west. The assays ran low in copper, nickel and cobalt. The gabbro is on the both side of the iron formation.

Pit 5 & 6 & 7

Has low assays in copper, nickel, cobalt in peridotite, some pyrite in the gabbro

all work performed from Oct 14/91 to Oct 24/91



Established 1928

Swastika Laboratories

A Division of Assayers Corporation Ltd.

Assaying - Consulting - Representation

Geochemical Analysis Certificate

1W-4467-RG1

Company: GRANGES INC
 Project:
 Attn: W. BATES

Date: NOV-21-91
 Copy 1. 136 CEDAR ST. S., TIMMINS
 2. C.D. MCKENZIE

We hereby certify the following Geochemical Analysis of 4 ROCK samples submitted NOV-18-91 by .

Sample Number	Ag ppm	Co ppm	Cu ppm	Ni ppm	Pb ppm	Zn ppm
2626	5.4	372	15000	888	23	602 Pit # 1
2627	3.8	126	14800	514	3	141 Pit # 1
2628	0.6	1830	1330	1780	5	80 Pit # 2
2629	0.2	19	92	62	7	61

Certified by Gonna Gardner

P.O. Box 10, Swastika, Ontario P0K 1T0
 Telephone (705) 642-3244 FAX (705) 642-3300



Established 1928

Swastika Laboratories

A Division of Assayers Corporation Ltd.

Assaying - Consulting - Representation

Geochemical Analysis Certificate

1W-4259-RG1

Company: **C. D. MACKENZIE**

Date: **OCT-29-91**

Project:

Copy 1. 446 POPLAR AVE, TIMMINS P4N 4S7

Attn:

2. INVOICE AND RESULTS TO GRANGES INC

3. 136 CEDAR ST S TIMMINS P4N 2G9

We hereby certify the following Geochemical Analysis of 14 ROCK samples submitted OCT-24-91 by C.D. MACKENZIE.

Whitesides Corp

Sample Number	Au ppb	Co ppm	Cu ppm	Ni ppm	Zn ppm
2607	Nil	55	348	282	} north trench
2608		54	349	309	
2609		64	359	283	
2610	Nil	318	358	4620	Pit one
2611	Nil		8380	135	" "
2612	45/41	65	4740	464	Pit 2
2613	Nil	131	869	1190	" 36 "
2614		303	507	1290	" 29 "
2615		163	8160	1070	" "
2616	Nil	149	2790	1120	Pit 3
2617	Nil	35	189	269	Pit 3 4 A
2618	Nil	39	562	161	" " 2A
2620	Nil	29	435	130	" 28 " 3A
2621	51/38	90	6220	770	near road old Pit Left Sic

P4-2A

Certified by Donna Gardner

P.O. Box 10, Swastika, Ontario P0K 1T0
 Telephone (705) 642-3244. FAX (705) 642-3300



Established 1928

Swastika Laboratories

A Division of Assayers Corporation Ltd.

Assaying - Consulting - Representation

Geochemical Analysis Certificate

1W-3305-RG1

Company: **C.D. MacKENZIE**
Project:
Attn:

Date: JUL-05-91
Copy 1. 446 POPLAR AVE, TIMMINS, ONT. P4N 4S7

We hereby certify the following Geochemical Analysis of 5 ROCK samples submitted JUL-03-91 by C.D. MacKENZIE.

Before Bleating

Sample Number	Au ppb	Co ppm	Cu ppm	Ni ppm	
2807		81	3990	907	Pit # 5
2808		59	373	366	" # 5
2809	<i>Cobalt Pit → 4/17</i>	1290	318	1110	Pit # 6
2810	10	194	659	1540	Pit # 4
2811	Ni1	142	404	1560	Pit # 4

Bean Lake Property

Certified by *Donna Gardner*

P.O. Box 10, Swastika, Ontario P0K 1T0
Telephone (705) 642-3244 FAX (705) 642-3300



Established 1928

Swastika Laboratories

A Division of Assayers Corporation Ltd.

Assaying - Consulting - Representation

Assay Certificate

1W-4500-RA1

Company: **HOMESTAKE CANADA LTD.**
Project: **5700**
Attn: **G. YULE**

Date: **NOV-28-91**

- Copy 1. P.O. Box 290, Timmins, P4N7N6 fax-267-2866
 2. 2116-120 Adelaide, St. W. Toronto. M5H1T1
 3. 446 Poplar Ave. Timmins, Ont. P4N4S7

We hereby certify the following Assay of 6 rock samples submitted NOV-27-91 by .

Sample Number	Au g/tonne	Au check g/tonne	Co ppm	Cu ppm	Ni ppm	
D-2630	Nil		205	1340	2440	<i>float fine about 20</i>
D-2631	0.02	0.03	88	572	442	<i>Pit #7</i>
D-2632	Nil		165	600	2100	<i>Pit on rd.</i>
D-2633	0.01		97	8400	537	<i>Pit #11</i>
D-2634	0.01		141	4600	588	<i>Pit #11</i>
D-2635	0.02		156	3630	900	<i>cobalt pit on rd.</i>

Certified by Donna Gardner

P.O. Box 10, Swastika, Ontario P0K 1T0
Telephone (705) 642-3244, FAX (705) 642-3300



Established 1928

Swastika Laboratories

A Division of Assayers Corporation Ltd.

Assaying - Consulting - Representation

Geochemical Analysis Certificate

1W-3502-RG1

Company: C.D. MacKenzie

Project:

Attn:

Date: JUL-26-91

Copy 1. 446 POPLAR AVE TIMMINS, ONT. P4N 4S7

We hereby certify the following Geochemical Analysis of 4 ROCK samples submitted JUL-23-91 by C.D. MacKENZIE.

Before Assaying

Sample Number	Au ppb	Au check ppb	Ag ppm	Co ppm	Cu ppm	Ni ppm	Zn ppm
2820	14		0.9	473	3360	1490	Pit # 3
2821	27	21	0.7	102	858	731	" # 3
2822	14		0.1	26		116	
2823	10		0.2	191		2490	Pit # 2

Certified by

P.O. Box 10, Swastika, Ontario P0K 1T0

Telephone (705) 642-3244

FAX (705) 642-3300



Established 1928

Swastika Laboratories

A Division of Assayers Corporation Ltd.

Assaying - Consulting - Representation

Geochemical Analysis Certificate

1W-3174-RG1

Company: **C. D. MACKENZIE**

Project:

Attn:

Date: JUN-26-91

Before Blasting

We hereby certify the following Geochemical Analysis of 2 ROCK samples submitted JUN-20-91 by .

Sample Number	Au ppb	Ag ppm	Co ppm	Cu ppm	Ni ppm	
2805	23	0.7	177	1150	1330	P.F.# 2
2806	16	0.4	97	577	918	" # 2

no Pt Pd detected

Certified by *Donna Gardner*

P.O. Box 10, Swastika, Ontario P0K 1T0

Telephone (705) 642-3244

FAX (705) 642-3300



**Report of Work Conducted
After Recording Claim**

Mining Act

Personal information collected on this form is obtained under the authority of the Mining Act. This collection should be directed to the Provincial Manager, Mining Lands, Ministry of Northern Development and Mines, Sudbury, Ontario, P3E 6A5, telephone (705) 670-7264.



42A05NW0106 63.6049 WHITESIDES

900

- Instructions:**
- Please type or print and submit in duplicate.
 - Refer to the Mining Act and Regulations for requirements of filing assessment work or consult the Mining Recorder.
 - A separate copy of this form must be completed for each Work Group.
 - Technical reports and maps must accompany this form in duplicate.
 - A sketch, showing the claims the work is assigned to, must accompany this form.

Recorded Holder(s) <i>D. Lalonde</i>		Client No. <i>156077</i>
Address <i>53 Way Ave Timmins Ont.</i>		Telephone No. <i>264-5939</i>
Mining Division <i>Porcupine</i>	Township/Area <i>Whitesides</i>	M or G Plan No.
Dates Work Performed From: <i>Oct 7/91</i>		To: <i>Oct 12/91</i>

Work Performed (Check One Work Group Only)

Work Group	
Geotechnical Survey	
Physical Work, Including Drilling	
Rehabilitation	
Other Authorized Work	<i>Power Stripping with 230 Skidder Timberjack</i>
Assays	
Assignment from Reserve	

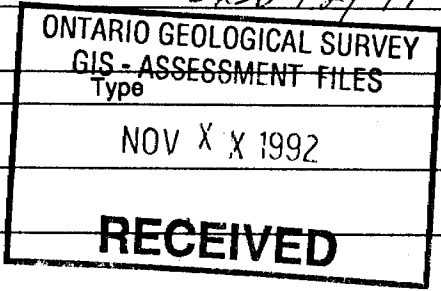

Total Assessment Work Claimed on the Attached Statement of Costs \$ *2500.00*

Note: The Minister may reject for assessment work credit all or part of the assessment work submitted if the recorded holder cannot verify expenditures claimed in the statement of costs within 30 days of a request for verification.

Persons and Survey Company Who Performed the Work (Give Name and Address of Author of Report)

Name	Address
<i>Bruce Cutler</i>	<i>Mountain Top</i>

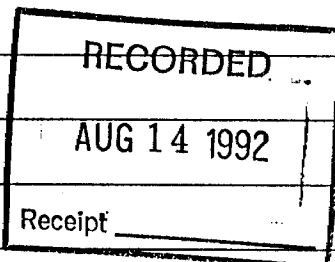

(attach a schedule if necessary)

Certification of Beneficial Interest * See Note No. 1 on reverse side

I certify that at the time the work was performed, the claims covered in this work report were recorded in the current holder's name or held under a beneficial interest by the current recorded holder.	Date <i>Aug 12/92</i>	Recorded Holder or Agent (Signature) <i>D. Lalonde</i>
--	--------------------------	---

Certification of Work Report

I certify that I have a personal knowledge of the facts set forth in this Work report, having performed the work or witnessed same during and/or after its completion and annexed report is true.

Name and Address of Person Certifying <i>D. Lalonde 53 Way Ave Timmins Ont.</i>		
Telephone No. <i>264-5939</i>	Date <i>Aug 12/92</i>	Certified By (Signature) <i>D. Lalonde</i>

For Office Use Only

Total Value Cr. Recorded <i>3 2500.00</i>	Date Recorded <i>AUG. 14/92</i>	Mining Recorder <i>White</i>	RECEIVED AUG 14 1992 <i>10:15 C X L</i>
	Deemed Approval Date <i>Nov. 13/92</i>	Date Approved	
	Date Notice for Amendments Sent		



Statement of Costs
for Assessment Credit

État des coûts aux fins
du crédit d'évaluation

Transaction No./N° de transaction
W260.00109

Mining Act/Loi sur les mines

Personal information collected on this form is obtained under the authority of the Mining Act. This information will be used to maintain a record and ongoing status of the mining claim(s). Questions about this collection should be directed to the Provincial Manager, Minings Lands, Ministry of Northern Development and Mines, 4th Floor, 159 Cedar Street, Sudbury, Ontario P3E 6A5, telephone (705) 670-7264.

Les renseignements personnels contenus dans la présente formule sont recueillis en vertu de la Loi sur les mines et serviront à tenir à jour un registre des concessions minières. Adresser toute question sur la collecte de ces renseignements au chef provincial des terrains miniers, ministère du Développement du Nord et des Mines, 159, rue Cedar, 4^e étage, Sudbury (Ontario) P3E 6A5, téléphone (705) 670-7264.

1. Direct Costs/Coûts directs

Type	Description	Amount Montant	Totals Total global
Wages Salaires	Labour Main-d'oeuvre		
	Field Supervision Supervision sur le terrain		
Contractor's and Consultant's Fees Droits de l'entrepreneur et de l'expert- conseil	Type <i>shipping bill</i>		
	<i>2.30.000</i>	<i>2.300.00</i>	<i>2.500.00</i>
Supplies Used Fournitures utilisées	Type		
Equipment Rental Location de matériel	Type		
Total Direct Costs Total des coûts directs			<i>2.500.00</i>

2. Indirect Costs/Coûts indirects

** Note: When claiming Rehabilitation work Indirect costs are not allowable as assessment work.
Pour le remboursement des travaux de réhabilitation, les coûts indirects ne sont pas admissibles en tant que travaux d'évaluation.

Type	Description	Amount Montant	Totals Total global
Transportation Transport	Type		
Food and Lodging Nourriture et hébergement	Receipt		
Mobilization and Démobilization Mobilisation et démobilisation			
Sub Total of Indirect Costs Total partiel des coûts indirects			
Amount Allowable (not greater than 20% of Direct Costs) Montant admissible (n'excédant pas 20 % des coûts directs)			
Total Value of Assessment Credit (Total of Direct and Allowable indirect costs)		Valeur totale du crédit d'évaluation (Total des coûts directs et indirects admissibles)	

Note: The recorded holder will be required to verify expenditures claimed in this statement of costs within 30 days of a request for verification. If verification is not made, the Minister may reject for assessment work all or part of the assessment work submitted.

Note : Le titulaire enregistré sera tenu de vérifier les dépenses demandées dans le présent état des coûts dans les 30 jours suivant une demande à cet effet. Si la vérification n'est pas effectuée, le ministre peut rejeter tout ou une partie des travaux d'évaluation présentés.

Filing Discounts

- Work filed within two years of completion is claimed at 100% of the above Total Value of Assessment Credit.
- Work filed three, four or five years after completion is claimed at 50% of the above Total Value of Assessment Credit. See calculations below:

Total Value of Assessment Credit	Total Assessment Claimed
$\times 0.50 =$	<i>2.500.00</i>

Remises pour dépôt

- Les travaux déposés dans les deux ans suivant leur achèvement sont remboursés à 100 % de la valeur totale susmentionnée du crédit d'évaluation.
- Les travaux déposés trois, quatre ou cinq ans après leur achèvement sont remboursés à 50 % de la valeur totale du crédit d'évaluation susmentionné. Voir les calculs ci-dessous.

Valeur totale du crédit d'évaluation	Évaluation totale demandée
$\times 0,50 =$	

Certification Verifying Statement of Costs

I hereby certify:
that the amounts shown are as accurate as possible and these costs were incurred while conducting assessment work on the lands shown on the accompanying Report of Work form.

that as *D. Palomede* I am authorized
(Recorded Holder, Agent, Position in Company)

to make this certification

Attestation de l'état des coûts

J'atteste par la présente :
que les montants indiqués sont le plus exact possible et que ces dépenses ont été engagées pour effectuer les travaux d'évaluation sur les terrains indiqués dans la formule de rapport de travail ci-joint.

Et qu'à titre de _____ je suis autorisé
(titulaire enregistré, représentant, poste occupé dans la compagnie)

à faire cette attestation.

Signature <i>D. Palomede</i>	Date <i>Aug 12/92</i>
---------------------------------	--------------------------

Report of Work Conducted After Recording Claim

Mining Act

Assmt Files
Transaction Number
W260.00110

Personal information collected on this form is obtained under the authority of the Mining Act. This information will be used for correspondence. Questions about this collection should be directed to the Provincial Manager, Mining Lands, Ministry of Northern Development and Mines, Fourth Floor, 159 Cedar Street, Sudbury, Ontario, P3E 6A5, telephone (705) 670-7264.

- Instructions:**
- Please type or print and submit in duplicate.
 - Refer to the Mining Act and Regulations for requirements of filing assessment work or consult the Mining Recorder.
 - A separate copy of this form must be completed for each Work Group.
 - Technical reports and maps must accompany this form in duplicate.
 - A sketch, showing the claims the work is assigned to, must accompany this form.

Recorded Holder(s) <i>Douglas Lalonde</i>	Client No. <i>156077</i>
Address <i>53 Way Ave Timmins Ont.</i>	Telephone No. <i>264-5939</i>
Mining Division <i>Porcupine</i>	Township/Area <i>Whitesides</i>
M of G Plan No.	
Dates Work Performed From: <i>Oct 14/91</i>	To: <i>Oct 24/91</i>

Work Performed (Check One Work Group Only)

Work Group	Type
Geotechnical Survey	
Physical Work, Including Drilling	<i>Drilling with Gas Plugger and Blasting</i>
Rehabilitation	
Other Authorized Work	
Assays	
Assignment from Reserve	

ONTARIO GEOLOGICAL SURVEY
GIS - ASSESSMENT FILES
NOV X X 1992
RECEIVED

Total Assessment Work Claimed on the Attached Statement of Costs \$ *3000.00*

Note: The Minister may reject for assessment work credit all or part of the assessment work submitted if the recorded holder cannot verify expenditures claimed in the statement of costs within 30 days of a request for verification.

Persons and Survey Company Who Performed the Work (Give Name and Address of Author of Report)

Name	Address
<i>Douglas Lalonde</i>	<i>53 Way Ave. Timmins</i>
<i>Larry Cutts</i>	<i>Porcupine Ont</i>

RECORDED
AUG 14 1992
Receipt _____

(attach a schedule if necessary)

Certification of Beneficial Interest * See Note No. 1 on reverse side

I certify that at the time the work was performed, the claims covered in this work report were recorded in the current holder's name or held under a beneficial interest by the current recorded holder.	Date <i>Aug 12/92</i>	Recorded Holder or Agent (Signature) <i>D. Lalonde</i>
--	--------------------------	---

Certification of Work Report

I certify that I have a personal knowledge of the facts set forth in this Work report, having performed the work or witnessed same during and/or after its completion and annexed report is true.

Name and Address of Person Certifying <i>D. Lalonde 53 Way Ave. Timmins Ont.</i>		
Telephone No. <i>264-5939</i>	Date <i>Aug 12/92</i>	Certified By (Signature) <i>D. Lalonde</i>

For Office Use Only

Total Value Cr. Recorded <i>\$ 3000.00</i>	Date Recorded <i>Aug. 14 / 92</i>	Mining Recorder <i>D. Lalonde</i>	RECEIVED AUG 14 1992 <i>1015 C LK</i>
	Deemed Approval Date <i>Nov. 13/92</i>	Date Approved	
	Date Notice for Amendments Sent		



Ontario

Statement of Costs
for Assessment Credit

État des coûts aux fins
du crédit d'évaluation

Transaction No./N° de transaction

W260.00110

Mining Act/Loi sur les mines

Personal information collected on this form is obtained under the authority of the Mining Act. This information will be used to maintain a record and ongoing status of the mining claim(s). Questions about this collection should be directed to the Provincial Manager, Minings Lands, Ministry of Northern Development and Mines, 4th Floor, 159 Cedar Street, Sudbury, Ontario P3E 6A5, telephone (705) 670-7264.

Les renseignements personnels contenus dans la présente formule sont recueillis en vertu de la Loi sur les mines et serviront à tenir à jour un registre des concessions minières. Adresser toute question sur la collecte de ces renseignements au chef provincial des terrains miniers, ministère du Développement du Nord et des Mines, 159, rue Cedar, 4^e étage, Sudbury (Ontario) P3E 6A5, téléphone (705) 670-7264.

1. Direct Costs/Coûts directs

Type	Description	Amount Montant	Totals Total global
Wages Salaires	Labour Main-d'oeuvre	3000. ⁰⁰	
	Field Supervision Supervision sur le terrain		3000. ⁰⁰
Contractor's and Consultant's Fees Droits de l'entrepreneur et de l'expert- conseil	Type		
Supplies Used Fournitures utilisées	Type		
Equipment Rental Location de matériel	Type		
Total Direct Costs Total des coûts directs			3000. ⁰⁰

2. Indirect Costs/Coûts indirects

** Note: When claiming Rehabilitation work indirect costs are not allowable as assessment work.
Pour le remboursement des travaux de réhabilitation, les coûts indirects ne sont pas admissibles en tant que travaux d'évaluation.

Type	Description	Amount Montant	Totals Total global
Transportation Transport	Type		
Food and Lodging Nourriture et hébergement			
Mobilization and Demobilization Mobilisation et démobilisation			
Sub Total of Indirect Costs Total partiel des coûts indirects			
Amount Allowable (not greater than 20% of Direct Costs) Montant admissible (n'excédant pas 20 % des coûts directs)			
Total Value of Assessment Credit (Total of Direct and Allowable indirect costs)		Valeur totale du crédit d'évaluation (Total des coûts directs et indirects admissibles)	

Note: The recorded holder will be required to verify expenditures claimed in this statement of costs within 30 days of a request for verification. If verification is not made, the Minister may reject for assessment work all or part of the assessment work submitted.

Note : Le titulaire enregistré sera tenu de vérifier les dépenses demandées dans le présent état des coûts dans les 30 jours suivant une demande à cet effet. Si la vérification n'est pas effectuée, le ministre peut rejeter tout ou une partie des travaux d'évaluation présentés.

Filing Discounts

1. Work filed within two years of completion is claimed at 100% of the above Total Value of Assessment Credit.
2. Work filed three, four or five years after completion is claimed at 50% of the above Total Value of Assessment Credit. See calculations below:

Total Value of Assessment Credit	Total Assessment Claimed
	× 0.50 =

Remises pour dépôt

1. Les travaux déposés dans les deux ans suivant leur achèvement sont remboursés à 100 % de la valeur totale susmentionnée du crédit d'évaluation.
2. Les travaux déposés trois, quatre ou cinq ans après leur achèvement sont remboursés à 50 % de la valeur totale du crédit d'évaluation susmentionné. Voir les calculs ci-dessous.

Valeur totale du crédit d'évaluation	Évaluation totale demandée
	× 0,50 =

Certification Verifying Statement of Costs

I hereby certify:
that the amounts shown are as accurate as possible and these costs were incurred while conducting assessment work on the lands shown on the accompanying Report of Work form.

that as D. Lalonde I am authorized
(Recorded Holder, Agent, Position in Company)

to make this certification

Attestation de l'état des coûts

J'atteste par la présente :
que les montants indiqués sont le plus exact possible et que ces dépenses ont été engagées pour effectuer les travaux d'évaluation sur les terrains indiqués dans la formule de rapport de travail ci-joint.

Et qu'à titre de _____ je suis autorisé
(titulaire enregistré, représentant, poste occupé dans la compagnie)

à faire cette attestation.

Signature	Date
<u>D. Lalonde</u>	<u>Aug 12/92</u>

Drilling on Claim # P-1159142
Gas Plugger was used Ponjar

Worked as ^{drill} Operator Oct 14/91 till Oct 24/91

Douglas Lalonde
Worked 10 days at 150.⁰⁰ day = \$1500.⁰⁰

Larry Cutts worked as drill helper

Worked 10 days at 150.⁰⁰ day = \$1500.⁰⁰

Total Money or Wages \$3000.⁰⁰

REFERENCES

AREAS WITHDRAWN FROM DISPOSITION

M.R.O. - MINING RIGHTS ONLY
 S.R.O. - SURFACE RIGHTS ONLY
 M.+S. - MINING AND SURFACE RIGHTS

Description	Order No.	Date	Disposition	File
① DANA AND JOWSEY LAKES PARK RES. SEC. 36/80	W.66/85		S.R.O. M.R.O.	171506
② SEC. 43/70		FEB. 3/66	M. & S.R.	171506
③ SEC. 43/70		28/1/71	M. & S.R.	171506

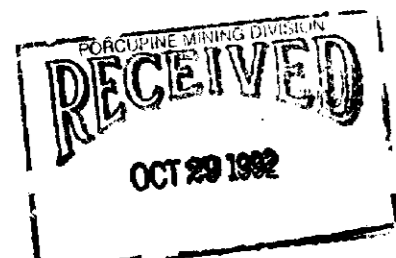

THE INFORMATION THAT APPEARS ON THIS MAP HAS BEEN COMPILED FROM VARIOUS SOURCES, AND ACCURACY IS NOT GUARANTEED. THOSE WISHING TO STAKE MINING CLAIMS SHOULD CONSULT WITH THE MINING RECORDER, MINISTRY OF NORTHERN DEVELOPMENT AND MINES, FOR ADDITIONAL INFORMATION ON THE STATUS OF THE

Massey Twp.

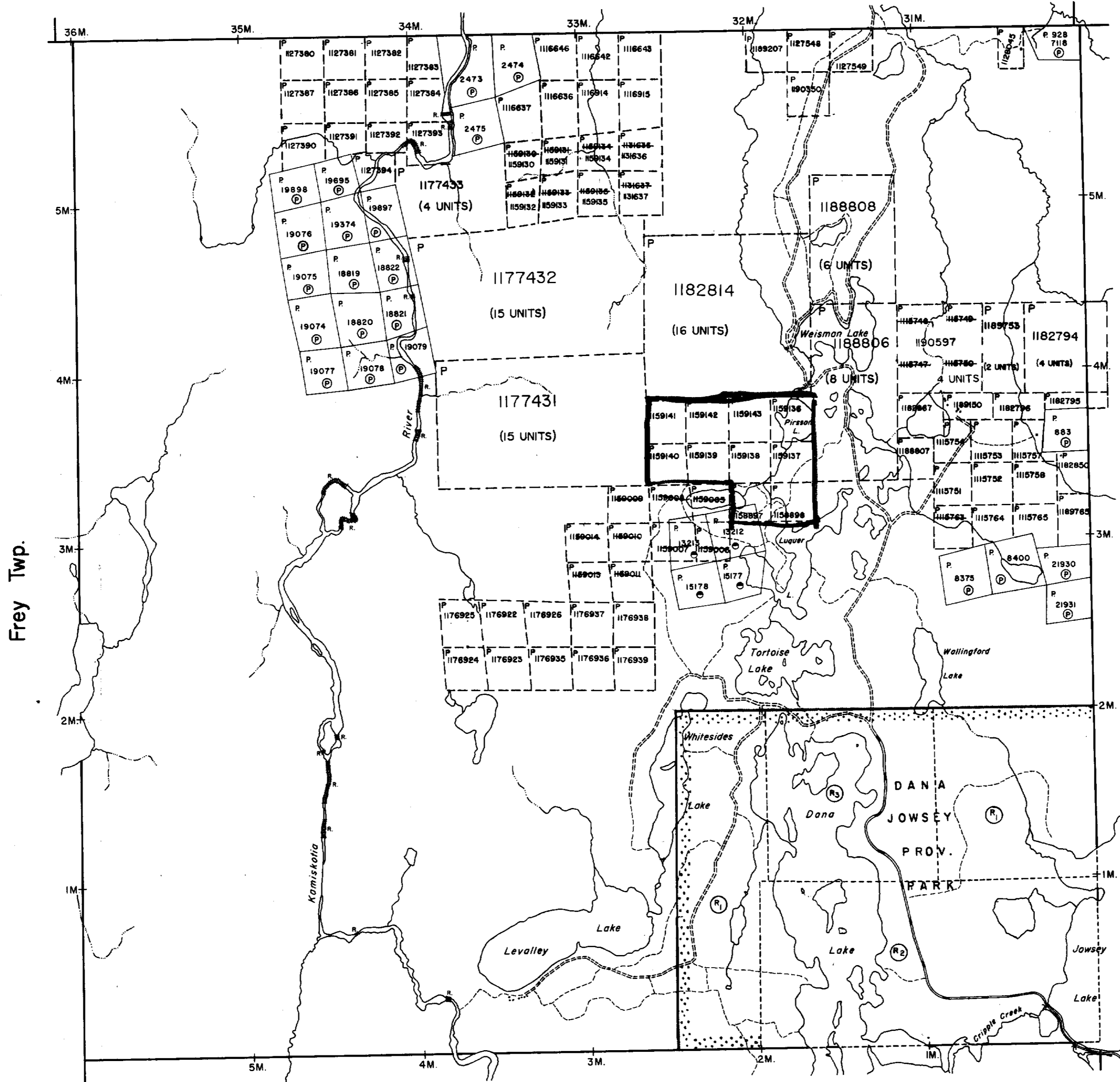

Frey Twp.

Carscallen Twp.

Keefe Twp.

LEGEND

- HIGHWAY AND ROUTE No.
- OTHER ROADS
- TRAILS
- SURVEYED LINES:
TOWNSHIPS, BASE LINES, ETC.
- LOTS, MINING CLAIMS, PARCELS, ETC.
- UNSURVEYED LINES:
LOT LINES
- PARCEL BOUNDARY
- MINING CLAIMS ETC.
- RAILWAY AND RIGHT OF WAY
- UTILITY LINES
- NON-PERENNIAL STREAM
- FLOODING OR FLOODING RIGHTS
- SUBDIVISION OR COMPOSITE PLAN
- RESERVATIONS
- ORIGINAL SHORELINE
- MARSH OR MUSKEG
- MINES
- TRAVERSE MONUMENT

DISPOSITION OF CROWN LANDS

TYPE OF DOCUMENT	SYMBOL
PATENT, SURFACE & MINING RIGHTS	⊙ or ●
" SURFACE RIGHTS ONLY	○
" MINING RIGHTS ONLY	◐
LEASE, SURFACE & MINING RIGHTS	■
" SURFACE RIGHTS ONLY	□
" MINING RIGHTS ONLY	◑
LICENCE OF OCCUPATION	◄
ORDER IN COUNCIL	OC
RESERVATION	⊙
CANCELLED	⊖
SAND & GRAVEL	⊙

NOTE: MINING RIGHTS IN PARCELS PATENTED PRIOR TO MAY 6, 1913, VESTED IN ORIGINAL PATENTEE BY THE PUBLIC LANDS ACT, R.S.O. 1970, CHAP. 380, SEC. 63, SUBSEC. 1.

SCALE: 1 INCH = 40 CHAINS

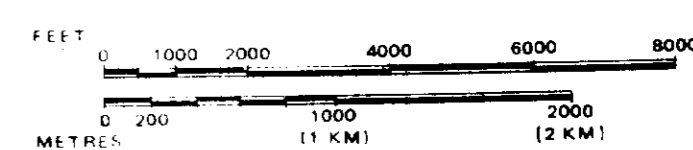

TOWNSHIP

WHITESIDES
 M.N.R. ADMINISTRATIVE DISTRICT
 TIMMINS
 MINING DIVISION
 PORCUPINE
 LAND TITLES / REGISTRY DIVISION
 COCHRANE

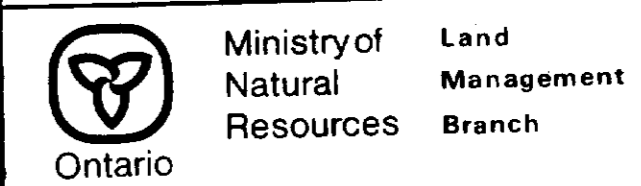

Date FEBRUARY 1985

Number
G-3230

ACTIVATED JUNE 30, 1992 BY D.C.

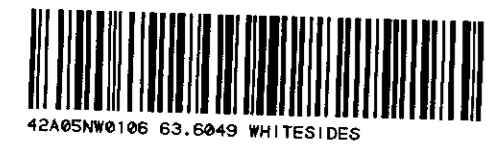

63.6049