

Dica Property

Whitesides



42A05NW8525 2.14484 WHITESIDES

010

July 15/91  
July 19/91

The outside boundary of the claims were struck out some and we prospecting as we went around the outside boundary we also check posts and tags before the line cutting would start to make sure the outside boundary was D.K. There was no rock sample take for assay there were no sample of any interest. The group of 9 claim boundary was check and the line then where cut the maps which was filed for assessment will show the claims the line where cut on. The work was done on the July 15/91 by D. Falcone 1 day  
 Work at a rate of \$100.00 per day each, Larry Cutler 1 day  
 assessment Total \$200.00  
 Pokupine

July 19/91

Work on claims 1115752, 1115758, 1115764, 1115765 checking out airborne anomalies with the mag & V.I.F. conductors before cutting the line on the property to make sure the line will be cut the right direction so that when we read the mag a V.I.F. we will be crossing the conductor the right angle. There was prospecting done as we where checking for conductors. There was no samples taken there was only 1 outcrop on the north part of claim 1115752 & 1115758 and there was a little mineralization but not of much interest. The rocks are felsic volcanic rocks & rhyolite. There was a small outcrop of rhyolite found near the south side of the creek in the south west corner of claim 1115764 but no samples of any interest. The work was carried out by

2.14484

20625

D. Lalonde worked - 1 day at \$100.00 day  
Cliff MacKenzie worked - 1 day at \$100.00 day  
Larry Cuts worked - 1 day at \$100.00 day. July 19/91

The prospecting and the Mag a V. L. F. conductor were done by guessing compass line from north to south across the claim mentioned. The conductor were pick up by the mag a V. L. F. So then we got the line cutting under way cutting the lines north & south. Can be referred to the work or assessment files of the Mag a V. L. F. and line cutting.  
Assessment total \$300.00

2.14484

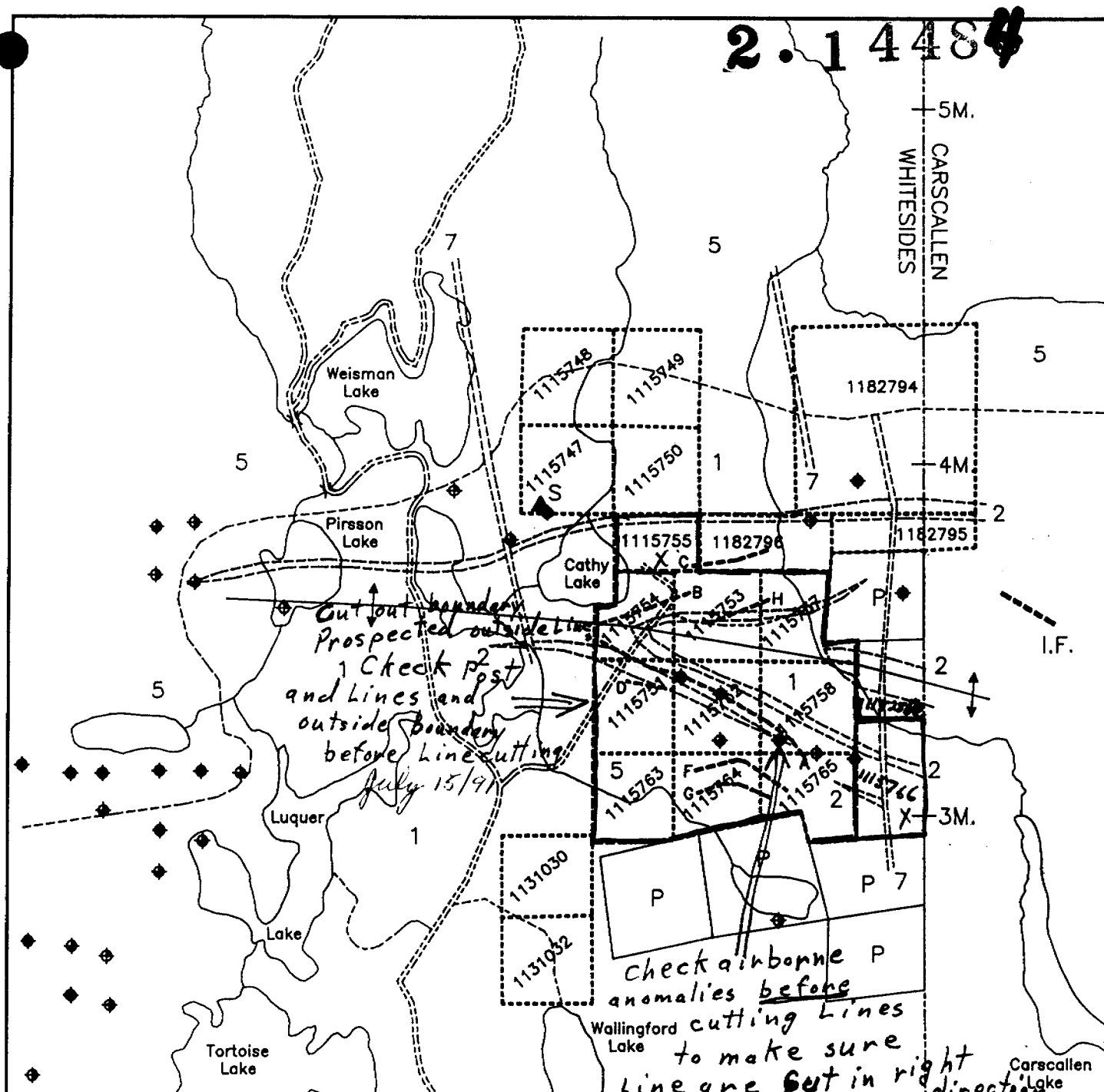

*Out out boundary  
Prospected outside line  
1 Check p2  
and lines and  
outside boundary  
before line cutting  
July 15/91*

*check airborne P  
anomalies before  
Wallingford cutting lines  
to make sure  
line are set in right  
direction*

*Anomalies  
July 19/91  
Check with Mag a v.l. for direction  
MRS. ARLENE DAE PROPERTY  
and Prospected.*

- 7 Diabase
  - 5 Mafic Intrusive Rocks
  - 2 Felsic Volcanic Rocks
  - 1 Mafic Volcanic Rocks
- A--- VLF Conductor

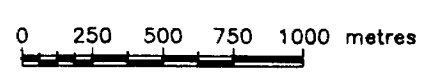

Whitesides and Carscallen Twps.

Geological Compilation  
& Claim Location Map

|                   |                   |
|-------------------|-------------------|
| Drawn: P.C.W.     | Revised:          |
| Date: Aug., 1991  | NTS:              |
| Province: Ontario | 42 A/5            |
| Scale:            | Drawing: see-comp |



2.14484

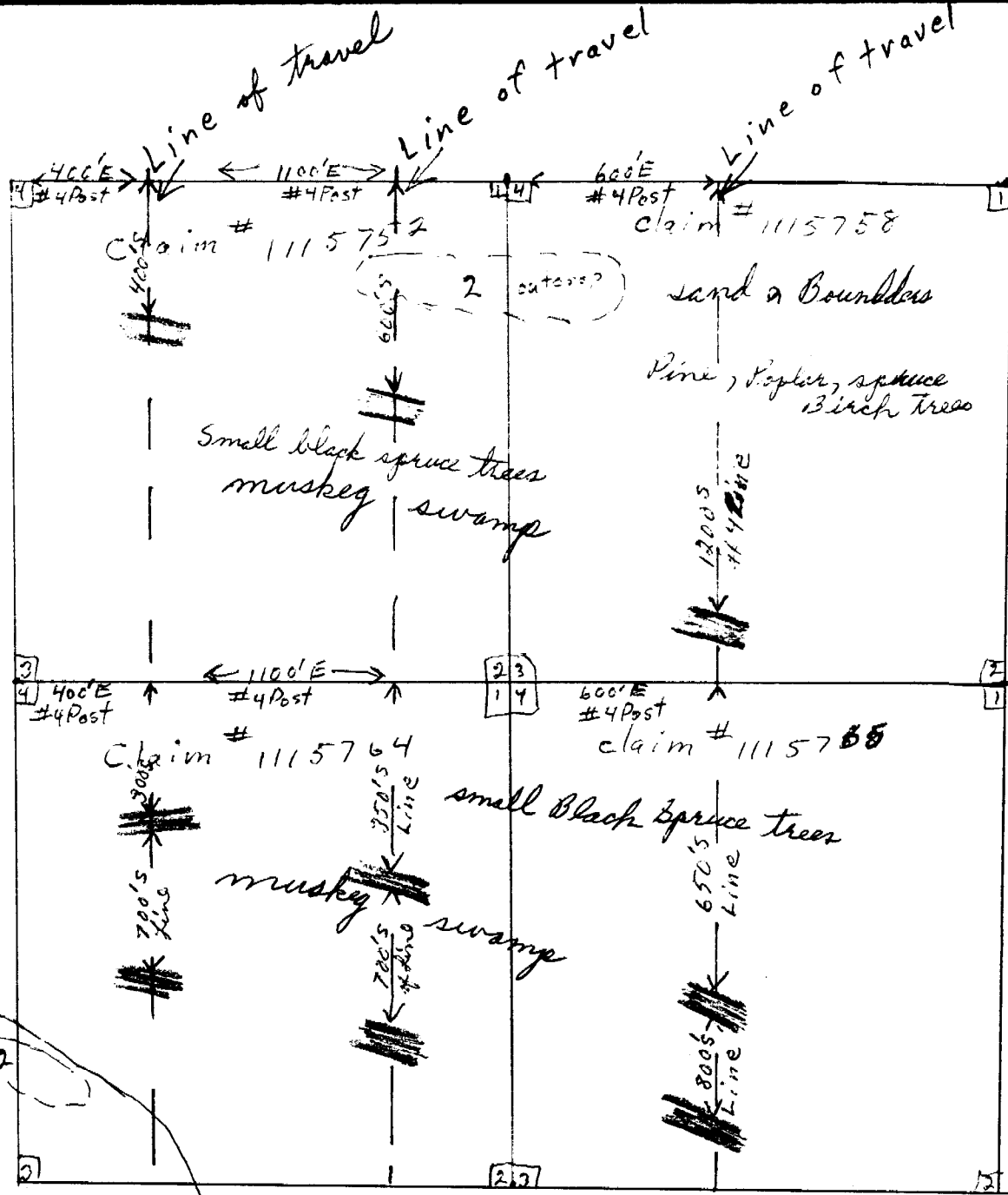

○ out crop  
 2 - Felicit Volcanic Rocks & Pyrite  
 Light Pyrite

Checking airborne anomalies targets before cutting the lines with Mag a V.L.F. to make sure the line-cutting will be done <sup>right</sup> cutting the lines the right direction and worked done by. Prospected at the same time.

L. Falonde Lic #20625  
 Cliff MacKenzie  
 Larry Cutts

On July 19/91  
 Whitesides Prop.  
 Dea Property

▬▬▬ About were the V.L.F. and Mag pick up the conductors on the travelled lines

1:5200

Dea Property

Whitesides 4. up.

Aug 14 & 1911

After the lines were cutted and the mag and V.F.F was completed and plotted was finish. We when to Dea property to see want we could find and to see want was give the conductor and to see if they were covered with overburden or not. On Aug 14 D. Lalonde & Larry Cutts worked on claim # 1115752 & # 1115764 We prospecting using the ~~lines~~<sup>Dr.</sup> lines which was cut by the line cutters We found that conductor A was a buried conductor all the way across and conductor F and G were also buried conductor the where all cover with musky swamp and small Black spruce trees. There was no outcrops found where the conductor where. There was 1 outcrop found and north end of claim 1115752 which was felsic volcanic rocks but with very little mineralization in it. And there was a small out crop found on south west corner of claim # 1115764 which was rhyolite and very little pyrite. Worked was done on Aug 14 by D. Lalonde - 1 day \$100.00 day.  
 Lic # 20625 Larry Cutts 1 day 100.00 day.  
 Assessment Total 200.00

2. 14484

Deer Property Whitesides Twp.

Aug 18/91

Prospecting and checking conductor A, F, G, was carry out on Aug 18 By. D. Lalonde & Larry Cutts to see if the conductors were covered by overburden or not. We used the lines which was cut by the linecutters to prospect and carry out checking the anomalies. We couldn't find any outcrop near or over anomalies A, D, F. they are all covered by muskeg swamp and small black spruce trees. There was out crop located at north west corner of claim #1115758 which was felsic volcanic rock but with very little mineralization. There was also a was a outcrop located on the east boundary of claim #1115758 it is also felsic volcanic rocks. but very little pyrite no assay where take. The rest of the claim is covered with sand & boulders pine, spruce, Populus trees. and claim #1115765 is all covered by muskeg swamp and black spruce trees.

Aug 18/91

Work was done by  
1 day each at \$100.00 day

Lic #20,625  
D. Lalonde 1 day  
Larry cutts 1 day

assessment Total \$200.00

2.14484

2. 14184

Line used to check V.L.F. anomalies if covered by overburden or not after the line-cutting and Mag a V.L.F. was completed

The line-cutting lines were used to carry out the work prospecting the same time when checking the conductors

Aug 14 & 18/91  
Work done by:  
D. Lalonde #20625  
Larry Cutler

Whitesides Trip  
See Property

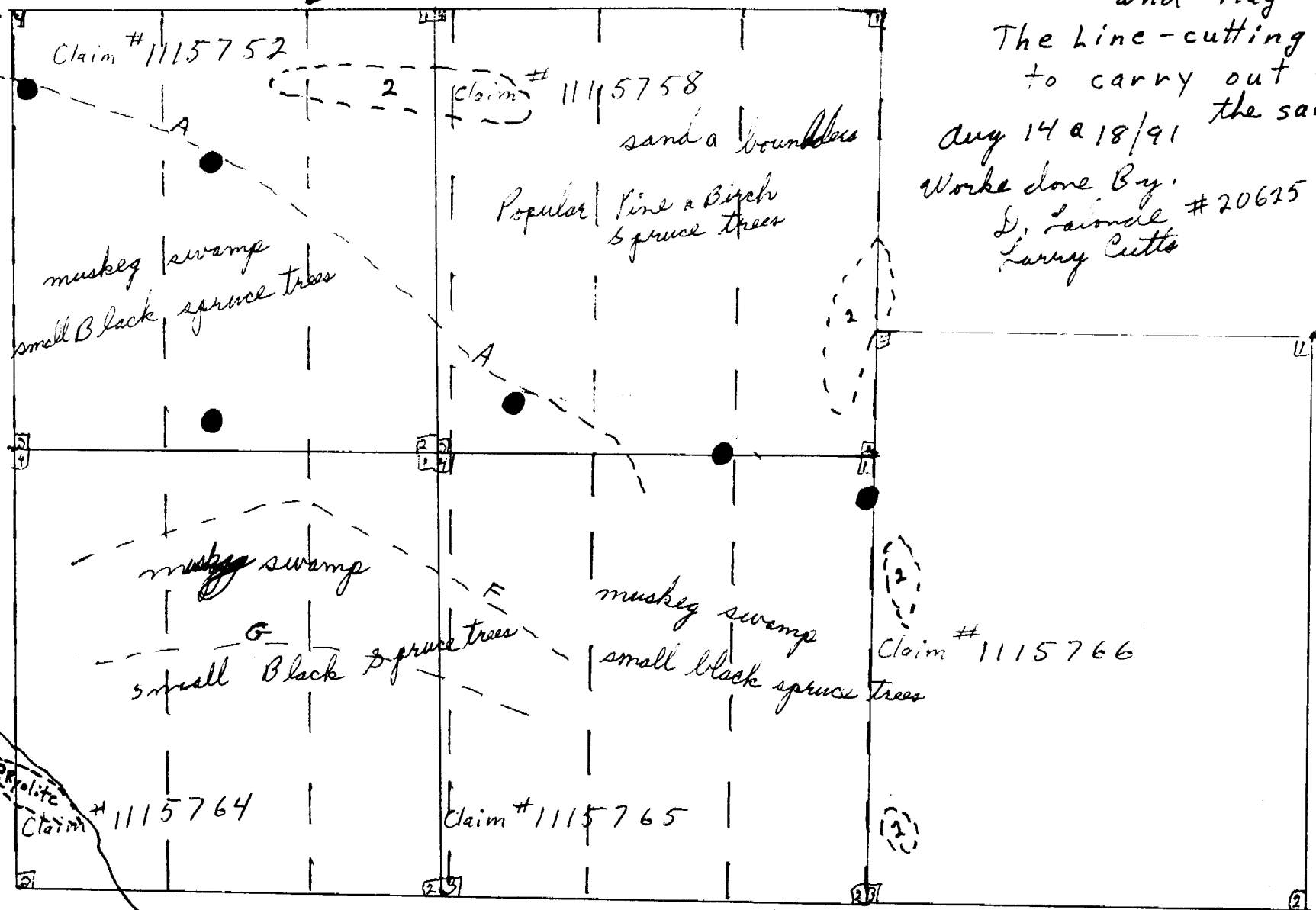

○ outcrop  
● Pelic Volcanic Rock & Rhyolite  
some pyrite

Work to be referred to the Mag a V.L.F. maps which was filed for assessment work on the Property.

● Airborne anomalies

--- V.L.F. conductors  
all V.L.F. conductors are covered by overburden.

1:5200



# Report of Work Conducted After Recording Claim

Mining Act

Transaction Number  
**W9260.00007**



42A05NW8525 2.14484 WHITESIDES

900

Personal information collected on this form is obtained under the authority of the Ministry. This collection should be directed to the Provincial Manager, Mining Lands, Ministry of Northern Development and Mines, Sudbury, Ontario, P3E 6A5, telephone (705) 870-7264.

- Instructions:**
- Please type or print and submit in duplicate.
  - Refer to the Mining Act and Regulations for requirements of filing assessment work or consult the Mining Recorder.
  - A separate copy of this form must be completed for each Work Group.
  - Technical reports and maps must accompany this form in duplicate.
  - A sketch, showing the claims the work is assigned to, must accompany this form.

|                                                       |                                    |                                  |
|-------------------------------------------------------|------------------------------------|----------------------------------|
| Recorded Holder(s)<br><i>Arlene Dea</i>               |                                    | Client No.<br><i>124643</i>      |
| Address<br><i>218 Polaris Rd Timmins Ont. P4N 4L4</i> |                                    | Telephone No.<br><i>264-5643</i> |
| Mining Division<br><i>Porcupine</i>                   | Township/Area<br><i>Whitesides</i> | M or G Plan No.                  |
| Date Work Performed                                   | From: <i>July 15/91</i>            | To: <i>Aug 18/91</i>             |

**Work Performed (Check One Work Group Only)**

| Work Group                        | Type                                                                   |
|-----------------------------------|------------------------------------------------------------------------|
| Geotechnical Survey               |                                                                        |
| Physical Work, including Drilling | <i>Prospecting &amp; checking mag &amp; V.L.F. airborne conductors</i> |
| Rehabilitation                    |                                                                        |
| Other Authorized Work             |                                                                        |
| Assays                            |                                                                        |
| Assignment from Reserve           |                                                                        |

Total Assessment Work Claimed on the Attached Statement of Costs \$ *900.00*

**Note:** The Minister may reject for assessment work credit all or part of the assessment work submitted if the recorded holder cannot verify expenditures claimed in the statement of costs within 30 days of a request for verification.

**Persons and Survey Company Who Performed the Work (Give Name and Address of Author of Report)**

| Name                       | Address |
|----------------------------|---------|
| <b>RECEIVED</b>            |         |
| <i>MAR 04 1992</i>         |         |
| <b>MINING LANDS BRANCH</b> |         |

**RECORDED**

**FEB 14 1992**

Receipt \_\_\_\_\_

(attach a schedule if necessary)

**Certification of Beneficial Interest \* See Note No. 1 on reverse side**

|                                                                                                                                                                                                          |                          |                                                           |
|----------------------------------------------------------------------------------------------------------------------------------------------------------------------------------------------------------|--------------------------|-----------------------------------------------------------|
| I certify that at the time the work was performed, the claims covered in this work report were recorded in the current holder's name or held under a beneficial interest by the current recorded holder. | Date<br><i>Feb 14/92</i> | Recorded Holder or Agent (Signature)<br><i>D. Lalonde</i> |
|----------------------------------------------------------------------------------------------------------------------------------------------------------------------------------------------------------|--------------------------|-----------------------------------------------------------|

**Certification of Work Report**

I certify that I have a personal knowledge of the facts set forth in this Work report, having performed the work or witnessed same during and/or after its completion and annexed report is true.

|                                                                                    |                          |                                               |
|------------------------------------------------------------------------------------|--------------------------|-----------------------------------------------|
| Name and Address of Person Certifying<br><i>Arlene Dea D. Lalonde Timmins Ont.</i> |                          |                                               |
| Telephone No.<br><i>264-5643</i>                                                   | Date<br><i>Feb 14/92</i> | Certified By (Signature)<br><i>D. Lalonde</i> |

**For Office Use Only**

|                                              |                                   |                                |                                                                                                                                                             |
|----------------------------------------------|-----------------------------------|--------------------------------|-------------------------------------------------------------------------------------------------------------------------------------------------------------|
| Total Value Cr. Recorded<br><i>\$ 900.00</i> | Date Recorded<br><i>FEB 14/92</i> | Mining Recorder<br><i>Whit</i> | <div style="border: 2px solid black; padding: 5px;"> <p><b>RECORDED</b></p> <p><b>FEB 14 1992</b></p> <p><i>@ 10:50 am</i></p> <p><i>counter</i></p> </div> |
| Deemed Approval Date<br><i>MAY 14/92</i>     | Date Approved                     |                                |                                                                                                                                                             |
| Date Notice for Amendments Sent              |                                   |                                |                                                                                                                                                             |





Statement of Costs for Assessment Credit

État des coûts aux fins du crédit d'évaluation

Mining Act/Loi sur les mines

Transaction No./N° de transaction  
**W7260.00007**

**4**

Personal information collected on this form is obtained under the authority of the Mining Act. This information will be used to maintain a record and ongoing status of the mining claim(s). Questions about this collection should be directed to the Provincial Manager, Minings Lands, Ministry of Northern Development and Mines, 4th Floor, 159 Cedar Street, Sudbury, Ontario P3E 6A5, telephone (705) 670-7264.

Les renseignements personnels contenus dans la présente formule ont été recueillis en vertu de la Loi sur les mines et serviront à tenir à jour un registre des concessions minières. Adresser toute question sur la collecte de ces renseignements au chef provincial des terrains miniers, ministère du Développement du Nord et des Mines, 159, rue Cedar, 4<sup>e</sup> étage, Sudbury (Ontario) P3E 6A5, téléphone (705) 670-7264.

1. Direct Costs/Coûts directs

| Type                                                                                                  | Description                                                                                                                                           | Amount<br>Montant | Totals<br>Total global |
|-------------------------------------------------------------------------------------------------------|-------------------------------------------------------------------------------------------------------------------------------------------------------|-------------------|------------------------|
| Wages<br>Salaires                                                                                     | Labour<br>Main-d'oeuvre                                                                                                                               |                   |                        |
|                                                                                                       | Field Supervision<br>Surveillance sur le terrain                                                                                                      |                   |                        |
| Contractor's<br>and Consultant's<br>Fees<br>Droits de<br>l'entrepreneur<br>et de l'expert-<br>conseil | Type <i>Prospect</i>                                                                                                                                  |                   |                        |
|                                                                                                       | <i>Cost of site, 1/2 hr<br/>for each site<br/>examined. 1/2 hr<br/>lines on cut to cut<br/>inspected after<br/>lines were cut using the<br/>sides</i> |                   | 900.00                 |
| Supplies Used<br>Fournitures<br>utilisées                                                             | Type                                                                                                                                                  |                   |                        |
| Equipment<br>Rental<br>Location de<br>matériel                                                        | Type                                                                                                                                                  |                   |                        |
| Total Direct Costs<br>Total des coûts directs                                                         |                                                                                                                                                       |                   | 900.00                 |

2. Indirect Costs/Coûts indirects

\*\* Note: When claiming Rehabilitation work Indirect costs are not allowable as assessment work.  
Pour le remboursement des travaux de réhabilitation, les coûts indirects ne sont pas admissibles en tant que travaux d'évaluation.

| Type                                                                                                                  | Description   | Amount<br>Montant                                                                                | Totals<br>Total global |
|-----------------------------------------------------------------------------------------------------------------------|---------------|--------------------------------------------------------------------------------------------------|------------------------|
| Transportation<br>Transport                                                                                           | Type          |                                                                                                  |                        |
|                                                                                                                       |               |                                                                                                  |                        |
|                                                                                                                       |               |                                                                                                  |                        |
|                                                                                                                       |               |                                                                                                  |                        |
| <b>RECORDED</b>                                                                                                       |               |                                                                                                  |                        |
| <b>FEB 14 1992</b>                                                                                                    |               |                                                                                                  |                        |
| Food and<br>Lodging<br>Nourriture et<br>hébergement                                                                   |               |                                                                                                  |                        |
| Mobilization and<br>Demobilization<br>Mobilisation et<br>démobilisation                                               | Receipt _____ |                                                                                                  |                        |
| Sub Total of Indirect Costs<br>Total partiel des coûts indirects                                                      |               |                                                                                                  |                        |
| Amount Allowable (not greater than 20% of Direct Costs)<br>Montant admissible (n'excédant pas 20 % des coûts directs) |               |                                                                                                  |                        |
| Total Value of Assessment Credit<br>(Total of Direct and Allowable<br>Indirect costs)                                 |               | Valeur totale du crédit<br>d'évaluation<br>(Total des coûts directs<br>et indirects admissibles) |                        |

Note: The recorded holder will be required to verify expenditures claimed in this statement of costs within 30 days of a request for verification. If verification is not made, the Minister may reject for assessment work all or part of the assessment work submitted.

Note: Le titulaire enregistré sera tenu de vérifier les dépenses demandées dans le présent état des coûts dans les 30 jours suivant une demande à cet effet. Si la vérification n'est pas effectuée, le ministre peut rejeter tout ou une partie des travaux d'évaluation présentés.

Filing Discounts

- Work filed within two years of completion is claimed at 100% of the above Total Value of Assessment Credit.
- Work filed three, four or five years after completion is claimed at 50% of the above Total Value of Assessment Credit. See calculations below:

|                                  |                          |
|----------------------------------|--------------------------|
| Total Value of Assessment Credit | Total Assessment Claimed |
| <i>900.00</i>                    | <i>900.00</i>            |
| $\times 0,50 =$                  |                          |

Remises pour dépôt

- Les travaux déposés dans les deux ans suivant leur achèvement sont remboursés à 100 % de la valeur totale susmentionnée du crédit d'évaluation.
- Les travaux déposés trois, quatre ou cinq ans après leur achèvement sont remboursés à 50 % de la valeur totale du crédit d'évaluation susmentionné. Voir les calculs ci-dessous.

|                                      |                            |
|--------------------------------------|----------------------------|
| Valeur totale du crédit d'évaluation | Evaluation totale demandée |
| <i>900.00</i>                        | <i>900.00</i>              |
| $\times 0,50 =$                      |                            |

Certification Verifying Statement of Costs

I hereby certify:  
that the amounts shown are as accurate as possible and these costs were incurred while conducting assessment work on the lands shown on the accompanying Report of Work form.

that as *D. Lalonde* I am authorized  
(Recorded Holder, Agent, Position in Company)

to make this certification

Attestation de l'état des coûts

J'atteste par la présente :  
que les montants indiqués sont le plus exact possible et que ces dépenses ont été engagées pour effectuer les travaux d'évaluation sur les terrains indiqués dans la formule de rapport de travail ci-joint.

Et qu'à titre de \_\_\_\_\_ je suis autorisé  
(titulaire enregistré, représentant, poste occupé dans la compagnie)

à faire cette attestation.

Signature *D. Lalonde* Date *Feb 14/92*



Ministry of  
Northern Development  
and Mines

Ministère du  
Développement du Nord  
et des Mines

Mining Lands Branch  
Geoscience Approvals Section  
159 Cedar Street, 4th Floor  
Sudbury, Ontario  
P3E 6A5

Telephone: (705) 670-7264  
Fax: (705) 670-7262

May 13, 1992

Our File: 2.14484  
Transaction #W9260.0007

Mining Recorder  
Ministry of Northern Development  
and Mines  
60 Wilson Avenue  
Timmins, Ontario  
Postal Code

Dear Sir/Madam:

Subject: APPROVAL OF ASSESSMENT WORK SUBMITTED ON MINING CLAIMS  
P1115752 ET AL. IN WHITESIDES TOWNSHIP

---

The assessment work credits for the Prospecting work, Section 9 of the Mining Act Regulations have been approved as of May 11, 1992.

The attached Assessment Work Credit Form outlines the value of work done on the claims and the credits assigned to them.

Please indicate this approval on your records.

Yours Sincerely,

Ron C. Gashinski  
Senior Manager, Mining Lands  
Mines and Minerals Division

fj/jl  
Enclosures:

cc: Resident Geologist  
Timmins, Ontario

Assessment Files Office  
Toronto, Ontario

ASSESSMENT WORK CREDIT FORM

FILE NUMBER: 2.14484  
DATE: May 13, 1992  
RECORDER'S REPORT NUMBER: W9260.00007

RECORDED HOLDER: Arlene Dea  
CLIENT NUMBER: 124643  
TOWNSHIP OR AREA: Whitesides

| CLAIM NO. | VALUE OF WORK<br>DONE ON CLAIM | VALUE APPLIED<br>TO THIS CLAIM | VALUE ASSIGNED<br>FROM THIS CLAIM |
|-----------|--------------------------------|--------------------------------|-----------------------------------|
| P1115752  | \$200                          | 0                              | \$200                             |
| 1115758   | 200                            | 0                              | 200                               |
| 1115764   | 200                            | 250                            | 0                                 |
| 1115765   | 0                              | 350                            | 0                                 |
| 1115766   | 0                              | 0                              | 0                                 |