



42A055E0204 15 KEEFER

010

DIAMOND DRILLING

TOWNSHIP: KEEFER

REPORT NO: 15

WORK PERFORMED FOR: Keefer Lake REsources Inc.

RECORDED HOLDER: Same as Above [xx]
: Other []

<u>Claim No.</u>	<u>Hole No.</u>	<u>Footage</u>	<u>Date</u>	<u>Note</u>
P 947865	KR-87-09	106'	Nov/87	(1)(2)

Notes: (1) #W8806.193, filed in Nov/88

(2) Similar diamond drilling log and cross-section added to this file Sept/89 from OMEP submittal #0187-S-I-110

LOCATION P-947865

Northing: 20+00 S Collar -50S
Easting: 24+00 E - 106 ft -50
Azimuth: N 177 E

KEEFER LAKE RESOURCES

Drilled by: Dominik Diamond Drilling
Core Size: BQ Length: 106 Feet
Date: November 27, 1987

HOLE No. KR 87-09

Page 1 of 1
Logged by: Kian A. Jensen
Date: December 1, 1987

Footage	Description	To	From	Sample	Au (opt)
0.0 - 14.0	Overburden - casing				No samples were taken from this hole
14.0 - 106.0	GABBRO				
	- coarse grained, pyroxene phenocrysts ranging from 1/8" to 3/8", massive, uniform, black green with local medium to dark green, fine grained light to medium green matrix, slightly to strongly magnetic with local visible magnetite grains, local pinkish to cream coloured carbonate intergranular material, trace to scattered sulphides				
	- 15.3 to 19.5 lathe shaped pyroxene phenocrysts, fine to medium grained				
	- 36.0 minor grinding				
	- 38.5 increasing whitish carbonate intergranular material 2% to 5%				
	- 38.8 to 39.2 pinkish carbonate veinlet CA=34, scattered 1/16" euhedral pyrite <0.5%				
	- 41.2 scattered fine grained pyrite <1%				
	- 55.0 to 66.0 5 feet ground core				
	- 56.5 decreasing amount of large phenocrysts to 20%				
	- 65.5 to 66.0 high epidote content				
	- 66.0 to 76.0 3 feet ground core				
	- 83.0 to 106.0 fine to medium grained, medium green, locally scattered phenocrysts				
	- 85.5 1/8" carbonate quartz stringer CA=30, minor reddish brown hematite alteration for 1/8" on both sides of stringer				
	- 85.5 to 86.0 1/8" feldspar phenocrysts				
	- 92.0 to 96.0 ground core				
	- 96.0 to 98.0 scattered feldspar phenocrysts in fine grained uniform groundmass				
	- 98.0 to 98.05 medium grained pyroxene phenocrysts with pinkish intergranular material with 1% pyrite and associated epidote				
	- 99.0 to 99.4 50% pink carbonate intergranular material with 1/2" lathe pyroxene, <0.5% epidote				

106.0

END OF HOLE - PORCUPINE MINING DIVISION

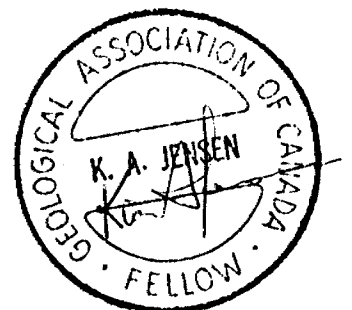
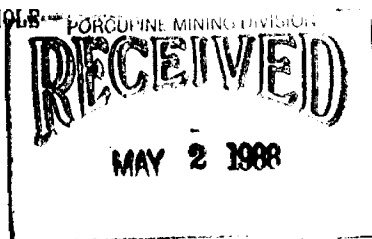

AZM N 177° E

KR 87-09

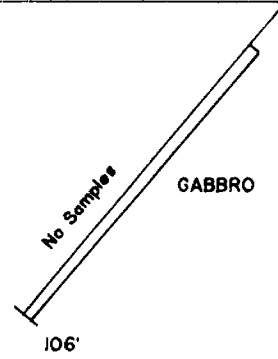

GRID 20+00 SOUTH, LINE 28+00 EAST

SCALE: 1 INCH = 50 FEET

0.014/5' Au(opt)/Foot

KEEFER LAKE RESOURCES INC.

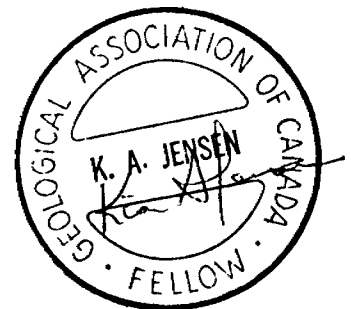

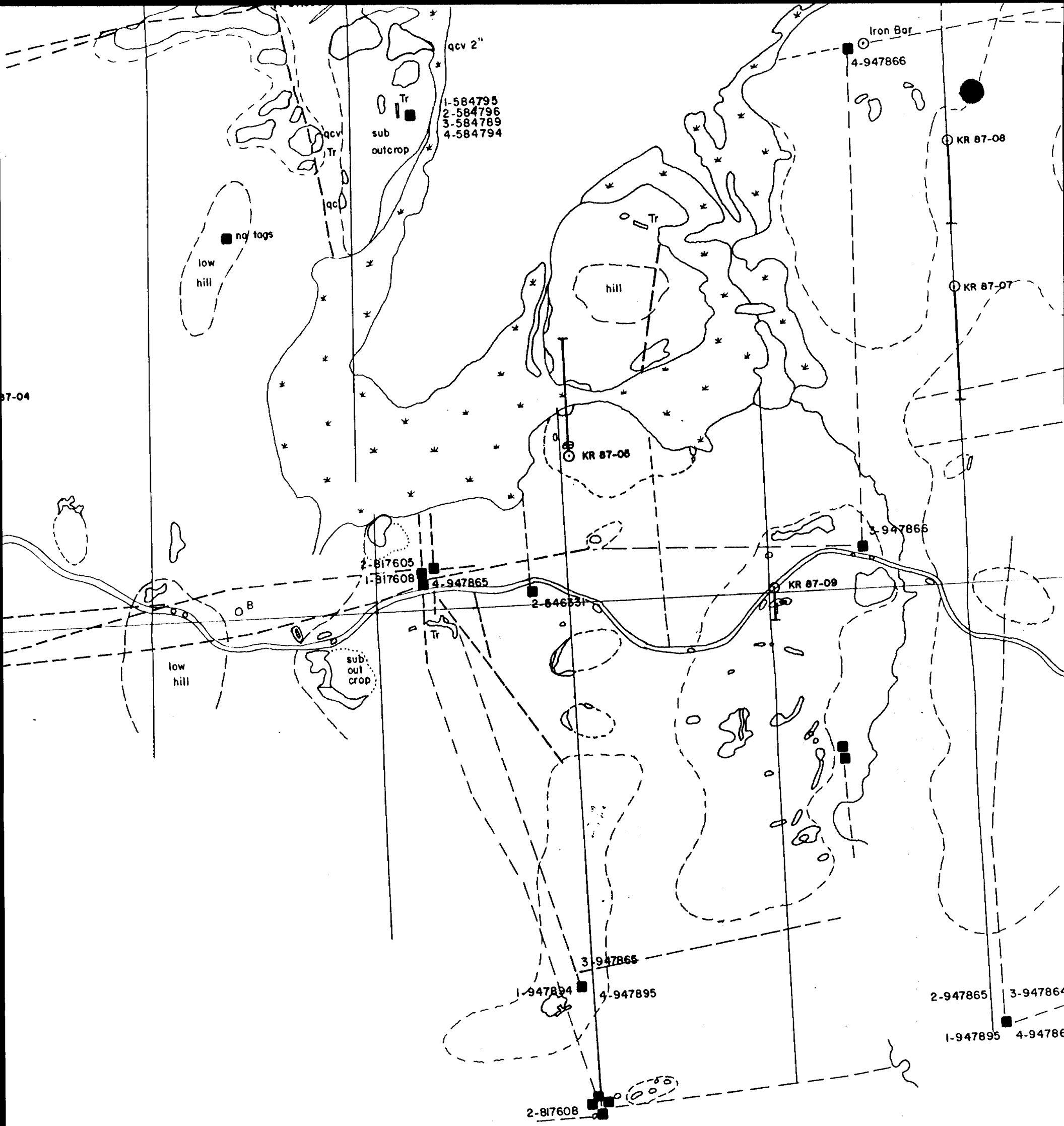

*See file related to
W2806-086*

LOCATION PLAN

**KEEFER LAKE
INCORPORATED**

KEEFER
PORCUPINE MINING

ND GRAVEL

NOTICE

of the WAFFERBOARD AGREEMENT

Plan, on file in The

shows the area to be

Further information may

Unit Forester

Resources

Timmins Ont.

62

Sewell Twp.

Frey Twp.

Hillary Twp.

Denton Twp.

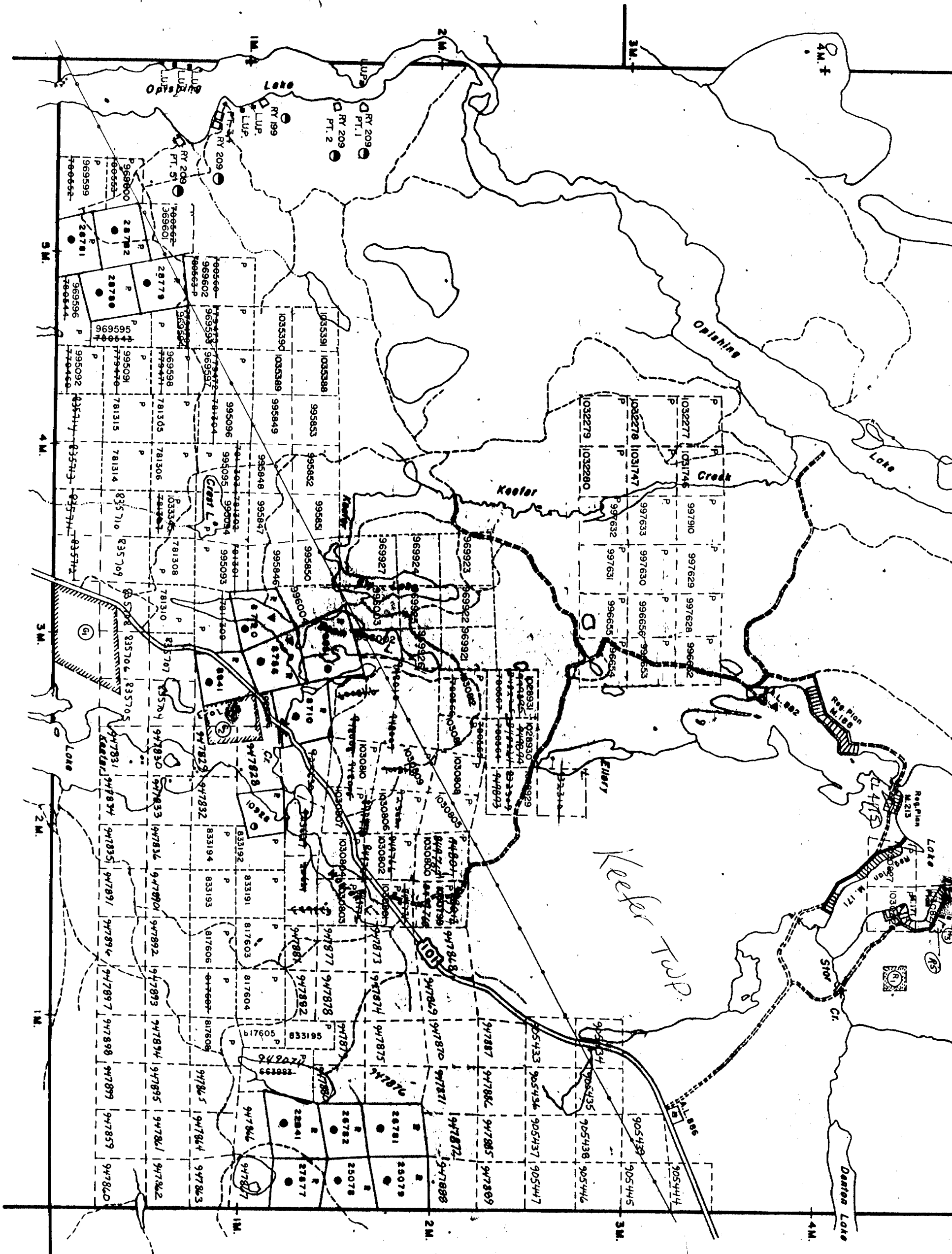

LOCATION P-947865

Northing: 20+00 S Collar -50S
Easting: 24+00 E - 106 ft -50
Azimuth: N 177 E

KEEFER LAKE RESOURCES

Drilled by: Dominik Diamond Drilling
Core Size: BQ Length: 106 Feet
Date: November 27, 1987

HOLE No. KR 87-09

Page 1 of 1
Logged by: Kian A. Jensen
Date: December 1, 1987

Footage	Description	To	From	Sample	Au (opt)
0.0 - 14.0	Overburden - casing				No samples were taken from this hole
14.0 - 106.0	GABBRO				
	- coarse grained, pyroxene phenocrysts ranging from 1/8" to 3/8", massive, uniform, black green with local medium to dark green, fine grained light to medium green matrix, slightly to strongly magnetic with local visible magnetite grains, local pinkish to cream coloured carbonate intergranular material, trace to scattered sulphides				
	- 15.3 to 19.5 lathe shaped pyroxene phenocrysts, fine to medium grained				
	- 36.0 minor grinding				
	- 38.5 increasing whitish carbonate intergranular material 2% to 5%				
	- 38.8 to 39.2 pinkish carbonate veinlet CA=34, scattered 1/16" euhedral pyrite <0.5%				
	- 41.2 scattered fine grained pyrite <1%				
	- 55.0 to 66.0 5 feet ground core				
	- 56.5 decreasing amount of large phenocrysts to 20%				
	- 65.5 to 66.0 high epidote content				
	- 66.0 to 76.0 3 feet ground core				
	- 83.0 to 106.0 fine to medium grained, medium green, locally scattered phenocrysts				
	- 85.5 1/8" carbonate quartz stringer CA=30, minor reddish brown hematite alteration for 1/8" on both sides of stringer				
	- 85.5 to 86.0 1/8" feldspar phenocrysts				
	- 92.0 to 96.0 ground core				
	- 96.0 to 98.0 scattered feldspar phenocrysts in fine grained uniform groundmass				
	- 98.0 to 98.05 medium grained pyroxene phenocrysts with pinkish intergranular material with 1% pyrite and associated epidote				
	- 99.0 to 99.4 50% pink carbonate intergranular material with 1/2" lathe pyroxene, <0.5% epidote				
106.0	END OF HOLE				

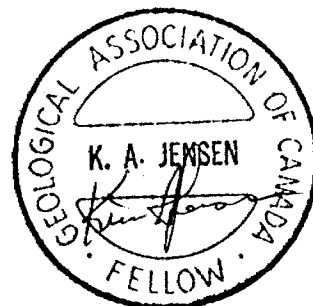

AZM N 177° E

KR 87-09

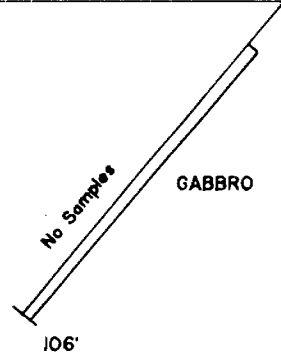

GRID 20+00 SOUTH, LINE 28+00 EAST

SCALE: 1 INCH = 50 FEET

0.014/5' Au(opt)/Feet

KEEPER LAKE RESOURCES INC.

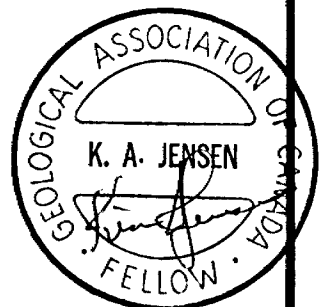



Name and Postal Address of Recorded Holder

Mining

KEEFER LAKE RESOURCES INC.

160 KINGCROSS DRIVE, BOX 72 KING CITY, ONTARIO L0G 1K0

Summary of Work Performance and Distribution of Credits

Total Work Days Cr. claimed 106 DAYS	Mining Claim		Work Days Cr.	Mining Claim		Work Days Cr.	Mining Claim		Work Days Cr.
	Prefix	Number		Prefix	Number		Prefix	Number	
for Performance of the following work. (Check one only) <input type="checkbox"/> Manual Work <input type="checkbox"/> Shaft Sinking Drifting or other Lateral Work. <input type="checkbox"/> Compressed Air, other Power driven or mechanical equip. <input type="checkbox"/> Power Stripping <input checked="" type="checkbox"/> Diamond or other Core drilling <input type="checkbox"/> Land Survey	P	817603	13						
		817606	28						
		817608	8						
		833191	13						
		833192	13						
		833193	13						
		833194	13						
	947867	5							

All the work was performed on Mining Claim(s): P-947865

Required Information eg: type of equipment, Names, Addresses, etc. (See Table Below)

DOMINIK Diamond Drilling, 409 KING STREET, PORCUPINE, ONT.

CORE SIZE: 8Q

HOLE KR-87-09 106.0 FEET NOV. 27 /87

Total 106.0 Feet.

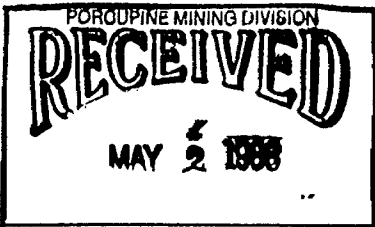
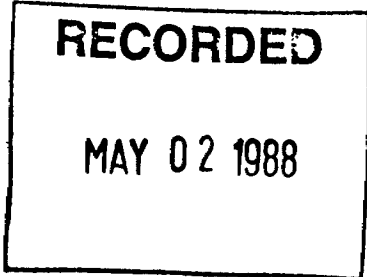
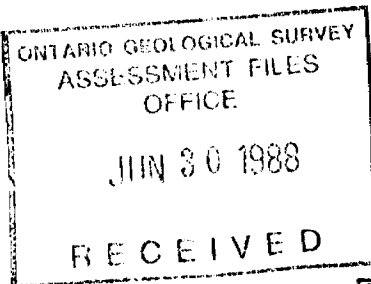

Date of Report: May 2, 1988
Recorded Holder or Agent (Signature): Kian Jensen

Certification Verifying Report of Work

I hereby certify that I have a personal and intimate knowledge of the facts set forth in the Report of Work annexed hereto, having performed the work or witnessed same during and/or after its completion and the annexed report is true.

Name and Postal Address of Person Certifying

KIAN A. JENSEN, P.O. BOX 37, SOUTH PORCUPINE

ONTARIO PON 1H0

Date Certified: May 2, 1988
Certified by (Signature): Kian Jensen

Table of Information/Attachments Required by the Mining Recorder

Type of Work	Specific Information per type	Other information (Common to 2 or more types)	Attachments
Manual Work	Nil	Names and addresses of men who performed manual work / operated equipment, together with dates and hours of employment.	Work Sketch: these are required to show the location and extent of work in relation to the nearest claim post.
Shaft Sinking, Drifting or other Lateral Work			
Compressed air, other power driven or mechanical equip.	Type of equipment	Names and addresses of owner or operator together with dates when drilling/stripping done.	
Power Stripping	Type of equipment and amount expended. Note: Proof of actual cost must be submitted within 30 days of recording.		
Diamond or other core drilling	Signed core log showing; footage, diameter of core, number and angles of holes.	Nil	Work Sketch (as above) in duplicate
Land Survey	Name and address of Ontario land surveyor.		Nil