



BELL-WHITE ANALYTICAL LAB

P.O. Box 187, 374 Browning St., Halleybury  
(705) 672-3107



42A05SE0205 2.11547 KEEFER

010

*Keefe Lake Re  
87-032  
Drilling*

*for a 10*

NO: 31315  
DATE: 11-20-87  
PAGE: 1 of 1

SOLD TO:

SHIP TO:

Kian Jensen Exploration  
P.O. Box 37  
South Porcupine, Ontario  
P0N 1H0

Same

ITEM NO.	QUANTITY	UNIT	DESCRIPTION	UNIT PRICE	AMOUNT
3789	8	1	Project: #87-027	8.50	68.00
	8	1	Au Sample Preparations	2.50	20.00
COMMENTS: Net 30 Days.				TOTAL	88.00

*242-463  
11/22/87*

KIAN A. JENSEN  
HOLLINGER BUILDING, SUITE 11  
TIMMINS, ONTARIO

0789

*Nov 25 1987*

PAY TO THE ORDER OF

*Bell White Analytical Laboratories Ltd \$ 88.00*

*Eighty Eight*

DOLLARS  
100

KIAN A. JENSEN

CANADA TRUSTCO MORTGAGE COMPANY  
194 THIRD AVE.  
TIMMINS, ONTARIO

PER

*Kian Jensen*

*Re: # 31315*

000789 1146205090

503941020

*for \$,000000088000*

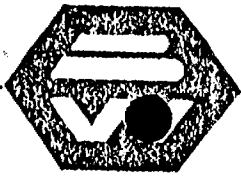

# BELL-WHITE ANALYTICAL LABORATORIES LTD.

P.O. BOX 187.

HAILEYBURY, ONTARIO

TEL: 672-3107

## Certificate of Analysis

NO. 3789 (Corrected)

DATE: November 30, 1987

SAMPLE(S) OF: Rock (8)

RECEIVED: November 1987

SAMPLE(S) FROM: Mr. Kian Jensen, Kian Jensen Exploration and Consulting Services

Sample No.

Oz. Gold

148519

Trace

148520

Trace

1

Trace

2

Trace

3

Trace

4

Trace

5

Trace

6

Trace

IN ACCORDANCE WITH LONG ESTABLISHED NORTH AMERICAN CUSTOM UNLESS IT IS SPECIFICALLY STATED OTHERWISE GOLD AND SILVER VALUES REPORTED ON THESE SHEETS HAVE NOT BEEN ADJUSTED TO COMPENSATE FOR LOSSES AND GAINS INCURRED IN THE FIRE ASSAY PROCESS.

BELL-WHITE ANALYTICAL LABORATORIES LTD.

PER 



# BELL - WHITE ANALYTICAL LABORATORIES LTD.

P.O. Box 187, 374 Browning St., Halleybury, Ontario POJ 1K0  
(705) 672-3107

*Dilling 87-032*

## INVOICE

NO: 31396

DATE: 11-30-87

PAGE: 1 of 1

SOLD TO:

SHIP TO:

Kian Jensen Exploration  
P.O. Box 37  
South Porcupine, Ontario  
P0N 1H0

Same

ITEM NO.	QUANTITY	UNIT	DESCRIPTION	UNIT PRICE	AMOUNT
3864	30	1	Au	8.50	255.00
	30	1	Sample Preparations	2.50	75.00
				TOTAL	330.00

*Paid  
Dec 11/87  
#809.*

COMMENTS:  
Net 30 Days.

KIAN A. JENSEN  
HOLLINGER BUILDING, SUITE 11  
TIMMINS, ONTARIO

0809

*Dec 11 19 87*

PAY TO THE ORDER OF

*Bell White Analytical Lab*

\$ 429.00

*Four Hundred and Twenty Nine*

DOLLARS  
100

KIAN A. JENSEN

CANADA TRUSTCO MORTGAGE COMPANY  
194 THIRD AVE.  
TIMMINS, ONTARIO

PER

*Kian Jensen*

*Re: 87-027*

000809 11462 5091

50394 1 211

0000042900



# BELL - WHITE ANALYTICAL LABORATORIES LTD.

P.O. BOX 187,

HAILEYBURY, ONTARIO

TEL: 672-3107

## Certificate of Analysis

NO. 3864

DATE: November 30, 1987

SAMPLE(S) OF: Core (30)

RECEIVED: November 1987

SAMPLE(S) FROM: Mr. Kian Jensen, Kian Jensen Exploration and Consulting Services

<u>Sample No.</u>	<u>Oz. Gold</u>
148501	Trace
2	Trace
3	0.002*
4	0.002*
5	0.004
6	0.014
7	Trace
8	Trace
9	Trace
148510	Trace
1	Trace
2	Trace
3	Trace
4	0.002
5	Trace
6	Trace
7	Trace
8	Trace
148527	Trace
8	Trace
9	Trace
148530	Trace
1	Trace
2	Trace
3	Trace
4	Trace
5	Trace
6	Trace
7	Trace
8	Trace

\* Estimated

IN ACCORDANCE WITH LONG ESTABLISHED NORTH AMERICAN CUSTOM, UNLESS IT IS SPECIFICALLY STATED OTHERWISE GOLD AND SILVER VALUES REPORTED ON THESE SMELTS HAVE NOT BEEN ADJUSTED TO COMPENSATE FOR LOSSES AND GAINS INHERENT IN THE FIRE ASSAY PROCESS.

BELL-WHITE ANALYTICAL LABORATORIES LTD.

PER 



# BELL-WHITE ANALYTICAL LABORATORIES LTD.

P.O. Box 187, 374 Browning St., Haileybury, Ontario P0J 1K0  
(705) 672-3107

Dilling 87-032

## INVOICE

NO: 31393

DATE: 11-30-87

PAGE: 1 of 1

SOLD TO:

SHIP TO:

Kian Jensen Exploration  
P.O. Box 37  
South Porcupine, Ontario  
P0N 1H0

Same

ITEM NO.	QUANTITY	UNIT	DESCRIPTION	UNIT PRICE	AMOUNT
3868	6	1	Au	8.50	51.00
	6	1	Sample Preparations	2.50	15.00
<i>Paid Dec 11/87 # 809</i>					
COMMENTS: Net 30 Days.				TOTAL	66.00



# BELL - WHITE ANALYTICAL LABORATORIES LTD.

P.O. BOX 187.

HAILEYBURY, ONTARIO

TEL: 672-3107

## Certificate of Analysis

NO. 3868

DATE: November 30, 1987

SAMPLE(S) OF: Core (6)

RECEIVED: November 1987

SAMPLE(S) FROM: Mr. Kian Jensen, Kian A. Jensen Exploration and Consulting Services

<u>Sample No.</u>	<u>Oz. Gold</u>
148339	Trace
148540	Trace
1	Trace
2	Trace
3	Trace
4	Trace

IN ACCORDANCE WITH LONG ESTABLISHED NORTH AMERICAN CUSTOM, UNLESS IT IS SPECIFICALLY STATED OTHERWISE, GOLD AND SILVER VALUES REPORTED ON THESE SHEETS HAVE NOT BEEN ADJUSTED TO COMPENSATE FOR LOSSES AND GAINS INCURRED IN THE FIRE ASSAY PROCESS.

BELL-WHITE ANALYTICAL LABORATORIES LTD.

PER 



# BELL-WHITE ANALYTICAL LABORATORIES LTD.

P.O. Box 187, 374 Browning St., Haileybury, Ontario P0J 1K0  
(705) 672-3107

*Paid Jan 11/87  
# 844*

*Dilling 87-027  
87-032*

## INVOICE

NO: 31757

DATE: 01-07-88

PAGE: 1 of 1

SOLD TO:

SHIP TO:

Kian Jensen Exploration  
P.O. Box 37  
South Porcupine, Ontario  
P0N 1H0

Same

87-032

ITEM NO.	QUANTITY	UNIT	DESCRIPTION	UNIT PRICE	AMOUNT
0159	34	1	Au	8.50	289.00
	34	1	Sample Preparations	2.50	85.00
				<b>TOTAL</b>	<b>374.00</b>

COMMENTS:  
Net 30 Days.

KIAN A. JENSEN  
HOLLINGER BUILDING, SUITE 11  
TIMMINS, ONTARIO

0844

*Jan 11 1988*

PAY TO THE ORDER OF Bell White Analytical Lab \$ 374.00  
Three Hundred and Seventy Four DOLLARS

KIAN A. JENSEN

CANADA TRUSTCO MORTGAGE COMPANY  
194 THIRD AVE.  
TIMMINS, ONTARIO

PER Kian Jensen

*Re: 87-032*

⑈000844⑈ ⑆11462⑈509⑆ 503941⑈2⑈ ⑆0000037400⑈



# BELL - WHITE ANALYTICAL LABORATORIES LTD.

P.O. BOX 187,

HAILEYBURY, ONTARIO

TEL: 672-3107

## Certificate of Analysis

NO. 0159

DATE: January 7, 1988

SAMPLE(S) OF: Core (34)

RECEIVED: January 1988

SAMPLE(S) FROM: Mr. Kian Jensen, Kian Jensen Exploration Ltd.

<u>Sample No.</u>	<u>Oz. Gold</u>
124461	Trace
2	Trace
3	Trace
4	Trace
5	Trace
6	Trace
7	Trace
8	Trace
9	Trace
124470	Trace
1	Trace
2	Trace
3	Trace
4	Trace
5	Trace
6	Trace
7	Trace
8	Trace
9	Trace
124480	Trace
1	Trace
2	Trace
3	Trace
4	Trace
5	Trace
6	Trace
7	Trace
8	Trace
9	Trace
124490	0.002*
1	0.002*
2	Trace
148545	Trace
6	Trace

\* Estimated

IN ACCORDANCE WITH LONG-ESTABLISHED NORTH AMERICAN CUSTOM, UNLESS IT IS SPECIFICALLY STATED OTHERWISE GOLD AND SILVER VALUES REPORTED ON THESE SHEETS HAVE NOT BEEN ADJUSTED TO COMPENSATE FOR LOSSES AND GAINS INHERENT IN THE FIRE ASSAY PROCESS.

BELL-WHITE ANALYTICAL LABORATORIES LTD.

PER





**Kian A. Jens**



**Exploration and Consulting Services**

P.O. BOX 37, SOUTH PORCUPINE, ONTARIO, P0N 1H0

TELEPHONE: OFFICE (705) 268-0111, RESIDENCE (705) 235-2301

900

August 24, 1988

**RECEIVED**

AUG 26 1988

**MINING LANDS SECTION**

Mr W. R. Cowan, Manager,  
Mining Lands Section,  
Mines and Mineral Branch,  
Room 6610, Whitney Block,  
Queen's Park,  
Toronto, Ontario  
M7A 1W3

Dear Mr. Cowan:

I am enclosing 2 copies of the invoices, assay certificates and cancelled cheques for the assaying charges incurred in the diamond drilling program.

I have previously filled the drill logs with the sample numbers and assay values.

Trusting this meets with your satisfaction, I remain,

Yours truly,

Kian A. Jensen

DOCUMENT No.  
W 8806-50062

Instructions: -- Please type or print.  
-- If number of mining claims traversed exceeds space on this form, attach a list.  
Note: -- Only days credits calculated in the "Expenditures" section may be entered in the "Expend. Days Cr." columns.  
-- Do not use shaded areas below.

2.11547

Mining Act

Type of Survey(s) <b>GEOCHEMICAL ASSAYS</b>	Township or Area <b>KEEFER TWP</b>
Claim Holder(s) <b>KEEFER LAKE RESOURCES INC.</b>	Prospector's Licence No. <b>T-5010</b>
Address <b>P.O. BOX 72, 160 KING CROSS DRIVE, KING CITY, ONTARIO LOG 1K0</b>	
Survey Company	Date of Survey (from & to) <b>30 11 87 07 01 88</b> Day   Mo.   Yr.   Day   Mo.   Yr.
Name and Address of Author (of Geo-Technical report) <b>KIAN A. JENSEN, P.O. BOX 37, SOUTH PORCUPINE, ONTARIO PON 1H0</b>	

Credits Requested per Each Claim in Columns at right Mining Claims Traversed (List in numerical sequence)

Special Provisions	Geophysical	Days per Claim
For first survey: Enter 40 days. (This includes line cutting)	- Electromagnetic	
	- Magnetometer	
For each additional survey: using the same grid: Enter 20 days (for each)	- Radiometric	
	- Other	
	Geological	
	Geochemical	
Man Days	Geophysical	Days per Claim
Complete reverse side	- Electromagnetic	
	- Magnetometer	
	- Radiometric	
	- Other	
	Geological	
	Geochemical	
Airborne Credits	Electromagnetic	Days per Claim
Note: Special provisions credits do not apply to Airborne Surveys.	Magnetometer	
	Radiometric	

Mining Claim			Mining Claim		
Prefix	Number	Expend. Days Cr.	Prefix	Number	Expend. Days Cr.
P	947886	40			
	947871	17.2			

RECEIVED  
AUG 18 1988

RECORDED  
AUG 18 1988

RECEIVED  
OCT 24 1988  
MINING LANDS SECTION  
ONTARIO GEOLOGICAL SURVEY  
ASSESSMENT FILES  
OFFICE  
DEC 16 1988  
RECEIVED

Expenditures (excludes power stripping)

Type of Work Performed  
**Assaying of Drill Core.**

Performed on Claim(s)  
**P-947882, P-949074, P-817605, and P-947866**

Calculation of Expenditure Days Credits

Total Expenditures	Total Days Credits
\$ 858.00	57.2

Instructions  
Total Days Credits may be apportioned at the claim holder's choice. Enter number of days credits per claim selected in columns at right.

For Office Use Only

Total Days Cr. Recorded	Date Recorded	Mining Board
57.2	Aug 18/88	[Signature]
	Date Approved as Recorded	
	15/DEC 88	[Signature]

Total number of mining claims covered by this report of work. **2**

Date **Aug 18/88** Recorded Holder or Agent (Signature) **Kian Jensen.**

I hereby certify that I have a personal and intimate knowledge of the facts set forth in the Report of Work annexed hereto, having performed the work or witnessed same during and/or after its completion and the annexed report is true.

Name and Postal Address of Person Certifying  
**KIAN A. JENSEN, P.O. BOX 37, SOUTH PORCUPINE, ONT. PON 1H0**

Date Certified **Aug 18/88** Certified by (Signature) **Kian Jensen.**

Instructions: -- Please type or print.  
 -- If number of mining claims traversed exceeds space on this form, attach a list.  
 Note: -- Only days credits calculated in the "Expenditures" section may be entered in the "Expend. Days Cr." columns.  
 -- Do not use shaded areas below.

Mining Act

Type of Survey(s) **GEOCHEMICAL ASSAYS 2.1154** Township or Area **KEEFER TWP**  
 Claim Holder(s) **KEEFER LAKE RESOURCES INC.** Prospector's Licence No. **T-5010**  
 Address **P.O. BOX 72, 160 KING CROSS DRIVE, KING CITY, ONTARIO LOG 1K0**  
 Survey Company \_\_\_\_\_ Date of Survey (from & to) **30 11 87 07 01 88** Total Miles of line Cut \_\_\_\_\_  
 (Day | Mo. | Yr. | Day | Mo. | Yr.)  
 Name and Address of Author (of Geo-Technical report) **KIAN A. JENSEN, P.O. BOX 37, SOUTH PORCUPINE, ONTARIO PON 1H0**

Credits Requested per Each Claim in Columns at right

Special Provisions	Geophysical	Days per Claim
For first survey: Enter 40 days. (This includes line cutting)  For each additional survey using the same grid: Enter 20 days (for each)	- Electromagnetic	
	- Magnetometer	
	- Radiometric	
	- Other	
	Geological	
Man Days  Complete reverse side	Geophysical	Days per Claim
	- Electromagnetic	
	- Magnetometer	
	- Radiometric	
	- Other	
Geological		
Geochemical		
Airborne Credits  Note: Special provisions credits do not apply to Airborne Surveys.	Electromagnetic	Days per Claim
	Magnetometer	
	Radiometric	
	Geochemical	

Mining Claims Traversed (List in numerical sequence)

Prefix	Mining Claim		Expend. Days Cr.	Prefix	Mining Claim		Expend. Days Cr.
	Number	Number			Number	Number	
P	947886		40				
	947871		17.2				
(Remaining rows are shaded out)							

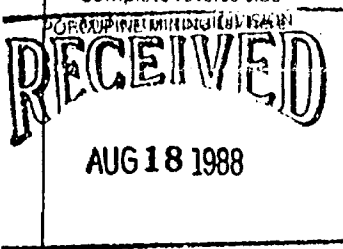

Expenditures (excludes power stripping)

Type of Work Performed **Assaying of Drill Core.**  
 Performed on Claim(s) **P-947882, P-949074, P-817605, and P-947866**  
 Calculation of Expenditure Days Credits  
 Total Expenditures  $\$ 858.00$   $\div$   $15 =$  Total Days Credits  $57.2$   
 Instructions: Total Days Credits may be apportioned at the claim holder's choice. Enter number of days credits per claim selected in columns at right.

Total number of mining claims covered by this report of work. **2**

For Office Use Only  
 Total Days Cr. Date Recorded \_\_\_\_\_ Mining Recorder \_\_\_\_\_  
 Recorded \_\_\_\_\_  
 Site Approved as Recorded \_\_\_\_\_ Branch Director \_\_\_\_\_

Date **Aug 18/88** Registered Holder or Agent Signature **Kian Jensen**

I hereby certify that I have read and understood the contents of this Report of Work and that it was prepared or witnessed during and/or after its completion and that it is a true and correct copy of the original.

REFERENCES

AREAS WITHDRAWN FROM DISPOSITION

- M.R.O. - MINING RIGHTS ONLY
- S.R.O. - SURFACE RIGHTS ONLY
- M.+S. - MINING AND SURFACE RIGHTS

Description	Order No.	Date	Disposition	File
(1) SEC. 43/70	W.26/77	11/3/77	S.R.O.	188543
(2) SEC. 42/60		FEB. 3/66	M.+S.	171506
(3) SEC. 42/60		7/10/66	M.+S.	149113
(4) DANA AND JOWBEY LAKES PARK RESERVE			S.R.O.	
SEC. 46/60	W. 26/77		M.R.O.	

(RS) DUMPING STATION

SAND AND GRAVEL

- (6) M.T.C. PIT 1593
- (7) GRAVEL FILE 44886

IMPORTANT NOTICE

This township forms part of the WAFERBOARD FOREST MANAGEMENT AGREEMENT

- The 1985/86 Annual Plan, on file in The

Mining Records Office shows the area to be affected in the next year

- If this plan affects you, further information may be obtained from:

Mr. Malcom Kilgour - Unit Forester  
 Ministry of Natural Resources  
 896 Riverside Drive, Timmins Ont.  
 Telephone: 267-7951  
 and/or

Mr. Pierre Corbeil  
 Waferboard Group  
 Telephone: 268-1462

Whitesides Twp.

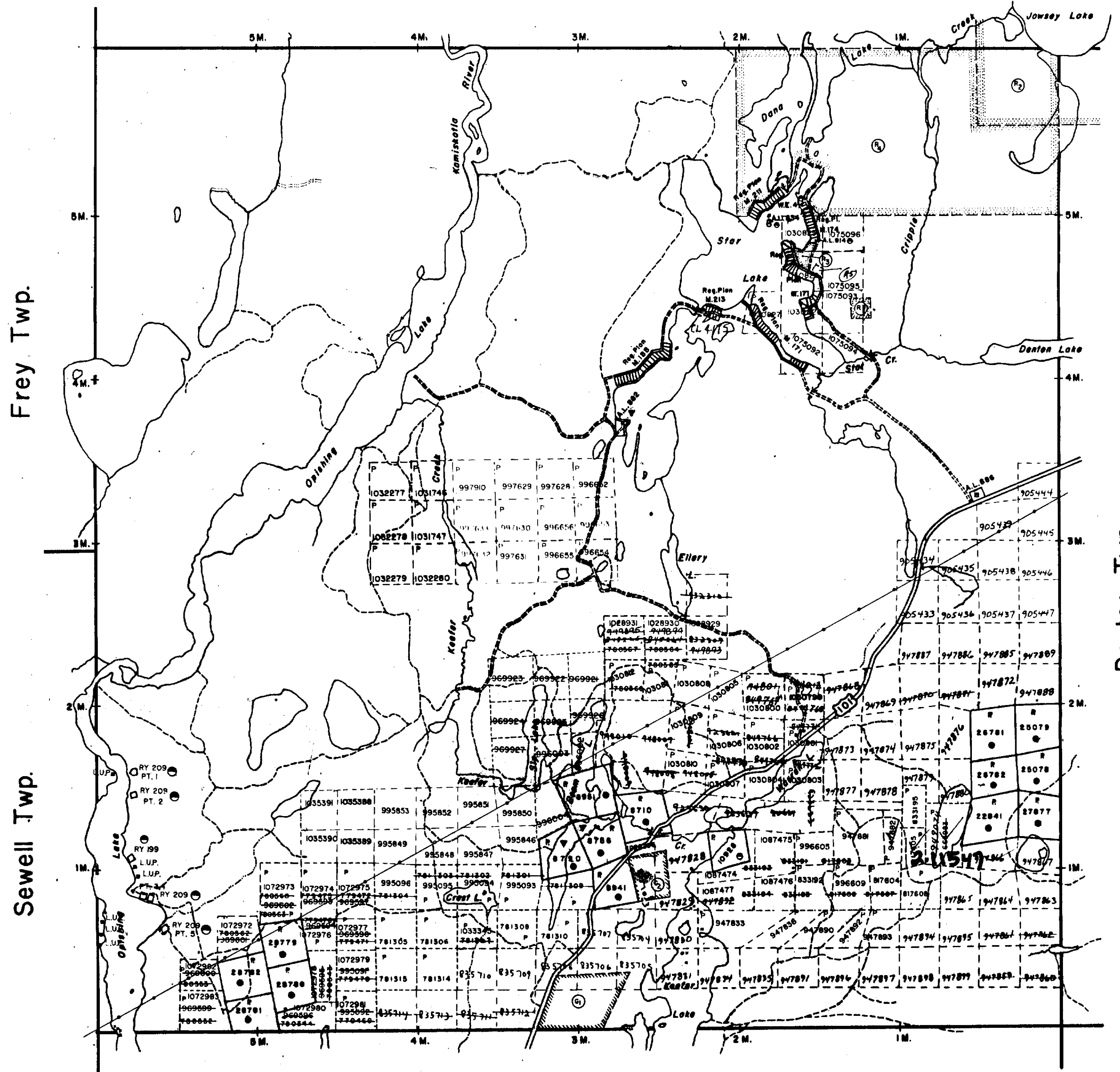

LEGEND

- HIGHWAY AND ROUTE No.
- OTHER ROADS
- TRAILS
- SURVEYED LINES:
  - TOWNSHIPS, BASE LINES, ETC.
  - LOTS, MINING CLAIMS, PARCELS, ETC.
- UNSURVEYED LINES:
  - LOT LINES
  - PARCEL BOUNDARY
  - MINING CLAIMS ETC.
- RAILWAY AND RIGHT OF WAY
- UTILITY LINES
- NON-PERENNIAL STREAM
- FLOODING OR FLOODING RIGHTS
- SUBDIVISION OR COMPOSITE PLAN
- RESERVATIONS
- ORIGINAL SHORELINE
- MARSH OR MUSKEG
- MINES
- TRAVERSE MONUMENT

DISPOSITION OF CROWN LANDS

TYPE OF DOCUMENT	SYMBOL
PATENT, SURFACE & MINING RIGHTS	
" SURFACE RIGHTS ONLY	
" MINING RIGHTS ONLY	
LEASE, SURFACE & MINING RIGHTS	
" SURFACE RIGHTS ONLY	
" MINING RIGHTS ONLY	
LICENCE OF OCCUPATION	
ORDER-IN-COUNCIL	
RESERVATION	
CANCELLED	
SAND & GRAVEL	
L.U.P. LAND USE PERMIT	

NOTE: MINING RIGHTS IN PARCELS PATENTED PRIOR TO MAY 6 1913, VESTED IN ORIGINAL PATENTEE BY THE PUBLIC LANDS ACT, R.S.O. 1970, CHAP. 380, SEC. 63, SUBSEC 1

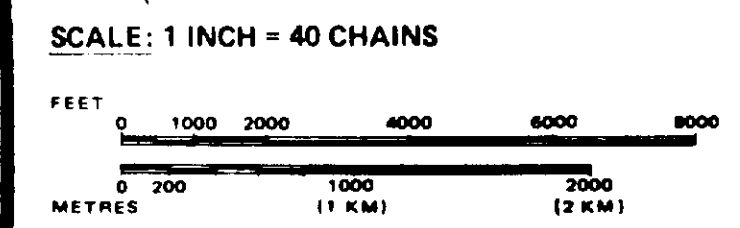

TOWNSHIP  
**KEEFER**  
 M.N.R. ADMINISTRATIVE DISTRICT  
**TIMMINS**  
 MINING DIVISION  
**PORCUPINE**  
 LAND TITLES / REGISTRY DIVISION  
**COCHRANE**

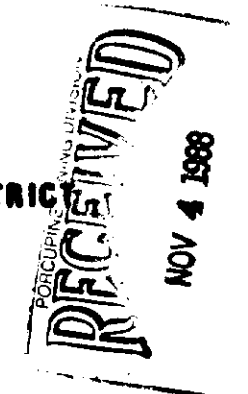

Ministry of Natural Resources  
 Land Management Branch  
 Ontario

Date MARCH, 1985  
 Number G-3237  
 Rec'd on file checked L.H.



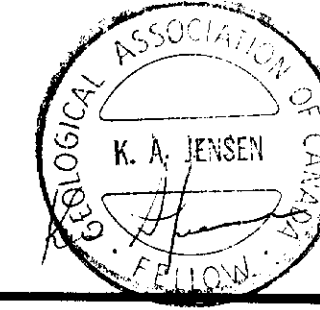
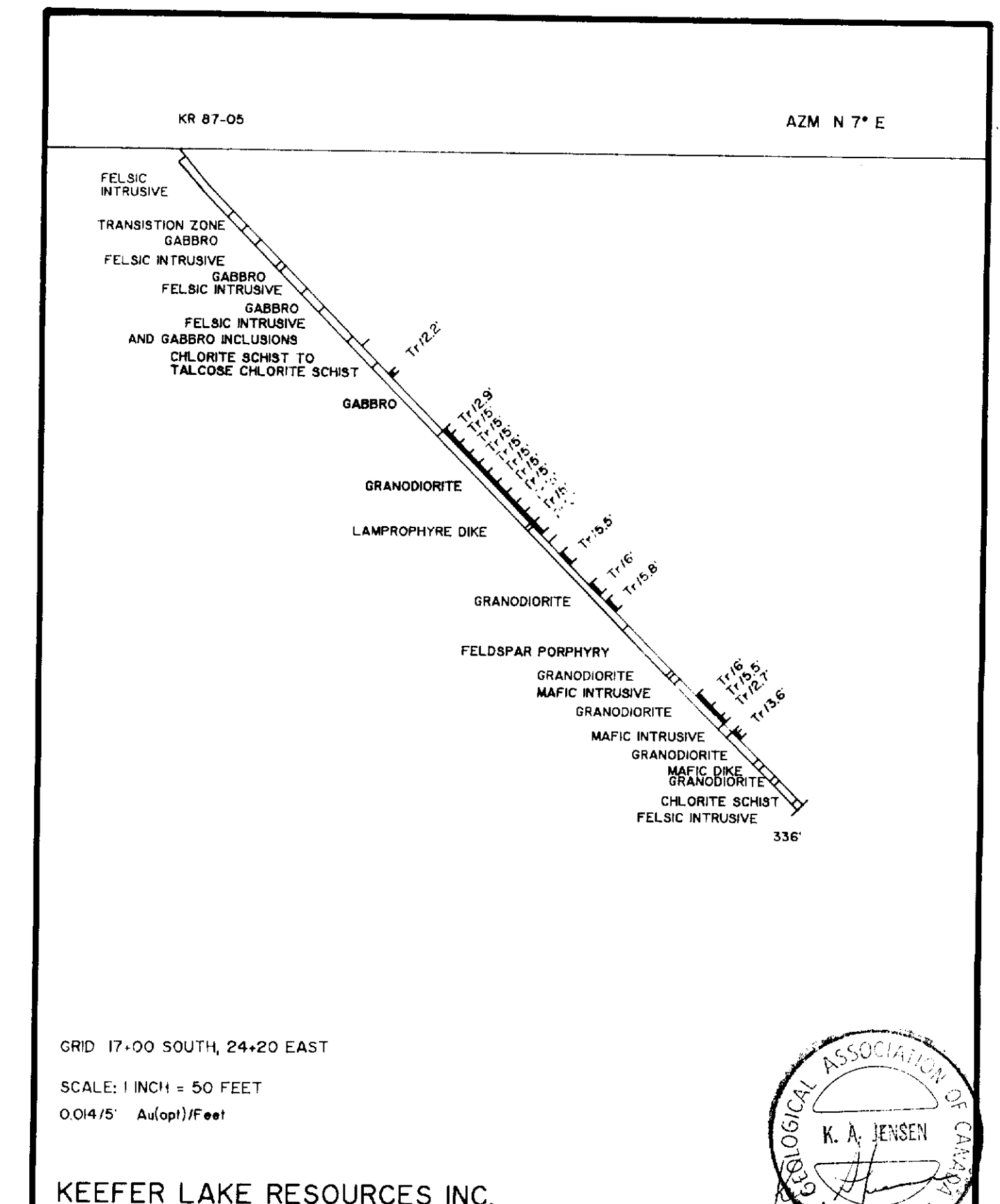
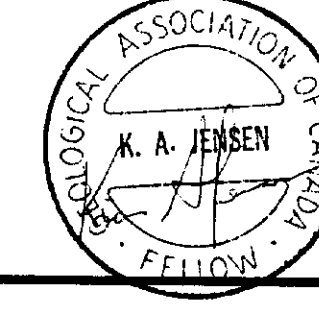
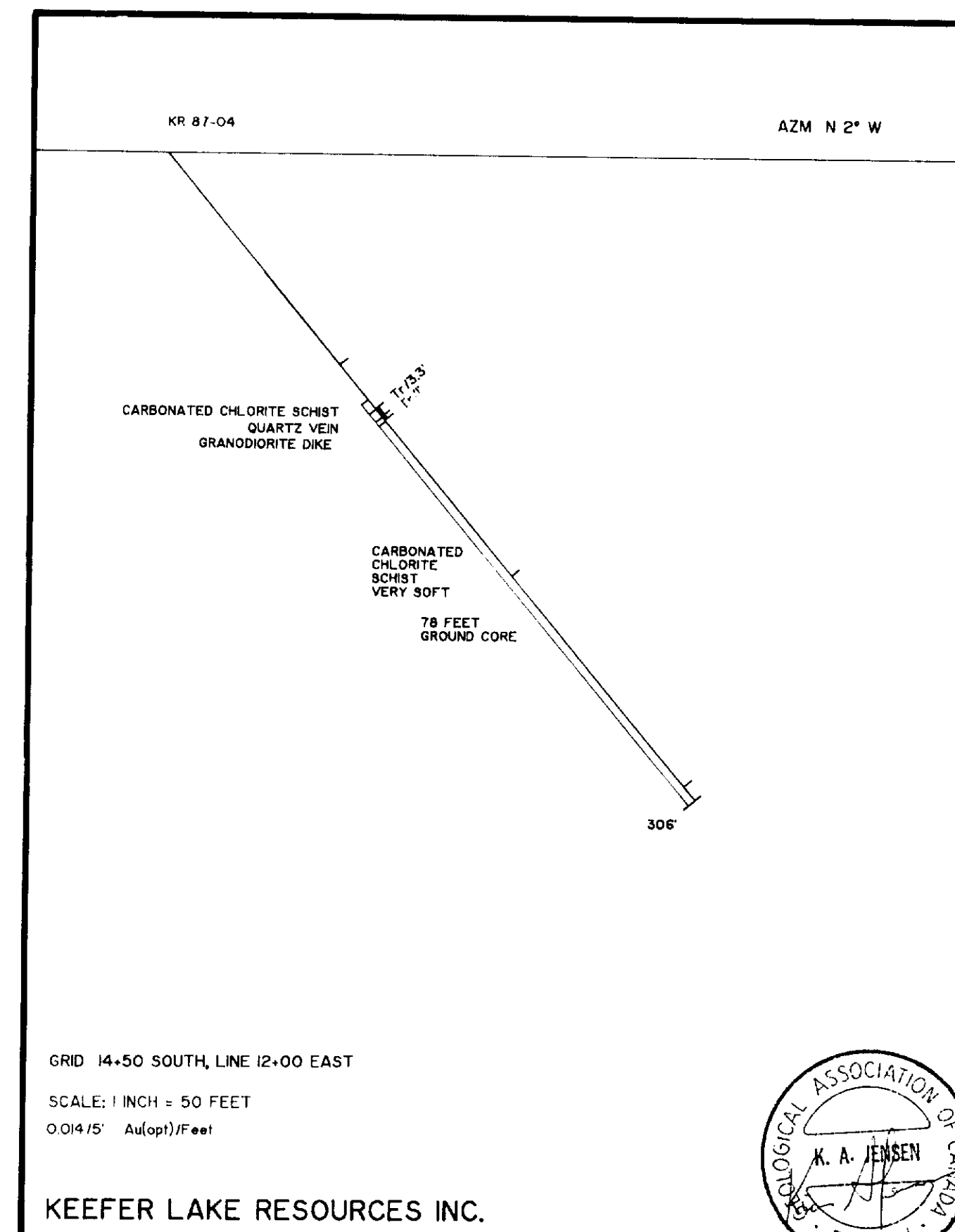
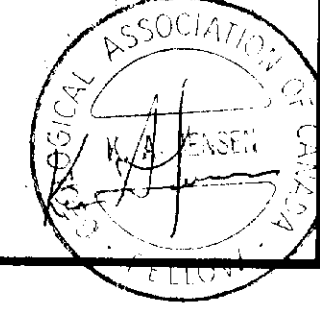
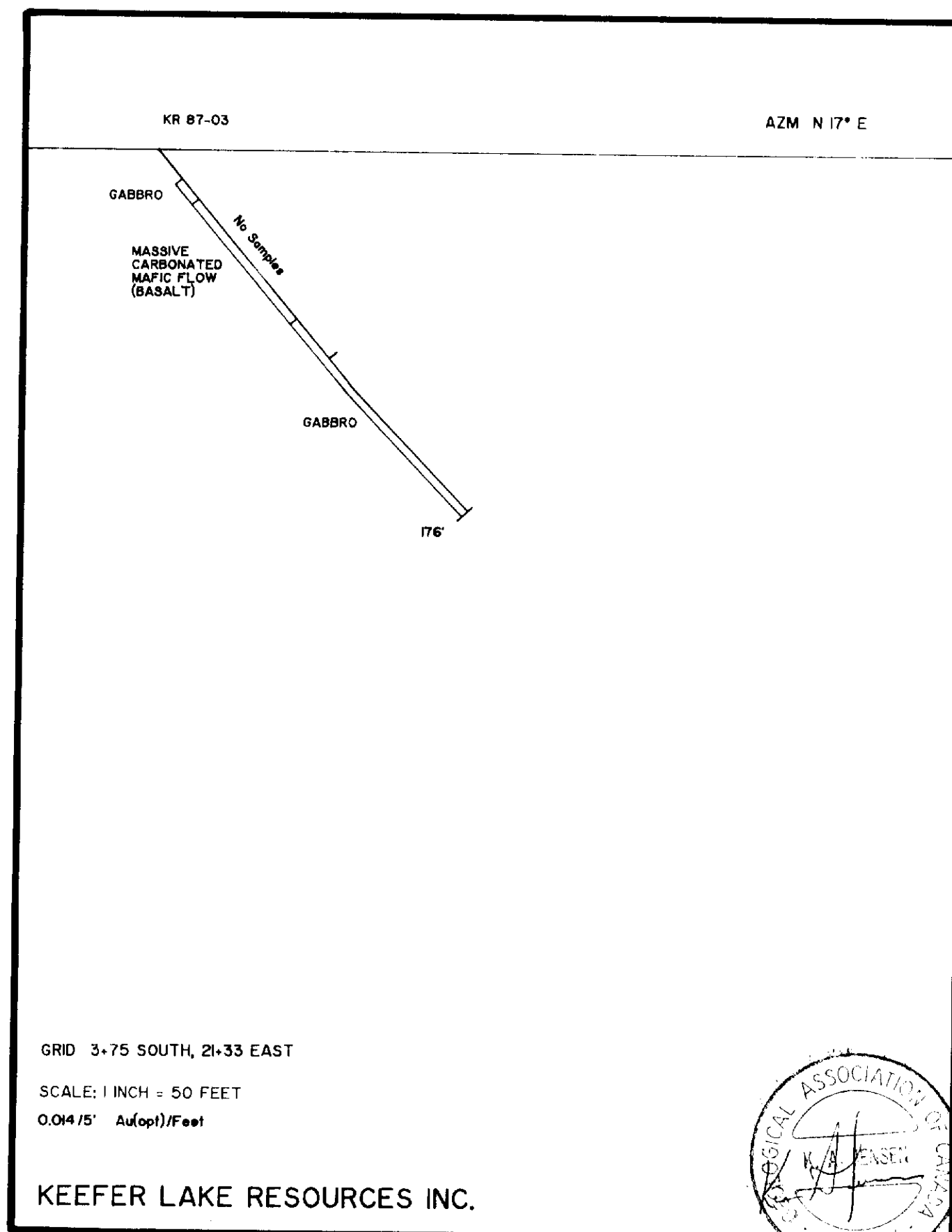
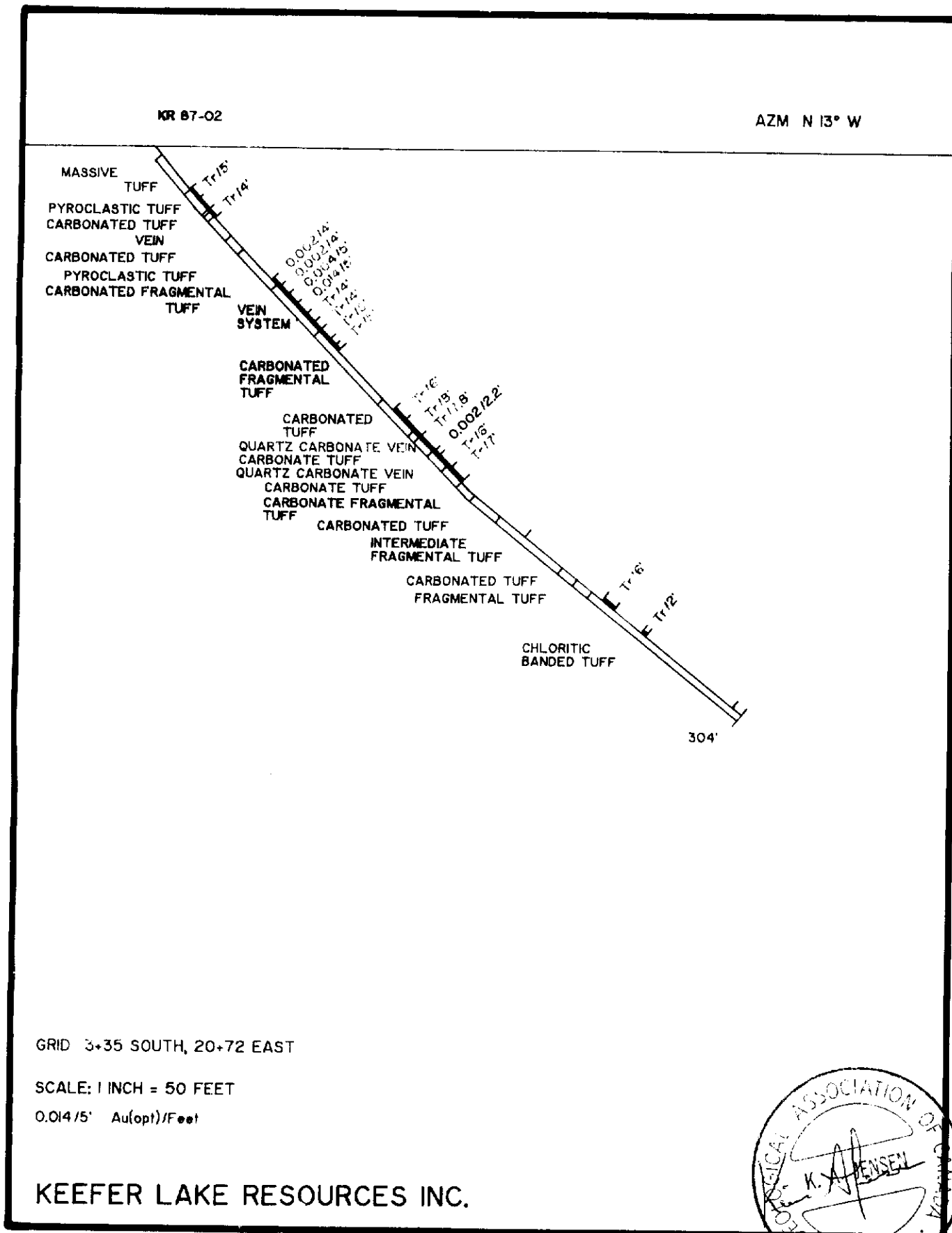
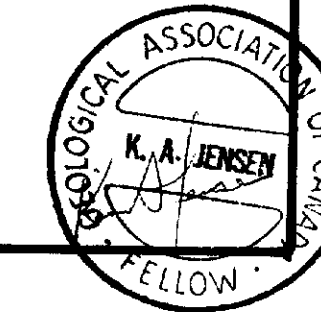
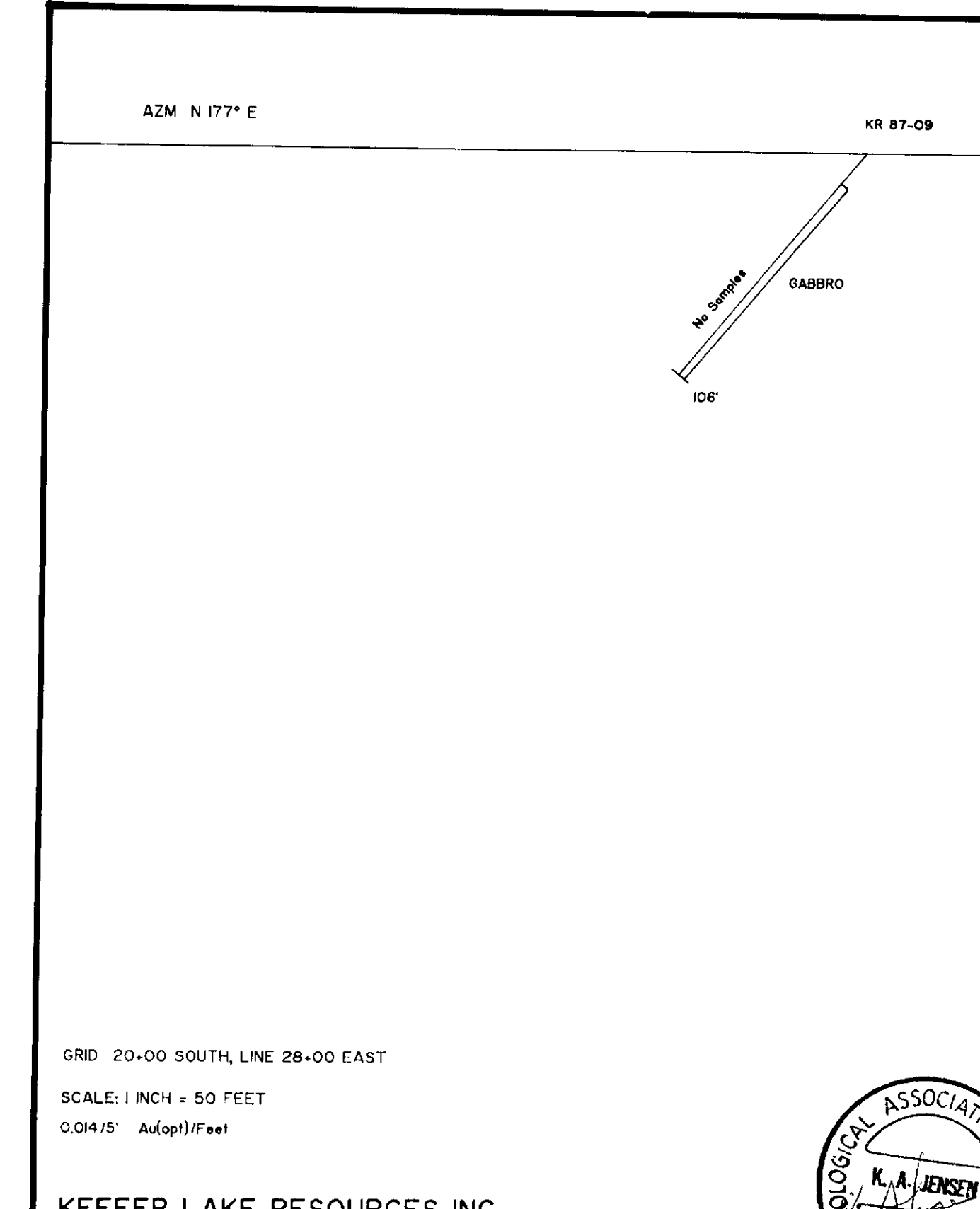
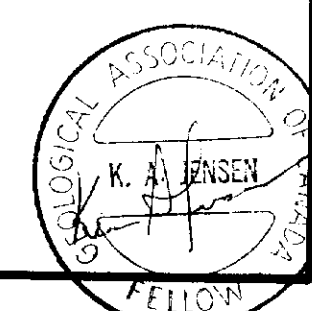
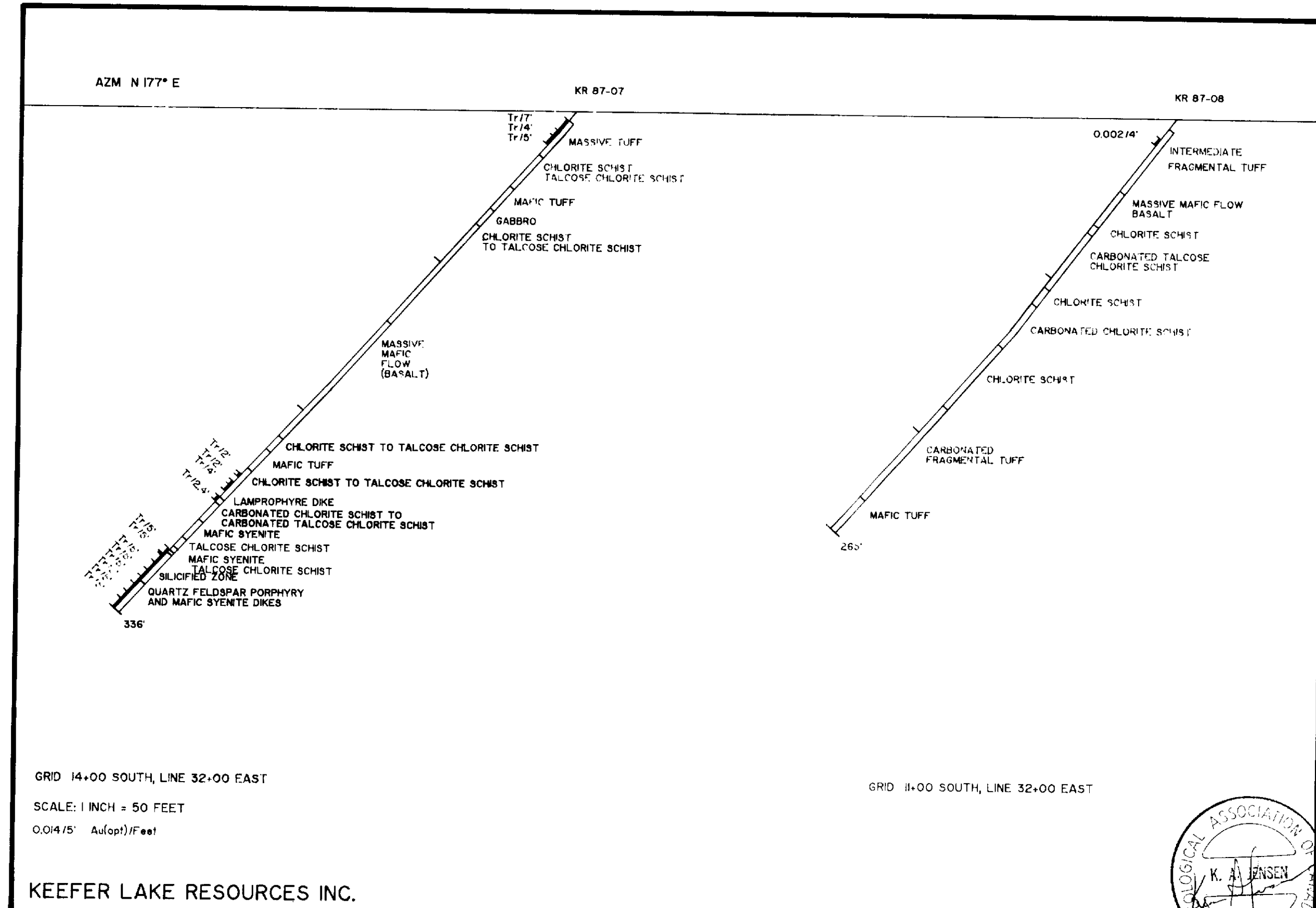
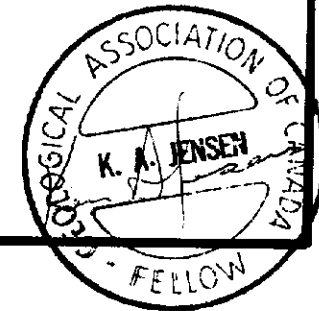

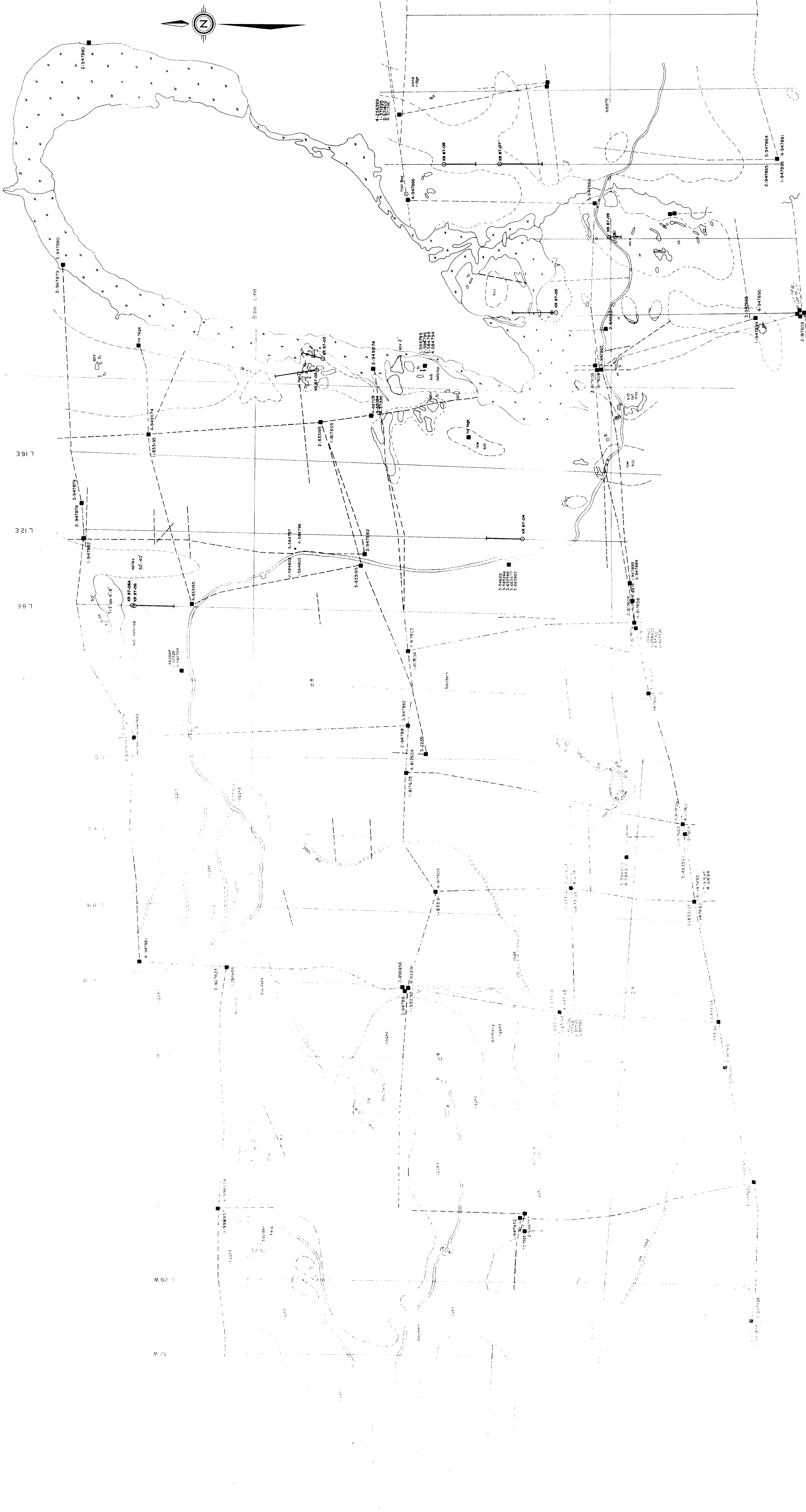

**KEFFER LAKE RESOURCES  
INCORPORATE**

KEFFER TOWNSHIP  
PORCUPINE MINING DIVISION

**DIAMOND DRILLING**

