



Ministry of Natural Resources

*Denton*  
*sup.*

W8006-347

#347



42A05SE5018 W8006-00347 DENTON

010

FORM #2

required for each type of work to be recorded.

THE MINING ACT REPORT OF WORK

To the Recorder of PORCUPINE Mining Division

I, BROWN McDADE MINES LTD. T 845

name of Recorded Holder Prospector's Licence

289 Kirby Ave., TIMMINS, Ontario.

Post Office Address

do hereby report the performance of 177 days of MECHANICAL STRIPPER *EQUIPMENT* type of work

not before reported to be applied on the following contiguous claims

Claim No.	Days	Claim No.	Days	Claim No.	Days
539619	20	.....	.....		
539622	20	.....	.....		
544599	40	.....	.....		
567640	40	.....	.....		
554598	40	.....	.....		
554597	17	.....	.....		

Geological Branch ODM  
ASSESSMENT FILES  
RESEARCH OFFICE  
DEC 11 1980  
RECEIVED

All the work was performed on Mining Claim (s) 554599 - 567640  
(In the case of geological and/or geophysical survey (s) where more than 18 claims are involved attach a schedule)

READ CAREFULLY: THE FOLLOWING INFORMATION IS REQUIRED BY THE MINING RECORDER.

For Manual Work, Stripping or Opening up of Mines, Sinking Shafts or Other Actual Mining Operations - Names and addresses of the men who performed the work and the dates and hours of their employment.

For Diamond and other Core Drilling - Footage, No. and angle of holes and diameter of core. Name and address of owner or operator of drill. Dates when drilling was done. Signed core log and sketch in duplicate.

For Compressed Air or Other Power Driven or Mechanical Equipment  
Type of drill or equipment. Names and addresses of men engaged in operating equipment and the dates and hours of their employment.

For Power Stripping - Type of equipment. Name and address of owner or operator. Amount expended. Dates on which work was done. Proof of actual cost must be submitted within 30 days of recording.

With each of the above types of work sketches are required to show the location and extent of the work in relation to the nearest claim post. In the case of diamond or other core drilling the sketch must be submitted in duplicate.

For Geophysical, Geological, Geochemical Surveys and Expenditure Credits - the name of author of report. Covering dates of survey (linecutting & office). Type of instrument used. Total amount of expenditure. Technical reports, maps, expenditure breakdown, receipts must be filed in duplicate with the Minister within 60 days of recording.

For Land Survey - the name and address of Ontario Land surveyor.

The Required Information is as Follows: (Attach a list if this space is insufficient)

- WILLIAM I. SCOTT  
289 Kirby Ave.,  
TIMMINS, Ontario. Caterpillar, Front End Loader  
June 4, 1980 - June 8, 1980  
Total Cost - \$1,775.00
- MIKE HWAY  
289 Kirby Ave.,  
TIMMINS, Ontario. 2 Operators

Date Dec 3/80

*Jack Heupert*  
Signature of Recorded Holder or Agent

The Mining Act  
Certificate Verifying Report of Work

I, JACK HEUPER T  
540 ROSS AVE E TIMMINS ONTARIO  
(Post Office Address)

hereby certify:

- That I have a personal and intimate knowledge of the facts set forth in the report of work annexed hereto, having performed the work or witnessed same during and/or after its completion.
- That the annexed report is true.

RECORDED  
DEC - 8 1980  
Signature

PORCUPINE MINING DIVISION  
Dated Dec 3 1980  
DEC 03 1980

*Jack Heupert*  
Signature

THE PENALTY FOR MAKING A FALSE STATEMENT IN THIS REPORT AND/OR CERTIFICATE IS \$500. OR SIX MONTHS IMPRISONMENT OR BOTH



42A95E5018 W8006-00347 DENTON

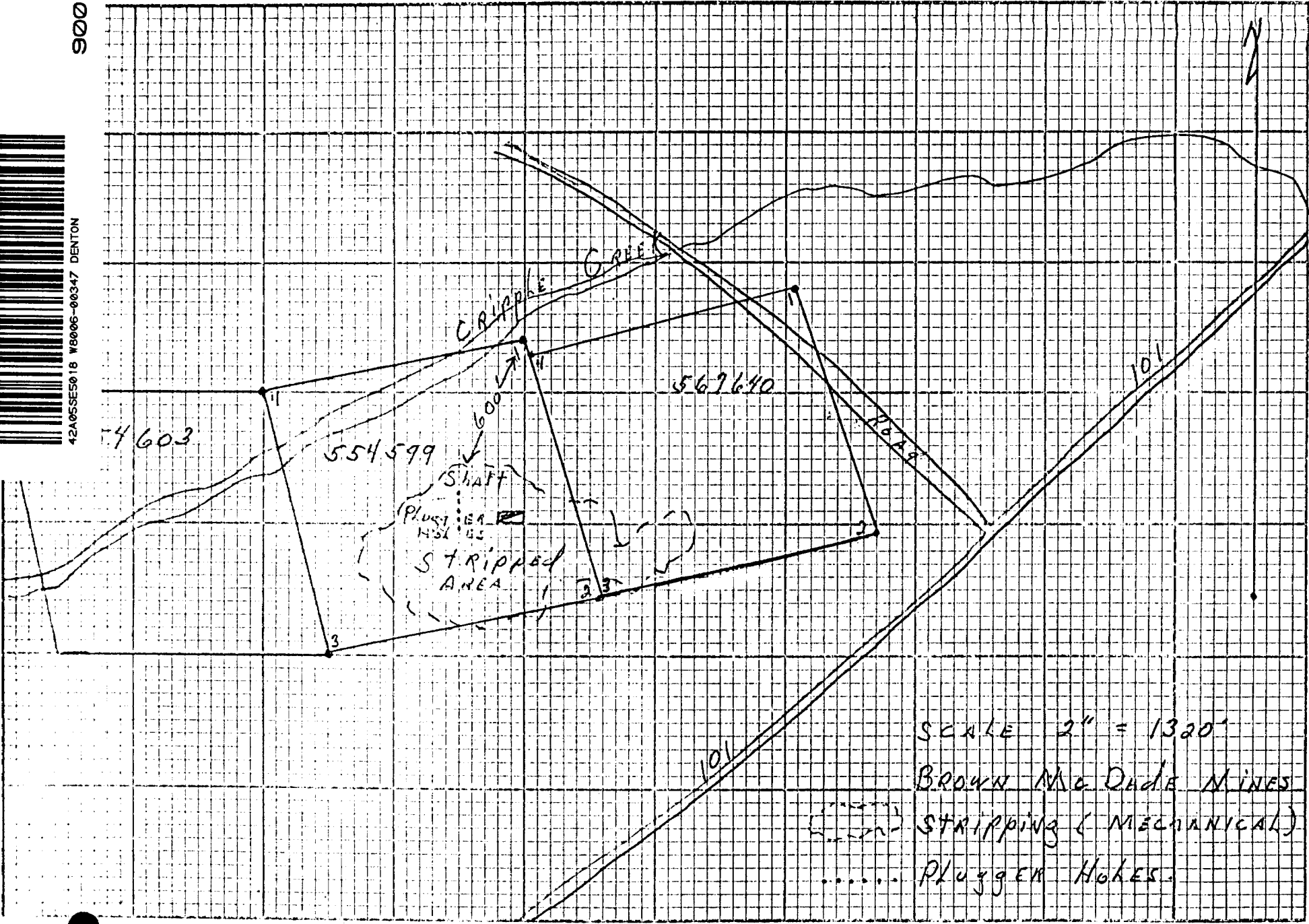

SCALE 2" = 1320'

BROWN Mc DUFF MINES

(---) STRIPPING (MECHANICAL)

..... PLUGGED HOLES.