

42A05SW0004 2 16782 KEEFER

010

**TEDDY BEAR VALLEY MINES, LIMITED
NIXON-BARTLEMAN CLAIMS
SIMS OPTION**

**GROUND MAGNETIC SURVEY
1996**

**North-East Ontario
Porcupine Mining Division
Kefer and Hillary Townships
NTS 42A5
Latitude 48 deg 17' N
Longitude 81 deg 50' W**

2. 1 67 8 2

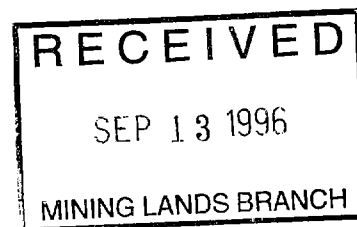

Claims covered:
P-28779 to 82
P-1115550 to 53
P-1115554 to 58
P-1115583 to 84
P-1116879 to 82

Author of report:
H. Limion *Qual. # 2.12/2.*
Suite 711
25 Adelaide Street East
Toronto, Ontario
M5C 1Y2
July, 1996

(i)

Summary

The nineteen Nixon-Bartleman claims were optioned by Teddy Bear Valley Mines, Limited on June 14, 1996.

Teddy Bear immediately launched a program of line cutting and ground magnetic surveys on the claims. Line cutting was by Georgex Exploration Contractors of Timmins. The magnetic survey was carried out by Rayan Exploration of Timmins, and completed in July.

Ground magnetics indicate a shallow north-east striking magnetic unit in the south-west portion of the claims. In the northern portion, magnetics indicate an east-west strike with deeper magnetic units. The property appears to be cut by north-west striking dykes which have a magnetic expression.



42A05SW0004 2 16782 KEEFER

010C

(ii)

Table of Contents

Summary	i
Introduction	1
Claims and Location	1
Geology	2
Target	2
Geophysical Coverage	2
Survey Results	2
Conclusions and Recommendations	3
References and Bibliography	4
Figure:	
1. Location Map	iii
Maps:	
Map 1 Ground Magnetic Survey Contours	in pocket
Map 2 Ground Magnetic Survey Values	in pocket

W 00' 28"

81° 15' W

48° 30' N

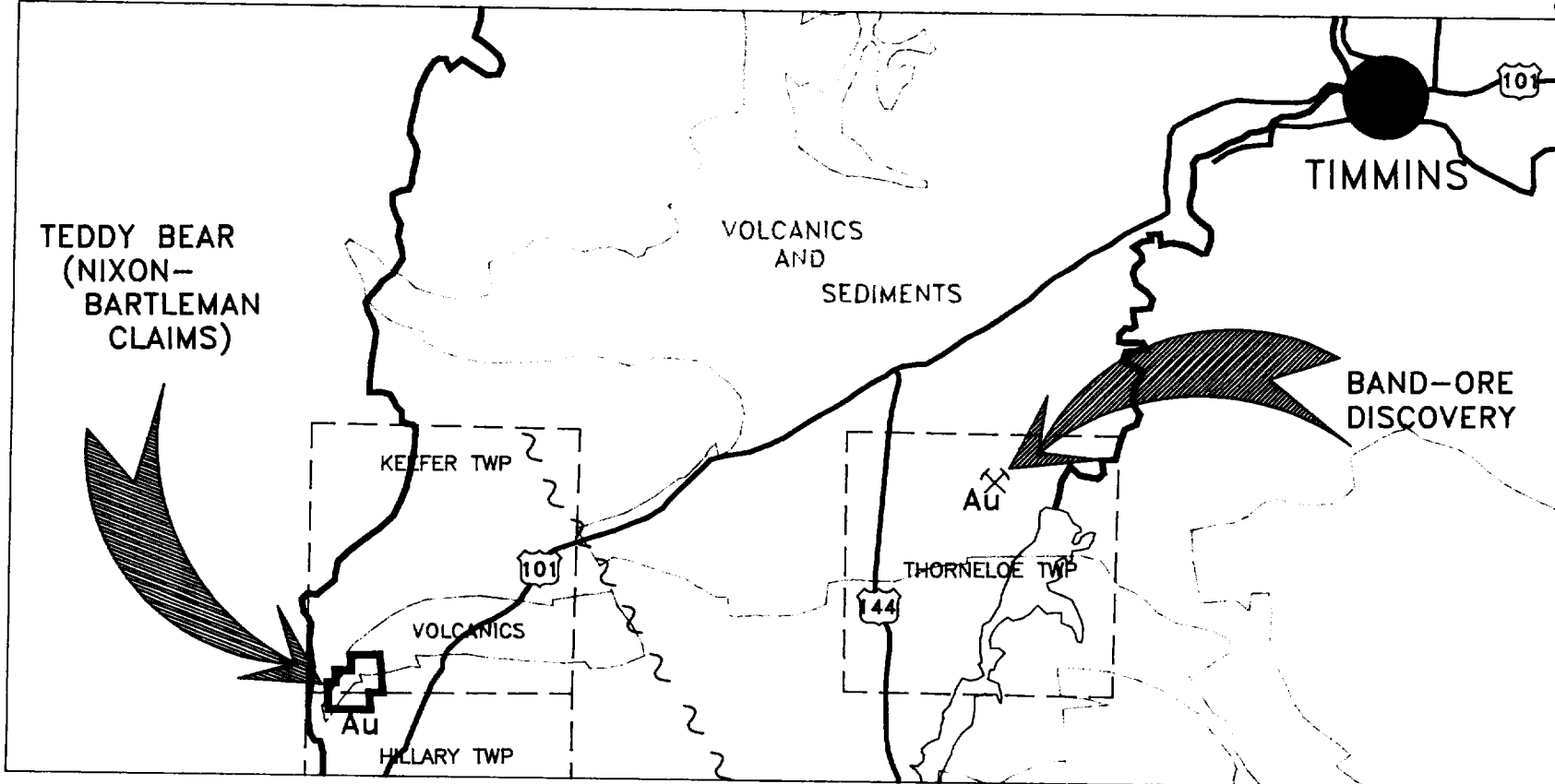

48° 15' N

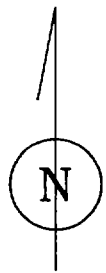

kilometres

TEDDY BEAR VALLEY MINES, LIMITED
NIXON-BARTLEMAN PROPERTY, SIMS OPTION
LOCATION MAP

SCALE 1 : 250,000
Keefer and Hillary Twp, NTS 42A5
Toronto **June 1996**

ATM
 Figure 1

Introduction

The Nixon-Bartleman claims have a long history of exploration.

In 1929, Manette carried out surface sampling of veins, but no report is available. In 1929-34, Nixon continued with smapling, trenching, and X-ray holes. In 1934, W. James and J. Sonnanstein reported on geology and sampling, but no logs or sections are available.

In 1946, Goldale Mines Limited carried out trenching, diamond drilling and mapping on 22 claims. This was followed by Hollinger with diamond drilling on 3 holes east of the patented claims and 2 holes to the west.

Noranda Exploration carried out ground magnetics and VLF in 1986, and an airborne magnetic and VLF survey in 1987. They also conducted a humic sampling program. This was followed in 1989 by a ground magnetic and VLF survey by Mingold Resources (Jensen, 1990), plus two diamond drill holes in the north-east corner of the claims. From 1991-95 there has been stripping and sampling by the property holder and interested companies.

The Keefer township portion of the claims was surveyed by a Geotem and airborne magnetic survey (Ontario Geological Survey, 1988). The survey indicates a north-east magnetic trend in the south-west portion of the claims, and an east-west trend in the northern portion. Weak to moderate Geotem conductors are found near the north-east boundary.

Much of the activity has been concentrated near #2 post of claim P-28782, where veins were trenched and sampled.

In 1996, Teddy Bear Valley Mines, Limited optioned 15 unpatented and four patented claims from William Sims Industries Limited and William Sims (see Figure 1).

Claims and Location

The claim group consists of nineteen (19) contiguous claims located in Keefer and Hillary Townships, Porcupine Mining Division, Ontario. The 4 patented claims (P-28779-82) are held by William Sims Industries Limited, the fifteen unpatented claims by William Sims. They are subject to a Teddy Bear Valley Mines, Limited option to earn 100% interest subject to royalties to William Sims Industries Limited and William Sims.

Access to the area is by Highway 101, approximately 50 km from Timmins.

The property location is shown in Figure 1, and the claims are shown on the magnetic survey maps.

Geology

The area is underlain by sheared and altered greenstone volcanics. The volcanics strike east-north-east and vary from 500 to 1,000 metres in north-south thickness. There is intense alteration in the andesitic volcanics with biotite and amphibole. The volcanics are bounded to the north and south by large granitic plutons.

A major fault zone runs N60E through the volcanics. Younger NNW trending faults are shown to displace the volcanics on the west and east ends of the property. Matachewan Series diabase dykes intrude both volcanics and granites.

Target

The magnetic survey was carried out to aid geologic mapping. This survey was read with closer lines and stations than previous work, and the better detail helped to establish line-to-line continuity between magnetic features. Use of the magnetic information to aid mapping and mineral exploration is the final goal.

Geophysical Coverage

Geophysical work was contracted to Rayan Exploration of Timmins.

Lines cut for geophysics in 1996 totalled 33.2 km plus tie lines. Those lines were read over 2,680 stations at a 12.5 m interval with total field magnetic measurements. There were several measurements under the power line which were noisy and unusable, and the number of usable readings is reduced to 2,604.

The magnetic survey instrument used by Rayan was an EDA OMNI proton precession magnetometer which measures total field. Station readings were corrected to an EDA OMNI base station magnetometer. Diurnal corrected readings are posted on the magnetic survey values map.

Survey Results

The magnetic survey indicates trends in three directions. In the south west portion of the grids, a south-west strike is seen for near surface magnetic units. One of the magnetic high units trends into the general area of known gold mineralization. In the northern portion of the claims, an east-west strike trend is evident from units that appear to be under 20 - 50 m of cover. Over the entire grid, a pattern of north west trends originates probably from magnetic dykes in that direction (see magnetic contour map).

Conclusions and Recommendations

Magnetic survey work on the claims has shown three major trends for magnetic units. One trend appears to strike into the area of mineralization, and that relationship will need to be determined. A second east-west trend appears to originate from under overburden. The third trend appears to strike parallel to well known dyke directions, and probably originates from those features.

The magnetic work has shown magnetic stratigraphy in more detail than previously available, and this needs to be incorporated in future interpretations of geology and mineralization.



Heikki Limion

References and Bibliography

- Jensen, K.A., 1990: Magnetic and electromagnetic surveys on the William Sims property in Keefer Township and Hillary Township. OPAP file number OP89-239.
- Ontario Geological Survey, 1988 : Airborne Electromagnetic and Total Intensity Survey, Timmins Area, Keefer Township, Districts of Cochrane and Timiskaming, Ontario, by Geotrex Limited for Ontario Geological Survey, Geophysical/Geochemical Series Map 81091, Scale 1:20,000.
- Ontario Geological Survey, 1989 : The geology of Keefer, Denton and Thorneloe Townships, District of Cochrane. Ministry of Northern Development and Mines, Mines and Minerals Division, Open File Report 5699.

H. Limion
Statement of Qualifications

I, Heikki Limion, received my B.A.Sc. degree in Engineering Science (Geophysics Option) from the University of Toronto in 1965.

In 1965-66 I worked one year with Hudson's Bay Oil and Gas as a Junior Geophysicist in seismic field work.

From 1967-76 I worked with INCO Exploration on ground and airborne geophysical surveys. In 1977-78 I was the head of the Geophysics Section for the Kenya Department of Mines and Geology. During this time I was under contract to CIDA (the Canadian International Development Agency).

From 1979-89 I held the position of Chief Geophysicist of Newmont Exploration of Canada Limited.

Since 1989 I have been a consultant in mineral exploration geophysics.

I am a member of the Society of Exploration Geophysicists, the Association of Professional Engineers of Ontario and the Prospectors and Developers Association.



Report of Work Conducted After Recording Claim

Mining Act

Transaction Number
49660.00466

Personal information collected on this form is obtained under the authority of the Mining Act. This information will be used for correspondence. Questions about this collection should be directed to the Provincial Manager, Mining Lands, Ministry of Northern Development and Mines, Fourth Floor, 159 Cedar Street, Sudbury, Ontario, P3E 6A5, telephone (705) 670-7264.

2.16782

- Instructions:
- Please type or print and submit in duplicate
 - Refer to the Mining Act and Regulation Recorder.
 - A separate copy of this form must be
 - Technical reports and maps must accompany
 - A sketch, showing the claims the work



Mining

900

Recorded Holder(s) <i>William Sims</i>	See attached schedule ("SAC")	Client No. <i>194697 SAC</i>
Address <i>392 Paisley Blvd West, Mississauga, ON L5B 2A6</i>		Telephone No. <i>SAC</i>
Mining Division <i>PORCUPINE SAC</i>	Township/Area <i>Kefer SAC</i>	M or G Plan No. <i>G.3237 SAC</i>
Date Work Performed From: <i>June 23/1996</i>	To: <i>July 22/1996</i>	

Work Performed (Check One Work Group Only)

Work Group	Type
Geotechnical Survey	LINE CUTTING AND GROUND MAGNETIC SURVEY
Physical Work, Including Drilling	
Rehabilitation	
Other Authorized Work	
Assays	
Assignment from Reserve	

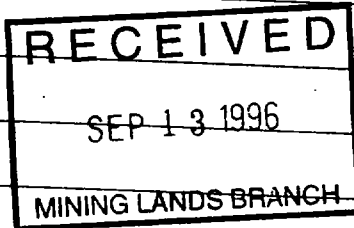

Total Assessment Work Claimed on the Attached Statement of Costs \$ 15,649.00

Note: The Minister may reject for assessment work credit all or part of the assessment work submitted if the recorded holder cannot verify expenditures claimed in the statement of costs within 30 days of a request for verification.

Persons and Survey Company Who Performed the Work (Give Name and Address of Author of Report)

Name	Address
GEORGEX (GEORGE FOURNIER) - LINE CUTTING	353 RAILWAY STREET TIMMINS, ONTARIO, PHN 2PH
RAYAN EXPLORATION LTD - MAGNETIC SURVEY	676 MURRAY STREET TIMMINS, ONTARIO, PHN 782
IMION GEOPHYSICS (HEIKKI HIMONEN) - REPORT ON MAGNETIC SURVEY	SUITE 711, 25 ADELAIDE STREET EAST TORONTO, ONTARIO, MSC 1Y2

Attach a schedule if necessary)

Verification of Beneficial Interest * See Note No. 1 on reverse side

Verify that at the time the work was performed, the claims covered in this work report were recorded in the current holder's name or held under a beneficial interest in the current recorded holder.	Date <i>JULY 29, 1996</i>	Recorded Holder or Agent (Signature) <i>Andrew M. Chater</i>
---	------------------------------	---

Verification of Work Report

Verify that I have a personal knowledge of the facts set forth in this Work report, having performed the work or witnessed same during and/or after completion and annexed report is true.		
Name and Address of Person Certifying <i>ANDREW M. CHATER, PRESIDENT, TEDDY BEAR VALLEY MINES, LIMITED SUITE 711, 25 ADELAIDE STREET EAST, TORONTO, ONTARIO, MSC 1Y2</i>		
File No. <i>16) 360 1974</i>	Date <i>JULY 29, 1996</i>	Certified By (Signature) <i>Andrew M. Chater</i>

Office Use Only

Initial Value Cr. Recorded	Date Recorded	Mining Recorder <i>NOT DATED</i>	Received RECEIVED
	Deemed Approval Date <i>OCT 28/96</i>	Date Approved <i>Jay White</i>	JUL 30 1996
	Date Notice for Amendments Sent		PORCUPINE MINING DIVISION



Ministry of
Northern Development
and Mines

Ministère du
Développement du Nord
et des mines

**Statement of Costs
for Assessment Credit**

**État des coûts aux fins
du crédit d'évaluation**

Mining Act/Loi sur les mines

Transaction No./N° de transaction
W 9660.00466

2.16782

Personal information collected on this form is obtained under the authority of the Mining Act. This information will be used to maintain a record and ongoing status of the mining claim(s). Questions about this collection should be directed to the Provincial Manager, Minings Lands, Ministry of Northern Development and Mines, 4th Floor, 159 Cedar Street, Sudbury, Ontario P3E 6A5, telephone (705) 670-7264.

Les renseignements personnels contenus dans la présente formule sont recueillis en vertu de la Loi sur les mines et serviront à tenir à jour un registre des concessions minières. Adresser toute question sur la collecte de ces renseignements au chef provincial des terrains miniers, ministère du Développement du Nord et des Mines, 159, rue Cedar, 4^e étage, Sudbury (Ontario) P3E 6A5, téléphone (705) 670-7264.

1. Direct Costs/Coûts directs

Type	Description	Amount Montant	Totals Total global
Wages Salaires	Labour Main-d'oeuvre		
	Field Supervision Supervision sur le terrain		
Contractor's and Consultant's Fees Droits de l'entrepreneur et de l'expert- conseil	Type Linecutting	11,309.90	
	Magnetic Survey	3,124.40	
	Report Compilation	1,215.00	15,649.30
Supplies Used Fournitures utilisées	Type		
Equipment Rental Location de matériel	Type		
Total Direct Costs Total des coûts directs			15,649.30

2. Indirect Costs/Coûts indirects

** Note: When claiming Rehabilitation work Indirect costs are not allowable as assessment work.
Pour le remboursement des travaux de réhabilitation, les coûts indirects ne sont pas admissibles en tant que travaux d'évaluation.

Type	Description	Amount Montant	Totals Total global
Transportation Transport	Type		
Food and Lodging Nourriture et hébergement			
Mobilization and Demobilization Mobilisation et démobilisation			
Sub Total of Indirect Costs Total partiel des coûts indirects			
Amount Allowable (not greater than 20% of Direct Costs) Montant admissible (n'excédant pas 20 % des coûts directs)			
Total Value of Assessment Credit (Total of Direct and Allowable indirect costs)		Valeur totale du crédit d'évaluation (Total des coûts directs et indirects admissibles)	15,649.30

Note: The recorded holder will be required to verify expenditures claimed in this statement of costs within 30 days of a request for verification. If verification is not made, the Minister may reject for assessment work all or part of the assessment work submitted.

Note : Le titulaire enregistré sera tenu de vérifier les dépenses demandées dans le présent état des coûts dans les 30 jours suivant une demande à cet effet. Si la vérification n'est pas effectuée, le ministre peut rejeter tout ou une partie des travaux d'évaluation présentés.

Filing Discounts

1. Work filed within two years of completion is claimed at 100% of the above Total Value of Assessment Credit.
2. Work filed three, four or five years after completion is claimed at 50% of the above Total Value of Assessment Credit. See calculations below:

Total Value of Assessment Credit	Total Assessment Claimed
	x 0.50 =

Remises pour dépôt

1. Les travaux déposés dans les deux ans suivant leur achèvement sont remboursés à 100 % de la valeur totale susmentionnée du crédit d'évaluation.
2. Les travaux déposés trois, quatre ou cinq ans après leur achèvement sont remboursés à 50 % de la valeur totale du crédit d'évaluation susmentionné. Voir les calculs ci-dessous.

Valeur totale du crédit d'évaluation	Évaluation totale demandée
	x 0,50 =

Certification Verifying Statement of Costs

I hereby certify:
that the amounts shown are as accurate as possible and these costs were incurred while conducting assessment work on the lands shown on the accompanying Report of Work form.

that as President of Teddy Bear I am authorized
(Recorded Holder, Agent, Position in Company)

to make this certification

Attestation de l'état des coûts

J'atteste par la présente :
que les montants indiqués sont le plus exact possible et que ces dépenses ont été engagées pour effectuer les travaux d'évaluation sur les terrains indiqués dans la formule de rapport de travail ci-joint.

Et qu'à titre de _____ je suis autorisé
(titulaire enregistré, représentant, poste occupé dans la compagnie)

à faire cette attestation.

Signature <u>Andrew M. Chater</u>	Date <u>July 29, 1996</u>
--------------------------------------	------------------------------

Teddy Bear Valley Mines, Limited - Attachment to Report of Work
Dated July 29, 1996

List of Claims and Owners

2.16782

A) Claims within the Township of Keefer, District of Cochrane or
Porcupine Mining Division (Plan # G-3237)

- 1) Parcel 8504 Centre Section Temiskaming
- Patented mining claim P.28780, containing 43-82/100
acres, more or less.

Owner: William Sims ~~Industries Limited~~ (100%)
392 Paisley Blvd. West
Mississauga, Ontario
L5B 2A6

Client #: None 194697
Telephone #: (905) 272-4983

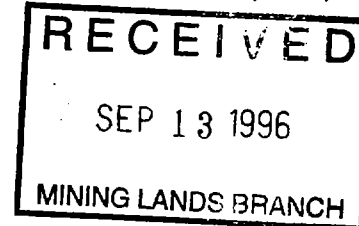

- 2) Parcel 8505 Centre Section Temiskaming
- Patented mining claim P.28779, containing 43-6/10
acres, more or less.

Owner: William Sims ~~Industries Limited~~ (100%)
392 Paisley Blvd. West
Mississauga, Ontario
L5B 2A6

Client #: None
Telephone #: (905) 272-4983

- 3) Parcel 8506 Centre Section Temiskaming
- Patented mining claim P.28781, containing 43-26/100
acres, more or less.

Owner: William Sims ~~Industries Limited~~ (100%)
392 Paisley Blvd. West
Mississauga, Ontario
L5B 2A6

Client #: None
Telephone #: (905) 272-4983

2.16782

- 4) Parcel 8507 Centre Section Temiskaming
- Patented mining claim P.28782, containing 50-26/100
acres, more or less.

Owner: William Sims Industries Limited (100%)
392 Paisley Blvd. West
Mississauga, Ontario
L5B 2A6

Client #: None
Telephone #: (905) 272-4983

- 5) Unpatented Mining Claims P.1115550-5, P.1115583-4 and
P.1116879-82 (total of 12 claims)

Owner: William Sims (100%)
392 Paisley Blvd. West
Mississauga, Ontario
L5B 2A6

Client #: 194697
Telephone #: (905) 272-4983

- B) Claims Within the Township of Hillary, Porcupine Mining
Division (Plan # G-31075)

- 1) Unpatented mining claims P.1115556-8 (total of 3 claims)

Owner: William Sims (100%)
392 Paisley Blvd. West
Mississauga, Ontario
L5B 2A6

Client #: 194697
Telephone #: (905) 272-4983

Ministry of
Northern Development
and Mines

Ministère du
Développement du Nord
et des Mines



October 18, 1996

Geoscience Assessment Office
933 Ramsey Lake Road
6th Floor
Sudbury, Ontario
P3E 6B5

Gary White
Mining Recorder
60 Wilson Avenue, 1st Floor
Timmins, ON
P4N 2S7

Telephone: (705) 670-5853
Fax: (705) 670-5863

Dear Sir or Madam:

Submission Number: 2.16782

Subject: Transaction Number(s): W9660.00466

After reviewing the Work Report(s) we have prepared this letter and the attached summary, which lists the results of our review. Requirements of the Assessment Work Regulation may not have been fully met. Please examine the summary to determine the next course of action concerning the identified Work Report(s).

NOTE: The 90 day deemed approval provision, subsection 6(7) of the Assessment Work Regulation, is no longer in effect for this submission.

PLEASE NOTE ANY REQUESTED REVISIONS MUST BE SUBMITTED IN DUPLICATE.

If the anniversary dates for the mining claims affected by this correspondence have not passed, a number of options are available. Please contact the Mining Recorder to discuss these options.

If you have any questions regarding this correspondence, please contact Steve Beneteau at (705)670-5855.

Yours sincerely,

A handwritten signature in black ink, appearing to read "Ron C. Gashinski".

ORIGINAL SIGNED BY
Ron C. Gashinski
Senior Manager, Mining Lands Section
Mines and Minerals Division

Work Report Assessment Results

Submission Number: 2.16782

Date Correspondence Sent: October 18, 1996

Assessor: Steve Beneteau

Transaction Number	First Claim Number	Township(s) / Area(s)	Status	Approval Date
W9660.00466	28779	KEEFER	Approval	October 18, 1996

Section:

14 Geophysical MAG

Correspondence to:

Mining Recorder
Timmins, ON

Resident Geologist
Timmins, ON

Assessment Files Library
Sudbury, ON

Recorded Holder(s) and/or Agent(s):

Andrew M. Chater
TORONTO, ONTARIO

WILLIAM SIMS
MISSISSAUGA, Ontario

REFERENCES

AREAS WITHDRAWN FROM DISPOSITION

- M.R.O. - MINING RIGHTS ONLY
- S.R.O. - SURFACE RIGHTS ONLY
- M.+S. - MINING AND SURFACE RIGHTS

Description	Order No.	Date	Disposition	File
(R1) SEC. 43/70 W.26/77 N.1/3/77 S.R.O.				189543
(R2) SEC. 42/60		02/3/66 M+S		17406
(R3) SEC. 42/60		10/7/66 M+S		149113
(R4) DANA AND JOWSEY LAKES PARK RESERVE				SEC 36/80 W.66/83 M+S
(R5) DUMPING STATION				

SAND AND GRAVEL

- (S1) M.T.C. PIT 1593
- (S2) GRAVEL FILE 44986

- (S3) APPLICATION PENDING UNDER THE PUBLIC LANDS ACT NOTICE RECEIVED 92/DEC/21 SNOWMOBILE TRAILS

THE INFORMATION THAT APPEARS ON THIS MAP HAS BEEN COMPILED FROM VARIOUS SOURCES, AND ACCURACY IS NOT GUARANTEED. THOSE WISHING TO STAKE MINING CLAIMS SHOULD CONSULT WITH THE MINING RECORDER, MINISTRY OF NORTHERN DEVELOPMENT AND MINES, FOR ADDITIONAL INFORMATION ON THE STATUS OF THE LANDS SHOWN HEREON

Whitesides Twp.

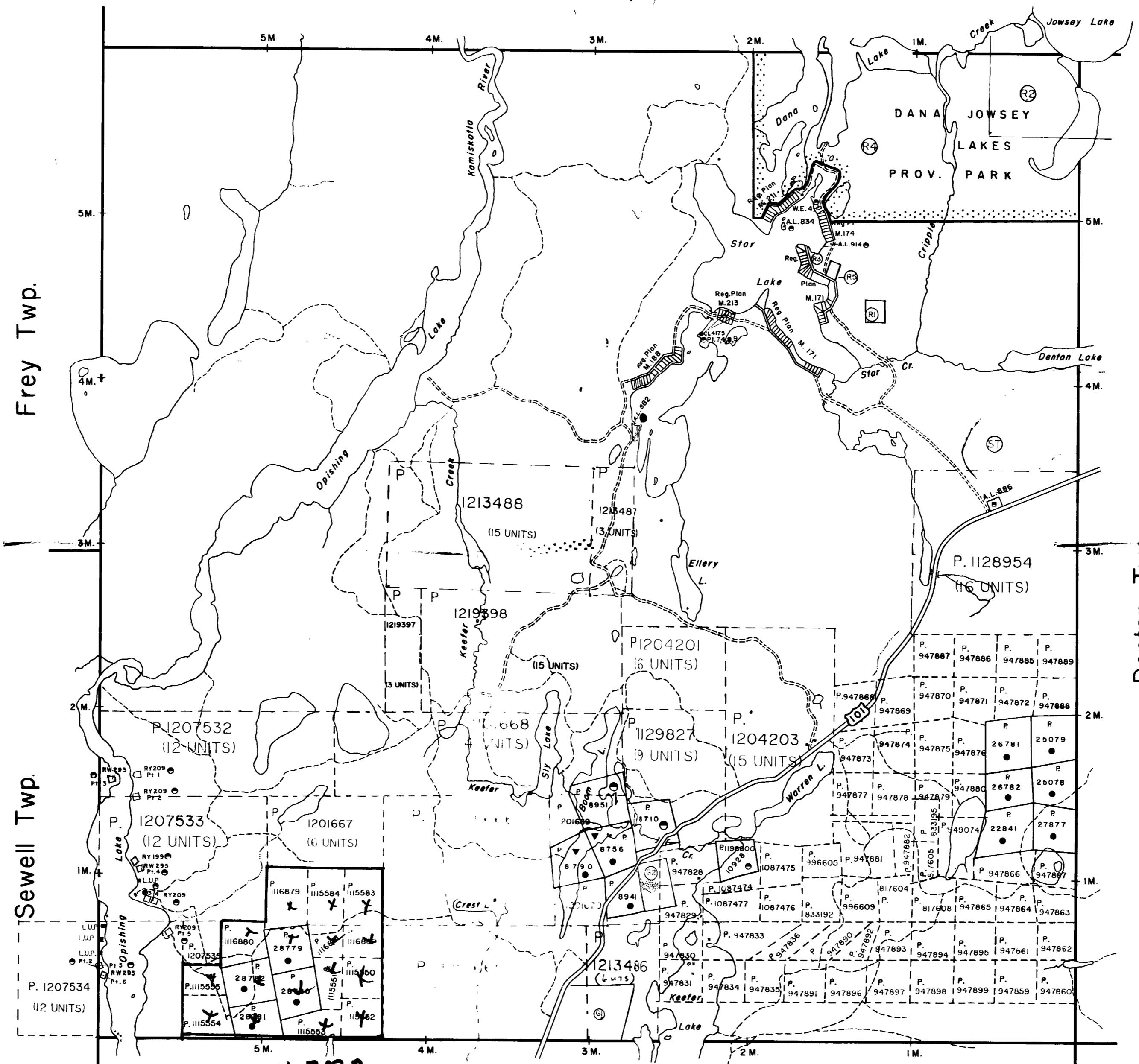

2.16782 (MAG)

LEGEND

- HIGHWAY AND ROUTE No.
- OTHER ROADS
- TRAILS
- SURVEYED LINES
- TOWNSHIPS, BASE LINES, ETC.
- LOTS, MINING CLAIMS, PARCELS, ETC.
- UNSURVEYED LINES
- LOT LINES
- PARCEL BOUNDARY
- MINING CLAIMS ETC.
- RAILWAY AND RIGHT OF WAY
- UTILITY LINES
- NON PERENNIAL STREAM
- FLOODING OR FLOODING RIGHTS
- SUBDIVISION OR COMPOSITE PLAN
- RESERVATION
- ORIGINAL SURVEY LINE
- MARSH OR MUSKEG
- MINES
- TRAVERSE MONUMENT

DISPOSITION OF CROWN LANDS

TYPE OF DOCUMENT	SYMBOL
PATENT SURFACE & MINING RIGHTS	●
PATENT SURFACE RIGHTS ONLY	○
PATENT MINING RIGHTS ONLY	◐
LEASE SURFACE & MINING RIGHTS	■
LEASE SURFACE RIGHTS ONLY	◼
LEASE MINING RIGHTS ONLY	◻
LICENCE OF OCCUPATION	▼
ORDER IN COUNCIL	○
RESERVATION	⊙
CANCELLED	⊘
SAND & GRAVEL	⊙

NOTE: MINING RIGHTS IN PARCELS PATENTED PRIOR TO MAY 6, 1913 VESTED IN ORIGINAL PATENTEE BY THE PUBLIC LANDS ACT, R.S.O. 1970, CHAP. 380, SEC. 63, SUBSEC. 1

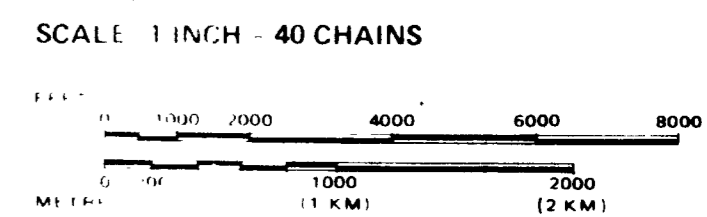

w 9660. 00466

TOWNSHIP
KEEFER

M.N.R. ADMINISTRATIVE DISTRICT
TIMMINS

MINING DIVISION
PORCUPINE

LAND TITLES / REGISTRY DIVISION
COCHRANE

2.16782

Ministry of Natural Resources
Land Management Branch
Ontario

Date MARCH, 1985
Number G-3237



REFERENCES

Areas withdrawn from staking under Section 43 of the Mining Act (R.S.O. - 1970)

File	Date	Disposition
164584	17/5/72	S.R.O.
169839	12 6 70	S.R.O. PUBLIC ACCESS RES.
172556	24 6 70	S.R.O. PUBLIC ACCESS RES.

F1 - THIS TWP SUBJECT TO FOREST ACTIVITY IN 1991/92 - FURTHER INFORMATION AVAILABLE ON FILE.

F2 - THIS TWP SUBJECT TO FORESTRY ACTIVITY IN 1994. FURTHER INFORMATION AVAILABLE ON FILE.

NOTE

F1 - PROPOSED COTTAGING AREAS NOTICE RECEIVED DEC. 22/88

THE INFORMATION THAT APPEARS ON THIS MAP HAS BEEN COMPILED FROM VARIOUS SOURCES, AND ACCURACY IS NOT GUARANTEED. THOSE WISHING TO STAKE MINING CLAIMS SHOULD CONSULT WITH THE MINING RECORDER, MINISTRY OF NORTHERN DEVELOPMENT AND MINES, FOR ADDITIONAL INFORMATION ON THE STATUS OF THE LANDS SHOWN HEREON.

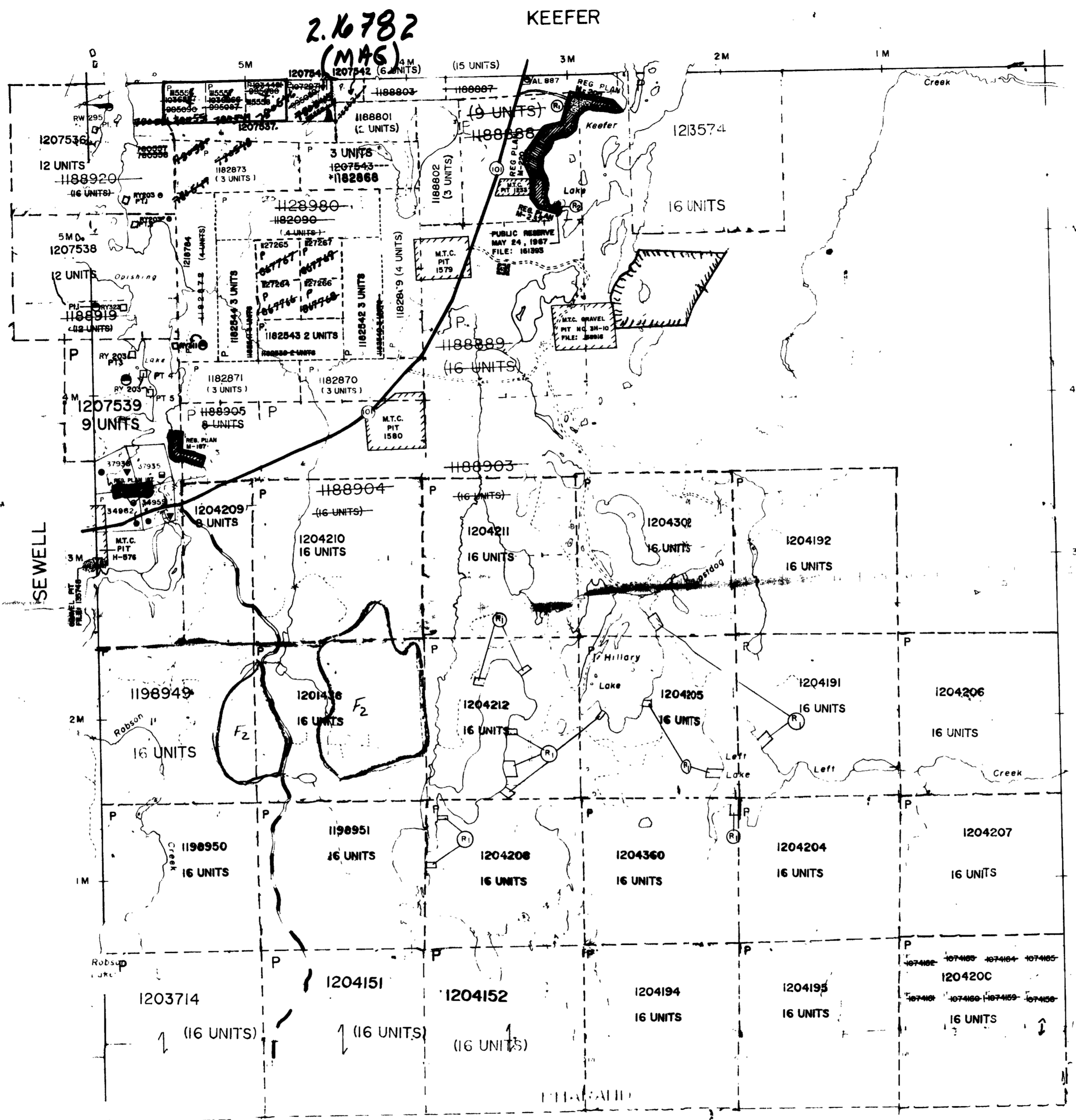

LEGEND

ROADWAY AND ROUTING	---
TRAIL	---
SURVEYED LINES	---
TOWNSHIP BOUNDARIES	---
UNREGISTERED LINES	---
PARCEL BOUNDARIES	---
MINING CLAIMS	---
RAILWAY AND HIGHWAY	---
NEW LINES	---
EXISTING LINES	---
REGISTERED PLAN OF SUBDIVISION	---

DISPOSITION OF CROWN LANDS

TYPE OF DOCUMENT	SYMBOL
PATENT SURFACE & MINING RIGHTS	●
SURFACE RIGHTS ONLY	○
MINING RIGHTS ONLY	◐
LEASE SURFACE & MINING RIGHTS	◑
SURFACE RIGHTS ONLY	◒
MINING RIGHTS ONLY	◓
LICENCE OF OCCUPATION	OC
ORDER IN COUNCIL	○
RESERVATION	○
CANCELLED	○
SAND & GRAVEL	○

NOTE: WHERE RIGHTS IN PARCELS HAVE BEEN VESTED IN ORIGINAL PATENTEE BY THE PUBLIC LANDS ACT R.S.O. 1970, CHAP. 380, SEC. 53 SUBSEC. 1

SCALE 1 INCH = 40 CHAINS

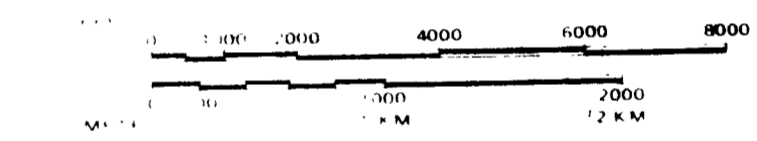

TOWNSHIP
HILLARY TWP.
w 9660. 00466
M.N.R. ADMINISTRATIVE DISTRICT
TIMMINS RECEIVED
MINING DIVISION
PORCUPINE
LAND TITLES / REGISTRY DIVISION
MINING LANDS BRANCH
TIMISKAMING

Ministry of Northern Development and Mines
Timiskaming Branch
2.16782
Number
G-1075



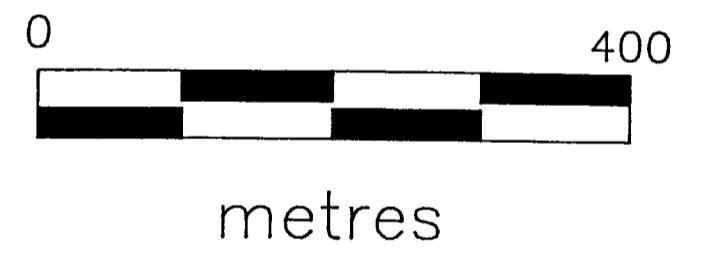
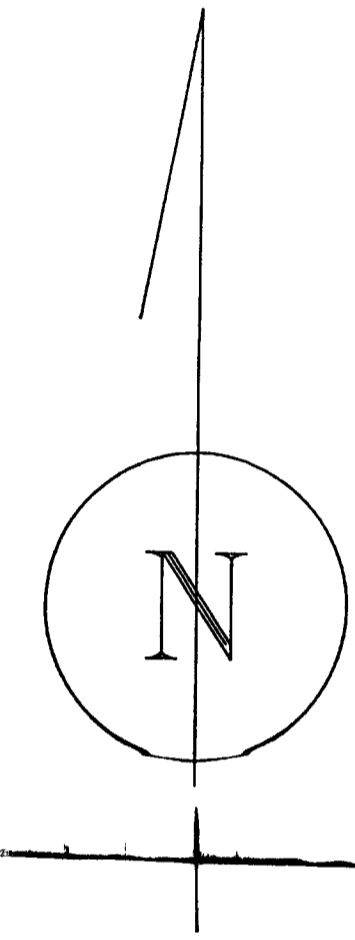
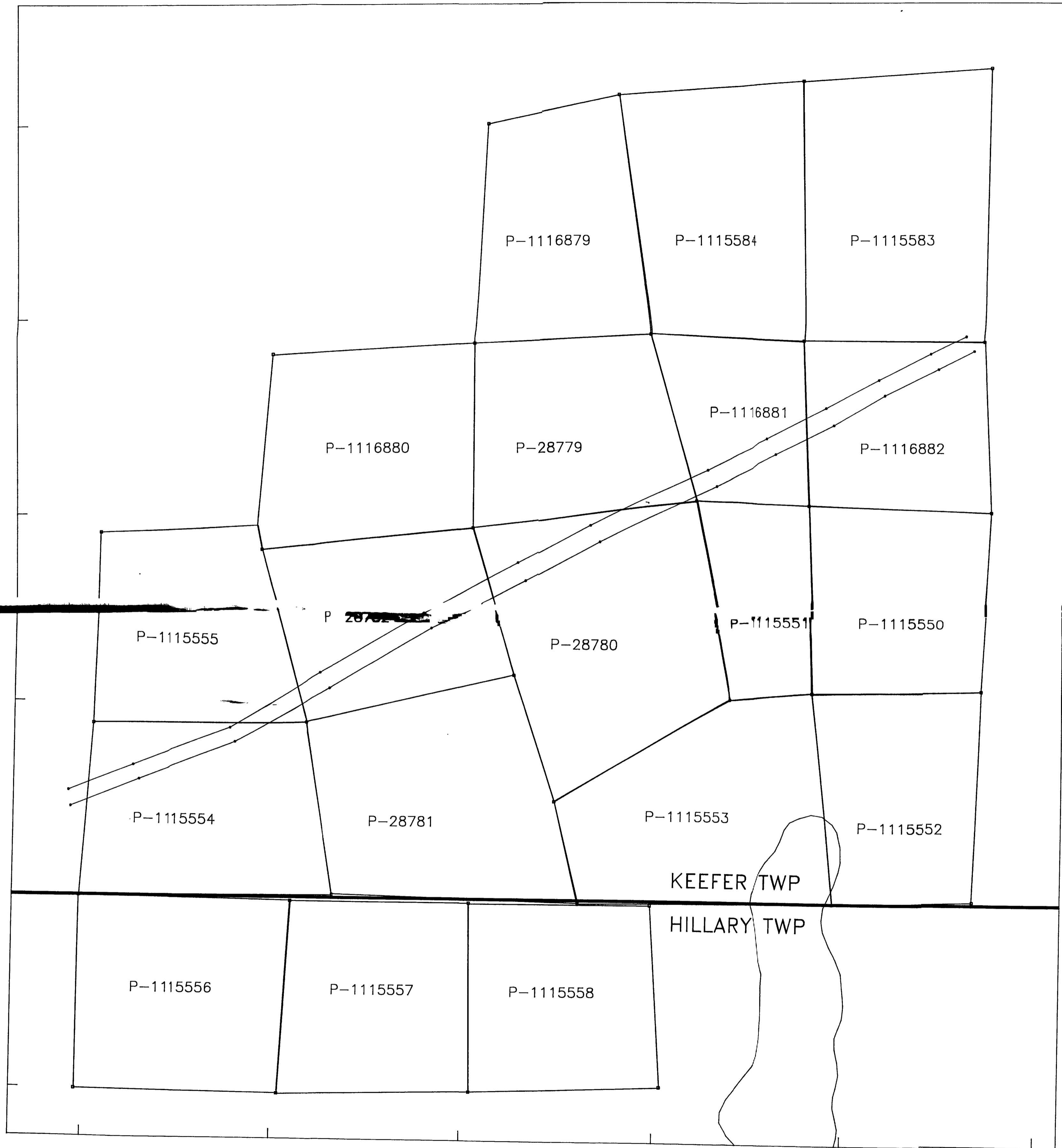

2.16782

RECEIVED
 2 SEP 13 1996
 MINING LANDS BRANCH

TEDDY BEAR VALLEY MINES, LIMITED
NIXON-BARTLEMAN PROPERTY, SIMS OPTION

Keefe and Hillary Twp, NTS 42A5
 Toronto June 1996



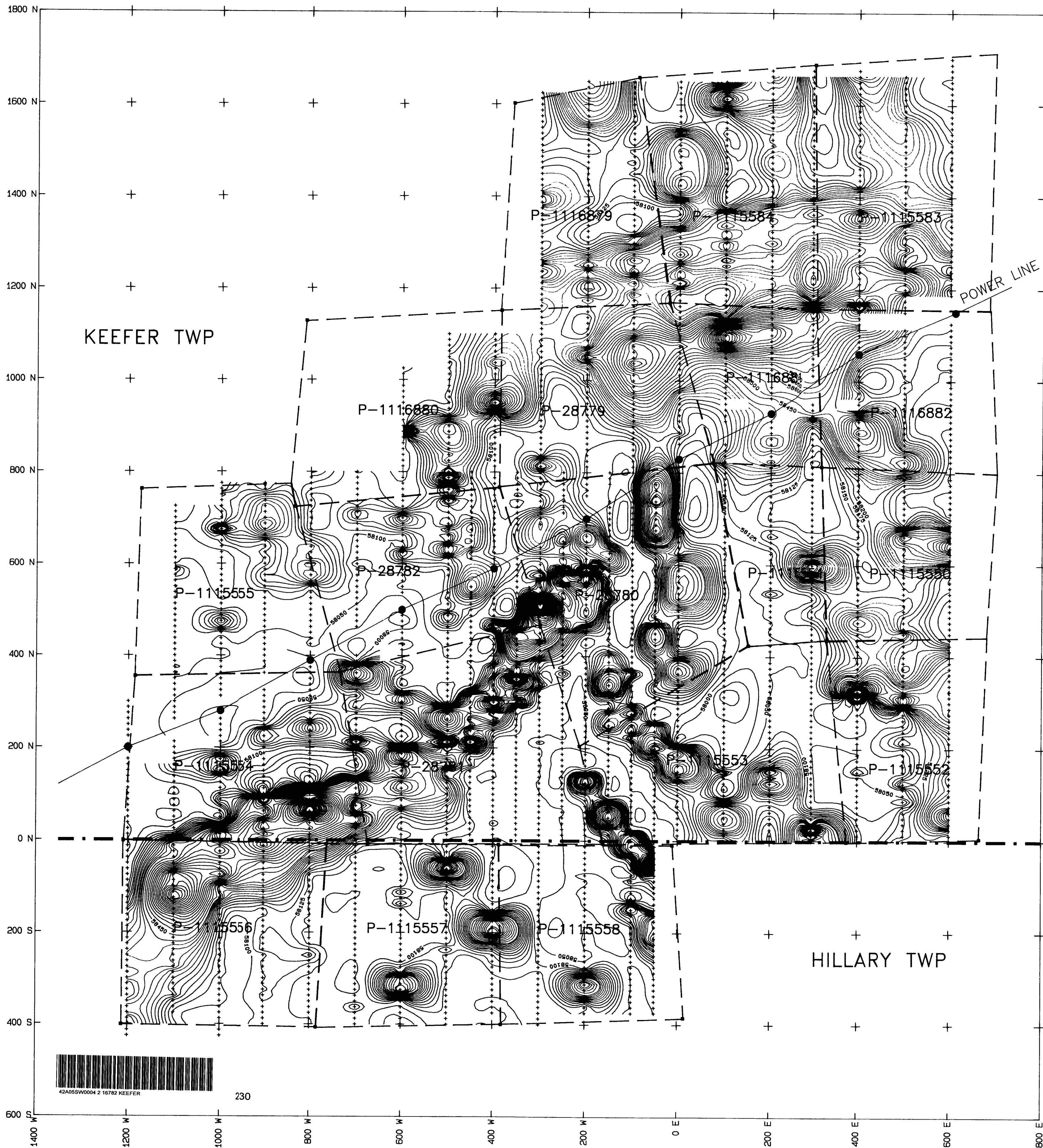

DATA COLLECTION and PLOTTING
 Field instrument : EDA Omni Proton Mag
 Base station : EDA Omni Proton Mag
 Corrections : Diurnal
 Gridding : Minimum curvature, 12.5m
 Filtering : none

Contours :
 57,000 to 58,100 every 50 gammas
 58,125 to 58,225 every 25 gammas
 58,250 to 58,375 every 25 gammas
 58,400 to 60,500 every 50 gammas

KEEFER TWP

HILLARY TWP

2.16782 RECEIVED
 JUL 15 1996
 LANDS DIVISION

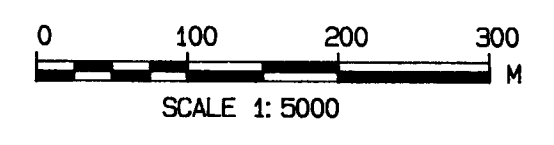

230

H. Linn
 TEDDY BEAR VALLEY MINES, LTD
 NIXON-BARTLEMAN PROPERTY
 SIMS OPTION
 Ground Magnetic Survey Contours
 NE Ontario Keefer and Hillary Twp
 NTS 42 A 5
 Survey by Rayan Exploration, July 1996
 Toronto July 1996

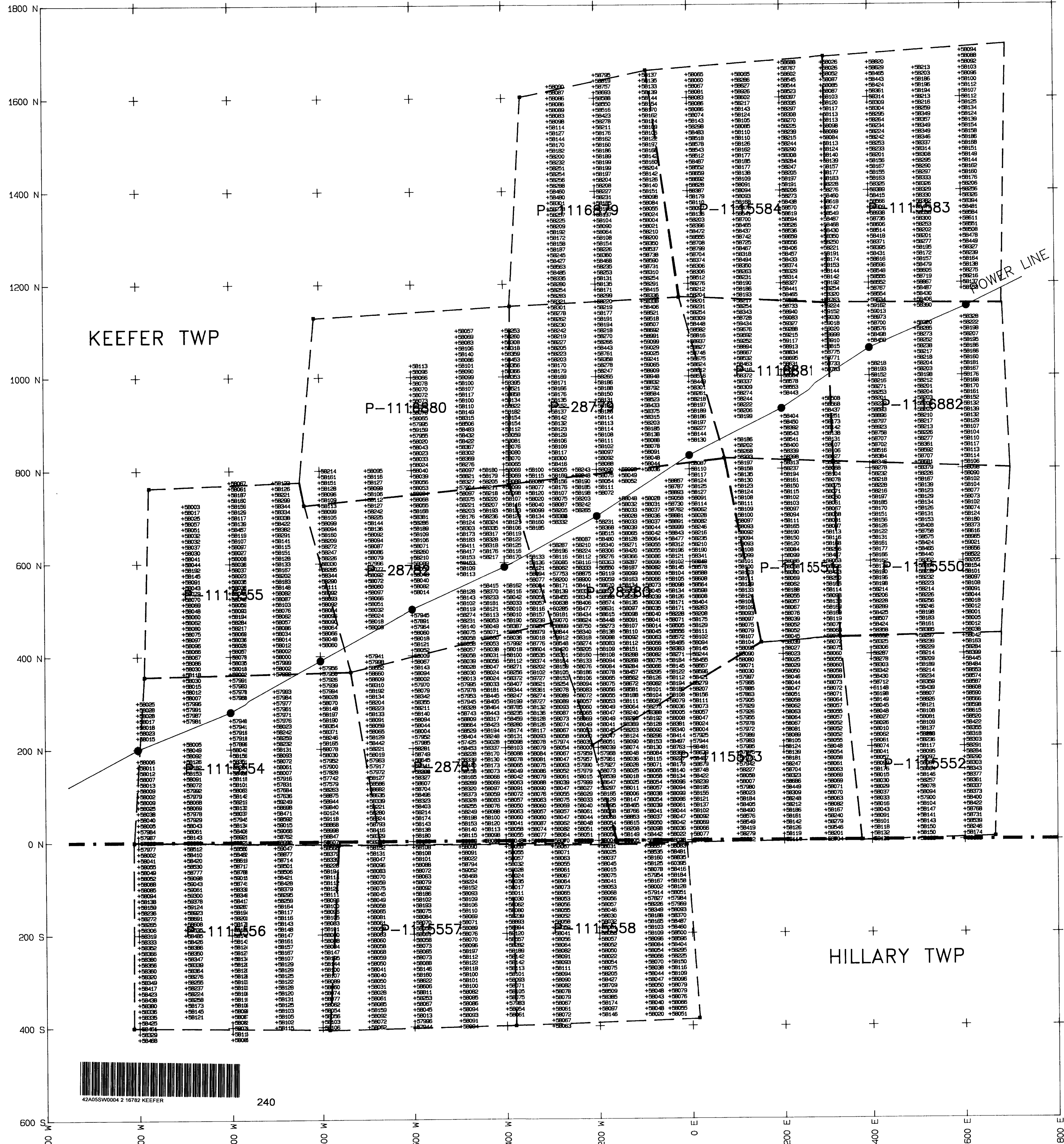

DATA COLLECTION
 Field instrument : EDA Omni Proton Mag
 Base station : EDA Omni Proton Mag
 Corrections : Diurnal
 Values : Total field gammas

RECEIVED
 16782
 NIXON-BARTLEMAN PROPERTY
 SCALE 1:5000

42A055W004 2 16782 KEEFER
 240

TEDDY BEAR VALLEY MINES, LTD
 NIXON-BARTLEMAN PROPERTY
 SIMS OPTION
 Ground Magnetic Survey Values
 NE Ontario Keefler and Hillary Twp
 NTS 42 A 5
 Survey by Rayan Exploration, July 1996
 Toronto July 1996