



#3021

W 8506-302

Mining



42A055W5004 W0506-00302 SEVELL

010

Name and Postal Address of Recorded Holder
R. U. Tremblay *Sewer stop* | *MI-20398*
380 Toke Street, Timmins *P.O. P4N 6V7*

Summary of Work Performance and Distribution of Credits

Total Work Days Cr. claimed	Mining Claim			Work Days Cr.	Mining Claim			Work Days Cr.	Mining Claim			Work Days Cr.
	Prefix	Number			Prefix	Number			Prefix	Number		
<i>40</i>												
for Performance of the following work. (Check one only)												
<input checked="" type="checkbox"/> Manual Work												
<input type="checkbox"/> Shaft Sinking Drifting or other Lateral Work.												
<input type="checkbox"/> Compressed Air, other Power driven or mechanical equip.												
<input type="checkbox"/> Power Stripping												
<input type="checkbox"/> Diamond or other Core drilling												
<input type="checkbox"/> Land Survey												
All the work was performed on Mining Claim(s): <i>P 798200 - P 798202 - P 831625</i>												

All the work was performed on Mining Claim(s): *P 798200 - P 798202 - P 831625*

Required Information eg: type of equipment, Names, Addresses, etc. (See Table Below)

R. U. Tremblay 380 Toke Street
Larry Levesque 336 Tamack
Claude Tremblay 380 Toke Street

Date of Report: *Aug 29/85* Recorded Holder or Agent (Signature): *R. U. Tremblay*

Certification Verifying Report of Work

I hereby certify that I have a personal and intimate knowledge of the facts set forth in the Report of Work annexed hereto, having performed the work or witnessed same during and/or after its completion and the annexed report is true.

Name and Postal Address of Person Certifying
R. U. Tremblay
380 Toke Street

Date Certified: *Aug 29/85* Certified by (Signature): *R. U. Tremblay*

Table of Information/Attachments Required by the Mining Recorder

Type of Work	Specific information per type	Other information (Common to 2 or more types)	Attachments
Manual Work	Nil	Names and addresses of men who performed manual work/operated equipment, together with dates and hours of employment.	Work Sketch: these are required to show the location and extent of work in relation to the nearest claim post.
Shaft Sinking, Drifting or other Lateral Work			
Compressed air, other power driven or mechanical equip.	Type of equipment	Names and addresses of owner or operator together with dates when drilling/stripping done.	Work Sketch (as
Power Stripping	Type of equipment and amount expended. Note: Proof of actual cost must be submitted within 30 days of recording.		
Diamond or other core	Signed core log showing: footage, diameter of		

REPORT

OF WORK



42A05575004 W0506-00302 SEWELL

900

WORK ON MINING CLAIM -

DATE	MANUAL WORK			MECHANICAL			TOTAL MEN HOURS		
	MEN	Pick Men Shovel Hours	Men Hours	MEN	Pluger Men	Hours	Pick	Shovel	Plugging
1985									
July									
12	1	4	.67	1	3	1			1.67
14	1	6	1	1	2	.67			1.67
16	2	3	1	2	6	4			5
17	1	4.5	.75	1	3	1			1.75
18	2	6	2						2
19	1	2	.33	1	8	2.67			3 P-798200
23	2	6.5	2.17	2	3	2			4.17
24	2	3.5	1.17	2	6	4			5.17
27	1	2.5	.42						.42
28	1	4	.67	1	4	1.33			2
31	2	9	3	2	1.5	3			6
0			13.18			19.67			32.85
Aug									
30	#	1	6	1	1	2	.67		1.67
4		2	5	1.67	2	3	2		3.67
6		2	8	2.67	2	1	.67		3.34
8		2	8	2.67	2	2	1.33		4
9		1	6	1					1 P-798202
10		1	4	.67					.67
11		2	8	2.67	2	1.5	1		3.67
12		2	8	2.67 15.67	2	.5	.33		3
14		1	4	.67	1	6	2		2.67 73.67
15		1	4	.67					.67
16		2	2.5	.83	2	6	4		4.83
17		1	5.5	.92					.92
19		2	4	1.33	2	2	1.33		2.66
20		2	3	1	2	3.5	2.33		3.33 P-83/625
21		2	4.5	1.5	2	6	4		5.5
22		1	6	1	1	2	.67		1.67
23		1	5.5	.92	1	4	1.33		2.25
26		2	5	1.67	2	3	2		3.67
27		1	8	1.33 11.17	1	2	.67 16.33		2
			32.85			24.33			51.19
Total			40.04			44.03			84.04

TWP. SEWELL

Claims # P831625 & P798202

N

4
831625
Manual work 11.17 days
Mechanical work 16.33 days
Total 27.50

798202
Manual work 15.69
Mechanical work 8
Total 23.69

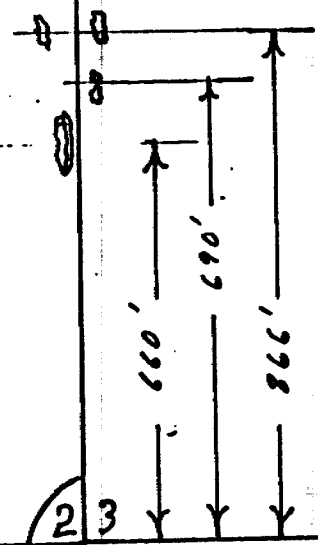

TWP. SEWELL
Claim # P 798206

N

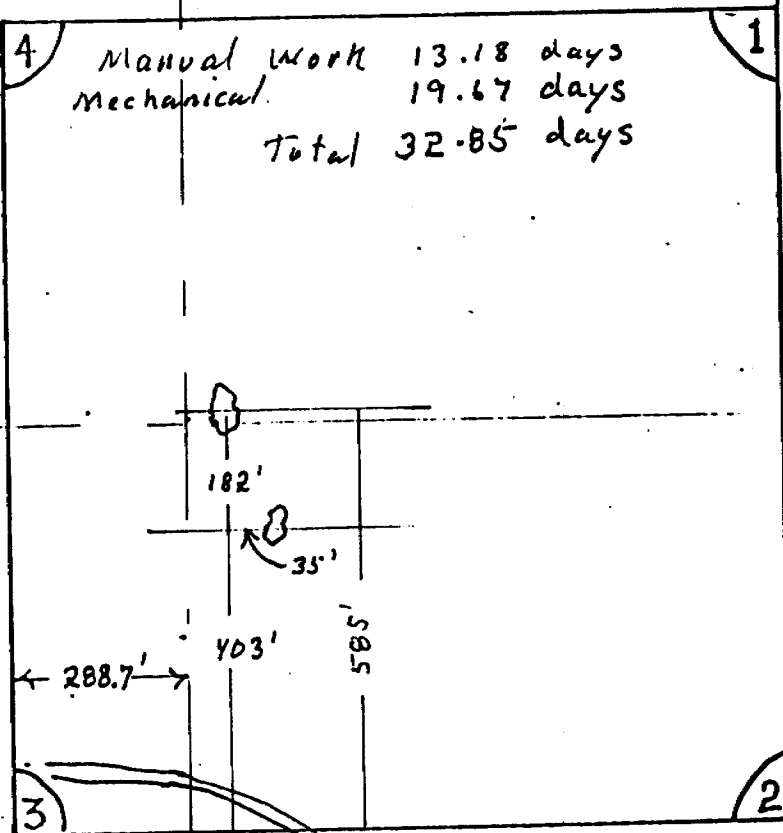

4 Manual Work 13.18 days
Mechanical 19.67 days
Total 32.85 days

Picket line

REE

Sewell Inj
C-3247

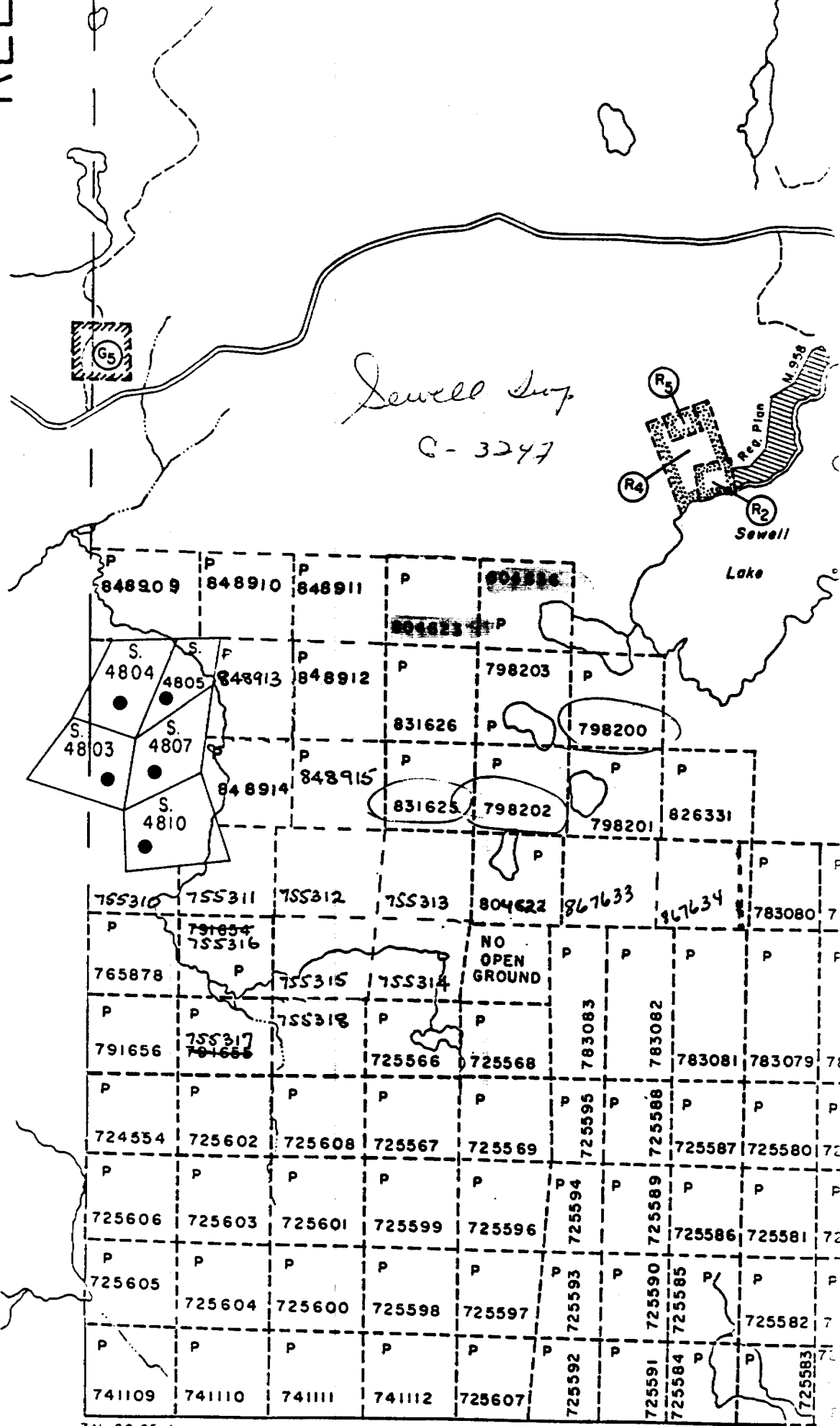

7 M. 29.25 chs.

6M