



42A06NE0019 2 16220 SHAW

010

2.16220



42A06NE0019 2.16220 SHAW

010C

[Faint, illegible text]

[Faint, illegible text]

[Faint, illegible text]

[Faint, illegible text]



[Faint, illegible text]

[Faint, illegible text]

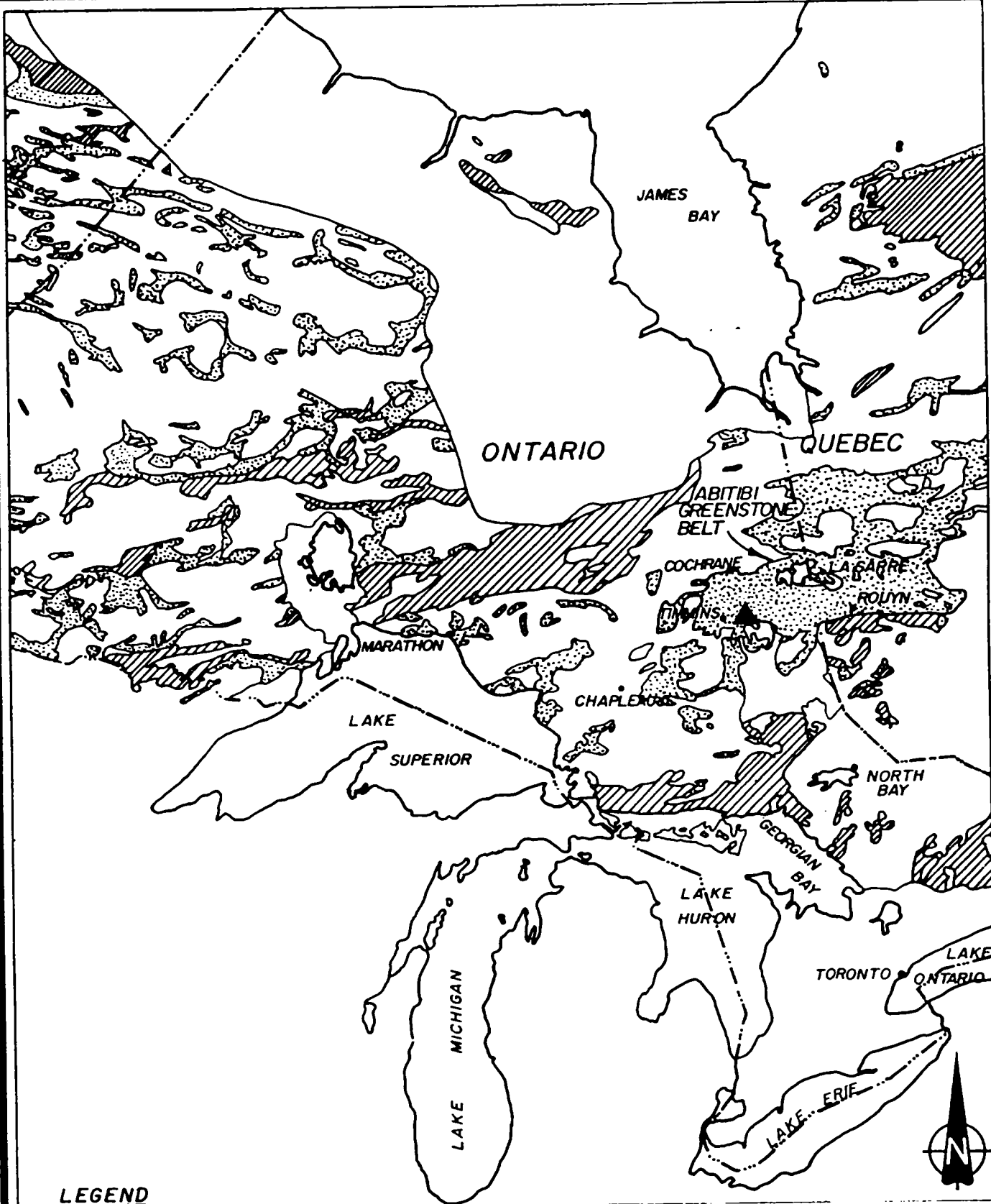
[Faint, illegible text]



LEGEND

-  Archean greenstone and associated Sediments
-  Granitic Terrain
-  Non Archean Sediments, volcanics, intrusions

SHAW PROPERTY		
Shaw Township, Ontario		
<u>PROPERTY LOCATION</u>		
Revisions	Date	Drawn
	NTS	Approvec
		Scale 1:7603200
		Figure 1

INTRODUCTION

The purpose of detailed linecutting, as well as geological mapping, is to determine the geological structure and composition of the area. The area is located in the Goose Lake and Hines National Forest, 23 miles southeast of South Fork, California.

The project was designed to determine the geological structure, locate gold-bearing zones, and to verify the existence of possible structural features of the area. The project was designed to determine the geological structure.

The field work was completed in the summer of 1968 and the results are presented in this report. The results are presented in this report.

TERMINOLOGY

The terms used in this report are defined as follows: 1. A linecut is a series of 10 sections, separated by 100 feet, which are used to determine the geological structure of the area. The lines are numbered as follows:

Line No.	Section No.
1100001	1
1100002	2
1100003	3
1100004	4
1100005	5
1100006	6
1100007	7
1100008	8
1100009	9
1100010	10

All linecuts are located in the area of the Goose Lake and Hines National Forest, 23 miles southeast of South Fork, California. The results are presented in this report.

LOCATION AND ACCESS

The area is located in the area of the Goose Lake and Hines National Forest, 23 miles southeast of South Fork, California. The results are presented in this report.

Access to the area is gained by traveling southward from the town of South Fork, California, via the Goose Lake and Hines National Forest, 23 miles southeast of South Fork, California. The results are presented in this report.

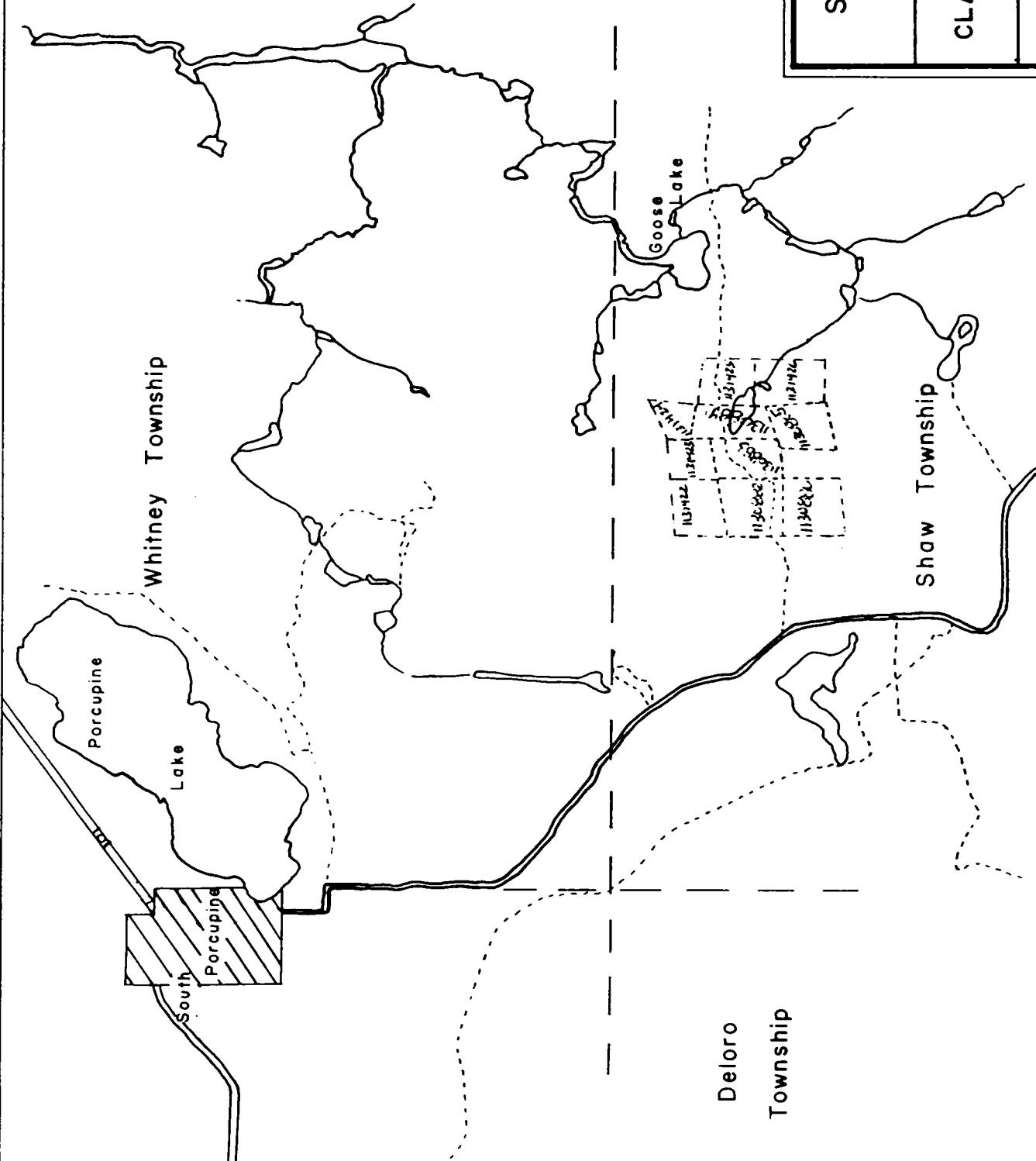

SHAW TOWNSHIP
PROPERTY

CLAIM LOCATION MAP

SCALE 1:50 000

Figure 2

	1107	0.07	pyritic quartz stringers in shale
	1108	0.07	mineralized buff
	1109	0.07	pyritic quartz stringers in shale
	1110	0.07	mineralized buff
	1111	0.07	pyritic quartz stringers in shale
	1112	0.07	mineralized buff
	1113	0.07	mineralized buff
	1114	0.07	pyritic andesite
	1115	0.07	mineralized buff
	1116	0.07	mineralized buff
	1117	0.07	mineralized buff
	1118	0.07	pyritic andesite
	1119	0.07	pyritic quartz vein
	1120	0.07	pyritic andesite, thin andesite
	1121	0.07	pyritic quartz vein
	1122	0.07	pyritic quartz vein
	1123	0.07	quartz carbonate sh. with pyritic veins, sh.

1124 - 1126 - pyritic andesite, sh., sh., sh.

1880: Aerial photo interpretation of a portion of the district belonging to Flint Rock Mines Limited. A geologic survey was completed on the district and a total of 21 diamond drill holes were sunk. Two of these holes penetrated the Iron Formation Zone while the others penetrated the Thin to Medium Zone. In the latter two holes the first 100 feet or so showed values of Au per ton over 10% (through sample), and 2.5 to 3.0 com. sample of gold per ton of sample ton. The purpose of the survey was subsequently dropped.

... the ... of the ... with ...
... the ... of the ... with ...
... the ... of the ... with ...

The ... of the ... with ...
... the ... of the ... with ...
... the ... of the ... with ...

... ..

The ... of the ... with ...
... the ... of the ... with ...
... the ... of the ... with ...

... ..

... ..

The ... of the ... with ...
... the ... of the ... with ...
... the ... of the ... with ...

... ..

1. The first part of the document discusses the importance of maintaining accurate records of all transactions. It emphasizes that proper record-keeping is essential for the integrity of the financial system and for the ability to detect and prevent fraud. The text notes that without reliable records, it would be difficult to verify the accuracy of financial statements and to identify any irregularities or discrepancies.

2. The second part of the document addresses the role of internal controls in ensuring the accuracy and reliability of financial information. It highlights that internal controls are designed to prevent errors and fraud, and to ensure that all transactions are properly authorized and recorded. The text stresses that a strong internal control system is a key component of an organization's risk management strategy and is essential for maintaining the trust of investors and other stakeholders.

3. The third part of the document discusses the importance of transparency and disclosure in financial reporting. It notes that providing clear and concise information about an organization's financial performance and position is crucial for making informed investment decisions. The text emphasizes that transparency is not only a legal requirement but also a best practice that can help to build confidence and credibility with the market.

4. The fourth part of the document focuses on the role of external audits in providing an independent and objective assessment of an organization's financial statements. It explains that external audits are conducted by qualified professionals who follow established standards and procedures to verify the accuracy and completeness of the financial records. The text notes that external audits are a critical component of the financial reporting process and provide a level of assurance that is essential for the reliability of financial information.

5. The fifth part of the document discusses the importance of ongoing monitoring and evaluation of the financial reporting process. It emphasizes that financial reporting is not a one-time event but a continuous process that requires regular review and improvement. The text notes that organizations should establish a framework for monitoring and evaluating their financial reporting practices to ensure that they remain effective and up-to-date with changing requirements and best practices.

6. The sixth part of the document concludes by summarizing the key points discussed and emphasizing the overall importance of a robust financial reporting system. It notes that a strong financial reporting system is essential for the success of any organization and for the stability of the financial system as a whole. The text encourages organizations to take a proactive approach to financial reporting and to continuously work to improve their practices to ensure the highest level of accuracy and transparency.

King Kuttu

Appendix A

PROBLEMAS DE CÁLCULO DE LA DERIVADA

Función	Derivada	Intervalo de Validad
f(x)	f'(x)	Intervalo de validad: $-\infty < x < \infty$
f(x)	f'(x)	Intervalo de validad: $-\infty < x < \infty$ excepto en $x = 0$
f(x)	f'(x)	Intervalo de validad: $-\infty < x < \infty$
f(x)	f'(x)	Intervalo de validad: $-\infty < x < \infty$
f(x)	f'(x)	Intervalo de validad: $-\infty < x < \infty$ excepto en $x = 0$
f(x)	f'(x)	Intervalo de validad: $-\infty < x < \infty$
f(x)	f'(x)	Intervalo de validad: $-\infty < x < \infty$
f(x)	f'(x)	Intervalo de validad: $-\infty < x < \infty$
f(x)	f'(x)	Intervalo de validad: $-\infty < x < \infty$
f(x)	f'(x)	Intervalo de validad: $-\infty < x < \infty$
f(x)	f'(x)	Intervalo de validad: $-\infty < x < \infty$
f(x)	f'(x)	Intervalo de validad: $-\infty < x < \infty$
f(x)	f'(x)	Intervalo de validad: $-\infty < x < \infty$
f(x)	f'(x)	Intervalo de validad: $-\infty < x < \infty$
f(x)	f'(x)	Intervalo de validad: $-\infty < x < \infty$

Appendix

List of Sample Numbers with Grid Coordinates(Blast Locations)

4000	0+38W/0+01S
4001	0+39W/0+01N
4002	0+49W/0+02N
4003	0+54W/0+05N
4004	0+56W/0+07N
4005	0+71W/BLO
4006	0+72W/0+01N
4007	0+98W/0+05S
4008	1+08W/0+02S
4009	1+06W/0+07S
4010	1+00W/0+01S
4011	0+17W/BLO
4012	0+24W/0+02N
4013	0+17W/0+01N
4014	0+42W/0+07N

RECEIVED

DEC 8 1995

MINING LANDS DIVISION

Labour

May 13 1995 8 hours-clearing out old overgrown trenches prior to drilling and blasting.
May 20 1995 16 hours-2 men-laying out and moving air hoses around, drilling holes with air driven plugger, loading holes, guarding blasts, blasting holes.

* Only 2 mandays at \$150/day were claimed.

Note: No new trenches were excavated. The blasting was carried out in selected locations in order to obtain fresh rock samples from highly oxidized bedrock exposures in and around old trenches some of which existed since the early 1900's.

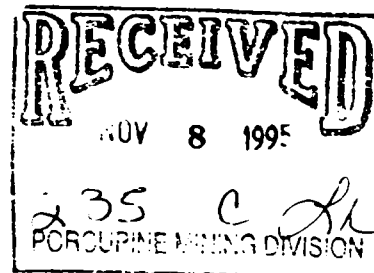

27-16220



Swastika Laboratories

A Division of TSL/Assayers Inc.

Assaying - Consulting - Representation

Established 1928

Assay Certificate

5W-2541-RA1

Company: **H. HUTTERI**

Date: JUN-09-95

Project:

Attn: **H. Hutteri**

We hereby certify the following Assay of 15 Rock samples submitted JUN-06-95 by .

Sample Number	Au oz / ton	Au Check oz / ton
4000	0.002	-
4001	0.002	-
4002	Nil	-
4003	0.006	0.006
4004	0.005	-
4005	Nil	-
4006	Nil	-
4007	0.001	-
4008	Nil	-
4009	0.003	0.003
4010	Nil	-
4011	0.003	0.003
4012	Nil	-
4013	0.006	0.006
4014	Nil	-

One assay ton portion used.

Certified by 



Report of Work Conducted After Recording Claim

Mining Act

Transaction Number
W9560, 00320

Personal information collected on this form is obtained under the authority of the Mining Act. This information will be used for correspondence. Questions about this collection should be directed to the Provincial Manager, Mining Lands, Ministry of Northern Development and Mines, Fourth Floor, 159 Cedar Street, Sudbury, Ontario, P3E 6A5, telephone (705) 670-7264.

- Instructions:**
- Please type or print and submit in duplicate.
 - Refer to the Mining Act and Regulations for re Recorder.
 - A separate copy of this form must be complet
 - Technical reports and maps must accompany
 - A sketch, showing the claims the work is assign



42A06NE0019 2 16220 SHAW

900

Recorded Holder(s) <i>Henry Hutter, Ed Kerba</i>		Client No. <i>147174, 153331</i>
Address <i>Box 59, Porcupine, Ont. P2N1C0</i>		Telephone No. <i>255-3546</i>
Mining Division <i>PORCUPINE</i>	Township/Area <i>SHAW</i>	M or G Plan No. <i>C-3999</i>
Dates Work Performed	From: <i>July 1/95</i>	To: <i>July 31/95</i>

Work Performed (Check One Work Group Only)

Work Group	Type
Geotechnical Survey	
Physical Work, Including Drilling	<i>Plugging, clearing around trenches, blasting</i>
Rehabilitation	
Other Authorized Work	
Assays	
Assignment from Reserve	

RECEIVED

DEC 8 1995

MINING LANDS BRANCH

Total Assessment Work Claimed on the Attached Statement of Costs \$ 443

Note: The Minister may reject for assessment work credit all or part of the assessment work submitted if the recorded holder cannot verify expenditures claimed in the statement of costs within 30 days of a request for verification.

Persons and Survey Company Who Performed the Work (Give Name and Address of Author of Report)

Name	Address
<i>Henry Hutter</i>	<i>Box 59, Porcupine, Ont. P2N1C0</i>
<i>Ed Kerba</i>	<i>R.R. 1, Sennagoht, Ont. P2N1A0</i>

(attach a schedule if necessary)

Certification of Beneficial Interest * See Note No. 1 on reverse side

I certify that at the time the work was performed, the claims covered in this work report were recorded in the current holder's name or held under a beneficial interest by the current recorded holder.	Date <i>July 17/95</i>	Recorded Holder or Agent (Signature) <i>Henry Hutter</i>
--	---------------------------	---

Certification of Work Report

I certify that I have a personal knowledge of the facts set forth in this Work report, having performed the work or witnessed same during and/or after its completion and annexed report is true.		
Name and Address of Person Certifying <i>Henry Hutter, Box 59, Porcupine, Ont. P2N1C0</i>		
Telephone No. <i>255-3546</i>	Date <i>July 17/95</i>	Certified By (Signature) <i>Henry Hutter</i>

For Office Use Only

Total Value Cr. Recorded <i>443</i>	Date Recorded	Mining Recorder	
	Deemed Approval Date <i>Oct 19/95</i>	Date Approved <i>July 8/95</i>	
	Date Notice for Amendments Sent <i>Oct 18/95</i>		



Ministry of
Northern Development
and Mines

Ministère du
Développement du Nord
et des mines

**Statement of Costs
for Assessment Credit**

**État des coûts aux fins
du crédit d'évaluation**

Mining Act/Loi sur les mines

Transaction No./N° de transaction
W9560.00320

Personal information collected on this form is obtained under the authority of the Mining Act. This information will be used to maintain a record and ongoing status of the mining claim(s). Questions about this collection should be directed to the Provincial Manager, Minings Lands, Ministry of Northern Development and Mines, 4th Floor, 159 Cedar Street, Sudbury, Ontario P3E 6A5, telephone (705) 670-7264.

Les renseignements personnels contenus dans la présente formule sont recueillis en vertu de la Loi sur les mines et serviront à tenir à jour un registre des concessions minières. Adresser toute question sur la collecte de ces renseignements au chef provincial des terrains miniers, ministère du Développement du Nord et des Mines, 159, rue Cedar, 4^e étage, Sudbury (Ontario) P3E 6A5, téléphone (705) 670-7264.

1. Direct Costs/Coûts directs

Type	Description	Amount Montant	Totals Total global
Wages Salaires	Labour ^{clearing and} Main-d'oeuvre ^{travaux plugger,} ^{blasting}	2 days @ 150/d	300 ⁰⁰
	Field Supervision Supervision sur le terrain		
Contractor's and Consultant's Fees Droits de l'entrepreneur et de l'expert- conseil	Type		
Supplies Used Fournitures utilisées	Type		
Equipment Rental Location de matériel	Type Plugger, compressor		
	400' hose rental	143 ²⁹	143 ²⁹
Total Direct Costs Total des coûts directs			443²⁹

2. Indirect Costs/Coûts indirects

** Note: When claiming Rehabilitation work Indirect costs are not allowable as assessment work.
Pour le remboursement des travaux de réhabilitation, les coûts indirects ne sont pas admissibles en tant que travaux d'évaluation.

Type	Description	Amount Montant	Totals Total global
Transportation Transport	Type		
Food and Lodging Nourriture et hébergement	MINING LANDS CHANGE		
Mobilization and Demobilization Mobilisation et démobilisation			
Sub Total of Indirect Costs Total partiel des coûts indirects			
Amount Allowable (not greater than 20% of Direct Costs) Montant admissible (n'excédant pas 20 % des coûts directs)			
Total Value of Assessment Credit (Total of Direct and Allowable indirect costs)		Valeur totale du crédit d'évaluation (Total des coûts directs et indirects admissibles)	443²⁹

Note: The recorded holder will be required to verify expenditures claimed in this statement of costs within 30 days of a request for verification. If verification is not made, the Minister may reject for assessment work all or part of the assessment work submitted.

Note : Le titulaire enregistré sera tenu de vérifier les dépenses demandées dans le présent état des coûts dans les 30 jours suivant une demande à cet effet. Si la vérification n'est pas effectuée, le ministre peut rejeter tout ou une partie des travaux d'évaluation présentés.

Filing Discounts

1. Work filed within two years of completion is claimed at 100% of the above Total Value of Assessment Credit.
2. Work filed three, four or five years after completion is claimed at 50% of the above Total Value of Assessment Credit. See calculations below:

Total Value of Assessment Credit	Total Assessment Claimed
	x 0.50 =

Remises pour dépôt

1. Les travaux déposés dans les deux ans suivant leur achèvement sont remboursés à 100 % de la valeur totale susmentionnée du crédit d'évaluation.
2. Les travaux déposés trois, quatre ou cinq ans après leur achèvement sont remboursés à 50 % de la valeur totale du crédit d'évaluation susmentionné. Voir les calculs ci-dessous.

Valeur totale du crédit d'évaluation	Évaluation totale demandée
	x 0,50 =

Certification Verifying Statement of Costs

I hereby certify:
that the amounts shown are as accurate as possible and these costs were incurred while conducting assessment work on the lands shown on the accompanying Report of Work form.

that as Recorded holder, partner I am authorized
(Recorded Holder, Agent, Position in Company)

to make this certification

Attestation de l'état des coûts

J'atteste par la présente :
que les montants indiqués sont le plus exact possible et que ces dépenses ont été engagées pour effectuer les travaux d'évaluation sur les terrains indiqués dans la formule de rapport de travail ci-joint.

Et qu'à titre de _____ je suis autorisé
(titulaire enregistré, représentant, poste occupé dans la compagnie)

à faire cette attestation.

Signature Henry Katten Date July 20/95



Ministry of Northern Development and Mines

Ministère du Développement du Nord et des mines

Statement of Costs for Assessment Credit

État des coûts aux fins du crédit d'évaluation

Mining Act/Loi sur les mines

Transaction No./N° de transaction
W9560.00320

Personal information collected on this form is obtained under the authority of the Mining Act. This information will be used to maintain a record and ongoing status of the mining claim(s). Questions about this collection should be directed to the Provincial Manager, Minings Lands, Ministry of Northern Development and Mines, 4th Floor, 188 Cedar Street, Sudbury, Ontario P3E 6A5, telephone (705) 670-7264.

Les renseignements personnels contenus dans la présente formule sont recueillis en vertu de la Loi sur les mines et serviront à tenir à jour un registre des concessions minières. Adresser toute question sur la collecte de ces renseignements au chef provincial des terrains miniers, ministère du Développement du Nord et des Mines, 159, rue Cedar, 4^e étage, Sudbury (Ontario) P3E 6A5, téléphone (705) 670-7264.

1. Direct Costs/Coûts directs

Type	Description	Amount Montant	Totals Total global
Wages Salaires	Labour ^{clearing work} / Main-d'œuvre ^{plugging, blasting}	2 days @ 150/d	300.00
	Field Supervision Supervision sur le terrain		
Contractor's and Consultant's Fees Droits de l'entrepreneur et de l'expert-consult	Type		
Supplies Used Fournitures utilisées	Type		
Equipment Rental Location de matériel	Type		
	Plugging compressor 400' hose rental	173.29	173.29
Total Direct Costs / Total des coûts directs			443.29

2. Indirect Costs/Coûts indirects

** Note: When claiming Rehabilitation work Indirect costs are not allowable as assessment work. Pour le remboursement des travaux de réhabilitation, les coûts indirects ne sont pas admissibles en tant que travaux d'évaluation.

Type	Description	Amount Montant	Totals Total global
Transportation Transport	Type		
Food and Lodging Nourriture et hébergement			
Mobilization and Demobilization Mobilisation et démoblisation			
Sub Total of Indirect Costs / Total partiel des coûts indirects			
Amount Allowable (not greater than 20% of Direct Costs) / Montant admissible (n'excédant pas 20 % des coûts directs)			
Total Value of Assessment Credit (Total of Direct and Allowable indirect costs) / Valeur totale de crédit d'évaluation (Total des coûts directs et indirects admissibles)			443.29

Note: The recorded holder will be required to verify expenditures claimed in this statement of costs within 30 days of a request for verification. If verification is not made, the Minister may reject for assessment work all or part of the assessment work submitted.

Note: Le titulaire enregistré sera tenu de vérifier les dépenses demandées dans le présent état des coûts dans les 30 jours suivant une demande à cet effet. Si la vérification n'est pas effectuée, le ministre peut rejeter tout ou une partie des travaux d'évaluation présentés.

Filing Discounts

- Work filed within two years of completion is claimed at 100% of the above Total Value of Assessment Credit.
- Work filed three, four or five years after completion is claimed at 50% of the above Total Value of Assessment Credit. See calculations below:

Total Value of Assessment Credit	Total Assessment Claimed
	× 0.50 =

Remises pour dépôt

- Les travaux déposés dans les deux ans suivant leur achèvement sont remboursés à 100 % de la valeur totale susmentionnée du crédit d'évaluation.
- Les travaux déposés trois, quatre ou cinq ans après leur achèvement sont remboursés à 50 % de la valeur totale du crédit d'évaluation susmentionné. Voir les calculs ci-dessous.

Valeur totale du crédit d'évaluation	Evaluation totale demandée
	× 0,50 =

Certification Verifying Statement of Costs

I hereby certify: that the amounts shown are as accurate as possible and these costs were incurred while conducting assessment work on the lands shown on the accompanying Report of Work form.

that as Recorded holder, partner I am authorized (Recorded Holder, Agent, Partner in Company)

to make this certification

Attestation de l'état des coûts

J'atteste par la présente: que les montants indiqués sont le plus exact possible et que ces dépenses ont été engagées pour effectuer les travaux d'évaluation sur les terrains indiqués dans la formule de rapport de travail ci-joint.

Et qu'à titre de titulaire enregistré, représentant, poste occupé dans la compagnie je suis autorisé

à faire cette attestation.

Signature: Henry Kathan Date: July 20/95

Report of Work Conducted After Recording Claim

Mining Act

Transaction Number
W9560.00322

Personal information collected on this form is obtained under the authority of the Mining Act. This information will be used for correspondence. Questions about this collection should be directed to the Provincial Manager, Mining Lands, Ministry of Northern Development and Mines, Fourth Floor, 159 Cedar Street, Sudbury, Ontario, P3E 6A5, telephone (705) 670-7264.

2.16220

- Instructions:**
- Please type or print and submit in duplicate.
 - Refer to the Mining Act and Regulations for requirements of filing assessment work or consult the Mining Recorder.
 - A separate copy of this form must be completed for each Work Group.
 - Technical reports and maps must accompany this form in duplicate.
 - A sketch, showing the claims the work is assigned to, must accompany this form.

Recorded Holder(s) <i>Henry Hutteri, Ed Korba</i>		Client No. <i>147174, 153331</i>
Address <i>Box 59, Porcupine, Ont. P0N1C0</i>		Telephone No. <i>235-3546</i>
Mining Division <i>Porcupine</i>	Township/Area <i>Shaw Twp</i>	M or G Plan No. <i>6-3999</i>
Dates Work Performed From: <i>May 1/95</i>		To: <i>June 30/95</i>

Work Performed (Check One Work Group Only)

Work Group	Type
<input type="checkbox"/> Geotechnical Survey	<i>Geology, Magnetic Surveys, linecutting.</i>
<input type="checkbox"/> Physical Work, Including Drilling	
<input type="checkbox"/> Rehabilitation	
<input type="checkbox"/> Other Authorized Work	<i>Prospecting</i>
<input type="checkbox"/> Assays	<i>Rock assaying</i>
<input type="checkbox"/> Assignment from Reserve	

RECEIVED

OCT 05 1995

MINING LANDS BRANCH

Total Assessment Work Claimed on the Attached Statement of Costs \$ 3193

Note: The Minister may reject for assessment work credit all or part of the assessment work submitted if the recorded holder cannot verify expenditures claimed in the statement of costs within 30 days of a request for verification.

Persons and Survey Company Who Performed the Work (Give Name and Address of Author of Report)

Name	Address
<i>Henry Hutteri</i>	<i>Box 59, Porcupine, Ont P0N1C0</i>
<i>Ed Korba</i>	<i>R.R. 1, Connaught, Ont. P0N1A0</i>

(Attach a schedule if necessary)

Certification of Beneficial Interest * See Note No. 1 on reverse side

I certify that at the time the work was performed, the claims covered in this work report were recorded in the current holder's name or held under a beneficial interest by the current recorded holder.	Date <i>July 17/95</i>	Recorded Holder or Agent (Signature) <i>Henry Hutteri</i>
--	---------------------------	--

Certification of Work Report

I certify that I have a personal knowledge of the facts set forth in this Work report, having performed the work or witnessed same during and/or after its completion and annexed report is true.

Name and Address of Person Certifying <i>Henry Hutteri, Box 59, Porcupine, Ont. P0N1C0</i>		
Telephone No. <i>235-3546</i>	Date <i>July 17/95</i>	Certified By (Signature) <i>Henry Hutteri</i>

Recorder Office Use Only

Total Value Cr. Recorded <i>3193</i>	Date Recorded	Mining Recorder <i>[Signature]</i>	<div style="border: 2px solid black; padding: 10px; display: inline-block;"> <p style="margin: 0;">RECEIVED</p> <p style="margin: 0;">JUL 21 1995</p> <p style="margin: 0;">1135 C Lic</p> <p style="margin: 0; font-size: small;">PORCUPINE MINING DIVISION</p> </div>
Deemed Approval Date <i>OCT. 19/95</i>	Date Approved	<i>[Signature]</i>	
Date Notice for Amendments Sent			

Work Report Number for Applying Reserve	Claim Number (see Note 2)	Number of Claim Units
	1130882	1
	1130883	1
	1131422	1
	1131423	1
	1131424	1
	1131425	1
	1131426	1
	1130584	1
	1130885	1
	1130886	1
Total Number of Claims		10

Value of Assessment of Work Done on the Claim	Value Applied to this Claim	
1958 #	325	
1915 #	315	
160	220	
160	220	
160	220	
0	220	
0	220	
0	220	
0	325	
0	325	
0	-	
Total Value Work Done		3193
Total Value Work Applied		2390 #

Value Assigned from this Claim	Reserve: Work to be Claimed at a Future Date	
1430 #	633 #	
170		
1430 #		
170		
1430 #		
170		
1430 #		
170		
1430 #		
170		
Total Assigned From		1430 #
Total Reserve		803

Credits you are claiming in this report may be cut back. In order to minimize the adverse effects of such deletions, please indicate from which claims you wish to prioritize the deletion of credits. Please mark (✓) one of the following:

- Credits are to be cut back starting with the claim listed last, working backwards.
- Credits are to be cut back equally over all claims contained in this report of work.
- Credits are to be cut back as prioritized on the attached appendix.

x cut back Reserve.
In the event that you have not specified your choice of priority, option one will be implemented.

2.16220

Note 1: Examples of beneficial interest are unrecorded transfers, option agreements, memorandum of agreements, etc., with respect to the mining claims.

Note 2: If work has been performed on patented or leased land, please complete the following:

I certify that the recorded holder had a beneficial interest in the patented or leased land at the time the work was performed.	Signature <i>Kenny Kuttner</i>	Date <i>July 27/95</i>
---	-----------------------------------	---------------------------



**Statement of Costs
for Assessment Credit**

**État des coûts aux fins
du crédit d'évaluation**

Mining Act/Loi sur les mines

Transaction No./N° de transaction
W9560.00322

2.16220

Personal information collected on this form is obtained under the authority of the Mining Act. This information will be used to maintain a record and ongoing status of the mining claim(s). Questions about this collection should be directed to the Provincial Manager, Minings Lands, Ministry of Northern Development and Mines, 4th Floor, 159 Cedar Street, Sudbury, Ontario P3E 6A5, telephone (705) 670-7264.

Les renseignements personnels contenus dans la présente formule sont recueillis en vertu de la Loi sur les mines et serviront à tenir à jour un registre des concessions minières. Adresser toute question sur la collecte de ces renseignements au chef provincial des terrains miniers, ministère du Développement du Nord et des Mines, 159, rue Cedar, 4^e étage, Sudbury (Ontario) P3E 6A5, téléphone (705) 670-7264.

1. Direct Costs/Coûts directs

Type	Description	Amount Montant	Totals Total global
Wages Salaires Distilling	Labour Main-d'oeuvre Field Supervision Supervision sur le terrain	9 days @ 150/d	1350
Contractor's and Consultant's Fees Droits de l'entrepreneur et de l'expert- conseil	Type Culogy & Supervision	4 days @ 250/d	1000
	Report	2 days @ 250/d	500
			1500
Supplies Used Fournitures utilisées	Type Issuance	184.58	184.58
			184.58
Equipment Rental Location de matériel	Type EDA May	53.50	53.50
			53.50
Total Direct Costs Total des coûts directs			3088.58

2. Indirect Costs/Coûts indirects

** Note: When claiming Rehabilitation work Indirect costs are not allowable as assessment work.
Pour le remboursement des travaux de réhabilitation, les coûts indirects ne sont pas admissibles en tant que travaux d'évaluation.

Type	Description	Amount Montant	Totals Total global
Transportation Transport	Type 11.1 reg 2	350 km @ .30	105.00
Food and Lodging Nourriture et hébergement			
Mobilization and Demobilization Mobilisation et démobilisation			
Sub Total of Indirect Costs Total partiel des coûts indirects			
Amount Allowable (not greater than 20% of Direct Costs) Montant admissible (n'excedant pas 20 % des coûts directs)			105.00
Total Value of Assessment Credit (Total of Direct and Allowable indirect costs)			3193.58
Valeur totale du crédit d'évaluation (Total des coûts directs et indirects admissibles)			

Note: The recorded holder will be required to verify expenditures claimed in this statement of costs within 30 days of a request for verification. If verification is not made, the Minister may reject for assessment work all or part of the assessment work submitted.

Note : Le titulaire enregistré sera tenu de vérifier les dépenses demandées dans le présent état des coûts dans les 30 jours suivant une demande à cet effet. Si la vérification n'est pas effectuée, le ministre peut rejeter tout ou une partie des travaux d'évaluation présentés.

Filing Discounts

- Work filed within two years of completion is claimed at 100% of the above Total Value of Assessment Credit.
- Work filed three, four or five years after completion is claimed at 50% of the above Total Value of Assessment Credit. See calculations below.

Total Value of Assessment Credit	Total Assessment Claimed
	x 0.50 =

Remises pour dépôt

- Les travaux déposés dans les deux ans suivant leur achèvement sont remboursés à 100 % de la valeur totale susmentionnée du crédit d'évaluation.
- Les travaux déposés trois, quatre ou cinq ans après leur achèvement sont remboursés à 50 % de la valeur totale du crédit d'évaluation susmentionné. Voir les calculs ci-dessous.

Valeur totale du crédit d'évaluation	Évaluation totale demandée
	x 0,50 =

Certification Verifying Statement of Costs

I hereby certify:
that the amounts shown are as accurate as possible and these costs were incurred while conducting assessment work on the lands shown on the accompanying Report of Work form.

that as Recorded Holder, partner I am authorized
(Recorded Holder, Agent, Position in Company)

to make this certification

Attestation de l'état des coûts

J'atteste par la présente :
que les montants indiqués sont le plus exact possible et que ces dépenses ont été engagées pour effectuer les travaux d'évaluation sur les terrains indiqués dans la formule de rapport de travail ci-joint.

Et qu'à titre de _____ je suis autorisé
(titulaire enregistré, représentant, poste occupé dans la compagnie)

à faire cette attestation.

Signature: Henry Kettler Date: July 26/95

Ministry of
Northern Development
and Mines

Ministère du
Développement du Nord
et des Mines

Geoscience Approvals Office
933 Ramsey Lake Road
6th Floor
Sudbury, Ontario
P3E 6B5

AMENDED

Telephone: (705) 670-5853
Fax: (705) 670-5863

December 18, 1995

Our File: 2.16220
Transaction #W9560.00322

Mining Recorder
Ministry of Northern Development & Mines
60 Wilson Avenue, 1st Floor
Timmins, Ontario
P4N 2S7

Dear Mr. White:

**RE: APPROVAL OF NOTICE OF DEFICIENCY ISSUED ON MINING CLAIMS
1130882 ET AL. IN SHAW TOWNSHIP.**

Information received by our office on December 8, 1995 indicates that the deficiencies associated with this submission were corrected and submitted to the Timmins Mining Recorder's Office on November 8, 1995. The deficiencies were corrected prior to the November 24, 1995 date indicated in the Notice of Deficiency.

Therefore assessment work credits have been approved as outlined on the original report of work forms for this submission. The assessment work credits have been approved under Sections 14, 17, and 12, Geophysics, Assays, and Geology, Mining Act Regulations.

THE APPROVAL DATE IS NOVEMBER 28, 1995. PLEASE INDICATE THIS APPROVAL ON THE CLAIM RECORD SHEETS.

MARK

2 Report of
works.

Physical not
signed by Recorder

Bruce

.../2

-2-

December 15, 1995
Recording Office - Timmins, Ontario

If you require any additional assistance please contact Bruce Gates
at (705) 670-5861.

Yours sincerely,
ORIGINAL SIGNED BY:



Ron C. Gashinski
Senior Manager, Mining Lands Section
Mining and Land Management Branch
Mines and Minerals Division

BIG BIG/jl
Enclosure:

cc: Resident Geologist
Timmins, Ontario

✓ Assessment Files Library
Sudbury, Ontario

MAP SYMBOLOGY

- | | |
|-------------------------------|-------------------------|
| Aerial Cableway | Pipeline (above ground) |
| Boundary | Railroad |
| International | Single Track |
| Double Track | Double Track |
| Disturbance | Abandoned |
| Lot, Concession | Road |
| Approximate | Highway, County |
| Approximate | Township |
| Park Boundary | Watercourse of doubtful |
| Bridge | importance of |
| Dam, Railroad | subdivision (dashed) |
| Building | Tram, Beam Road |
| Chimney | (single or double) |
| Cliff, Pit, Pile | Rapids |
| Contours | Double line river |
| Interpretation | with multiple rapids |
| Approximate | Reservoir |
| Depression | River, Stream, Canal |
| Control Points | Approximate |
| Horizontal | position |
| Vertical | location of file |
| Culvert | hoop |
| Ditch line river | Spot Elevation |
| Fence, Hedge, Wall | (above natural) |
| Feature Outline | Tower |
| (Construction features, etc.) | Transmission Line |
| Flooded Land | Power |
| Lock | Lines |
| Marsh or Swamp | Utility Poles |
| Mast | Wharf, Dock, Pier |
| Mine Head Frame | Wooded Area |
| Outcrop | |

AREAS WITHDRAWN FROM DISPOSITION

Description	Order No.	Date	Disposition	File
M.R.O. - MINING RIGHTS ONLY				
S.R.O. - SURFACE RIGHTS ONLY				
M.+S. - MINING AND SURFACE RIGHTS				
REC. PUMP	SEC 5 PLA			18843
	W 9177	18/12/77	B.R.O.	88206

SAND AND GRAVEL

⊙ GRAVEL 88668

⊙ GRAVEL 88780

⊙ THIS TWP SUBJECT TO FOREST ACTIVITY IN 1985/1986 FURTHER INFORMATION AVAILABLE ON FILE.

THE INFORMATION THAT APPEARS ON THIS MAP HAS BEEN COMPILED FROM VARIOUS SOURCES AND ACCURACY IS NOT GUARANTEED. THOSE WISHING TO STAKE MINING CLAIMS SHOULD CONSULT WITH THE MINING RECORDER, MINISTRY OF NORTHERN DEVELOPMENT AND MINES, FOR ADDITIONAL INFORMATION ON THE STATUS OF THE LANDS SHOWN HEREON.

WHITNEY TWP.

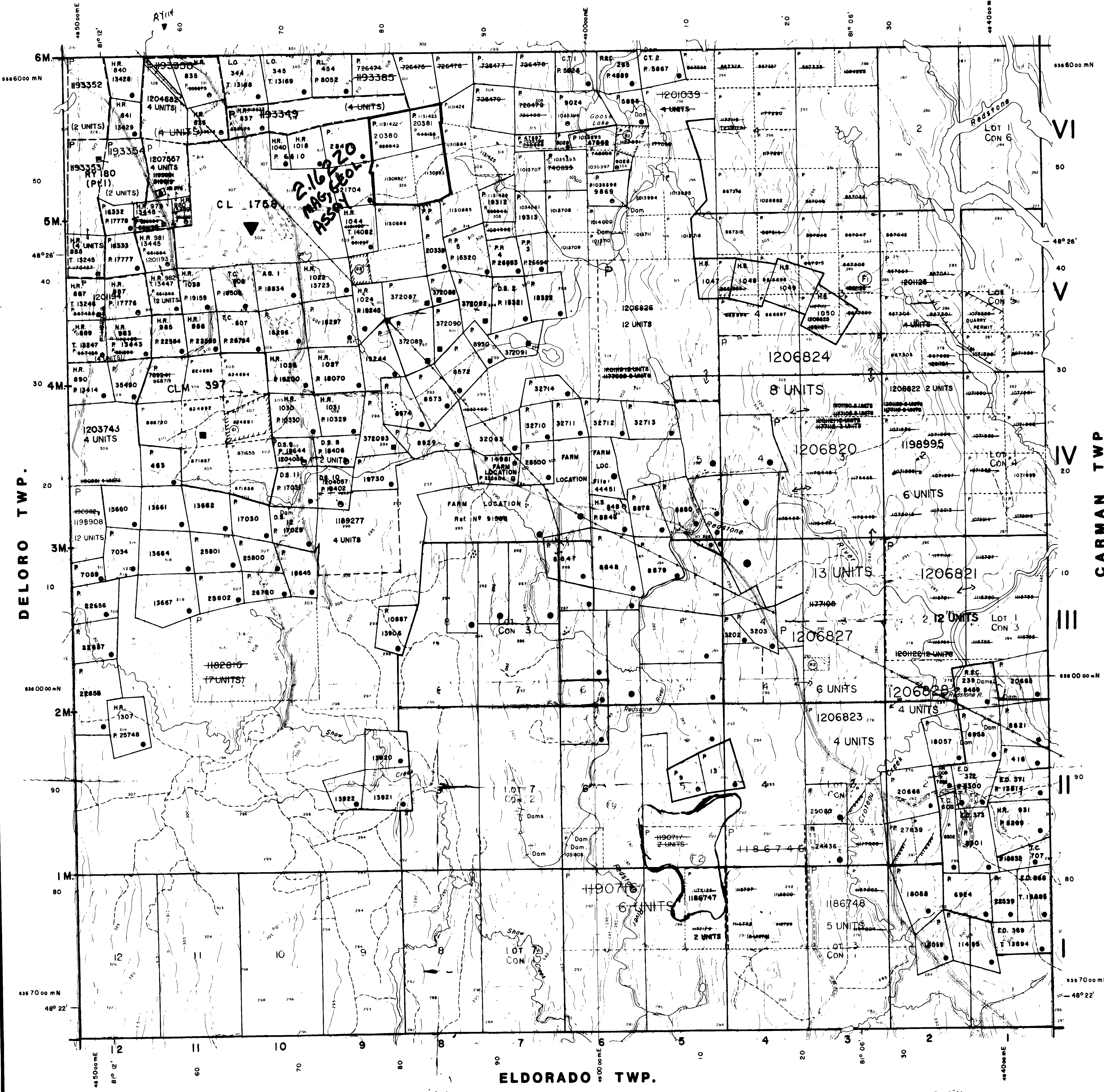

LEGEND

- | | |
|------------------------------------|--|
| HIGHWAY AND ROUTE No. | |
| OTHER ROADS | |
| TRAILS | |
| SURVEYED LINES | |
| TOWNSHIP, BASE LINES, ETC. | |
| LOTS, MINING CLAIMS, PARCELS, ETC. | |
| UNSURVEYED LINES | |
| LOT LINES | |
| PARCEL BOUNDARY | |
| MINING CLAIMS ETC. | |
| RAILWAY AND RIGHT OF WAY | |
| UTILITY LINES | |
| NON PERENNIAL STREAM | |
| FLOODING OR FLOODING RIGHTS | |
| SUBDIVISION OR COMPOSITE PLAN | |
| RESERVATIONS | |
| ORIGINAL SHORELINE | |
| MARSH OR MUSKIEG | |
| MINES | |
| TRAVERSE MONUMENT | |

DISPOSITION OF CROWN LANDS

TYPE OF DOCUMENT	SYMBOL
PATENT, SURFACE & MINING RIGHTS	
" SURFACE RIGHTS ONLY	
" MINING RIGHTS ONLY	
LEASE, SURFACE & MINING RIGHTS	
" SURFACE RIGHTS ONLY	
" MINING RIGHTS ONLY	
LICENCE OF OCCUPATION	
ORDER-IN-COUNCIL	
RESERVATION	
CANCELLED	
SAND & GRAVEL	

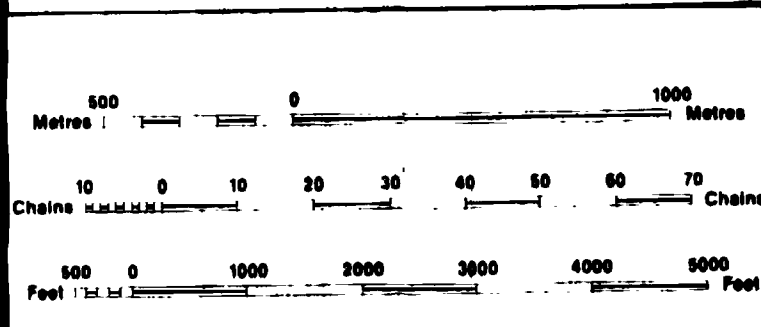

SCALE 1:20 000
GRID ZONE 17

2.16220

TOWNSHIP

SHAW

M.N.R. ADMINISTRATIVE DISTRICT

TIMMINS

MINING DIVISION

PORCUPINE

LAND TITLES / REGISTRY DIVISION

COCHRANE

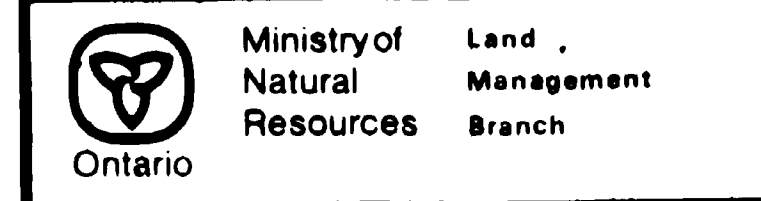

ORIGINAL COMPILATION JULY 1984

REVISED IN SERVICE DEC 9, 1985

Number **G-3999**

MAP SYMBOLOLOGY

Aerial Cableway	Pipelene (above ground)
Boundary	Railroad
Interpretation	Double Track
Historical Township	Abandoned
Historical Reserve	Turbidite
Historical	Road
Lot, Concession	Highway, County
Appropriation	Yanobio
Farm Boundary	Access Road of doubtful maintenance or equipment driveway
Bridge	Trail, Bush Road (single track)
Road, Railroad	Rapids
Building	Double line river with multiple rapids
Chimney	Reservoir
Chief, Pit, Pile	River, Stream, Canal
Contours	Approximate Direction of flow
Interpretation	Rock
Appropriation	Manifestation
Control Points	Spot Elevation (from elevations)
Horizontal	Transmission Line
Vertical	Pit
Culvert	Pit
Ridge line river with multiple rapids	Tower
Fence, Hedge, Wall	Tunnel
Feature Outline (concentration features, etc.)	
Flooded Land	
Leak	
Marsh or Swamp	
Mud	
Mud Head Frame	
Wire	

AREAS WITHDRAWN FROM DISPOSITION

Description	Order No.	Date	Disposition	File
R.R. PURA SEC 3 PLA				100043
V. 97/77	18/18/77	S.R.O.		00000

SAND AND GRAVEL

GRAVEL	55000
SAND	60000

THIS TWP SUBJECT TO FOREST ACTIVITY IN 1995/96
FURTHER INFORMATION AVAILABLE ON FILE.

THE INFORMATION THAT APPEARS ON THIS MAP HAS BEEN COMPILED FROM VARIOUS SOURCES AND ACCURACY IS NOT GUARANTEED. THOSE WISHING TO STAKE MINING CLAIMS SHOULD CONSULT WITH THE MINING RECORDER, MINISTRY OF NORTHERN DEVELOPMENT AND MINES, FOR ADDITIONAL INFORMATION ON THE STATUS OF THE LANDS SHOWN HEREON.

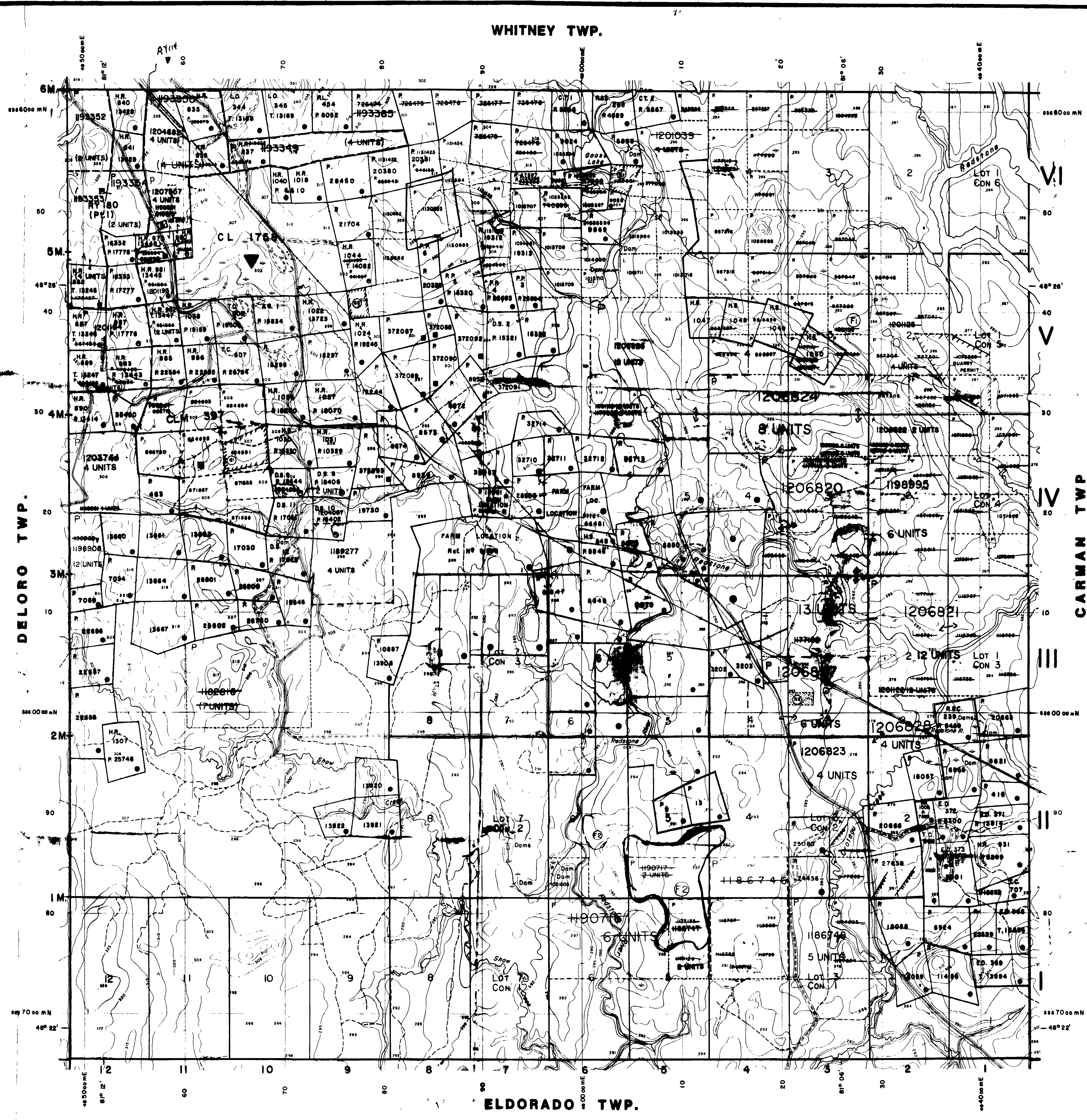

LEGEND

HIGHWAY AND ROUTE No.	OTHER ROADS
TRAILS	SURVEYED LINES: TOWNSHIP, BASE LINES, ETC.
UNSURVEYED LINES: LOT LINES	PARCEL BOUNDARY
MINING CLAIMS ETC.	RAILWAY AND RIGHT OF WAY
UTILITY LINES	NON-PERENNIAL STREAM
FLOODING OR FLOODING RIGHTS	SUBDIVISION OR COMPOSITE PLAN
RESERVATIONS	ORIGINAL SHORELINE
MARSH OR MUDBANK	MINES
TRAVERSE MONUMENT	

DISPOSITION OF CROWN LANDS

TYPE OF DOCUMENT	SYMBOL
PATENT, SURFACE & MINING RIGHTS	
SURFACE RIGHTS ONLY	
MINING RIGHTS ONLY	
LEASE, SURFACE & MINING RIGHTS	
SURFACE RIGHTS ONLY	
MINING RIGHTS ONLY	
LICENCE OF OCCUPATION	
ORDER-IN-COUNCIL	
RESERVATION	
CANCELLED	
SAND & GRAVEL	

NOTE: MINING RIGHTS IN PARCELS PATENTED PRIOR TO MAY 6, 1912, VESTED IN ORIGINAL PATENTEES BY THE PUBLIC LANDS ACT, R.S.O. 1970, CHAP. 220, SEC. 62, SUBSEC. 1.

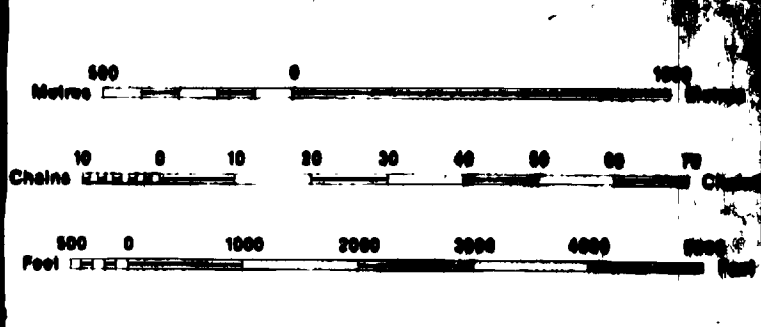

SCALE 1:20 000
GRID ZONE 17

W9560.00320
Comp P Man

RECEIVED
DEC 8 1995
MINING LANDS BRANCH

ISSUED
1995
PORCUPINE MINING DIVISION

TOWNSHIP
SHAW
M.N.R. ADMINISTRATIVE DISTRICT
TIMMINS
MINING DIVISION
PORCUPINE
LAND TITLES / REGISTRY DIVISION
COCHRANE

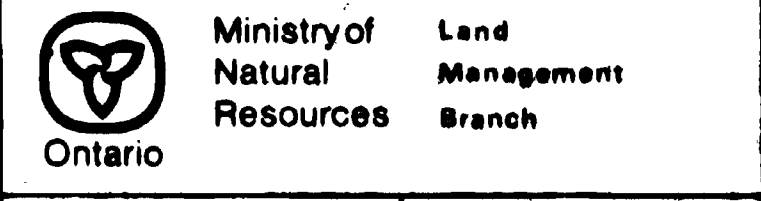

ORIGINAL COMPILATION JULY 1984
REVISED IN SERVICE DEC 1995
CHECKED BY: [Signature]
G-3999

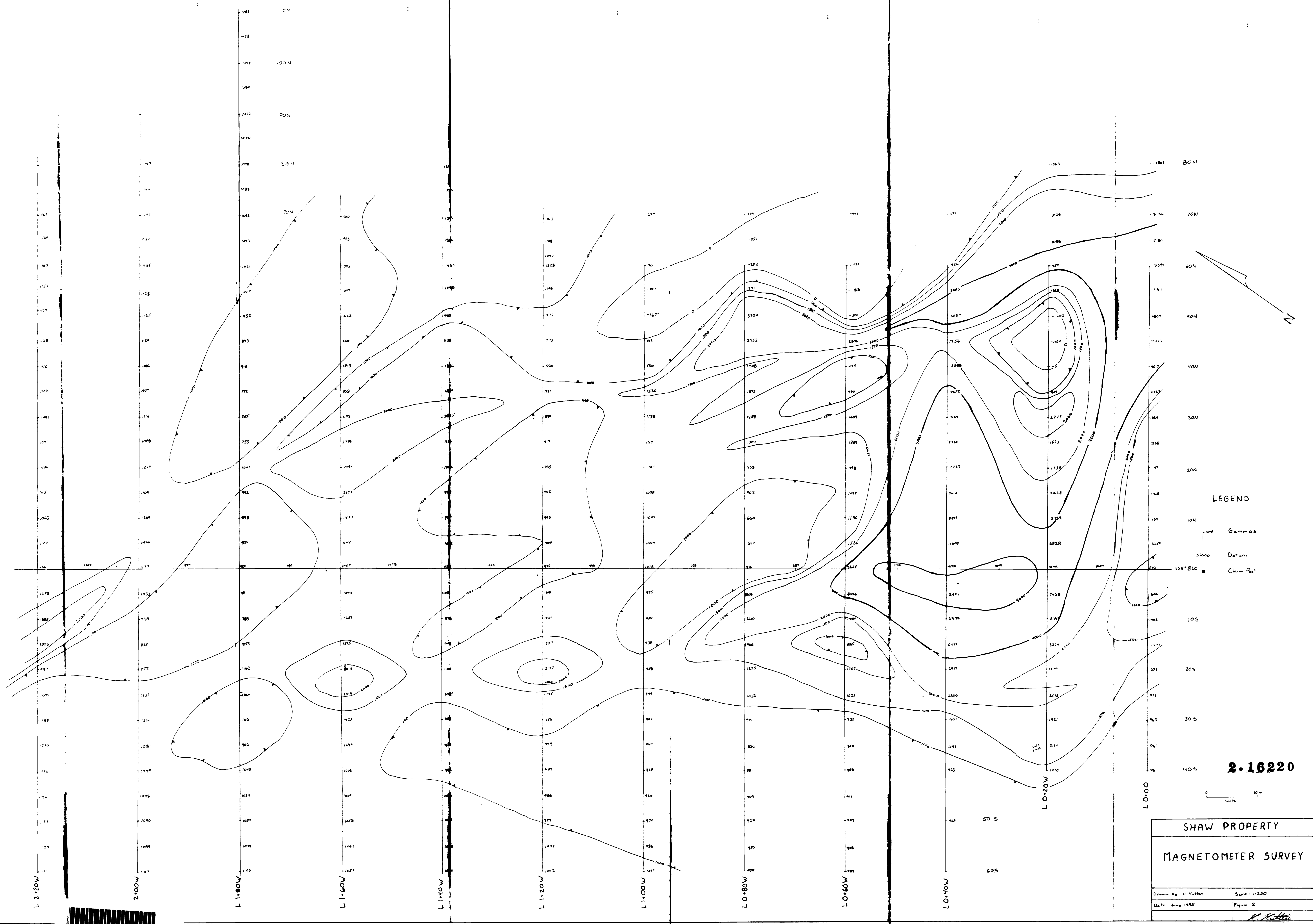

LEGEND

- Gamma
- Datum
- Claim Post

2.16220

SHAW PROPERTY	
MAGNETOMETER SURVEY	
Drawn by H. Hutter	Scale: 1:250
Date: June 1945	Figure 2
<i>H. Hutter</i>	

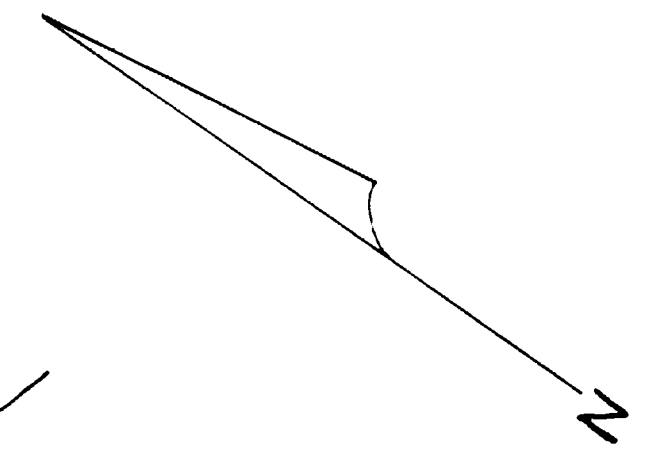
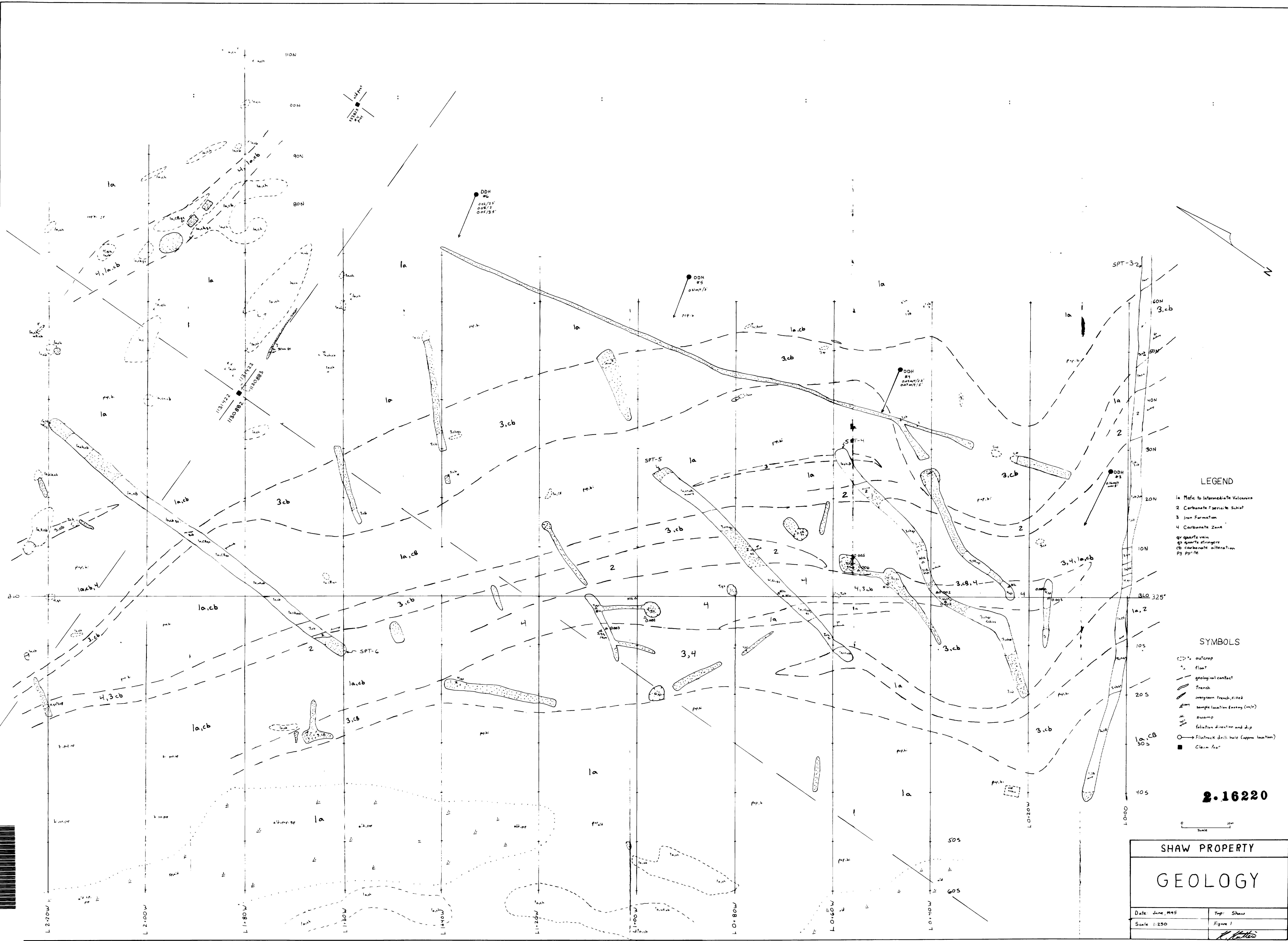

- LEGEND**
- 1a Mafic to Intermediate Volcanics
 - 2 Carbonate Tertiary Schist
 - 3 Iron Formation
 - 4 Carbonate Zone
 - qv quartz vein
 - qs quartz stringers
 - ca carbonate alteration
 - py pyrite

- SYMBOLS**
- outcrop
 - △ fault
 - geological contact
 - ▭ trench
 - ▨ overgraben trench, filled
 - sample location (east)
 - swamp
 - ↖ fault direction and dip
 - Flintrock drill hole (approx location)
 - Claim Post

2.16220

Scale 1:250

SHAW PROPERTY	
GEOLOGY	
Date: June, 1945	Top: Shaw
Scale: 1:250	Figure: 1
<i>R. H. Miller</i>	