



42A06NE0252 11 CARMAN

010

Diamond Drilling

Township OF CARMAN

Report No: 11

Work performed by: CANADIAN SUPERIOR EXPLORATION

Claim No	Hole No	Footage	Date	Note
P 77077	#C- 65- 1	463'	Feb/65	
P 77078	#C- 65- 2	348.5'	Feb/65	
P 77079				
P 77081	#C- 65- 4	605'	Mar/65	
P 77082	#C- 65- 3	361.5'	Feb/65	

Notes:

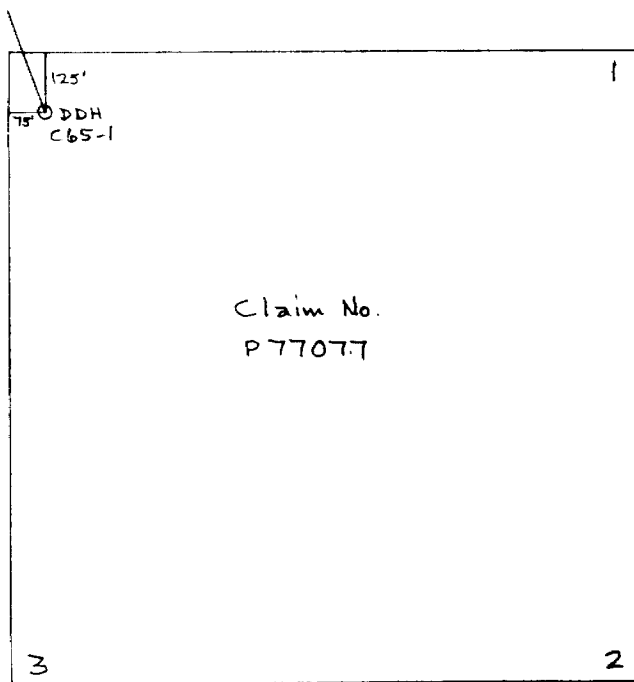

Claim No.
P77077

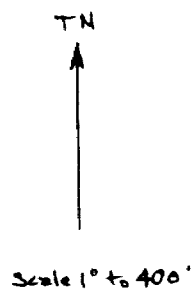

Canadian Superior Exploration Ltd.
Location of Drill Hole C65-1
Carmen Twp., Ont.

W.K. 5/11/65

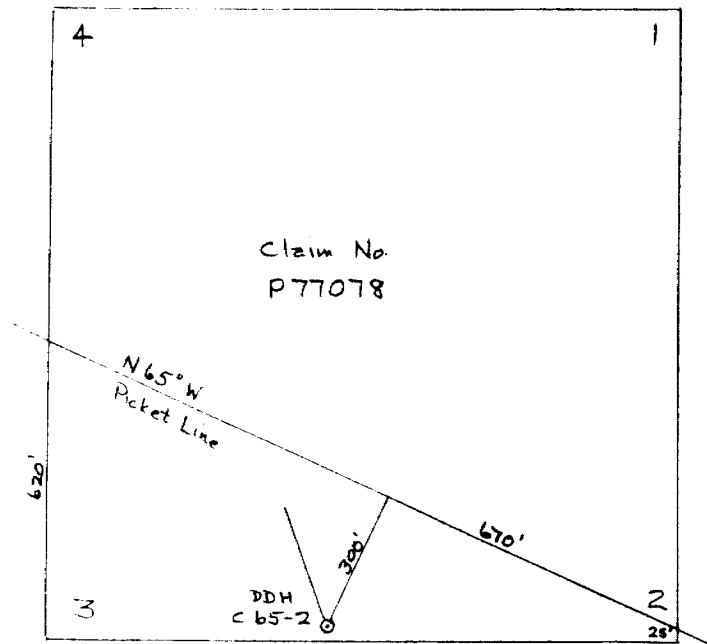

TN
 ↑
 Scale 1" to 400'

Canadian Superior Exploration Ltd.
 Location of Drill Hole C 65-2
 Carman Twp., Ont.

W.K. 5/11/65

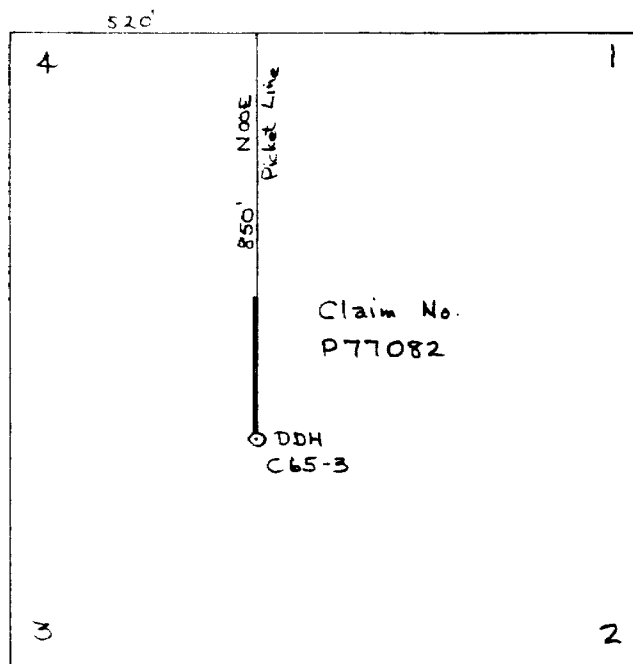

Canadian Superior Exploration Ltd.
Location of Drill Hole C65-3
Carman Twp., Ont.

W.K. 5/11/65

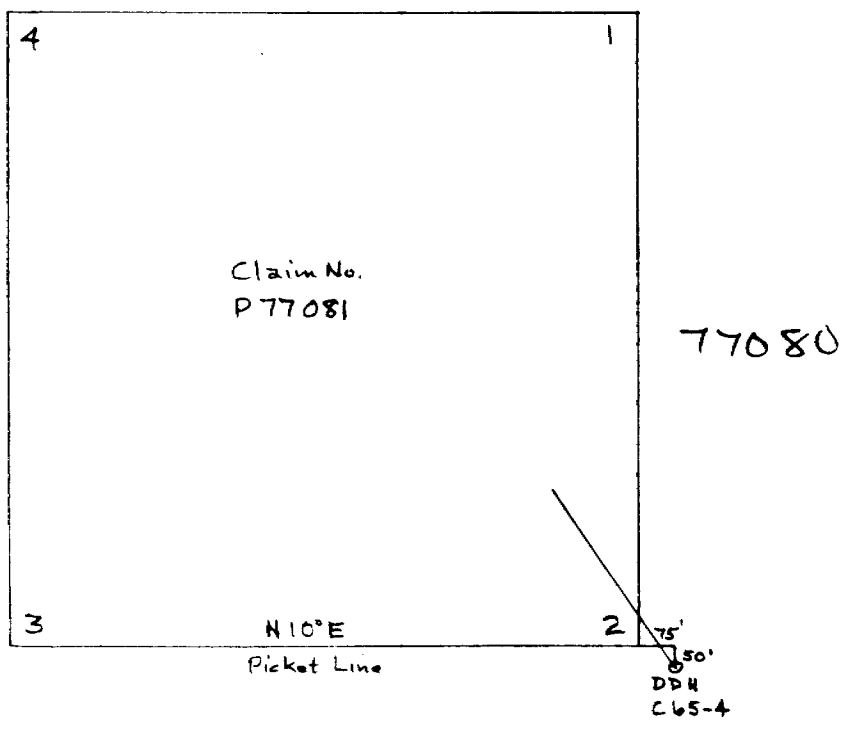

TN
 ↑
 Scale 1" to 400'

77079

Canadian Superior Exploration Ltd.
 Location of Drill Hole C65-4
 Carman Twp., Ont.

CANADIAN SUPERIOR EXPLORATION LIMITED
DIAMOND DRILL RECORD

LOCATION: **4 + 75 E) or (Line C**
0 + 50 S) (2 S
AZIMUTH: ~~300° (mag)~~ **N 25° W (mag)**

HOLE NO: **C-65-4**

PROPERTY: **Carmen Twp., Ontario**
Northern Group

DIP: **-45°** LENGTH: **605'** ELEVATION: CLAIM NO: ~~P-77079~~ **P-77081**

STARTED: **March 5, 1965** CORE SIZE: DATE LOGGED: SECTION:

COMPLETED: **March 15, 1965** DIP TESTS: **200° - 40½° (corrected)** LOGGED BY: **D.J.W., W.K.**
400° - 42½° "
600° - 42½° " *William Kane*

PURPOSE:

FOOTAGE from	FOOTAGE to	DESCRIPTION	SAMPLE NO:	FOOTAGE		LENGTH	Ag.Oz.	Ag.Oz.	Cu.%
				from	to				
0	106	Casing							
106	204	Andesite, green to black, fine grained, uniform, talcose, possibly intrusive, minor graphite, some shearing at 30° to core axis, some feldspar porphyritic sections, minor pyrite-pyrrhotite, missing core 160-185 and 187-193							
204	218	Sediment or tuff, black, graphitic fine grained, siliceous, some fragments, sheared or bedded at 60° to core axis, 3-4% pyrite	815	210	215	5'	Nil	Nil	
218	308	Hyalite breccia, possibly agglomeratic very siliceous, sections of massive pyrrhotite up to 18" between 244 and 270, fair pyrrhotite as bands and pin-sized pins	816	218	225	7'	Nil	Nil	0.01
			817	225	230	5'	Nil	Nil	0.02
			818	230	235	5'	Nil	Nil	0.02
			819	240	245	5'	Nil	Nil	0.02
			820	245	250	5'	Nil	Nil	0.01
308	308	Sediment or tuff, black, graphitic, siliceous, minor pyrite-pyrrhotite	821	250	255	5'	Nil	0.02	0.02
			822	255	260	5'	Nil	Nil	0.01
308	325	Quartz-feldspar porphyry, massive, hard, grey-tuff colored, phenocrysts up to 1/8", medium-fine grained	823	260	265	5'	Nil	Nil	0.02
			824	265	270	5'	Nil	Nil	0.01
			825	270	275	5'	Nil	Nil	0.02
	605	END OF HOLE	826	285	290	5'	Nil	Nil	0.01