

2.4331

RECEIVED

NOV 23 1981

MINING LANDS SECTION

REPORT ON A GEOLOGICAL SURVEY



42A06NE0306 2.4331 CODY

010

CARMAN-2

PROJECT 1043-10

NTS: 42-A-6

AMAX MINERALS EXPLORATION

Timmins, Ontario
September, 1981

J. MacPherson
Geologist

SUMMARY

During July and August, 1981, a detailed geological survey was carried out on a group of seventy-four (74) claims located in western Cody and Carman townships, District of Cochrane, Ontario.

The property appears to be underlain mainly by metasediments, with lesser intermediate to felsic volcanics. These rocks are cut by Keeweenawan-age diabase dykes. There are also a number of strong electromagnetic conductors on the property.

It is recommended that the best electromagnetic conductors be drilled. Section drilling of the rocks to the north of the conductors may also be necessary to outline possible favourable zones of gold mineralization. Special attention should be paid to the area of folding and faulting around the entrance bay to Goose Creek.

INTRODUCTION

During late July and early August, 1981, a detailed geological survey was carried out on a group of seventy-four (74) claims located in Cody and Carman townships. The claim numbers are P-554-680,81,84, P-555042-56, P-597186-225, P-579226-28, P-579686-93, P-596271-74 and P-596294. These are all recorded in the name of Amax of Canada Limited.

This group of claims cover several air electromagnetic anomalies uncovered during helicopter-borne surveys carried out by Amax during the spring of 1981 (see Airborne Geophysical Report), and the fall of 1979.

Detailed ground geophysics consisting of magnetometer and

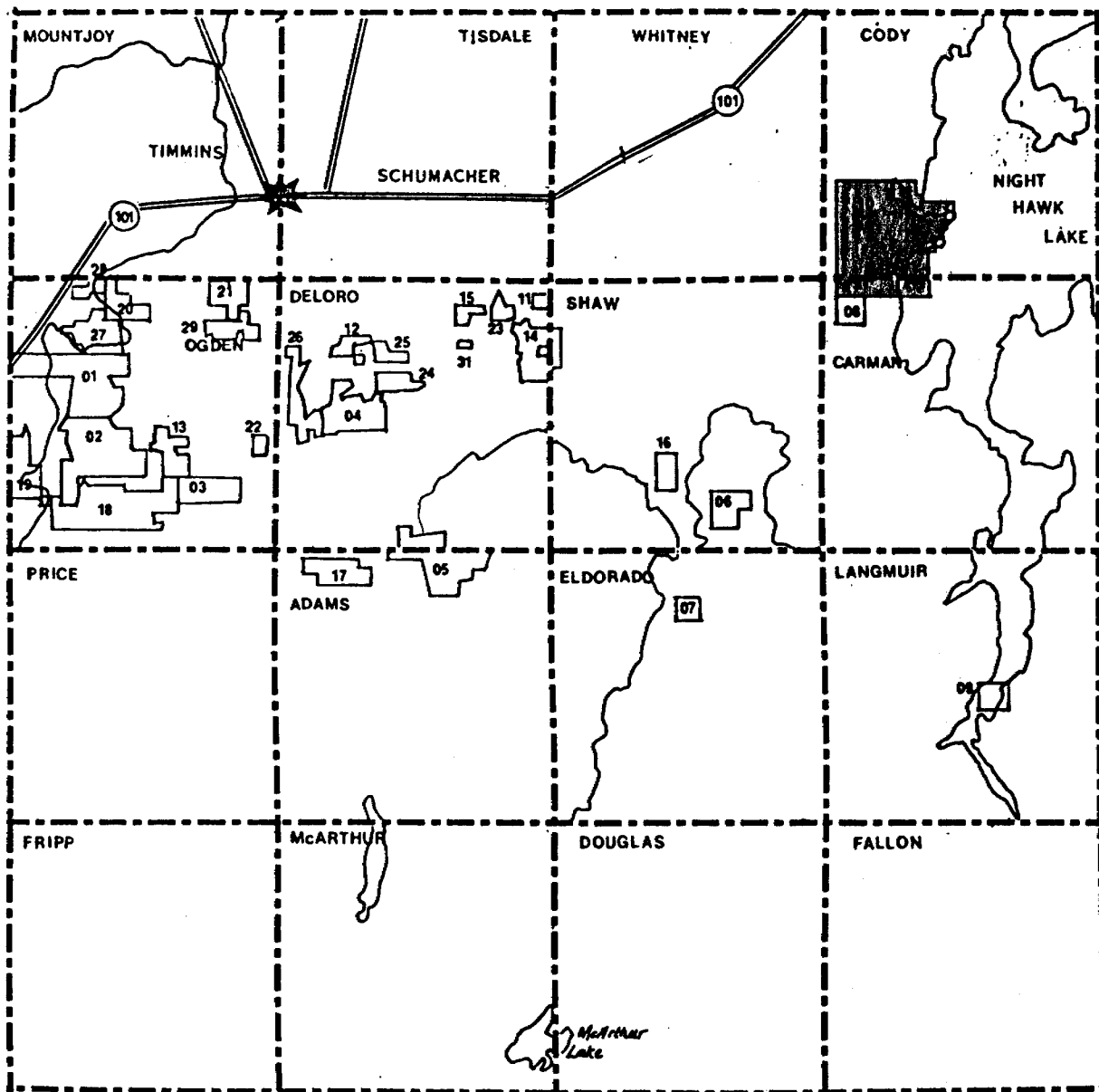

LOCATION MAP
 Project 1043-10

CARMAN-2
 1" = 4 miles

Lot 10 Lot 9 Lot 8 Lot 7

Con. III

Con. II

Con. I

Cody Twp. Red Stone River
Carman Twp.

Night Hawk Lake

N

P596271	P596272	P596273	P596274	P597186			
P597187	P597188	P597189	P597190	P597191			
P597192	P597193	P597194	P597195	P597196			
P597201	P597201	P597200	P597199	P597198	P597197		
P597203	P597204	P597205	P596294	P597206	P597207		
P597215	P597214	P597213	P597212	P597211	P597210	P597209	P597208
P597216	P597217	P555043	P555042	P579218	P579227	P597226	P579693
P597219	P597218	P555044	P555045	P579680	P579691	P579692	
P597220	P597221	P555047	P555046	P579688	P579689		
P597222	P555048	P555049	P555050	P579687			
P597223	P555051	P555052	P555053	P579686			
P597224	P555054	P555055	P555056	P597225			
	P554684	P554685	P554680				

CLAIM MAP

Project 1043-10

CARMAN-2

Cody & Carman Townships

1"=1 mile (approx.)

horizontal loop (high and low frequency) were carried out during the 1980-81 winter season.

LOCATION AND ACCESS

The property is located on the western shore of Nighthawk Lake in Cody and Carman townships, District of Cochrane, Ontario.

Access to the property is possible only by boat or helicopter. The group is located about five miles south of Nighthawk Marina on Nighthawk Lake. This water route is the easiest way to reach the property.

TOPOGRAPHY AND RESOURCES

Nearly half the claims are staked on Nighthawk Lake itself. The remainder of the claims are situated on swampy lowland. An exception to this is Poplar Point, a moderately high headland jutting east into Nighthawk Lake. The majority of the outcrop exposure is located on and immediately around Poplar Point.

Vegetation consists mainly of alders in the swamps and birch and poplar on the high ridge.

Goose Creek flows into Nighthawk Lake from the north west and the Redstone River flows into Nighthawk from the south of the property.

TABLE OF FORMATIONS

CENZOIC

Quaternary

Recent

Swamp and stream deposits

Pleistocene

Till, clay, sand, gravel

Unconformity

PRECAMBRIAN

Mafic Intrusive Rocks

Olivine diabase, quartz diabase

Intrusive Contact

Huronian Supergroup

Gowganda Formation, Cobalt Group

Arkose, wacke, argillite, conglomerate

Unconformity

ARCHEAN

Mafic Intrusive Rocks

Diabase

Intrusive Contact

Felsic Intrusive Rocks

Quartz feldspar porphyry, granite, diorite, granodiorite

Metamorphosed Mafic Intrusive Rocks

Gabbro, quartz gabbro

Intrusive and Gradational Contact

TABLE OF FORMATIONS

CENZOIC

Quaternary

Recent

Swamp and stream deposits

Pleistocene

Till, clay, sand, gravel

Unconformity

PRECAMBRIAN

Mafic Intrusive Rocks

Olivine diabase, quartz diabase

Intrusive Contact

Huronian Supergroup

Gowganda Formation, Cobalt Group

Arkose, wacke, argillite, conglomerate

Unconformity

ARCHEAN

Mafic Intrusive Rocks

Diabase

Intrusive Contact

Felsic Intrusive Rocks

Quartz feldspar porphyry, granite, diorite, granodiorite

Metamorphosed Mafic Intrusive Rocks

Gabbro, quartz gabbro

Intrusive and Gradational Contact

PREVIOUS WORK

From Assessment Files:

Inco drilled three holes in Cody township in 1966. Two are on the present Amax Property. One was drilled just north of the entrance to Goose Bay and intersected felsic to intermediate meta-volcanics with graphite, pyrite and pyrrhotite. A second hole was drilled just south of the entrance bay to the Redstone River. It encountered interbedded amphibolite, tuffite, felsic to intermediate volcanic rocks and locally graphitic and pyritic metasediments.

A small copper-zinc showing on the north side of Poplar Point was discovered by Len Hill in 1964. He drilled six packsack holes on the property. The property was later optioned to Texasgulf Sulphur and Amax Exploration. Texasgulf drilled 1500 feet on graphitic horizons and Amax carried out several electromagnetic surveys to help determine the base metal potential of the property. The option was later dropped due to lack of encouraging results.

Whitco Porcupine Mining Syndicate drilled four (4) holes on the present Amax claims in 1944-45. Assays indicated nil to trace amounts of gold. Rock types encountered were similar to those encountered in the Texasgulf and Inco holes.

Found In Field:

Several pits were found in the neighbourhood of the Len Hill showing. Very little sulphide mineralization was visible, however. A couple of small pits and trenches were located along the most westerly claim line one mile south of the north boundary. These were located on barren quartz veins cutting metasediments.



PRESENT AMAX CLAIM BOUNDARY

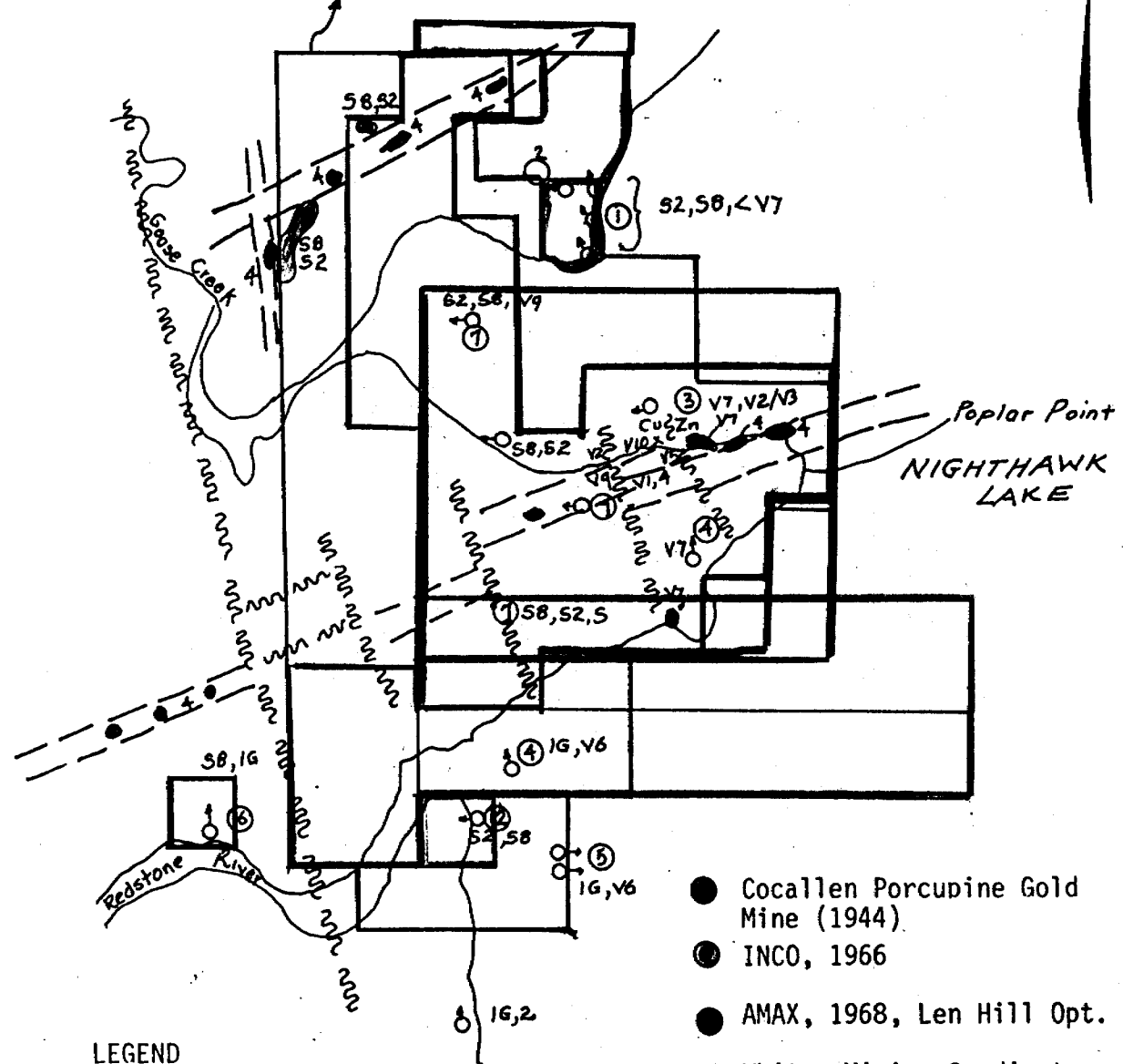

LEGEND

- V2 Rhyolite
- V3 Rhyodacite
- V6 Andesite
- V7 Basalt
- V9 Tuff
- V10 Agglomerate
- S2 Greywacke
- S8 Argillite
- 1G Granite
- 4 Diabase
- Fault
- Geological Boundary
- Drill Hole

- Cocallen Porcupine Gold Mine (1944)
- INCO, 1966
- AMAX, 1968, Len Hill Opt.
- Whitco Mining Syndicate 1944-1945
- Edgewater Porcupine Gold Mines (1945-1946)
- Redstone Porcupine Gold Mines, 1945
- Texasgulf, Inc.

AMAX MINERALS EXPLORATION

PROJECT: DELORO (1043)
 GROUP: 1043-10, Carman-2
 TWP :Carman
 Survey : Compilation
 Date : August, 1981
 SCALE : 1" = 1 mile (approx.)

SURVEY METHOD

The survey was performed by J. MacPherson, P. Lickley and assistants during late July and early August, 1981. Air photos at 1:30,000 scale, air photo blow-ups at 1:5,000 and the Amax detail geophysical grid were used as control for the geological survey.

Where topography allowed pace and compass traverse lines at 400 foot spacings were run across the claim group to provide good coverage.

REGIONAL GEOLOGY

The volcanic rocks of the Timmins area consist of the older Deloro Group and the younger overlying Tisdale Group.

The Deloro Group is confined to a large domal structure centred in Shaw township. It grades from andesite and basalt flows in the lower portion to dacite and rhyolite pyroclastics near the top. Oxide iron formation is the marker horizon which may be used to separate the two groups of rocks. A major change in volcanism marks the beginning of the Tisdale Group, the Lower Volcanic Formation of which is marked by serpentinized ultramafic flows.

The Destor-Porcupine Fault is the major structural feature in the area, along with the Porcupine Syncline to the north and the Shaw Dome to the south.

PROPERTY GEOLOGY

Much of the group is covered by swamp or lake, and as a

result, there was very little outcrop to be found. Most of this occurs on Poplar Point or on small islands in Nighthawk Lake itself. There is also a small outcrop area in the extreme north west part of the claim group.

A large east-west trending Keeweenawan diabase dyke is located on Poplar Point. The diabase is quite fine-grained near the contacts with the volcanics and is very coarse-grained in the interior of the dyke. Individual crystals may be up to one inch in diameter.

This dyke intrudes intermediate to felsic volcanics, mainly andesite with minor rhyolite. The andesite is massive to locally pillowed and medium to fine-grained. It may be cut by the occasional barren quartz stringer. Rhyolite is present in only one small outcrop on the north shore of Poplar Point. There is a small copper-zinc showing associated with the rhyolite.

A small outcrop area present in the north west part of the property consists of a Keeweenawan diabase dyke intruding metasediments.

The remainder of the property geology is interpreted from previous drilling. Metasediments and tuffaceous metasediments with lesser intermediate to felsic volcanics appear to make up the rest of the geology.

There appears to be a large folded structure trending north-east through the entrance bay to Goose Creek. A series of north-east trending faults may also be present on the property.

No gold or base metal mineralization of significance was found on the property, aside from the small copper-zinc showing on the north side of Poplar Point.

CONCLUSIONS AND RECOMMENDATIONS

The property is underlain by metasediments and tuffaceous

metasediments with lesser felsic to intermediate volcanic rocks. There are a large number of strong airborne electromagnetic conductors present on the property.

It is recommended that the best of the conductors should be drilled, if it can be shown that they have not been tested previously by diamond drilling. Due to the nature of the ground this will have to be a winter drill program. Further work in the form of section drilling may be necessary, especially in the Goose Creek area, to outline possible areas of gold mineralization.

Timmins, Ontario
September, 1981

J. A. MacPherson
J. MacPherson
Geologist

APPENDIX A

<u>PROJECT/GROUP</u>	<u>CLAIM NO.</u>	<u>TOWNSHIP</u>	<u>RECORDING DATE</u>
1043-10	554680	Carman	April 8/80
	554681	"	"
Carman-2	554684	"	"
	555042	Cody	"
	555043	"	"
	555044	"	"
	555045	"	"
	555046	"	"
	555047	"	"
	555048	"	"
	555049	"	"
	555050	"	"
	555051	"	"
	555052	"	"
	555053	"	"
	555054	"	"
	555055	"	"
	555056	"	"
	597186	"	Jan. 29/80
	597187	"	"
	597188	"	"
	597189	"	"
	597190	"	"
	597191	"	"
	597192	"	"
	597193	"	"
	597194	"	"
	597195	"	"
	597196	"	"
	597197	"	"
	597198	"	"
	597199	"	"
	597200	"	"
	597201	"	"
	597202	"	"
	597203	"	"
	597204	"	"
	597205	"	"
	597206	"	"
	597207	"	"
	597208	"	"
	597209	"	"
	597210	"	"
	597211	"	"
	597212	"	"
	597213	"	"
	597214	"	"
	597215	"	"
	597216	"	"
	597217	"	"
	597218	"	"
	597219	"	"

PROJECT/GROUP

CLAIM NO.

TOWNSHIP

RECORDING DATE

1043-10	597220	Cody	Jan. 29/80
Carman-2	597221	"	"
(cont.)	597222	"	"
	597223	"	"
	597224	"	"
	597225	"	"
	579226	"	"
	579227	"	"
	579228	"	"
	579686	"	"
	579687	"	"
	579688	"	"
	579689	"	"
	579690	"	"
	579591	"	"
	579592	"	"
	579593	"	"
	596271	"	"
	596272	"	"
	596273	"	"
	596274	"	"
	596294	"	"

Project 1043-10, Carman-2 has a total of seventy-four (74) claims.

DECLARATION

I, Joseph A. MacPherson, of the City of Sudbury, in the Province of Ontario, with a mailing address of 255 Algonquin Blvd. West, Timmins, Ontario, do hereby declare:

1. I am a geologist employed by Amax of Canada Limited, with offices at 255 Algonquin Blvd. West, Timmins, Ontario.
2. I completed an honours B.Sc. programme (geology) in 1980 at Laurentian University in Sudbury, Ontario.
3. I did personally set forth the facts as outlined in this report and did conduct or supervise, or review, the work contained herein.
4. I do not have, nor do I expect to have, any interest in the properties held by Amax of Canada Limited.

Joseph A. MacPherson
Joseph A. MacPherson

Dated at Timmins, Ontario



42A06NE0306 2.4331 CODY

900

1982 09 10

2.4331

Mining Recorder
Ministry of Natural Resources
60 Wilson Avenue
Timmins, Ontario
P4N 2S7

Dear Sir:

RE: Geological Survey on Mining Claims P 554680
at al in the Townships of Cody and Carman

The Geological Survey assessment work credits as listed with my Notice of Intent dated July 26, 1982 have been approved as of the above date.

Please inform the recorded holder of these mining claims and so indicate on your records.

Yours very truly

E.F. Anderson
Director
Land Management Branch

Whitney Block, Room 6450
Queen's Park
Toronto, Ontario
M7A 1W3
Phone: 416/965-1380

A. Barr: sc

cc: Amax of Canada Limited
Toronto, Ontario

cc: J. Macpherson
Timmins, Ontario

cc: Resident Geologist
Timmins, Ontario



Ministry of
Natural
Resources

Ontario

AUG 16, 1982

Your file:

1982 07 26

Our file: 2.4331

The Mining Recorder
Ministry of Natural Resources
60 Wilson Avenue
Timmins, Ontario
P4N 2S7

Dear Sir:

Enclosed are two copies of a Notice of Intent with statements listing a reduced rate of assessment work credits to be allowed for a technical survey. Please forward one copy to the recorded holder of the claims and retain the other. In approximately fifteen days from the above date, a final letter of approval of these credits will be sent to you. On receipt of the approval letter, you may then change the work entries on the claim record sheets.

Yours very truly,

**for further information,
if required, please contact
Mr. F.W. Matthews at
416/965-6918.**

E.F. Anderson
Director
Lands Administration Branch
Whitney Block, Room 6450
Queen's Park
Toronto, Ontario
M7A 1W3
Phone: 416/965-1316

A. Barr/sc

**c.c. Amax of Canada Limited
Toronto, Ontario**

**c.c. J. MacPherson
Timmins, Ontario**

**c.c. Mr. G.H. Ferguson
Mining & Lands Commissioner
Toronto, Ontario**



Ministry of
Natural
Resources

Ontario

Notice of Intent
for Technical Reports

1982 07 26

2.4331

An examination of your survey report indicates that the requirements of The Ontario Mining Act have not been fully met to warrant maximum assessment work credits. This notice is merely a warning that you will not be allowed the number of assessment work days credits that you expected and also that in approximately 15 days from the above date, the mining recorder will be authorized to change the entries on his record sheets to agree with the enclosed statement. Please note that until such time as the recorder actually changes the entry on the record sheet, the status of the claim remains unchanged.

If you are of the opinion that these changes by the mining recorder will jeopardize your claims, you may during the next fifteen days apply to the Mining and Lands Commissioner for an extension of time. Abstracts should be sent with your application.

If the reduced rate of credits does not jeopardize the status of the claims then you need not seek relief from the Mining and Lands Commissioner and this Notice of Intent may be disregarded.

If your survey was submitted and assessed under the "Special Provision-Performance and Coverage" method and you are of the opinion that a re-appraisal under the "Man-days" method would result in the approval of a greater number of days credit per claim, you may, within the said fifteen day period, submit assessment work breakdowns listing the employees names, addresses and the dates and hours they worked. The new work breakdowns should be submitted direct to the Lands Management Branch, Toronto. The report will be re-assessed and a new statement of credits based on actual days worked will be issued.

Recorded Holder	AMAX OF CANADA LIMITED
Township or Area	CARMAN AND CODY TOWNSHIPS

Type of survey and number of Assessment days credit per claim	Mining Claims Assessed
Geophysical	
Electromagnetic _____ days	P 555042
Magnetometer _____ days	555047
Radiometric _____ days	555053 to 55 incl
Induced polarization _____ days	579226 to 28 incl
Section 86 (18) _____ days	579690 to 93 incl
Geological <u>16</u> days	596271 - 72
Geochemical _____ days	597186 to 188 incl
Man days <input type="checkbox"/>	597191 to 93 incl
Airborne <input type="checkbox"/>	597195-96-98-99
Special provision <input type="checkbox"/>	597201 to 04 incl
Ground <input type="checkbox"/>	597208-09
<input checked="" type="checkbox"/> Credits have been reduced because of partial coverage of claims.	597214 to 24 incl
<input type="checkbox"/> Credits have been reduced because of corrections to work dates and figures of applicant.	

Special credits under section 86 (15a) for the following mining claims

No credits have been allowed for the following mining claims

<input checked="" type="checkbox"/> not sufficiently covered by the survey	<input type="checkbox"/> Insufficient technical data filed	
P. 554680-81-84	P 597189	P 597225
555043 to 46 incl	597194	
555048 to 52 incl	597197	
555056	597200	
579686 to 89 incl	597205-06-07	
596273-74	597210 to 13 incl	
596294		

The Mining Recorder may reduce the above credits if necessary in order that the total number of approved assessment days recorded on each claim does not exceed the maximum allowed as follows: Geophysical — 80; Geological — 40; Geochemical — 40; Section 86(18)-60:



Mining Lands Comments

To: Geophysics

Comments		
<input type="checkbox"/> Approved <input type="checkbox"/> Wish to see again with corrections	Date	Signature

To: Geology - Expenditures

Mr Kustra

Comments		
<input checked="" type="checkbox"/> Approved <input type="checkbox"/> Wish to see again with corrections	Date	Signature
	<i>Mar. 22/82</i>	<i>Kustra</i>

To: Geochemistry

Comments		
<input type="checkbox"/> Approved <input type="checkbox"/> Wish to see again with corrections	Date	Signature

To: Mining Lands Section, Room 6462, Whitney Block.

(Tel: 5-1380)

December 14, 1981

2.4331

Office of the Mining Recorder
Ministry of Natural Resources
60 Wilson Avenue
Timmins, Ontario
P4N 2S7

Dear Sir:

We have received reports and maps for a Geological Survey submitted under Special Provisions (credit for Performance and Coverage) on Mining Claims P.554680 et al, in the Townships of Cody and Carman.

This material will be examined and assessed and a statement of assessment work credits will be issued.

Yours very truly,

E.F. Anderson
Director
Land Management Branch

Whitney Block, Room 6450
Queen's Park
Toronto, Ontario
M7A 1W3
Phone: 416/965-1380

J. Skura/bk

cc: Joseph MacPherson
Timmins, Ontario

cc: AMAX Minerals Exploration
Timmins, Ontario
Attention: Rosemary Tittley

MINING CLAIMS TRAVERSED

Prefix	Claim Number	Expend. Days Cr.	Prefix	Claim Number	Expend. Days Cr.
P	554680	20	P	597186	20
P	554681	20	P	597187	20
P	554684	20	P	597188	20
P	555042	20	P	597189	20
P	555043	20	P	597190	20
P	555044	20	P	597191	20
P	555045	20	P	597192	20
P	555046	20	P	597193	20
P	555047	20	P	597194	20
P	555048	20	P	597195	20
P	555049	20	P	597196	20
P	555050	20	P	597197	20
P	555051	20	P	597198	20
P	555052	20	P	597199	20
P	555053	20	P	597200	20
P	555054	20	P	597201	20
P	555055	20	P	597202	20
P	555056	20	P	597203	20
P	579226	20	P	597204	20
P	579227	20	P	597205	20
P	579228	20	P	597206	20
P	579686	20	P	597207	20
P	579687	20	P	597208	20
P	579688	20	P	597209	20
P	579689	20	P	597210	20
P	579690	20	P	597211	20
P	579691	20	P	597212	20
P	579692	20	P	597213	20
P	579693	20	P	597214	20
P	596271	20	P	597215	20
P	596272	20	P	597216	20
P	596273	20	P	597217	20
P	596274	20	P	597218	20
P	596294	20	P	597219	20

MINING CLAIMS TRAVERSED

Prefix	Claim Number	Expend. Days Cr.
P	597220	20
P	597221	20
P	597222	20
P	597223	20
P	597224	20
P	597225	20

Total of 74 Mining Claims

MINING CLAIMS TRAVERSED

Prefix	Claim Number	Prefix	Claim Number
P	554680	P	597186
P	554681	P	597187
P	554684	P	597188
P	555042	P	597189
P	555043	P	597190
P	555044	P	597191
P	555045	P	597192
P	555046	P	597193
P	555047	P	597194
P	555048	P	597195
P	555049	P	597196
P	555050	P	597197
P	555051	P	597198
P	555052	P	597199
P	555053	P	597200
P	555054	P	597201
P	555055	P	597202
P	555056	P	597203
P	579226	P	597204
P	579227	P	597205
P	579228	P	597206
P	579686	P	597207
P	579687	P	597208
P	579688	P	597209
P	579689	P	597210
P	579690	P	597211
P	579691	P	597212
P	579692	P	597213
P	579693	P	597214
P	596271	P	597215
P	596272	P	597216
P	596273	P	597217
P	596274	P	597218
P	596294	P	597219

MINING CLAIMS TRAVERSED

Prefix	Claim Number
P	597220
P	597221
P	597222
P	597223
P	597224
P	597225

Total of 74 Mining Claims

GEOPHYSICAL TECHNICAL DATA

GROUND SURVEYS -- If more than one survey, specify data for each type of survey

Number of Stations _____ Number of Readings _____
Station interval _____ Line spacing _____
Profile scale _____
Contour interval _____

MAGNETIC

Instrument _____
Accuracy - Scale constant _____
Diurnal correction method _____
Base Station check-in interval (hours) _____
Base Station location and value _____

ELECTROMAGNETIC

Instrument _____
Coil configuration _____
Coil separation _____
Accuracy _____
Method: Fixed transmitter Shoot back In line Parallel line
Frequency _____
(specify V.L.F. station)
Parameters measured _____

GRAVITY

Instrument _____
Scale constant _____
Corrections made _____

Base station value and location _____

Elevation accuracy _____

**INDUCED POLARIZATION
RESISTIVITY**

Instrument _____
Method Time Domain Frequency Domain
Parameters - On time _____ Frequency _____
- Off time _____ Range _____
- Delay time _____
- Integration time _____
Power _____
Electrode array _____
Electrode spacing _____
Type of electrode _____

MINING CLAIMS TRAVERSED

<u>Prefix</u>	<u>Claim Number</u>	<u>Prefix</u>	<u>Claim Number</u>
P	554680	P	597186
P	554681	P	597187
P	554684	P	597188
P	555042	P	597189
P	555043	P	597190
P	555044	P	597191
P	555045	P	597192
P	555046	P	597193
P	555047	P	597194
P	555048	P	597195
P	555049	P	597196
P	555050	P	597197
P	555051	P	597198
P	555052	P	597199
P	555053	P	597200
P	555054	P	597201
P	555055	P	597202
P	555056	P	597203
P	579226	P	597204
P	579227	P	597205
P	579228	P	597206
P	579686	P	597207
P	579687	P	597208
P	579688	P	597209
P	579689	P	597210
P	579690	P	597211
P	579691	P	597212
P	579692	P	597213
P	579693	P	597214
P	596271	P	597215
P	596272	P	597216
P	596273	P	597217
P	596274	P	597218
P	596294	P	597219

MINING CLAIMS TRAVERSED

Prefix	Claim Number
P	597220
P	597221
P	597222
P	597223
P	597224
P	597225

Total of 74 Mining Claims

MATHESON TWP. M.297

THE TOWNSHIP OF
OF
CODY

DISTRICT OF
COCHRANE

PORCUPINE
MINING DIVISION

SCALE: 1-INCH 40 CHAINS

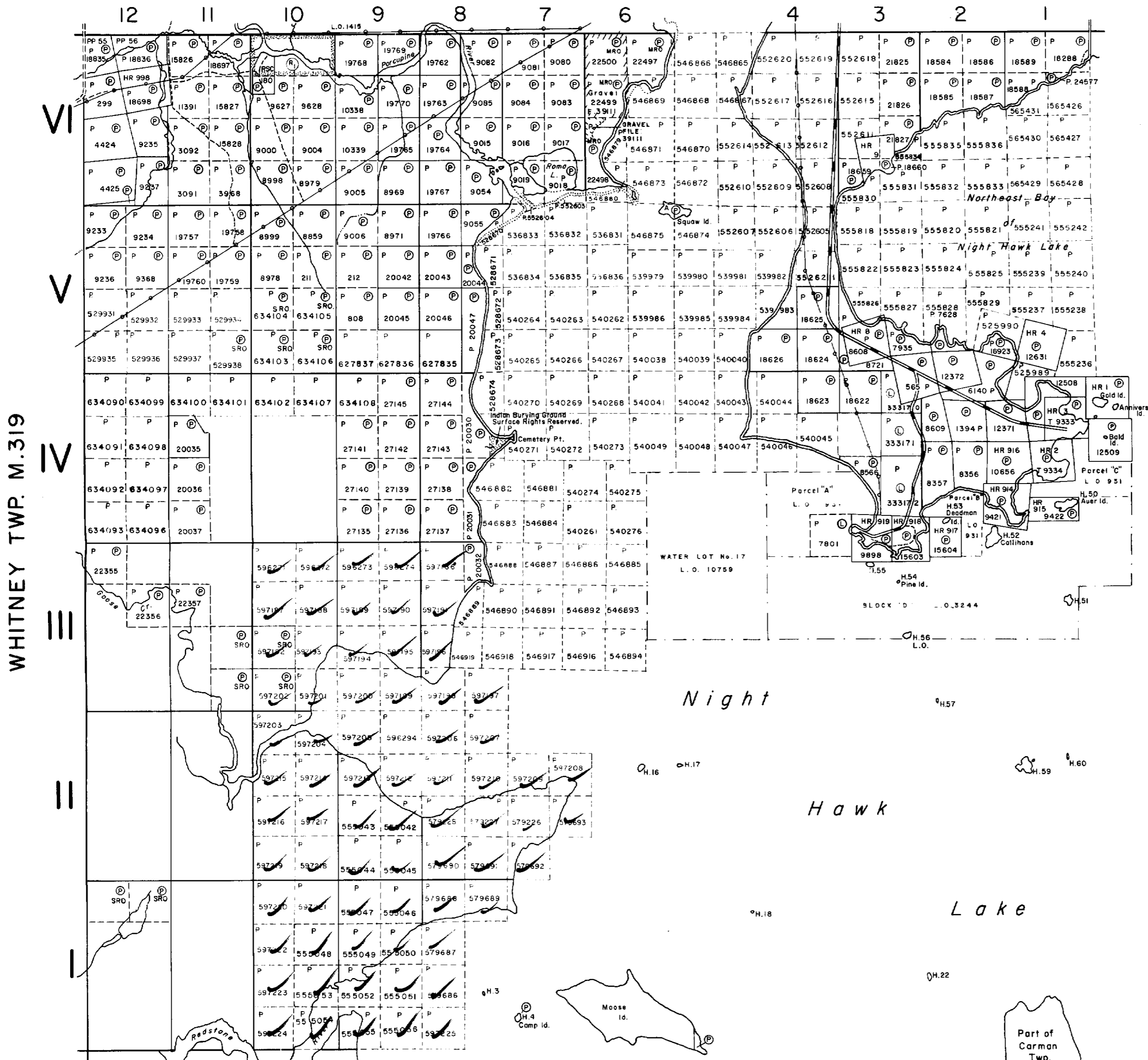

LEGEND

- PATENTED LAND (P)
- CROWN LAND SALE (C.S.)
- LEASES (L)
- LOCATED LAND (Loc.)
- LICENSE OF OCCUPATION (L.O.)
- MINING RIGHTS ONLY (M.R.O.)
- SURFACE RIGHTS ONLY (S.R.O.)
- ROADS (—)
- IMPROVED ROADS (—)
- KING'S HIGHWAYS (—)
- RAILWAYS (—)
- POWER LINES (—)
- MARSH OR MUSKEG (—)
- MINES (—)
- CANCELLED (—)

NOTES

400' surface rights reservation along the shores of all lakes and rivers.

The whole of Moose Island is attached to the Township of Cody. File 23642.

This Township lies within the Municipality of The City of Timmins.

Reserve flooding rights to Ont. Hydro to elevation 903.5' T.B.N.O. Railway datum on Night Hawk lake and that portion of the river between Night Hawk lake and Frederick House Lake.

Areas withdrawn from staking under Section 43 of the Mining Act (R.S.O. 1970).

Order No.	File	Date	Disposition
(R) W.53/76	16539	10/9/76	S.R.O.

DATE OF ISSUE
MAY 28 1982
Ministry of Natural Resources
TORONTO

6100103

PLAN NO. **M.270**

24321 ONTARIO
MINISTRY OF NATURAL RESOURCES
SURVEYS AND MAPPING BRANCH





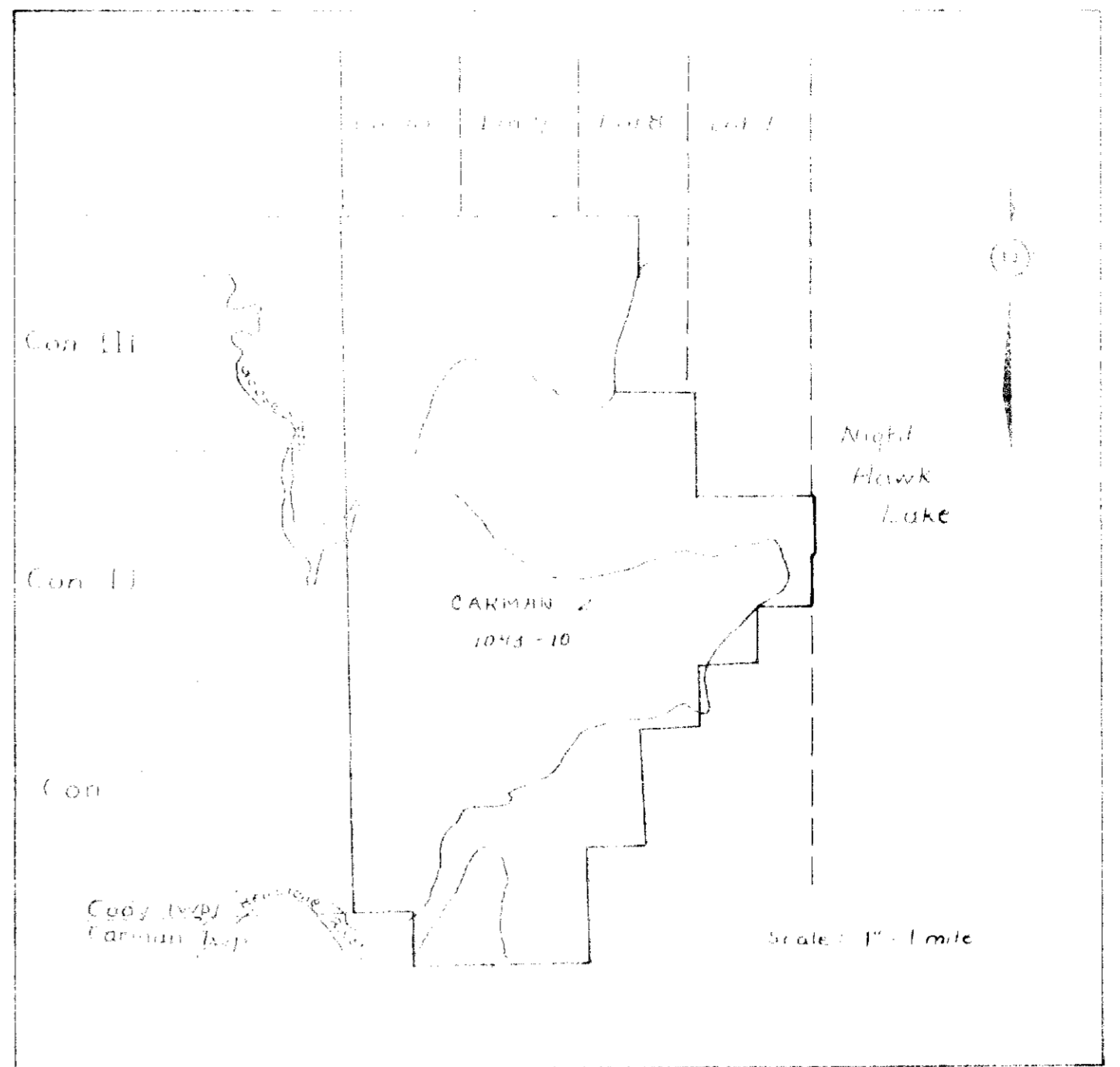

INDEX MAP

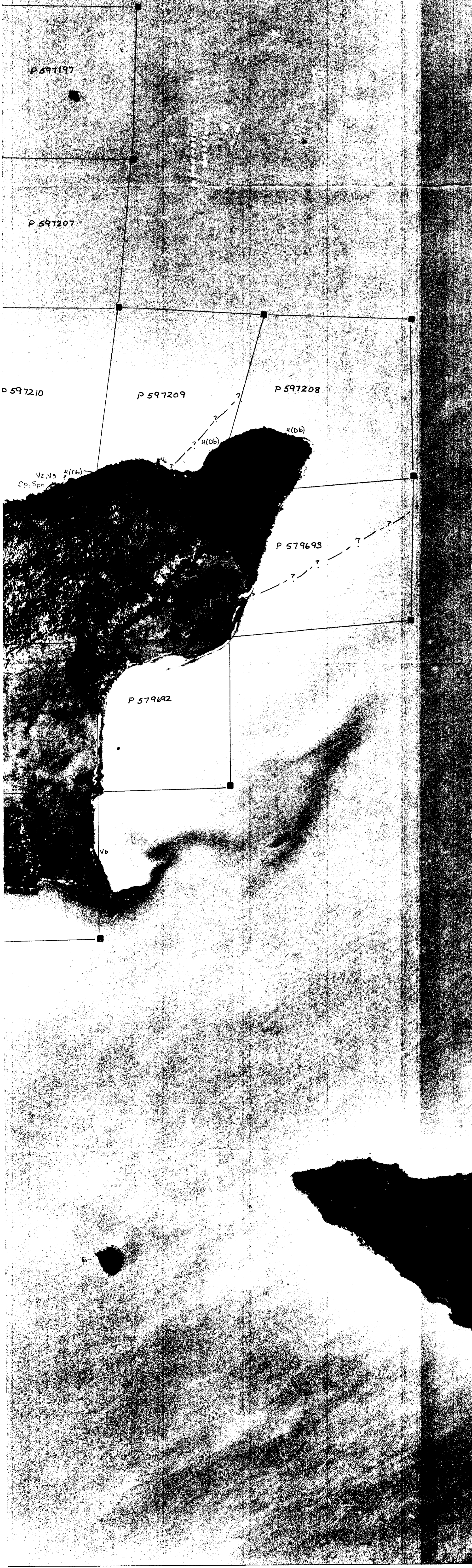

* Note: Property covered mainly by swamp

LEGEND

VOLCANIC ROCKS

- V2 Rhyolite
- V3 Rhyodacite
- V6 Andesite
- V7 Basalt

INTRUSIVE ROCKS

- 4(bb) Diabase

SYMBOLS

- q.v. Quartz Vein
- Cp Chalcopyrite
- Sph Sphalerite
- W.P. Witness Post
- Geologic Contact - known
- - - Geologic Contact - projected
- Swamp
- Claim Post
- Traverse Line
- Outcrop Boundary
- Trench

AMAX MINERALS EXPLORATION
GEOLOGY SURVEY

CARMAN -2 1043 -10
CODY AND CARMAN TOWNSHIPS
DISTRICT OF COCHRANE

Scale 1 : 5,000

NTS 42-A-6
42-A-7
Timmins Office

Date: August 1981

Mapped By: P. Lickley
J. MacPherson