



42A06NE0363 34 SHAW

010

DIAMOND DRILLING

Township: Shaw

Report No: 34

WORK PERFORMED FOR: Cominco

RECORDED HOLDER: SAME AS ABOVE []

: OTHER []

<u>CLAIM NO.</u>	<u>HOLE NO.</u>	<u>FOOTAGE</u>	<u>DATE</u>	<u>NOTE</u>
624691	STC-1	577'	Apr/87	(1)

NOTES: (1) #104-87(filed in August/87)

## Drill Hole Record



Property SHAW TALE District PORCUPINE Hole No. STC-1  
 Commenced APRIL 28/87 Location SHAW TOWNSHIP Tests at 12m 101m 176m Hor. Comp.  
 Completed APRIL 30/87 Core Size NQ Corr. Dip Vert. Comp.  
 Co-ordinates True Brg. Logged by R. Foy  
 Objective % Recov. 99% Date APRIL 30/87

Claim 624691

T Brg.

Collar Dip -45°

Elev.

Length 176mHole No. Sheet 1

Footage METERAGE		Description	Sample No.	Length	Analysis
From	To				
0	10.2 m	OVERBURDEN -- SAND			
10.2	16.4 m	QUARTZ - MAGNESITE			
		f.g - m.g. GREEN-GRAY, SILICEOUS UNIT; QUARTZ, SERICITE, MAGNESITE WITH 2-3% f.g. DISSEMINATED SPECULAR HEMATITE THROUGHOUT; ROCK HAS A MASSIVE TO MODERATELY DEVELOPED (PRIMARY?) FABRIC AND IS LOCALLY FRACTURED AND VEINED; FABRIC GENERALLY TRENDS 030° TO CA; FRACTURING AND VEINING VARY FROM 030° TO 090° TO CA; 10-40 cm WIDE SOFT RUSTY ZONES ACCOMPANY FRACTURING AND VEINING (i.e. 12.2-12.4, 16.6-17.0); LOCALLY (i.e. 13.0-13.5) HAS A FRAGMENTAL (AGGLOMERITIC) TEXTURE; LOWER CONTACT IS RELATIVELY SHARP AND IS BEST RECOGNIZED BY A CHANGE IN HARDNESS;			
	11.4	-- 3 cm wide MILKY, BARREN, QUARTZ VEIN WITH 5% CARBONATE; TRENDS 080°			
	11.8	-- 3 cm wide QUARTZ VEIN WITH 5% CARBONATE; TRENDS 030°			
	13.4	-- 1 cm wide CREAM COLOURED FOLDED QUARTZ-CARBONATE VEIN; GENERALLY TRENDS 030°			
16.4	73.9 m	MAGNESITE - TALC - SERICITE			
		f.g - c.g. DARK TO LIGHT GREEN ITALY ROCK; TALC, MAGNESITE, CHLORITE, SERICITE WITH 5% DISSEMINATED SPECULAR HEMATITE THROUGHOUT; LOCALLY WITH BIOTITE; NON-MAGNETIC; ROCK IS EASILY SCRATCHED AND VARIABLY MASSIVE TO MODERATELY			

R. Foy

## Drill Hole Record



Property	District	Hole No.	STC-1
Commenced	Location	Tests at	Hor. Comp.
Completed	Core Size	Corr. Dip	Vert. Comp.
Co-ordinates		True Brg.	Logged by
Objective		% Recov.	Date

Claim

T Brg.

Collar Dip

Elev.

Length

Hole No.

Sheet 7

Footage From	METERAGE To	Description	Sample No.	Length	Analysis
		FOLIATED TO HIGHLY VEINED AND FRACTURED; v.f.g. TALC IS AMBIGUOUS AND AS 1-15 mm WIDE VEINS AND FRACTURE FILLS AT VARIOUS ORIENTATIONS AND GENERATIONS; MAGNESITE OCCURS AS FINE TO MEDIUM SIZED GRAINS IN A f.g. MATRIX OF TALC ± CHLORITE ± SERICITE; ROCK IS VARIABLY TEXTURED FROM FINE TO COARSE GRAINED, RELATIVELY MASSIVE (i.e. 21.0-22.5) TO c.g. (RECRYSTALLIZED?) SECTIONS WITH HIGH DENSITY OF FRACTURING AND VEINING (i.e. 41.0-43.0);			
		16.4 - 25.9 -- RELATIVELY MASSIVE SECTION WITH LOW DENSITY VEINING & FRACTURING; f.g. TALC THROUGHOUT;			
		25.9 - 27.4 -- ROCK HAS A FRAGMENTAL TEXTURE ON LARGE SCALE (i.e. 30 cm), PILLOWS?			
		27.4 - 30.9 -- FRACTURED AND VEINED SECTION. MODERATE TO HIGH DENSITY OF FRACTURING AND TALC VEINLETS			
		30.9 - 32.0 -- SIMILAR FRAGMENTAL TEXTURE, BUT MORE ALTERED; SHARP CONTACTS BETWEEN m.g. DARK GREEN & c.g. CREAM COLOURED ALONG CONTACTS WITH FRAGMENTS; FRAGMENTS ARE f.g. AND LIGHT GREEN; PILLOWS?			
		32.0 - 35.1 -- HIGH DENSITY OF VEINING AND FRACTURING AT VARIOUS ANGLES (030° TO 090°) LOCALLY 15-20% SPECULAR HEMATITE (i.e. 34.0);			
		35.1 - 36.4 -- v.f.g. GREEN TALC - MAGNESITE SECTION WITH BLACK-GRAY INTERSTITIAL MATERIAL; POSSIBLY REMANANT VARIOLLES;			
		41.1 - 45.4 -- HIGH DENSITY VEINING OF VARIOUS ORIENTATIONS & GENERATIONS IN DARK GREEN f.g. TO c.g. ROCK			
		45.4 - 46.6 -- FRACTURING AND VEINING OVERPRINTED BY WEAK LIGHT GREEN (CARBONATE) ALTERATION			



## Drill Hole Record



Property	District	Hole No. <u>STC - 1</u>	
Commenced	Location	Tests at	Hor. Comp.
Completed	Core Size	Corr. Dip	Vert. Comp.
Co-ordinates		True Brg.	Logged by
Objective		% Recov.	Date

Claim

T Brg.

Collar Dip

Elev.

Length

Hole No.

Sheet 4

Footage From	MÉTÉRAGE To	Description	Sample No.	Length	Analysis				
	78.7	-- CREAM COLOURED v.f.g. q.v. TRENDS 010° TO CA							
	81.1-83.6	-- YELLOWISH-GREEN ALTERATION/SHEAR ZONE CONTAINS ABUNDANT MAGNESITE AND TALC WITH 10 CM FAULT GOUGE AT 83.7 AND 5 CM CLAY-TALC FAULT GOUGE (83.7) AND 2 CM FAULT GOUGE AT 83.5 <del>ALL</del> TRENDS 045° TO CA							
	86.7-87.1	-- SEVERAL NARROW (1/2 cm) q.v. ARE FRACTURED AND OFFSET							
	107.7	-- NARROW (2 cm) FAULT GOUGE TRENDS 040°							
	121.4-129.0	-- NARROW (1/2 cm) FIBROUS SERPENTINE ASSOCIATED WITH SHIP PLANE (040°) TO (020°); 1-2 PER M;							
	133.0	-- NARROW (2 cm) ALTERATION ZONE (SLIP?) WITH 5-10% FIBROUS SERPENTINE BANDS, 040°							
	135.5	-- SIMILAR TO 133.0							
	150.4-156.0	-- SOME FRACTURE FILLS WITH 5-15% FIBROUS SERPENTINE							
	155.0-176.0	TALC - MAGNESITE							
		f.g.-c.g. LIGHT GREEN-GRAY; UNIT CONTAINS ABUNDANT m.g. TO c.g. TALC WITH MAGNESITE AND v. NARROW (1/2 cm) CHLORITIC STRINGERS; UNIT EXHIBITS A GENERAL FABRIC PARALLEL TO CA (FLOW TEXTURE?); LOCALLY UP TO 5% SPECULAR HEMATITE; TALC OCCURS WITH QUARTZ VEIN IN 2 CM WIDE VEIN PARALLEL TO CA (i.e. 164.4-164.8) AND AS NARROW VEINS AND POOLS (i.e. 167.0)							



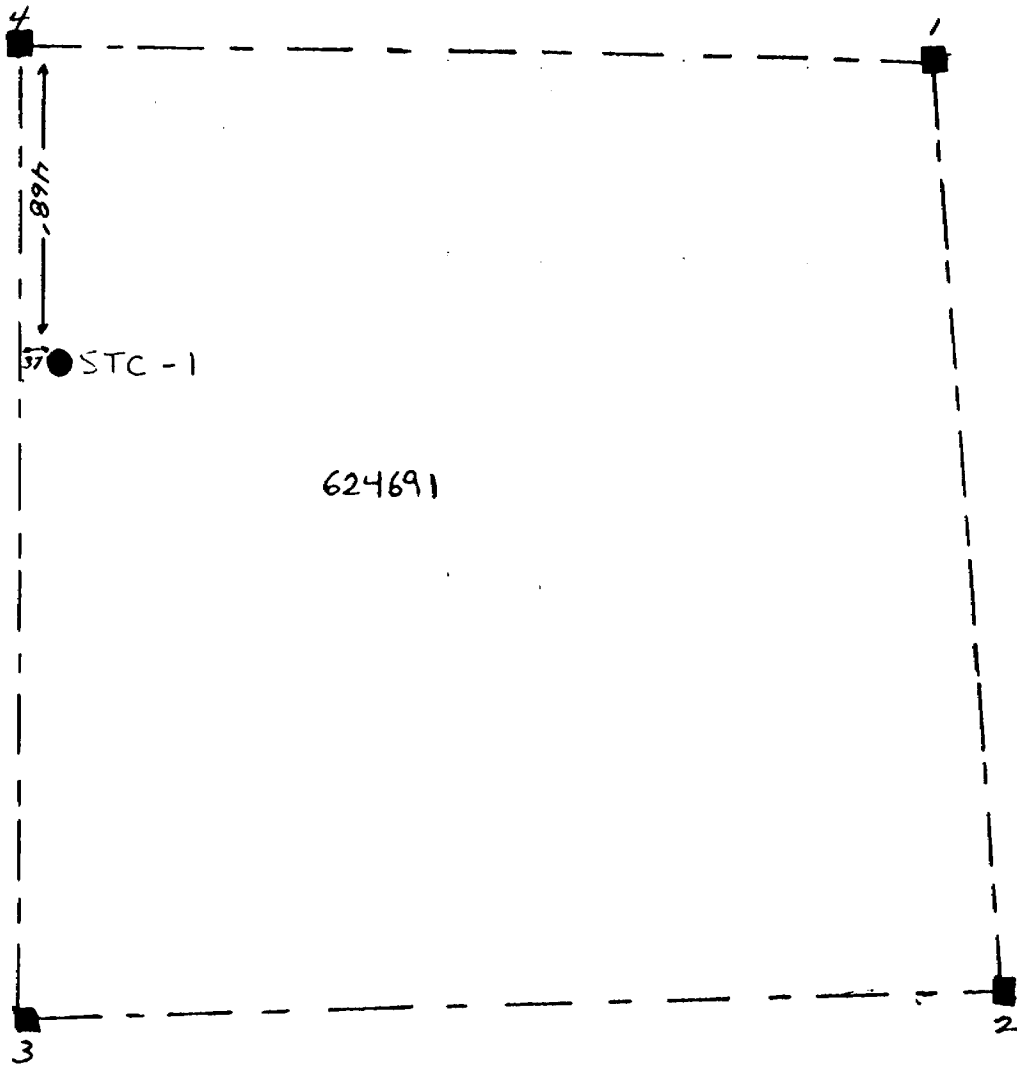

624691

4

1

89.5  
STC - 1

3

2

1" = 300'



Name and Postal Address of Recorded Holder

COMINCO LTD.

A.10043

2200-120 ADELAIDE STREET WEST, TORONTO, ONTARIO M5H 1T1

Summary of Work Performance and Distribution of Credits

Total Work Days Cr. claimed 577.42	Mining Claim		Work Days Cr.	Mining Claim		Work Days Cr.	Mining Claim		Work Days Cr.
	Prefix	Number		Prefix	Number		Prefix	Number	
for Performance of the following work. (Check one only)  <input type="checkbox"/> Manual Work <input type="checkbox"/> Shaft Sinking Drifting or other Lateral Work. <input type="checkbox"/> Compressed Air, other Power driven or mechanical equip. <input type="checkbox"/> Power Stripping <input type="checkbox"/> Diamond or other Core drilling <input type="checkbox"/> Land Survey	P	624691	43.42	P	871657	60			
		624692	100						
		624693	100						
		624694	100						
		866719	40						
		866720	40						
		871655	39						
		871656	55						

All the work was performed on Mining Claim(s): 624691

Required Information eg: type of equipment, Names, Addresses, etc. (See Table Below)

Hole No.	Length	Diam.	Angle	Dates Drilled
STC-1	176(m) x 3.2808 = 577.42 feet	NQ	-45°	April 28-30, 1987

Drilled by: Bradley Bros. Limited  
Timmins, Ontario

Date of Report May 12, 1987	Recorded Holder or Agent (Signature) <i>[Signature]</i>
--------------------------------	--

Certification Verifying Report of Work

I hereby certify that I have a personal and intimate knowledge of the facts set forth in the Report of Work annexed hereto, having performed the work or witnessed same during and/or after its completion and the annexed report is true.

Name and Postal Address of Person Certifying

R.C. LAROCHE, COMINCO LTD., 2200-120 ADELAIDE ST.W., TORONTO, ONTARIO M5H 1T1

Date Certified

May 12/87

Certified by (Signature)

*[Signature]*

Table of Information/Attachments Required by the Mining Recorder

Type of Work	Specific information per type	Other information (Common to 2 or more types)	Attachments
Manual Work	Nil	Names and addresses of men who performed manual work/operated equipment, together with dates and hours of employment.	Work Sketch: these are required to show the location and extent of work in relation to the nearest claim post.
Shaft Sinking, Drifting or other Lateral Work			
Compressed air, other power driven or mechanical equip.	Type of equipment	Names and addresses of owner or operator together with dates when drilling/stripping done.	
Power Stripping	Type of equipment and amount expended. Note: Proof of actual cost must be submitted within 30 days of recording.		
Diamond or other core drilling	Signed core log showing; footage, diameter of core, number and angles of holes.	Nil	Work Sketch (as above) in duplicate
Land Survey	Name and address of Ontario land surveyer.		Nil



