



42A06NE0402 35 DELORO

010

DIAMOND DRILLING

TOWNSHIP: DELORO

REPORT NO: 35

WORK PERFORMED FOR: Mill City Gold Inc.

RECORDED HOLDER: Same as Above [xx]
: Other []

<u>Claim No.</u>	<u>Hole No.</u>	<u>Footage</u>	<u>Date</u>	<u>Note</u>
P 946131	MCDS-88-01	502'	Feb/88	(1)

Notes: (1) W8806.055, filed in Sept/88

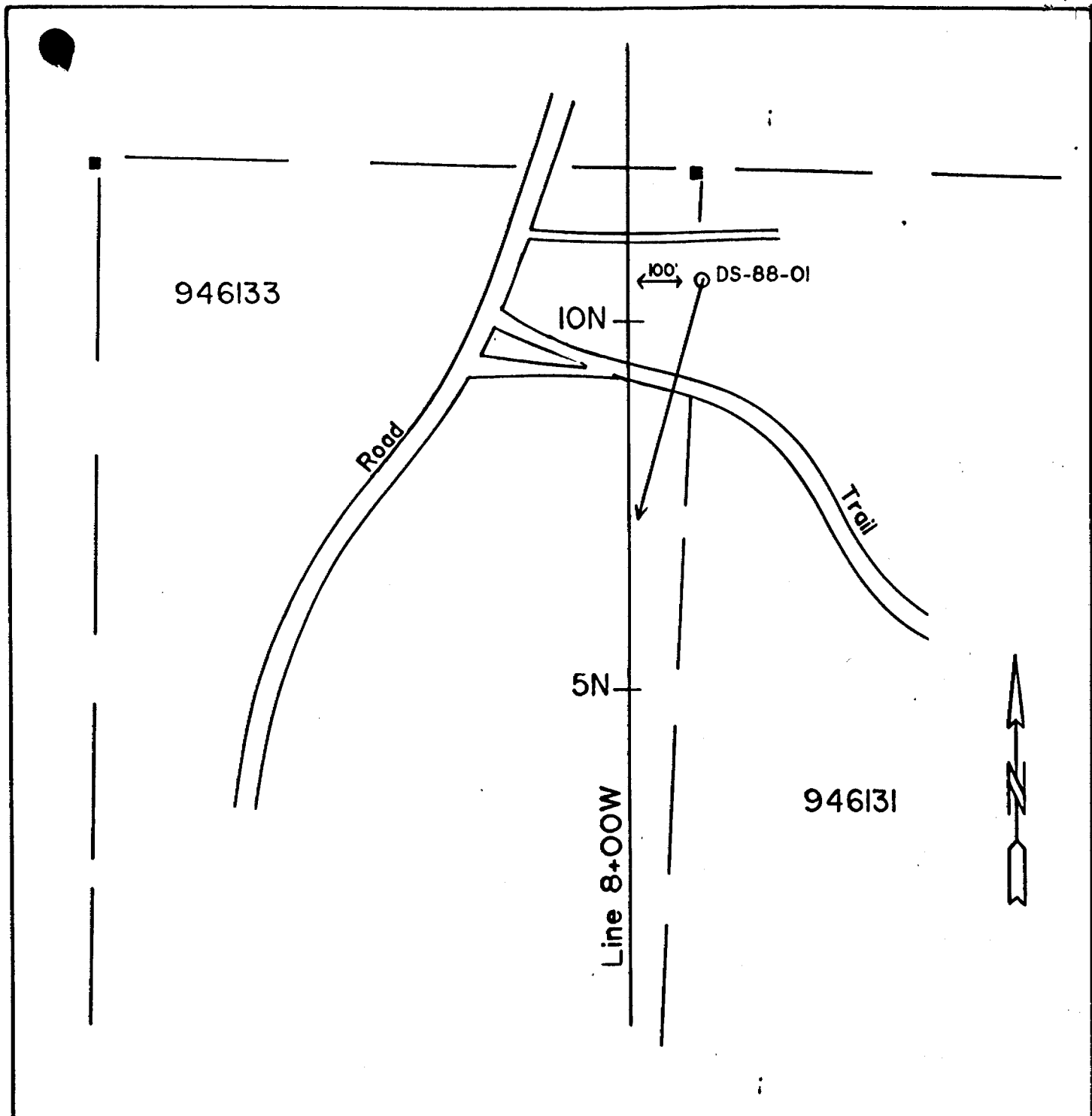

E.H. van Hees Geological Services Inc.	
for	
Mill City	
Sketch Plan to show Location of Drill Hole DS-88-01	
Twp/Area: Deloro/Shaw	P/ov: Ontario
Mining Div.: Cochrane	Proj: _____
References:	N.P. Sg. H. VAN HEES
Drawn: A.A.	Drafted: J.F.
Scale: 1"=200'	Date: Feb. 10, 1988

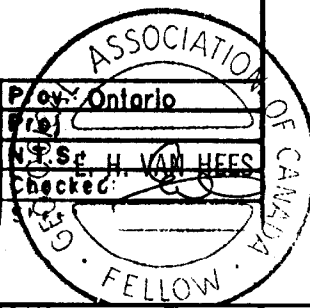

E. H. van Hees Geological Services Inc.

ONTARIO GEOLOGICAL SURVEY
ASSESSMENT FILES
OFFICE
APR 8 1988
RECEIVED

Project: Mill City - Deloro/Shaw

Azimuth - 195°
Dip - 45° (south)

Hole No.: MCDS-88-01
Logged By: A. Amos
Date: Feb 2 1988

Page 1 of 3

FROM	TO	UNIT/DESCRIPTION	FROM	TO	SAMPLE NO.	LENGTH	ASSAY OPT
0.0	5.0	Casing					
5.0	54.0	Andesitic Volcanics					
		- typical, fg to mg, green colour					
		- locally tuffaceous with good primary bedding at high angles tca					
		- lightly to moderately calcitic throughout					
		- also narrow (<1/4") calcite str 30 - 60 deg tca scattered throughout entire hole					
		- 6.6 - 7.1 - 5 - 10% fine py 70 deg tca	6.6	7.1	15001	0.5	
		- 9.0 - 9.8 - 5% dissem py mainly as streaks 50 deg tca	9.0	9.8	15002	0.8	
		- 13.3 - 2" 5% dissem py					
		- 14.1 - minor py and tourm. in calcite str 70 deg tca					
		- 35.0 - minor cubic py					
		- 42.2 - 2" grey qtz vein 35 deg tca cut by calcite str					
54.0	63.1	Cherty - Carbonate - Sulphide Iron Formation					
		- bedding good at 65 deg tca					
		- 54.0 - 54.9 - 15% cherty qtz, py cubes to 1/4"					
		- 56.0 - 56.8 - 50% grey cherty qtz, 15% py along bedding at 65 deg tca small scale faulting with minor chalcopryrite along fault	56.0	56.8	15003	0.8	
		- 60.0 - 61.7 - 80% cherty grey qtz, 10% py	60.0	61.7	15004	1.7	
		- 61.7 - 63.1 - 90% cherty grey qtz, 15% py mainly as introduced str, LC sharp at 60 deg tca	61.7	63.1	15005	1.4	
63.1	502.0	Andesitic Volcanics					
		- as above, except more massive and few examples of bedding					
		- 63.1 - 79.5 - fg, and uniform, narrow qtz str at 63.9, 71.2, 75.4, and 76.2					

FROM	TO	UNIT/DESCRIPTION	FROM	TO	SAMPLE NO.	LENGTH	ASSAY OPT
63.1	502.0	Andesitic Volcanics - continued					
		- 79.5 - 98.0 - mottled, amygdaloidal(?) texture, minor scattered py					
		- 89.0 - 94.0 - calcite amygdules poorly developed; grey qtz amygdules abundant and to 1/4" in size beautifully dev. siliceous white concentric chalcedony micro-growths inside the above qtz amyg.					
		- 98.0 - 157.8 - spotted texture; dark coloured, soft, chlorite spots 1 - 3 mm in size					
		- 101 - 1/2" pink, hem. stained qv at 40 deg tca					
		- 127.2 - 1/2 - 3/4" qtz vein at 30 deg tca					
		- 151.5 - 1/2" qtz vein at 40 deg tca					
		- 157.8 - 172.0 - short sections of grey qtz amygdules (up to 7mm) very well developed, often nearly spherical					
		- 171.2 - 3/4" grey qtz vein at 30 deg tca					
		- 184.5 & 185.3 - 3/4" qtz veins at 35 deg tca					
		- 203.0 - 214.5 - small chlorite spots as above					
		- 220.0 - 225.0 - highly silicified, both contacts sharp at 45-60 deg tca					
		- 223.0 - 1" qtz vein at 40 deg tca					
		- 260.7 - 264.0 - 5% py, mainly cubic, some dissem	260.7	264.0	15006	3.3	
		- 267.8 - 2" qtz vein with 40% py					
		- 268.0 - 275.2 - excellent primary bedding at 65 deg tca	272.2	274.4	15007	2.2	
		- 272.2 - 274.4 - highly chloritic, interflow sed., 5% py along bedding planes 65 deg tca, highly calcitic					
		- 298.0 - 298.6 - qtz veining 35 deg tca					
		- 334.3 - Shear Zone? - 1" wide, strong chlorite slip faces 50 deg tca, 1/2" pink cal. vein at same angle					
		- 336.0 - 1" qtz vein (with tiny white calcite strs) at 30 deg tca:					
		- 343.8 - 346.0 - numerous narrow qtz/carb strs, most concentrated over 6" section at 345.6					
		- 361.0 - 3" qtz vein with tiny calcite strs as above at 30 deg tca:					
		- 369.8 - 2" shear zone ? - chlorite rich, 55 deg tca, introduced qtz and calcite					

FROM	TO	UNIT/DESCRIPTION	FROM	TO	SAMPLE NO.	LENGTH	ASSAY OPT
63.1	502.0	Andesitic Volcanics - continued					
		- 380.6 - narrow irreg. grey qtz str with 2 - 3% py					
		- 390.4 - 1/4" grey qtz str at 30 deg tca with minor py and cpy					
		- 409.0 - 498.8 - continuing mainly massive, considerably harder,					
		noticable increase in fract. at small angles tca					
		30 deg and less, usually qtz - calcite filled					
		- 417.0 - 421.0 - 2 - 3% fine dissem magnetite,					
		often cubic					
		- 464.5 - microfaulting at 20 deg tca, tourmaline					
		in fault?					
		- 479.1 - 480.3 - Shear Zone ? - chlorite-qtz-carb.					
		at 60 deg tca,	488.5	489.8	15008	1.3	
		weakly schistose					
		- 483.0 - 484.0 - 30% irreg. qtz veining, no sulph.					
		- 488.5 - 489.8 - 60% qtz/carb veining but most					
		at 20 deg tca, no sulph.					
		- 498.8 - 502.0 - Chloritic (Shear ?) Zone					
		- nearly massive chlorite					
		- 499.4 - 501.2 - 80% qtz/carb. epidote veining	499.4	501.2	15009	1.8	
		mainly parallel tca, no sulph.					

EOH 502.0'

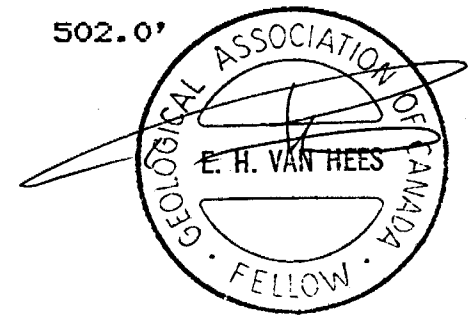



W8806.00055

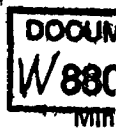

42A06NE0402 35 DELORO

900

Name and Postal Address of Recorded Holder

Mill City Gold Inc.

T-1647 *T. Jones*

c/o 165 Tamarack St., Timmins, Ontario P4N 6P7

Summary of Work Performance and Distribution of Credits

Total Work Days Cr. claimed	Mining Claim			Work Days Cr.	Mining Claim			Work Days Cr.
	Prefix	Number	Work Days Cr.		Prefix	Number	Work Days Cr.	
500	P	946128	38		946136	78		
for Performance of the following work. (Check one only)		" 29	38		" 37	78		
	<input type="checkbox"/> Manual Work	" 30	38					
	<input type="checkbox"/> Shaft Sinking Drifting or other Lateral Work.	" 31	38					
	<input type="checkbox"/> Compressed Air, other Power driven or mechanical equip.	" 32	38					
	<input type="checkbox"/> Power Stripping	" 33	38					
	<input checked="" type="checkbox"/> Diamond or other Core drilling	" 34	38					
<input type="checkbox"/> Land Survey	" 35	78						

All the work was performed on Mining Claim(s): 946131 and 946133

Required Information eg: type of equipment, Names, Addresses, etc. (See Table Below)

Diamond Drill: J.K.S. Schmidt 300

Owner/Operator: E. Colbert Diamond Drilling
167 Lakeshore Lane
Timmins, Ontario
P4N 7A1

RECORDED

FEB 12 1988

Work Completed between February 7, 1988 and February 7, 1988

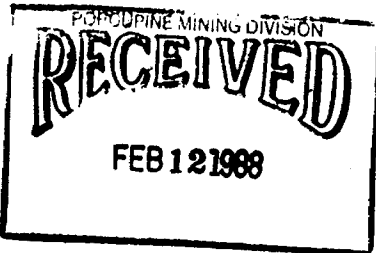
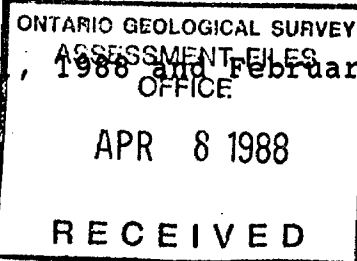

Date of Report: February 12/88
Recorded/Holder or Agent (Signature): *[Signature]*

Certification Verifying Report of Work

I hereby certify that I have a personal and intimate knowledge of the facts set forth in the Report of Work annexed hereto, having performed the work or witnessed same during and/or after its completion and the annexed report is true.

Name and Postal Address of Person Certifying
A.C. Amos, 165 Tamarack St.

Timmins, Ontario P4N 6P7

Date Certified: Feb. 12, 1988

Certified by (Signature): *[Signature]*

Table of Information/Attachments Required by the Mining Recorder

Type of Work	Specific information per type	Other information (Common to 2 or more types)	Attachments
Manual Work	Nil	Names and addresses of men who performed manual work/operated equipment, together with dates and hours of employment.	Work Sketch: these are required to show the location and extent of work in relation to the nearest claim post.
Shaft Sinking, Drifting or other Lateral Work			
Compressed air, other power driven or mechanical equip.	Type of equipment	Names and addresses of owner or operator together with dates when drilling/stripping done.	
Power Stripping	Type of equipment and amount expended. Note: Proof of actual cost must be submitted within 30 days of recording.		
Diamond or other core drilling	Signed core log showing; footage, diameter of core, number and angles of holes.	Nil	Work Sketch (as above) in duplicate
Land Survey	Name and address of Ontario land surveyor.		Nil



SHAW TWP. G-3999

South

Loyd Lake

Creek

5M

4M

5M

Handwritten scribbles and marks on the right side of the map.

Map contains numerous parcel numbers (e.g., 764451, 764452, 764453, 764454, 764455, 764456, 764457, 764458, 764459, 764460, 764461, 764462, 764463, 764464, 764465, 764466, 764467, 764468, 764469, 764470, 764471, 764472, 764473, 764474, 764475, 764476, 764477, 764478, 764479, 764480, 764481, 764482, 764483, 764484, 764485, 764486, 764487, 764488, 764489, 764490, 764491, 764492, 764493, 764494, 764495, 764496, 764497, 764498, 764499, 764500, 764501, 764502, 764503, 764504, 764505, 764506, 764507, 764508, 764509, 764510, 764511, 764512, 764513, 764514, 764515, 764516, 764517, 764518, 764519, 764520, 764521, 764522, 764523, 764524, 764525, 764526, 764527, 764528, 764529, 764530, 764531, 764532, 764533, 764534, 764535, 764536, 764537, 764538, 764539, 764540, 764541, 764542, 764543, 764544, 764545, 764546, 764547, 764548, 764549, 764550, 764551, 764552, 764553, 764554, 764555, 764556, 764557, 764558, 764559, 764560, 764561, 764562, 764563, 764564, 764565, 764566, 764567, 764568, 764569, 764570, 764571, 764572, 764573, 764574, 764575, 764576, 764577, 764578, 764579, 764580, 764581, 764582, 764583, 764584, 764585, 764586, 764587, 764588, 764589, 764590, 764591, 764592, 764593, 764594, 764595, 764596, 764597, 764598, 764599, 764600, 764601, 764602, 764603, 764604, 764605, 764606, 764607, 764608, 764609, 764610, 764611, 764612, 764613, 764614, 764615, 764616, 764617, 764618, 764619, 764620, 764621, 764622, 764623, 764624, 764625, 764626, 764627, 764628, 764629, 764630, 764631, 764632, 764633, 764634, 764635, 764636, 764637, 764638, 764639, 764640, 764641, 764642, 764643, 764644, 764645, 764646, 764647, 764648, 764649, 764650, 764651, 764652, 764653, 764654, 764655, 764656, 764657, 764658, 764659, 764660, 764661, 764662, 764663, 764664, 764665, 764666, 764667, 764668, 764669, 764670, 764671, 764672, 764673, 764674, 764675, 764676, 764677, 764678, 764679, 764680, 764681, 764682, 764683, 764684, 764685, 764686, 764687, 764688, 764689, 764690, 764691, 764692, 764693, 764694, 764695, 764696, 764697, 764698, 764699, 764700, 764701, 764702, 764703, 764704, 764705, 764706, 764707, 764708, 764709, 764710, 764711, 764712, 764713, 764714, 764715, 764716, 764717, 764718, 764719, 764720, 764721, 764722, 764723, 764724, 764725, 764726, 764727, 764728, 764729, 764730, 764731, 764732, 764733, 764734, 764735, 764736, 764737, 764738, 764739, 764740, 764741, 764742, 764743, 764744, 764745, 764746, 764747, 764748, 764749, 764750, 764751, 764752, 764753, 764754, 764755, 764756, 764757, 764758, 764759, 764760, 764761, 764762, 764763, 764764, 764765, 764766, 764767, 764768, 764769, 764770, 764771, 764772, 764773, 764774, 764775, 764776, 764777, 764778, 764779, 764780, 764781, 764782, 764783, 764784, 764785, 764786, 764787, 764788, 764789, 764790, 764791, 764792, 764793, 764794, 764795, 764796, 764797, 764798, 764799, 764800, 764801, 764802, 764803, 764804, 764805, 764806, 764807, 764808, 764809, 764810, 764811, 764812, 764813, 764814, 764815, 764816, 764817, 764818, 764819, 764820, 764821, 764822, 764823, 764824, 764825, 764826, 764827, 764828, 764829, 764830, 764831, 764832, 764833, 764834, 764835, 764836, 764837, 764838, 764839, 764840, 764841, 764842, 764843, 764844, 764845, 764846, 764847, 764848, 764849, 764850, 764851, 764852, 764853, 764854, 764855, 764856, 764857, 764858, 764859, 764860, 764861, 764862, 764863, 764864, 764865, 764866, 764867, 764868, 764869, 764870, 764871, 764872, 764873, 764874, 764875, 764876, 764877, 764878, 764879, 764880, 764881, 764882, 764883, 764884, 764885, 764886, 764887, 764888, 764889, 764890, 764891, 764892, 764893, 764894, 764895, 764896, 764897, 764898, 764899, 764900, 764901, 764902, 764903, 764904, 764905, 764906, 764907, 764908, 764909, 764910, 764911, 764912, 764913, 764914, 764915, 764916, 764917, 764918, 764919, 764920, 764921, 764922, 764923, 764924, 764925, 764926, 764927, 764928, 764929, 764930, 764931, 764932, 764933, 764934, 764935, 764936, 764937, 764938, 764939, 764940, 764941, 764942, 764943, 764944, 764945, 764946, 764947, 764948, 764949, 764950, 764951, 764952, 764953, 764954, 764955, 764956, 764957, 764958, 764959, 764960, 764961, 764962, 764963, 764964, 764965, 764966, 764967, 764968, 764969, 764970, 764971, 764972, 764973, 764974, 764975, 764976, 764977, 764978, 764979, 764980, 764981, 764982, 764983, 764984, 764985, 764986, 764987, 764988, 764989, 764990, 764991, 764992, 764993, 764994, 764995, 764996, 764997, 764998, 764999, 765000).

