

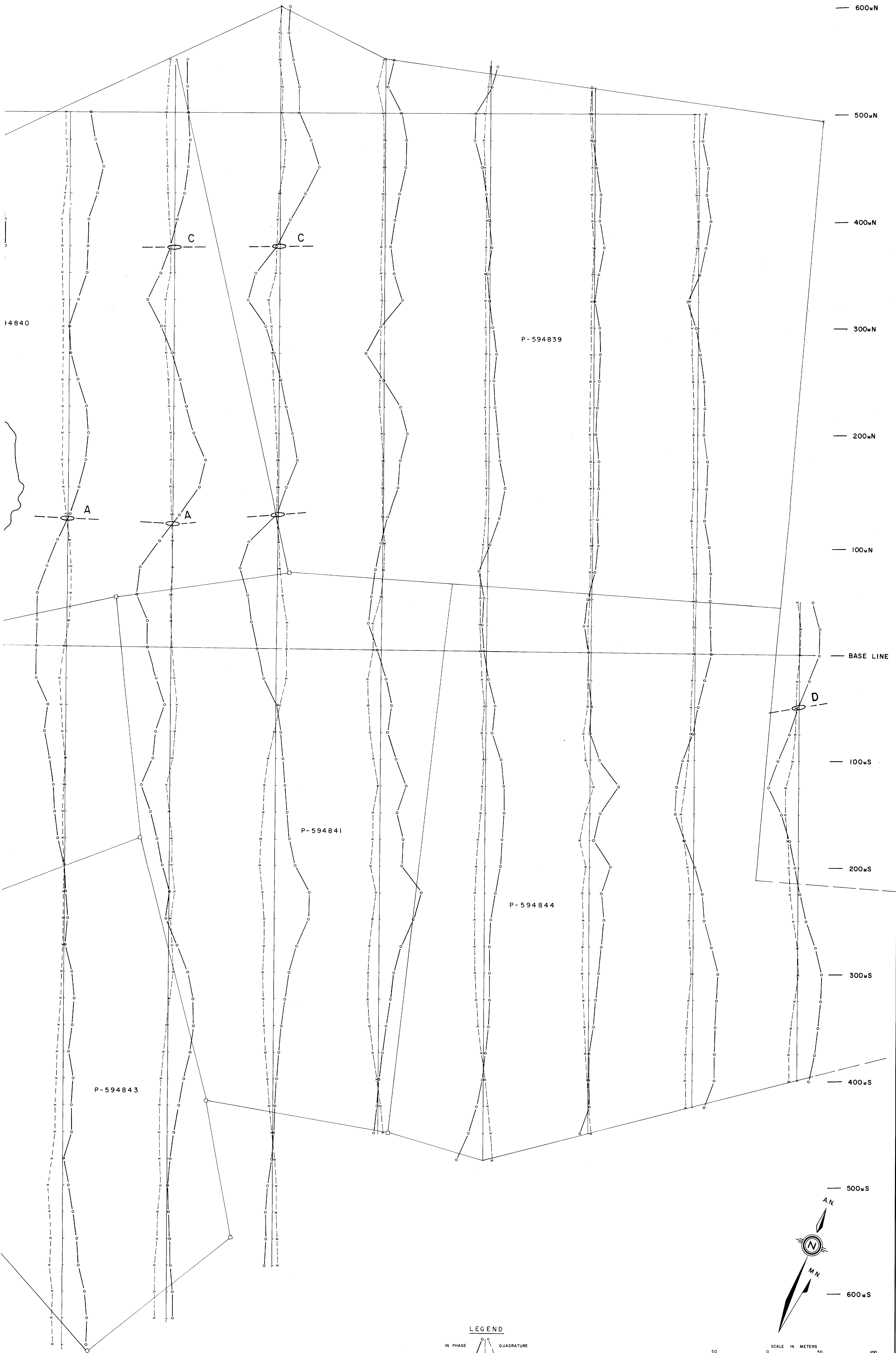

400wE 500wE 600wE 700wE 800wE 900wE 1000wE 1100wE



14840

600wN

500wN

400wN

300wN

200wN

100wN

BASE LINE

100wS

200wS

300wS

400wS

500wS

600wS

LEGEND

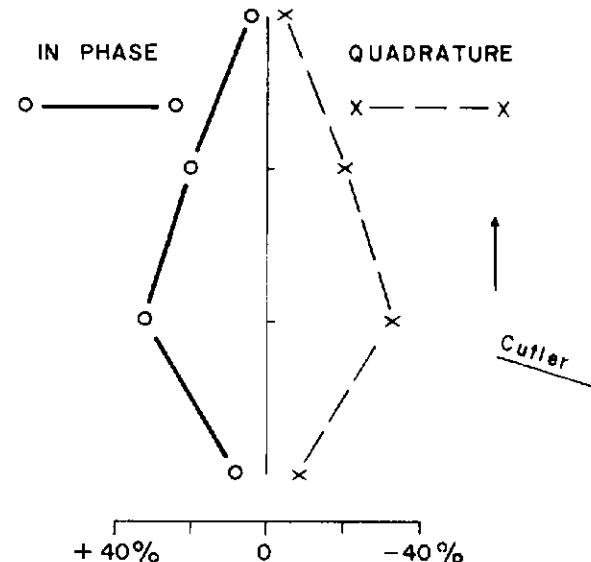

INSTRUMENT: GEONICS EM-16  
 STATION: CUTLER, MAINE  
 FREQUENCY: 17.8 kHz, COORDINATES: 67°17' W 44°39' N

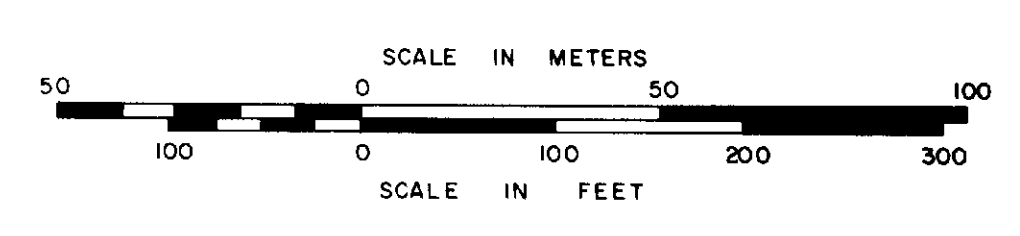

|  |                  |
|--|------------------|
| <b>VATCO EXPLORATION INCORPORATED</b>          |                  |
| VATRI PROJECT - DELWOOD PROPERTY               |                  |
| DELOORO TOWNSHIP, ONTARIO                      | 63.4034          |
| PORCUPINE MINING DIVISION                      |                  |
| <b>VLF EM-16 SURVEY</b>                        |                  |
| WORK CARRIED OUT BY MCGILL EXPLORATION LIMITED |                  |
| SCALE: 1:1250                                  | DRAFTED BY: gmes |
| CHECKED BY: G.M. THOMAS                        | MAP NO. 2        |

OMEP91-5-C-116



400mE

500mE

600mE

700mE

800mE

900mE

1000mE

1100mE

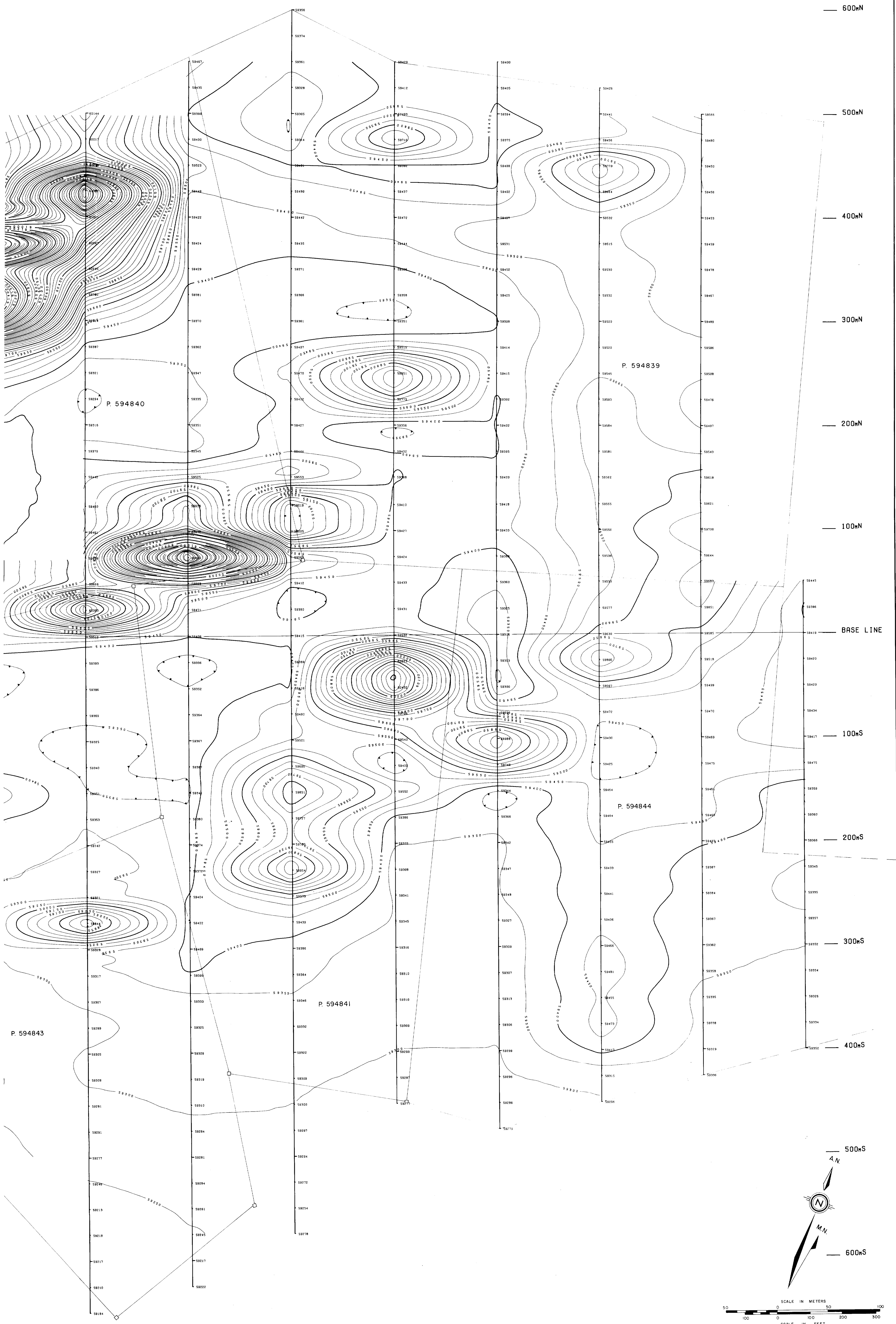

— 600mN

— 500mN

— 400mN

— 300mN

— 200mN

— 100mN

— BASE LINE

— 100mS

— 200mS

— 300mS

— 400mS

— 500mS

— 600mS

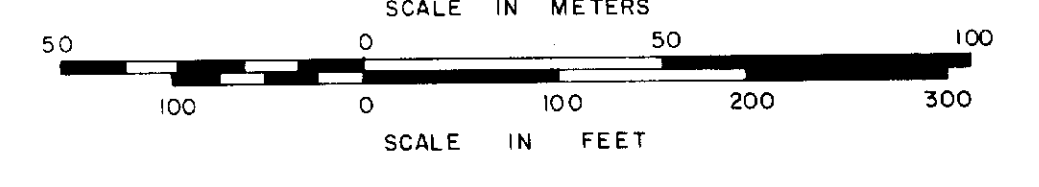
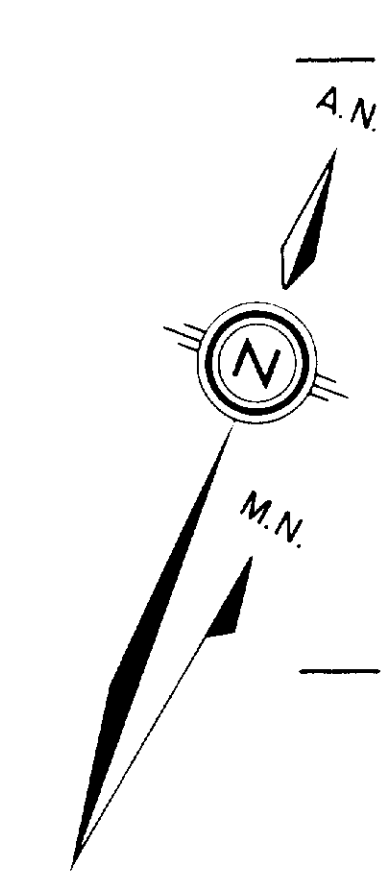

LEGEND

— 58300 UNITS OF GAMMAS  
 (Earth's total field accuracy of  $\pm 1$  gamma)

— 58400 CONTOUR INTERVAL 50 GAMMAS

INSTRUMENT: SCINTREX MP-2 PROTON PRECESSION MAGNETOMETER

|  |                  |
|--|------------------|
| VATCO EXPLORATION INCORPORATED                 |                  |
| VATRI PROJECT — DELWOOD PROPERTY               |                  |
| DELOORO TOWNSHIP, ONTARIO 63.4034              |                  |
| PORCUPINE MINING DIVISION                      |                  |
| <b>MAGNETIC SURVEY</b>                         |                  |
| WORK CARRIED OUT BY MCGILL EXPLORATION LIMITED |                  |
| SCALE: 1:1250                                  | DRAFTED BY: gmes |
| CHECKED BY: G. M. THOMAS                       | MAP NO. 3        |

0MEP81-5-C-116

400mE 500mE 600mE 700mE 800mE 900mE 1000mE 1100mE

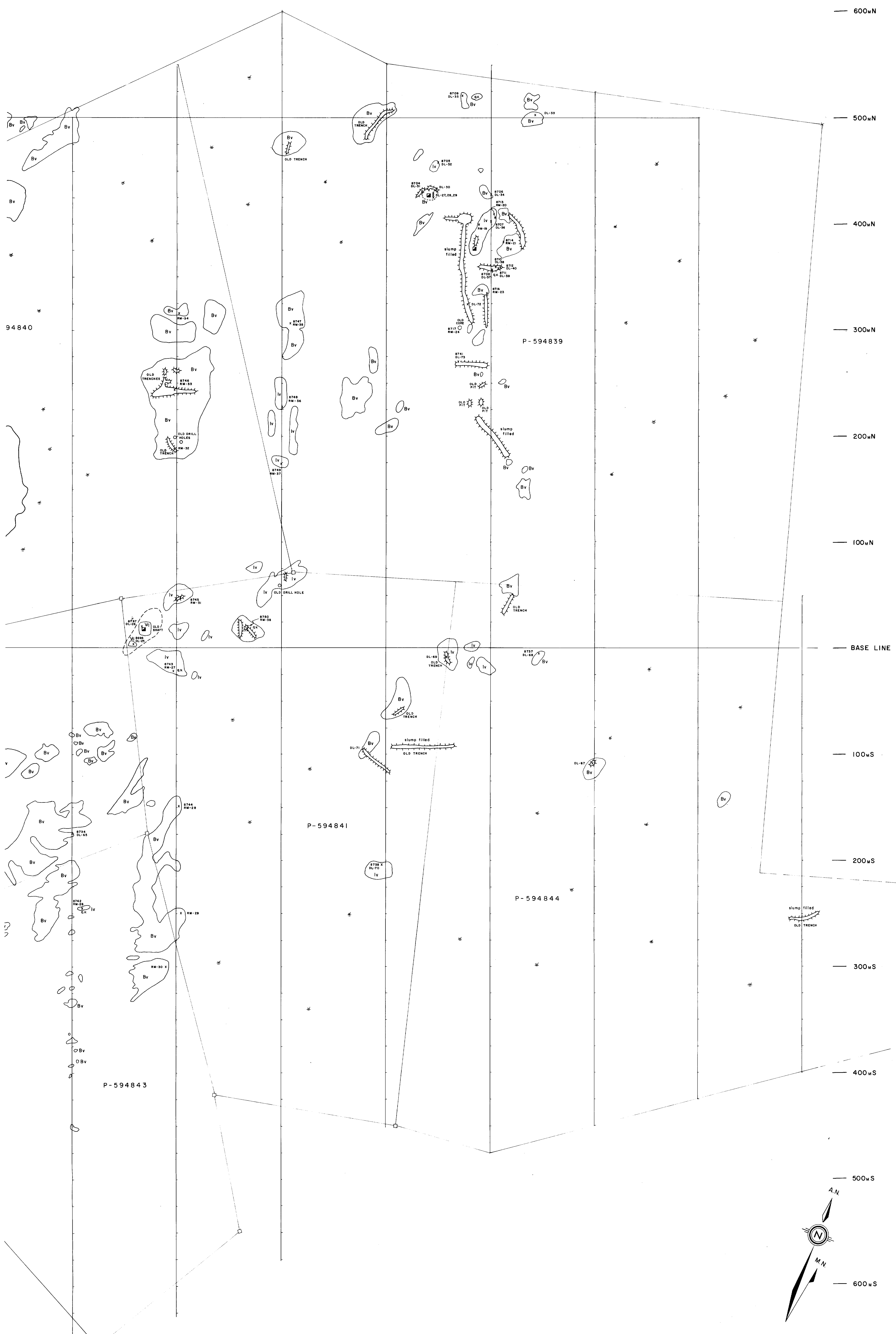

**LEGEND**  
 QUATERNARY  
 PLEISTOCENE AND RECENT  
 MORAINE  
 PRECAMBRIAN  
 KEEWATIN  
 Vc RUSTY WEATHERING CARBONATE DERIVED FROM KEEWATIN LAVAS  
 Vb VOLCANIC BRECCIA AND PYROCLASTICS  
 Iv INTERMEDIATE VOLCANIC  
 Bv BASIC VOLCANIC

**SYMBOLS**  
 SWAMP, MUSKEG  
 SHAFT  
 TRENCH  
 PIT  
 TAILINGS  
 ROCK SAMPLE NUMBER  
 SAMPLE ASSAY NUMBER  
 OUTCROP  
 GEOLOGICAL BOUNDARY  
 Qv QUARTZ VEIN

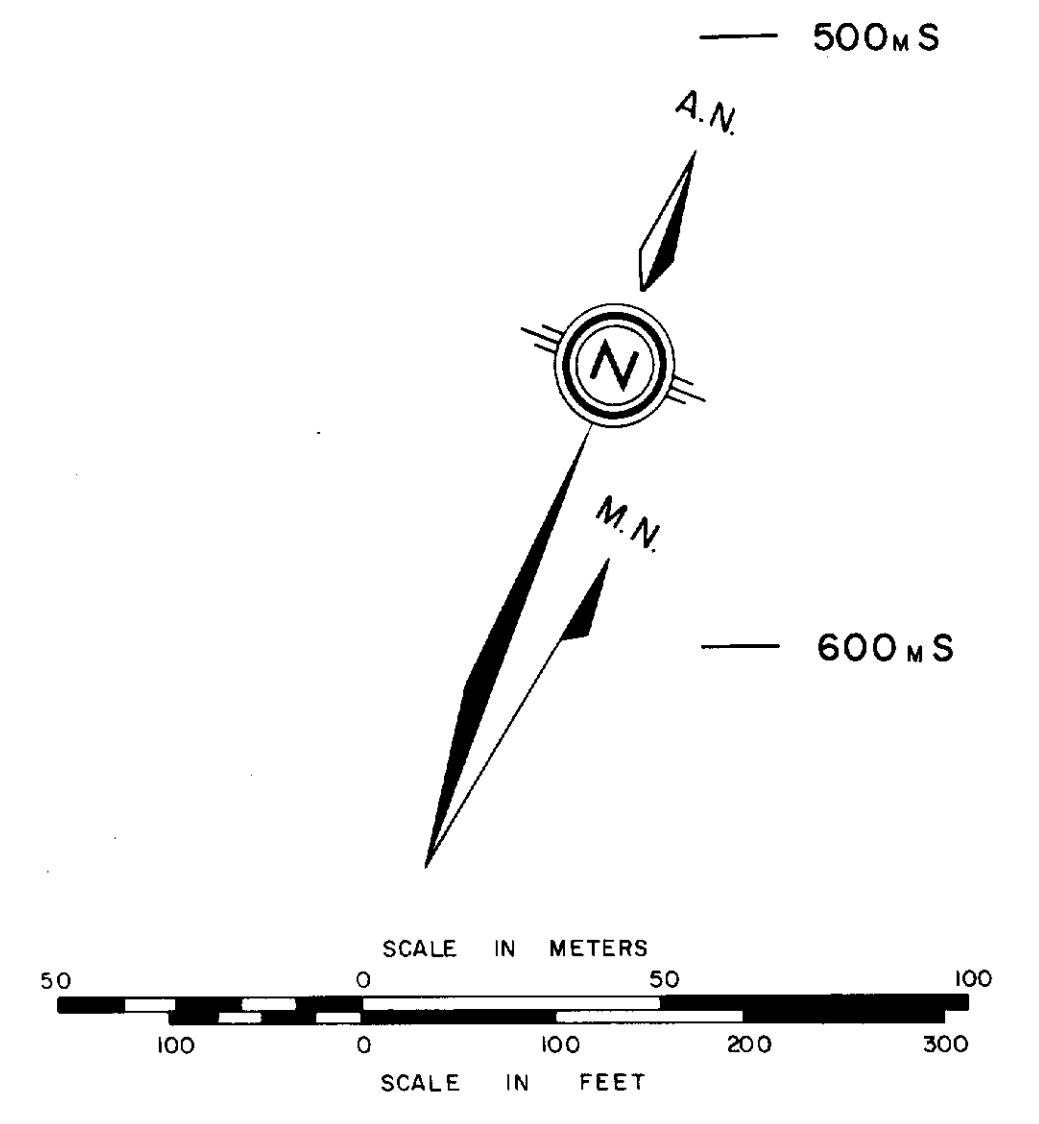

|  |                  |
|--|------------------|
| <b>VATCO EXPLORATION INCORPORATED</b>          |                  |
| VATRI PROJECT - DELWOOD PROPERTY               |                  |
| DELORO TOWNSHIP, ONTARIO                       | 63-4034          |
| PORCUPINE MINING DIVISION                      |                  |
| <b>GEOLOGY</b>                                 |                  |
| WORK CARRIED OUT BY MCGILL EXPLORATION LIMITED |                  |
| SCALE: 1:1250                                  | DRAFTED BY: gmes |
| CHECKED BY: G. M. THOMAS                       | MAP NO. 4        |

OME87-5-C-116

800W 700W 650W 600W

1000N

550W 500W 450W 400W

900N

350W 300W 250W 200W

800N

700N

600N

B

P 530598

100W

0

TL 500N

P 529005

P 567522

400N

300N

C

200N

100N

BASE LINE

P 530599

100S

100W

0

200S

300S

750W 700W 650W 600W 550W 500W 450W 400W 350W 300W 250W 200W

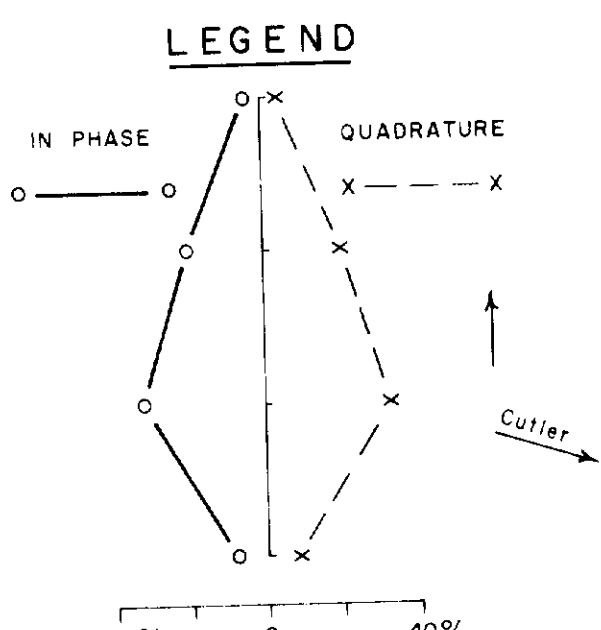
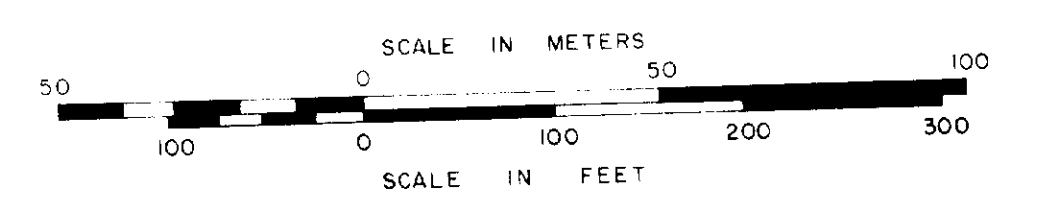
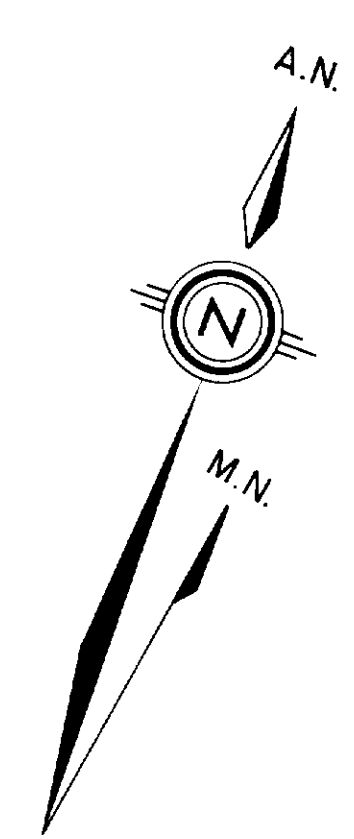

INSTRUMENT: GEONICS EM-16  
STATION: CUTLER, MAINE  
FREQUENCY: 17.8 kHz, COORDINATES: 67°17'W 44°39'N

|  |                 |
|--|-----------------|
| <b>VATCO EXPLORATION INCORPORATED</b>          |                 |
| VATRI PROJECT - BIG DYKE PROPERTY              |                 |
| DELORO TOWNSHIP, ONTARIO 63-4034               |                 |
| PORCUPINE MINING DIVISION                      |                 |
| <b>VLF EM-16 SURVEY</b>                        |                 |
| WORK CARRIED OUT BY MCGILL EXPLORATION LIMITED |                 |
| SCALE: 1:1250                                  | DRAFTED BY: UNK |
| CHECKED BY: G.M. THOMAS                        | MAP NO: 2       |

OMEPS-1-5-C-116



750mW 700mW 650mW 600mW 550mW 500mW 450mW 400mW 350mW 300mW 250mW 200mW 100mW 0W

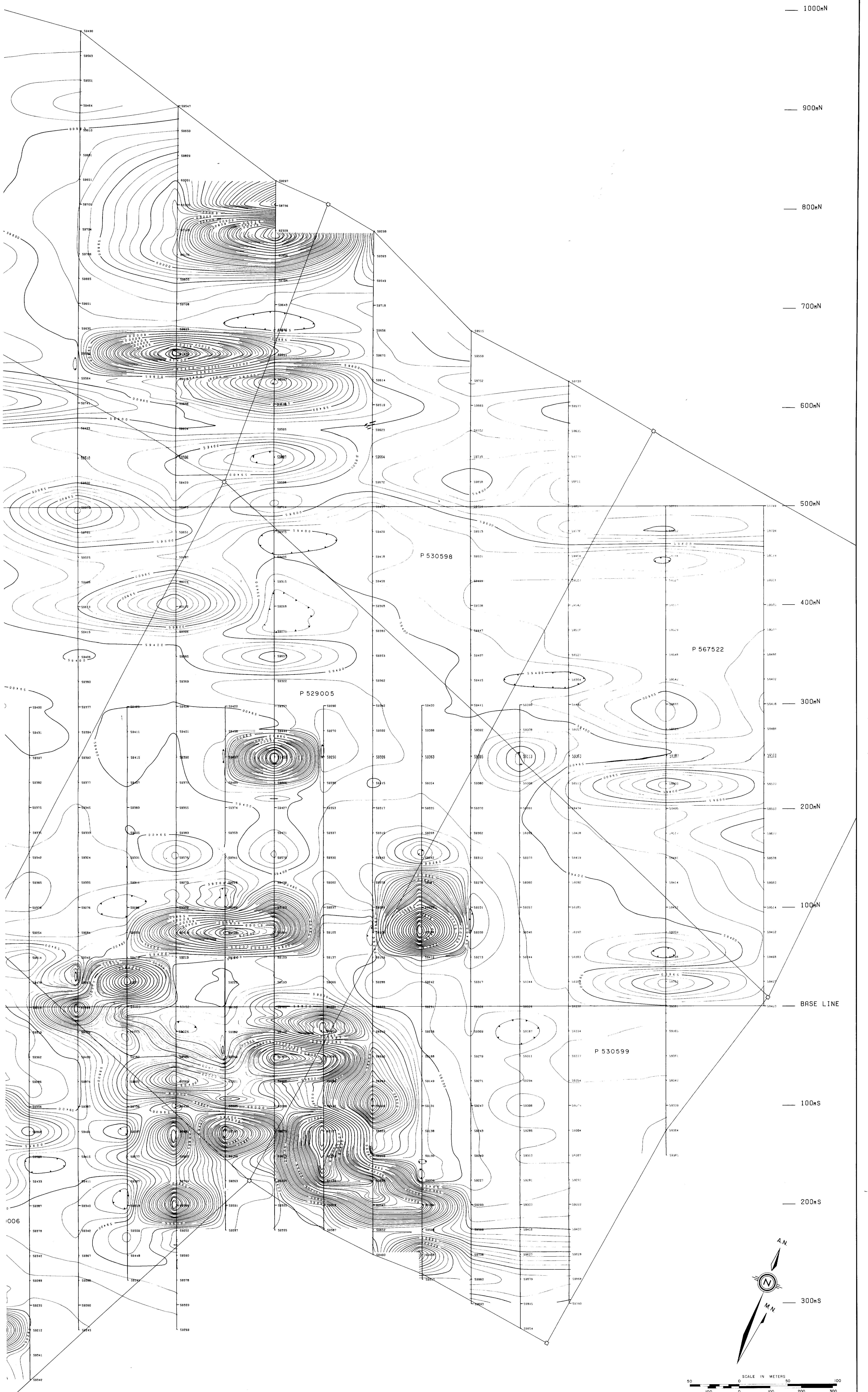

— 1000N

— 900N

— 800N

— 700N

— 600N

— 500N

— 400N

— 300N

— 200N

— 100N

— BASE LINE

— 100mS

— 200mS

— 300mS

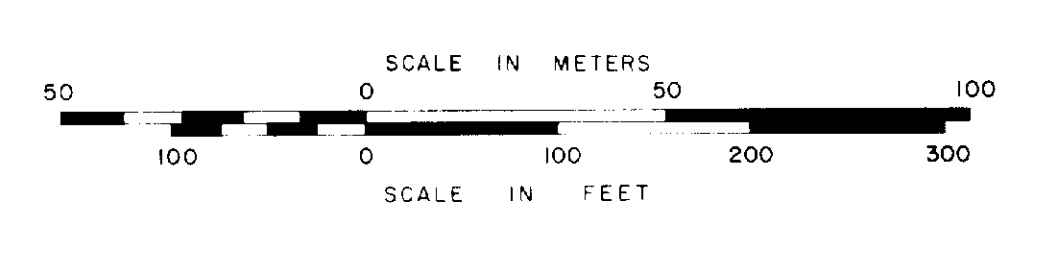
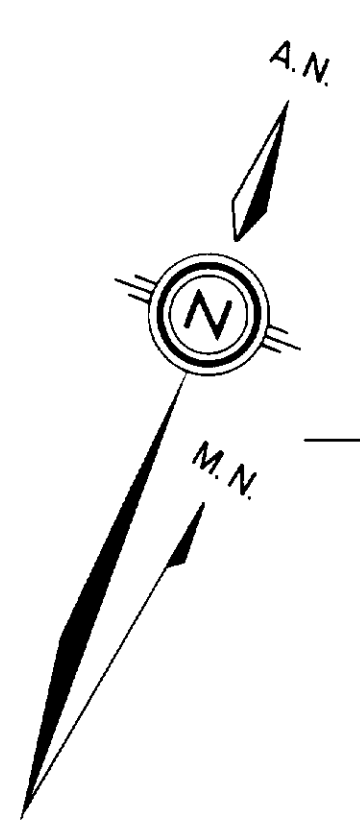

LEGEND

UNITS OF GAMMAS  
(Earth's total field accuracy of ±1 gamma)

— 50 GAMMAS  
CONTOUR INTERVAL 50 GAMMAS

INSTRUMENT: SINTREX MP-2 PROTON PRECESSION MAGNETOMETER

|  |                  |
|--|------------------|
| VATCO EXPLORATION INCORPORATED                 |                  |
| VATRI PROJECT — BIG DYKE PROPERTY              |                  |
| DELORE TOWNSHIP, ONTARIO                       | 63-4034          |
| PORCUPINE MINING DIVISION                      |                  |
| <b>MAGNETIC SURVEY</b>                         |                  |
| WORK CARRIED OUT BY MCGILL EXPLORATION LIMITED |                  |
| SCALE: 1:7500                                  | DRAFTED BY: gmax |
| CHECKED BY: S.W. THOMAS                        | MAP NO: 3        |

07 SEP 81-5-C-116



750W 700W 650W 600W

550W 500W 450W 400W

350W 300W 250W 200W

1000N

900N

800N

700N

600N

TL 500N

400N

300N

200N

100N

BASE LINE

100S

200S

300S

750W 700W 650W 600W 550W 500W 450W 400W 350W 300W 250W 200W

LEGEND

QUATERNARY  
PLEISTOCENE AND RECENT  
MORaine

PRECAMBRIAN

KEEWATIN

IF BANDED SILICIOUS IRON FORMATION  
Vc RUSTY WEATHER CARBONATE DELIVERED FROM KEEWATIN VOLCANICS  
Vb FRAGMENTAL LAVA, BRECCIA AND PYROCLASTICS  
Iv INTERMEDIATE LAVA INCLUDING TUFF  
Bv BASIC LAVA, IN PART FLOWS, PILLOW LAVA, MINOR BRECCIA (IN PART POSSIBLY LAMPS)

SYMBOLS

SWAMP, MUSKED  
ROAD  
SHAFT  
TRENCH  
PIT  
TAILINGS  
ROCK SAMPLE NUMBER  
SAMPLE ASSAY NUMBER  
OUTCROP  
GEOLOGICAL BOUNDARY  
STRIKE AND DIP OF BEDDING  
QUARTZ VEIN

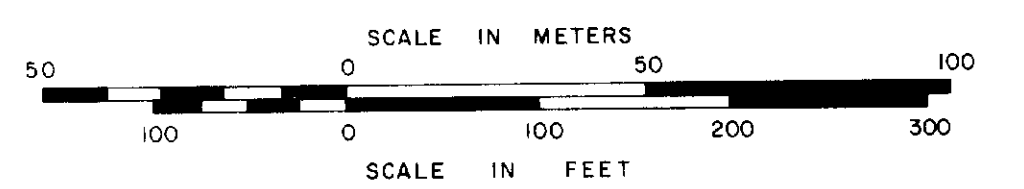

VATCO EXPLORATION INCORPORATED  
VATRI PROJECT - BIG DYKE PROPERTY  
DE LORO TOWNSHIP, ONTARIO  
PORCUPINE MINING DIVISION  
GEOLOGY  
WORK CARRIED OUT BY MCGILL EXPLORATION LIMITED  
SCALE: 1:1250  
DRAFTED BY: gmes  
CHECKED BY: G.M. THOMAS  
MAP NO. 4  
63-4034  
OMEPB1-5-C-116

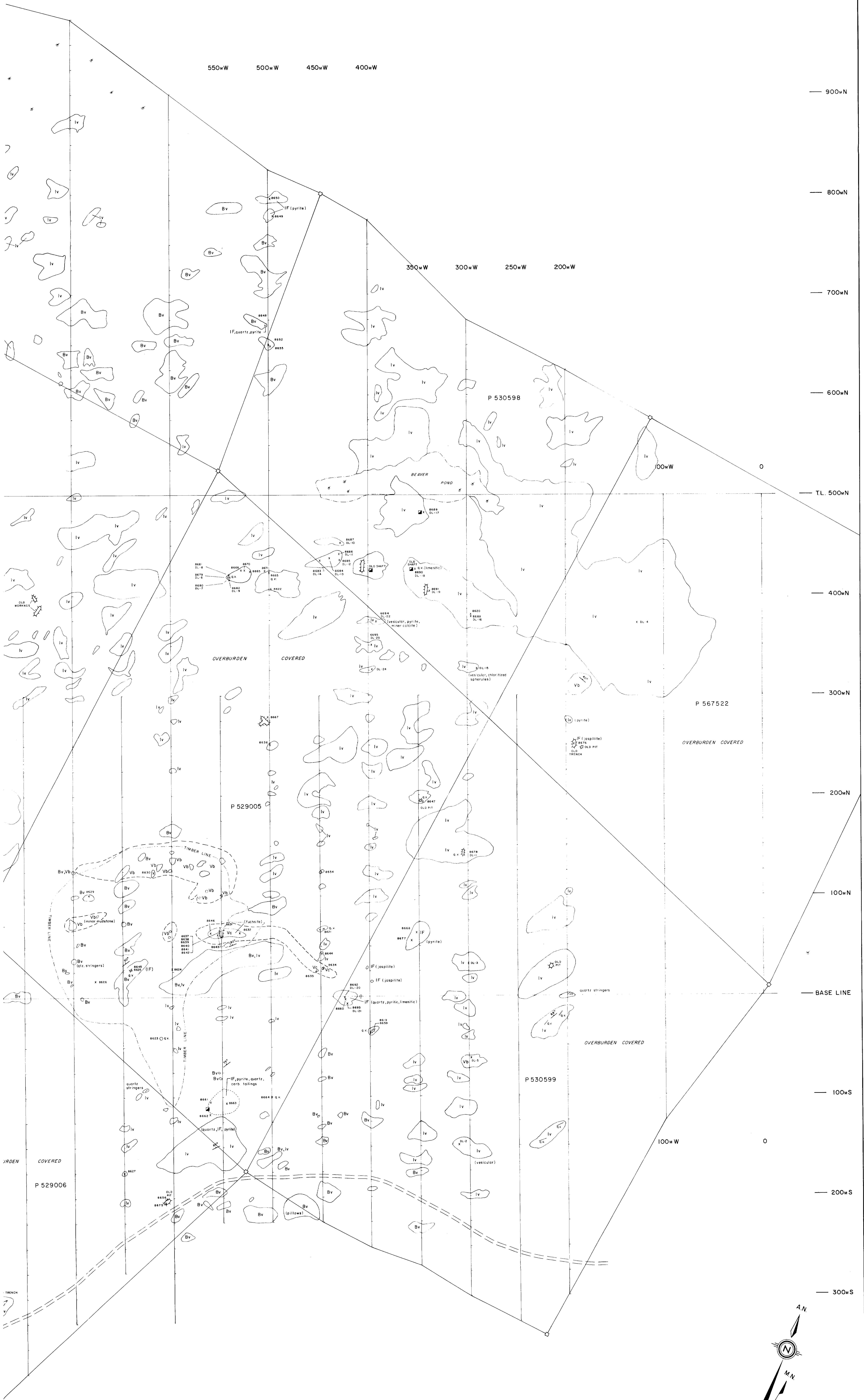

100wE

200wE

300wE

400wE

500wE

600wE

700wE

600wN

T.L. 500wN

400wN

300wN

200wN

100wN

B.L.

100wS

200wS

300wS

400wS

500wS

600wS

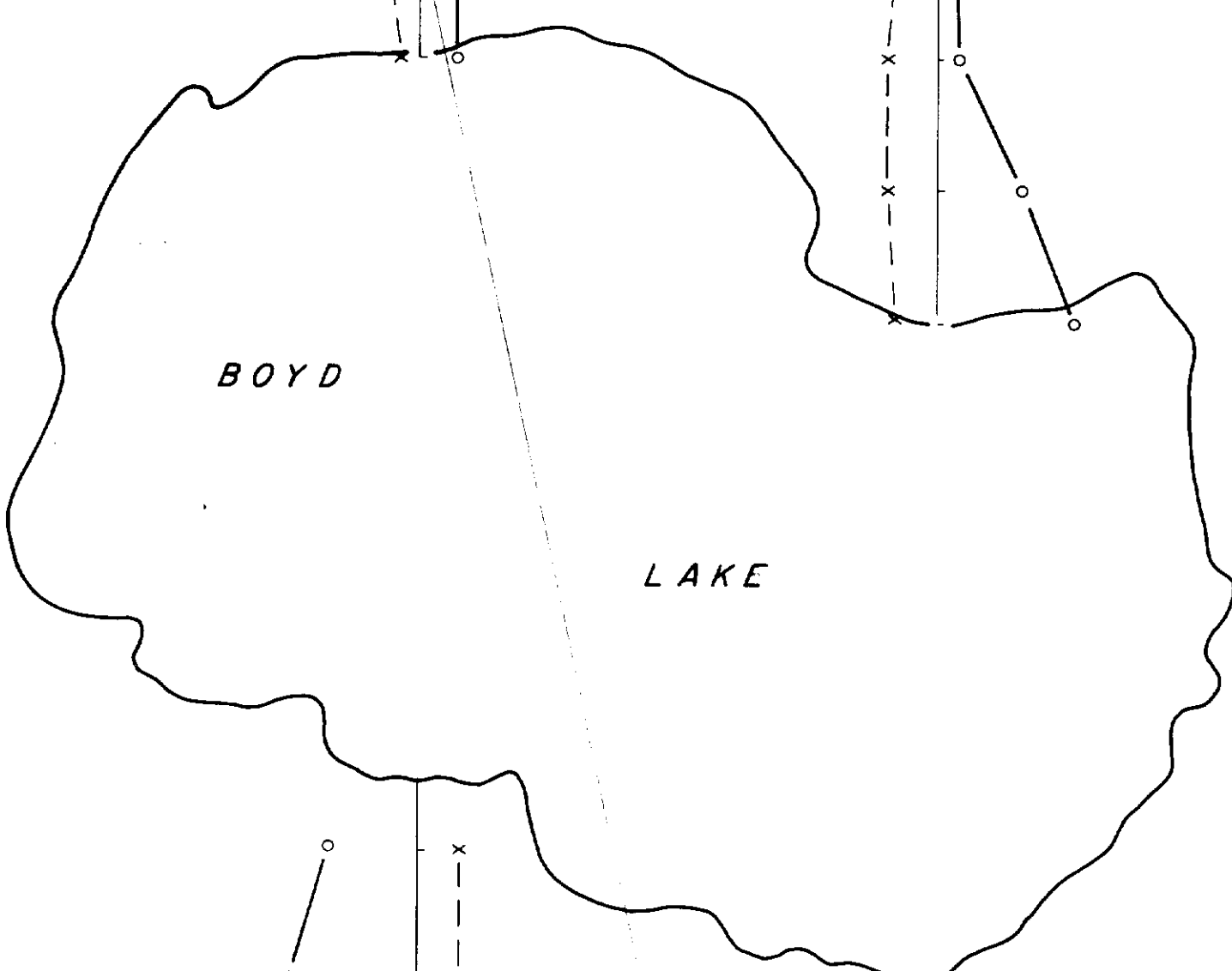

P-594840

P-594842

P-594843

P-594841

B

A

C

C

IN P

○

+

INST

ST

FREQUENCY : 17-6





100nE

200nE

300nE

400nE

500nE

600nE

700nE

600nN

500nN

400nN

300nN

200nN

100nN

BASE LINE

100nS

200nS

300nS

400nS

500nS

600nS

BOYD

LAKE

P. 594840

P. 594842

P. 594843

P. 594841







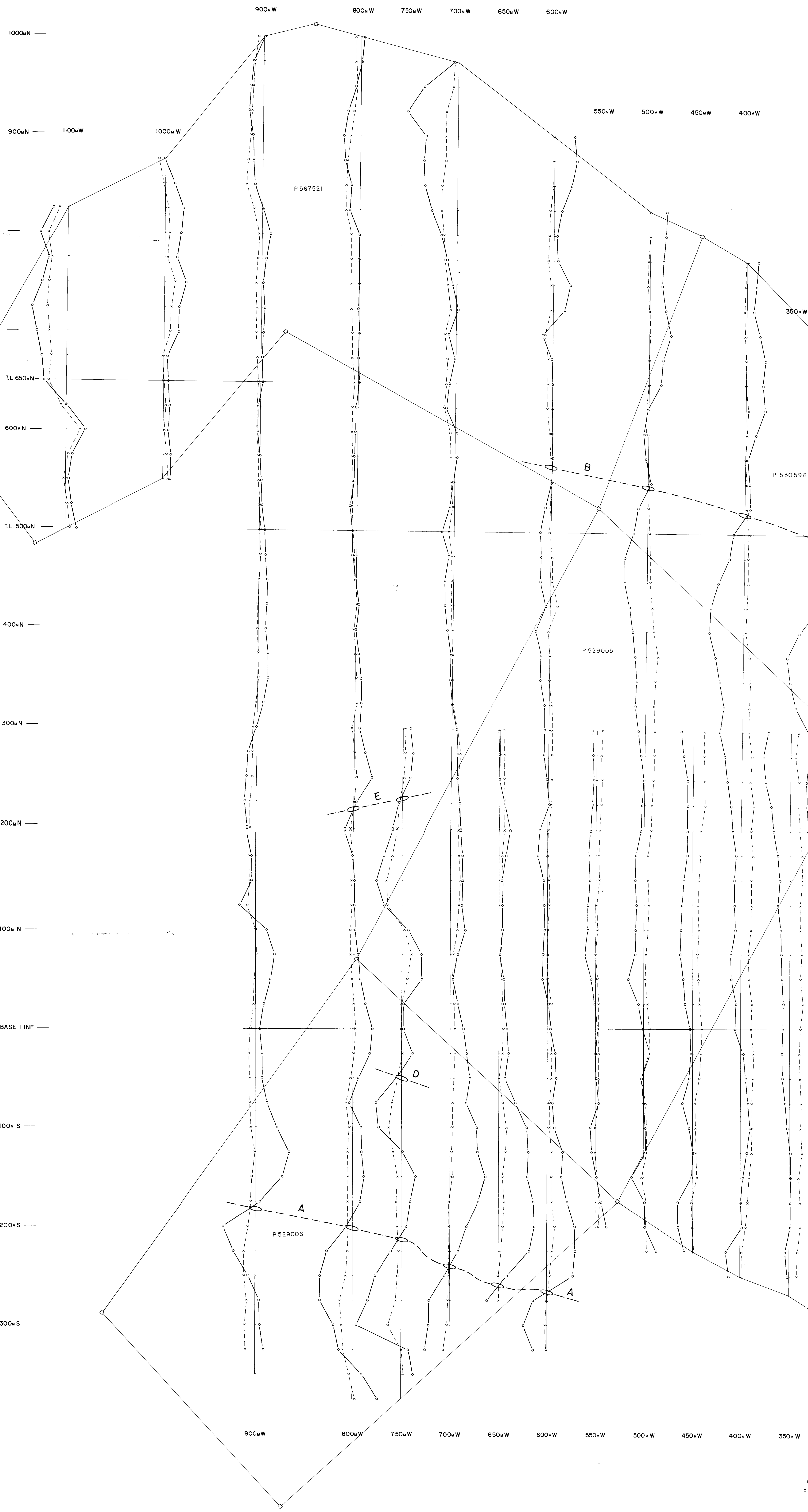

1100mW 1000mW 900mW 800mW 750mW 700mW 650mW 600mW 550mW 500mW 450mW 400mW 350mW

1000mN

900mN

800mN

700mN

600mN

T.L. 500mN

400mN

300mN

200mN

100mN

BASE LINE

100mS

200mS

300mS

P 567521

P 529005

P 529006

P 530





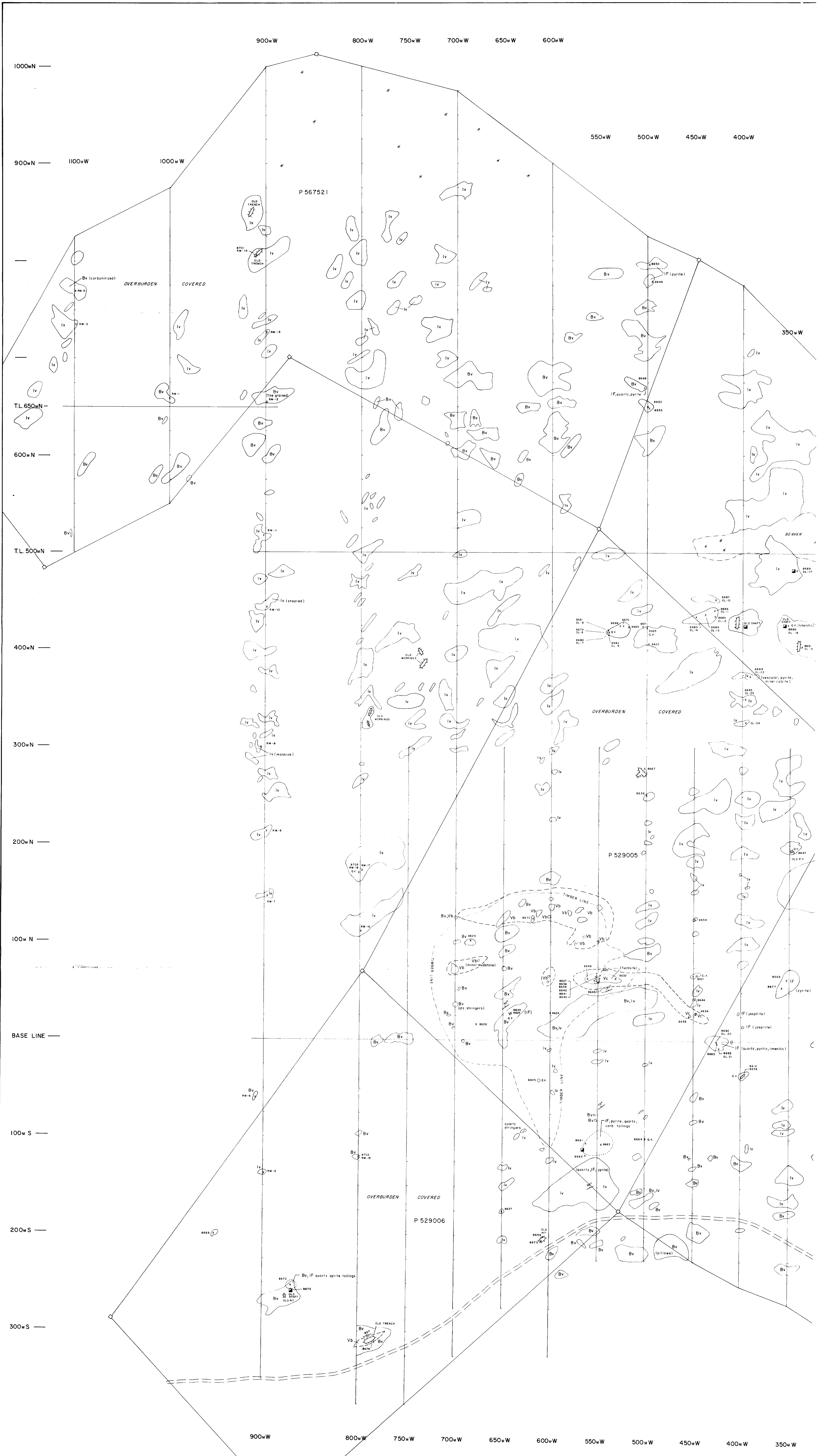

LEGEND

- QUATERNARY  
 PLEISTOCENE AND RECENT  
 MORaine
- PRECAMBRIAN  
 KEEWATIN  
 IF BANDED SILICIOUS IRON FORMATION  
 Vc RUSTY WEATHER, CARBONATE DELIVERED FROM KEEWATIN VOLCANICS  
 Vb FRAGMENTARY LAVA, BRECCIA AND PYROCLASTICS  
 Iv INTERMEDIATE LAVA INCLUDING TUFF  
 Bv BASIC LAVA, IN PART FLOWS, PILLOW LAVA, MINOR BRECCIA (IN PART POSSIBLY *flows*)

SYMBOLS

- SWAMP, MUSKEG  
 ROAD  
 SHAFT  
 TRENCH  
 PIT  
 TAILINGS  
 ROCK SAMPLE NUMBER  
 SAMPLE ASSAY NUMBER  
 OUTCROP  
 GEOLOGICAL BOUNDARY  
 STRIKE AND DIP OF BEDDING  
 QUARTZ VEIN

