



42A06NE0419 2.4241 DELORO

010

McGill Exploration Limited
Report of Geophysical Work
Deloro Township
Porcupine Mining Division

RECEIVED

OCT 30 1981

MINING LANDS SECTION

INTRODUCTION:

A program of linecutting and ground geophysical surveying was carried out on 6 contiguous mining claims in Deloro Township between August 13 and September 12, 1981.

The work was performed by McGill Exploration Limited on behalf of Thomas Skimming & Associates Limited acting for Vatco Exploration, Inc. of Mississauga, Ontario.

PROPERTY:

The property consists of 6 unpatented mining claims situated in Deloro Township approximately 6 miles south-east of the City of Timmins (see Plan 1).

The claims are numbered as follows:

- P.594839
- P.594840
- P.594841
- P.594842
- P.594843
- P.594844

ACCESS:

The property is reached by gravel road heading south from the Buffalo Ankerite headframe for a distance of about 2 miles. The claims lie along the access road to the old Faymar Mine approximately 1/4 mile off to the east.

LINECUTTING:

A baseline originating at Post 4 of claim P.594842 traverses the property at N.105°E. Picket lines were turned-off perpendicular to the baseline every 100 meters. Parallel to baseline, line 5+00N ties in

picket lines 1+00E to 10+00E. In total, 12.4 kilometers of line was cut and picketed to provide control for geophysical surveying.

ELECTROMAGNETIC SURVEY:

A VLF electromagnetic survey was performed on the control lines using the Geonics EM-16 receiver tuned to transmitter NAA (17.8 kHz) in Cutler, Maine. The inphase and quadrature components of the secondary field were measured in percentages as a function of the tilt of the instrument relative to the horizontal (primary) field. Readings were taken facing northerly along the lines and recorded at 25 meter intervals. The data is plotted in profile and is presented as Plan 2.

MAGNETIC SURVEY:

A magnetic survey was performed using the Scintrex MP-2 Proton Precession magnetometer. Base stations were established at each baseline/picket line intersection for diurnal correction and all measurements were calculated relative to the base station readings. The magnetic field was measured to an accuracy of ± 5 gammas at 25 meter intervals (see Plan 3).

CONCLUSION:

A geological survey is required in order to evaluate the significance of the geophysical data.

October 27, 1981
Timmins, Ontario

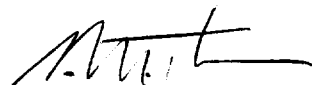
G. M. Thomas
Geologist

2-4208



Ministry of
Natural
Resources

Deloro

Report of Work
(Geophysical, Geological,
Geochemical and Expenditures)

Check

2.4241
569

P-594829



42A06NE0419 2.4241 DELORO

The Mining Act

900

Type of Survey(s) **Geophysical** Deloro

Claim Holder(s) **B. Vatri** Prospector's Licence No. **M-21337**

Survey Company **McGill Exploration Limited** Survey Dates (linecutting to office) **13** **8** **81** **12** **9** **81**
Day Mo. Yr. Day Mo. Yr. Total Miles of line Cut **7.5**

Name and Address of Author (of Geo-Technical report) **G. M. Thomas, 33 Young Road, Kanata, Ontario.** **2.4241**

Special Provisions Credits Requested

Instructions	Geophysical	Days per Claim
For first survey: Enter 40 days. (This includes line cutting)	- Electromagnetic	40
	- Magnetometer	20
For each additional survey: using the same grid: Enter 20 days (for each)	- Radiometric	
	- Other	
	Geological	
	Geochemical	

Mining Claims Traversed (List in numerical sequence)

Mining Claim			Mining Claim		
Prefix	Number	Expend. Days Cr.	Prefix	Number	Expend. Days Cr.
P.	594839				
	594840				
	594841				
	594842				
	594843				
	594844				

in Days

Instructions	Geophysical	Days per Claim
Complete reverse side and enter total(s) here	- Electromagnetic	
	- Magnetometer	
	- Radiometric	
	- Other	
	Geological	
	Geochemical	

Airborne Credits

Note: Special provisions credits do not apply to Airborne Surveys.		Days per Claim
	Electromagnetic	
	Magnetometer	
	Radiometric	

Expenditures (excludes power stripping)

Type of Work Performed **RECORDED**

Performed on Claim(s) **DEC 5 0 1981**

Receipt No.

Calculation of Expenditure Days Credits

Total Expenditures \$ + **15** =

Total Days Credits

Instructions: Total Days Credits may be apportioned at the claim holder's choice. Enter number of days credits per claim selected in columns at right.

Report Completed

Date of Report **Oct. 27, 1981**

Recorded Holder or Agent (Signature) *[Signature]*

Certification Verifying Report of Work

I hereby certify that I have a personal and intimate knowledge of the facts set forth in the Report of Work annexed hereto, having performed the work or witnessed same during and/or after its completion and the annexed report is true.

Name and Postal Address of Person Certifying **G. M. Thomas, 33 Young Road, Kanata, Ontario.**

Date Certified **Dec. 14, 1981**

Certified by (Signature) *[Signature]*

RECEIVED
JAN - 6 1982
MINING LANDS SECTION

For Office Use Only

Total Days Cr. Recorded **360**

Date Recorded **Dec 30/81**

Date Approved or Recorded **83:05:10**

Total number of mining claims covered by this report of work. **6**

Mining Recorder *[Signature]*

Regional Mining Recorder *[Signature]*



Ministry of
Natural
Resources

Deloro
Report of Work
(Geophysical, Geological,
Geochemical and Expenditures)

569

Instructions: - Please type or print.
- If number of mining claims traversed exceeds space on this form, attach a list.
Note: - Only days credits calculated in the "Expenditures" section may be entered in the "Expend. Days Cr." columns.
- Do not use shaded areas below.

The Mining Act

Type of Survey(s) **Geophysical** Township or Area **Deloro**
 Claim Holder(s) **B. Vatri** Prospector's Licence No. **M-21337**
 Survey Company **McGill Exploration Limited** Survey Dates (linecutting to office) **13 8 81 12 9 81** Total Miles of line Cut **7.5**
 Name and Address of Author (of Geo-Technical report) **G. M. Thomas, 33 Young Road, Kanata, Ontario.**

Special Provisions Credits Requested

Instructions	Geophysical	Days per Claim
For first survey: Enter 40 days. (This includes line cutting)	- Electromagnetic	40
	- Magnetometer	20
For each additional survey: using the same grid: Enter 20 days (for each)	- Radiometric	
	- Other	
	Geological	
	Geochemical	

Plan Days

Instructions	Geophysical	Days per Claim
Complete reverse side and enter total(s) here	- Electromagnetic	
	- Magnetometer	
	- Radiometric	
	- Other	
	Geological	
	Geochemical	

Airborne Credits

Instructions	Days per Claim
Note: Special provisions credits do not apply to Airborne Surveys.	
Electromagnetic	
Magnetometer	
Radiometric	

Expenditures (excludes power stripping)

Type of Work Performed **RECORDED**

Performed on Claim(s) **DEC 30 1981**

Receipt No.

Calculation of Expenditure Days Credits

Total Expenditures \$ + 15 = Total Days Credits

Instructions: Total Days Credits may be apportioned at the claim holder's choice. Enter number of days credits per claim selected in columns at right.

Report Completed

Date of Report **Oct. 27, 1981** Recorded Holder or Agent (Signature) *[Signature]*

Certification Verifying Report or WBK

I hereby certify that I have a personal and intimate knowledge of the facts set forth in the Report of Work annexed hereto, having performed the work or witnessed same during and/or after its completion and the annexed report is true.

Name and Postal Address of Person Certifying **G. M. Thomas, 33 Young Road, Kanata, Ontario.**

Date Certified **Dec 14, 1981** Certified by (Signature) *[Signature]*

Mining Claims Traversed (List in numerical sequence)

Prefix	Mining Claim		Expend. Days Cr.	Prefix	Mining Claim		Expend. Days Cr.
	Number				Number		
P	594839						
	594840						
	594841						
	594842						
	594843						
	594844						

Qual.
2.4208

RECEIVED
JAN - 5 1982
MINING LANDS SECTION

For Office Use Only

Total Days Cr. Recorded **360** Date Recorded **Dec 30/81** Mining Recorder *[Signature]*

Date Approved as Recorded **Dec 30/81** Regional/Branch Director *[Signature]*
Regional Mining Recorder *[Signature]*

Total number of mining claims covered by this report of work **6**



Ministry of
Natural
Resources

Ontario

2.4241

1983 03 03

Your file:

Our file: 2.4150
2.4208
2.4241 ✓
2.4224

Mr. Christian Von Hessert
49 Wellington Street East
Toronto, Ontario
M5E 1C9

Dear Sir:

I understand that you are endeavouring to provide the required data for geophysical surveys of Mining Claims P 529005 et al held by Mr. B. Vatri. As you requested, I have extended the time for submitting the missing maps from March 7 to March 31, 1983.

Yours very truly,

E.F. Anderson
Director
Land Management Branch

Whitney Block, Room 6450
Queen's Park
Toronto, Ontario
M7A 1W3
Phone: 416/965-1380

John F.W. Matthews:sc

ok now!

1983 02 18

2.4241

Mr. B. Vatri
11 Cherry Post Crescent
Etobicoke, Ontario
M9C 2T5

Dear Sir:

RE: Geophysical (Electromagnetic and Magnetometer) Survey
submitted on Mining Claims P 594839 et al in the
Township of Deloro

Enclosed is a copy of our letter dated November 9, 1982 requesting additional information for the above mentioned survey.

Unless you can provide the required data by March 7, 1983, the mining recorder will be directed to cancel the work credits recorded on December 30, 1981.

For further information, please contact Mr. F.W. Matthews at 416/965-1380.

Yours very truly,

E.F. Anderson
Director
Land Management Branch

Whitney Block, Room 6450
Queen's Park
Toronto, Ontario
M7A 1W3
Phone: 416/965-1380

Diane Wice:sc

Encls:

cc: Mr. G.M. Thomas
Kanata, Ontario

cc: Mining Recorder
Timmins, Ontario

2.4241
~~2.0421~~

November 9, 1982

Mr. B. Vatri
11 Cherry Post Crescent
Etobicoke, Ontario
M9C 2T5

Dear Sir:

Further to our letter dated November 3, 1982, we have located the file covering Mining Claims P 594839-44 inclusive in the Township of Deloro. Please disregard our previous notice regarding this matter.

However, we are still waiting for maps (in duplicate) to be returned to this office. The following information was requested from Mr. G.M. Thomas of McGill Exploration Ltd., on May 17, 1982:

- (a) V.L.F. maps need the values of the readings.
- (b) The magnetometer maps must be contoured.

For further information, please contact Mr. F.W. Matthews at 416/965-1380.

Yours very truly,

E.F. Anderson
Director
Land Management Branch

Whitney Block, Room 6450
Queen's Park
Toronto, Ontario
M7A 1W3
Phone: 416/965-1316

Diene Wice

cc: Mining Recorder
Porcupine, Ontario

1982 05 17

2.4241

McGill Exploration Limited
33 Young Road
Kanata, Ontario
K2L 1V9

Attention: Mr. G.M. Thomas

Dear Sir:

RE: Geophysical (Electromagnetic and Magnetometer)
Survey submitted on Mining Claims P 594839
et al in the Township of Deloro

Enclosed are the plans (in duplicate) for the above-mentioned survey. In order to complete your submission, the following information is required on these maps:

- (a) V.L.F. maps need the values of the readings.
- (b) The magnetometer maps must be contoured.

For further information, please contact Mr. F.W. Matthews at 416/965-1380.

Yours very truly,

E.F. Anderson
Director
Land Management Branch

Whitney Block, Room 6450
Queen's Park
Toronto, Ontario
M7A 1W3
Phone: 416/965-1316

A. Barr/amc

Encl.

cc: Mr. B. Vatri
11 Cherry Post Crescent
Etobicoke, Ontario M9C 2J9

cc: Mining Recorder
Timmins, Ontario

GEOTECHNICAL REPORT APPROVAL

MINING LANDS COMMENTS:

~~no great~~

L.D.

VLF maps need readings

GEOPHYSICS

Mr. Barlow

- VLF maps need readings on maps
- MAG maps must be contoured

DATE:

March 2 / 82

✓

APPROVED

SIGNATURE:

Ray Barlow

WISH TO SEE AGAIN WITH CORRECTIONS

GEOLOGY - EXPENDITURES

DATE:

APPROVED

SIGNATURE:

WISH TO SEE AGAIN WITH CORRECTION

GEOCHEMISTRY

DATE:

APPROVED

SIGNATURE:

WISH TO SEE AGAIN WITH CORRECTION

1981 11 03

2.4241

Mining Recorder's Office
Ministry of Natural Resources
60 Wilson Avenue
Timmins, Ontario
P4N 2S7

Dear Sir;

We have received reports and Maps for a Geophysical (Electromagnetic and Magnetometer) survey submitted under Special Provisions (credit for Performance and Coverage) on mining claims P 594839 et al in the Township of Deloro.

This material will be examined and assessed and a statement of assessment work credits will be issued.

Yours very truly

E.F. Anderson
Director
Land Management Branch

Whitney Block, Room 6450
Queen's Park
Toronto, Ontario
M7A 1W3
Phone 416/965-1380

Joan Skura

cc: McGill Exploration Limited
Kanata, Ontario

October 28, 1981

McGill Exploration Limited,
33 Young Road, Kanata,
Ontario. K2L 1V9

Mr. Fred. Matthews,
Lands Administration Branch,
Mining Lands Section,
Ministry of Natural Resources,
Room 1617, Whitney Block,
Queen's Park, Toronto.

Dear Sir:

Please find enclosed two copies of reports and maps for assessment. The work was performed on claims P.594839 to P.594844 inclusive in the Township of Deloro.

Yours truly,

McGill Exploration Limited

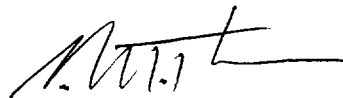

G. M. Thomas
Geologist

Encl.

RECEIVED

OCT 30 1981

MINING LANDS SECTION

L.D.

CHRISTIAN VON HESSERT
CONSULTING GEOLOGIST
SUITE 200 - 49 WELLINGTON STREET EAST
TORONTO, ONT. M5E 1C9

✓ 2.4241

(416) 863-6796

March 9, 1983

F. W. Mathews
Land Management Branch
Whitney Block, Room 6450
Queen's Park
Toronto, Ont. M7A 1W3

Re: Vatco Properties, your file #s 2.4150
2.4208
2.4241
2.4224

Dear Sir:

Please find enclosed duplicate signed sets of contoured magnetic and proper VLF maps for your files.

I have also included a resume outlining my qualifications.

Yours very truly,

Christain von Hessert
Consulting Geologist

cc: Bruno Vatri
Unit 16, 5500 Tomken Road
Mississauga, Ont. L4W 1P2

encl:

RECEIVED	
Land Management Branch	
CIRCULATE	<input type="checkbox"/>
COMMENTS PLEASE	<input type="checkbox"/>
BY	
MAR - 9 1983	
E. F. ANDERSON	
J. R. MORTON	
J. C. SMITH	
G. SHERMAN	
J. M. SMITH	
RETURN TO R. 6450	

RESUME

Christian von Hessert,
1st Floor, 49 Wellington St. E.
Toronto, Ontario

Tel: (416) 863 6796 Toronto

PERSONAL DATA:

Date of Birth: November 21, 1941
Education: B. Sc. Geology
M.Sc. Economic Geology

Columbia University 1968
University of Minnesota 1971

EXPERIENCE: 1979-80

ASAMERA OIL CORPORATION LTD.
Suite 300, 224-4th Ave., S.
Saskatoon, Sask. S7K 1M9

Senior Project Geologist: Supervised, organized and conducted a full range of exploration activities on Asamera's permits and claims in the Wollaston Lake area of Saskatchewan. Opened an office in Saskatoon. Directed the collection, interpretation and dissemination of technical data to Joint Venture Partners. Overall annual budget for Asamera operated property exceeds 7 million dollars.

1977-78

WESTERN MINES LIMITED
Suite 1414, 390 Bay Street,
Toronto, Ontario

Project Geologist: Organized, supervised and conducted "Western Mines" exploration projects in Saskatchewan. Participated in a joint venture overburden drilling project in winter of '76-'77 at Costigan Lake, Saskatchewan.

1975-76

CONWEST URANIUM JOINT VENTURE
85 Richmond Street, West
Toronto, Ontario

Party Chief: Conducted and supervised uranium exploration in Saskatchewan in the Virgin River and Key Lake - Rabbit Lake districts. Participated in an overburden drilling program in the winter of '75-'76 on Conwest's Geikie River claim blocks, Saskatchewan.

1973-75

WATTS, GRIFFIS & MCQUAT
159 Bay Street,
Toronto, Ontario

Supervised and conducted work on a variety of projects, both base metal and gold in North America and overseas. Assisted in feasibility studies and the preparation of exploration proposals.

1971-73

U.S. BUREAU OF MINES
Minneapolis, Minnesota

Project leader in a research project investigating how surfactants speed drilling rates in silicate rock.

Summer 1970

BEAR CREEK MINING COMPANY
Ely, Minnesota

Mapped 14 7.5 minute quadrangles in the greenstone belt of north central Minnesota, with the aid of an assistant, in an exploration program for volcanogenic base metals.

Summer 1969

STRAUS EXPLORATION COMPANY
Tucson, Arizona

Geologist in a geochemical survey in Nevada and Arizona.

Summer 1967

GUGGENHEIM EXPLORATION COMPANY

Performed geochemical sampling of stream sediments in Maine.

CONSULTING ASSIGNMENTS 1980-82

<u>Client Company</u>	<u>Work Description</u>	<u>Client's Representative</u>
Key Lake Explorations SMDC AMAX AGIP Minatco	Uranium drill program in Saskatchewan	E. Dillman (416) 366-4201
Wollex Phoenix Canada Oil Ltd. MSZ Resources	Gold drill program in Saskatchewan	M. Pyke (403) 271-0376
Silvermaque Mines	Gold program in Quebec; prepare report for Ontario Securities Commission	D. Hellens (416) 366-8058
Andex Mines	Gold program in Timmins; prepare report for Vancouver Securities Commission	T. Skimming (416) 239-3069
Royex Sturgex Mines	Gold project in Eastern Artic	T. Skimming (416) 239-3069
Cullaton Lake Gold Mine	Gold project in Eastern Artic	C. Page (416) 354-3182
Silver Pack Resources	Review data and recommend assessment work on a gold property in Ontario	D. Pearl (416) 868-0908
Phillips Australian Oil	Recommend gold joint ventures in West Australia	D. Martin (612) 854-1819
Kognak Gold Explorations	Gold project in Eastern Artic	Walter Hood (705) 778-2071
Dakota Energy Corporation	Gold project in Hemlo area, Ontario	Dave Bell (705) 264-4286
Starrex Mining Corporation	Review data and recommend work on company's Saskatchewan gold property; report for Ontario Securities Commission	Donald Moore (416) 368-4440
Key Lake Explorations	Review data and recommend work on company's Sierra Leone gold permit; report for Vancouver Securities Commission	E. Dillman (416) 366-4201

TISDALE TWP. M-315

THE TOWNSHIP OF
DELORO

DISTRICT OF
COCHRANE

PORCUPINE
MINING DIVISION

SCALE 1-INCH = 20 CHAINS

LEGEND

- PATENTED LAND (P)
- CROWN LAND SALE (CS)
- LEASES (L)
- LOCATED LAND (Loc.)
- LICENSE OF OCCUPATION (L.O.)
- MINING RIGHTS ONLY (M.R.O.)
- SURFACE RIGHTS ONLY (S.R.O.)
- ROADS
- IMPROVED ROADS
- KING'S HIGHWAYS
- RAILWAYS
- POWER LINES
- MARSH OR MUSKEG
- MINES
- CANCELLED (C)
- PATENTED S.R.O. (C)

NOTES

400' Surface Rights reservation along the shores of all lakes and rivers.

For status of fraction situated between Mg. Claims: HR 1132, HR 947 & M.E. 42 see File No. 119653

Mining claims within the area shown thus are subject to rights & privileges granted under an Easement Order dated May 19, 1957 to Deinite Mine Ltd

This township lies within the Municipality of CITY OF TIMMINS.

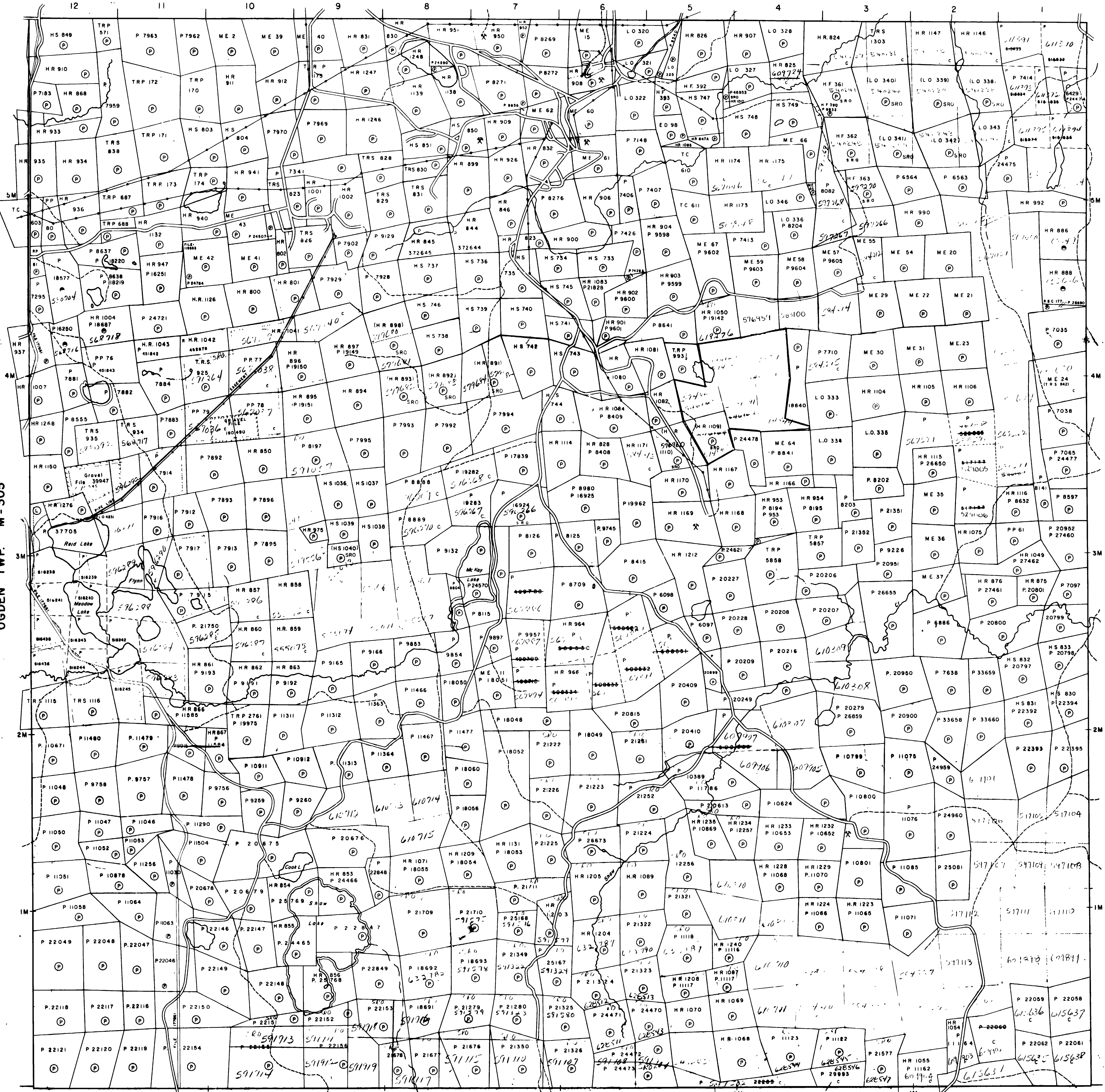

OGDEN TWP. M-305

SHAW TWP. M-311

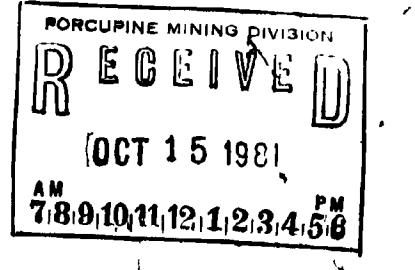

PLAN No. - M-272

ONTARIO
MINISTRY OF NATURAL RESOURCES
SURVEYS AND MAPPING BRANCH

ADAMS TWP. M-261



100wE 200wE 300wE 400wE 500wE 600wE 700wE 800wE 900wE 1000wE 1100wE

600nN

600nN

500nN

500nN

400nN

400nN

300nN

300nN

200nN

200nN

100nN

100nN

BASE LINE

BASE LINE

100nS

100nS

200nS

200nS

300nS

300nS

400nS

400nS

500nS

500nS

600nS

600nS

BOYD LAKE

P. 594840

P. 594839

P. 594842

P. 594844

P. 594843

P. 594841

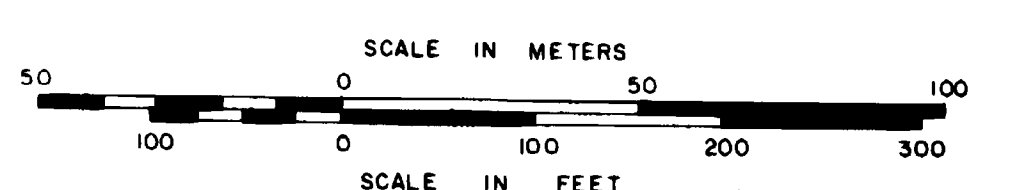
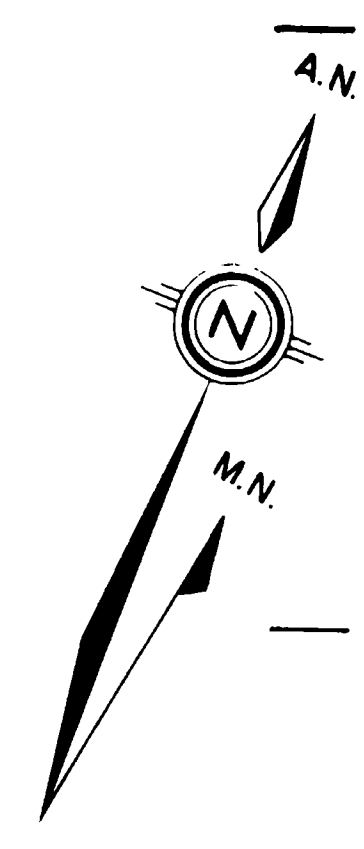

LEGEND

UNITS OF GAMMAS (Earth's total field accuracy of ±1 gamma)

CONTOUR INTERVAL 50 GAMMAS

INSTRUMENT SCINTREX MP-2 PROTON PRECESSION MAGNETOMETER

VATCO EXPLORATION INCORPORATED
 VATRI PROJECT - DELWOOD PROPERTY
 DELORO TOWNSHIP, ONTARIO
 PORCUPINE MINING DIVISION
MAGNETIC SURVEY
 WORK CARRIED OUT BY MCGILL EXPLORATION LIMITED
 SCALE 1:1250 DRAFTED BY: gmm
 CHECKED BY: G M THOMAS MAP NO. 3



100m E 200m E 300m E 400m E 500m E 600m E 700m E 800m E 900m E 1000m E 1100m E

600m N — 600m N

T.L. 500m N — 500m N

400m N — 400m N

300m N — 300m N

200m N — 200m N

100m N — 100m N

B.L. — BASE LINE

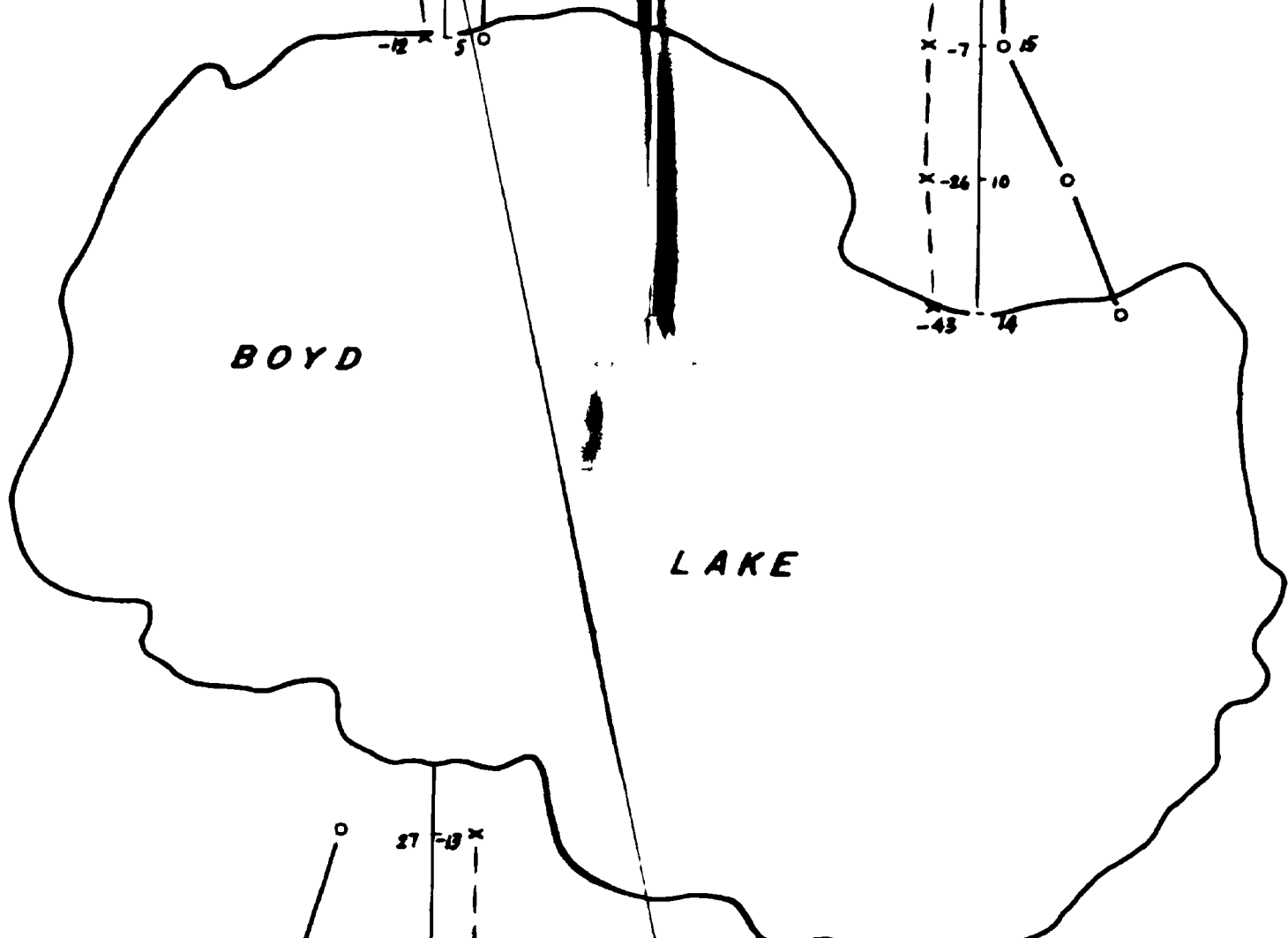

P-594840

P-594839

C

C

A

A

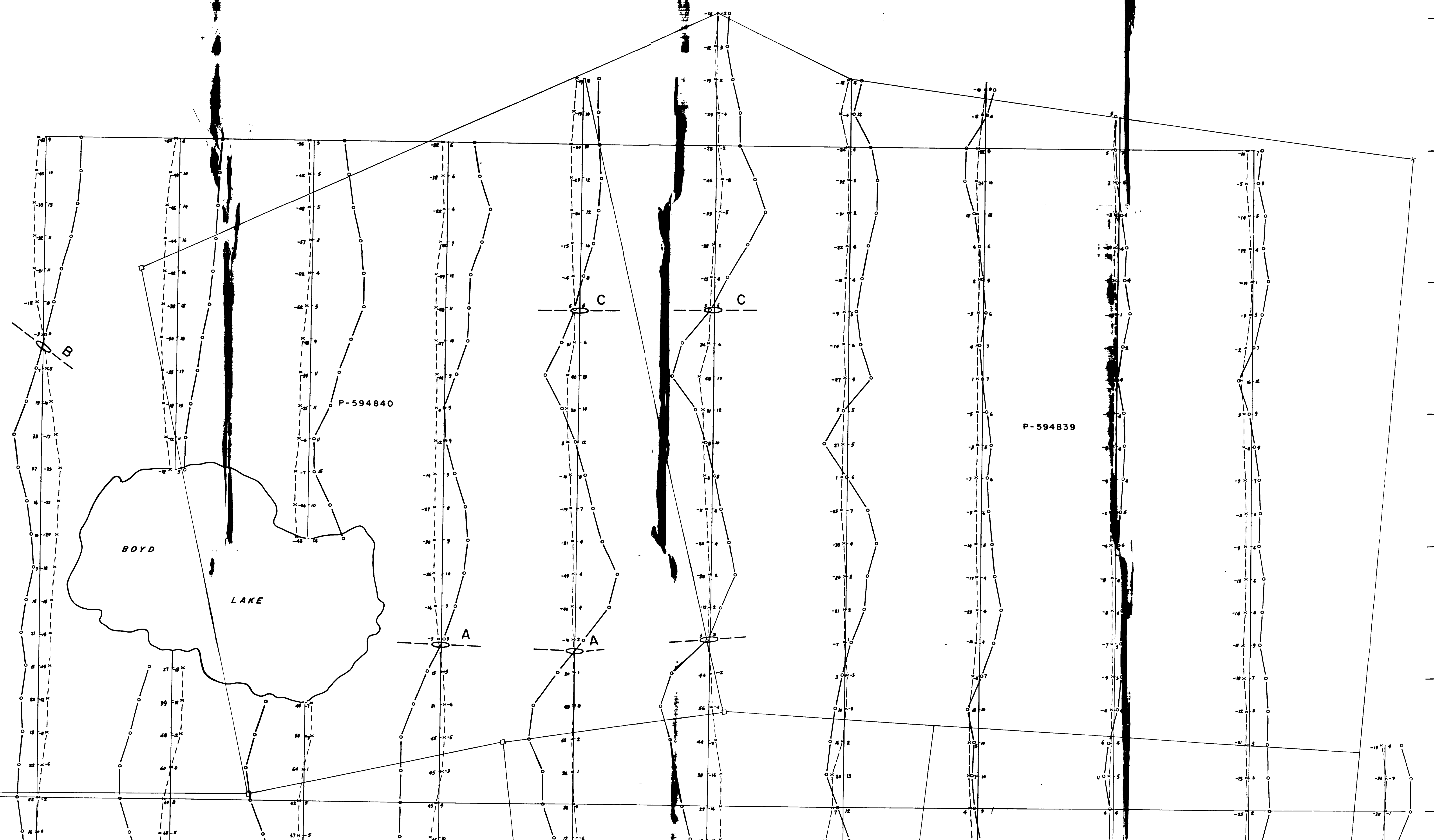

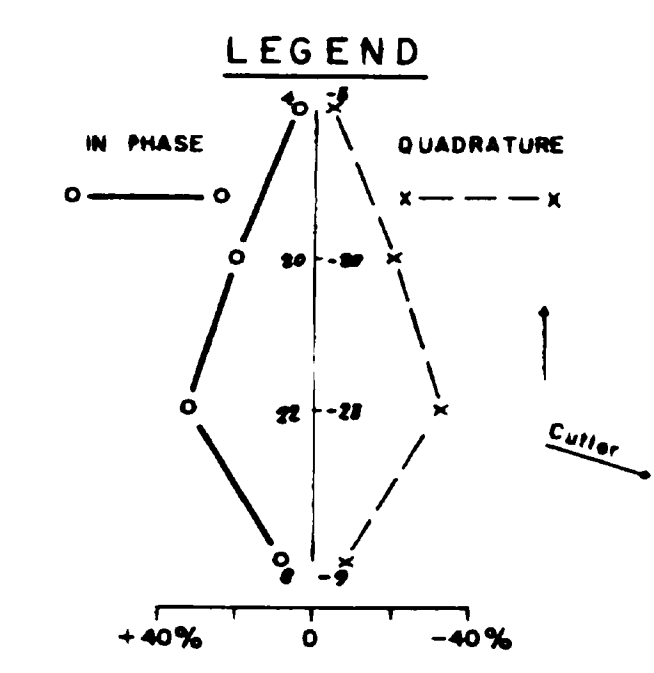
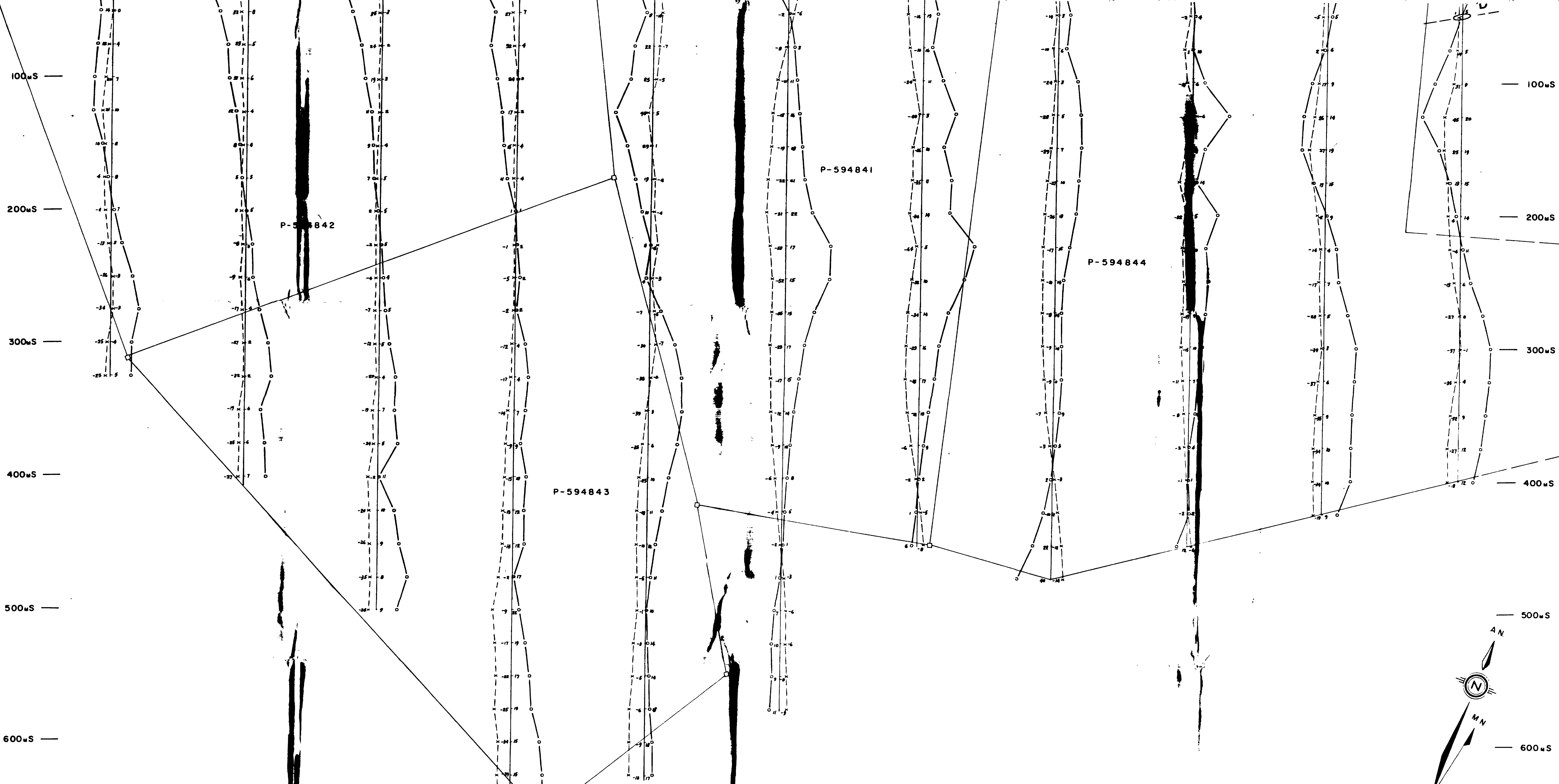

INSTRUMENT: GEONICS EM-16
 STATION: CUTLER, MAINE
 FREQUENCY: 17.8 kHz, COORDINATES: 67°17' W 44°39' N

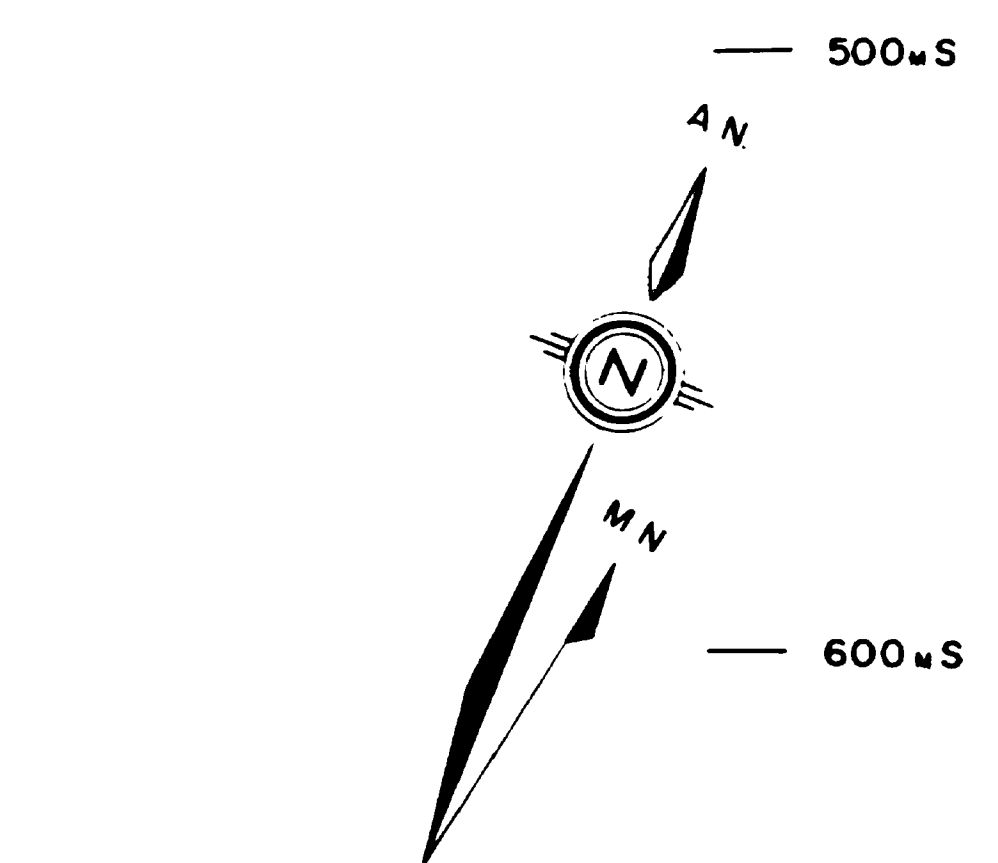

VATCO EXPLORATION INCORPORATED	
VATRI PROJECT - DELWOOD PROPERTY	
DELORO TOWNSHIP, ONTARIO PORCUPINE MINING DIVISION	
VLF EM-16 SURVEY	
WORK CARRIED OUT BY MCGILL EXPLORATION LIMITED	
SCALE: 1:1250	DRAFTED BY: gmax
CHECKED BY: G. M. THOMAS	MAP NO. 2