

TIMMINS TESTING LABORATORIES (T.T.L.) LIMITED

62 Norton Avenue
 Willowdale, Ontario
 M2N 4A3
 (416) 225-3981
 P.O. Box 1392
 Timmins, Ontario
 P4N 7N2
 (705) 235-5450

ASSAY REPORT

SAMPLES: DELORO TOWNSHIP

DATE: JULY 31, 1987



42A06NE0434 2.11467 DELORO

010

SAMPLE NO.	DESCRIPTION	Ni %		
5308	8 IF sugary quartz plus magn.	N/D		
5318	18 Sericite schist	N/D		
5322	22 IF (grey sugary qtz & magn)	0.023		
5323	23 Ditto 3% qtz. stringers	0.023		
5323	24 Ditto	0.016		
5366	66 IF thinly bedded	N/D		
5406	106 White qtz. specks pyrite	N/D		

Celia Camps.
 Assayer

TIMMINS TESTING LABORATORIES (T.T.L.) LIMITED

62 Norton Avenue
Willowdale, Ontario
M2N 4A3
(416) 225-3981
P.O. Box 1392
Timmins, Ontario
P4N 7N2
(705) 235-5450

July 31, 1987

DIEPDAUME MINES LIMITED
P.O. BOX 1392
TIMMINS, ONTARIO
P4N 7N2

INVOICE

7 ASSAYS	for Ni @ \$6.50/assay	\$45.50

	TOTAL	\$45.50

GWR/exc

Paid in full.

Gurlescher

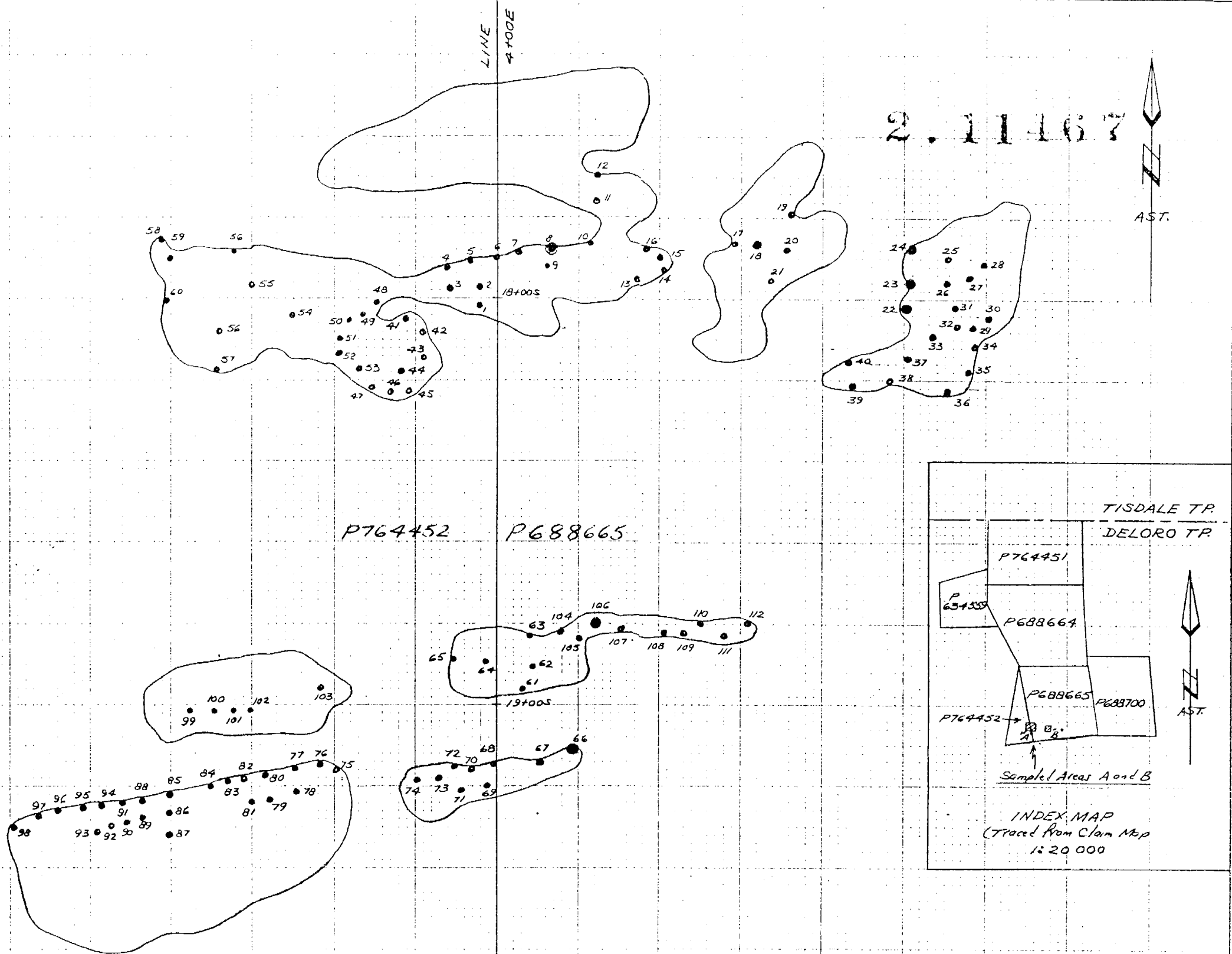

2.11467

P764452

P688665

TISDALE TP.

DELDRO TP.

P764451

P651335

P688664

P688665

P688700

P764452

Sample Areas A and B

INDEX MAP
(Traced from Claim Map
1:20 000)

SAMPLES LOCATION PLAN

SHERIDAN CLAIMS

DELDRO TOWNSHIP

PORCUPINE MINING DIVISION

ONTARIO

SCALE: 1IN=20FT. AUG. 1987

SYMBOLS

● 37 Sample Location and Number

○ Rock Outcrop - Partially overburdened

● July 1988 Nickel Assays

FIG 7
MAP A

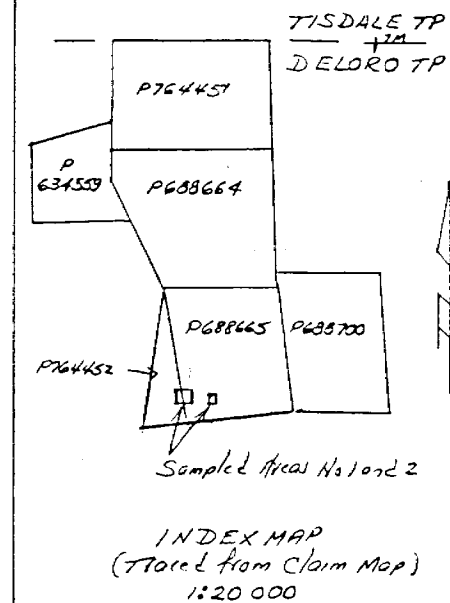
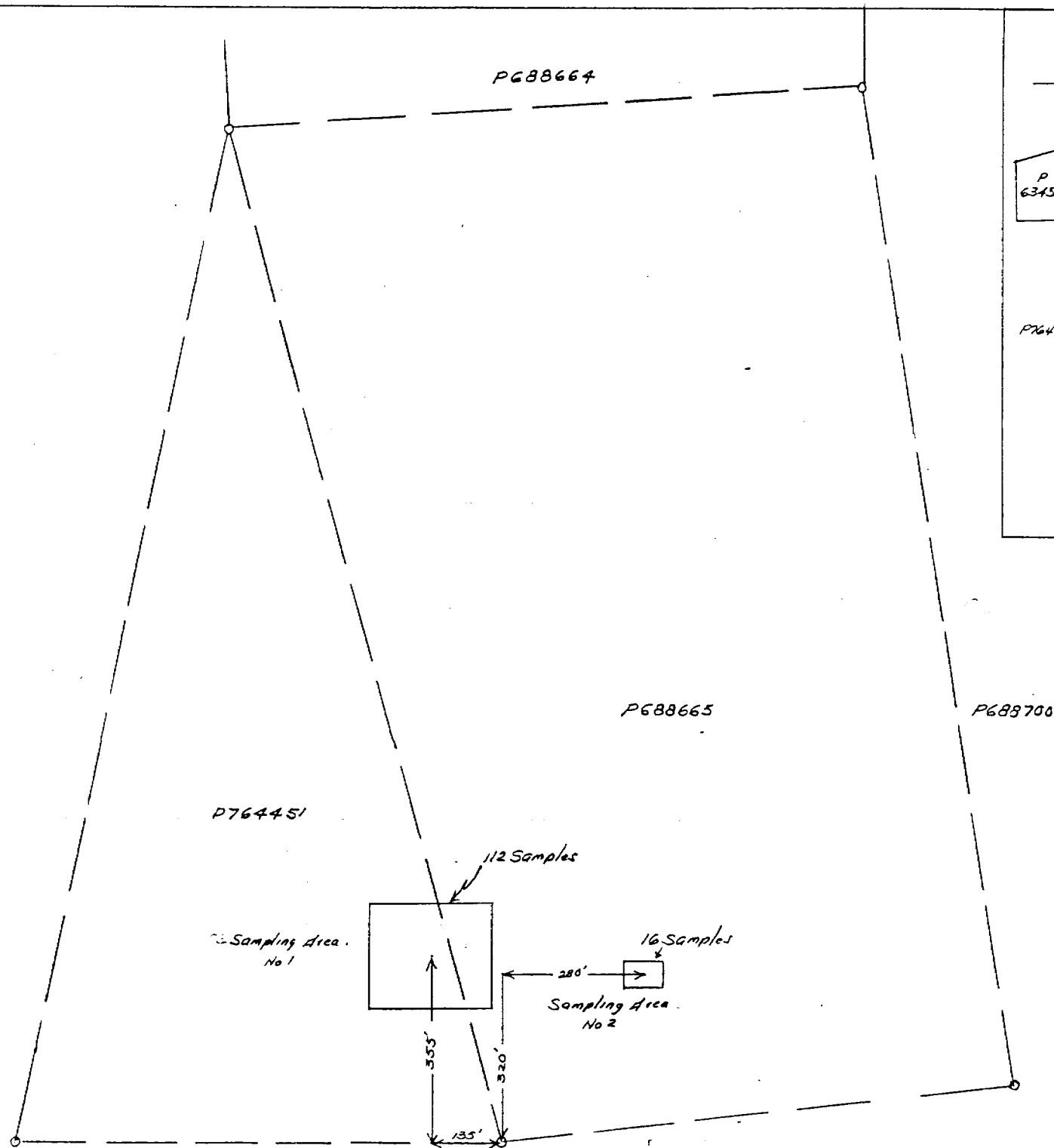

2.11467

AREA No 4
SAMPLING AREAS
DE LORO TOWNSHIP
PORCUPINE MINING DIVISION
ONTARIO
SCALE: 1"=200 FT JULY 23, 1987

