



42A06NE0443 2.10393 DELORO

010

REPORT  
ON  
EXPLORATION PROGRAM  
  
SHERIDAN CLAIMS  
  
DELORO TOWNSHIP  
PORCUPINE MINING DIVISION  
ONTARIO

**RECEIVED**  
SEP 25 1987  
**MINING LANDS SECTION**

Timmins, Ontario  
September 22, 1987



42A06NE0443 2.10393 DELORO

TABLE

010C

	<u>PAGE NO.</u>
TITLE PAGE	
SUMMARY	3
PREVIOUS WORK	3
PROPERTY AND LOCATION	3
ACCESSIBILITY	3
GEOLOGY - GENERAL	3
GEOLOGY - LOCAL	4
SAMPLING	4
CONCLUSIONS	4
MAPS	
A. Sample Location Map - Area A	1"=20ft
B. Sample Location Map - Area B	1"=20ft
No. 1 Geological Map - Sample Area A	1"=20ft
2 Geological Map - Sample Area B	1"=20ft
APPENDICES	
1. Samples List and Description	
2. Receipt for Assaying Charges	

## SUMMARY

Geological mapping and sampling were carried out over two limited areas - mostly in Iron Formation where sporadic gold values were received in random sampling in previous work.

One hundred and twenty-eight samples were taken in a final effort to ascertain the source of previous gold samples and other metal content of this selected area. Metal content in this portion of the Iron Formation was found to be negligible.

## PREVIOUS WORK

Geophysical surveys, limited diamond drilling and surface sampling was carried out previously by the present claim owners. Unrecorded work consisting of prospecting and sampling by private concerns dating back to 1962 revealed sporadic gold values in quartz stringers in the Iron Formation now covered by these claims.

## PROPERTY AND LOCATION

The property encompassed by the work performed consists of six contiguous unpatented mining claims situated in the north-east quadrant of Deloro Township, Porcupine Mining Division of Ontario.

The claims are numbered P634559, P688664, P688665, P688700, P764451 and P764452.

## ACCESSIBILITY

Access is made off the Timmins "back road" via the gated private Dome Mines Limited tailings dam road which enters the north-east part of Deloro Tp from the east-side. This road ends at the Dome Tailings overflow discharge into Porcupine Creek - a distance of one half mile from the present work area.

## GEOLOGY - GENERAL

The property is underlain by northeast trending steeply dipping (north) Archean Rocks of the Deloro Sub-Group.

The rocks in this area are mafic to intermediate volcanics, on the south progressing north into intermediate to acid sericite and/or chlorite schists derived from tuff, crystal tuff and highly siliceous interbedded Iron Formation. A bed of pyritiferous graphitic tuff lies immediately north of the northern band of Iron Formation. Slate and argillite overlie this assemblage followed by the serpentized rocks of the Porcupine Destor Fault.

GEOLOGY - LOCAL

The mapped area covered by this report lies immediately south of the main band of Iron Formation which is highly siliceous with  $\frac{1}{2}$ " beds of alternating magnetite and hematite.

Thin bands of Iron formation composed of red, white, brown and grey sugary quartz with disseminated magnetite interbedded with sericite schists (probably derived from felsic tuffs and crystal tuffs and with chlorite schists (probably derived from ash rock) are noted in the mapped area.)

Abundant barren white quartz veins - conformable occur in local areas. Transverse white quartz veinlets (tension fractures) are also noted.

One small dikelet of quartz porphyry was seen. Larger bodies of quartz porphyry are seen one half mile farther east which was not known on older maps.

SAMPLING

One hundred and twenty-eight surface samples were taken from the main Iron Formation in an effort to pin down the source of previous gold assays reported from this area but no gold was found. Other mineral content assayed for returned nil to negligible results.

CONCLUSIONS

Nothing of economic interest was found in this concentrated area of exploration.

Respectfully submitted,



C. F. Desson

Qual. con  
63. 1558

# TIMMINS TESTING LABORATORIES (T.T.L.) LIMITED

62 Norton Avenue  
Willowdale, Ontario  
M2N 4A3

## ASSAY REPORT

SAMPLES DELORO TOWNSHIP

(416) 225-3981

DATE: July 31, 1987

P.O. Box 1392  
Timmins, Ontario  
P4N 7N2

(705) 235-5450

SAMPLE NO.	DESCRIPTION	Ag oz./ton	Au oz./ton	Cu %	Zn %
1	Ser. schist spks pyrite	N/D	N/D	N/D	0.007
2	Ser. schist (sh'd Tuff)	N/D	N/D	N/D	0.007
3	Ser. schist spks Pyrite	N/D	N/D	N/D	0.007
4	Ditto	N/D	N/D	N/D	0.013
5	IF sugary qtz. plus magn.	N/D	N/D	N/D	0.020
6	Ditto	N/D	N/D	N/D	0.013
7	80% white qtz. in ser. sch	N/D	N/D	0.050	0.017
8	IF sugary qtz, magn, hem	N/D	N/D	N/D	0.007
9	Qtz. Porphyry spks pyr.	N/D	N/D	N/D	0.013
10	IF sugary qtz. & fine magn.	N/D	N/D	N/D	0.007
11	Ditto	N/D	N/D	N/D	0.003
12	Ditto	N/D	N/D	N/D	0.003
13	Sericite schist	N/D	N/D	N/D	0.007
14	Ditto	N/D	N/D	N/D	0.007
15	IF sugary qtz & fine magn	N/D	N/D	N/D	0.010
16	Ditto. Contorted	N/D	N/D	N/D	0.007
17	Sericite-chlorite schist	N/D	N/D	N/D	0.007
18	Sericite schist	N/D	N/D	0.014	0.013
19	Ser. sch. & IF (sugary qtz)	N/D	N/D	N/D	0.033
20	Cherty IF	N/D	N/D	N/D	0.013
21	IF (Grey sugary qtz & magn)	N/D	N/D	N/D	0.013
22	Ditto	N/D	N/D	0.021	0.007
23	Ditto. 3% qtz. stringers	N/D	N/D	0.014	0.010
24	Ditto	N/D	N/D	0.014	0.013
25	Ditto	N/D	N/D	N/D	0.037
26	IF Siliceous heavy Magn.	N/D	N/D	N/D	0.007
27	Ditto	N/D	N/D	N/D	0.010
28	Ditto	N/D	N/D	N/D	0.007
29	IF (white & grey sugary qtz)	N/D	N/D	N/D	0.013
30	Chlorite Schist (pass Ash)	N/D	N/D	N/D	0.007

APPENDIX 1

*Cecilia Camps*  
Assayer

# TIMMINS TESTING LABORATORIES (T.T.L.) LIMITED

62 Norton Avenue  
Willowdale, Ontario  
M2N 4A3

(416) 225-3981

P.O. Box 1392  
Timmins, Ontario  
P4N 7N2

(705) 235-5450

## ASSAY REPORT

SAMPLES: DELORO TOWNSHIP

DATE: July 31, 1987

SAMPLE NO.	DESCRIPTION	Ag oz./ton	Au oz./ton	Cu %	Zn %
31	IF thinly bedded & Magn	N/D	N/D	N/D	0.007
32	Ditto	N/D	N/D	N/D	0.007
33	Ditto. contorted	N/D	N/D	N/D	0.007
34	Ditto	N/D	N/D	N/D	0.010
35	IF-white&grey sugary qtz	N/D	N/D	N/D	0.020
36	IF-dark grey sugary qtz.	N/D	N/D	N/D	0.013
37	IF-abund. Magn.	N/D	N/D	N/D	0.017
38	Ditto	N/D	N/D	N/D	0.013
39	Ditto	N/D	N/D	N/D	0.023
40	IF-wht-sug* qtz, hvy magn	N/D	N/D	N/D	0.013
41	IF-thin bedded sugary qtz	N/D	N/D	N/D	0.027
42	Chlorite schist	N/D	N/D	N/D	0.013
43	IF contorted sugary qtz.	N/D	N/D	N/D	0.017
44	IF-brownish bedded sug. qtz	N/D	N/D	N/D	0.017
45	IF Ditto-Abund. Hematite	N/D	N/D	N/D	0.033
46	Ditto	N/D	N/D	N/D	0.013
47	Ditto - Contorted	N/D	N/D	N/D	0.013
48	If as No. 44	N/D	N/D	N/D	0.013
49	Ditto plus diss'd magn	N/D	N/D	N/D	0.010
50	Chl-ser. schist-alt'd P?	N/D	N/D	N/D	0.010
51	Crenvated sericite schist	N/D	N/D	N/D	0.010
52	IF as 44 & qtz-carb seams	N/D	N/D	N/D	0.013
53	IF reddish sugary qtz.	N/D	N/D	N/D	0.073
54	IF Ditto plus magn.	N/D	N/D	N/D	0.013
55	If contorted	N/D	N/D	N/D	0.023
56	Sericite schist	N/D	N/D	N/D	0.010
57	IF bedded Hem & Magn.	N/D	N/D	N/D	0.033
58	Ser. Schist-spks pyrite	N/D	N/D	N/D	0.013
59	Ditto	N/D	N/D	N/D	0.017
60	Ser-chlorite schist	N/D	N/D	N/D	0.013

*Cecilia Campo*  
Assayer

# TIMMINS TESTING LABORATORIES (T.T.L.) LIMITED

62 Norton Avenue  
Willowdale, Ontario  
M2N 4A3

(416) 225-3981

P.O. Box 1392  
Timmins, Ontario  
P4N 7N2

(705) 235-5450

## ASSAY REPORT

SAMPLES DELORO TOWNSHIP

DATE: July 31, 1987

SAMPLE NO.	DESCRIPTION	Ag oz./ton	Au oz./ton	Cu %	Zn %
61	Ser. schist	N/D	N/D	N/D	0.069
62	IF grey sug. qtz & magn.	N/D	N/D	N/D	0.010
63	IF Ditto	N/D	N/D	N/D	0.017
64	White qtz. plus chlorite	N/D	N/D	N/D	0.013
65	IF reddish sugary qtz	N/D	N/D	N/D	0.033
66	IF thinly bedded	N/D	N/D	0.043	0.013
67	IF- as No. 65	N/D	N/D	N/D	0.047
68	Ditto- weathered porous	N/D	N/D	N/D	0.013
69	IF reddish sugary qtz	N/D	N/D	N/D	0.020
70	IF Ditto-thinly bedded	N/D	N/D	N/D	0.013
71	IF Ditto	N/D	N/D	N/D	0.027
72	80% wh. qtz. and IF	N/D	N/D	N/D	0.013
73	IF reddish sugary qtz	N/D	N/D	N/D	0.020
74	IF whitish sugary qtz	N/D	N/D	N/D	0.010
75	IF Br & Wh. sugary qtz.	N/D	N/D	0.014	0.010
76	Ditto	N/D	N/D	N/D	0.013
77	IF thinly bedded sugary qtz	N/D	N/D	N/D	0.017
78	IF contorted with seams qtz	N/D	N/D	N/D	0.013
79	Ditto 20% white qtz.	N/D	N/D	N/D	0.023
80	Ditto	N/D	N/D	N/D	0.010
81	Ditto	N/D	N/D	N/D	0.020
82	Ditto	N/D	N/D	N/D	0.007
83	As #77 miner qtz carb seams	N/D	N/D	N/D	0.027
84	Ditto	N/D	N/D	N/D	0.007
85	IF sugary qtz well fract'd	N/D	N/D	0.014	0.007
86	IF red & white sugary qtz	N/D	N/D	N/D	0.010
87	IF dk grey sugary qtz&magn	N/D	N/D	N/D	0.037
88	As No. 85	N/D	N/D	N/D	0.007
89	As No. 87	N/D	N/D	N/D	0.007
90	Ditto	N/D	N/D	N/D	0.010

*Cecilia Campo*  
Assayer

# TIMMINS TESTING LABORATORIES (T.T.L.) LIMITED

62 Norton Avenue  
Willowdale, Ontario  
M2N 4A3

(416) 225-3981

P.O. Box 1392  
Timmins, Ontario  
P4N 7N2

(705) 235-5450

## ASSAY REPORT

SAMPLES: DELORO TOWNSHIP

DATE: July 31, 1987

SAMPLE NO.	DESCRIPTION	Ag oz. / ton	Au oz. / ton	Cu %	Zn %
91	IF diss'd magn 1/8"qtz seams	N/D	N/D	N/D	0.013
92	IF sugary qtz cs pyrite	N/D	N/D	N/D	0.013
93	IF red & white sugary qtz	N/D	N/D	N/D	0.010
94	IF grey & white sugary qtz	N/D	N/D	N/D	0.017
95	Chlorite schist-(ash)	N/D	N/D	N/D	0.010
96	Ash rock spks pyr. chl.	N/D	N/D	0.014	0.013
97	Ditto	N/D	N/D	0.064	0.007
98	Chl. ash-thinly bedded	N/D	N/D	0.057	0.013
99	IF gr. sug. qtz & 1/4"qtz str	N/D	N/D	N/D	0.007
100	Ditto	N/D	N/D	N/D	0.003
101	Ditto	N/D	N/D	N/D	0.020
102	Ditto	N/D	N/D	N/D	0.010
103	Ditto-20% qtz cs spks pyr	N/D	N/D	N/D	0.007
104	Sheared ash-chl.spks pyr	N/D	N/D	N/D	0.013
105	90% white qtz spks pyr	N/D	N/D	N/D	0.003
106	white qtz specks pyrite	N/D	N/D	0.013	0.007
107	Chlorite Ash	N/D	N/D	N/D	0.013
108	IF Brownish sugary qtz	N/D	N/D	N/D	0.007
109	Wh. qtz porous & limonite	N/D	N/D	0.021	0.007
110	Highly oxidized-spec. hem	N/D	N/D	N/D	0.037
111	IF brown sugary qtz	N/D	N/D	N/D	0.013
112	IF brown & white sugary qtz	N/D	N/D	N/D	N/D
113	Sericite-chlorite schist	N/D	N/D	N/D	N/D
114	Chlorite schist	N/D	N/D	N/D	N/D
115	IF grey cherty qtz	N/D	N/D	N/D	N/D
116	Ash - specks pyrite	N/D	N/D	N/D	N/D
117	Chlorite Ash specks pyrite	N/D	N/D	N/D	0.020
118	Laminated blackish Ash rock	N/D	N/D	N/D	0.030
119	Ditto	N/D	N/D	N/D	0.027
120	Ditto	N/D	N/D	N/D	0.027

*Cecilia Campo*  
Assayer



# TIMMINS TESTING LABORATORIES (T.T.L.) LIMITED

62 Norton Avenue  
Willowdale, Ontario  
M2N 4A3

(416) 225-3981

P.O. Box 1392  
Timmins, Ontario  
P4N 7N2

(705) 235-5450

## ASSAY REPORT

SAMPLES: DELORO TOWNSHIP

DATE: JULY 31, 1987

SAMPLE NO.	DESCRIPTION	Ag oz./ton	Au oz./ton	Cu %	Zn %
121	As No. 118	N/D	N/D	N/D	0.027
122	Ditto	N/D	N/D	N/D	0.023
123	Ditto-schisted chlorite	N/D	N/D	N/D	0.023
124	Ash grey thinly bedded chl	N/D	N/D	0.021	0.023
125	Ash-F gr. massive	N/D	N/D	0.029	0.027
126	Ash-laminated	N/D	N/D	0.021	0.027
127	Siliceous Ash - Chlorite	N/D	N/D	0.021	0.040
128	Chlorite Ash	N/D	N/D	0.029	0.017

Assayer Cecilia Camps

# TIMMINS TESTING LABORATORIES (T.T.L.) LIMITED

62 Norton Avenue  
Willowdale, Ontario  
M2N 4A3  
(416) 225-3981  
P.O. Box 1392  
Timmins, Ontario  
P4N 7N2  
(705) 235-5450

September 18, 1987

DIEPDAUME MINES LIMITED  
P.O. BOX 1392  
TIMMINS, ONTARIO  
P4N 7N2

## INVOICE

128 ASSAYS	for Au @ \$8.00/assay	\$1,024.00
128 ASSAYS	for Ag @ \$8.00/assay	\$1,024.00
128 ASSAYS	for Cu @ \$6.50/assay	\$832.00
128 ASSAYS	for Zn @ \$4.25/assay	\$544.00
128 SAMPLES	sample preparation & handling @ \$2.75/sample	\$352.00
	Sample NO. 1-128 (128)	-----
		\$3,776.00
		-----

GWR/cxc

*Paid in full.*  
*Gwbeschke*

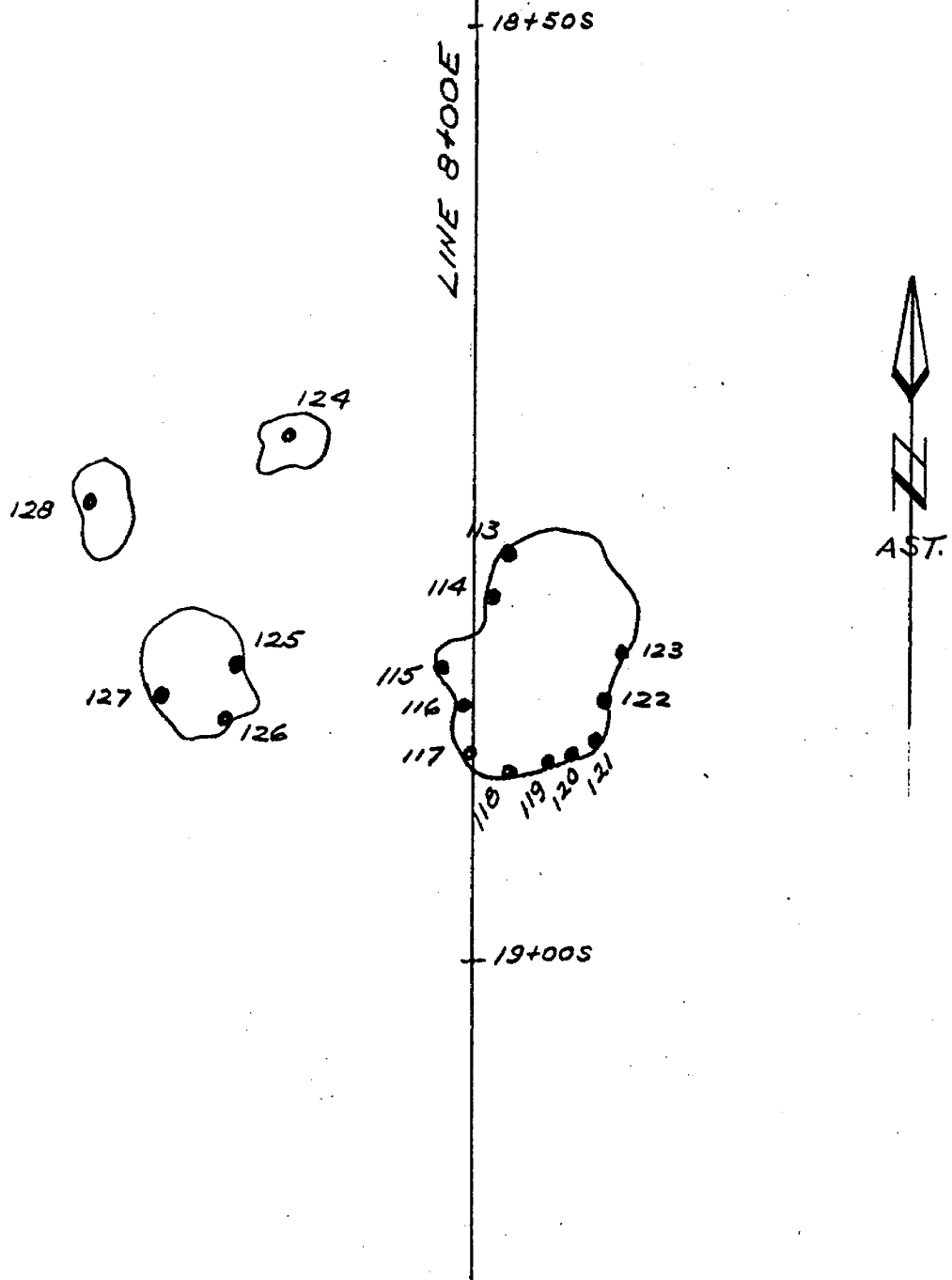

SAMPLES LOCATION PLAN  
 SHERIDAN CLAIMS  
 DELORO TOWNSHIP  
 PORCUPINE MINING DIVISION  
 ONTARIO  
 SCALE: 1 IN = 20 FT      AUG. 1987

Note: See Samples Location Plan "A" for Index Map and Symbols

MAP "B"  
 CH

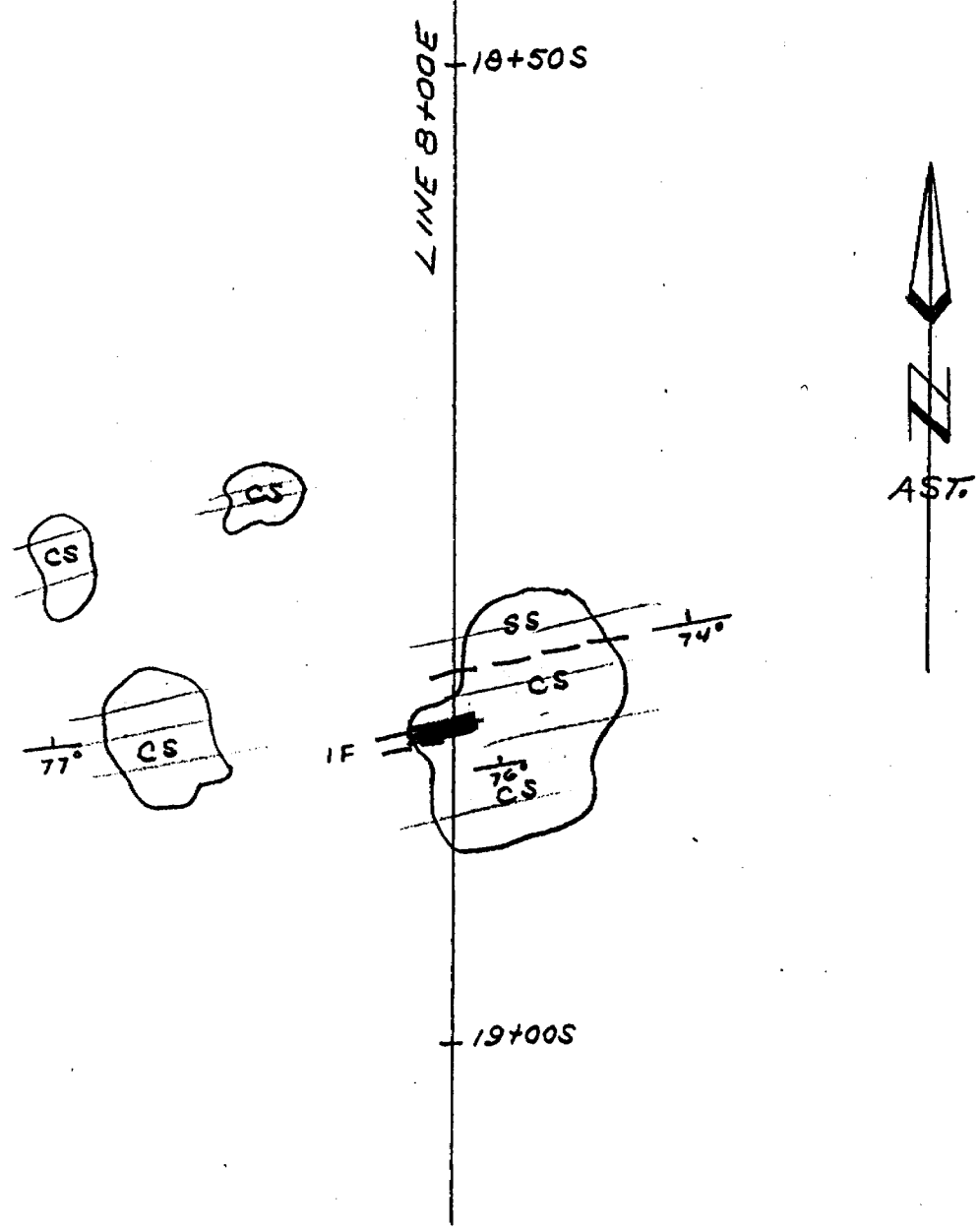

GEOLOGY MAP  
 SHERIDAN CLAIMS  
 DELORO TOWNSHIP  
 PORCUPINE MINING DIVISION  
 ONTARIO  
 SCALE: 1 IN = 20 FT.    AUG. 1987

Note: See Geology Map No. 1 for Index Map and Geological Legend    Map No 2  
 CMH



42A06NE0443 2.10393 DELORO

900



2.10393

Sept 18

DOCUMENT No. 8706.181  
 Instructions: Please type or print.  
 Note: 1 number of mining claims traversed exceeds space on this form, attach a list.  
 Only days credits calculated in the "Expenditures" section may be entered in the "Expend. Days Cr." columns.  
 Do not use shaded areas below.

Type of Survey(s) *Expenditures* Township or Area *Delora Tp*  
 Claim Holder(s) *Mr. J. P. Sheridan* Prospector's Licence No. *M15350*  
 Address *150 York Street Suite 1814 Toronto, Ontario M5H3S5*  
 Survey Company *Timmin Testing Lab* Date of Survey (from & to) *10 07 87 28 07 87* Total Miles of line Cut *—*  
 Name and Address of Author (of Geo-Technical report) *C F Desson Box 1392 Timmins, Ontario P4N 7N2*

Credits Requested per Each Claim in Columns at right

Mining Claims Traversed (List in numerical sequence)

Special Provisions	Geophysical	Days per Claim
For first survey: Enter 40 days. (This includes line cutting)	- Electromagnetic	
	- Magnetometer	
For each additional survey: using the same grid: Enter 20 days (for each)	- Radiometric	
	- Other	
	Geological	
	Geochemical	
Man Days	Geophysical	Days per Claim
Complete reverse side and enter total(s) here	- Electromagnetic	
	- Magnetometer	
	- Radiometric	
	- Other	
	Geological	
	Geochemical	
Airborne Credits	Electromagnetic	Days per Claim
Note: Special provisions credits do not apply to Airborne Surveys.	Magnetometer	
	Radiometric	

Mining Claim			Mining Claim		
Prefix	Number	Expend. Days Cr.	Prefix	Number	Expend. Days Cr.
<i>P</i>	<i>634959</i>	<i>26</i>			
	<i>688664</i>	<i>49</i>			
	<i>688665</i>	<i>49</i>			
	<i>688700</i>	<i>49</i>			
	<i>764451</i>	<i>37</i>			
	<i>764452</i>	<i>41</i>			

RECEIVED

AUG 31 1987

MINING LANDS SECTION

RECEIVED

JUL 30 1987

RECORDED

JUL 30 1987

Expenditures (excludes power stripping)  
 Type of Work Performed *A-5594109 (Sec 77-19)*  
 Performed on Claim(s) *P 688665 and P 764452*  
 Calculation of Expenditure Days Credits  
 Total Expenditures  $\$ 3776.00$  ÷ Total Days Credits  $15 = 251$

Total number of mining claims covered by this report of work. **6**

Instructions  
 Total Days Credits may be apportioned at the claim holder's choice. Enter number of days credits per claim selected in columns at right.

For Office Use Only  
 Total Days Cr. Recorded *251* Date Recorded *July 30/87*  
 Date Approved as Recorded *1987.10.27*  
 Mining Recorder *[Signature]*  
 Branch Director *[Signature]*

Date *July 28/87* Recorded Holder or Agent (Signature) *[Signature]*

Certification Verifying Report of Work

I hereby certify that I have a personal and intimate knowledge of the facts set forth in the Report of Work annexed hereto, having performed the work or witnessed same during and/or after its completion and the annexed report is true.

Name and Postal Address of Person Certifying *Mr. C. F. Desson*  
*Box 1392 Timmins Ont P4N 7N2*  
 Date Certified *July 28/87* Certified by (Signature) *[Signature]*



TISDALE TWP G-3976

**MAP SYMBOLOLOGY**

Railroad	Pipeline
Boundary	Railroad
International	Single Track
Interprovincial	Double Track
District, Township, Indian Reserve	Abandoned
Approximate	Terrace
Lot, Concession	Road
Approximate	Highway, County
Park Boundary	Access (road of doubtful maintenance or unimproved driveway)
Bridge	Trail, Back Road (marked, steep)
Beam, Railroad	Rapids
Building	Double line river with multiple rapids
Chimney	Double line river with multiple rapids
Cliff, Pit, Pile	Reservoir
Contours	Approximate
Intersected	Direction of flow
Approximate	River, Stream, Canal
Depression	Approximate
Control Points	Spot Elevation
Horizontal	(lake, stream, slope)
Vertical	Tower
Culvert	Transmission Line
Falls	Pole
Death line river	Pylon
Fence, Hedge, Wall	Tunnel
Feature Outline (Construction Features, etc.)	Utility Poles
Flooded Land	Wharf, Dock, Pier
Lock	Wooded Area
Marsh or Swamp	
Mosel	
Mine Head Frame	
Outcrop	

**AREAS WITHDRAWN FROM DISPOSITION**

M.R.O. - MINING RIGHTS ONLY				
S.R.O. - SURFACE RIGHTS ONLY				
M.F.S. - MINING AND SURFACE RIGHTS				
Description	Order No.	Date	Disposition	File

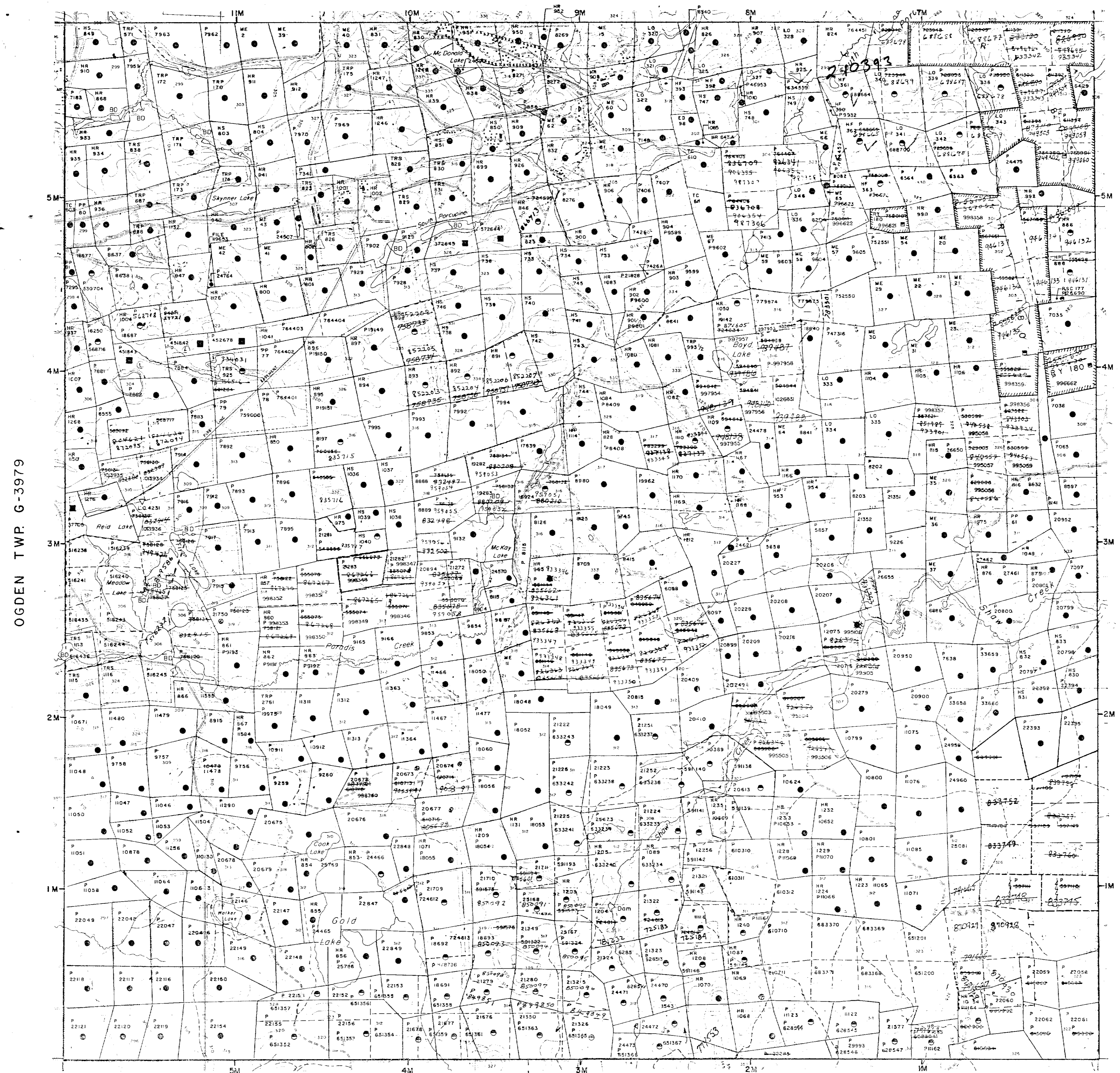

OGDEN TWP. G-3979

SHAW TWP. G-3999

**LEGEND**

HIGHWAY AND ROUTING	
OTHER ROADS	
TRAILS	
SURVEYED LINES	
TOWNSHIP, BASE LINES ETC.	
LOTS, MINING CLAIMS, PARCELS ETC.	
UNSURVEYED LINES	
LOT LINES	
PARCEL BOUNDARY	
MINING CLAIMS ETC.	
RAILWAY AND RIGHT OF WAY	
UTILITY LINES	
NON-PERMANENT STREAM	
FLOODING OR FLOODING RIGHTS	
SUBDIVISION OR COMPOSITE PLAN	
RESERVATIONS	
ORIGINAL SHORELINE	
MARSH OR MUSKEG	
MINES	
TRAVERSE MONUMENT	

**DISPOSITION OF CROWN LANDS**

TYPE OF DOCUMENT	SYMBOL
PATENT, SURFACE & MINING RIGHTS	●
" SURFACE RIGHTS ONLY	○
" MINING RIGHTS ONLY	○
LEASE, SURFACE & MINING RIGHTS	■
" SURFACE RIGHTS ONLY	■
" MINING RIGHTS ONLY	■
LICENSE OF OCCUPATION	▽
ORDER-IN-COUNCIL	OC
RESERVATION	⊙
CANCELLED	⊙
SAND & GRAVEL	⊙

NOTE: MINING RIGHTS IN PARCELS PATENTED PRIOR TO MAY 6, 1913, ARE SET IN ORIGINAL PATENTEE BY THE PUBLIC LANDS ACT, R.S.O. 1910, CHAP. 380, SEC. 63, SUBSEC. 1.

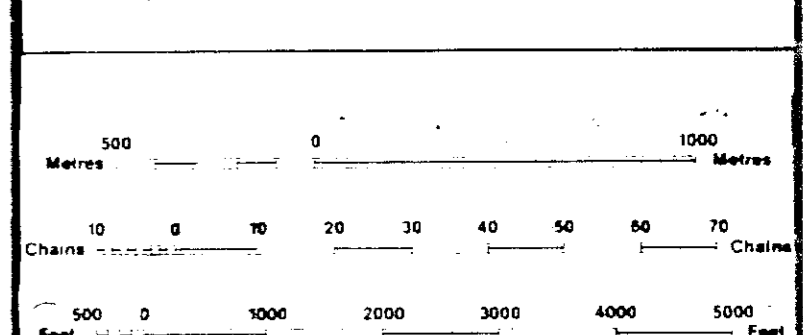

SCALE 1:20 000

**NOTES**

REGISTERED PLAN OF SUBDIVISION

MINING CLAIMS SHOWN WITHIN THIS AREA ARE SUBJECT TO THE RIGHTS AND PRIVILEGES GRANTED UNDER AN ELEMENT ORDER DATED MAY 19, 1917 TO DELNITE MINES LTD.

DOME MINES, LIMITED SURFACE RIGHTS LEASE #103926

APPLICATION UNDER P.L.A. FOR SURFACE RIGHTS... DUCKS UNLIMITED CANADA

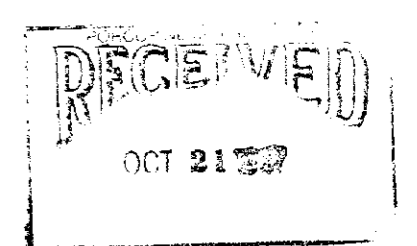

TOWNSHIP **2.10393**

**DELORO**

M.N.R. ADMINISTRATIVE DISTRICT

**TIMMINS**

MINING DIVISION

**PORCUPINE**

LAND TITLES / REGISTRY DIVISION

**COCHRANE**

Ministry of Natural Resources Ontario

Land Management Branch

Date RECEIVED: 1994

Number: **G-3993**



ADAMS TWP. G-



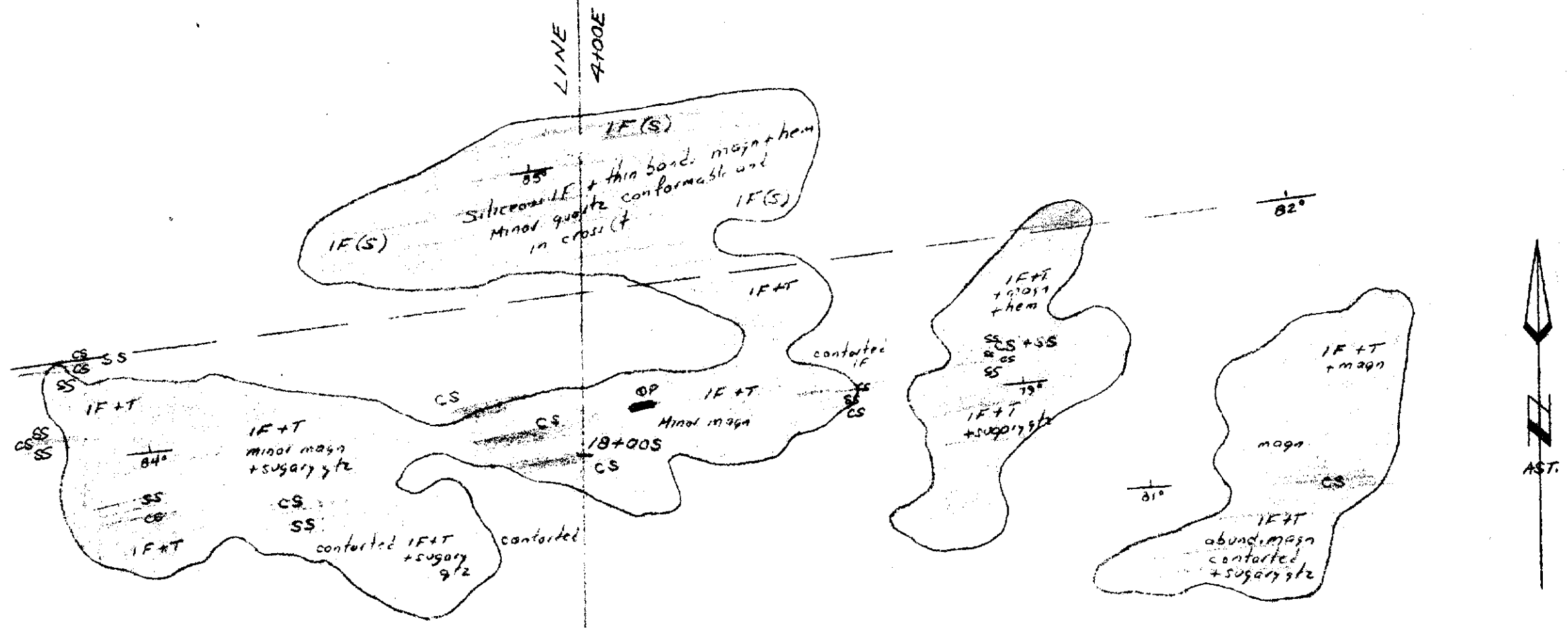

18+50S

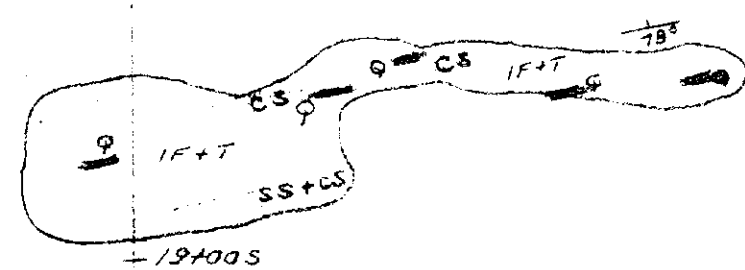

19+00S

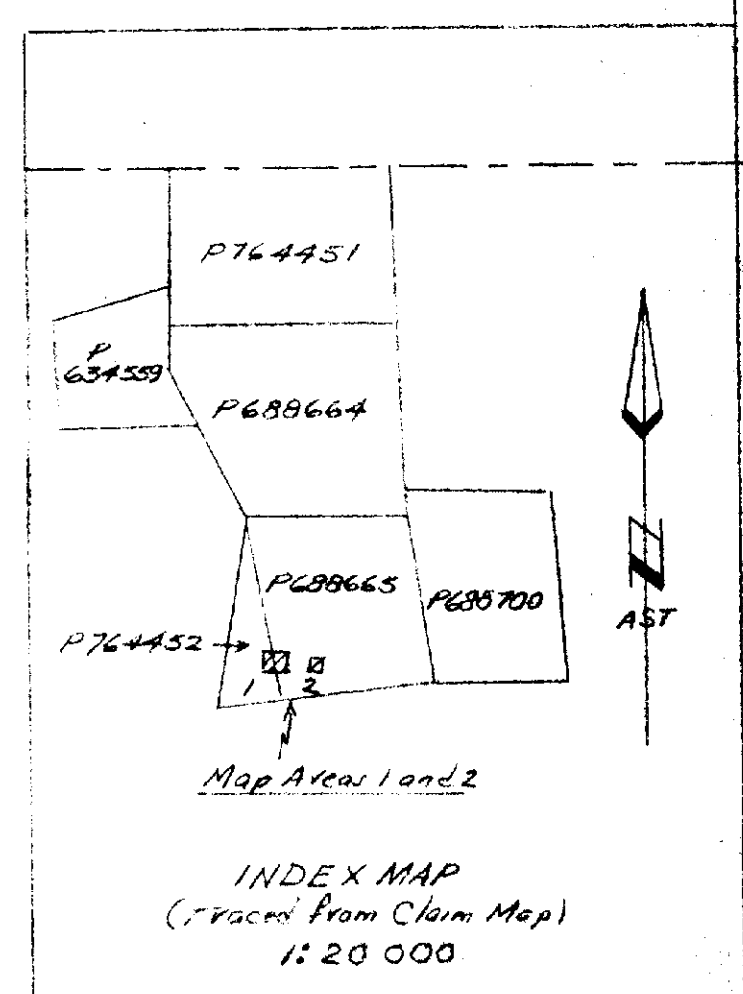
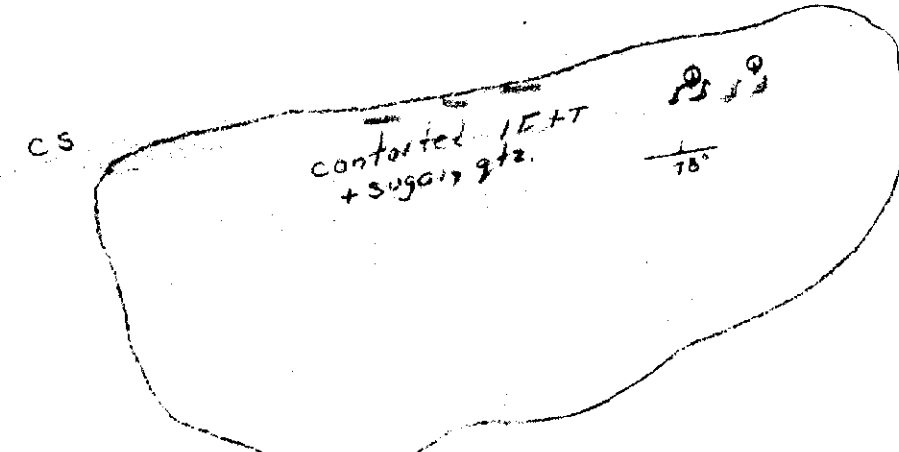
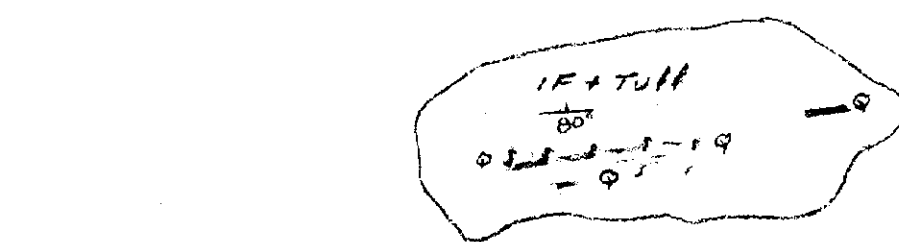
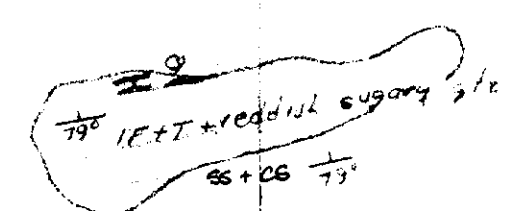

**LEGEND**

- IF(S) Iron Formation (highly siliceous - magn + hem.)
- IF+T Iron Formation (interbedded TSP and Ash)
- CS Chlorite Schist (derived from ash rock)
- SS Sericite Schist (derived from TSP and Crystal Tuff)
- Q Vein Quartz
- QP Quartz Porphyry (dikelet)

**SYMBOLS**

- Geological Contact
- Attitude - foliation and for bedding
- Sheared or schistified



**GEOLOGY MAP**  
SHERIDAN CLAIMS  
DELORO TOWNSHIP  
PORCUPINE MINING DIVISION  
ONTARIO  
SCALE: 1IN=20FT. AUG 1987

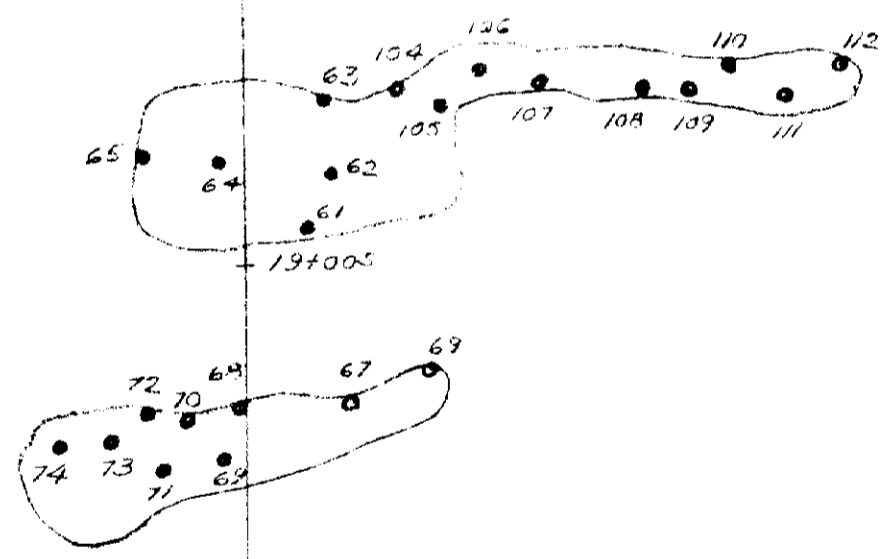
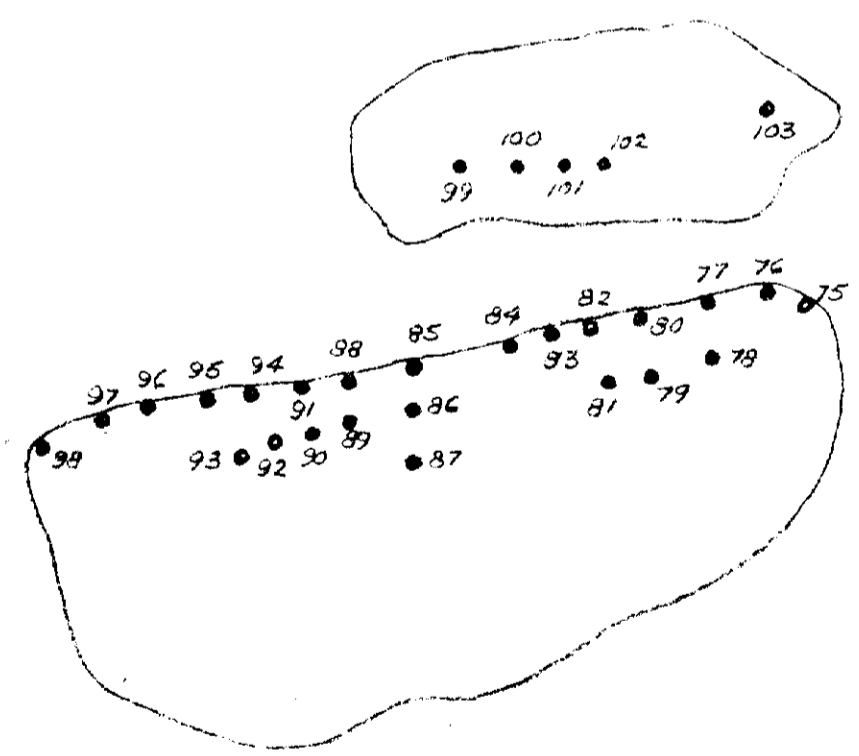
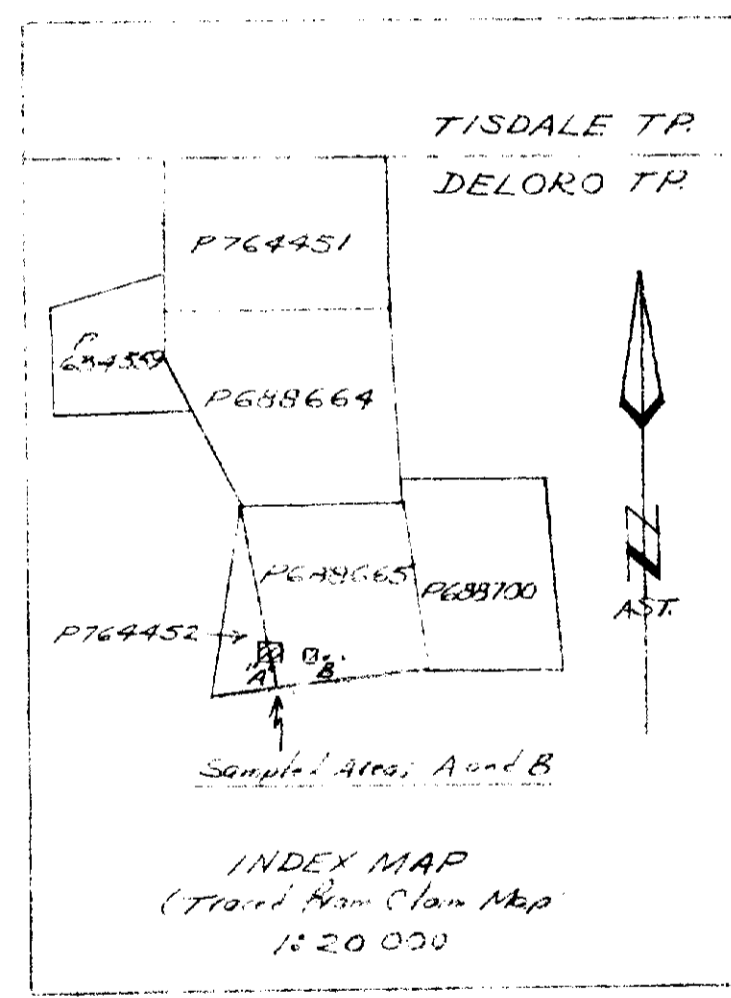
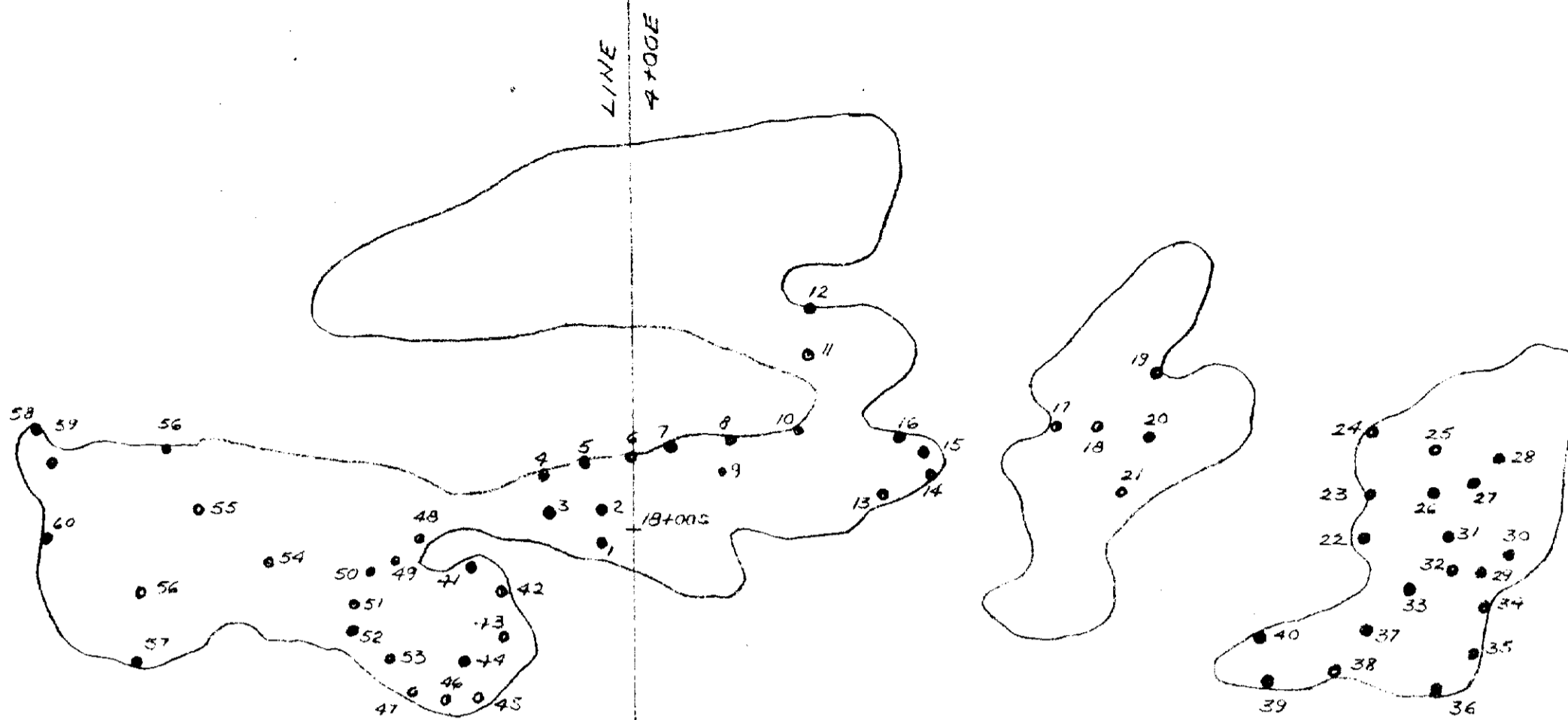

**SAMPLES LOCATION PLAN**  
 SHERIDAN CLAIMS  
 DELOORO TOWNSHIP  
 PORCUPINE MINING DIVISION  
 ONTARIO  
 SCALE 1:11=20' 1" AUG 1987

SYMBOLS  
 ● 37 Sample Location and Number  
 ○ Rock Outcrop - Partially overburdened

