



42A06NE2003 2.19649 SHAW

010

2 19649

ASSESSMENT WORK REPORT

CROXALL-VUKSANOVICH PROPERTY

SHAW TOWNSHIP- PORCUPINE MINING DIVISION

On October 9, 1998 Denis Alarie, President of Leo Alarie and Sons Limited of Timmins walked due east from the Langmuir Road to claim P.1229264. He intercepted the north-south flagged and measured baseline previously installed by J.Croxall, recorded holder and his partner E.Vuksanovich in late September 1998. The property had been offered for option to Alarie and Sons by the property owners.

Mr. Alarie sampled in an east to west direction across the main silica (chert) showing from the north end of the flagged baseline installed earlier by the property owners. He also took two samples earlier about 450' south and 50' west of the baseline. The samples are numbered from 1 to 13 and their locations are as shown in Figure 3B attached. He submitted the samples to XRAL Laboratories for whole rock analyses. The results are attached to this work report.

J.Croxall and E.Vuksanovich reviewed the reference samples kept by Alarie and concluded the following:

- 1) Sample 13 was the hostrock andesite and not the chert.
- 2) "DUP1" is excluded from the calculated average grade to be conservative.
- 3) Samples 2 and 5 have uncharacteristic Fe₂O₃ contents and were taken from atypical, isolated rusty patches within the chert.
- 4) The 9 remaining samples are believed to be typical of the bulk of the exposed chert bedrock in the main showing area. Their free silica content ranged from 94.3% to 99.9% and averaged 98.37%.

An option agreement was signed between the property owners and Leo Alarie and Sons Limited on February 9, 1999. Alarie had additional assessment work performed in May 1999 (\$4397 as geological and geophysical mapping) and it was filed separately by Alarie. (w9960.00303).

J. E. Croxall
J.E. Croxall, P.Eng.

Recorded holder of the property

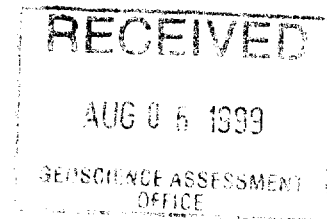

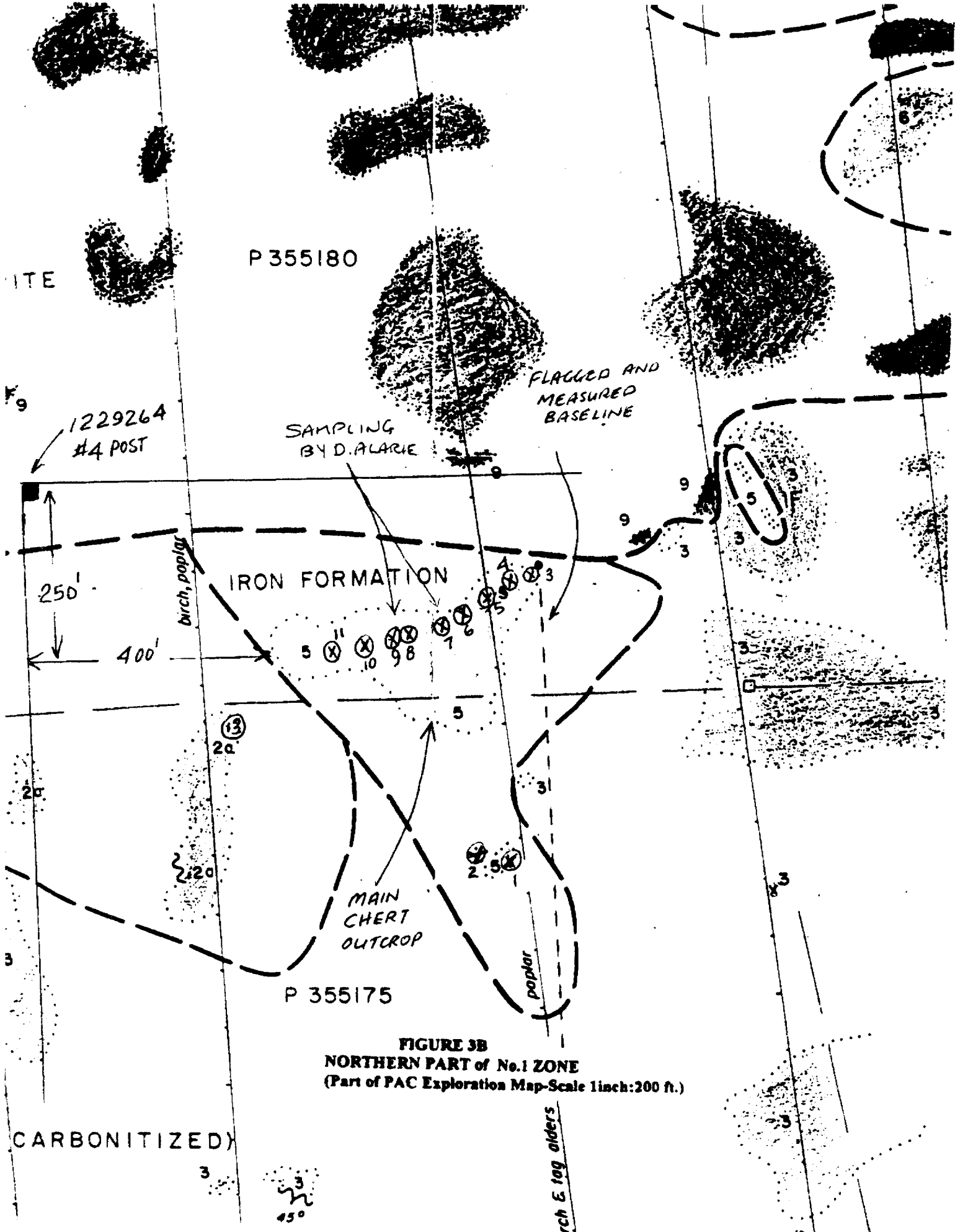

P 355180

ITE

F₉

1229264
#4 POST

SAMPLING
BY D. ALARIE

FLAGGED AND
MEASURED
BASELINE

IRON FORMATION

birch, poplar

250'

400'

MAIN
CHERT
OUTCROP

poplar

P 355175

FIGURE 3B
NORTHERN PART of No. 1 ZONE
(Part of PAC Exploration Map-Scale 1inch:200 ft.)

CARBONITIZED)

rich & tall alders

45°

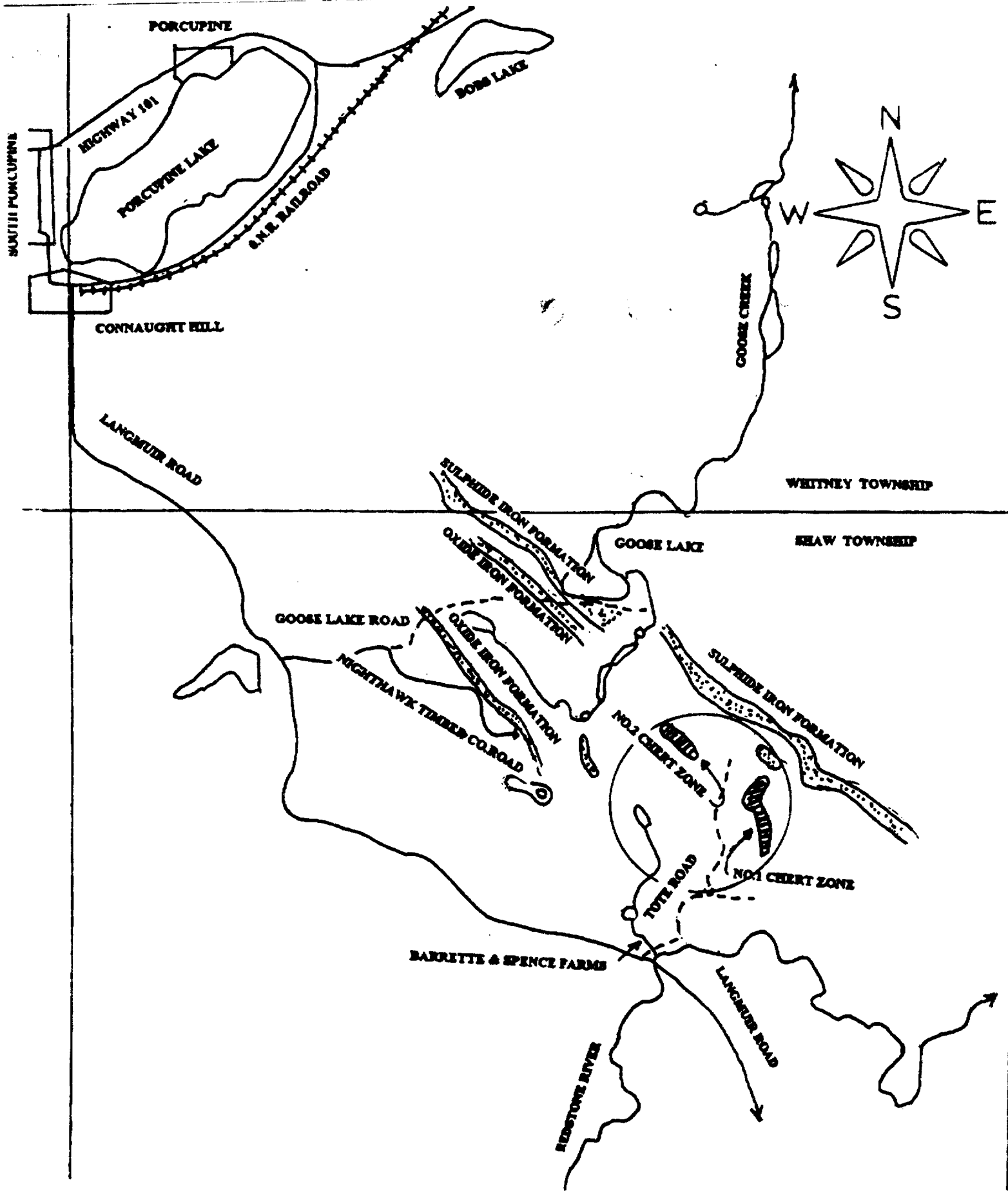

FIGURE 1 C-V PROPERTY LOCATION MAP

SCALE: 1CM: 0.5KM

ALARIE

OCT-28-98 MON 11:08 AM XRAL LABORATORIES FAX NO. 418494192

10 P. 74101

Shaw TWR

SEND BY FAX ORIGINAL TO BE FORWARDED Yes No Special Instructions 262-434 Date 26-10-98 Operator

Cr Only Page 1 of 1

Fe Only

PRELIMINARY

Work Order: 052696 Date: 26/10/98



XRAL Laboratories A Division of SGS Canada Inc.

1 705 2682541 P. 01/01

Element Method of Lim. Unit

1 2 3 TOP OF BASELINE 4 HAT 45 WEST 5 90 WEST 6 135 WEST 7 180 WEST 8 240 WEST 9 260 WEST 10 11 13 -> Host Analysis -> *Dup 1

Table with 13 columns: SiO2, Al2O3, CaO, MgO, Na2O, K2O, Fe2O3, MnO, TiO2, P2O5, Cr2O3, LOI. Rows 1-13 containing analytical data.

Invoice/Facture No.: 081:028070



XRAL Laboratories
A Division of SGS Canada Inc.

INVOICE

Invoice To/Facture A:
Leo Alarie & Sons Limited
Attn: Jan Luthe
P.O. Box 912
Highway 101 West
TIMMINS
ONTARIO, CANADA P4N 7H1

Submitted By/Soumettez Par:
Leo Alarie & Sons Limited
Attn: Jan Luthe
P.O. Box 912
Highway 101 West
TIMMINS
ONTARIO, CANADA P4N 7H1

Work Order: 052696
Invoice Date: 28/10/98
Date Submitted: 15/10/98
Shipped Via: Purrolator

Customer No.: 050081
Your P.O. No.: 263005
Your Project No.: 26065
Waybill No.: 12313424850

Qty	Code	Description	# Ele	Unit Cost	Amt/Montant
12	PC02	Crushing entire sample		\$2.90	\$34.80
12	PP02	Milling 200g in Cr steel		\$2.65	\$31.80
12	ICP95	ICP, Lithium Metaborate Fusion	13	\$11.50	\$138.00
1	AD25	Fax Charge		\$9.00	\$9.00
		Sub Total			----- \$213.60
	GST	7% GST Reg No. R105082572 Applied.			\$14.95 -----

"COPY"

TOTAL IN CANADIAN FUNDS / TOTAL EN DOLLARS CANADIEN \$228.55

Please remit to / S.V.P. envoyer votre paiement à:
P.O. Box 9581
Station 'A'
Toronto, ON
Canada
M5W 2K3

Please courier to / S.V.P. envoyer par courier à:
1885 Leslie Street
Don Mills, ON
Canada M3B 3J4
Tel: (416) 445-5755
Fax: (416) 445-4152

Please Quote Invoice Number / S.V.P. Spécifier le numéro de facture 081:028070

Note/N.B.: 1.5% per month interest on Overdue Accounts / Intérêt de sur Comptes Arriérés de 1.5% Par Mois: Terms Net 30 days

ORIGINAL INVOICE



42A06NE2003 2.19649 SHAW 900

riority of subsections 65(2) and 66(3) of the Mining Act. Under section 8 of the act to review the assessment work and correspond with the mining land holder. Mining Recorder, Ministry of Northern Development and Mines, 6th Floor,

Instructions: - For work performed on Crown Lands before recording a claim, use form 0240.
 - Please type or print in ink.

2.19649

1. Recorded holder(s) (Attach a list if necessary)

Name <i>JAMES E. CROXALL</i>	Client Number <i>122685</i>
Address <i>152 BROCK AVE.</i>	Telephone Number <i>(705)-267-4314</i>
<i>TIMMINS, ONT, P4N7P1</i>	Fax Number <i>(705)-267-4314</i>
Name	Client Number
Address	Telephone Number
	Fax Number

2. Type of work performed: Check (✓) and report on only ONE of the following groups for this declaration.

Geotechnical: prospecting, surveys, assays and work under section 18 (regs) Physical: drilling, stripping, trenching and associated assays Rehabilitation

Work Type <i>SAMPLING & ASSAYS</i>	Office Use
	Commodity
	Total \$ Value of Work Claimed <i>329.00</i>
Dates Work Performed From <i>9</i> Day <i>10</i> Month <i>98</i> Year To <i>28</i> Day <i>10</i> Month <i>98</i> Year	NTS Reference
Global Positioning System Data (if available)	Mining Division <i>Porcupine</i>
Township/Area <i>SHAW TWP.</i>	Resident Geologist District
M or G-Plan Number <i>G-3999</i>	

Please remember to: - obtain a work permit from the Ministry of Natural Resources as required;
 - provide proper notice to surface rights holders before starting work;
 - complete and attach a Statement of Costs, form 0212;
 - provide a map showing contiguous mining lands that are linked for assigning work;
 - include two copies of your technical report.

3. Person or companies who prepared the technical report (Attach a list if necessary)

Name <i>J. CROXALL</i>	Telephone Number <i>705-267-4314</i>
Address <i>152 BROCK AVE., TIMMINS, ONT., P4N7P1</i>	Fax Number <i>705-267-4314</i>
Name	Telephone Number
Address	Fax Number
Name	Telephone Number
Address	Fax Number

RECORDED
 AUG - 5 1999

RECORDED
 (c)
 AUG 5 1999
 TB 10:30
 PORCUPINE MINING DIVISION

4. Certification by Recorded Holder or Agent

I, *JAMES E. CROXALL*, do hereby certify that I have personal knowledge of the facts set forth in this Declaration of Assessment Work having caused the work to be performed or witnessed the same during or after its completion and, to the best of my knowledge, the annexed report is true.

Signature of Recorded Holder or Agent: *J. E. Croxall* *Deemed Nov 03/99*

Agent's Address: *152 BROCK AVE., TIMMINS, ONT., P4N7P1*

RECEIVED
 AUG 5 1999
 GEOSCIENCE ASSESSMENT OFFICE
 Telephone Number: *705-267-4314*

Date: *JULY 23/99*
 Fax Number: *705-267-4314*

5. Work to be recorded and distributed. Work can only be assigned to claims that are contiguous (adjoining the mining land where work was performed, at the time work was performed. A map showing the contiguous link must accompany this form.

W 9960-00 322

eg	Mining Claim Number. Or if work was done on other eligible mining land, show in this column the location number indicated on the claim map.	Number of Claim Units. For other mining land, list hectares.	Value of work performed on this claim or other mining land.	Value of work applied to this claim.	Value of work assigned to other mining claims.	Bank. Value of work to be distributed at a future date.
eg	TB 7827	16 ha	\$26,825	N/A	\$24,000	\$2,825
eg	1234567	12	0	\$24,000	0	0
eg	1234568	2	\$8,892	\$4,000	0	\$4,892
1	1229264	1	\$228.55	0	\$228.55	
2	1229265	1	0	\$228.55	-	
3						
4						
5						
6						
7						
8						
9						
10						
11						
12						
13						
14						
15						
Column Totals			\$228.55	228.55	228.55	

RL
Al

RECORDED
AUG - 5 1999

I, JAMES E. CROXALL, do hereby certify that the above work credits are eligible under subsection 7 (1) of the Assessment Work Regulation 6/96 for assignment to contiguous claims or for application to the claim where the work was done.

Signature of Recorded Holder or Agent Authorized in Writing: J. E. Croxall Date: July 23/99

6. Instructions for cutting back credits that are not approved.

Some of the credits claimed in this declaration may be cut back. Please check (✓) in the boxes below to show how you wish to prioritize the deletion of credits:

- 1. Credits are to be cut back from the Bank first, followed by option 2 or 3 or 4 as indicated.
- 2. Credits are to be cut back starting with the claims listed last, working backwards; or
- 3. Credits are to be cut back equally over all claims listed in this declaration; or
- 4. Credits are to be cut back as prioritized on the attached appendix or as follows (describe):

Note: If you have not indicated how your credits are to be deleted, credits will be cut back from the Bank first, followed by option number 2 if necessary.

For Office Use Only Received Stamp AUG 5 1999	Deemed Approved Date	RECEIVED AUG 5 1999 GEOLOGICAL SURVEY OF CANADA OFFICE	Date Notification Sent
	Date Approved		Approved
Approved for Recording by Mining Recorder (Signature)			

I, JAMES E. CROXALL, do hereby certify, that the amounts shown are as accurate as may reasonably
(please print full name)
be determined and the costs were incurred while conducting assessment work on the lands indicated on the accompanying

Declaration of Work form as RECORDED HOLDER I am authorized to make this certification.
(recorded holder, agent, or state company position with signing authority)

0212 (03/97)

Signature <i>J. E. Croxall</i>	Date July 23/99
-----------------------------------	--------------------

RECORDED
AUG - 5 1999

2.19649

RECEIVED
AUG 26 1999
GEOSCIENCE ASSESSMENT
OFFICE

Geoscience Assessment Office
933 Ramsey Lake Road
6th Floor
Sudbury, Ontario
P3E 6B5

Telephone: (888) 415-9846
Fax: (877) 670-1555

August 30, 1999

JAMES ERNEST CROXALL
152 BROCK AVENUE
TIMMINS, ONTARIO
P4N-7P1

Visit our website at:
www.gov.on.ca/MNDM/MINES/LANDS/mlsmnpge.htm

Dear Sir or Madam:

Submission Number: 2.19649

Status

Subject: Transaction Number(s): W9960.00322 Deemed Approval

We have reviewed your Assessment Work submission with the above noted Transaction Number(s). The attached summary page(s) indicate the results of the review. **WE RECOMMEND YOU READ THIS SUMMARY FOR THE DETAILS PERTAINING TO YOUR ASSESSMENT WORK.**

If the status for a transaction is a 45 Day Notice, the summary will outline the reasons for the notice, and any steps you can take to remedy deficiencies. The 90-day deemed approval provision, subsection 6(7) of the Assessment Work Regulation, will no longer be in effect for assessment work which has received a 45 Day Notice. Allowable changes to your credit distribution can be made by contacting the Geoscience Assessment Office within this 45 Day period, otherwise assessment credit will be cut back and distributed as outlined in Section #6 of the Declaration of Assessment work form.

Please note any revisions must be submitted in DUPLICATE to the Geoscience Assessment Office, by the response date on the summary.

If you have any questions regarding this correspondence, please contact Bruce Gates by e-mail at bruce.gates@ndm.gov.on.ca or by telephone at (705) 670-5856.

Yours sincerely,



ORIGINAL SIGNED BY
Blair Kite
Supervisor, Geoscience Assessment Office
Mining Lands Section

Work Report Assessment Results

Submission Number: 2.19649

Date Correspondence Sent: August 30, 1999

Assessor: Bruce Gates

Transaction Number	First Claim Number	Township(s) / Area(s)	Status	Approval Date
W9960.00322	1229264	SHAW	Deemed Approval	August 26, 1999

Section:
17 Assays ASSAY

Correspondence to:
Resident Geologist
South Porcupine, ON

Recorded Holder(s) and/or Agent(s):
JAMES ERNEST CROXALL
TIMMINS, ONTARIO

Assessment Files Library
Sudbury, ON

MAP SYMBOLOLOGY

Aerial Cableway	Pipeline (above ground)
Boundary	Railroad
International	Single Track
District, Township	Double Track
Approximate	Abandoned
Lot, Concession	Turbine
Approximate	Road
Park Boundary	Highway, County
Bridge	Township
Rock, Railroad	Along (road of easement or easement of significant drainage)
Building	Traffic, Bush Road (average width)
Chimney	Rapids
Cliff, Pit, Pile	Double line river with multiple rapids
Contours	Approximate location of flow
Intermittent	Rock
Approximate	Significant
Discharge	Shoal
Control Points	Spot Elevation (from sea level) 300.0
Horizontal	Tower
Vertical	Transmission Line
Culvert	Power
Falls	Tunnel
Double line river	Utility Poles
Fence, Hedge, Wall	Wharf, Dock, Pier
Feature Outline (Classification Features, etc.)	Wooded Area
Flooded Land	
Lock	
Marsh or Swamp	
Moat	
Mine Head Frame	
Outcrop	

AREAS WITHDRAWN FROM DISPOSITION

M.R.O. - MINING RIGHTS ONLY				
S.R.O. - SURFACE RIGHTS ONLY				
M.S. - MINING AND SURFACE RIGHTS				
Description	Order No.	Date	Disposition	File
REC PURP	SEC 3 PLA			188543
	W 9777	15/12/77	S.R.O.	86555

SAND AND GRAVEL

GRAVEL	65868
GRAVEL	66780

THE INFORMATION THAT APPEARS ON THIS MAP HAS BEEN COMPILED FROM VARIOUS SOURCES, AND ACCURACY IS NOT GUARANTEED. THOSE WISHING TO STAKE MINING CLAIMS SHOULD CONSULT WITH THE MINING RECORDER, MINISTRY OF NORTHERN DEVELOPMENT AND MINES.

WHITNEY TWP.

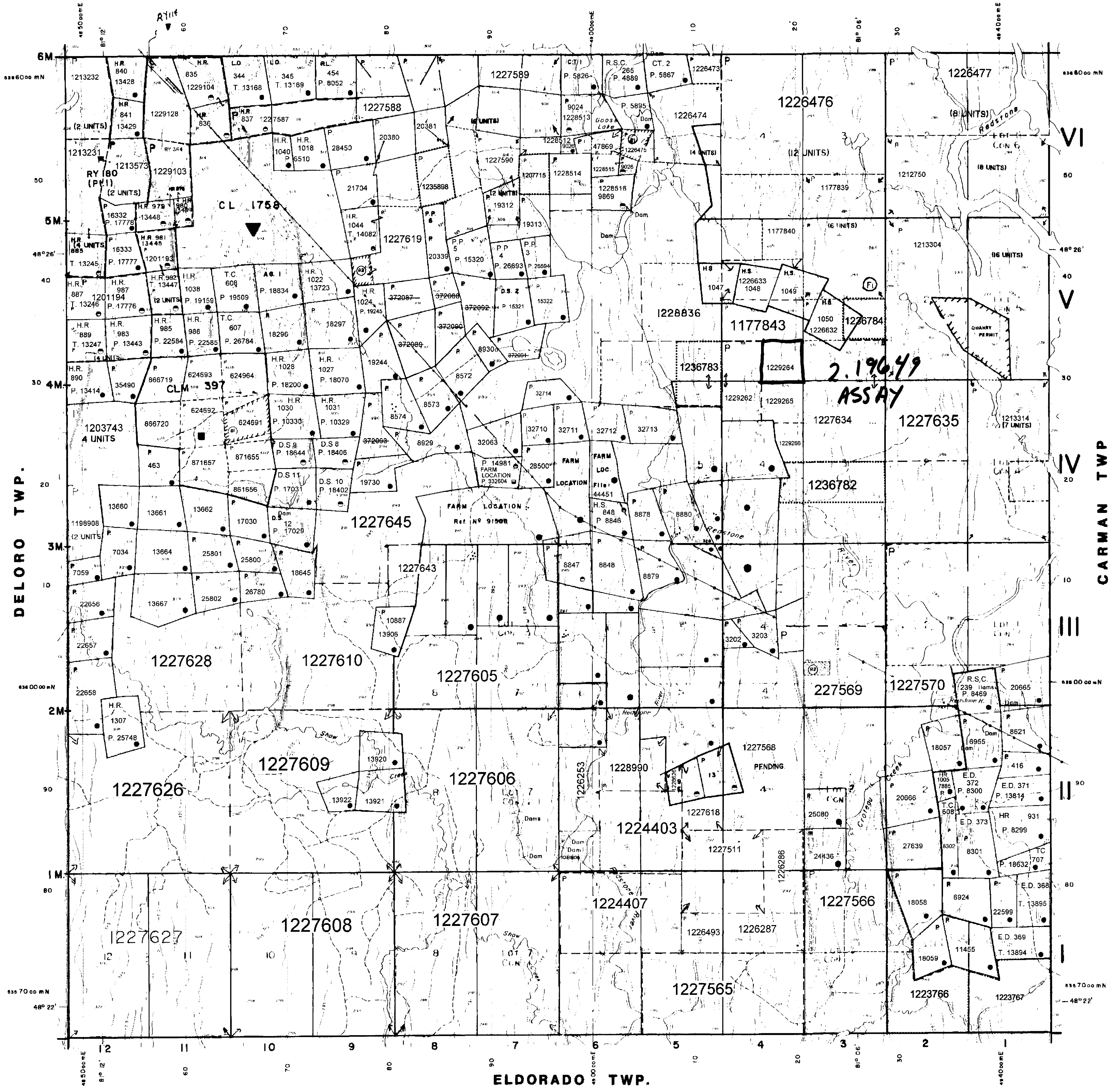

LEGEND

HIGHWAY AND ROUTE No.	
OTHER ROADS	
TRAILS	
SURVEYED LINES	
TOWNSHIPS, BASE LINES, ETC.	
LOTS, MINING CLAIMS, PARCELS, ETC.	
UNSURVEYED LINES	
LOT LINES	
PARCEL BOUNDARY	
MINING CLAIMS ETC.	
RAILWAY AND RIGHT OF WAY	
UTILITY LINES	
NON PERENNIAL STREAM	
FLOODING OR FLOODING RIGHTS	
SUBDIVISION OR COMPOSITE PLAN	
RESERVATIONS	
ORIGINAL SHORELINE	
MARSH OR MUSKEG	
MINES	
TRAVERSE MONUMENT	

DISPOSITION OF CROWN LANDS

TYPE OF DOCUMENT	SYMBOL
PATENT SURFACE & MINING RIGHTS	
SURFACE RIGHTS ONLY	
MINING RIGHTS ONLY	
LEASE SURFACE & MINING RIGHTS	
SURFACE RIGHTS ONLY	
MINING RIGHTS ONLY	
LICENCE OF OCCUPATION	
ORDER IN COUNCIL	
RESERVATION	
CANCELLED	
SAND & GRAVEL	

NOTE: MINING RIGHTS IN PARCELS PATENTED PRIOR TO MAY 8, 1913, VESTED IN ORIGINAL PATENTEE BY THE PUBLIC LANDS ACT, R.S.O. 1970, CHAP. 380, SEC. 63, SUBSEC. 1

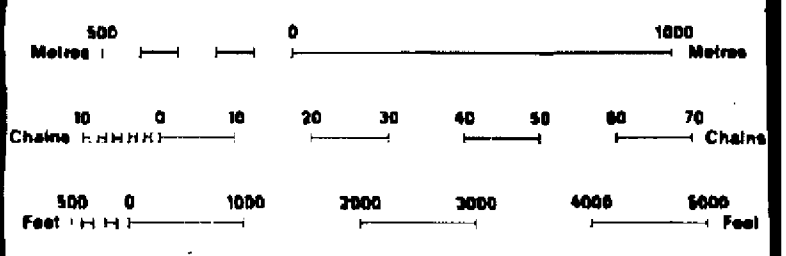

SCALE 1:20 000
GRID ZONE: 17

THE INFORMATION THAT APPEARS ON THIS MAP HAS BEEN COMPILED FROM VARIOUS SOURCES, AND ACCURACY IS NOT GUARANTEED.

OCT 6 1999

THOSE WISHING TO STAKE MINING CLAIMS SHOULD CONSULT WITH THE MINING RECORDER, MINISTRY OF NORTHERN DEVELOPMENT AND MINES, FOR ADDITIONAL INFORMATION ON THE STATUS OF THE LANDS SHOWN HEREON.

TOWNSHIP
SHAW
M.N.R. ADMINISTRATIVE DISTRICT
TIMMINS
MINING DIVISION
PORCUPINE
LAND TITLES / REGISTRY DIVISION
COCHRANE



ORIGINAL JULY 1984
COMPILED IN SERVICE DEC 5, 1999
REVISED
CHECKED BY: [Signature]
Number: **G-3999**